



DEPARTMENT OF REGULATORY AND ECONOMIC RESOURCES (RER)
BOARD AND CODE ADMINISTRATION DIVISION

MIAMI-DADE COUNTY
PRODUCT CONTROL SECTION
11805 SW 26 Street, Room 208
Miami, Florida 33175-2474
T (786) 315-2590 F (786) 315-2599

www.miamidade.gov/economy

NOTICE OF ACCEPTANCE (NOA)

Green-Span Profiles, L.P.
21200 FM 362
Waller, TX 77484

SCOPE:

This NOA is being issued under the applicable rules and regulations governing the use of construction materials. The documentation submitted has been reviewed and accepted by Miami-Dade County RER- Product Control Section to be used in Miami Dade County and other areas where allowed by the Authority Having Jurisdiction (AHJ).

This NOA shall not be valid after the expiration date stated below. The Miami-Dade County Product Control Section (In Miami Dade County) and/or the AHJ (in areas other than Miami Dade County) reserve the right to have this product or material tested for quality assurance purposes. If this product or material fails to perform in the accepted manner, the manufacturer will incur the expense of such testing and the AHJ may immediately revoke, modify, or suspend the use of such product or material within their jurisdiction. RER reserves the right to revoke this acceptance, if it is determined by Miami-Dade County Product Control Section that this product or material fails to meet the requirements of the applicable building code.

This product is approved as described herein, and has been designed to comply with the High Velocity Hurricane Zone of the Florida Building Code.

DESCRIPTION: "IWP Series" Insulated Steel Wall Panel

APPROVAL DOCUMENT: Drawing No. 438-0086T-13, titled "IWP Series", sheets 1 through 14 of 14, prepared by Brian N. Jaks, P.E., dated May 29, 2015, signed and sealed by Brian N. Jaks, P.E., on June 10, 2015, bearing the Miami-Dade County Product Control Approval stamp with the Notice of Acceptance number and the approval date by the Miami-Dade County Product Control Section.

MISSILE IMPACT RATING: Large and Small Missile Impact Resistant

LABELING: Each panel shall bear a permanent label with the manufacturer's name or logo, city, state and the following statement: "Miami-Dade County Product Control Approved", unless otherwise noted herein.

RENEWAL of this NOA shall be considered after a renewal application has been filed and there has been no change in the applicable building code negatively affecting the performance of this product.

TERMINATION of this NOA will occur after the expiration date or if there has been a revision or change in the materials, use, and/or manufacture of the product or process. Misuse of this NOA as an endorsement of any product, for sales, advertising or any other purposes shall automatically terminate this NOA. Failure to comply with any section of this NOA shall be cause for termination and removal of NOA.

ADVERTISEMENT: The NOA number preceded by the words Miami-Dade County, Florida, and followed by the expiration date may be displayed in advertising literature. If any portion of the NOA is displayed, then it shall be done in its entirety.

INSPECTION: A copy of this entire NOA shall be provided to the user by the manufacturer or its distributors and shall be available for inspection at the job site at the request of the Building Official.

This NOA consists of this page 1, evidence submitted page E-1 as well as approval document mentioned above.

The submitted documentation was reviewed by **Helmy A. Makar, P.E., M.S.**



Helmy A. Makar
01/14/2016

NOA No. 15-0204.02
Expiration Date: 01/14/2021
Approval Date: 01/14/2016
Page 1

Green-Span Profiles, L.P.

NOTICE OF ACCEPTANCE: EVIDENCE SUBMITTED

A. DRAWINGS

1. *Drawing No. 438-0086T-13, titled "IWP Series", sheets 1 through 14 of 14, prepared by Brian N. Jaks, P.E., dated May 29, 2015, signed and sealed by Brian N. Jaks, P.E., on June 10, 2015.*

B. TESTS

1. *Test report on Large Missile Impact Test per TAS 201, Cyclic Wind Pressure Test per TAS 203, and Uniform Static Air Pressure Test per TAS 202 on Exterior Steel Insulated Wall Panel, prepared by Force Engineering & Testing, Inc., Report No. 438-0086T-13, dated 12/09/2013, signed by Brandon Jasek, P.E.*
2. *Test report on Large Missile Impact Test per TAS 201, Cyclic Wind Pressure Test per TAS 203, on Exterior Steel Insulated Wall Panel, prepared by Force Engineering & Testing, Inc., Report No. 438-0239T-15, dated 10/12/2015, signed by Brandon Jasek, P.E.*

C. CALCULATIONS

1. *Calculations, 10 pages, prepared by Brian N. Jaks, P.E., dated October 13, 2014, signed and sealed by Brian N. Jaks, P.E., on October 13, 2014.*

D. QUALITY ASSURANCE

1. *By Miami-Dade County Department of Regulatory and Economic Resources.*

E. MATERIAL CERTIFICATIONS

1. *Tensile Test Data issued by Metallurgical Engineering Services, Inc., for Interior Skin, dated October 27, 2015, with mechanical properties of Sheet Steel.*
2. *Tensile Test Data issued by Metallurgical Engineering Services, Inc., for Exterior Skin, dated October 27, 2015, with mechanical properties of Sheet Steel.*
3. *Accelerated Weathering 2000 hours per ASTM D 659, Humidity test 1000 hours per ASTM D 1654, Salt Spray test per ASTM D 1654.*



Helmy A. Makar, P.E., M.S.
Product Control Section Supervisor
NOA No. 15-0204.02
Expiration Date: 01/14/2021
Approval Date: 01/14/2016

Approval Document for Miami-Dade Notice of Acceptance

Applicant: Green-Span Profiles, LP
Category: Panels
Subcategory: Wall
Material: Composite
Description: IWP Series (Insulated Wall Panels)
Interior/Exterior Material: Steel
Core Material: Polyisocyanurate Foam

RECEIVED
MAY 15 2015
MAY 15 2015
MAY 15 2015

Approved as complying with the
Florida Building Code
Date 01/14/2016
NOA# 15-0204.02
Miami Dade Product Control

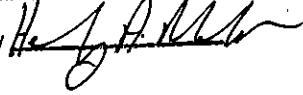
By 

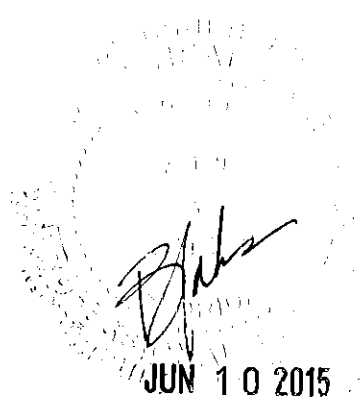

JUN 10 2015



1. Compliance Statement – The product as described in this document demonstrated compliance with the Florida Building Code 2014, HVHZ.
2. Product Description – Wall panel system with an interior and exterior steel facing bonded to an insulating polyisocyanurate foam core. A concealed clip in the interlocking side-joint attaches the wall panels to supports. Structural application.
3. Panel: Green Span's IWP Series
 - 3.1. Profiles
 - 3.1.1. MesaLine
 - 3.1.2. VeeLine
 - 3.1.3. ShadowLine
 - 3.1.4. WaveLine
 - 3.1.5. Impression
 - 3.1.6. Stucco
 - 3.1.7. Infinity
 - 3.2. Thicknesses
 - 3.2.1. 2"
 - 3.2.2. 2.5"
 - 3.2.3. 3"
 - 3.2.4. 4"
 - 3.2.5. 5"
 - 3.2.6. 6"
 - 3.3. Widths: 42" maximum
 - 3.4. Side-joint: Green-Lock, interlocking double tongue-and-groove joint
 - 3.5. Materials
 - 3.5.1. Metal Facings
 - 3.5.1.1. Steel, ASTM A792 Galvalume coated or ASTM A653 G90 galvanized
 - 3.5.1.2. 50-ksi min. yield
 - 3.5.1.3. 26-ga. min
 - 3.5.1.4. Embossed or smooth finish
 - 3.5.2. Core
 - 3.5.2.1. Polyisocyanurate (PIR) insulating foam
 - 3.5.2.2. Huntsman Rubitherm WR 40618 / Rubinate 1850
 - 3.5.2.3. Non-ozone depleting blowing agent
 - 3.5.2.4. Nominal 2.25-pcf apparent density
 - 3.5.3. Concealed Clip
 - 3.5.3.1. Corrosion resistant G90 galvanized steel
 - 3.5.3.2. 14 gauge thickness
 - 3.5.3.3. 1 7/16" x 4" with (5) pre-punched holes
 - 3.5.4. Clip Fastener
 - 3.5.4.1. (2) ¼-14 self-driller, corrosion resistant
 - 3.5.5. Panel Fastener
 - 3.5.5.1. (3) 10-12 Fab-Lok

15 JUN 15 PM 0:27
 15 JUN 15 PM 0:27
 15 JUN 15 PM 0:27

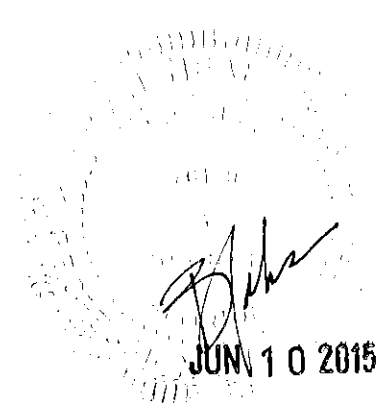
Approved as complying with the
 Florida Building Code
 Date 01/14/2016
 NOA# 15-0204.02
 Miami-Dade Product Control
 By H. A. M. M.

 JUN 10 2015

4. Substrate:
 - 4.1. 14-ga. minimum thickness
 - 4.2. Spaced at maximum 5'-0" on center

5. Performance
 - 5.1. TAS 201
 - 5.1.1. Large Missile Impact
 - 5.1.2. Passed
 - 5.2. TAS 203
 - 5.2.1. Cyclic Wind Pressure
 - 5.2.2. Passed
 - 5.3. TAS 202
 - 5.3.1. Design Wind Load
 - 5.3.1.1. Positive: +75-psf
 - 5.3.1.2. Negative: -75-psf
 - 5.3.2. Air Infiltration – passed
 - 5.3.3. Water Infiltration – passed
 - 5.4. ASTM E-84
 - 5.4.1. Flame Spread < 25
 - 5.4.2. Passed
 - 5.4.3. Smoke Developed < 450
 - 5.4.4. Passed
 - 5.5. ASTM D 3361
 - 5.5.1. Accelerated Weathering for 2000 hours
 - 5.5.2. Passed
 - 5.6. ASTM B 117
 - 5.6.1. Salt Spray for 1000 hours
 - 5.6.2. Passed

6. Identification: Each panel shall bear a permanent label with the manufacturer's name or logo, city, state and the following statement: "Miami-Dade County Product Control Approved."

7. Installation: per manufacturer's instructions and in compliance with attached drawings

8. Limitations of Use
 - 8.1. Panel supports shall be 14-ga. minimum thickness
 - 8.2. Supports shall be spaced at maximum 5'-0" on center
 - 8.3. Minimum (2) fasteners per clip
 - 8.4. Minimum (3) Fabloks installed at 10.5" on center along the interior panel face
 - 8.5. Panels shall not be used as axial or shear components.

Approved as complying with the
 Florida Building Code
 Date 01/14/2016
 NOA# 15-07-04.02
 Miami-Dade Product Control

By 

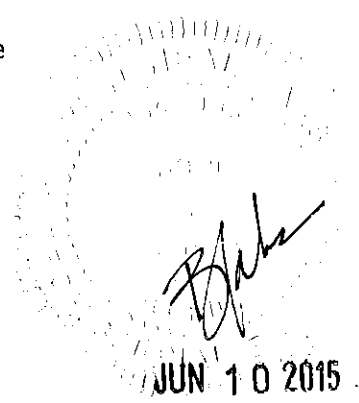

9. Approved Quality Assurance Entity – Factory Mutual

10. Reference Documents

- 10.1. Force Engineering & Testing Report No. 438-0086T-13, dated 12-9-2013
 - 10.1.1. TAS 201
 - 10.1.2. TAS 202
 - 10.1.3. TAS 203
- 10.2. Factory Mutual Approvals, Project ID: 3044381, dated 11-21-2012
 - 10.2.1. ASTM E84

Approved as complying with the
Florida Building Code
Date 01/14/2016
NOA# 15-0204.02
Miami, Dade Product Control

By [Signature]

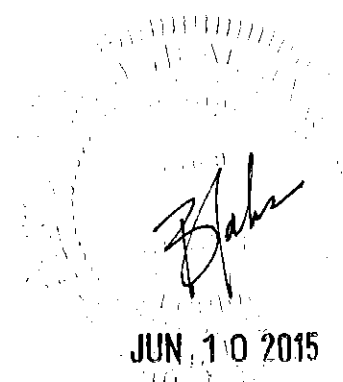



DIM 'A' = 2", 2.5", 3", 4", 5", or 6"

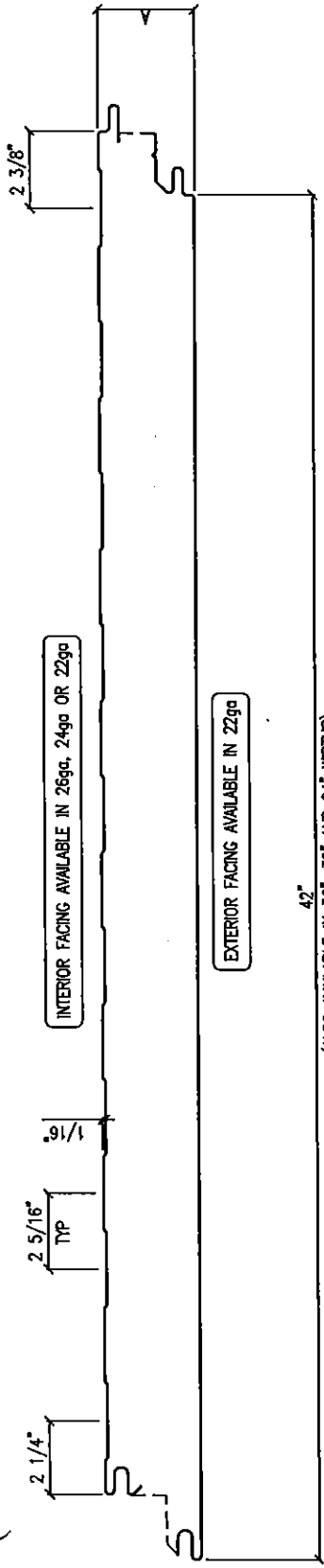

INTERIOR FACING AVAILABLE IN 26ga, 24ga OR 22ga

EXTERIOR FACING AVAILABLE IN 22ga

(ALSO AVAILABLE IN 36", 30" AND 24" WIDTHS)

EXTERIOR FACING HAS A HEAVILY EMBOSSED TEXTURE

Approved as complying with the Florida Building Code Date 01/14/2016 NOA# 15-0204.02 Miami Dade Product Control

Handwritten signature



REVISIONS		IMPRESSION	
DATE	DESCRIPTION	DATE	BY

Handwritten signature and JUN 10 2015 stamp



DIM 'A' = 2", 2.5", 3", 4", 5", or 6"

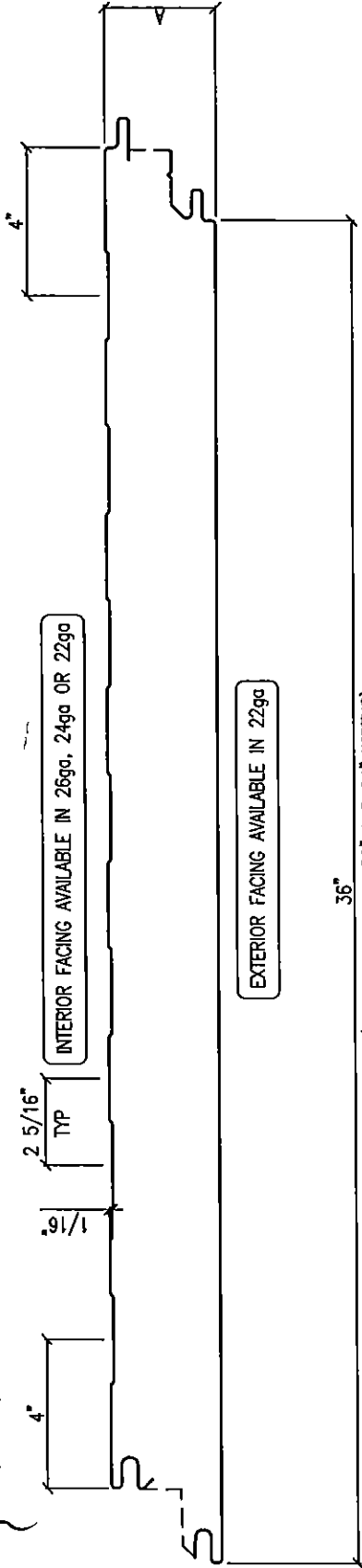

INTERIOR FACING AVAILABLE IN 26ga, 24ga OR 22ga

EXTERIOR FACING AVAILABLE IN 22ga

(ALSO AVAILABLE IN 30" AND 24" WIDTHS)

EXTERIOR FACING IS SMOOTH

Approved as complying with the Florida Building Code
Date 01/14/2016
NOA# 15-0204.02
Miami Dade Product Control

By *[Signature]*



PROFILE	INFINITY
DATE	1-14-12
DESIGNER	DC
SCALE	1/8" = 1'-0"
CHECKED	
APPROVED	
DATE	

REVISIONS	
NO.	DESCRIPTION
1	1-14-12

[Signature]
JUN 10 2015



DIM 'A' = 2", 2.5", 3", 4", 5", or 6"

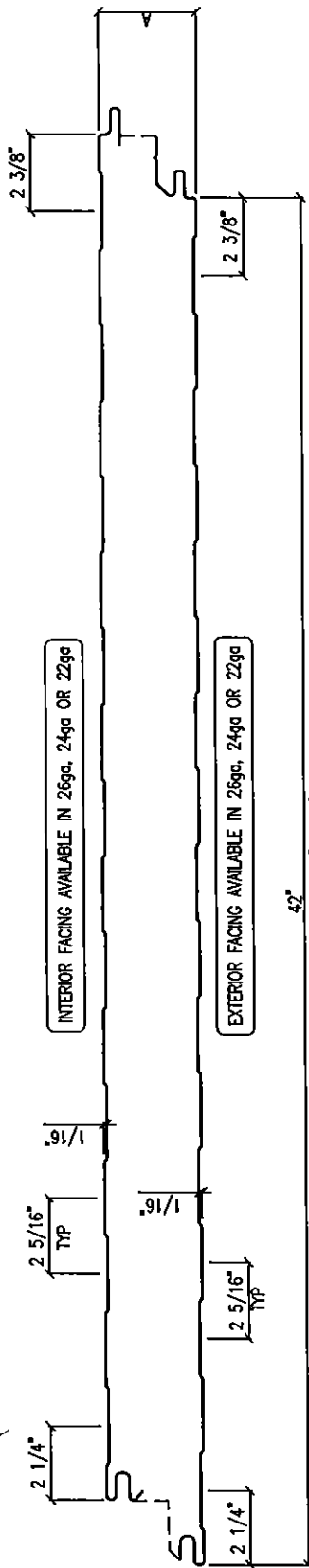

INTERIOR FACING AVAILABLE IN 26ga, 24ga OR 22ga

EXTERIOR FACING AVAILABLE IN 26ga, 24ga OR 22ga

42" (ALSO AVAILABLE IN 36" WIDTH)

Approved as complying with the Florida Building Code Date 01/14/2016 NOA# 15-0204.02 Miami Dade Product Control

By *[Signature]*



REVISIONS		PROFILE	
NO.	DESCRIPTION	DATE	BY
1	ISSUED	1-10-02	
2			
3			
4			
5			
6			
7			
8			
9			
10			

PROFILE	MESALINE	DATE	
DATE	1-10-02	BY	
SCALE	AS SHOWN	ORIGIN	
PROJECT		APPROVED	

[Signature]
JUN 10 2015



DIM 'A' = 2", 2.5", 3", 4", 5", or 6"

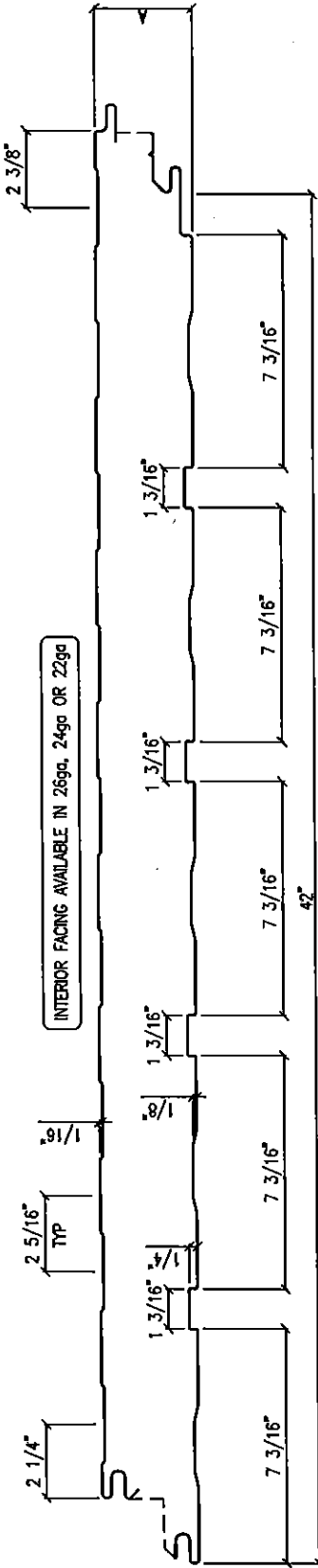

INTERIOR FACING AVAILABLE IN 26ga, 24ga OR 22ga

EXTERIOR FACING AVAILABLE IN 26ga, 24ga OR 22ga

Approved as complying with the
 Florida Building Code
 Date 01/14/2016
 NOA# 15-0204.02
 Miami Dade Product Control

By *[Signature]*



REVISIONS	
NO.	DESCRIPTION

PROJECT: SHADOWLINE	DATE: 1-14-12
DRAWN BY: [Blank]	CHECKED BY: [Blank]
APPROVED BY: [Blank]	DATE: [Blank]

REVISIONS	
NO.	DESCRIPTION

[Signature]
 JUN 10 2015



DIM 'A' = 2", 2.5", 3", 4", 5", or 6"

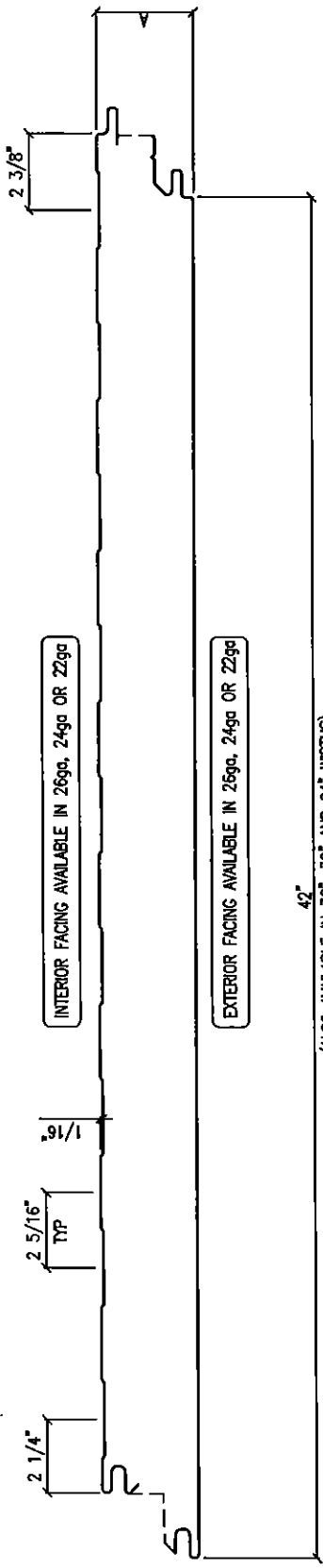

INTERIOR FACING AVAILABLE IN 26ga, 24ga OR 22ga

EXTERIOR FACING AVAILABLE IN 26ga, 24ga OR 22ga

(ALSO AVAILABLE IN 36", 30" AND 24" WIDTHS)

EXTERIOR FACING HAS AN EMBOSSED TEXTURE

Approved as complying with the Florida Building Code
Date 01/14/2016
NOA# 15-0204-02
Miami Dade Product Control

By [Signature]



PROFILE	STUCCO
DATE	1-14-16
DESIGNER	BRN
SCALE	AS SHOWN
OTHER	
REVISED	
DATE	

REVISIONS	DATE

[Signature]
JUN 10 2015



DIM 'A' = 2", 2.5", 3", 4", 5", or 6"

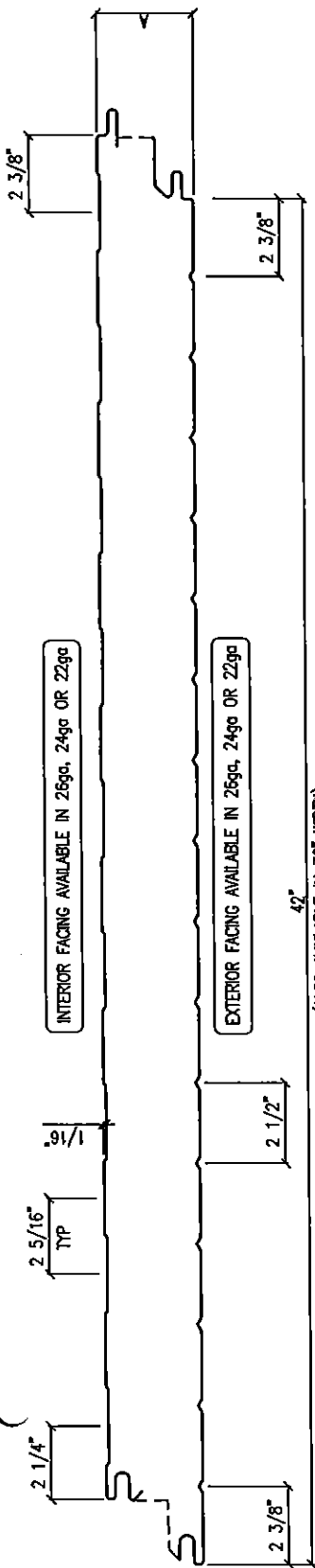

INTERIOR FACING AVAILABLE IN 25ga, 24ga OR 22ga

EXTERIOR FACING AVAILABLE IN 25ga, 24ga OR 22ga

(ALSO AVAILABLE IN 36" WIDTH)

Approved as complying with the Florida Building Code
Date 01/16/2016
NOA# 15-0204.02
Miami Dade Product Control

By *[Signature]*



PROFILE	VEELINE
DATE	1-16-17
DESIGNED BY	
DRAWN BY	
CHECKED BY	
APPROVED BY	
DATE	

REVISIONS	DATE

[Signature]
JUN 10 2015



DIM 'A' = 2", 2.5", 3", 4", 5", or 6"

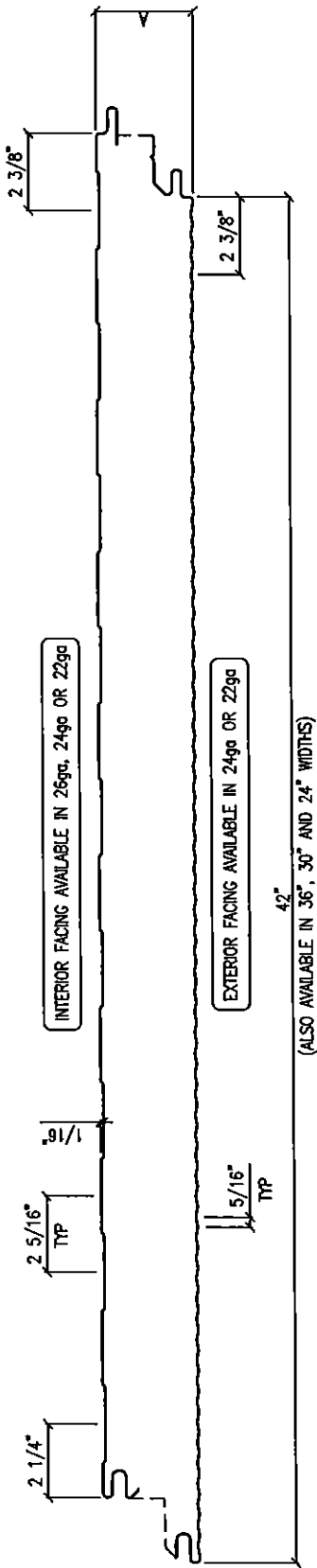

INTERIOR FACING AVAILABLE IN 26ga, 24ga OR 22ga

EXTERIOR FACING AVAILABLE IN 24ga OR 22ga

(ALSO AVAILABLE IN 36", 30" AND 24" WIDTHS)

Approved as complying with the
 Florida Building Code
 Date 01/14/2016
 NOA# 15-0704.02
 Miami Dade Product Control

By [Signature]

REVISIONS		DATE

PROFILE	WAVELINE
DATE	1-14-16
DESIGNER	
DRAWN BY	
CHECKED	
APPROVED	

[Signature]
 JUN 10 2015

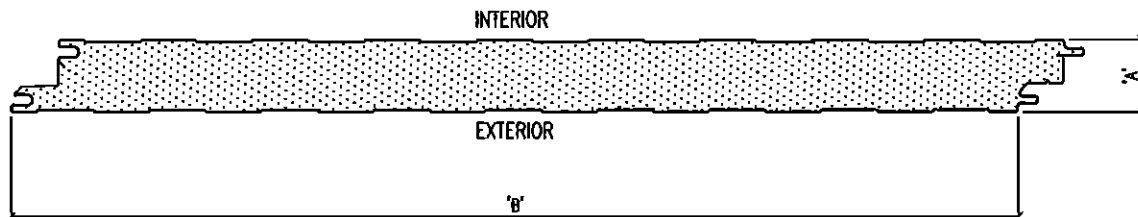

GENERAL PANEL PROFILE
MIN. 26-GA

DIM 'A' = 2", 2.5", 3", 4", 5", or 6"

DIM 'B' = 42", 36", 30" OR 24"

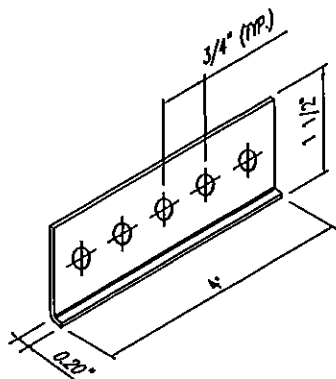

WALL PANEL CLIP [AC-01]
14GA. (0.070") MIN.



1/4-14 X TEK3 SDS FASTENER

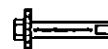

FAB-LOK FASTENER

Approved as complying with the
Florida Building Code

Date 01/14/2016
NOA# 15-0204.02
Miami Dade Product Control

By Herby A. [Signature]

[Signature]

JUN 10 2015

MANUFACTURED BY:

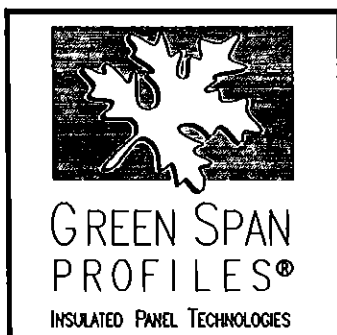

SECTIONS WITH DIMENSIONS AND THICKNESSES

DATE: MARCH 19, 2004	NOTES: CHECK LIST SECTION 'A'
PAGE: 1 OF 3	PRODUCT NAME: IWP SERIES
REVISION: NONE	DOCUMENT NUMBER: 438-0086T-13
	PREPARED BY: BRIAN N. JAKS, FLPE #70159
21200 FM362, WALLER, TEXAS 77484	281-807-7400 WWW.GREENSPANPROFILES.COM

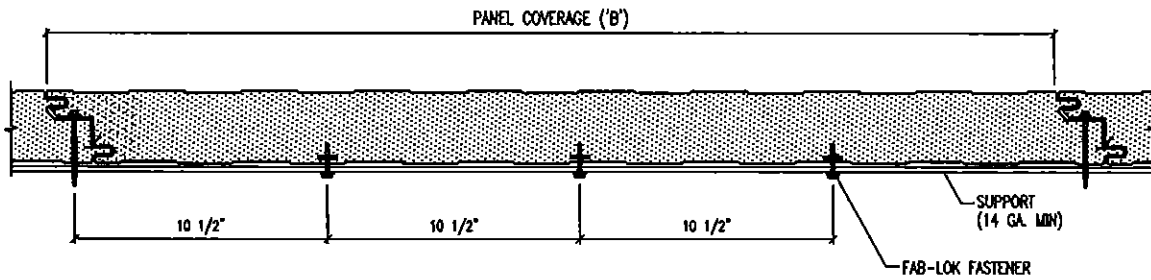

SECTION 'A'-'A': TYPICAL FASTENER PATTERN DIAGRAM

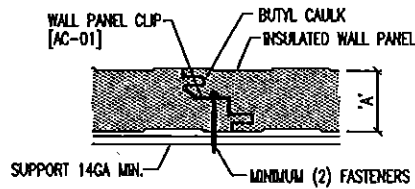

SECTION 'B'-'B': PANEL SIDELAP FASTENING

Approved as complying with the
 Florida Building Code
 Date 01/14/2016
 NOA# 15-0704.02
 Miami Dade Product Control

By *[Signature]*

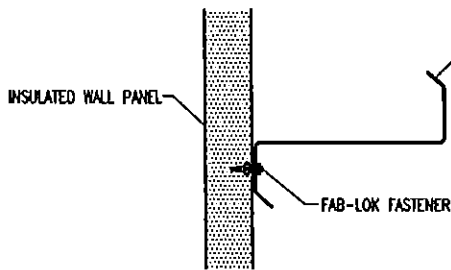

DETAIL 'C': PANEL CONNECTION

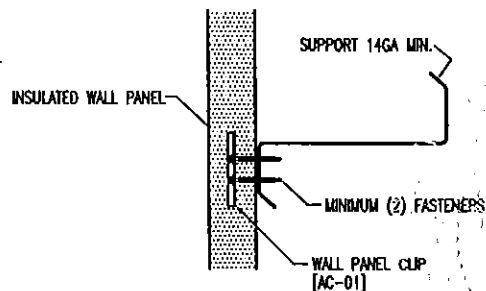

DETAIL 'D': PANEL CONNECTION

[Signature]

JUN 10 2015

MANUFACTURED BY:

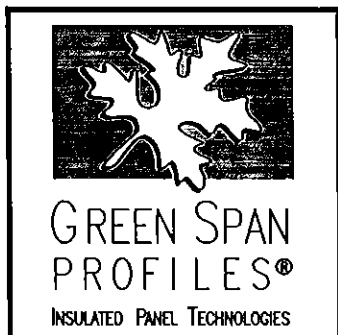

ASSEMBLY DETAILS WITH CONNECTIONS		
DATE: MARCH 19, 2004	NOTES: CHECK LIST SECTION 'B'	
PAGE: 2 OF 3	PRODUCT NAME: IWP SERIES	
REVISION: NONE	DOCUMENT NUMBER: 438-0086T-13	
PREPARED BY: BRIAN N. JAKS, FLPE #70159		
21200 FM362, WALLER, TEXAS 77484	281-807-7400	WWW.GREENSPANPROFILES.COM

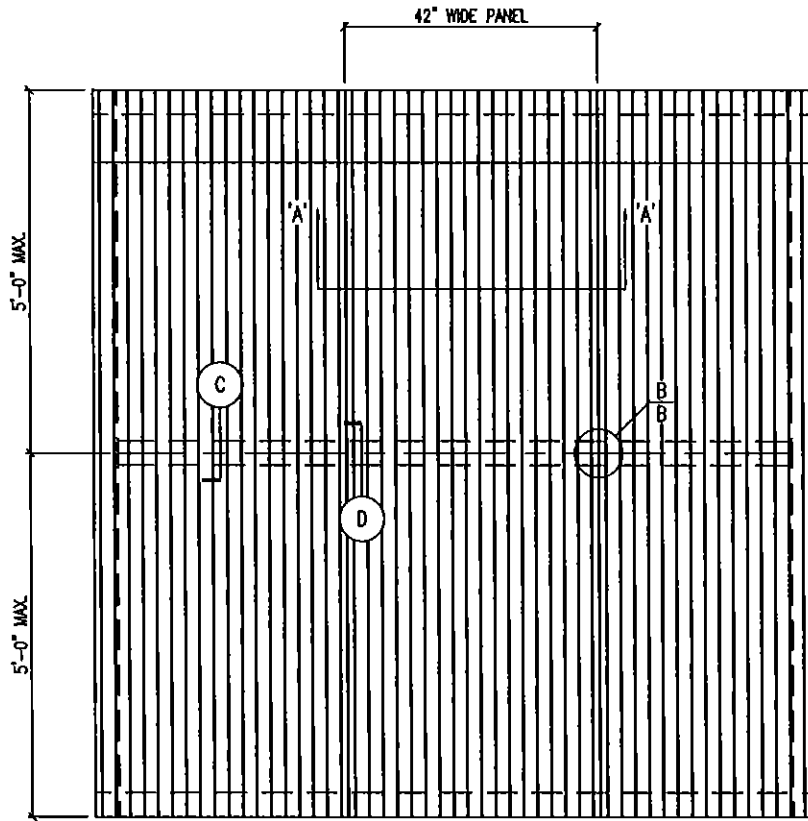

TYPICAL EXTERIOR WALL ELEVATION

Approved as complying with the
Florida Building Code

Date 01/14/2016

NOA# 15-0204-02

Miami, Dade Product Control

By *[Signature]*

[Signature]
JUN 10 2015

MANUFACTURED BY:

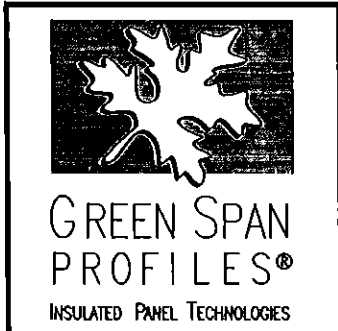

TYPICAL FASTENING DIAGRAMS		
DATE: MARCH 19, 2004	NOTES: CHECK LIST SECTION 'C'	
PAGE: 3 OF 3	PRODUCT NAME: IWP SERIES	
REVISION: NONE	DOCUMENT NUMBER: 438-0086T-13	
	PREPARED BY: BRIAN N. JAKS, FLPE #70159	
21200 FM362, WALLER, TEXAS 77484	281-807-7400	WWW.GREENSPANPROFILES.COM