



DEPARTMENT OF REGULATORY AND ECONOMIC RESOURCES (RER)
BOARD AND CODE ADMINISTRATION DIVISION

NOTICE OF ACCEPTANCE (NOA)

MIAMI-DADE COUNTY
PRODUCT CONTROL SECTION
11805 SW 26 Street, Room 208
Miami, Florida 33175-2474
T (786) 315-2590 F (786) 315-2599
www.miamidade.gov/economy

ACME Engineering and Manufacturing Corporation
1820 N. York Street
Muskogee, OK 74403

SCOPE:

This NOA is being issued under the applicable rules and regulations governing the use of construction materials. The documentation submitted has been reviewed and accepted by Miami-Dade County RER-Product Control Section to be used in Miami Dade County and other areas where allowed by the Authority Having Jurisdiction (AHJ).

This NOA shall not be valid after the expiration date stated below. The Miami-Dade County Product Control Section (In Miami Dade County) and/or the AHJ (in areas other than Miami Dade County) reserve the right to have this product or material tested for quality assurance purposes. If this product or material fails to perform in the accepted manner, the manufacturer will incur the expense of such testing and the AHJ may immediately revoke, modify, or suspend the use of such product or material within their jurisdiction. RER reserves the right to revoke this acceptance if it is determined by Miami-Dade County Product Control Section that this product or material fails to meet the requirements of the applicable building code.

This product is approved as described herein and has been designed to comply with the Florida Building Code, including the High Velocity Hurricane Zone.

DESCRIPTION: Series TIBLE Steel Rooftop Exhaust Fans

APPROVAL DOCUMENT: Drawing No. **806003**, titled "TIBLE Hurricane Fans", sheets 1 through 7 of 7, dated 09/10/2020, prepared by ACME Engineering and Manufacturing Corporation, signed and sealed by Richard O. Boyette, P.E. on 04/27/2022, bearing the Miami-Dade County Product Control approval stamp with the Notice of Acceptance number and approval date by the Miami-Dade County Product Control Section.

MISSILE IMPACT RATING: Large and Small Missile Impact Resistant

LABELING: Each unit shall bear a permanent label with the manufacturer's name or logo, city, state, model/series, and following statement: "Miami-Dade County Product Control Approved", unless otherwise noted herein.

RENEWAL of this NOA shall be considered after a renewal application has been filed and there has been no change in the applicable building code negatively affecting the performance of this product.

TERMINATION of this NOA will occur after the expiration date or if there has been a revision or change in the materials, use, and/or manufacture of the product or process. Misuse of this NOA as an endorsement of any product, for sales, advertising or any other purposes shall automatically terminate this NOA. Failure to comply with any section of this NOA shall be cause for termination and removal of NOA.

ADVERTISEMENT: The NOA number preceded by the words Miami-Dade County, Florida, and followed by the expiration date may be displayed in advertising literature. If any portion of the NOA is displayed, then it shall be done in its entirety.

INSPECTION: A copy of this entire NOA shall be provided to the user by the manufacturer or its distributors and shall be available for inspection at the job site at the request of the Building Official.

This NOA consists of this page 1 and evidence page E-1, as well as approval document mentioned above.

The submitted documentation was reviewed by **Carlos M. Utrera, P.E.**



NOA No. 21-0324.01
Expiration Date: September 29, 2027
Approval Date: September 29, 2022
Page 1

NOTICE OF ACCEPTANCE: EVIDENCE SUBMITTED

A. DRAWINGS

1. Drawing No. **806003**, titled “TIBLE Hurricane Fans”, sheets 1 through 7 of 7, dated 09/10/2020, prepared by ACME Engineering and Manufacturing Corporation, signed and sealed by Richard O. Boyette, P.E. on 04/27/2022.

B. TESTS

1. Test report on 1) Uniform Static Air Pressure Test, Loading per FBC, TAS 202-94
2) Large Missile Impact Test per FBC, TAS 201-94,
3) Tensile Strength of Metallic Material per ASTM E8,
along with marked-up drawings and installation diagram of three Model **TIBLEO 2f-080** Twin Hurricane Fan, prepared by Intertek, Test Report No. **L3063.01-801-18 R3**, with revision dated 07/12/2022, signed and sealed by Tyler Westerling, P.E.
2. Test report on 1) Uniform Static Air Pressure Test, Loading per FBC, TAS 202-94
2) Large Missile Impact Test per FBC, TAS 201-94,
3) Lateral Loading per ASTM E72 (Modified),
along with marked-up drawings and installation diagram of three Model **TIBLET-245** Hurricane Fan, prepared by Intertek, Test Report No. **L3063.02-801-18 R1**, with revision dated 07/12/2022, signed and sealed by Tyler Westerling, P.E.
3. Test report on 1) Uniform Static Air Pressure Test, Loading per FBC, TAS 202-94
2) Large Missile Impact Test per FBC, TAS 201-94,
3) Lateral Loading per ASTM E72 (Modified),
along with marked-up drawings and installation diagram of three Model **TIBLEN-245** Hurricane Fan, prepared by Intertek, Test Report No. **L3063.03-801-18 R1**, with revision dated 07/12/2022, signed and sealed by Tyler Westerling, P.E.

C. CALCULATIONS

1. Anchorage verification calculations prepared by Rick Boyette Consulting, Inc, dated 02/16/2021, signed and sealed by Richard O. Boyette, P.E.

D. QUALITY ASSURANCE

1. Miami-Dade Department of Regulatory and Economic Resources (RER).

E. MATERIAL CERTIFICATIONS

1. None.

F. STATEMENTS

1. Statement letter of code conformance to the 7th edition (2020) of the FBC, issued by Rick Boyette Consulting, Inc, dated 02/16/2021, signed and sealed by Richard O. Boyette, P.E.
2. Statement letter of no financial interest issued by Rick Boyette Consulting, Inc, dated 02/16/2021, signed and sealed by Richard O. Boyette, P.E.



Carlos M. Utrera, P.E.
Product Control Examiner
NOA No. 21-0324.01

Expiration Date: September 29, 2027
Approval Date: September 29, 2022

MODEL	FASTENER A	QTY	FASTENER B	QTY	FASTENER C	QTY	FASTENER D	QTY	FASTENER E	QTY	FASTENER F	QTY
TIBLEN080-120	3/8-16 x 1.00 WHIZ LOCK SS W/ NUT, WASHER	8	3/8-16 x 0.75 WHIZ LOCK SS W/ NUT, WASHER	24	5/16-18 x 1.00 WHIZ LOCK SS W/ NUT, WASHER	32	5/16-18 x 1.00 SS SCREW	32	1/4-20 x 0.75 SS W/ NUT, WASHER	6	1/4-20 x 0.50 SS W/ NUT, WASHER	12
TIBLEO080-120												
TIBLET080-120												
TIBLEN135-165	3/8-16 x 1.00 WHIZ LOCK SS W/ NUT, WASHER	8	3/8-16 x 0.75 WHIZ LOCK SS W/ NUT, WASHER	24	5/16-18 x 1.00 WHIZ LOCK SS W/ NUT, WASHER	32	5/16-18 x 1.00 SS SCREW	32	1/4-20 x 0.75 SS W/ NUT, WASHER	6	1/4-20 x 0.50 SS W/ NUT, WASHER	12
TIBLEO135-165												
TIBLET135-165												
TIBLEN185	3/8-16 x 1.00 WHIZ LOCK SS W/ NUT, WASHER	8	3/8-16 x 0.75 WHIZ LOCK SS W/ NUT, WASHER	24	5/16-18 x 1.00 WHIZ LOCK SS W/ NUT, WASHER	40	5/16-18 x 1.00 SS SCREW	40	1/4-20 x 0.75 SS W/ NUT, WASHER	6	1/4-20 x 0.50 SS W/ NUT, WASHER	12
TIBLEO185												
TIBLET185												
TIBLEN200	3/8-16 x 1.00 WHIZ LOCK SS W/ NUT, WASHER	8	3/8-16 x 0.75 WHIZ LOCK SS W/ NUT, WASHER	24	5/16-18 x 1.00 WHIZ LOCK SS W/ NUT, WASHER	48	5/16-18 x 1.00 SS SCREW	48	1/4-20 x 0.75 SS W/ NUT, WASHER	6	1/4-20 x 0.50 SS W/ NUT, WASHER	12
TIBLEO200												
TIBLET200												
TIBLEN235-245	3/8-16 x 1.00 WHIZ LOCK SS W/ NUT, WASHER	8	3/8-16 x 0.75 WHIZ LOCK SS W/ NUT, WASHER	24	5/16-18 x 1.00 WHIZ LOCK SS W/ NUT, WASHER	56	5/16-18 x 1.00 SS SCREW	56	1/4-20 x 0.75 SS W/ NUT, WASHER	6	1/4-20 x 0.50 SS W/ NUT, WASHER	12
TIBLEO235-245												
TIBLET235-245												

Notes:
a. This rooftop lab exhaust fan has been designed to comply with the 2020 FBC ASCE 7-16.
b. Roof structure must be designed to withstand the weight and loading transmitted by this rooftop exhaust fan.
c. This approval is for the structural capacity of the exterior housing only, it does not include any interior mechanism and/or electrical part.
d. This rooftop lab exhaust fan has not been tested for wind driven rain according to Florida Building Code, TAS 100(A).
e. All fasteners must be corrosion resistant.
f. Curb by others.

Dimensions are in inches unless otherwise noted.

DIMENSIONAL DATA										
MODELS		G	H	J	K	L	M	CURB HT.	OUTLET DIA.	*EST. UNIT WEIGHT (LBS.)
TIBLEN	080, 100, 120	32.00	44.00	128.00	40.00	98.00	21.00	8 to 24	18.00	668
TIBLEN	135, 150, 155, 160, 165	32.00	44.00	127.00	40.00	97.00	25.00	8 to 24	24.00	668
TIBLEN	185	41.00	55.00	130.00	49.00	100.00	30.00	8 to 24	27.00	754
TIBLEN	200	48.00	60.00	131.00	56.00	101.00	37.00	8 to 24	32.00	832
TIBLEN	235, 240, 245	56.00	71.00	130.00	64.00	100.00	45.00	8 to 24	36.00	1583
TIBLEO	080, 100, 120	32.00	44.00	128.00	40.00	98.00	21.00	8 to 24	18.00	923
TIBLEO	135, 150, 155, 160, 165	32.00	44.00	127.00	40.00	97.00	25.00	8 to 24	24.00	923
TIBLEO	185	41.00	55.00	130.00	49.00	100.00	30.00	8 to 24	27.00	1031
TIBLEO	200	48.00	60.00	131.00	56.00	101.00	37.00	8 to 24	32.00	1131
TIBLEO	235, 240, 245	56.00	71.00	130.00	64.00	100.00	45.00	8 to 24	36.00	1911
TIBLET	080, 100, 120	32.00	53.00	128.00	40.00	98.00	21.00	8 to 24	18.00	962
TIBLET	135, 150, 155, 160, 165	32.00	53.00	127.00	40.00	97.00	25.00	8 to 24	24.00	962
TIBLET	185	41.00	64.00	130.00	49.00	100.00	30.00	8 to 24	27.00	1087
TIBLET	200	48.00	69.00	131.00	56.00	101.00	37.00	8 to 24	32.00	1205
TIBLET	235, 240, 245	56.00	89.00	130.00	64.00	100.00	45.00	8 to 24	36.00	2027

*LESS CURB

PRODUCT APPROVED
as complying with the Florida
Building Code
NOA-No. 21-0324.01

Approval Date 09/29/2022

By *[Signature]*
Miami-Dade Product Control

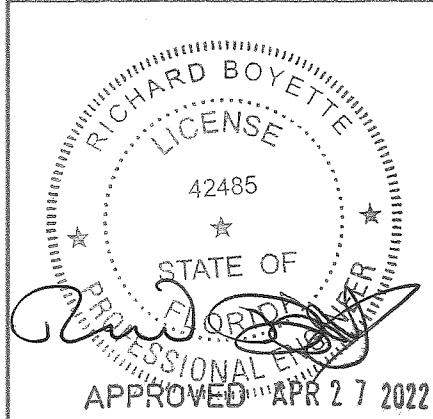
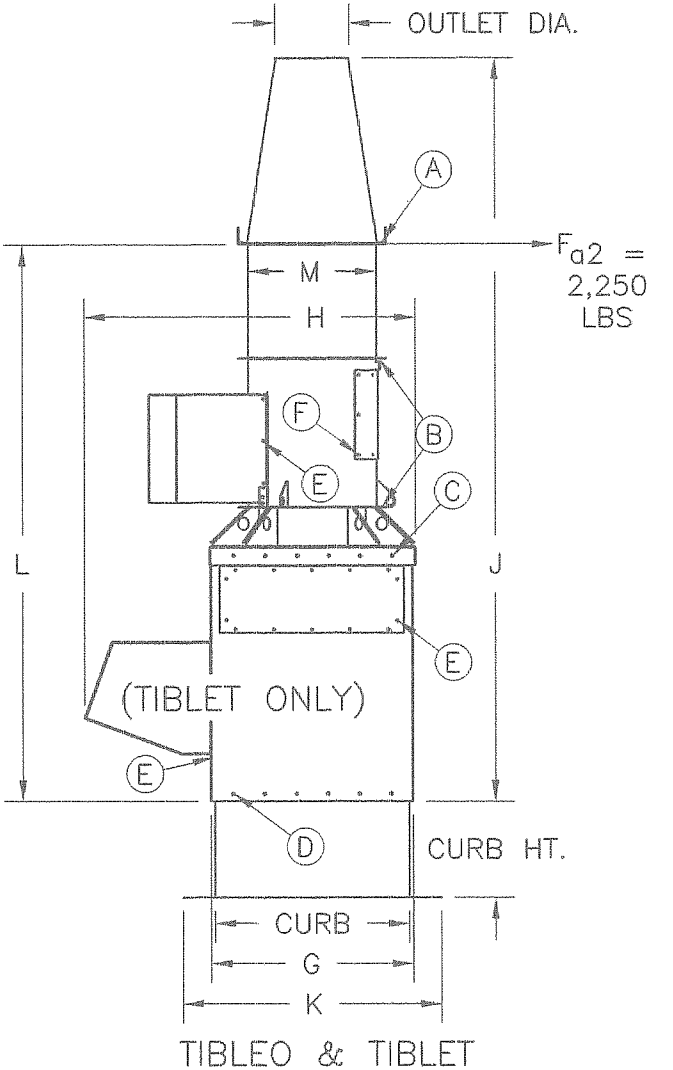
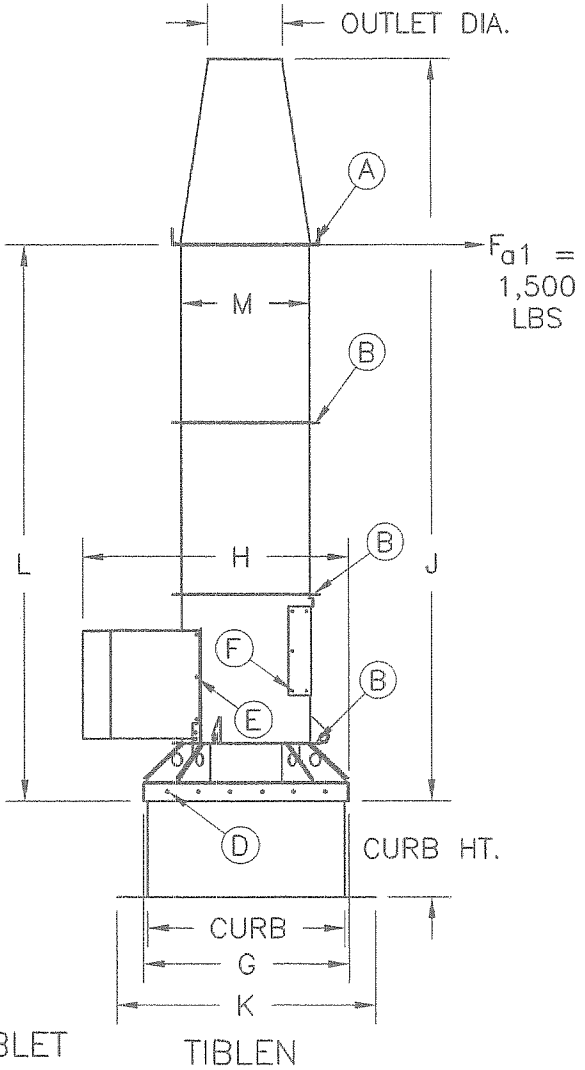

Large Missile Impact Resistant
Max rated design pressure : +140.0 / -140.0 PSF

Richard Boyette, FL PE #42485
Rick Boyette Consulting Inc - CoA #9707
4031 Coconut Blvd
Royal Palm Beach FL 33411
561-790-5766

F_{a1} = Allowable Lateral Force
per Each Model: TIBLEN

F_{a2} = Allowable Lateral Force
per Each Model: TIBLEO, TIBLET

DWG NO. 806003 Sheet 1/7

TITLE TIBLE HURRICANE FANS

MAT'L	
DRAFTER MTJ	DATE 9/10/20
DESIGN ENG. TCR	RELEASED 9/10/20
CHKD BY	SCALE NTS

LET.	REVISION RECORD	BY	CKD.	DATE

Acme Engineering &
Manufacturing Corp.
1820 N. York Street
Muskogee, OK 74403
918-682-7791

TIBLEN

Item #	Qty.	Description	80 - 120	135 - 165	185	200	235 - 245
1	1	Cone	16 ga.	16 ga.	16 ga.	16 ga.	16 ga.
2	1	Tube Extension	12 ga.	12 ga.	12 ga.	12 ga.	12 ga.
3	1	Tube Extension	12 ga.	12 ga.	12 ga.	12 ga.	12 ga.
4	1	Fan Housing	12 ga.	12 ga.	12 ga.	12 ga.	12 ga.
5	1	Motor Cover	18 ga.	18 ga.	18 ga.	18 ga.	18 ga.
6	1	Cap Assembly	10 ga.	10 ga.	10 ga.	10 ga.	10 ga.

TIBLCO

Item #	Qty.	Description	80 - 120	135 - 165	185	200	235 - 245
1	1	Cone	16 ga.	16 ga.	16 ga.	16 ga.	16 ga.
2	1	Tube Extension	12 ga.	12 ga.	12 ga.	12 ga.	12 ga.
4	1	Fan Housing	12 ga.	12 ga.	12 ga.	12 ga.	12 ga.
5	1	Motor Cover	18 ga.	18 ga.	18 ga.	18 ga.	18 ga.
6	1	Cap Assembly	10 ga.	10 ga.	10 ga.	10 ga.	10 ga.
7	1	Plenum w/ Doors	12 ga.	12 ga.	12 ga.	12 ga.	12 ga.

TIBLET

Item #	Qty.	Description	80 - 120	135 - 165	185	200	235 - 245
1	1	Cone	16 ga.	16 ga.	16 ga.	16 ga.	16 ga.
2	1	Tube Extension	12 ga.	12 ga.	12 ga.	12 ga.	12 ga.
4	1	Fan Housing	12 ga.	12 ga.	12 ga.	12 ga.	12 ga.
5	1	Motor Cover	18 ga.	18 ga.	18 ga.	18 ga.	18 ga.
6	1	Cap Assembly	10 ga.	10 ga.	10 ga.	10 ga.	10 ga.
7	1	Plenum w/ Doors	12 ga.	12 ga.	12 ga.	12 ga.	12 ga.
8	1	Weather Cover	16 ga.	16 ga.	16 ga.	16 ga.	16 ga.

* Steel material gages shown are nominal. 1. Carbon Steel SY=20 ksi MIN
Actual thicknesses will vary in accordance with industry standard tolerances.
2. Interchangeable grades of steel sheet:
 o CRS=Cold Rold Steel - A1008 CS Type B, 20-40 ksi, 14, 16, 18 gage
 o HRPO=Hot Rolled Pickled and Oiled-A1001 CS Type B, 30-50 ksi, 10, 12 gage
 o HRPO=Hot Rolled Pickled and Oiled-A1011 HSLAS Type, Grade 50, 50 ksi min
3. All steel parts are Coated with Electrostatic Powder Coating

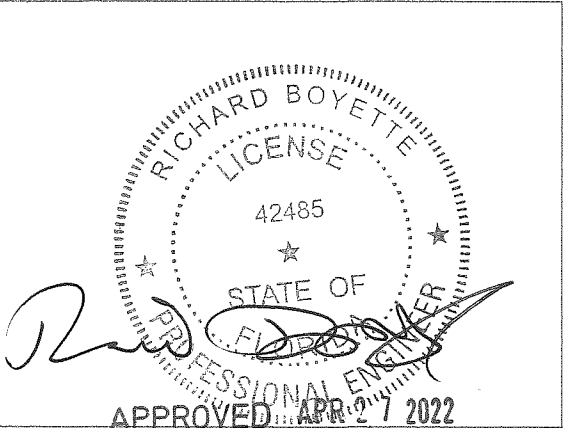

Richard Boyette, FL PE #42485
Rick Boyette Consulting Inc - CoA #9707
4031 Coconut Blvd
Royal Palm Beach FL 33411
561-790-5766

PRODUCT APPROVED
as complying with the Florida
Building Code
NOA-No. 21-0324.01
Approval Date 09/29/2022
By *[Signature]*
Miami-Dade Product Control

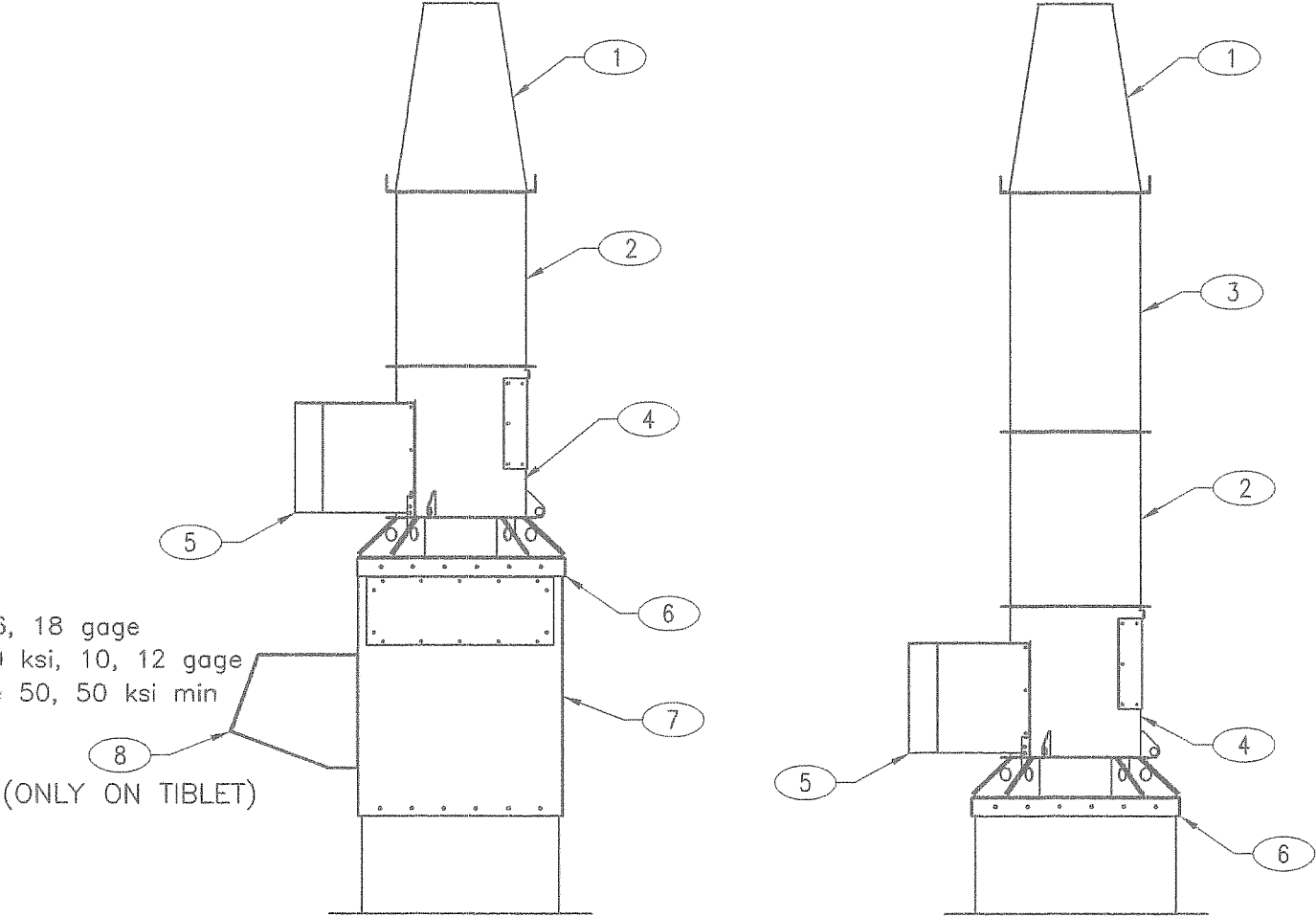

TIBLCO & TIBLET
TIBL 080-245 FANS

DWG NO.	806003	Sheet 2/7	LET.	REVISION RECORD	BY	CKD.	DATE
TITLE	TIBL HURRICANE FANS						
MAT'L							
DRAFTER	MTJ	DATE	9/10/20				
DESIGN ENG.	TCR	9/10/20	RELEASED				
CHKD BY	MFG.	SCALE	NTS				

Acme Engineering &
Manufacturing Corp.
1820 N. York Street
Muskogee, OK 74403
918-682-7791

Large Missile Impact Resistant
Max rated design pressure : +140.0 / -140.0 PSF

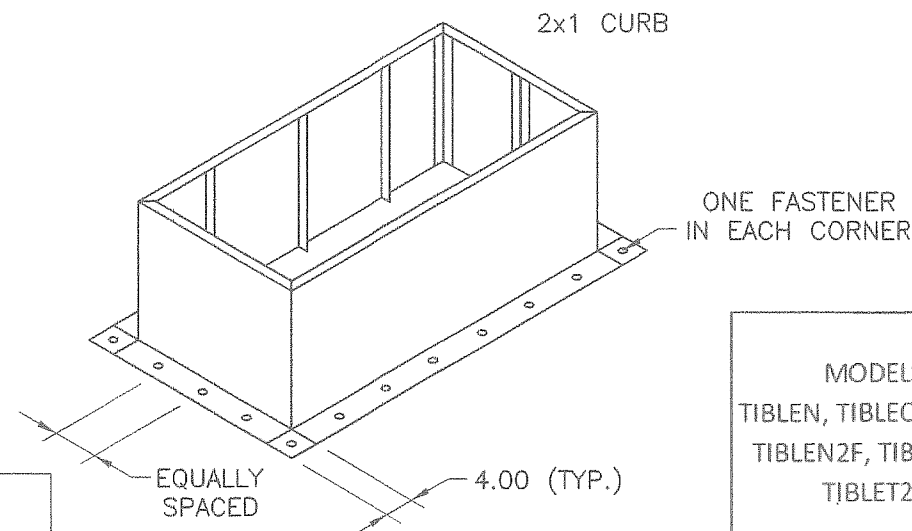
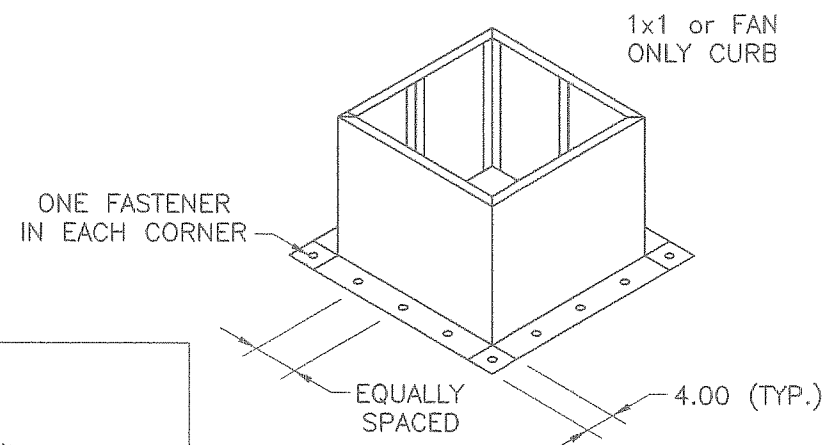
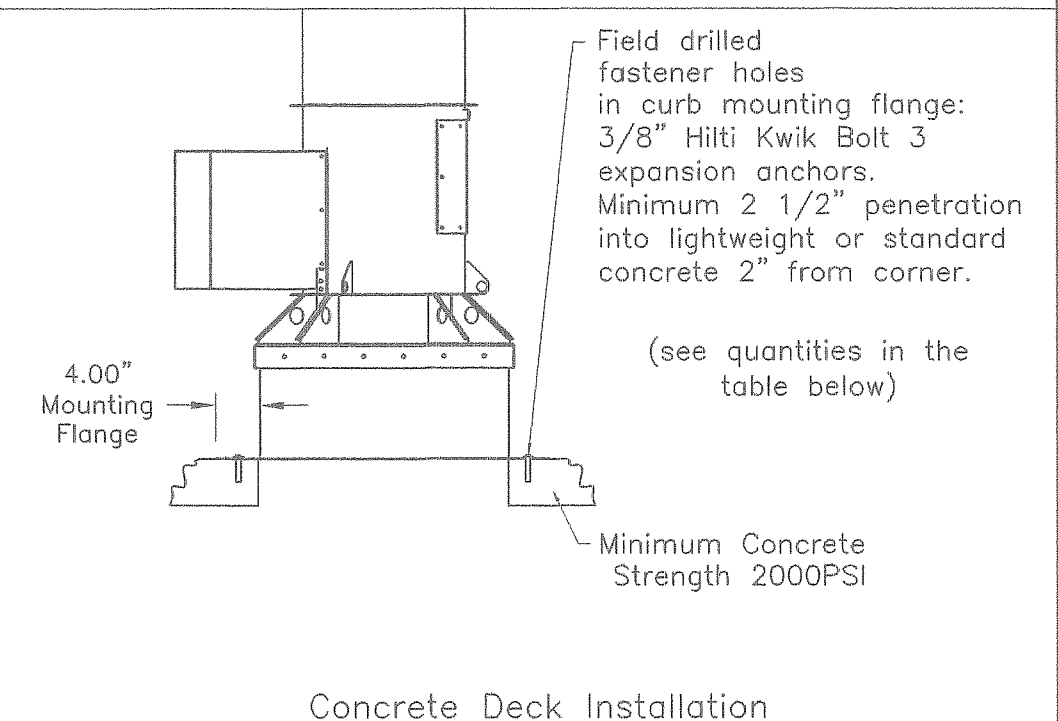
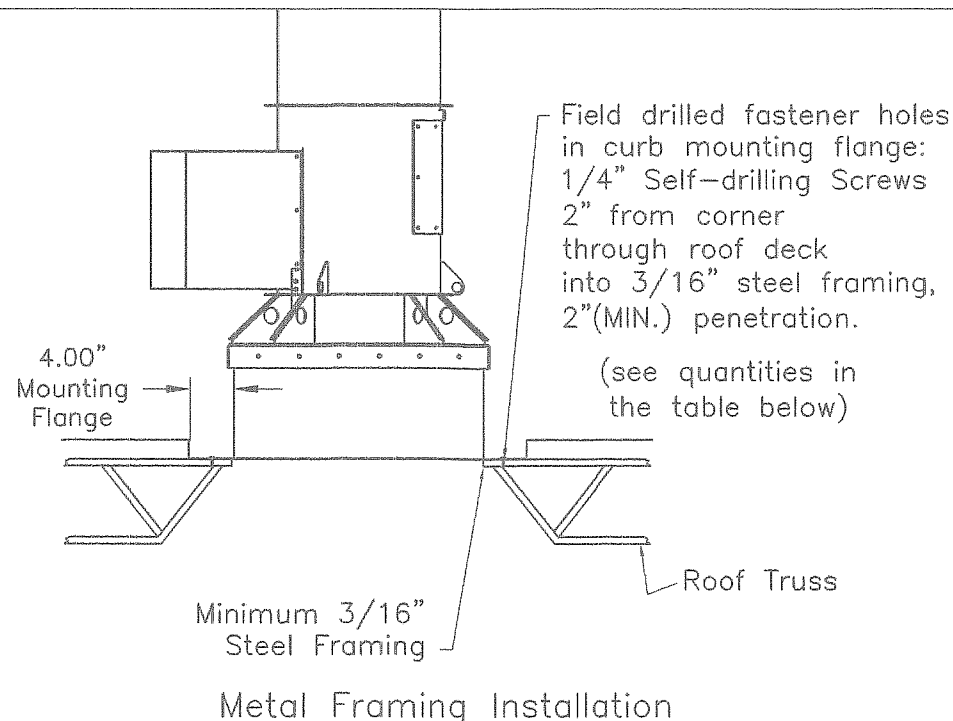
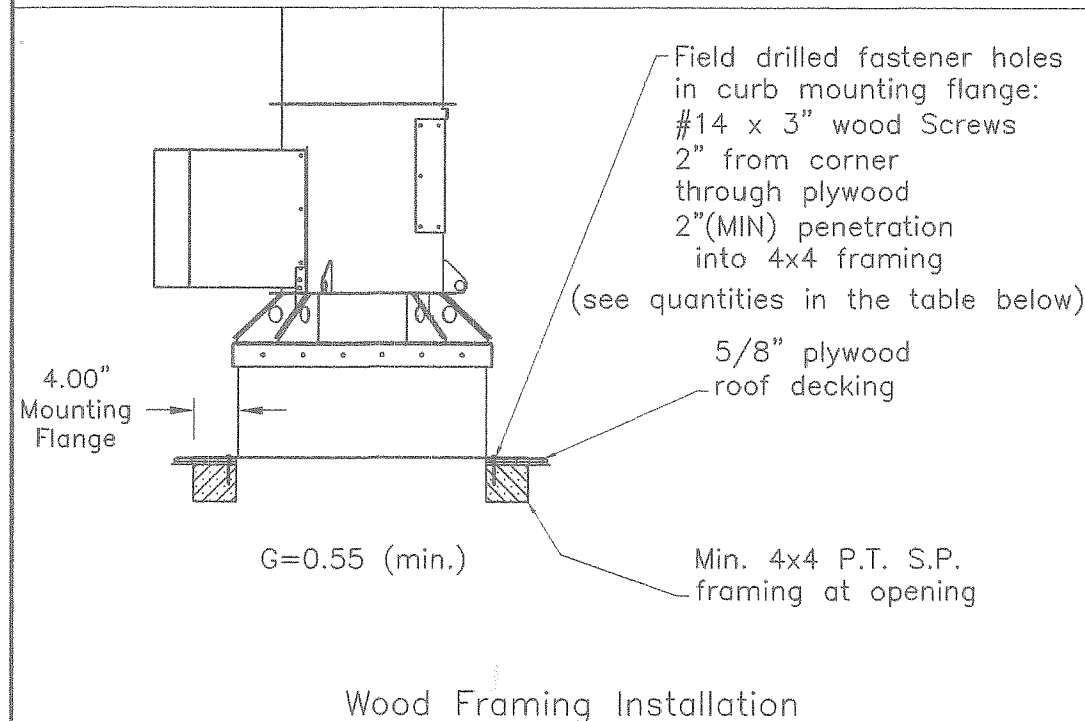

PRODUCT APPROVED
as complying with the Florida
Building Code
NOA-No. 21-0324.01
Approval Date 09/29/2022
By *[Signature]*
Miami-Dade Product Control

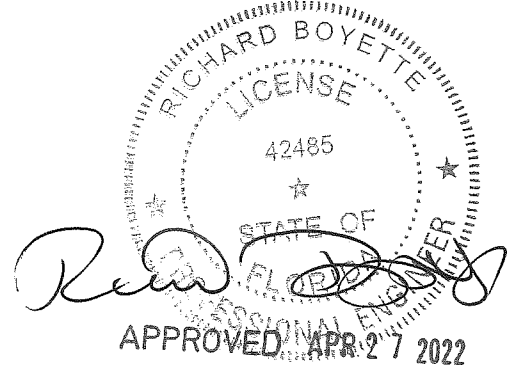

Richard Boyette, FL PE #42485
Rick Boyette Consulting Inc - CoA #9707
4031 Coconut Blvd
Royal Palm Beach FL 33411
561-790-5766

MODELS TIBLEN, TIBLEO, TIBLET TIBLEN2F, TIBLEO2F, TIBLET2F	MINIMUM NUMBER OF FASTENERS PER SIDE TO ATTACH CURB TO STRUCTURE (excludes 4 corner fasteners)					
	Concrete deck anchoring		Timber anchoring		Steel anchoring- self drill/tap	
	1x1 or fan only	2x1	1x1 or fan only	2x1	1x1 or fan only	2x1
080-120	4	7	8	14	5	7
135-165	4	7	8	14	5	7
185	5	8	11	17	6	9
200	6	12	13	24	7	11
235-245	7	12	14	25	9	12

DWG NO.	806003	Sheet	3/7
TITLE TIBLE HURRICANE FANS			
MAT'L			
DRAFTER	MTJ	DATE	9/10/20
DESIGN ENG.	TCR	9/10/20	RELEASED
CHKD BY	MFG.	SCALE	NTS

LET.	REVISION RECORD	BY	CKD.	DATE

Acme Engineering &
Manufacturing Corp.
1820 N. York Street
Muskogee, OK 74403
918-682-7791

MODEL	FASTENER A	QTY	FASTENER B	QTY	FASTENER C	QTY	FASTENER D	QTY	FASTENER E	QTY	FASTENER F	QTY
TIBLEN080-120	3/8-16 x 1.00 WHIZ LOCK SS W/ NUT, WASHER	16	3/8-16 x 0.75 WHIZ LOCK SS W/ NUT, WASHER	48	5/16-18 x 1.00 WHIZ LOCK SS W/ NUT, WASHER	64	5/16-18 x 1.00 SS SCREW	54	1/4-20 x 0.75 SS W/ NUT, WASHER	12	1/4-20 x 0.50 SS W/ NUT, WASHER	24
TIBL0080-120												
TIBLET080-120												
TIBLEN135-165	3/8-16 x 1.00 WHIZ LOCK SS W/ NUT, WASHER	16	3/8-16 x 0.75 WHIZ LOCK SS W/ NUT, WASHER	48	5/16-18 x 1.00 WHIZ LOCK SS W/ NUT, WASHER	64	5/16-18 x 1.00 SS SCREW	54	1/4-20 x 0.75 SS W/ NUT, WASHER	12	1/4-20 x 0.50 SS W/ NUT, WASHER	24
TIBL0135-165												
TIBLET135-165												
TIBLEN185	3/8-16 x 1.00 WHIZ LOCK SS W/ NUT, WASHER	16	3/8-16 x 0.75 WHIZ LOCK SS W/ NUT, WASHER	48	5/16-18 x 1.00 WHIZ LOCK SS W/ NUT, WASHER	80	5/16-18 x 1.00 SS SCREW	68	1/4-20 x 0.75 SS W/ NUT, WASHER	12	1/4-20 x 0.50 SS W/ NUT, WASHER	24
TIBL0185												
TIBLET185												
TIBLEN200	3/8-16 x 1.00 WHIZ LOCK SS W/ NUT, WASHER	16	3/8-16 x 0.75 WHIZ LOCK SS W/ NUT, WASHER	48	5/16-18 x 1.00 WHIZ LOCK SS W/ NUT, WASHER	96	5/16-18 x 1.00 SS SCREW	80	1/4-20 x 0.75 SS W/ NUT, WASHER	12	1/4-20 x 0.50 SS W/ NUT, WASHER	24
TIBL0200												
TIBLET200												
TIBLEN235-245	3/8-16 x 1.00 WHIZ LOCK SS W/ NUT, WASHER	16	3/8-16 x 0.75 WHIZ LOCK SS W/ NUT, WASHER	48	5/16-18 x 1.00 WHIZ LOCK SS W/ NUT, WASHER	112	5/16-18 x 1.00 SS SCREW	92	1/4-20 x 0.75 SS W/ NUT, WASHER	12	1/4-20 x 0.50 SS W/ NUT, WASHER	24
TIBL0235-245												
TIBLET235-245												

- Notes:
- This rooftop lab exhaust fan has been designed to comply with the 2020 FBC ASCE 7-16.
 - Roof structure must be designed to withstand the weight and loading transmitted by this rooftop exhaust fan.
 - This approval is for the structural capacity of the exterior housing only, it does not include any interior mechanism and/or electrical part.
 - This rooftop lab exhaust fan has not been tested for wind driven rain according to Florida Building Code, TAS 100(A).
 - All fasteners must be corrosion resistant.
 - Curb by others.

Large Missile Impact Resistant
Max rated design pressure : +140.0 / -140.0 PSF

DIMENSIONAL DATA												
MODELS	G	H	J	K	L	M	N	P	CURB HT.	OUTLET DIA.	*EST. UNIT WEIGHT (LBS.)	
TIBLEN2F 080, 100, 120	75.00	32.00	152.00	83.00	122.00	21.00	40.00	44.00	8 to 24	18.00	1693	
TIBLEN2F 135, 150, 155, 160, 165	75.00	32.00	151.00	83.00	121.00	25.00	40.00	44.00	8 to 24	24.00	1693	
TIBLEN2F 185	95.00	40.00	156.00	103.00	126.00	30.00	48.00	55.00	8 to 24	27.00	2061	
TIBLEN2F 200	111.00	47.00	159.00	119.00	129.00	37.00	55.00	60.00	8 to 24	32.00	2218	
TIBLEN2F 235, 240, 245	127.00	55.00	162.00	135.00	132.00	45.00	63.00	71.00	8 to 24	36.00	2958	
TIBL02F 080, 100, 120	75.00	32.00	152.00	83.00	122.00	21.00	40.00	44.00	8 to 24	18.00	2203	
TIBL02F 135, 150, 155, 160, 165	75.00	32.00	151.00	83.00	121.00	25.00	40.00	44.00	8 to 24	24.00	2203	
TIBL02F 185	95.00	40.00	156.00	103.00	126.00	30.00	48.00	55.00	8 to 24	27.00	2615	
TIBL02F 200	111.00	47.00	159.00	119.00	129.00	37.00	55.00	60.00	8 to 24	32.00	2816	
TIBL02F 235, 240, 245	127.00	55.00	162.00	135.00	132.00	45.00	63.00	71.00	8 to 24	36.00	4718	
TIBLET2F 080, 100, 120	75.00	32.00	152.00	83.00	122.00	21.00	40.00	44.00	8 to 24	18.00	2281	
TIBLET2F 135, 150, 155, 160, 165	75.00	32.00	151.00	83.00	121.00	25.00	40.00	44.00	8 to 24	24.00	2281	
TIBLET2F 185	95.00	40.00	156.00	103.00	126.00	30.00	48.00	55.00	8 to 24	27.00	2727	
TIBLET2F 200	111.00	47.00	159.00	119.00	129.00	37.00	55.00	60.00	8 to 24	32.00	2964	
TIBLET2F 235, 240, 245	127.00	55.00	162.00	135.00	132.00	45.00	63.00	71.00	8 to 24	36.00	4950	

Dimensions are in inches unless otherwise noted.
*LESS CURB

PRODUCT APPROVED
as complying with the Florida
Building Code
NOA-No. 21-0324.01

Approval Date 09/29/2022

By 
Miami-Dade Product Control

Richard Boyette, FL PE #42485
Rick Boyette Consulting Inc - CoA #9707
4031 Coconut Blvd
Royal Palm Beach FL 33411
561-790-5766

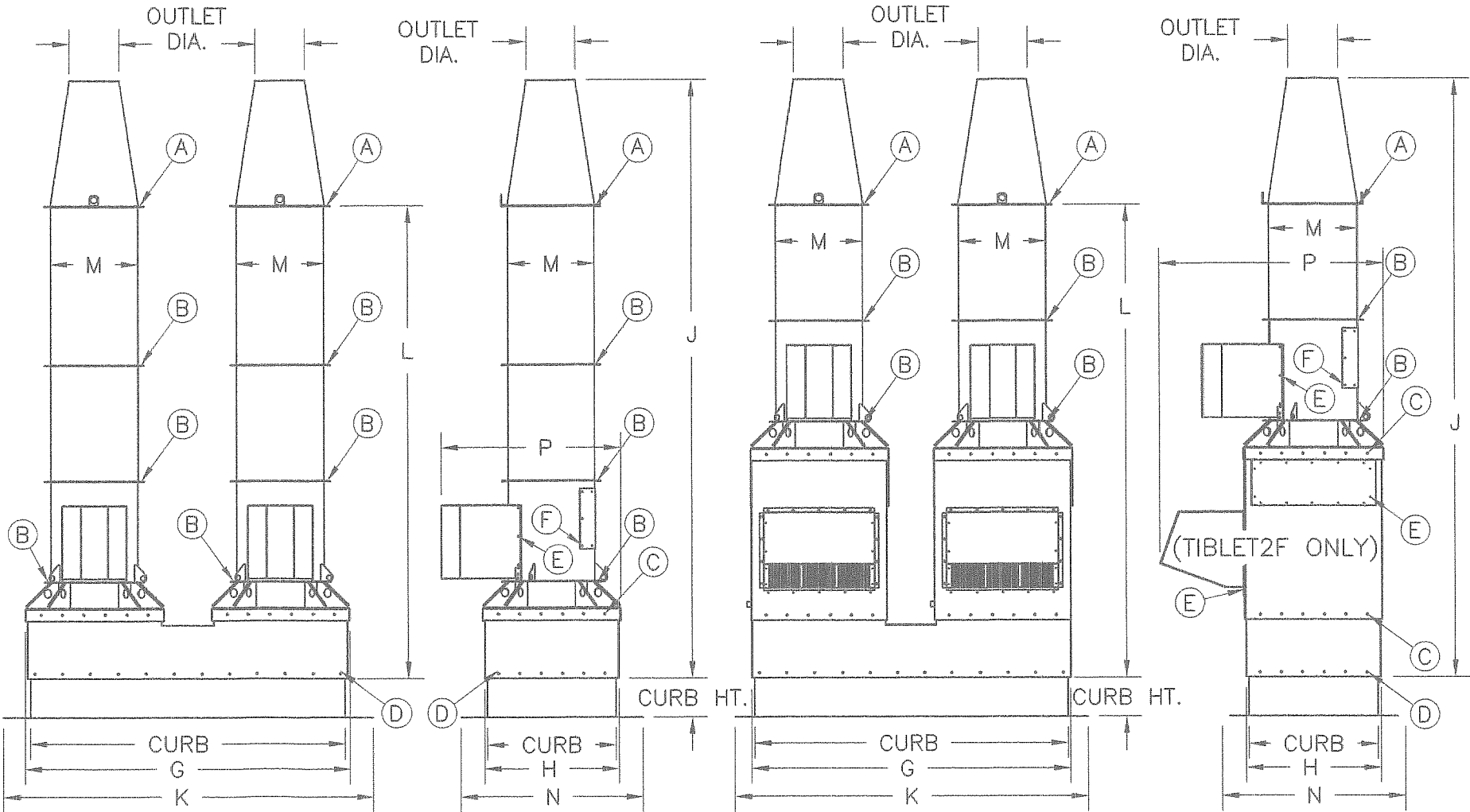
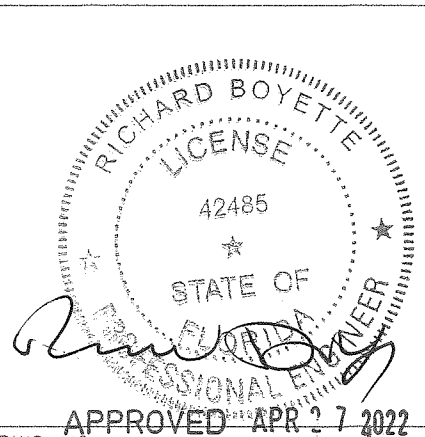

TIBLEN2F

TIBL02F & TIBLET2F

DWG NO.	806003	Sheet 4/7
TITLE	TIBLE HURRICANE FANS	
MAT'L		
DRAFTER	MTJ	DATE 9/10/20
DESIGN ENG.	TCR	RELEASED 9/10/20
CHKD BY	MFG.	SCALE NTS

LET.	REVISION RECORD	BY	CKD.	DATE

Acme Engineering &
Manufacturing Corp.
1820 N. York Street
Muskogee, OK 74403
918-682-7791

TIBLEN2F

Item #	Qty.	Description	80 - 120	135 - 165	185	200	235 - 245
1	2	Cone	16 ga.	16 ga.	16 ga.	16 ga.	16 ga.
2	2	Tube Extension	12 ga.	12 ga.	12 ga.	12 ga.	12 ga.
3	2	Tube Extension	12 ga.	12 ga.	12 ga.	12 ga.	12 ga.
4	2	Fan Housing	12 ga.	12 ga.	12 ga.	12 ga.	12 ga.
5	2	Motor Cover	18 ga.	18 ga.	18 ga.	18 ga.	18 ga.
6	2	Cap Assembly	10 ga.	10 ga.	10 ga.	10 ga.	10 ga.
9	1	2F Distribution Box	12 ga.	12 ga.	12 ga.	12 ga.	12 ga.

TIBLE02F

Item #	Qty.	Description	80 - 120	135 - 165	185	200	235 - 245
1	2	Cone	16 ga.	16 ga.	16 ga.	16 ga.	16 ga.
2	2	Tube Extension	12 ga.	12 ga.	12 ga.	12 ga.	12 ga.
4	2	Fan Housing	12 ga.	12 ga.	12 ga.	12 ga.	12 ga.
5	2	Motor Cover	18 ga.	18 ga.	18 ga.	18 ga.	18 ga.
6	2	Cap Assembly	10 ga.	10 ga.	10 ga.	10 ga.	10 ga.
7	2	Plenum w/ Doors	12 ga.	12 ga.	12 ga.	12 ga.	12 ga.
9	1	2F Distribution Box	12 ga.	12 ga.	12 ga.	12 ga.	12 ga.

TIBLET2F

Item #	Qty.	Description	80 - 120	135 - 165	185	200	235 - 245
1	2	Cone	16 ga.	16 ga.	16 ga.	16 ga.	16 ga.
2	2	Tube Extension	12 ga.	12 ga.	12 ga.	12 ga.	12 ga.
4	2	Fan Housing	12 ga.	12 ga.	12 ga.	12 ga.	12 ga.
5	2	Motor Cover	18 ga.	18 ga.	18 ga.	18 ga.	18 ga.
6	2	Cap Assembly	10 ga.	10 ga.	10 ga.	10 ga.	10 ga.
7	2	Plenum w/ Doors	12 ga.	12 ga.	12 ga.	12 ga.	12 ga.
8	2	Weather Cover	16 ga.	16 ga.	16 ga.	16 ga.	16 ga.
9	1	2F Distribution Box	12 ga.	12 ga.	12 ga.	12 ga.	12 ga.

*Steel material gages shown are nominal. 1. Carbon Steel SY=20 ksi MIN
Actual thicknesses will vary in accordance with industry standard tolerances.

2. Interchangeable grades of steel sheet:
- CRS=Cold Rold Steel - A1008 CS Type B, 20-40 ksi, 14, 16, 18 gage
 - HRPO=Hot Rolled Pickled and Oiled-A1001 CS Type B, 30-50 ksi, 10, 12 gage
 - HRPO=Hot Rolled Pickled and Oiled-A1011 HSLAS Type, Grade 50, 50 ksi min
3. All steel parts are Coated with Electrostatic Powder Coating

Richard Boyette, FL PE #42485
Rick Boyette Consulting Inc - CoA #9707
4031 Coconut Blvd
Royal Palm Beach FL 33411
561-790-5766

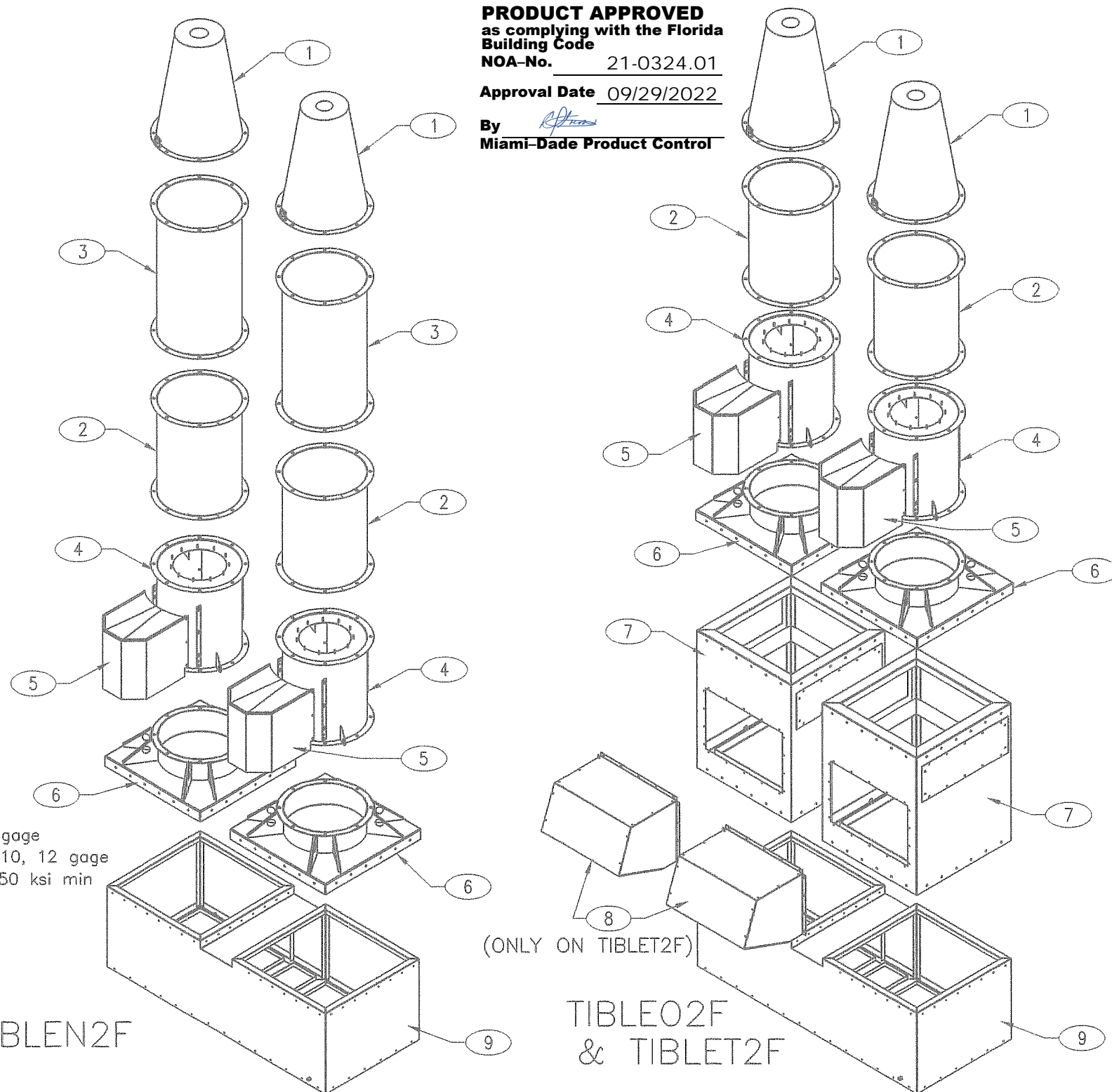
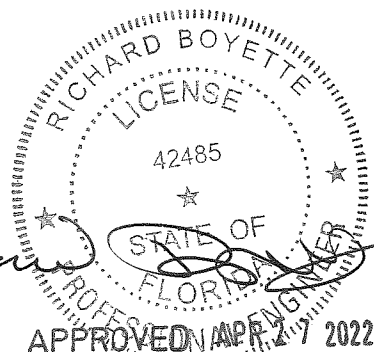

PRODUCT APPROVED
as complying with the Florida
Building Code
NOA-No. 21-0324.01
Approval Date 09/29/2022
By *[Signature]*
Miami-Dade Product Control

TIBLE 080-245 FANS

DWG NO. 806003 Sheet 5/7

TITLE TIBLE HURRICANE FANS

MAT'L
DRAFTER MTJ DATE 9/10/20
DESIGN ENG. TCR 9/10/20 RELEASED
CHKD BY MFG. SCALE NTS

LET.	REVISION RECORD	BY	CKD.	DATE

Acme Engineering &
Manufacturing Corp.
1820 N. York Street
Muskogee, OK 74403
918-682-7791

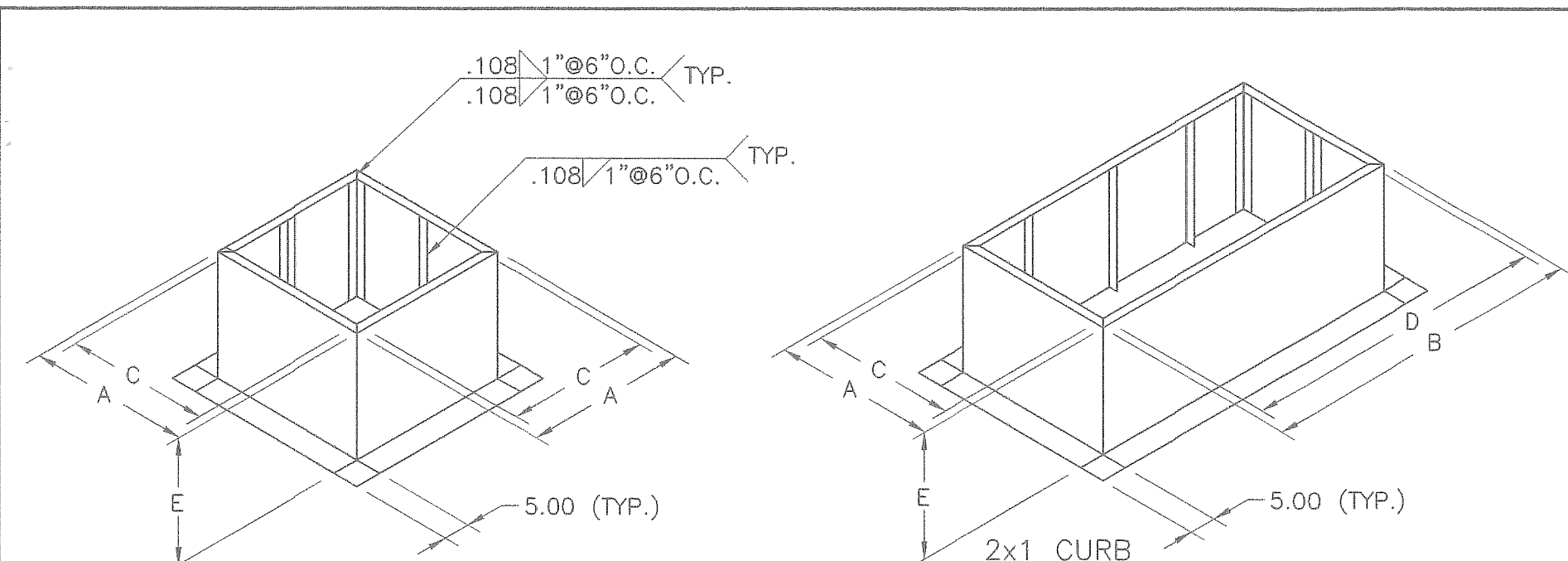

TIBLEN, TIBLCO, TIBLET TIBLEN2F, TIBLCO2F, TIBLET2F	CURB DIMENSIONS					MATERIAL
	A	B	C	D	E	
080 - 165	32.00	75.00	28.50	71.50	8 to 24	12 GA. GALV
185	41.00	95.00	37.50	91.50	8 to 24	12 GA. GALV
200	48.00	111.00	44.50	107.50	8 to 24	12 GA. GALV
235-245	56.00	127.00	52.50	123.50	8 to 24	12 GA. GALV

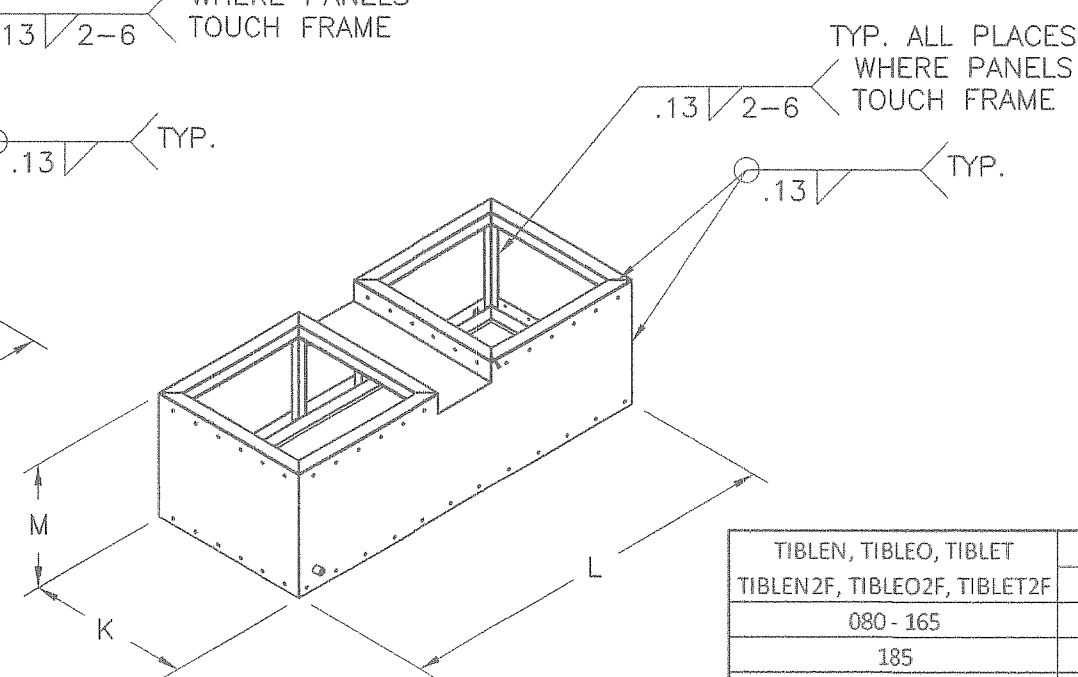
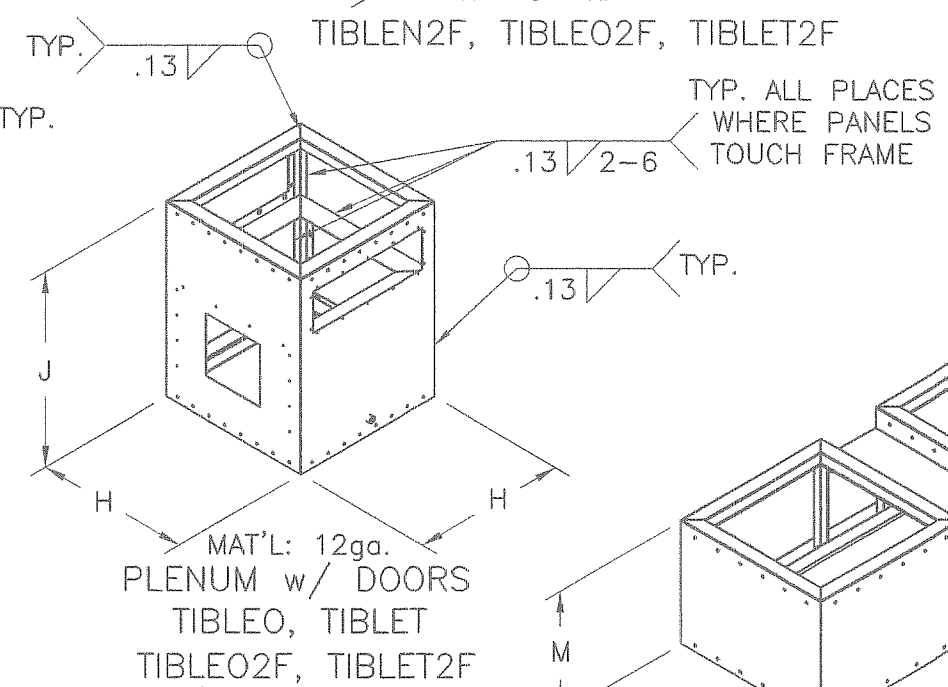
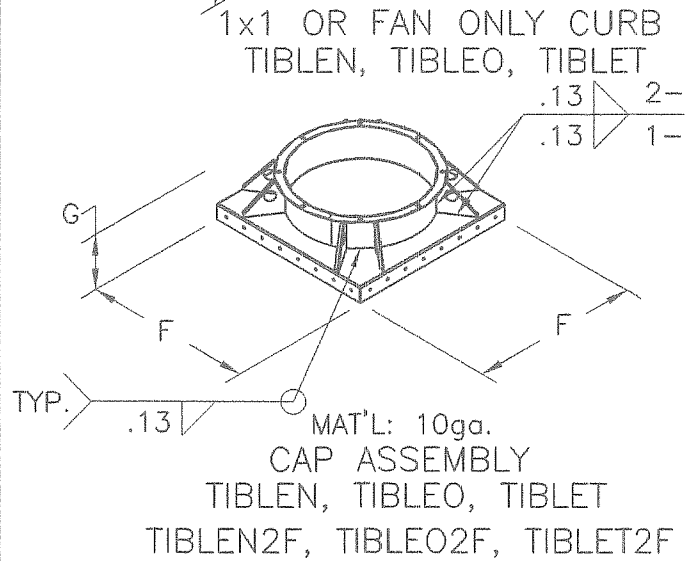
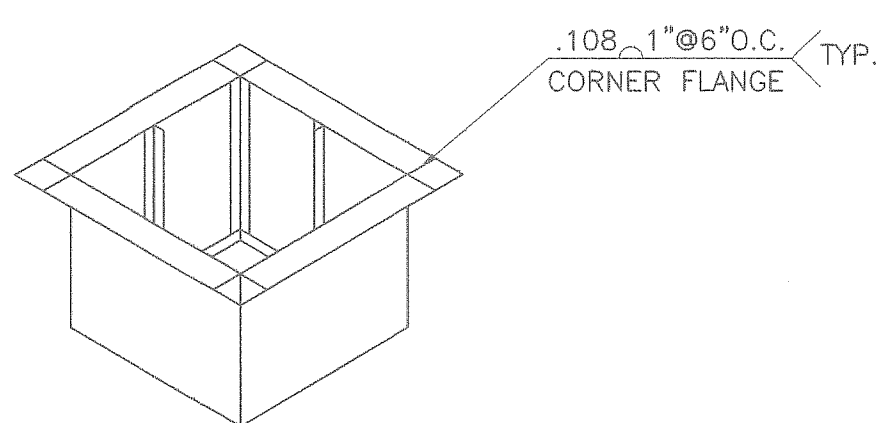

TYP. BOTTOM VIEW (FOR REFERENCE)

PRODUCT APPROVED
as complying with the Florida
Building Code
NOA-No. 21-0324.01
Approval Date 09/29/2022
By *[Signature]*
Miami-Dade Product Control

TIBLEN, TIBLCO, TIBLET TIBLEN2F, TIBLCO2F, TIBLET2F	DIMENSIONAL DATA						
	F	G	H	J	K	L	M
080 - 165	32.00	10.00	32.00	40.00	32.00	75.00	24.00
185	41.00	10.00	41.00	40.00	41.00	95.00	26.00
200	48.00	11.00	48.00	43.00	48.00	111.00	28.00
235-245	56.00	11.00	56.00	48.00	56.00	127.00	32.00

Large Missile Impact Resistant
Max rated design pressure : +140.0 / -140.0 PSF

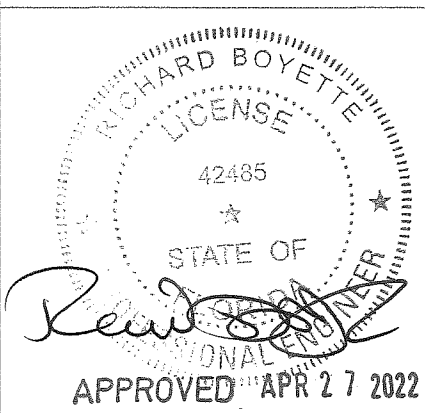

Richard Boyette, FL PE #42485
Rick Boyette Consulting Inc - CoA #9707
4031 Coconut Blvd
Royal Palm Beach FL 33411
561-790-5766

DWG NO. 806003 Sheet 6/7	
TITLE TIBLE HURRICANE FANS	
MAT'L	
DRAFTER MTJ	DATE 9/10/20
DESIGN ENG. TCR 9/10/20	RELEASED
CHKD BY	SCALE NTS

LET.	REVISION RECORD	BY	CKD.	DATE

Acme Engineering &
Manufacturing Corp.
1820 N. York Street
Muskogee, OK 74403
918-682-7791

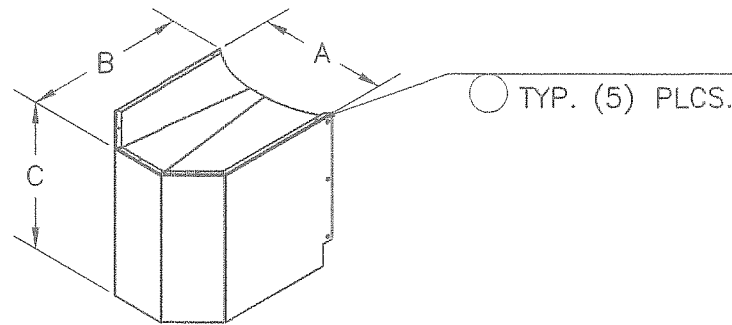

MAT'L: 18ga.
MOTOR COVER
TIBLEN, TIBLCO, TIBLET
TIBLEN2F, TIBLCO2F, TIBLET2F

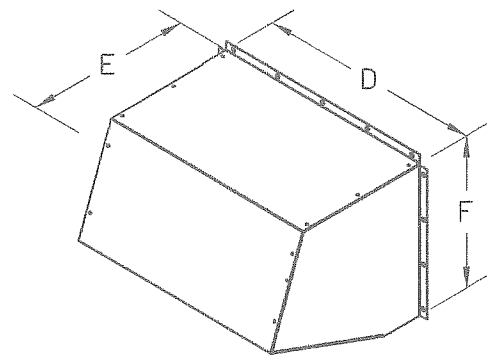

MAT'L: 16ga.
WEATHER COVER ASSY
TIBLEN, TIBLCO, TIBLET
TIBLEN2F, TIBLCO2F, TIBLET2F

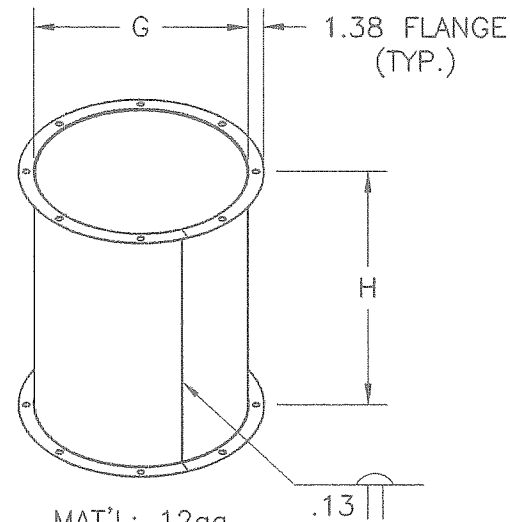

MAT'L: 12ga.
TUBE EXTENSION 1 & 2
TIBLEN, TIBLCO, TIBLET
TIBLEN2F, TIBLCO2F, TIBLET2F

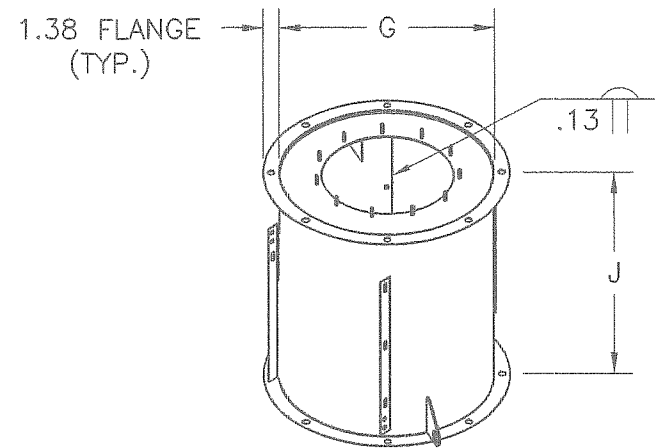

MAT'L: 12ga.
FAN HOUSING
TIBLEN, TIBLCO, TIBLET
TIBLEN2F, TIBLCO2F, TIBLET2F

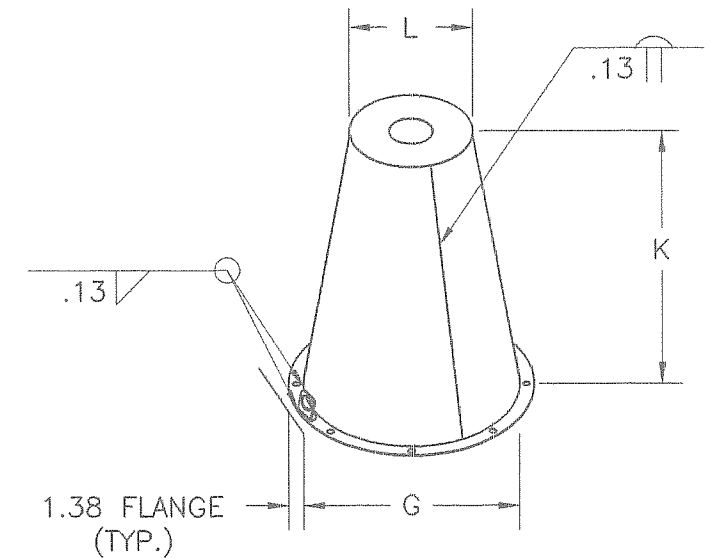

MAT'L: 16ga.
CONE
TIBLEN, TIBLCO, TIBLET
TIBLEN2F, TIBLCO2F, TIBLET2F

SIZE	DIMENSIONAL DATA										
	A	B	C	D	E	F	G	H (Ext.#1)	H (Ext.#2)	J	L
080-120	15.06	18.67	17.00	28.00	19.90	18.59	21.00	27.00	37.00	24.00	11.75 to 17.54
135-165	15.06	18.67	17.00	28.00	19.90	18.59	25.00	23.00	37.00	27.00	11.75 to 23.38
185	16.37	19.98	22.14	30.75	19.89	20.91	30.00	18.00	37.00	35.00	11.75 to 27.00
200	16.37	19.98	22.14	41.75	25.19	24.40	37.00	8.00	40.00	42.00	11.75 to 31.18
235-245	20.06	21.30	33.93	49.75	33.55	28.56	45.00	45.00 (N)		44.00	11.75 to 34.63

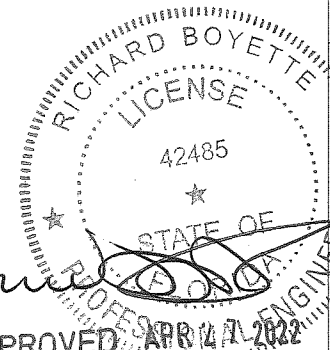

Richard Boyette, FL PE #42485
★ Rick Boyette Consulting Inc - CoA #9707
4031 Coconut Blvd
Royal Palm Beach FL 33411
561-790-5766

PRODUCT APPROVED
as complying with the Florida
Building Code

NOA-No. 21-0324.01

Approval Date 09/29/2022

By *[Signature]*
Miami-Dade Product Control

Large Missile Impact Resistant
Max rated design pressure : +140.0 / -140.0 PSF

DWG NO. 806003 Sheet 7/7

TITLE TIBLE HURRICANE FANS

MAT'L
DRAFTER MTJ DATE 9/10/20
DESIGN ENG. TCR 9/10/20 RELEASED
CHKD BY MFG. SCALE NTS

LET.	REVISION RECORD	BY	CKD.	DATE

Acme Engineering &
Manufacturing Corp.
1820 N. York Street
Muskogee, OK 74403
918-682-7791