



DEPARTMENT OF REGULATORY AND ECONOMIC RESOURCES (RER)
BOARD AND CODE ADMINISTRATION DIVISION

NOTICE OF ACCEPTANCE (NOA)

MIAMI-DADE COUNTY
PRODUCT CONTROL SECTION

11805 SW 26 Street, Room 208
Miami, Florida 33175-2474
T (786) 315-2590 F (786) 315-2599

www.miamidade.gov/economy

CertainTeed Ceilings Corporation
5015 Oakbrook Parkway, Suite 100
Norcross, GA 30093

SCOPE:

This NOA is being issued under the applicable rules and regulations governing the use of construction materials. The documentation submitted has been reviewed and accepted by Miami-Dade County RER-Product Control Section to be used in Miami Dade County and other areas where allowed by the Authority Having Jurisdiction (AHJ).

This NOA shall not be valid after the expiration date stated below. The Miami-Dade County Product Control Section (In Miami Dade County) and/or the AHJ (in areas other than Miami Dade County) reserve the right to have this product or material tested for quality assurance purposes. If this product or material fails to perform in the accepted manner, the manufacturer will incur the expense of such testing and the AHJ may immediately revoke, modify, or suspend the use of such product or material within their jurisdiction. RER reserves the right to revoke this acceptance if it is determined by Miami-Dade County Product Control Section that this product or material fails to meet the requirements of the applicable building code.

This product is approved as described herein and has been designed to comply with the Florida Building Code, including the High Velocity Hurricane Zone.

DESCRIPTION: 150F Vented Aluminum Exterior Ceiling System

APPROVAL DOCUMENT: Drawing No. **150F-B1.0-1.10**, titled "150F Product Specifications", sheets 1 through 10 of 10, dated 04/15/2021, prepared by the manufacturer, signed and sealed by Scott Wolters, P.E., bearing the Miami-Dade County Product Control revision stamp with the Notice of Acceptance number and expiration date by the Miami-Dade County Product Control Section.

MISSILE IMPACT RATING: None

LABELING: Each piece shall be permanently marked at not more than 4' o.c. with a number or marking and the packaging shall include the manufacturer's name or logo, city, state, model number or name, Miami-Dade County NOA number, test standards and net free area per FBC 1709.10.2 and 1709.10.3.

RENEWAL of this NOA shall be considered after a renewal application has been filed and there has been no change in the applicable building code negatively affecting the performance of this product.

TERMINATION of this NOA will occur after the expiration date or if there has been a revision or change in the materials, use, and/or manufacture of the product or process. Misuse of this NOA as an endorsement of any product, for sales, advertising or any other purposes shall automatically terminate this NOA. Failure to comply with any section of this NOA shall be cause for termination and removal of NOA.

ADVERTISEMENT: The NOA number preceded by the words Miami-Dade County, Florida, and followed by the expiration date may be displayed in advertising literature. If any portion of the NOA is displayed, then it shall be done in its entirety.

INSPECTION: A copy of this entire NOA shall be provided to the user by the manufacturer or its distributors and shall be available for inspection at the job site at the request of the Building Official.

This NOA **revises NOA # 20-0203.01** and consists of this page 1 and evidence pages E-1, E-2, E-3 and E-4, as well as approval document mentioned above.

The submitted documentation was reviewed by **Carlos M. Utrera, P.E.**



NOA No. 21-0427.06
Expiration Date: March 19, 2025
Approval Date: July 1, 2021
Page 1

NOTICE OF ACCEPTANCE: EVIDENCE SUBMITTED

1. Evidence submitted under NOA #14-1222.04

A. DRAWINGS

1. Drawing No. **150F-B1.0-1.10**, titled "150F Product Specifications", sheets 1 through 10 of 10, dated 11/11/2014, prepared by HDAP Engineering, signed and sealed by Scott Wolters, P.E.

B. TESTS

1. Test reports on 1) Uniform Static Air Pressure Test, Loading per FBC TAS 202-94
2) Cyclic Wind Pressure Loading per FBC, TAS 203-94
along with marked-up drawings of 150F (18" Configuration) Soffit System, prepared by Intertek-Architectural Testing, Inc., Test Report No. **D6475.01-550-18**, dated 11/24/2014, with revision 2 dated 12/11/2014, signed and sealed by Shawn G. Collins, P.E.
2. Test reports on 1) Uniform Static Air Pressure Test, Loading per FBC TAS 202-94
2) Cyclic Wind Pressure Loading per FBC, TAS 203-94
along with marked-up drawings of 150F (49" Configuration) Soffit System, prepared by Intertek-Architectural Testing, Inc., Test Report No. **D6475.03-550-18**, dated 11/24/2014, with revision 2 dated 12/11/2014, signed and sealed by Shawn G. Collins, P.E.
3. Test reports on 1) Uniform Static Air Pressure Test, Loading per FBC TAS 202-94
2) Cyclic Wind Pressure Loading per FBC, TAS 203-94
along with marked-up drawings of 150F (16" Configuration) Soffit System, prepared by Intertek-Architectural Testing, Inc., Test Report No. **D6475.04-550-18**, dated 11/24/2014, with revision 2 dated 12/11/2014, signed and sealed by Shawn G. Collins, P.E.
4. Test report on Wind Driven Rain Resistance Test per FBC, TAS 100(A)-95 of 150F Vented Soffit, prepared by Intertek-Architectural Testing, Inc., Test Report No. **D6475.05-109-18**, dated 11/24/2014, signed and sealed by Michael D. Stremmel, P.E.
5. Test report on Tensile Test per ASTM E8 of 150F Soffit Aluminum, prepared by Intertek-Architectural Testing, Inc., Test Report No. **D6475.07-106-18**, dated 12/04/2014, signed and sealed by Gary T. Hartman, P.E.

C. CALCULATIONS

1. Structural and anchorage calculations prepared by Wolters Engineering, Inc., dated 12/18/2014, signed and sealed by Scott Wolters, P.E.

D. QUALITY ASSURANCE

1. Miami-Dade Department of Regulatory and Economic Resources (RER)

E. MATERIAL CERTIFICATIONS

1. None.

F. STATEMENTS

1. Statement letter of code conformance to 2010 and 5th edition (2014) FBC issued by Wolters Engineering, Inc., dated 03/11/2015, signed and sealed by Scott Wolters, P.E.
2. Statement letter of no financial interest issued by Wolters Engineering, Inc., dated 12/18/2014, signed and sealed by Scott Wolters, P.E.



Carlos M. Utrera, P.E.
Product Control Examiner
NOA No. 21-0427.06
Expiration Date: March 19, 2025
Approval Date: July 1, 2021

NOTICE OF ACCEPTANCE: EVIDENCE SUBMITTED

2. Evidence submitted under NOA # 17-0807.10

A. DRAWINGS

1. None.

B. TESTS

1. None.

C. CALCULATIONS

1. None.

D. QUALITY ASSURANCE

1. Miami-Dade Department of Regulatory and Economic Resources (RER)

E. MATERIAL CERTIFICATIONS

1. None.

F. STATEMENTS

1. None.

G. OTHERS

1. Company name change request correspondence.



Carlos M. Utrera, P.E.
Product Control Examiner
NOA No. 21-0427.06
Expiration Date: March 19, 2025
Approval Date: July 1, 2021

NOTICE OF ACCEPTANCE: EVIDENCE SUBMITTED

3. Evidence submitted under NOA # 19-0214.01

A. DRAWINGS

1. Drawing No. **150F-B1.0-1.10**, titled “150F Product Specifications”, sheets 1 through 10 of 10, dated 03/01/2019, prepared by HDAP Engineering, signed and sealed by Scott Wolters, P.E.

B. TESTS

1. None.

C. CALCULATIONS

1. None.

D. QUALITY ASSURANCE

1. Miami-Dade Department of Regulatory and Economic Resources (RER)

E. MATERIAL CERTIFICATIONS

1. None.

F. STATEMENTS

1. Statement letter of code conformance to the 6th edition (2017) FBC issued by Wolters Engineering, Inc., dated 03/22/2019, signed and sealed by Scott Wolters, P.E.
2. Statement letter from Hunter Douglas, Inc. stating the following: a) They have legally sold all assets of the NOA, b) Requesting the existing NOA to be rescinded, c) They no longer manufacture the product under the existing NOA, d) They have given up all the rights to the existing NOA, and e) All the necessary machinery, equipment, and know-how used in the fabrication of the product used for the tests, which were the basis for obtaining the NOA are being sold to the applicant, dated 03/04/2019, signed by Richard Gottuso, Senior Vice-President & General Counsel.
3. Statement letter from CertainTeed Ceilings Corporation stating that they have purchased all the assets relative to the Hunter Douglas, Inc. NOA and requesting that a new NOA be issued under its name, dated 04/05/2019, signed by Carmen A. Bodden, President.

G. OTHERS

1. Asset Purchase Agreement dated 07/02/2018, signed by Carmen Bodden, President of CertainTeed Ceilings Corporation and Richard Gottuso, Vice President and General Counsel of Hunter Douglas, Inc.



Carlos M. Utrera, P.E.
Product Control Examiner
NOA No. 21-0427.06
Expiration Date: March 19, 2025
Approval Date: July 1, 2021

NOTICE OF ACCEPTANCE: EVIDENCE SUBMITTED

4. New evidence submitted

A. DRAWINGS

1. Drawing No. **150F-B1.0-1.10**, titled “150F Product Specifications”, sheets 1 through 10 of 10, dated 04/15/2021, prepared by the manufacturer, signed and sealed by Scott Wolters, P.E.

B. TESTS

1. None.

C. CALCULATIONS

1. None.

D. QUALITY ASSURANCE

1. Miami-Dade Department of Regulatory and Economic Resources (RER).

E. MATERIAL CERTIFICATIONS

1. None.

F. STATEMENTS

1. Statement letter of code conformance to the 7th edition (2020) of the FBC issued by Wolters Engineering, Inc., dated 04/24/2021, signed and sealed by Scott Wolters, P.E.



Carlos M. Utrera, P.E.
Product Control Examiner
NOA No. 21-0427.06
Expiration Date: March 19, 2025
Approval Date: July 1, 2021

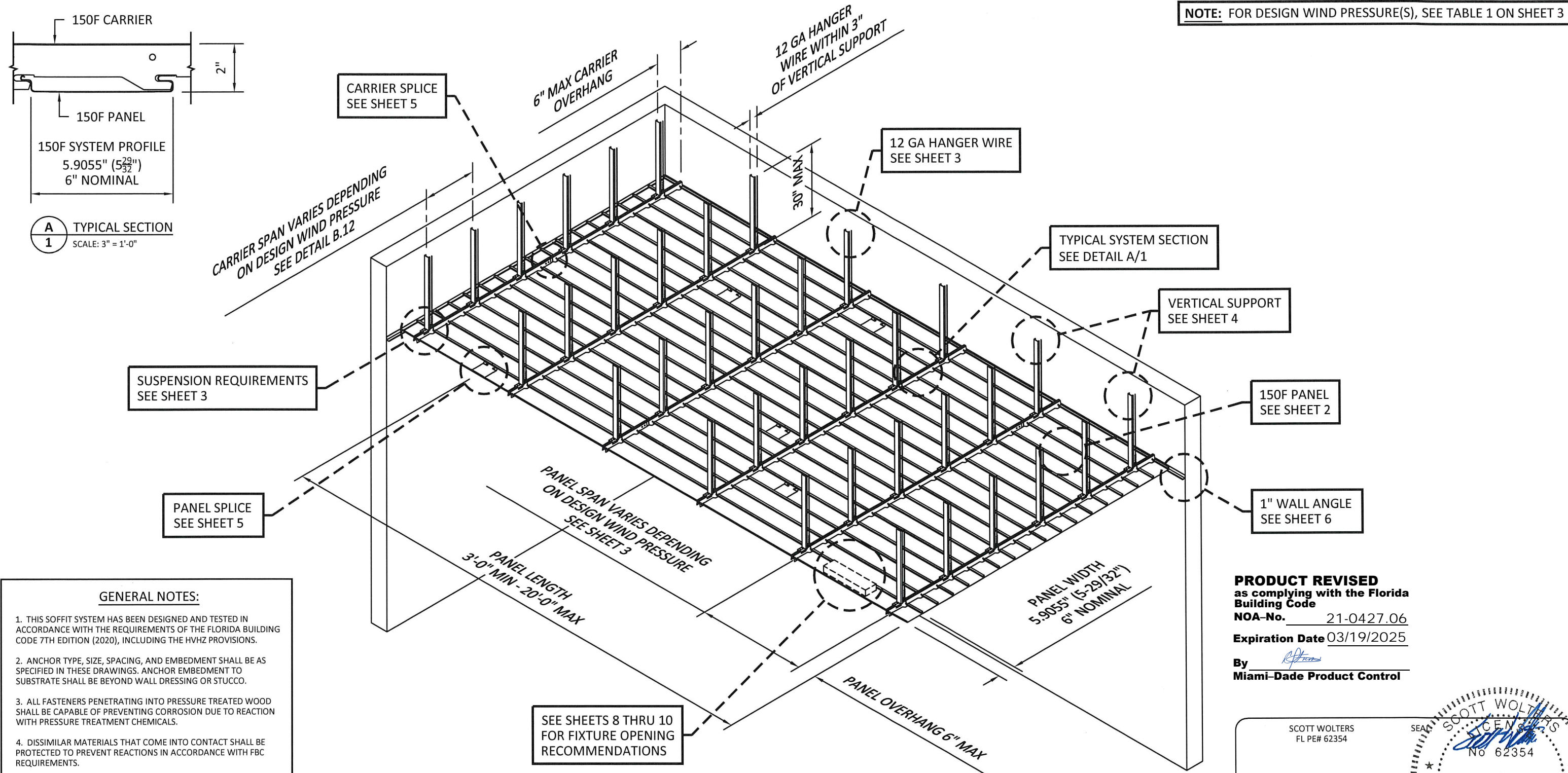

GENERAL NOTES:

1. THIS SOFFIT SYSTEM HAS BEEN DESIGNED AND TESTED IN ACCORDANCE WITH THE REQUIREMENTS OF THE FLORIDA BUILDING CODE 7TH EDITION (2020), INCLUDING THE HVHZ PROVISIONS.
2. ANCHOR TYPE, SIZE, SPACING, AND EMBEDMENT SHALL BE AS SPECIFIED IN THESE DRAWINGS. ANCHOR EMBEDMENT TO SUBSTRATE SHALL BE BEYOND WALL DRESSING OR STUCCO.
3. ALL FASTENERS PENETRATING INTO PRESSURE TREATED WOOD SHALL BE CAPABLE OF PREVENTING CORROSION DUE TO REACTION WITH PRESSURE TREATMENT CHEMICALS.
4. DISSIMILAR MATERIALS THAT COME INTO CONTACT SHALL BE PROTECTED TO PREVENT REACTIONS IN ACCORDANCE WITH FBC REQUIREMENTS.
5. A WINDLOAD DURATION FACTOR (Cd) OF 1.6 WAS USED FOR ANALYSIS OF WOOD SCREWS ONLY. THE 1/3 INCREASE IN ALLOWABLE STRESS FOR WIND DESIGN WAS NOT USED.

PRODUCT REVISED
as complying with the Florida
Building Code
NOA-No. 21-0427.06
Expiration Date 03/19/2025
By
Miami-Dade Product Control

SCOTT WOLTERS
FL PE# 62354

WOLTERS ENGINEERING
(COA# 27194)
15211 97TH ROAD N
WEST PALM BEACH, FL 33412
PH/FAX: (561) 225-1982

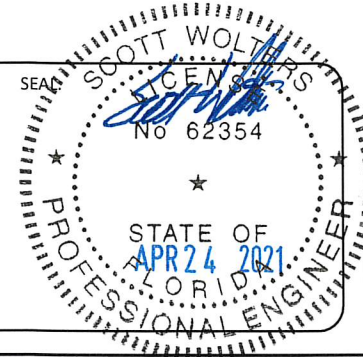

EXTERIOR INSTALLATION

ARCHITECTURAL

CertainTeed
SAINT-GOBAIN

5015 Oakbrook Parkway, Suite 100
Norcross, GA 30093
O 800 366 4327
F 770 806 0214
www.certainteed.com/architectural

SPECIFICATIONS

(unless noted otherwise)

MATERIAL: .025" ALUMINUM ALLOY 3005-H48 150F PANEL | .040" ALUMINUM ALLOY 5050-H48 150F CARRIER
FINISH: PAINT | POWDER COAT | DECORATED WOOD FINISH | LUXACOTE
PERFORATION: NON-PERFORATED | #124 (15% OPEN)

OVERALL ISOMETRIC VIEW

PROJECT: 150F PRODUCT SPECIFICATIONS
DRAWING NUMBER: 150F-B1.0
SHEET: 1 OF 10
SCALE: AS SHOWN
DRAWN BY: CT ENGINEERING
DATE: 4/15/21

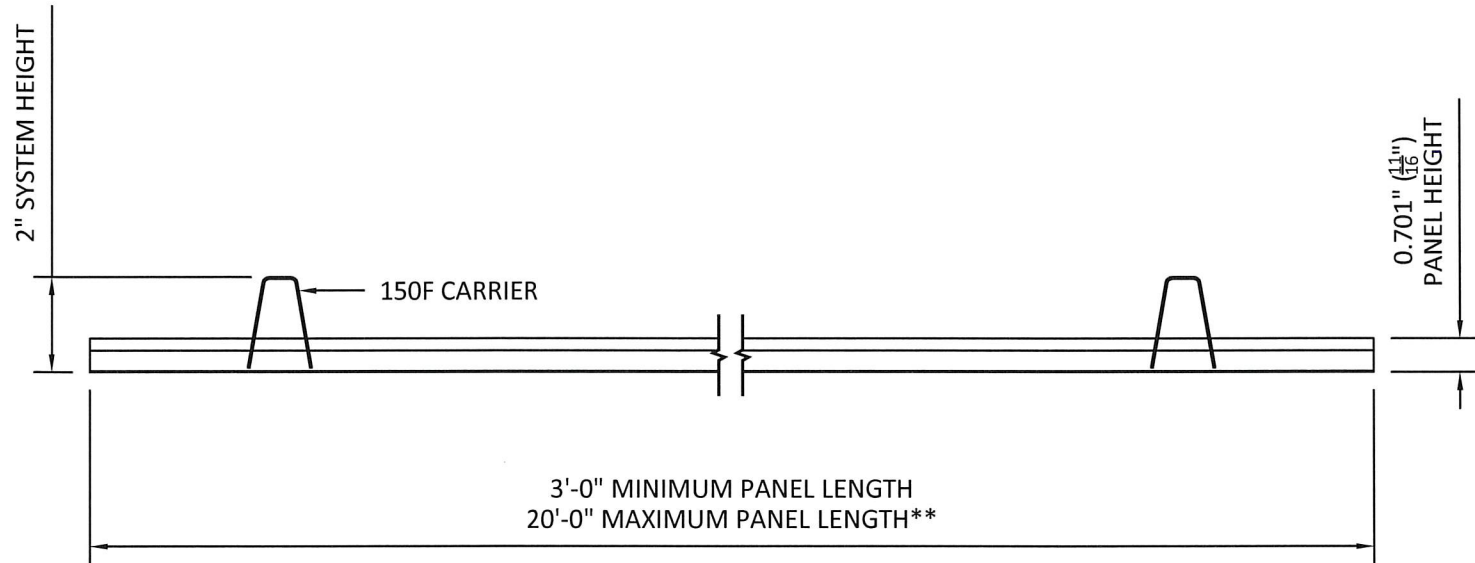

FACTORY SIDE PANEL VIEW

SCALE: 3" = 1'-0"

*VERTICAL SUPPORT OMITTED FOR CLARITY

**PANEL LENGTHS VARIABLE IN $\frac{1}{8}$ " (.125") INCREMENTS, TOLERANCE +/- $\frac{1}{8}$ "

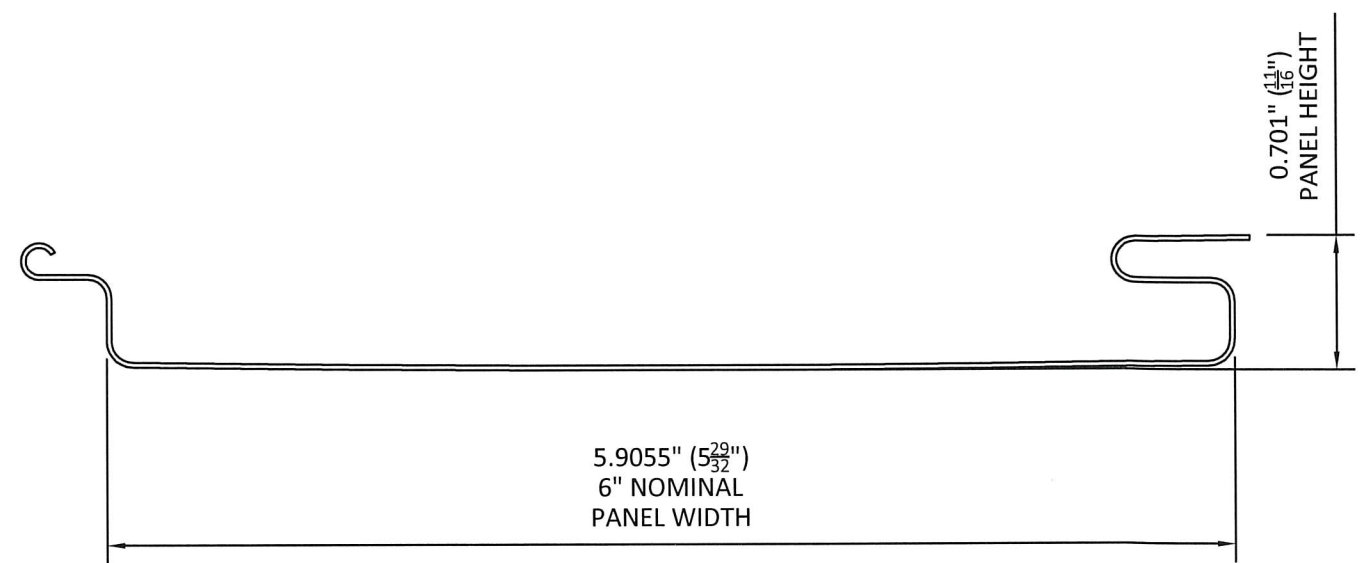

FACTORY END PANEL VIEW

SCALE: FULL

*SUSPENSION OMITTED FOR CLARITY

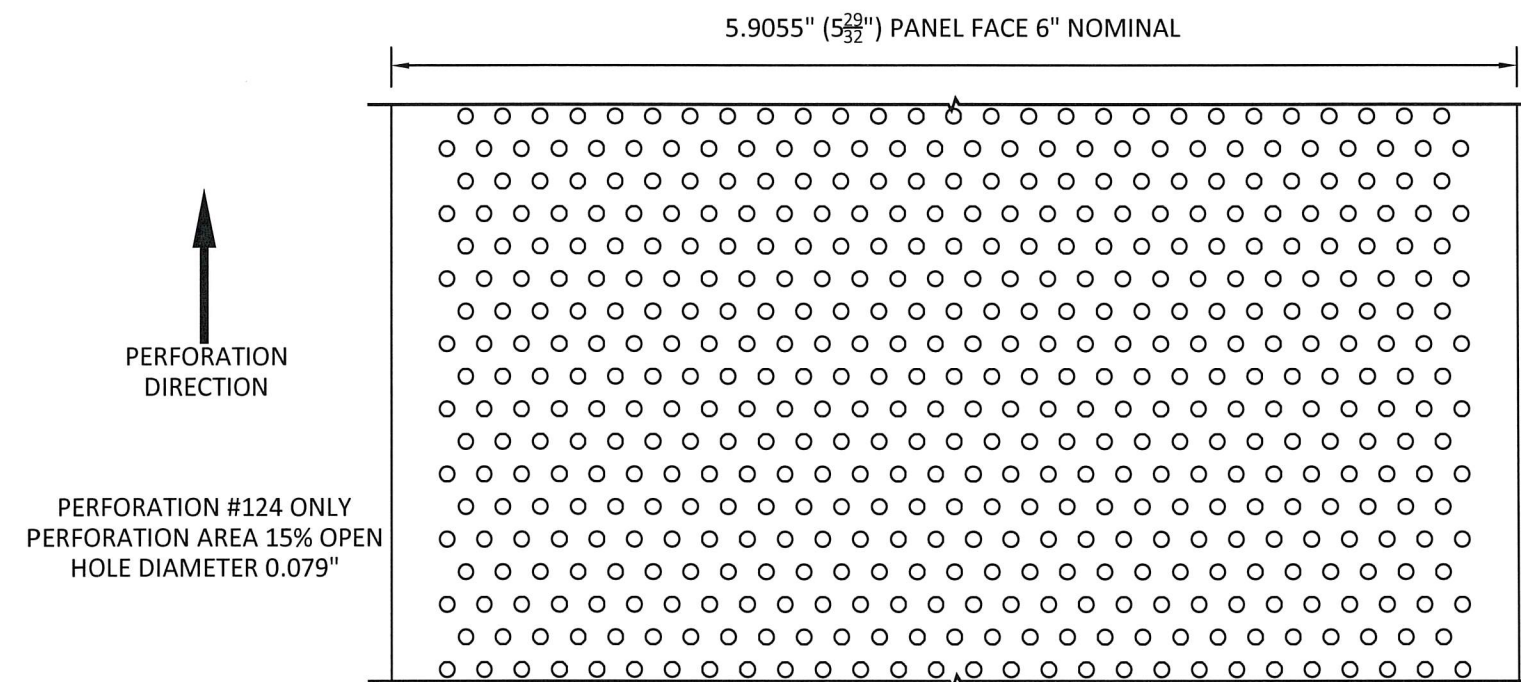

AVAILABLE PERFORATION

SCALE: FULL

150F PANEL MATERIAL THICKNESS
.025" ALUMINUM ALLOY 3005-H48

150F PANEL FINISHES

PAINTED & POWDER COATED - INTERIOR &
EXTERIOR

LUXACOTE - INTERIOR & EXTERIOR

DECORATED WOOD FINISH (POWDER COATED) -
INTERIOR & EXTERIOR

PRODUCT REVISED
as complying with the Florida
Building Code

NOA-No. 21-0427.06

Expiration Date 03/19/2025

By *[Signature]*
Miami-Dade Product Control

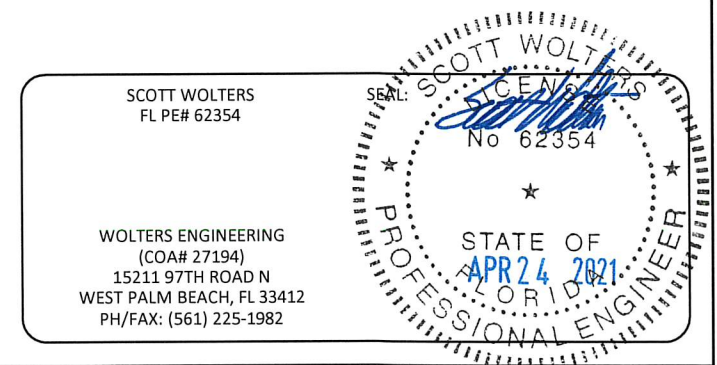

PANEL MATERIAL/FINISHES

SCALE: NOT TO SCALE

ARCHITECTURAL

CertainTeed
SAINT-GOBAIN

5015 Oakbrook Parkway, Suite 100
Norcross, GA 30093
O 800 366 4327
F 770 806 0214
www.certainteed.com/architectural

SPECIFICATIONS

(unless noted otherwise)

MATERIAL: .025" ALUMINUM ALLOY 3005-H48 150F PANEL | .040" ALUMINUM
ALLOY 5050-H48 150F CARRIER

FINISH: PAINT | POWDER COAT | DECORATED WOOD FINISH | LUXACOTE

PERFORATION: NON-PERFORATED | #124 (15% OPEN)

PANEL SPECIFICATIONS

PROJECT: 150F PRODUCT SPECIFICATIONS

DRAWING NUMBER: 150F-B1.1

SHEET: 2 OF 10

SCALE: AS SHOWN

DRAWN BY: CT ENGINEERING

DATE: 4/15/21

NOTE A:

CARRIER SPACING (PANEL SPAN) AND CARRIER SPAN (HANGER WIRE & VERTICAL SUPPORT SPACING) VARIES DEPENDING ON DESIGN WIND PRESSURE (POUNDS PER SQUARE FOOT). AS A GENERAL GUIDE, REFER TO THE DETAIL AND WIND LOAD TABLE 1 BELOW FOR CARRIER SPACING AND CARRIER SPAN. THE WIND LOAD CRITERIA IS BASED ON USING 3 OR MORE ROWS OF CARRIER. MAXIMUM PANEL OVERHANG = 6". MAXIMUM CARRIER OVERHANG = 6".

HANGER WIRE (12 GA MIN.) MUST BE LOCATED AT EACH VERTICAL SUPPORT STRUT. VERTICAL SUPPORT STRUT MUST NOT EXCEED SPACING SHOWN FOR A GIVEN DESIGN WIND PRESSURE. SEE DRAWING # 150F-B1.3 FOR VERTICAL SUPPORT SPECIFICATION. HANGER WIRE AND VERTICAL SUPPORT STRUT MUST BE ATTACHED TO STRUCTURE ABOVE TO SAFELY SUPPORT ALL LOADS IMPOSED BY SOFFIT SYSTEM.

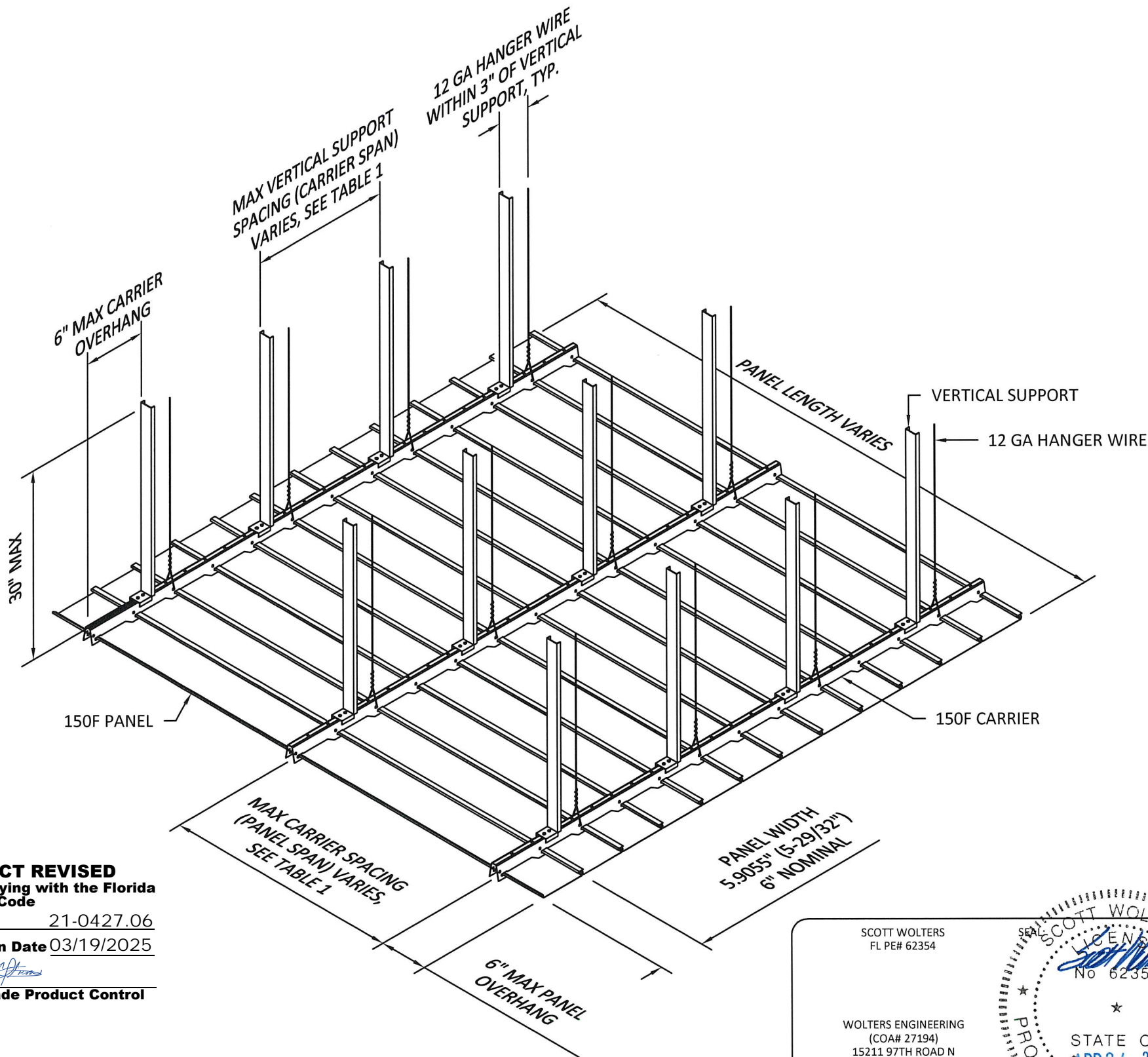

150F CARRIER*
MATERIAL: .040" ALUMINUM ALLOY 5050-H48
FINISH: MATTE BLACK
PART LENGTH: 16'-0"

*CONTAINS INTEGRAL SPLICE

TABLE 1 - DESIGN WIND LOAD - 150F EXTERIOR CEILING SYSTEM

PANEL MATERIAL: .025" ALUMINUM
CARRIER MATERIAL: .040" ALUMINUM

ALLOWABLE CARRIER SPACING (PANEL SPAN)
ALLOWABLE CARRIER SUPPORT SPACING (HANGER WIRE/VERTICAL SUPPORT SPACING)

* CARRIER SPACING BASED ON USING 3 OR MORE CARRIERS		
** POUNDS PER SQUARE FOOT		
DESIGN WIND PRESSURE (POSITIVE OR NEGATIVE PSF**)	CARRIER SPACING * (PANEL SPAN)	CARRIER SPAN (VERTICAL SUPPORT SPACING)
20	49"	20"
25	40"	20"
30	34"	20"
35	29"	20"
40	26"	20"
50	22"	20"
55	21"	20"
60	18"	20"
75	16"	20"

PRODUCT REVISED
as complying with the Florida
Building Code
NOA-No. 21-0427.06
Expiration Date 03/19/2025
By 
Miami-Dade Product Control

EXTERIOR INSTALLATION

SCOTT WOLTERS
FL PE# 62354

WOLTERS ENGINEERING
(COA# 27194)
15211 97TH ROAD N
WEST PALM BEACH, FL 33412
PH/FAX: (561) 225-1982

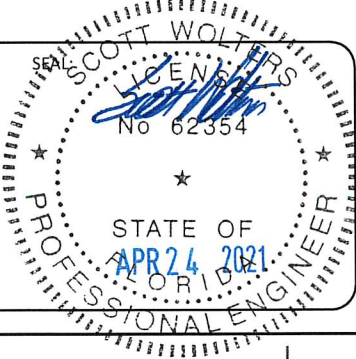

ARCHITECTURAL

CertainTeed
SAINT-GOBAIN

5015 Oakbrook Parkway, Suite 100
Norcross, GA 30093
O 800 366 4327
F 770 806 0214
www.certainteed.com/architectural

SPECIFICATIONS
(unless noted otherwise)

MATERIAL: .025" ALUMINUM ALLOY 3005-H48 150F PANEL | .040" ALUMINUM ALLOY 5050-H48 150F CARRIER

FINISH: PAINT | POWDER COAT | DECORATED WOOD FINISH | LUXACOTE

PERFORATION: NON-PERFORATED | #124 (15% OPEN)

SUSPENSION SPECIFICATIONS

PROJECT: 150F PRODUCT SPECIFICATIONS
DRAWING NUMBER: 150F-B1.2
SHEET: 3 OF 10
SCALE: NOT TO SCALE
DRAWN BY: CT ENGINEERING
DATE: 4/15/21

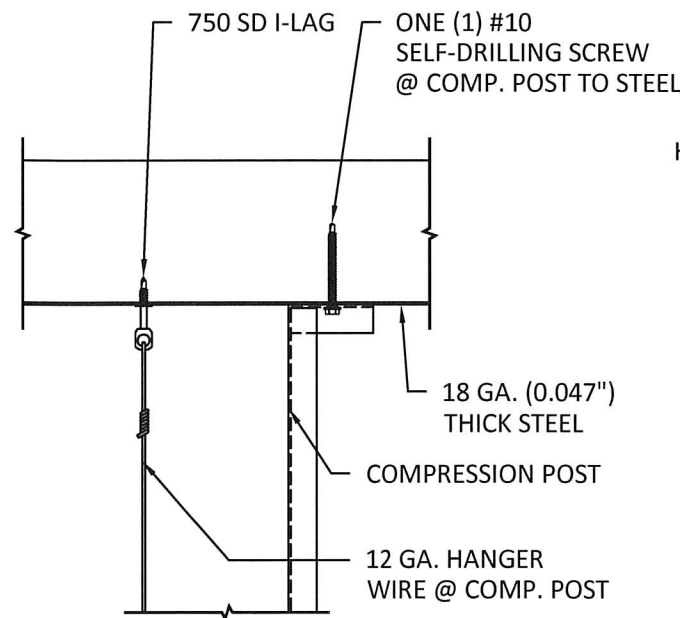

STEEL CONNECTION W/ I-LAGS & SELF-DRILLING SCREWS

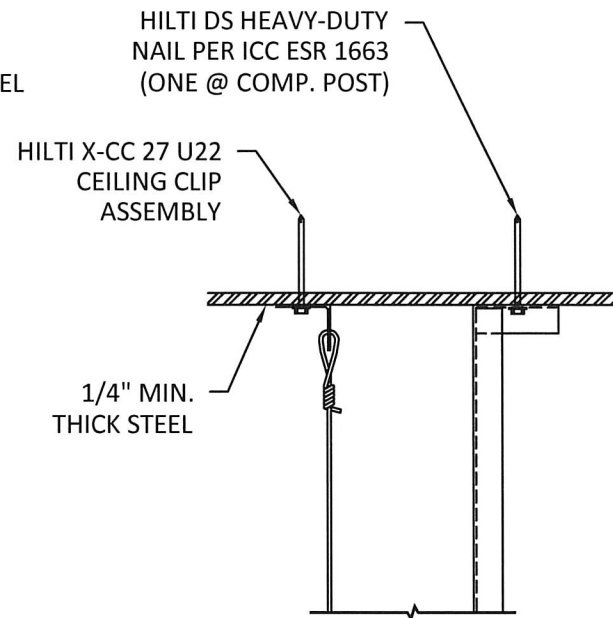

STEEL CONNECTION W/ SHOT PINS

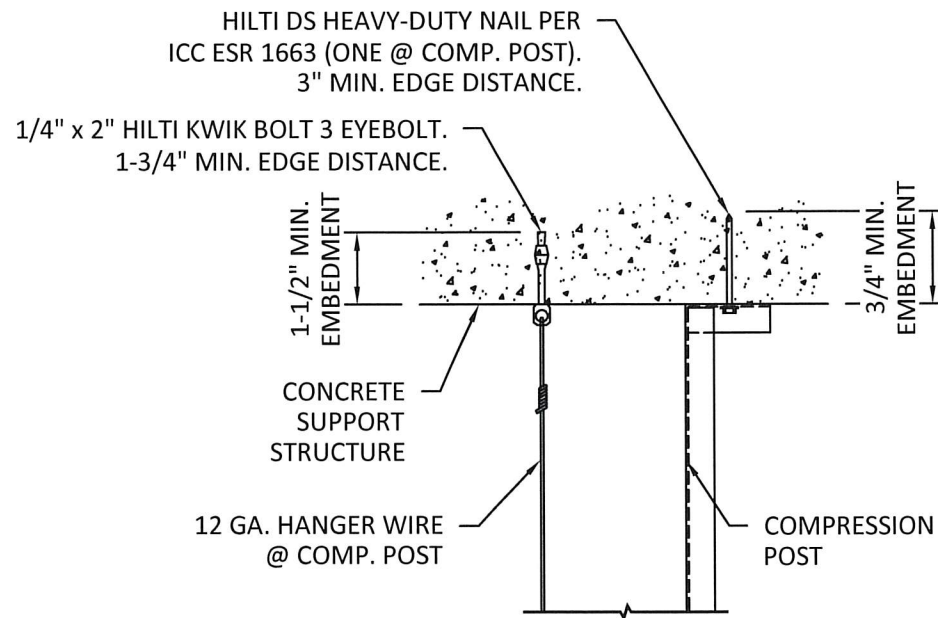

CONCRETE CONNECTION W/ EXP. ANCHORS & SHOT PINS

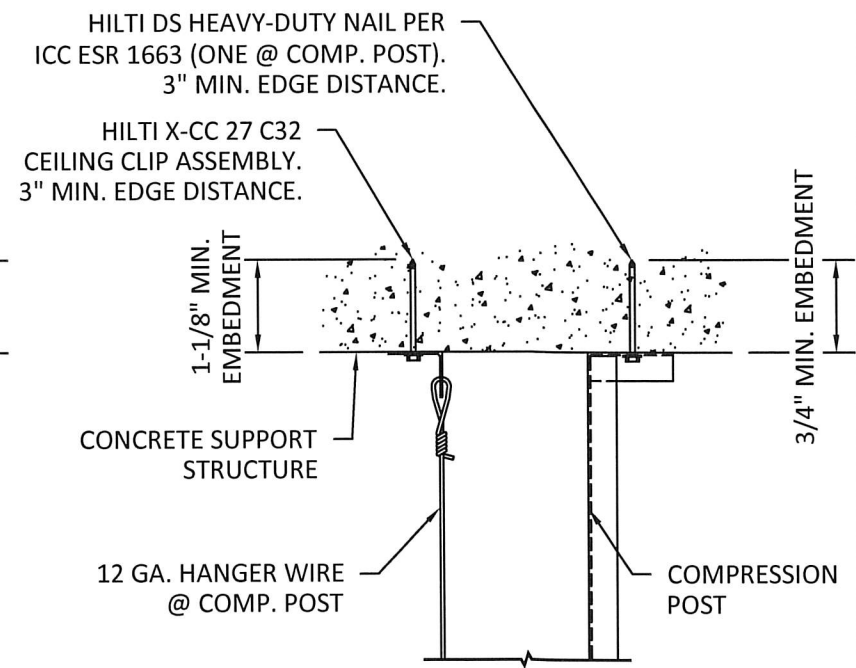

CONCRETE CONNECTION W/ SHOT PINS

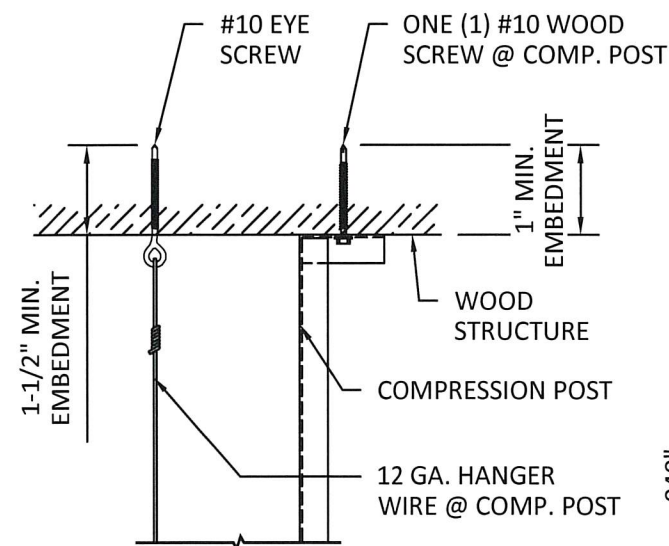

WOOD CONNECTION W/ WOOD SCREWS

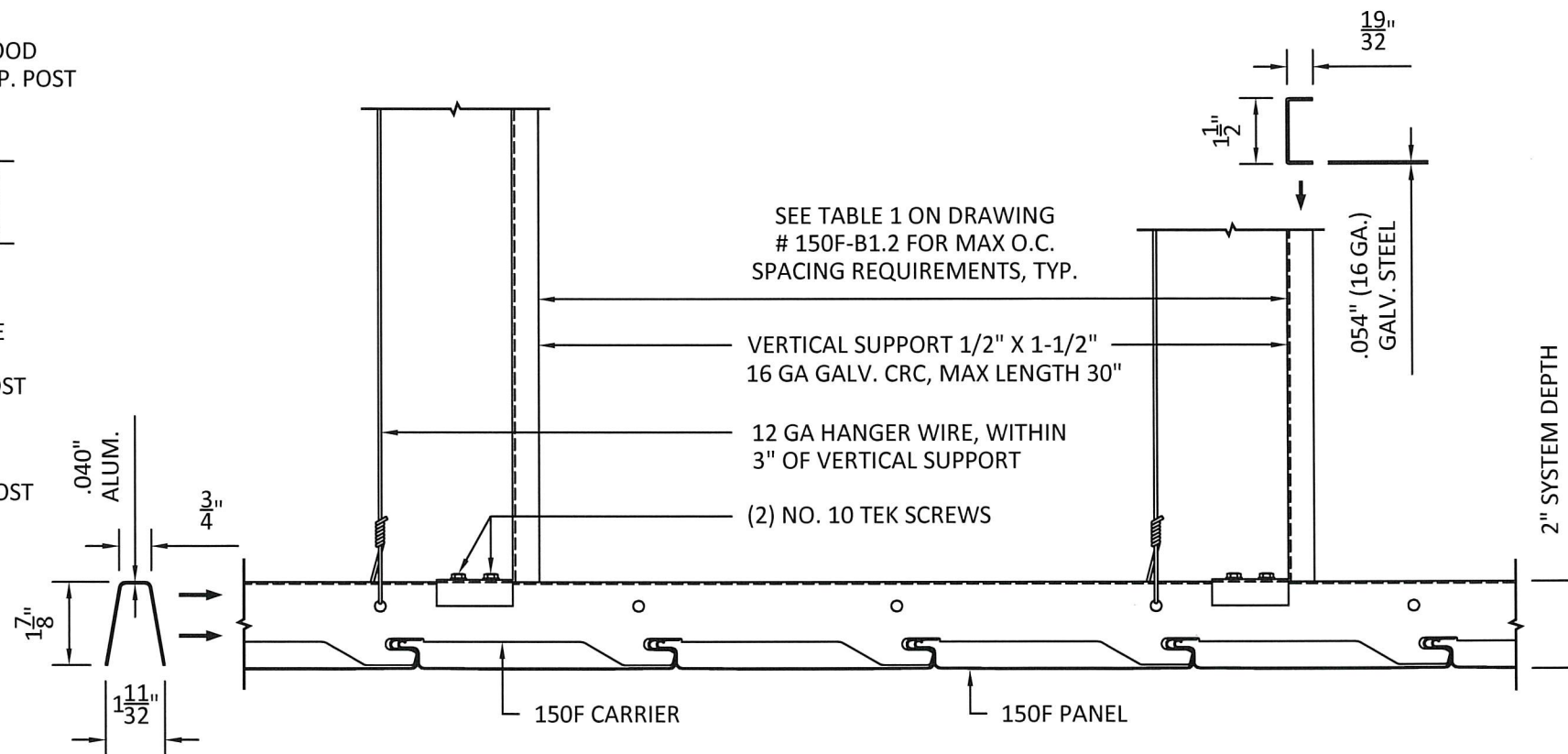

A
4 SECTION AT VERTICAL SUPPORT ATTACHMENT
SCALE: 3\" = 1'-0\"

EXTERIOR INSTALLATION

PRODUCT REVISED
as complying with the Florida Building Code
NOA-No. 21-0427.06
Expiration Date 03/19/2025
By *[Signature]*
Miami-Dade Product Control

SCOTT WOLTERS
FL PE# 62354

SCOTT WOLTERS
No 62354

WOLTERS ENGINEERING
(COA# 27194)
15211 97TH ROAD N
WEST PALM BEACH, FL 33412
PH/FAX: (561) 225-1982

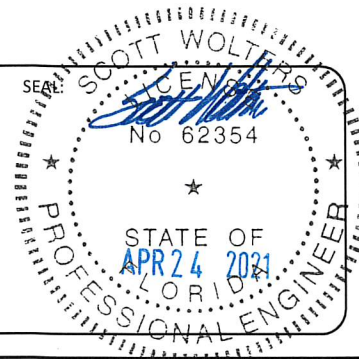

ARCHITECTURAL

CertainTeed
SAINT-GOBAIN

5015 Oakbrook Parkway, Suite 100
Norcross, GA 30093
O 800 366 4327
F 770 806 0214
www.certainteed.com/architectural

SPECIFICATIONS
(unless noted otherwise)

MATERIAL: .025\" ALUMINUM ALLOY 3005-H48 150F PANEL | .040\" ALUMINUM ALLOY 5050-H48 150F CARRIER
FINISH: PAINT | POWDER COAT | DECORATED WOOD FINISH | LUXACOTE
PERFORATION: NON-PERFORATED | #124 (15% OPEN)

VERTICAL SUPPORT SPECIFICATIONS

PROJECT: 150F PRODUCT SPECIFICATIONS
DRAWING NUMBER: 150F-B1.3
SHEET: 4 OF 10
SCALE: AS SHOWN
DRAWN BY: CT ENGINEERING
DATE: 4/15/21

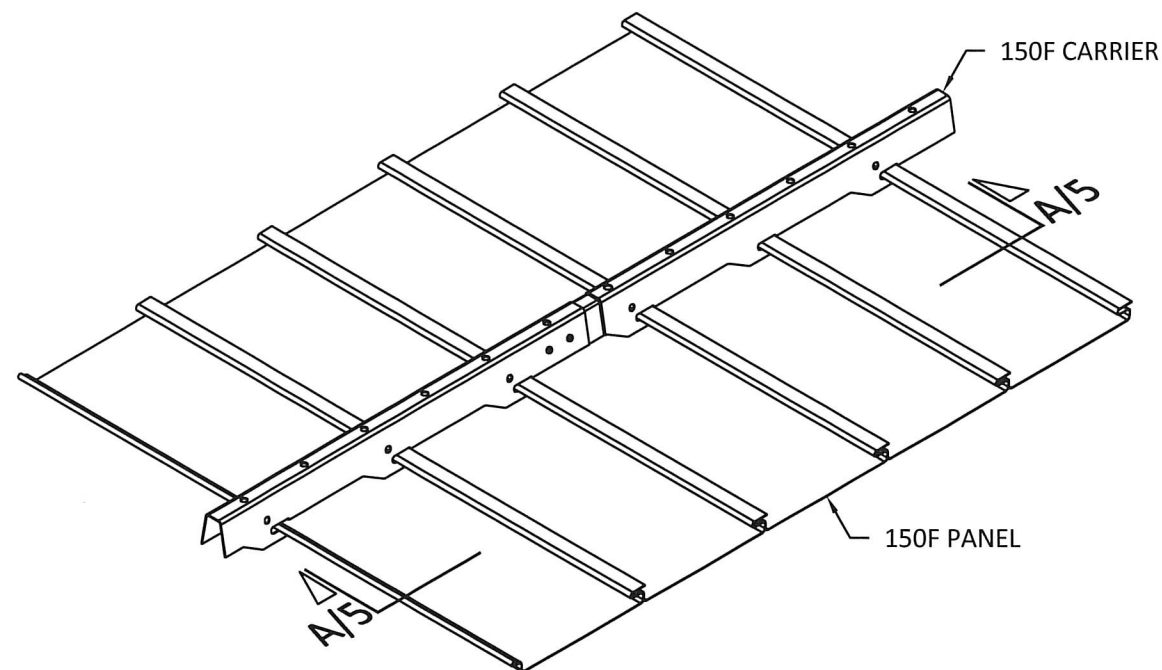

THE 150F CARRIER CONTAINS AN INTEGRAL SPLICE. NEST ONE END OF THE CARRIER INTO THE OTHER END AND LINE UP THE HOLES AND FLANGES TO MAINTAIN THE MODULE.

INSTALL #10 SCREW FASTENERS (2) ON EACH SIDE OF THE NESTED CARRIER ASSEMBLY, (4) TOTAL ARE REQUIRED TO SECURE THE CARRIERS.

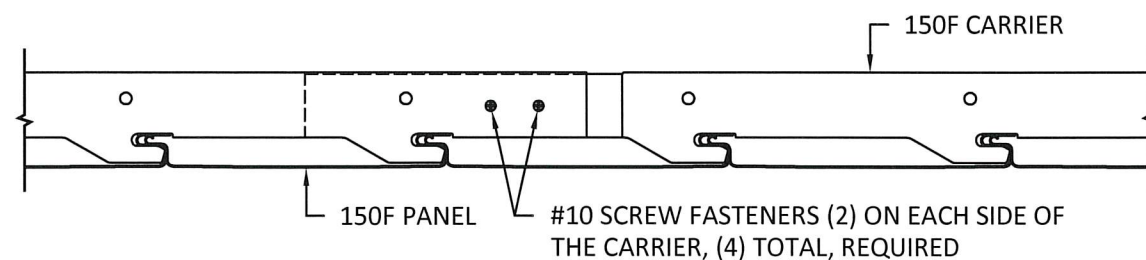
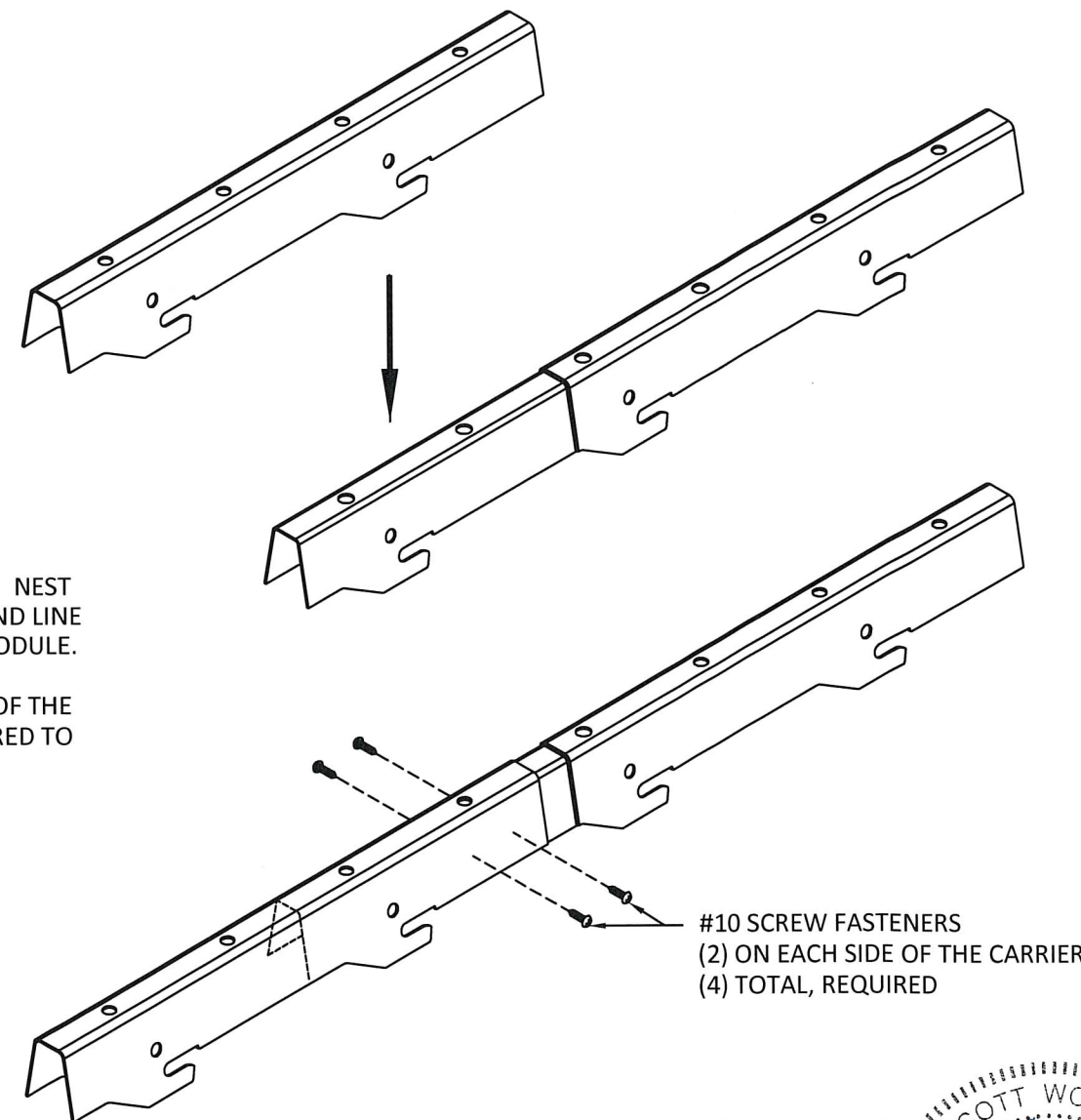

A
5 SECTION AT INTEGRAL SPLICE
SCALE: 3" = 1'-0"

PRODUCT REVISED
as complying with the Florida
Building Code

NOA-No. 21-0427.06

Expiration Date 03/19/2025

By *[Signature]*
Miami-Dade Product Control

EXTERIOR INSTALLATION

*VERTICAL SUPPORT OMITTED FOR CLARITY

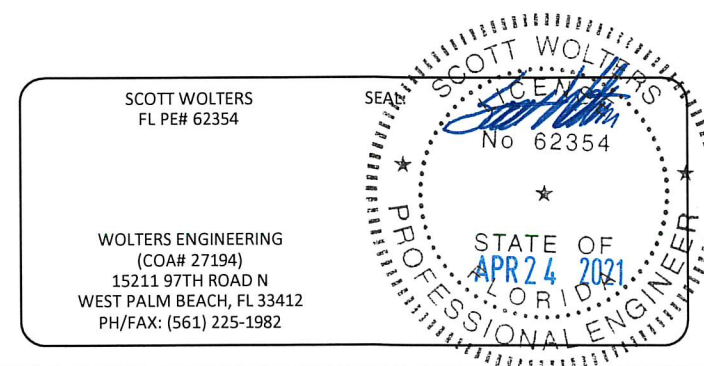

ARCHITECTURAL

CertainTeed
SAINT-GOBAIN

5015 Oakbrook Parkway, Suite 100
Norcross, GA 30093
O 800 366 4327
F 770 806 0214
www.certainteed.com/architectural

SPECIFICATIONS

(unless noted otherwise)

MATERIAL: .025" ALUMINUM ALLOY 3005-H48 150F PANEL | .040" ALUMINUM

ALLOY 5050-H48 150F CARRIER

FINISH: PAINT | POWDER COAT | DECORATED WOOD FINISH | LUXACOTE

PERFORATION: NON-PERFORATED | #124 (15% OPEN)

CARRIER SPLICE

PROJECT: 150F PRODUCT SPECIFICATIONS

DRAWING NUMBER: 150F-B1.4

SHEET: 5 OF 10

SCALE: AS SHOWN

DRAWN BY: CT ENGINEERING

DATE: 4/15/21

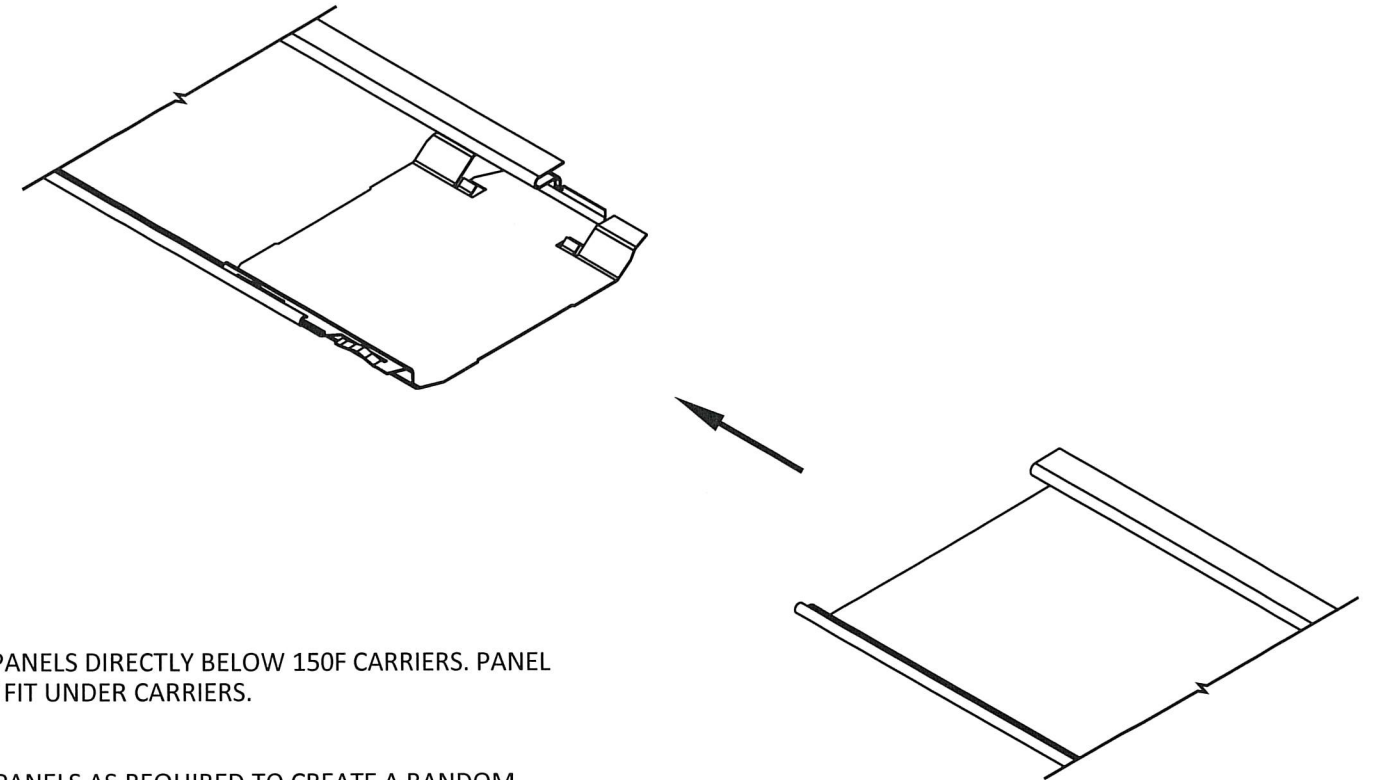
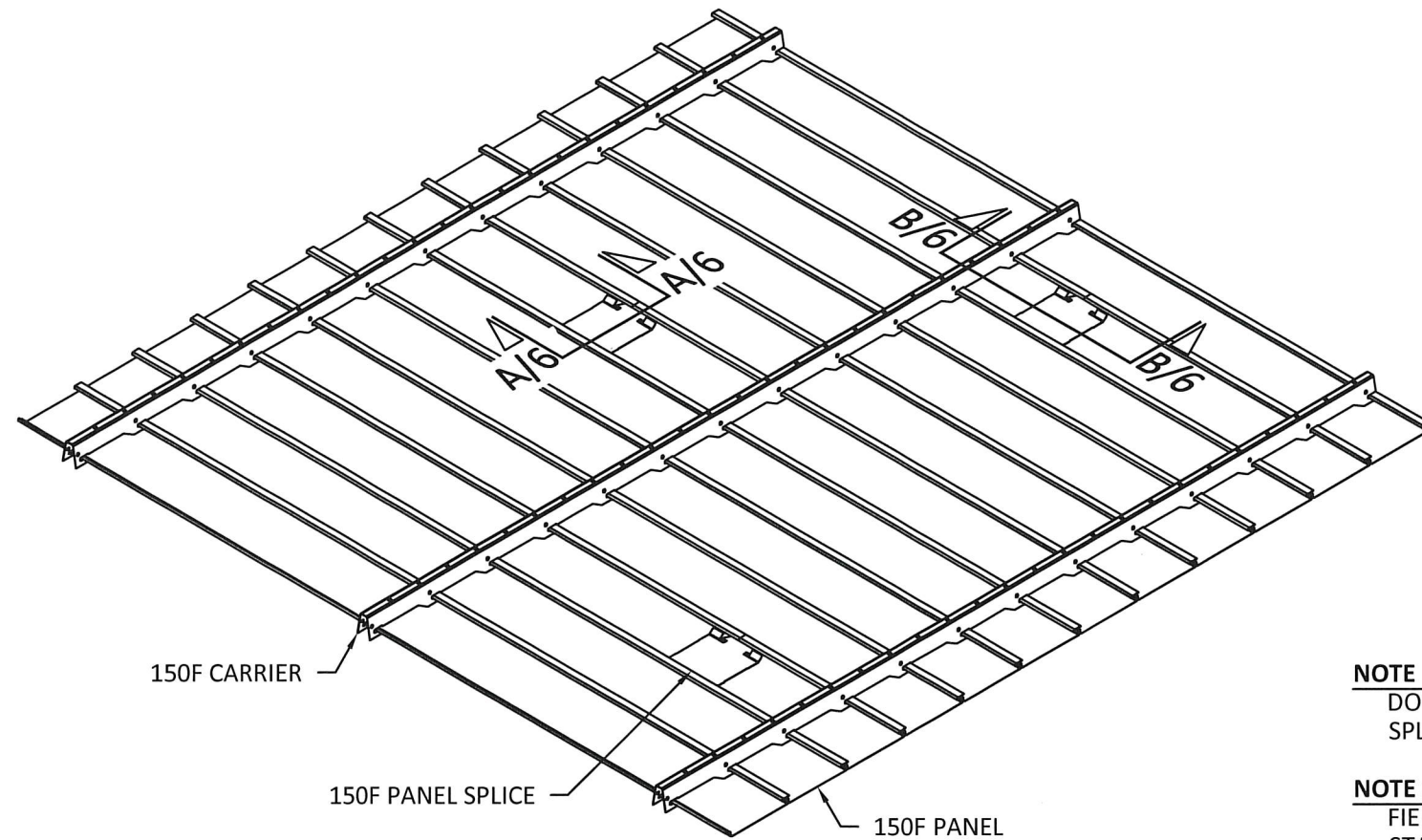

NOTE 1:

DO NOT SPLICE PANELS DIRECTLY BELOW 150F CARRIERS. PANEL SPLICES DO NOT FIT UNDER CARRIERS.

NOTE 2:

FIELD CUT 150F PANELS AS REQUIRED TO CREATE A RANDOM STAGGERED SEAM PATTERN. AVOID ALIGNED SEAMS.

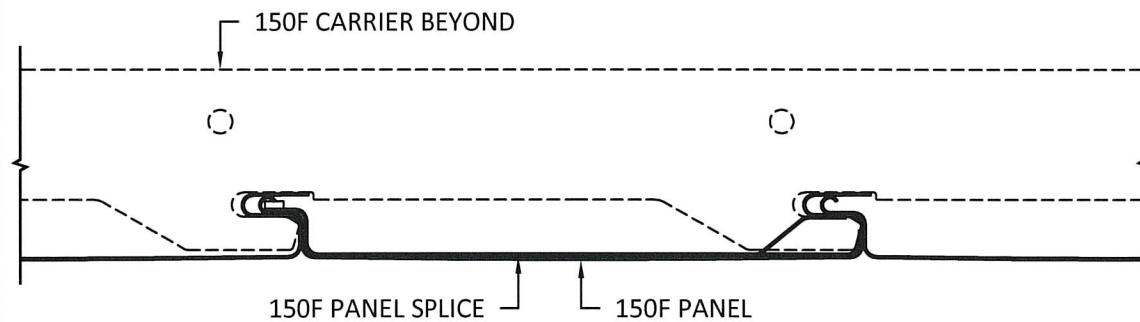

A SECTION AT PANEL SPLICE
6 SCALE: 6" = 1'-0"

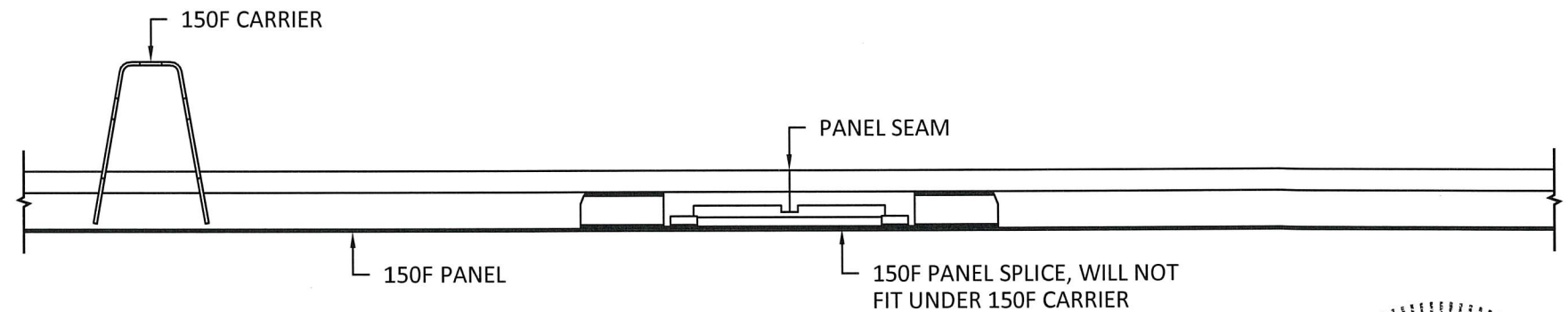

B SECTION AT PANEL SPLICE
6 SCALE: 6" = 1'-0"

PRODUCT REVISED
as complying with the Florida
Building Code
NOA-No. 21-0427.06
Expiration Date 03/19/2025
By *[Signature]*
Miami-Dade Product Control

SCOTT WOLTERS
FL PE# 62354

SEAL

No 62354

WOLTERS ENGINEERING
(COA# 27194)
15211 97TH ROAD N
WEST PALM BEACH, FL 33412
PH/FAX: (561) 225-1982

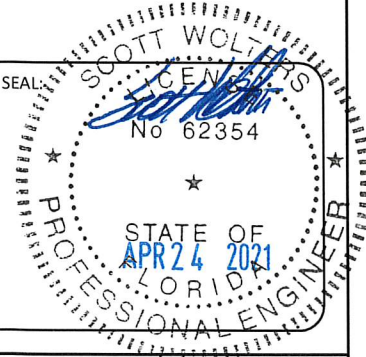

*VERTICAL SUPPORT OMITTED FOR CLARITY

EXTERIOR INSTALLATION

ARCHITECTURAL

CertainTeed
SAINT-GOBAIN

5015 Oakbrook Parkway, Suite 100
Norcross, GA 30093
O 800 366 4327
F 770 806 0214
www.certainteed.com/architectural

SPECIFICATIONS

(unless noted otherwise)

MATERIAL: .025" ALUMINUM ALLOY 3005-H48 150F PANEL | .040" ALUMINUM
ALLOY 5050-H48 150F CARRIER
FINISH: PAINT | POWDER COAT | DECORATED WOOD FINISH | LUXACOTE
PERFORATION: NON-PERFORATED | #124 (15% OPEN)

PANEL SPLICE

PROJECT: 150F PRODUCT SPECIFICATIONS
DRAWING NUMBER: 150F-B1.5
SHEET: 6 OF 10
SCALE: AS SHOWN
DRAWN BY: CT ENGINEERING
DATE: 4/15/21

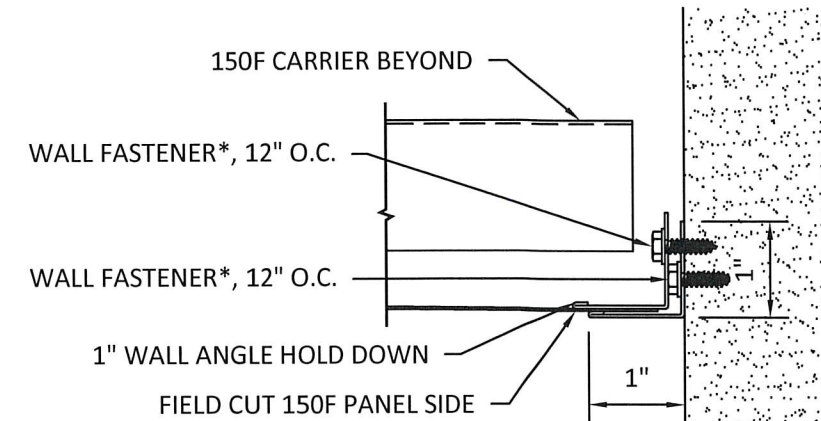
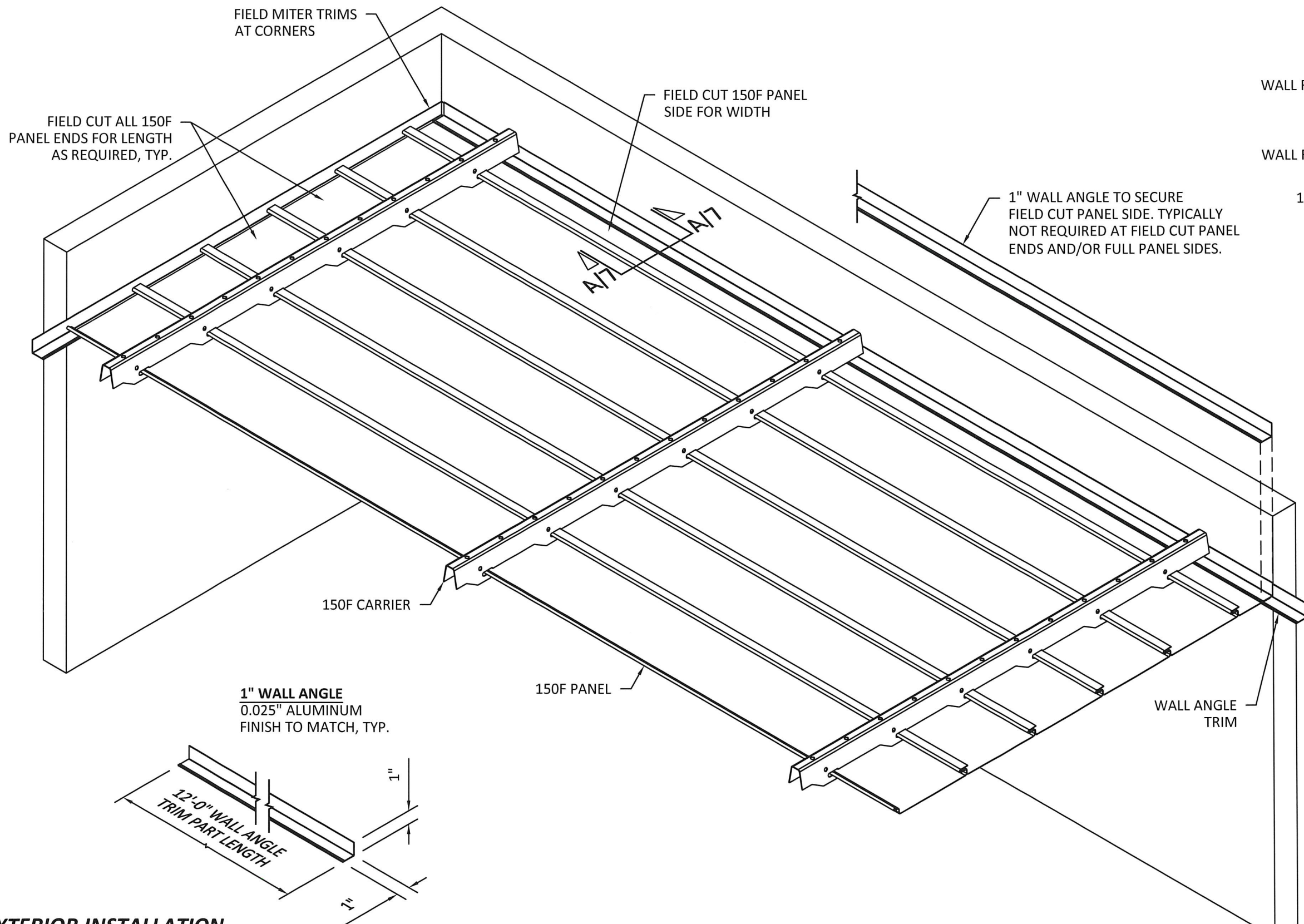

A
7 SECTION AT WALL ANGLE
SCALE: 6" = 1'-0"

WALL FASTENER TYPES*:

- WOOD - #10 WOOD SCREW W/ 1-1/2" MIN. EMBED AND 3/4" MIN. EDGE DISTANCE
- CONCRETE - 3/16" DIA. TAPCON W/ 1-1/4" MIN. EMBED AND 1-1/2" MIN. EDGE DISTANCE.
- STEEL/ALUM. - #10 TEK SCREW W/ FULL EMBED THRU 18 GA. (MIN.) STEEL OR 1/8" (MIN.) ALUMINUM W/ 3/4" MIN. EDGE DISTANCE.

PRODUCT REVISED
as complying with the Florida Building Code

NOA-No. 21-0427.06

Expiration Date 03/19/2025

By *[Signature]*
Miami-Dade Product Control

SCOTT WOLTERS
FL PE# 62354

SEAL:

SCOTT WOLTERS
No 62354

WOLTERS ENGINEERING
(COA# 27194)
15211 97TH ROAD N
WEST PALM BEACH, FL 33412
PH/FAX: (561) 225-1982

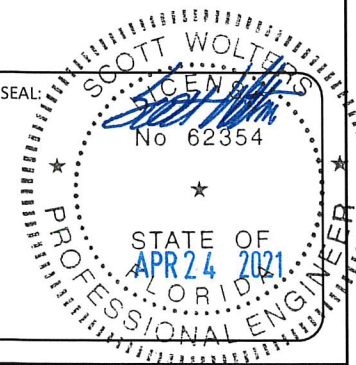

*VERTICAL SUPPORT OMITTED FOR CLARITY

EXTERIOR INSTALLATION

ARCHITECTURAL

CertainTeed
SAINT-GOBAIN

5015 Oakbrook Parkway, Suite 100
Norcross, GA 30093
O 800 366 4327
F 770 806 0214
www.certainteed.com/architectural

SPECIFICATIONS

(unless noted otherwise)

MATERIAL: .025" ALUMINUM ALLOY 3005-H48 150F PANEL | .040" ALUMINUM ALLOY 5050-H48 150F CARRIER
FINISH: PAINT | POWDER COAT | DECORATED WOOD FINISH | LUXACOTE
PERFORATION: NON-PERFORATED | #124 (15% OPEN)

WALL ANGLE TRIM

PROJECT: 150F PRODUCT SPECIFICATIONS
DRAWING NUMBER: 150F-B1.6
SHEET: 7 OF 10
SCALE: AS SHOWN
DRAWN BY: CT ENGINEERING
DATE: 4/15/21

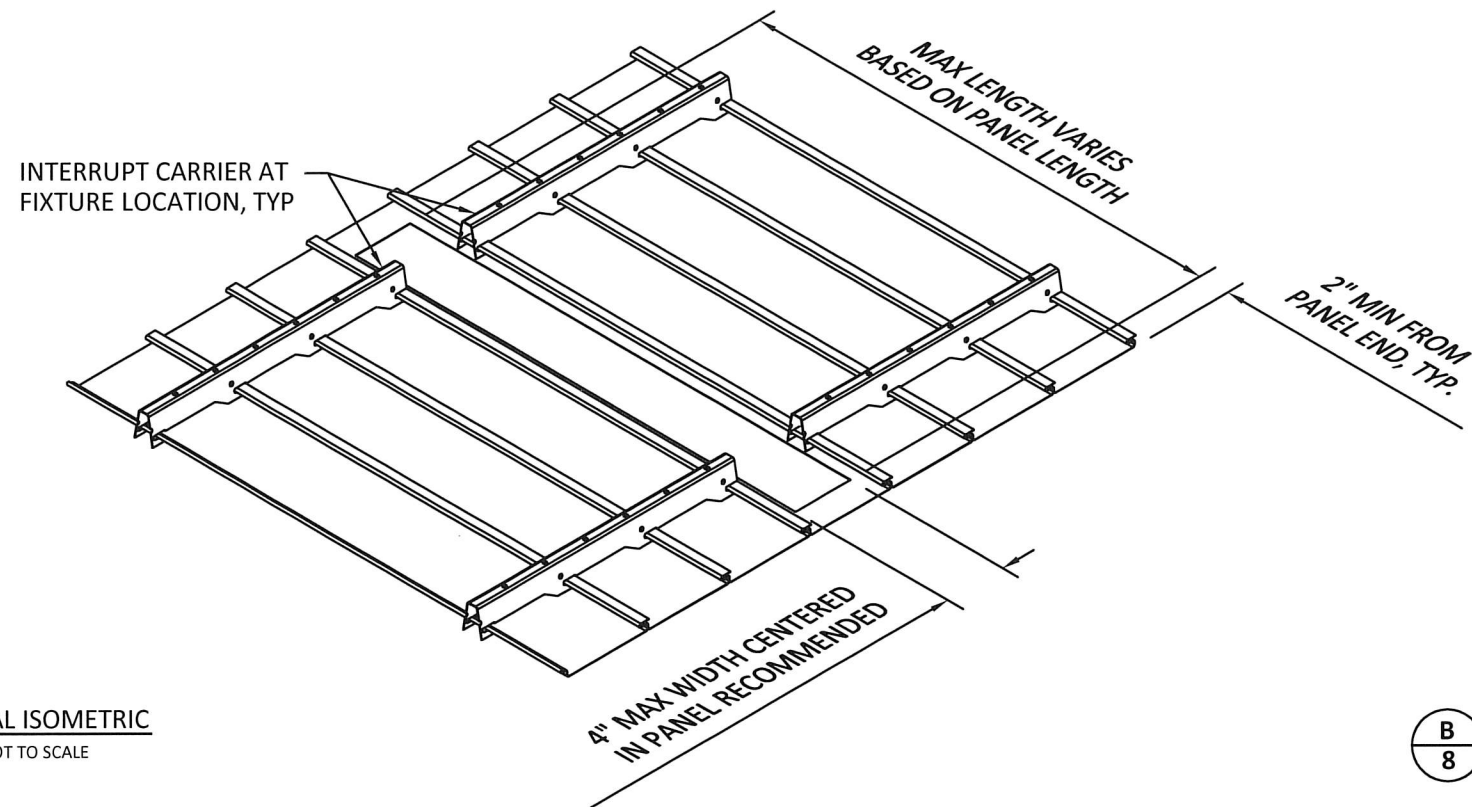

A
8 TYPICAL ISOMETRIC
SCALE: NOT TO SCALE

B
8 TYPICAL R.C.P.
SCALE: NOT TO SCALE

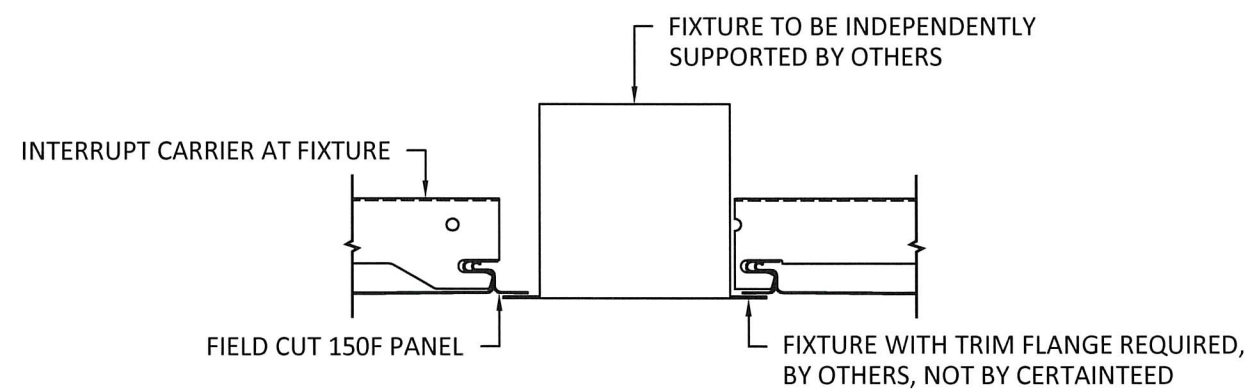
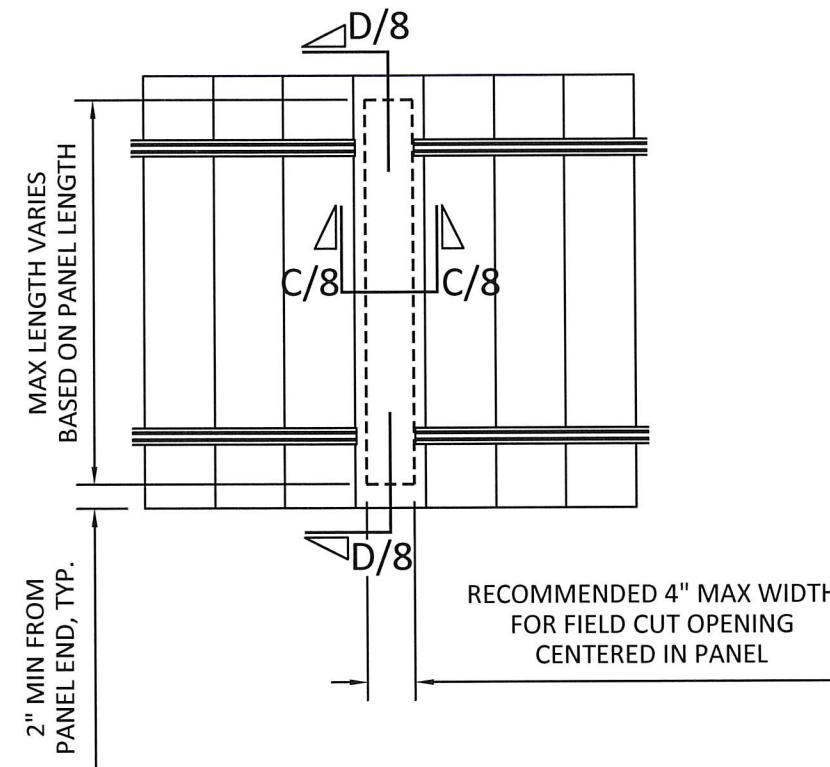

C
8 SECTION AT FIXTURE OPENING
SCALE: 3" = 1'-0"

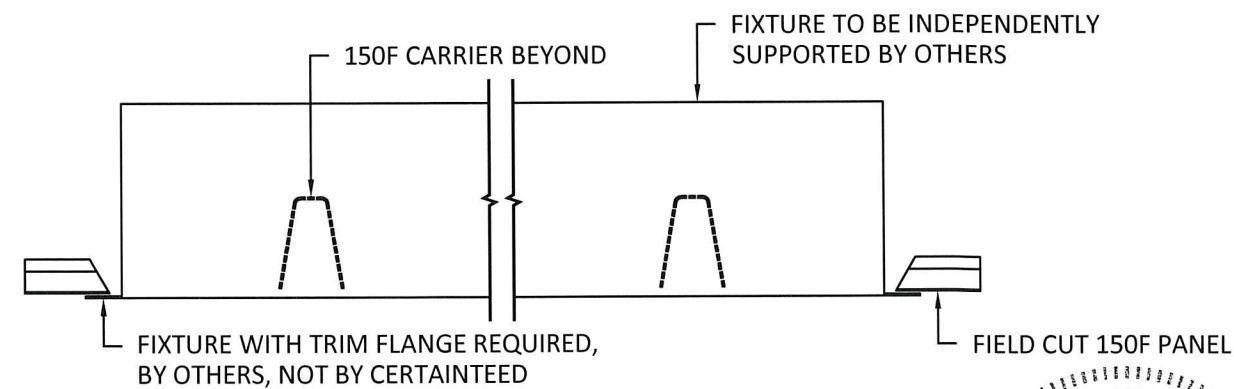

D
8 SECTION AT FIXTURE OPENING
SCALE: 3" = 1'-0"

NOTE: ROUND OPENINGS LESS THAN EIGHT (8) INCHES DIAMETER TYPICALLY FIELD CUT INTO PANEL FACE, TRIM FOR ALL FIXTURES BY OTHERS, NOT BY CERTAINTEED

*VERTICAL SUPPORT OMITTED FOR CLARITY

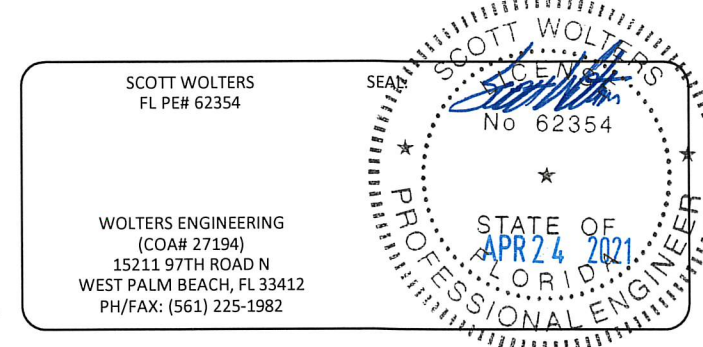

5015 Oakbrook Parkway, Suite 100
Norcross, GA 30093
O 800 366 4327
F 770 806 0214
www.certainteed.com/architectural

SPECIFICATIONS
(unless noted otherwise)

MATERIAL: .025" ALUMINUM ALLOY 3005-H48 150F PANEL | .040" ALUMINUM ALLOY 5050-H48 150F CARRIER
FINISH: PAINT | POWDER COAT | DECORATED WOOD FINISH | LUXACOTE
PERFORATION: NON-PERFORATED | #124 (15% OPEN)

FIELD CUT PANEL FOR FIXTURE OPENINGS

PROJECT: 150F PRODUCT SPECIFICATIONS
DRAWING NUMBER: 150F-B1.8
SHEET: 8 OF 10
SCALE: AS SHOWN
DRAWN BY: CT ENGINEERING
DATE: 4/15/21

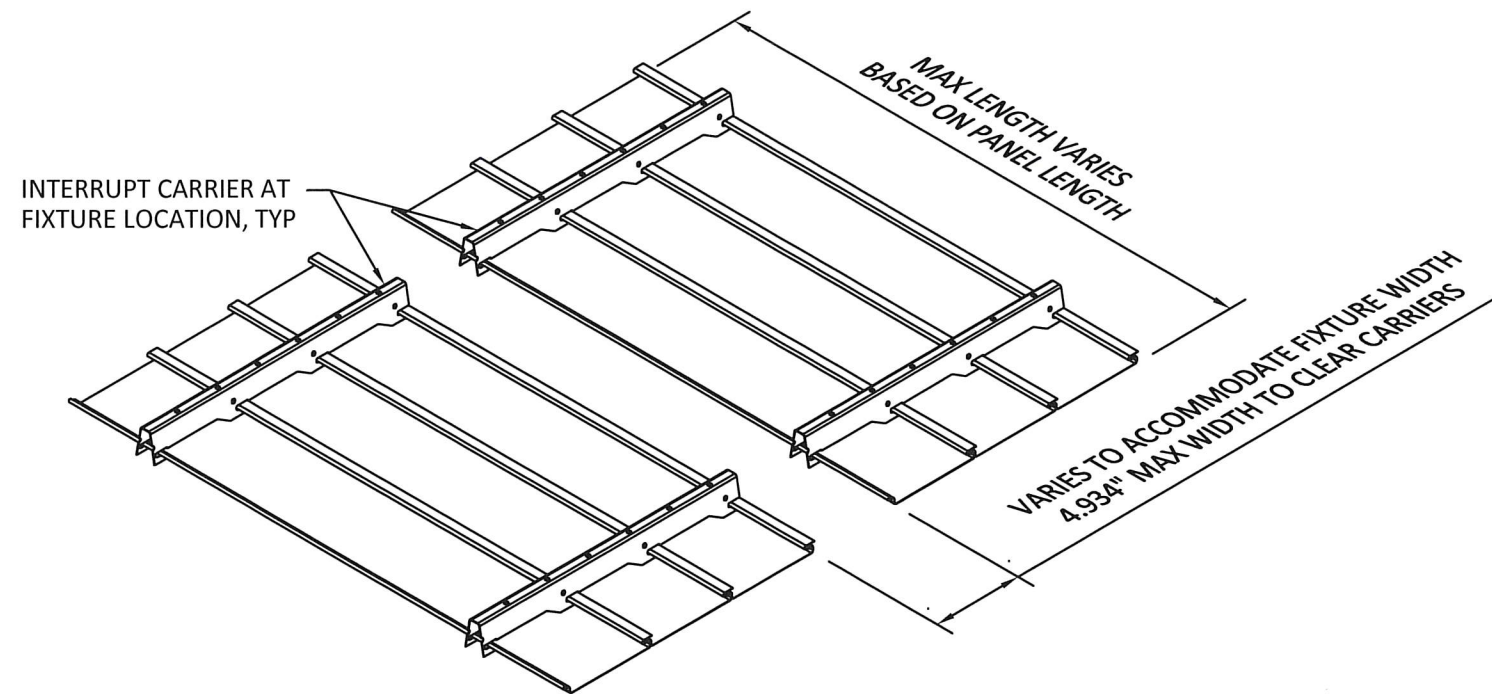

A TYPICAL ISOMETRIC
9 SCALE: NOT TO SCALE

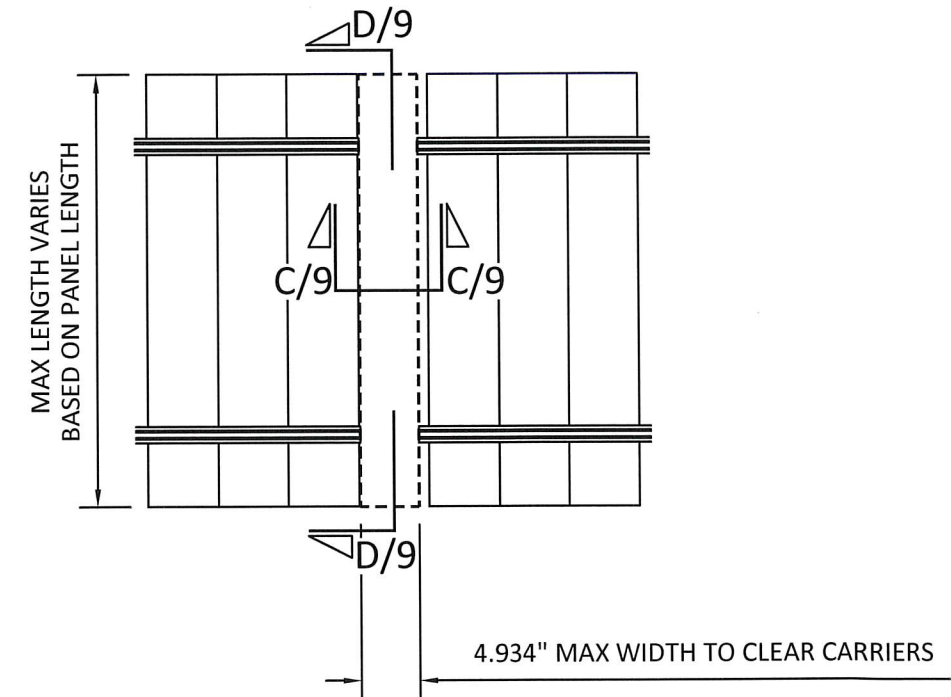

B TYPICAL R.C.P.
9 SCALE: NOT TO SCALE

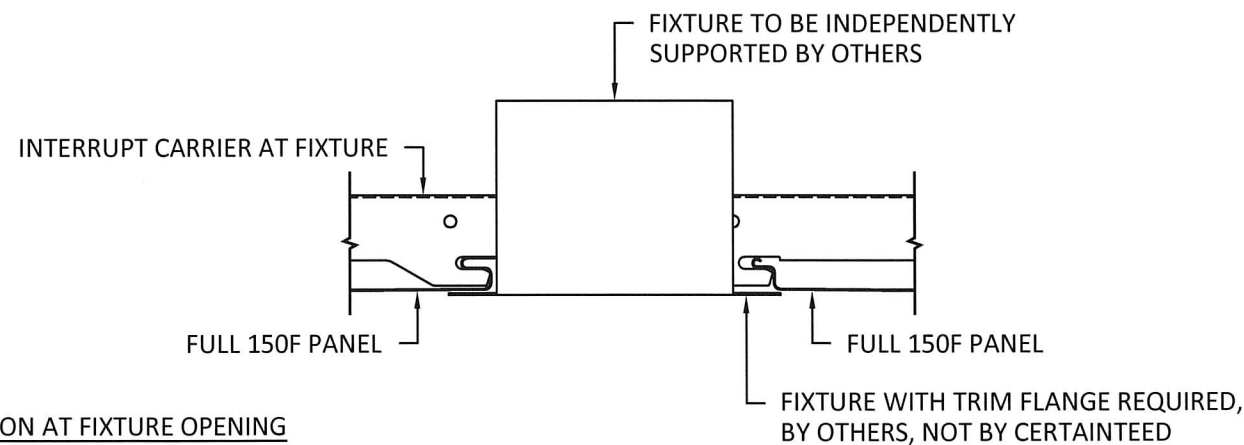

C SECTION AT FIXTURE OPENING
9 SCALE: 3" = 1'-0"

PRODUCT REVISED
as complying with the Florida
Building Code
NOA-No. 21-0427.06
Expiration Date 03/19/2025
By *[Signature]*
Miami-Dade Product Control

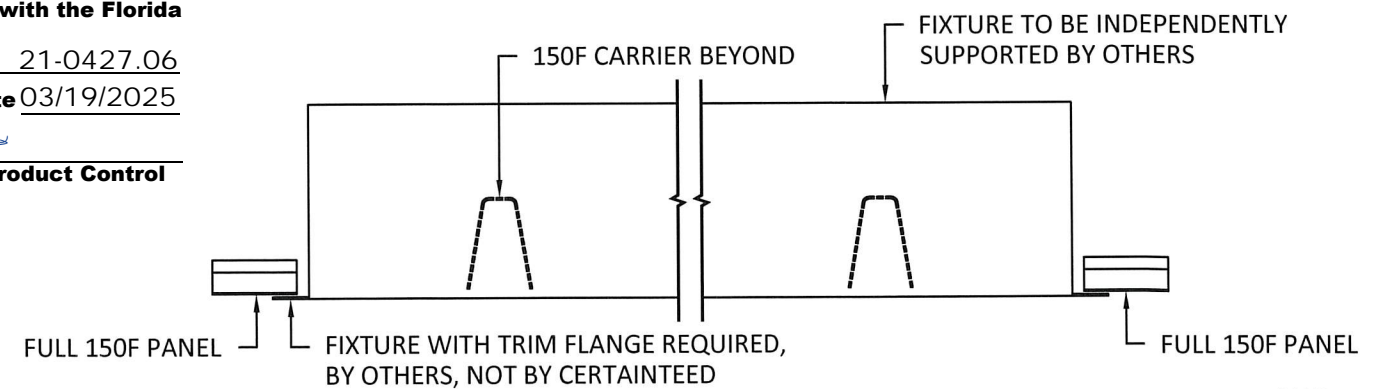

D SECTION AT FIXTURE OPENING
9 SCALE: 3" = 1'-0"

NOTE: FIXTURE WITH TRIM FLANGE NOT BY CERTAINTeed

*VERTICAL SUPPORT OMITTED FOR CLARITY

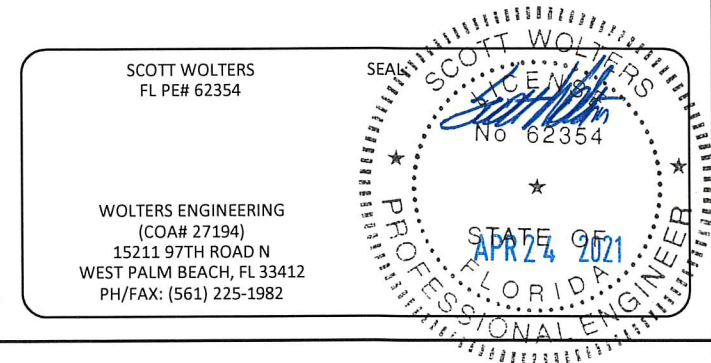

5015 Oakbrook Parkway, Suite 100
Norcross, GA 30093
O 800 366 4327
F 770 806 0214
www.certainteed.com/architectural

SPECIFICATIONS
(unless noted otherwise)

MATERIAL: .025" ALUMINUM ALLOY 3005-H48 150F PANEL | .040" ALUMINUM
ALLOY 5050-H48 150F CARRIER
FINISH: PAINT | POWDER COAT | DECORATED WOOD FINISH | LUXACOTE
PERFORATION: NON-PERFORATED | #124 (15% OPEN)

INTERRUPTED PANEL FOR FIXTURE OPENINGS

PROJECT: 150F PRODUCT SPECIFICATIONS
DRAWING NUMBER: 150F-B1.9
SHEET: 9 OF 10
SCALE: AS SHOWN
DRAWN BY: CT ENGINEERING
DATE: 4/15/21

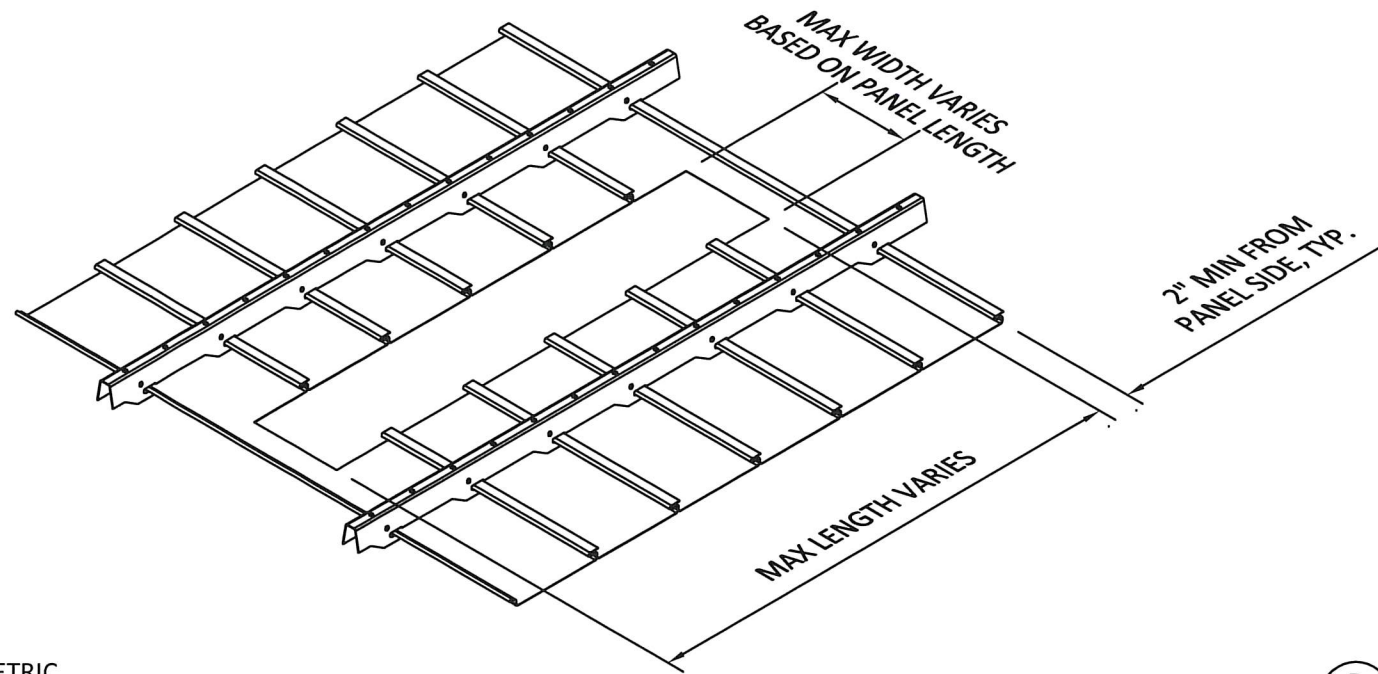

A
10 TYPICAL ISOMETRIC
SCALE: NOT TO SCALE

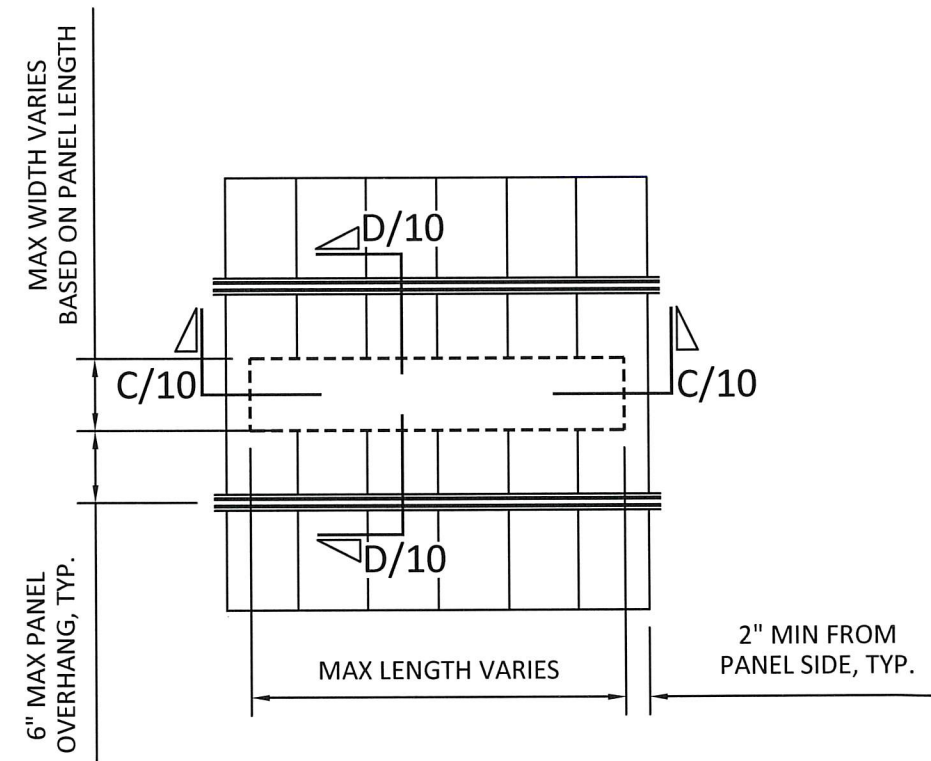

B
10 TYPICAL R.C.P.
SCALE: NOT TO SCALE

PRODUCT REVISED
as complying with the Florida
Building Code
NOA-No. 21-0427.06
Expiration Date 03/19/2025
By *[Signature]*
Miami-Dade Product Control

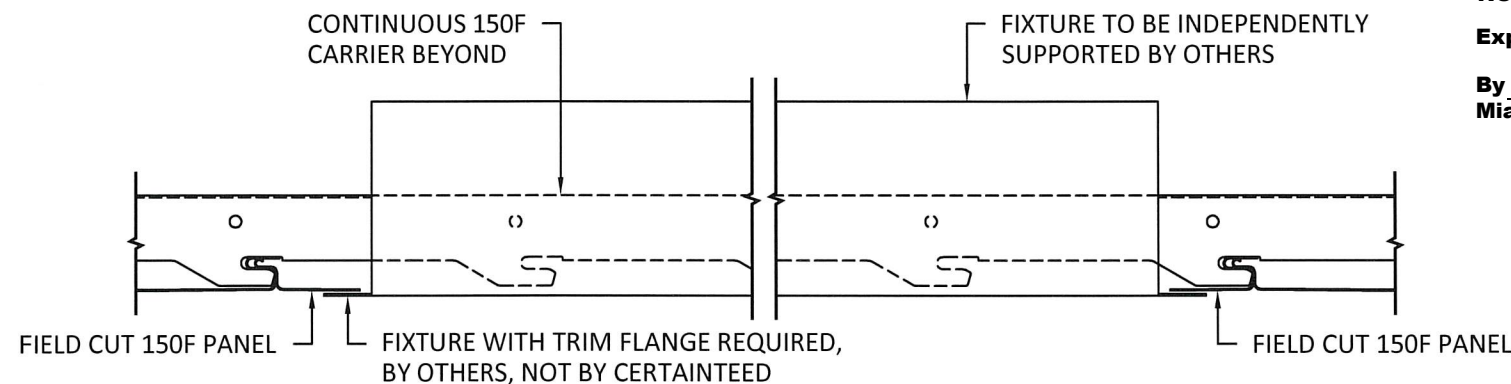

C
10 SECTION AT FIXTURE OPENING
SCALE: 3" = 1'-0"

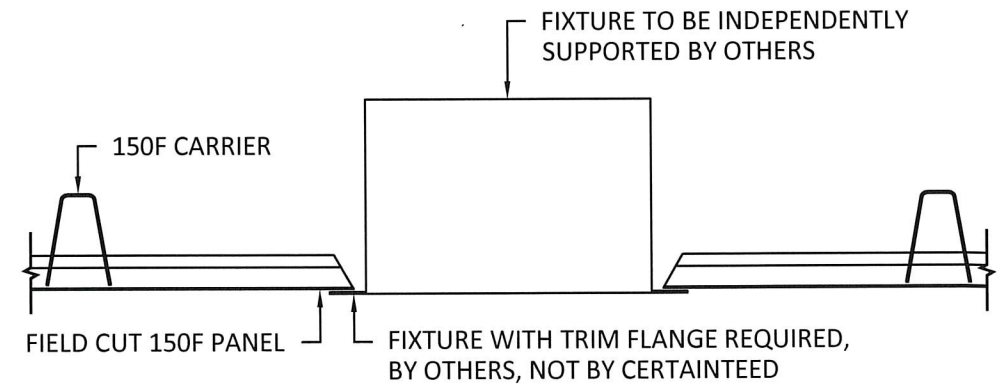

D
10 SECTION AT FIXTURE OPENING
SCALE: 3" = 1'-0"

NOTE: ROUND OPENINGS LESS THAN EIGHT (8) INCHES DIAMETER TYPICALLY FIELD CUT INTO PANEL FACE, TRIM FOR ALL FIXTURES BY OTHERS, NOT BY CERTAINTED

*VERTICAL SUPPORT OMITTED FOR CLARITY

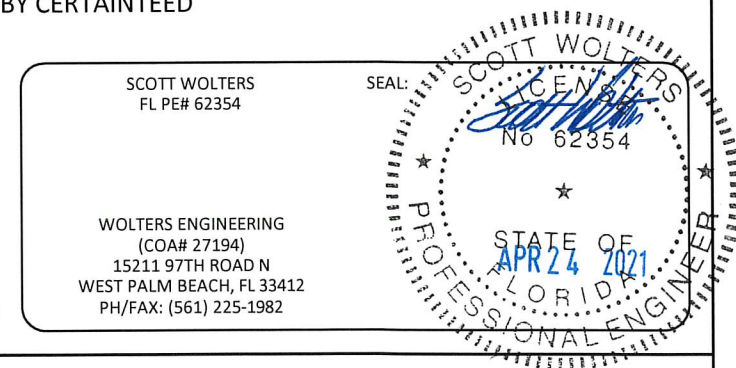

ARCHITECTURAL

CertainTeed
SAINT-GOBAIN

5015 Oakbrook Parkway, Suite 100
Norcross, GA 30093
O 800 366 4327
F 770 806 0214
www.certainteed.com/architectural

SPECIFICATIONS
(unless noted otherwise)

MATERIAL: .025" ALUMINUM ALLOY 3005-H48 150F PANEL | .040" ALUMINUM ALLOY 5050-H48 150F CARRIER
FINISH: PAINT | POWDER COAT | DECORATED WOOD FINISH | LUXACOTE
PERFORATION: NON-PERFORATED | #124 (15% OPEN)

FIELD CUT PANEL FOR FIXTURE OPENINGS

PROJECT: 150F PRODUCT SPECIFICATIONS
DRAWING NUMBER: 150F-B1.10
SHEET: 10 OF 10
SCALE: AS SHOWN
DRAWN BY: CT ENGINEERING
DATE: 4/15/21