



DEPARTMENT OF REGULATORY AND ECONOMIC RESOURCES (RER)
BOARD AND CODE ADMINISTRATION DIVISION

NOTICE OF ACCEPTANCE (NOA)

MIAMI-DADE COUNTY
PRODUCT CONTROL SECTION

11805 SW 26 Street, Room 208
Miami, Florida 33175-2474
T (786) 315-2590 F (786) 315-2599

www.miamidade.gov/economy

Aire Technologies, Inc.
1502 Industrial Drive
Monongahela, PA 15063

SCOPE:

This NOA is being issued under the applicable rules and regulations governing the use of construction materials. The documentation submitted has been reviewed and accepted by Miami-Dade County RER-Product Control Section to be used in Miami Dade County and other areas where allowed by the Authority Having Jurisdiction (AHJ).

This NOA shall not be valid after the expiration date stated below. The Miami-Dade County Product Control Section (In Miami Dade County) and/or the AHJ (in areas other than Miami Dade County) reserve the right to have this product or material tested for quality assurance purposes. If this product or material fails to perform in the accepted manner, the manufacturer will incur the expense of such testing and the AHJ may immediately revoke, modify, or suspend the use of such product or material within their jurisdiction. RER reserves the right to revoke this acceptance, if it is determined by Miami-Dade County Product Control Section that this product or material fails to meet the requirements of the applicable building code.

This product is approved as described herein and has been designed to comply with the Florida Building Code, including the High Velocity Hurricane Zone.

DESCRIPTION: Model DC-436 4" Deep Aluminum Louver

APPROVAL DOCUMENT: Drawing No. **08-00181 Rev D**, titled "DC-436 Aluminum Fixed Louver Panel", sheets 1 through 8 of 8, dated 07/02/2007 and last revised on 04/26/2021, prepared by the manufacturer, signed and sealed by Luis R. Lomas, P.E., bearing the Miami-Dade County Product Control Revision stamp with the Notice of Acceptance number and expiration date by the Miami-Dade County Product Control Section.

MISSILE IMPACT RATING: Large and Small Missile Impact Resistant

LABELING: A permanent label with the manufacturer's name or logo, manufacturing plant's city and state, model/series, and the statement reading "Miami-Dade County Product Control Approved" is to be located on each unit.

RENEWAL of this NOA shall be considered after a renewal application has been filed and there has been no change in the applicable building code negatively affecting the performance of this product.

TERMINATION of this NOA will occur after the expiration date or if there has been a revision or change in the materials, use, and/or manufacture of the product or process. Misuse of this NOA as an endorsement of any product, for sales, advertising or any other purposes shall automatically terminate this NOA. Failure to comply with any section of this NOA shall be cause for termination and removal of NOA.

ADVERTISEMENT: The NOA number preceded by the words Miami-Dade County, Florida, and followed by the expiration date may be displayed in advertising literature. If any portion of the NOA is displayed, then it shall be done in its entirety.

INSPECTION: A copy of this entire NOA shall be provided to the user by the manufacturer or its distributors and shall be available for inspection at the job site at the request of the Building Official.

This NOA revises NOA #20-0211.03 and consists of this page 1 and evidence pages E-1, E-2 and E-3, as well as approval document mentioned above.

The submitted documentation was reviewed by **Ishaq I. Chanda, P.E.**



6/9/21

NOA No. 21-0510.11
Expiration Date: February 7, 2024
Approval Date: June 17, 2021
Page 1

NOTICE OF ACCEPTANCE: EVIDENCE SUBMITTED

1. Evidence submitted under previous NOA's

A. DRAWINGS “Submitted under NOA # 12-0208.07”

1. Drawing No. **FL 00181**, titled “DC-436 Aluminum Fixed Louver Panel”, Sheets 1 through 7 of 7, dated 07/02/2007, with revision B dated 01/24/2012, prepared by the manufacturer, signed and sealed by Luis R. Lomas, P.E.

B. TESTS “Submitted under NOA # 07-1105.04”

1. Test report on 1) Uniform Static Air Pressure Test, Loading per FBC TAS 202-94
2) Large Missile Impact Test per FBC, TAS 201-94
3) Cyclic Wind Pressure Loading per FBC, TAS 203-94
along with marked-up drawings and installation diagram of Fixed Louver Panels, prepared by National Certified Testing Laboratories, Test Report No. **210-3368-2**, dated 01/22/2007, signed and sealed by Gerard J. Ferrara, P.E.

C. CALCULATIONS “Submitted under NOA # 07-1105.04”

1. Anchors calculations, dated 10/15/2007 and 12/17/2007, issued, signed and sealed by Luis R. Lomas, P.E.

D. QUALITY ASSURANCE

1. Miami-Dade Department of Regulatory and Economic Resources (RER)

E. MATERIAL CERTIFICATIONS

1. None.

F. STATEMENTS “Submitted under NOA # 12-0208.07”

1. Statement letter of code conformance to 2010 FBC and no financial interest, dated 01/24/2012, issued, signed and sealed by Luis R. Lomas, P.E.

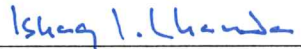

Ishaq I. Chanda, P.E.
Product Control Unit Supervisor
NOA No. 21-0510.11
Expiration Date: February 7, 2024
Approval Date: June 17, 2021

NOTICE OF ACCEPTANCE: EVIDENCE SUBMITTED

2. Evidence submitted under NOA # 18-0828.01

A. DRAWINGS

1. Drawing No. **08-00181**, titled "DC-436 Aluminum Fixed Louver Panel", sheets 1 through 8 of 8, dated 07/02/2007, with revision C dated 07/31/2018, prepared by the manufacturer, signed and sealed by Luis R. Lomas, P.E.

B. TESTS

1. None.

C. CALCULATIONS

1. Anchors calculations, dated 07/31/2018, issued, signed and sealed by Luis R. Lomas, P.E.

D. QUALITY ASSURANCE

1. Miami-Dade Department of Regulatory and Economic Resources (RER)

E. MATERIAL CERTIFICATIONS

1. None.

F. STATEMENTS

1. Statement letter of code conformance to the 6th edition (2017) FBC and of no financial interest, dated 07/31/2018, issued, signed and sealed by Luis R. Lomas, P.E.
2. Bill of sales dated 07/13/2018.



Ishaq I. Chanda, P.E.

Product Control Unit Supervisor

NOA No. 21-0510.11

Expiration Date: February 7, 2024

Approval Date: June 17, 2021

NOTICE OF ACCEPTANCE: EVIDENCE SUBMITTED

3. New Evidence submitted

A. DRAWINGS

1. Drawing No. **08-00181 Rev D**, titled "DC-436 Aluminum Fixed Louver Panel", sheets 1 through 8 of 8, dated 07/02/2007 and last revised on 04/26/2021, prepared by the manufacturer, signed and sealed by Luis R. Lomas, P.E.

B. TESTS

1. None.

C. CALCULATIONS

1. Anchors verification calculations, dated 04/26/21, prepared, signed and sealed by Luis R. Lomas, P.E.

D. QUALITY ASSURANCE

1. Miami-Dade Department of Regulatory and Economic Resources (RER)

E. MATERIAL CERTIFICATIONS

1. None.

F. STATEMENTS

1. Statement letter of code conformance to FBC 7th edition (2020), dated 04/26/21, prepared, issued, signed and sealed by Luis R. Lomas, P.E.

G. OTHER

1. This NOA revises **NOA #20-0211.03**, expiring 02/07/2024.



Ishaq I. Chanda, P.E.
Product Control Unit Supervisor
NOA No. 21-0510.11
Expiration Date: February 7, 2024
Approval Date: June 17, 2021

REVISIONS			
REV	DESCRIPTION	DATE	APPROVED
D	UPDATED PER NEW CODE	04/26/2021	R.L.

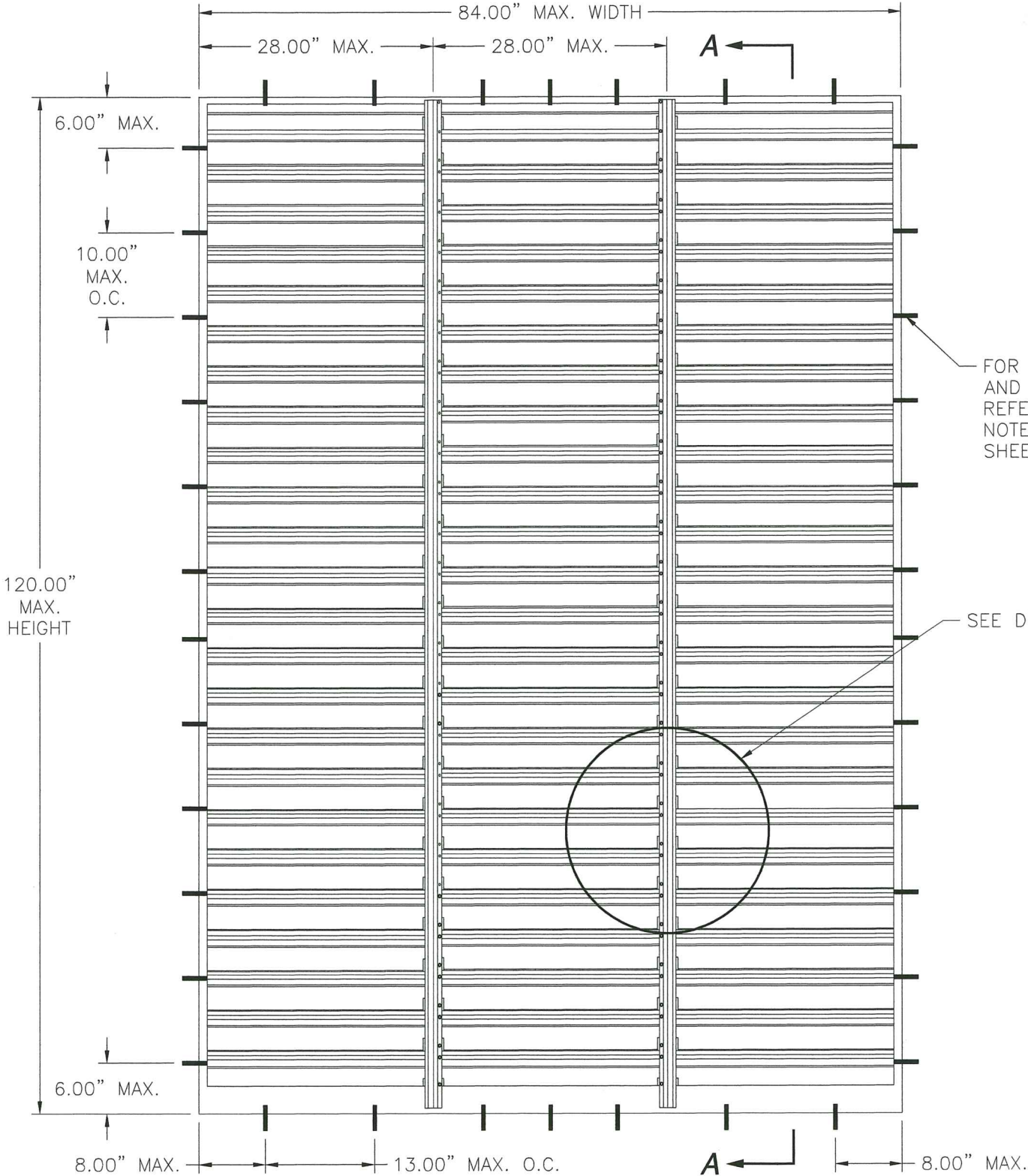

FOR ANCHOR TYPE
AND INSTALLATION
REFER TO ANCHORING
NOTES 1 AND 2
SHEET 1

SEE DETAIL B

DC-436 ALUMINUM FIXED LOUVER

DESIGN PRESSURE RATING	IMPACT RATING
±120.0PSF	LARGE MISSILE IMPACT

PRODUCT REVIEWED
as complying with the Florida
Building Code
Acceptance No. 21-0516-11
Expiration Date 2/7/24
Luis R. Lomas
Mr. Lomas Product Control

AIRE TECHNOLOGIES, INC.
1502 INDUSTRIAL DRIVE
E. MONONGAHELA, PA 15603

DC-436 ALUMINUM FIXED
LOUVER PANEL
SINGLE PANEL ELEVATION

DRAWN: R.L.	DWG NO. 08-00181	REV D
SCALE NTS	DATE 07/02/07	SHEET 2 OF 8

L. ROBERTO LOMAS P.E.
1432 WOODFORD RD LEWISVILLE, NC 27023
434-688-0609 rllomas@rlomaspe.com

SIGNED: 04/26/2021

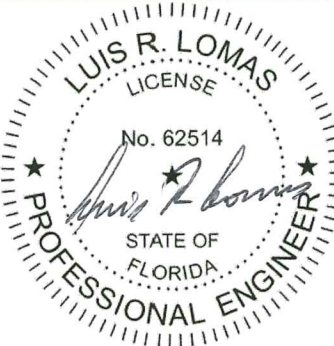

Luis R. Lomas P.E.
FL No.: 62514

8.00" MAX. 14.00" MAX. O.C. 8.00" MAX. 8.00" MAX. 14.00" MAX. O.C. 8.00" MAX.

6.00" MAX. 13.00" MAX. O.C. 120.00" MAX. HEIGHT

SEE DETAIL B

6.00" MAX.

28.00" MAX. TYP. 28.00" MAX. TYP. 84.00" MAX. PANEL WIDTH TYP. 252.00" WIDTH

SEE DETAIL C

FOR ANCHOR TYPE AND INSTALLATION, REFER TO ANCHORING NOTES 1, 2 AND 3 SHEET 1

(3) THREE PANELS SHOWN, UNLIMITED NUMBER OF PANELS IS APPLICABLE AS LONG AS INDIVIDUAL PANEL(S) DO NOT EXCEED PANEL SIZE SHOWN.

PRODUCT REVIEW
as complying with the Florida
Building Code
Acceptance No 21-0510-11
Expiration Date 2/7/24
by Ishag J. Ghannouch
Mr. Joe Pinder Product Control

L. ROBERTO LOMAS P.E.
1432 WOODFORD RD LEWISVILLE, NC 27023
434-688-0609 rllomas@lrlomaspe.com

LUIS R. LOMAS
LICENSE
No. 62514
★ ★
PROFESSIONAL ENGINEER
STATE OF FLORIDA

Luis R. Lomas P.E.
FL No.: 62514

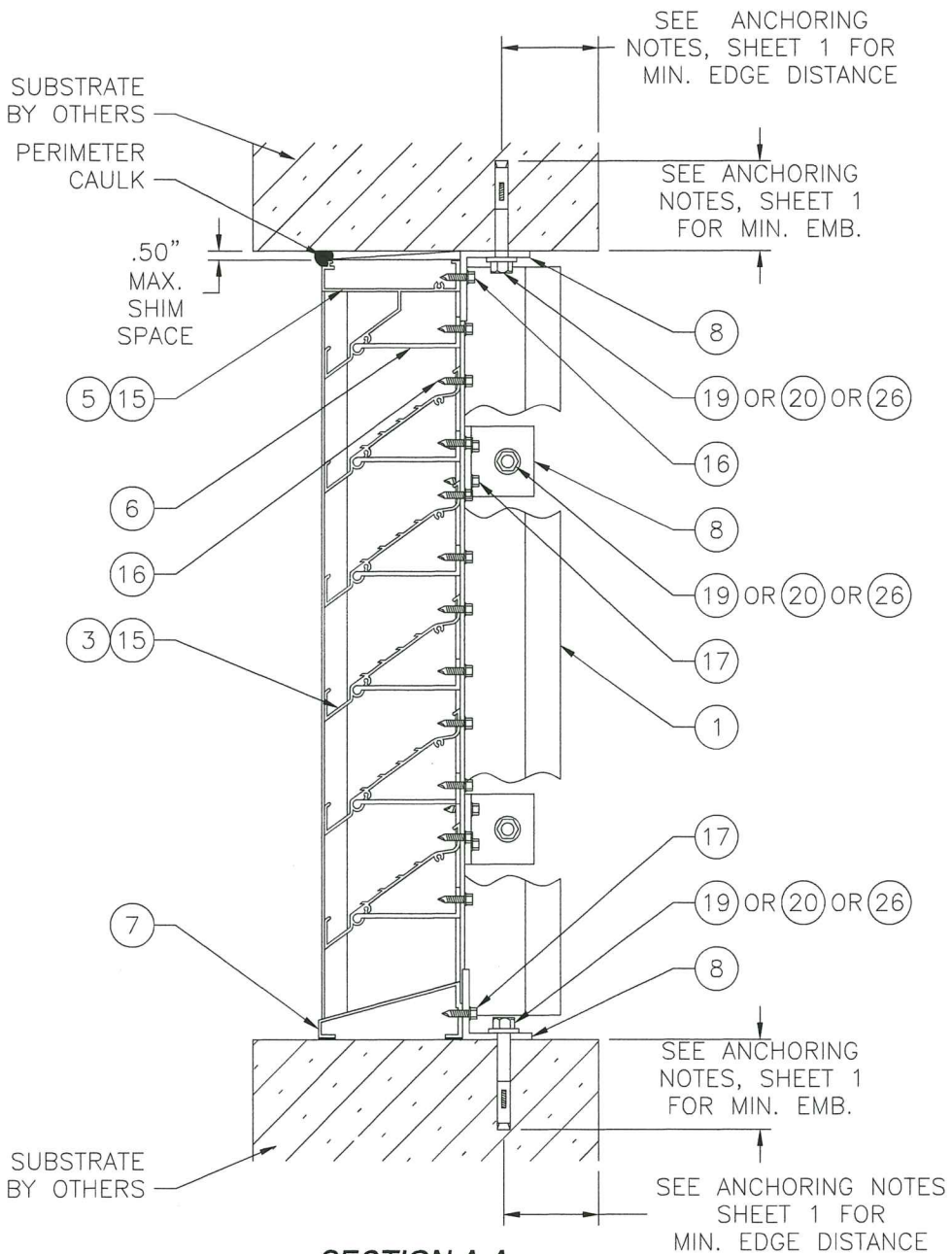

SECTION A-A
DC-436-1 INSTALLATION

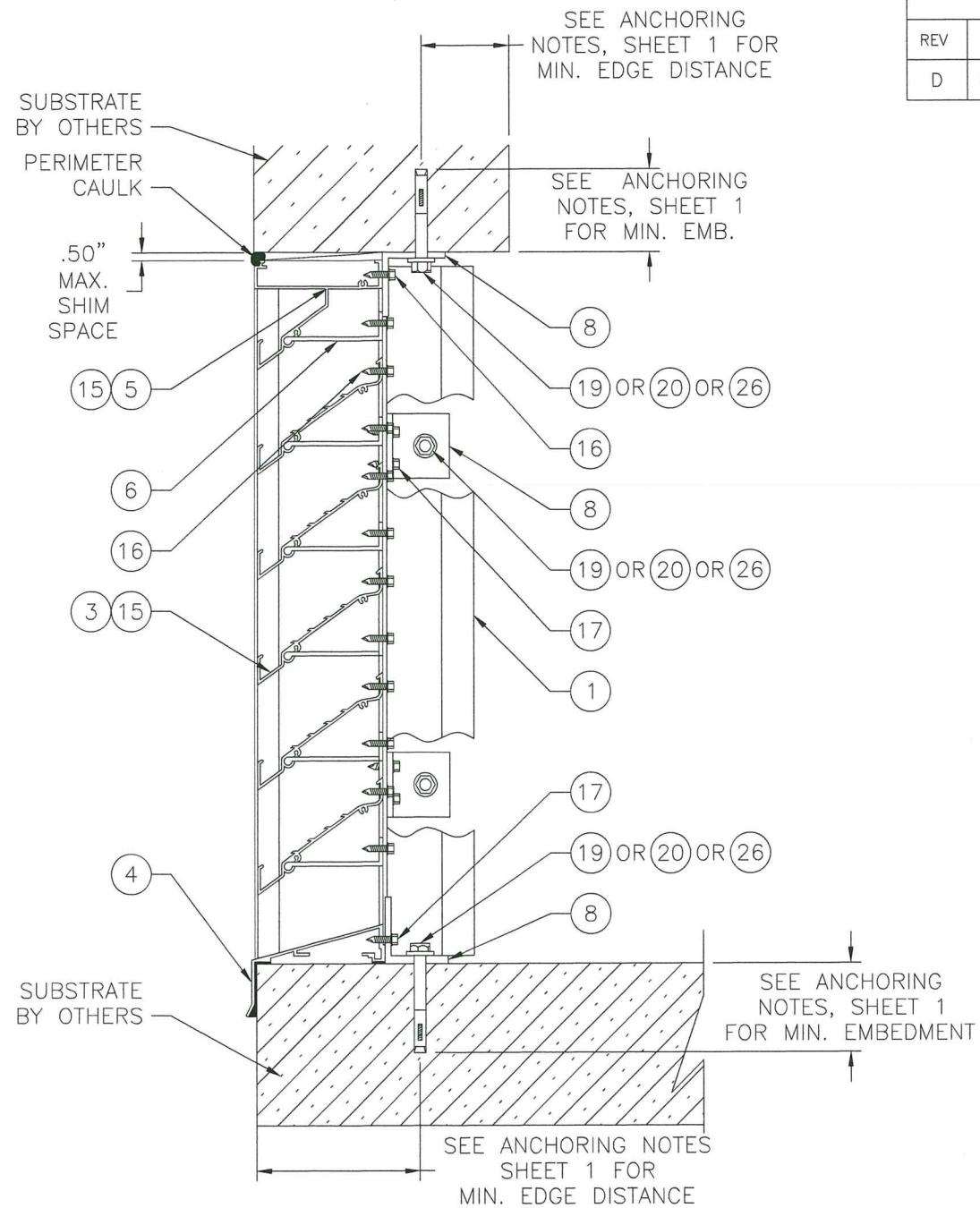

SECTION A-A
DC-436-2 INSTALLATION

REVISIONS			
REV	DESCRIPTION	DATE	APPROVED
D	UPDATED PER NEW CODE	04/26/2021	R.L.

PRODUCT REVIEW
as complying with the Florida
Building Code
Acceptance No. 21-0510-11
Expiration Date 2/7/24
Luis R. Lomas
Major Dept. Product Control

AIRE TECHNOLOGIES, INC.
1502 INDUSTRIAL DRIVE
E. MONONGAHELA, PA 15603

DC-436 ALUMINUM FIXED
LOUVER PANEL
INSTALLATION DETAILS

DRAWN: R.L.	DWG NO. 08-00181	REV D
SCALE NTS	DATE 07/02/07	SHEET 4 OF 8

L. ROBERTO LOMAS P.E.
1432 WOODFORD RD LEWISVILLE, NC 27023
434-688-0609 rllomas@lrlomaspe.com

SIGNED: 04/26/2021

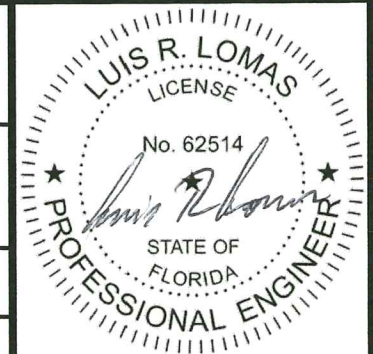

Luis R. Lomas P.E.
FL No.: 62514

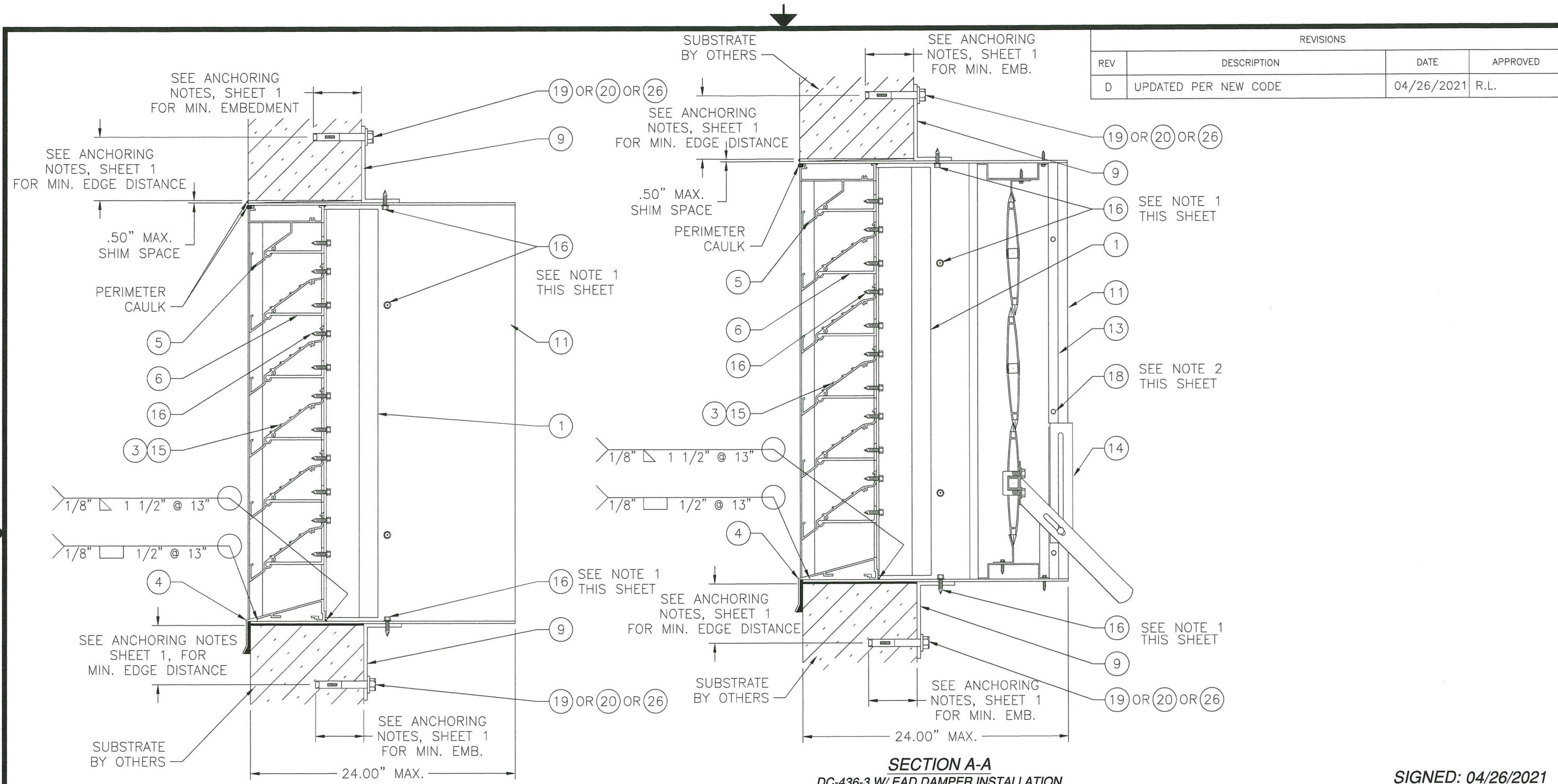

REVISIONS			
REV	DESCRIPTION	DATE	APPROVED
D	UPDATED PER NEW CODE	04/26/2021	R.L.

- NOTES:
- 1) LOCATE ITEM 16, 6" FROM EACH CORNER AND 9" MAX. O.C. AT JAMBS AND 6" MAX. FROM EACH CORNER AND 13 1/2" MAX. O.C. AT HEAD AND SILL.
 - 2) LOCATE ITEM 18, 12" FROM EACH CORNER AND 12" MAX. O.C. AT JAMBS HEAD AND SILL.

SECTION A-A
DC-436-3 W/ EAD DAMPER INSTALLATION

SIGNED: 04/26/2021

PRODUCT REVISED
as complying with the Florida
Building Code
Acceptance No. 21-0510-11
Expiration Date 2/7/24
Luis R. Lomas
Air or Duct Product Control

AIRE TECHNOLOGIES, INC. 1502 INDUSTRIAL DRIVE E. MONONGAHELA, PA 15603		
DC-436 ALUMINUM FIXED LOUVER PANEL INSTALLATION DETAILS		
DRAWN: R.L.	DWG NO. 08-00181	REV D
SCALE NTS	DATE 07/02/07	SHEET 5 OF 8
L. ROBERTO LOMAS P.E. 1432 WOODFORD RD LEWISVILLE, NC 27023 434-688-0609 rllomas@rlomaspe.com		

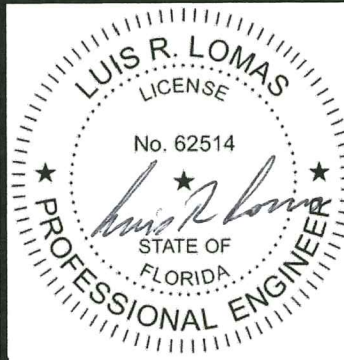

Luis R. Lomas P.E.
FL No.: 62514

PARTS LIST		
NO.	PART NUMBER	DESCRIPTION
1		VERTICAL BLADE SUPPORT, AL 6063-T5
2		JAMB, AL 6063-T5
3		BLADE , AL 6063-T5
4		SILL FLANGE, AL 6063-T5
5		HEAD, AL 6063-T5
6		BLADE SUPPORT, AL 6063-T5
7		SILL, AL 6063-T5
8		2 X 2 X 3/16 X 2" LONG ANGLE, AL 6063-T5
9		2 X 4 X 3/16 CONTINUOUS ANGLE, AL 6063-T5
10		2 X 2 X 3/16 CONTINUOUS ANGLE, AL 6063-T5
11		.101" THICK SLEEVE, AL 3003-H14
12		.101" THICK FLANGED SLEEVE, AL 3003-H14
13		DAMPER EAD
14		HAND QUADRANT
15		#8 X 1/2 TEK SCREW
16		#12 X 7/8 TEK SCREW
17		#12 X 1 TEK SCREW
18		#14 X 7/8 TEK SCREW
19		5/16 LAG BOLT
20		3/8" HILTI KWIK BOLT 3
21		MULLION CLIP
22		2 X 4 X 1/4 X 120 LONG MULLION AL 6063-T5
23		C4 X 5.4 CHANNEL , STEEL
24		3/8-16 X 1" HH W/ WASHER AND NUT SST
25		3/8-16 X 1 1/5 HH W/ WASHER AND NUT, SST
26		1/4" TEK SCREW
27		MULLION CLIP

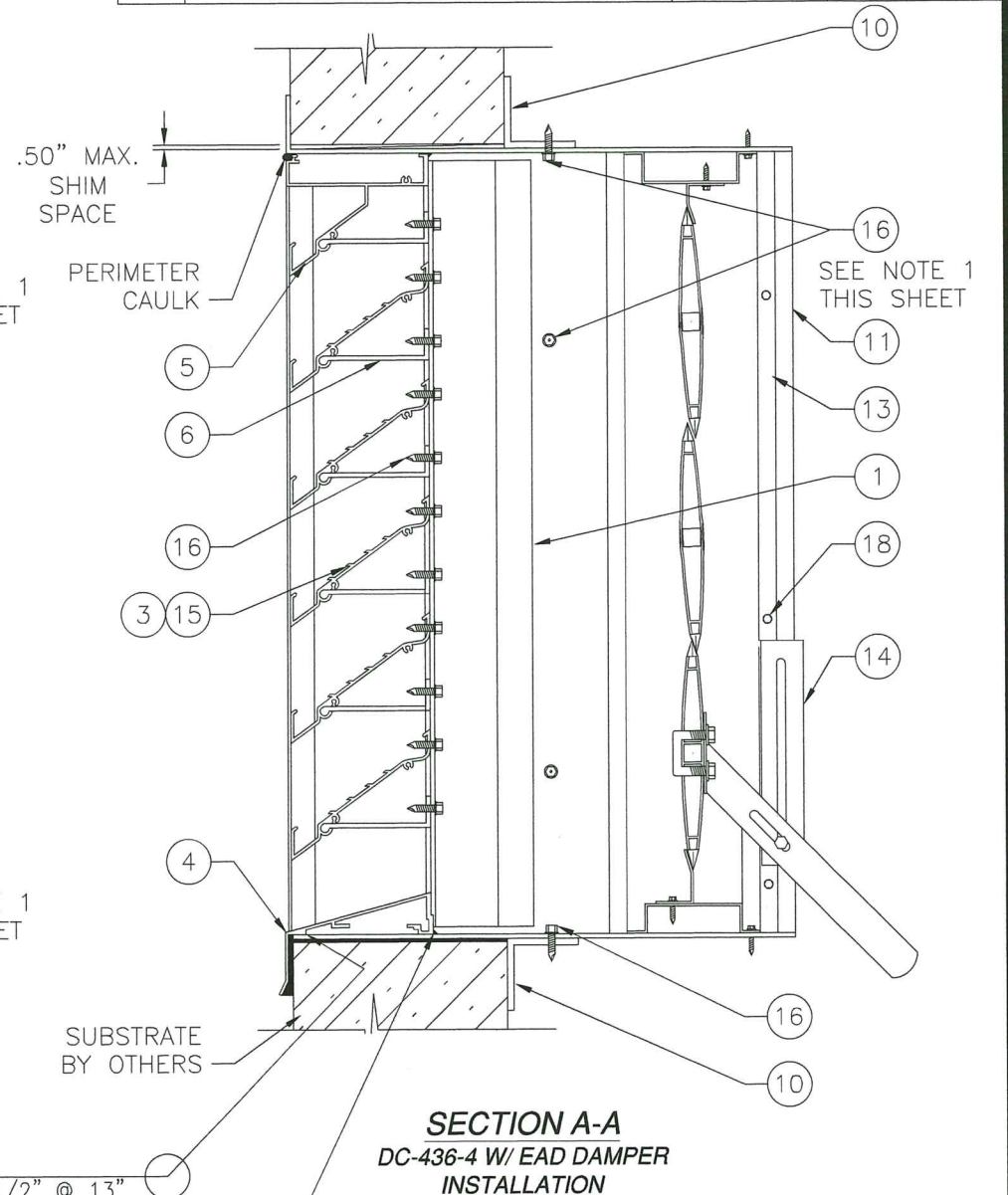
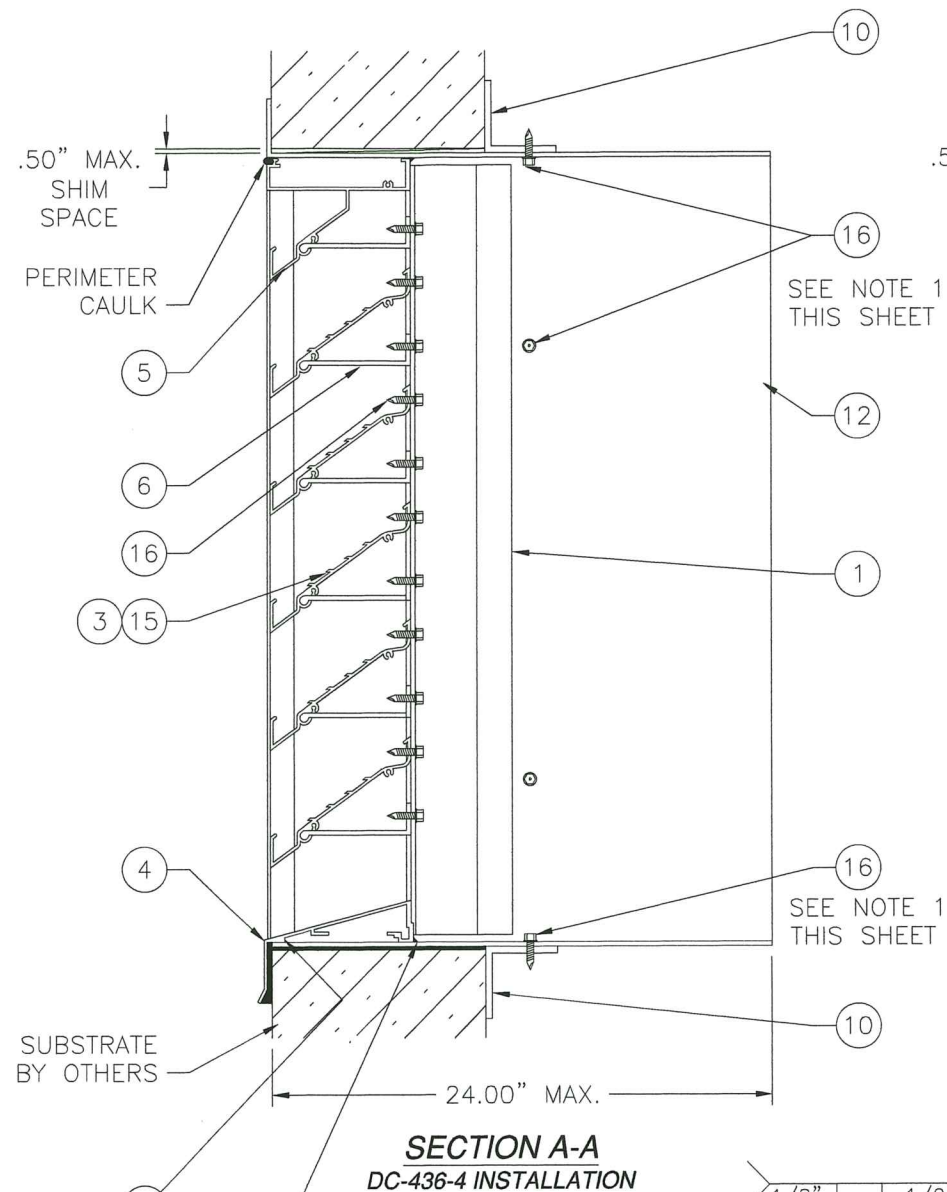

REVISIONS			
REV	DESCRIPTION	DATE	APPROVED
D	UPDATED PER NEW CODE	04/26/2021	R.L.

NOTES:

- 1) LOCATE ITEM 16, 6" FROM EACH CORNER AND 9" MAX. O.C. AT JAMBS AND 6" MAX. FROM EACH CORNER AND 13 1/2" MAX. O.C. AT HEAD AND SILL.

PRODUCT REVISION
as complying with the Florida
Building Code
Acceptance No. 21-0510-11
Expiration Date 2/17/24
By: [Signature]
Mr. [Name] Product Control

AIRE TECHNOLOGIES, INC.
1502 INDUSTRIAL DRIVE
E. MONONGAHELA, PA 15603

DC-436 ALUMINUM FIXED
LOUVER PANEL
INSTALLATION DETAILS

DRAWN: R.L.	DWG NO. 08-00181	REV D
SCALE NTS	DATE 07/02/07	SHEET 6 OF 8

L. ROBERTO LOMAS P.E.
1432 WOODFORD RD LEWISVILLE, NC 27023
434-688-0609 rlomas@rlomaspe.com

SIGNED: 04/26/2021



Luis R. Lomas P.E.
FL No.: 62514

REVISIONS			
REV	DESCRIPTION	DATE	APPROVED
D	UPDATED PER NEW CODE	04/26/2021	R.L.

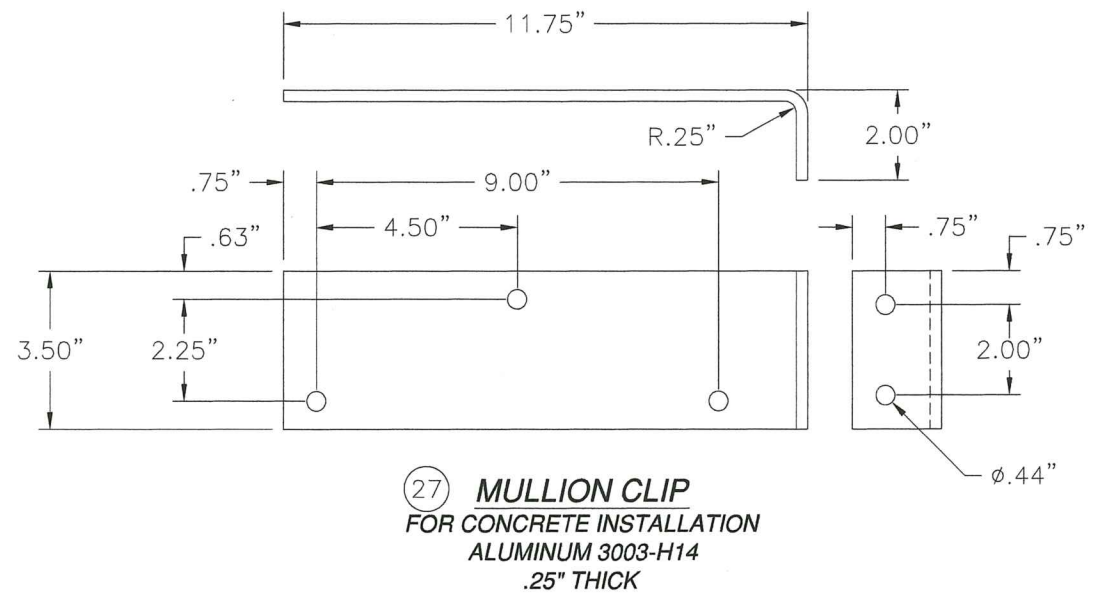
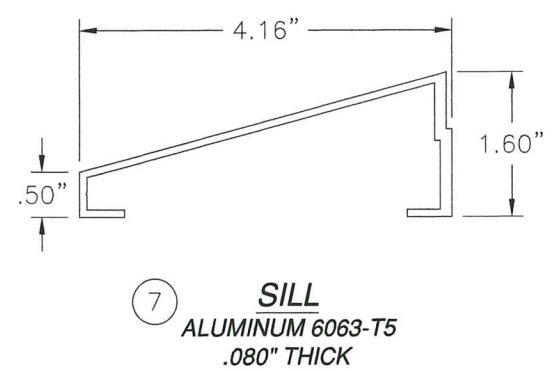
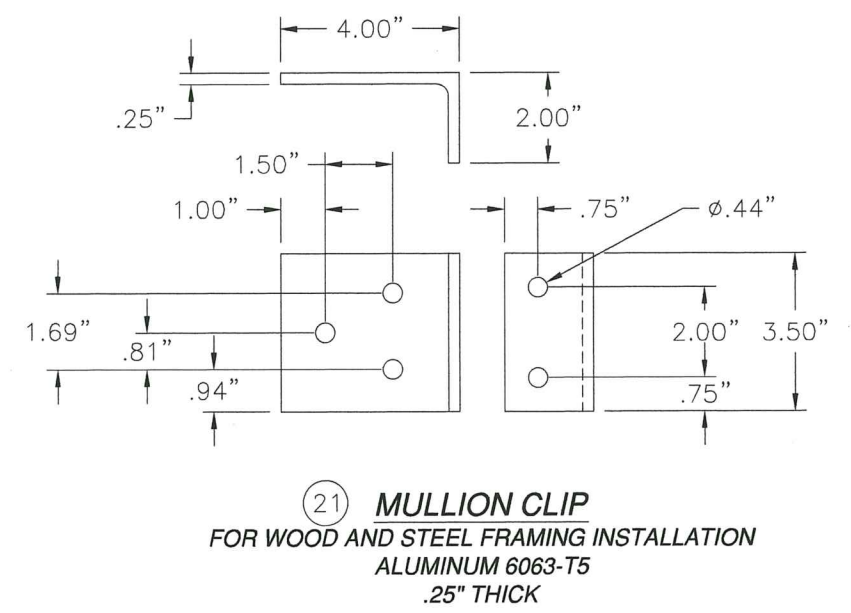
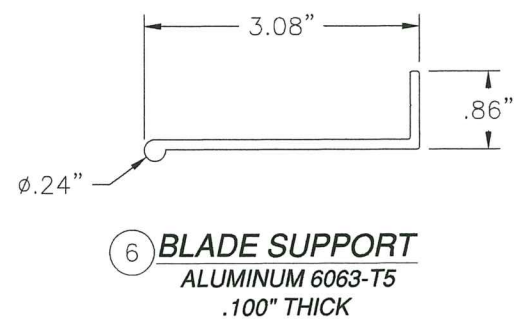
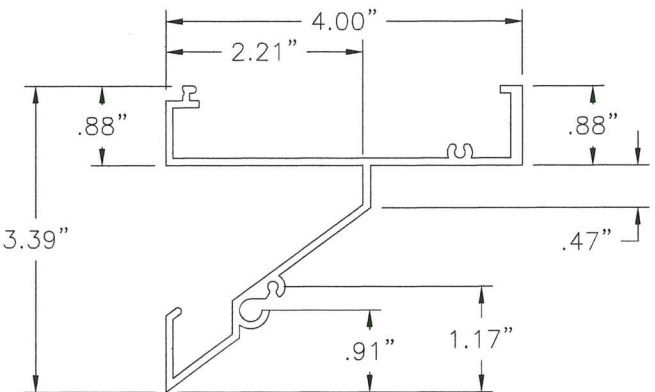
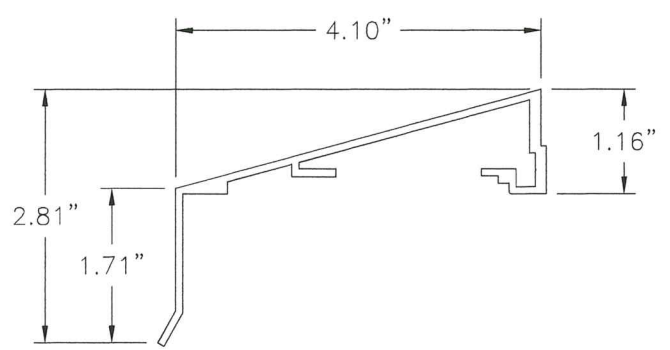
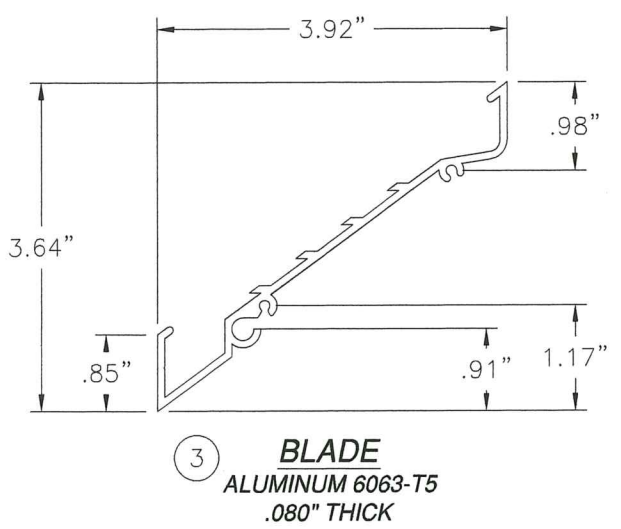
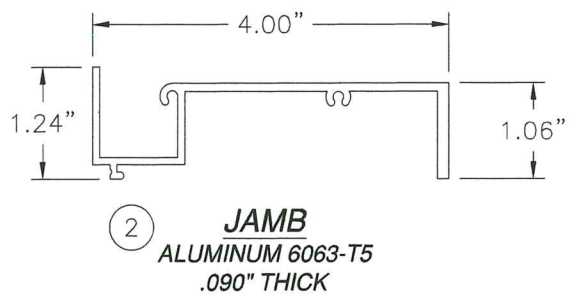
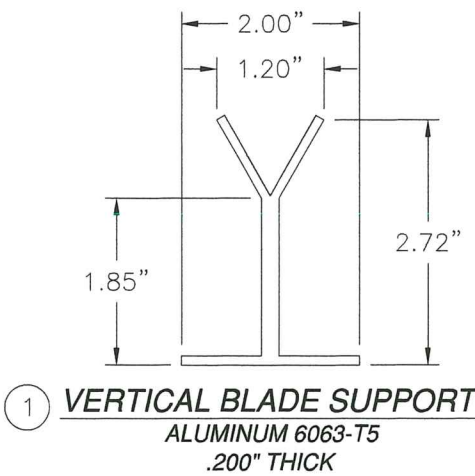

SIGNED: 04/26/2021

PRODUCT REVIEW
as complying with the Florida
Building Code
Acceptance No. 21-0510-11
Expiration Date 2/7/24
By: [Signature] Product Control

AIRE TECHNOLOGIES, INC.
1502 INDUSTRIAL DRIVE
E. MONONGAHELA, PA 15603

DC-436 ALUMINUM FIXED
LOUVER PANEL
COMPONENTS

DRAWN: R.L.	DWG NO. 08-00181	REV D
SCALE NTS	DATE 07/02/07	SHEET 8 OF 8

L. ROBERTO LOMAS P.E.
1432 WOODFORD RD LEWISVILLE, NC 27023
434-688-0609 rllomas@rlomaspe.com

LUIS R. LOMAS
LICENSE
No. 62514
STATE OF
FLORIDA
PROFESSIONAL ENGINEER

Luis R. Lomas P.E.
FL No.: 62514