



DEPARTMENT OF REGULATORY AND ECONOMIC RESOURCES (RER)
BOARD AND CODE ADMINISTRATION DIVISION

**MIAMI-DADE COUNTY
PRODUCT CONTROL SECTION**

11805 SW 26 Street, Room 208
Miami, Florida 33175-2474
T (786) 315-2590 F (786) 315-2599
www.miamidade.gov/economy

NOTICE OF ACCEPTANCE (NOA)

Tremco CPG, Inc.
3735 Green Road
Beachwood, OH 44122

SCOPE:

This NOA is being issued under the applicable rules and regulations governing the use of construction materials. The documentation submitted has been reviewed and accepted by Miami-Dade County RER - Product Control Section to be used in Miami Dade County and other areas, where allowed by the Authority Having Jurisdiction (AHJ).

This NOA shall not be valid after the expiration date stated below. The Miami-Dade County Product Control Section (In Miami Dade County) and/or the AHJ (in areas other than Miami Dade County) reserve the right to have this product or material tested for quality assurance purposes. If this product or material fails to perform in the accepted manner, the manufacturer will incur the expense of such testing and the AHJ may immediately revoke, modify, or suspend the use of such product or material within their jurisdiction. RER reserves the right to revoke this acceptance, if it is determined by Miami-Dade County Product Control Section that this product or material fails to meet the requirements of the applicable building code.

This product is approved as described herein and has been designed to comply with the Florida Building Code including the High Velocity Hurricane Zone of the Florida Building Code.

DESCRIPTION: TremLock Roof Edge Termination Systems

LABELING: Each unit shall bear a permanent label with the manufacturer's name or logo, city, state and following statement: "Miami-Dade County Product Control Approved", unless otherwise noted herein.

RENEWAL of this NOA shall be considered after a renewal application has been filed and there has been no change in the applicable building code negatively affecting the performance of this product.

TERMINATION of this NOA will occur after the expiration date or if there has been a revision or change in the materials, use, and/or manufacture of the product or process. Misuse of this NOA as an endorsement of any product, for sales, advertising or any other purposes shall automatically terminate this NOA. Failure to comply with any section of this NOA shall be cause for termination and removal of NOA.

ADVERTISEMENT: The NOA number preceded by the words Miami-Dade County, Florida, and followed by the expiration date may be displayed in advertising literature. If any portion of the NOA is displayed, then it shall be done in its entirety.

INSPECTION: A copy of this entire NOA shall be provided to the user by the manufacturer or its distributors and shall be available for inspection at the job site at the request of the Building Official.

This NOA revises NOA #20-1214.02 and consists of pages 1 through 35.
The submitted documentation was reviewed by Alex Tigera.



NOA-No.: 22-0228.23
Expiration Date: 12/11/23
Approval Date: 09/29/22
Page 1 of 35

ROOFING COMPONENT APPROVAL

Category: Roofing
Sub-Category: Roofing Fasteners
Materials Steel

SCOPE:

This approves roofing components “**TremLock Roof Edge Termination Systems**” as described in this Notice of Acceptance. Designed to comply with the Florida Building Code and the High Velocity Hurricane Zone of the Florida Building Code for the locations where the pressure requirements, as determined by applicable building code do not exceed the design pressure values listed herein.

TRADE NAMES OF PRODUCTS MANUFACTURED OR LABELED BY APPLICANT:

Table 1

<u>Product Name</u>	<u>Dimensions</u>	<u>Test Specification</u>	<u>Product Description</u>
TremLock Infinity Coping	Coping: Max. 12” Outside Face Max. 4” Inside Face Max. Width 32” Wall Min. Thickness. 24ga. Anchor Clip: Max. Width. 12” Max. Length 12’ Min. Thickness 20ga.	TAS 111 (C)	Decorative aluminum coping cap with galvanized steel anchor/support cleats.
TremLock Infinity Gold Coping	Coping: Max. 12” Outside Face Max. 4” Inside Face Max. Width 32” Wall Max. Length 12’ Min Thickness. 24ga. or 0.040” aluminum Anchor Clip: Max. Width. 12” Max. Length 12’ Min. Thickness 16ga.	TAS 111 (C)	Decorative aluminum coping cap with galvanized steel anchor/support cleats.
TremLock 215 Fascia Single Ply	Max. 8.5” Outside Face Max. Length 12’ Min. Thickness 24ga.,or 0.040” aluminum	TAS 111 (B)	Decorative galvanized steel or aluminum fascia with continuous extruded aluminum bar.



TremLock 215 Fascia Single Ply BUR/MD	Max. 8.5" Outside Face Max. Length 12' Min. Thickness 24ga., or 0.040" aluminum	TAS 111 (B)	Decorative galvanized steel or aluminum fascia with continuous extruded aluminum bar.
TremLock 215 EXT Fascia Single Ply	Max. 13" Outside Face Max. Length 12' Min. Thickness 0.050" aluminum	TAS 111 (B)	Decorative galvanized steel or aluminum fascia with continuous extruded aluminum bar.
TremLock 215 EXT Fascia BUR/MB	Max. 13" Outside Face Max. Length 12' Min. Thickness 24 ga. or 0.040" aluminum	TAS 111 (B)	Decorative galvanized steel or aluminum fascia with continuous extruded aluminum bar.
TremLock 215 EXT Canted Fascia	Max. 8.5" Outside Face Max. Length 12' Min. Thickness 24 ga. or 0.040" aluminum	TAS 111 (B)	Decorative galvanized steel or aluminum fascia with continuous extruded aluminum bar.
TremLock 215 Drip Edge	Max. 7.5" Outside Face Max. Length 12' Min. 0.040" aluminum	TAS 111 (B)	Decorative galvanized steel or aluminum fascia with extruded aluminum bar.
TremLock 215 HD Fascia Single Ply	Max. 10" Outside Face Max. Length 12' Min. Thickness 22ga or 0.050" aluminum	TAS 111 (B)	Decorative aluminum fascia with continuous extruded aluminum bar.
TremLock 215 HD Fascia BUR/MB	Max. 10" Outside Face Max. Length 12' Min. Thickness 22ga or 0.050" aluminum	TAS 111 (B)	Decorative aluminum fascia with continuous extruded aluminum bar.
TremLock Eco Edge MB	Max. 8" Outside Face Max. Length 12' Min. Thickness 24ga., or 0.040" aluminum	TAS 111 (B)	Decorative galvanized steel or aluminum fascia with continuous formed rail.
TremLock Eco-Slot Drip Edge	Max. 6" Front Face Max 4" Top flange Max. Length 12' Min. Thickness 24ga., or 0.040" aluminum	TAS 111 (B)	Decorative galvanized steel or aluminum fascia with continuous formed rail.

TremLock Eco Drip Edge S	Max. 10" Front Face Max. Length 12' Max 4" Top Flange Min. Thickness 24ga., or 0.040" aluminum	TAS 111 (B)	Decorative galvanized steel or aluminum fascia with continuous formed rail.
TremLock Eco Edge Single Ply	Max. 8" Outside Face Max. Length 12' Min. Thickness 24ga., or 0.040" aluminum	TAS 111 (B)	Decorative galvanized steel or aluminum fascia with continuous formed rail.
TremLock Eco Edge Extended Fascia	Max. 12.5" Outside Face Max. Length 12' Min. Thickness 0.050" aluminum	TAS 111 (B)	Decorative galvanized steel or aluminum fascia with continuous formed rail.
TremLock Eco Gravel Stop	Max. 10" Outside Face Max. Length 12' Max 4" Top Flange Min. Thickness 24ga., or 0.040" aluminum	TAS 111 (B)	Decorative galvanized steel or aluminum fascia with continuous formed rail.
TremLock 200S Fascia	Max. 12.75" Face Height Max. Length 12' Min. Thickness 24ga., or 0.040" aluminum	TAS 111 (B)	Decorative galvanized steel or aluminum fascia with formed galvanized waterdam.
TremLock 300S Fascia	Max. 12.75" Face Height Max. Length 12' Min. Thickness 24ga., or 0.040" aluminum	TAS 111 (B)	Decorative galvanized steel or aluminum fascia with continuous formed galvanized waterdam.
TremLock Infinity Flush Coping	Max. 12" Outside Face Max. Length 12' Max. Wall width 32" Inside Face 4" Min. Thickness 24ga. or 0.040" aluminum	TAS 111 (C)	Decorative aluminum or galvanized coping cap with galvanized steel anchor/support cleats.
TremLock Infinity Cleat Coping	Max. 12" Outside Face Max. Length 12' Max. Wall width 32" Inside Face 4" Min. Thickness 24ga., or 0.040" aluminum	TAS 111 (C)	Decorative aluminum or galvanized coping cap with galvanized steel anchor/support cleats.

TremLock Traverse Coping	Max. 10" Outside Face Max. Length 12' Max. Wall width 24" Max. 4" Inside Face Min. Thickness 24ga. or 0.040" aluminum	TAS 111 (C)	Decorative aluminum or galvanized coping cap with galvanized steel anchor/support cleats.
---------------------------------	--	-------------	--

EVIDENCE SUBMITTED:

<u>Test Agency</u>	<u>Test Identifier</u>	<u>Test Name/Report</u>	<u>Date</u>
Intertek ETL Semko	3032125	TAS 111(B)	10/31/02
		TAS 111(C)	10/31/02
	3033767	TAS 111 (B)	10/31/02
	3033767 Addendum	TAS 111 (B)	10/02/03
Farabaugh Engineering and Testing, Inc.	T295-16	TAS 111 (C)	11/02/16
	T294-16	TAS 111 (C)	11/02/16
	T291-16	TAS 111 (B)	11/02/16
Factory Mutual Research Corp.	3052487	FM 4435	08/17/16
	PR449542	FM 4435	10/02/18
	3062924	FM 4435	04/17/19

MANUFACTURING LOCATION

1. Waukesha, WI.



INSTALLATION:

TremLock Infinity Coping (14"):

Perma-Tite Anchor clips shall be spaced a maximum of three feet o.c. Anchor clips shall be fastened with #10 x 1-1/2" hex head screws fastened through the third hole of the top portion of the anchor clip the side where the stainless-steel spring clip is located (see detail "A" herein). And with two additional 1-1/4" annular ring shank nail fastened in the provided holes on the opposite face at a maximum of 3" up from the bottom lip (see detail "A" herein).

Maximum Design Pressure: -168.5 psf. (vertical)

TremLock Infinity Coping (16"):

Perma-Tite Anchor clips shall be spaced a maximum of three feet O.C. Anchor clips shall be fastened with #10-12 s 1-1/2" long S.S. hex head screws with 1/2" washer. One fastener located in third full hole from bend on both sides of 12" wide anchor clip on inside face and outside face of coping. In addition, one fastener #14-12 x 1-1/2" long flat head screw located in hole closest to center of wood blocking on both sides of 12" anchor clip on inside wall of coping and one fastener #14-12 x 1-1/2" long flat head screw in fifth hold from bottom of drip edge on both sides of 12" wide anchor clip (see detail "B" herein).

Maximum Design Pressure: -301.7 psf. (horizontal); -261.5 psf. (vertical)

TremLock Infinity Gold Coping:

Perma-Tite Anchor clips shall be spaced a maximum of three feet O.C. Anchor clips shall be fastened with #10-12 s 1-1/2" long S.S. hex head screws with 1/2" washer. One fastener located in third full hole from bend on both sides of 12" wide anchor clip on inside face and outside face of coping. In addition, one fastener #14-12 x 1-1/2" long flat head screw located in hole closest to center of wood blocking on both sides of 12" anchor clip on inside wall of coping and one fastener #14-12 x 1-1/2" long flat head screw in fifth hold from bottom of drip edge on both sides of 12" wide anchor clip (see detail "C" herein).

Maximum Design Pressure: -368.3 psf. (horizontal); -242.8 psf. (vertical)



TremLock 215 Fascia Single Ply	TAS 111 (B)	Decorative galvanized steel or aluminum fascia with continuous extruded aluminum bar.
TremLock 215 Fascia BUR/MB	TAS 111 (B)	Decorative galvanized steel or aluminum fascia with continuous extruded aluminum bar.

TremLock 215 Fascia Single Ply or B.U.R./Modified Version

- For Face Height less than or equal to 5.5 in (140 mm): The anchor bar is secured to the wood nailer with #10-2.0 in (51 mm) long or #14 stainless steel screws (wood substrates only) or masonry screws (wood or masonry substrates) with washer secured on the vertical face with the fasteners spaced 12 in (305 mm) o.c. approximately 1.25 in (32 mm) down from top of anchor bar.
- For Face Heights less than or equal to 8.5 in (216 mm) The anchor bar is secured to the wood nailer with #10-2.0 in (51 mm) long or #14 stainless steel screws (wood substrates only) or masonry screws (wood or masonry substrates) secured on the vertical face in one row only. The top row of fasteners is spaced 12 in (305 mm) o.c. approximately 1.25 in (32 mm) from the top of the anchor bar.
- For Face Heights greater than 5.5 in (140 mm) and less than or equal to 8.5 in (216 mm) The anchor bar is secured to the wood nailer with #10-2.0 in (51 mm) long or #14 stainless steel screws (wood substrates only) or masonry screws (wood or masonry substrates) secured on the vertical face in two rows. The top row of fasteners is spaced 12 in (305 mm) o.c. approximately 1.25 in (32 mm) from the top of the anchor bar. The bottom row of fasteners is spaced 24 in (610 mm) o.c. approximately 2.75 in (70 mm) from top of the anchor bar. The rows are staggered
- Fascia cover is installed over the anchor bar.

Material	Max Face Height (in.)	Perimeter Pressure (psf.)		Corner Pressure (psf.)	
		Horizontal	Vertical	Horizontal	Vertical
0.040in. Alum [Fascia Cover]	5.5	262	454	272	570
0.040in. Alum [Fascia Cover]	8.5 [fastening only (1) row]	146	252	145	304
0.040in. Alum [Fascia Cover]	5.5 [fastening (2) rows]	175	302	163	342
0.040in. Alum [Fascia Cover]	8.5 fastening (2) rows]	175	302	163	342
24ga. Steel [Fascia Cover]	5.5	262	454	272	570
24ga. Steel [Fascia Cover]	8.5 [fastening only (1) row]	146	252	145	304
24ga. Steel [Fascia Cover]	5.5 [fastening (2) rows]	175	302	163	342
24ga. Steel [Fascia Cover]	8.5 [fastening (2) rows]	175	302	163	342



TremLock 215 Fascia Single Ply	TAS 111 (B)	Decorative galvanized steel or aluminum fascia with continuous extruded aluminum bar.			
TremLock 215 Fascia BUR/MB	TAS 111 (B)	Decorative galvanized steel or aluminum fascia with continuous extruded aluminum bar.			
TremLock 215 Fascia Single Ply Version or B.U.R./Modified Version <ul style="list-style-type: none">• The anchor bar is secured to the wood nailer with #10-2.0 in (51 mm) long or #14 stainless steel screws (wood substrates only) or masonry screws (wood or masonry substrates) secured on the vertical face with the fasteners spaced maximum 12 in (305 mm) o.c. approximately 1.25 in (32 mm) down from the top anchor bar.• The cleat is secured to the wood nailer with #14 stainless steel screws (wood substrates only) or masonry screws (wood or masonry substrates) secured on the vertical face with the fasteners spaced maximum 24 in (610 mm) o.c. approximately 2.125 (54 mm) o.c. up from the bottom of the cleat• Fascia cover is applied over the anchor bar.					
Material	Max Face Height (in.)	Perimeter Pressure (psf.)		Corner Pressure (psf.)	
		Horizontal	Vertical	Horizontal	Vertical
0.050in. Alum [Fascia Cover]	13	175	302	163	342
0.063in. Alum [Fascia Cover]	13	175	303	163	342
20ga. Steel [Cleat]	13	175	303	163	342

TremLock 215 EXT Canted Fascia	TAS 111 (B)	Decorative galvanized steel or aluminum fascia with continuous extruded aluminum bar.
---------------------------------------	-------------	---

TremLock 215 EXT Canted Fascia

- The waterdam is secured to wood nailers with 1.25 in (32 mm) long ring shank roofing nails spaced maximum 6 in (152 mm) o.c. 0.5 in (13 mm) from edge of roof flange using 4 in. (102 mm) wide 24 ga clips 72 in (1829 mm) o.c.
- The anchor bar is secured to the wood nailer with #10-2.0 in (51 mm) long or #14 stainless steel screws (wood substrates only) or masonry screws (wood or masonry substrates), secured on the vertical face with the fasteners spaced 12 in (305 mm) o.c. approximately 1.25 in (32 mm) from the top anchor bar.
- The cleat is secured to the wood nailer with 1/4 x1 1/4 masonry/wood screws secured on the vertical face with the fasteners spaced maximum 24 in (610 mm) o.c. approximately 2.0 (51 mm) o.c. up from the bottom of the cleat
- Fascia cover is snapped into place.

Material	Max Face Height (in.)	Perimeter Pressure (psf.)		Corner Pressure (psf.)	
		Horizontal	Vertical	Horizontal	Vertical
0.040in. Alum [Fascia Cover]	5.5	175	302	163	342
0.050in. Alum [Fascia Cover]	8.5	291	504	289	607
0.050in. Alum [Fascia Cover]	10	204	353	199	417
0.050in. Alum [Fascia Cover]	13.5	131	227	127	266
0.063in. Alum [Fascia Cover]	8.5	291	504	289	607
0.063in. Alum [Fascia Cover]	10	204	353	199	417
0.063in. Alum [Fascia Cover]	13.5	131	227	127	266
20ga. Steel [Cleat]	13.5	131	227	127	266
22ga. Steel [Fascia Cover]	7.5	175	302	163	342
22ga. Steel [Fascia Cover]	10	175	302	163	342
24ga. Steel [Fascia Cover]	8.5	175	302	163	342
24ga. Steel [Waterdam]	13.5	131	227	127	266



TremLock 215 Drip Edge		TAS 111 (B)		Decorative galvanized steel or aluminum fascia with continuous formed rail.	
TremLock 215 Drip Edge <ul style="list-style-type: none">The anchor bar is secured to the wood nailer with #10-1.5 in (38 mm) long or #14 stainless steel screws (wood substrates only) or masonry screws (wood or masonry substrates) secured on the vertical face in two rows. The top row of fasteners is spaced 12 in (305 mm) o.c. approximately 1.25 in (32 mm) from the top of the anchor bar. The bottom row of fasteners is spaced 24 in (610 mm) o.c. approximately 2.75 in (70 mm) from top of the anchor bar. The rows are staggered<ul style="list-style-type: none">Fascia cover is applied over the anchor bar.					
Material	Max Face Height (in.)	Perimeter Pressure (psf.)		Corner Pressure (psf.)	
		Horizontal	Vertical	Horizontal	Vertical
0.040in. Alum [Fascia Cover]	6	568	983	560	1176
24ga. Steel [Fascia Cover]	6	568	983	561	1176

TremLock 215 Drip Edge		TAS 111 (B)		Decorative galvanized steel or aluminum fascia with continuous formed rail.		
TremLock 215 Drip Edge <ul style="list-style-type: none">The anchor bar is secured to the wood nailer with #10-2.0 in (51 mm) long or #14 stainless steel screws (wood substrates only) or masonry screws (wood or masonry substrates) secured on the vertical face in two rows. The top row of fasteners is spaced 12 in (305 mm) o.c. approximately 1.25 in (32 mm) from the top of the anchor bar. (Optional) The bottom row of fasteners is spaced 24 in (610 mm) o.c. approximately 2.75 in (70 mm) from top of the anchor bar. The rows are staggered<ul style="list-style-type: none">Fascia cover is applied over the anchor bar.						
Material	Max Face Height (in.)	Perimeter Pressure (psf.)		Corner Pressure (psf.)		# of Fastening Rows
		Horizontal	Vertical	Horizontal	Vertical	
0.040in. Alum [Fascia Cover]	7.5	87	151	90	190	1
	7.5	247	428	253	531	2



TremLock 215 HD Fascia Single Ply	TAS 111 (B)	Decorative aluminum fascia with continuous extruded aluminum bar.
TremLock 215 HD Fascia BUR/MB	TAS 111 (B)	Decorative aluminum fascia with continuous extruded aluminum bar.

TremLock 215 HD Fascia Single Ply or B.U.R./Modified Version

- The anchor bar is secured to the wood nailer with #10-2.0 in (51 mm) long or #14 stainless steel screws (wood substrates only) or masonry screws (wood or masonry substrates) secured on the vertical face with the fasteners spaced 12 in (305 mm) o.c. approximately 1.25 in (32 mm) from the top anchor bar.
- Fascia cover is applied over the anchor bar.

Material	Max Face Height (in.)	Perimeter Pressure (psf.)		Corner Pressure (psf.)	
		Horizontal	Vertical	Horizontal	Vertical
0.040in. Alum [Fascia Cover]	8.5	175	302	163	342
0.050in. Alum [Fascia Cover]	7	364	630	362	759
0.050in. Alum [Fascia Cover]	8.5	291	504	289	607
0.050in. Alum [Fascia Cover]	10	189	328	181	380
0.063in. Alum [Fascia Cover]	7	364	630	362	759
22ga. Steel [Fascia Cover]	8.5 or 10	175	302	163	342



TremLock Eco Edge MB	TAS 111 (B)	Decorative galvanized steel or aluminum fascia with continuous formed rail.
-----------------------------	-------------	---

TremLock Eco Edge MB

- For Face Height less than or equal to 5 in (127 mm): The rail is secured to the wood nailer with #10-2.0 in (51 mm) long or #14 stainless steel screws (wood substrates only) or masonry screws (wood or masonry substrates) secured on the vertical face with the fasteners spaced maximum 12 in (305 mm) o.c. approximately 1.25 in (32 mm) from the top of the rail.
- For Face Heights less than or equal to 8 in (203 mm) The rail is secured to the wood nailer with two rows of #10-2.0 in (51 mm) long or #14 stainless steel screws (wood substrates only) or masonry screws (wood or masonry substrates). The top row is secured on the vertical face with the fasteners spaced 12 in (305 mm) o.c. approximately 1.25 in (32 mm) from the top of the rail. The bottom row is secured on the vertical face with the fasteners spaced 24 in (610 mm) o.c. approximately 2.75 in (70 mm) from the top of the rail.
- Spring clips are placed over the rail spaced 48 in (1219 mm) o.c.
- Fascia cover is snapped into place.

Material	Max Face Height (in.)	Perimeter Pressure (psf.)		Corner Pressure (psf.)	
		Horizontal	Vertical	Horizontal	Vertical
0.040in. Alum [Fascia Cover]	5	407	706	416	873
0.040in. Alum [Fascia Cover]	8	175	302	163	342
20ga. Steel [Rail]	5	407	706	416	873
20ga. Steel [Rail]	8	175	302	163	342
24ga. Steel [Fascia Cover]	5	407	706	416	873
24ga. Steel [Fascia Cover]	8	175	302	163	342



TremLock Eco-Slot Drip Edge		TAS 111 (B)		Decorative galvanized steel or aluminum fascia with continuous formed rail.	
TremLock Eco-Slot Drip Edge <ul style="list-style-type: none">• The continuous cleat is secured to the wood nailer with 1.25 in (32 mm) long ring shank nails secured on the vertical face spaced maximum 12 in (305 mm) o.c. approximately 0.813 in (21 mm) down from the top of the wall.• The top flange of the fascia cover is fastened with 1.25 in (32 mm) long ring shank nails in two staggered rows, each row spaced 12 in (305 mm) o.c., the rows are 1.75 in (44 mm) and 3 in (76 mm) from edge of wall.					
Material	Max Face Height (in.)	Perimeter Pressure(psf.)		Corner Pressure (psf.)	
		Horizontal	Vertical	Horizontal	Vertical
0.040in. Alum [Fascia Cover]	6	276	479	271	569
22ga. Steel [Cleat]	6	276	479	271	569
24ga. Steel [Fascia Cover]	6	276	479	271	569



TremLock Eco Drip Edge S	TAS 111 (B)	Decorative galvanized steel or aluminum fascia with continuous formed rail.
---------------------------------	-------------	---

TremLock Eco Drip Edge S

- For Face Height less than or equal to 6 in (152 mm): The continuous cleat is secured to the wood nailer with 1.25 in (32 mm) long ring shank nails secured on the vertical face spaced 12 in (305 mm) o.c. approximately 0.813 in (21 mm) down from the top of the wall.
- The top flange of the fascia cover is fastened with 1.25 in (32 mm) long ring shank nails spaced 6 in (152 mm) o.c, 0.5 in (13 mm) edge of flange.
- For Face Height greater than 6 in (152 mm) and less than or equal to 10 in (254 mm): The continuous cleat is secured to the wood nailer with 1.25 in (32 mm) long ring shank nails secured on the vertical face spaced 12 in (305 mm) o.c. approximately 1.5 in (38 mm) up from the drip.
- The top flange of the fascia cover is fastened with 1.25 in (32 mm) long ring shank nails spaced 6 in (152 mm) o.c, 0.4375 in (11 mm) edge of flange.

Material	Max Face Height (in.)	Perimeter Pressure (psf.)		Corner Pressure (psf.)	
		Horizontal	Vertical	Horizontal	Vertical
0.040in. Alum [Fascia Cover]	6	276	479	271	569
0.040in. Alum [Fascia Cover]	10	175	302	163	342
0.050in. Alum [Fascia Cover]	6	276	479	271	569
0.050in. Alum [Fascia Cover]	10	175	302	163	342
0.063in. Alum [Fascia Cover]	6	276	479	271	569
0.063in. Alum [Fascia Cover]	10	175	302	163	342
0.040in. Alum [Fascia Cover – PVC or TPO Coating]	6	276	479	271	569
0.040in. Alum [Fascia Cover – PVC or TPO Coating]	10	175	302	163	342
22ga. Steel [Fascia Cover]	6	276	479	271	569
22ga. Steel [Fascia Cover]	10	175	302	163	342
24ga. Steel [Fascia Cover]	6	276	479	271	569
24ga. Steel [Fascia Cover]	10	175	302	163	342
24ga. Steel [Fascia Cover – PVC or TPO Coating]	6	276	479	271	569
24ga. Steel [Fascia Cover – PVC or TPO Coating]	10	175	302	163	342
22ga. Steel [Cleat]	6	276	479	271	569
22ga. Steel [Cleat]	10	175	302	163	342



TremLock Eco Edge Single Ply		TAS 111 (B)		Decorative galvanized steel or aluminum fascia with continuous formed rail.	
TremLock Eco Edge Single Ply <ul style="list-style-type: none">• The continuous cleat is secured to the wood nailer with #10-2 in (51 mm) long or #14 stainless steel screws (wood substrates only) or masonry screws (wood or masonry substrates) secured 12 in (305 mm) o.c. approximately 13/16 - 1 in (21-25 mm) down from the upper horizontal surface.• Spring clips are placed over the rail spaced 48 in (1219 mm) o.c.• Fascia cover is snapped into place.					
Material	Max Face Height (in.)	Perimeter Pressure (psf.)		Corner Pressure (psf.)	
		Horizontal	Vertical	Horizontal	Vertical
0.040in. Alum [Fascia Cover]	4	393	680	380	797
0.040in. Alum [Fascia Cover]	8	146	252	145	304
24ga. Steel [Fascia Cover]	4	393	680	380	797
24ga. Steel [Fascia Cover]	8	146	252	145	304
20ga. Steel [Cleat]	4	393	680	380	797
20ga. Steel [Cleat]	8	146	252	145	304

TremLock Eco Edge Extended Fascia		TAS 111 (B)		Decorative galvanized steel or aluminum fascia with continuous formed rail.	
TremLock Eco Edge Extended Fascia <ul style="list-style-type: none">• The continuous cleat is secured to the wood nailer in two rows. The top row is #10-2 in (51 mm) long or #14 stainless steel screws (wood substrates only) or masonry screws (wood or masonry substrates) secured 12 in (305 mm) o.c. approximately 1 in (19 mm) down from the upper horizontal surface. The bottom row is 1/4x1 ¼ Long masonry/wood screws spaced 24 in (605 mm) o.c. approximately 2.125 in (54 mm) up from the bottom edge of the cleat.• Spring clips are placed over the rail spaced 48 in (1219 mm) o.c.• Fascia cover is snapped into place.					
Material	Max Face Height (in.)	Perimeter Pressure (psf.)		Corner Pressure (psf.)	
		Horizontal	Vertical	Horizontal	Vertical
0.050in. Alum [Fascia Cover]	12.5	146	252	145	304
20ga. Steel [Cleat]	12.5	146	252	145	304



TremLock Eco Gravel Stop	TAS 111 (B)	Decorative galvanized steel or aluminum fascia with continuous formed rail.
---------------------------------	-------------	---

TremLock Eco Gravel Stop

- For Face Height less than or equal to 6 in (152 mm): The continuous cleat is secured to the wood nailer with 1.25 in (32 mm) long ring shank nails secured on the vertical face spaced 12 in (305 mm) o.c. approximately 13/16 in (21 mm) down from the top of the wall.
- The top flange of the fascia cover is fastened with 1.25 in (32 mm) long ring shank nails spaced 6 in (152 mm) o.c, 0.4375 in (11 mm) edge of flange.
- For Face Height >6 in (152) up to 10 in (254 mm): The continuous cleat is secured to the wood nailer with 1.25 in (32 mm) long ring shank nails secured on the vertical face spaced 12 in (305 mm) o.c. approximately 1.5 in (38 mm) up from bottom of cleat.
- The top flange of the fascia cover is fastened with 1.25 in (32 mm) long ring shank nails spaced 6 in (152 mm) o.c, 0.4375 in (11 mm) edge of flange.

Material	Max Face Height (in.)	Perimeter Pressure (psf.)		Corner Pressure (psf.)	
		Horizontal	Vertical	Horizontal	Vertical
0.040in. Alum [Fascia Cover]	6	204	353	200	417
0.040in. Alum [Fascia Cover]	10	247	428	253	531
0.050in. Alum [Fascia Cover]	6	204	353	200	417
0.050in. Alum [Fascia Cover]	10	247	428	253	531
0.063in. Alum [Fascia Cover]	6	204	353	200	417
0.063in. Alum [Fascia Cover]	10	247	428	253	531
0.040in. Alum [Fascia Cover – PVC or TPO Coating]	6	204	353		417
0.040in. Alum [Fascia Cover – PVC or TPO Coating]	10	247	428	253	531
24ga. Steel [Fascia Cover]	6	204	353	200	417
24ga. Steel [Fascia Cover]	10	247	428	253	531
24ga. Steel [Fascia Cover – PVC or TPO Coating]	6	204	353	200	417
24ga. Steel [Fascia Cover – PVC or TPO Coating]	10	247	428	253	531
22ga. Steel [Cleat]	6	204	353	200	417
22ga. Steel [Cleat]	10	247	428	253	531



TremLock 200S Fascia	TAS 111 (B)	Decorative galvanized steel or aluminum fascia with continuous formed rail.
TremLock 300S Fascia	TAS 111 (B)	Decorative galvanized steel or aluminum fascia with continuous formed rail.

TremLock 200S Fascia or 300 Fascia, Modified, Snap-On

- Steel cant/waterdam is secured to wood nailers with 1-¼ in (32 mm) long ring shank roofing nails secured on the vertical face spaced 12 in (305 mm) o.c. 2 ¼ in (57 mm) from bottom of drip edge and on the top 6 in (152) o.c. approximately 0.5 in (13 mm) from the edge.
- Stainless steel spring clips are applied maximum 4 ft. (1.2 m) o.c.
- An FM Approved roof membrane is applied over the cant.
- The fascia cover is then snapped into place over the cant.

Material	Max Face Height (in.)	Perimeter Pressure (psf.)		Corner Pressure (psf.)	
		Horizontal	Vertical	Horizontal	Vertical
0.040in. Alum [Fascia Cover]	8.25	189	328	182	380
0.040in. Alum [Fascia Cover]	12.75	116	202	109	228
0.050in. Alum [Fascia Cover]	8.25	204	353	200	417
0.050in. Alum [Fascia Cover]	12.75	116	202	109	228
0.063in. Alum [Fascia Cover]	12.75	116	202	109	228
24ga. Steel [Fascia Cover]	8.25	189	328	182	380
24ga. Steel [Fascia Cover]	12.75	116	202	109	228
24ga. Steel [Waterdam]	8.25	189	328	182	380
24ga. Steel [Waterdam]	12.75	116	202	109	228



TremLock Infinity Coping		TAS 111 (C)		Decorative aluminum coping cap with galvanized steel anchor/support cleats.			
TremLock Infinity Coping (Min. 20ga. Anchor Clips) <ul style="list-style-type: none">Anchor clips are secured on the 6 in (152 mm) face with two #10 or #14 stainless steel screws (wood substrates only) or masonry screws (wood or masonry substrates) 1.5 in (38 mm) from the bottom and on the top of the 6 in (152 mm) side with two screws 1.75 in (44 mm) from the edge. On the 4 in (102 mm) side the face is secured with two screws 1.25 in (32 mm) from the bottom and on the top of the 4 in (102 mm) side with two screws 1.125 in (28.6 mm) from the edge.Anchor clips are spaced 24 in (610 mm), 36 in (914 mm) or 48 in (1219 mm) o.c.The coping cap is snapped into place over the anchor clips.							
Material	Max Face Height (in.)	Max Wall Width (in.)	Max Back Height (in.)	Perimeter Pressure (psf.)		Corner Pressure (psf.)	
				Horizontal	Vertical	Horizontal	Vertical
0.040in. Alum or 24ga. Steel [Coping Cap]	4	8	6	161	278	127	266
	Anchor Clip Material and O.C. Spacing: 20 ga, and 4 ft o.c.						
	4	12	6	87	151	73	152
	Anchor Clip Material and O.C. Spacing: 20 ga, and 4 ft o.c.						
	4	10	6	204	353	163	342
	Anchor Clip Material and O.C. Spacing: 16 ga, and 4 ft o.c.						
	4	12	6	116	202	91	190
	Anchor Clip Material and O.C. Spacing: 20 ga, and 3 ft o.c.						
	4	14	6	116	202	91	190
	Anchor Clip Material and O.C. Spacing: 20 ga, and 3 ft o.c.						
	4	16	6	131	227	109	228
	Anchor Clip Material and O.C. Spacing: 16 ga, and 4 ft o.c.						
4	24	6	73	126	N/A	N/A	
Anchor Clip Material and O.C. Spacing: 16 ga, and 3 ft o.c.							
0.040in. Alum or 24ga. Steel [Coping Cap]	4	16	12	73	126	N/A	N/A
	Anchor Clip Material and O.C. Spacing: 16 ga, and 4 ft o.c.						
0.050in. or 0.063in. Alum [Coping Cap]	4	8	6	218	378	182	380
	Anchor Clip Material and O.C. Spacing: 20 ga, and 4 ft o.c.						
	4	10	6	233	403	182	380
	Anchor Clip Material and O.C. Spacing: 16 ga, and 4 ft o.c.						
	4	12	6	131	227	109	228
	Anchor Clip Material and O.C. Spacing: 20 ga, and 3 ft o.c.						
	4	14	6	116	202	91	190
	Anchor Clip Material and O.C. Spacing: 20 ga, and 3 ft o.c.						
	4	16	6	88	152	73	152
	Anchor Clip Material and O.C. Spacing: 20 ga, and 3 ft o.c.						
	4	24	6	102	177	73	152
	Anchor Clip Material and O.C. Spacing: 16 ga, and 3 ft o.c.						
4	32	6	88	152	73	152	
Anchor Clip Material and O.C. Spacing: 16 ga, and 2 ft o.c.							
0.050in. or 0.063in. Alum [Coping Cap]	4	16	12	117	202	91	190
	Anchor Clip Material and O.C. Spacing: 16 ga, and 4 ft o.c.						
	4	24	12	102	177	91	190
	Anchor Clip Material and O.C. Spacing: 16 ga, and 3 ft o.c.						

TremLock Infinity Coping		TAS 111 (C)		Decorative aluminum coping cap with galvanized steel anchor/support cleats.			
TremLock Infinity Coping (16 ga. Anchor Clips) <ul style="list-style-type: none">Anchor clips are secured on the 6 in (152 mm) face with two #10 or #14 stainless steel screws (wood substrates only) or masonry screws (wood or masonry substrates) 1.5 in (38 mm) from the bottom and on the top of the 6 in (152 mm) side with two screws 1.75 in (44 mm) from the edge. On the 4 in (102 mm) side the face is secured with two screws 1.25 in (32 mm) from the bottom and on the top of the 4 in (102 mm) side with two screws 1.125 in (28.6 mm) from the edge.Anchor clips are spaced 24 in (610 mm), 36 in (914 mm) or 48 in (1219 mm) o.c.The coping cap is snapped into place over the anchor clips.							
Material	Max Face Height (in.)	Max Wall Width (in.)	Max Back Height (in.)	Perimeter Pressure (psf.)		Corner Pressure (psf.)	
				Horizontal	Vertical	Horizontal	Vertical
0.040in. Alum or 24ga. Steel [Coping Cap]	4	12	6	146	252	109	228
	Anchor Clip Material and O.C. Spacing: 16 ga, and 4 ft o.c.						
0.050in. or 0.063in. Alum [Coping Cap]	4	12	6	218	378	182	380
	Anchor Clip Material and O.C. Spacing: 16 ga, and 4 ft o.c.						
	4	16	6	146	252	127	266
	Anchor Clip Material and O.C. Spacing: 16 ga, and 4 ft o.c.						

TremLock Infinity Flush Coping			TAS 111 (C)			Decorative aluminum coping cap with galvanized steel anchor/support cleats.	
TremLock Infinity Gold Coping			TAS 111 (C)			Decorative aluminum coping cap with galvanized steel anchor/support cleats.	
TremLock Infinity Flush Coping or TremLock Infinity Gold Coping (Min. 20 ga. Anchor Clips) <ul style="list-style-type: none">Anchor clips are secured on the outside face with two #10 or #14 stainless steel screws (wood substrates only) or masonry screws (wood or masonry substrates) 1.5 in (38 mm) from the bottom and on the top of the outside with two screws 1.75 in (44 mm) from the edge. On the inside face are secured with two screws 1.25 in (32 mm) from the bottom and on the top of the inside with two screws 1.125 in (28.6 mm) from the edge.Anchor clips are spaced 24 in (610 mm), 36 in (914 mm) or 48 in (1219 mm) o.c. as noted belowThe coping cap is snapped into place over the anchor clips.							
Material	Max Face Height (in.)	Max Wall Width (in.)	Max Back Height (in.)	Perimeter Pressure (psf)		Corner Pressure (psf.)	
				Horizontal	Vertical	Horizontal	Vertical
0.040in. Alum or 24ga. Steel [Coping Cap]	4	8	6	146	252	109	228
	Anchor Clip Material and O.C. Spacing: 20 ga, and 4 ft o.c.						
	4	10	6	218	378	182	380
	Anchor Clip Material and O.C. Spacing: 16 ga, and 4 ft o.c.						
	4	12	6	116	202	91	190
	Anchor Clip Material and O.C. Spacing: 20 ga, and 3 ft o.c.						
	4	14	6	87	151	73	152
	Anchor Clip Material and O.C. Spacing: 20 ga, and 3 ft o.c.						
	4	16	6	87	151	N/A	N/A
	Anchor Clip Material and O.C. Spacing: 20 ga, and 3 ft o.c.						
0.040in. Alum or 24ga. Steel [Coping Cap]	4	16	12	131	227	109	228
	Anchor Clip Material and O.C. Spacing: 16 ga, and 4 ft o.c.						
	4	24	12	87	151	73	152
	Anchor Clip Material and O.C. Spacing: 16 ga, and 4 ft o.c.						
0.050in. or 0.063in. Alum [Coping Cap]	4	8	6	190	328	163	342
	Anchor Clip Material and O.C. Spacing: 20 ga, and 4 ft o.c.						
	4	10	6	291	504	236	493
	Anchor Clip Material and O.C. Spacing: 16 ga, and 4 ft o.c.						
	4	12	6	146	252	109	228
	Anchor Clip Material and O.C. Spacing: 20 ga, and 3 ft o.c.						
	4	14	6	116	202	91	190
	Anchor Clip Material and O.C. Spacing: 20 ga, and 3 ft o.c.						
	4	16	6	102	176	73	152
	Anchor Clip Material and O.C. Spacing: 20 ga, and 3 ft o.c.						
	4	24	6	131	227	109	228
	Anchor Clip Material and O.C. Spacing: 16 ga, and 3 ft o.c.						
0.050in. or 0.063in. Alum [Coping Cap]	4	32	6	87	151	73	152
	Anchor Clip Material and O.C. Spacing: 16 ga, and 2 ft o.c.						
	4	16	12	146	252	109	228
	Anchor Clip Material and O.C. Spacing: 16 ga, and 4 ft o.c.						
0.050in. or 0.063in. Alum [Coping Cap]	4	24	12	102	176	91	190
	Anchor Clip Material and O.C. Spacing: 16 ga, and 3 ft o.c.						
	Anchor Clip Material and O.C. Spacing: 16 ga, and 3 ft o.c.						

TremLock Infinity Flush Coping	TAS 111 (C)	Decorative aluminum coping cap with galvanized steel anchor/support cleats.
TremLock Infinity Gold Coping	TAS 111 (C)	Decorative aluminum coping cap with galvanized steel anchor/support cleats.

TremLock Infinity Flush Coping or TremLock Infinity Gold Coping (16 ga. Anchor Clips)

- Anchor clips are secured on the outside face with two #10 or #14 stainless steel screws (wood substrates only) or masonry screws (wood or masonry substrates) 1.5 in (38 mm) from the bottom and on the top of the outside with two screws 1.75 in (44 mm) from the edge. On the inside face are secured with two screws 1.25 in (32 mm) from the bottom and on the top of the inside with two screws 1.125 in (28.6 mm) from the edge.
- Anchor clips are spaced 24 in (610 mm), 36 in (914 mm) or 48 in (1219 mm) o.c. as noted below
- The coping cap is snapped into place over the anchor clips.

Material	Max Face Height (in.)	Max Wall Width (in.)	Max Back Height (in.)	Perimeter Pressure (psf)		Corner Pressure (psf)	
				Horizontal	Vertical	Horizontal	Vertical
0.040in. Alum or 24ga. Steel [Coping Cap]	4	12	6	189	328	163	342
	Anchor Clip Material and O.C. Spacing: 16 ga, and 4 ft o.c.						
	4	16	6	131	227	109	228
0.050in. or 0.063in. Alum [Coping Cap]	4	12	6	233	403	182	380
	Anchor Clip Material and O.C. Spacing: 16 ga, and 4 ft o.c.						
	4	16	6	146	252	109	228
Anchor Clip Material and O.C. Spacing: 16 ga, and 4 ft o.c.							



TremLock Infinity Cleat Coping	TAS 111 (C)	Decorative aluminum coping cap with galvanized steel anchor/support cleats.
---------------------------------------	-------------	---

TremLock Infinity Cleat Coping

- The outside cleat is secured to the front face of the substrate with #14 stainless steel screws (wood substrate only) or masonry screw spaced 12 in (305 mm) o.c. and 1.25 in (32 mm) up from the bottom edge of the cleat and is secured to the top face of the substrate with #14 stainless steel screws (wood substrate only) or masonry screw spaced 12 in (305 mm) o.c. and 0.5 in (13 mm) from the edge of the cleat.
- The inside cleat is secured to the inside face of the substrate with #14 stainless steel screws (wood substrates only) or masonry screw spaced 12 in (305 mm) o.c. and 1.75 in (44 mm) up from the bottom edge of the cleat and is secured to the top face of the substrate with #14 stainless steel screws (wood substrates only) or masonry screw spaced 12 in (305 mm) o.c. and 0.5 in (13 mm) from the edge of the cleat.
- The coping cap is secured over the two cleats and crimped on the inside face with a hand crimper maximum 18 in (457 mm) o.c.

Material	Max Face Height (in.)	Max Wall Width (in.)	Max Back Height (in.)	Perimeter Pressure (psf.)		Corner Pressure (psf.)	
				Horizontal	Vertical	Horizontal	Vertical
0.040in. Alum or 24ga. Steel [Coping Cap]	4	12	6	190	328	145	304
	4	14	6	160	277	127	266
	4	16	6	175	304	145	304
	4	24	6	88	152	73	152
0.040in. Alum or 24ga. Steel [Coping Cap]	4	16	12	146	252	109	228
	4	24	12	88	152	73	152
0.050in. or 0.063in. Alum [Coping Cap]	4	12	6	218	378	182	380
	4	14	6	175	304	145	304
	4	16	6	233	404	199	418
	4	24	6	131	227	109	228
	4	32	6	102	176	73	152
0.050in. or 0.063in. Alum [Coping Cap]	4	16	12	218	378	182	380
	4	24	12	131	227	109	228



TremLock Traverse Coping	TAS 111 (C)	Decorative aluminum coping cap with galvanized steel anchor/support cleats.
---------------------------------	-------------	---

TremLock Traverse Coping

For 6 in (152 mm) face and 16 in (406 mm) wide walls: Anchor clips are secured on the inside face with two #10 or #14 stainless steel screws (wood substrate only) or masonry screw 1.75 in (44 mm) from the bottom and on the top of the inside side with two screws 1.5 in (38 mm) from the edge. On the top of the outside face is secured with two #10 or #14 stainless steel screws (wood substrate only) or masonry screw 4.5 in (114 mm) from the edge and another two screws 5 in (127 mm) from the edge.

For 10 in (254 mm) face and 24 in (610 mm) wide walls: Anchor clips are secured on the inside face with two #10 or #14 stainless steel screws (wood substrate only) or masonry screw 1.375 in (35 mm) from the bottom and on the top of the inside side with two screws 2.5 in (63.5 mm) from the edge. The top of the outside face is secured with two #10 or #14 stainless steel screws (wood substrate only) or masonry screw 4.5 in (114 mm) from the edge and another two screws 5 in (127 mm) from the edge.

Anchor clips are spaced 36 in (914 mm) o.c.

The coping cap is snapped into place over the anchor clips.

Material	Max Face Height (in.)	Max Wall Width (in.)	Max Back Height (in.)	Perimeter Pressure (psf.)		Corner Pressure (psf.)	
				Horizontal	Vertical	Horizontal	Vertical
0.040in. Alum or 24ga. Steel [Coping Cap]	4	16	6	116	202	91	190
0.050in. Alum or 0.063in. Alum [Coping Cap]	4	16	6	116	202	91	190
0.040in. Alum or 24ga. Steel [Coping Cap]	4	24	10	88	152	N/A	N/A
0.050in. Alum or 0.063in. Alum [Coping Cap]	4	24	10	88	152	73	152



LIMITATIONS:

1. All products listed herein shall be installed in accordance with the requirements set forth in RAS 111.
2. Maximum dimensions shall be as outlined in Table 1 herein.
3. All products listed herein shall be installed in conjunction with Tremco CPG's required accessories including but not limited to: miters, splice caps, splice plates, corners, end caps, pier caps, etc.
4. Downspout scuppers, spillout scuppers shall be fabricated and installed in accordance with RAS 111.
5. If required, install water cut-off as recommended by the membrane manufacturer and under the anchor bar.
6. Contractor shall check as-built conditions and verify roof edge details for accuracy to fit as built conditions prior to installation. Installer shall comply with Tremco CPG's published installation requirements.
7. Fasteners shall be Tremco CPG's approved fasteners.
8. Fasteners shall provide a minimum pull out resistance of 240lbf (109 kg) into the substrate being fastened into. When tested in accordance with TAS 105.
9. No exposed fasteners shall be permitted.
10. All fasteners shall be of compatible materials.
11. Finishes shall be natural aluminum mill finish, or pre-coated Kynar 500. All coatings shall be in compliance with the Florida Building Code (FBC).
12. The maximum design pressures listed here in are applicable to the perimeter areas of the roof. Increased design pressures for corner areas, in compliance with applicable building code may be met through rational analysis by increasing the number of attachment points in these areas. The maximum fastener spacing noted in the "Systems Description" section of this approval shall not be exceeded. All rational analysis computations shall be prepared, signed and sealed by a Florida Registered Professional Engineer, Registered Architect, or Registered Roof Consultant.
13. All products listed herein shall have a quality assurance audit in accordance with the Florida Building Code and Rule 61G20-3 of the Florida Administrative Code.
14. All approved products listed herein shall be labeled and shall bear the imprint or identifiable marking of the manufacturer's name or logo and following statement: "Miami-Dade County Product Control Approved" or the Miami-Dade County Product Control Seal as shown below.



DETAIL A

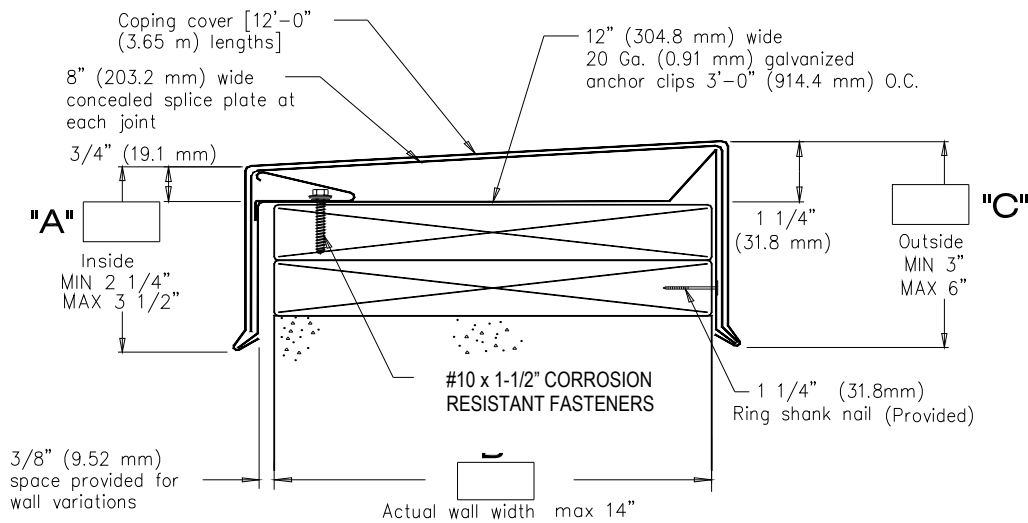

TREMLOCK INFINITY COPING (14" WIDE)

DETAIL B

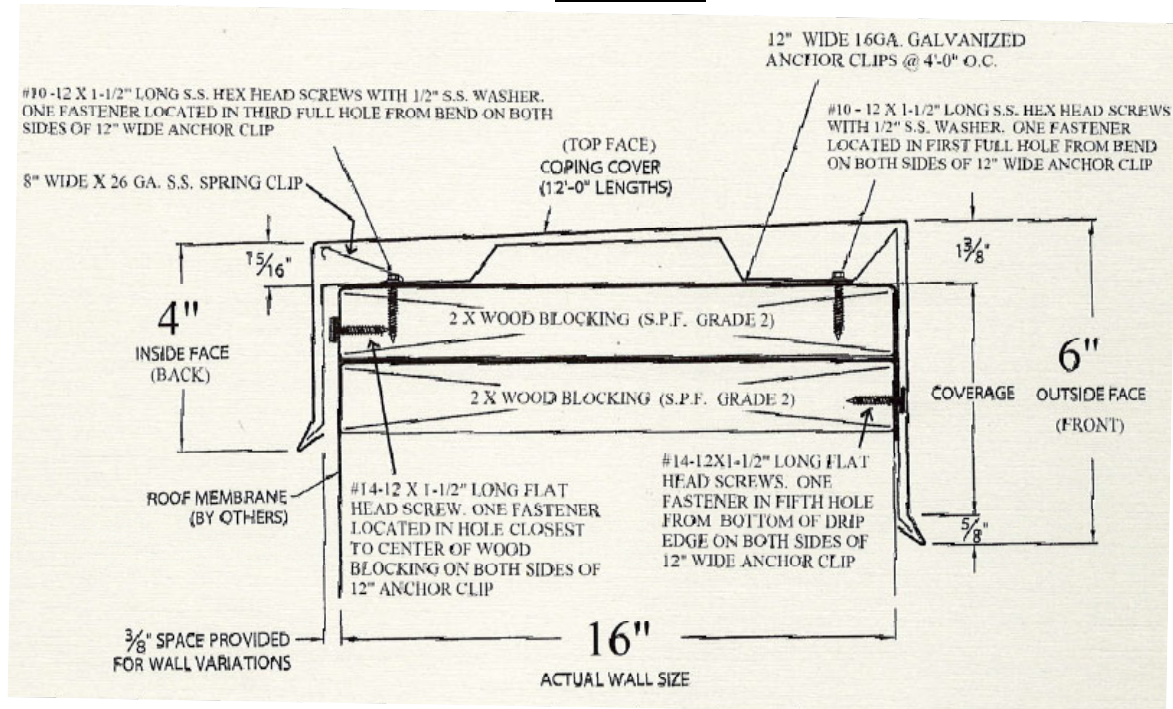

TREMLOCK INFINITY COPING (16" WIDE)

DETAIL C

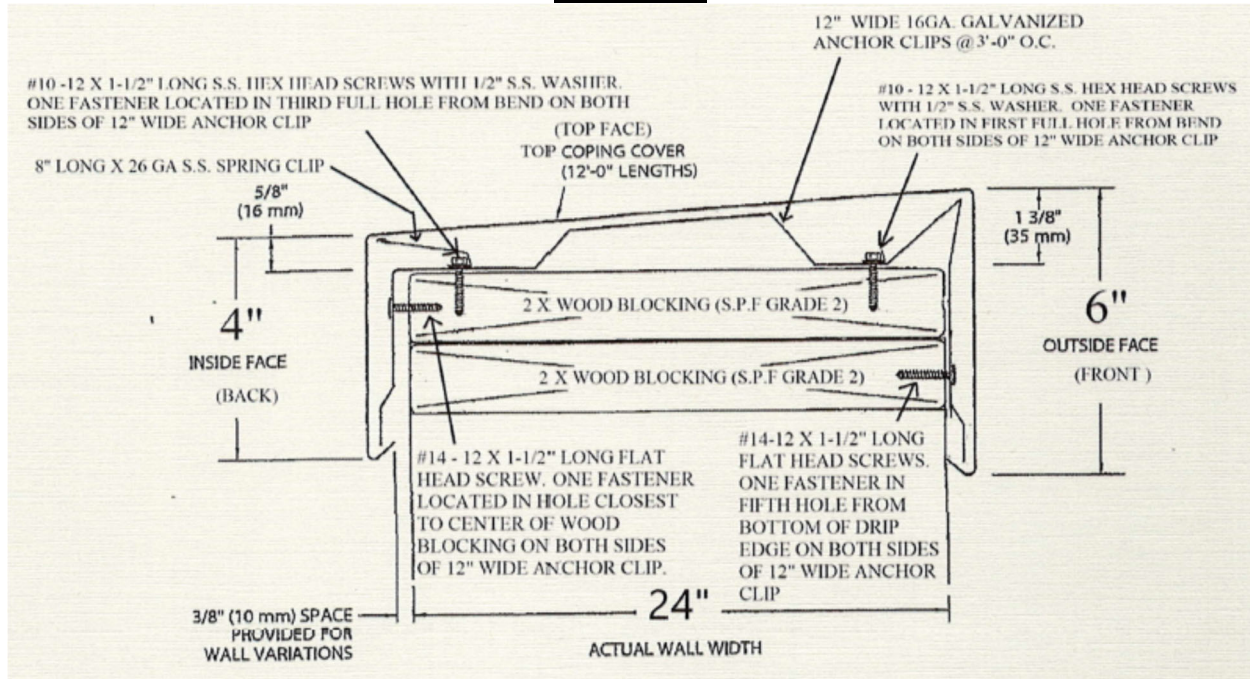

TREMLOCK INFINITY GOLD COPING

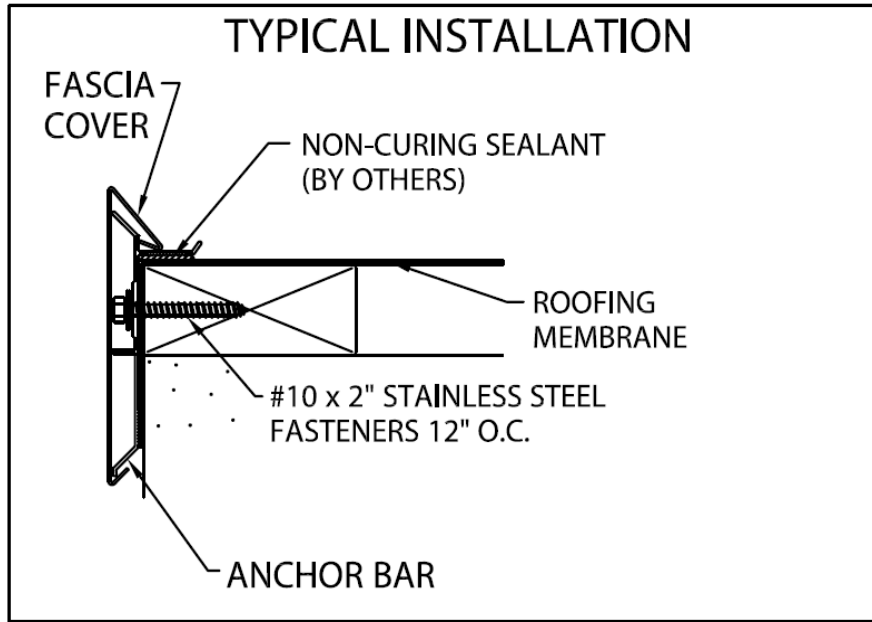

TREMLOCK 215 FASCIA SINGLE PLY

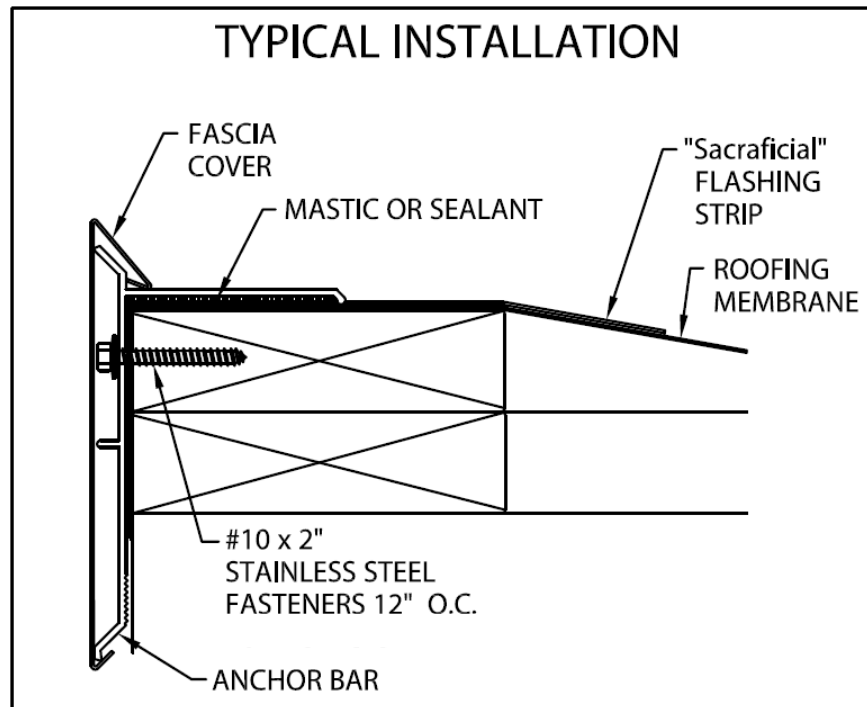

TREMLOCK 215 FASCIA SINGLE PLY

SINGLE-PLY APPLICATION TYPICAL INSTALLATION

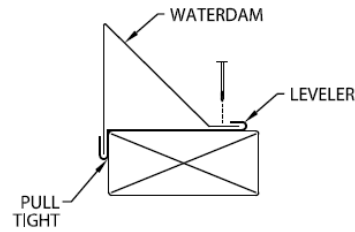
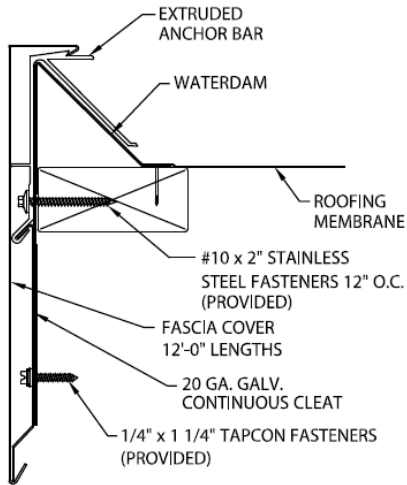

WATERDAM MUST BE PULLED TIGHT TO THE OUTSIDE FACE OF THE BUILDING BEFORE NAILING THE ROOF FLANGE.

TREMLOCK 215 FASCIA SINGLE PLY OR TREMLOCK 215 EXT CANTED FASCIA

B.U.R. / MODIFIED APPLICATION TYPICAL INSTALLATION

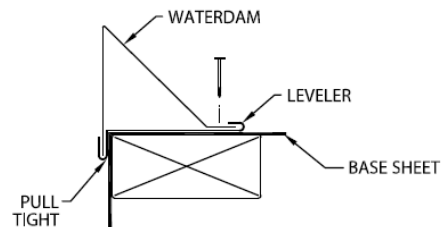
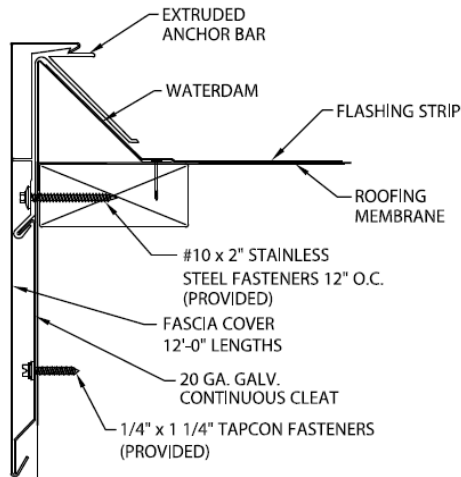

WATERDAM MUST BE PULLED TIGHT TO THE OUTSIDE FACE OF THE BUILDING BEFORE NAILING THE ROOF FLANGE.

TREMLOCK 215 EXT FASCIA BUR/MB OR TREMLOCK 215 EXT CANTED FASCIA

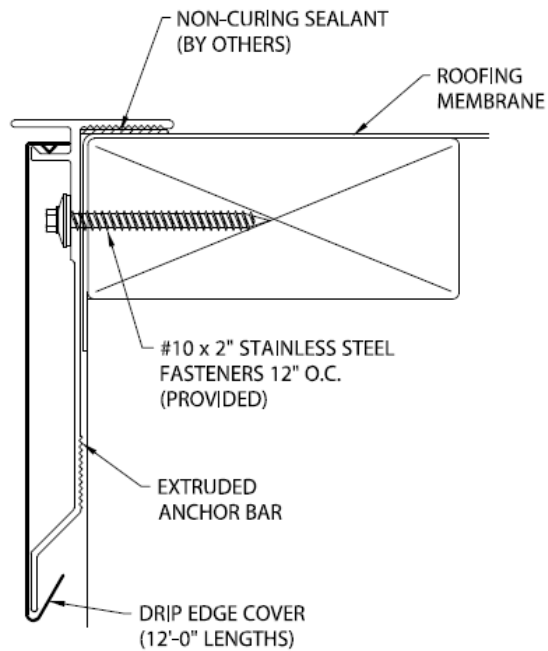

TREMLOCK 215 DRIP EDGE

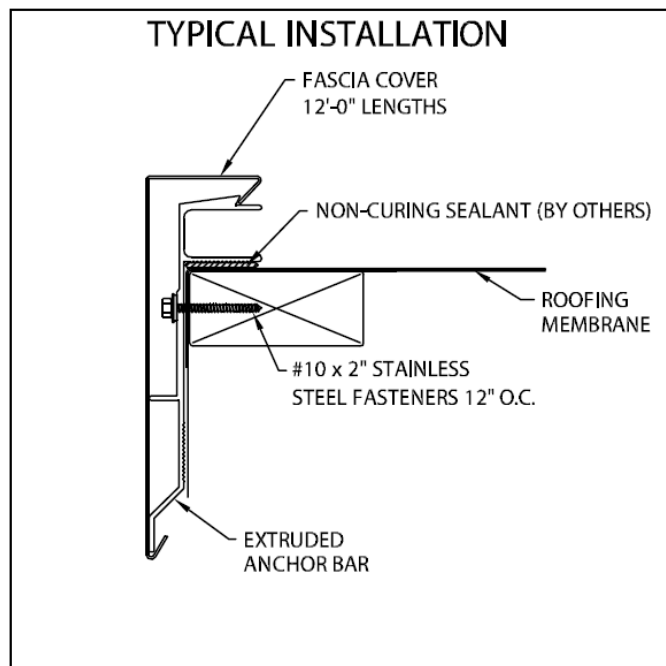

TREMLOCK 215 HD FASCIA SINGLE PLY

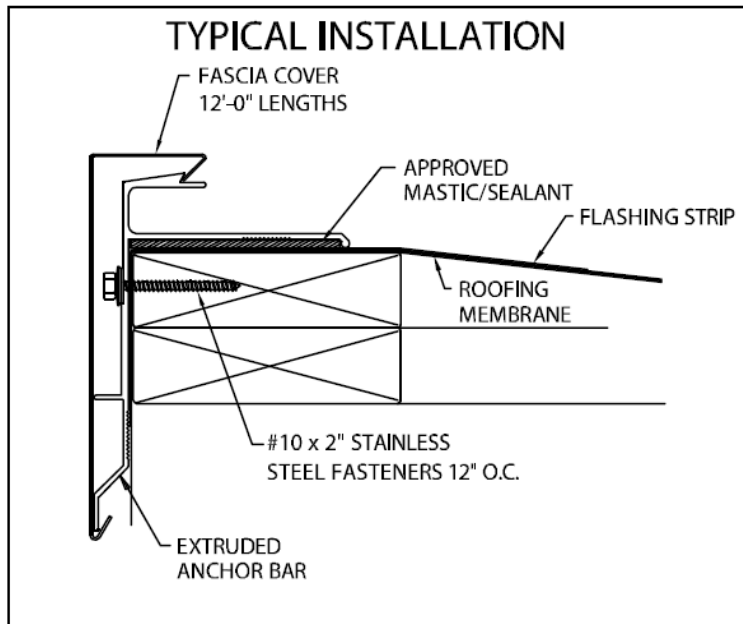

TREMLOCK 215 HD FASCIA BUR/MB

TYPICAL INSTALLATION FOR 12'-0" STRAIGHT COVER

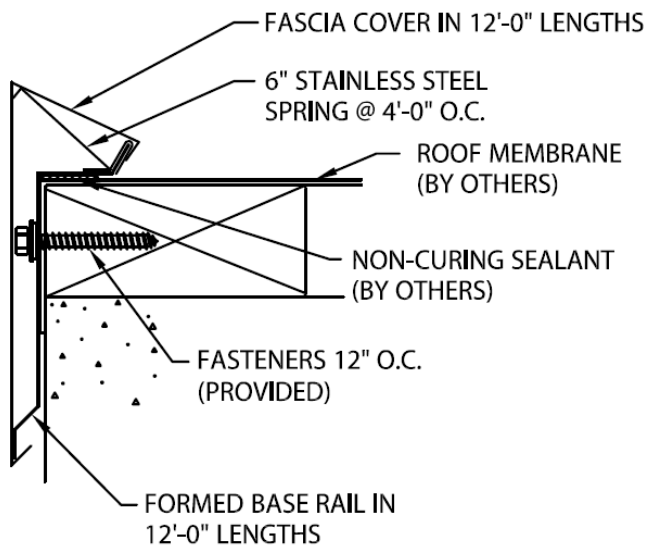

TREMLOCK ECO EDGE MB OR TREMLOCK ECO EDGE SINGLE PLY

TYPICAL INSTALLATION

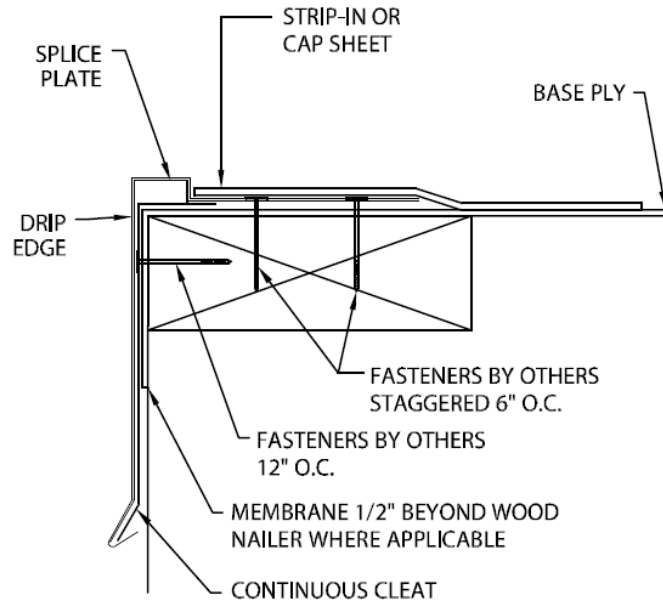

TREMLOCK ECO-SLOT DRIp EDGE

TYPICAL INSTALLATION

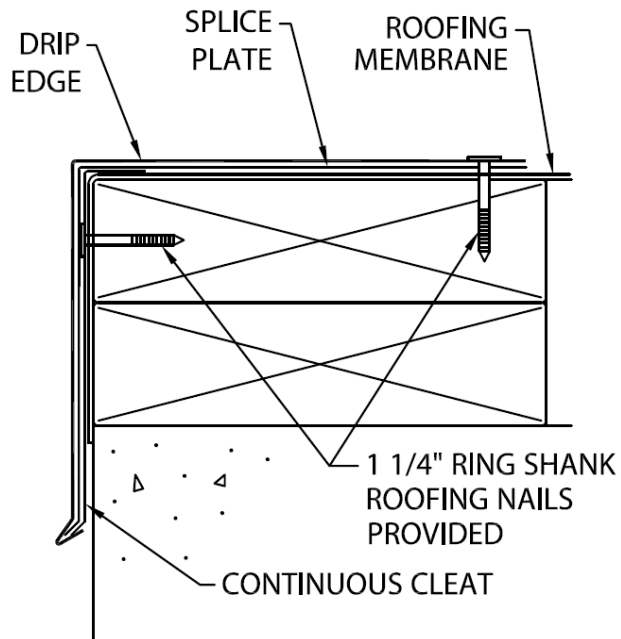

TREMLOCK ECO DRIp EDGE S

TYPICAL INSTALLATION FOR 12'-0" STRAIGHT COVER

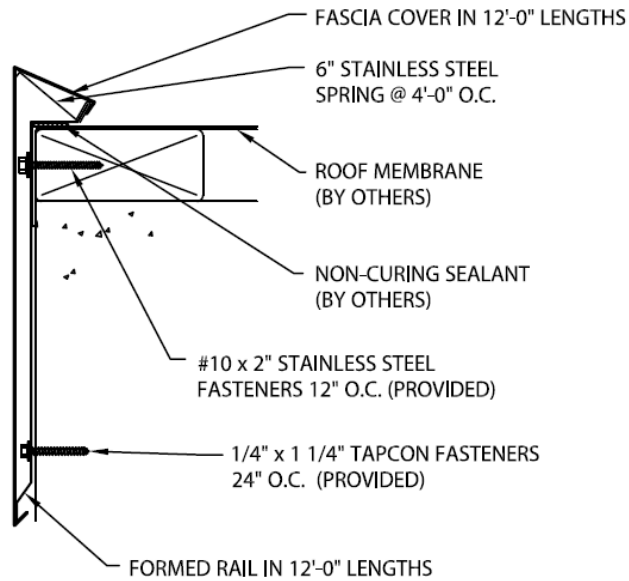

TREMLOCK ECO EDGE EXTENDED FASCIA

TYPICAL INSTALLATION

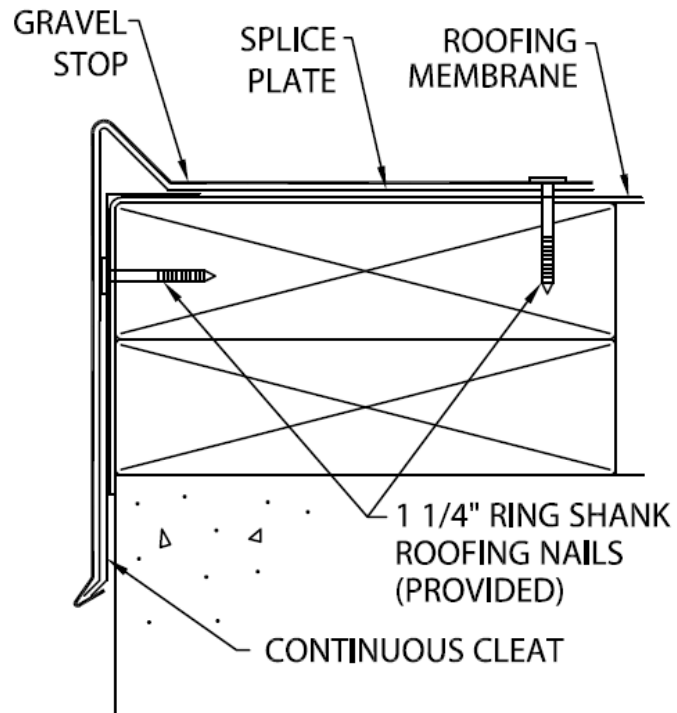

TREMLOCK ECO GRAVEL STOP



TYPICAL INSTALLATION

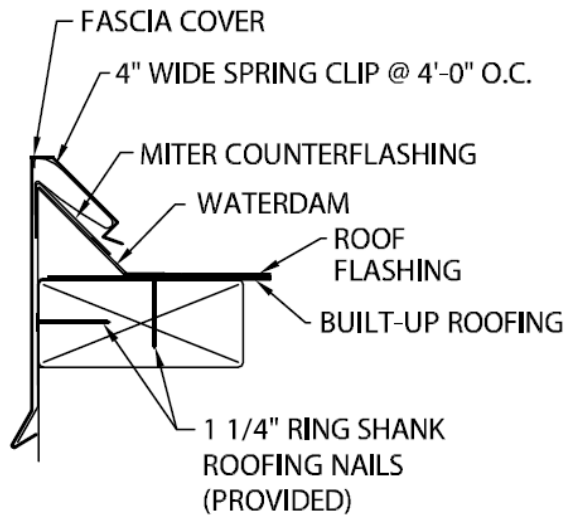

TREMLOCK 300S FASCIA

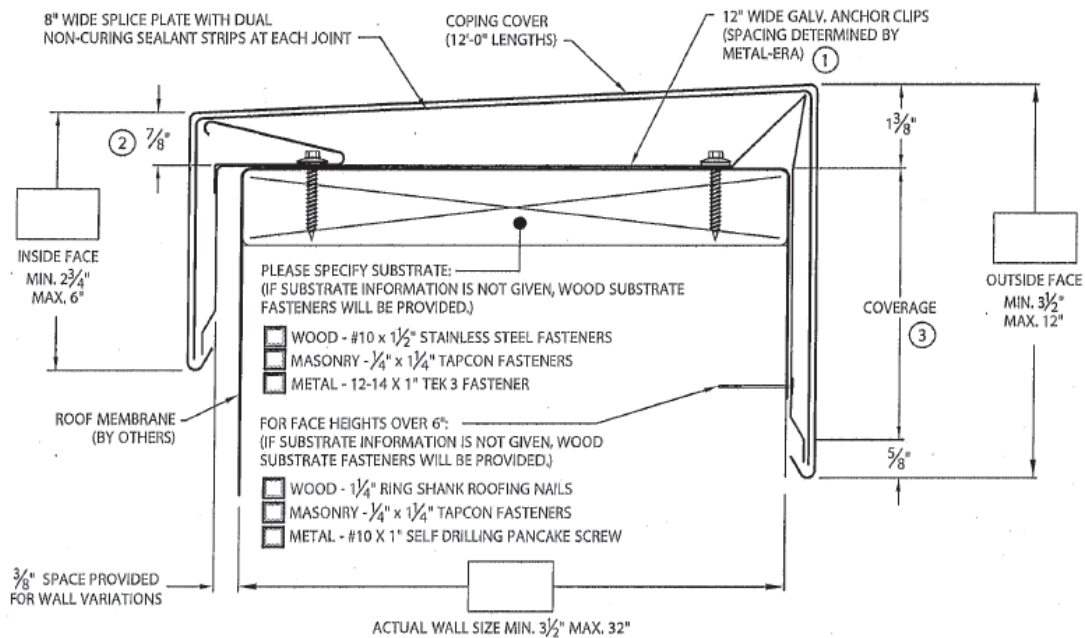

TREMLOCK INFINITY FLUSH COPING

TYPICAL INSTALLATION

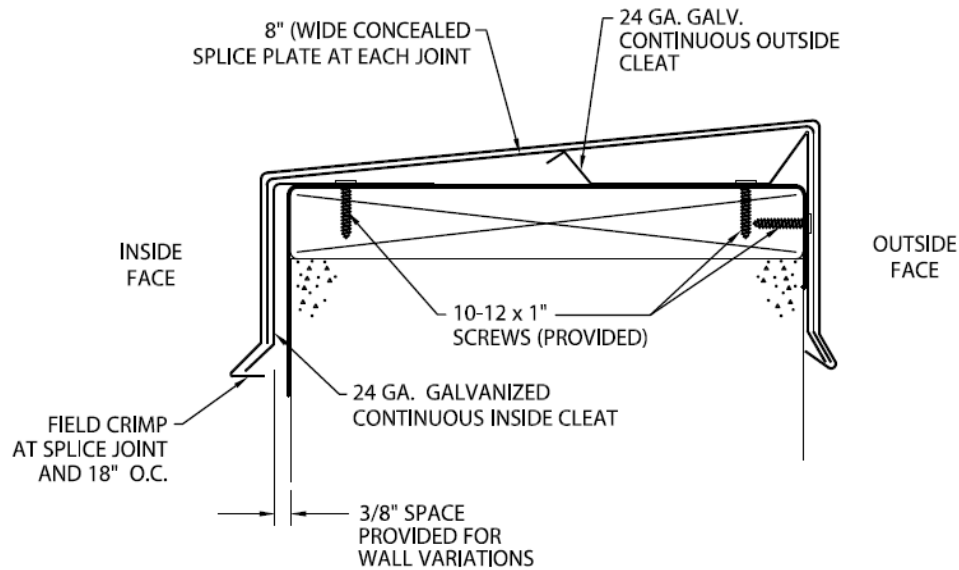

TREMLOCK INFINITY CLEAT COPING

TYPICAL COPING INSTALLATION

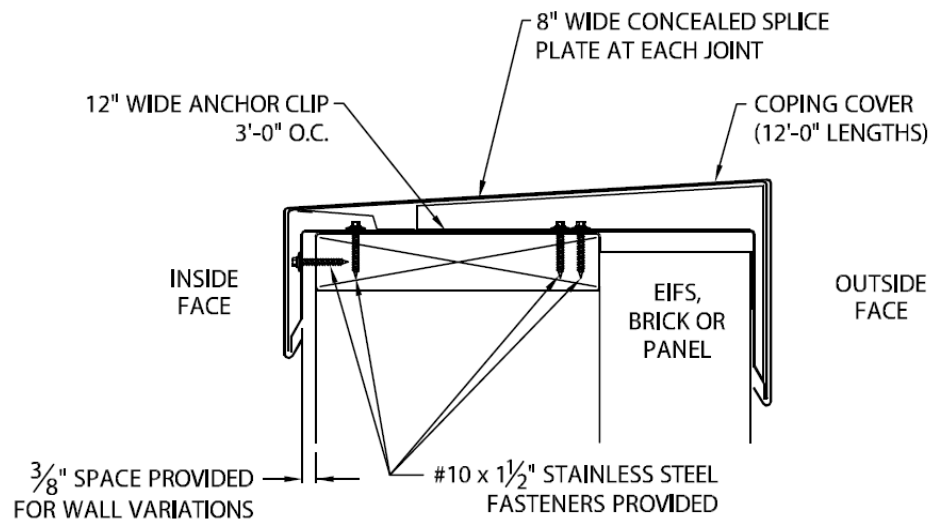

TREMLOCK TRAVERSE COPING

END OF THIS ACCEPTANCE