



DEPARTMENT OF REGULATORY AND ECONOMIC RESOURCES (RER)
BOARD AND CODE ADMINISTRATION DIVISION

NOTICE OF ACCEPTANCE (NOA)

MIAMI-DADE COUNTY
PRODUCT CONTROL SECTION

11805 SW 26 Street, Room 208
Miami, Florida 33175-2474
T (786) 315-2590 F (786) 315-2599

www.miamidade.gov/economy

MKT Fastening, LLC
1 Gunnebo Drive
Lonoke, AR 72086

SCOPE:

This NOA is being issued under the applicable rules and regulations governing the use of construction materials. The documentation submitted has been reviewed and accepted by Miami-Dade County RER-Product Control Section to be used in Miami-Dade County and other areas where allowed by the Authority Having Jurisdiction (AHJ).

This NOA shall not be valid after the expiration date stated below. The Miami-Dade County Product Control Section (In Miami-Dade County) and/ or the AHJ (in areas other than Miami-Dade County) reserve the right to have this product or material tested for quality assurance purposes. If this product or material fails to perform in the accepted manner, the manufacturer will incur the expense of such testing and the AHJ may immediately revoke, modify, or suspend the use of such product or material within their jurisdiction. RER reserves the right to revoke this acceptance if it is determined by Miami-Dade County Product Control Section that this product or material fails to meet the requirements of the applicable building code.

This product is approved as described herein and has been designed to comply with the Florida Building Code, including the High Velocity Hurricane Zone.

DESCRIPTION: MKT CONSET Screws for Concrete and Masonry

APPROVAL DOCUMENT: Drawing No. **CNST-MD-22-XXXX_01**, titled "MKT CONSET Concrete and Masonry Screws", sheets 1 and 2 of 2, prepared by manufacturer, dated on 01/10/2022, signed and sealed by Alejandro Contreras, P.E., bearing the Miami-Dade County Product Control approval stamp with the Notice of Acceptance number and approval date by the Miami-Dade County Product Control Section.

MISSILE IMPACT RATING: None

LABELING: Each box shall bear a permanent label with the manufacturer's name or logo, Kaohsiung, Taiwan, R.O.C. and following statement: "Miami-Dade County Product Control Approved or MDCPCA", unless otherwise noted herein.

RENEWAL of this NOA shall be considered after a renewal application has been filed and there has been no change in the applicable building code negatively affecting the performance of this product.

TERMINATION of this NOA will occur after the expiration date or if there has been a revision or change in the materials, use, and/or manufacture of the product or process. Misuse of this NOA as an endorsement of any product, for sales, advertising or any other purposes shall automatically terminate this NOA. Failure to comply with any section of this NOA shall be cause for termination and removal of NOA.

ADVERTISEMENT: The NOA number preceded by the words Miami-Dade County, Florida, and followed by the expiration date may be displayed in advertising literature. If any portion of the NOA is displayed, then it shall be done in its entirety.

INSPECTION: A copy of this entire NOA shall be provided to the user by the manufacturer or its distributors and shall be available for inspection at the job site at the request of the Building Official.

This NOA consists of this page 1, evidence page E-1, as well as approval document mentioned above.

The submitted documentation was reviewed by **Carlos M. Utrera, P.E.**



NOA No: 22-0412.04
Expiration Date: July 22, 2026
Approval Date: June 16, 2022

NOTICE OF ACCEPTANCE: EVIDENCE SUBMITTED

A. DRAWINGS

1. Drawing No. **CNST-MD-22-XXXX_01**, titled “MKT CONSET Concrete and Masonry Screws”, sheets 1 and 2 of 2, prepared by manufacturer, dated on 01/10/2022, signed and sealed by Alejandro Contreras, P.E.

B. TESTS “Submitted under NOA # 21-0304.01”

1. Test report supplement on Tensile Strength of 3/16” and 1/4” Diameter TAP Universal Screw Anchors per AISI S903, prepared by Applied Testing & Geosciences, LLC, Test Report No. **12432**, dated 06/07/2021, signed and sealed by Craig Joss, PhD, P.E.
2. Test report on Tension and Shear allowable capacities of 3/16” and 1/4” Diameter TAP Universal Screw Anchors per AC193, AC106, ASTM A370 and ASTM E 488, prepared by Applied Testing & Geosciences, LLC, Test Report No. **12432**, dated 01/21/2021, signed and sealed by Craig Joss, PhD, P.E.
3. Test report on Corrosion Resistance of SealProT and SealProACQ Screw Anchors per ASTM G 85, Annex 5 and TAS 114-95, Appendix E, prepared by Element Materials Technology, Test Report No. **ESP032962P.1R2**, dated 05/27/2021, signed by Jason R. Steen, P.E.

C. CALCULATIONS “Submitted under NOA # 21-0304.01”

1. Screw anchors tensile strength calculations issued by Construction Anchors Co., LTD., dated 05/22/2021, signed and sealed by Alejandro Contreras, P.E.
2. Anchors allowable capacities calculations issued by Alejandro Contreras, P.E., dated 02/24/2021, signed and sealed by Alejandro Contreras, P.E.

D. MATERIAL CERTIFICATIONS

1. None.

E. QUALITY ASSURANCE

1. Miami-Dade Department of Regulatory and Economic Resources (RER).

F. STATEMENTS “Submitted under NOA # 21-0304.01”

1. Drawing statement of code conformance to the 7th edition (2020) of the FBC issued by Alejandro Contreras, P.E., dated 05/24/2021, signed and sealed by Alejandro Contreras, P.E.
2. Statement letter of no financial interest issued by Alejandro Contreras, P.E., dated 12/20/2020, signed and sealed by Alejandro Contreras, P.E.
3. Private label agreement dated 02/08/2022.



Carlos M. Utrera, P.E.
Product Control Examiner
NOA No: 22-0412.04
Expiration Date: July 22, 2026
Approval Date: June 16, 2022

MKT Fastening, LLC

MKT® CONSET® Concrete Masonry Screws for CONCRETE and MASONRY with SealProT or SealProACQ Coating

ITEM NO.	L	E	MARK
CSP141340	1 3/4	1 1/2	A
CSP142140	2 1/4	1 7/8	B
CSP142340	2 3/4	2 1/4	C
CSP143140	3 1/4	2 1/4	D
CSP143340	3 3/4	2 1/4	E
CSP144000	4	2 1/4	F
CSP145000	5	2 1/4	H
CSP146000	6	2 1/4	J

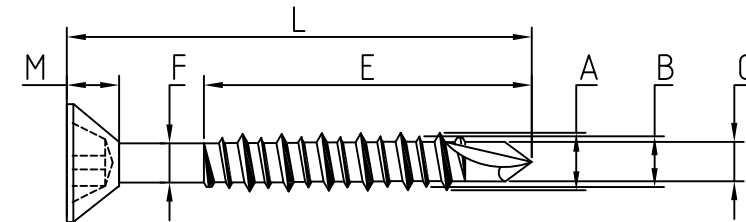
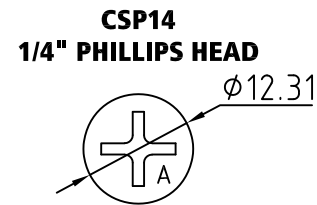

CST141340	1 3/4	1 1/2	A
CST142140	2 1/4	1 7/8	B
CST142340	2 3/4	2 1/4	C
CST143140	3 1/4	2 1/4	D
CST143340	3 3/4	2 1/4	E
CST144000	4	2 1/4	F
CST145000	5	2 1/4	H
CST146000	6	2 1/4	J

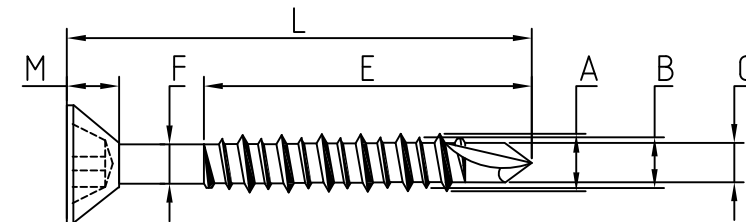
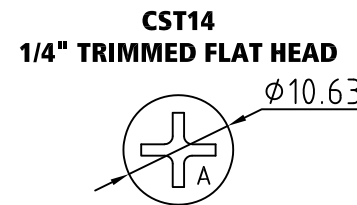

CSF141340	1 3/4	1 5/8	A
CSF142140	2 1/4	1 7/8	B
CSF142340	2 3/4	2 1/4	C
CSF143140	3 1/4	2 1/4	D
CSF143340	3 3/4	2 1/4	E
CSF144000	4	2 1/4	F
CSF145000	5	2 1/4	H
CSF146000	6	2 1/4	J

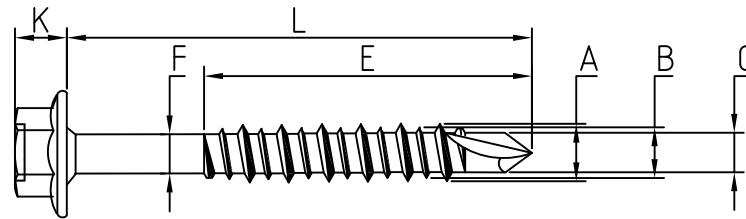
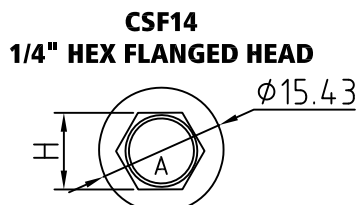

CSH141340	1 3/4	1 5/8	A
CSH142140	2 1/4	1 7/8	B
CSH142340	2 3/4	2 1/4	C
CSH143140	3 1/4	2 1/4	D
CSH143340	3 3/4	2 1/4	E
CSH144000	4	2 1/4	F
CSH145000	5	2 1/4	H
CSH146000	6	2 1/4	J

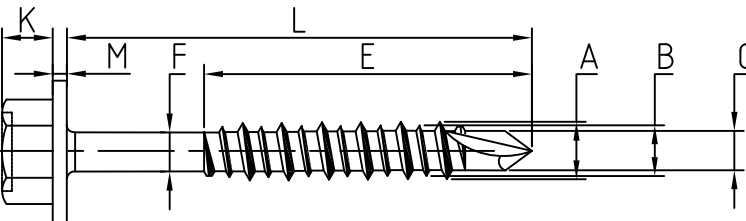
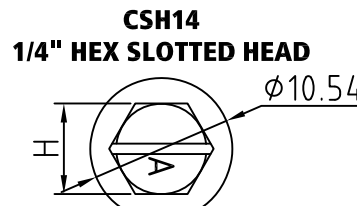

ITEM NO.	L	E	MARK
CSP316134	1 3/4	1 1/2	A
CSP316214	2 1/4	1 7/8	B
CSP316234	2 3/4	2 1/4	C
CSP316314	3 1/4	2 1/4	D
CSP316334	3 3/4	2 1/4	E
CSP316400	4	2 1/4	F

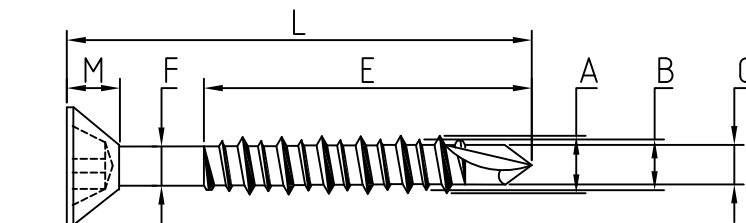

CSH316134	1 3/4	1 5/8	A
CSH316214	2 1/4	1 7/8	B
CSH316234	2 3/4	2 1/4	C
CSH316314	3 1/4	2 1/4	D
CSH316334	3 3/4	2 1/4	E
CSH316400	4	2 1/4	F

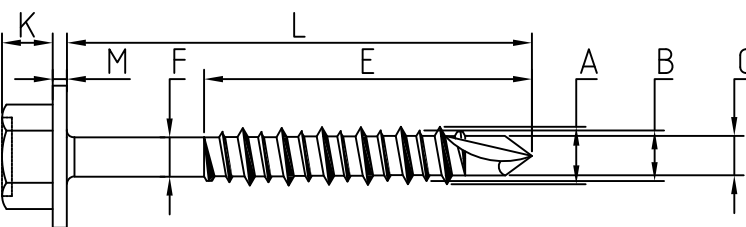
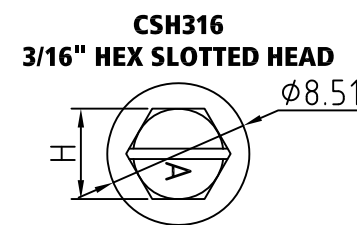

COMPLIANCE SUMMARY

CODE: 2020 FBC COMPLIANT

HVHZ: HVHZ COMPLIANT

CORROSION RESISTANT:

ASTM G 85, ANNEX 5,
140 CYCLES
(TAS 114, APPENDIX E)

MATERIALS: SAE 1022 OR EQUIVALENT

SCREW STRENGTH: 3/16 fut 145,000 psi
fy 116,000 psi
1/4 fut 165,000 psi
fy 132,000 psi

COATING: SealProT/SealProACQ

COLOR: BLUE, WHITE, BRONZE
OR SILVER

MFG ID: Δ (DELTA)

SLOTTED HI THREAD

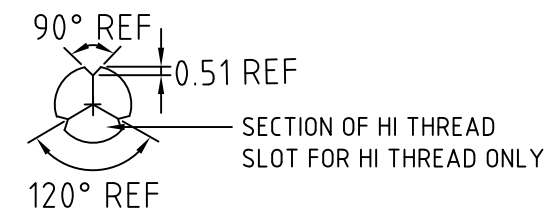

DIMENSIONS - CONSET

mm	CSP14	CST14	CSF14	CSH14	CSP 316	CSH 316
A	6.35	6.35	6.35	6.35	5.34	5.34
B	4.96	4.96	4.96	4.96	4.08	4.08
C	4.32	4.32	4.32	4.32	3.20	3.20
F	4.74	4.74	4.74	4.74	3.71	3.71
M	5.74 MAX	4.80 MAX	/	0.86	4.67 MAX	0.72
H	/	/	7.84	7.81	/	6.25
K	/	/	5.97	3.81	/	2.62



1 Gunnebo Drive
Lonoke, Arkansas 72086

MKT® CONSET®
Concrete Masonry
Screws
for Concrete and Masonry

REVISIONS

REV	DATE	BY
-----	------	----

PRODUCT APPROVED
as complying with the Florida
Building Code

NOA-No. 22-0412.04

Approval Date 06/16/2022

By *[Signature]*
Miami-Dade Product Control



THIRD ANGLE
PROJECTION

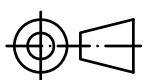

PREPARED BY

SIMON LAW

SCALE -

SHEET 1/2

REV 0 DATE JAN 10 2022

DWG NO CNST-MD-22-0412_01

MKT Fastening, LLC

MKT® CONSET® Concrete Masonry Screws for CONCRETE and MASONRY with SealProT or SealProACQ Coating

CONCRETE (f'c = 3,270 psi) SUBSTRATE					
ALLOWABLE CAPACITIES PER ANCHOR					
ANCHOR DIAMETER	MINIMUM EMBEDMENT	MINIMUM SPACING	MINIMUM EDGE DISTANCE	TENSION	SHEAR
	INS.	INS.	INS.	LBS.	LBS.
3/16	1 3/4	1	1 1/4	396	159
	2	1	1 1/4	448	
1/4	1 3/4	1 1/4	1 1/4	534	348
	2	1 1/4	1 1/4	701	

MASONRY SUBSTRATE - GROUT FILLED (1,500 psi)							
ALLOWABLE CAPACITIES PER ANCHOR							
ANCHOR DIAMETER	LOCATION	MINIMUM EMBEDMENT	MINIMUM SPACING	MINIMUM EDGE DISTANCE	MINIMUM END DISTANCE	TENSION	SHEAR
		INS.	INS.	INS.	INS.	LBS.	LBS.
3/16	TOP GROUT	1 1/2	3	3	3	180	136
		1 1/2	3	1 1/2	3	156	116
	FACE SHELL	1 1/2	3	3	3	104	127
	FACE WEB	1 1/2	3	3	3	123	133
1/4	TOP GROUT	1 1/2	4	4	4	280	228
		1 1/2	4	1 1/2	4	218	235
	FACE SHELL	1 1/2	4	4	4	164	320
	FACE WEB	1 1/2	4	4	4	187	273

NOTES

1. ANCHORS SHALL BE INSTALLED IN ACCORDANCE WITH MANUFACTURERS' RECOMMENDATION;
2. ANCHOR EMBEDMENT AND EDGE DISTANCE EXCLUDES STUCCO, FOAM, BRICK AND OTHER WALL FINISHES;
3. ALLOWABLE DESIGN LOAD CAPACITIES ARE BASED ON ULTIMATE LOAD DIVIDED BY SAFETY FACTOR AS FOLLOWS:
4. CONCRETE: 4
MASONRY: 5
5. SUBSTRATES SHALL CONFORM TO:
CONCRETE: ACI 318
MASONRY: ASTM C-90
6. ANCHORS SHALL NOT BE INSTALLED INTO CRACKED CONCRETE AS DEFINED IN ACI 355.2
7. THIS PRODUCT EVALUATION DOCUMENT IS GENERIC AND DOES NOT PROVIDE INFORMATION FOR A SPECIFIC SITE. FOR SITE CONDITIONS DIFFERENT FROM THE CONDITIONS DETAILED HEREIN, A LICENSED PROFESSIONAL ENGINEER OR REGISTERED ARCHITECT SHALL PREPARE SITE-SPECIFIC DOCUMENTS FOR USE IN CONJUNCTION WITH THE APPROVAL AND APPLY FOR MIAMI-DADE COUNTY PRODUCT CONTROL ONE-TIME NOTICE OF ACCEPTANCE.
8. PILOT HOLE:

SIZE

3/16"

1/4"

BIT SIZE

5/32" TYP

3/16" TYP

HOLE DEPTH

EMBEDMENT+1/4"

EMBEDMENT+1/4"

PRODUCT APPROVED
as complying with the Florida
Building Code
NOA-No. 22-0412.04
Approval Date 06/16/2022
By 
Miami-Dade Product Control



MKT® CONSET®
Concrete Masonry
Screws
for Concrete and Masonry

REVISIONS

REV	DATE	BY
-----	------	----

THIRD ANGLE
PROJECTION

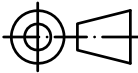

PREPARED BY

SIMON LAW

SCALE

-

SHEET

2/2

REV

0

DATE

JAN 10 2022

DWG NO

CNST-MD-22-0412_01