



DEPARTMENT OF REGULATORY AND ECONOMIC RESOURCES (RER)
BOARD AND CODE ADMINISTRATION DIVISION

NOTICE OF ACCEPTANCE (NOA)

MIAMI-DADE COUNTY
PRODUCT CONTROL SECTION

11805 SW 26 Street, Room 208
Miami, Florida 33175-2474
T (786) 315-2590 F (786) 315-2599

www.miamidade.gov/economy

PlyGem Resid. Solut, div of Cornerstone Bldg. Brands
2415 Campbell Road
Sidney, OH 45365

SCOPE: This NOA is being issued under the applicable rules and regulations governing the use of construction materials. The documentation submitted has been reviewed and accepted by Miami-Dade County RER-Product Control Section to be used in Miami Dade County and other areas where allowed by the Authority Having Jurisdiction (AHJ).

This NOA shall not be valid after the expiration date stated below. The Miami-Dade County Product Control Section (In Miami Dade County) and/or the AHJ (in areas other than Miami Dade County) reserve the right to have this product or material tested for quality assurance purposes. If this product or material fails to perform in the accepted manner, the manufacturer will incur the expense of such testing and the AHJ may immediately revoke, modify, or suspend the use of such product or material within their jurisdiction. RER reserves the right to revoke this acceptance if it is determined by Miami-Dade County Product Control Section that this product or material fails to meet the requirements of the applicable building code.

This product is approved as described herein and has been designed to comply with the Florida Building Code, including the High Velocity Hurricane Zone.

DESCRIPTION: Georgia Pacific and TrueWall Vinyl Siding and Vented Soffit

APPROVAL DOCUMENT: Drawing No. **PGRS002**, titled "Georgia Pacific and TrueWall Vinyl Siding and Vented Soffit", sheets 1 and 3 of 3, dated 08/30/2022, prepared by Building Drops, Inc., signed and sealed by Hermes F. Norero, P.E. on 10/24/2022, bearing the Miami-Dade County Product Control revision stamp with the Notice of Acceptance number and expiration date by the Miami-Dade County Product Control Section.

MISSILE IMPACT RATING: Large and Small Missile Impact Resistant

LABELING: Each piece shall bear a permanent label marked at not more than 4' o.c. with the manufacturer's name or logo, city, state, and following statement: "Miami-Dade County Product Control Approved" and per FBC 1709.10.2 and 1709.10.3 on Soffits.

RENEWAL of this NOA shall be considered after a renewal application has been filed and there has been no change in the applicable building code negatively affecting the performance of this product.

TERMINATION of this NOA will occur after the expiration date or if there has been a revision or change in the materials, use, and/or manufacture of the product or process. Misuse of this NOA as an endorsement of any product, for sales, advertising or any other purposes shall automatically terminate this NOA. Failure to comply with any section of this NOA shall be cause for termination and removal of NOA.

ADVERTISEMENT: The NOA number preceded by the words Miami-Dade County, Florida, and followed by the expiration date may be displayed in advertising literature. If any portion of the NOA is displayed, then it shall be done in its entirety.

INSPECTION: A copy of this entire NOA shall be provided to the user by the manufacturer or its distributors and shall be available for inspection at the job site at the request of the Building Official.

This NOA **renew** and **revises** NOA # **21-1109.03** and consists of this page 1 and evidence pages E-1, E-2, E-3 and E-4, as well as approval document mentioned above.

The submitted documentation was reviewed by **Carlos M. Utrera, P.E.**



NOA No. 22-0908.04
Expiration Date: October 31, 2027
Approval Date: November 17, 2022
Page 1

NOTICE OF ACCEPTANCE: EVIDENCE SUBMITTED

1. Evidence submitted under previous NOA's

A. DRAWINGS

1. Drawing No. **12-0829.13**, titled "Installation Design Drawing for Vinyl Siding/Soffit", sheets 1 and 2 of 2, dated 01/25/2013, prepared by the manufacturer, signed and sealed by Allen N. Reeves, P.E. on 10/27/2017.

B. TESTS "*Submitted under NOA # 03-1017.01*"

- | | Laboratory Report | Test | Date | Signature |
|----|--|---------------|-------------|------------------|
| 1. | 01-44749.02 | TAS 202 & 203 | 03/10/04 | J. A. Reed, P.E. |
| 2. | 01-44739.02 | TAS 202 & 203 | 03/10/04 | J. A. Reed, P.E. |
| 3. | 01-44750.02 | TAS 202 & 203 | 03/10/04 | J. A. Reed, P.E. |
| 4. | 50437.01-106-18 | ASTM G155 | 12/06/04 | J. A. Reed, P.E. |
| 5. | 50437.01-106-18 | ASTM D638 | 12/06/04 | J. A. Reed, P.E. |
| 6. | Test reports on 1) Uniform Static Air Pressure Test, Loading per FBC TAS 202-94
2) Cyclic Wind Pressure Loading per FBC, TAS 203-94
along with marked-up drawings and installation diagram of Variform Contractors Choice D5 Vinyl Siding, prepared by Intertek/ATI, Test Report No. " <i>Submitted under NOA #17-1107.06</i> " H5091.01-109-18 , dated 11/29/2017, signed and sealed by Joseph A. Reed, P.E. | | | |
| 7. | Test reports on 1) Uniform Static Air Pressure Test, Loading per FBC TAS 202-94
2) Cyclic Wind Pressure Loading per FBC, TAS 203-94
along with marked-up drawings and installation diagram of Variform Model 145 Standard Double 5 Vinyl Soffit, prepared by Intertek/ATI, Test Report No. H5171.01-109-18 , dated 10/31/2017, signed and sealed by Joseph A. Reed, P.E.
" <i>Submitted under NOA # 18-0808.01</i> " | | | |
| 8. | Test report on Wind Driven Rain Resistance Test per FBC TAS 100(A)-95 of the Triple 3-1/3" perforated soffit, prepared by Intertek/ATI, Test Report No. G8989.01-109-18 , dated 02/14/2018, signed and sealed by Joseph A. Reed, P.E. | | | |

C. CALCULATIONS

1. None.

D. QUALITY ASSURANCE

1. Miami-Dade Department of Regulatory and Economic Resources (RER).

E. MATERIAL CERTIFICATIONS

1. None.

F. STATEMENTS

1. Private label agreement letter dated 08/14/2002.
2. Statement letter of code conformance to the 6th edition (2017) FBC and of no financial interest issued by H.R. Engineering, Inc., dated 06/25/2018, signed and sealed by Allen N. Reeves, P.E.



Carlos M. Utrera, P.E.
Product Control Examiner
NOA No. 22-0908.04
Expiration Date: October 31, 2027
Approval Date: November 17, 2022

NOTICE OF ACCEPTANCE: EVIDENCE SUBMITTED

2. Evidence submitted under NOA # 19-0606.01

A. DRAWINGS

1. Drawing No. **12-0829.13**, titled “Installation Design Drawing for Vinyl Siding/Soffit”, sheets 1 thru 4 of 4, dated 04/15/2019, prepared by the manufacturer, signed and sealed by Allen N. Reeves, P.E. on 10/24/2019 and 01/29/2020.

B. TESTS

1. None.

C. CALCULATIONS

1. Calculation titled “Installation Analysis of Vinyl Siding”, sheets 1 thru 6 of 6 and “Installation Analysis of Vinyl Soffit”, sheets 1 thru 5 of 5, dated 03/25/2019, signed and sealed by Allen N. Reeves, P.E. on 04/17/2019.

D. QUALITY ASSURANCE

1. Miami-Dade Department of Regulatory and Economic Resources (RER).

E. MATERIAL CERTIFICATIONS

1. None.

F. STATEMENTS

1. Statement letter of code conformance to the 6th edition (2017) FBC and of no financial interest issued by H.R. Engineering, Inc., dated 04/11/2019, signed and sealed by Allen N. Reeves, P.E.

G. OTHERS

1. Notice of Acceptance No. **18-0808.02**, issued to **Georgia Pacific, Div. of Ply Gem Industries, Inc.** for **Georgia Pacific Vinyl Siding and Vented Soffit**”, approved on 09/20/2018 and expiring on 10/31/2022.



Carlos M. Utrera, P.E.
Product Control Examiner
NOA No. 22-0908.04
Expiration Date: October 31, 2027
Approval Date: November 17, 2022

NOTICE OF ACCEPTANCE: EVIDENCE SUBMITTED

3. Evidence submitted under NOA # 21-1109.03

A. DRAWINGS

1. Drawing No. **12-0829.13**, titled "Installation Design Drawing for Vinyl Siding/Soffit", sheets 1 thru 4 of 4, dated 04/15/2019, prepared by the manufacturer, signed and sealed by Allen N. Reeves, P.E. on 01/27/2022.

B. TESTS

1. None.

C. CALCULATIONS

1. Calculation titled "Installation Analysis of Vinyl Siding", sheets 1 thru 6 of 6, prepared by HR Engineering, Inc., dated 01/18/2022, signed and sealed by Allen N. Reeves, P.E.

D. QUALITY ASSURANCE

1. Miami-Dade Department of Regulatory and Economic Resources (RER).

E. MATERIAL CERTIFICATIONS

1. None.

F. STATEMENTS

1. Statement letter of code conformance to the 7th edition (2020) of the FBC issued by H.R. Engineering, Inc., dated 10/14/2021, signed and sealed by Allen N. Reeves, P.E.
2. Statement letter of no financial interest issued by H.R. Engineering, Inc., dated 10/14/2021, signed and sealed by Allen N. Reeves, P.E.



Carlos M. Utrera, P.E.
Product Control Examiner
NOA No. 22-0908.04
Expiration Date: October 31, 2027
Approval Date: November 17, 2022

NOTICE OF ACCEPTANCE: EVIDENCE SUBMITTED

4. New evidence submitted

A. DRAWINGS

1. Drawing No. **PGRS002**, titled “Georgia Pacific and TrueWall Vinyl Siding and Vented Soffit”, sheets 1 and 3 of 3, dated 08/30/2022, prepared by Building Drops, Inc., signed and sealed by Hermes F. Norero, P.E. on 10/24/2022.

B. TESTS

1. None.

C. CALCULATIONS

1. Anchor calculations prepared by Building Drops, Inc., dated 10/10/2022, signed and sealed by Hermes F. Norero, P.E.

D. QUALITY ASSURANCE

1. Miami-Dade Department of Regulatory and Economic Resources (RER).

E. MATERIAL CERTIFICATIONS

1. None.

F. STATEMENTS

1. Statement letter of code conformance to the 7th edition (2020) of the FBC and of no financial interest, issued by Building Drops, Inc., dated 10/10/2022, signed and sealed by Hermes F. Norero, P.E.



Carlos M. Utrera, P.E.
Product Control Examiner
NOA No. 22-0908.04
Expiration Date: October 31, 2027
Approval Date: November 17, 2022

PLY GEM RESIDENTIAL SOLUTIONS
GEORGIA PACIFIC AND TRUE WALL VINYL SIDING
AND VENTED SOFFIT PRODUCTS

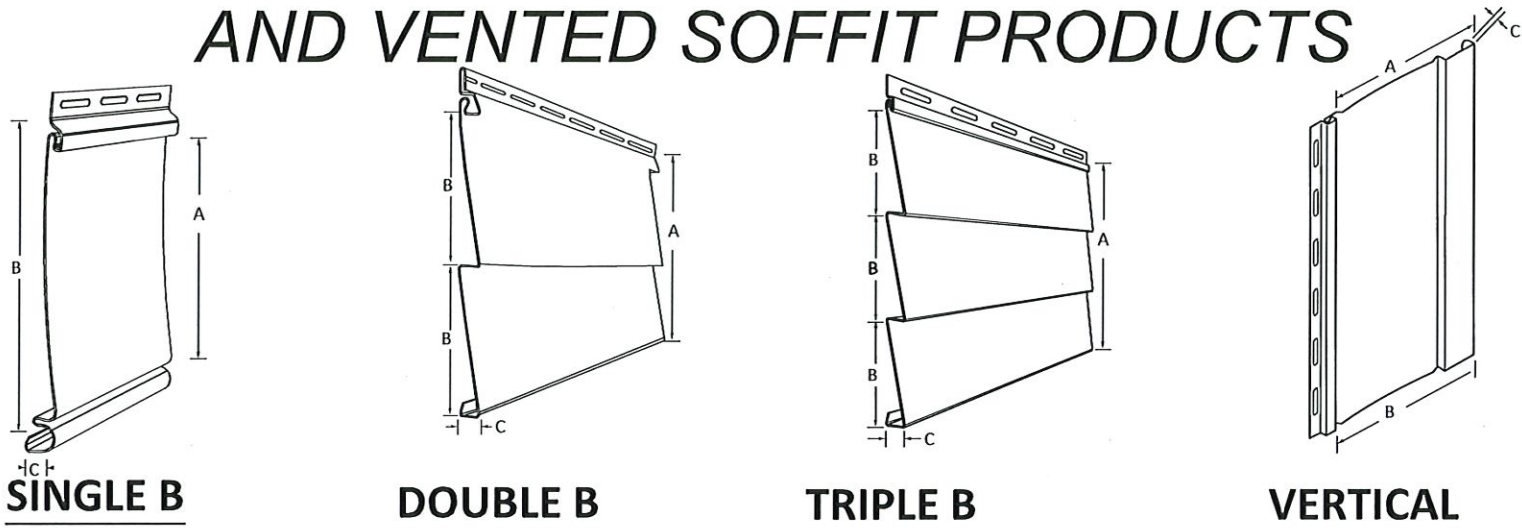

SIDING DESIGN PRESSURE TABLE:

APPROVED MODELS	CONFIGURATION	EXPOSURE "A" (IN)	B (IN)	C (IN)	NAIL SPACING	THICKNESS ~.001 (IN)	DESIGN PRESSURE (PSF)
Parkside	Double 5"	10"	5	1/2	8"h x 10"v	0.038	-68.75
Forest Ridge	Double 5"	10"	5	1/2	8"h x 10"v	0.042	-68.75
Vision Pro	Double 5"	10"	5	1/2	8"h x 10"v	0.04	-68.75
Parkside	Double 5" DL	10"	5	1/2	8"h x 10"v	0.038	-68.75
Vision Pro	Double 5" DL	10"	3 1/3	1/2	8"h x 10"v	0.04	-68.75
ShadowRidge	Double 5" DL	10"	5	1/2	8"h x 10"v	0.042	-68.75
Parkside	Triple 3 1/3"	10"	5	1/2	8"h x 10"v	0.038	-68.75
True Wall Series 4000	Double 5"	10"	5	1/2	8"h x 10"v	0.04	-68.75
True Wall Series 4000	Double 5" DL	10"	5	1/2	8"h x 10"v	0.04	-68.75
True Wall Series 3800	Double 5"	10"	5	1/2	8"h x 10"v	0.036	-68.75
True Wall Series 3800	Double 5" DL	10"	5	1/2	8"h x 10"v	0.036	-68.75
True Wall Series 4200	Double 5"	10"	5	1/2	8"h x 10"v	0.042	-68.75
True Wall Series 4200	Double 5" DL	10"	5	1/2	8"h x 10"v	0.042	-68.75
True Wall Series 4400	Double 5"	10"	5	1/2	8"h x 10"v	0.044	-68.75
True Wall Series 4010	Double 5" DL	10"	5	1/2	8"h x 10"v	0.04	-68.75
Parkside	Double 4"	8"	4	1/2	8"h x 8"v	0.038	-85.93
Forest Ridge	Double 4"	8"	4	1/2	8"h x 8"v	0.042	-85.93
Vision Pro	Double 4"	8"	4	1/2	8"h x 8"v	0.04	-85.93
Parkside	Double 4" DL	8"	4	1/2	8"h x 8"v	0.038	-85.93
Vision Pro	Double 4" DL	8"	4	1/2	8"h x 8"v	0.04	-85.93
ShadowRidge	Double 4" DL	8"	4	1/2	8"h x 8"v	0.042	-85.93
True Wall Series 3800	Double 4"	8"	4	1/2	8"h x 8"v	0.038	-85.93
True Wall Series 3800	Double 4" DL	8"	4	1/2	8"h x 8"v	0.038	-85.93
True Wall Series 4000	Double 4"	8"	4	1/2	8"h x 8"v	0.04	-85.93
True Wall Series 4000	Double 4" DL	8"	4	1/2	8"h x 8"v	0.04	-85.93
True Wall Series 4400	Double 4"	8"	4	1/2	8"h x 8"v	0.044	-85.93
True Wall Series 4010	Double 4" DL	8"	4	1/2	8"h x 8"v	0.04	-85.93
True Wall Series 4200	Double 4"	8"	4	1/2	8"h x 8"v	0.042	-85.93
True Wall Series 4200	Double 4" DL	8"	4	1/2	8"h x 8"v	0.042	-85.93
CastleRidge	Single 8"	8"	8	3/4	8"h x 8"v	0.044	-85.93
Parkside	Double 4 1/2"	9"	4.5	1/2	8"h x 9"v	0.038	-76.38
ChathamRidge	Triple 3"	9"	3	1/2	8"h x 9"v	0.04	-76.38
True Wall Series 3800	Double 4 1/2" DL	9"	4.5	1/2	8"h x 9"v	0.038	-76.38
True Wall Series 4400	Double 4 1/2" DL	9"	4.5	1/2	8"h x 9"v	0.044	-76.38
True Wall Series 4010	Double 4 1/2" DL	9"	4.5	1/2	8"h x 9"v	0.04	-76.38
Board & Batten	Single 7"	7"	7	3/4	8"h x 7"v	0.048	-98.21
Somerset Beaded	Single 6 1/2"	6.5"	6.5	1/2	8"h x 6.5"v	0.044	-98.21
True Wall Series B&B	Single 7"	7"	7	3/4	8"h x 7"v	0.044	-98.21

NOTE:
1) A FACTOR OF SAFETY OF 1.5 HAS BEEN UTILIZED IN DETERMINING ALLOWABLE DESIGN PRESSURE.
2) THE PRESSURE EQUALIZATION FACTOR HAS BEEN USED IN THE DETERMINATION OF ALLOWABLE DESIGN PRESSURE IN ACCORDANCE WITH ASTM D 3679-09, APPENDIX A.

PRODUCT REVISED
as complying with the Florida
Building Code
NOA-No. 22-0908.04
Expiration Date 10/31/2027
By Miami-Dade Product Control

GENERAL NOTES

- 1. THE PRODUCT SHOWN HEREIN IS DESIGNED AND MANUFACTURED TO COMPLY WITH THE 7TH ED FLORIDA BUILDING CODE (FBC), INCLUDING HVHZ AND HAS BEEN EVALUATED ACCORDING TO THE FOLLOWING:
- ASTM D 3679
- TAS 202-94
- TAS 203-94
- ASTM G155
- ASTM D638
- 2. ADEQUACY OF THE EXISTING STRUCTURAL CONCRETE/MASONRY AND 2X FRAMING AS A MAIN WIND FORCE RESISTING SYSTEM CAPABLE OF WITHSTANDING AND TRANSFERRING APPLIED PRODUCT LOADS TO THE FOUNDATION IS THE RESPONSIBILITY OF THE ENGINEER OR ARCHITECT OF RECORD FOR THE PROJECT OF INSTALLATION.
- 3. VINYL SIDING MEETS THE REQUIREMENTS OF CHAPTER 14 OF THE FLORIDA BUILDING CODE.
- 4. VINYL SIDING SPECIFICATIONS:
- SIDING MATERIAL: PVC (PER ASTM D 3679)
- MINIMUM WALL THICKNESS: 0.040"
- REFER TO DESIGN PRESSURE TABLE, SHEET 2 FOR ALLOWABLE DESIGN PRESSURES.
- 5. VARIFORM, INC. VINYL SIDING & SOFFIT PRODUCTS ARE MFG. FROM A FORMULATED PVC COMPOUND MEETING OR EXCEEDING THE REQUIREMENTS OF ASTM D 3679 STD. FOR PVC SIDING AND COMPOUNDS.
- 6. WALLS AND SOFFIT TO RECEIVE VINYL SIDING / SOFFIT SHALL BE CHECKED FOR STRUCTURAL ADEQUACY, CRACKS AND DEFECTS THAT SHALL BE ELIMINATED.
- 7. WALLS & SOFFIT WHERE THE SIDING / SOFFIT ARE TO BE INSTALLED SHALL BE DESIGNED BY A REGISTERED ARCHITECT OR ENGINEER BY A REGISTERED ARCHITECT OR ENGINEER ACCODING TO THE FBC AND THE MINIMUM REQUIREMENTS OF THIS DRAWING.
- 8. INSTALLATION OF THE SIDING / SOFFIT AND ACCESSORY PRODUCTS SHALL BE DONE IN ACCORDANCE WITH THE MANUFACTURER'S INSTRUCTIONS AND THE APPLICABLE SECTIONS OF THE FBC.
- 9. WALLS SHALL BE WATERPROOFED WITH ASPHALT SATURATED FELT OF NOT LESS THAN 15 100 SQ. FT AS DESCRIBED IN SECTION 2121.6.2 OR 1404.2 OF THE FBC.



PlyGem Residential Solutions
303 W. Major
Kearney, MO 64060

TITLE: GEORGIA PACIFIC AND TRUE WALL VINYL SIDING AND VENTED SOFFIT
DESIGN PRESSURE TABLE & ISOMETRIC VIEWS
PREPARED BY: BUILDING DROPS, INC.
398 E. DANIA BEACH BLVD., STE. 338
DANIA BEACH, FL 33004
PH: (954)399-9478
FAX: (954)744-4738
WEB: www.buildingdrops.com

REMARKS	BY	DATE

THE INSTALLATION DETAILS DESCRIBED HEREIN ARE GENERIC AND MAY NOT REFLECT ACTUAL CONDITIONS FOR A SPECIFIC SITE. IF SITE CONDITIONS CAUSE INSTALLATION TO DEVIATE FROM THE REQUIREMENTS DETAILED HEREIN, A LICENSED ENGINEER OR ARCHITECT SHALL PREPARE SITE SPECIFIC DOCUMENTS FOR USE WITH THIS DOCUMENT.

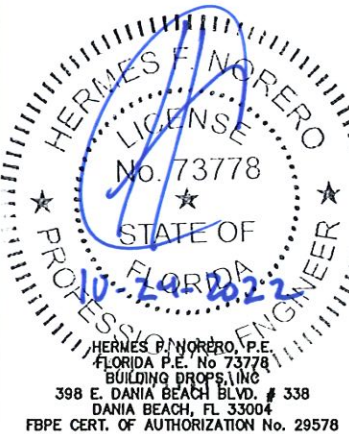

DATE: 08.30.22
DWG. BY: DI
CHK. BY: HFN
SCALE: NTS
DWG. #: PGRS002
SHEET: 1

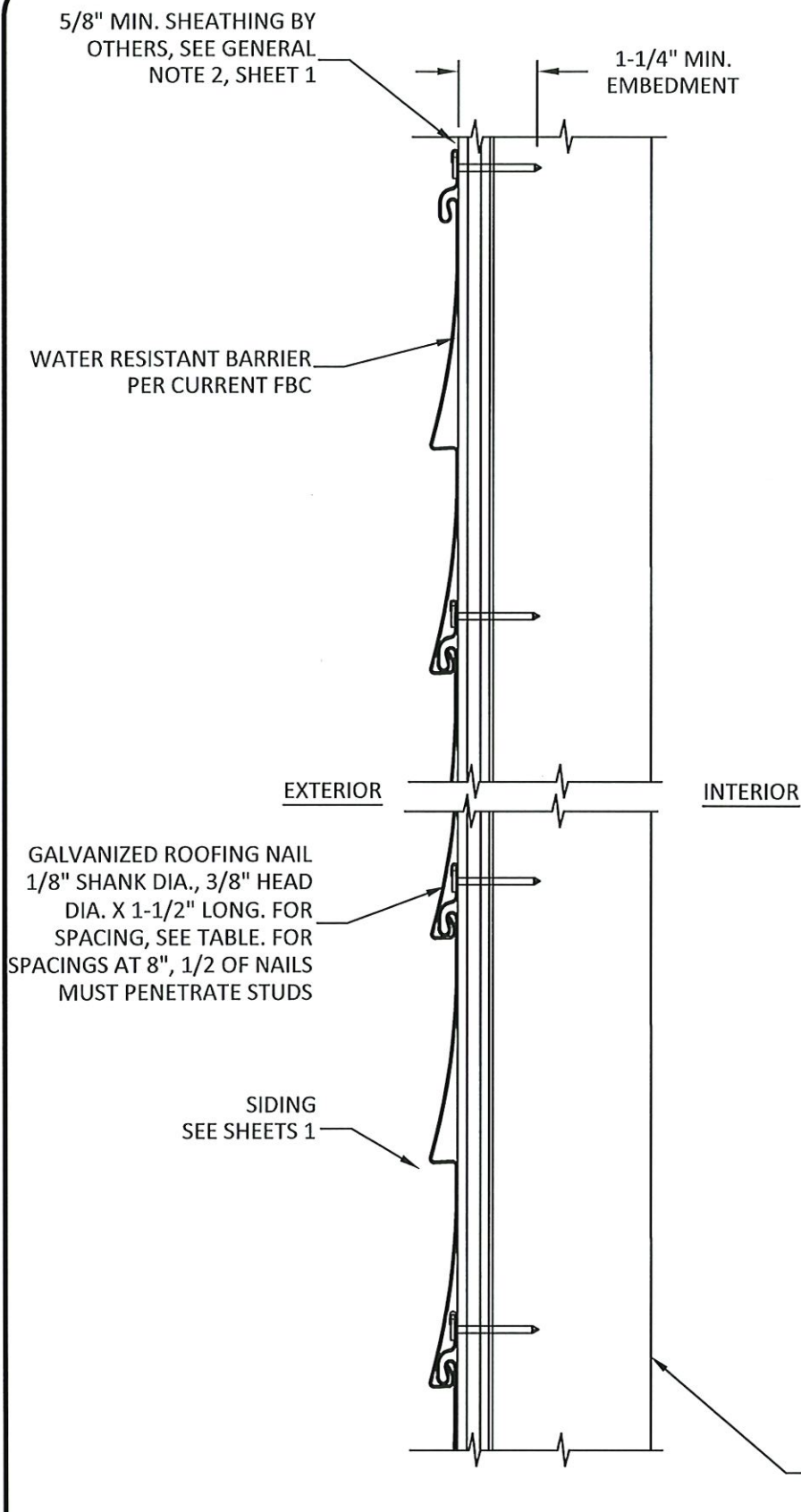

SIDING INSTALLATION DETAIL
5/8" SHEATHING OVER 2X WOOD FRAMING

INSTALLATION NOTES:

- ONE (1) INSTALLATION FASTENER IS REQUIRED AT EACH ANCHOR LOCATION SHOWN.
- INSTALLATION FASTENERS ARE 1 1/2" LONG WITH 1/8" DIAMETER SHANKS AND 3/8" DIAMETER HEADS GALVANIZED STEEL ROOFING NAILS.
- INSTALLATION FASTENERS SHALL BE LISTED AND SPACED AS SHOWN ON DETAILS. FASTENERS EMBEDMENT TO BASE MATERIAL SHALL BE BYOND WALL DRESSING.
- INSTALLATION FASTENERS AND ASSOCIATED HARDWARE MUST BE MADE OF CORROSION RESISTANT MATERIAL OR HAVE A CORROSION RESISTANT COATING.
- INSTALLATION FASTENERS SHALL BE INSTALLED IN ACCORDANCE WITH ANCHOR MANUFACTURER'S INSTALLATION INSTRUCTIONS, AND FASTENERS SHALL NOT BE USED IN SUBSTRATES WITH STRENGTHS LESS THAN THE MINIMUM STRENGTH SPECIFIED BY THE ANCHOR MANUFACTURER.
- INSTALLATION ANCHOR CAPACITIES FOR PRODUCTS HEREIN ARE BASED ON SUBSTRATE MATERIALS WITH THE FOLLOWING PROPERTIES:
 - WOOD - MINIMUM SPECIFIC GRAVITY OF 0.55.

FURRING INSTALLATION NOTES:

- 2 X 3 WOOD FURRING STRIPS NO. 2 MIXED SOUTHERN PINE OR BETTER. PLACE VERTICALLY. SPACING TO MATCH HORIZONTAL SPACING IN TABLE.
- INSTALL FURRING STRIPS INTO MASONRY WALL USING 3/16" ITW TAPCONS WITH MINIMUM 1-1/4" EMBEDMENT.
- TAPCON SPACING 8" MAX WHEN FURRING IS AT 12" AND TAPCON SPACING 6" MAX WHEN FURRING IS AT 8".

PRODUCT REVISED
as complying with the Florida
Building Code
NOA-No. 22-0908.04
Expiration Date 10/31/2027
By *[Signature]*
Miami-Dade Product Control

GALVANIZED ROOFING NAIL
1/8" SHANK DIA., 3/8" HEAD
DIA. X 1-1/2" LONG. FOR
SPACING, SEE TABLE. FOR
SPACINGS AT 8", 1/2 OF NAILS
MUST PENETRATE STUDS

2X FURRING STRIP
SEE FURING INSTALL NOTES

SIDING
SEE SHEETS 1

FURRING STRIP ANCHOR
3/16" ITW TAPCON
SEE FURING INSTALL NOTES,
SHEET 2

MASONRY/CONCRETE BY
OTHERS
SEE GENERAL NOTE 2,
SHEET 1

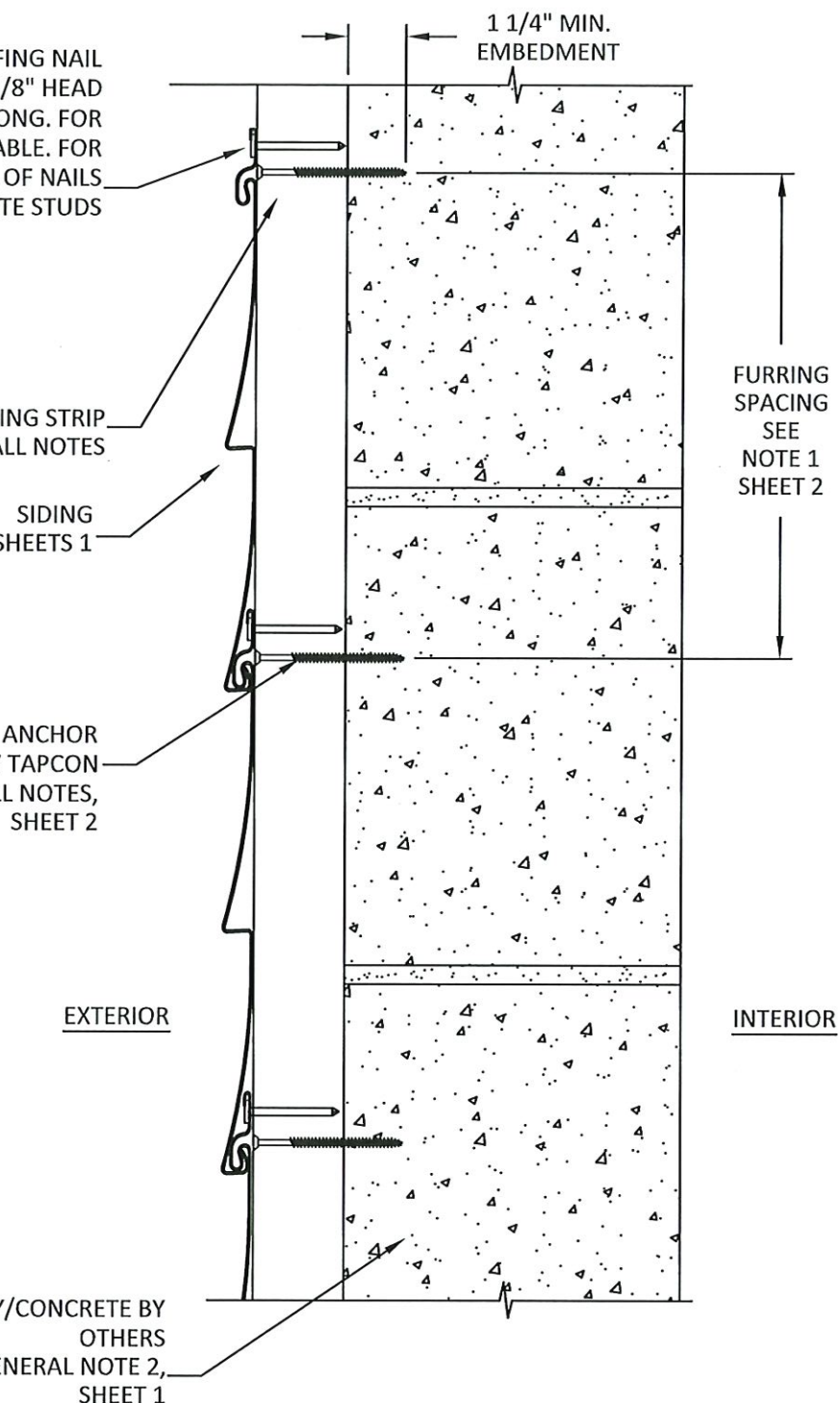

SIDING INSTALLATION DETAIL
2X FURRING STRIP OVER MASONRY/CONCRETE WALL



PlyGem Residential Solutions
303 W. Major
Kearney, MO 64060

TITLE:
GEORGIA PACIFIC AND TRUE WALL
VINYL SIDING AND VENTED SOFFIT

INSTALLATION NOTES

PREPARED BY:
BUILDING DROPS, INC.
398 E. DANIA BEACH BLVD., STE. 338
DANIA BEACH, FL 33004
PH: (954) 995-8478
FAX: (954) 744-4738
WEB: www.buildingdrops.com



REMARKS	BY	DATE

THE INSTALLATION DETAILS DESCRIBED HEREIN ARE GENERIC AND MAY NOT REFLECT ACTUAL CONDITIONS FOR A SPECIFIC SITE. IF SITE CONDITIONS CAUSE INSTALLATION TO DEVIATE FROM THE REQUIREMENTS DETAILED HEREIN, A LICENSED ENGINEER OR ARCHITECT SHALL PREPARE SITE SPECIFIC DOCUMENTS FOR USE WITH THIS DOCUMENT.

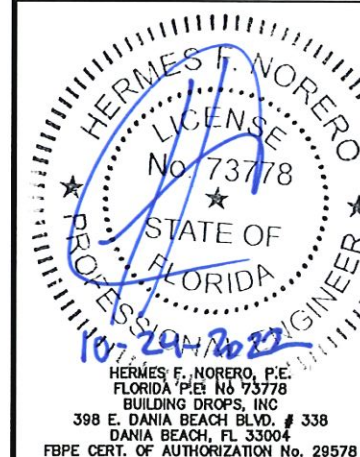

DATE: 08.30.22

DWG. BY: DI CHK. BY: HFN

SCALE: NTS

DWG. #: PGRS002

SHEET:

2

OF 3

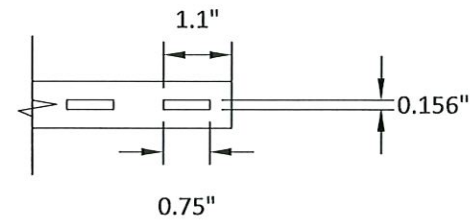
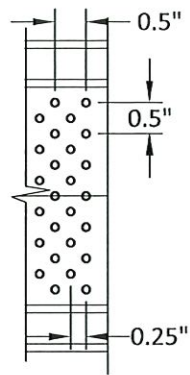

B 3 HORIZONTAL PLAN

VENT HOLD PATTERN
VINYL

C 3 HORIZONTAL PLAN

HIDDEN VENT - 134
VINYL

SOFFIT DESIGN PRESSURE TABLE:

APPROVED MODELS	PANEL CONFIGURATION	EXPOSURE (IN)	TYPICAL THICKNESS	DESIGN PRESSURE (PSF)	NET FREE AREA (IN/FT ²)
				Nails 12" O.C.	
150	Triple 4"	12.00	0.035	+60.0 / -50.0	0.000
151	Triple 4"	12.00	0.035	+60.0 / -50.0	14.340
152	Triple 4"	12.00	0.035	+60.0 / -50.0	4.780
140	Double 5"	10.00	0.044	±60.0	0.000
141	Double 5"	10.00	0.044	±60.0	6.200
144	Double 5"	10.00	0.040	±60.0	0.000
145	Double 5"	10.00	0.040	±60.0	6.200
157	Beaded 7"	7.00	0.040	±85.7	0.000
158	Beaded 7"	7.00	0.040	±85.7	2.660
True Wall Series 9100	Triple 4"	12.00	0.035	+60.0 / -50.0	0.000
True Wall Series 9110	Triple 4"	12.00	0.035	+60.0 / -50.0	4.780
True Wall Series 9120	Triple 4"	12.00	0.035	+60.0 / -50.0	14.340
True Wall Series 9200	Double 5" Standard	10.00	0.040	±60.0	0.000
True Wall Series 9220	Double 5" Standard	10.00	0.040	±60.0	6.200
True Wall Series 9300	Double 5" Premium	10.00	0.044	±60.0	0.000
True Wall Series 9320	Double 5" Premium	10.00	0.044	±60.0	6.200

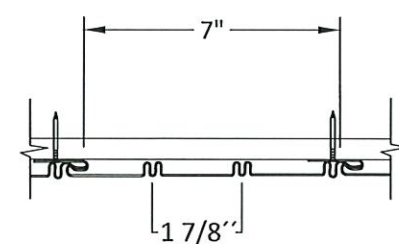
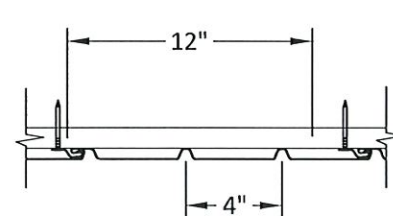
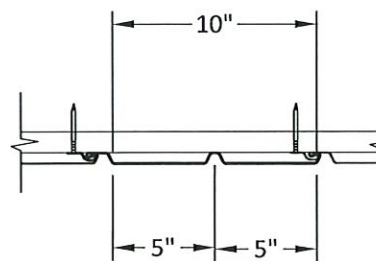
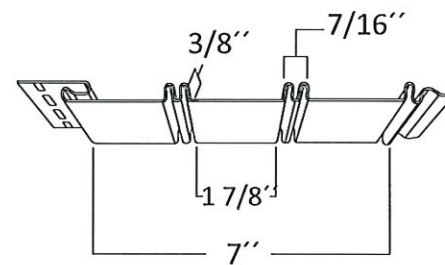
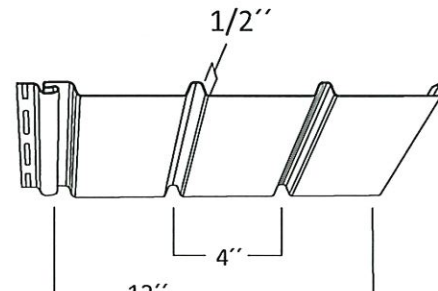
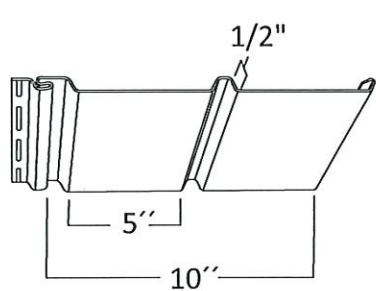

DOUBLE 5"

TRIPLE 4" &
TRIPLE 3-1/3"

BEADED 7"

PRODUCT REVISED
as complying with the Florida
Building Code
NOA-No. 22-0908.04
Expiration Date 10/31/2027
By *[Signature]*
Miami-Dade Product Control

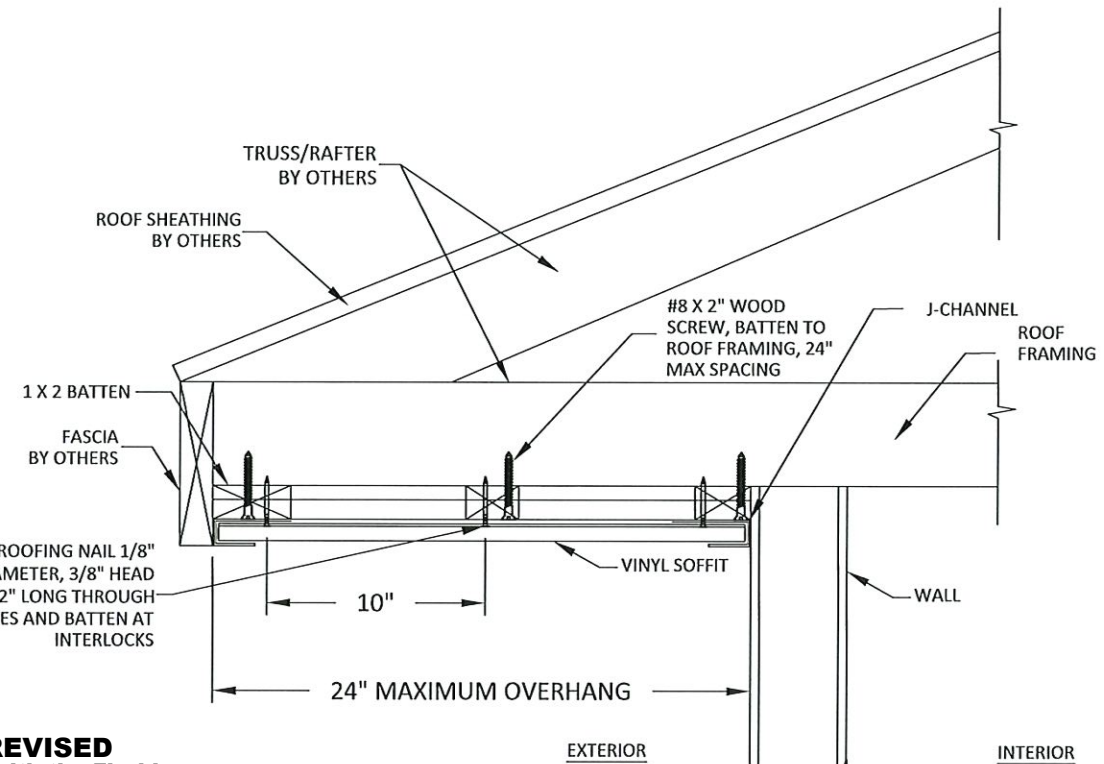

A 3 VERTICAL SECTION

SOFFIT INSTALLATION DETAIL
1 X 2 BATTEN

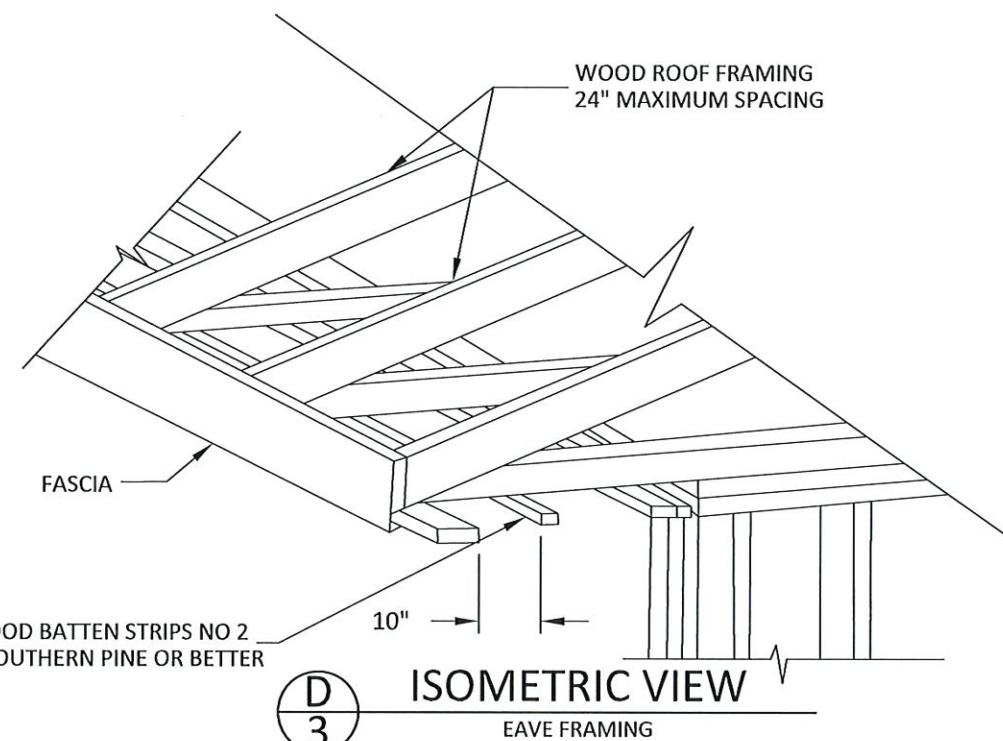

D 3 ISOMETRIC VIEW

EAVE FRAMING



PlyGem Residential Solutions
303 W. Major
Kearney, MO 64060

TITLE: GEORGIA PACIFIC AND TRUE WALL
VINYL SIDING AND VENTED SOFFIT

INSTALLATION NOTES

PREPARED BY:
BUILDING DROPS, INC.
398 E. DANIA BEACH BLVD., STE. 338
DANIA BEACH, FL 33004
PH: (954)395-8478
FAX: (954)744-4738
WEB: www.buildingdrops.com



REMARKS	BY	DATE

THE INSTALLATION DETAILS DESCRIBED HEREIN ARE GENERIC AND MAY NOT REFLECT ACTUAL CONDITIONS FOR A SPECIFIC SITE. IF SITE CONDITIONS CAUSE INSTALLATION TO DEVIATE FROM THE REQUIREMENTS DETAILED HEREIN, A LICENSED ENGINEER OR ARCHITECT SHALL PREPARE SITE SPECIFIC DOCUMENTS FOR USE WITH THIS DOCUMENT.

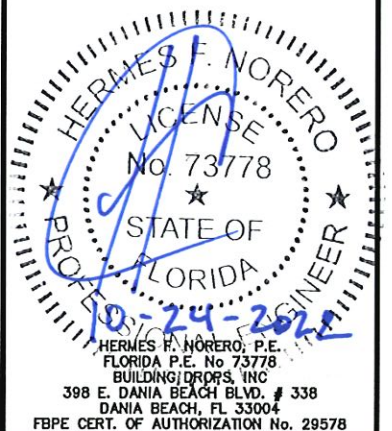

DATE:	08.30.22
DWG. BY:	DI
CHK. BY:	HFN
SCALE:	NTS
DWG. #:	PGRS002
SHEET:	3