



DEPARTMENT OF REGULATORY AND ECONOMIC RESOURCES (RER)
BOARD AND CODE ADMINISTRATION DIVISION

NOTICE OF ACCEPTANCE (NOA)

MIAMI-DADE COUNTY
PRODUCT CONTROL SECTION
11805 SW 26 Street, Room 208
Miami, Florida 33175-2474
T (786) 315-2590 F (786) 315-2599
www.miamidade.gov/economy

Antonio Afonso S.L.
El Timple, s/n. 38437 Icon De Los Vinos
Santa Cruz De Tenerife, Spain

SCOPE:

This NOA is being issued under the applicable rules and regulations governing the use of construction materials. The documentation submitted has been reviewed and accepted by Miami-Dade County RER-Product Control Section to be used in Miami Dade County and other areas where allowed by the Authority Having Jurisdiction (AHJ).

This NOA shall not be valid after the expiration date stated below. The Miami-Dade County Product Control Section (In Miami Dade County) and/or the AHJ (in areas other than Miami Dade County) reserve the right to have this product or material tested for quality assurance purposes. If this product or material fails to perform in the accepted manner, the manufacturer will incur the expense of such testing and the AHJ may immediately revoke, modify, or suspend the use of such product or material within their jurisdiction. RER reserves the right to revoke this acceptance if it is determined by Miami-Dade County Product Control Section that this product or material fails to meet the requirements of the applicable building code.

This product is approved as described herein and has been designed to comply with the Florida Building Code, including the High Velocity Hurricane Zone.

DESCRIPTION: Glassydur Fiber Cement Siding Systems

APPROVAL DOCUMENT: Drawing No. **AD15-61**, titled "Glassydur Fiber Cement Siding", sheets 1 through 5 of 5, 08/15/2016, with revision 2 dated 09/28/2022, prepared by MCY Engineering, Inc., signed and sealed by Yiping Wang, P.E., bearing the Miami-Dade County Product Control revision stamp with the Notice of Acceptance number and expiration date by the Miami-Dade County Product Control Section.

MISSILE IMPACT RATING: Large and Small Missile Impact Resistant

LABELING: A permanent label with the manufacturer's name or logo, manufacturing plant's city and state, model/series, and the statement reading 'Miami-Dade County Product Control Approved' is to be located on each panel.

RENEWAL of this NOA shall be considered after a renewal application has been filed and there has been no change in the applicable building code negatively affecting the performance of this product.

TERMINATION of this NOA will occur after the expiration date or if there has been a revision or change in the materials, use, and/or manufacture of the product or process. Misuse of this NOA as an endorsement of any product, for sales, advertising or any other purposes shall automatically terminate this NOA. Failure to comply with any section of this NOA shall be cause for termination and removal of NOA.

ADVERTISEMENT: The NOA number preceded by the words Miami-Dade County, Florida, and followed by the expiration date may be displayed in advertising literature. If any portion of the NOA is displayed, then it shall be done in its entirety.

INSPECTION: A copy of this entire NOA shall be provided to the user by the manufacturer or its distributors and shall be available for inspection at the job site at the request of the Building Official.

This NOA **renews** and **revises** **NOA # 19-0326.11** and consists of this page 1, evidence pages E-1, E-2 and E-3, as well as approval document mentioned above.

The submitted documentation was reviewed by **Carlos M. Utrera, P.E.**



NOA No. 22-1004.01
Expiration Date: October 5, 2027
Approval Date: October 27, 2022
Page 1

NOTICE OF ACCEPTANCE: EVIDENCE SUBMITTED

1. Evidence submitted under previous NOA's

A. DRAWINGS “Submitted under NOA # 17-0426.07”

1. Drawing No. **AD15-61**, titled “Glassydur Fiber Cement Siding”, sheets 1 through 5 of 5, dated 08/15/2016, prepared by MCY Engineering, Inc., signed and sealed by Yiping Wang, P.E on 07/25/2017.

B. TESTS “Submitted under NOA # 17-0426.07”

1. Test reports on 1) Uniform Static Air Pressure Test, Loading per FBC TAS 202-94
2) Cyclic Wind Pressure Loading per FBC, TAS 203-94
along with marked-up drawings of Fiber Cement Siding Panels, model Altos, prepared by Hurricane Engineering & Testing, Inc., Test Report No. **HETI-15-5049A/B**, dated 04/24/2015, signed and sealed by Rafael E. Droz-Seda, P.E.
2. Test reports on 1) Uniform Static Air Pressure Test, Loading per FBC TAS 202-94
2) Cyclic Wind Pressure Loading per FBC, TAS 203-94
along with marked-up drawings of Fiber Cement Siding Panels, model Ladrillo, prepared by Hurricane Engineering & Testing, Inc., Test Report No. **HETI-14-5056A/B**, dated 04/24/2015, signed and sealed by Rafael E. Droz-Seda, P.E.
3. Test reports on 1) Uniform Static Air Pressure Test, Loading per FBC TAS 202-94
2) Cyclic Wind Pressure Loading per FBC, TAS 203-94
along with marked-up drawings of Fiber Cement Siding Panels, model Bermeja, prepared by Hurricane Engineering & Testing, Inc., Test Report No. **HETI-14-5057A/B**, dated 04/24/2015, signed and sealed by Rafael E. Droz-Seda, P.E.
4. Test reports on Cyclic Wind Pressure Loading per FBC, TAS 203-94 along with marked-up drawings of Fiber Cement Siding Panels, model Caravista, prepared by Hurricane Engineering & Testing, Inc., Test Report No. **HETI-15-5050**, dated 04/24/2015, signed and sealed by Rafael E. Droz-Seda, P.E.

C. CALCULATIONS “Submitted under NOA # 17-0426.07”

1. Anchor verification calculations prepared by MCY Engineering, Inc., dated 08/15/2016, signed and sealed by Yiping Wang, P.E.

D. QUALITY ASSURANCE

1. Miami-Dade Department of Regulatory and Economic Resources (RER).

E. MATERIAL CERTIFICATIONS

1. None.

F. STATEMENTS “Submitted under NOA # 17-0426.07”

1. Statement letter of code conformance to the 5th Edition (2014) FBC issued by MCY Engineering, Inc., dated 07/16/2015, signed and sealed by Yiping Wang, P.E.
2. Statement letter of no financial interest issued by MCY Engineering, Inc., dated 07/16/2015, signed and sealed by Yiping Wang, P.E.
3. Distributor agreement dated 04/24/2017.



Carlos M. Utrera, P.E.
Product Control Examiner
NOA No. 22-1004.01

Expiration Date: October 5, 2027
Approval Date: October 27, 2022

NOTICE OF ACCEPTANCE: EVIDENCE SUBMITTED

2. Evidence submitted under NOA # 19-0326.11

A. DRAWINGS

1. Drawing No. **AD15-61**, titled “Glassydr Fiber Cement Siding”, sheets 1 through 5 of 5, dated 08/15/2016, with revision 1 dated 02/27/2019, prepared by MCY Engineering, Inc., signed and sealed by Yiping Wang, P.E.

B. TESTS

1. None.

C. CALCULATIONS

1. None.

D. QUALITY ASSURANCE

1. Miami-Dade Department of Regulatory and Economic Resources (RER).

E. MATERIAL CERTIFICATIONS

1. None.

F. STATEMENTS

1. Statement letter of code conformance to the 6th Edition (2017) FBC issued by MCY Engineering, Inc., dated 03/12/2019, signed and sealed by Yiping Wang, P.E.
2. Statement letter of no financial interest issued by MCY Engineering, Inc., dated 03/12/2019, signed and sealed by Yiping Wang, P.E.



Carlos M. Utrera, P.E.
Product Control Examiner
NOA No. 22-1004.01
Expiration Date: October 5, 2027
Approval Date: October 27, 2022

NOTICE OF ACCEPTANCE: EVIDENCE SUBMITTED

3. New evidence submitted

A. DRAWINGS

1. Drawing No. **AD15-61**, titled “Glassydur Fiber Cement Siding”, sheets 1 through 5 of 5, dated 08/15/2016, with revision 2 dated 09/28/2022, prepared by MCY Engineering, Inc., signed and sealed by Yiping Wang, P.E.

B. TESTS

1. None.

C. CALCULATIONS

1. None.

D. QUALITY ASSURANCE

1. Miami-Dade Department of Regulatory and Economic Resources (RER).

E. MATERIAL CERTIFICATIONS

1. None.

F. STATEMENTS

1. Statement letter of code conformance to the 7th Edition (2020) of the FBC and of no financial interest, issued by MCY Engineering, Inc., dated 09/28/2022, signed and sealed by Yiping Wang, P.E.



Carlos M. Utrera, P.E.
Product Control Examiner
NOA No. 22-1004.01
Expiration Date: October 5, 2027
Approval Date: October 27, 2022

1.18" MAX. THK.
0.52" MIN. THK.

17 1/2" MAX.
O.C. TYP.

SUBSTRATE

SECTION A

OPTION 1
(ALTOS SIDING)

0.79" MAX. THK.
0.42" MIN. THK.

17 1/2" MAX.
O.C. TYP.

SUBSTRATE

SECTION A

OPTION 2
(LADRILLO SIDING)

0.79" MAX. THK.
3/8" MIN. THK.

16" O.C.
MAX. TYP.

SUBSTRATE

SECTION A

OPTION 3
(BERMEJA SIDING)

1.18" MAX. THK.
1/2" MIN. THK.

16" O.C.
MAX. TYP.

SUBSTRATE

SECTION A

OPTION 4
(CARAVISTA SIDING)

UNLIMITED
HEIGHT

36" AVERAGE
PANEL HEIGHT

17 1/2" MAX.
O.C. TYP.

18 1/2" O.C. TYP.

UNLIMITED WIDTH

36" AVERAGE
PANEL WIDTH

12" O.C. TYP.

12" MAX. O.C. TYP.

12" MAX. O.C. TYP.

1

EDGES OF MEETING PANELS
TO BE JOINED WITH 2500
PSI GROUT MIX.

TYPICAL ELEVATION

ALTOS SIDING
OPTION 1

ANCHOR INTO CONCRETE BLOCK OPTION

FIBER CEMENT PANELS ANCHORED TO SHEAR WALLS AS EXTERIOR CLADDING.

APPROVAL APPLIES TO MULTIPLE UNIT INSTALLATIONS

MIN. PANEL THICKNESS = 3/8"

MAX. PANEL SIZE = SEE CHART

NOTE: FRAME WALLS (SUBSTRATE) MUST HAVE A WATER
RESISTIVE BARRIER PER FBC 1404.2. IT MUST BE VERIFIED
BY A PROFESSIONAL ENGINEER.

THIS FIBER CEMENT SIDING SYSTEM CONFORMS TO THE
REQUIREMENTS OF ASTM C1186, TYPE A (FBC 1404.10)

ABBREVIATIONS AND SYMBOLS

F.H. - FRAME HEIGHT

F.W. - FRAME WIDTH

W - WITH

WO - WITHOUT

O.C. - ON CENTER

SECTION NUMBER
C
4
SHEET NUMBER

MAXIMUM DESIGN LOAD

+ 70 PSF

- 70 PSF

GLASSYDUR FIBER CEMENT SIDING NOTES:

- 1- THIS PRODUCT HAS BEEN DESIGNED AND TESTED TO COMPLY WITH THE REQUIREMENTS OF THE FLORIDA BUILDING CODE 7TH EDITION (2020) INCLUDING HIGH VELOCITY HURRICANE ZONE (HVHZ).
- 2- ANCHORS SHALL BE AS LISTED, SPACED AS SHOWN ON DETAILS. ANCHORS EMBEDMENT TO BASE MATERIAL SHALL BE BEYOND WALL DRESSING OR STUCCO.
- 3- ANCHORING OR LOADING CONDITIONS NOT SHOWN IN THESE DETAILS ARE NOT PART OF THIS APPROVAL.
- 4- MATERIALS INCLUDING BUT NOT LIMITED TO STEEL/METAL SCREWS THAT COME INTO CONTACT WITH OTHER DISSIMILAR MATERIALS SHALL MEET THE REQUIREMENTS OF THE FLORIDA BUILDING CODE 7TH EDITION (2020) SECTION AS APPLICABLE.
- 5- METAL STRUCTURES NOT BY ANTONIO AFONSO, S.L. DESIGNED TO SUPPORT THE LOADS IMPOSED BY THIS SIDING SYSTEM AND TO TRANSFER SUCH LOADS TO THE BUILDING MAIN STRUCTURE.
- 6- ULTIMATE LOAD OBTAINED FROM ASCE 7-16, MULTIPLY BY 0.6 SHALL BE LESS THAN OR EQUAL TO MAX. DESIGN LOAD IN THIS DOCUMENT. THE DESIGN LOADS SHOWN IN THIS DOCUMENT ARE ALLOWABLE DESIGN LOADS.
- 7- THIS FIBER CEMENT SIDING IS COMPOSED OF PORTLAND CEMENT, SAND, FIBERGLASS (NOT CELLULOSE FIBER) AND INORGANIC COLORS; IT DOES NOT REQUIRE TO BE TESTED PER ASTM E136 AND ASTM E84.

PRODUCT REVISED
as complying with the Florida
Building Code
NOA-No. 22-1004.01
Expiration Date 10/05/2027
By *[Signature]*
Miami-Dade Product Control
MIAMI-DADE COUNTY

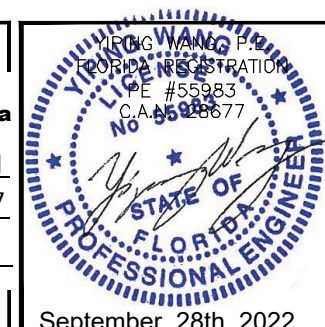

COVER

DATE	09.28.2022
SCALE	AS SHOWN
DRAWN	T.G.
PROJECT	15-108

DRAWING NO.
AD15-61

1 OF 5

GLASSYDUR FIBER CEMENT SIDING

ANTONIO AFONSO S.L.

Calle El Timple, s/n. Poligono Industrial Las Almenas
Icod de los Vinos, 38430. Santa Cruz de Tenerife. Islas Canarias. España
TEL (34) 608 682 040 EMAIL: usa@glassydur.com

MCY ENGINEERING, INC.

GLAZING CONSULTANTS

12781 MIRAMAR PARKWAY #301 P: 305.271.0117
MIRAMAR FL33027

mcy@mcyengineering.com www.MCYEngineering.com

REVISIONS

NO	DATE	DESCRIPTION
----	------	-------------

2	09.28.2022	RENEWAL
---	------------	---------

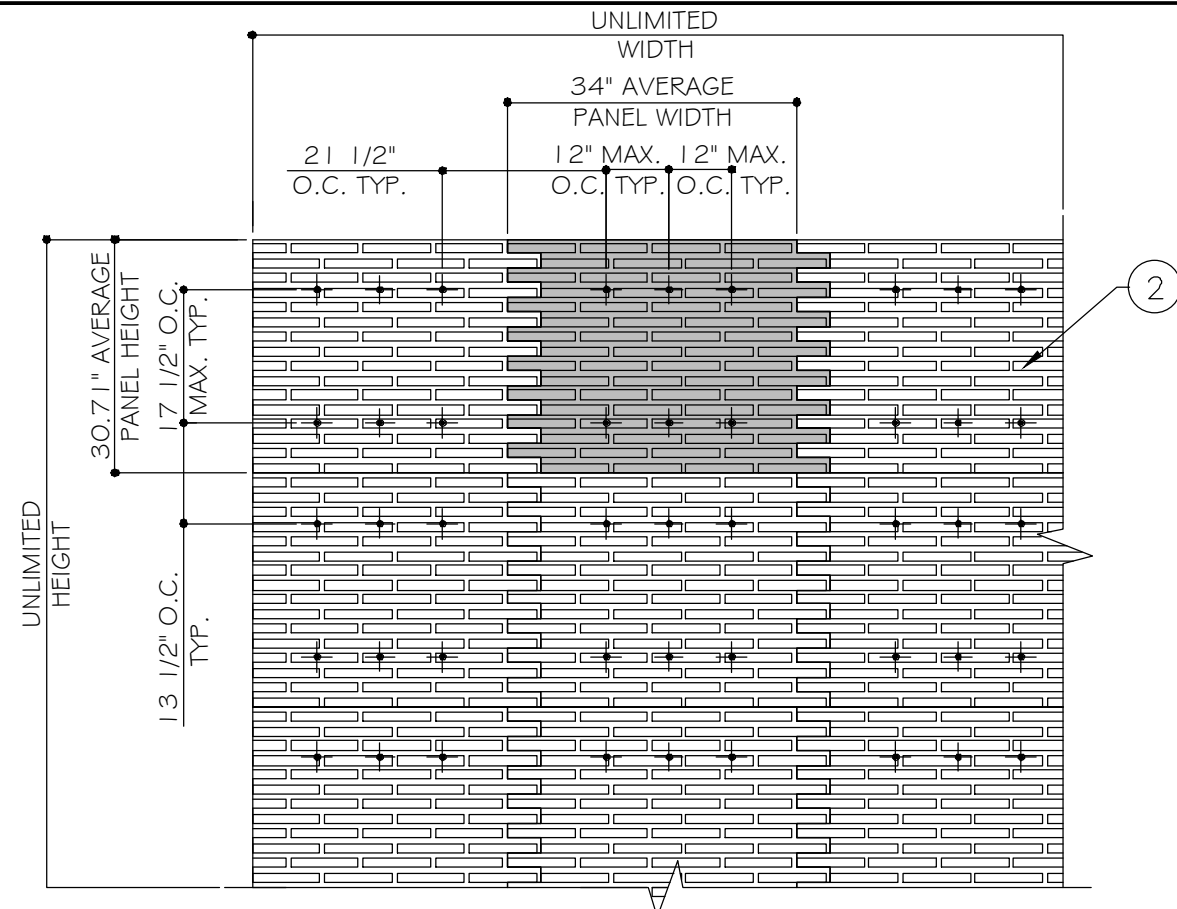

TYPICAL ELEVATION
LADRILLO SIDING
OPTION 2
ANCHOR INTO CONCRETE BLOCK OPTION

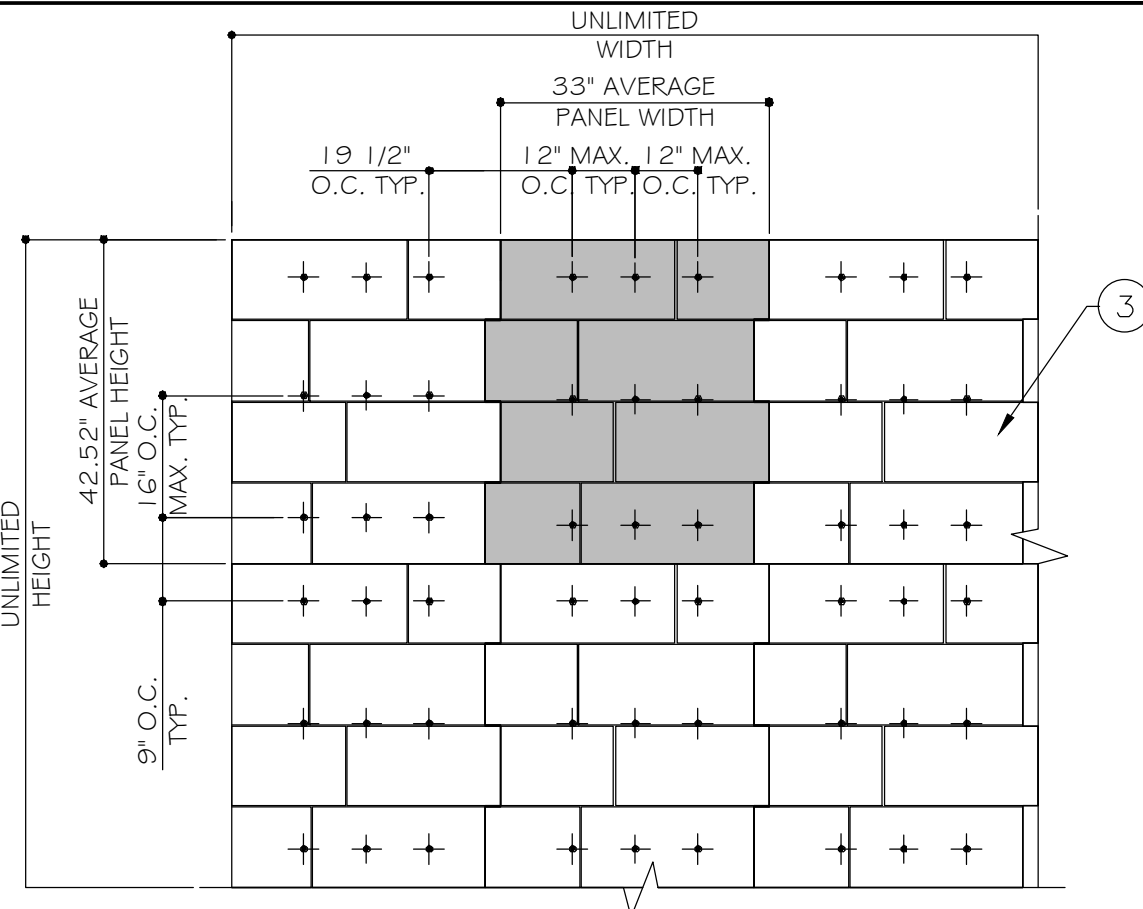

TYPICAL ELEVATION
BERMEJA SIDING
OPTION 3
ANCHOR INTO CONCRETE BLOCK OPTION

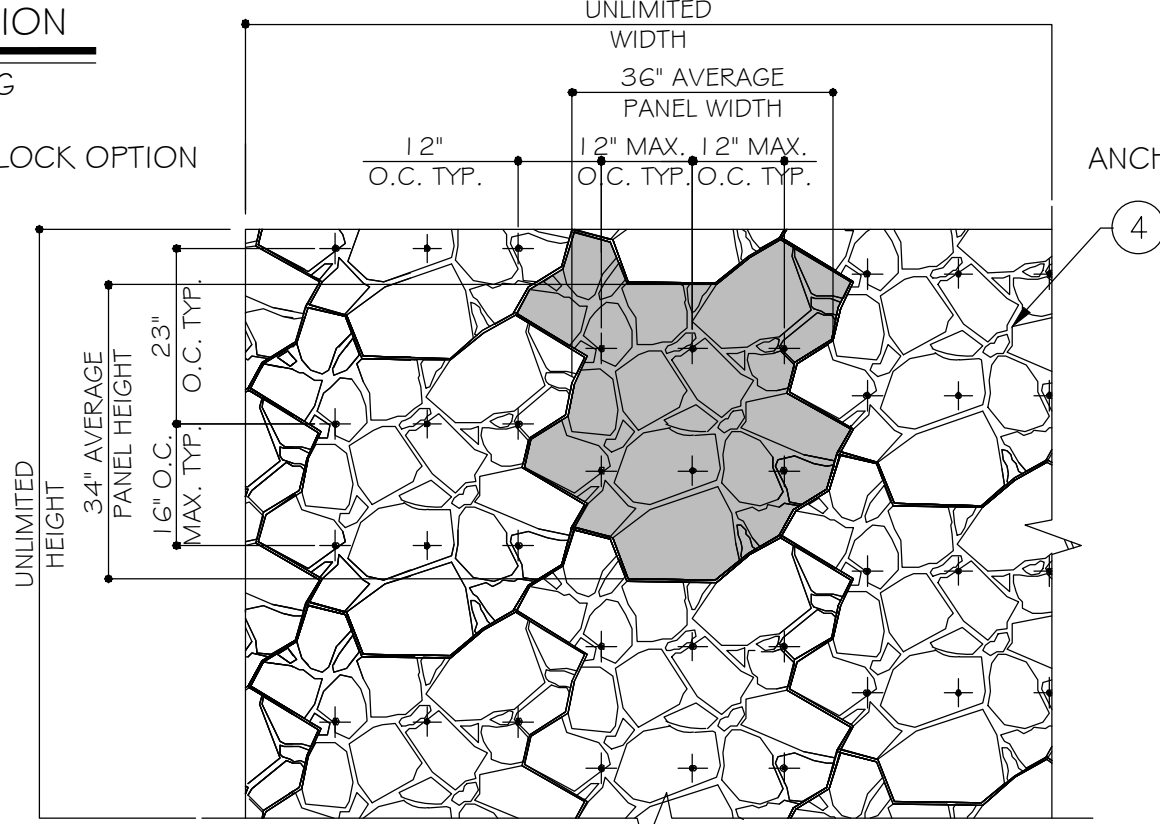

TYPICAL ELEVATION
CARAVISTA SIDING
OPTION 4
ANCHOR INTO CONCRETE BLOCK OPTION

PRODUCT REVISED
as complying with the Florida
Building Code
NOA-No. 22-1004.01
Expiration Date 10/05/2027
By *[Signature]*
Miami-Dade Product Control
 MIAMI-DADE COUNTY

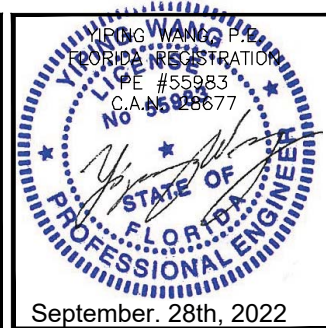

NO	DATE	DESCRIPTION
2	09-28-2022	RENEWAL

MCY ENGINEERING, INC.
 GLAZING CONSULTANTS
 12781 MIRAMAR PARKWAY #301 P: 305.271.0117
 MIRAMAR FL33027
 mcy@mcyengineering.com www.MCYEngineering.com

GLASSYDUR FIBER CEMENT SIDING
ANTONIO AFONSO S.L.
 Calle El Timple, s/n. Poligono Industrial Las Almenas
 Icod de los Vinos, 38430. Santa Cruz de Tenerife. Islas Canarias. España
 TEL (34) 608 682 040 EMAIL: usa@glassydur.com

E1
DATE 09.28.2022
SCALE AS SHOWN
DRAWN T.G.
PROJECT 15-108
DRAWING NO. AD15-61
2 OF 5

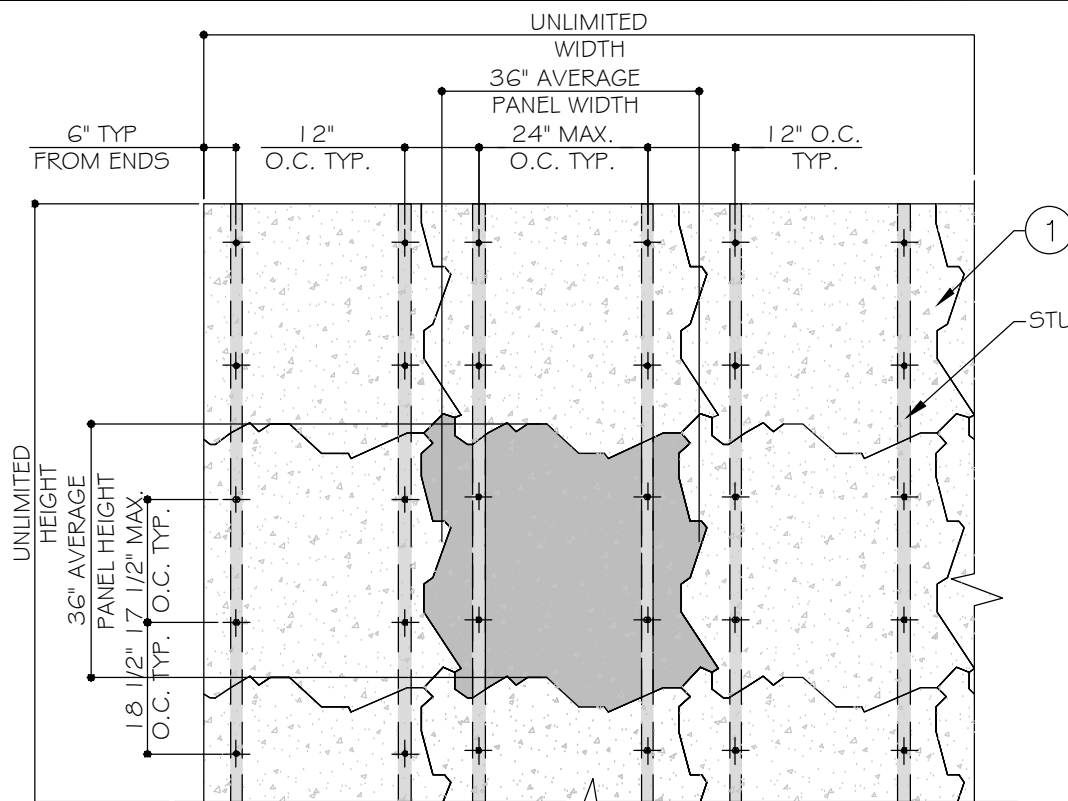

TYPICAL ELEVATION

ALTOS SIDING
OPTION 1
ANCHOR INTO STUDS OPTION

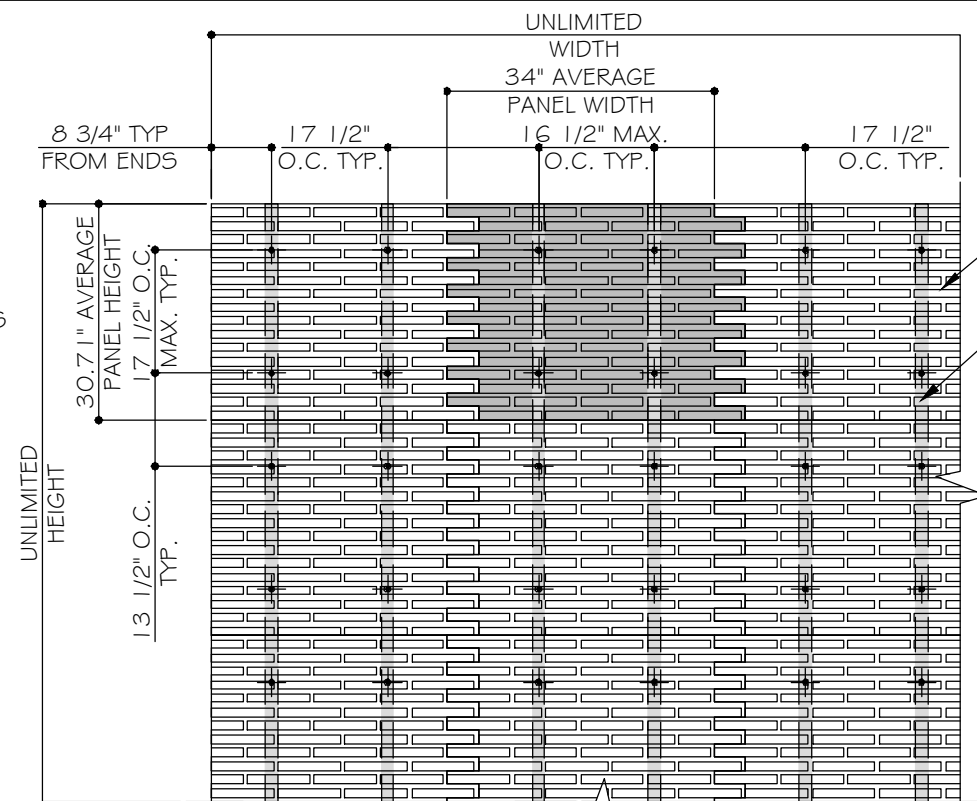

TYPICAL ELEVATION

LADRILLO SIDING
OPTION 2
ANCHOR INTO STUDS OPTION

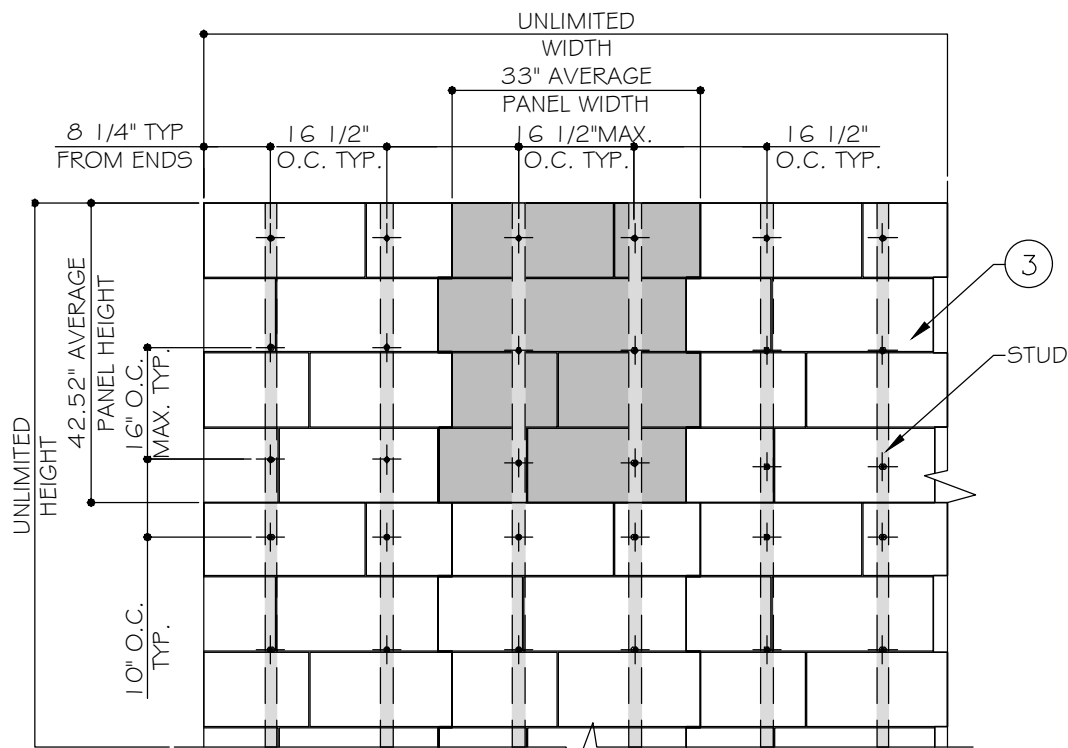

TYPICAL ELEVATION

BERMEJA SIDING
OPTION 3
ANCHOR INTO STUDS OPTION

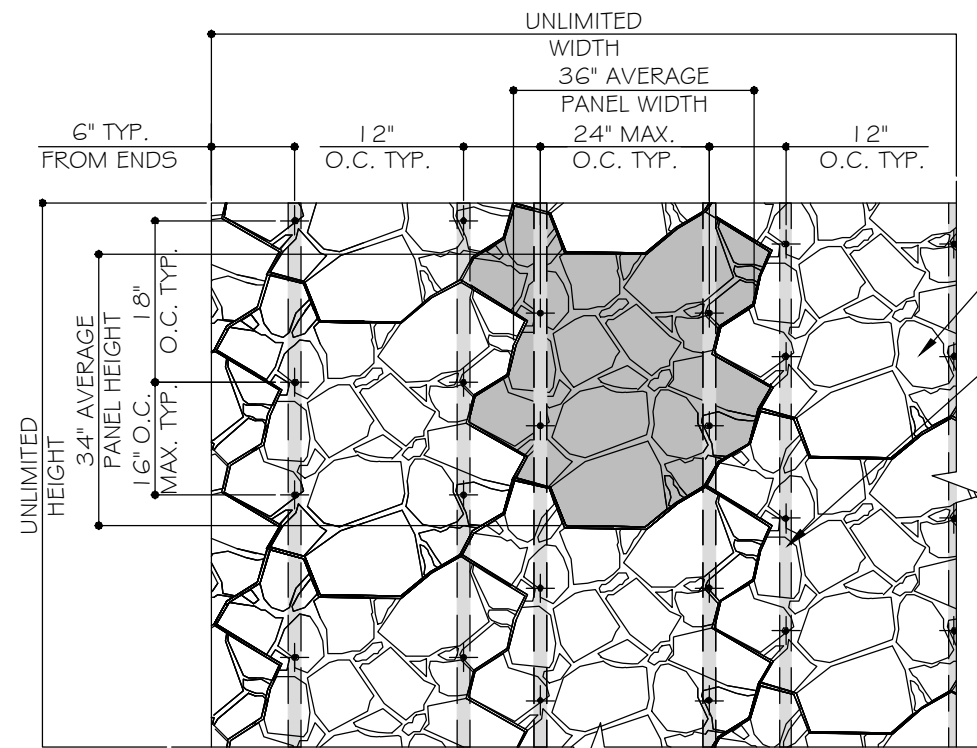

TYPICAL ELEVATION

CARAVISTA SIDING
OPTION 4
ANCHOR INTO STUDS OPTION

PRODUCT REVISED
as complying with the Florida
Building Code
NOA-No. 22-1004.01
Expiration Date 10/05/2027
By *[Signature]*
Miami-Dade Product Control
MIAMI-DADE COUNTY

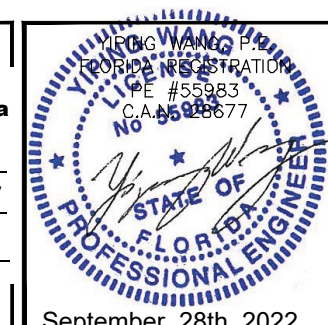

REVISIONS		
NO	DATE	DESCRIPTION
2	09-28-2022	RENEWAL

MCY ENGINEERING, INC.
GLAZING CONSULTANTS
12781 MIRAMAR PARKWAY #301 P: 305.271.0117
MIRAMAR FL33027
mcy@mcyengineering.com www.MCYEngineering.com

GLASSYDUR FIBER CEMENT SIDING
ANTONIO AFONSO S.L.
Calle El Timple, s/n. Poligono Industrial Las Almenas
Icod de los Vinos, 38430. Santa Cruz de Tenerife. Islas Canarias. España
TEL (34) 608 682 040 EMAIL: usa@glassydur.com

E2	
DATE	09.28.2022
SCALE	AS SHOWN
DRAWN	T.G.
PROJECT	15-108
DRAWING NO.	
AD15-61	
3 OF 5	

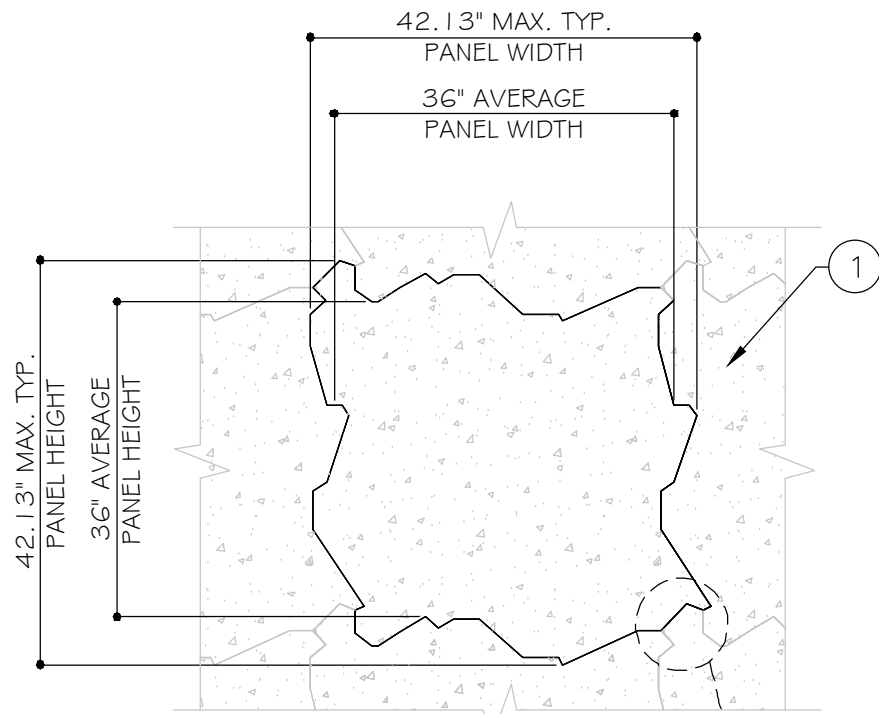

TYPICAL ELEVATION

ALTOS SIDING
OPTION 1

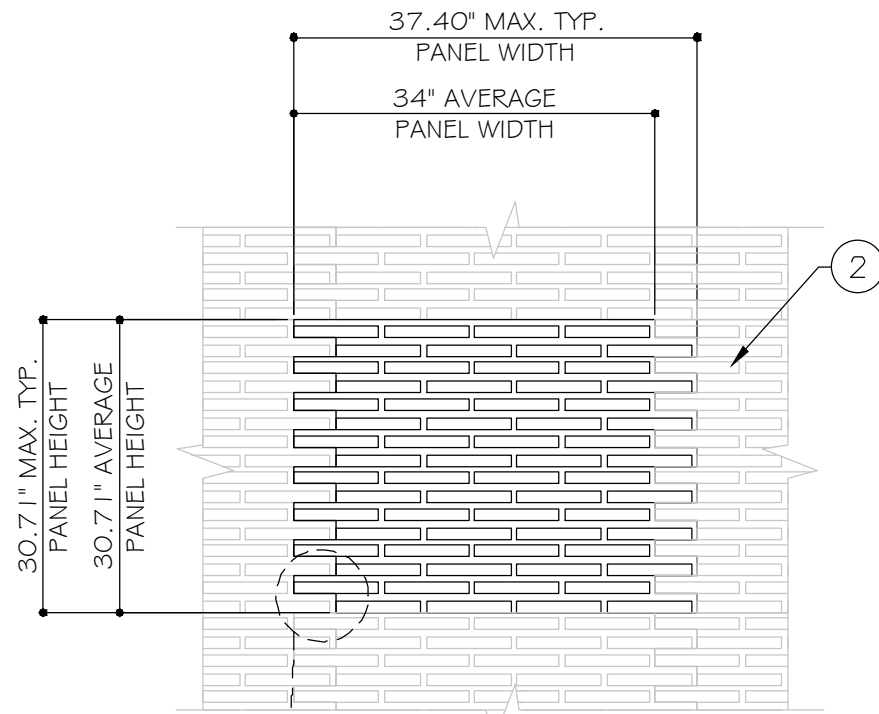

TYPICAL ELEVATION

LADRILLO SIDING
OPTION 2

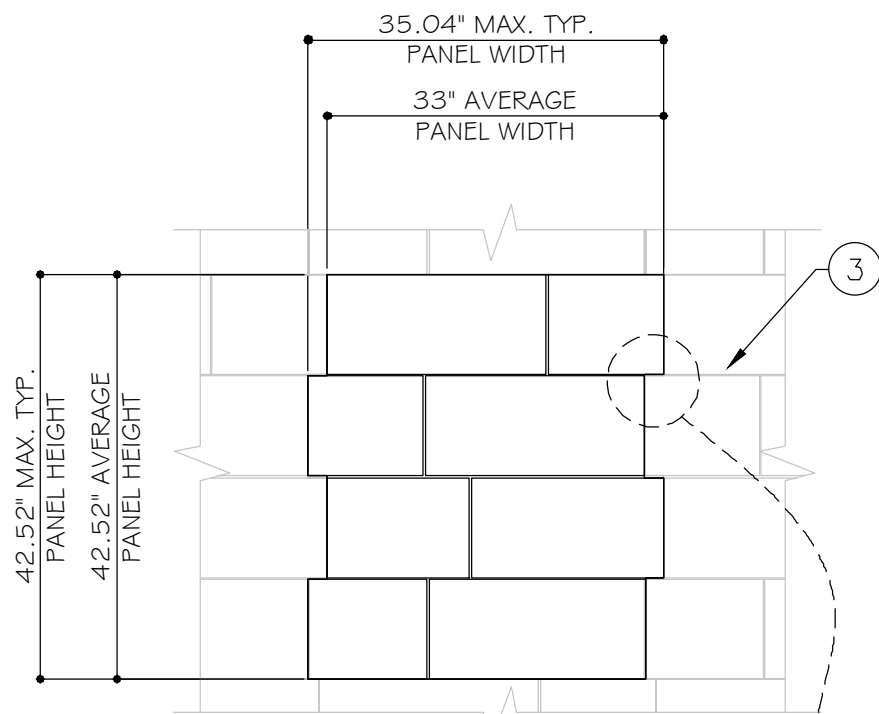

TYPICAL ELEVATION

BERMEJA SIDING
OPTION 3

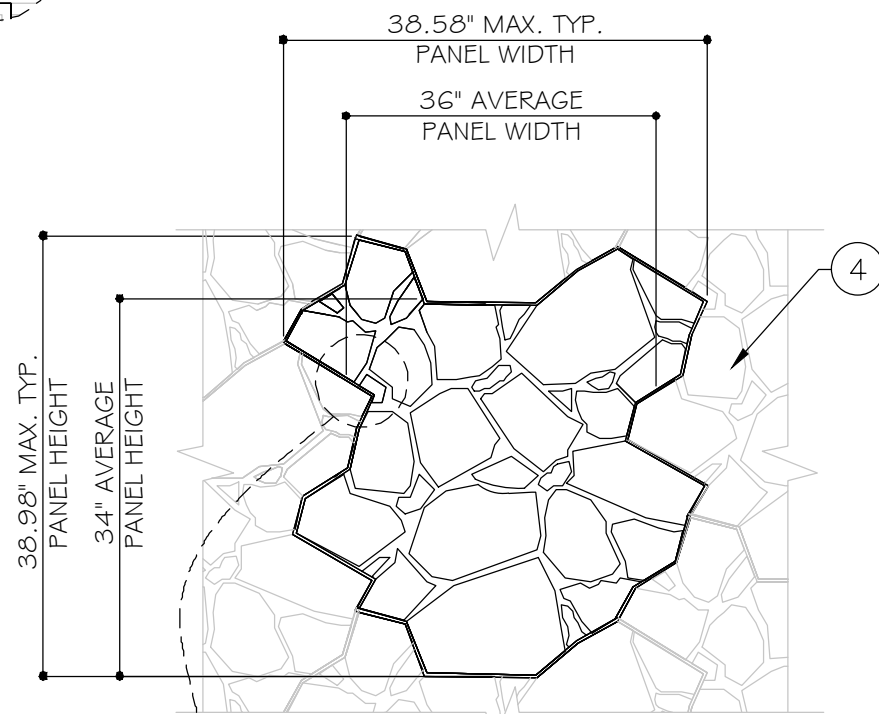

TYPICAL ELEVATION

CARAVISTA SIDING
OPTION 4



1/4" MAX.
GROUT

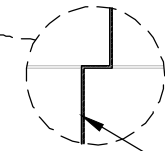
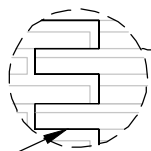

1/4" MAX.
GROUT

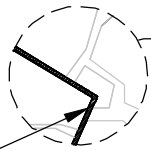

PRODUCT REVISED
as complying with the Florida
Building Code
NOA-No. 22-1004.01

Expiration Date 10/05/2027

By 
Miami-Dade Product Control

MIAMI-DADE COUNTY

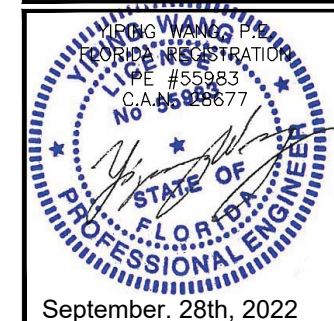

REVISIONS		
NO.	DATE	DESCRIPTION
2	09.28.2022	RENEVAL

MCY ENGINEERING, INC.
GLAZING CONSULTANTS
12781 MIRAMAR PARKWAY #301 P: 305.271.0117
MIRAMAR, FL 33027
mcy@mcyengineering.com www.MCYEngineering.com

GLASSYDUR FIBER CEMENT SIDING
ANTONIO AFONSO S.L.
Calle El Timple, s/n. Poligono Industrial Las Almenas
Icod de los Vinos, 38430. Santa Cruz de Tenerife. Islas Canarias. España
TEL (34) 608 682 040 EMAIL-usa@glassydur.com

E3	
DATE	09.28.2022
SCALE	AS SHOWN
DRAWN	T.G.
PROJECT	15-108
DRAWING NO. AD15-61	
4 OF 5	

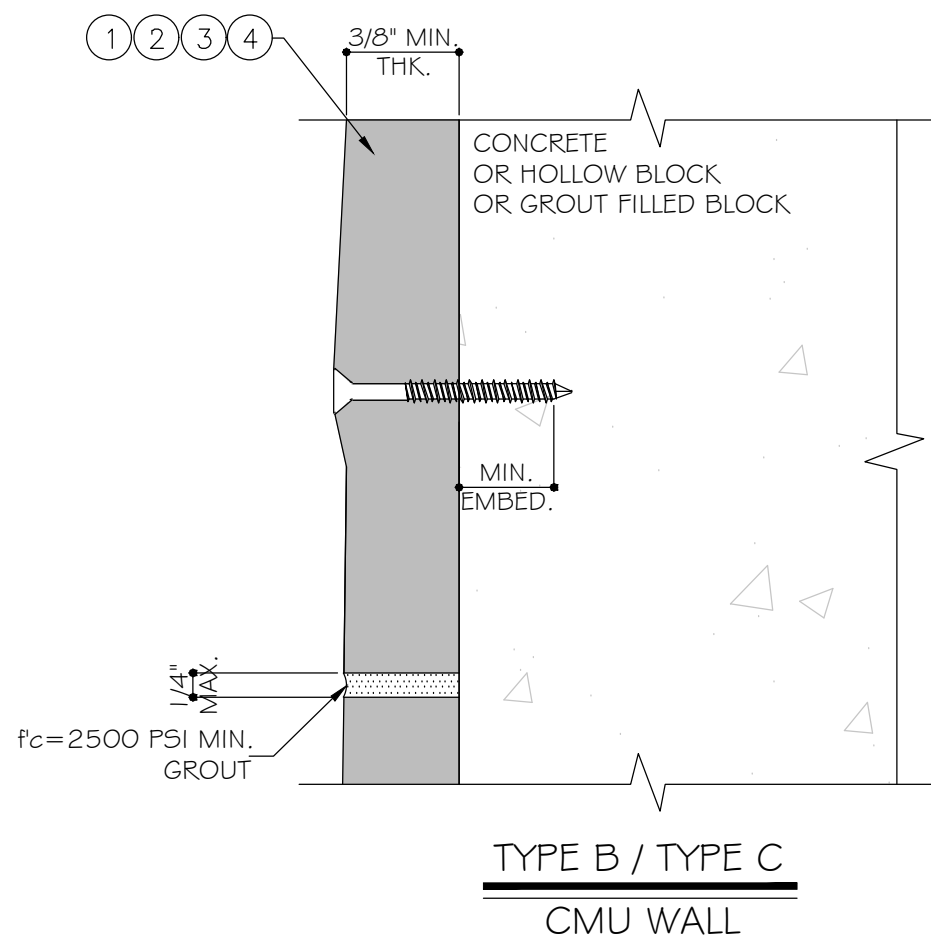
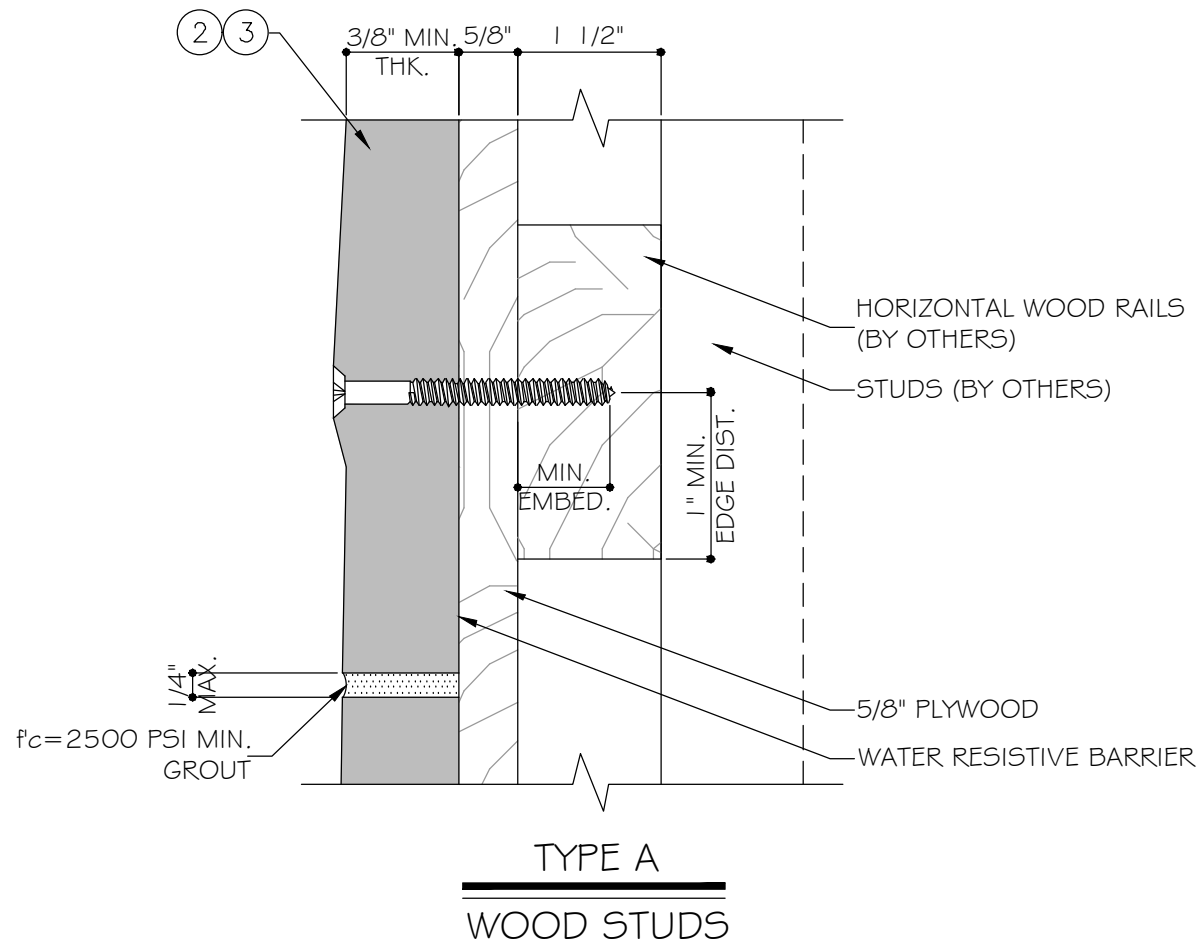

#	PROFILE
1	ALTOS
2	LADRILLO
3	BERMEJA
4	CARAVISTA

TYPICAL ANCHORS:

TYPE "A": #14 WOOD SCREW OR LAG SCREW (GRADE 2 CRS) THRU 5/8" PLYWOOD, DIRECTLY INTO 2 BY WOOD BUCK FRAME OR WOOD STRUCTURES, $G=0.55$ MIN. 1-1/4" MIN. EMBED.

TYPE "B": 1/4" DIA. 'ITW' TAPCON ($F_u=120$ KSI, $F_y=92$ KSI) OR 1/4" ULTRACON+BY 'DEWALT' ($F_u=164$ KSI, $F_y=148$ KSI) INTO $f'_c=3000$ PSI MIN. CONCRETE 1-1/4" MIN. EMBED. 1-1/4" MIN. EDGE DIST.

TYPE "C": 1/4" DIA. 'DEWALT' ULTRACON+ ($F_u=164$ KSI, $F_y=148$ KSI) INTO HOLLOW BLOCK OR GROUT FILLED BLOCK $f'_m=2000$ PSI MIN. 1-1/4" MIN. EMBED. 1-1/4" MIN. EDGE DIST.

TYPE "D": 1/4" SMS ($F_u=74$ KSI, $F_y=57$ KSI) OR 1/4" TEKS SCREW, GRADE 5 ($F_u=120$ KSI, $F_y=92$ KSI) INTO 16 GA MIN. METAL STUDS OR 0.090" THK. ALUM. STRUCTURE (6063-T5 MIN.) 3/4" MIN. EDGE DIST.

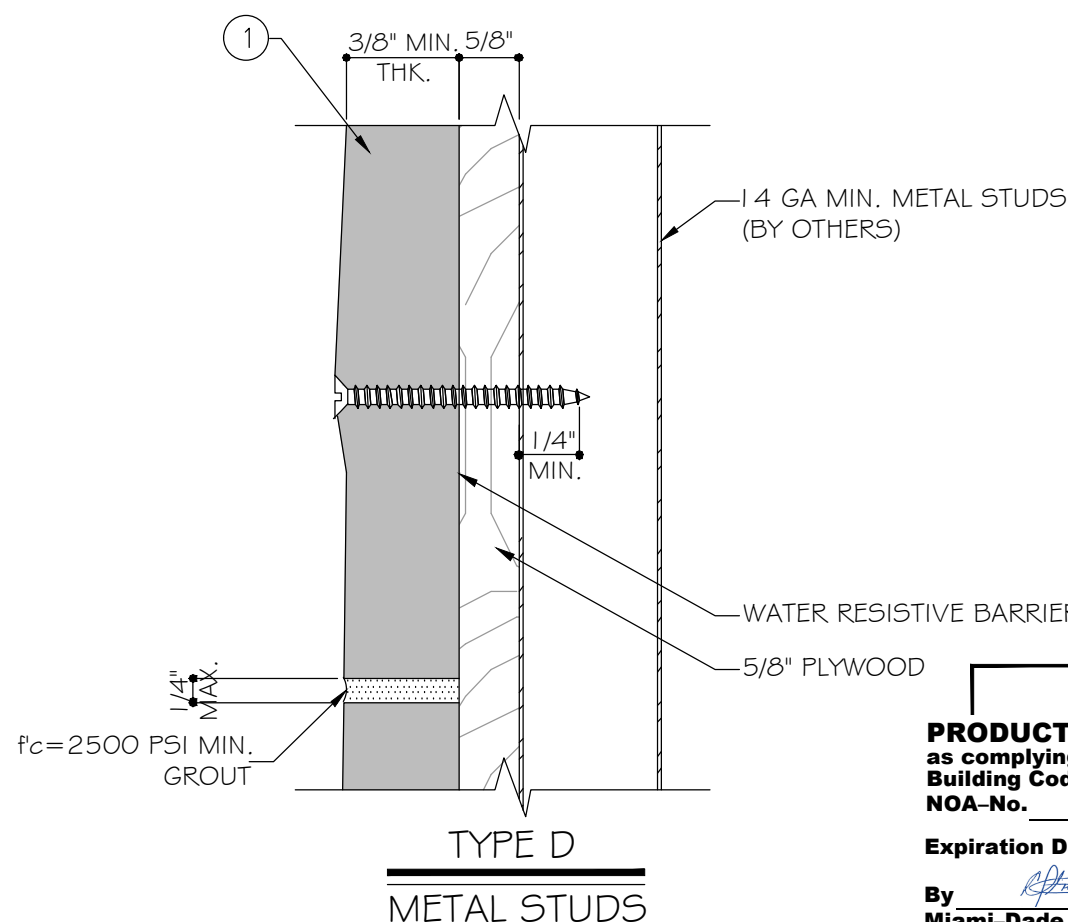

PRODUCT REVISED
as complying with the Florida Building Code
NOA-No. 22-1004.01
Expiration Date 10/05/2027
By *[Signature]*
Miami-Dade Product Control
MIAMI-DADE COUNTY

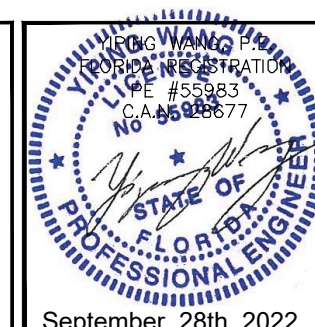

NO	DATE	DESCRIPTION
2	09.28.2022	RENEWAL

MCY ENGINEERING, INC.
GLAZING CONSULTANTS
12781 MIRAMAR PARKWAY #301 P: 305.271.0117
MIRAMAR FL 33027
mcy@mcyengineering.com www.MCYEngineering.com

GLASSYDUR FIBER CEMENT SIDING
ANTONIO AFONSO S.L.
Calle El Timple, s/n, Polígono Industrial Las Almenas
Icod de los Vinos, 38430. Santa Cruz de Tenerife. Islas Canarias. España
TEL (34) 608 682 040 EMAIL: usa@glassydur.com

D1
DATE 09.28.2022
SCALE AS SHOWN
DRAWN T.G.
PROJECT 15-108
DRAWING NO. AD15-61
5 OF 5