



DEPARTMENT OF REGULATORY AND ECONOMIC RESOURCES (RER)  
BOARD AND CODE ADMINISTRATION DIVISION

MIAMI-DADE COUNTY  
PRODUCT CONTROL SECTION  
11805 SW 26 Street, Room 208  
Miami, Florida 33175-2474  
T (786) 315-2590 F (786) 315-2599

## NOTICE OF ACCEPTANCE (NOA)

[www.miamidade.gov/economy](http://www.miamidade.gov/economy)

**SWISSPEARL / Cladding Corp.**  
**640 Airport Rd. 1<sup>st</sup> Floor**  
**Winchester, VA 22602**

### SCOPE:

This NOA is being issued under the applicable rules and regulations governing the use of construction materials. The documentation submitted has been reviewed and accepted by Miami-Dade County RER- Product Control Section to be used in Miami Dade County and other areas where allowed by the Authority Having Jurisdiction (AHJ).

This NOA shall not be valid after the expiration date stated below. The Miami-Dade County Product Control Section (In Miami Dade County) and/or the AHJ (in areas other than Miami Dade County) reserve the right to have this product or material tested for quality assurance purposes. If this product or material fails to perform in the accepted manner, the manufacturer will incur the expense of such testing and the AHJ may immediately revoke, modify, or suspend the use of such product or material within their jurisdiction. RER reserves the right to revoke this acceptance if it is determined by Miami-Dade County Product Control Section that this product or material fails to meet the requirements of the applicable building code.

This product is approved as described herein and has been designed to comply with the High Velocity Hurricane Zone of the Florida Building Code.

### DESCRIPTION: "SWISSPEARL Façade" Cement Composite Wall Panel System

**APPROVAL DOCUMENT:** Drawing titled "Swisspearl Façade System Cement Composite Panel", sheets 1 through 37 of 37, prepared by Salvatore Ray Granata, P.E., dated January 21, 2022, signed and sealed by Salvatore Ray Granata, P.E., on February 10, 2022, bearing the Miami-Dade County Product Control Revision stamp with the Notice of Acceptance number and the expiration date by the Miami-Dade County Product Control Section.

### MISSILE IMPACT RATING: Large and Small Missile Impact Resistant

**LABELING:** Each panel shall bear a permanent label with the manufacturer's name or logo, city, state and the following statement: "Miami-Dade County Product Control Approved", unless otherwise noted herein.

**RENEWAL** of this NOA shall be considered after a renewal application has been filed and there has been no change in the applicable building code negatively affecting the performance of this product.

**TERMINATION** of this NOA will occur after the expiration date or if there has been a revision or change in the materials, use, and/or manufacture of the product or process. Misuse of this NOA as an endorsement of any product, for sales, advertising or any other purposes shall automatically terminate this NOA. Failure to comply with any section of this NOA shall be cause for termination and removal of NOA.

**ADVERTISEMENT:** The NOA number preceded by the words Miami-Dade County, Florida, and followed by the expiration date may be displayed in advertising literature. If any portion of the NOA is displayed, then it shall be done in its entirety.

**INSPECTION:** A copy of this entire NOA shall be provided to the user by the manufacturer or its distributors and shall be available for inspection at the job site at the request of the Building Official.

This NOA **revises & renews** NOA #19-0417.01 and consists of this page 1, evidence submitted pages E-1, E-2 & E-3 as well as approval document mentioned above.

The submitted documentation was reviewed by **Helmy A. Makar, P.E., M.S.**



*Helmy A. Makar*  
07/11/24

NOA No. 23-0606.09  
Expiration Date: 04/22/2029  
Approval Date: 07/11/2024  
Page 1

**SWISSPEARL / Cladding Corp.**

**NOTICE OF ACCEPTANCE: EVIDENCE SUBMITTED**

**1. EVIDENCE SUBMITTED UNDER PREVIOUS APPROVAL # 09-0115.05**

**A. DRAWINGS**

1. *Drawing No. C08-258, titled "Swisspearl Façade System Cement Composite Panel", sheets 1 through 31 of 31, prepared by CBuck Engineering, dated April 09, 2009, signed and sealed by James L. Buckner, P.E., on April 10, 2009.*

**B. TESTS**

1. *Test report on Large Missile Impact Test, Cyclic Wind Pressure Test and Uniform Static Air Pressure Test on Swisspearl Fiber-Cement Façade Panel System, prepared by Architectural Testing, Report No. 77956.01-109-18, dated 12/18/2008, signed and sealed by Michael D. Stremmel, P.E.*

**C. CALCULATIONS**

1. *Calculations titled "Eternit Wall Panel System", dated March 09, 2009, 9 pages, prepared by CBuck Engineering, signed and sealed by James L. Buckner, P.E., on March 09, 2009.*

**D. QUALITY ASSURANCE**

1. *By Miami-Dade County Building Code Compliance Office.*

**E. MATERIAL CERTIFICATIONS**

1. *None.*

**2. EVIDENCE SUBMITTED UNDER PREVIOUS APPROVAL # 14-0605.07**

**A. DRAWINGS**

1. *Drawing No. C08-258, titled "Swisspearl Façade System Cement Composite Panel", sheets 1 through 31 of 31, prepared by CBuck Engineering, dated April 09, 2009, Revision #4, signed and sealed by James L. Buckner, P.E., on April 22, 2014.*

**B. TESTS**

1. *None.*

**C. CALCULATIONS**

1. *None.*

**D. QUALITY ASSURANCE**

1. *By Miami-Dade County Department of Regulatory and Economic Resources.*

**E. MATERIAL CERTIFICATIONS**

1. *None.*



Helmy A. Makar, P.E., M.S.  
Product Control Section Supervisor  
NOA No. 23-0606.09  
Expiration Date: 04/22/2029  
Approval Date: 07/11/2024



**NOTICE OF ACCEPTANCE: EVIDENCE SUBMITTED**

**3. EVIDENCE SUBMITTED UNDER PREVIOUS APPROVAL # 19-0417.01**

**A. DRAWINGS**

1. *Drawing titled "Swisspearl Façade System Cement Composite Panel", sheets 1 through 37 of 37, prepared by Salvatore Ray Granata, P.E., dated January 21, 2022, signed and sealed by Salvatore Ray Granata, P.E., on February 10, 2022.*

**B. TESTS**

1. *Test report on Large Missile Impact Test, Cyclic Wind Pressure Test and Uniform Static Air Pressure Test on Swisspearl Fiber-Cement Façade Panel System, prepared by Farabaugh Engineering and Testing, Inc., Report No. T301-20, dated 08/12/2020, signed and sealed by Daniel G. Farabaugh, P.E., on 10/21/2020.*
2. *Test report on Large Missile Impact Test, Cyclic Wind Pressure Test and Uniform Static Air Pressure Test on Swisspearl Fiber-Cement Façade Panel System, prepared by Farabaugh Engineering and Testing, Inc., Report No. T302-20, dated 08/12/2020, signed and sealed by Daniel G. Farabaugh, P.E., on 10/21/2020.*

**C. CALCULATIONS**

1. *Calculations titled "Swisspearl Cement Composite Wall Panel System", 16 pages, dated May 05, 2021, prepared by Salvatore Ray Granata, P.E., signed and sealed by Salvatore Ray Granata, P.E., on May 05, 2021.*

**D. QUALITY ASSURANCE**

1. *By Miami-Dade County Department of Regulatory and Economic Resources.*

**E. MATERIAL CERTIFICATIONS**

1. *None.*

**4. NEW EVIDENCE SUBMITTED**

**A. DRAWINGS**

1. *None.*

**B. TESTS**

1. *None.*

**C. CALCULATIONS**

1. *None.*

**D. QUALITY ASSURANCE**

1. *By Miami-Dade County Department of Regulatory and Economic Resources.*

**E. MATERIAL CERTIFICATIONS**

1. *None.*



Helmy A. Makar, P.E., M.S.  
Product Control Section Supervisor  
NOA No. 23-0606.09  
Expiration Date: 04/22/2029  
Approval Date: 07/11/2024

**SWISSPEARL / Cladding Corp.**

**NOTICE OF ACCEPTANCE: EVIDENCE SUBMITTED**

**F. STATEMENTS**

1. *Distributor Agreement, dated 03/22/2024, signed by Julien Ferrer of Swisspearl Schweiz AG (manufacturer) and Don Heft of Cladding Corp. (Distributor).*
2. *Florida Building Code 2023 compliance letter issued by Salvatore R. Granata, P.E., dated 06/18/24, signed and sealed by Salvatore R. Granata, P.E.*

  
\_\_\_\_\_  
Helmy A. Makar, P.E., M.S.  
Product Control Section Supervisor  
NOA No. 23-0606.09  
Expiration Date: 04/22/2029  
Approval Date: 07/11/2024



Engineering Report for Submittal  
To  
Miami-Dade Products Approvals  
Revision & Renewal of **NOA 14-0605.07**  
Report Date 01/21/2022

## **Swisspearl Façade** **Cement Composite Wall Panel System**

Category: Panels  
Sub-Category: Wall  
Panel Dimensions: Nominal 4' x 10'  
Support Frame: 16 Ga Steel Stud Framing

Manufacturer  
Eternit (Schweiz)AG Swisspearl  
Eternitstrasse 3  
Niederurnen 886  
Switzerland

### **Table of Contents**

System Support Type C1 – CMU Block Wall pages 2-14  
System Support Type S – Steel Stud Wall 13-5/16" Spacing pages 15-26  
System Support Type S1 – Steel Stud Wall 15-1/2" Spacing pages 27-37

PRODUCT REVISED  
as complying with the Florida  
Building Code  
Acceptance No 23-0606.09  
Expiration Date 04/22/2029  
By H. A. Mohr  
Miami Dade Product Control

PRODUCT REVISED  
as complying with the Florida  
Building Code  
Acceptance No 19-0417.01  
Expiration Date APR 22 2024  
By H. A. Mohr  
Miami Dade Product Control

RECEIVED  
FEB 14 2022  
R.E.R.  
Product Control Section

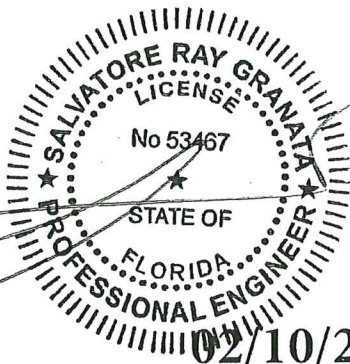

02/10/22

Engineer Salvatore Granata  
Florida PE # 53467  
[sal@srgpe.net](mailto:sal@srgpe.net)  
(678) 367-3151

Distributor Swisspearl Imports  
12618 Verterans Memorial Parkway  
Wentzville, MO 63385

**0.0 System Support Type C(1): CMU Concrete Block Wall**

**1.0 Product**

- 1.1 Manufacturer** Eternit (Schweiz) AG
- 1.2 Product Name** SWISSPEARL® Facade System
- 1.3 Category** Panels
- 1.4 Sub Category** Walls

**2.0 Evaluation Scope:**

**2.1 Evaluation Criteria:**

- 2.1.1 Florida Building Code (FBC) 2020 Code Section: High Velocity Hurricane Zone (HVHZ)
- 2.1.2 Miami-Dade Building Code Compliance Office (BCCO) Checklist

**2.2 Properties Evaluated:**

- 2.2.1 Wind Resistance Properties
  - 2.2.1.1 Uniform Static Air Pressure
  - 2.2.1.2 Large Missile Impact
  - 2.2.1.3 Cyclic Wind Pressure
- 2.2.2 Fire Resistance Properties
- 2.2.3 Panel Material Properties

**2.3 Limits of Evaluation:**

This product is limited to compliance with the criteria in section 2.1 and properties in section 2.2. of this report.

**3.0 Evaluated Uses:**

SWISSPEARL Wall Panels are used as nonbearing exterior (facade) wall panels.

**4.0 Support:** The Support assembly is designed by others and shall have the following minimum Characteristics:

- 4.1 Material: CMU Concrete Block
- 4.2 Filler: Grout Filled

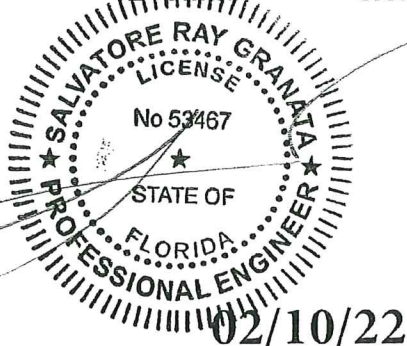

Engineer Salvatore Granata  
Florida PE # 53467  
[sal@srgpe.net](mailto:sal@srgpe.net)  
(678) 367-3151

Swisspearl Façade System

PRODUCT REVISED  
as complying with the Florida  
Building Code  
Acceptance No 19-0417.01  
Expiration Date APR 22 2024  
By *Heidi A. Melzer*  
Miami Dade Product Control

PRODUCT REVISED  
as complying with the Florida  
Building Code  
Acceptance No 23-0606.09  
Expiration Date 04/22/2029  
By *Heidi A. Melzer*  
Miami Dade Product Control

Distributer Swisspearl Imports  
12618 Verterans Memorial Parkway  
Wentzville, MO 63385

## 5.0 Product Description:

### 5.1. General:

The SWISSPEARL cement composite facade wall panels are riveted to a steel sub-frame.  
The steel sub-frame is fastened into the CMU Concrete Block support Wall.

### 5.2 Panel Dimensions:

5.2.1. Length (Maximum):	9 ft 11-5/8in
5.2.2 Width (Maximum):	4 ft
5.2.3 Thickness:	5/16 in

## 6.0 Performance

### 6.1 Wind Resistance:

6.1.1 Design Pressure:	Positive	+63 psf
	Negative	-63 psf

Panel Span:	14.5" o.c.
Panel Span Condition:	3 or more spans

#### 6.1.2 Uniform Static Air Pressure Test:

6.1.2.1 Standard	TAS 2022
6.1.2.2 Results:	Passed

#### 6.1.3 Cyclic Air Pressure Test

6.1.3.1 Standard:	TAS 203
6.1.3.2 Results:	Passed

### 6.2 Impact Rating:

6.2.1 Large Missile impact:	
6.2.2 Standard:	TAS 201
6.2.3 Results	Passed
6.2.4 Test Laboratory:	Farabaugh Engineering and Testing, Inc.

### 6.3 Fire Resistance

6.3.1 Test Standard:	E - 84 / E-136
6.3.2 Results:	Flame Spread: 0
	Smoke Density: 15

PRODUCT REVISED  
as complying with the Florida  
Building Code  
Acceptance No 23-0606.09  
Expiration Date 04/22/2029  
By H. G. A. M. M.  
Miami Dade Product Control

PRODUCT REVISED  
as complying with the Florida  
Building Code  
Acceptance No 19-0417.01  
Expiration Date APR 22 2024  
By H. G. A. M. M.  
Miami Dade Product Control

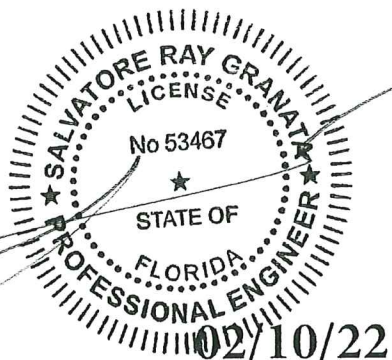

Engineer Salvatore Granata  
Florida PE # 53467  
[sal@srgpe.net](mailto:sal@srgpe.net)  
(678) 367-3151

Swisspearl Façade System

Distributor Swisspearl Imports  
12618 Verterans Memorial Parkway  
Wentzville, MO 63385



#### 6.4 Panel Material Properties

6.4.1	Test Standard:	ASTM C1185 – 95
6.4.2	Results	Passed

#### 7.0 Limitations of Use:

- 7.1 Maximum Panel span 16 in.
- 7.2 Maximum Panel Deflection shall be  $L/180$ .
- 7.3 Diaphragm and axial load capacity is outside the scope of this evaluation.
- 7.4 This evaluation is limited to the wall panel, the vertical and horizontal hat and Zee channels, and the fasteners. The structural properties of all other structural items are outside the scope of this evaluation and should be reviewed by the structural plans examiner of the requisite building department.

#### 8.0 Code Compliance

- 8.1 Product meets the High Velocity Hurricane Zone (HVHZ) Requirements of the Florida Building Code (FBC) 2020 for the properties evaluated.

#### 9.0 Identification:

- 9.1. Each Panel shall bear a permanent label with the manufacturer's name or logo, manufacturing plant's city, state and the statement reading "Miami-Dade County Product Control Approved" is to be located on each panel.

#### 10.0 Installation:

1. The Horizontal Hat Channels are spaced  $34\frac{3}{4}$  in o.c. vertically on the wall. These are fastened to the CMU support at 16 in o.c. (Drawing Page 8) using designated Fastener (section 11.2)
2. Vertical Hat Channels are spaced 10 ft on center (Drawing Page 9). They are fastened at the horizontal Zee channels ( $34\frac{3}{4}$  in o.c.) using designated fastener (section 11.3).
3. Vertical Zee Channels are fastened to the Horizontal Zee Channels between the Hat Channels at 16 in o.c. (See Drawing Page 9). These are fastened at the horizontal Zee channels ( $34\frac{3}{4}$  in o.c.) using designated fastener (section 11.3).

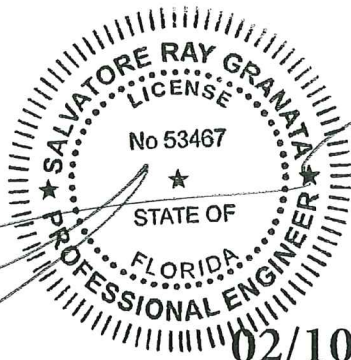

02/10/22

Engineer Salvatore Granata

Florida PE # 53467

[sal@srgpe.net](mailto:sal@srgpe.net)

(678) 367-3151

PRODUCT REVISED  
as complying with the Florida  
Building Code  
Acceptance No 19-0417.01  
Expiration Date APR 22 2024  
By Helga A. Melin  
Miami Dade Product Control

PRODUCT REVISED  
as complying with the Florida  
Building Code  
Acceptance No 23-0606.09  
Expiration Date 04/22/2029  
By Helga A. Melin  
Miami Dade Product Control

Distributor Swisspearl Imports  
12618 Verterans Memorial Parkway  
Wentzville, MO 63385

4. SWISSPEARL cement composite Panels are fastened to the vertical hat channels (at each end) and vertical Zee channels spaced between the hat channels (Drawing Page 10). These are fastened at each support (nominally 14.5 in o.c), and vertically nominally 8 in o.c. up the panel.

## 11.0 Components

### 11.1 Panel:

11.1.1	Material	Cement reinforced composite
11.1.2	Thickness:	5/16 in (8 mm)

### 11.2 Fasteners:

Fastens the horizontal Zee's to the CMU block support system

11.2.1	Manufacturer:	Tapcon
11.2.2	Type:	Masonry Fastener
11.2.3	Size:	1/4 in -14
11.2.4	Inbedment:	1 3/4" Minimum
11.2.5	Edge Distance:	1 1/4" Minimum
11.2.6	Head:	Hex head
11.2.7	Corrosion Resistance:	Stainless Steel

### 11.3 Fasteners:

Fastens the vertical Hats and Zee's to the horizontal Zee's.

Fastens the cement composite panel to the steel vertical Hats and Zee's.

11.3.1	Manufacturer:	SFS
11.3.2	Type:	Rivets
11.3.3	Designation:	SSO-D15
11.3.4	Size:	4.0 x 18mm
11.3.5	Corrosion Resistance:	Stainless Steel
11.3.6	Vertical fastener spacing:	8 in o.c. Maximum
11.3.7	Horizontal fastener spacing:	16 in o.c. Maximum

PRODUCT REVISED  
as complying with the Florida  
Building Code  
Acceptance No 23-0606.09  
Expiration Date 04/22/2029  
By Heidi A. Miller  
Miami Dade Product Control

PRODUCT REVISED  
as complying with the Florida  
Building Code  
Acceptance No 19-0417.01  
Expiration Date APR 22 2024  
By Heidi A. Miller  
Miami Dade Product Control

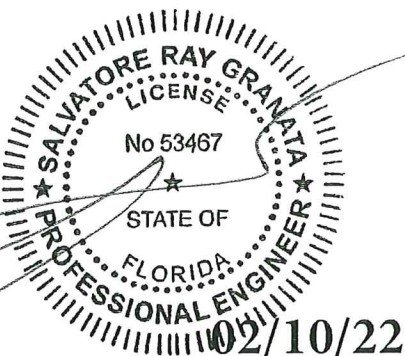

Engineer Salvatore Granata  
Florida PE # 53467  
[sal@srgpe.net](mailto:sal@srgpe.net)  
(678) 367-3151

Swisspearl Façade System

Distributor Swisspearl Imports  
12618 Verterans Memorial Parkway  
Wentzville, MO 63385

#### 11.4 Horizontal Supports:

Zee channel that is fastened to the steel support. The Vertical Hats and Zee channels are attached to this.

11.4.1	Type:	Zee Channel
11.4.2	Width:	3-1/8 in.
11.4.3	Height:	1-9/16 in.
11.4.4	Thickness:	16 Gauge
11.4.5	Material:	Steel
11.4.6	Corrosion Resistance:	Galvanized. G90
11.4.7	Spacing:	34 3/4" in o.c.

#### 11.5 Vertical, Supports:

Hat channel that is fastened to the Horizontal Zee channel. The cement composite panels are fastened to this support.

11.5.1	Type:	Hat Channel
11.5.2	Width:	5-1/2 in.
11.5.3	Height:	1-1/2 in.
11.5.4	Thickness:	16 Gauge
11.5.5	Material:	Steel
11.5.6	Corrosion Resistance:	Galvanized G90
11.5.7	Spacing:	9 ft 11-5/8 in o.c. (at panel joints)

Zee channel that is fastened to the Horizontal Zee channel. The cement composite panels are fastened to this support.

11.5.8	Type:	Zee Channel
11.5.9	Width:	3-1/8 in.
11.5.10	Height:	1-9/16 in.
11.5.11	Thickness:	16 Gauge
11.5.12	Material:	Steel
11.5.13	Corrosion Resistance:	Galvanized G90
11.5.14	Spacing:	14 1/2 in o.c.

PRODUCT REVISED  
as complying with the Florida  
Building Code  
Acceptance No 23-0606.09  
Expiration Date 04/22/2029  
By H. A. M. M.  
Miami Dade Product Control

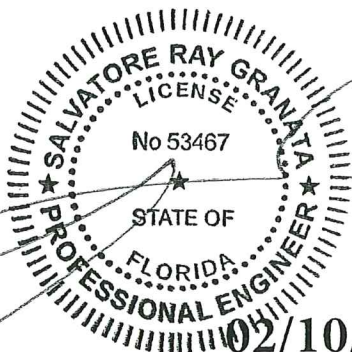

PRODUCT REVISED  
as complying with the Florida  
Building Code  
Acceptance No 19-0417.01  
Expiration Date APR 22 2024  
By H. A. M. M.  
Miami Dade Product Control

RECEIVED  
FEB 14 2022  
R.E.R.  
Product Control S.

Engineer Salvatore Granata  
Florida PE # 53467  
[sal@srgpe.net](mailto:sal@srgpe.net)  
(678) 367-3151

Swisspearl Façade System

Distributer Swisspearl Imports  
12618 Verterans Memorial Parkway  
Wentzville, MO 63385



### 11.6 Ventilation profile (Optional):

Perforated L piece that goes in multiple-edge locations.

11.6.1	Length:	98.5 in.
11.6.2	Width:	3-1/8 in.
11.6.3	Height:	1-9/16 in.
11.6.4	Thickness:	.027 in.
11.6.5	Material:	Aluminum

### 11.7 L-Flashing (Optional):

L-piece that goes in multiple edge locations.

11.7.1	Length:	98.5 in.
11.7.2	Width:	3-1/8 in.
11.7.3	Height:	1-9/16 in.
11.7.4	Thickness:	.027 in
11.7.5	Material:	Stainless Steel

### 12.0 Reference Data:

#### 12.1 Structural Performance

12.1.1 TAS 201, 202 & 203, Large Missile Impact Test, Air Infiltration Test, Uniform Static Air Pressure Test & Water Resistant Test & Cyclic Wind Pressure Loading, respectively.

By: Architectural Testing, Inc.

Report No.: 77956.01-109-18

Dated: 4/7/08 Revised Date: 12/08/08

#### 12.2 Fire Performance

12.2.1 ASTM E-84 &. ASTM E-136 Flame Spread Index / Smoke Density

By: Architectural Testing, Inc. (SGS U.S.)

Report No.: 170982

Dated: 11/20/02

#### 12.3 Material properties

12.3.1 ASTM C 1185-95 Test Specification for Non-Asbestos Fiber-Cement Flat Sheet, roofing and Siding Shingles, and Clapboards

By: Architectural-Testing, Inc.

Report No.: 01.42233.01

Dated: 11/20/02

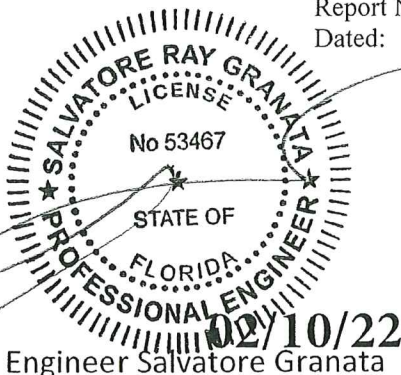

Engineer Salvatore Granata

Florida PE # 53467

[sal@srgpe.net](mailto:sal@srgpe.net)

(678) 367-3151

PRODUCT REVISED  
as complying with the Florida  
Building Code  
Acceptance No. 19-0417.01  
Expiration Date APR 22 2024  
By: *Helga A. McInerney*  
Miami Dade Product Control

PRODUCT REVISED  
as complying with the Florida  
Building Code  
Acceptance No. 23-0606.09  
Expiration Date 09/22/2029  
By: *Helga A. McInerney*  
Miami Dade Product Control

Distributor Swisspearl Imports  
12618 Verterans Memorial Parkway  
Wentzville, MO 63385

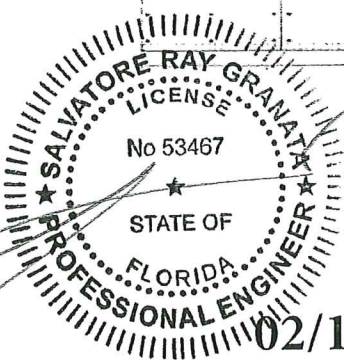
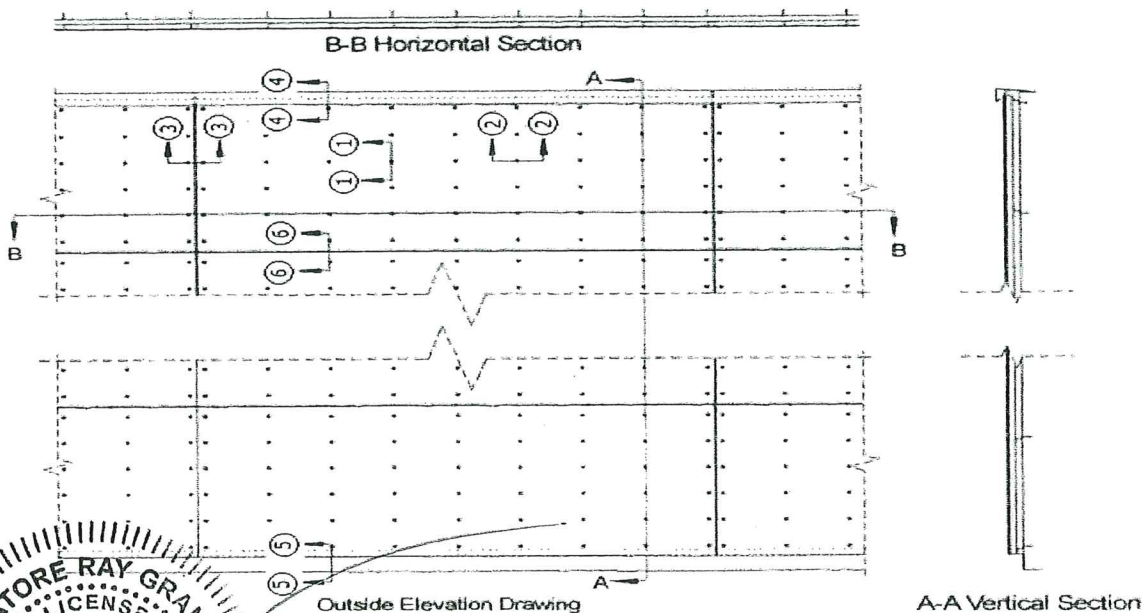
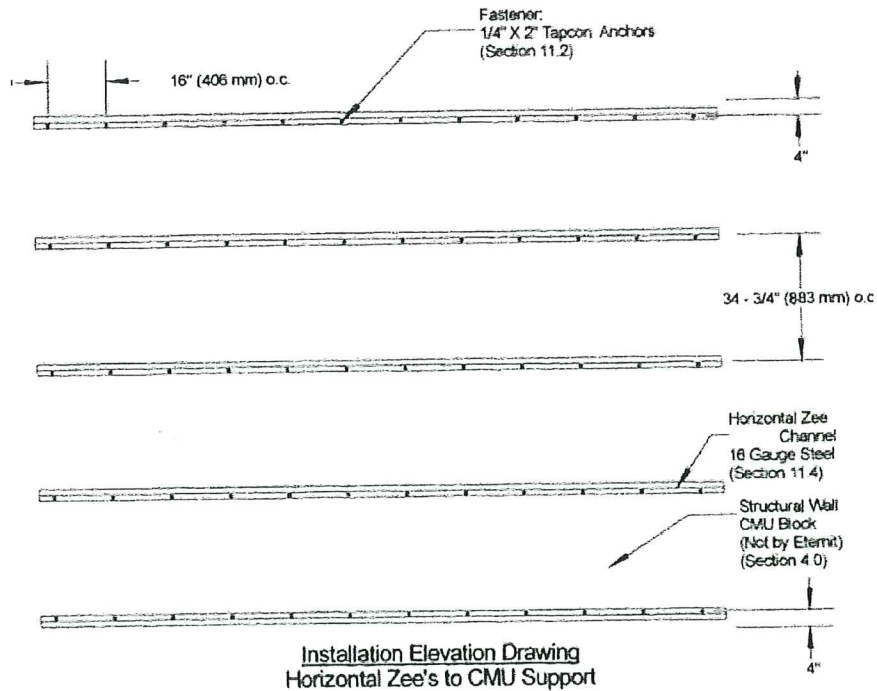

**02/10/22**  
 Engineer Salvatore Granata  
 Florida PE # 53467  
 sal@srgpe.net  
 (678) 367-3151

PRODUCT REVISED  
 as complying with the Florida  
 Building Code  
 Acceptance No. **19-0417.01**  
 Expiration Date **APR 22 2024**  
 By *Helga A. Miller*  
 Miami Dade Product Control

**PRODUCT REVISED**  
 as complying with the Florida  
 Building Code  
 Acceptance No. **23-0606.09**  
 Expiration Date **04/22/2029**  
 By *Helga A. Miller*  
 Miami Dade Product Control

Distributor Swisspearl Imports  
 12618 Verterans Memorial Parkway  
 Wentzville, MO 63385

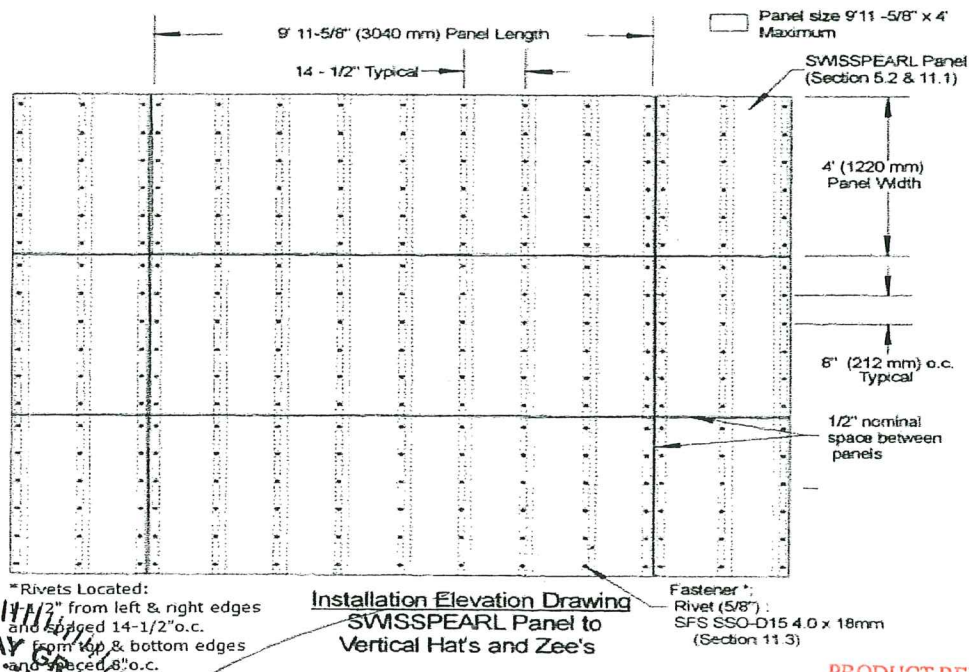
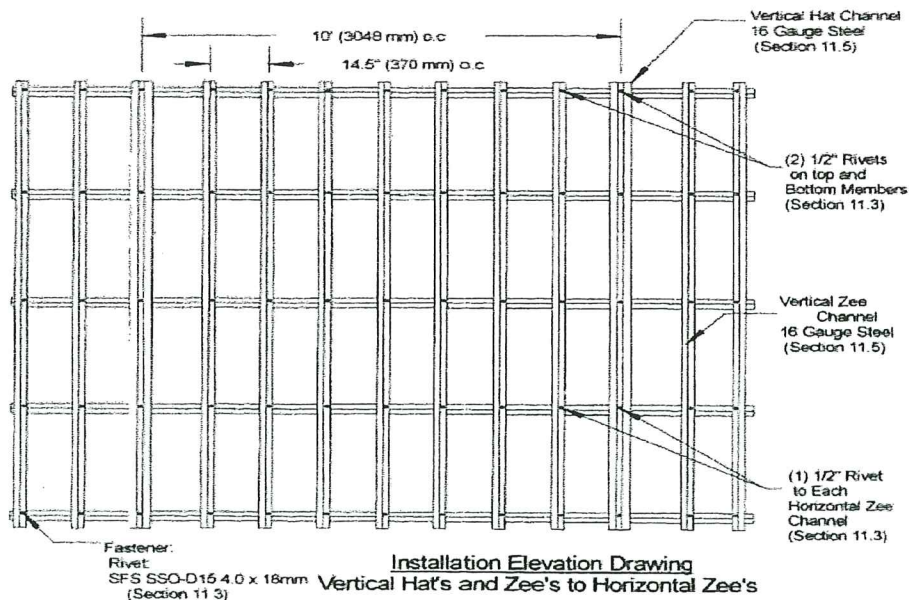

**Salvatore Ray Granata**  
LICENSE  
No 53467  
STATE OF  
FLORIDA  
PROFESSIONAL ENGINEER  
02/10/22  
Engineer Salvatore Granata  
Florida PE # 53467  
sal@srgpe.net  
(678) 367-3151

PRODUCT REVISED  
as complying with the Florida  
Building Code  
Acceptance No 19-0417.01  
Expiration Date APR 22 2024  
By *Hely A. Noh*  
Miami Date Product Control

PRODUCT REVISED  
as complying with the Florida  
Building Code  
Acceptance No 23-0606.09  
Expiration Date 04/22/2027  
By *Hely A. Noh*  
Miami Date Product Control

Distributor Swisspearl Imports  
12618 Verterans Memorial Parkway  
Wentzville, MO 63385



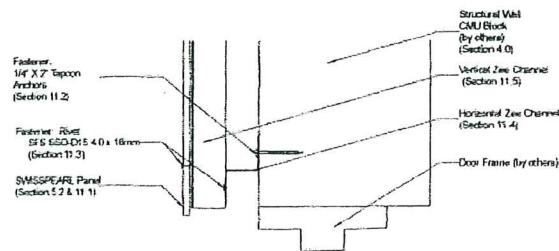
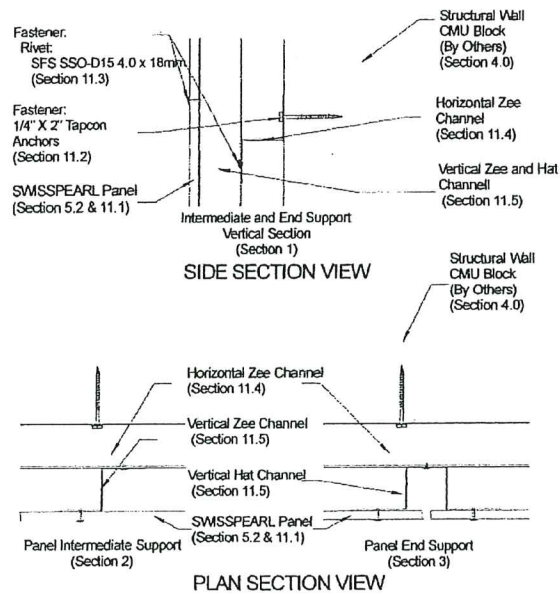

Typical Door Head Section

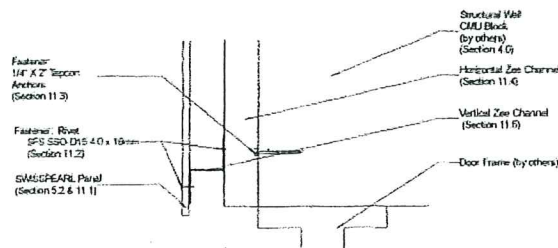

Typical Door Jamb Section

PRODUCT REVISED  
as complying with the Florida  
Building Code  
Acceptance No **23-0606.09**  
Expiration Date **09/22/2029**  
By *H. A. M. M.*  
Miami Dade Product Control

PRODUCT REVISED  
as complying with the Florida  
Building Code  
Acceptance No **19-0417.01**  
Expiration Date **APR 22 2024**  
By *H. A. M. M.*  
Miami Dade Product Control

**SALVATORE RAY GRANATA**  
LICENSE  
No 53467  
STATE OF  
FLORIDA  
PROFESSIONAL ENGINEER  
**02/10/22**  
Engineer Salvatore Granata  
Florida PE # 53467  
[sal@srgpe.net](mailto:sal@srgpe.net)  
(678) 367-3151

Distributor Swisspearl Imports  
12618 Verterans Memorial Parkway  
Wentzville, MO 63385

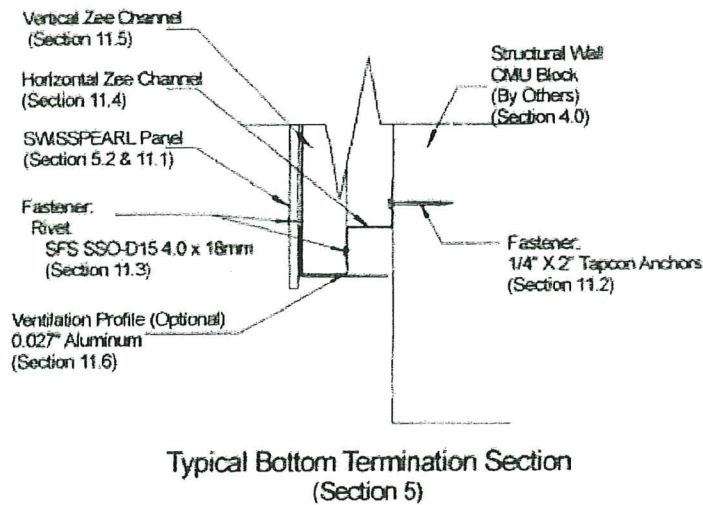
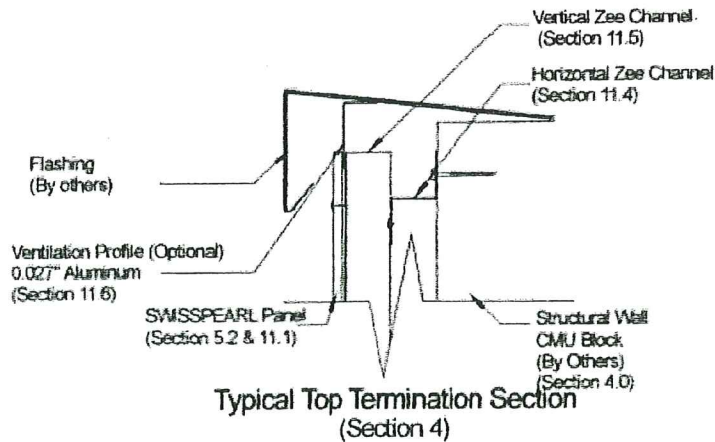

PRODUCT REVISED  
as complying with the Florida  
Building Code  
Acceptance No 23-0606.09  
Expiration Date 04/22/2029  
By Hesya A. Mohr  
Miami Dade Product Control

PRODUCT REVISED  
as complying with the Florida  
Building Code  
Acceptance No 19-0417.01  
Expiration Date APR 22 2024  
By Hesya A. Mohr  
Miami Dade Product Control

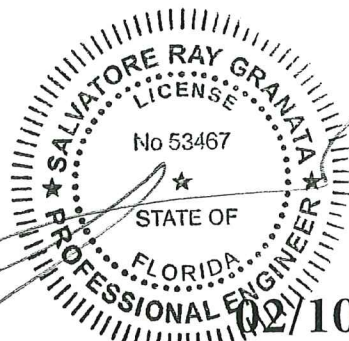

**02/10/22**  
Engineer Salvatore Granata  
Florida PE # 53467  
[sal@srgpe.net](mailto:sal@srgpe.net)  
(678) 367-3151

Distributor Swisspearl Imports  
12618 Verterans Memorial Parkway  
Wentzville, MO 63385

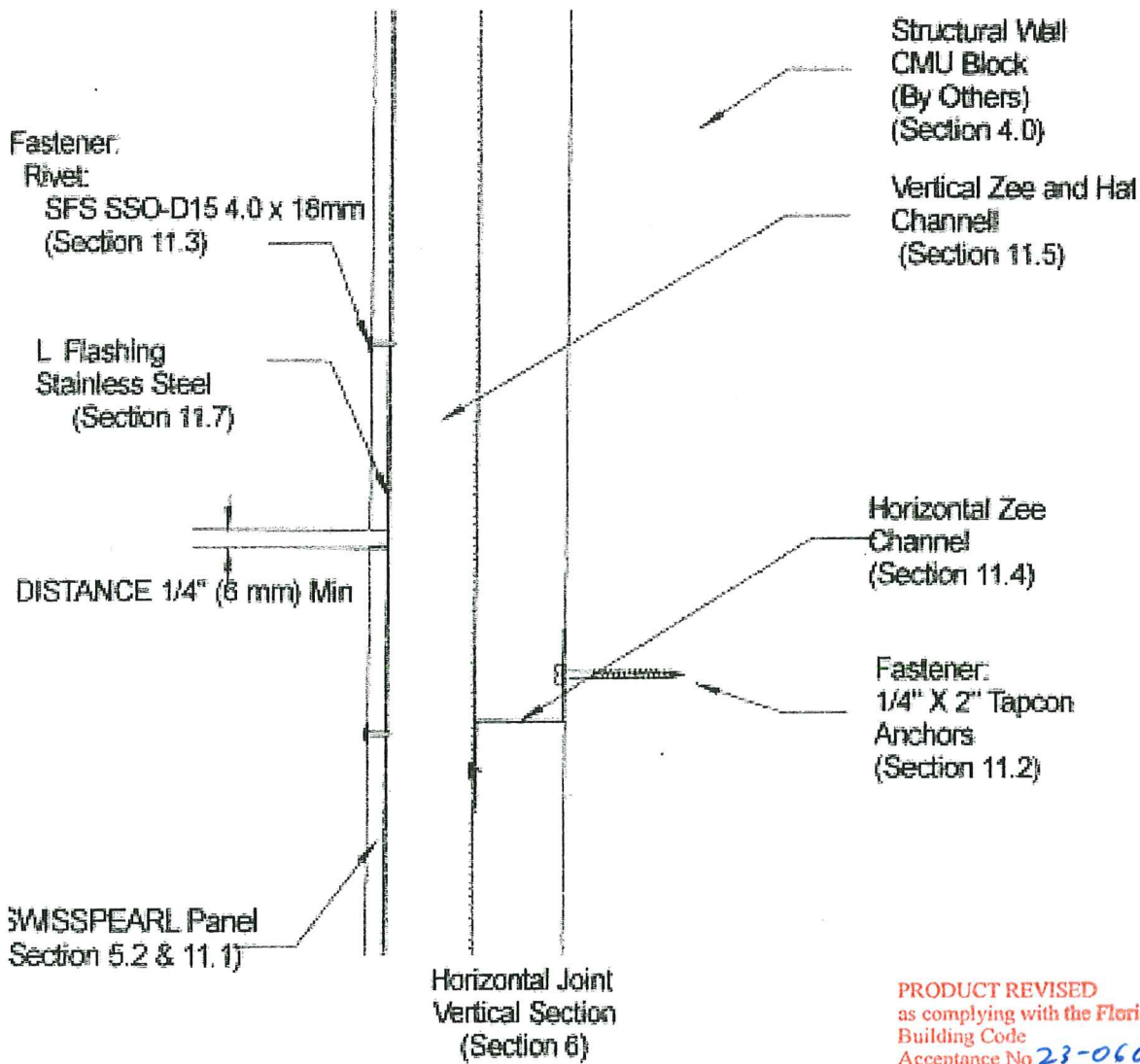

## SIDE SECTION VIEW

PRODUCT REVISED  
as complying with the Florida  
Building Code  
Acceptance No 23-0606.09  
Expiration Date 04/22/2029  
By Hely A. Mahr  
Miami Dade Product Control

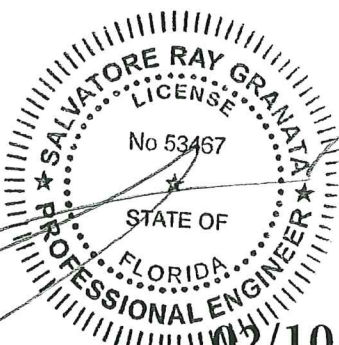

Engineer Salvatore Granata  
Florida PE # 53467  
[sal@srgpe.net](mailto:sal@srgpe.net)  
(678) 367-3151

PRODUCT REVISED  
as complying with the Florida  
Building Code  
Acceptance No 19-0417.01  
Expiration Date APR 22 2024  
By Hely A. Mahr  
Miami Dade Product Control

RECEIVED  
FEB 14 2022  
R.E.R.  
Product Control Section

Distributor Swisspearl Imports  
12618 Verterans Memorial Parkway  
Wentzville, MO 63385  
Swisspearl Façade System



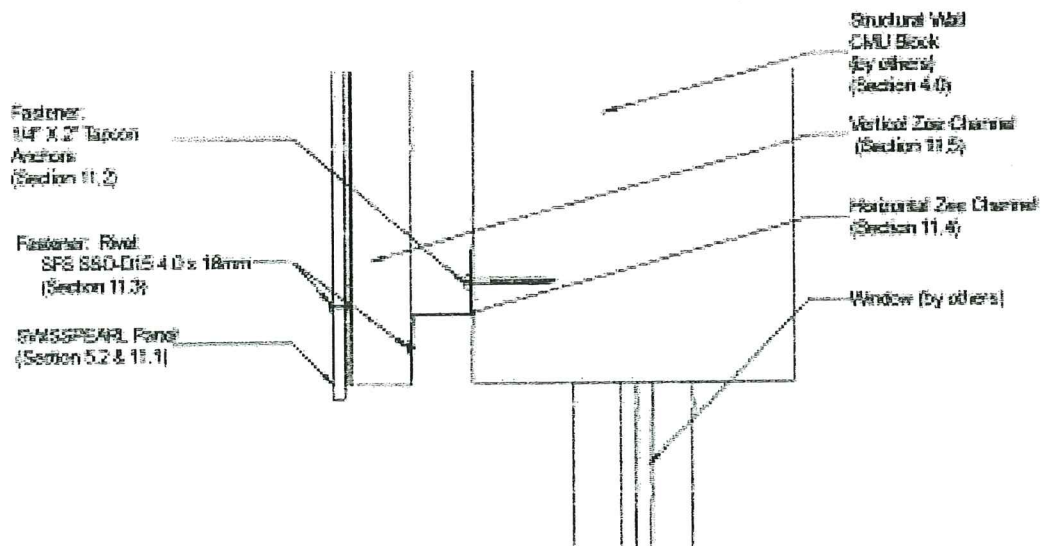

Typical Window Head Section

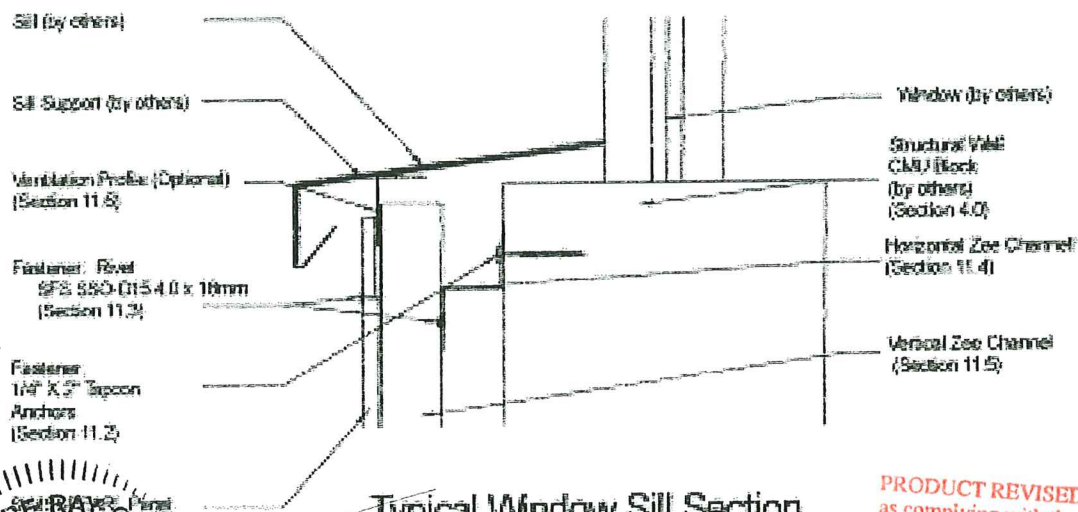

Typical Window Sill Section

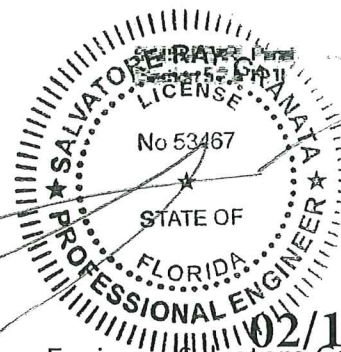

Engineer Salvatore Granata  
Florida PE # 53467  
[sal@srgpe.net](mailto:sal@srgpe.net)  
(678) 367-3151

PRODUCT REVISED  
as complying with the Florida  
Building Code  
Acceptance No 19-0417.01  
Expiration Date ADD 2 2 2024  
By [Signature]  
Miami Date Product Control

PRODUCT REVISED  
as complying with the Florida  
Building Code  
Acceptance No 23-0606.09  
Expiration Date 04/22/2029  
By [Signature]  
Miami Date Product Control

Distributor Swisspearl Imports  
12618 Verterans Memorial Parkway  
Wentzville, MO 63385

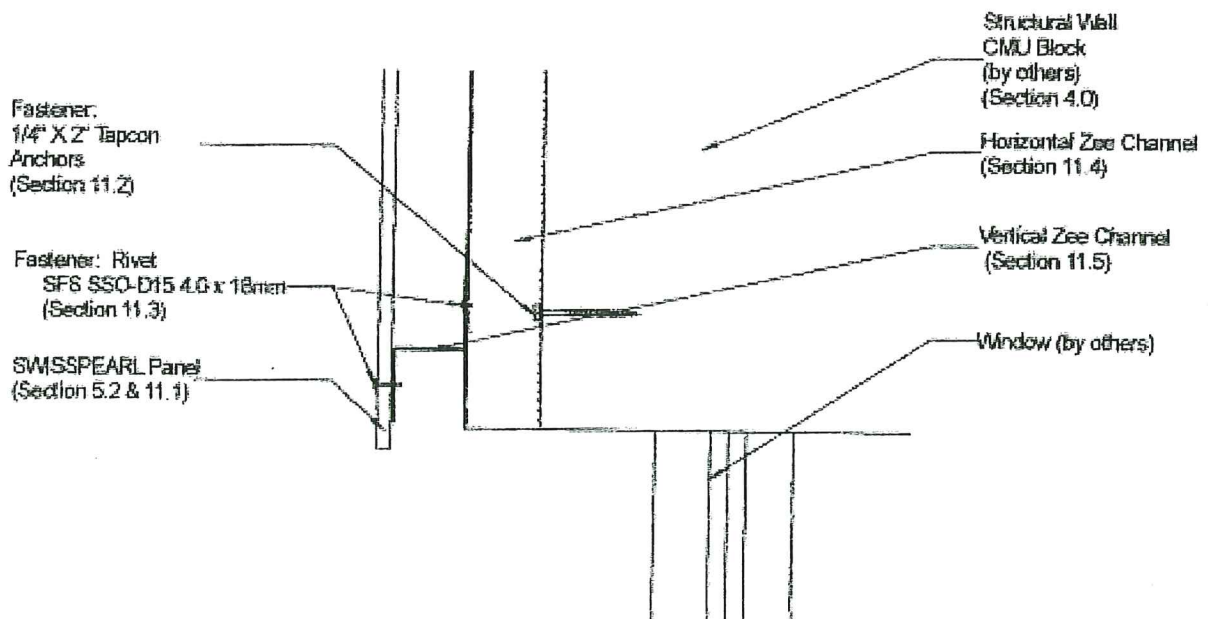

Typical Window Jamb Section

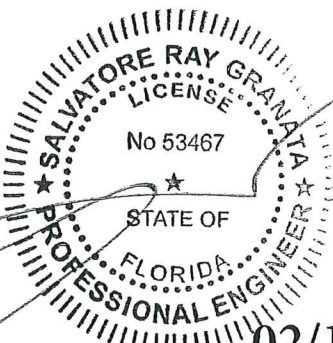

02/10/22

Engineer Salvatore Granata

Florida PE # 53467

[sal@srgpe.net](mailto:sal@srgpe.net)

(678) 367-3151

PRODUCT REVISED  
as complying with the Florida  
Building Code  
Acceptance No. 19-0417-01  
Expiration Date APR 22 2024  
By H. G. A. Miller  
Miami Dade Product Control

PRODUCT REVISED  
as complying with the Florida  
Building Code  
Acceptance No. 23-0606.09  
Expiration Date 04/22/2029  
By H. G. A. Miller  
Miami Dade Product Control

Distributor Swisspearl Imports

12618 Verterans Memorial Parkway

Wentzville, MO 63385

Swisspearl Façade System

**0.0 System Support Type S(1): Vertical Steel Support 13-5/16" spacing**

**1.0 Product**

- 1.1 Manufacturer** Eternit (Schweiz) AG
- 1.2 Product Name** SWSSPEARL® Facade System
- 1.3 Category** Panels
- 1.4 Sub Category** Walls

**2.0 Evaluation Scope:**

**2.1 Evaluation Criteria:**

- 2.1.1** Florida Building Code (FBC) 2020  
Code Section: High Velocity Hurricane Zone (HVHZ)
- 2.1.2** Miami-Dade Building Code Compliance Office (BCCO) Checklist

**2.2 Properties Evaluated:**

- 2.2.1** Wind Resistance Properties
  - 2.2.1.1** Uniform Static Air Pressure
  - 2.2.1.2** Large Missile Impact
  - 2.2.1.3** Cyclic Wind Pressure
- 2.2.2** Fire Resistance Properties
- 2.2.3** Panel Material Properties

**2.3 Limits of Evaluation:**

This product is limited to compliance with the criteria in section 2.1 and properties in section 2.2 of this report

**3.0 Evaluates Uses:**

SWISSPEARL Wall Panels are used as nonbearing exterior (facade) wall panels.

**4.0 Support:** The Support assembly is designed by others and shall have the following minimum Characteristics

**4.1 Studs**

- 4.1.1** Material: Steel
- 4.1.2** Thickness: 16 Ga. (0.062 in)
- 4.1.3** Face Width: 2 - 1/4 in Minimum
- 4.1.4** Spacing: 16 in Maximum

**PRODUCT REVISED**  
as complying with the Florida  
Building Code  
Acceptance No 23-0606.09  
Expiration Date 04/22/2029  
By H. G. A. M. L.  
Miami Dade Product Control

**PRODUCT REVISED**  
as complying with the Florida  
Building Code  
Acceptance No 19-0417.01  
Expiration Date APR 22 2024  
By H. G. A. M. L.  
Miami Dade Product Control

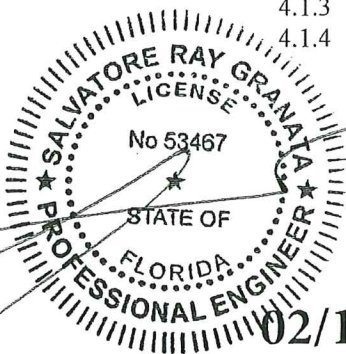

**02/10/22**

Engineer Salvatore Granata  
Florida PE # 53467  
[sal@srgpe.net](mailto:sal@srgpe.net)  
(678) 367-3151

Swisspearl Façade System

Distributor Swisspearl Imports  
12618 Veterans Memorial Parkway  
Wentzville, MO 63385



#### 4.2 Sheathing

- |       |                             |                       |
|-------|-----------------------------|-----------------------|
| 4.2.1 | Material:                   | 5/8" 5 Ply Plywood    |
| 4.2.2 | Thickness:                  | 5/8 in                |
| 4.2.3 | (Optional additional layer) | 5/8" Type "X" Drywall |

#### 4.3 Sheathing Fasteners

- |       |                       |  |
|-------|-----------------------|--|
| 4.3.1 | Type:                 | Drywall Screws, Self-Tapping             |
| 4.3.2 | Size:                 | #6 x 1- 5/8 in                           |
| 4.3.3 | Corrosion Resistance: | Phosphate coated                         |
| 4.3.4 | Fastener spacing:     | 12 in o.c. around perimeter at each stud |

#### 5.0 Description:

##### 5.1 General:

The SWISSPEARL cement composite facade wall panels are riveted to a steel sub-frame.  
The steel sub-frame is fastened into the Steel stud support Wall.

##### 5.2 Panel Dimensions:

- |       |                   |               |
|-------|-------------------|---------------|
| 5.2.1 | Length (Maximum): | 9 ft 11-5/8in |
| 5.2.2 | Width (Maximum):  | 4 ft          |
| 5.2.3 | Thickness:        | 5/16 in       |

#### 6.0 Performance

##### 6.1 Wind. Resistance:

- |        |                       |                 |                |
|--------|-----------------------|-----------------|----------------|
| 6.1.1. | Design Pressures      | <b>Positive</b> | <b>+95 psf</b> |
|        |                       | <b>Negative</b> | <b>-95 psf</b> |
|        | Panel Span:           | 13-5/16" o.c.   |                |
|        | Panel Span Condition: | 3 or more spans |                |

##### 6.1.2 Uniform Static Air Pressure Test:

- |         |           |         |
|---------|-----------|---------|
| 6.1.2.1 | Standard: | TAS 202 |
| 6.1.2.2 | Results:  | Passed  |

##### 6.1.3 Cyclic Air Pressure Test

- |         |           |         |
|---------|-----------|---------|
| 6.1.3.1 | Standard: | TAS 203 |
| 6.1.3.2 | Results:  | Passed  |

##### 6.2 Impact Rating:

- |       |                       |         |
|-------|-----------------------|---------|
| 6.2.1 | Large Missile Impact: | TAS 201 |
| 6.2.2 | Standard              | Passed  |
| 6.2.3 | Results               |         |

PRODUCT REVISED  
as complying with the Florida  
Building Code  
Acceptance No 23-0606.09  
Expiration Date 04/22/2029  
By Healy A. Maly  
Miami Dade Product Control

PRODUCT REVISED  
as complying with the Florida  
Building Code  
Acceptance No 19-0417.01  
Expiration Date APR 7 2024  
By Healy A. Maly  
Miami Dade Product Control

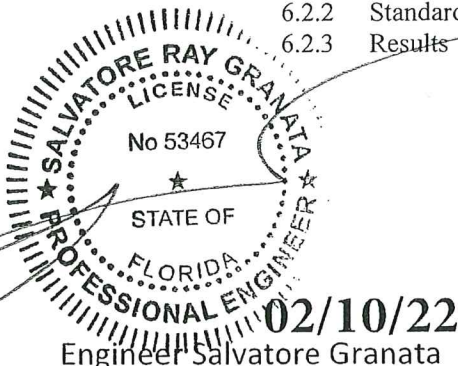

Distributor Swisspearl Imports  
12618 Verterans Memorial Parkway  
Wentzville, MO 63385

### 6.3 Fire Resistance

6.3.1	Test Standard:	E - 84 / E-136
6.3.2	Results:	Flame Spread: 0
		Smoke Density: 15

### 6.4 Panel Material Properties

6.4.1	Test Standard:	ASTM C 1185 - 95
6.4.2	Results	Passed

### 7.0 Limitations of Use:

- 7.1 Maximum Panel span 16 in.
- 7.2 Maximum Panel Deflection shall be L/180.
- 7.3 Diaphragm and axial load capacity is outside the "scope of this evaluation.
- 7.4 This evaluation is limited to the wall panel, the vertical and horizontal hat and Zee channels, and the fasteners. The structural properties of all other structural items (beams, columns, purlins, fascia supports etc.) are outside the scope of this evaluation and should be reviewed by the structural plans examiner of the requisite building department.

### 8.0 Code Compliance

- 8.1 Product meets the High Velocity Hurricane Zone (HVHZ) Requirements of the Florida Building Code (FBC) 2020 for the properties evaluated.

### 9.0 Identification:

- 9.1. Each Panel shall bear a permanent label with the manufacturer's name or logo, manufacturing plant's city, state and the statement reading "Miami-Dade County Product Control Approved" is to be located on each panel.

### 10.0 Installation:

1. The Horizontal Zee Channels are spaced 34-3/4 in o.c. vertically on the wall. These are fastened to the Steel support at each stud (16 in o.c.) through the 5/8" plywood using ONE designated Fasteners.
2. Vertical Hat Channels are spaced 10 ft on center. They are fastened to the horizontal Zee channels (34-3/4 in o.c.) using designated fastener.

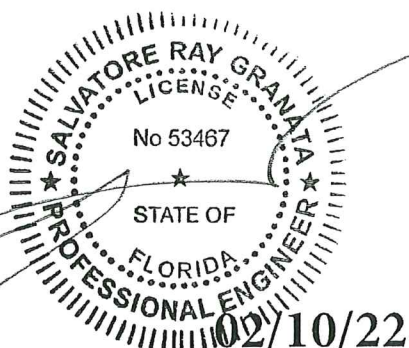

Engineer Salvatore Granata

Florida PE # 53467

[sal@srgpe.net](mailto:sal@srgpe.net)

(678) 367-3151

PRODUCT REVISED  
as complying with the Florida  
Building Code  
Acceptance No. 19-0417.01  
Expiration Date APR 22 2024  
By *H. G. A. M. M.*  
Miami Dade Product Control

PRODUCT REVISED  
as complying with the Florida  
Building Code  
Acceptance No. 23-0606.09  
Expiration Date 04/23/2029  
By *H. G. A. M. M.*  
Miami Dade Product Control

Distributor Swisspearl Imports  
12618 Veterans Memorial Parkway  
Wentzville, MO 63385

3. Vertical Zee Channels are fastened to the Horizontal Zee Channels between the Hat Channels at 16 in o.c. These are fastened at the horizontal Zee channels (34-3/4 in o.c.) using designated fastener.
4. SWISSPEARL cement composite Panels are fastened to the vertical Zee channels (at each end) and vertical Zee channels spaced between the hat channels. These are fastened at each support (nominally 13-5/16 in o.c.), and vertically nominally 7 in o.c. up the panel.

## 11.0 Components

### 11.1 Panel:

11.1.1	Material	Cement reinforced composite
11.1.2	Thickness:	5/16 in (8 mm)

### 11.2 Fasteners:

Fastens the horizontal Zee's to the Steel Stud support system

11.2.1	Type:	Self Tapping Screw
11.2.2	Size:	#6 x 1-5/8 in
11.2.3	Number per Intersection:	1
11.2.4	Head:	Hex head
11.2.5	Corrosion Resistance:	Phosphate coated

### 11.3 Fasteners:

Fastens the vertical Hats and Zee's to the horizontal Zee's.

Fastens the cement composite panel to the steel vertical Hats and Zee's.

11.3.1	Manufacturer:	SFS
11.3.2	Type:	Rivets
11.3.3	Designation:	SSO-D15
11.3.4	Size:	4.0 x 18mm
11.3.5	Corrosion Resistance:	Stainless Steel
11.3.6	Vertical fastener spacing:	8 in o.c. Maximum
11.3.7	Horizontal fastener spa	16in o.c. Maximum

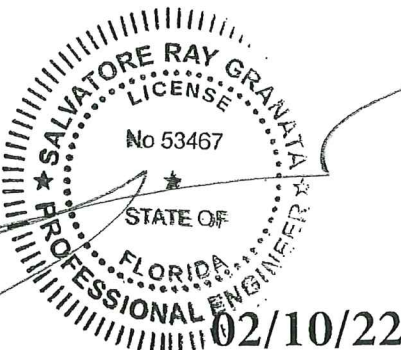

Engineer Salvatore Granata  
Florida PE # 53467  
[sal@srgpe.net](mailto:sal@srgpe.net)  
(678) 367-3151

PRODUCT REVISED  
as complying with the Florida  
Building Code  
Acceptance No 19-0417-01  
Expiration Date APR 22 2024  
By *Heidi A. Mator*  
Miami Dade Product Control

PRODUCT REVISED  
as complying with the Florida  
Building Code  
Acceptance No 23-0606-09  
Expiration Date 09/22/2029  
By *Heidi A. Mator*  
Miami Dade Product Control

Distributor Swisspearl Imports  
12618 Verterans Memorial Parkway  
Wentzville, MO 63385



#### 11.4 Horizontal Supports

Zee channel that is fastened to the steel support. The Vertical Hats and Zee channels are attached to this.

11.4.1	Type:	Zee Channel.
11.4.2	Width:	3-1/8 in.
11.4.3	Height:	1-9/16 in.
11.4.4	Thickness:	16 Gauge
11.4.5	Material:	Steel
11.4.6	Corrosion Resistance:	Galvanized G90
11.4.7	Spacing:	34-3/4 in o.c.

#### 11.5 Vertical Supports:

Hat channel that is fastened to the Horizontal Zee channel. The cement composite panels are fastened to this support.

11.5.1	Type:	Zee Channel
11.5.2	Width:	3-1/8 in
11.5.3	Height:	1-9/16 in.
11.5.4	Thickness:	16 Gauge
11.5.5	Material:	Steel
11.5.6	Corrosion Resistance:	Galvanized G90
11.5.7	Spacing:	7 in o.c. (at panel joints)

#### 11.6 Ventilation profile (Optional):

Perforated L piece that goes in multiple edge locations.

11.6.1	Length:	98.5 in.
11.6.2	Width:	3-1/8 in.
11.6.3	Height:	1-9/16 in.
11.6.4	Thickness:	.027 in
11.6.5	Material:	Aluminum

PRODUCT REVISED  
as complying with the Florida  
Building Code  
Acceptance No 23-0606.09  
Expiration Date 04/22/2029  
By Healy A. Mohr  
Miami Dade Product Control

PRODUCT REVISED  
as complying with the Florida  
Building Code  
Acceptance No 19-0417.01  
Expiration Date APR 12 2024  
By Healy A. Mohr  
Miami Dade Product Control

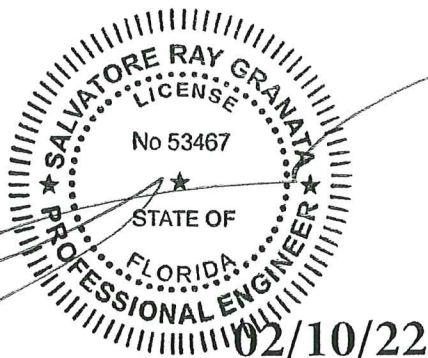

Engineer Salvatore Granata  
Florida PE # 53467

[sal@srgpe.net](mailto:sal@srgpe.net)  
(678) 367-3151

Swisspearl Façade System

Distributor Swisspearl Imports  
12618 Veterans Memorial Parkway  
Wentzville, MO 63385

### 11.7 L-Flashing (Optional):

L piece that goes in multiple edge locations

11.7.1	Length:	98.5 in.
11.7.2	Width:	3-1/8 in.
11.7.3	Height:	1-9/16 in.
11.7.4	Thickness:	.027 in.
11.7.5	Material:	Stainless Steel

### 12.0 Reference Data:

#### 12.1 Structural Performance

12.1.1 TAS 201, 202 & 203, Large Missile Impact Test, Air Infiltration Test, Uniform Static Air Pressure Test & Water Resistant Test & Cyclic Wind Pressure Loading, respectively.

By: Farabaugh Engineering and Testing Inc.

Report Ne: T301-20

Dated: 8/12/2020 Revised Date: NA

#### 12.2 Fire Performance

12.2.1 ASTM E-84 & ASTM E-136 Flame Spread Index / Smoke Density

By: Architectural Testing, Inc. (SGS U.S.)

Report No. 170982

Dated: 11/20/02

#### 12.3 Material properties

12.3.1 ASTM C 1185-95 Test Specification for Non-Asbestos Fiber-Cement Flat Sheet, roofing and Siding Shingles, and Clapboards

By: Architectural Testing, Inc.

Report No.: 01.42233.01

Dated: 11/20/02

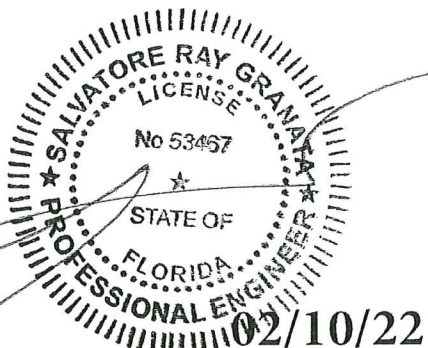

Engineer Salvatore Granata

Florida PE # 53467

[sal@srgpe.net](mailto:sal@srgpe.net)

(678) 367-3151

PRODUCT REVISED  
as complying with the Florida  
Building Code  
Acceptance No 19-0417.01  
Expiration Date APR 22 2024  
By *Heidi A. Malt*  
Miami Dade Product Control

PRODUCT REVISED  
as complying with the Florida  
Building Code  
Acceptance No 23-0606.09  
Expiration Date 04/22/2029  
By *Heidi A. Malt*  
Miami Dade Product Control

Distributor Swisspearl Imports  
12618 Verterans Memorial Parkway  
Wentzville, MO 63385

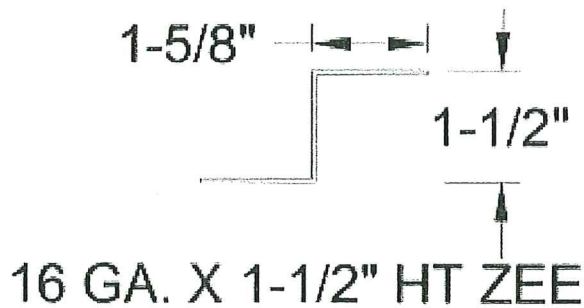
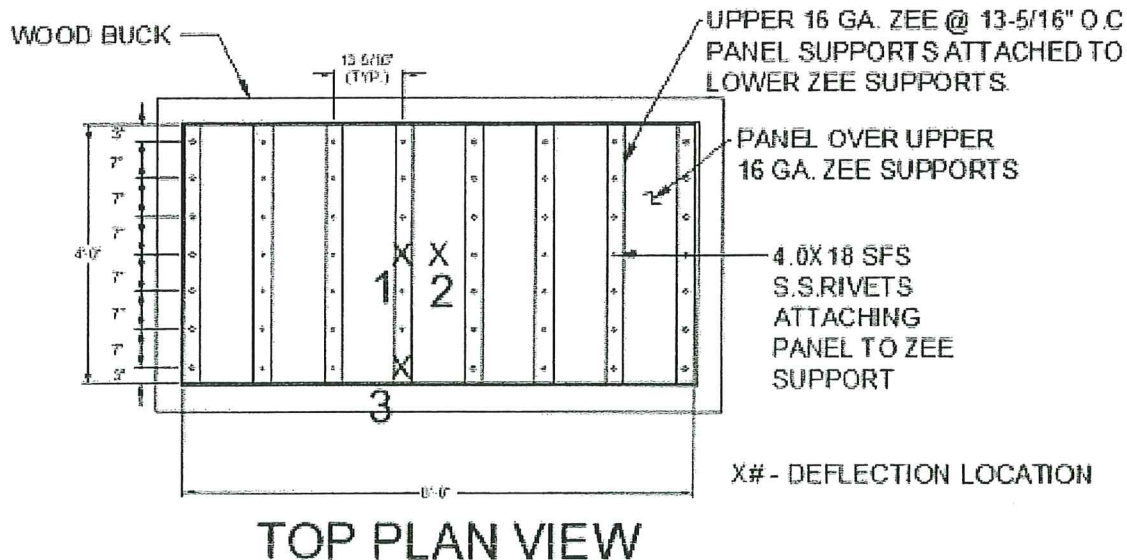

PRODUCT REVISED  
as complying with the Florida  
Building Code  
Acceptance No 23-0608.09  
Expiration Date 09/22/2029  
By H. G. A. Miller  
Miami Dade Product Control

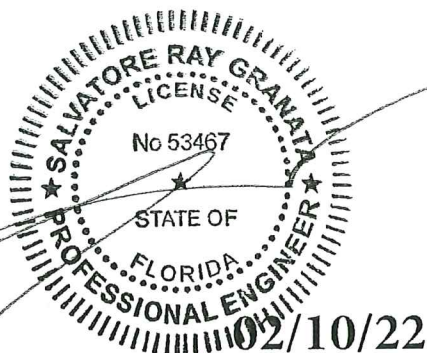

Engineer Salvatore Granata  
Florida PE # 53467  
[sal@srgpe.net](mailto:sal@srgpe.net)  
(678) 367-3151

PRODUCT REVISED  
as complying with the Florida  
Building Code  
Acceptance No 19-0417.01  
Expiration Date APR 22 2024  
By H. G. A. Miller  
Miami Dade Product Control

RECEIVED  
FEB 14 2022  
R.E.R.  
Product Control Section

Distributor Swisspearl Imports  
12618 Verterans Memorial Parkway  
Wentzville, MO 63385

Swisspearl Façade System



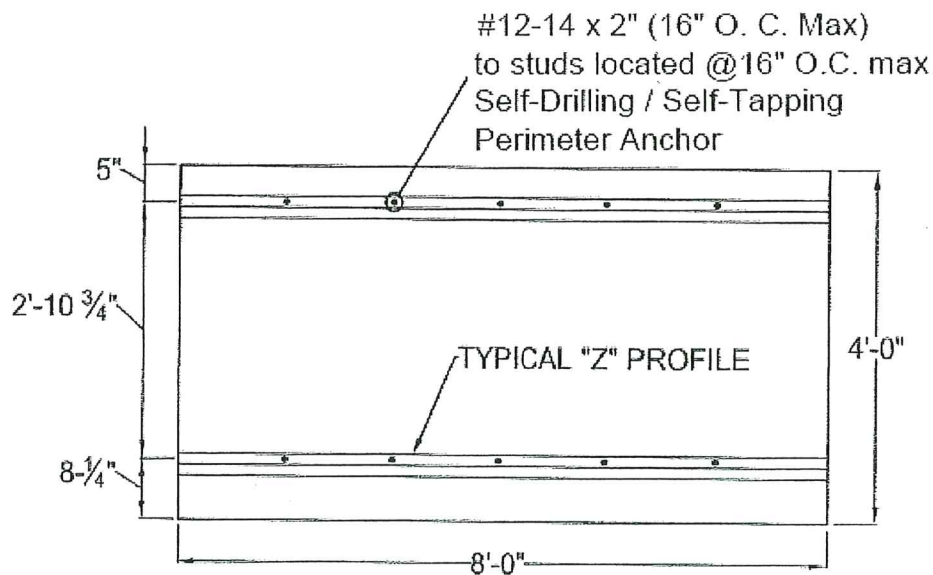

## SUB-FRAMING

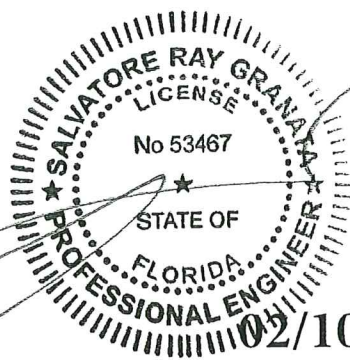

02/10/22

Engineer Salvatore Granata  
Florida PE # 53467  
[sal@srgpe.net](mailto:sal@srgpe.net)  
(678) 367-3151

PRODUCT REVISED  
as complying with the Florida  
Building Code  
Acceptance No. 19-0417.01  
Expiration Date APR 22 2024  
By *Heidi A. Miller*  
Miami Dade Product Control

PRODUCT REVISED  
as complying with the Florida  
Building Code  
Acceptance No. 23-0606.09  
Expiration Date 04/22/2029  
By *Heidi A. Miller*  
Miami Dade Product Control

Distributor Swisspearl Imports  
12618 Verterans Memorial Parkway  
Wentzville, MO 63385

Engineer Salvatore Granata  
Florida PE # 53467

Swisspearl Façade System

NOA 14-0605.07

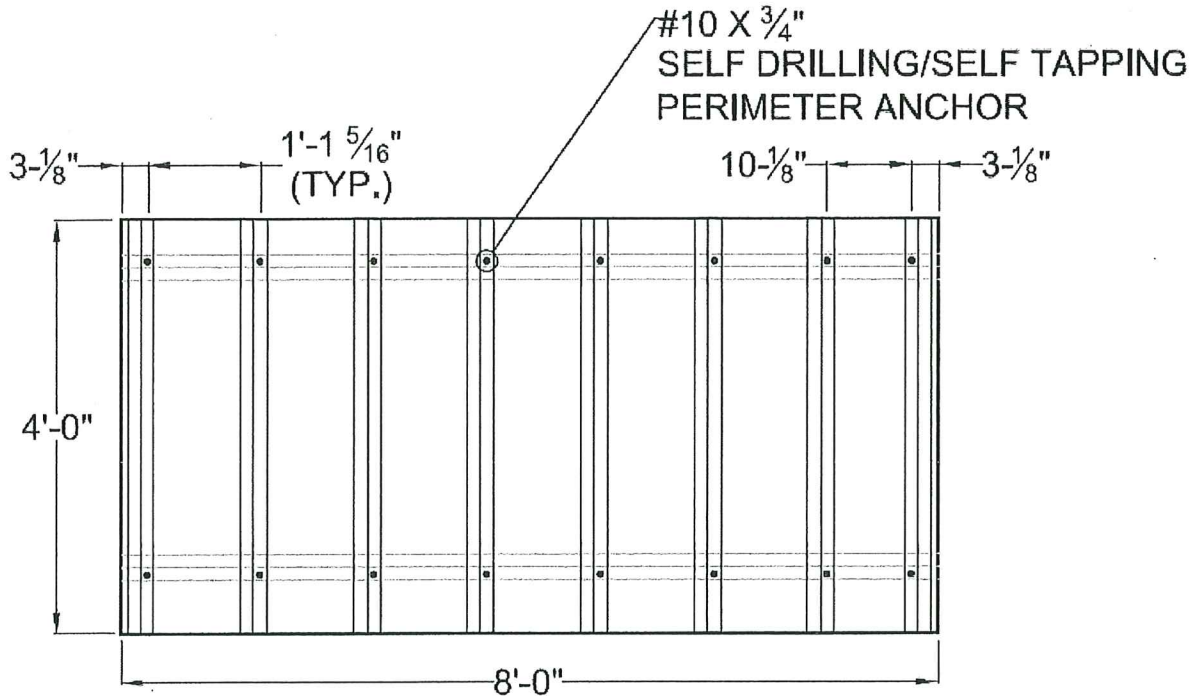

## Z-PANEL SUBFRAME

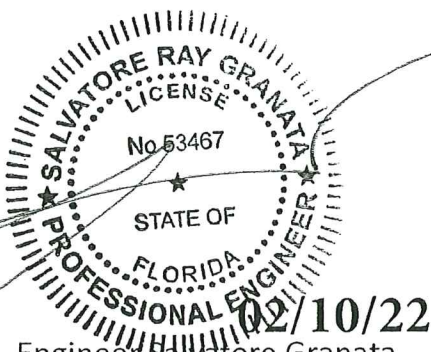

Engineer Salvatore Granata  
Florida PE # 53467

[sal@srgpe.net](mailto:sal@srgpe.net)

(678) 367-3151

PRODUCT REVISED  
as complying with the Florida  
Building Code  
Acceptance No. 19-0417.01  
Expiration Date APR 22 2024  
By *Healy A. Malin*  
Miami Data Product Control

PRODUCT REVISED  
as complying with the Florida  
Building Code  
Acceptance No. 23-0606.09  
Expiration Date 09/22/2029  
By *Healy A. Malin*  
Miami Data Product Control

Distributor Swisspearl Imports  
12618 Verterans Memorial Parkway  
Wentzville, MO 63385

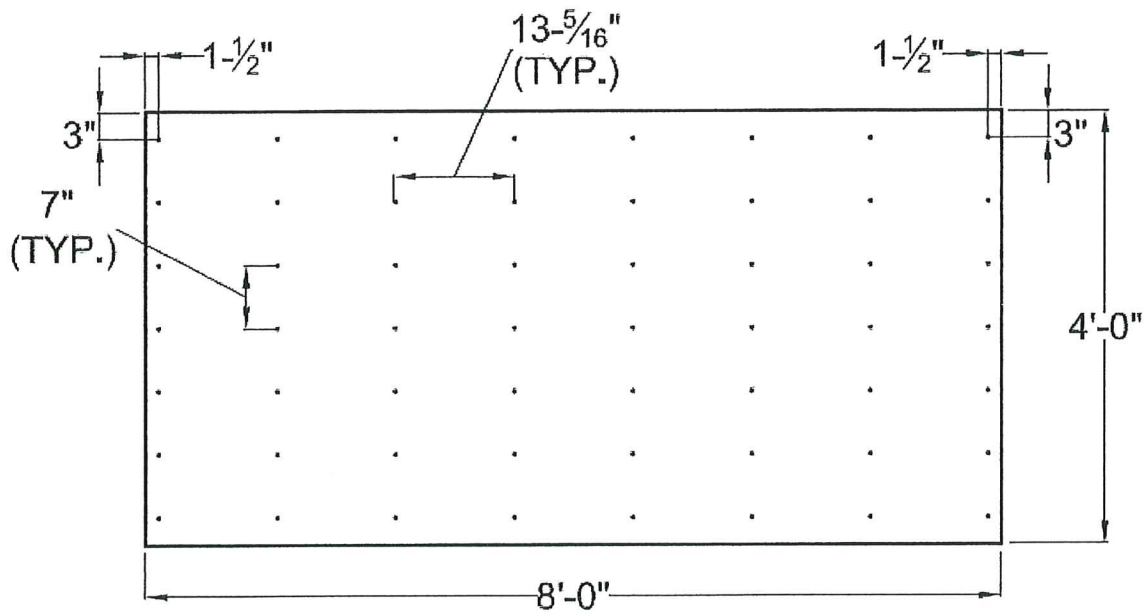

## SWISSPEARL PANEL

PRODUCT REVISED  
as complying with the Florida  
Building Code  
Acceptance No 23-0606.09  
Expiration Date 04/22/2029

By H. G. A. M. M.  
Miami Date Product Control

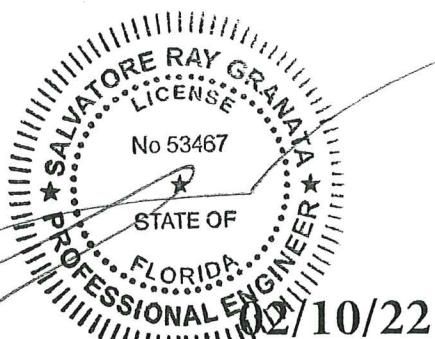

Engineer Salvatore Granata  
Florida PE # 53467  
[sal@srgpe.net](mailto:sal@srgpe.net)  
(678) 367-3151

PRODUCT REVISED  
as complying with the Florida  
Building Code  
Acceptance No 19-0417.01  
Expiration Date APR 22 2024  
By H. G. A. M. M.  
Miami Date Product Control

RECEIVED  
FEB 14 2022

R.E.R.  
Product Control Section

Distributor Swisspearl Imports  
12618 Verterans Memorial Parkway  
Wentzville, MO 63385



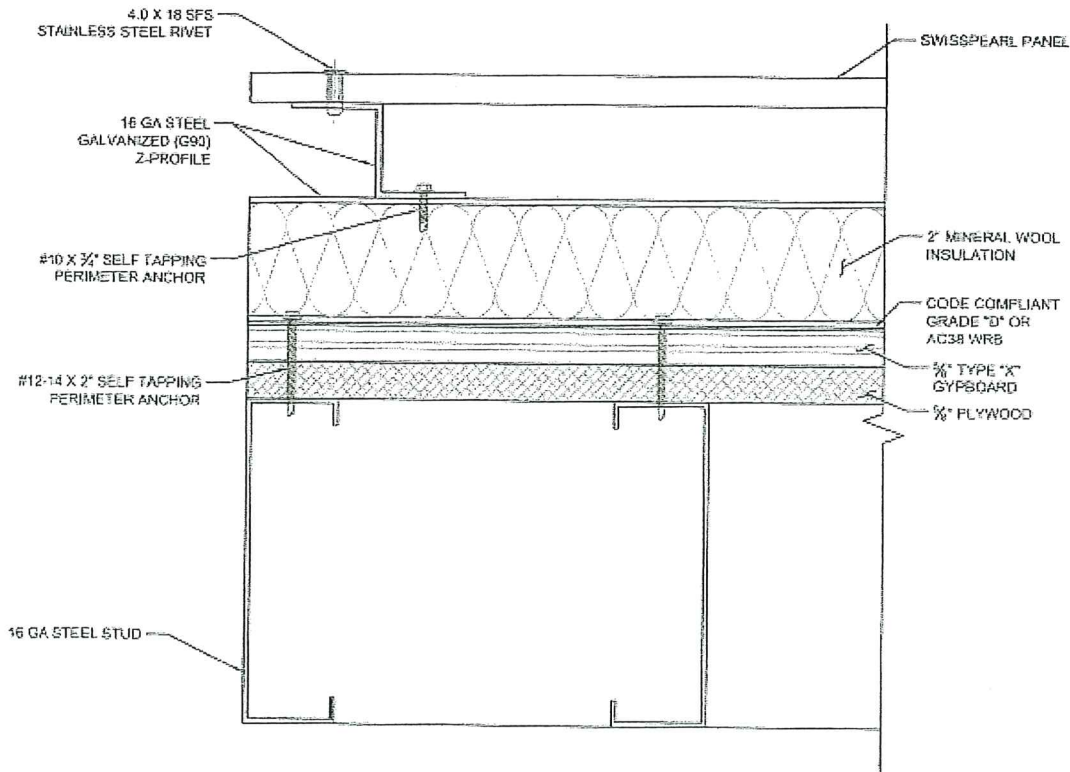

SWISSPEARL PLAN DETAIL  
(8' SIDE)

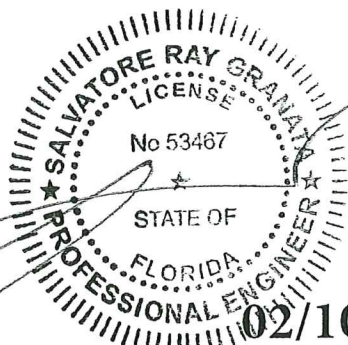

Engineer Salvatore Granata  
Florida PE # 53467  
[sal@srgpe.net](mailto:sal@srgpe.net)  
(678) 367-3151

PRODUCT REVISED  
as complying with the Florida  
Building Code  
Acceptance No. 19-0417.01  
Expiration Date APR 22 2024  
By Heidi A. Miller  
Miami Dade Product Control

PRODUCT REVISED  
as complying with the Florida  
Building Code  
Acceptance No. 23-0606.09  
Expiration Date 09/22/2029  
By Heidi A. Miller  
Miami Dade Product Control

Distributor Swisspearl Imports  
12618 Verterans Memorial Parkway  
Wentzville, MO 63385

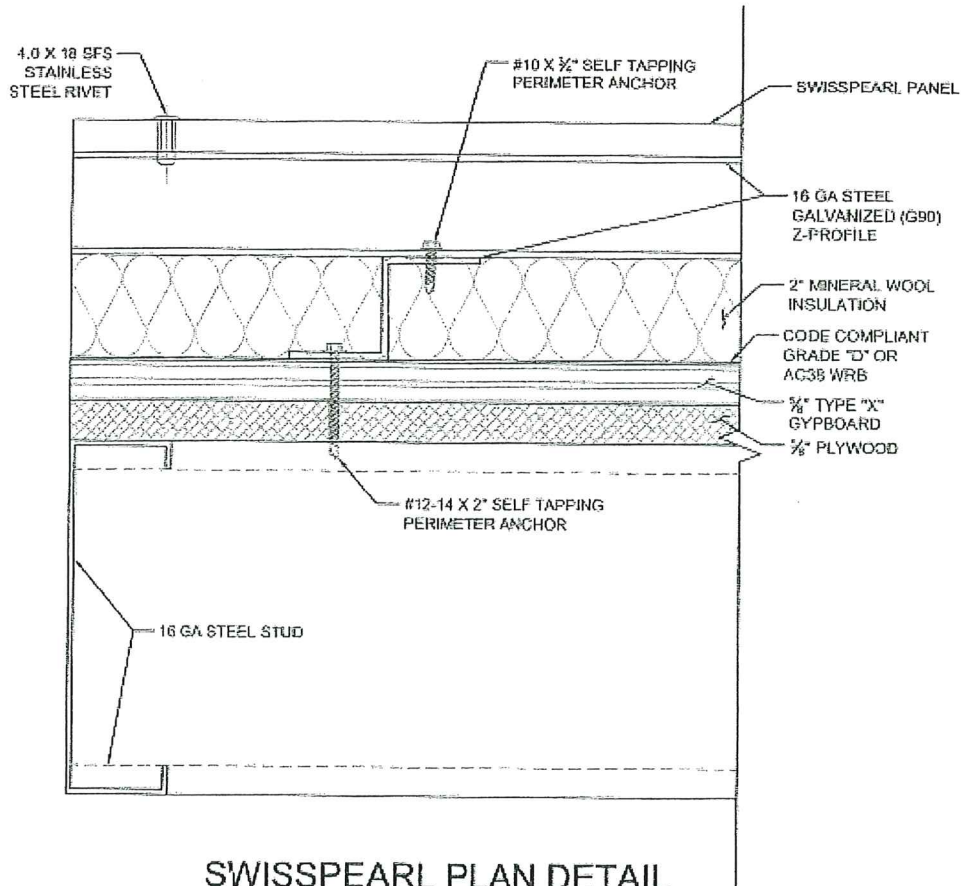

SWISSPEARL PLAN DETAIL  
(4' SIDE)

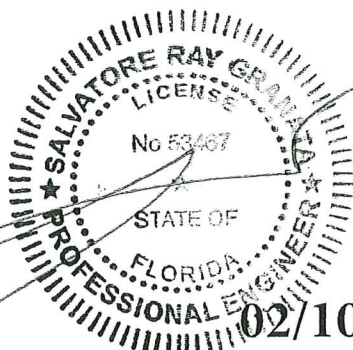

Engineer Salvatore Granata  
Florida PE # 53467  
[sal@srgpe.net](mailto:sal@srgpe.net)  
(678) 367-3151

PRODUCT REVISED  
as complying with the Florida  
Building Code  
Acceptance No 19-0417-01  
Expiration Date APR 22 2024  
By H. G. A. M. Jr.  
Miami Data Product Control

PRODUCT REVISED  
as complying with the Florida  
Building Code  
Acceptance No 23-0606-09  
Expiration Date 04/22/2024  
By H. G. A. M. Jr.  
Miami Data Product Control

Distributor Swisspearl Imports  
12618 Verterans Memorial Parkway  
Wentzville, MO 63385

**0.0 System Support Type S(2): Vertical Steel Support 15-1/2" Spacing**

**1.0 Product**

- 1.1 Manufacturer** Eternit (Schweiz) AG
- 1.2 Product Name** SWISSPEARL® Facade System
- 1.3 Category** Panels
- 1.4 Sub Category** Walls

**2.0 Evaluation Scope:**

**2.1 Evaluation Criteria:**

- 2.1.1 Florida Building Code (FBC) 2020  
Code Section: High Velocity Hurricane Zone (HVHZ)
- 2.1.2 Miami-Dade Building Code Compliance Office (BCCO) Checklist

**2.2 Properties Evaluated:**

- 2.2.1 Wind Resistance Properties
  - 2.2.1.1 Uniform Static Air Pressure
  - 2.2.1.2 Large Missile Impact
  - 2.2.1.3 Cyclic Wind Pressure
- 2.2.2 Fire Resistance Properties
- 2.2.3 Panel Material Properties

**2.3 Limits of Evaluation:**

This product is limited to compliance with the criteria in section 2.1 and properties in section 2.2 of this report

**3.0 Evaluates Uses:**

SWISSPEARL Wall Panels are used as nonbearing exterior (facade) wall panels.

**4.0 Support:** The Support assembly is designed by others and shall have the following minimum Characteristics

**4.1 Studs**

- 4.1.1 Material: Steel
- 4.1.2 Thickness: 16 Ga. (0.062 in)
- 4.1.3 Face Width: 2 - 1/4 in Minimum
- 4.1.4 Spacing: 16 in Maximum

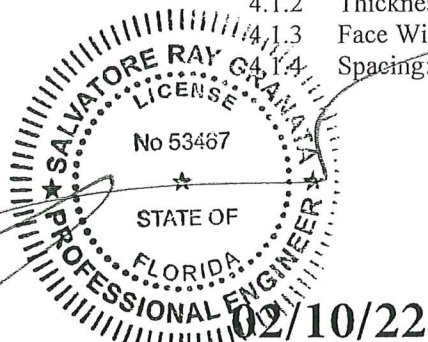

PRODUCT REVISED  
as complying with the Florida  
Building Code  
Acceptance No 19-0417.01  
Expiration Date APR 22 2024  
By *Helga A. Miller*  
Miami Dade Product Control

PRODUCT REVISED  
as complying with the Florida  
Building Code  
Acceptance No 23-0606.09  
Expiration Date 09/22/2029  
By *Helga A. Miller*  
Miami Dade Product Control

Engineer Salvatore Granata  
Florida PE # 53467

Swisspearl Façade System

Distributer Swisspearl Imports  
12618 Verterans Memorial Parkway  
Wentzville, MO 63385

[sal@srgpe.net](mailto:sal@srgpe.net)

(678) 367-3151



#### 4.2 Sheathing

- |       |                             |                       |
|-------|-----------------------------|-----------------------|
| 4.2.1 | Material:                   | 5/8" 5 Ply Plywood    |
| 4.2.2 | Thickness:                  | 5/8 in                |
| 4.2.3 | (Optional additional layer) | 5/8" Type "X" Drywall |

#### 4.3 Sheathing Fasteners

- |       |                       |  |
|-------|-----------------------|--|
| 4.3.1 | Type:                 | Drywall Screws, Self-Tapping             |
| 4.3.2 | Size:                 | #6 x 1- 5/8 in                           |
| 4.3.3 | Corrosion Resistance: | Phosphate coated                         |
| 4.3.4 | Fastener spacing:     | 12 in o.c. around perimeter at each stud |

### 5.0 Description:

#### 5.1 General:

The SWISSPEARL cement composite facade wall panels are riveted to a steel sub-frame.  
The steel sub-frame is fastened into the Steel stud support Wall.

#### 5.2 Panel Dimensions:

- |       |                   |               |
|-------|-------------------|---------------|
| 5.2.1 | Length (Maximum): | 9 ft 11-5/8in |
| 5.2.2 | Width (Maximum):  | 4 ft          |
| 5.2.3 | Thickness:        | 5/16 in       |

### 6.0 Performance

#### 6.1 Wind Resistance:

- |        |                       |                         |
|--------|-----------------------|-------------------------|
| 6.1.1. | Design Pressures      | <b>Positive</b> +95 psf |
|        |                       | <b>Negative</b> -95 psf |
|        | Panel Span:           | 15-1/2" o.c.            |
|        | Panel Span Condition: | 3 or more spans         |

#### 6.1.2 Uniform Static Air Pressure Test:

- |         |           |         |
|---------|-----------|---------|
| 6.1.2.1 | Standard: | TAS 202 |
| 6.1.2.2 | Results:  | Passed  |

#### 6.1.3 Cyclic Air Pressure Test

- |         |           |         |
|---------|-----------|---------|
| 6.1.3.1 | Standard: | TAS 203 |
| 6.1.3.2 | Results:  | Passed  |

#### 6.2 Impact Rating:

- |       |                       |         |
|-------|-----------------------|---------|
| 6.2.1 | Large Missile Impact: |         |
| 6.2.2 | Standard              | TAS 201 |
| 6.2.3 | Results               | Passed  |

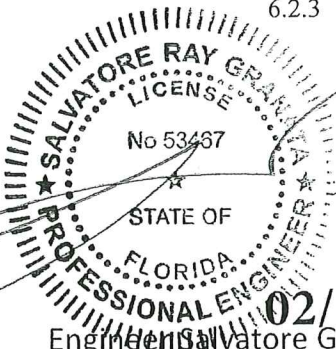

Engineer Salvatore Granata

Florida PE # 53467

[sal@srgpe.net](mailto:sal@srgpe.net)

(678) 367-3151

PRODUCT REVISED  
as complying with the Florida  
Building Code 19-0417.01  
Acceptance No. APR 2-2 2024  
Expiration Date  
By *Healy A. Malin*  
Miami Data Product Control

PRODUCT REVISED  
as complying with the Florida  
Building Code  
Acceptance No. 23-0606.09  
Expiration Date 04/22/2029  
By *Healy A. Malin*  
Miami Data Product Control

Distributor Swisspearl Imports  
12618 Verterans Memorial Parkway  
Wentzville, MO 63385

### 6.3 Fire Resistance

6.3.1	Test Standard:	E - 84 / E-136
6.3.2	Results:	Flame Spread: 0 Smoke Density: 15

### 6.4 Panel Material Properties

6.4.1	Test Standard:	ASTM C 1185 - 95
6.4.2	Results	Passed

### 7.0 Limitations of Use:

- 7.1 Maximum Panel span 16 in.
- 7.2 Maximum Panel Deflection shall be L/180.
- 7.3 Diaphragm and axial load capacity is outside the "scope of this evaluation.
- 7.4 This evaluation is limited to the wall panel, the vertical and horizontal hat and Zee channels, and the fasteners. The structural properties of all other structural items (beams, columns, purlins, fascia supports etc.) are outside the scope of this evaluation and should be reviewed by the structural plans examiner of the requisite building department.

### 8.0 Code Compliance

- 8.1 Product meets the High Velocity Hurricane Zone (HVHZ) Requirements of the Florida Building Code (FBC) 2020 for the properties evaluated.

### 9.0 Identification:

- 9.1. Each Panel shall bear a permanent label with the manufacturer's name or logo, manufacturing plant's city, state and the statement reading "Miami-Dade County Product Control Approved" is to be located on each panel.

### 10.0 Installation:

1. The Horizontal Zee Channels are spaced 34-3/4 in o.c. vertically on the wall. These are fastened to the Steel support at each stud (16 in o.c.) through the 5/8" plywood using ONE designated Fasteners.
2. Vertical Hat Channels are spaced 10 ft on center. They are fastened at the horizontal Zee channels (34-3/4 in o.c.) using designated fastener.
3. Vertical Zee Channels are fastened to the Horizontal Zee Channels between the Hat Channels at 16 in o.c. These are fastened at the horizontal Zee channels (34-3/4 in o.c.) using designated fastener.

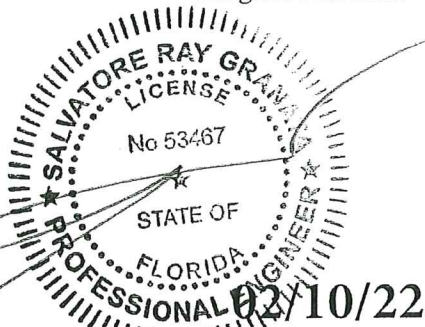

Engineer Salvatore Granata

Florida PE # 53467

[sal@srgpe.net](mailto:sal@srgpe.net)

(678) 367-3151

PRODUCT REVISED  
as complying with the Florida  
Building Code  
Acceptance No 19-0417.01  
Expiration Date APR 22 2024  
By *[Signature]*  
Miami Dade Product Control

PRODUCT REVISED  
as complying with the Florida  
Building Code  
Acceptance No 23-0606.09  
Expiration Date 04/22/2029  
By *[Signature]*  
Miami Dade Product Control

Distributor Swisspearl Imports

12618 Veterans Memorial Parkway

Wentzville, MO 63385

4. SWISSPEARL cement composite Panels are fastened to the vertical Zee channels (at each end) and vertical Zee channels spaced between the hat channels. These are fastened at each support (nominally 15-1/2 in o.c.), and vertically nominally 14 in o.c. up the panel.

## 11.0 Components

### 11.1 Panel:

11.1.1	Material	Cement reinforced composite
11.1.2	Thickness:	5/16 in (8 mm)

### 11.2 Fasteners:

Fastens the horizontal Zee's to the Steel Stud support system

11.2.1	Type:	Self Tapping Screw
11.2.2	Size:	#6 x 1-5/8 in
11.2.3	Number per Intersection:	1
11.2.4	Head:	Hex head
11.2.5	Corrosion Resistance:	Phosphate coated

### 11.3 Fasteners:

Fastens the vertical Hats and Zee's to the horizontal Zee's.

Fastens the cement composite panel to the steel vertical Hats and Zee's.

11.3.1	Manufacturer:	SFS
11.3.2	Type:	Rivets
11.3.3	Designation:	SSO-D15
11.3.4	Size:	4.0 x 18mm
11.3.5	Corrosion Resistance:	Stainless Steel
11.3.6	Vertical fastener spacing:	8 in o.c. Maximum
11.3.7	Horizontal fastener spacing:	16in o.c. Maximum



Engineer Salvatore Granata

Florida PE # 53467

[sal@srge.net](mailto:sal@srge.net)

(678) 367-3151

PRODUCT REVISED  
as complying with the Florida  
Building Code  
Acceptance No 19-0417.01  
Expiration Date APR 22 2024  
By H. G. A. M. L.  
Miami Date Product Control

PRODUCT REVISED  
as complying with the Florida  
Building Code  
Acceptance No 23-0606.09  
Expiration Date 04/22/2029  
By H. G. A. M. L.  
Miami Date Product Control

Distributor Swisspearl Imports  
12618 Verterans Memorial Parkway  
Wentzville, MO 63385



#### 11.4 Horizontal Supports

Zee channel that is fastened to the steel support. The Vertical Zee channels are attached to this.

11.4.1	Type:	Zee Channel.
11.4.2	Width:	3-1/8 in.
11.4.3	Height:	1-1/2 in.
11.4.4	Thickness:	16 Gauge
11.4.5	Material:	Steel
11.4.6	Corrosion Resistance:	Galvanized G90
11.4.7	Spacing:	34-3/4 in o.c.

#### 11.5 Vertical Supports:

Zee channel that is fastened to the Horizontal Zee channel. The cement composite panels are fastened to this support.

11.5.1	Type:	Zee Channel
11.5.2	Width:	3-1/8 in
11.5.3	Height:	1-1/2 in.
11.5.4	Thickness:	16 Gauge
11.5.5	Material:	Steel
11.5.6	Corrosion Resistance:	Galvanized G90
11.5.7	Spacing:	14 in o.c. (at panel joints)

#### 11.6 Ventilation profile (Optional):

Perforated L piece that goes in multiple edge locations.

11.6.1	Length:	98.5 in.
11.6.2	Width:	3-1/8 in.
11.6.3	Height:	1-9/16 in.
11.6.4	Thickness:	.027 in
11.6.5	Material:	Aluminum

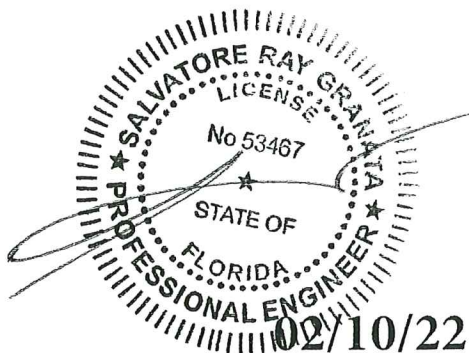

Engineer Salvatore Granata  
Florida PE # 53467  
[sal@srgpe.net](mailto:sal@srgpe.net)  
(678) 367-3151

PRODUCT REVISED  
as complying with the Florida  
Building Code  
Acceptance No 19-0417-01  
Expiration Date APR 22 2024  
By *Heidi A. Miller*  
Miami Date Product Control

PRODUCT REVISED  
as complying with the Florida  
Building Code  
Acceptance No 23-0606-09  
Expiration Date 04/22/2029  
By *Heidi A. Miller*  
Miami Date Product Control

Distributor Swisspearl Imports  
12618 Verterans Memorial Parkway  
Wentzville, MO 63385

### 11.7 L-Flashing (Optional):

L piece that goes in multiple edge locations

11.7.1	Length:	98.5 in.
11.7.2	Width:	3-1/8 in.
11.7.3	Height:	1-9/16 in.
11.7.4	Thickness:	.027 in.
11.7.5	Material:	Stainless Steel

### 12.0 Reference Data:

#### 12.1 Structural Performance

12.1.1 TAS 201, 202 & 203, Large Missile Impact Test, Air Infiltration Test, Uniform Static Air Pressure Test & Water Resistant Test & Cyclic Wind Pressure Loading, respectively.

By: Farabaugh Engineering and Testing Inc.

Report Ne: T302-20

Dated: 8/12/2020 Revised Date: NA

#### 12.2 Fire Performance

12.2.1 ASTM E-84 & ASTM E-136 Flame Spread Index / Smoke Density

By: Architectural Testing, Inc. (SGS U.S.)

Report No. 170982

Dated: 11/20/02

#### 12.3 Material properties

12.3.1 ASTM C 1185-95 Test Specification for Non-Asbestos Fiber-Cement Flat Sheet, roofing and Siding Shingles, and Clapboards

By: Architectural Testing, Inc.

Report No.: 01.42233.01

Dated: 11/20/02

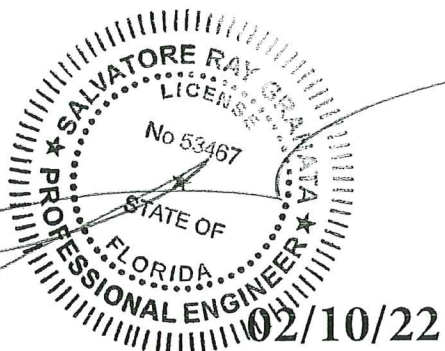

Engineer Salvatore Granata

Florida PE # 53467

[sal@srgpe.net](mailto:sal@srgpe.net)

(678) 367-3151

PRODUCT REVISED  
as complying with the Florida  
Building Code  
Acceptance No 19-0417.01  
Expiration Date APR 22 2024  
By *Helga A. Mahr*  
Miami Dade Product Control

PRODUCT REVISED  
as complying with the Florida  
Building Code  
Acceptance No 23-0606.09  
Expiration Date 09/23/2029  
By *Helga A. Mahr*  
Miami Dade Product Control

Distributor Swisspearl Imports

12618 Verterans Memorial Parkway

Swisspearl Façade System

Wentzville, MO 63385

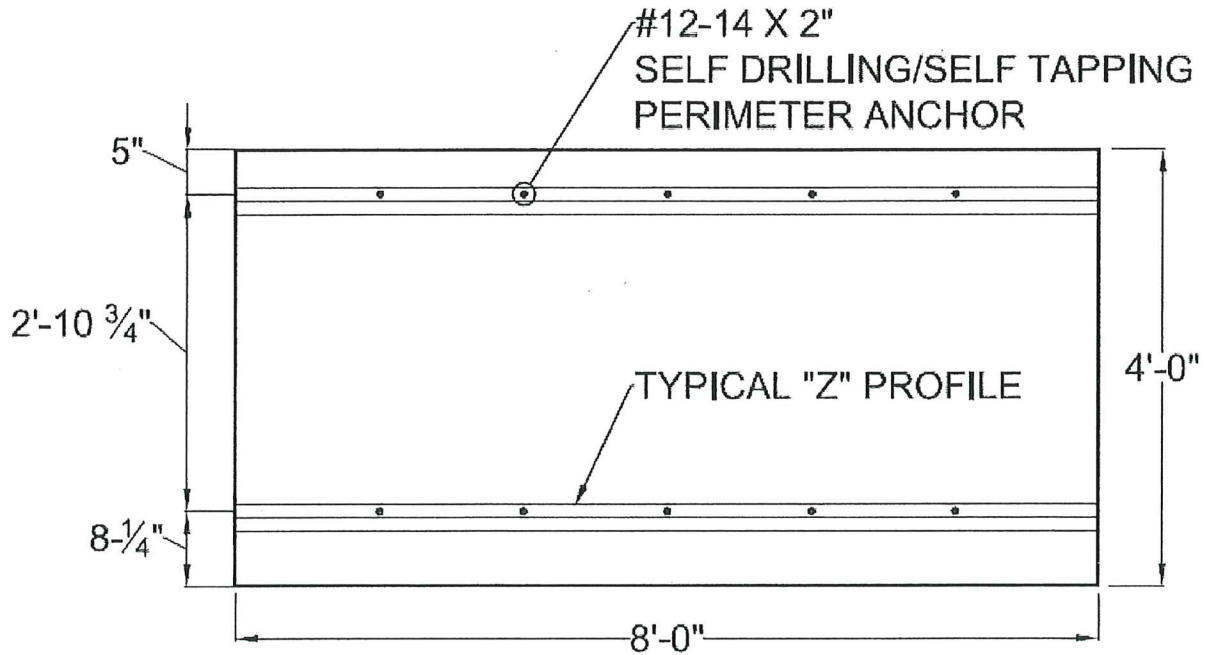

## SUB-FRAMING

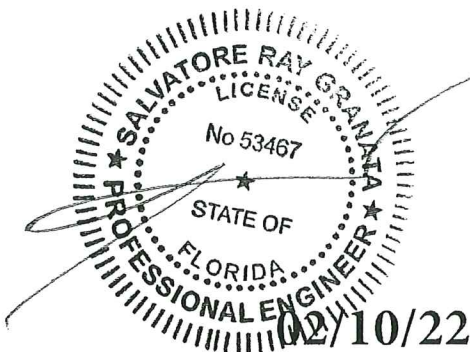

Engineer Salvatore Granata  
Florida PE # 53467

[sal@srgpe.net](mailto:sal@srgpe.net)

(678) 367-3151

PRODUCT REVISED  
as complying with the Florida  
Building Code  
Acceptance No 19-0417.01  
Expiration Date APR 22 2024  
By H. G. A. M. W.  
Miami Dade Product Control

PRODUCT REVISED  
as complying with the Florida  
Building Code  
Acceptance No 23-0606.09  
Expiration Date 04/22/2029  
By H. G. A. M. W.  
Miami Dade Product Control

Distributor Swisspearl Imports  
12618 Verterans Memorial Parkway  
Wentzville, MO 63385



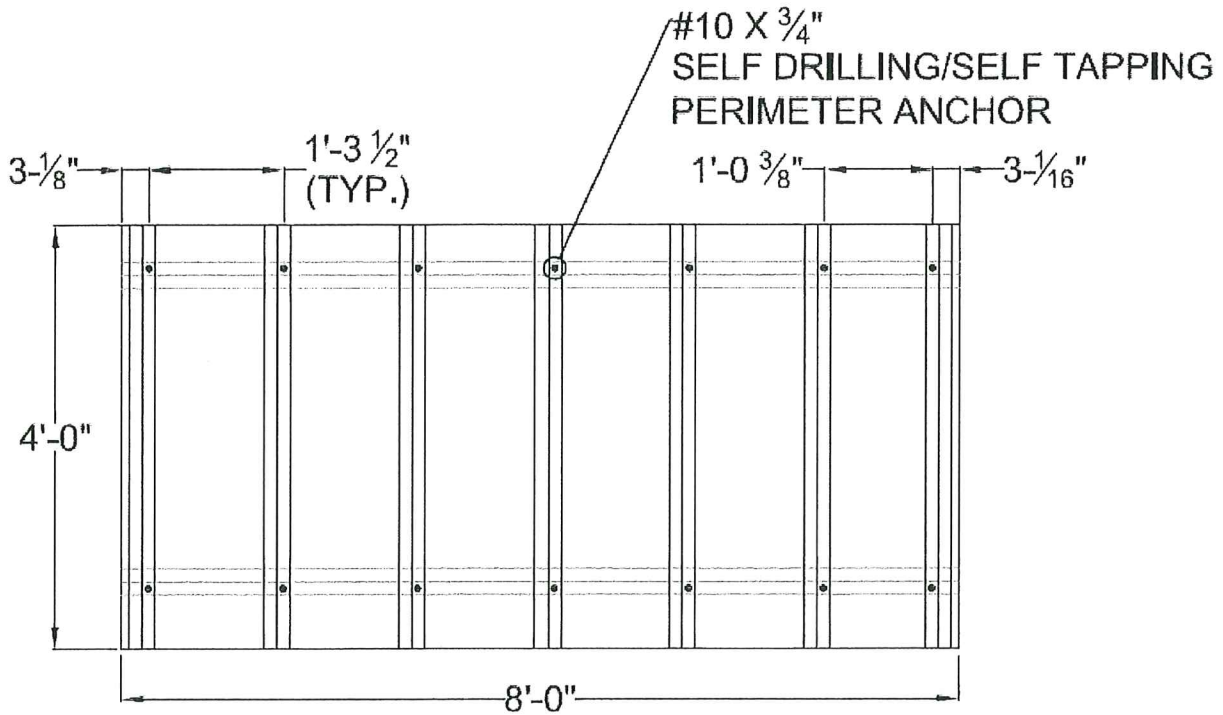

## Z-PANEL SUBFRAME

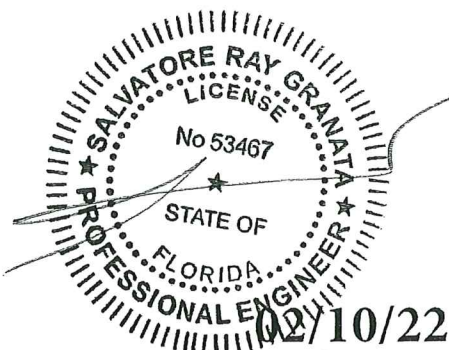

Engineer Salvatore Granata  
Florida PE # 53467  
[sal@srgpe.net](mailto:sal@srgpe.net)  
(678) 367-3151

PRODUCT REVISED  
as complying with the Florida  
Building Code  
Acceptance No 19-0417.01  
Expiration Date APR 22 2024  
By H. A. Mahr  
Miami Dade Product Control

PRODUCT REVISED  
as complying with the Florida  
Building Code  
Acceptance No 23-0606.09  
Expiration Date 04/22/2029  
By H. A. Mahr  
Miami Dade Product Control

Distributor Swisspearl Imports  
12618 Verterans Memorial Parkway  
Wentzville, MO 63385

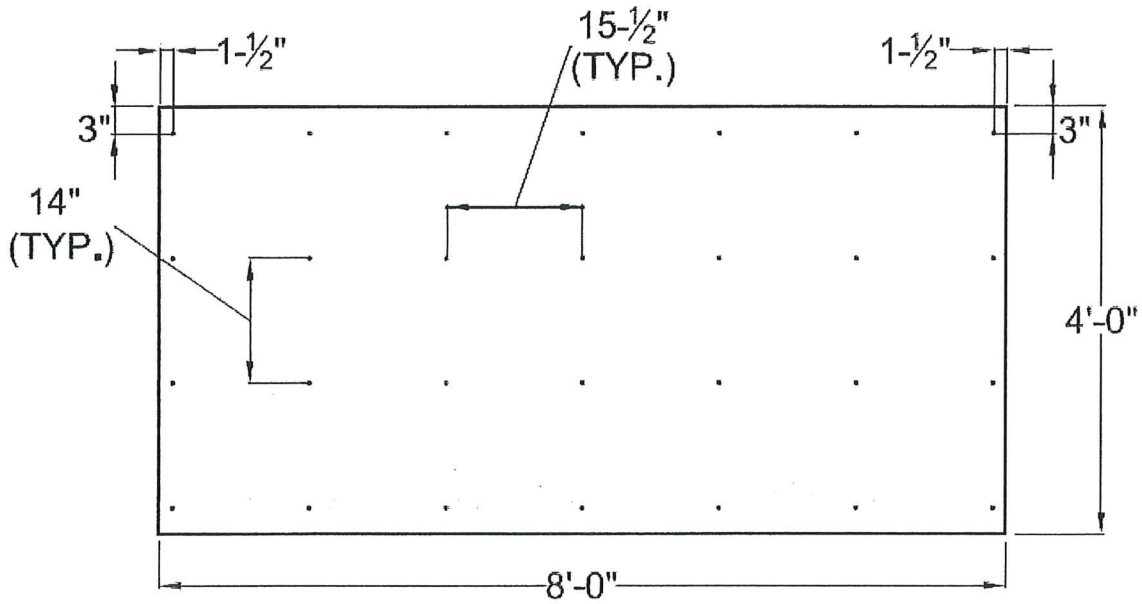

## SWISSPEARL PANEL

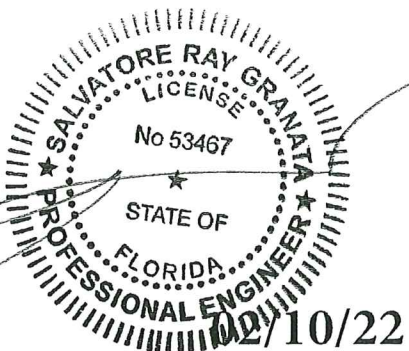

Engineer Salvatore Granata  
 Florida PE # 53467  
[sal@srgpe.net](mailto:sal@srgpe.net)  
 (678) 367-3151

PRODUCT REVISED  
 as complying with the Florida  
 Building Code  
 Acceptance No. 19-0417.01  
 Expiration Date APR 22 2024  
 By *H. A. M.*  
 Miami Dade Product Control

PRODUCT REVISED  
 as complying with the Florida  
 Building Code  
 Acceptance No. 23-0606.09  
 Expiration Date 04/22/2029  
 By *H. A. M.*  
 Miami Dade Product Control

Distributor Swisspearl Imports  
 12618 Verterans Memorial Parkway  
 Wentzville, MO 63385

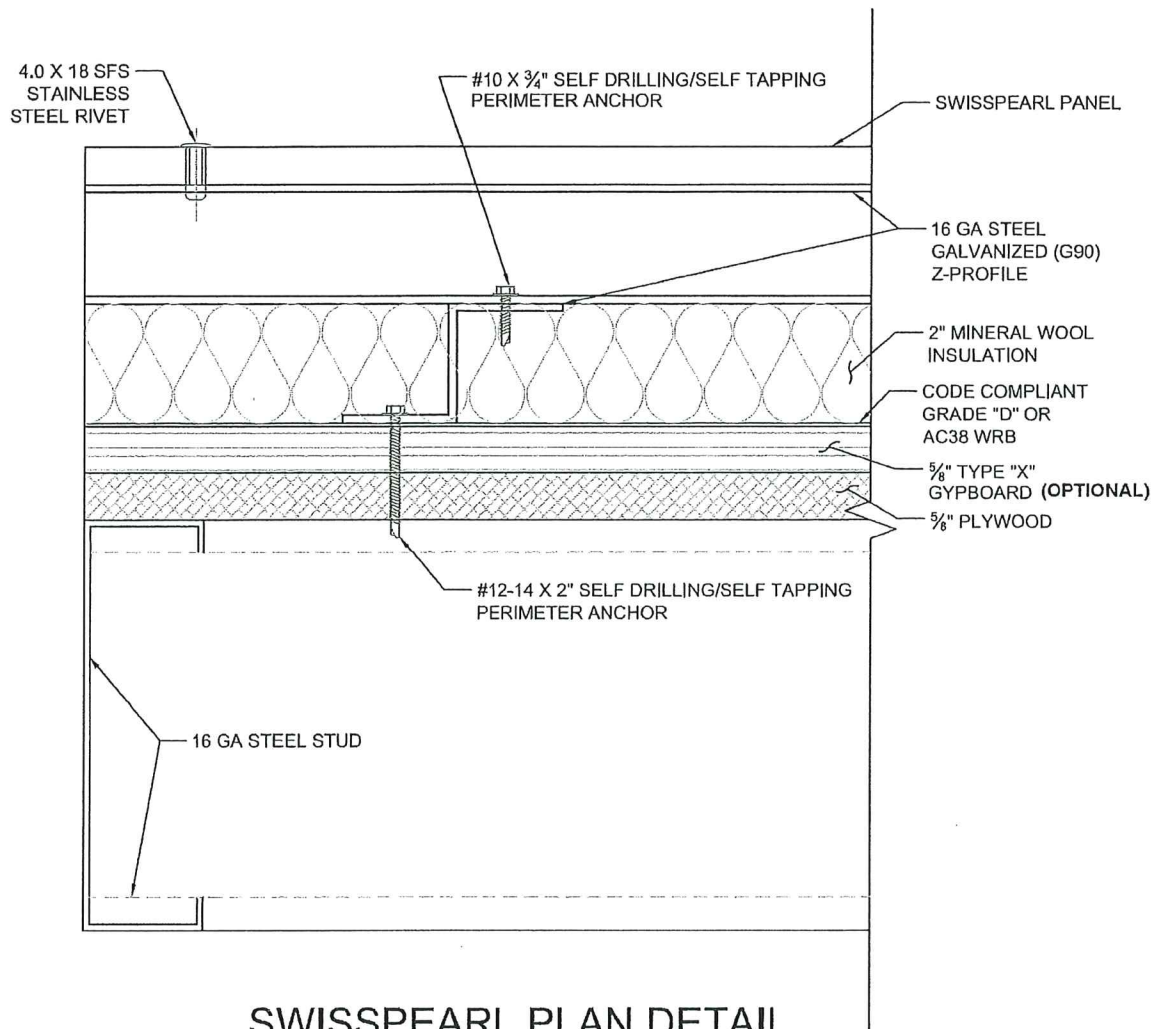

SWISSPEARL PLAN DETAIL  
(4' SIDE)

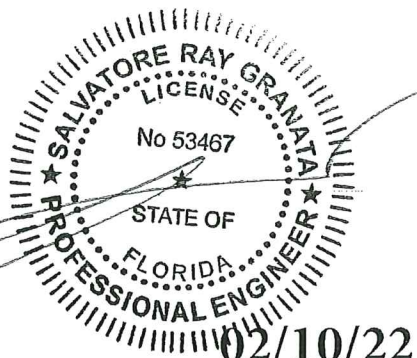

Engineer Salvatore Granata  
Florida PE # 53467  
[sal@srgpe.net](mailto:sal@srgpe.net)  
(678) 367-3151

PRODUCT REVISED  
as complying with the Florida  
Building Code  
Acceptance No 19-0417.01  
Expiration Date APR 22 2024  
By *Heidi A. Miller*  
Miami Dade Product Control

PRODUCT REVISED  
as complying with the Florida  
Building Code  
Acceptance No 23-0606.09  
Expiration Date 04/22/2029  
By *Heidi A. Miller*  
Miami Dade Product Control

Distributor Swisspearl Imports  
12618 Verterans Memorial Parkway  
Wentzville, MO 63385

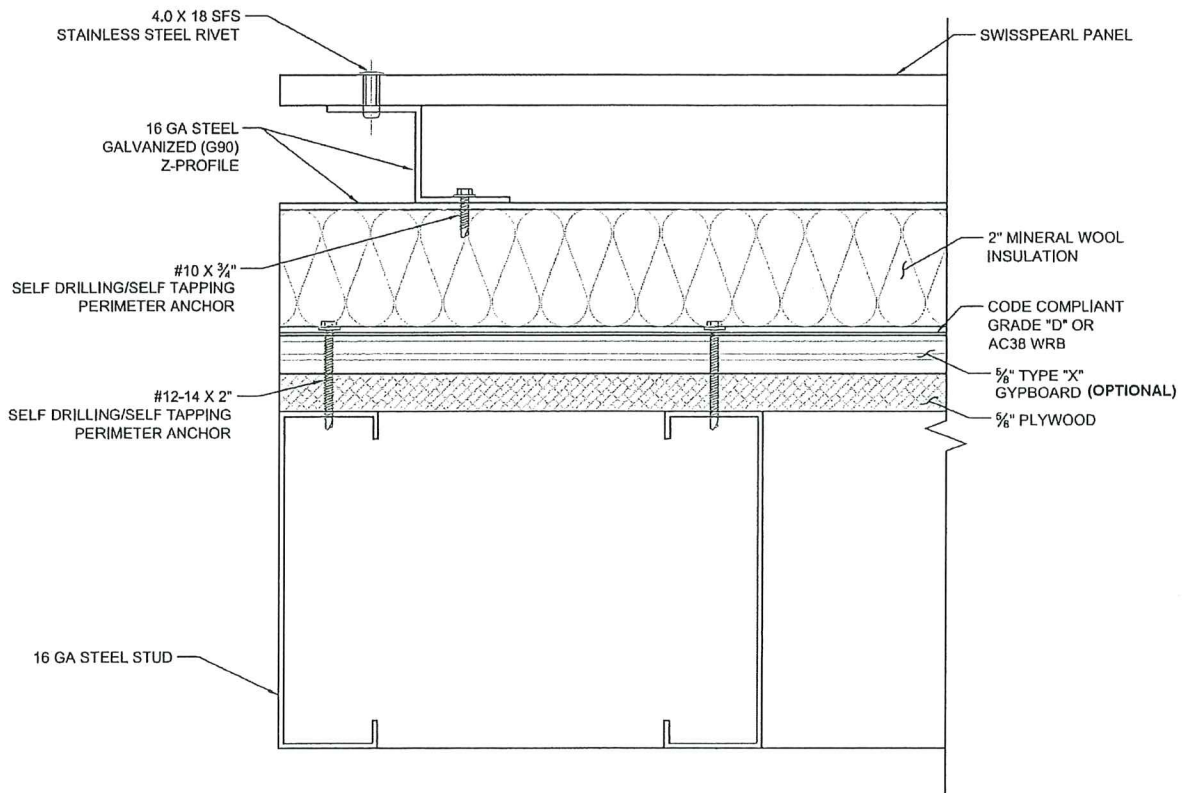

SWISSPEARL PLAN DETAIL  
(8' SIDE)

PRODUCT REVISED  
as complying with the Florida  
Building Code  
Acceptance No 23-0606.09  
Expiration Date 04/22/2029  
By Heidi A. Mohr  
Miami Dade Product Control

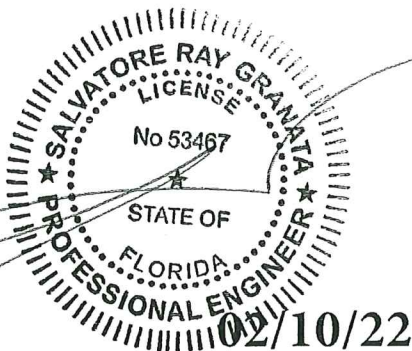

Engineer Salvatore Granata  
Florida PE # 53467  
[sal@srgpe.net](mailto:sal@srgpe.net)  
(678) 367-3151

PRODUCT REVISED  
as complying with the Florida  
Building Code  
Acceptance No 19-0417.01  
Expiration Date APR 22 2024  
By Heidi A. Mohr  
Miami Dade Product Control

Distributor Swisspearl Imports  
12618 Verterans Memorial Parkway  
Wentzville, MO 63385