



MIAMI-DADE COUNTY  
PRODUCT CONTROL SECTION  
11805 SW 26 Street, Room 208  
Miami, Florida 33175-2474  
T (786) 315-2590 F (786) 315-2599  
[www.miamidade.gov/building](http://www.miamidade.gov/building)

DEPARTMENT OF REGULATORY AND ECONOMIC RESOURCES (RER)  
BOARD AND CODE ADMINISTRATION DIVISION  
**NOTICE OF ACCEPTANCE (NOA)**

**Roatan Mahogany USA, Inc.**  
**4004C Aurora Street**  
**Coral Gables, FL 33146**

**SCOPE:**

This NOA is being issued under the applicable rules and regulations governing the use of construction materials. The documentation submitted has been reviewed and accepted by Miami-Dade County RER - Product Control Section to be used in Miami Dade County and other areas where allowed by the Authority Having Jurisdiction (AHJ).

This NOA shall not be valid after the expiration date stated below. The Miami-Dade County Product Control Section (In Miami-Dade County) and/or the AHJ (in areas other than Miami-Dade County) reserve the right to have this product or material tested for quality assurance purposes. If this product or material fails to perform in the accepted manner, the manufacturer will incur the expense of such testing and the AHJ may immediately revoke, modify, or suspend the use of such product or material within their jurisdiction. RER reserves the right to revoke this acceptance if it is determined by Miami-Dade County Product Control Section that this product or material fails to meet the requirements of the applicable building code. This product is approved as described herein, and has been designed to comply with the Florida Building Code, including the High Velocity Hurricane Zone.

**DESCRIPTION: Series "Swietenia" Outswing Glazed Wood Door - L.M.I.**

**APPROVAL DOCUMENT:** Drawing No. **23-158** (former **20-045**), titled "Swietenia Series – Swing Out Doors", sheets 1 through 10 of 10, dated 05/21/22 and last revised on 09/04/23, prepared by PPMF Inc., signed and sealed by Pedro M. De Figueiredo, P.E., bearing the Miami-Dade County Product Control Revision stamp with the Notice of Acceptance number and expiration date by the Miami-Dade County Product Control Section.

**MISSILE IMPACT RATING: Large and Small Missile Impact Resistant**

**Limitations:**

1. See sheet **5** for hardware. See primary locking notes 2 & 3 and additional secondary locking required during Hurricane events, per note 4.
2. Partial Raised Wood panel (glazing type **GL-2** per sheets **2, 4 & 7**) is **limited** to max. **25"W x 75-1/2"H**.
3. Min 3ksi concrete required at head/sill installation.

**LABELING:** Each unit shall bear a permanent label with the manufacturer's name or logo, city, state, model/series, and following statement: "Miami-Dade County Product Control Approved", unless otherwise noted herein.

**RENEWAL** of this NOA shall be considered after a renewal application has been filed and there has been no change in the applicable building code negatively affecting the performance of this product.

**TERMINATION** of this NOA will occur after the expiration date or if there has been a revision or change in the materials, use, and/or manufacture of the product or process. Misuse of this NOA as an endorsement of any product, for sales, advertising or any other purposes shall automatically terminate this NOA. Failure to comply with any section of this NOA shall be cause for termination and removal of NOA.

**ADVERTISEMENT:** The NOA number preceded by the words Miami-Dade County, Florida, and followed by the expiration date may be displayed in advertising literature. If any portion of the NOA is displayed, then it shall be done in its entirety.

**INSPECTION:** A copy of this entire NOA shall be provided to the user by the manufacturer or its distributors and shall be available for inspection at the job site at the request of the Building Official.

This NOA **revises NOA No. 22-0606.07** and consists of this page 1 and evidence pages E-1, E-2, E-3, E-4 and E-5, as well as approval document mentioned above.

The submitted documentation was reviewed by **Ishaq I. Chanda, P.E.**



*Ishaq I. Chanda*

**NOA No. 23-0928.34**  
**Expiration Date: August 08, 2029**  
**Approval Date: November 09, 2023**  
**Page 1**

**NOTICE OF ACCEPTANCE: EVIDENCE SUBMITTED**

**1. EVIDENCE SUBMITTED UNDER PREVIOUS NOA's**

**A. DRAWINGS**

1. Manufacturer's die drawings and sections.  
*(Submitted under NOA No. 07-0717.08)*
2. Drawing No. **18-106**, titled "Swietenia Series – Swing Out Doors", sheets 1 through 7 of 7, dated, dated 02/26/18, prepared by PPMF Inc., signed and sealed by Pedro M. De Figueiredo, P.E.  
*(Submitted under NOA No. 19-0808.05)*

**B. TESTS**

1. Test reports on: 1) Air Infiltration Test, per FBC TAS 202-94  
2) Uniform Static Air Pressure Test, Loading per FBC TAS 202-94  
3) Water Resistance Test, per FBC TAS 202-94  
4) Large Missile Impact Test per FBC, TAS 201-94  
5) Cyclic Wind Pressure Loading per FBC, TAS 203-94  
6) Forced Entry Test, per FBC 2411 3.2.1, TAS 202-94  
along with marked-up drawings and installation diagram of an outswing mahogany door, prepared by Hurricane Engineering & Testing, Inc., Test Reports No. **HETI-01-1184** dated 10/29/01, **HETI-01-1095**, dated 11/02/01, **HETI-01-1185** dated 04/18/01, **HETI-01-1077** dated 11/09/01, **HETI-01-1190** dated 11/25/01, **HETI-01-1079** dated 11/26/01, **HETI-01-1007** dated 11/06/01, **HETI-01-1186** dated 04/18/01 and **HETI-01-1006** dated 10/26/01, all signed and sealed by Hector M. Medina, P.E.  
*(Submitted under NOA's No. 14-0722.10, No. 13-0814.04, No. 12-0713.06 and No. 07-0717.08)*

**C. CALCULATIONS**

1. Anchor verification calculations and structural analysis, complying with FBC 5<sup>th</sup> Edition (2014), dated 04/26/16, prepared by EngCo, Inc., signed and sealed by Pedro M. De Figueiredo, P.E.  
*(Submitted under NOA No. 13-0814.04)*
2. Glazing complies with **ASTM E1300-04 & 09**.

**D. QUALITY ASSURANCE**

1. Miami-Dade Department of Regulatory and Economic Resources (RER).

*Ishaq I. Chanda*

---

**Ishaq I. Chanda, P.E.**  
**Product Control Unit Supervisor**  
**NOA No. 23-0928.34**  
**Expiration Date: August 08, 2029**  
**Approval Date: November 09, 2023**

**Roatan Mahogany USA, Inc.**

**NOTICE OF ACCEPTANCE: EVIDENCE SUBMITTED**

**1. EVIDENCE SUBMITTED UNDER PREVIOUS NOA's (CONTINUED)**

**E. MATERIAL CERTIFICATIONS**

1. Notice of Acceptance No. **18-0619.01** issued to **Polymer Extrusion Technology, Inc. dba Glasslam** for their "**Glasslam Safety-Plus II Glass Interlayer**" dated 07/26/18, expiring on 08/07/23.

**F. STATEMENTS**

1. Statement letter of conformance, complying with **FBC 6<sup>th</sup> Edition (2017)**, and of no financial interest, dated February 27, 2018, issued by PPMF Inc., signed and sealed by Pedro M. De Figueiredo, P.E.  
*(Submitted under NOA No. 18-0305.04)*

**G. OTHERS**

1. Notice of Acceptance No. **18-0305.04**, issued to Roatan Mahogany USA, Inc. for their Swietenia Series Outswing Glazed Wood Doors – L.M.I., approved on 05/03/18 and expiring on 08/08/19.

*Ishaq I. Chanda*

---

**Ishaq I. Chanda, P.E.**  
**Product Control Examiner**  
**NOA No. 23-0928.34**  
**Expiration Date: August 08, 2029**  
**Approval Date: November 09, 2023**

**NOTICE OF ACCEPTANCE: EVIDENCE SUBMITTED**

**2. EVIDENCE SUBMITTED under previous approval**

**A. DRAWINGS**

1. Drawing No. **20-045**, titled “Swietenia Series – Swing Out Doors”, sheets 1 through 10 of 10, dated, dated 05/21/22, prepared by PPMF Inc., signed and sealed by Pedro M. De Figueiredo, P.E.

**B. TESTS**

1. Test reports on: 1) Air Infiltration Test, per FBC TAS 202-94  
2) Uniform Static Air Pressure Test, Loading per FBC TAS 202-94  
3) Water Resistance Test, per FBC TAS 202-94  
4) Large Missile Impact Test per FBC, TAS 201-94  
5) Cyclic Wind Pressure Loading per FBC, TAS 203-94  
along with marked-up drawings and installation diagram of a series “Swietenia” outswing double entrance door, prepared by Fenestration Testing Laboratory, Inc., Test Report No. **FTL-19-8842**, dated 01/04/21, signed and sealed by Idalmis Ortega, P.E.
2. Test reports on: 1) Air Infiltration Test, per FBC TAS 202-94  
2) Uniform Static Air Pressure Test, Loading per FBC TAS 202-94  
3) Water Resistance Test, per FBC TAS 202-94  
4) Large Missile Impact Test per FBC, TAS 201-94  
5) Cyclic Wind Pressure Loading per FBC, TAS 203-94  
along with marked-up drawings and installation diagram of a series “Swietenia” fixed window, prepared by Fenestration Testing Laboratory, Inc., Test Report No. **FTL-19-8843**, dated 01/29/19, signed and sealed by Idalmis Ortega, P.E.

**C. CALCULATIONS**

1. Anchor verification calculations and structural analysis, complying with FBC 7<sup>th</sup> Edition (2020), dated 05/15/22, prepared by PPMF, Inc., signed and sealed by Pedro M. De Figueiredo, P.E.

**D. QUALITY ASSURANCE**

1. Miami-Dade Department of Regulatory and Economic Resources (RER)

**E. MATERIAL CERTIFICATIONS**

1. Notice of Acceptance No. **22-0217.04** issued to **Polymer Extrusion Technology, Inc.** dba Glasslam for their “**Glasslam Safety-Plus II Glass Interlayer**” dated 03/31/22, expiring on 08/07/23.

*Ishaq I. Chanda*

---

**Ishaq I. Chanda, P.E.**  
**Product Control Unit Supervisor**  
**NOA No. 23-0928.34**  
**Expiration Date: August 08, 2029**  
**Approval Date: November 09, 2023**

**Roatan Mahogany USA, Inc.**

**NOTICE OF ACCEPTANCE: EVIDENCE SUBMITTED**

**2. EVIDENCE SUBMITTED under previous approval (CONTINUED)**

**F. STATEMENTS**

1. Statement letter of conformance, complying with **FBC 7<sup>th</sup> Edition (2020)**, and of no financial interest, dated May 15, 2022, issued by PPMF Inc., signed and sealed by Pedro M. De Figueiredo, P.E.
2. Testing Proposal No. **19-0021** issued by the Product Control Section, dated January 25, 2019, signed by Ishaq Chanda, P.E.
3. Testing Proposal No. **19-0022** issued by the Product Control Section, dated January 25, 2019, signed by Ishaq Chanda, P.E.

**G. OTHERS**

1. Notice of Acceptance No. **19-0808.05**, issued to Roatan Mahogany USA, Inc. for their Swietenia Series Outswing Glazed Wood Doors – L.M.I., approved on 08/22/19 and expiring on 08/08/24.

*Ishaq I. Chanda*

---

**Ishaq I. Chanda, P.E.**  
**Product Control Unit Supervisor**  
**NOA No. 23-0928.34**  
**Expiration Date: August 08, 2029**  
**Approval Date: November 09, 2023**

**NOTICE OF ACCEPTANCE: EVIDENCE SUBMITTED**

**3. NEW EVIDENCE SUBMITTED**

**A. DRAWINGS**

1. Drawing No. **23-158** (former **20-045**), titled “Swietenia Series – Swing Out Doors”, sheets 1 through 10 of 10, dated 05/21/22 and last revised on 09/04/23, prepared by PPMF Inc., signed and sealed by Pedro M. De Figueiredo, P.E.

**B. TESTS**

1. None.

**C. CALCULATIONS**

1. None.

**D. QUALITY ASSURANCE**

1. Miami-Dade Department of Regulatory and Economic Resources (RER).

**E. MATERIAL CERTIFICATIONS**

1. Notice of Acceptance No. **23-0523.01** issued to **Polymer Extrusion Technology, Inc.** dba Glasslam for their “**Glasslam Safety-Plus II Glass Interlayer**”, expiring on 08/07/28.

- F.**
1. Statement letter of conformance, complying with **FBC 8<sup>th</sup> Edition (2023)**, prepared by PPMF Inc., dated 09/04/23, signed and sealed by Pedro M. De Figueiredo, P.E.
  2. Statement letter of no changes other than minor code and standard updates, prepared by PPMF Inc., dated 09/04/23, signed and sealed by Pedro M. De Figueiredo, P.E.

**G. OTHER**

1. This NOA revises **NOA No. 22-0606.07** and updates to FBC 2023, expiring 08/08/2029.

*Ishaq I. Chanda*

---

**Ishaq I. Chanda, P.E.**  
**Product Control Unit Supervisor**  
**NOA No. 23-0928.34**  
**Expiration Date: August 08, 2029**  
**Approval Date: November 09, 2023**



GENERAL NOTES:  
FLORIDA BUILDING CODE 2023 - 8TH EDITION - HVHZ  
LARGE & SMALL MISSILE IMPACT RATED

1- DEFINITION: THIS PRODUCT IS A SWING-OUT MAHOGANY DOOR; DESIGNED, CONSTRUCTED AND ERECTED TO ENCLOSE AN AREA, PROVIDING PROTECTION FROM HURRICANE FORCE WINDS WITHIN THE ALLOWABLE DESIGNED PRESSURES AND LIMITATIONS STATED IN THIS APPROVAL.

2- CODE: THIS PRODUCT HAS BEEN TESTED AND DESIGNED IN ACCORDANCE WITH THE FLORIDA BUILDING CODE, HIGH VELOCITY HURRICANE ZONES (HVHZ).

3- POSTING: A PERMANENT LEGIBLE DECAL SHALL BE PLACED AT A READILY VISIBLE LOCATION STATING THE FOLLOWING:

"ROATAN MAHOGANY USA, INC. - MIAMI - FLORIDA  
LARGE MISSILE IMPACT RESISTANT  
SWIETENIA SERIES - GLAZED SWING-OUT DOOR  
MIAMI-DADE COUNTY PRODUCT APPROVED"

4- LOADS: DESIGNED LOAD CALCULATED BASED ON THE ASCE 7-22 AND PROVIDED BY A PROFESSIONAL ARCHITECT OR ENGINEER FOR EACH SPECIFIC PROJECT. THE CALCULATED DESIGNED PRESSURE MUST NOT EXCEED THE ALLOWABLE PRESSURES HERE IN SPECIFIED. THE DESIGN PRESSURES, AS DETERMINED FROM ASCE 7-22, ARE TO BE MULTIPLE BY 0.6

5- MATERIAL: WOOD TYPE: VERNACULAR NAME: TRUE MAHOGANY  
SCIENTIFIC NAME: SWIETENIA MACROPHYLLA G. KING  
FAMILY: MELIACEAE  
MINIMUM SPECIFIC GRAVITY, SG= 0.45  
MATERIAL TO BE FABRICATED FROM KILN DRIED MAHOGANY.  
ALTERNATE WOOD SPECIES WITH SG >= 0.45 ARE ACCEPTABLE

6- FASTENERS: ASSEMBLY SCREWS AND ANCHORS SHALL BE AS SPECIFIED IN THE CURRENT SET OF DRAWINGS. INSTALLATION AND LOADS AS PER THIS APPROVAL.

7- USE: IT SHALL BE THE RESPONSIBILITY OF THE CONTRACTOR, ARCHITECT OR ENGINEER OF RECORD TO VERIFY THE FOLLOWING:

7.1- THE STABILITY OF THE STRUCTURE WHERE THE SHUTTER IS TO BE ATTACHED INSURING PROPER ANCHORAGE.

7.2- THE SITE SPECIFIC PROJECT CRITERIA, SUCH AS BUT NOT LIMITED TO, WINDLOADS, LOCAL CODE REQUIREMENTS, DESIGNED PRESSURES ETC.

7.3- THAT THIS APPROVAL IS ADEQUATE TO THE SPECIFIC PROJECT.

TYPICAL SINGLE ELEVATIONS

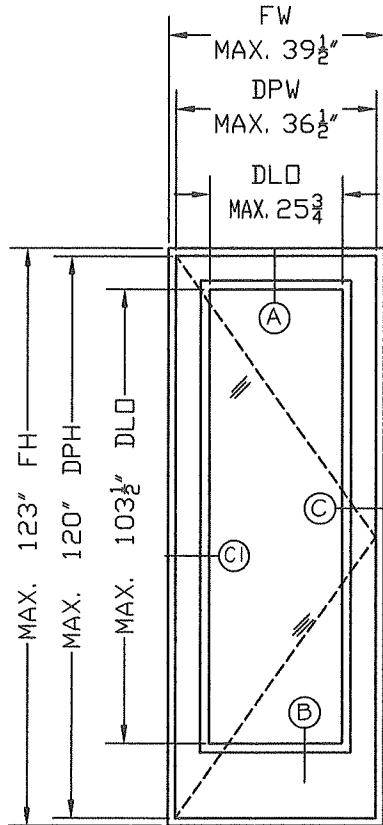

TYPE 1  
SQUARE  
CONFIGURATION

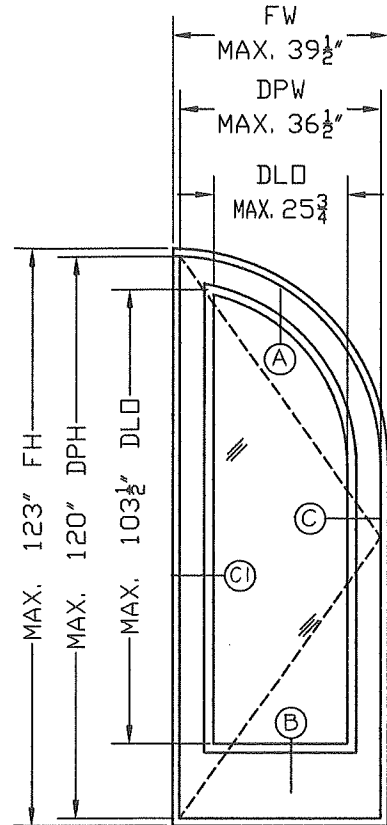

TYPE 2  
1/2 ARCH  
CONFIGURATION

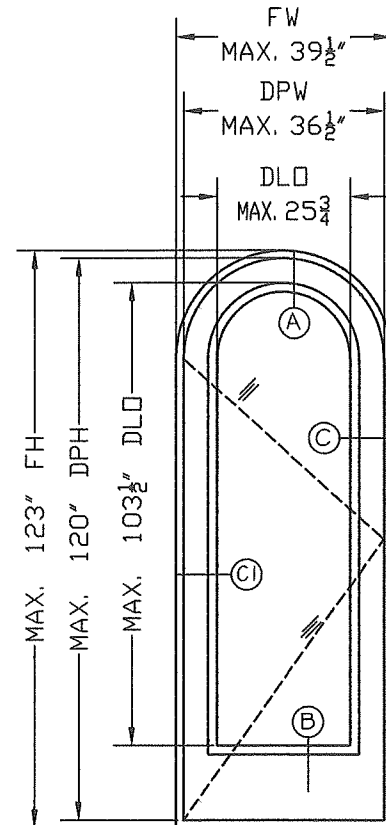

TYPE 3  
FULL ARCH  
CONFIGURATION

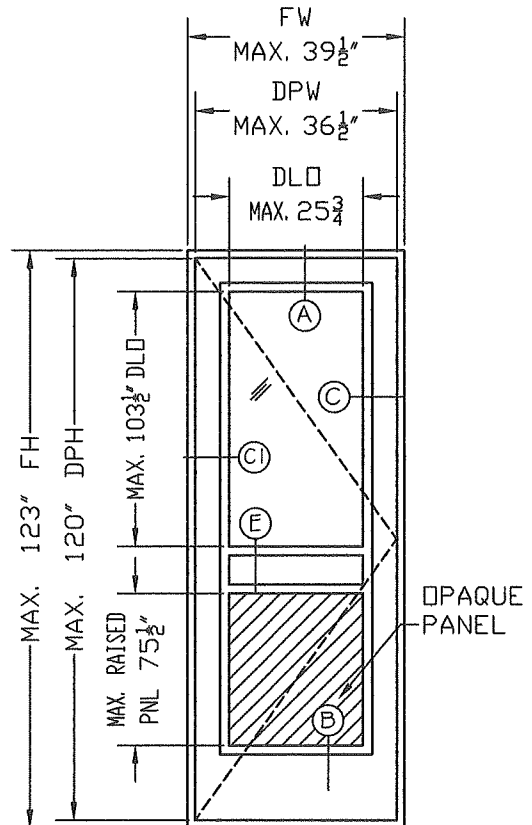

TYPE 4  
LITE WITH PANEL  
CONFIGURATION

GLAZING OPTIONS	DESIGNED PRESSURE RATING (PSF)		MAXIMUM DLO (IN)
A	+75	-75	25 3/4" X 103 1/2"
B	+75	-70	23 1/2" X 103 1/2"
C	+75	-75	25 3/4" X 103 1/2"
D	+75	-70	23 1/2" X 103 1/2"

- 1- MAXIMUM FRAME SIZES: FW= 39 1/2" X FH= 123"  
2- SEE GLAZING OPTIONS ON SHEET 9  
3- FH: FRAME FINISHED HEIGHT  
4- FW: FRAME FINISHED WIDTH  
5- DLO: DAY LIGHT OPENING APPLICABLE FOR GLASS  
6- DPH: DOOR PANEL HEIGHT  
7- DPW: DOOR PANEL WIDTH

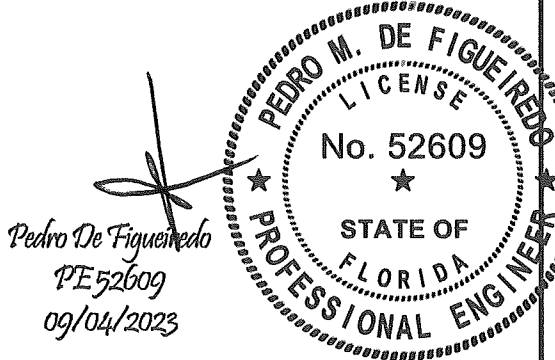

PRODUCT CATEGORY: DOORS - SWING OUT  
PRODUCT MATERIAL: WOOD / GLASS  
IMPACT RATING: LARGE & SMALL MISSILE  
GLAZED WOOD SWING-OUT DOOR  
SWIETENIA SERIES - SWING OUT DOORS

MANUFACTURER:  
ROATAN  
MAHOGANY USA INC.  
7005 N. WATERWAY DR. 302  
MIAMI FLORIDA 33155

MIAMI-DADE BCCO:

PRODUCT REVISED  
as complying with the Florida  
Building Code  
NOA-No. 23-0928.34  
Expiration Date 08/08/2029  
By Ishag I. Chank  
Miami-Dade Product Control

SCALE:  
NA  
DATE:  
09/04/2023  
DRAWING #  
23-158  
SHEET  
1 OF 10

TABLE OF CONTENTS:

SHEET	CONTENTS
1 OF 10	SINGLE ELEVATIONS, DESIGN RATING, GENERAL NOTES, TABLE OF CONTENTS
2 OF 10	PAIR ELEVATIONS, DESIGN RATING
3 OF 10	TYPICAL ELEVATION ANCHORAGE LAY-OUT
4 OF 10	TYPICAL ANCHORAGE DETAILS
5 OF 10	HARDWARE TYPE 1 LAY-OUT
6 OF 10	HARDWARE TYPE 2 LAY-OUT - ASTRAGAL INSTALLATION
7 OF 10	CROSS SECTIONS WITH HARDWARE TYPE 1
8 OF 10	CROSS SECTIONS WITH HARDWARE TYPE 2
9 OF 10	GLAZING OPTIONS
10 OF 10	PRODUCT COMPONENTS, ASSEMBLY AND BILL OF MATERIALS

TYPICAL PAIR ELEVATIONS

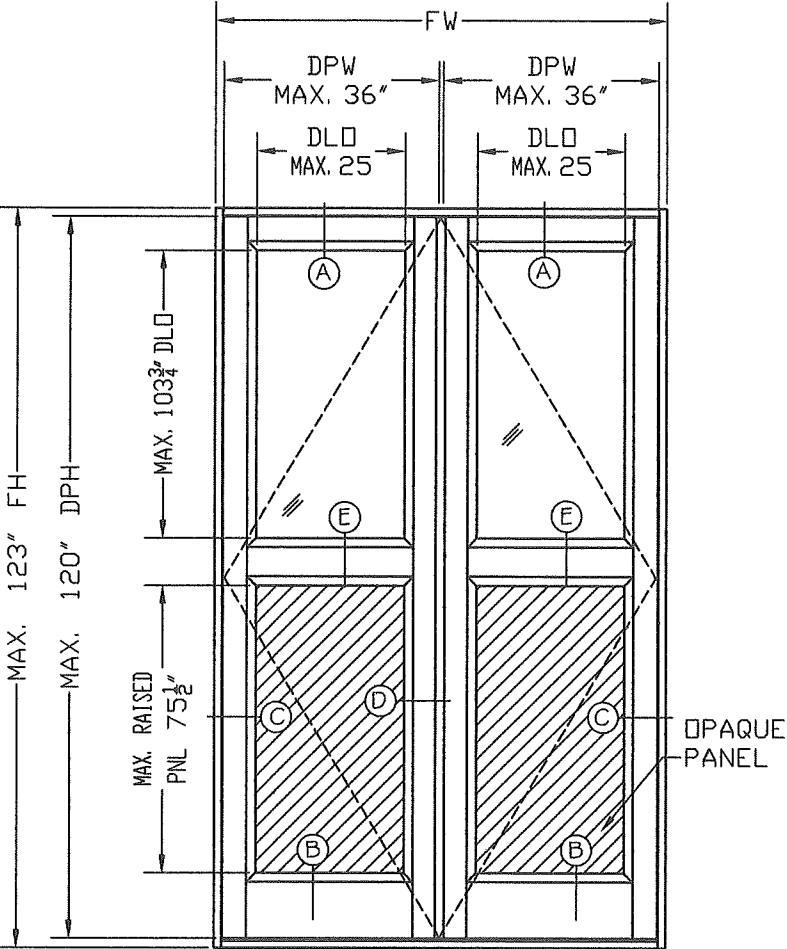

TYPE 5  
SPLIT PANEL CONFIGURATION

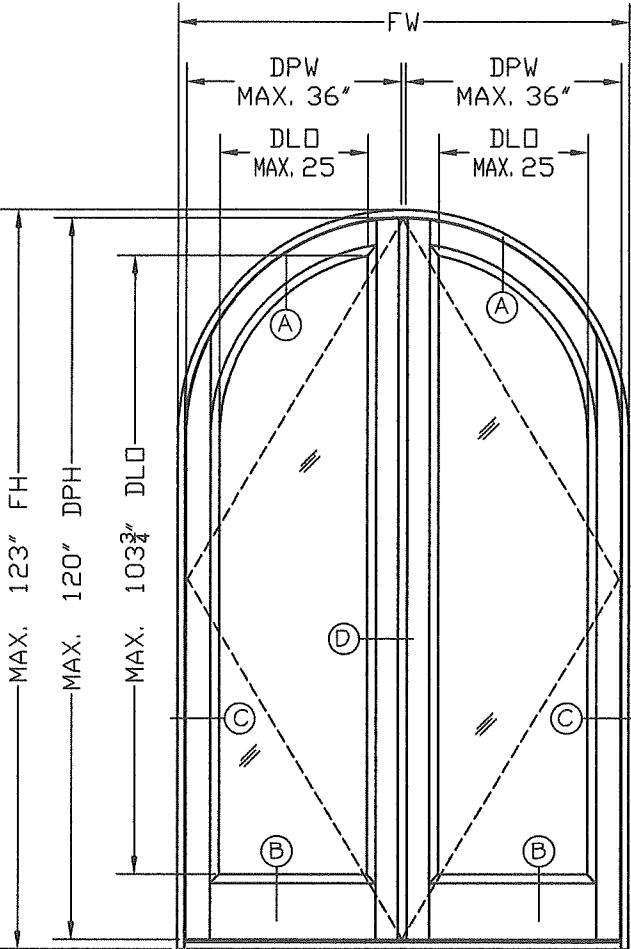

TYPE 6  
ARCH CONFIGURATION

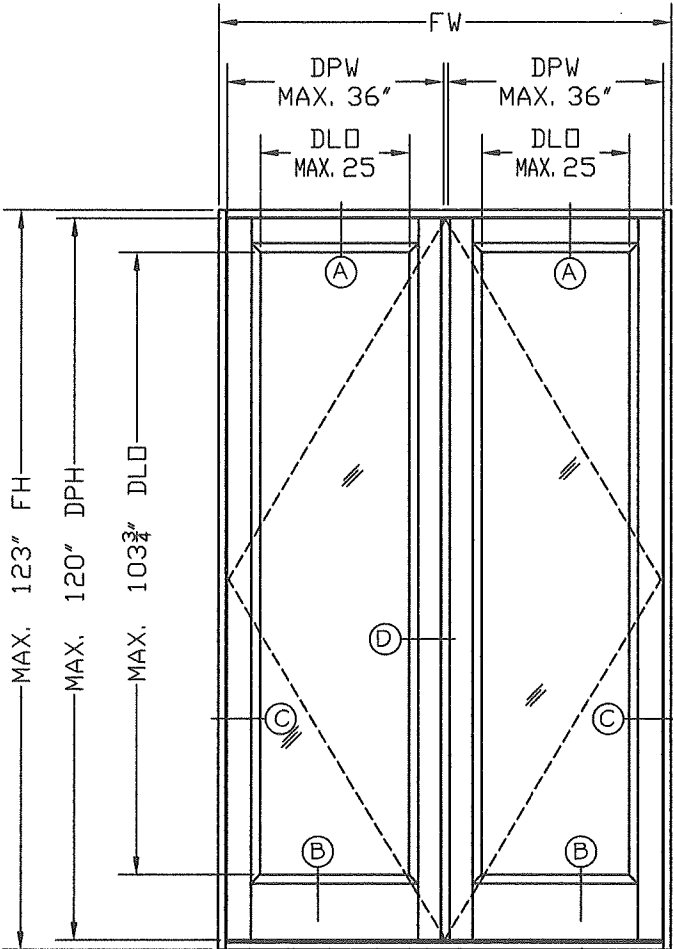

TYPE 7  
SQUARE CONFIGURATION

GLAZING OPTIONS	DESIGNED PRESSURE RATING (PSF)		MAXIMUM DLO (IN)
	+75	-75	
A	+75	-75	25 3/4" X 103 1/2"
B	+75	-70	23 1/2" X 103 1/2"
C	+75	-75	25 3/4" X 103 1/2"
D	+75	-70	23 1/2" X 103 1/2"

- 1- MAXIMUM FRAME SIZES: FW= 75 1/2" X FH= 123"  
2- SEE GLAZING OPTIONS ON SHEET 9  
3- FH: FRAME FINISHED HEIGHT  
4- FW: FRAME FINISHED WIDTH  
5- DLO: DAY LIGHT OPENING APPLICABLE FOR GLASS  
6- DPH: DOOR PANEL HEIGHT  
7- DPW: DOOR PANEL WIDTH

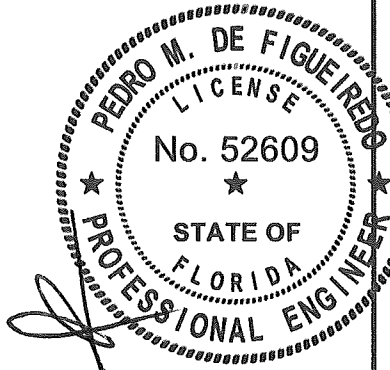

Pedro De Figueiredo  
PE 52609  
09/04/2023



PRODUCT CATEGORY: DOORS - SWING OUT  
PRODUCT MATERIAL: WOOD / GLASS  
IMPACT RATING: LARGE & SMALL MISSILE  
**GLAZED WOOD SWING-OUT DOOR**  
SWIETENIA SERIES - SWING OUT DOORS

MANUFACTURER:  
**ROATAN**  
MAHOGANY USA INC.  
7005 N. WATERWAY DR. 302  
MIAMI FLORIDA 33155

MIAMI-DADE BCCO:

**PRODUCT REVISED**  
as complying with the Florida  
Building Code  
NOA-No. 23-0928.34  
Expiration Date 08/08/2029  
By Ishag I. Chank  
Miami-Dade Product Control

SCALE:  
NA  
DATE:  
09/04/2023  
DRAWING #  
23-158  
SHEET  
2 OF 10





TYPICAL ANCHORAGE DETAILS

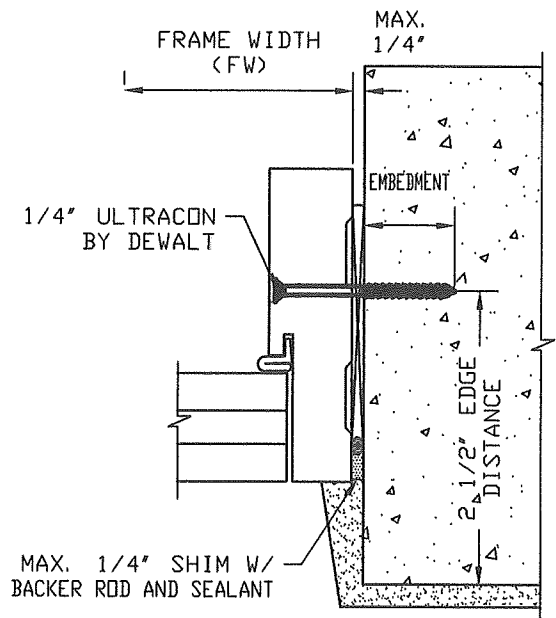

OPTION 1  
FRAME WITH MAXIMUM 1/4" PT WOOD SHIM  
1/4" ULTRACONS BY DEWALT WITH 1 1/4" MIN.  
EMBEDMENT INTO MASONRY  
(SEE SHEET 3 FOR ANCHORS LAY-OUT)

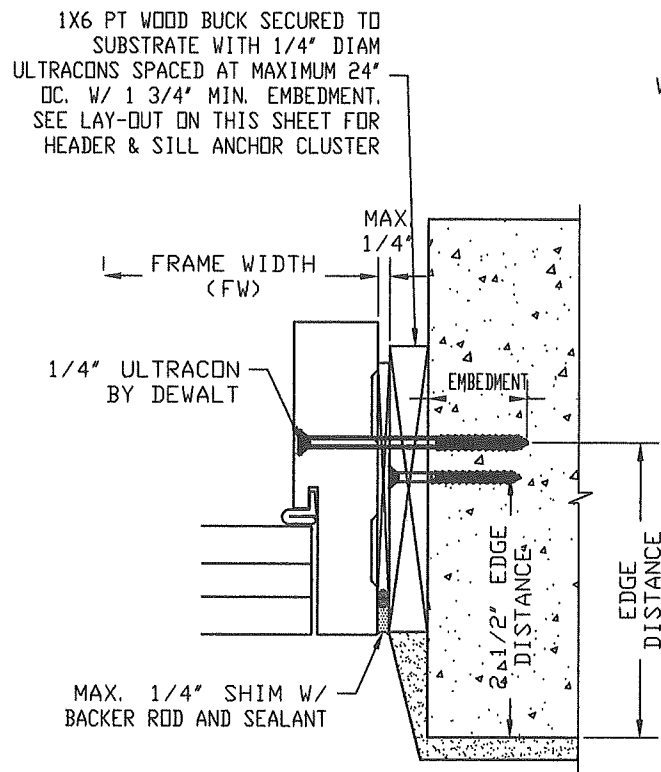

OPTION 2  
FRAME WITH MAXIMUM 1/4" PT WOOD SHIM AND  
1" PT CONT. WOOD SPACER  
1/4" ULTRACONS BY DEWALT WITH 1 1/4" MIN.  
EMBEDMENT INTO MASONRY  
(SEE SHEET 3 FOR ANCHORS LAY-OUT)

2X8 TRIMMED TO 6 1/2" PT WOOD BUCK  
SECURED TO SUBSTRATE WITH 1/4" DIAM  
ULTRACONS SPACED AT MAXIMUM 24"  
OC. W/ 1 3/4" MIN. EMBEDMENT  
IT MUST MATCH FRAMING LAY-OUT

#14 SS WOOD SCREWS OR  
1/4" ULTRACONS BY DEWALT  
W/ MIN. 1 1/2" INTO 2X BUCK

CONCRETE  
STRUCTURE  
MIN. 3000 PSI

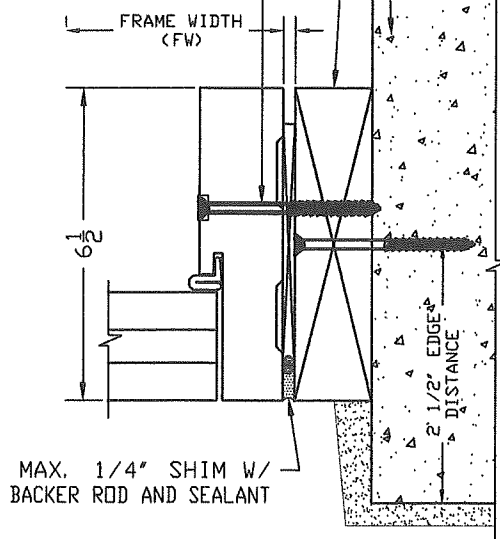

OPTION 3  
FRAME WITH MAXIMUM 1/4" PT WOOD SHIM AND  
SECURED TO THE 2X PT CONT. WOOD BUCK WITH  
#14 SS WOOD SCREWS OR 1/4" ULTRACONS WITH  
1 1/2" MIN. EMBEDMENT INTO WOOD (SG=.55)  
(SEE SHEET 3 FOR ANCHORS LAY-OUT)

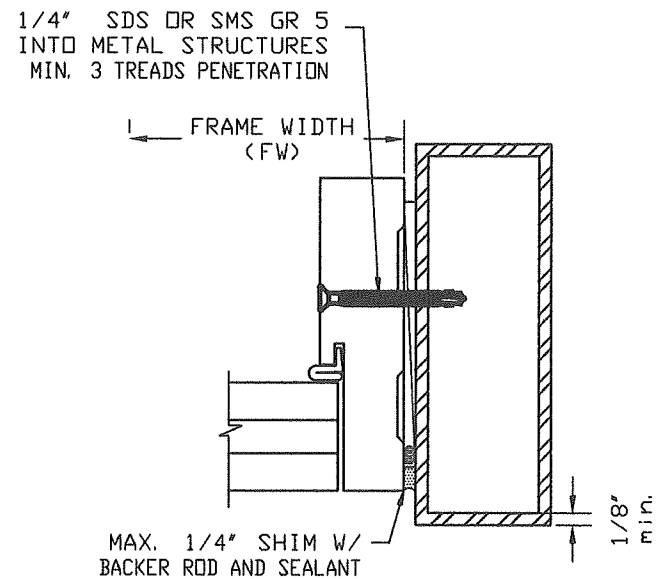

OPTION 4  
FRAME WITH MAXIMUM 1/4" PT WOOD SHIM  
1/4" SDS OR SMS GRADE 5 INTO MIN. 1/8"  
A36 STEEL  
(SEE SHEET 3 FOR ANCHORS LAY-OUT)

OPTION 2 - 1X LAY-OUT AT HEADER & SILL CLUSTER OF ANCHORS

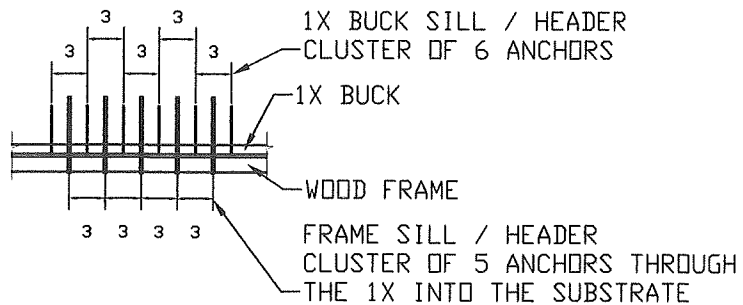

OPTION 3 - 2X LAY-OUT AT HEADER & SILL CLUSTER OF ANCHORS

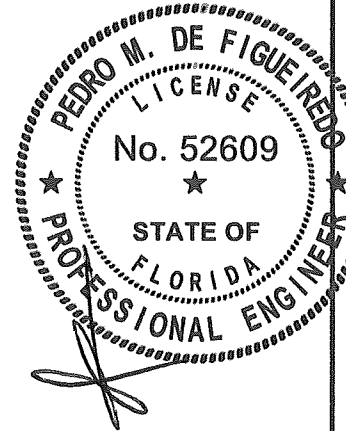
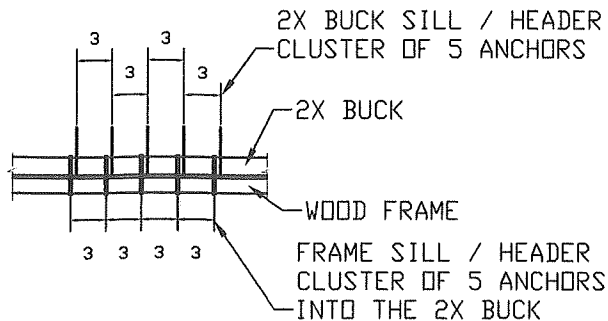

Pedro De Figueiredo  
PE 52609  
09/04/2023



ENGINEERING SERVICES - CA 32459  
9715 W. BROWARD BLVD.  
PLANTATION, FL 33324  
PPMFAOL.COM  
ENGINEER SEAL  
PEDRO DE FIGUEIREDO  
PE 52609

PRODUCT CATEGORY: DOORS - SWING OUT  
PRODUCT MATERIAL: WOOD / GLASS  
IMPACT RATING: LARGE & SMALL MISSILE  
**GLAZED WOOD SWING-OUT DOOR**  
SWIETENIA SERIES - SWING OUT DOORS

MANUFACTURER:  
**ROATAN**  
MAHOGANY USA INC.  
7005 N. WATERWAY DR. 302  
MIAMI FLORIDA 33155

MIAMI-DADE BCCO:

**PRODUCT REVISED**  
as complying with the Florida  
Building Code

NOA-No. 23-0928.34

Expiration Date 08/08/2029

By Ishag I. Chank  
Miami-Dade Product Control

SCALE:  
NA

DATE:  
09/04/2023

DRAWING #  
23-158

SHEET  
4 OF 10



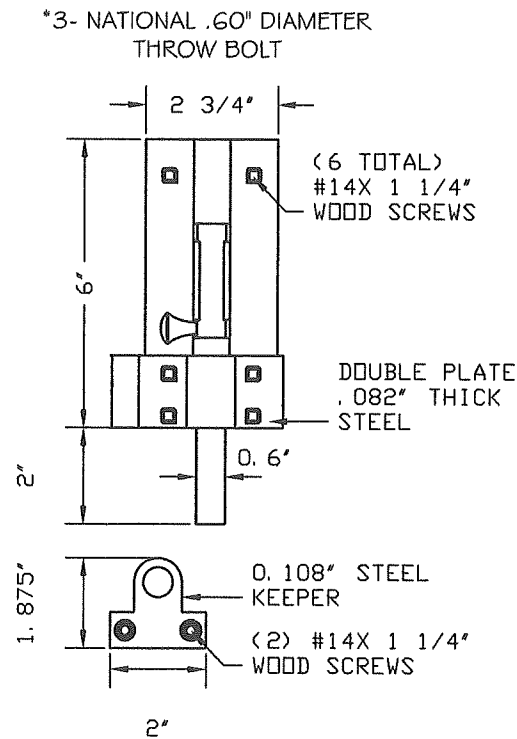

\*2- ARDIMPEX  
THREE POINT CREMONES  
SAME DETAIL TOP AND BOTTOM

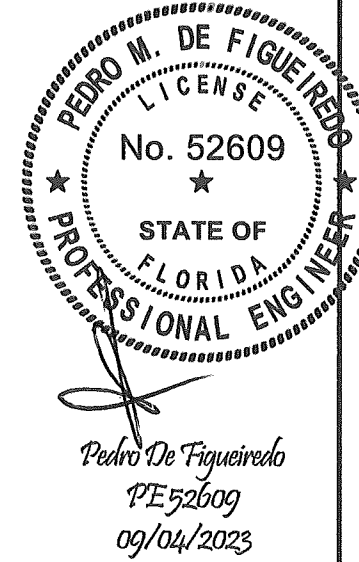
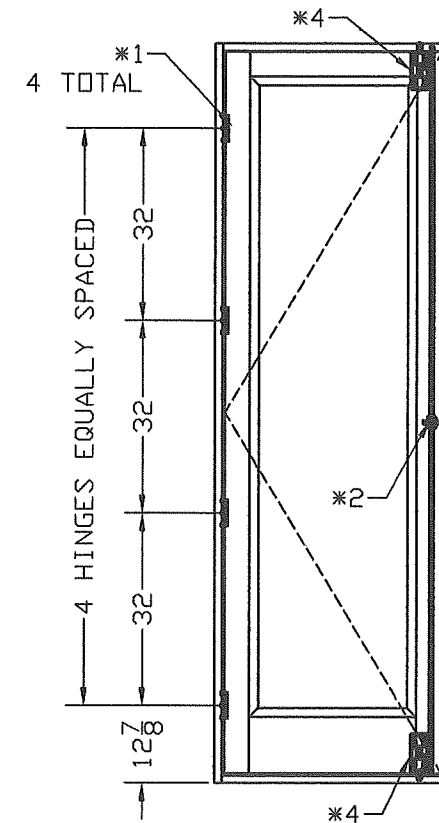
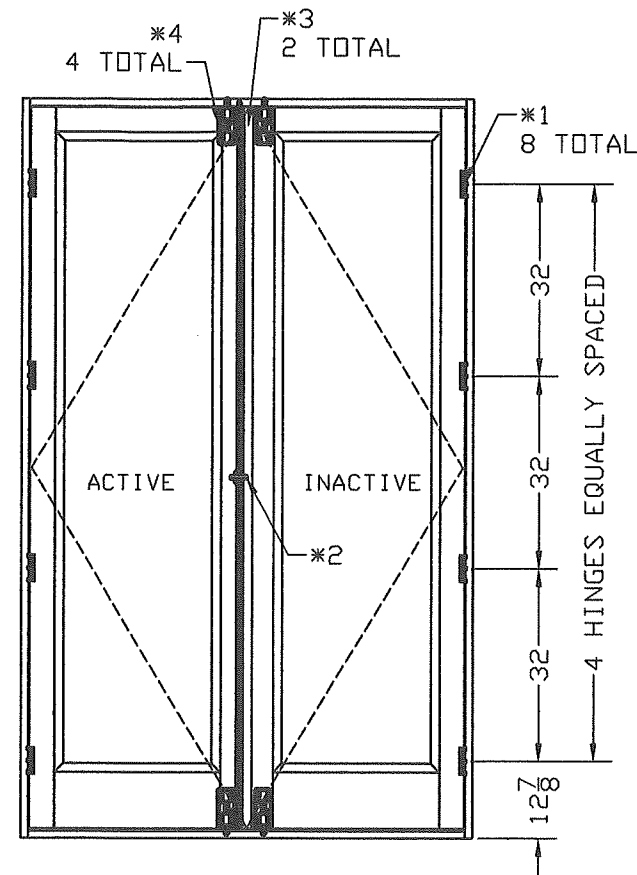
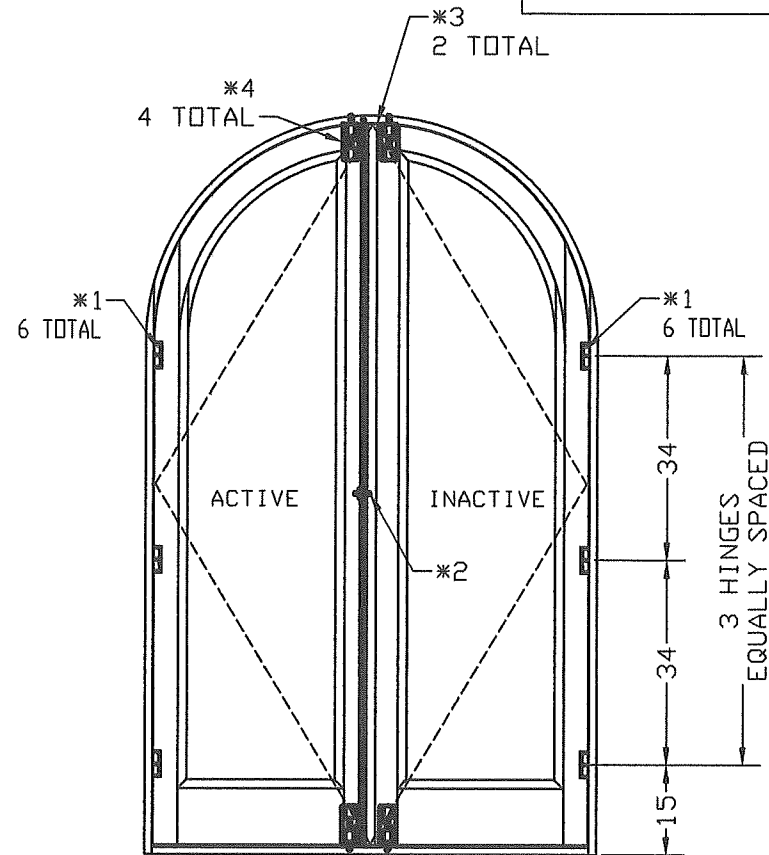
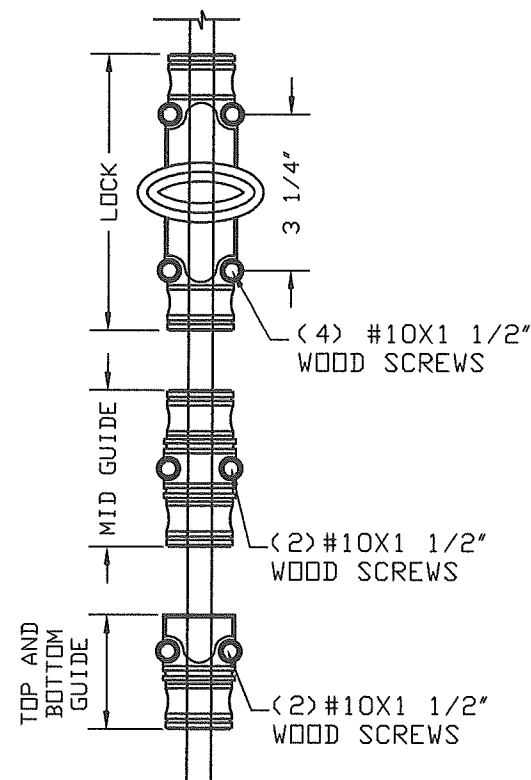

ENGINEERING SERVICES - CA 32459  
9715 W. BROWARD BLVD.  
PLANTATION, FL 33324  
PPMF@AOL.COM  
ENGINEER SEAL  
PEDRO DE FIGUEIREDO  
PE 52609

PRODUCT CATEGORY: DOORS - SWING OUT  
PRODUCT MATERIAL: WOOD / GLASS  
IMPACT RATING: LARGE & SMALL MISSILE  
**GLAZED WOOD SWING-OUT DOOR**  
SWIETENIA SERIES - SWING OUT DOORS

MANUFACTURER:  
**ROATAN**  
MAHOGANY USA INC.  
7005 N. WATERWAY DR. 302  
MIAMI FLORIDA 33155

HARDWARE TYPE 1 - PD= +75 PSF, -75 PSF					
ID	QTY	DESCRIPTION	LOCATION	PANEL	ATTACHMENT
1	8	4 1/2"x 4 1/2" x .136 HAGER 1279 HINGES - SQUARE DOOR, 4 PER LEAF	SEE ELEVATIONS	ACTIVE & INACTIVE	(8) #12X1 1/4" FH SMS
1	6	5 1/2"x 4 1/2" x .136 HAGER 1279 HINGES - ARCH DOOR, 3 PER LEAF	SEE ELEVATIONS	ACTIVE & INACTIVE	(6) #12X1 1/4" FH SMS
2	1	ARDIMPEX THREE POINT CREMONS ON ACTIVE LEAF FASTENED WITH (12) #10X 1 1/2" FH SMS.	SEE ELEVATIONS	ACTIVE	(12) #10 X 1 1/2" FH SMS
3	2	HARROW PRODUCTS INC. FLUSH BOLTS 29GG UL LISTED	TOP AND BOTTOM	INACTIVE	(6) #14 X 1 1/4" WOOD SCREWS
4	4	SECONDARY LOCKS (ACTIVATE ONLY WHEN HURRICANE FORCE WINDS ARE EXPECTED) - NATIONAL 0.60 DIA THROW BOLT	TOP AND BOTTOM	ACTIVE & INACTIVE	(6) #14 X 1 1/4" WOOD SCREWS

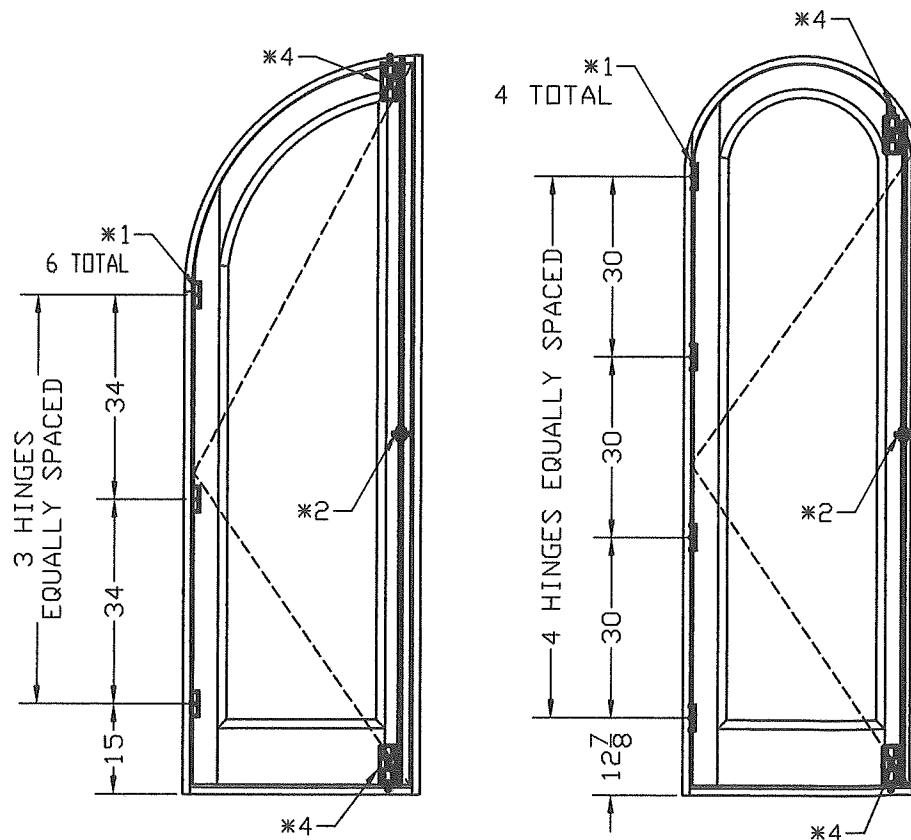

MIAMI-DADE BCCO:

**PRODUCT REVISED**  
as complying with the Florida  
Building Code

NOA-No. 23-0928.34

Expiration Date 08/08/2029

By Ishag I. Chank  
Miami-Dade Product Control

SCALE:  
NA

DATE:  
09/04/2023

DRAWING #  
23-158

SHEET  
5 OF 10

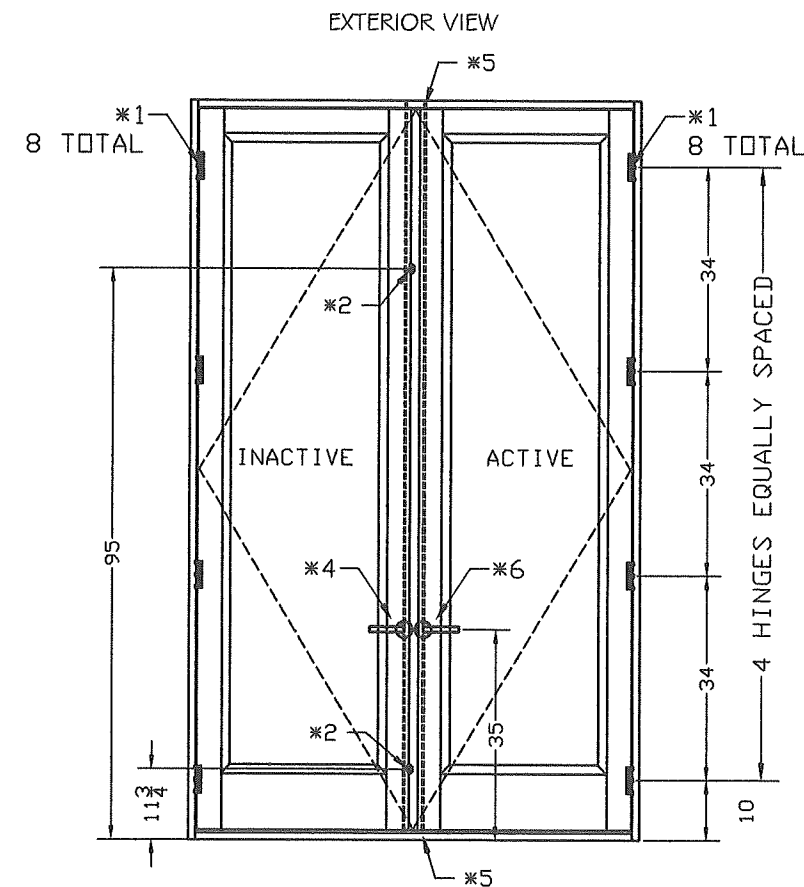

## HARDWARE TYPE 2 - LAY-OUT

HARDWARE TYPE 2 - PD= +75 PSF, -70 PSF					
ID	QTY	DESCRIPTION	LOCATION	PANEL	ATTACHMENT
1	8	4 1/2" x 4 1/2" DELTANA STEEL SURFACE MOUNT HINGES	10" FROM BOTTOM AND 34" EQUALLY SPACED	ACTIVE & INACTIVE	(8) #12X1 1/4" FHSM5
2	2	FLUSH MOUNT STEEL KEEPERS BY HOPPE	11 3/4" AND 95" FROM BOTTOM	INACTIVE	(2) #8X 1/2" FH SM5
3	1	FLUSH MOUNT STEEL STRIKE PLATE BY HOPPE	35 1/2" FROM BOTTOM	INACTIVE	(3) #8X 1/2" FH SM5
4	1	SURFACE MOUNT STEEL 2PT LOCK SYSTEM W/ ACTIVATING LEVER TYPE HANDLES BY HOPPE	35" FROM BOTTOM	INACTIVE	(2) #8-32 X 2 3/4" FHMS
5	2	SURFACE MOUNT STEEL STRIKE PLATE BY HOPPE	MIDSPAN FRAME HEADER AND THRESHOLD	FRAME	(2) #14X3 1/4" FHSM5
6	1	SURFACE MOUNT STEEL MULTI POINT 9000 SERIES LOCK SYSTEM WITH ACTIVATING LEVER TYPE HANDLES BY HOPPE	35" FROM BOTTOM	ACTIVE	(2) #8-32 X 2 3/4" FHMS

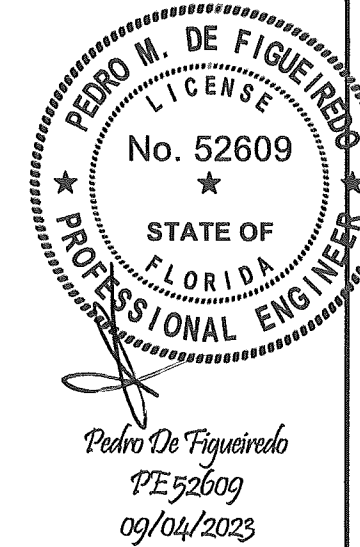

ENGINEERING SERVICES - CA 32459  
9715 W. BROWARD BLVD.  
PLANTATION, FL 33324  
PPMF@AOL.COM  
ENGINEER SEAL  
PEDRO DE FIGUEIREDO  
PE 52609

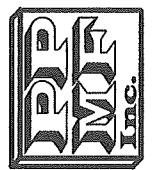

PRODUCT CATEGORY: DOORS - SWING OUT  
PRODUCT MATERIAL: WOOD / GLASS  
IMPACT RATING: LARGE & SMALL MISSILE  
**GLAZED WOOD SWING-OUT DOOR**  
SWIETENIA SERIES - SWING OUT DOORS

## ACTIVE ASTRAGAL INSTALLATION TO DOOR STILE SAME DETAIL TOP AND BOTTOM

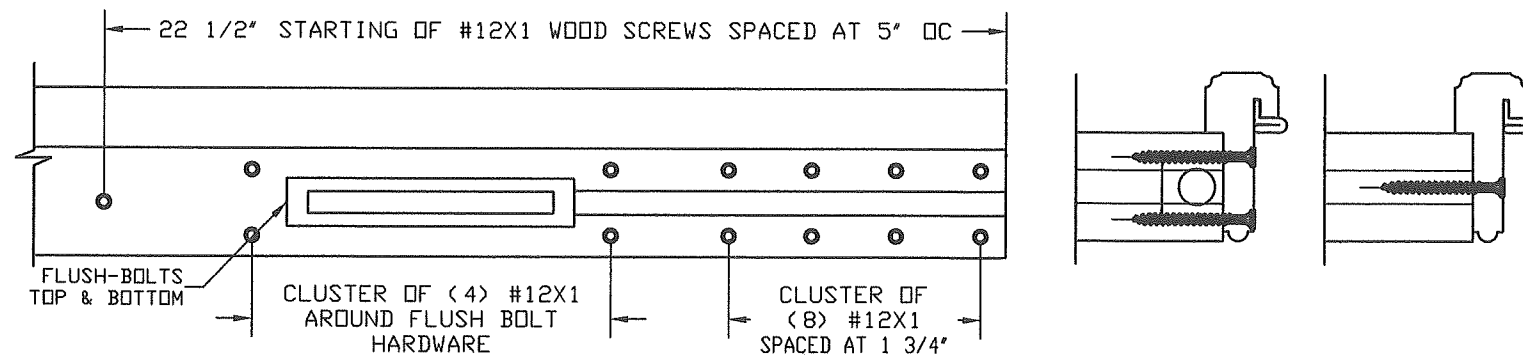

## INACTIVE ASTRAGAL INSTALLATION TO DOOR STILE SAME DETAIL TOP AND BOTTOM

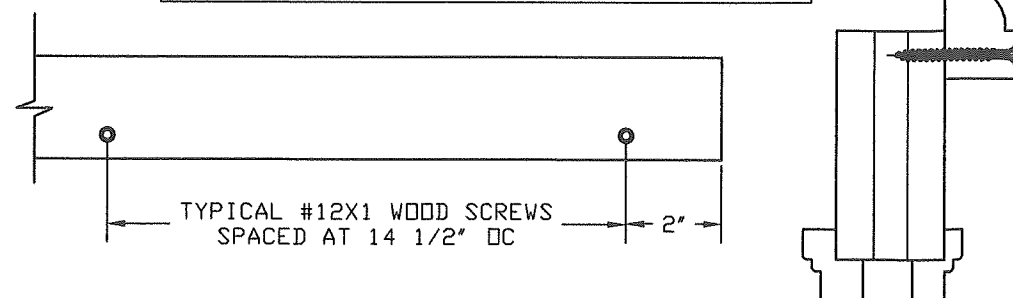

MIAMI-DADE BCCO:

**PRODUCT REVISED**  
as complying with the Florida  
Building Code

NOA-No. 23-0928.34

Expiration Date 08/08/2029

By Ishag I. Chank  
Miami-Dade Product Control

MANUFACTURER:

**ROATAN**  
MAHOGANY USA INC.  
7005 N. WATERWAY DR. 302  
MIAMI FLORIDA 33155

SCALE:  
NA

DATE:  
09/04/2023

DRAWING #  
23-158

SHEET  
6 OF 10

# CROSS SECTIONS WITH HARDWARE TYPE I

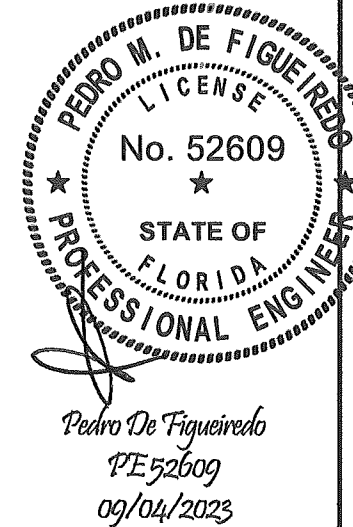
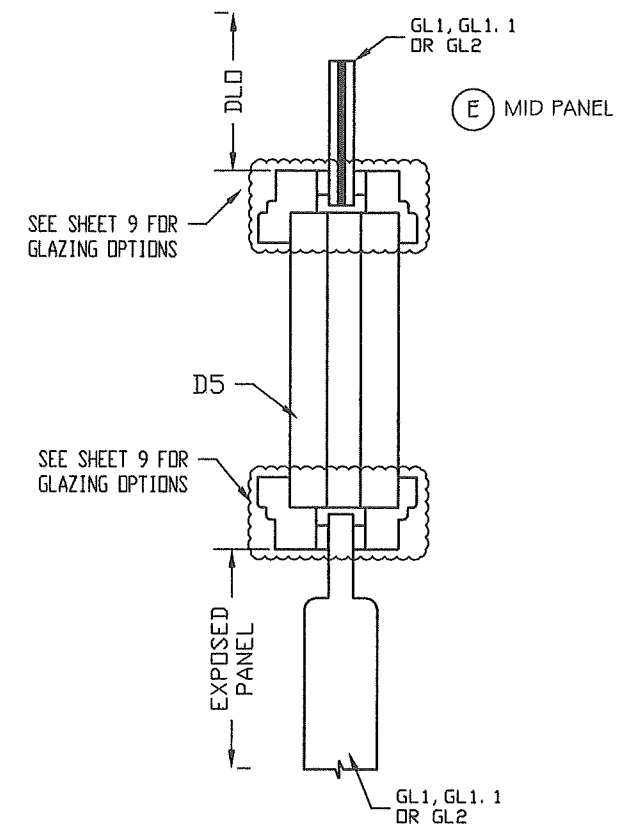
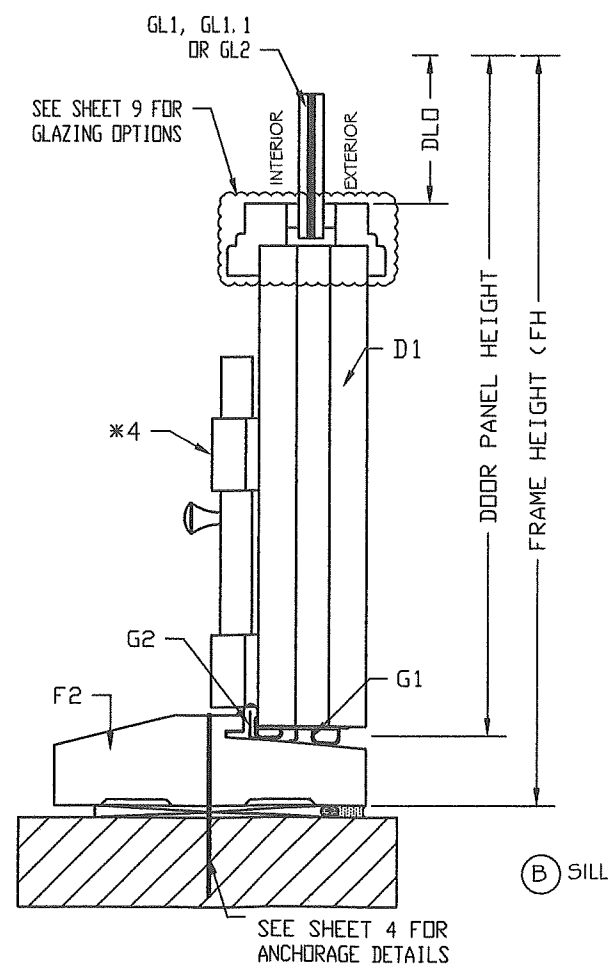
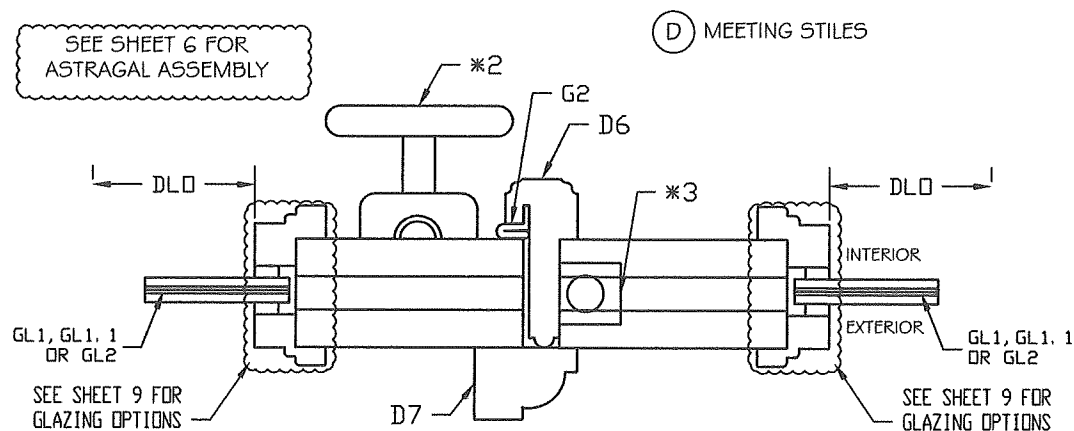
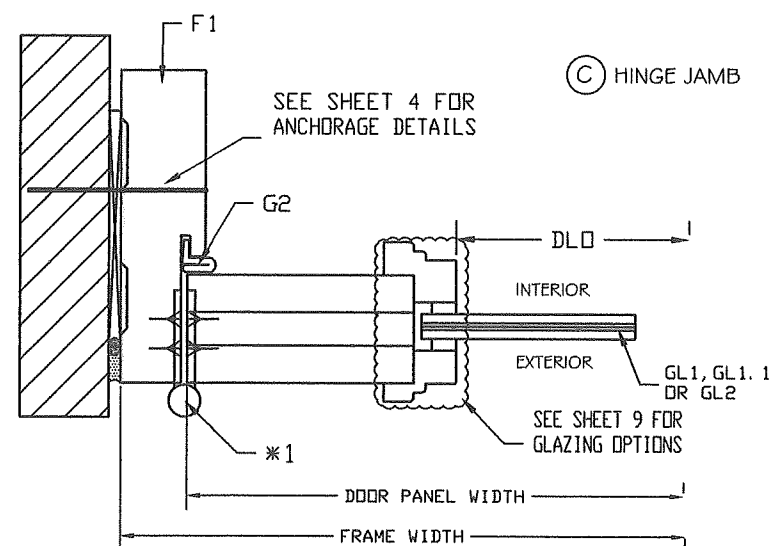
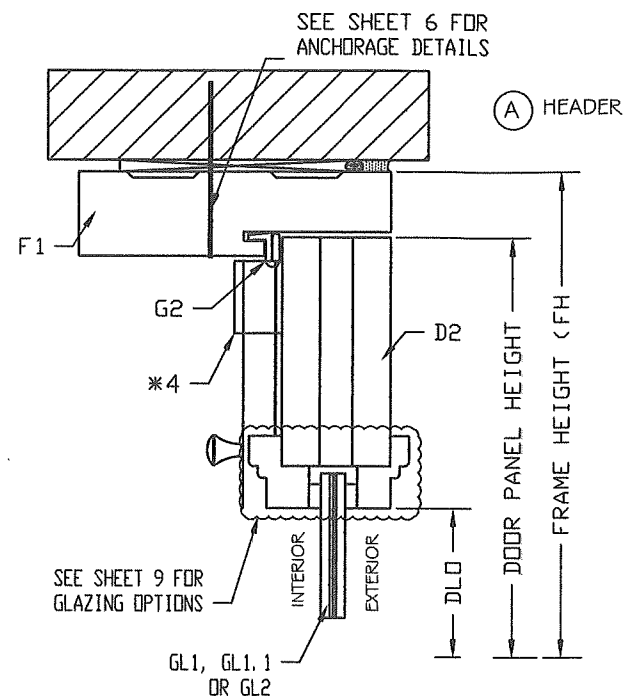
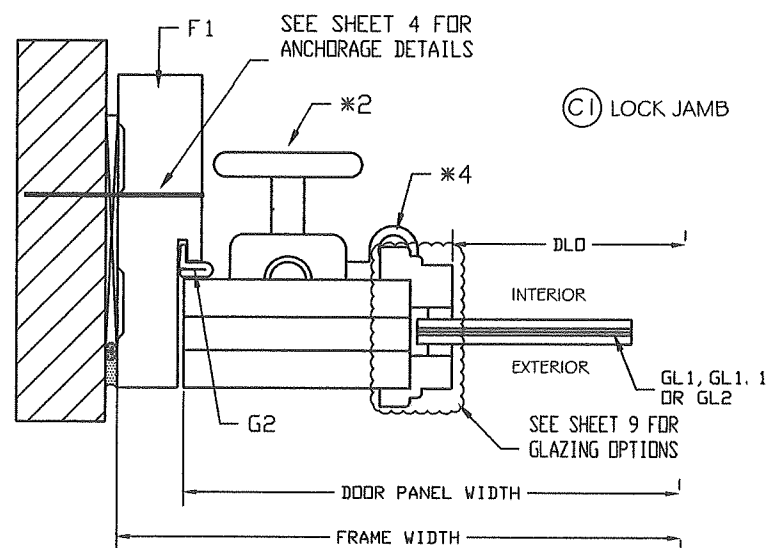

ENGINEERING SERVICES - CA 32459  
9715 W. BROWARD BLVD.  
PLANTATION, FL 33324  
PPMF@AOL.COM  
ENGINEER SEAL  
PEDRO DE FIGUEIREDO  
PE 52609



PRODUCT CATEGORY: DOORS - SWING OUT  
PRODUCT MATERIAL: WOOD / GLASS  
IMPACT RATING: LARGE & SMALL MISSILE  
**GLAZED WOOD SWING-OUT DOOR**  
SWIETENIA SERIES - SWING OUT DOORS

MANUFACTURER:  
**ROATAN**  
MAHOGANY USA INC.  
7005 N. WATERWAY DR. 302  
MIAMI FLORIDA 33155

MIAMI-DADE BCCO:

**PRODUCT REVISED**  
as complying with the Florida  
Building Code  
NOA-No. 23-0928.34  
Expiration Date 08/08/2029  
By Ishag I. Chank  
Miami-Dade Product Control

SCALE:  
NA  
DATE:  
09/04/2023  
DRAWING #  
23-158  
SHEET  
7 OF 10



CROSS SECTIONS WITH HARDWARE TYPE 2

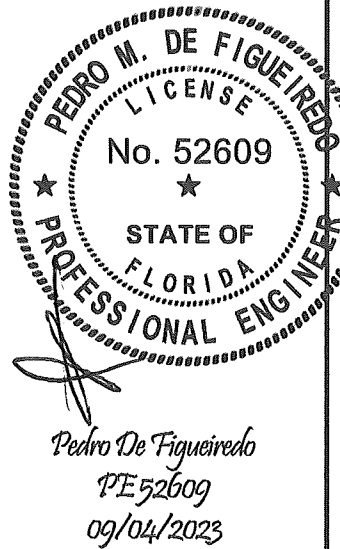
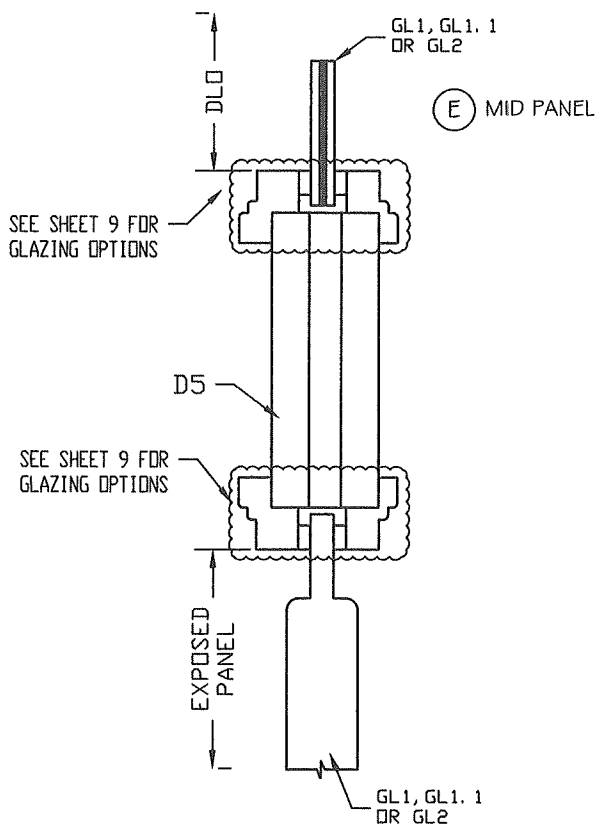
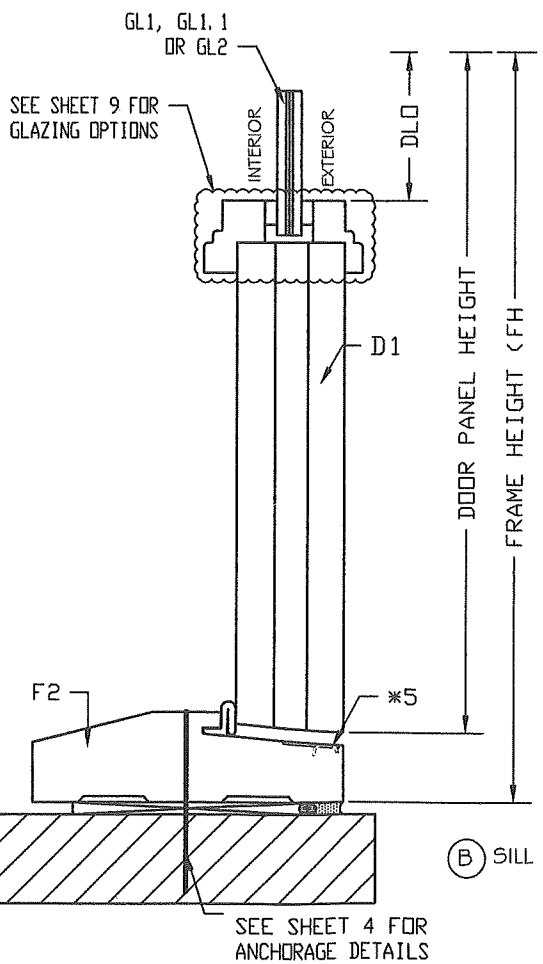
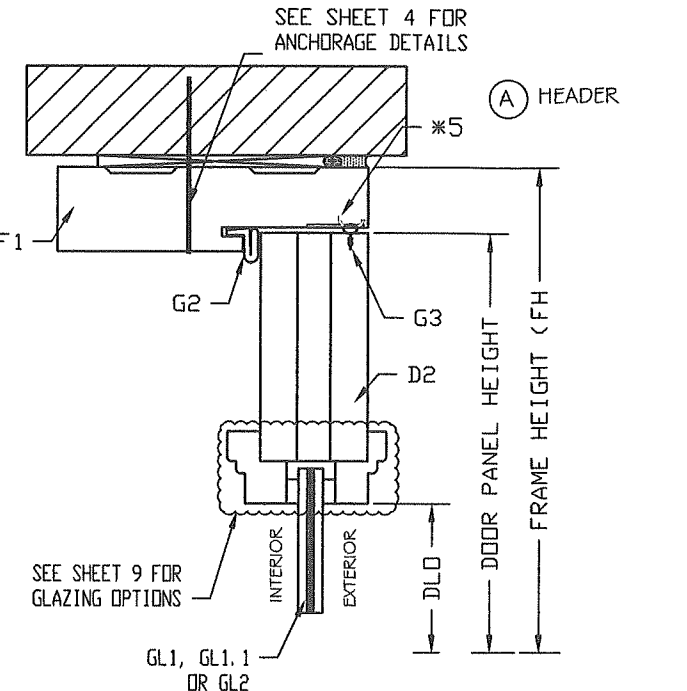
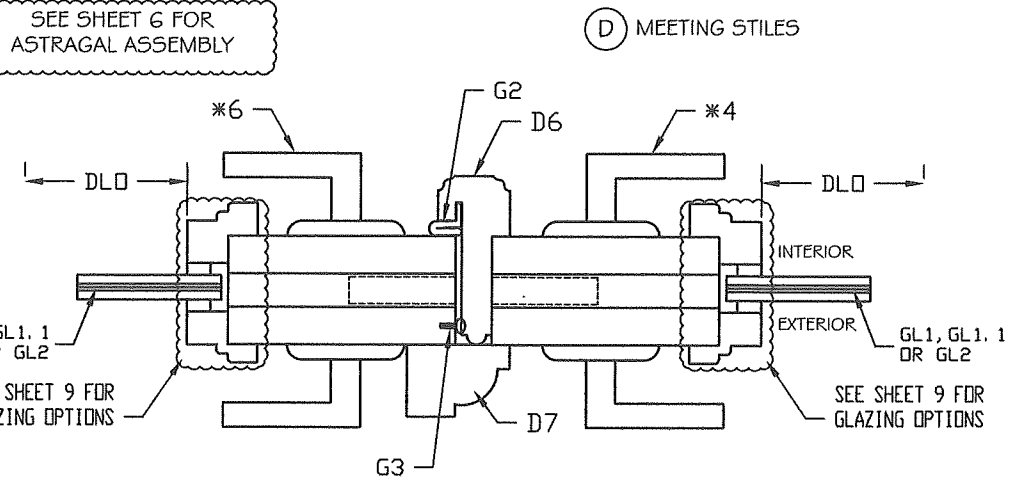
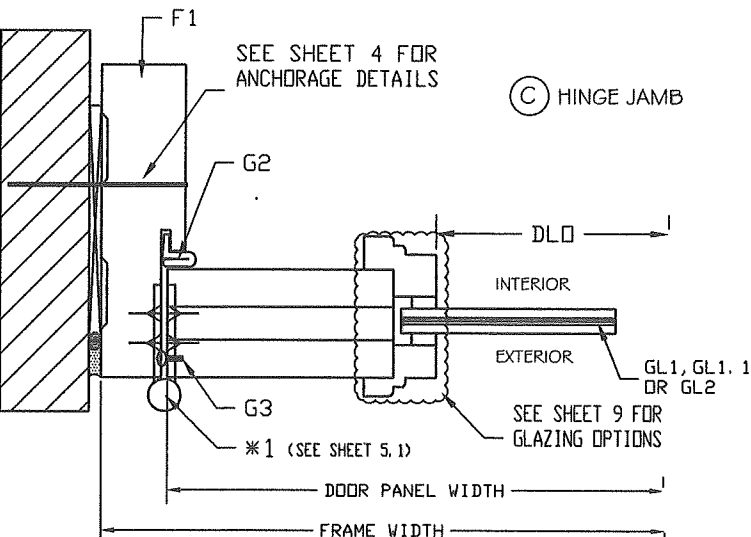
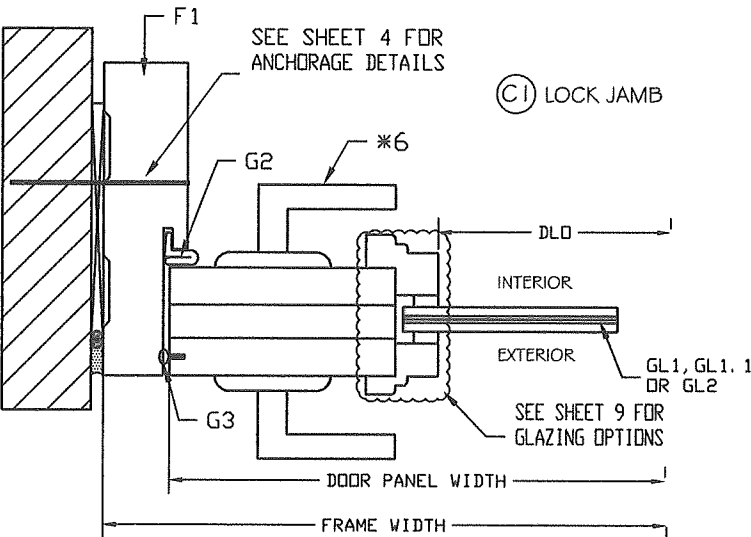

ENGINEERING SERVICES - CA 32459  
9715 W. BROWARD BLVD.  
PLANTATION, FL 33324  
PPMF@AOL.COM  
ENGINEER SEAL  
PEDRO DE FIGUEIREDO  
PE 52609

PRODUCT CATEGORY: DOORS - SWING OUT  
PRODUCT MATERIAL: WOOD / GLASS  
IMPACT RATING: LARGE & SMALL MISSILE  
GLAZED WOOD SWING-OUT DOOR  
SWIETENIA SERIES - SWING OUT DOORS

MANUFACTURER:  
**ROATAN**  
MAHOGANY USA INC.  
7005 N. WATERWAY DR. 302  
MIAMI FLORIDA 33155

MIAMI-DADE BCCO:

**PRODUCT REVISED**  
as complying with the Florida  
Building Code  
NOA-No. 23-0928.34  
Expiration Date 08/08/2029  
By Ishag I. Chank  
Miami-Dade Product Control

SCALE:  
NA

DATE:  
09/04/2023

DRAWING #  
23-158

SHEET  
8 OF 10

GLAZING OPTIONS

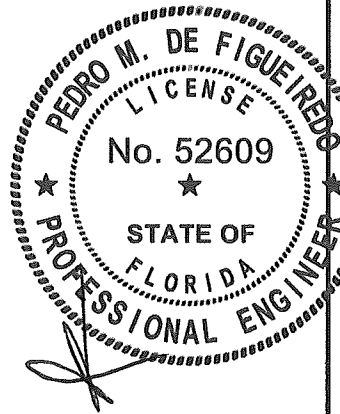
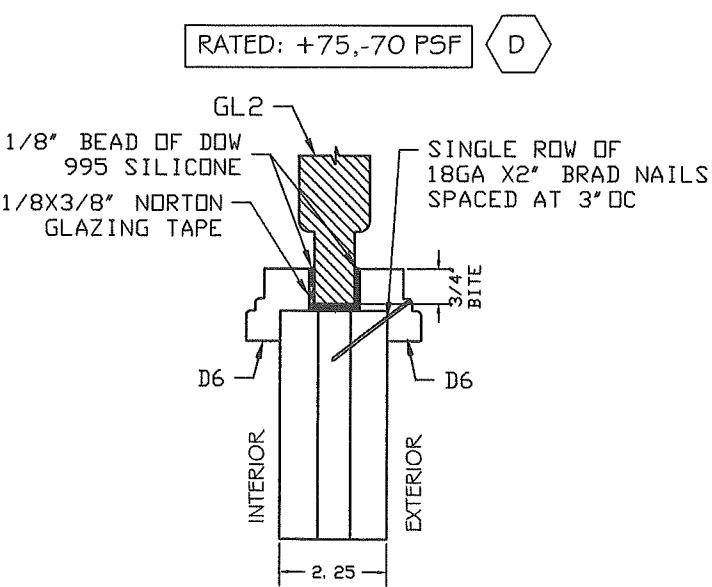
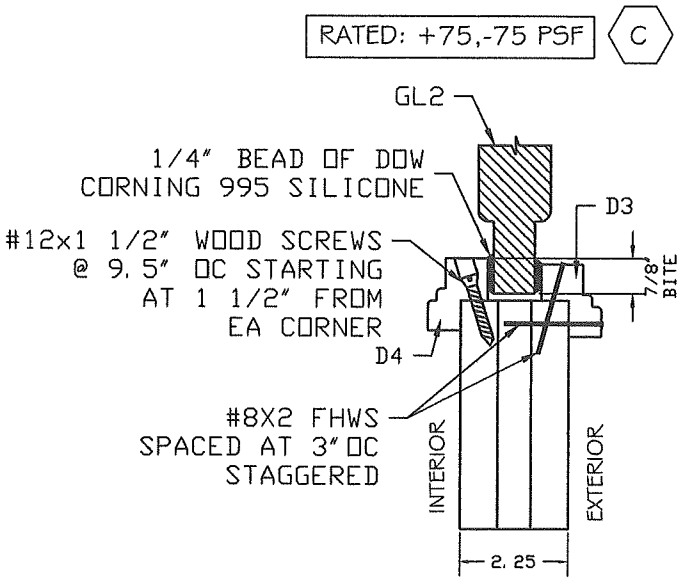
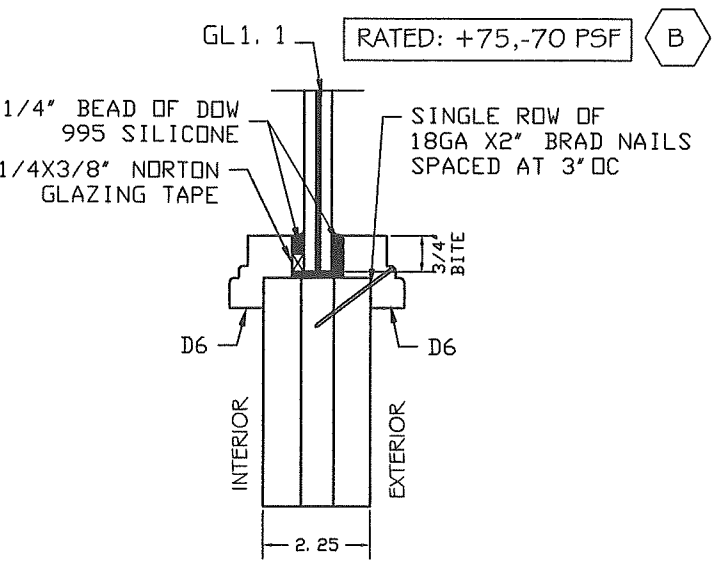
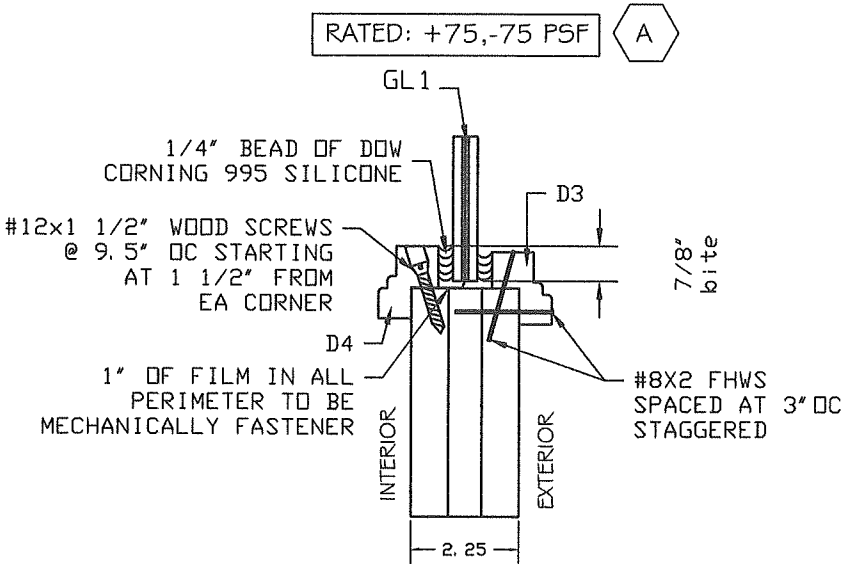

Pedro De Figueiredo  
PE 52609  
09/04/2023



PRODUCT CATEGORY: DOORS - SWING OUT  
PRODUCT MATERIAL: WOOD / GLASS  
IMPACT RATING: LARGE & SMALL MISSILE  
GLAZED WOOD SWING-OUT DOOR  
SWIETENIA SERIES - SWING OUT DOORS

MANUFACTURER:  
ROATAN  
MAHOGANY USA INC.  
7005 N. WATERWAY DR. 302  
MIAMI FLORIDA 33155

MIAMI-DADE BCCO:

**PRODUCT REVISED**  
as complying with the Florida  
Building Code  
NOA-No. 23-0928.34  
Expiration Date 08/08/2029

By Ishag I. Chank  
Miami-Dade Product Control

SCALE:  
NA

DATE:  
09/04/2023

DRAWING #  
23-158

SHEET  
9 OF 10

PRODUCT COMPONENTS, BILL OF MATERIALS AND ASSEMBLY

DOOR PARTS

CLADDING

FRAME AND DOOR ASSEMBLY

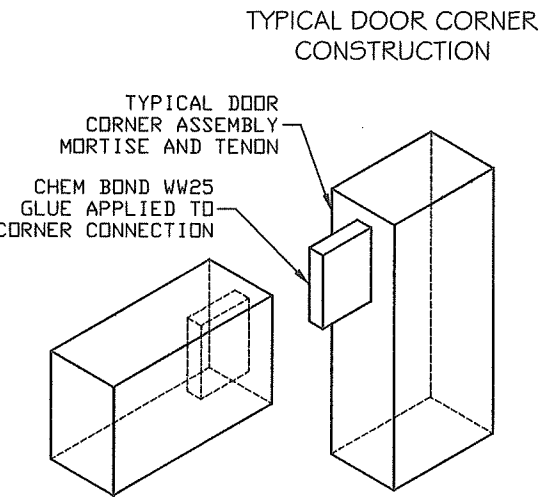
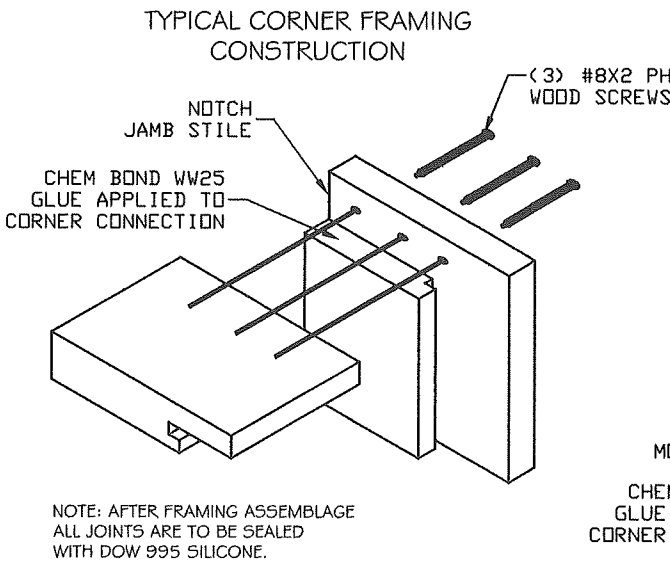
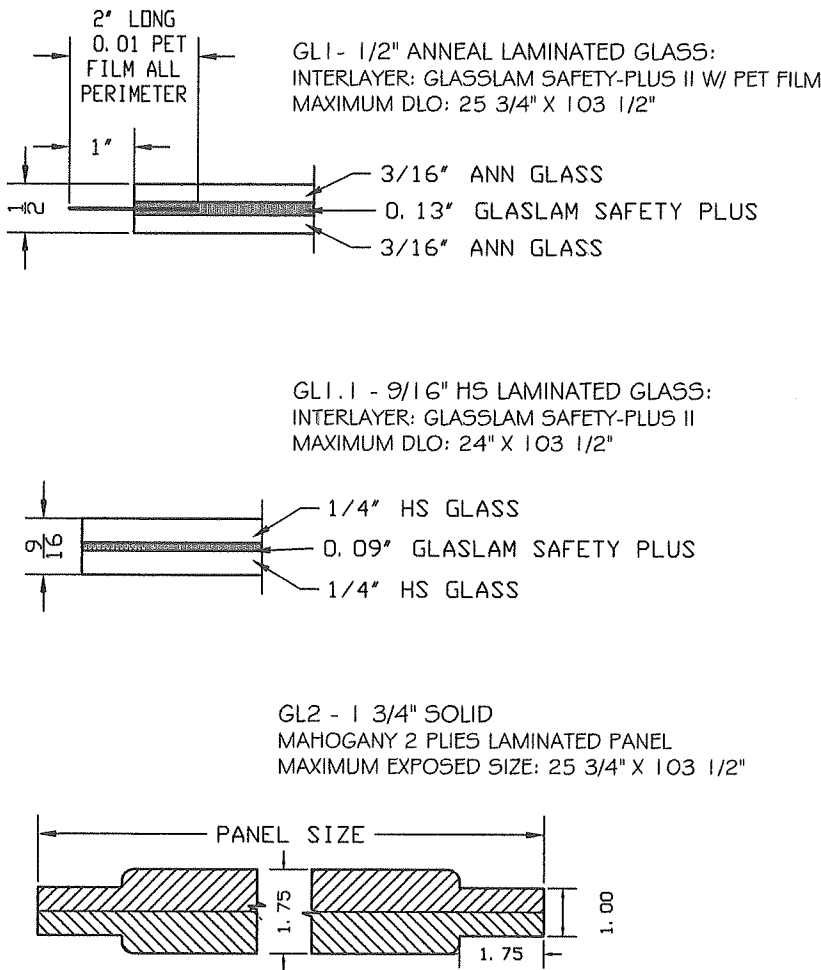
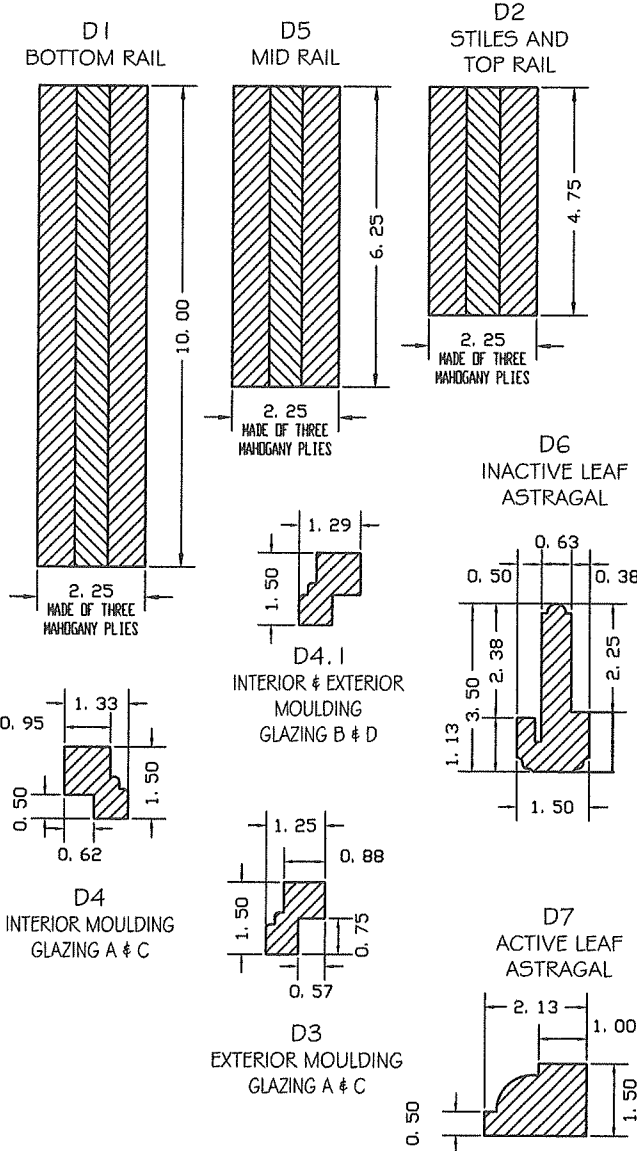

FRAME PARTS

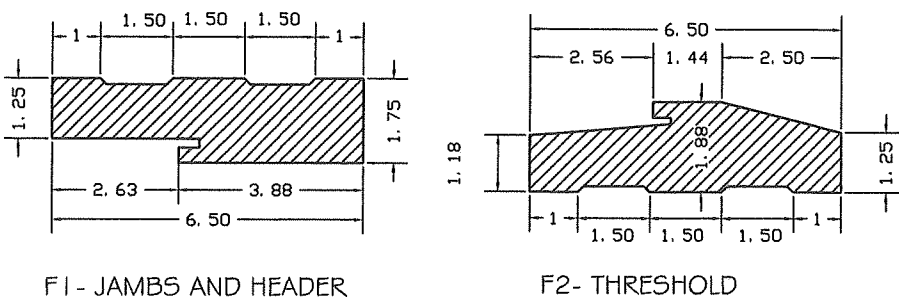

BILL OF MATERIALS			
ITEM#	DESCRIPTION	SIZE	REMARKS
D1	BOTTOM RAIL	2.25"X 10"	MAHOGANY WOOD
D2	TOP RAIL & STILES	2.25"X 4.75"	MAHOGANY WOOD
D3	EXTERIOR MOULDING FOR GLAZING TYPE A OR C	1.50"X 1.25"	MAHOGANY WOOD
D4	INTERIOR MOULDING FOR GLAZING TYPE A OR C	1.50"X 1.33"	MAHOGANY WOOD
D4.1	MOULDING FOR GLAZING TYPE B OR D	1.50" X 1.29"	MAHOGANY WOOD
D5	MID RAIL	2.25"X 6.25"	MAHOGANY WOOD
D6	INACTIVE ASTRAGAL	3.50"X 1.50"	MAHOGANY WOOD
D7	ACTIVE ASTRAGAL	2.13"X 1.50"	MAHOGANY WOOD
GL1	IMPACT GLASS	1/2" LAMINATED	BY GLASSLAM
GL1.1	IMPACT GLASS	9/16" LAMINATED	BY GLASSLAM
GL2	LAMINATED WOOD PANEL	1.75" THICK	MAHOGANY WOOD
F1	JAMB AND HEADER	1.75"X6.50"	MAHOGANY WOOD
F2	SILL	1.875"X6.50"	MAHOGANY WOOD
G1	BOTTOM RAIL GASKET	2.25"X0.5"	PEMKO V80DS VINYL
G2	FRAME SEAL	0.65"X0.58"	SCHEGEL QDS 650
G3	FRAME SEAL	BUBBLE STRIP	AP-425

WEATHER GASKETS

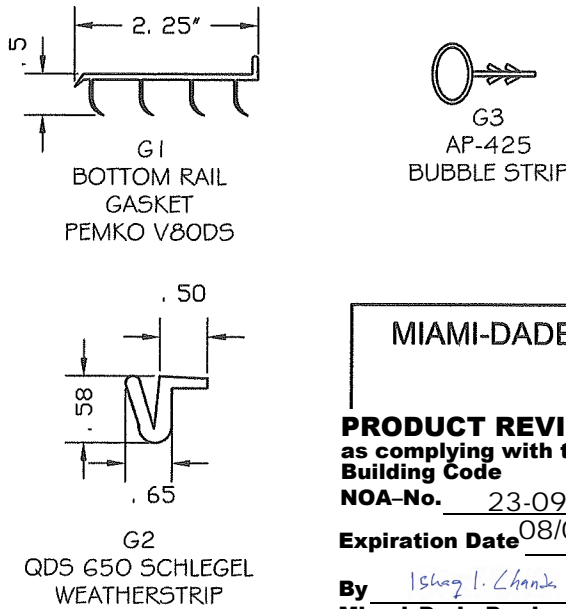

MIAMI-DADE BCCO:

**PRODUCT REVISED**  
as complying with the Florida Building Code  
NOA-No. 23-0928.34  
Expiration Date 08/08/2029  
By Ishag I. Chank  
Miami-Dade Product Control

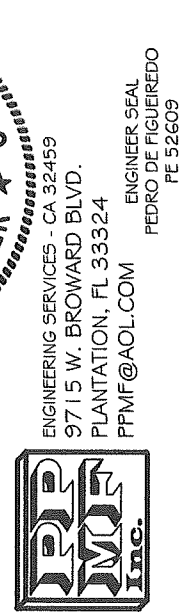
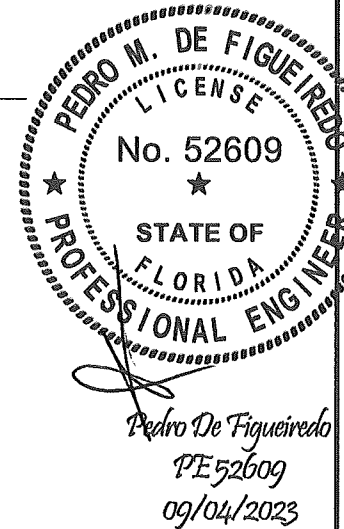

PRODUCT CATEGORY: DOORS - SWING OUT  
PRODUCT MATERIAL: WOOD / GLASS  
IMPACT RATING: LARGE & SMALL MISSILE  
**GLAZED WOOD SWING-OUT DOOR**  
SWIETENIA SERIES - SWING OUT DOORS

MANUFACTURER:  
**ROATAN**  
MAHOGANY USA INC.  
7005 N. WATERWAY DR. 302  
MIAMI FLORIDA 33155

SCALE: NA  
DATE: 09/04/2023  
DRAWING # 23-158  
SHEET 10 OF 10