



DEPARTMENT OF REGULATORY AND ECONOMIC RESOURCES (RER)

BOARD AND CODE ADMINISTRATION DIVISION

NOTICE OF ACCEPTANCE (NOA)

MIAMI-DADE COUNTY, FLORIDA
PRODUCT CONTROL SECTION

11805 SW 26 Street, Room 208

Miami, FL 33175

T (786) 315-2590 F (786) 315-2599

www.miamidade.gov/economy

Impact Precious Wood, Inc.

6333 NW 74 Ave

Miami, FL 33166

SCOPE:

This NOA is being issued under the applicable rules and regulations governing the use of construction materials. The documentation submitted has been reviewed and accepted by Miami-Dade County RER-Product Control Section to be used in Miami-Dade County and other areas where allowed by the Authority Having Jurisdiction (AHJ).

This NOA shall not be valid after the expiration date stated below. The Miami-Dade County Product Control Section (In Miami-Dade County) and/ or the AHJ (in areas other than Miami-Dade County) reserve the right to have this product or material tested for quality assurance purposes. If this product or material fails to perform in the accepted manner, the manufacturer will incur the expense of such testing and the AHJ may immediately revoke, modify, or suspend the use of such product or material within their jurisdiction. RER reserves the right to revoke this acceptance, if it is determined by Miami-Dade County Product Control Section that this product or material fails to meet the requirements of the applicable building code. This product is approved as described herein, and has been designed to comply with the Florida Building Code, including the High Velocity Hurricane Zone.

DESCRIPTION: Series "Double & Single" Out-Swing Glazed Wood Doors and Panel – L.M.I.

APPROVAL DOCUMENT: Drawing No. **23-232** (former **20-291**), titled "Double & Single Outswing Wood Doors, w/ Wood & Glazed Panels", sheets 1 through 10 of 10, dated 10/12/2020 and last revised on 10/16/2023, prepared by Tilteco, Inc., signed and sealed by Walter A. Tillit, Jr., P.E., bearing the Miami-Dade County Product Control Section Revision stamp with the Notice of Acceptance number and expiration date by the Miami-Dade County Product Control Section.

MISSILE IMPACT RATING: Large and Small Missile Impact Resistant

LABELING: Each unit shall bear a permanent label with the manufacturer's name or logo, **Bogota D.C., Colombia**, series, and following statement: "Miami-Dade County Product Control Approved", unless otherwise noted herein.

RENEWAL of this NOA shall be considered after a renewal application has been filed and there has been no change in the applicable building code negatively affecting the performance of this product.

TERMINATION of this NOA will occur after the expiration date or if there has been a revision or change in the materials, use, and/ or manufacture of the product or process. Misuse of this NOA as an endorsement of any product, for sales, advertising or any other purposes shall automatically terminate this NOA. Failure to comply with any section of this NOA shall be cause for termination and removal of NOA.

ADVERTISEMENT: The NOA number preceded by the words Miami-Dade County, Florida, and followed by the expiration date may be displayed in advertising literature. If any portion of the NOA is displayed, then it shall be done in its entirety.

INSPECTION: A copy of this entire NOA shall be provided to the user by the manufacturer or its distributors and shall be available for inspection at the job site at the request of the Building Official.

This NOA **revises NOA No. 20-1103.02** and consists of this page 1 and evidence pages E-1, E-2 and E-3, as well as approval document mentioned above.

The submitted documentation was reviewed by **Ishaq I. Chanda, P.E.**



Ishaq I. Chanda

NOA No. 23-1017.12

Expiration Date: October 12, 2026

Approval Date: November 16, 2023

Page 1

Impact Precious Wood, Inc.

NOTICE OF ACCEPTANCE: EVIDENCE SUBMITTED

1. EVIDENCE SUBMITTED UNDER PREVIOUS NOA'S

A. DRAWINGS

1. Manufacturer's die drawings and sections. *(Submitted under NOA No. 06-0809.02)*
2. Drawing No. **16-003**, titled "Double & Single Outswing Wood Doors, w/ wood & Glazed Panels", sheets 1 through 10 of 10, dated 03/30/06 with the latest revision dated 05/18/16, prepared by Tilteco, Inc., signed and sealed by Walter A. Tillit, Jr., P.E.

B. TESTS

1. Test reports on: 1) Air Infiltration Test, per FBC, TAS 202-94
2) Uniform Static Air Pressure Test, Loading per FBC TAS 202-94
3) Water Resistance Test, per FBC, TAS 202-94
4) Large Missile Impact Test per FBC, TAS 201-94
5) Cyclic Wind Pressure Loading per FBC, TAS 203-94
6) Forced Entry Test, Side-Hinged Door Systems, per ANSI/AAMA 1302.5/ 1303.5 and per FBC 2411.3.2.1, TAS 202-94
along with marked-up drawings and installation diagram of Mahogany Out-Swinging Entrance Doors, prepared by Fenestration Testing Laboratory, Inc. Test Reports No.'s **FTL-4560** and **FTL-4552**, dated 07/20/05 and 12/05/05, both signed and sealed by Edmundo J. Largaespada, P.E. *(Submitted under NOA No. 06-0809.02)*
2. Test reports on: 1) Large Missile Impact Test per FBC, TAS 201-94
2) Cyclic Wind Pressure Loading per FBC, TAS 203-94
along with marked-up drawings and installation diagram of Mahogany Out-Swinging Entrance Doors, prepared by Hurricane Engineering Testing, LLC, Test Reports No.'s **HETI-04-1923A** and **HETI-04-1923B**, dated 10/05 and 11/11/04, both signed and sealed by Ivonne Ghia, P.E. *(Submitted under NOA No. 06-0809.02)*

C. CALCULATIONS

1. Anchor verification calculations and structural analysis, complying with **FBC-5th Edition (2014)**, prepared by Tilteco, Inc., dated 01/12/16, signed and sealed by Walter A. Tillit, Jr., P.E.
2. **Glazing complies with ASTM E1300-98/09a**

D. QUALITY ASSURANCE

1. Miami-Dade Department of Regulatory and Economic Resources (RER).

E. MATERIAL CERTIFICATIONS

1. Notice of Acceptance No. **17-0919.09** issued to **Allnex USA, Inc.** for their "Uvekol S Laminated Glass Interlayer", dated 12/28/17, expiring on 02/08/19.
2. Notice of Acceptance No. **16-0208.12** issued to **Polymer Extrusion Technology, Inc. dba Glasslam** for their "Glasslam Safety-Plus II Glass Interlyer", dated 06/16/16, expiring on 08/07/18.

Ishaq I. Chanda

Ishaq I. Chanda, P. E.
Product Control Unit Supervisor
NOA No. 23-1017.12
Expiration Date: October 12, 2026
Approval Date: November 16, 2023

Impact Precious Wood, Inc.

NOTICE OF ACCEPTANCE: EVIDENCE SUBMITTED

F. STATEMENTS

1. Statement letter of conformance, of complying with **FBC 5th Edition (2014)** and with ANSI/AAMA/NWDA 101/ I.S2-97, dated 01/12/16, and Statement letter of no financial interest and independency, dated 08/11/11, signed and sealed by Walter A. Tillit, Jr., P. E. signed and sealed by Walter A. Tillit, Jr., P. E.
2. Distributor Agreement between **Colmad, Ltda.**; Bogota, D.C.; Colombia and **Impact Precious Wood, Inc.**, Miami, Florida, USA, dated 11/12/11, signed by Marebel Reyes Bustos and Ruth Velia Giraldo, respectively. *(Submitted under NOA No. 11-0817.10)*
3. Proposal issued by Product Control, dated 07/26/05, signed by Jaime D. Gascon, P. E. *(Submitted under NOA No. 06-0809.02)*

G. OTHERS

1. This NOA revises NOA #16-0119.01, expiring on 10/12/2021.

2. EVIDENCE SUBMITTED under previous approval

A. DRAWINGS

1. Drawing No. **17-293**, titled “Double & Single Outswing Wood Doors, w/ Wood & Glazed Panels”, sheets 1 through 10 of 10, dated 11/20/17 with the latest revision dated 11/20/17, prepared by Tilteco, Inc., signed and sealed by Walter A. Tillit, Jr., P.E.

B. TESTS

1. None.

C. CALCULATIONS

1. None.

D. QUALITY ASSURANCE

1. Miami-Dade Department of Regulatory and Economic Resources (RER).

E. MATERIAL CERTIFICATIONS

1. NOA No. **20-0901.03** issued to **Allnex USA, Inc.** for their “**Uvekol S Laminated Glass Interlayer**”, expiring on 02/08/24.
2. NOA No. **18-0619.01** issued to **Polymer Extrusion Technology, Inc. dba Glasslam** for their “**Glasslam Safety-Plus II Glass Interlyer**”, expiring on 08/07/23.

F. STATEMENTS

1. Statement letter of conformance, to **FBC 7th Edition (2020)** and with ANSI/AAMA/NWDA 101/I.S2-97, dated 10/12/2020, signed and sealed by Walter A. Tillit, Jr., P. E.

G. OTHERS

1. This NOA revises and renews NOA #17-1226.09, expiring on 10/12/2021.

Ishaq I. Chanda _____
Ishaq I. Chanda, P. E.
Product Control Unit Supervisor
NOA No. 23-1017.12
Expiration Date: October 12, 2026
Approval Date: November 16, 2023

Impact Precious Wood, Inc.

NOTICE OF ACCEPTANCE: EVIDENCE SUBMITTED

3. NEW EVIDENCE SUBMITTED

A. DRAWINGS

1. Drawing No. **17-293**, titled “Double & Single Outswing Wood Doors, w/ Wood & Glazed Panels”, sheets 1 through 10 of 10, dated 11/20/17 with the latest revision dated 11/20/17, prepared by Tilteco, Inc., signed and sealed by Walter A. Tillit, Jr., P.E.

B. TESTS

1. None.

C. CALCULATIONS

1. None.

D. QUALITY ASSURANCE

1. Miami-Dade Department of Regulatory and Economic Resources (RER).

E. MATERIAL CERTIFICATIONS

1. NOA No. **20-0901.03** issued to **Allnex USA, Inc.** for their “**Uvekol S Laminated Glass Interlayer**”, expiring on 02/08/24.

F. STATEMENTS

1. Statement letter of conformance, to **FBC 8th Edition (2023)**, dated 10/11/2023, signed and sealed by Walter A. Tillit, Jr., P. E.

G. OTHERS

1. This NOA **revises** NOA #**20-1103.02** and updates to FBC 2023, expiring on 10/12/2026.

Ishaq I. Chanda

Ishaq I. Chanda, P. E.
Product Control Unit Supervisor
NOA No. 23-1017.12
Expiration Date: October 12, 2026
Approval Date: November 16, 2023

GENERAL NOTES AND SPECIFICATIONS:

1. FENESTRATIONS SHOWN ON THIS PRODUCT APPROVAL DOCUMENT (P.A.D.) HAVE BEEN VERIFIED FOR COMPLIANCE IN ACCORDANCE WITH THE **2023 (8th EDITION) AND 2020 (7th EDITION)** OF THE FLORIDA BUILDING CODE. FENESTRATIONS MAY BE INSTALLED AT HIGH VELOCITY HURRICANE ZONES. DESIGN WIND LOADS SHALL BE DETERMINED AS PER SECTION **1620** OF THE ABOVE MENTIONED CODE, USING **ASCE 7-22 (FBC 2023) AND ASCE 7-16 (FBC 2020)** STANDARD, AND SHALL NOT EXCEED THE MAXIMUM (A.S.D.) DESIGN PRESSURE INDICATED ON NOTE 2 BELOW. IN ORDER TO VERIFY THE ABOVE CONDITION, ULTIMATE DESIGN WIND LOADS DETERMINED PER **ASCE 7-22 & ASCE 7-16** SHALL BE FIRST REDUCED TO A.S.D. DESIGN WIND LOADS BY MULTIPLYING THEM BY 0.6 IN ORDER TO COMPARE THESE W/ MAX. (A.S.D) DESIGN PRESSURE RATINGS INDICATED ON NOTE 2. IN ORDER TO VERIFY THAT ANCHORS ON THIS P.A.D., AS TESTED, WERE NOT OVER STRESSED, A 33% INCREASE IN ALLOWABLE STRESS FOR WIND LOADS WAS **NOT** USED IN THEIR ANALYSIS. THESE FENESTRATION'S ADEQUACY FOR IMPACT AND CYCLIC RESISTANCE HAS BEEN VERIFIED IN ACCORDANCE WITH SECTION **1626** OF THE ABOVE MENTIONED CODE AS PER PROTOCOLS TAS-201, TAS-202, TAS-203, PER FTL REPORTS No. 4752 AND 4560, AND HETI REPORTS No. 04-1923A, 04-1923B AND AS PER SUBMITTED STRUCTURAL CALCULATIONS, PERFORMED AS PER SECTION 1616 OF THE FLORIDA BUILDING CODE.
2. **MAXIMUM (ALLOWABLE STRESS DESIGN=A.S.D) DESIGN PRESSURE RATING IS: +60.0 psf., -65.0 psf WITH REQUIRED HARDWARE. AS PER ELEVATIONS SHOWN ON SHEETS 2, 3 & 4.**
3. THESE FENESTRATIONS ARE APPROVED FOR AIR/WATER INFILTRATION.
4. ALL COMPONENTS SHALL BE AS PER BILL OF MATERIALS ON SHEET 5.
5. WOOD BUCKS BY OTHERS, MUST BE ANCHORED PROPERLY TO TRANSFER LOADS TO THE BUILDING STRUCTURE. WOOD BUCKS MUST BE SOUTHERN PINE WITH A MINIMUM SPECIFIC DENSITY G=0.55. WOOD BUCKS MUST SUSTAIN LOADS IMPOSED BY FENESTRATIONS AND TRANSFER THEM TO THE BUILDING STRUCTURE AND TO BE REVIEWED BY BUILDING OFFICIAL, AND SHALL COMPLY W/ SECTIONS 2411.3.3.3 & 2326 OF THE FLORIDA BUILDING CODE. PROVIDE 1/4" MAX. LOAD BEARING SHIM SPACE (TYP.), WHEN ALLOWED BY THIS DRAWING.
6. ALL FRAME MEMBERS SHALL BE ANCHORED TO EXISTING STRUCTURE FOLLOWING SPECS INDICATED ON SHEETS 2, 3, 4 & 9, AS APPLICABLE.
7. **THESE FENESTRATIONS WILL NOT REQUIRE A HURRICANE PROTECTION DEVICE.**
8. FENESTRATION'S MANUFACTURER LABEL SHALL BE PLACED ON A READILY VISIBLE LOCATION. ONE LABEL SHALL BE PLACED FOR EVERY OPENING. LABEL SHALL COMPLY WITH SECTION 1709.5 OF THE FLORIDA BUILDING CODE.
9. FENESTRATIONS INSTALLATION SHALL STRICTLY COMPLY WITH SPECS INDICATED ON THIS DRAWING PLUS ANY BUILDING AND ZONING REGULATIONS PROVIDED BY THE JURISDICTION WHERE PERMIT IS APPLIED TO.
10. ALL FENESTRATIONS COMPONENT EDGES WHICH REMAIN IN CONTINUOUS CONTACT WITH THE BUILDING SHALL BE SEALED/CAULK TO PREVENT WIND/RAIN INTRUSION. CAULK AND SEAL ALL AROUND FULL LENGTH.

11. (a) THIS P.A.D. PREPARED BY THIS ENGINEER IS GENERIC AND DOES NOT PROVIDE INFORMATION FOR A SITE SPECIFIC PROJECT; i.e. WHERE THE SITE CONDITIONS DEVIATE FROM THE P.A.D.

(b) CONTRACTOR TO BE RESPONSIBLE FOR THE SELECTION, PURCHASE AND INSTALLATION INCLUDING LIFE SAFETY OF THIS PRODUCT, BASED ON THIS P.A.D., PROVIDED HE/SHE DOES NOT DEVIATE FROM THE CONDITIONS DETAILED ON THIS DOCUMENT. CONSTRUCTION SAFETY AT SITE IS THE CONTRACTOR'S RESPONSIBILITY.

(c) THIS P.A.D. WILL BE CONSIDERED INVALID IF ALTERED BY ANY MEANS.

(d) SITE SPECIFIC PROJECTS SHALL BE PREPARED BY A FLORIDA REGISTERED ENGINEER OR ARCHITECT WHICH WILL BECOME THE ENGINEER OF RECORD (P.O.R.) FOR THE PROJECT AND WHO WILL BE RESPONSIBLE FOR THE PROPER USE OF THE P.A.D. ENGINEER OF RECORD, ACTING AS A DELEGATED ENGINEER TO THE P.A.D. ENGINEER SHALL SUBMIT TO THIS LATTER THE SITE SPECIFIC DRAWINGS FOR REVIEW IN ADDITION TO A MANDATORY SUBMITTAL TO MIAMI-DADE COUNTY BUILDING CODE COMPLIANCE OFFICE FOR EITHER A PRODUCT APPROVAL REVISION OR A ONE TIME APPROVAL.

(e) ORIGINAL P.A.D. SHALL BEAR THE DATE AND ORIGINAL SEAL AND SIGNATURE OF THE PROFESSIONAL ENGINEER OF RECORD THAT PREPARED IT.

THIS DRAWING SHALL ONLY BE USED TO
OBTAIN PERMITS IN THE STATE OF FLORIDA

PRODUCT REVISED
as complying with the Florida
Building Code
NOA-No. 23-1017.12
Expiration Date 10/12/2026
By Ishag I. Chande
Miami-Dade Product Control

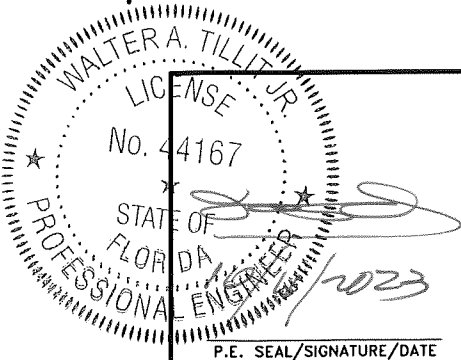

FLORIDA BUILDING CODE (High Velocity Hurricane Zone)					
<div>© 2023 TILTECO INC.</div> <div>TILTECO INC.</div> <div>TILLIT TESTING & ENGINEERING COMPANY 6355 N.W. 36th. St., Ste. 305 - VIRGINIA GARDENS, FL 33166 Phone : (305) 871-1530 , Fax : (305) 871-1531 e-mail: tilteco@aol.com CA-0006719 WALTER A. TILLIT Jr., P.E. FLORIDA Lic. # 44167</div>			DOUBLE & SINGLE OUTSWING WOOD DOORS, W/ WOOD & GLAZED PANELS		W.H DRAWN BY:
			IMPACT PRECIOUS WOOD, INC.		10/11/2023 DATE:
			6333 NW 74 Ave. Miami, FL 33166 PH: (786) 222-0427, FAX: (305) 428-3011		23-232 DRAWING N°
REV N°	DESCRIPTION	DATE	REV N°	DESCRIPTION	DATE
1	OLD 20-291	10/11/23	3	-	-
2			4	-	-
					SHEET 1 OF 10

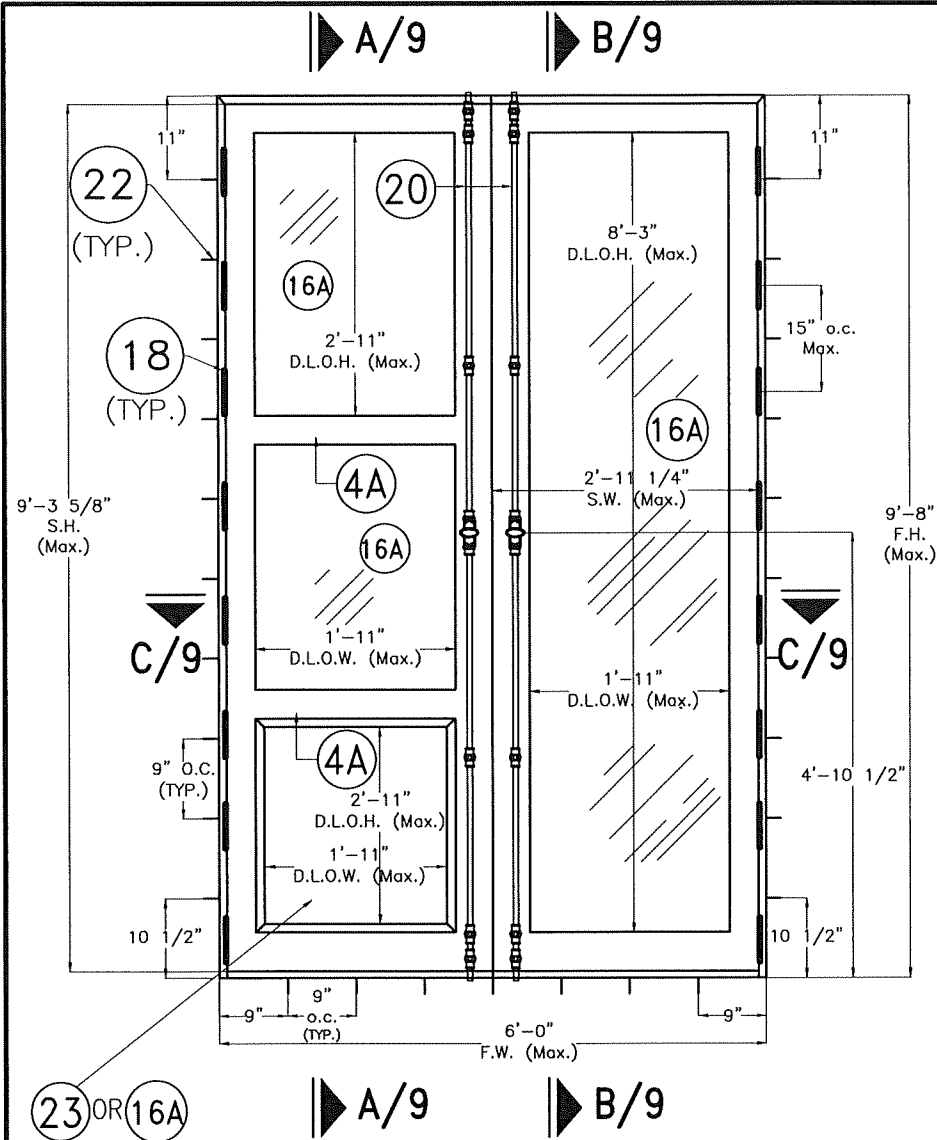

REGULAR OUTSWING DOOR
(XX)

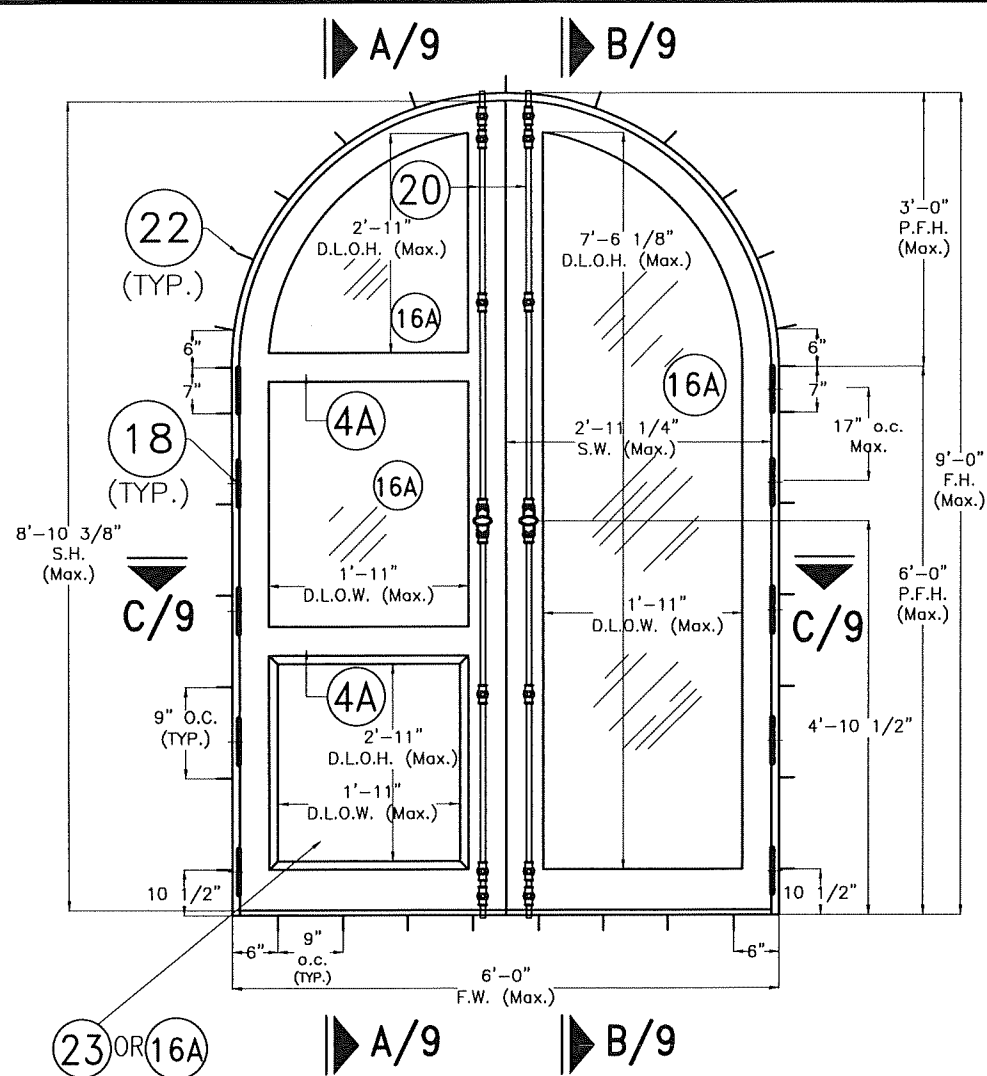

FULL ARCHED OUTSWING DOOR
(XX)

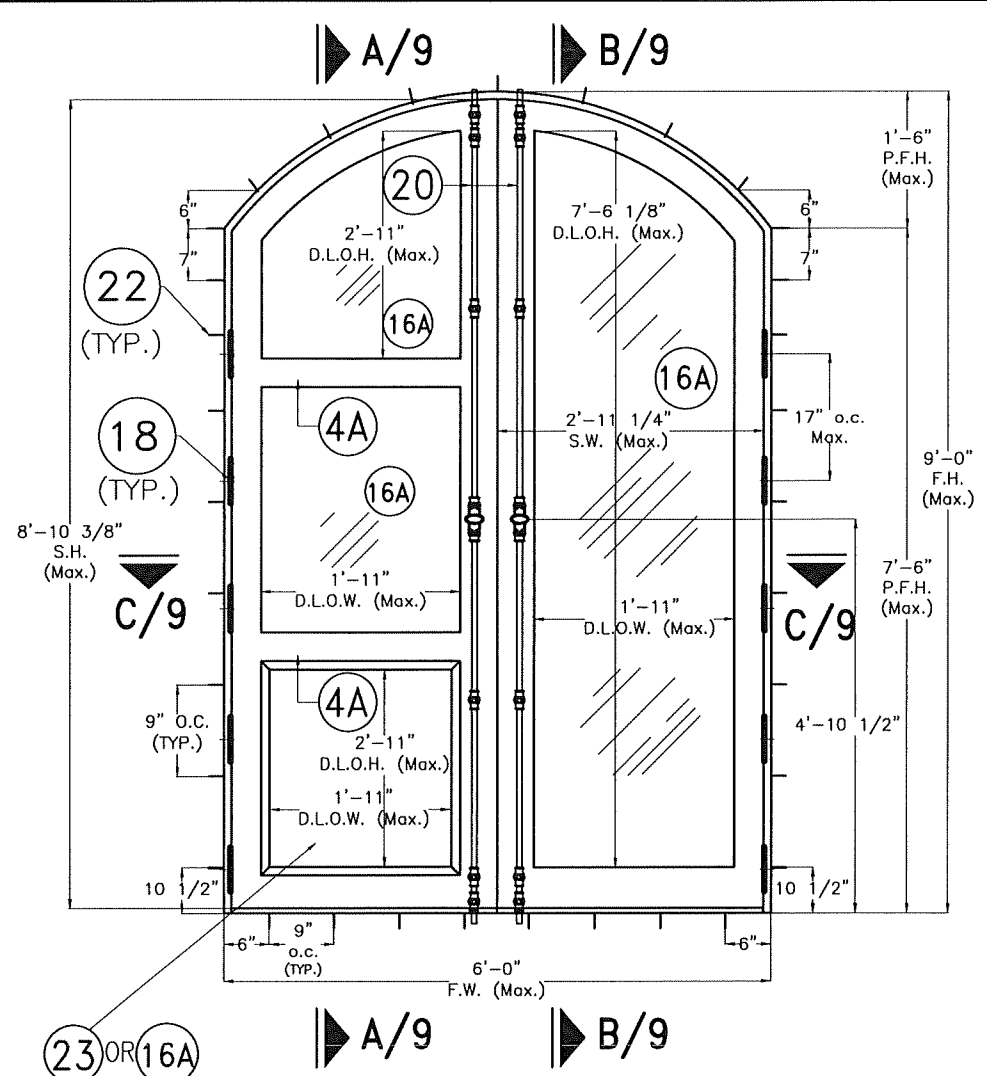

ELLIPTICAL OUTSWING DOOR
(XX)

INTERIOR ELEVATIONS
N.T.S.

PRODUCT REVISED
as complying with the Florida
Building Code
NOA-No. 23-1017.12
Expiration Date 10/12/2026
By *Ishaq I. Chande*
Miami-Dade Product Control

PREFIX LEGEND:

- F.W. : FRAME WIDTH
- F.H. : FRAME HEIGHT
- S.W. : SASH WIDTH
- S.H. : SASH HEIGHT
- D.L.O.W. : DAYLIGHT OPENING WIDTH
- D.L.O.H. : DAYLIGHT OPENING HEIGHT
- P.F.H. : PARTIAL FRAME HEIGHT

MAX. (A.S.D.) DESIGN PRESSURE RATING:
DOUBLE DOORS WITH
THREE POINT CREMONES (20)

POSITIVE	60 psf
NEGATIVE	65 psf

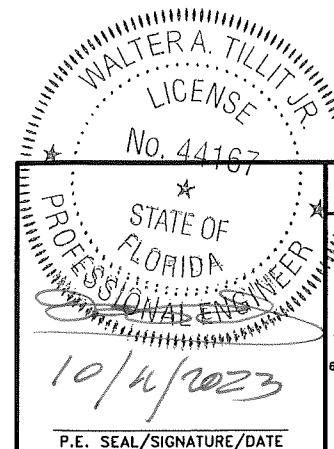

© 2023 TILTECO INC.

TILTECO INC.

TILLIT TESTING & ENGINEERING COMPANY
6355 N.W. 36th St., Ste. 305 - VIRGINIA GARDENS, FL 33166
Phone : (305) 871-1530 , Fax : (305) 871-1531
e-mail: tilliteco@aol.com
CA-0006719
WALTER A. TILLIT Jr., P.E.
FLORIDA Lic. # 44167

FLORIDA BUILDING CODE (High Velocity Hurricane Zone)

DOUBLE & SINGLE OUTSWING WOOD DOORS, W/ WOOD & GLAZED PANELS

IMPACT PRECIOUS WOOD, INC.

6333 NW 74 Ave.
Miami, FL 33166
PH: (786) 222-0427, FAX: (305) 428-3011

REV	DESCRIPTION	DATE	REV	DESCRIPTION	DATE
1	OLD 20-291	10/11/23	3	-	-
2	-	-	4	-	-

W.H. DRAWN BY:
10/11/2023 DATE:
23-232 DRAWING N°
SHEET 2 OF 10

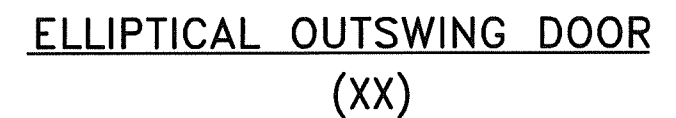
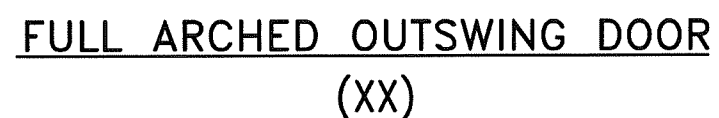
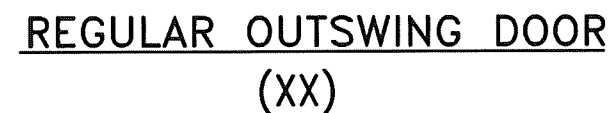

N.T.S.

By Ishaq I. Chande
Miami-Dade Product Control

- F.W. : FRAME WIDTH
- F.H. : FRAME HEIGHT
- S.W. : SASH WIDTH
- S.H. : SASH HEIGHT
- D.L.O.W. : DAYLIGHT OPENING WIDTH
- D.L.O.H. : DAYLIGHT OPENING HEIGHT
- P.F.H. : PARTIAL FRAME HEIGHT

POSITIVE	60 psf
NEGATIVE	65 psf

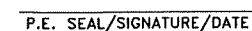

TILTECO INC.
TILLIT TESTING & ENGINEERING COMPANY
6355 N.W. 36th. St., Ste. 305 - VIRGINIA GARDENS, FL 33157
Phone : (305) 871-1530 , Fax : (305) 871-1531
e-mail: tilteco@aol.com
CA-0006719
WALTER A. TILLIT Jr., P.E.
FLORIDA Lic. # 44167

REV N°	DESCRIPTION	DATE	REV N°	DESCRIPTION	DATE
1	OLD 20-291	10/11/23	3	-	-
2			4	-	-

REV N°	DESCRIPTION	DATE	REV N°	DESCRIPTION	DATE
1	OLD 20-291	10/11/23	3	-	-
2			4	-	-

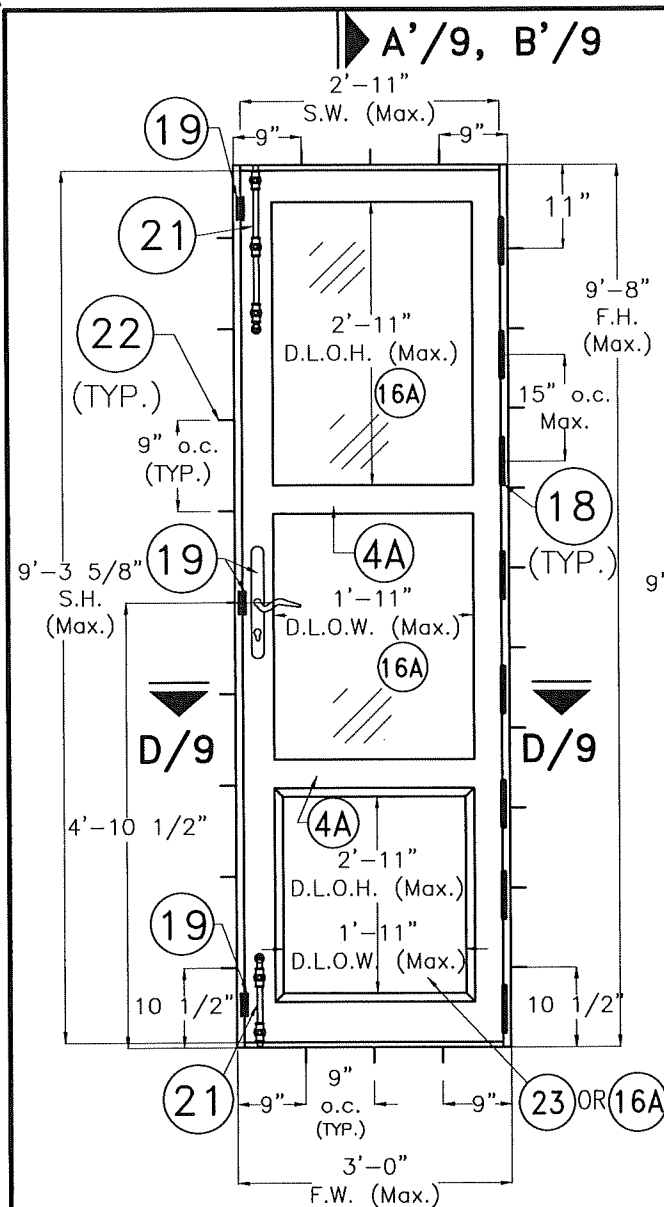

**SINGLE REGULAR
OUTSWING DOOR**
(X)

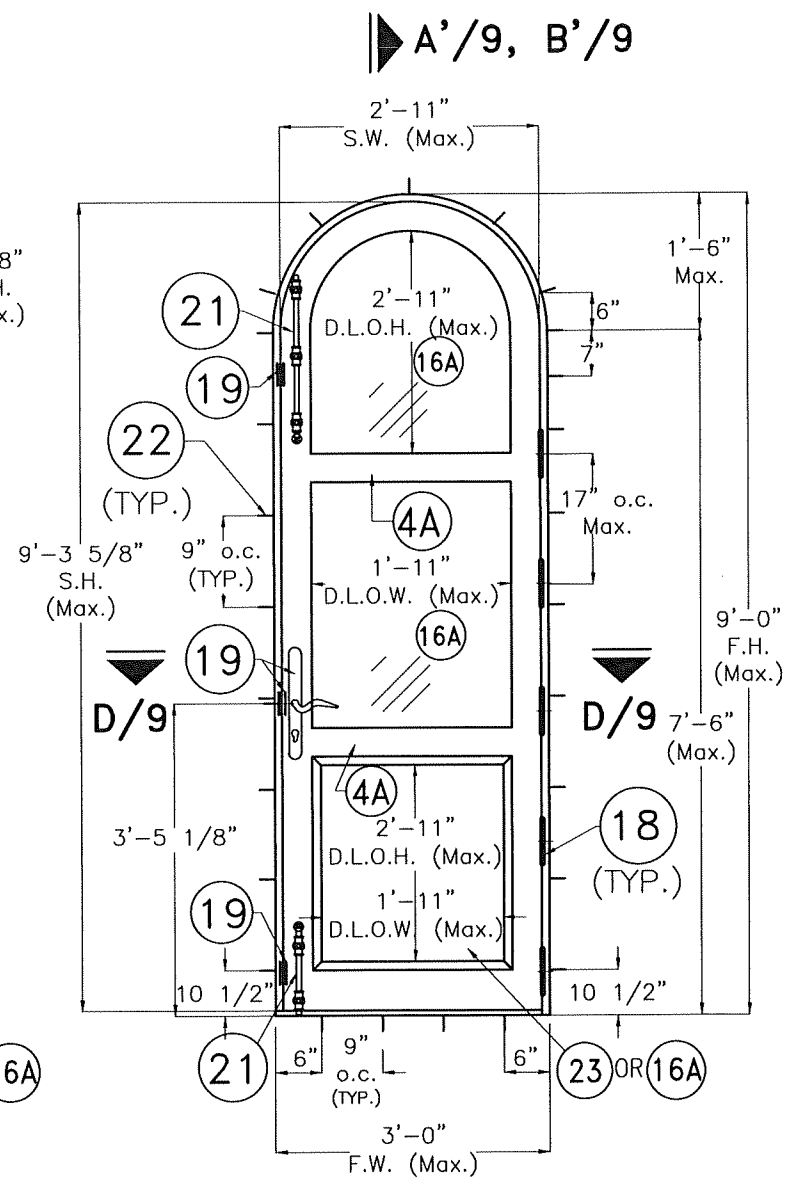

**SINGLE FULL ARCHED
OUTSWING DOOR**
(X)

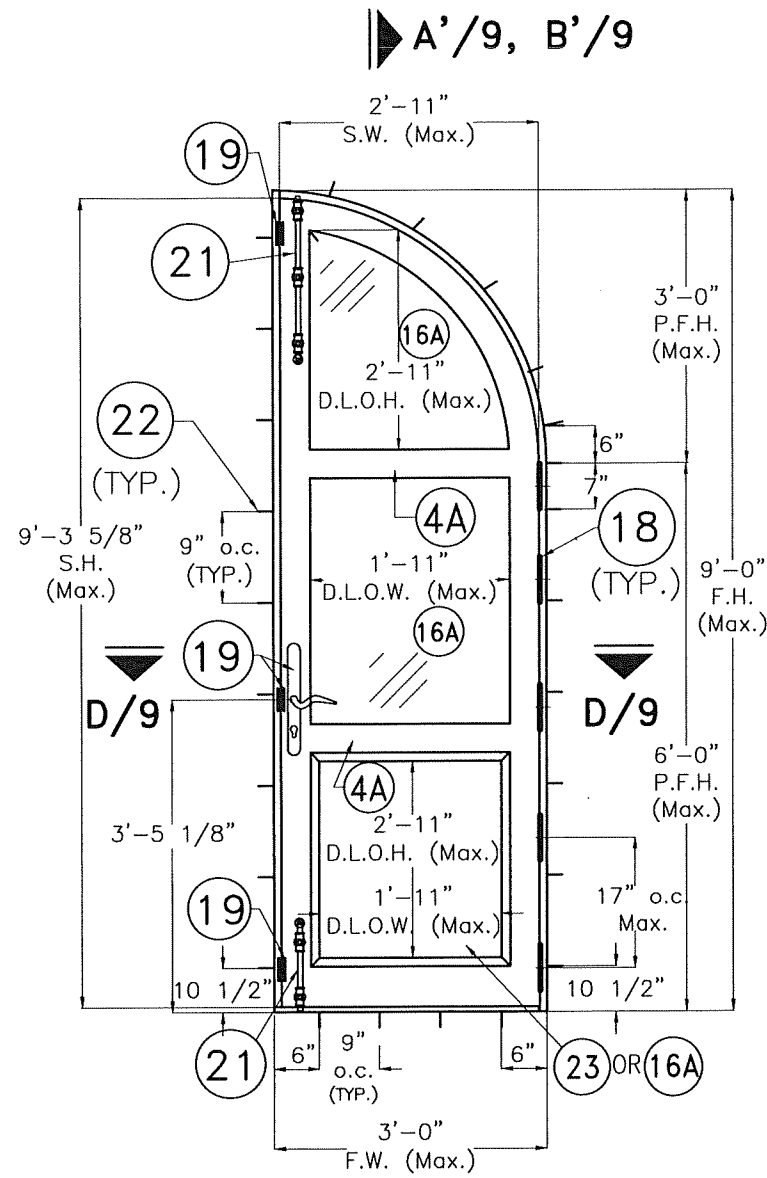

**SINGLE 1/2 ARCHED
OUTSWING DOOR**
(X)

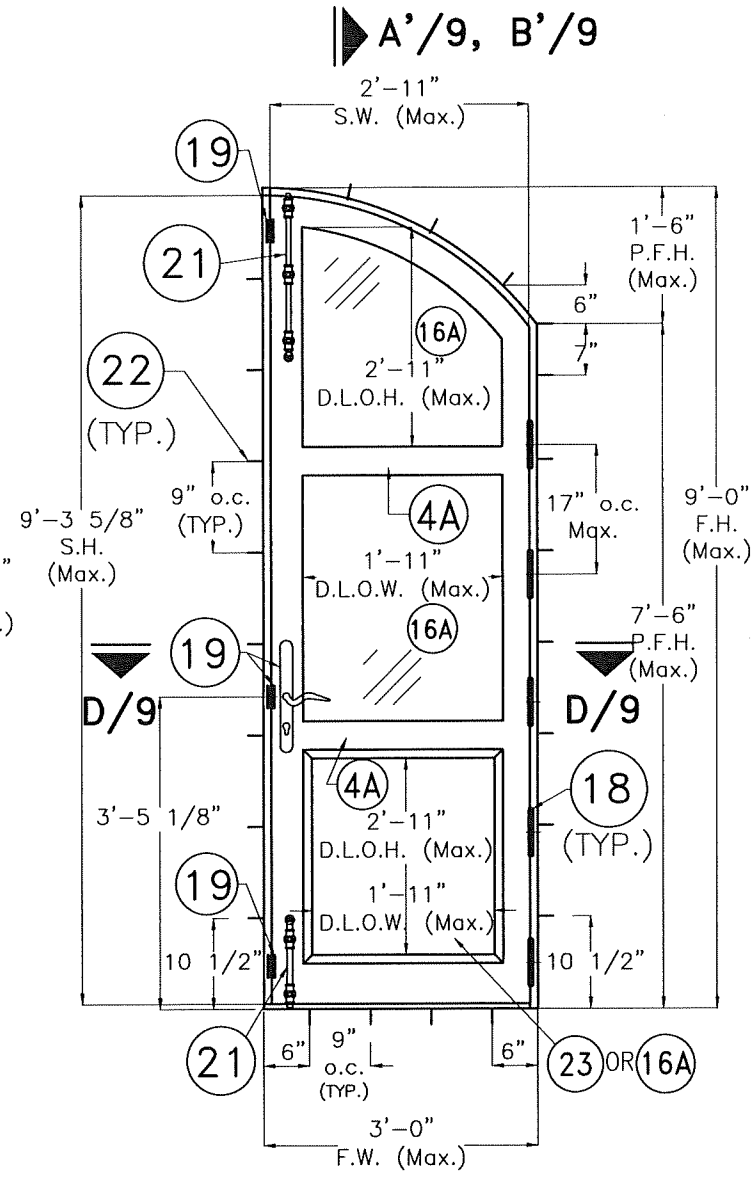

**SINGLE 1/2 ELLIPTICAL
OUTSWING DOOR**
(X)

INTERIOR ELEVATIONS

N.T.S.

PREFIX LEGEND:

- F.W. : FRAME WIDTH
- F.H. : FRAME HEIGHT
- S.W. : SASH WIDTH
- S.H. : SASH HEIGHT
- D.L.O.W. : DAYLIGHT OPENING WIDTH
- D.L.O.H. : DAYLIGHT OPENING HEIGHT
- P.F.H. : PARTIAL FRAME HEIGHT

**MAX. (A.S.D.) DESIGN PRESSURE RATING:
SINGLE DOORS WITH (2)
CREMONE SURFACE BOLTS (21)
+ 3 POINT LOCK (19)**

POSITIVE	60 psf
NEGATIVE	65 psf

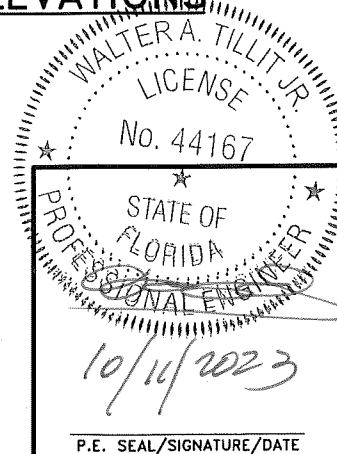

© 2023 TILTECO INC.
TILTECO INC.
TILLIT TESTING & ENGINEERING COMPANY
6355 N.W. 36th St., Ste. 305 - VIRGINIA GARDENS, FL 33166
Phone : (305) 871-1530, Fax : (305) 871-1531
e-mail: tilteco@aol.com
CA-0006719
WALTER A. TILLIT Jr., P.E.
FLORIDA Lic. # 44167

FLORIDA BUILDING CODE (High Velocity Hurricane Zone)

DOUBLE & SINGLE OUTSWING WOOD
DOORS, W/ WOOD & GLAZED PANELS
IMPACT PRECIOUS WOOD, INC.

6333 NW 74 Ave.
Miami, FL 33166
PH: (786) 222-0427, FAX: (305) 428-3011

REV #	DESCRIPTION	DATE	REV #	DESCRIPTION	DATE
1	OLD 20-291	10/11/23	3	-	-
2	-	-	4	-	-

W.H
DRAWN BY:

10/11/2023
DATE:

23-232
DRAWING N°

SHEET 4 OF 10

PRODUCT REVISED
as complying with the Florida
Building Code

NOA-No. 23-1017.12

Expiration Date 10/12/2026

By Ishag I. Chande
Miami-Dade Product Control

BILL OF MATERIALS				
ITEM #	REQ'D.	DESCRIPTION	SIZE	MATERIAL & REMARKS
1	1	FRAME HEAD	1.78" x 6.09"	MAHOGANY WOOD
2	1	FRAME SILL	1.92" x 6.125"	MAHOGANY WOOD
3	2	FRAME JAMB	1.78" x 6.09"	MAHOGANY WOOD
4	2	TOP RAIL	2.25" x 6.125"	MAHOGANY WOOD
4A	1	INTERMEDIATE RAIL	2.25" x 4.715"	MAHOGANY WOOD
5	2	BOTTOM RAIL	2.25" x 6.996"	MAHOGANY WOOD
6	2	HINGE STILE	2.25" x 6.125"	MAHOGANY WOOD
7	1	LOCK STILE	2.25" x 6.841"	MAHOGANY WOOD @ ACTIVE
8	1	ASTRAGAL LOCK STILE	2.25" x 6.541"	MAHOGANY WOOD @ IN-ACTVE
9	AS REQ'D.	MAHOGANY WOOD BEAD	7/8" x 1"	ATTACHED TO SASH W/ 16 gage x 1 1/2" FINISHING NAILS SPACED AT 2" FROM CORNERS & 10" o.c.
11	AS REQ'D.	CLOSED CELL FOAM STRIP	1/2" x 5/8" FOAM TAPE	FULL LENGTH OF SILL
12	1	THRESHOLD (DOOR STOP) MAHOGANY	3/4" x 4" x 6'-2 1/4" LONG.	ATTACHED TO SILL W/ # 8 x 1 1/2" F.H. WOOD SCREW FIRST 6", @ 20" O.C.
13	AS REQ'D.	Q-LON DOOR SEAL AT FRAME	PROFILE 5/8" w x 1.00" h	SCHLEGEL # QDS 650
14	AS REQ'D.	Q-LON WEATHER SEAL AT SASH	PROFILE 3/8" w x 5/8" h	SCHLEGEL # QEZD 320
15	AS REQ'D.	SEALANT - CLEAR SILICONE	FRAME & FASTENER INSTALLATION SEALANT	"GE" STOCK No. GE012A
16A	AS REQ'D.	1/2" (NOMINAL) IMPACT RESISTANT LAMINATED GLASS	0.470" Min. THICK = 3/16" TEMPERED + 0.100" INTERLAYER + 3/16" TEMPERED	INTERLAYER CONSIST OF UVEKOL S LAMINATED GLASS BY ALLNEX USA INC.
17	AS REQ'D.	GLAZING - CLEAR SILICONE	7/8" WIDE & 1/8" THICK	"DOW CORNING" No. 995 SILICONE
18	AS REQ'D.	STEEL HINGES W/ POLYESTER COATING	3 1/16" x 6 1/4" x 1/8"	HERRAJE SIDANEZ, S.A. # AR06, WITH (8) #10x1 1/2" WOOD SCREWS (5) REQ'D/LEAF AT FULL ARCHED/ELLIPTICAL DOORS & (8) REQ'D/LEAF AT REGULAR DOORS
19	1	3 POINT LOCK WITH BRASS KEEP SET	45 mm B.S. FULL HEIGHT	SCHLEGEL SL-16 LOCK-STAINLESS STEEL
20	2	FABHERR THREE POINT CREMONES	FULL HEIGHT	STEEL W/ POLYESTER COATING
21	2/SASH	CREMONE SURFACE BOLT	Min. 12", 22" LONG	12" LONG @ BOTTOM, 22" LONG @ TOP
22	AS REQ'D.	FRAME INSTALLATION SCREWS	1/4" F.H. ULTRACONS W/ 1 1/4" Min. EMBED. INTO CONCRETE OR CONCRETE BLOCK & 1 1/2" INTO WOOD.	ELCO CONSTRUCTION PRODUCTS, SPACED AT 9" o.c Max. STARTING AS SHOWN ON ELEVATIONS EACH WAY FROM CORNERS MIN. EDGE DISTANCE = 2 1/2" INTO CONCRETE OR BLOCK & 1" INTO WOOD
23	AS REQ'D.	WOOD RAISED PANEL	5/8" THK. AT ENDS & 1 3/4" AT CENTER	MAHOGANY WOOD, 3/4" PANEL BITE
24	AS REQ'D.	CORNER CONSTRUCTION GLUE	APPLIED AT ALL MORTISE & TENON SURFACES	CHEMICAL BOND WW25
25	1	STRIKE PLATE FOR CREMONE AT INACTIVE DOOR LEAF LOCK	SEE DETAIL, SHEET 8	AISI 304 SERIES S.S. FASTENED TO STILE W/ (3) # 10 x 1" F.H. WOOD SCREWS
26	1	STRIKE PLATE FOR CREMONE & SURFACE BOLTS TOP & BOTTOM	1/2"x 5"x 16" x 14 GAGE	AISI 304 SERIES S.S. FASTENED TO SILL W/ (5) #8x1 1/2" F.H. WOOD SCREWS

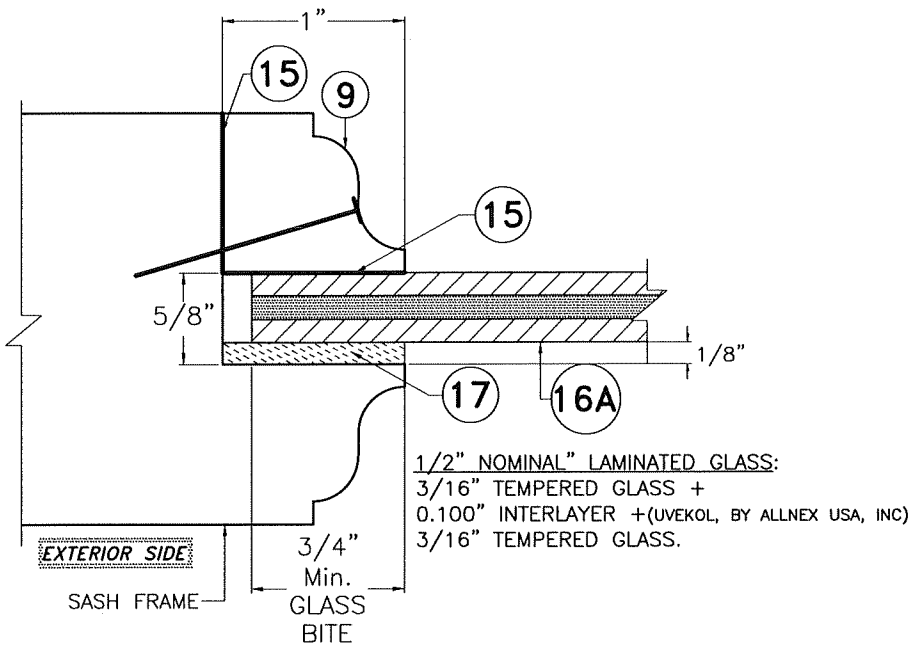

GLAZING DETAIL FOR 16A
N.T.S.

PRODUCT REVISED
as complying with the Florida
Building Code
NOA-No. 23-1017.12
Expiration Date 10/12/2026
By Ishag I. Chande
Miami-Dade Product Control

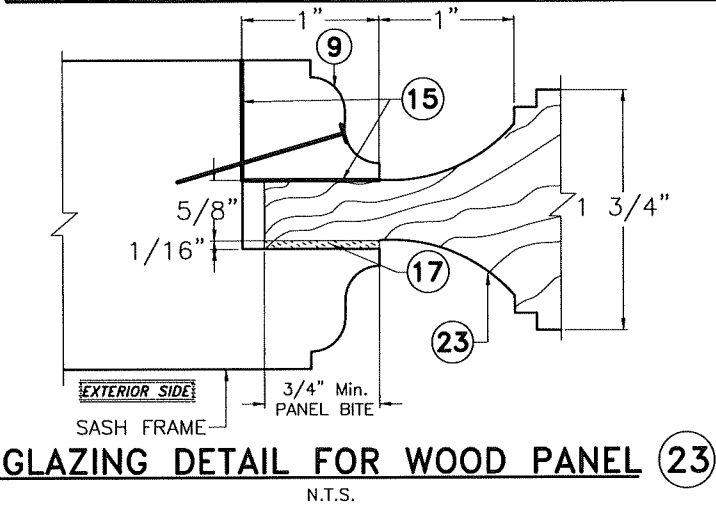

GLAZING DETAIL FOR WOOD PANEL 23
N.T.S.

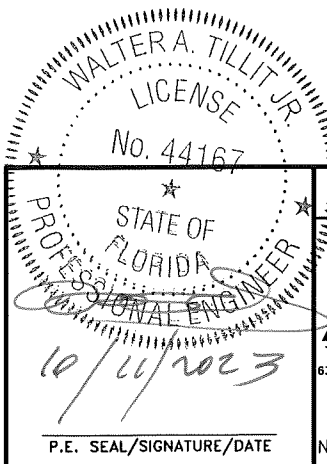

© 2023 TILTECO INC.		FLORIDA BUILDING CODE (High Velocity Hurricane Zone)			
TILTECO INC.		DOUBLE & SINGLE OUTSWING WOOD DOORS, W/ WOOD & GLAZED PANELS			
TILLIT TESTING & ENGINEERING COMPANY 6355 N.W. 35th St., Ste. 305 - VIRGINIA GARDENS, FL 33166 Phone : (305) 871-1530 , Fax : (305) 871-1531 e-mail: tilliteco@aol.com CA-0006719		W.H. DRAWN BY: 10/11/2023 DATE: 23-232 DRAWING N°			
WALTER A. TILLIT Jr., P.E. FLORIDA Lic. # 44167		6333 NW 74 Ave. Miami, FL 33166 PH: (786) 222-0427, FAX: (305) 428-3011			
REV N°	DESCRIPTION	DATE	REV N°	DESCRIPTION	DATE
1	OLD 20-291	10/11/23	3	-	-
2	-	-	4	-	-

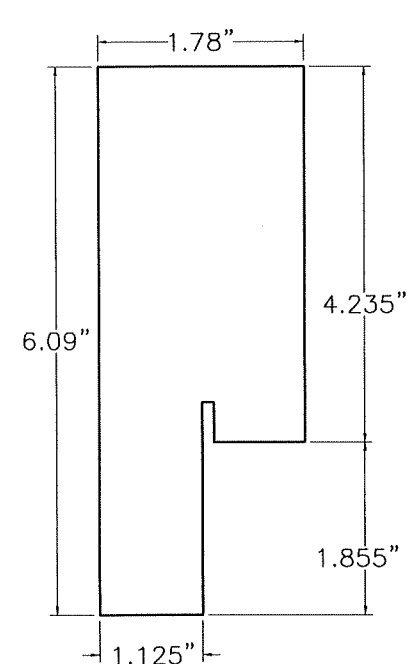

① **FRAME HEAD**

③ **FRAME JAMB**

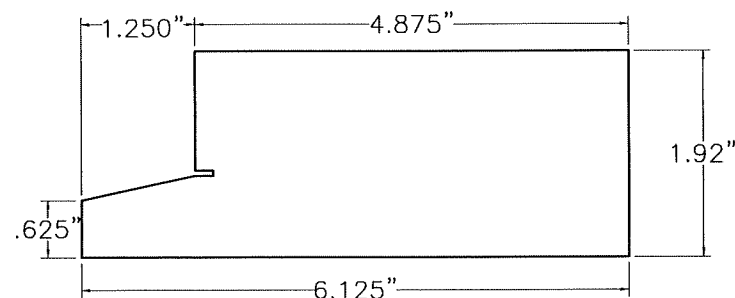

② **FRAME SILL**

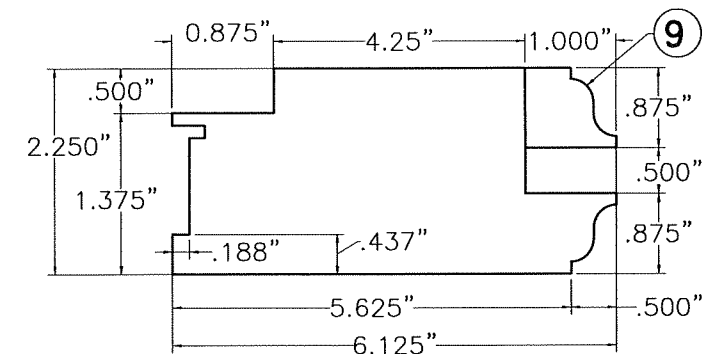

④ **TOP RAIL,**
⑥ **HINGE STILE**

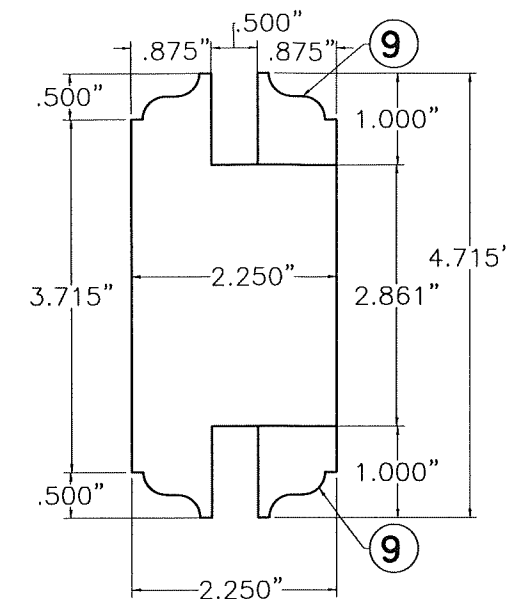

④A **INTERMEDIATE RAIL**

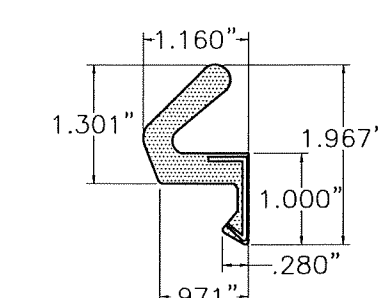

⑬ **Q-LON DOOR SEAL**

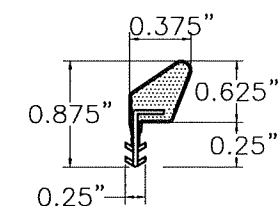

⑭ **Q-LON WEATHER SEAL**

SEAL COMPONENTS

N.T.S.

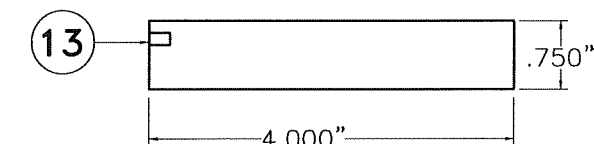

⑫ **DOOR STOP (THRESHOLD) AT SILL**

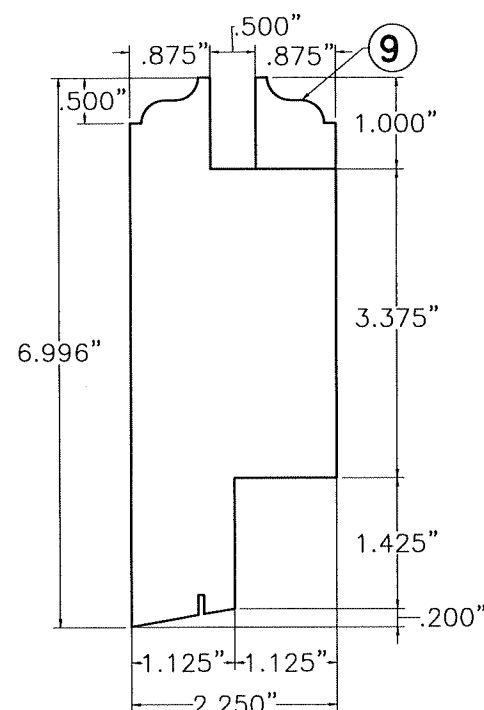

⑤ **BOTTOM RAIL**

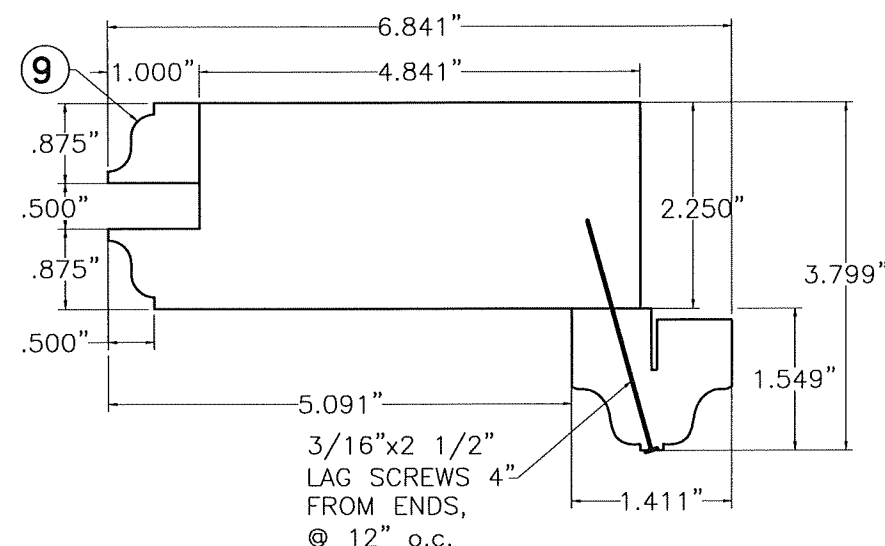

⑦ **LOCK STILE (ACTIVE)**

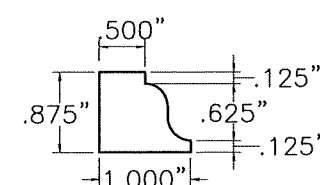

⑨ **MAHOGANY**
WOOD BEAD

WOOD COMPONENTS

N.T.S.

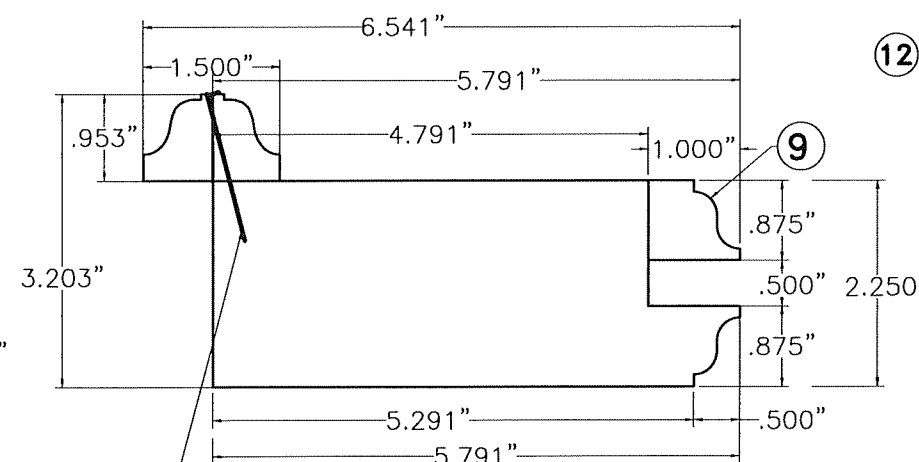

#10x2 1/2" F.H.
WOOD SCREWS
4" FROM ENDS,
@ 12" o.c.

⑧ **ASTRAGAL LOCK STILE (INACTIVE)**

PRODUCT REVISED
as complying with the Florida
Building Code

NOA-No. 23-1017.12

Expiration Date 10/12/2026

By *Ishag I. Chandra*
Miami-Dade Product Control

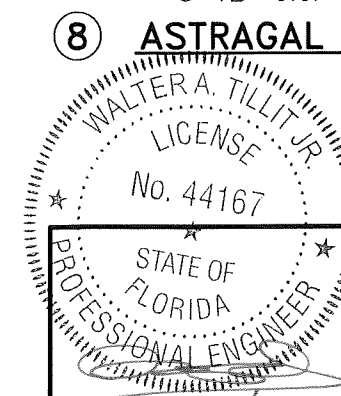

P.E. SEAL/SIGNATURE/DATE

©2023 TILTECO INC.

TILTECO INC.
TILLIT TESTING & ENGINEERING COMPANY
6355 N.W. 36th St., Ste. 305 - VIRGINIA GARDENS, FL 33166
Phone : (305) 871-1530 , Fax : (305) 871-1531
e-mail: tilliteco@aol.com
CA-0006719
WALTER A. TILLIT Jr., P.E.
FLORIDA Lic. # 44167

FLORIDA BUILDING CODE (High Velocity Hurricane Zone)

DOUBLE & SINGLE OUTSWING WOOD
DOORS, W/ WOOD & GLAZED PANELS

IMPACT PRECIOUS WOOD, INC.

6333 NW 74 Ave.
Miami, FL 33166
PH: (786) 222-0427, FAX: (305) 428-3011

W.H
DRAWN BY:

10/11/2023
DATE:

23-232
DRAWING N°

REV N°	DESCRIPTION	DATE	REV N°	DESCRIPTION	DATE
1	OLD 20-291	10/11/23	3	-	-
2			4	-	-

SHEET 6 OF 10

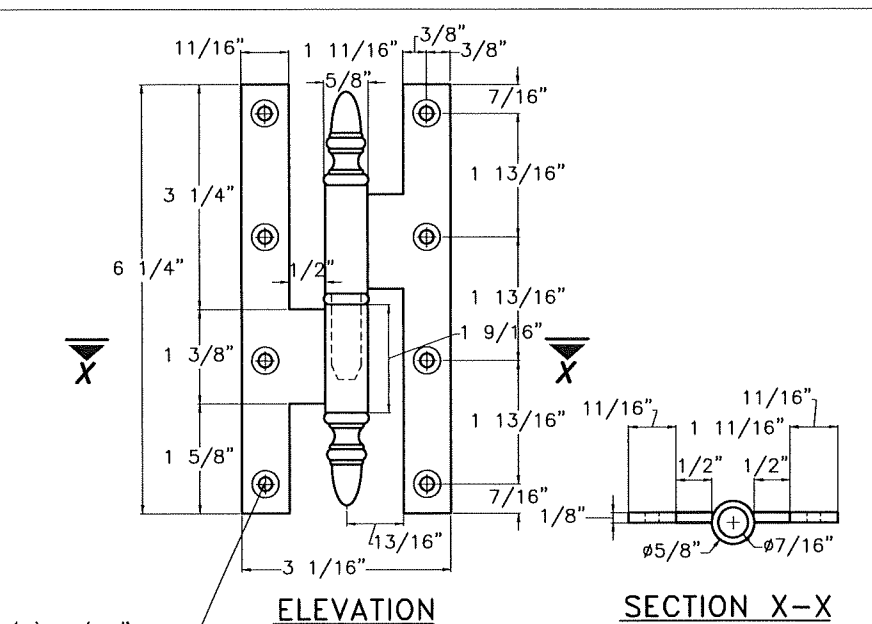
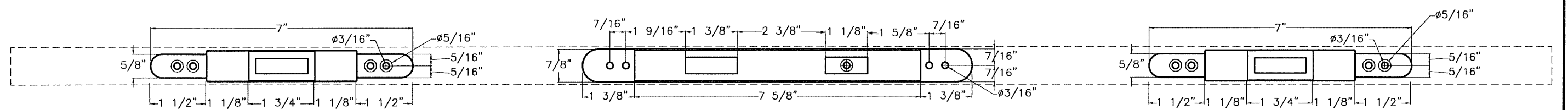
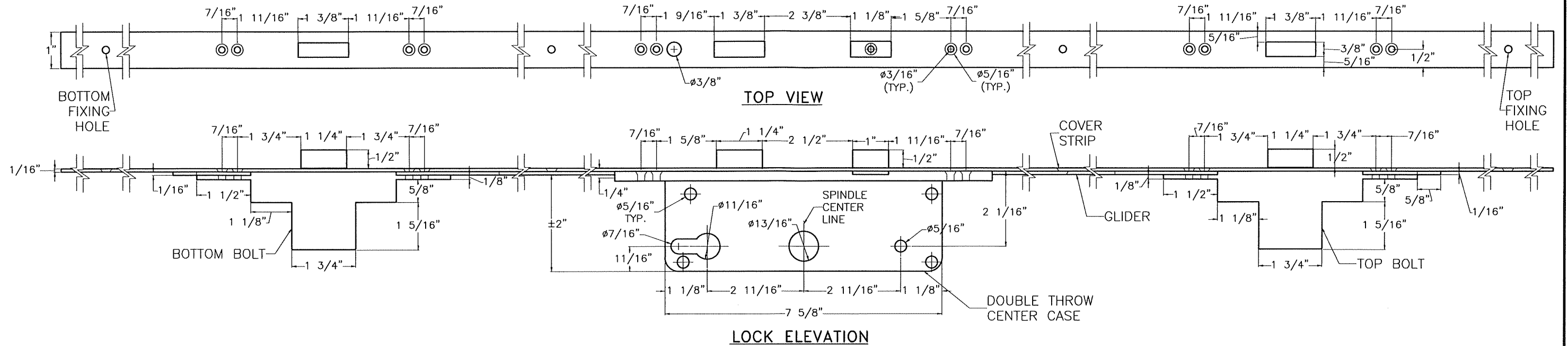

(8) 3/16"Ø
HOLES FOR
#10x1 1/2" F.H.
WOOD SCREWS

18 HINGE
SCALE: 3/8"= 1"

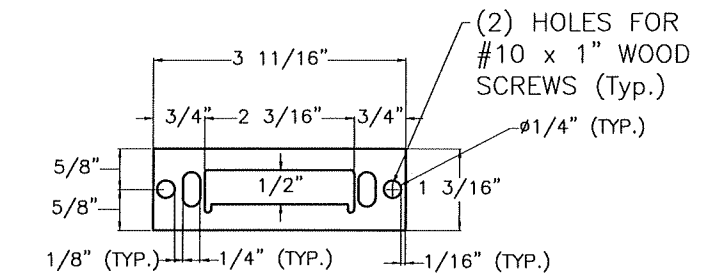
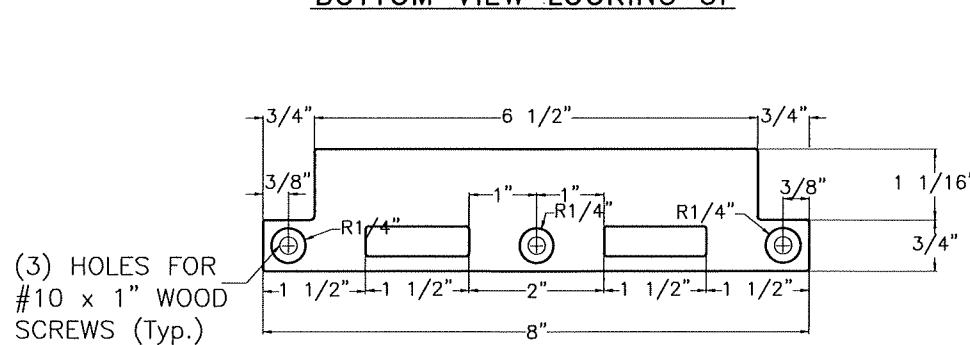

19 SL-16 45mm BACKSET DOUBLE THROW 3 POINT LOCK
N.T.S.

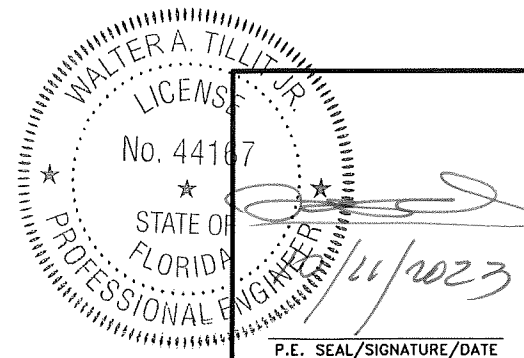

FLORIDA BUILDING CODE (High Velocity Hurricane Zone)					
TILTECO INC. TILLIT TESTING & ENGINEERING COMPANY 6355 N.W. 36th St., Ste. 305 - VIRGINIA GARDENS, FL 33166 Phone : (305) 871-1530 , Fax : (305) 871-1531 e-mail: tiltco@aol.com CA-0006719 WALTER A. TILLIT Jr., P.E. FLORIDA Lic. # 44167			DOUBLE & SINGLE OUTSWING WOOD DOORS, W/ WOOD & GLAZED PANELS IMPACT PRECIOUS WOOD, INC. 6333 NW 74 Ave. Miami, FL 33166 PH: (786) 222-0427, FAX: (305) 428-3011		
REV #	DESCRIPTION	DATE	REV #	DESCRIPTION	DATE
1	OLD 20-291	10/11/23	3	-	-
2			4	-	-
			W.H DRAWN BY: 10/11/2023 DATE: 23-232 DRAWING N° SHEET 7 OF 10		

PRODUCT REVISED
as complying with the Florida
Building Code
NOA-No. 23-1017.12
Expiration Date 10/12/2026
By *Ismael L. Chanda*
Miami-Dade Product Control

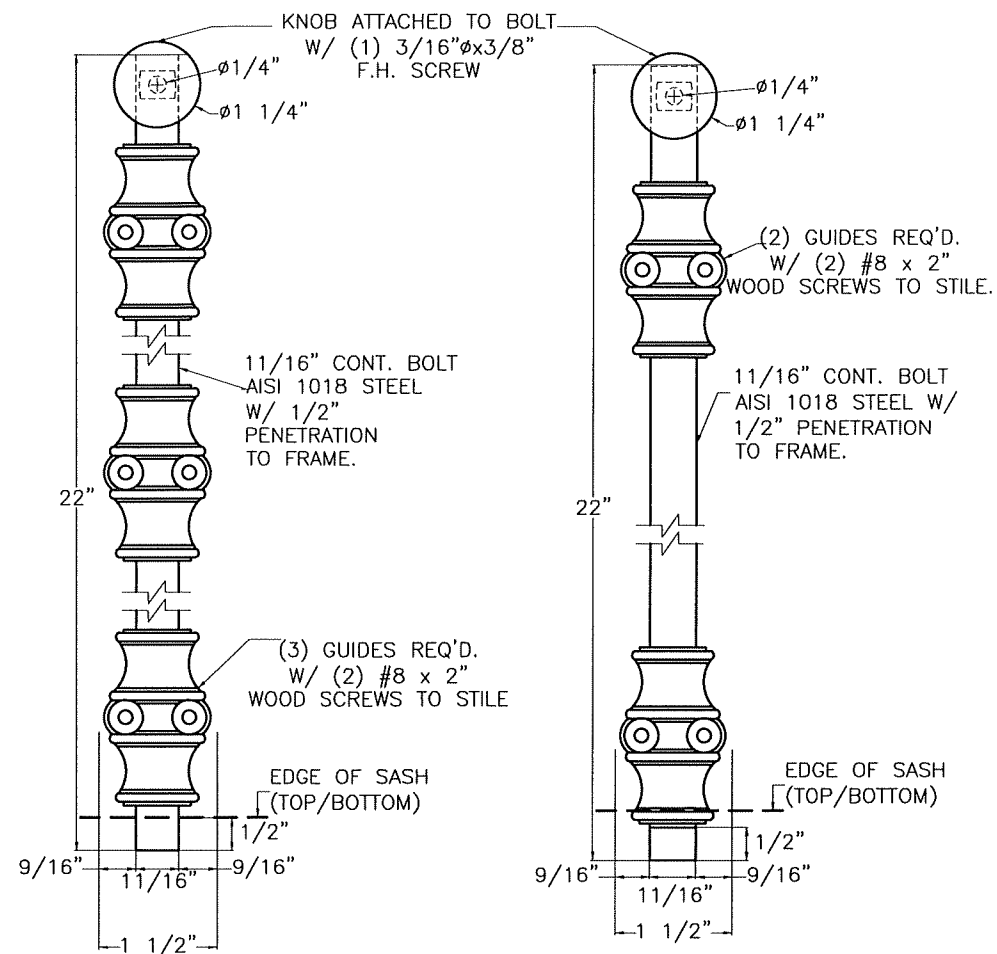
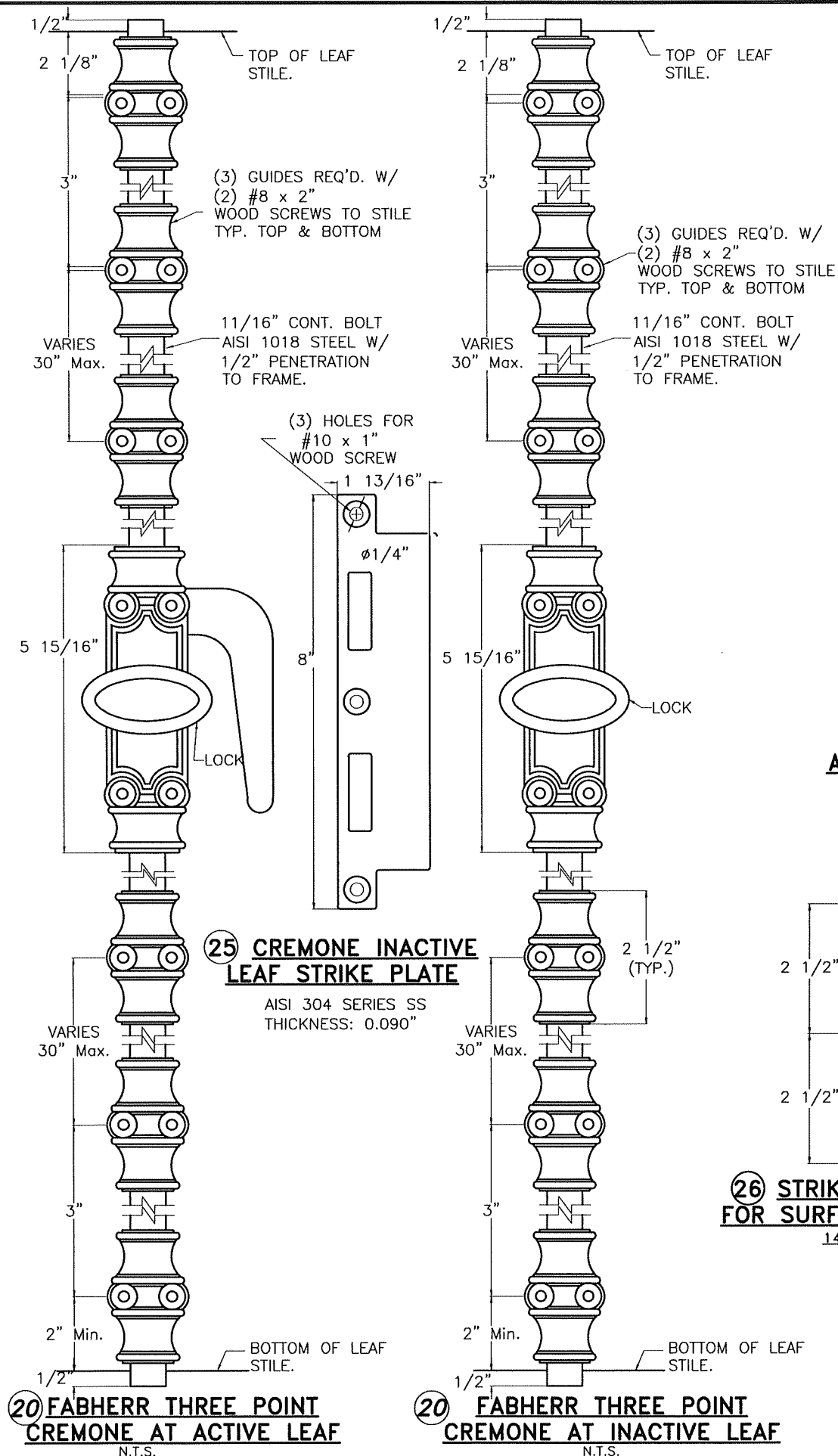

AT TOP: Min. 22" LONG. 3 GUIDES AT BOTTOM: Min. 12" LONG. 2 GUIDES

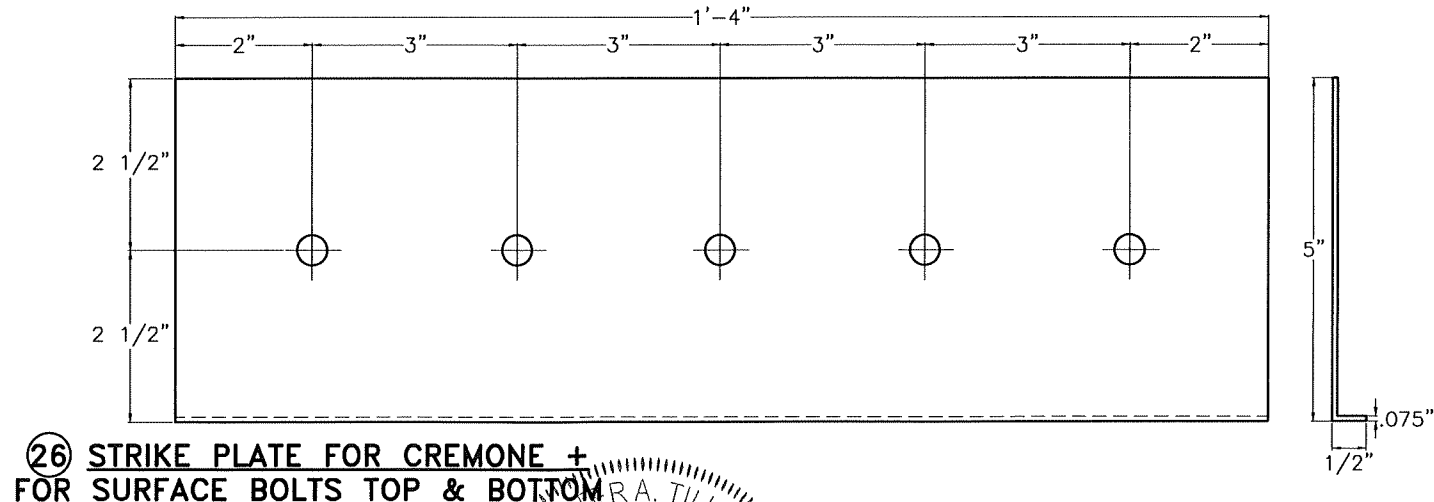

PRODUCT REVISED
as complying with the Florida
Building Code
NOA-No. 23-1017.12
Expiration Date 10/12/2026
By Ishay L. Chandra
Miami-Dade Product Control

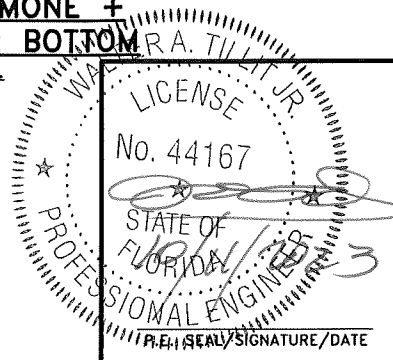

FLORIDA BUILDING CODE (High Velocity Hurricane Zone)					
© 2023 TILTECO INC. TILTECO INC. TILLIT TESTING & ENGINEERING COMPANY 6355 N.W. 36th St., Ste. 305 - VIRGINIA GARDENS, FL 33166 Phone : (305) 871-1530 , Fax : (305) 871-1531 e-mail: tiltco@aol.com CA-0006719 WALTER A. TILLIT Jr., P.E. FLORIDA Lic. # 44167			DOUBLE & SINGLE OUTSWING WOOD DOORS, W/ WOOD & GLAZED PANELS IMPACT PRECIOUS WOOD, INC. 6333 NW 74 Ave. Miami, FL 33166 PH: (786) 222-0427, FAX: (305) 428-3011		
REV #	DESCRIPTION	DATE	REV #	DESCRIPTION	DATE
1	OLD 20-291	10/11/23	3	-	-
2			4	-	-
					W.H DRAWN BY: 10/11/2023 DATE: 23-232 DRAWING N° SHEET 8 OF 10

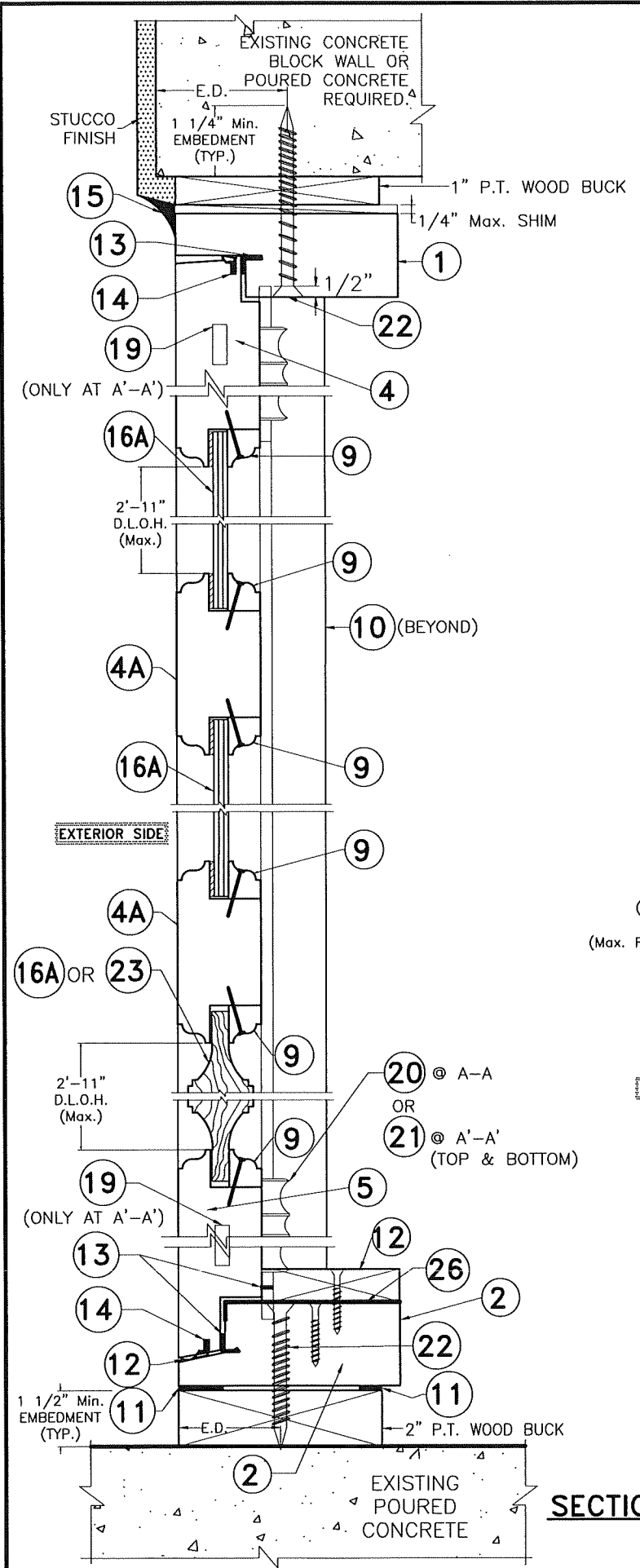

SECTIONS A-A & A'-A'
N.T.S.

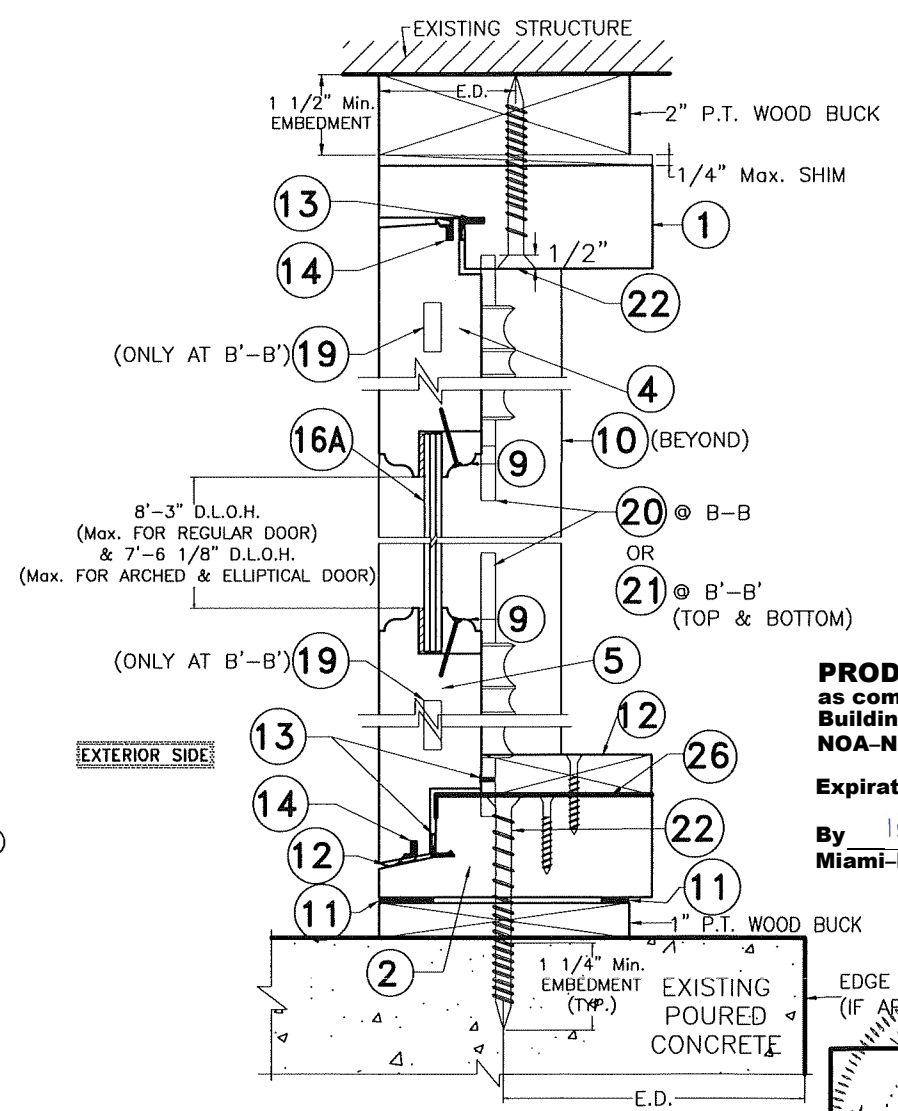

SECTIONS B-B & B'-B'
N.T.S.

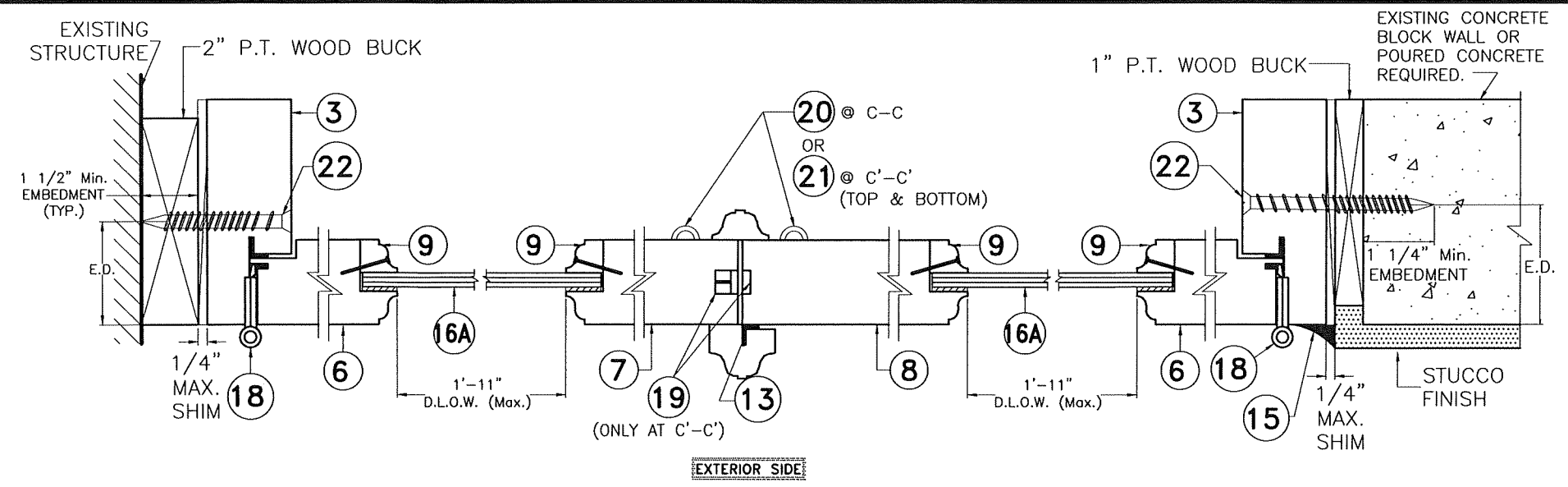

SECTIONS C-C & C'-C' (XX)
N.T.S.

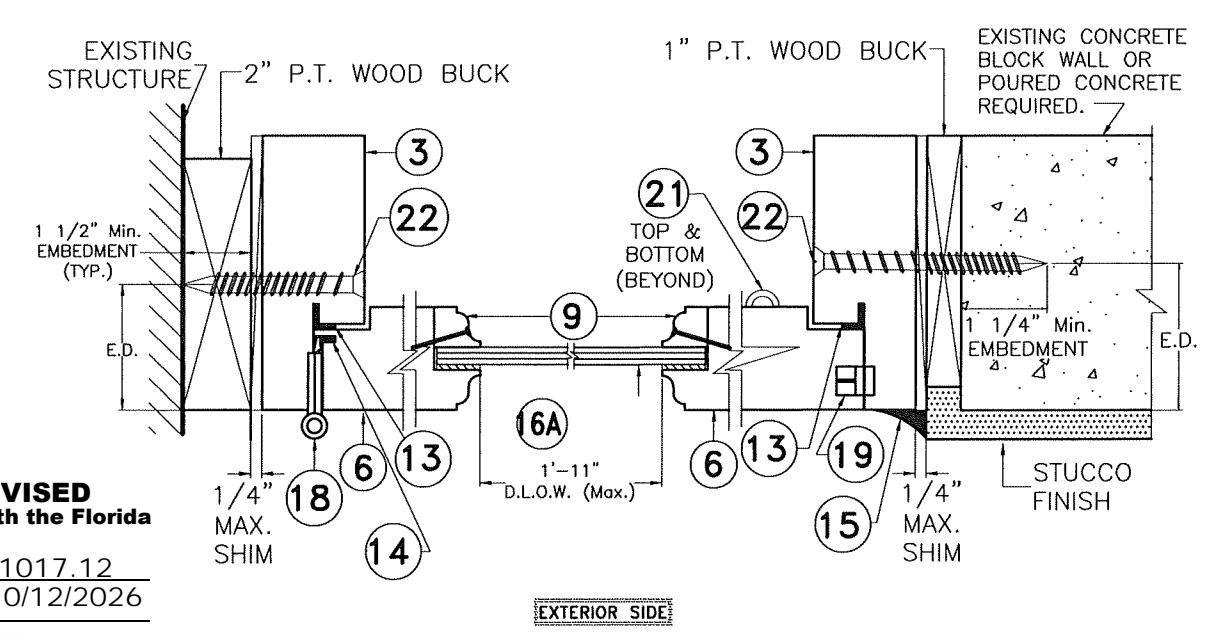

SECTION D-D (X)
N.T.S.

PRODUCT REVISED
as complying with the Florida
Building Code
NOA-No. 23-1017.12
Expiration Date 10/12/2026
By *Ishag I. Chande*
Miami-Dade Product Control

PROFESSIONAL ENGINEER
STATE OF FLORIDA
No. 44167
WALTER A. TILLIT JR., P.E.
P.E. SEAL/SIGNATURE/DATE

<p>© 2023 TILTECO INC.</p> <p>TILTECO INC.</p> <p>TILLIT TESTING & ENGINEERING COMPANY 6355 N.W. 36th. St., Ste. 305 - VIRGINIA GARDENS, FL 33166 Phone : (305) 871-1530 , Fax : (305) 871-1531 e-mail: tilliteco@aol.com CA-0006719 WALTER A. TILLIT Jr., P.E. FLORIDA Lic. # 44167</p>						<p>FLORIDA BUILDING CODE (High Velocity Hurricane Zone)</p> <p>DOUBLE & SINGLE OUTSWING WOOD DOORS, W/ WOOD & GLAZED PANELS</p> <p>IMPACT PRECIOUS WOOD, INC.</p> <p>6333 NW 74 Ave. Miami, FL 33166 PH: (786) 222-0427, FAX: (305) 428-3011</p>						<p>W.H DRAWN BY:</p> <p>10/11/2023 DATE:</p> <p>23-232 DRAWING N°</p> <p>SHEET 9 OF 10</p>	
REV N°	DESCRIPTION	DATE	REV N°	DESCRIPTION	DATE								
1	OLD 20-291	10/11/23	3	-	-								
2			4	-	-								

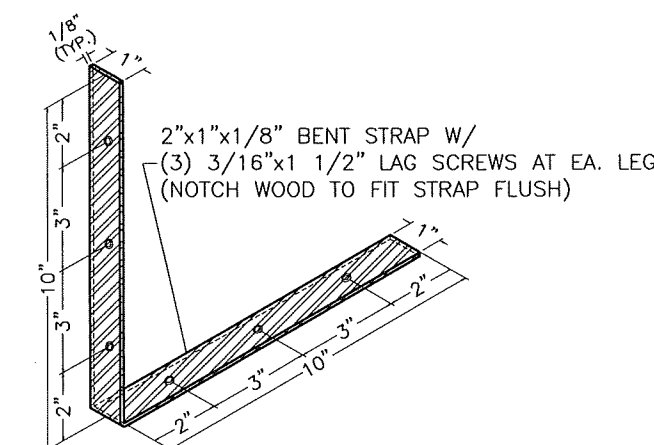

STRAP DETAIL
SCALE: 3/16" = 1"

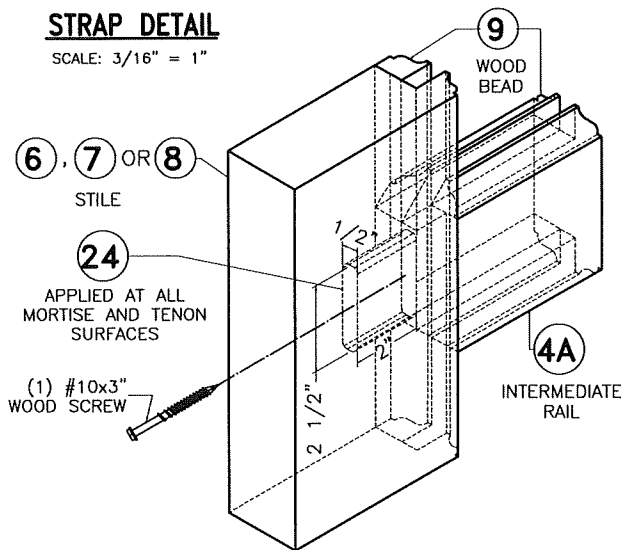

TYPICAL SASH INTERMEDIATE CONNECTION (EXTERIOR VIEW)
SCALE: 3/16" = 1"

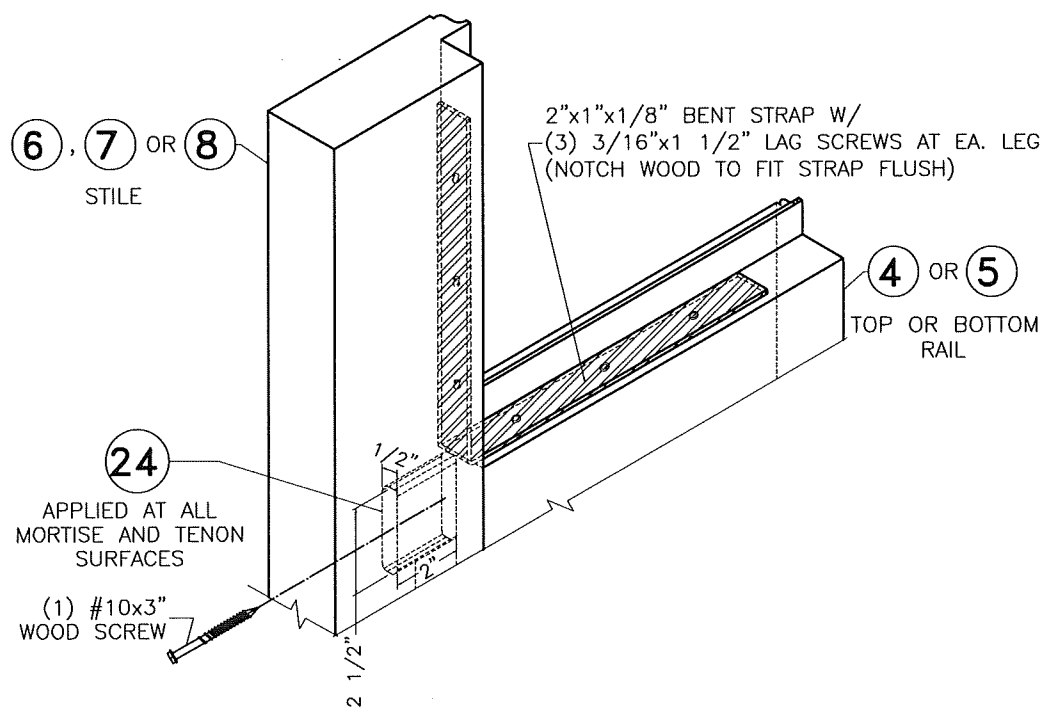

TYPICAL SASH TOP/BOTTOM CONNECTION (EXTERIOR VIEW)
SCALE: 3/16" = 1"

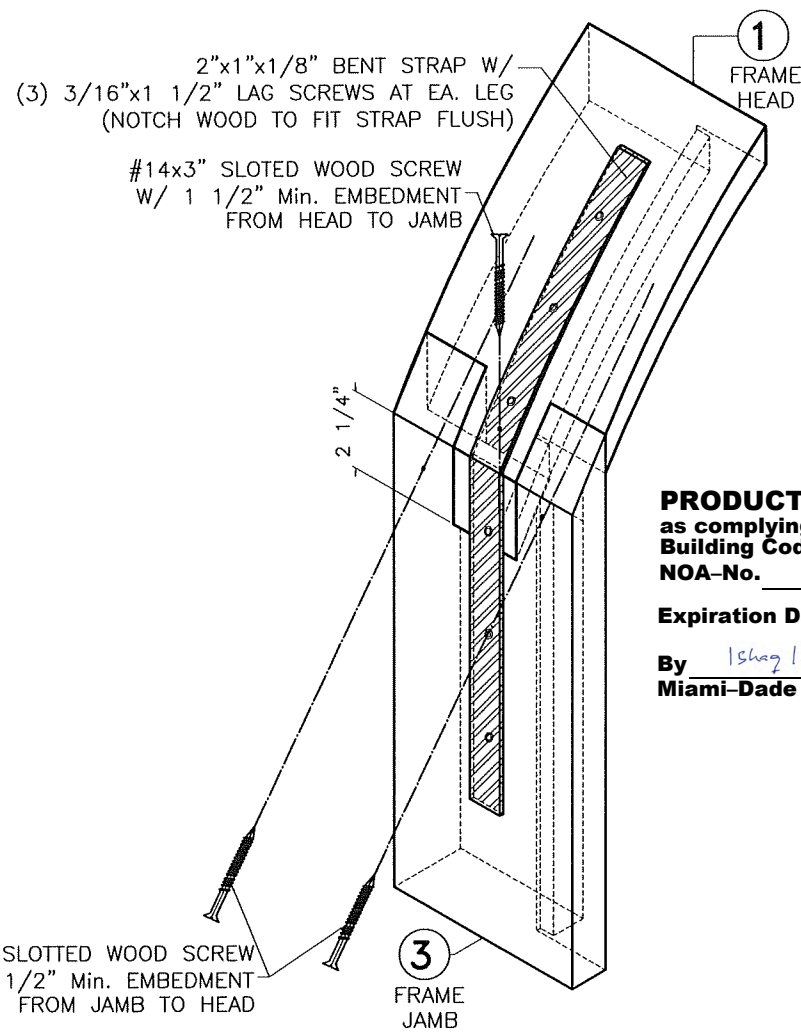

TYPICAL ARCHED/ELLIPTICAL FRAME TOP CONNECTION
SCALE: 3/16" = 1"

INSTALLATION SEALANT NOTE:
FRAME AND ALL EXPOSED INSTALLATION FASTENERS MUST BE PROPERLY SEALED WITH SEALANT (15).

PRODUCT REVISED
as complying with the Florida Building Code
NOA-No. 23-1017.12
Expiration Date 10/12/2026
By Ishag L. Chande
Miami-Dade Product Control

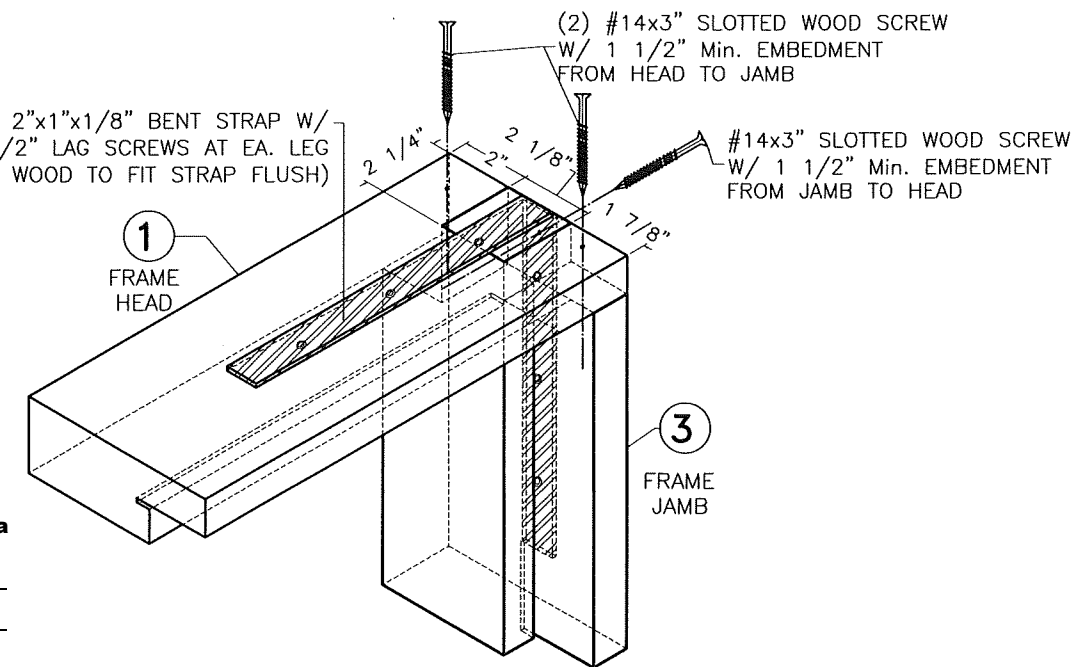

TYPICAL REGULAR FRAME TOP CONNECTION
SCALE: 3/16" = 1"

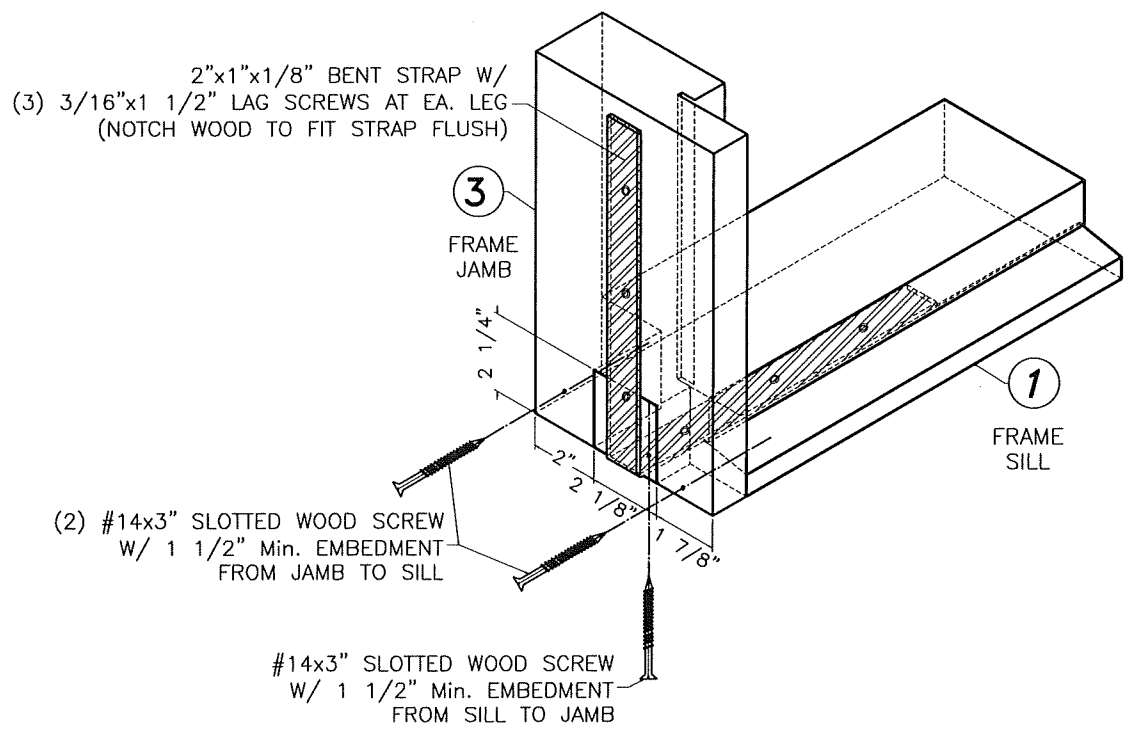

TYPICAL FRAME BOTTOM CONNECTION
SCALE: 3/16" = 1"

WALTER A. TILLIT JR.
LICENSE
No. 44167
STATE OF FLORIDA
PROFESSIONAL ENGINEER
10/11/2023
P.E. SEAL/SIGNATURE/DATE

<p>©2023 TILTECO INC.</p> <p>TILTECO INC.</p> <p>TILLIT TESTING & ENGINEERING COMPANY 6355 N.W. 36th St., Ste. 305 - VIRGINIA GARDENS, FL 33166 Phone : (305) 871-1530 , Fax : (305) 871-1531 e-mail: tiltco@aol.com CA-0006719 WALTER A. TILLIT Jr., P.E. FLORIDA Lic. # 44167</p>						<p>FLORIDA BUILDING CODE (High Velocity Hurricane Zone)</p> <p>DOUBLE & SINGLE OUTSWING WOOD DOORS, W/ WOOD & GLAZED PANELS</p> <p>IMPACT PRECIOUS WOOD, INC.</p> <p>6333 NW 74 Ave. Miami, FL 33166 PH: (786) 222-0427, FAX: (305) 428-3011</p>						<p>W.H DRAWN BY:</p> <p>10/11/2023 DATE:</p> <p>23-232 DRAWING N°</p>	
REV N°	DESCRIPTION	DATE	REV N°	DESCRIPTION	DATE	SHEET 10 OF 10							
1	OLD 20-291	10/11/23	3	-	-								
2			4	-	-								