



DEPARTMENT OF REGULATORY AND ECONOMIC RESOURCES (RER)  
BOARD AND CODE ADMINISTRATION DIVISION  
**NOTICE OF ACCEPTANCE (NOA)**

MIAMI-DADE COUNTY  
PRODUCT CONTROL SECTION  
11805 SW 26 Street, Room 208  
Miami, Florida 33175-2474  
T (786) 315-2590 F (786) 315-2599  
[www.miamidade.gov/economy](http://www.miamidade.gov/economy)

**Ruskin Company**  
**3900 Dr. Greaves Road**  
**Grandview, MO 64030**

**SCOPE:**

This NOA is being issued under the applicable rules and regulations governing the use of construction materials. The documentation submitted has been reviewed and accepted by Miami-Dade County RER-Product Control Section to be used in Miami Dade County and other areas where allowed by the Authority Having Jurisdiction (AHJ).

This NOA shall not be valid after the expiration date stated below. The Miami-Dade County Product Control Section (In Miami Dade County) and/or the AHJ (in areas other than Miami Dade County) reserve the right to have this product or material tested for quality assurance purposes. If this product or material fails to perform in the accepted manner, the manufacturer will incur the expense of such testing and the AHJ may immediately revoke, modify, or suspend the use of such product or material within their jurisdiction. RER reserves the right to revoke this acceptance if it is determined by Miami-Dade County Product Control Section that this product or material fails to meet the requirements of the applicable building code.

This product is approved as described herein and has been designed to comply with the Florida Building Code, including the High Velocity Hurricane Zone.

**DESCRIPTION: Model ACL1245AFD Aluminum Louver**

**APPROVAL DOCUMENT:** Drawing No. **60-022208**, titled "ACL1245AFD Louver", sheets 1 through 6 of 6, dated 07/16/2011, with revision C dated 07/01/2022, prepared by Ruskin Company, signed and sealed by Jeffery D. Smith, P.E., bearing the Miami-Dade County Product Control revision stamp with the Notice of Acceptance number and expiration date by the Miami-Dade County Product Control Section.

**MISSILE IMPACT RATING: Large and Small Missile Impact Resistant**

**LABELING:** Each unit shall bear a permanent label with the manufacturer's name or logo, Geneva, AL, model/series, and following statement: "Miami-Dade County Product Control Approved", unless otherwise noted herein.

**RENEWAL** of this NOA shall be considered after a renewal application has been filed and there has been no change in the applicable building code negatively affecting the performance of this product.

**TERMINATION** of this NOA will occur after the expiration date or if there has been a revision or change in the materials, use, and/or manufacture of the product or process. Misuse of this NOA as an endorsement of any product, for sales, advertising or any other purposes shall automatically terminate this NOA. Failure to comply with any section of this NOA shall be cause for termination and removal of NOA.

**ADVERTISEMENT:** The NOA number preceded by the words Miami-Dade County, Florida, and followed by the expiration date may be displayed in advertising literature. If any portion of the NOA is displayed, then it shall be done in its entirety.

**INSPECTION:** A copy of this entire NOA shall be provided to the user by the manufacturer or its distributors and shall be available for inspection at the job site at the request of the Building Official.

This NOA **revises NOA # 22-0407.06** and consists of this page 1 and evidence pages E-1 and E-2 as well as approval document mentioned above.

The submitted documentation was reviewed by **Sifang Zhao, P.E.**



02/01/2024

NOA No. 23-1116.06  
Expiration Date: November 8, 2027  
Approval Date: February 01, 2024  
Page 1

**NOTICE OF ACCEPTANCE: EVIDENCE SUBMITTED**

**A. DRAWINGS**

1. Drawing No. **60-022208**, titled "ACL1245AFD Louver", sheets 1 through 6 of 6, dated 07/16/2011, with revision C dated 07/01/2022, prepared by Ruskin Company, signed and sealed by Jeffrey D. Smith, P.E. *"Submitted under NOA # 22-0407.06"*

**B. TESTS**

1. Test reports on 1) Uniform Static Air Pressure Test, Loading per FBC TAS 202-94  
2) Large Missile Impact Test per FBC, TAS 201-94  
3) Cyclic Wind Pressure Loading per FBC, TAS 203-94  
along with marked-up drawings and installation diagram of Series ACL1245AFD Aluminum Louvers", prepared by National Certified Testing Laboratories, Report No. **210-3711-3**, dated 11/05/2010, signed and sealed by Gerald J. Ferrara, P.E. *"Submitted under NOA # 11-0207.22"*
2. Test reports on 1) Uniform Static Air Pressure Test, Loading per FBC TAS 202-94  
2) Large Missile Impact Test per FBC, TAS 201-94  
3) Cyclic Wind Pressure Loading per FBC, TAS 203-94  
along with marked-up drawings and installation diagram of ACL1245AFD Louver", prepared by National Certified Testing Laboratories, Report No. **NCTL-210-4244-02**, dated 03/18/2022, signed and sealed by Douglas J. McDougall, P.E. *"Submitted under NOA # 22-0407.06"*

**C. CALCULATIONS**

1. Anchor verification calculations and structural analysis, complying with FBC-2007, prepared by Ruskin Company, dated 01/11/2011, signed and sealed by William J. Mossie, P.E. *"Submitted under NOA # 11-0207.22"*
2. Louver wind load review prepared by Ruskin Company, dated 07/19/2022, signed and sealed by Jeffrey D. Smith, P.E. *"Submitted under NOA # 22-0407.06"*

**D. QUALITY ASSURANCE**

1. Miami-Dade Department of Regulatory and Economic Resources (RER).

**E. MATERIAL CERTIFICATIONS**

1. Test report on impact test per AMCA 540 of an ACL1245AFD Acoustical louver, prepared by Ruskin Company, Test Report No. **082412D**, dated 08/24/2012, signed and sealed by Daniel J. Rau, P.E.



---

Sifang Zhao, P.E.,  
Product Control Examiner  
NOA No. 23-1116.06  
Expiration Date: November 8, 2027  
Approval Date: February 01, 2024

**NOTICE OF ACCEPTANCE: EVIDENCE SUBMITTED**

**F. STATEMENTS**

1. Statement letter of code conformance to the 5<sup>th</sup> edition (2014) FBC issued by Ruskin Company, dated 06/14/2016, signed and sealed by Daniel J. Rau, P.E.
2. Statement letter of no financial interest, issued by Ruskin Company, dated 07/12/2013, signed and sealed by Daniel J. Rau, P.E. ***“Submitted under NOA # 13-0502.06”***
3. Statement letter of code conformance to the 6<sup>th</sup> edition (2017) FBC issued by Ruskin Company, dated 10/09/2017, signed and sealed by Daniel J. Rau, P.E.
4. Statement letter of code conformance to the 7<sup>th</sup> edition (2020) of the FBC issued by Ruskin Company, dated 08/27/2021, signed and sealed by Jeffery D. Smith, P.E. ***“Submitted under NOA # 21-0512.01”***
5. Statement letter dated 09/15/2021 of Successor Engineer adopting another Engineer’s work per FS 61G15-27.001, signed and sealed by Jeffery D. Smith, P.E. ***“Submitted under NOA # 21-0512.01”***
6. Statement letter dated 06/15/2021, issued by National Certified Testing Lab (NCTL) for upcoming scheduled verification, signed by Christopher Bennett, Lab Manager. ***“Submitted under NOA # 21-0512.01”***
7. Statement letter of code conformance to the 8<sup>th</sup> edition (2023) of the FBC and of no financial interest, issued by Ruskin Company, dated 10/30/2023, signed and sealed by Jeffrey Devon Smith, P.E.

**G. OTHER**

1. This NOA **revises NOA # 22-0407.06** for the 8<sup>th</sup> edition (2023) of the FBC update.



---

Sifang Zhao, P.E.,  
Product Control Examiner  
NOA No. 23-1116.06  
Expiration Date: November 8, 2027  
Approval Date: February 01, 2024



FRAME	
Formed .125" aluminum channel.	✕
BLADES	
Formed .081" aluminum exterior w/ .050" perforated aluminum interior surface.	✕
4" Thick Mineral Wool Blanket.	✕
4 # Density	
SCREEN	
1/2" mesh x 19 ga galv bird screen.	
5/8" x .040" expanded flattened aluminum bird screen.	
1/2" mesh x .063" aluminum bird screen.	
18-16 mesh al. insect screen.	
No screen.	✕
FINISH	
Mill.	✕
Kynar (opt).	
Baked enamel (modified fluoropolymer, 50% Kynar, opt).	
Color anodize (opt).	
Clear anodize (opt).	
ACCESSORIES (opt)	
Flange frame.	
Extended sill.	
Clip angles.	✕
Blankoff panel.	

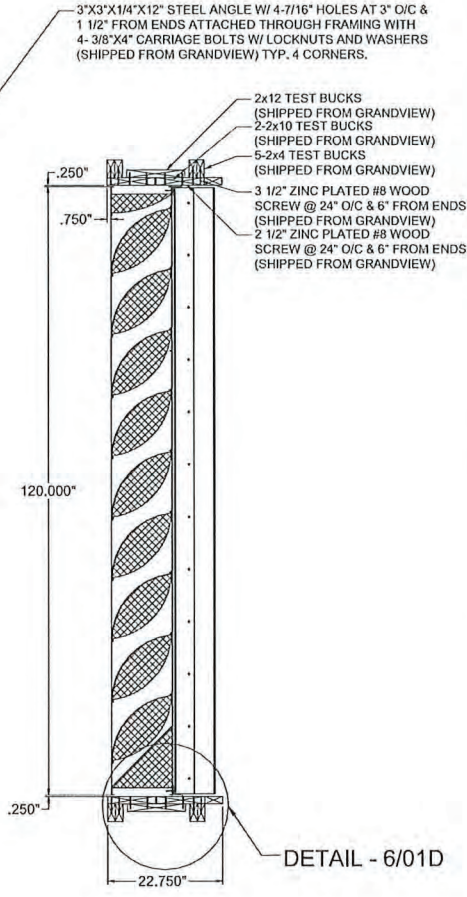
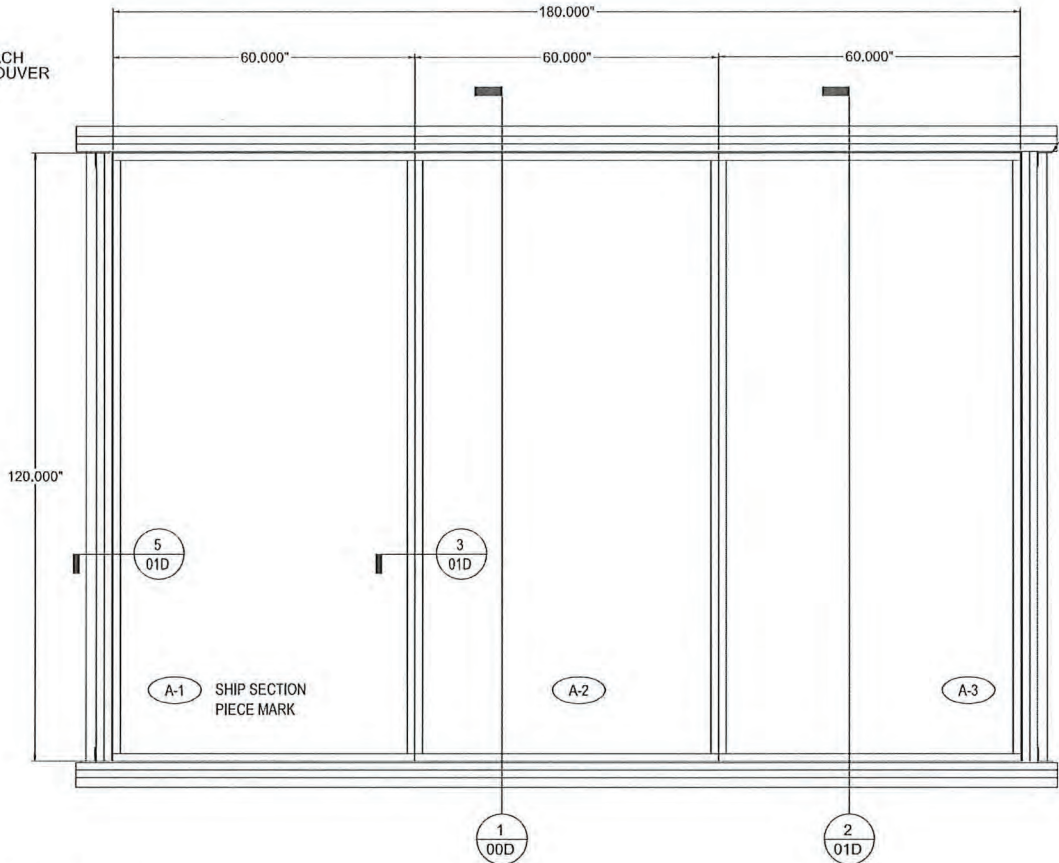
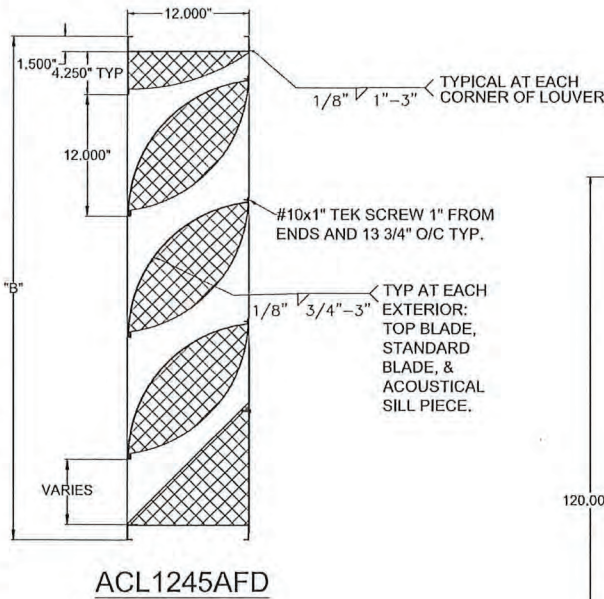

ASSEMBLY 'A'

3-ASSEMBLIES REQUIRED WITH 3-SHIP SECTIONS  
N.T.S.

FRONT VIEW

1 SECTION  
N.T.S.

NOTES:

- 1) THE ACL1245AFD HAS BEEN TESTED IN ACCORDANCE WITH MIAMI-DADE COUNTY PROTOCOLS TAS-201, 202 & 203 FOR LARGE MISSILE IMPACT, UNIFORM PRESSURE AND CYCLIC WIND PRESSURE.
- 2) THIS LOUVER SYSTEM IS APPROVED FOR APPLICATIONS WITH DESIGN PRESSURES OF +/- 150 PSF OR LESS.
- 3) THIS LOUVER SYSTEM IS NON-BEARING AND IS NOT DESIGNED TO WITHSTAND BUILDING DEAD LOADS.
- 4) LOUVER ANCHORS ARE REVIEWED FOR ATTACHMENT INTO STEEL, CONCRETE, MASONRY OR TIMBER SUBSTRUCTURE. MINIMUM EDGE DISTANCE AND EMBEDMENT REQUIREMENTS ARE SHOWN. RUSKIN DOES NOT DETERMINE THE STRUCTURAL INTEGRITY OF THE SUB-STRUCTURE.
- 5) MAXIMUM SINGLE SECTION SIZE: 60" WIDE X 120" HIGH.
- 6) MAXIMUM ASSEMBLED LOUVER SIZE: UNLIMITED WIDE X 120" HIGH. MAX: MULLION SPACING IS 60".
- 7) SECTIONS OR ASSEMBLIES MAY BE STACKED VERTICALLY PROVIDING A SUITABLE STRUCTURAL SUPPORT IS DESIGNED AND INSTALLED BY OTHERS TO SUPPORT ALL LOADS TRANSFERRED FROM THE LOUVER.
- 8) THIS LOUVER IS TO BE INSTALLED IN A LOCATION WHERE THE ROOM BEHIND THE LOUVER IS DESIGNED TO DRAIN WATER PENETRATING INTO THE ROOM AND THE ROOM WILL HOUSE WATER RESISTANT/WATER PROOF EQUIPMENT, COMPONENTS OR SUPPLIES.

DRAWING INDEX:

- 60-022208-00D ACL1245AFD LOUVER - SPEC, ASS'Y AND NOTES  
Drawing 1 of 6.  
60-022208-01D ACL1245AFD LOUVER - SECTION AND DETAILS  
Drawing 2 of 6.  
60-022208-02D ACL1245AFD LOUVER - SECTION AND DETAILS  
Drawing 3 of 6.  
60-022208-03D ACL1245AFD LOUVER - SECTION AND DETAILS  
Drawing 4 of 6.  
60-022208-04D ACL1245AFD LOUVER - PART DETAILS  
Drawing 5 of 6.  
60-022208-05D ACL1245AFD LOUVER - PART DETAILS  
Drawing 6 of 6.

TESTS PERFORMED:

TAS-201 LARGE MISSILE IMPACT  
TAS-202 UNIFORM STATIC AIR PRESSURE TEST  
TAS-203 CYCLIC WIND PRESSURE TEST  
DESIGN PRESSURE RATING 150 PSF

MULLION / MULLION SUPPORT TABLE	
HEIGHT	MULLION SUPPORT
18" - 106"	MULLION W/O SUPPORT
106" - 120"	2" X 8" X 1/4" TUBE

PRODUCT REVISED  
as complying with the Florida  
Building Code  
NOA-No. 23-1116.06

Expiration Date 11/08/2027

By *[Signature]*  
Miami-Dade Product Control

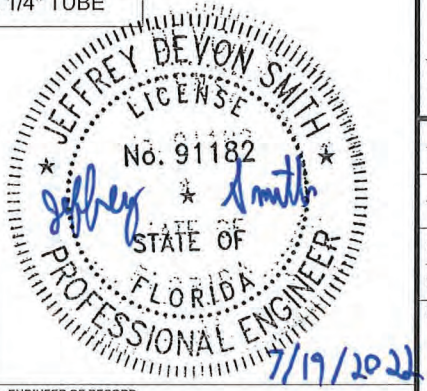

ENGINEER OF RECORD:  
JEFFREY DEVON SMITH  
ENGINEERING DISCIPLINE:  
CIVIL - STRUCTURAL  
STATE OF FLORIDA 91182

C	REVISED FOR EASE OF INSTALLATION				07/01/22	RVT	JDS	JDS
B	REVISED NOTES, DRAWING INDEX & ENGINEER OF RECORD				07/09/13	RKP	DJR	DJR
A	REVISED BLADE WELDING INFORMATION				10/14/10	VMA		
REV.		DESCRIPTION			DATE	REV'D BY	CHK'D BY	APP'D BY
TOLERANCES UNLESS SPECIFIED OTHERWISE					NOTE: 1) ALL DIMENSIONS ARE GIVEN IN INCHES. 2) ALL EXPOSED SURFACES MUST BE FREE OF DIE LINES. 3) ALUMINUM ASSOCIATION TOLERANCES APPLY UNLESS OTHERWISE SPECIFIED. 4) ** EXTRUDER SPECIFIC ID MARK: .008R x .008DP			
3 PLACE .XXX ±.010								
2 PLACE .XX ±.020								
ANGLE DIMENSIONS ± 2°								
USE WIIQ-007 & 008								
THIS INFORMATION DISCLOSED HEREIN WAS ORIGINATED BY AND IS THE PROPERTY OF RUSKIN INDUSTRIES, AND EXCEPT FOR USES EXPRESSLY GRANTED TO THE UNITED STATES GOVERNMENT, RUSKIN INDUSTRIES RESERVES ALL PATENT, PROPRIETARY, DESIGN, USE, SALE, MANUFACTURING AND REPRODUCTION RIGHTS THERETO. THIS DOES NOT APPLY TO ANY VENDOR PARTS.								

CTR	CENTER	OC	ON CENTER
CL	CENTER LINE	OD	OUTSIDE DIAMETER
C-C	CENTER TO CENTER	OR	OUTSIDE RADIUS
CHAM	CHAMFER	PI	POINT OF INTERSECTION
DAT	DATUM	R	FULL RADIUS
DET	DETAIL	REF	REFERENCE
E-E	END TO END	SYM	SYMMETRICAL
EXP	EXPOSED	TAN	TANGENT
ID	INSIDE DIAMETER	TYP	TYPICAL
IR	INSIDE RADIUS		

RUSKIN

3900 DR. GREAVES RD  
GRANDVIEW, MO 64030  
PH: (816) 761-7476 FAX: (816) 763-8102

AREA	EST. PER.	EST. WT/FT.
-	-	-
ALLOY & TEMPER	UNSPEC. RADII	UNSPEC. WALL
-	-	-
DWN: WJM	CHK:	APPV:
DATE: 07/16/11	DATE:	DATE:

PART DESC.		
ACL1245AFD LOUVER SPECS, ASSY'S AND NOTES		
SCALE: NTS	ECN: -	DATE:
DWG No.	Drawing 1 of 6	
60 -	022208 -00D	



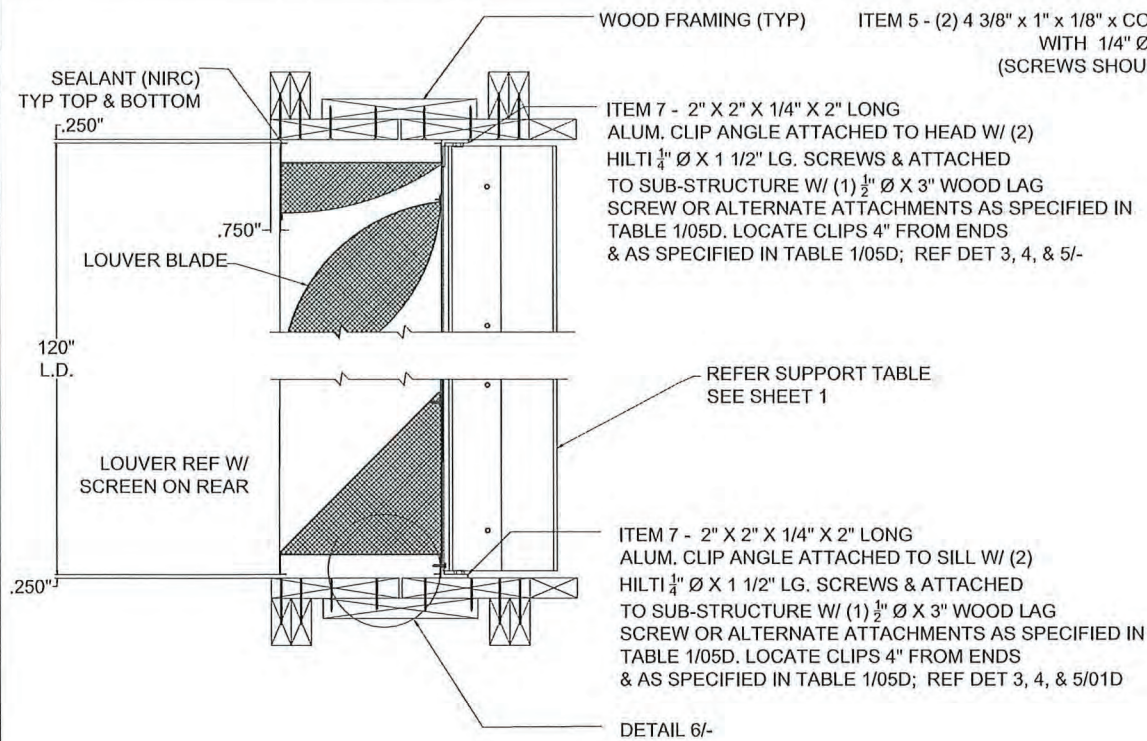

2 LOUVER DETAIL @ HEAD & SILL  
00D N.T.S.

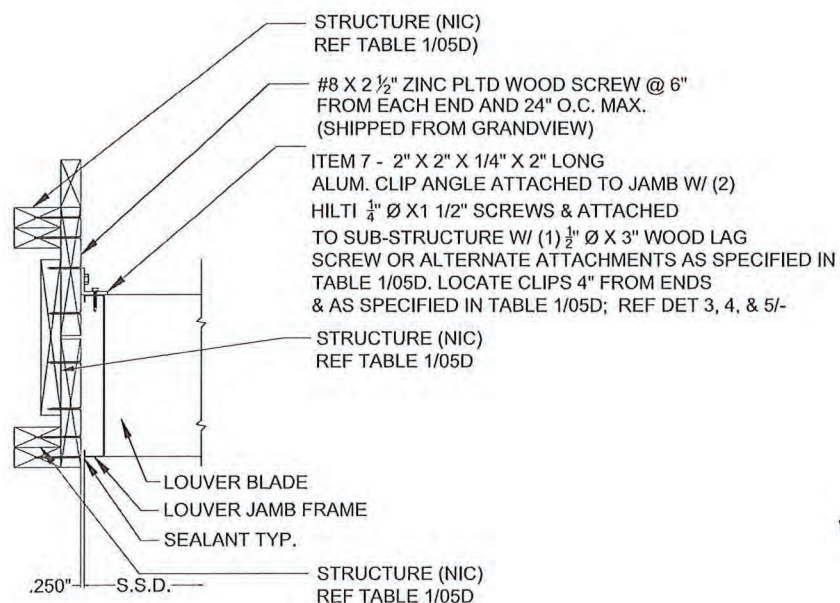

5 LOUVER @ JAMB DETAIL  
00D N.T.S.

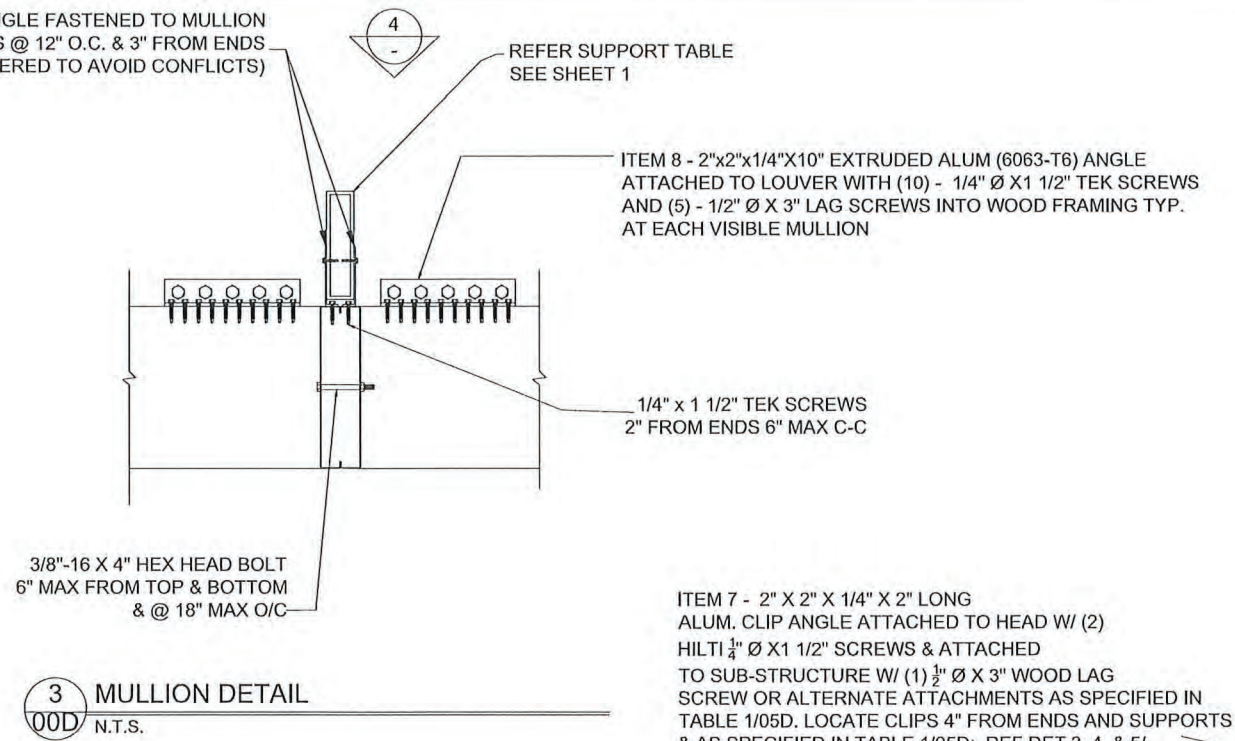

3 MULLION DETAIL  
00D N.T.S.

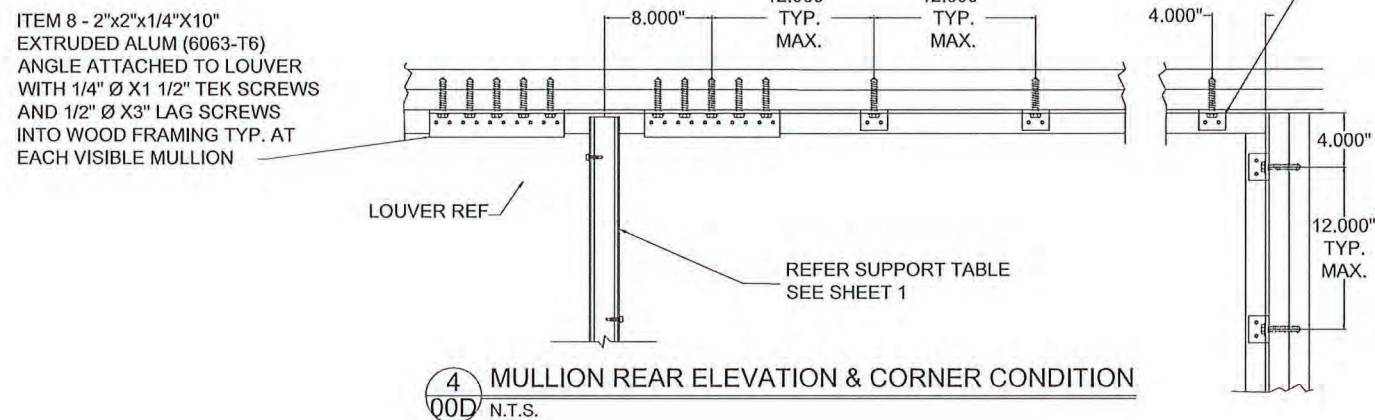

4 MULLION REAR ELEVATION & CORNER CONDITION  
00D N.T.S.

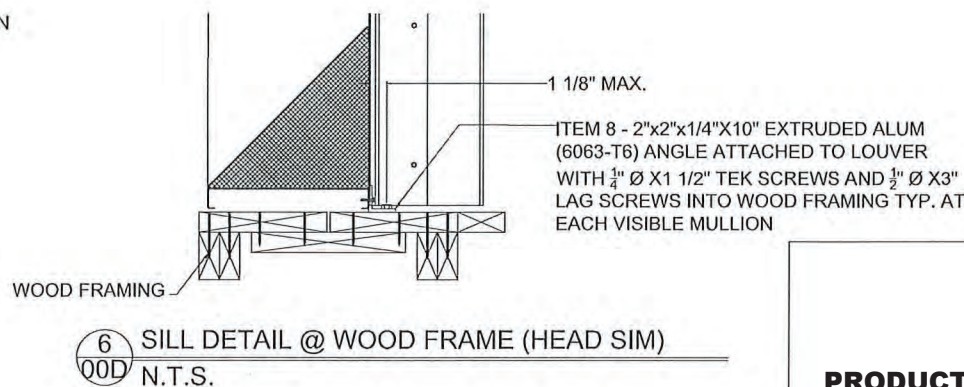

6 SILL DETAIL @ WOOD FRAME (HEAD SIM)  
00D N.T.S.

FOR OFFICE USE ONLY

**PRODUCT REVISED**  
as complying with the Florida  
Building Code  
NOA-No. 23-1116.06  
Expiration Date 11/08/2027  
By *[Signature]*  
Miami-Dade Product Control



ENGINEER OF RECORD:  
JEFFREY DEVON SMITH  
ENGINEERING DISCIPLINE:  
CIVIL - STRUCTURAL  
STATE OF FLORIDA 91182

REVISED FOR EASE OF INSTALLATION		DESCRIPTION	
C	REVISED ENGINEER OF RECORD	B	REVISED ENGINEER OF RECORD
JDS	07/01/22	JDS	07/01/22
DJR	07/09/13	DJR	07/09/13
CHKD BY	DATE	CHKD BY	DATE
APPD BY		APPD BY	
NOTE: 1) ALL DIMENSIONS ARE GIVEN IN INCHES. 2) ALL EXPOSED SURFACES MUST BE FREE OF DIE LINES. 3) ALUMINUM ASSOCIATION TOLERANCES APPLY UNLESS OTHERWISE SPECIFIED. 4) ** EXTRUDER SPECIFIC ID MARK: .008R x .008DP			

CTR	CENTER	OC	ON CENTER
CL	CENTER LINE	OD	OUTSIDE DIAMETER
C-C	CENTER TO CENTER	OR	OUTSIDE RADIUS
CHAM	CHAMFER	PI	POINT OF INTERSECTION
DAT	DATUM	R	FULL RADIUS
DET	DETAIL	REF	REFERENCE
E-E	END TO END	SYM	SYMMETRICAL
EXP	EXPOSED	TAN	TANGENT
ID	INSIDE DIAMETER	TYP	TYPICAL
IR	INSIDE RADIUS		

**RUSKIN**

3900 DR. GREAVES RD  
GRANDVIEW, MO 64030  
PH: (816) 761-7476 FAX: (816) 763-8102

AREA	EST. PER.	EST. WT/FT.
-	-	-
ALLOY & TEMPER	UNSPEC. RADII	UNSPEC. WALL
-	-	-
DWN: WJM	CHK: -	APPV: -
DATE: 07/16/10	DATE: -	DATE: -
PART DESC.		

ACL1245AFD LOUVER  
SECTION AND DETAILS

SCALE: NTS	ECN: -	DATE:
DWG No.	Drawing 2 of 6	
60 -	022208 -01D	



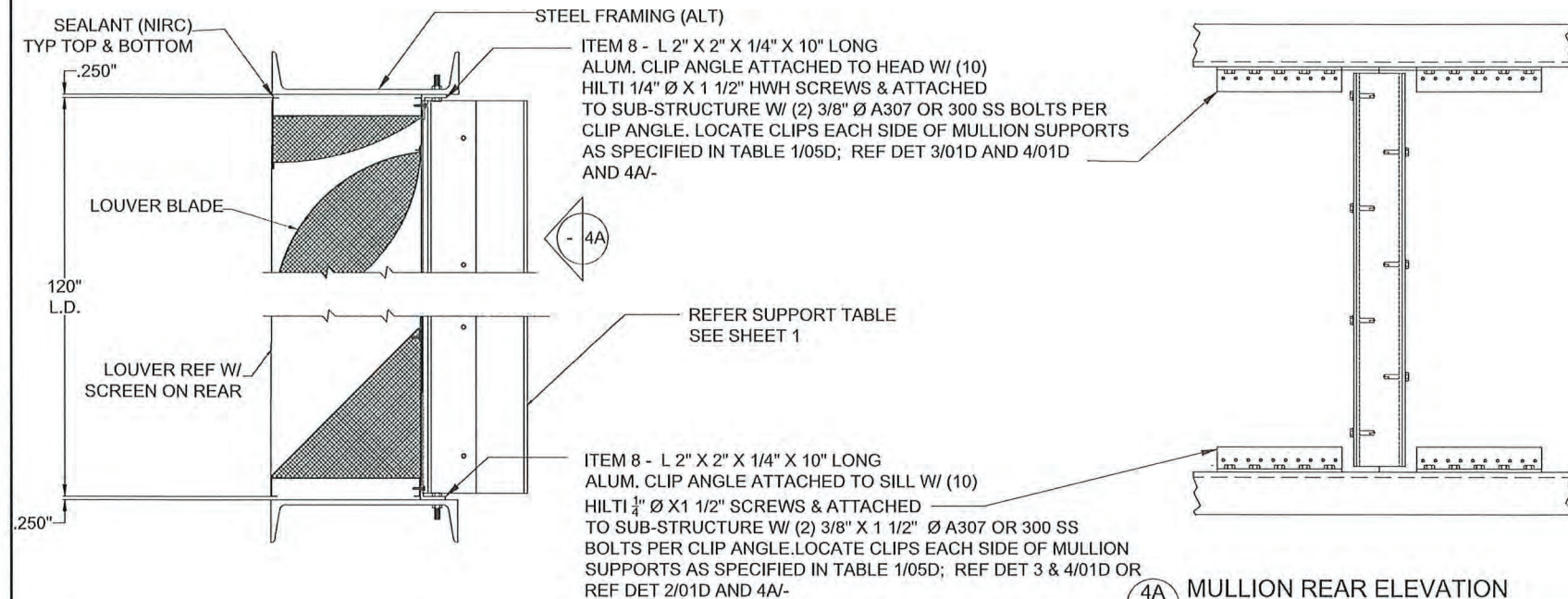

2A LOUVER DETAIL @ HEAD & SILL

N.T.S.  
ALT. STRUCTURE - STEEL FRAME  
12 GAUGE MIN. THICKNESS

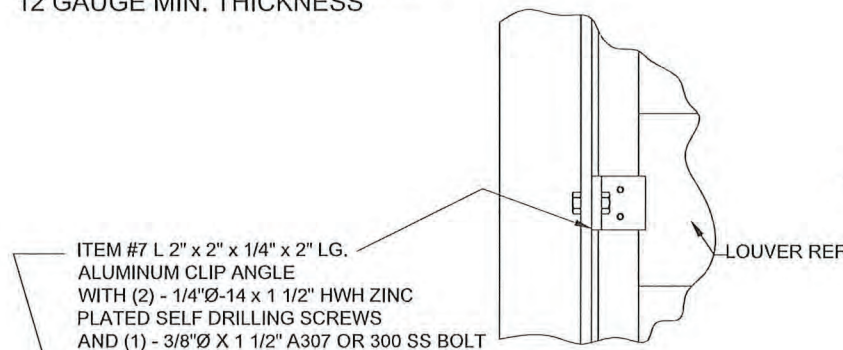

5A1 LOUVER @ JAMB DETAIL

N.T.S.  
ALT. STRUCTURE - STEEL FRAME  
12 GAUGE MIN. THICKNESS

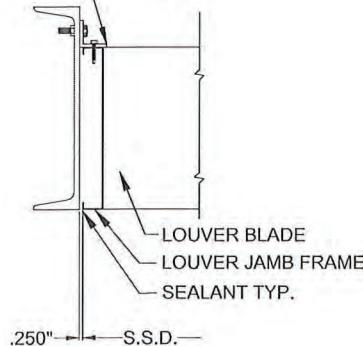

5 LOUVER @ JAMB DETAIL

N.T.S.  
ALT. STRUCTURE - STEEL FRAME  
12 GAUGE MIN. THICKNESS

4A MULLION REAR ELEVATION

N.T.S.  
ALT. STRUCTURE - STEEL FRAME  
12 GAUGE MIN. THICKNESS

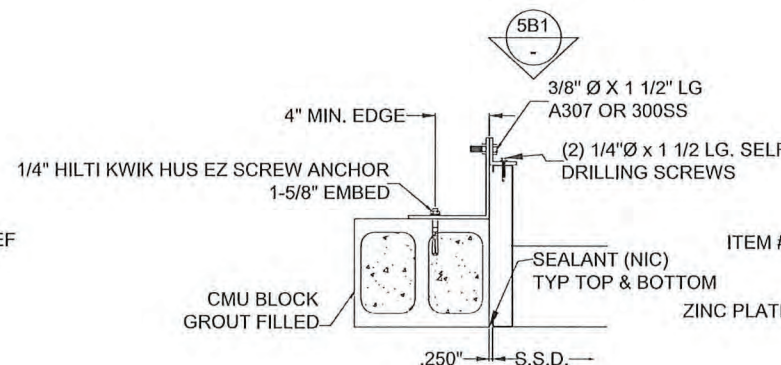

5B LOUVER @ JAMB DETAIL

N.T.S.  
ALT. STRUCTURE - CMU BLOCK

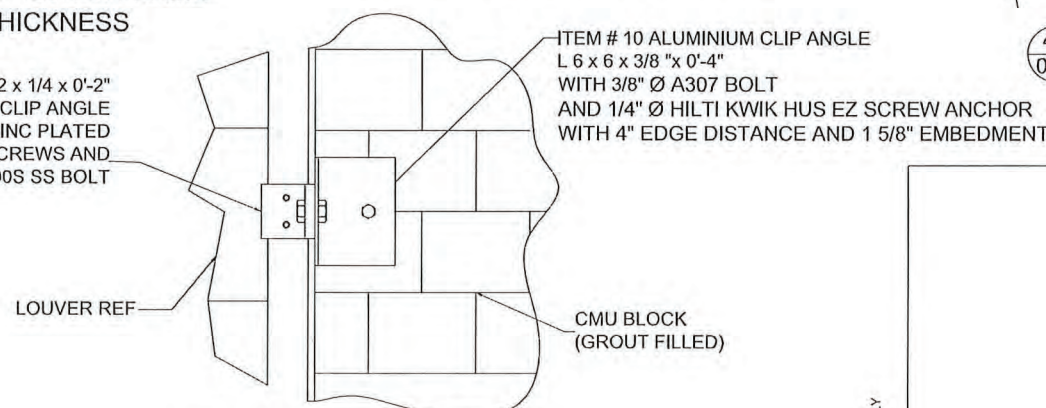

5B1 LOUVER @ JAMB DETAIL

N.T.S.  
ALT. STRUCTURE - CMU BLOCK

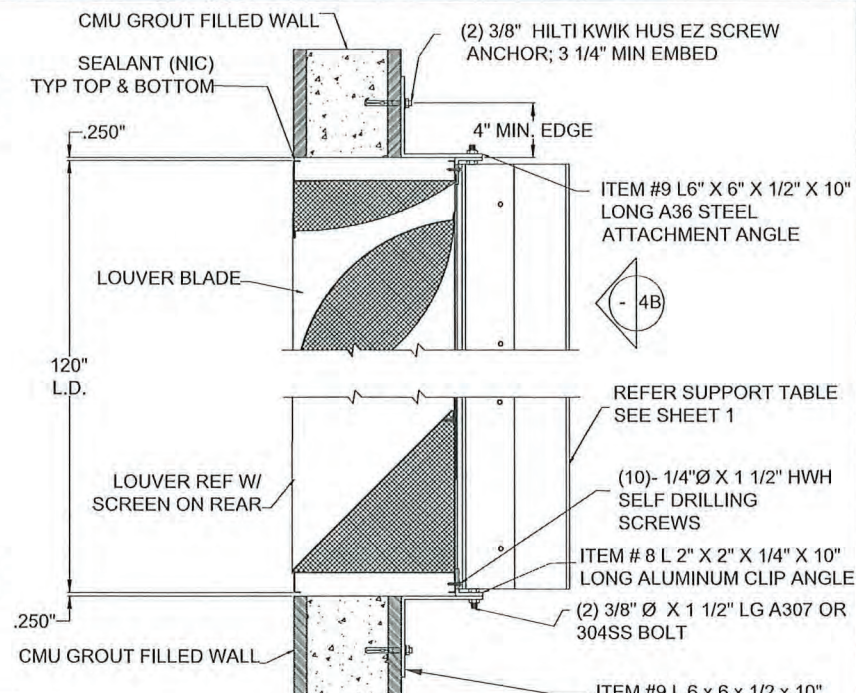

2B LOUVER DETAIL @ HEAD & SILL

N.T.S.  
ALT. STRUCTURE - CMU BLOCK

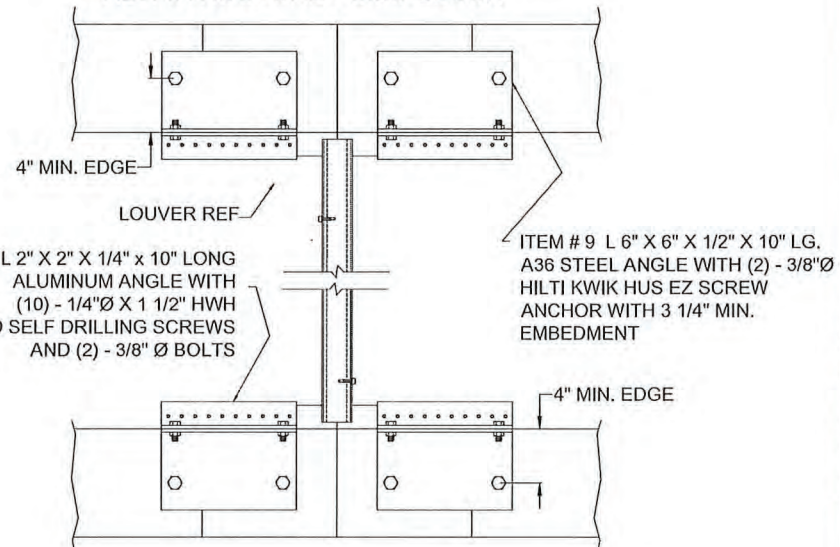

4B MULLION REAR ELEVATION

N.T.S.  
ALT. STRUCTURE - CMU BLOCK

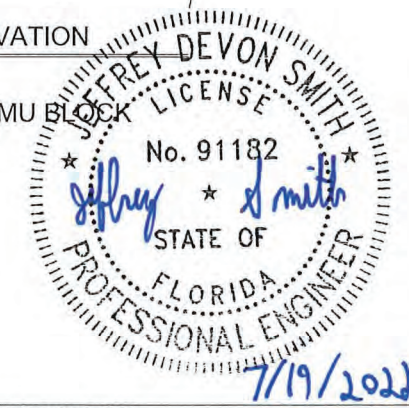

ENGINEER OF RECORD:  
JEFFREY DEVON SMITH

ENGINEERING DISCIPLINE:  
CIVIL - STRUCTURAL

STATE OF FLORIDA 91182

REV.	DESCRIPTION	DATE	CHKD BY	APP'D BY
C	REVISED FOR EASE OF INSTALLATION	07/01/22	JDS	JDS
B	REVISED ENGINEER OF RECORD	07/09/13	RKP	DJR
A				

NOTE:  
1) ALL DIMENSIONS ARE GIVEN IN INCHES.  
2) ALL EXPOSED SURFACES MUST BE FREE OF DIE LINES.  
3) ALUMINUM ASSOCIATION TOLERANCES APPLY UNLESS OTHERWISE SPECIFIED.  
4) \*\* EXTRUDER SPECIFIC ID MARK: .008R x .008DP

TOLERANCES UNLESS SPECIFIED OTHERWISE:  
3 PLACE .XXX ±.010  
2 PLACE .XX ±.020  
ANGLE DIMENSIONS ± 2°  
USE W1Q-007 & 008

CTR	CENTER	OC	ON CENTER
CL	CENTER LINE	OD	OUTSIDE DIAMETER
C-C	CENTER TO CENTER	OR	OUTSIDE RADIUS
CHAM	CHAMFER	PI	POINT OF INTERSECTION
DAT	DATUM	R	FULL RADIUS
DET	DETAIL	REF	REFERENCE
E-E	END TO END	SYM	SYMMETRICAL
EXP	EXPOSED	TAN	TANGENT
ID	INSIDE DIAMETER	TYP	TYPICAL
IR	INSIDE RADIUS		

**RUSKIN**

3900 DR. GREAVES RD  
GRANDVIEW, MO 64030  
PH: (816) 761-7476 FAX: (816) 763-8102

AREA	EST. PER.	EST. WT/FT.
-	-	-
ALLOY & TEMPER	UNSPEC. RADII	UNSPEC. WALL
-	-	-
DWN: WJM	CHK: -	APPV: -
DATE: 08/16/10	DATE: -	DATE: -

PART DESC.  
ACL1245AFD LOUVER  
SECTION AND DETAILS

SCALE: NTS	ECN: -	DATE: -
DWG No.	Drawing 3 of 6	
60 -	022208	-02D



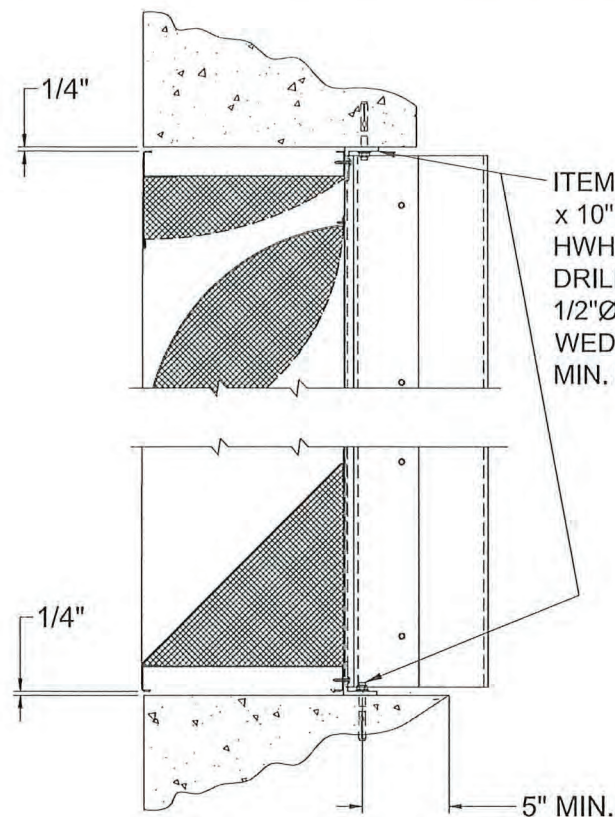

2C LOUVER DETAIL @ HEAD & SILL  
00D N.T.S.  
ALT. STRUCTURE - CONCRETE SUPPORT

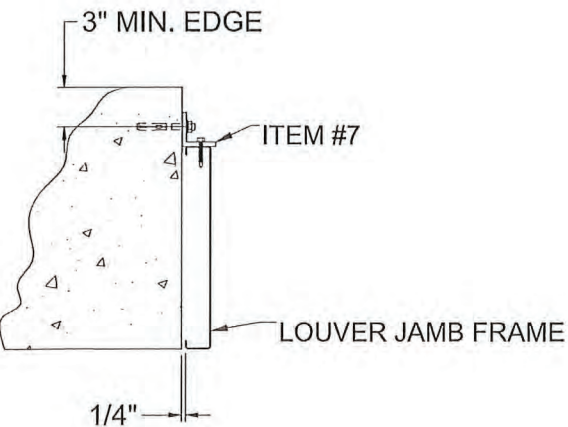

5C LOUVER @ JAMB DETAIL  
00D N.T.S.  
ALT. STRUCTURE - CONCRETE SUPPORT

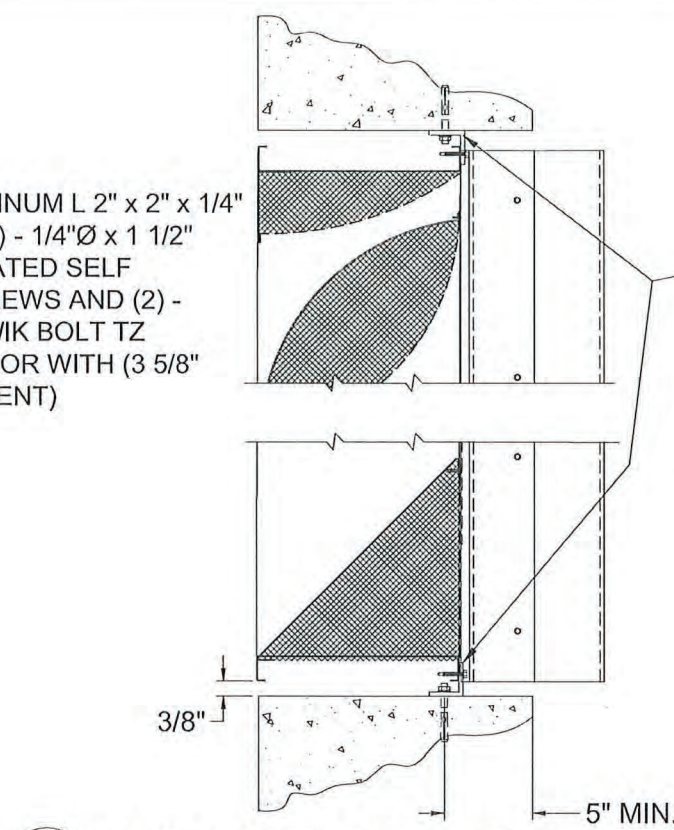

2C-ALT LOUVER DETAIL @ HEAD & SILL  
00D N.T.S.  
ALT. STRUCTURE - CONCRETE SUPPORT

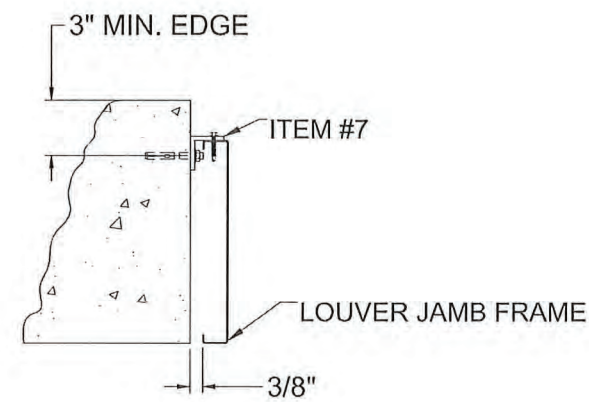

5C-ALT LOUVER @ JAMB DETAIL  
00D N.T.S.  
ALT. STRUCTURE - CONCRETE SUPPORT

ITEM #8 ALUMINUM L 2" x 2" x 1/4" x 10" WITH (10) - 1/4"Ø x 1 1/2" HWH ZINC PLATED SELF DRILLING SCREWS AND (2) - 1/2"Ø HILTI KWIK BOLT TZ WEDGE ANCHOR (3 5/8" MIN. EMBEDMENT)

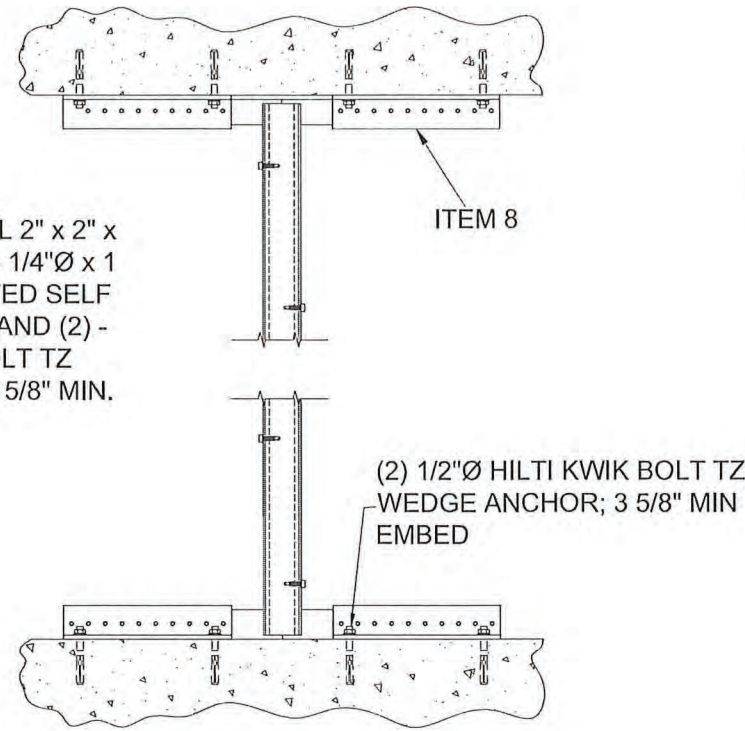

4C MULLION REAR ELEVATION  
00D N.T.S.  
ALT. STRUCTURE - CONCRETE SUPPORT

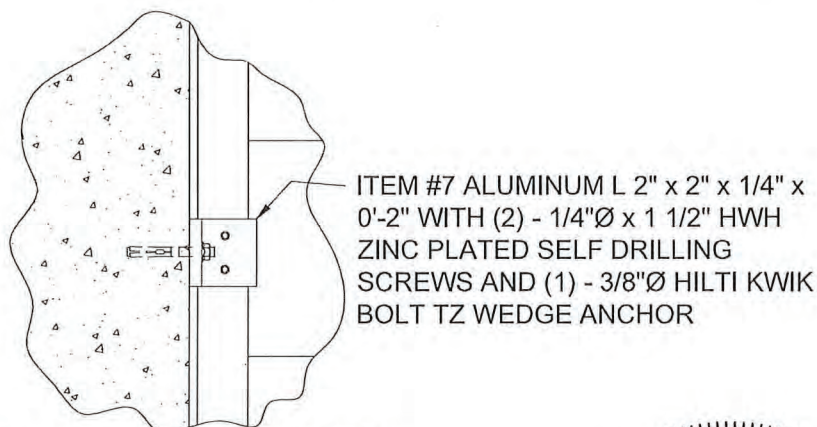

5C1 LOUVER @ JAMB DETAIL  
00D N.T.S.  
ALT. STRUCTURE - CONCRETE SUPPORT

ITEM #7 ALUMINUM L 2" x 2" x 1/4" x 0'-2" WITH (2) - 1/4"Ø x 1 1/2" HWH ZINC PLATED SELF DRILLING SCREWS AND (1) - 3/8"Ø HILTI KWIK BOLT TZ WEDGE ANCHOR

FOR OFFICE USE ONLY

**PRODUCT REVISED**  
as complying with the Florida  
Building Code  
NOA-No. 23-1116.06  
Expiration Date 11/08/2027  
By *[Signature]*  
Miami-Dade Product Control

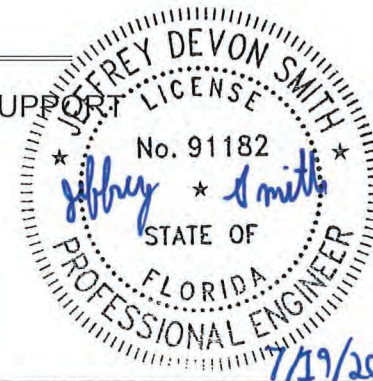

ENGINEER OF RECORD:  
JEFFREY DEVON SMITH  
ENGINEERING DISCIPLINE:  
CIVIL - STRUCTURAL  
STATE OF FLORIDA 91182

REVISED FOR EASE OF INSTALLATION		DESCRIPTION		DATE		CHK'D BY		APP'D BY	
C	B	REV.	DESCRIPTION	DATE	DATE	CHK'D BY	CHK'D BY	APP'D BY	APP'D BY
NOTE: 1) ALL DIMENSIONS ARE GIVEN IN INCHES. 2) ALL EXPOSED SURFACES MUST BE FREE OF DIE LINES. 3) ALUMINUM ASSOCIATION TOLERANCES APPLY UNLESS OTHERWISE SPECIFIED. 4) ** EXTRUDER SPECIFIC ID MARK: .008R x .008DP									
TOLERANCES UNLESS SPECIFIED OTHERWISE 3 PLACE .XXX ±.010 2 PLACE .XX ±.020 ANGLE DIMENSIONS ± 2° USE W1Q-007 & 008									

CTR	CENTER	OC	ON CENTER
CL	CENTER LINE	OD	OUTSIDE DIAMETER
C-C	CENTER TO CENTER	OR	OUTSIDE RADIUS
CHAM	CHAMFER	PI	POINT OF INTERSECTION
DAT	DATUM	R	FULL RADIUS
DET	DETAIL	REF	REFERENCE
E-E	END TO END	SYM	SYMMETRICAL
EXP	EXPOSED	TAN	TANGENT
ID	INSIDE DIAMETER	TYP	TYPICAL
IR	INSIDE RADIUS		

**RUSKIN**  
3900 DR. GREAVES RD  
GRANDVIEW, MO 64030  
PH: (816) 761-7476 FAX: (816) 763-8102

AREA	EST. PER.	EST. WT/FT.
-	-	-
ALLOY & TEMPER	UNSPEC. RADII	UNSPEC. WALL
-	-	-
DWN: WJM	CHK:	APPV:
DATE: 08/17/10	DATE:	DATE:

PART DESC. ACL1245AFD LOUVER SECTION AND DETAILS  
SCALE: NTS ECN: - DATE:  
DWG No. Drawing 4 of 6  
60 - 022208 - 03D

THIS INFORMATION DISCLOSED HEREIN IS THE PROPERTY OF RUSKIN INDUSTRIES, AND EXCEPT FOR USES EXPRESSLY GRANTED TO THE UNITED STATES GOVERNMENT, RUSKIN INDUSTRIES RESERVES ALL PATENT, PROPRIETARY, DESIGN, USE, SALE, MANUFACTURING AND REPRODUCTION RIGHTS THERETO. THIS DOES NOT APPLY TO ANY VENDOR PARTS.



SCALE: NTS	ECN: -	DATE:
DWG No. Drawing 5 of 6 <b>60 - 022208 - 04D</b>		



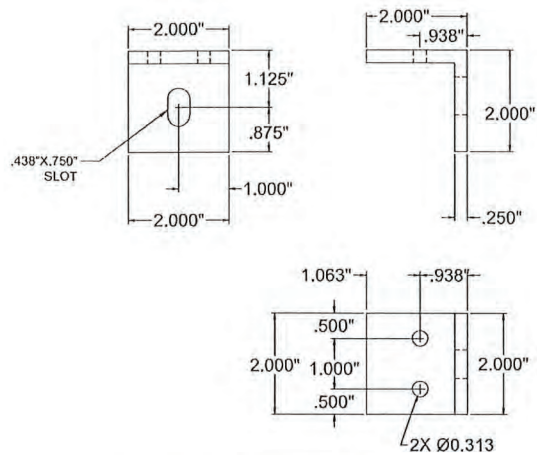

ITEM 7 - CLIP ANGLE

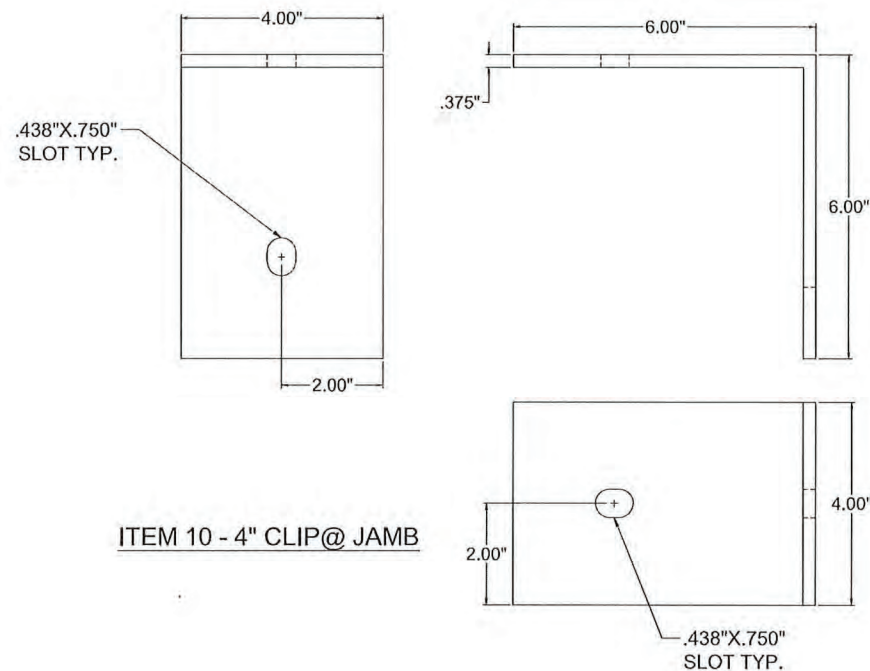

ITEM 10 - 4\"/>

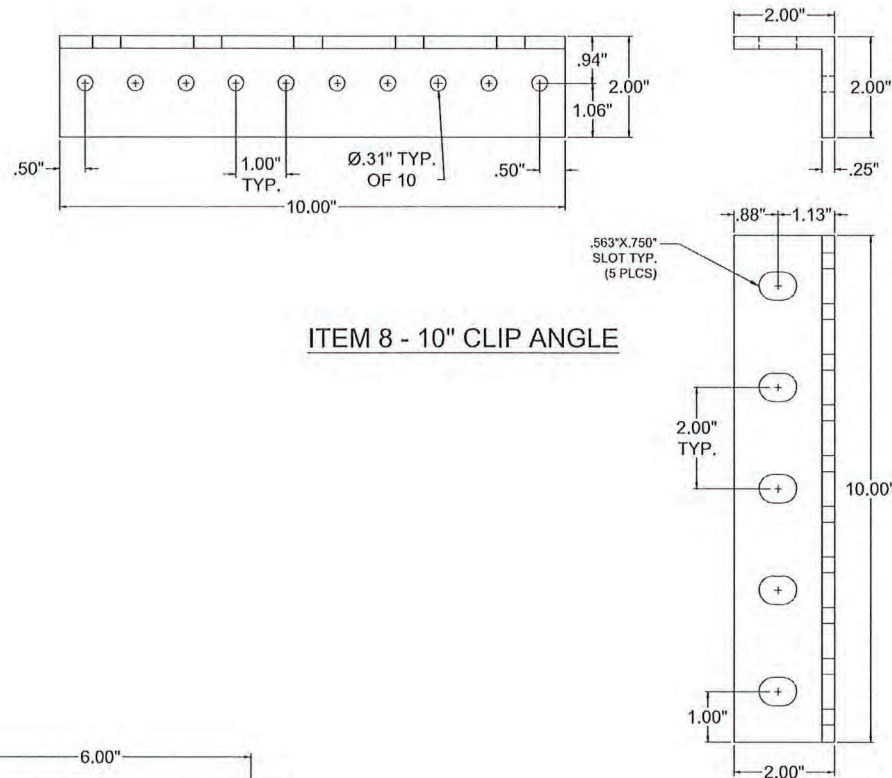

ITEM 8 - 10\"/>

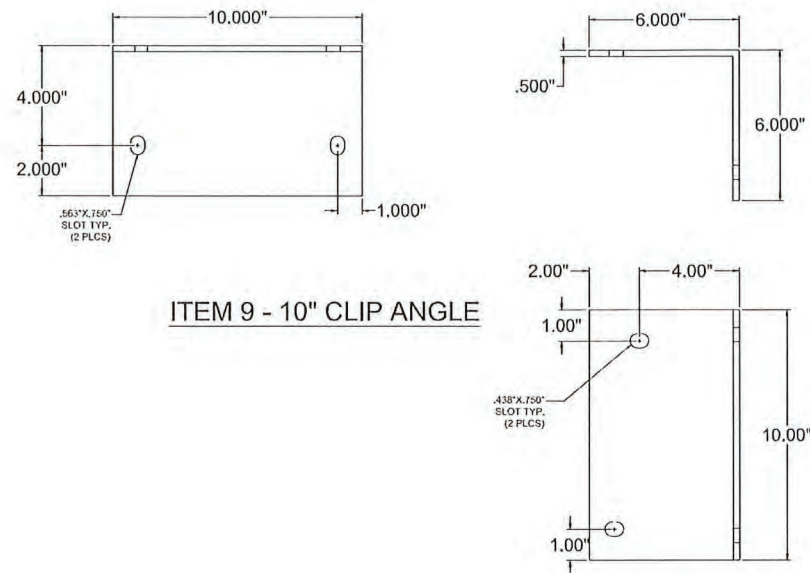

ITEM 9 - 10\"/>

TABLE #2: DRAWING CROSS REFERENCE

ITEM	DRAWING	MATERIAL	DESCRIPTION	RUSKIN #
1	60-022208-00D	3003-H14 AL	HEAD, JAMB AND SILL FRAMES	70-020440-00B
2	60-022208-00D	3003-H14 AL	INTERIOR TOP BLADE	70-020514-00B
3	60-022208-00D	3003-H14 AL	EXTERIOR BLADE	70-020099-00B
4	60-022208-00D	3003-H14 AL	SILL PIECE	70-020446-00B
5	60-022208-00D	6063-T6 AL	MULLION SUPPORT ANGLE	70-024276-00B
6	60-022208-00D	6063-T6 AL	2\"	70-023522-00B
7	60-022208-00D	6063-T6 AL	2\"	85-022012-00B
8	60-022208-00D	6063-T6 AL	2\"	-
9	60-022208-00D	A36 STEEL	6\"	-
10	60-022208-00D	6063-T6 AL	6\"	-

TABLE #1: APPROVED ATTACHMENTS FOR JAMB CLIPS

MIN. SUPPORT MAT'L	TYPE CONNECTION	ANGLE SLOT WIDTH	MAX SPACING	MIN EMBEDMENT	MIN EDGE
(12 GA MIN) STEEL	3/8\"	9/16\"	12\" C-C MAX.	N/A	1\"
(6\" MIN) CONCRETE	3/8\"	9/16\"	12\" C-C MAX.	2\"	3\"
(8\" CMU) GROUT FILLED MASONRY	1/4\"	9/16\"	12\" C-C MAX.	1 5/8\"	4\"
(2) 2 X - WOOD	1/2\"	9/16\"	12\" C-C MAX.	3\"	2 1/2\"

NOTE: ALL FASTENERS MUST BE INSTALLED PER THE MANUFACTURER'S FLORIDA / DADE COUNTY APPROVED INSTALLATION INSTRUCTIONS

FOR OFFICE USE ONLY

**PRODUCT REVISED**  
as complying with the Florida  
Building Code  
NOA-No. 23-1116.06  
Expiration Date 11/08/2027  
By *[Signature]*  
Miami-Dade Product Control

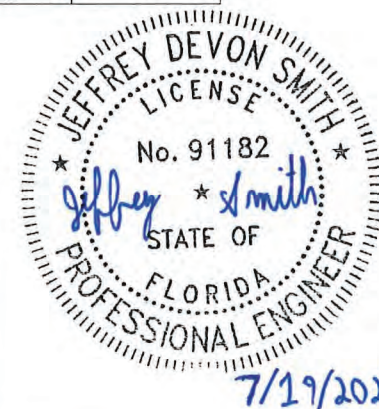

ENGINEER OF RECORD:  
JEFFREY DEVON SMITH  
ENGINEERING DISCIPLINE:  
CIVIL - STRUCTURAL  
STATE OF FLORIDA 91182

C		REVISED FOR EASE OF INSTALLATION		07/01/22	RVT	JDS	JDS
B		REVISED ENGINEER OF RECORD		07/09/13	RKP	DJR	DJR
REV.		DESCRIPTION		DATE	REV'D BY	CHK'D BY	APP'D BY
TOLERANCES UNLESS SPECIFIED OTHERWISE		NOTE:		1) ALL DIMENSIONS ARE GIVEN IN INCHES.			
3 PLACE .XXX ±.010		2) ALL EXPOSED SURFACES MUST BE FREE OF DIE LINES.		3) ALUMINUM ASSOCIATION TOLERANCES APPLY UNLESS OTHERWISE SPECIFIED.			
2 PLACE .XX ±.020		4) ** EXTRUDER SPECIFIC ID MARK: .008R x .008DP					
ANGLE DIMENSIONS ± 2°							
USE WIC-007 & 008							
CTR CENTER		OC ON CENTER					
CL CENTER LINE		OD OUTSIDE DIAMETER					
C-C CENTER TO CENTER		OR OUTSIDE RADIUS					
CHAM CHAMFER		PI POINT OF INTERSECTION					
DAT DATUM		R FULL RADIUS					
DET DETAIL		REF REFERENCE					
E-E END TO END		SYM SYMMETRICAL					
EXP EXPOSED		TAN TANGENT					
ID INSIDE DIAMETER		TYP TYPICAL					
IR INSIDE RADIUS							
<h1>RUSKIN</h1>							
3900 DR. GREAVES RD GRANDVIEW, MO 64030 PH: (816) 761-7476 FAX: (816) 763-8102							
AREA		EST. PER.		EST. WT/FT.			
-		-		-			
ALLOY & TEMPER		UNSPEC. RADII		UNSPEC. WALL			
-		-		-			
DWN:	WJM	CHK:		APPV:			
DATE:	07/19/10	DATE:		DATE:			
PART DESC.							
ACL1245AFD LOUVER PART DETAILS							
SCALE: NTS		ECN: -		DATE:			
DWG No.		Drawing 6 of 6					
60		022208		-05D			

THIS INFORMATION DISCLOSED HEREIN WAS ORIGINATED BY AND IS THE PROPERTY OF RUSKIN INDUSTRIES, AND EXCEPT FOR USES EXPRESSLY GRANTED TO THE UNITED STATES GOVERNMENT, RUSKIN INDUSTRIES RESERVES ALL PATENT, PROPRIETARY, DESIGN, USE, SALE, MANUFACTURING AND REPRODUCTION RIGHTS THERE TO. THIS DOES NOT APPLY TO ANY VENDOR PARTS.