



DEPARTMENT OF REGULATORY AND ECONOMIC RESOURCES (RER)  
BOARD AND CODE ADMINISTRATION DIVISION  
**NOTICE OF ACCEPTANCE (NOA)**

**Gensteel Doors Inc.**  
**4950 Hickmore Street**  
**Ville St. Laurent, Quebec, Canada H4T1K6**

**SCOPE:**

This NOA is being issued under the applicable rules and regulations governing the use of construction materials. The documentation submitted has been reviewed and accepted by Miami-Dade County RER -Product Control Section to be used in Miami Dade County and other areas were allowed by the Authority Having Jurisdiction (AHJ).

This NOA shall not be valid after the expiration date stated below. The Miami-Dade County Product Control Section (In Miami Dade County) and/or the AHJ (in areas other than Miami Dade County) reserve the right to have this product or material tested for quality assurance purposes. If this product or material fails to perform in the accepted manner, the manufacturer will incur the expense of such testing and the AHJ may immediately revoke, modify, or suspend the use of such product or material within their jurisdiction. RER reserves the right to revoke this acceptance, if it is determined by Miami-Dade County Product Control Section that this product or material fails to meet the requirements of the applicable building code.

This product is approved as described herein and has been designed to comply with the Florida Building Code, including the High Velocity Hurricane Zone.

**DESCRIPTION: Series "GenStorm" Flush Single Outswing Steel Doors**

**APPROVAL DOCUMENT:** Drawing No. **AD10-02**, titled "Genstorm Outswing Steel Door System (LMI)", sheet 1 through 7 of 7, dated 02-10-11 and last revised on 01/28/2024, prepared by manufacturer, signed and sealed by Gordan D. Thomas, P.E., bearing the Miami-Dade County Product Control Revision stamp with the Notice of Acceptance number and expiration date by the Miami-Dade County Product Control Section.

**MISSILE IMPACT RATING: Large Missile Impact Resistant**

**Limitations:**

1. See Design Pressures & corresponding Hardware in sheet **5**. Max. Exterior (positive) DP= **+65**, where water infiltration requirement is needed.
2. Options **#1, 2 & #4** require total two (2) flush bolts (top/bottom) on active panel.

**LABELING:** Each unit shall bear one of the following permanent labels:

Gensteel Doors Inc.	Gensteel Doors Inc.	Gensteel Doors USA
4950 Hickmore Street	2335 Industrial Park Drive	1551 Fairground Road
Ville St. Laurent, Quebec, Canada H4T1K6	Cornwall, Ontario, Canada K6H7M4	Madison, Georgia USA 30650

and series and the statement: "Miami-Dade County Product Control Approved".

**RENEWAL** of this NOA shall be considered after a renewal application has been filed and there has been no change in the applicable building code negatively affecting the performance of this product.

**TERMINATION** of this NOA will occur after the expiration date or if there has been a revision or change in the materials, use, and/or manufacture of the product or process. Misuse of this NOA as an endorsement of any product, for sales, advertising or any other purposes shall automatically terminate this NOA. Failure to comply with any section of this NOA shall be cause for termination and removal of NOA.

**ADVERTISEMENT:** The NOA number preceded by the words Miami-Dade County, Florida, and followed by the expiration date may be displayed in advertising literature. If any portion of the NOA is displayed, then it shall be done in its entirety.

**INSPECTION:** A copy of this entire NOA shall be provided to the user by the manufacturer or its distributors and shall be available for inspection at the job site at the request of the Building Official.

This NOA **revises NOA #20-1230.10** and consists of this page 1 and evidence pages E-1, E-2, E-3 and E-4, as well as approval document mentioned above.

The submitted documentation was reviewed by **Ishaq I. Chanda, P.E.**

*Ishaq I. Chanda*

**NOA No. 23-1207.12**  
**Expiration Date: July 14, 2025**  
**Approval Date: March 14, 2024**  
**Page 1**

**NOTICE OF ACCEPTANCE: EVIDENCE SUBMITTED**

- 1. Evidence submitted under previous files**
- A. DRAWINGS**
  1. Manufacturer's die drawings and sections (submitted under file listed below)
  2. Drawing No. **AD10-02**, titled "Genstorm Outswing Steel Door System (LMI)", sheet 1 through 7 of 7, dated 02-10-11 and last revised on AUG 21, 2015, prepared by MCY Engineering, Inc., signed and sealed by Yiping Wang, P.E.
- B. TESTS (submitted under files #12-0223.35 /#10-1203.03/#05-0127.11)**
  1. Test reports on 1) Uniform Static Air Pressure Test, Loading per FBC, TAS 202-94  
2) Water Resistance Test, per FBC, TAS 202-94 (PMK 2005-AT)  
Along with marked-up drawings and installation diagram of Genstorm Opaque Double Swinging Doors, prepared by Fenestration Testing Laboratory, Inc., Test Report No. **FTL 6346**, dated 10/14/10, signed and sealed by Jorge A. Causo, P.E.
  2. Test reports on 1) Air Infiltration Test, per FBC, TAS 202-94  
2) Uniform Static Air Pressure Test, Loading per FBC, TAS 202-94  
3) Water Resistance Test, per FBC, TAS 202-94(PMK177T threshold)  
4) Large Missile Impact Test per FBC, TAS 201-94  
5) Cyclic Wind Pressure Loading per FBC, TAS 203-94  
6) Forced Entry Test, per FBC 2411 3.2.1 and TAS 202-94  
7) Tensile test per FBC, TAS 202  
Along with marked-up drawings and installation diagram of Genstorm Opaque, Glazed and Louvered Single and Double Swinging Doors, prepared by Fenestration Testing Laboratory, Inc., Test Report No. **FTL 5877**, dated 10/13/09 and **FTL 5898**, dated 09/14/09, both signed and sealed by Julio E. Gonzalez, P.E. (transferred from file # **10-0125.01**)
  3. Additional Test reports per FBC TAS 201, 202 and 203-94, test report No. **ITS-3058370-DOUBLE**, dated 12/09/04 for Double Outswing Honeycomb Steel Door System, prepared by Intertek Testing Services, sealed and signed by Stephen J. Emerman, P. E. (**# 05-0127.11**).
- C. CALCULATIONS**
  1. Anchor verification calculations and structural analysis, complying with FBC-2014(5<sup>th</sup> Edition), prepared by MCY Engineering, Inc, dated 08/21/15, signed and sealed by Yiping Wang, P.E.
- D. QUALITY ASSURANCE**
  1. Miami Dade Department of Regulatory and Economic Resources (RER).
- E. MATERIAL CERTIFICATIONS**
  1. Tensile Test, per ASTM A370-05 item B (1) (7)
  2. Tensile test report N0. FTL 5877 per ASTM A370-05 dated 10/13/09, issued by Fenestration Testing Lab, signed and sealed by Julio Gonzales, P.E. (submitted under file # **10-1203.02**).
- F. STATEMENTS**
  1. Statement letter of conformance to FBC 2014 (5<sup>th</sup> Edition), dated 08/20/15, prepared by MCY Engineering, Inc, signed and sealed by Yiping Wang, P.E.
  2. Statement letter of Lab. Compliance, as a part of above test reports.
- G. OTHER**
  1. This NOA **revises & renews # 12-0223.35**, expired on 07/14/15.
  2. Test proposal No. **08-1489**, issued to Gensteel Door Inc, approved on 11/14/08.
  3. Distribution agreement between GenSteel Door, Canada & North American Door Corp, N.Y.

dated 10/22/10, signed by Bruno Gervasi & Antonio Gervasi, respectively.

*Ishaq I. Chanda*

**Ishaq I. Chanda, P.E.**  
**Product Control Unit Supervisor**  
**NOA No. 23-1207.12**  
**Expiration Date: July 14, 2025**  
**Approval Date: March 14, 2024**

**NOTICE OF ACCEPTANCE: EVIDENCE SUBMITTED**

**2. Evidence submitted under previous NOA**

**A. DRAWINGS**

1. Drawing No. **AD10-02**, titled “Genstorm Outswing Steel Door System (LMI)”, sheet 1 through 7 of 7, dated 02-10-11 and last revised on JAN 02, 2018, prepared by MCY Engineering, Inc., signed and sealed by Yiping Wang, P.E.

**B. Test**

1. None.

**C. CALCULATIONS**

1. None.

**D. QUALITY ASSURANCE**

1. Miami Dade Department of Regulatory and Economic Resources (RER).

**E. MATERIAL CERTIFICATIONS**

1. None.

**F. STATEMENTS**

1. Statement letter of conformance to FBC 2017 (6<sup>th</sup> Edition), dated 01/02/18, prepared by MCY Engineering, Inc., signed and sealed by Yiping Wang, P.E.

**G. OTHER**

1. This NOA **revises # 15-0825.03**, expiring 07/14/21.

**3. Evidence submitted under previous approval**

**A. DRAWINGS**

1. Drawing No. **AD10-02**, titled “Genstorm Outswing Steel Door System (LMI)”, sheet 1 through 7 of 7, dated 02-10-11 and last revised on JAN 02, 2018, prepared by MCY Engineering, Inc., signed and sealed by Yiping Wang, P.E.

**B. Test**

1. None.

**C. CALCULATIONS**

1. None.

**D. QUALITY ASSURANCE**

1. Miami Dade Department of Regulatory and Economic Resources (RER).

**E. MATERIAL CERTIFICATIONS**

1. None.

**F. STATEMENTS**

2. Statement letter of conformance to FBC 2017 (6<sup>th</sup> Edition), dated 01/02/18, prepared by MCY Engineering, Inc., signed and sealed by Yiping Wang, P.E.

**G. OTHER**

1. This NOA **renews # 18-0116.17**, expiring 07/14/25.

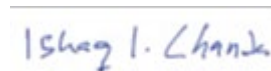

---

**Ishaq I. Chanda, P.E.**  
**Product Control Unit Supervisor**  
**NOA No. 23-1207.12**  
**Expiration Date: July 14, 2025**  
**Approval Date: March 14, 2024**

**NOTICE OF ACCEPTANCE: EVIDENCE SUBMITTED**

**4. Evidence submitted under previous approval**

**A. DRAWINGS**

1. Drawing No. **AD10-02**, titled “Genstorm Outswing Steel Door System (LMI)”, sheet 1 through 7 of 7, dated 02-10-11 and last revised on December 24, 2020, prepared by MCY Engineering, Inc., signed and sealed by Yiping Wang, P.E.

**B. Test**

1. None.

**C. CALCULATIONS**

1. Anchor verification calculations and structural analysis, complying with FBC-2020 (7<sup>th</sup> Edition), prepared by MCY Engineering, Inc., dated 12/14/20, signed and sealed by Yiping Wang, P.E.

**D. QUALITY ASSURANCE**

1. Miami Dade Department of Regulatory and Economic Resources (RER).

**E. MATERIAL CERTIFICATIONS**

1. None.

**F. STATEMENTS**

1. Statement letter of conformance to FBC 2020 (7<sup>th</sup> Edition), dated 12/24/20, prepared by MCY Engineering, Inc., signed and sealed by Yiping Wang, P.E.
2. Distribution agreement dated JAN 26, 2021 between Gensteel Doors, Inc., Canada & North American Door Corp, N.Y. (dba Gensteel Doors, LLC, USA), signed by Bruno Gervasi, VP manufacturing and Antonio Gervasi, President, respectively on behalf of their companies.

**G. OTHER**

1. This NOA revises # **20-0312.04**, expiring 07/14/25.

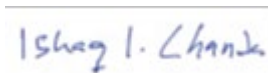

---

**Ishaq I. Chanda, P.E.**  
**Product Control Unit Supervisor**  
**NOA No. 23-1207.12**  
**Expiration Date: July 14, 2025**  
**Approval Date: March 14, 2024**

**NOTICE OF ACCEPTANCE: EVIDENCE SUBMITTED**

**4. New Evidence submitted**

**A. DRAWINGS**

1. Drawing No. **AD10-02**, titled “Genstorm Outswing Steel Door System (LMI)”, sheet 1 through 7 of 7, dated 02-10-11 and last revised on 01/28/2024, prepared by manufacturer, signed and sealed by Gordan D. Thomas, P.E.

**B. Test**

1. None.

**C. CALCULATIONS (submitted under pervious approval)**

1. None.

**D. QUALITY ASSURANCE**

1. Miami Dade Department of Regulatory and Economic Resources (RER).

**E. MATERIAL CERTIFICATIONS**

1. None

**F. STATEMENTS (item # 5 was submitted under previous submittal)**

1. Statement letter of conformance to FBC 2023(8<sup>th</sup> Edition) dated 1/28/24, prepared, signed and sealed by Gordon D. Thomas, P.E.
2. Successor Engineer Statement letter of adopting another Engineer’s work dated 12/14/23 per FLA Administrative rule 61G15.27.001 and taking full responsibility, prepared, signed and sealed by Gordon D. Thomas, P.E.
3. Statement letter of “No financial interest to the testing Lab” dated 12/14/23, prepared, signed and sealed by Gordon D. Thomas, P.E.
4. Statement letter, no changes other than title block, prepared, signed and sealed by Gordon D. Thomas, P.E.
5. Distribution agreement dated JAN 26, 2021 between Gensteel Doors, Inc., Canada & North American Door Corp, N.Y. (dba Gensteel Doors, LLC, USA), signed by Bruno Gervasi, VP manufacturing and Antonio Gervasi, President, respectively on behalf of their companies.

**G. OTHER**

1. This NOA revises # **20-1230.10**, updates to FBC 2023, expiring 07/14/25.

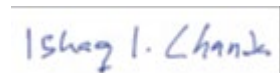

---

**Ishaq I. Chanda, P.E.**  
**Product Control Unit Supervisor**  
**NOA No. 23-1207.12**  
**Expiration Date: July 14, 2025**  
**Approval Date: March 14, 2024**

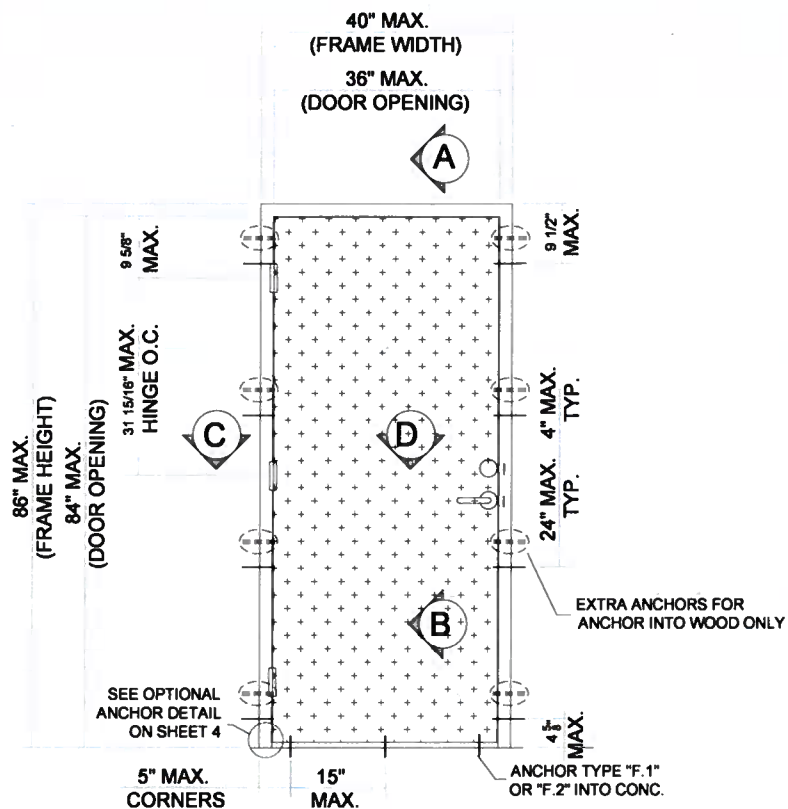

**SINGLE DOOR TYP. EXT. ELEVATION**

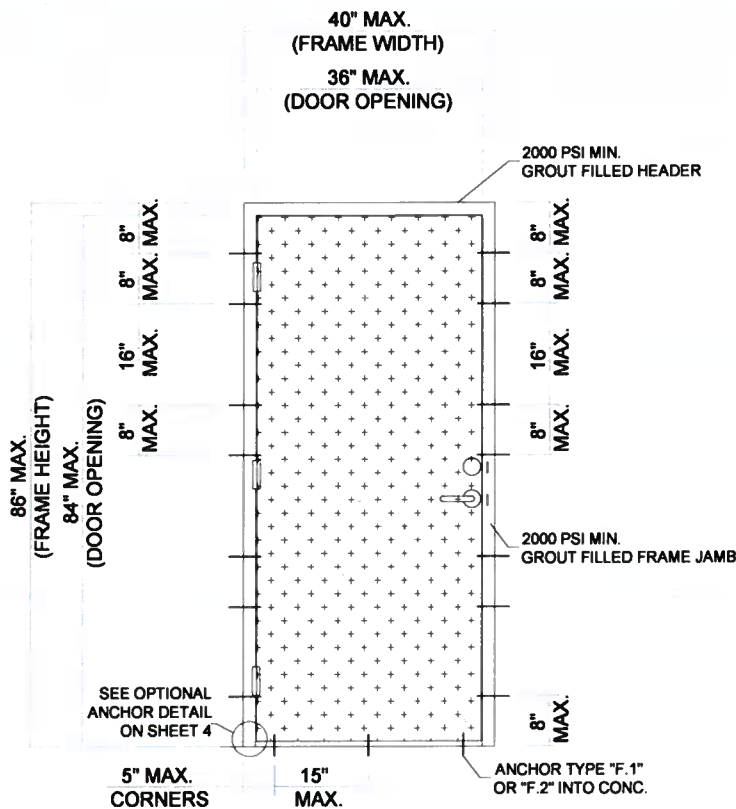

**ANCHOR LAYOUT  
(FOR WIRE ANCHOR ONLY)**

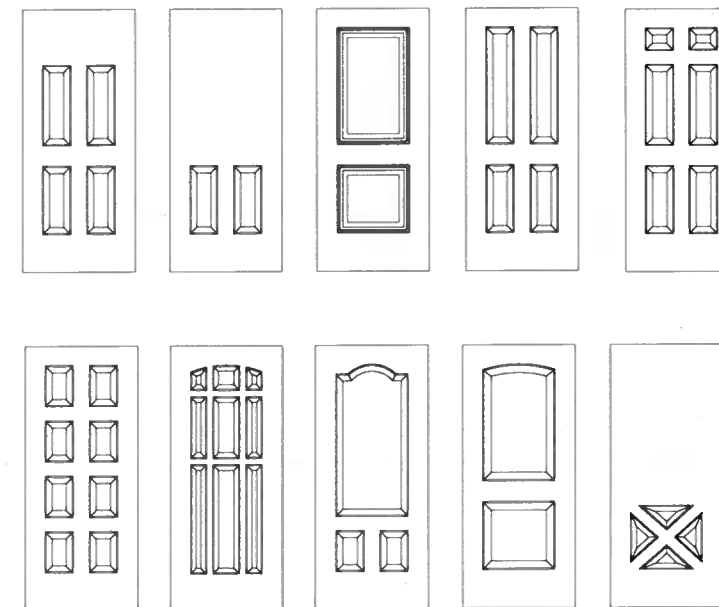

**OPTIONAL EMBOSSED DOOR LEAF PATTERNS:**

**DESIGN LOAD**  
(FOR SIZES SHOWN ABOVE OR SMALLER  
AS PERMITTED BY FBC)  
SEE SHEET 5 OF 7

**SERIES GENSTORM OPAQUE OUTSWING STEEL DOOR (LMI)**

- THIS PRODUCT HAS BEEN DESIGNED AND TESTED TO COMPLY WITH THE REQUIREMENTS OF THE 8TH EDITION FLORIDA BUILDING CODE (2023) INCLUDING HIGH VELOCITY HURRICANE ZONE (HVHZ).
- DOORS RATED FOR LARGE MISSILE IMPACT AND DO NOT REQUIRE SHUTTERS.
- DOORS APPROVED FOR INSTALLATIONS WHERE WATER INFILTRATION RESISTANCE IS OR IS NOT REQUIRED. (SINGLE ROW SELF ADHESIVE CLOSED CELL FOAM TAPE TO BE APPLIED ENTIRE PERIMETER OF FRAME).
- ANCHORS SHALL BE AS LISTED, SPACED AS SHOWN ON DETAILS. ANCHORS EMBEDMENT TO BASE MATERIAL SHALL BE BEYOND WALL DRESSING OR STUCCO.
- ANCHORING OR LOADING CONDITIONS NOT SHOWN IN THESE DETAILS ARE NOT PART OF THIS APPROVAL.
- MATERIALS INCLUDING BUT NOT LIMITED TO STEEL/METAL SCREWS THAT COME INTO CONTACT WITH OTHER DISSIMILAR MATERIALS SHALL MEET THE REQUIREMENTS OF THE 8TH EDITION FLORIDA BUILDING CODE (2023) SECTION AS APPLICABLE.
- METAL STRUCTURES NOT BY GENSTEEL DOOR CO. MUST SUPPORT LOADS IMPOSED BY DOOR SYSTEM AND TRANSFER THEM TO THE BUILDING STRUCTURE.

- ULTIMATE DESIGN LOAD OBTAINED FROM ASCE 7-16, MULTIPLY BY 0.6, SHALL BE LESS THAN OR EQUAL TO MAX. DESIGN LOAD IN THIS DOCUMENT.
- 2 X WOOD BUCKS BY OTHERS MUST BE ANCHORED PROPERLY TO TRANSFER LOADS TO THE STRUCTURE.
- A LOAD DURATION FACTOR IN ALLOWABLE STRESS IS USED IN DESIGN OF ANCHORS INTO WOOD ONLY.
- DOOR PANEL: MIN. 20 GA. (0.039") STEEL MIN.  $F_y = 42$  KSI MIN.,  $F_u = 53$  KSI MIN.  
DOOR FRAME: MIN. 18 GA. (0.048") STEEL MIN.  $F_y = 48$  KSI MIN.,  $F_u = 53$  KSI MIN.
- DOOR PANEL STAINLESS OPTION: 20 GA. (0.039") STAINLESS STEEL DOOR PANEL MEETING MIN.  $F_y = 42$  KSI,  $F_u = 53$  KSI MIN. OR BETTER MAY QUALIFY HAVING "MIL-CERTIFICATE" AS A VERIFICATION OF THE AVAILABLE MIN. YIELD STRENGTH.
- DOOR FRAME STAINLESS OPTION: 18 GA. (0.048") STAINLESS STEEL DOOR FRAME MEETING MIN  $F_y = 48$  KSI,  $F_u = 53$  KSI MIN. OR BETTER MAY QUALIFY HAVING "MIL-CERTIFICATE" AS A VERIFICATION OF THE AVAILABLE MIN. YIELD STRENGTH.

**NOTES:**  
EGRESS REQUIREMENTS TO BE REVIEWED BY BUILDING OFFICIAL.

**PRODUCT REVISED**  
as complying with the Florida  
Building Code  
NOA-No. 23-1207.12  
Expiration Date 07/14/2025  
By Ishag I. Chande  
Miami-Dade Product Control

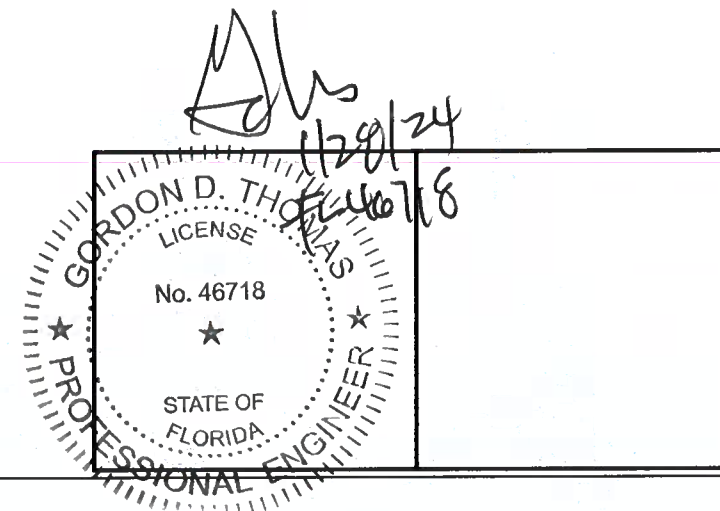

REVISIONS	
NO.	DESCRIPTION

GENSTORM OUTSWING SINGLE DOOR SYSTEM - LMI  
**Gensteel Doors**  
www.gensteeldoors.com  
4950 Hickmore, St. Laurent, Quebec, Canada, H4T1K6  
Tel: (514) 733-3562 Fax: (514) 733-1932

DATE	10/20/2023
SCALE	NTS.
DRAWN	
PROJECT	

DRAWING NO.  
AD10-02

SHEET 1 OF 7

APPROVED  
SEALANT/CAULKING  
TO BE APPLIED  
AS NEEDED

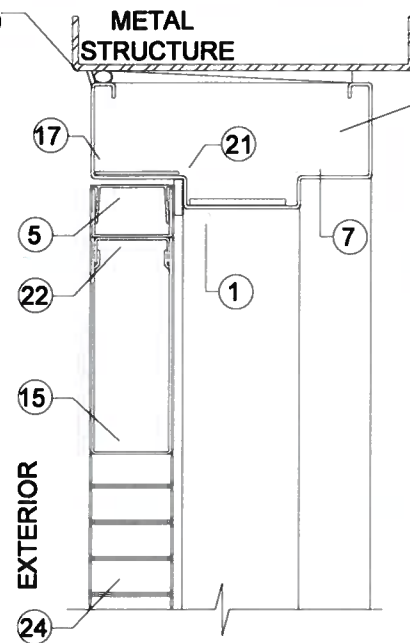

HEAD DETAIL

A

NOTE: HEADER TO BE 2000  
PSI MIN. GROUT FILLED  
WHEN WIRE ANCHORS ARE  
USED AT JAMBS

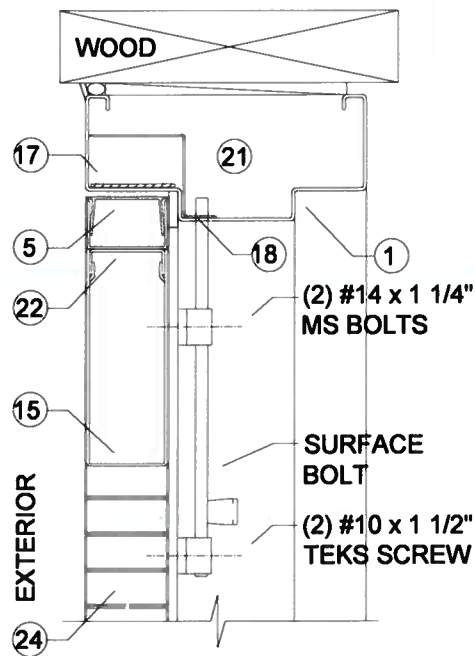

HEAD DETAIL

A

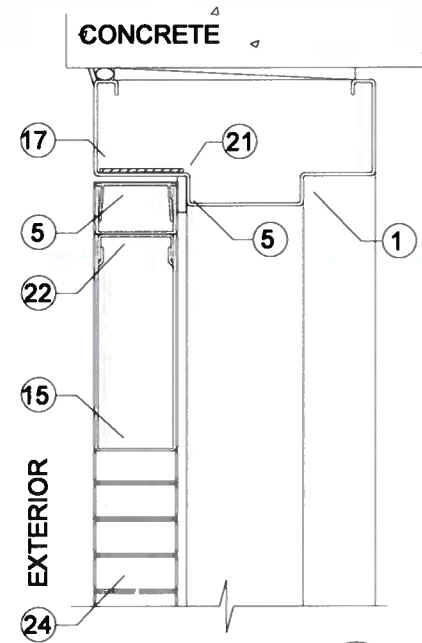

HEAD DETAIL

A

**PRODUCT REVISED**  
as complying with the Florida  
Building Code  
NOA-No. 23-1207.12

Expiration Date 07/14/2025

By Ishag I. Chank  
Miami-Dade Product Control

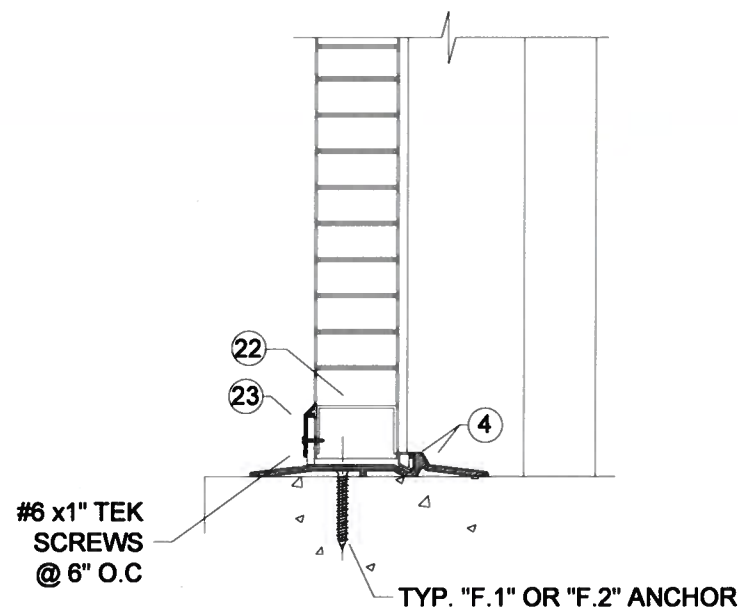

OPTIONAL THRESHOLD

B

APPR'D FOR WATER  
RESISTANCE

TYPICAL ANCHORS @ THRESHOLD:

- TYPE F.1** 1/4" DIA. ULTRACON+ BY 'DEWALT' Fy = 148 KSI Fu = 164 KSI  
5/16" DIA. ULTRACONS BY 'DEWALT' Fy = 155 KSI Fu = 177 KSI  
DIRECTLY INTO fc'=3000 PSI MIN. CONCRETE  
1-1/2" MIN. EMBED  
2-1/2" MIN. EDGE DISTANCE
- TYPE F.2** 1/4" TAPCON BY ITW Fy = 90 KSI Fu = 120 KSI  
DIRECTLY INTO fc'=3000 PSI MIN. CONCRETE  
1-1/2" MIN. EMBED  
2-1/2" MIN. EDGE DISTANCE

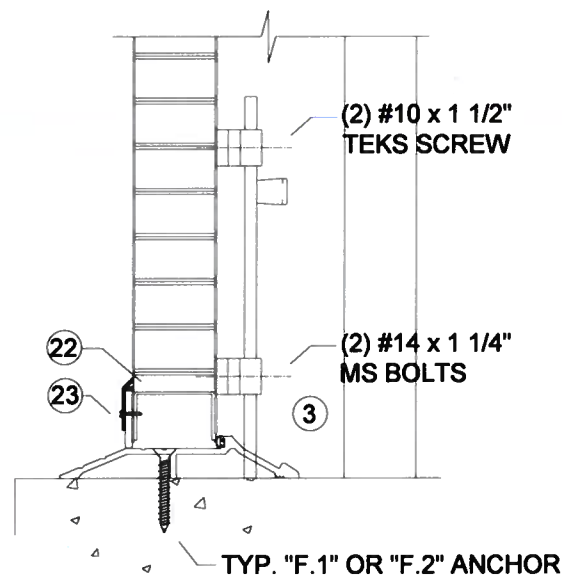

TYPICAL THRESHOLD

B

APPR'D FOR WATER  
RESISTANCE

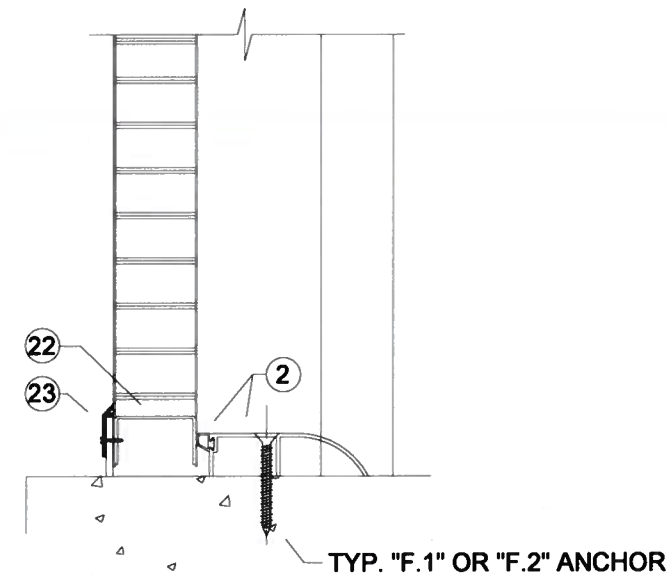

TYPICAL THRESHOLD

B

APPR'D FOR WATER  
RESISTANCE

2-1/2" MIN. EDGE DISTANCE

SEALANT:  
ALL FRAME JOINTS AND CORNERS TO BE SEALED  
WITH SILICONE AT PERIMETER  
ALL SCREWS SEALED WITH GE SILICONE II

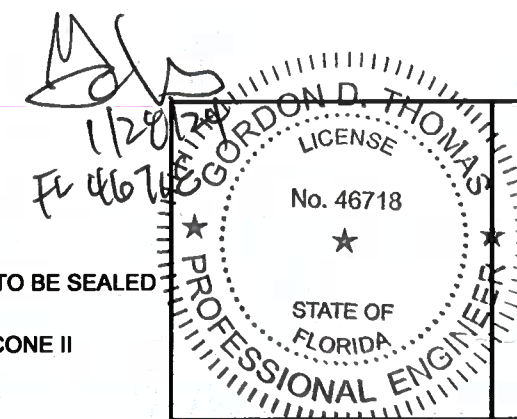

REVISIONS	DESCRIPTION
NO.	DATE

GENSTORM OUTSWING SINGLE DOOR SYSTEM - LMI

**gensteel**

www.gensteeldoors.com

4950 Hickmore, St. Laurent, Quebec, Canada, H4T1K6  
Tel: (514) 733-3562 Fax: (514) 733-1932

DATE	10/20/2023
SCALE	NIS.
DRAWN	
PROJECT	

DRAWING NO.  
AD10-02

SHEET 2 OF 7

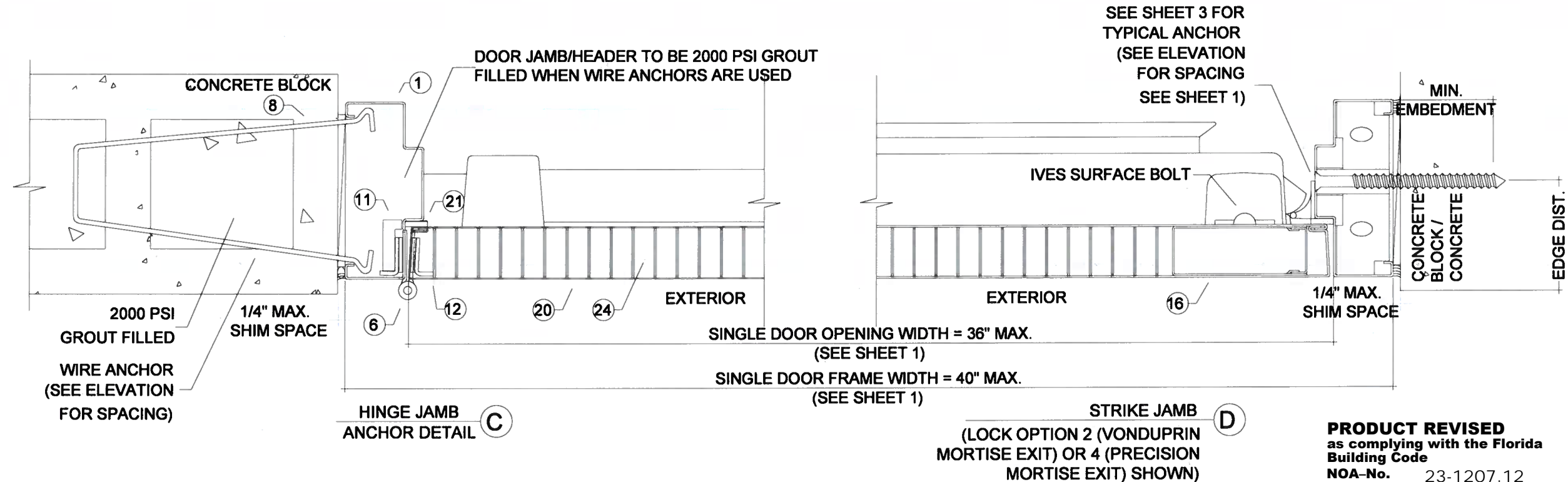

### TYPICAL ANCHORS THRU EMA (EXISTING MASONRY ANCHOR) @ JAMB:

- 5/16" DIA. ULTRACONS BY 'DEWALT'  $F_y=155$  KSI  $F_u = 177$  KSI
- TYPE A.1 DIRECTLY INTO 2BY WOOD BUCK
- TYPE A.2 DIRECTLY INTO  $f_c=3000$  PSI CONCRETE
- 1-1/2" MIN. EMBED
- 2-1/2" MIN. EDGE DISTANCE
- 3/8" DIA. HLC SLEEVE ANCHOR BY 'HILTI'
- TYPE B.1 DIRECTLY INTO  $f_c=3000$  PSI CONCRETE, 3" MIN. EDGE DIST.
- TYPE B.2 DIRECTLY INTO  $f_m=2000$  PSI CONCRETE BLOCK, 3-1/2" MIN. EDGE DIST.
- 1-1/4" MIN. EMBED
- 3/8" DIA. SLEEVE ANCHOR BY 'WEJ-IT'
- TYPE C.1 DIRECTLY INTO  $f_c=4000$  PSI CONCRETE, 2-3/8" MIN. EMBED
- TYPE C.2 DIRECTLY INTO  $f_m=2000$  PSI CONCRETE BLOCK, 1-1/4" MIN. EMBED
- 3-1/2" MIN. EDGE DISTANCE

- TYPE D. 3/8" DIA. POWER BOLT BY 'POWERS' DIRECTLY INTO  $f_c=3000$  PSI CONCRETE
- 2-1/2" MIN. EMBED
- 3" MIN. EDGE DISTANCE
- TYPE E. 5/16" DIA. SMS OR MACHINE BOLTS (MIN. GRADE 2 CRS) OR ST/ST INTO METAL STRUCTURES (STEEL OR ALUMINUM 1/8" MIN. THICK.)
- 5/8" MIN. EDGE DISTANCE
- STEEL :  $F_y = 36$  KSI MIN.
- ALUMINUM : 6063-T6 MIN.
- (STEEL IN CONTACT WITH ALUMINUM TO BE PLATED OR PAINTED)
- TYPE G. WIRE ANCHOR ( $F_y = 60$  KSI) MIN. 10" LONG
- 0.173 DIA. STEEL WIRE ANCHORS EMBED INTO 2000 PSI CONCRETE BLOCK (HEADER/JAMB TO BE GROUTED WITH 2000 PSI CONCRETE)

**PRODUCT REVISED**  
as complying with the Florida  
Building Code  
NOA-No. 23-1207.12  
Expiration Date 07/14/2025  
By Ishag I. Chande  
Miami-Dade Product Control

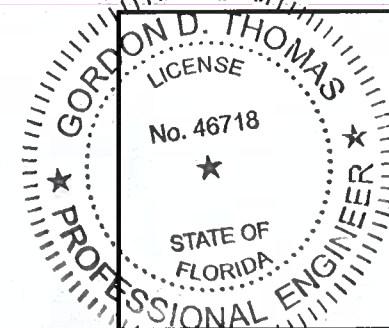

REVISIONS	
NO.	DESCRIPTION

GENSTORM OUTSWING SINGLE DOOR SYSTEM - LMI

**gensteel**

www.gensteeldoors.com

4950 Hickmore, St. Laurent, Quebec, Canada, H4T1K6

Tel: (514) 733-3562 Fax: (514) 733-1932

DATE	10/20/2023
SCALE	N.T.S.
DRAWN	
PROJECT	

DRAWING NO.  
AD10-02

SHEET 3 OF 7

**PRODUCT REVISED**  
as complying with the Florida  
Building Code  
NOA-No. 23-1207.12  
Expiration Date 07/14/2025  
By *Ishag I. Chande*  
Miami-Dade Product Control

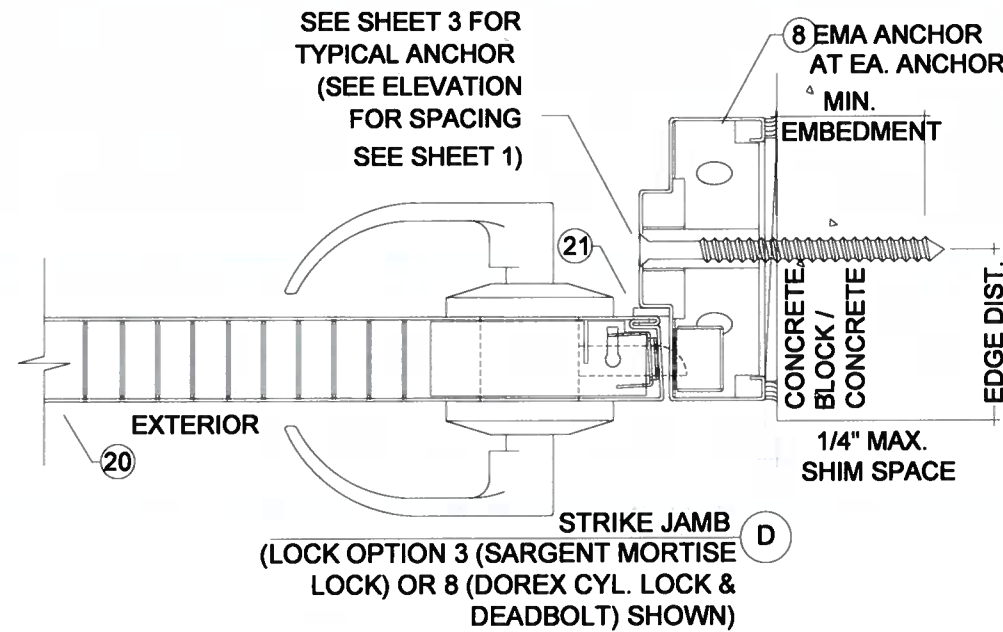
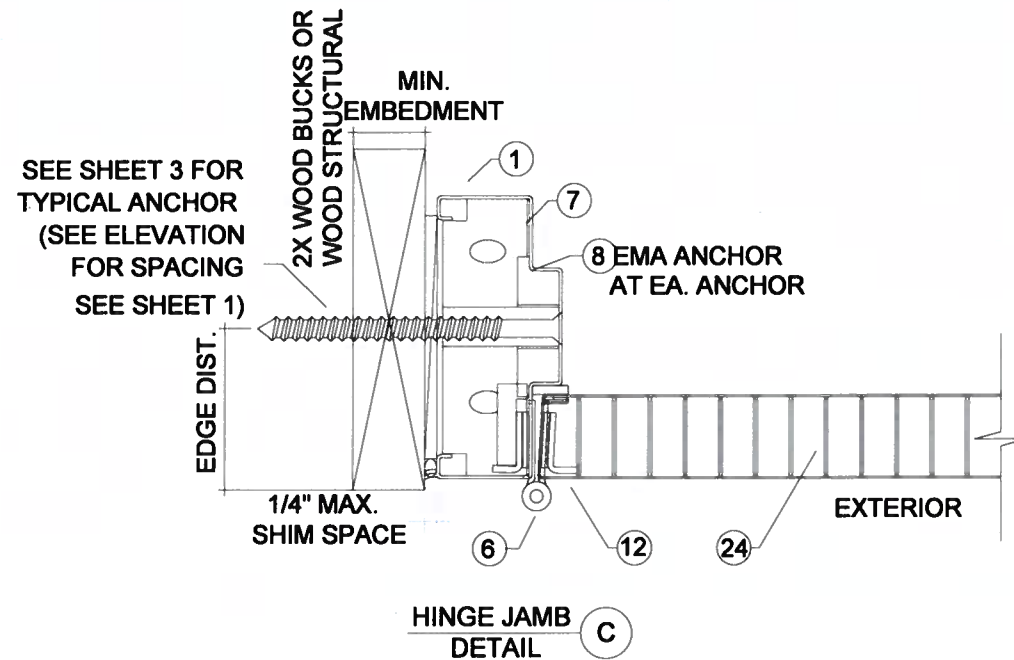

ANCHOR TYPE F.3  
3/16" DIA. ULTRACON+  
(1 1/2" EMBED) 2 1/2" E.D.

9  
1 1/2" x 1 1/2"  
18 GA STEEL  
4 1/2" LG ANGLE

OPTIONAL BOTTOM CORNER ANCHOR DETAIL

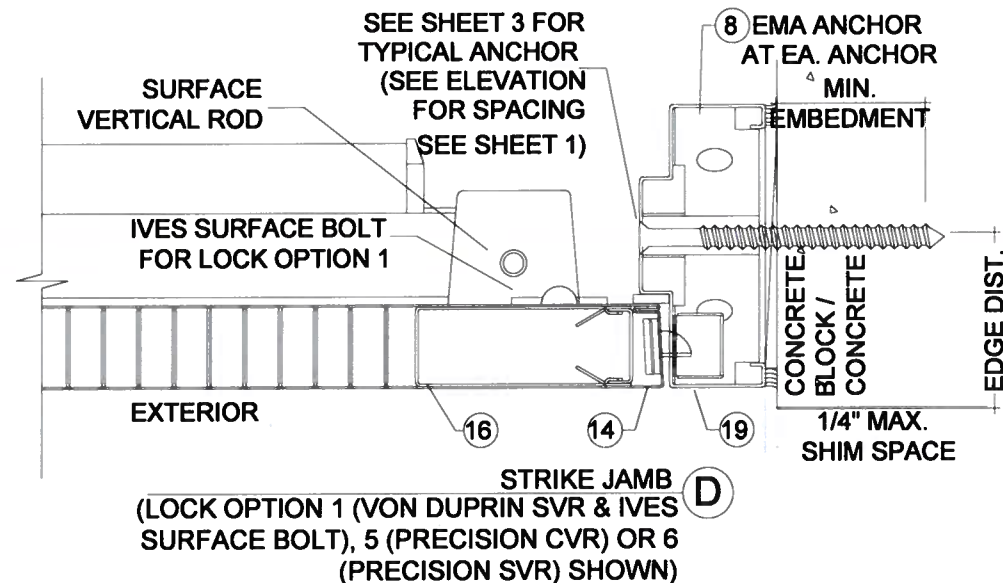
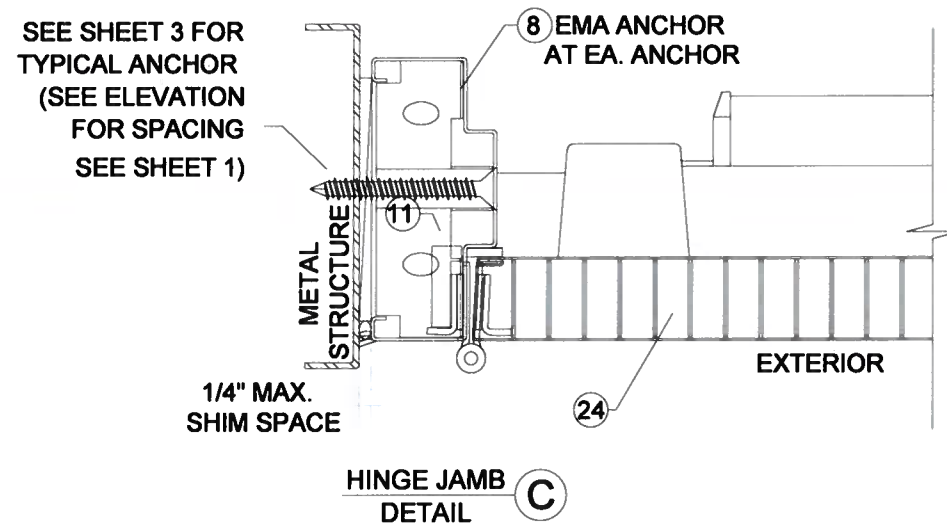

SVR = SURFACE VERTICAL ROD  
CVR = CONCEALED VERTICAL ROD

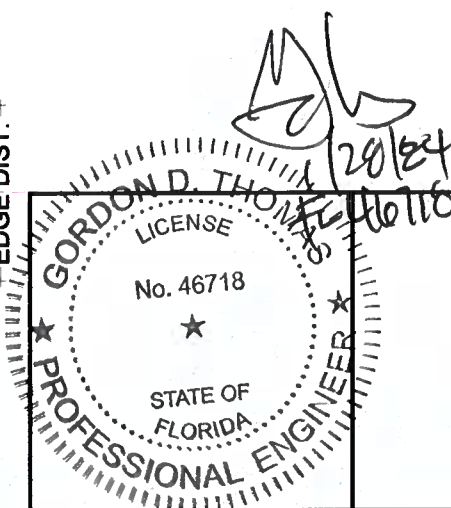
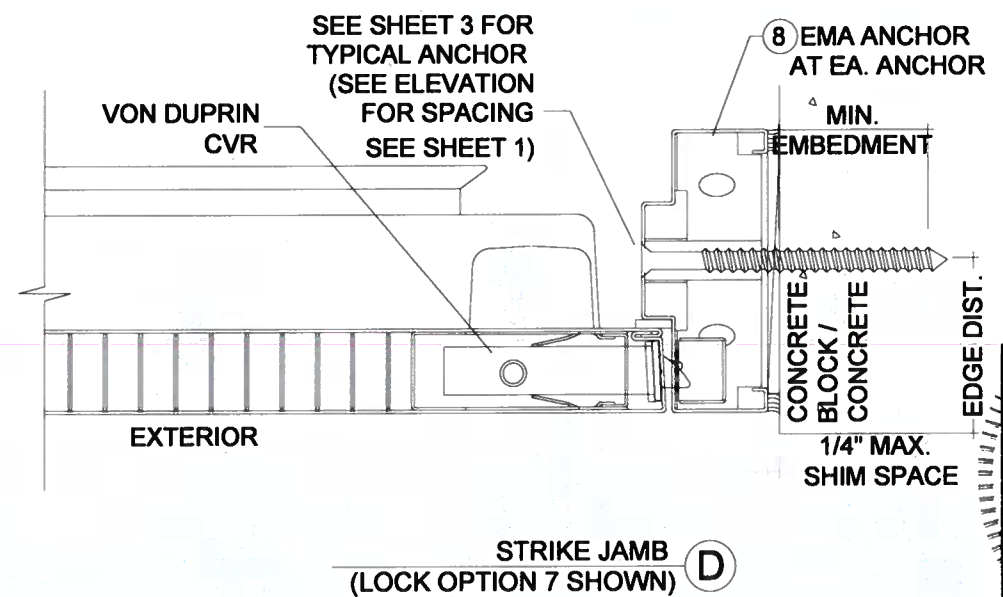
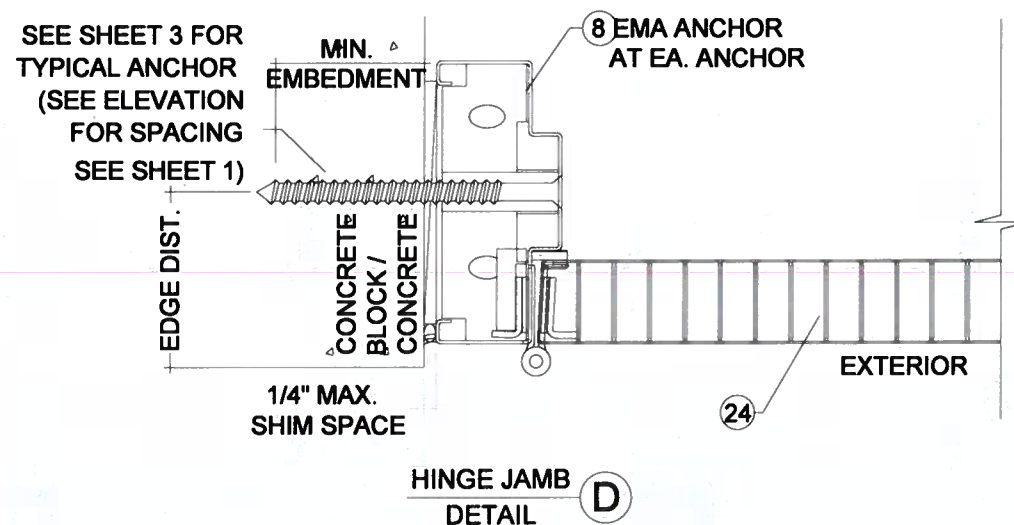

REVISIONS	
NO.	DESCRIPTION

GENSTORM OUTSWING SINGLE DOOR SYSTEM - LMI  
**gensteel**  
www.gensteeldoors.com  
4950 Hickmore, St. Laurent, Quebec, Canada, H4T1K6  
Tel: (514) 733-3562 Fax: (514) 733-1932

DATE	10/20/2023
SCALE	N.T.S.
DRAWN	
PROJECT	

DRAWING NO.  
AD10-02

LOCK OPTIONS

PRODUCT REVISED  
as complying with the Florida  
Building Code  
NOA-No. 23-1207.12  
Expiration Date 07/14/2025  
By Ishag I. Chank  
Miami-Dade Product Control

SINGLE DOOR

HINGES: STEEL MORTISE HINGES 3 PER LEAF.  
LOCATED AT 9 5/8" MAX. FROM TOP OF DOOR TO  
CENTER LINE OF HINGE. AND TO BE SPACED OUT  
31-15/16" MAX. FROM CL TO CL OF HINGE. TO BE  
FASTENED BY #12-24 x 1/2" FLATHEAD MACHINE  
SCREWS.

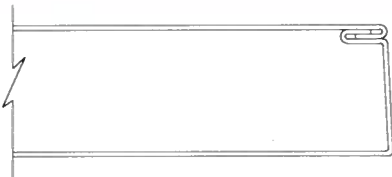

DOOR EDGE CONSTRUCTION

OPTION 1

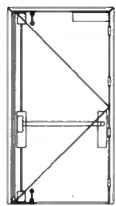

DESIGN LOAD  
+65.0 PSF  
-65.0 PSF

- VON DUPRIN 9847EO SURFACE VERTICAL ROD WITH #229 STRIKE  
USING SIX #9x25mm (1") MACHINE SCREWS AND TWO #14x25mm  
(1") MACHINE SCREWS SEALED WITH  
"GE SILICONE II"  
- "IVES" SB453 SURFACE MOUNT MANUALLY OPERATED FLUSH  
BOLT. TO BE FASTENED WITH (2) 10 x 1-1/2" TEKS SCREW + (2) 14x1  
1-1/4" MS

OPTION 5

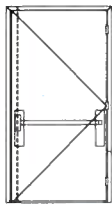

DESIGN LOAD  
+80.0 PSF  
-80.0 PSF

"PRECISION" HC2800 CONCEALED VERTICAL ROD. SURFACE  
MOUNT TWO POINT LOCK SYSTEM WITH "PRECISION" PANIC  
DEVICE WITH (4) 10-24 x 1-1/4". LOCATED 39-1/2" FROM  
BOTTOM  
(2)-SURFACE MOUNT METALLIC STRIKE PLATE AT HEAD TO  
BE FASTENED WITH (2) 1/4-20 FH MS

OPTION 2

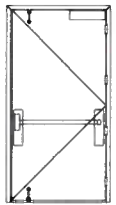

DESIGN LOAD  
+80.0 PSF  
-80.0 PSF

- "VON DUPRIN" 9875EO MORTISE EXIT WITH (2) 8-32 x 3/8" FH MS.  
LOCATED 39-3/4" FROM BOTTOM  
- "IVES" SB453 SURFACE MOUNT MANUALLY OPERATED FLUSH  
BOLT. TO BE FASTENED WITH (2) 10 x 1-1/2" TEKS SCREW + (2) 14x1  
1-1/4" MS

OPTION 6

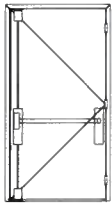

DESIGN LOAD  
+80.0 PSF  
-80.0 PSF

"PRECISION" HC2200 SURFACE VERTICAL ROD.  
(4) 10-24 x 1-1/4" OH MS. LOCATED 39-3/4" FROM BOTTOM

OPTION 3



DESIGN LOAD  
+65.0 PSF  
-65.0 PSF

"SARGENT" 8200 SURFACE MOUNT MORTISE LOCK WITH  
HANDLE. WITH SURFACE MOUNT METALLIC DEAD-BOLT.  
LOCATED 38" FROM BOTTOM WITH (2) 8-32 x 1/4" FH MS

OPTION 7

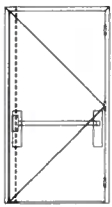

DESIGN LOAD  
+80.0 PSF  
-80.0 PSF

"VON DUPRIN" 9847 CONCEALED VERTICAL ROD WITH PANIC  
DEVICE WITH (2) 8-32 x 3/8" FH MS. LOCATED 39-3/4" FROM  
BOTTOM

OPTION 4

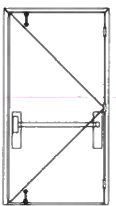

DESIGN LOAD  
+65.0 PSF  
-65.0 PSF

"PRECISION" HC2300 MORTISE PANIC EXIT. SURFACE MOUNT  
MANUALLY OPERATED FLUSH BOLT AT TOP AND BOTTOM.  
WITH (4) 10 x 1-1/4" FH SMS

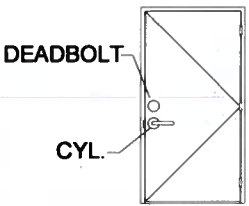

DESIGN LOAD  
+80.0 PSF  
-80.0 PSF

OPTION 8

"DOREX" FC 10 SERIES LEVER LOCK.  
"DOREX" HFA51 DEADBOLT

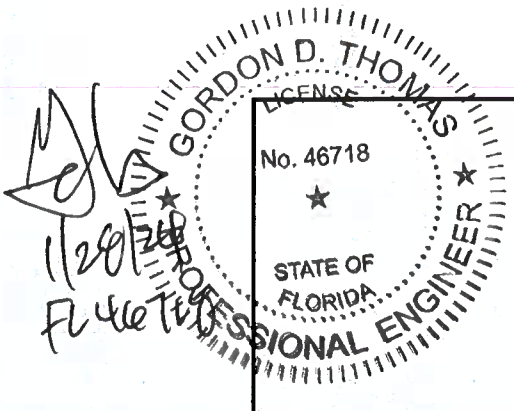

REVISIONS	
NO.	DESCRIPTION

GENSTORM OUTSWING SINGLE DOOR SYSTEM - LMI

**Gensteel**

www.gensteeldoors.com

4950 Hickmore, St. Laurent, Quebec, Canada, H4T1K6  
Tel: (514) 733-3562 Fax: (514) 733-1932

DATE	10/20/2023
SCALE	NTS.
DRAWN	
PROJECT	
DRAWING NO.	
AD10-02	
SHEET 5 OF 7	

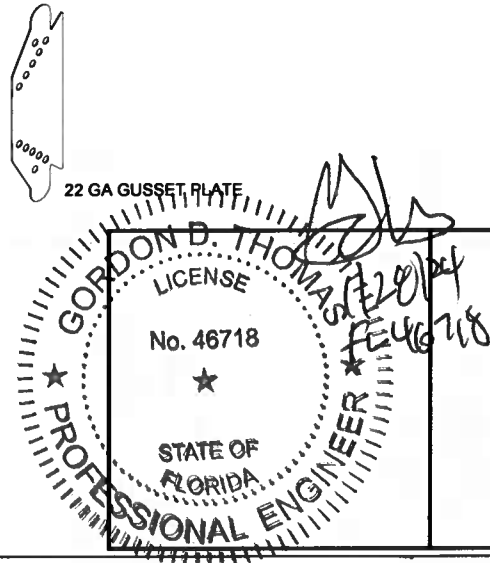
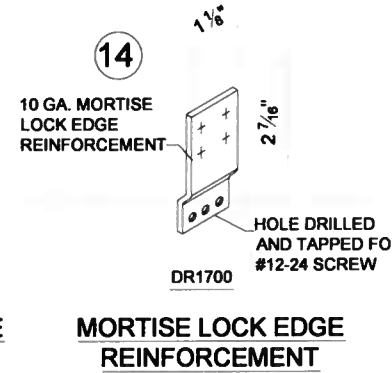
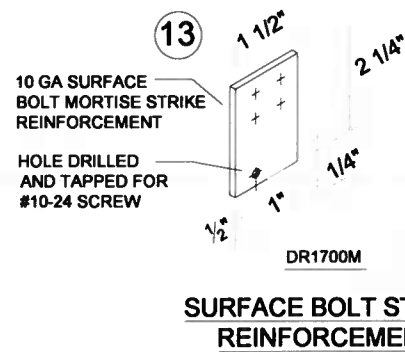
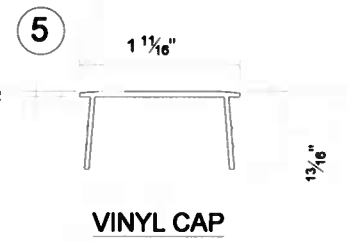
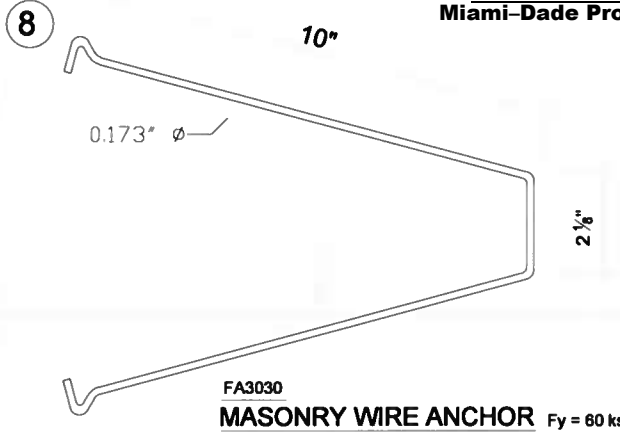
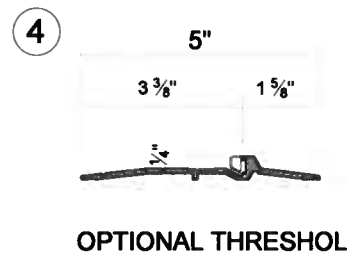
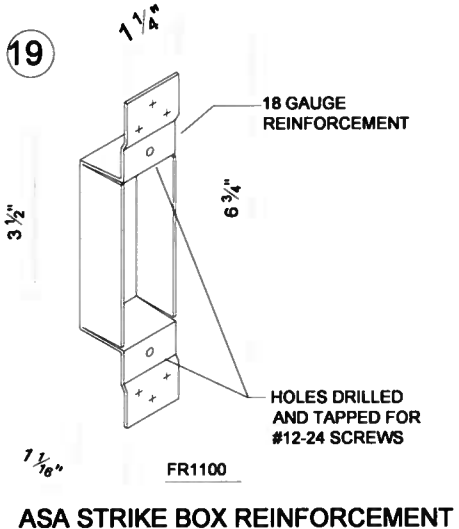
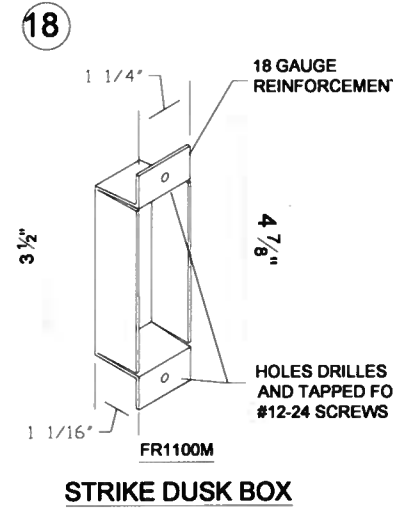
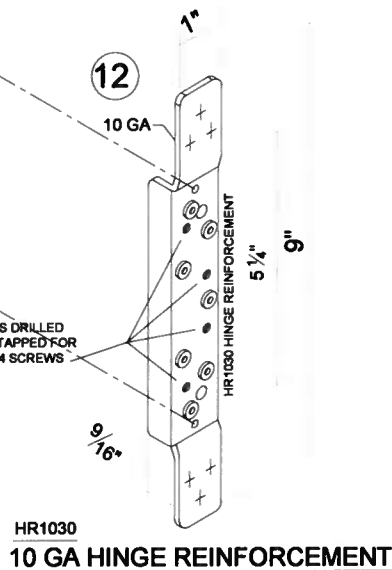
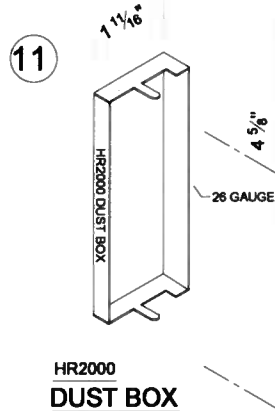
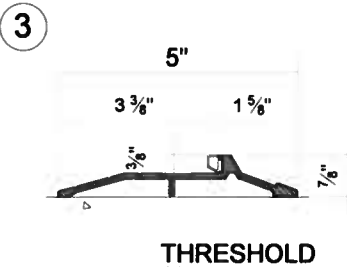
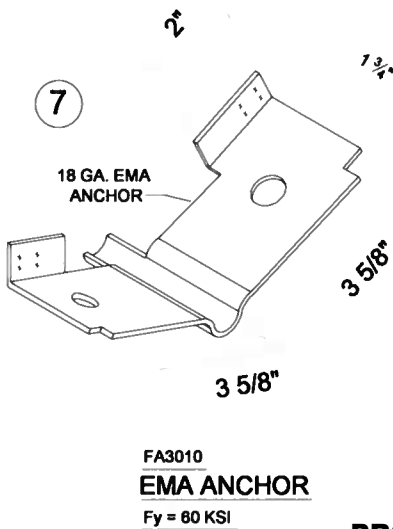
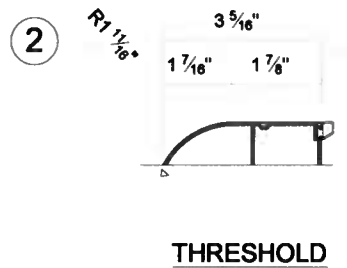
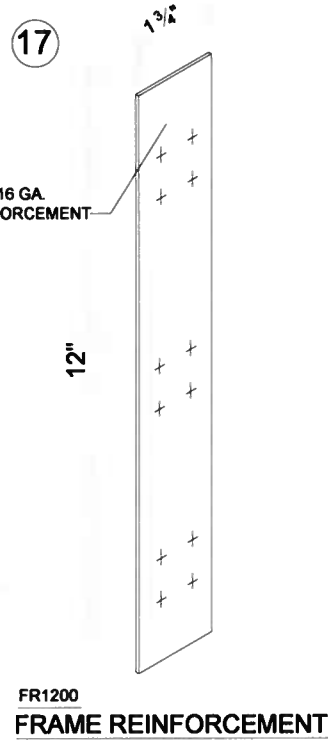
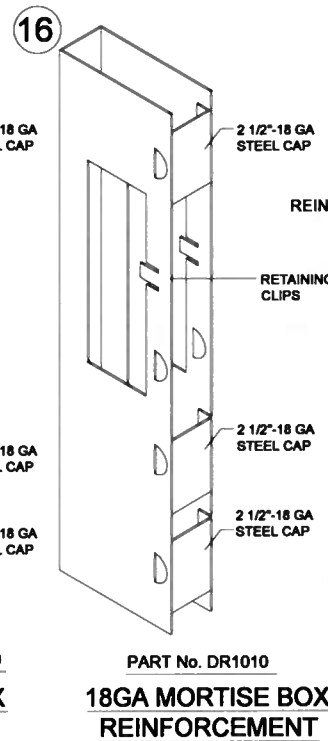
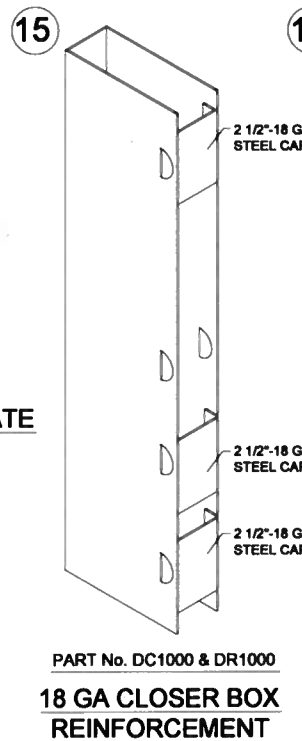
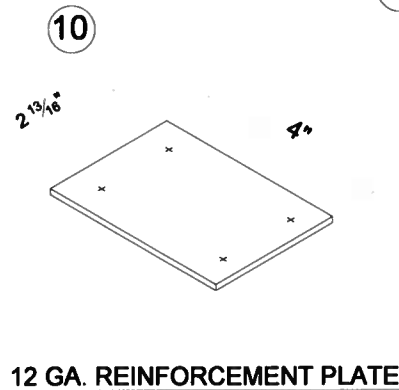
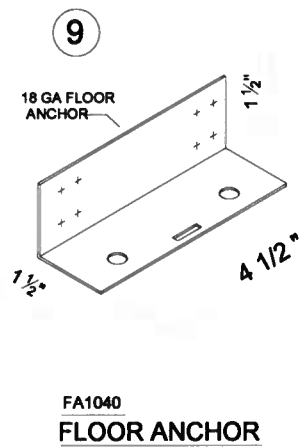
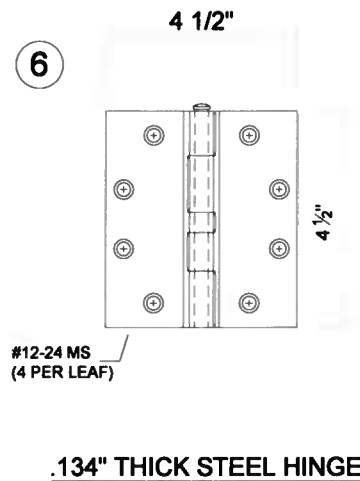
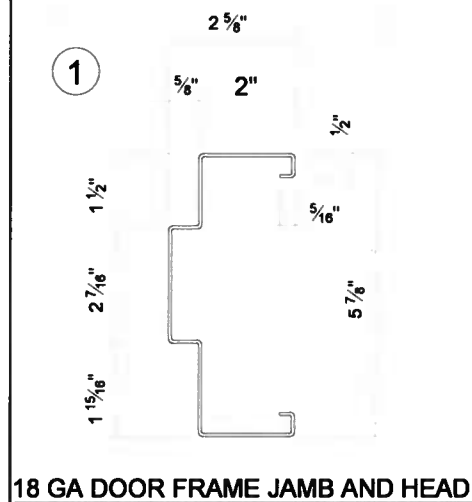

**PRODUCT REVISED**  
as complying with the Florida Building Code  
NOA-No. 23-1207.12  
Expiration Date 07/14/2025  
By Isaac I. Chan  
Miami-Dade Product Control

REVISIONS		DESCRIPTION	
NO.	DATE		

GENSTORM OUTSWING SINGLE DOOR SYSTEM - LMI	
www.gensteel.com	
4950 Hickmore, St. Laurent, Quebec, Canada, H4T1K6	
Tel: (514) 733-3562 Fax: (514) 733-1932	

  

DATE	10/20/2023
SCALE	NTS.
DRAWN	
PROJECT	

  

DRAWING NO.	AD10-02
SHEET 6 OF 7	

BILL OF MATERIALS					
ITEM	PART No.	MATERIAL	QTY.	DESCRIPTION	MANUFACTURER/SUPPLIER/ REMARKS
1	-	STEEL DR ST/ST	AS REQD.	FRAME HEAD/JAMB (5- $\frac{7}{8}$ " x 2")	18 GA. (0.048MIN.) Fy=48KSI MIN., Fu=53KSI MIN.
2	PMK2051	ALUM.	1	THRESHOLD	PEMKO
3	PMK177A	ALUM.	1	THRESHOLD	PEMKO
4	PMK2005AT	ALUM.	1	THRESHOLD OPTION	PEMKO
5	-	VINYL	1	VINYL CAP	-
6	HINGE	STEEL	3 PER LEAF	HAGER #179-454-15 HINGE	-
7	FA3010	STEEL	AS REQD.	EMA ANCHOR	GENSTEEL
8	FA3030	STEEL	AS REQD.	MASONRY WIRE ANCHOR	0.173 DIA. Fy= 60 KSI MIN.
9	FA1040	STEEL	2	FLOOR ANCHOR 18 GA. (1- $\frac{1}{2}$ " x 1- $\frac{1}{2}$ " x 4- $\frac{1}{2}$ " LG)	GENSTEEL
10	-	STEEL	AS REQD.	2- $\frac{3}{16}$ " x 4" 12 GA. STEEL REINFORCEMENT	GENSTEEL
11	HR2000	STEEL	3 PER LEAF	HINGE DUST BOX	GENSTEEL
12	HR1030	STEEL (10 GA.)	3 PER LEAF	HINGE REINFORCEMENT WELDED TO FRAME	GENSTEEL
13	DR1700M	STEEL	AS REQD.	SURFACE BOLT MORTISE STRIKE REINFORCEMENT	GENSTEEL
14	DR1700	STEEL	AS REQD.	MORTISE LOCK EDGE REINFORCEMENT WELDED	GENSTEEL
15	DC1000 & DR1000	STEEL	AS REQD.	CLOSER BOX REINFORCEMENT	GENSTEEL
16	DR1010	STEEL	AS REQD.	MORTISE BOX REINFORCEMENT	GENSTEEL
17	FR1200	STEEL	AS REQD.	1- $\frac{3}{4}$ " x 12" 16 GA. FRAME REINFORCEMENT	GENSTEEL
18	FR1100M	STEEL	AS REQD.	STRIKE DUST BOX	GENSTEEL
19	FR1100	STEEL	AS REQD.	ASA STRIKE BOX REINFORCEMENT	GENSTEEL
20	--	STEEL DR ST/ST	AS REQD.	DOOR PANEL	20GA. (0.039 MIN.) Fy=42KSI, Fu=53KSI
21	P 387	-	AS REQD.	PEMKO 387 CLOSED CELL SPONGE WEATHERSTRIP	PEMKO
22	CH3601	STEEL	2	DOOR END CHANNEL	GENSTEEL
23	2100	ALUM.	AS REQD.	DOOR SWEEP	UNIQUE
24	HONEYCOMB	STEEL	AS REQD.	INSIDE OF DOOR PANEL	GENSTEEL

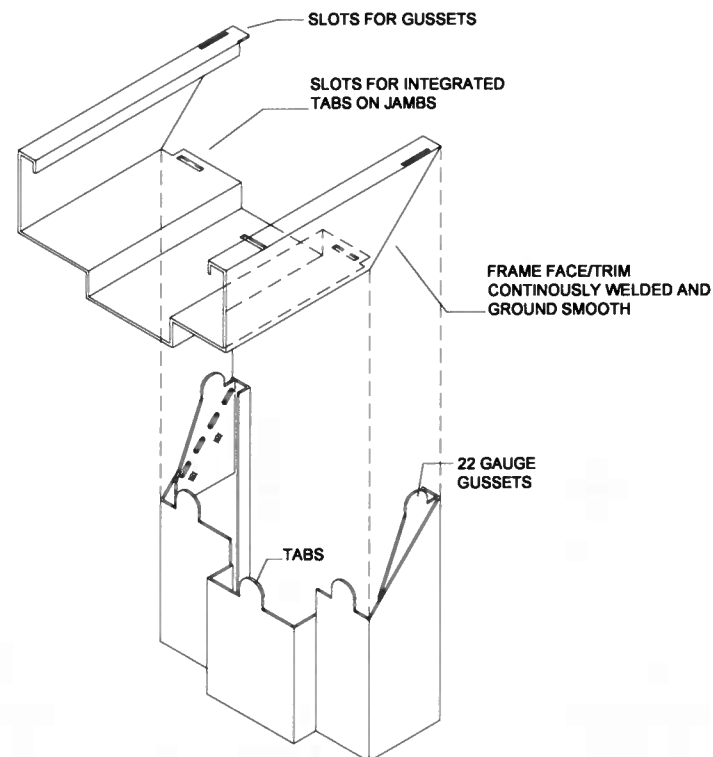
[illegible]

GENSTORM OUTSWING SINGLE DOOR SYSTEM - LMI

 **Gensteel**

4950 Hickmore, St. Laurent, Quebec, Canada, H4T1K6  
Tel: (514) 733-3562 Fax: (514) 733-1932  
[www.gensteeldoors.com](http://www.gensteeldoors.com)

DATE	10/20/2023
SCALE	NTS.
DRAWN	
PROJECT	

DRAWING NO.  
AD10-02

SHEET 7 OF 7