



DEPARTMENT OF REGULATORY AND ECONOMIC RESOURCES (RER)
BOARD AND CODE ADMINISTRATION DIVISION

NOTICE OF ACCEPTANCE (NOA)

MIAMI-DADE COUNTY
PRODUCT CONTROL SECTION
11805 SW 26 Street, Room 208
Miami, Florida 33175-2474
T (786) 315-2590 F (786) 315-2599
www.miamidade.gov/building

Boston Valley Terra Cotta LLC
6860 South Abbott Rd.
Orchard Park, NY 14127

SCOPE:

This NOA is being issued under the applicable rules and regulations governing the use of construction materials. The documentation submitted has been reviewed and accepted by Miami-Dade County RER-Product Control Section to be used in Miami Dade County and other areas where allowed by the Authority Having Jurisdiction (AHJ).

This NOA shall not be valid after the expiration date stated below. The Miami-Dade County Product Control Section (In Miami Dade County) and/or the AHJ (in areas other than Miami Dade County) reserve the right to have this product or material tested for quality assurance purposes. If this product or material fails to perform in the accepted manner, the manufacturer will incur the expense of such testing and the AHJ may immediately revoke, modify, or suspend the use of such product or material within their jurisdiction. RER reserves the right to revoke this acceptance if it is determined by Miami-Dade County Product Control Section that this product or material fails to meet the requirements of the applicable building code.

This product is approved as described herein and has been designed to comply with the Florida Building Code, including the High Velocity Hurricane Zone.

DESCRIPTION: TerraClad® Ceramic Rainscreen Wall Cladding System

APPROVAL DOCUMENT: Drawing No. **12069B.01**, titled "System: Wall Cladding Terra Cotta Panels Horizontal and Vertical" sheets 1 through 10 of 10, dated 05/30/15, prepared by L. Roberto Lomas, P.E., signed and sealed by Luis R. Lomas, P.E. on 02/21/2024, bearing the Miami-Dade County Product Control Revision stamp with the Notice of Acceptance number and expiration date by the Miami-Dade County Product Control Section.

MISSILE IMPACT RATING: Large and Small Missile Impact Resistant

LABELING: Each unit shall bear a permanent label with the manufacturer's name or logo, city, state and following statement: "Miami-Dade County Product Control Approved", unless otherwise noted herein.

RENEWAL of this NOA shall be considered after a renewal application has been filed and there has been no change in the applicable building code negatively affecting the performance of this product.

TERMINATION of this NOA will occur after the expiration date or if there has been a revision or change in the materials, use, and/or manufacture of the product or process. Misuse of this NOA as an endorsement of any product, for sales, advertising or any other purposes shall automatically terminate this NOA. Failure to comply with any section of this NOA shall be cause for termination and removal of NOA.

ADVERTISEMENT: The NOA number preceded by the words Miami-Dade County, Florida, and followed by the expiration date may be displayed in advertising literature. If any portion of the NOA is displayed, then it shall be done in its entirety.

INSPECTION: A copy of this entire NOA shall be provided to the user by the manufacturer or its distributors and shall be available for inspection at the job site at the request of the Building Official.

This NOA **revises NOA No. 22-0908.06** and consists of this page 1 and evidence pages E-1, E-2 and E-3, as well as approval document mentioned above.

The submitted documentation was reviewed by **Carlos M. Utrera, P.E.**



03/25/24

NOA No. 23-1222.17
Expiration Date: December 24, 2025
Approval Date: April 4, 2024

NOTICE OF ACCEPTANCE: EVIDENCE SUBMITTED

1. EVIDENCE SUBMITTED UNDER PREVIOUS NOA's

A. DRAWINGS

1. Manufacturer's die drawings and sections.
(Submitted under NOA No. 15-0514.04)
2. Drawing No **12069B.01**, titled: "System: Wall Cladding Terra Cotta Panels Horizontal and Vertical" sheets 1 through 10 of 10, dated 05/30/15, prepared by L. Roberto Lomas, P.E., signed and sealed by Luis R. Lomas, P.E.
(Submitted under NOA No. 15-0514.04)

B. TESTS

1. Test reports on: 1) Air Infiltration Test, per FBC, TAS 202-94
2) Uniform Static Air Pressure Test, Loading per FBC, TAS 202-94
3) Water Resistance Test, per FBC, TAS 202-94
4) Cyclic Wind Pressure Loading per FBC, TAS 203-94
along with marked-up drawings and installation diagram of 5' by 2' Terra Cotta Panels (Horizontal Panel Orientation), prepared by Quast Consulting and Testing, Inc, Test Report No. **QCT15-3478.01**, dated 03/25/15, signed and sealed by Brian M. Sasman, P.E.
(Submitted under NOA No. 15-0514.04)
2. Test reports on: 1) Air Infiltration Test, per FBC, TAS 202-94
2) Uniform Static Air Pressure Test, Loading per FBC, TAS 202-94
3) Water Resistance Test, per FBC, TAS 202-94
4) Cyclic Wind Pressure Loading per FBC, TAS 203-94
along with marked-up drawings and installation diagram of 2' by 5' Terra Cotta Panels (Vertical Panel Orientation), prepared by Quast Consulting and Testing, Inc, Test Report No. **QCT15-3479.02**, dated 03/25/15, signed and sealed by Brian M. Sasman, P.E.
(Submitted under NOA No. 15-0514.04)
3. Test report on Clay Roof Tiles per ASTM C1167-03 of TerraClad Terra Cotta Panels, prepared by Architectural Testing, Inc, Test Report No. **73688.01-106-18**, dated 12/10/07, signed and sealed by Joseph A. Reed, P.E.
(Submitted under NOA No. 15-0514.04)



Carlos M. Utrera, P.E.
Product Control Examiner
NOA No. 23-1222.17
Expiration Date: December 24, 2025
Approval Date: April 4, 2024

NOTICE OF ACCEPTANCE: EVIDENCE SUBMITTED

1. EVIDENCE SUBMITTED UNDER PREVIOUS NOA's (CONTINUED)

C. CALCULATIONS

1. Anchors calculations prepared by Luis R. Lomas, P.E., dated 11/20/17, signed and sealed by Luis R. Lomas, P.E.
(Submitted under NOA No. 18-0815.01)

D. QUALITY ASSURANCE

1. Miami-Dade Department of Regulatory and Economic Resources (RER)

E. MATERIAL CERTIFICATIONS

1. None.

F. STATEMENTS

1. Statement letter of conformance, complying with **FBC 7th Edition (2020)** and of no financial interest, dated March 18, 2021, issued by L. Roberto Lomas, P.E., signed and sealed by Luis R. Lomas, P.E.
(Submitted under NOA No. 21-0106.07)

G. OTHERS

1. Notice of Acceptance No. **18-0815.01**, issued to Boston Valley Pottery, Inc. for their TerraClad[®] Ceramic Rainscreen Wall Cladding System, approved on 09/27/18 and expiring on 12/24/20.



Carlos M. Utrera, P.E.
Product Control Examiner
NOA No. 23-1222.17
Expiration Date: December 24, 2025
Approval Date: April 4, 2024

NOTICE OF ACCEPTANCE: EVIDENCE SUBMITTED

2. Evidence submitted under 22-0908.06 and new

A. DRAWINGS

1. Drawing No. **12069B.01**, titled “System: Wall Cladding Terra Cotta Panels Horizontal and Vertical” sheets 1 through 10 of 10, dated 05/30/15, prepared by L. Roberto Lomas, P.E., signed and sealed by Luis R. Lomas, P.E. on 02/21/2024.

B. TESTS

1. None.

C. CALCULATIONS

1. None.

D. QUALITY ASSURANCE

1. Miami-Dade Department of Regulatory and Economic Resources (RER).

E. MATERIAL CERTIFICATIONS

1. None.

F. STATEMENTS

1. Statement letter of code conformance with the 8th edition (2023) of the FBC and of no financial interest, issued by L. Roberto Lomas, P.E., dated 12/15/2023, signed and sealed by Luis R. Lomas, P.E.

“Submitted under NOA # 22-0908.06”

2. Statement letter requesting a name change of NOA No. 21-0106.07 from **Boston Valley Pottery, Inc.** to **Boston Valley Terra Cotta LLC**, dated 9/7/22, issued by Boston Valley Terra Cotta LLC, signed by Craig Cudney, Quality Control Manager.
3. Certificate of Merger of **Boston Valley Pottery, Inc.** and **Boston Valley Terra Cotta LLC** into **Boston Valley Terra Cotta LLC**, filed with the State of Delaware on October 26, 2021.
4. Certificate of Merger of **Boston Valley Pottery, Inc.** and **Boston Valley Terra Cotta LLC** into **Boston Valley Terra Cotta LLC**, filed with the State of New York on October 27, 2021.
5. Letter from owners of existing NOA No. **21-0106.07**, stating that a name change has legally occurred and requesting that a new NOA be issued under the new name **Boston Valley Terra Cotta LLC** and that the existing NOA be rescinded, dated October 13, 2022, signed by Ms. Amy Bossert.



Carlos M. Utrera, P.E.
Product Control Examiner
NOA No. 23-1222.17
Expiration Date: December 24, 2025
Approval Date: April 4, 2024

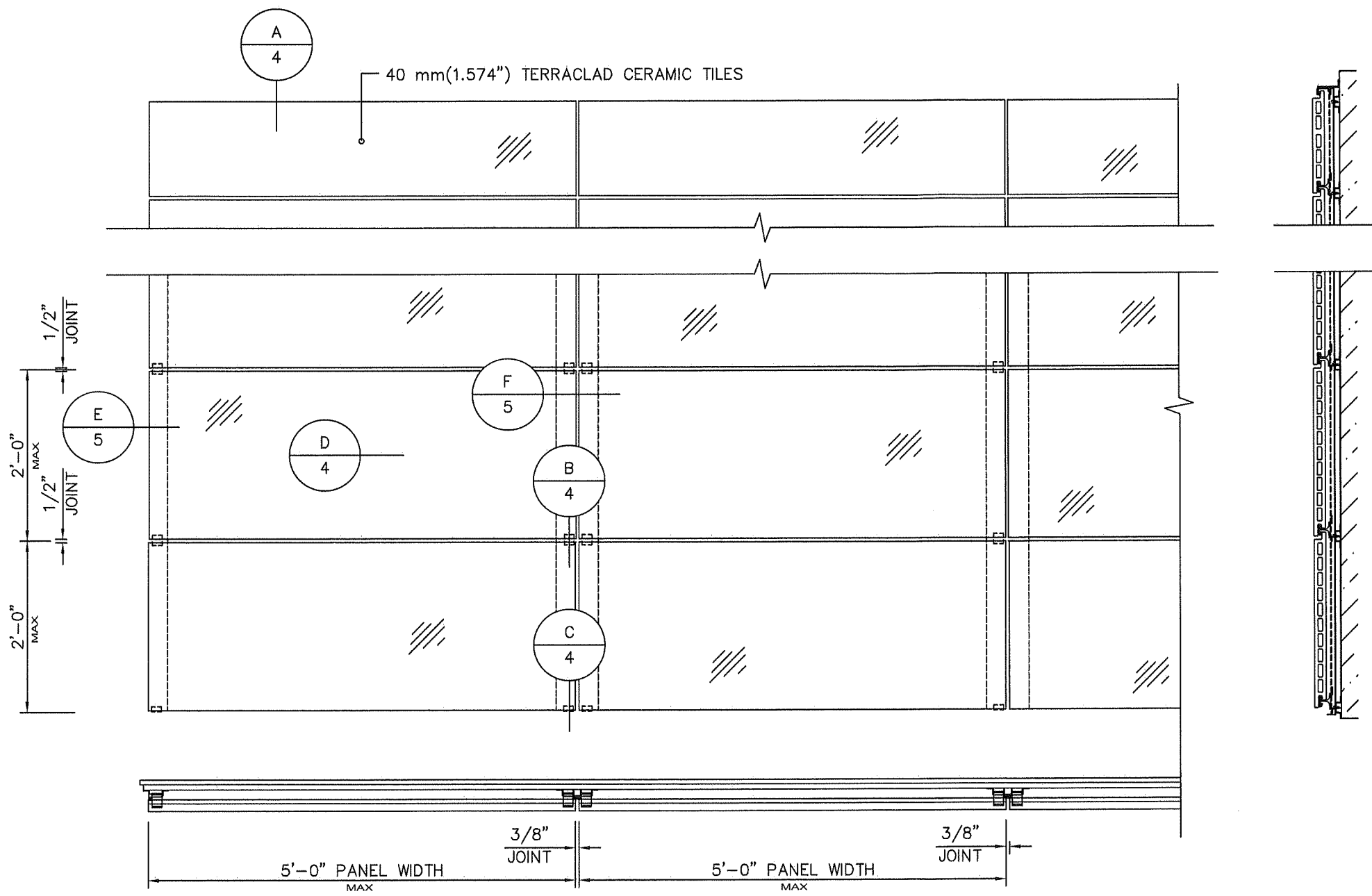

HORIZONTAL PANEL SYSTEM

TERRACLAD RAINSCREEN CLADDING SYSTEM
 TERRACOTA TILES ANCHORED TO FBC WALL ASSEMBLY FOR EXTERIOR CLADDING.

APPROVAL APPLIES TO MULTIPLE UNIT INSTALLATIONS

MAX. DESIGN LOAD = + 80.0 PSF
 - 80.0 PSF

MAX. HAT CHANNEL SPACING = 24 IN.
 MAX. ATTACHMENT CLIP SPACING = 24 IN.
 MAX. VERTICAL TRACK SPACING = 60 IN.
 MAX. TILE SIZE = 24" HIGH X 60" WIDE

THIS PRODUCT HAS BEEN DESIGNED AND TESTED TO COMPLY WITH THE REQUIREMENTS OF THE FLORIDA BUILDING CODE INCLUDING THE HIGH VELOCITY HURRICANE ZONE (HVHZ)

ANCHORS SHALL BE AS LISTED, SPACED AS SHOWN ON DETAILS, ANCHORS EMBEDMENT TO BASE MATERIAL SHALL BE BEYOND WALL DRESSING OR STUCCO.

ANCHORING OR LOADING CONDITIONS NOT SHOWN IN THESE DETAILS ARE NOT PART OF THIS APPROVAL.

MATERIALS INCLUDING BUT NOT LIMITED TO STEEL/METAL SCREWS, THAT COME INTO CONTACT WITH OTHER DISSIMILAR MATERIALS SHALL MEET THE REQUIREMENTS OF THE FLORIDA BUILDING CODE.

PRODUCT REVISED
 as complying with the Florida Building Code
 NOA-No. 23-1222.17
 Expiration Date 12/24/2025
 By *[Signature]*
 Miami-Dade Product Control

SIGNED: 02/21/2024

 LUIS R. LOMAS
 LICENSE
 No. 62514
 STATE OF FLORIDA
 PROFESSIONAL ENGINEER

Mark	Date	Revision
Δ	4/21/15	NOA SUB UPDATES
Δ		
Δ		
Δ		
Δ		
Δ		

PRODUCT DESCRIPTION:
 SYSTEM: WALL CLADDING
 TERRA COTTA PANELS
 HORIZONTAL and VERTICAL

Boston Valley Terra Cotta
 6860 S ABBOT RD,
 ORCHARD PARK, NY 14127
 1-716-649-7490
 www.terraclad.com

L. Roberto Lomas P.E.
 1432 Woodford Road
 Lewisville, NC 27023
 (434)-688-0609
 www.lrlomaspe.com
 FL No.# 62514

Drawn By: WJH&A
Date Drawn: 5/30/2015
Checked By:
D-Scale: 1"=1'-0"
B-Scale: 1/2"=1'-0"
DRAWING: 12069B.01
Title: TEST PLAN
Sheet NO: 1 of 10

VERTICAL PANEL SYSTEM

ASTM C 1167-03 Standard Specification for Clay Roof Tiles (with modification as required to ASTM C 67) DATA	
TEST	RESULT
5 HOUR COLD WATER ABSORPTION	6.1%
24 HOUR COLD WATER ABSORPTION	6.3%
1 HOUR BOILING WATER ABSORPTION	8.8%
2 HOUR BOILING WATER ABSORPTION	8.8%
5 HOUR BOILING WATER ABSORPTION	9.5%
FREEZE/THAW	NO BREAKAGE OR CRACKING WITH +0.7% CHANGE
WET TRANSVERSE STRENGTH	1,031 LBS.
EFFLORESCENCE	NO CHANGE - "NOT EFFECTED"
PERMEABILITY	NO WATER DROPLETS HAVE FALLEN FROM THE UNDERSIDE OF THE TILE

TERRACLAD RAINSCREEN CLADDING SYSTEM
TERRACOTA TILES ANCHORED TO FBC APPROVED WALL ASSEMBLY FOR EXTERIOR CLADDING.

APPROVAL APPLIES TO MULTIPLE UNIT INSTALLATIONS
MAX. DESIGN LOAD = + 80.0 PSF
- 80.0 PSF

MAX. ATTACHMENT CLIP SPACING = 9 IN.
MAX. TRACK SPACING = 60 IN.
MAX. TILE SIZE = 24" HIGH X 60" WIDE

THIS PRODUCT HAS BEEN DESIGNED AND TESTED TO COMPLY WITH THE REQUIREMENTS OF THE FLORIDA BUILDING CODE INCLUDING THE HIGH VELOCITY HURRICANE ZONE (HVHZ)

ANCHORS SHALL BE AS LISTED, SPACED AS SHOWN ON DETAILS, ANCHORS EMBEDMENT TO BASE MATERIAL SHALL BE BEYOND WALL DRESSING OR STUCCO.

ANCHORING OR LOADING CONDITIONS NOT SHOWN IN THESE DETAILS ARE NOT PART OF THIS APPROVAL.

MATERIALS INCLUDING BUT NOT LIMITED TO STEEL/METAL SCREWS, THAT COME INTO CONTACT WITH OTHER DISSIMILAR MATERIALS SHALL MEET THE REQUIREMENTS OF THE FLORIDA BUILDING CODE.

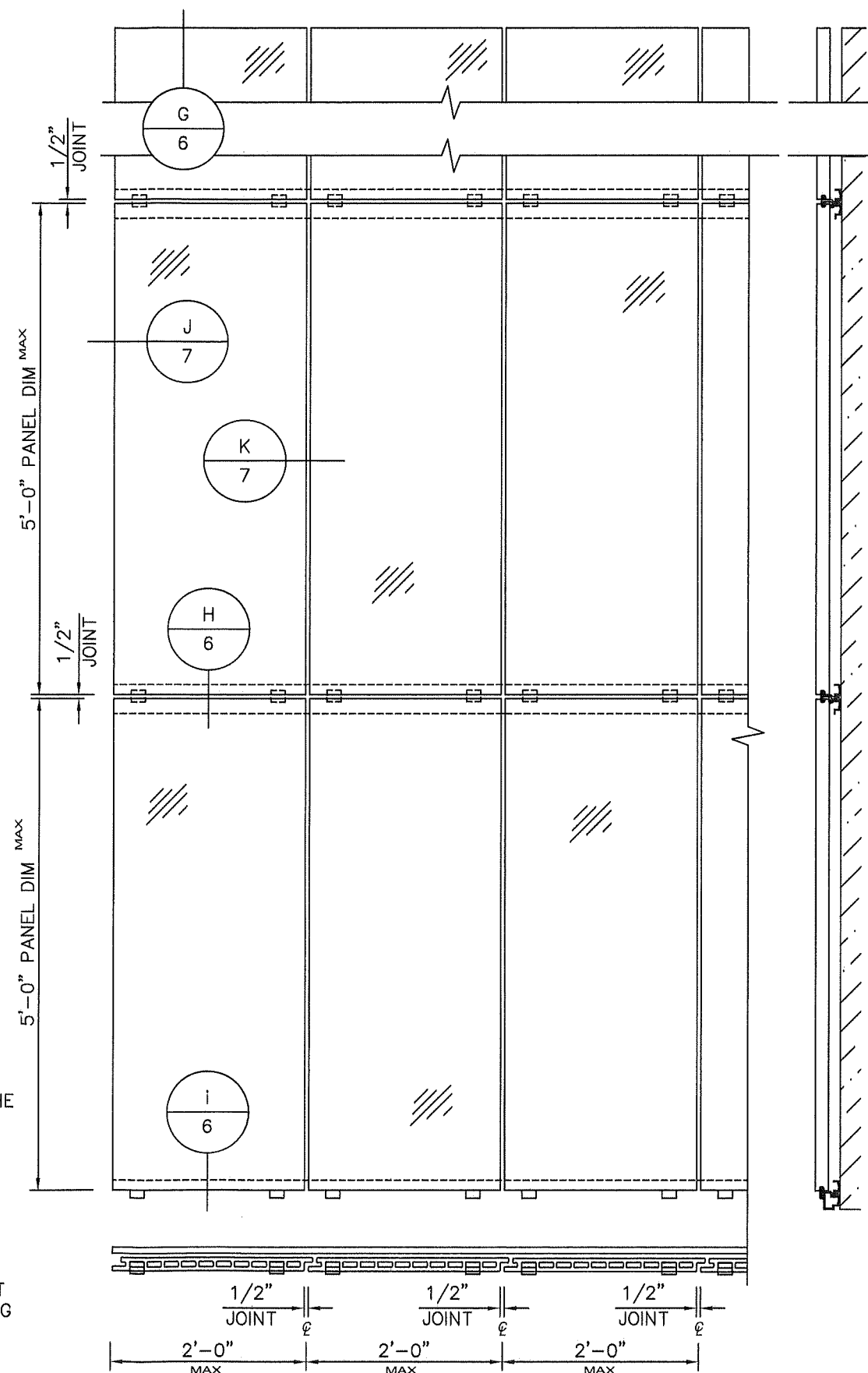

PRODUCT REVISED
as complying with the Florida Building Code
NOA-No. 23-1222.17
Expiration Date 12/24/2025
By *[Signature]*
Miami-Dade Product Control

SIGNED: 02/21/2024

LUIS R. LOMAS
LICENSE
No. 62514
STATE OF FLORIDA
PROFESSIONAL ENGINEER

Mark	Δ	Δ	Δ	Δ	Δ	Δ
Date	4/27/15					
Revision	NOA SUB UPDATES					
PRODUCT DESCRIPTION:						
SYSTEM: WALL CLADDING TERRA COTTA PANELS HORIZONTAL and VERTICAL						
Boston Valley Terra Cotta						
6860 S ABBOT RD, ORCHARD PARK, NY 14127 www.terraclad.com						
1-716-649-7490						
L. Roberto Lomas P.E.						
1432 Woodford Road Lewisville, NC 27023 (434)-688-0609 www.lrlomaspe.com						
FL No.# 62514						
Drawn By: WJH&A						
Date Drawn: 5/30/2015						
Checked By:						
D-Scale: 1"=1'-0"						
B-Scale: 1/2"=1'-0"						
DRAWING: 12069B.01						
Title:						
Sheet NO: 2 of 10						

VERTICAL TRACK SYSTEM
HORIZONTAL PANEL
ORIENTATION

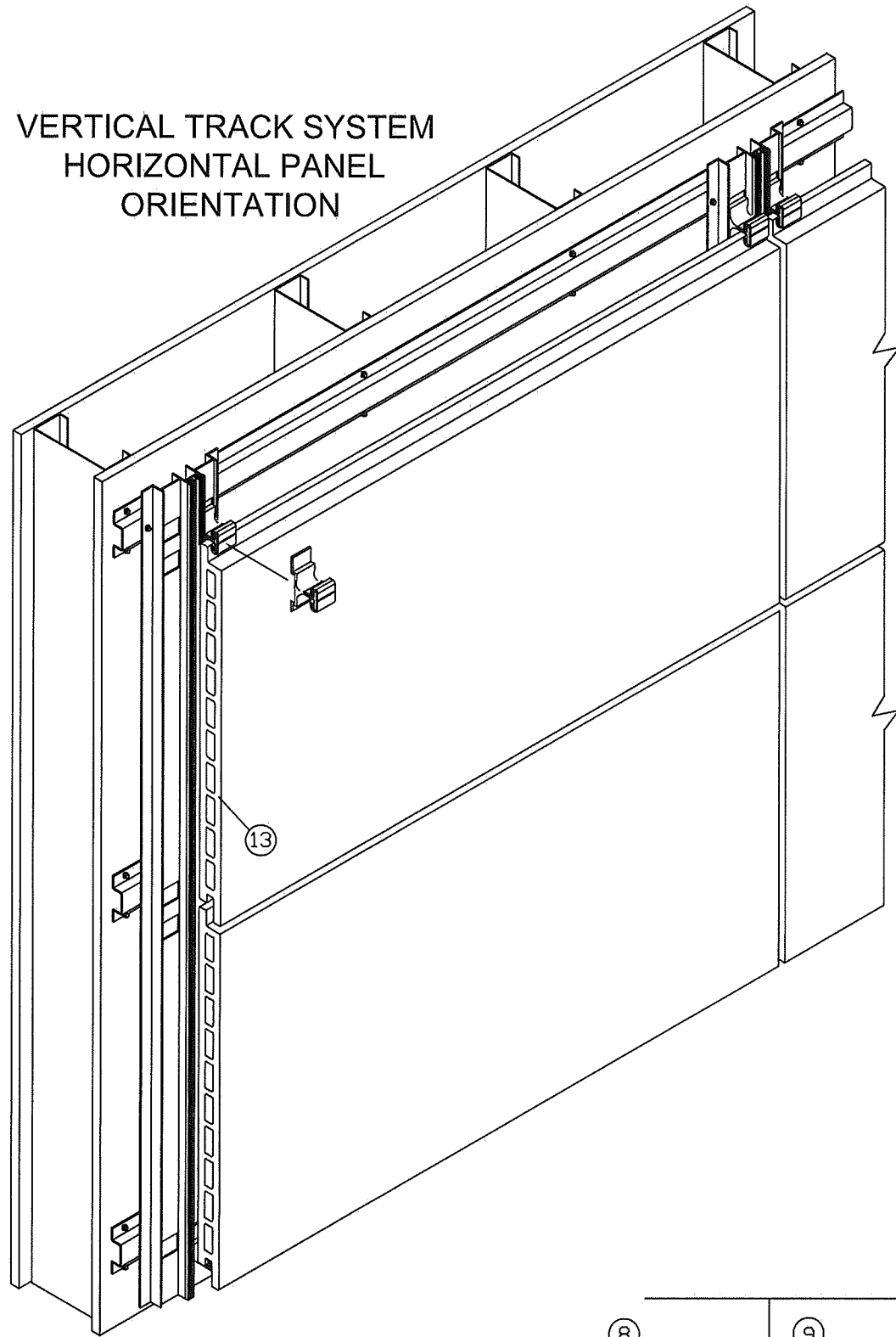

BILL OF MATERIALS

ITEM NO.	QUANTITY	DESCRIPTION	MATERIAL
1	AS REQ'D	ROLLED FORMED HAT Fy=36ksi Fu=58ksi	STEEL
2		VERTICAL TRACK	ALUMINUM 6063-T6
3		VERTICAL CENTER TRACK	
4		HORIZONTAL PANEL CLIP A	
5		HORIZONTAL CENTER TRACK	
6		HORIZONTAL PANEL CLIP B	
7		HORIZONTAL TRACK	
8		HORIZONTAL PANEL CLIP C	SILICONE
9		VERTICAL PANEL CLIP	
10		PANEL CLIP GASKET	
11		VERTICAL TRACK GASKET	EPDM
12		PANEL CLIP COMPRESSION GASKET	
13			40 MM TERRA COTTA TILE PANEL

PRODUCT REVISED
as complying with the Florida
Building Code
NOA-No. 23-1222.17
Expiration Date 12/24/2025
By *[Signature]*
Miami-Dade Product Control

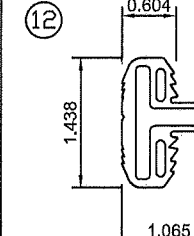
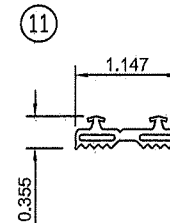
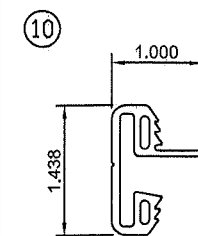
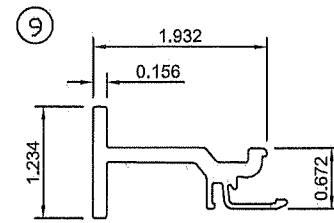
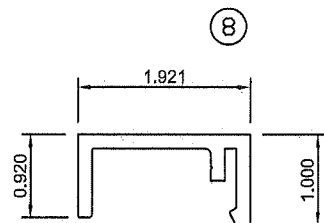
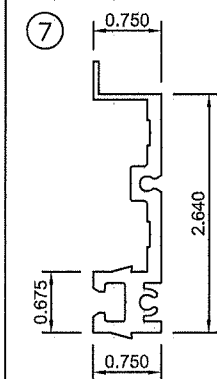
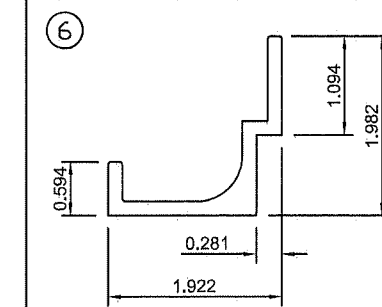
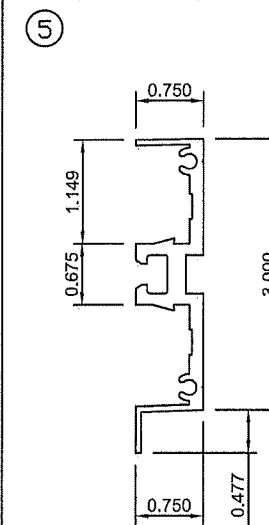
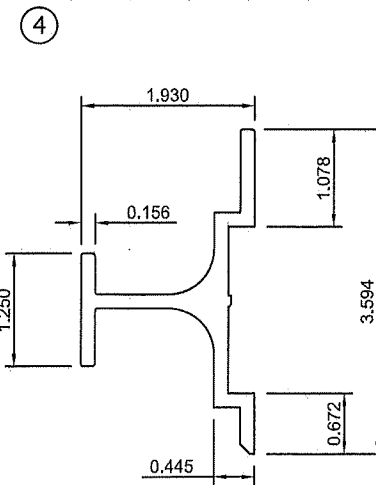
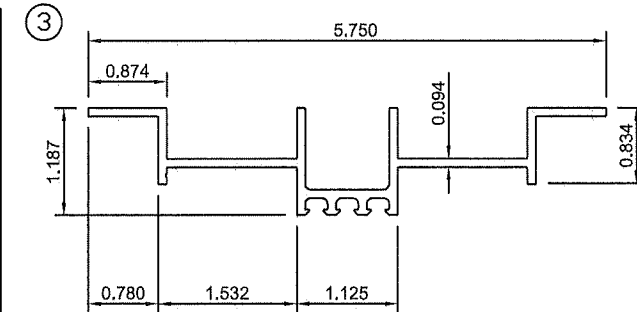
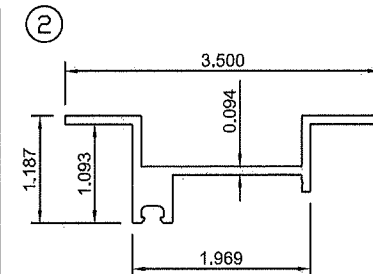
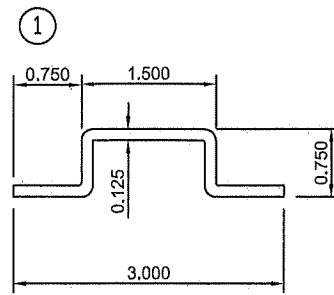

SIGNED: 02/21/2024

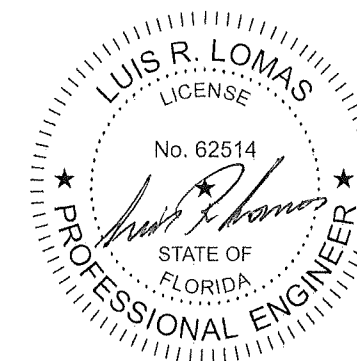

Revision	Date	Mark
NOA SUB UPDATES	4/27/15	△
		△
		△
		△
		△

PRODUCT DESCRIPTION:
SYSTEM: WALL CLADDING
TERRA COTTA PANELS
HORIZONTAL and VERTICAL

Boston Valley
Terra Cotta
6860 S ABBOT RD,
ORCHARD PARK, NY 14127
www.terraclad.com

L. Roberto Lomas P.E.
1432 Woodford Road
Lewisville, NC 27023
(434)-688-0609
www.lrlomaspe.com
FL No.# 62514

Drawn By: WJH&A
Date Drawn: 5/30/2015
Checked By:
D-Scale: Full
B-Scale: 8"=1'-0"
DRAWING: 12089B.01
Title:
Sheet NO: 3 of 10

G PANEL HEAD
SCALE: .5 = 1.0

WATER RESISTIVE BARRIER
(BY OTHERS)
TYPICAL

H HORZ PANEL / PANEL
SCALE: .5 = 1.0

40 MM (1.574") TERRA COTTA
TYPICAL

i PANEL SILL
SCALE: .5 = 1.0

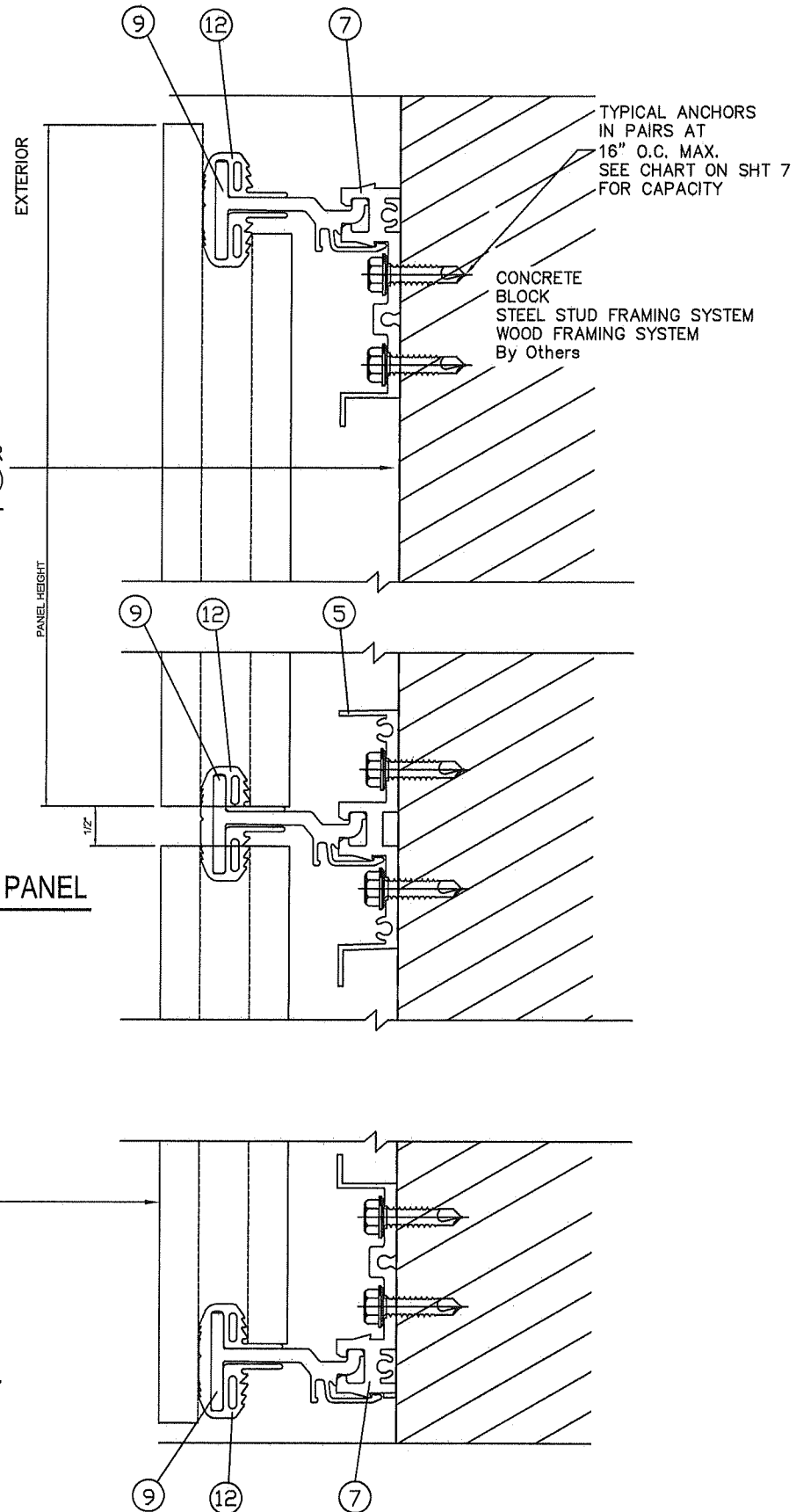

**HORIZONTAL TRACK SYSTEM
VERTICAL PANEL
ORIENTATION**

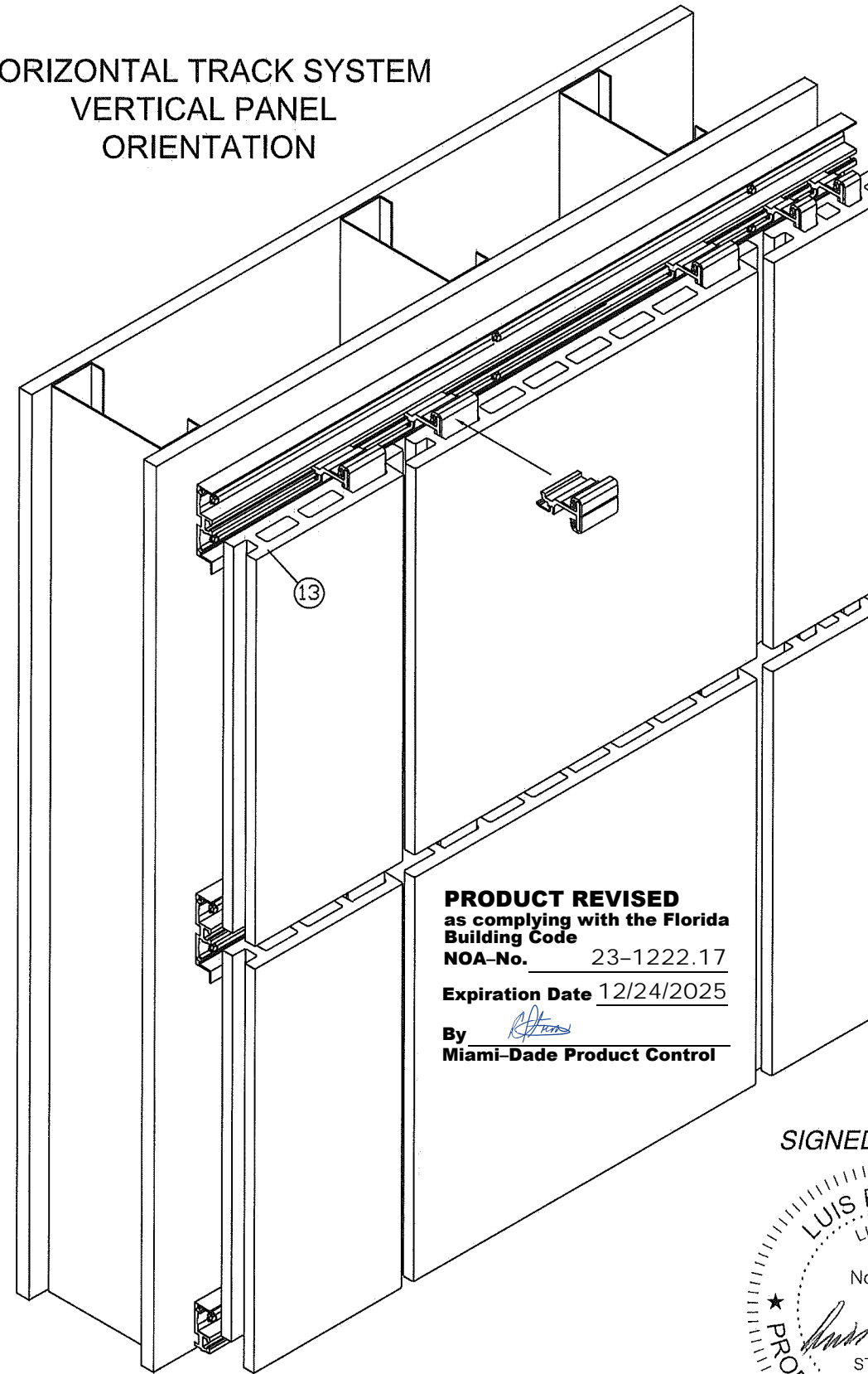

PRODUCT REVISED
as complying with the Florida
Building Code
NOA-No. 23-1222.17
Expiration Date 12/24/2025
By *[Signature]*
Miami-Dade Product Control

SIGNED: 02/21/2024

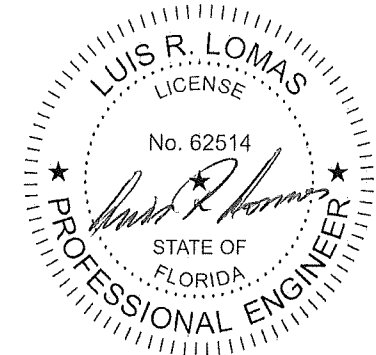

Revision	NOA SUB UPDATES
Date	4/27/15
Mark	△ △ △ △ △ △ △ △
PRODUCT DESCRIPTION: SYSTEM: WALL CLADDING TERRA COTTA PANELS HORIZONTAL and VERTICAL	
Boston Valley Terra Cotta 6860 S ABBOT RD, ORCHARD PARK, NY 14127 1-716-649-7490 www.terraclad.com	
L. Roberto Lomas P.E. 1432 Woodford Road Lewisville, NC 27023 (434)-688-0609 www.lrlomaspe.com FL No. # 62514	
Drawn By:	WJH&A
Date Drawn:	5/30/2015
Checked By:	
D-Scale:	Full
B-Scale:	6"=1'-0"
DRAWING:	12089B.01
Title:	
Sheet NO:	8 of 10

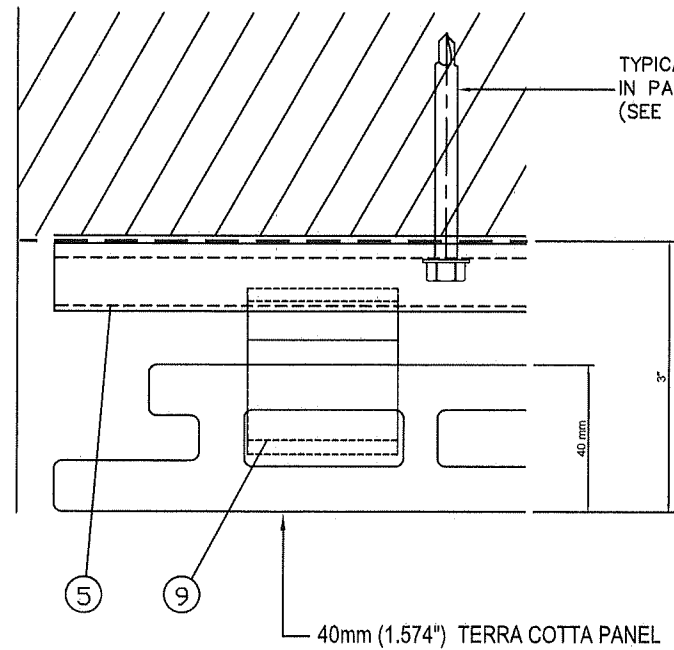

J PANEL JAMB
SCALE: .5 = 1.0

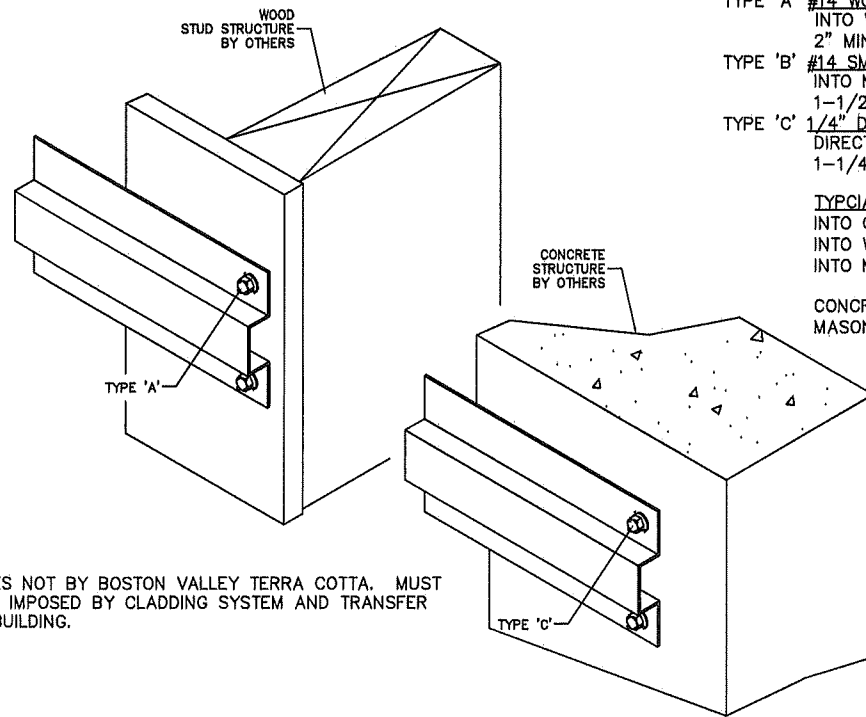
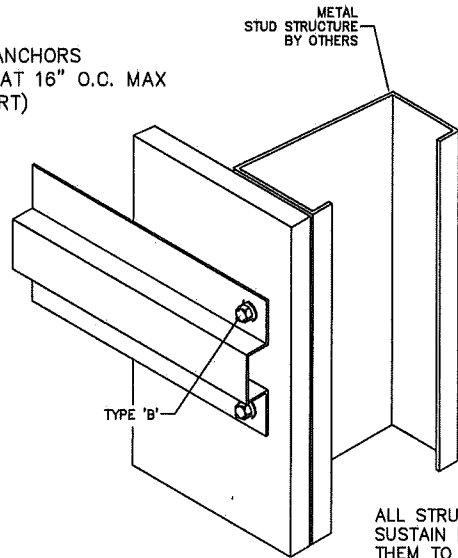

ALL STRUCTURES NOT BY BOSTON VALLEY TERRA COTTA, MUST SUSTAIN LOADS IMPOSED BY CLADDING SYSTEM AND TRANSFER THEM TO THE BUILDING.

TYPICAL ANCHORS:

- TYPE 'A' #14 WOOD SCREWS
INTO WOOD STRUCTURES
2" MIN. PENETRATION INTO WOOD
- TYPE 'B' #14 SMS OR SELF DRILLING SCREWS
INTO METAL STUDS WITH WOOD BACKING
1-1/2" MIN. PENETRATION INTO WOOD BACKING
- TYPE 'C' 1/4" DIA. ELCO ULTRACON
DIRECTLY INTO MASONRY OR CONCRETE
1-1/4" MIN. EMBED INTO MASONRY OR CONCRETE

TYPICAL EDGE DISTANCE:

- INTO CONCRETE AND MASONRY = 3" MIN.
- INTO WOOD STRUCTURE = 5/8" MIN.
- INTO METAL STRUCTURE = 1" MIN.

CONCRETE f'c = 3000 PSI MIN.
MASONRY f'm = 2000 PSI MIN.

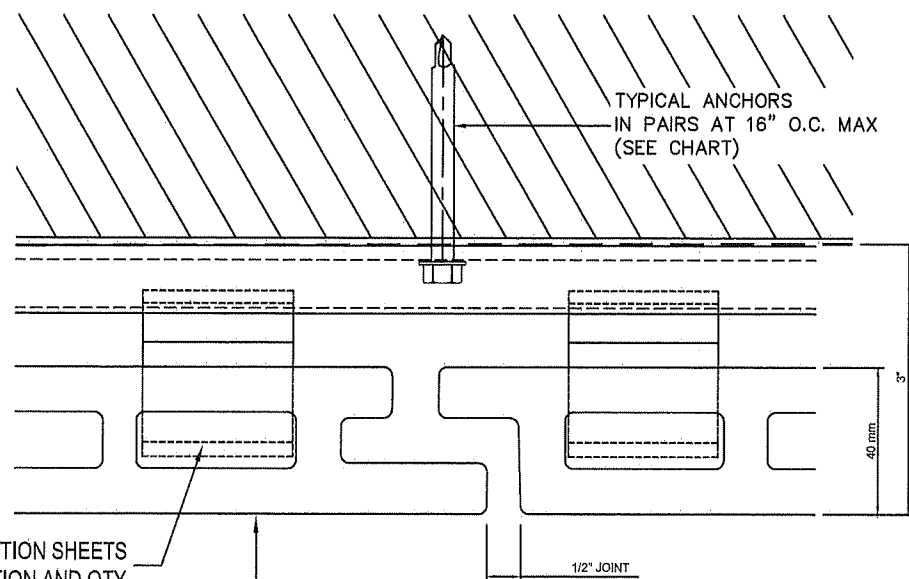

REFER TO ELEVATION SHEETS
FOR LOCATION AND QTY

40mm (1.574") TERRA COTTA PANEL

K VERTICAL PANEL / PANEL
SCALE: .5 = 1.0

PRODUCT REVISED
as complying with the Florida
Building Code
NOA-No. 23-1222.17
Expiration Date 12/24/2025
By *[Signature]*
Miami-Dade Product Control

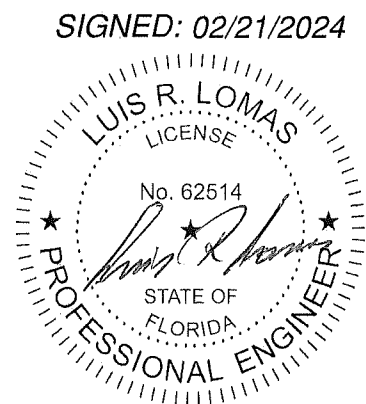

Revision	NOA SUB UPDATES
Date	4/27/15
Mark	△ △ △ △ △ △ △ △
PRODUCT DESCRIPTION:	SYSTEM: WALL CLADDING TERRA COTTA PANELS HORIZONTAL and VERTICAL
Boston Valley Terra Cotta 6860 S ABBOT RD. ORCHARD PARK, NY 14127 www.terraclad.com 1-716-649-7490	
L. Roberto Lomas P.E. 1432 Woodford Road Lewisville, NC 27023 (434)-688-0609 www.lrlomaspe.com FL No. # 62514	
Drawn By:	WJH&A
Date Drawn:	5/30/2015
Checked By:	
D-Scale:	Full
B-Scale:	8"=1'-0"
DRAWING:	12069B.01
Title:	
Sheet NO:	7 of 10

HORIZONTAL PANELS ORIENTATION OPTIONAL CORNER DETAILS

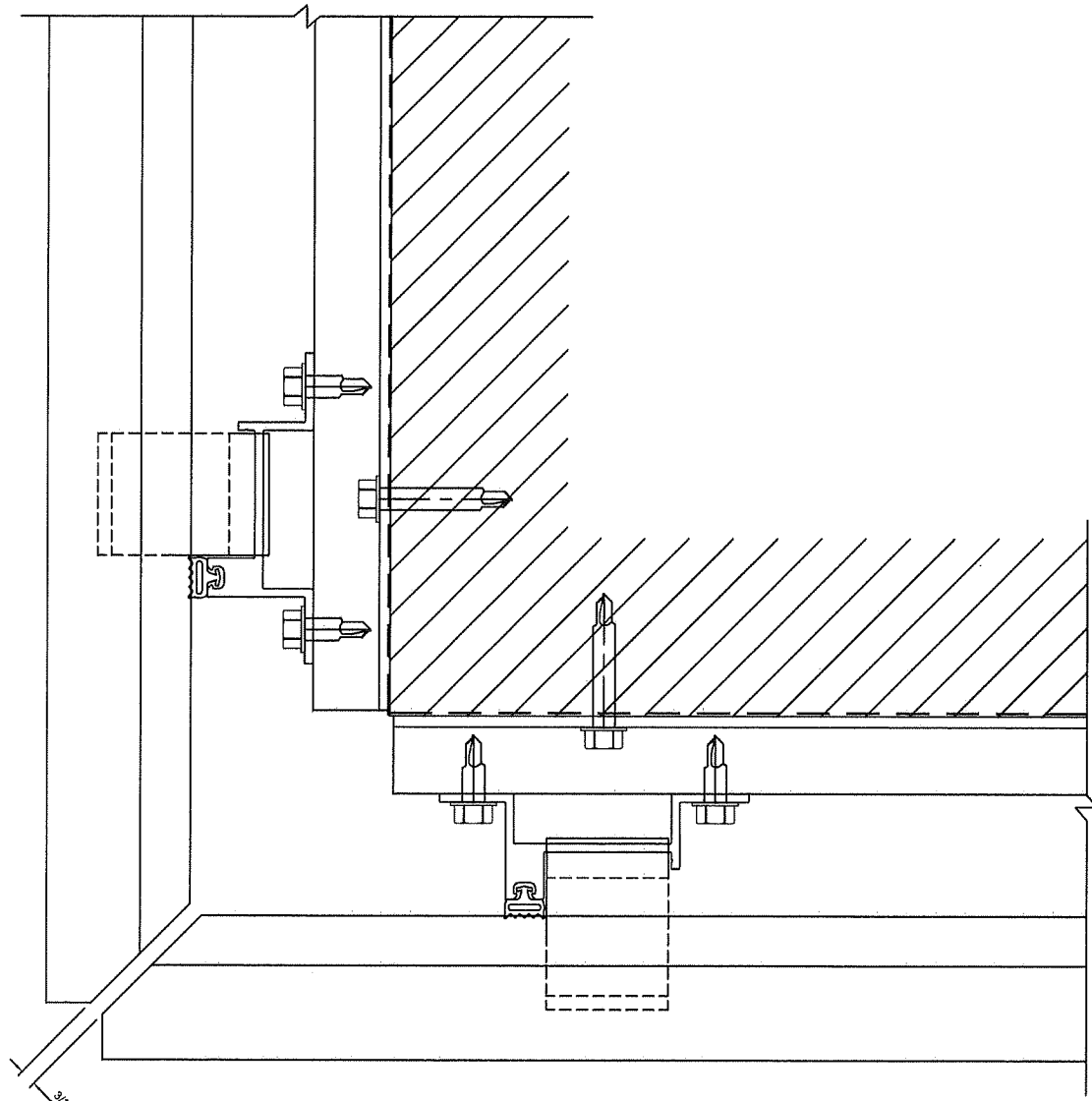

OUTSIDE CORNER 90 DEG

FOR ANCHOR TYPE, SPACING,
MINIMUM EDGE DISTANCE, AND
MINIMUM EMBEDMENT SEE SHEET 7.

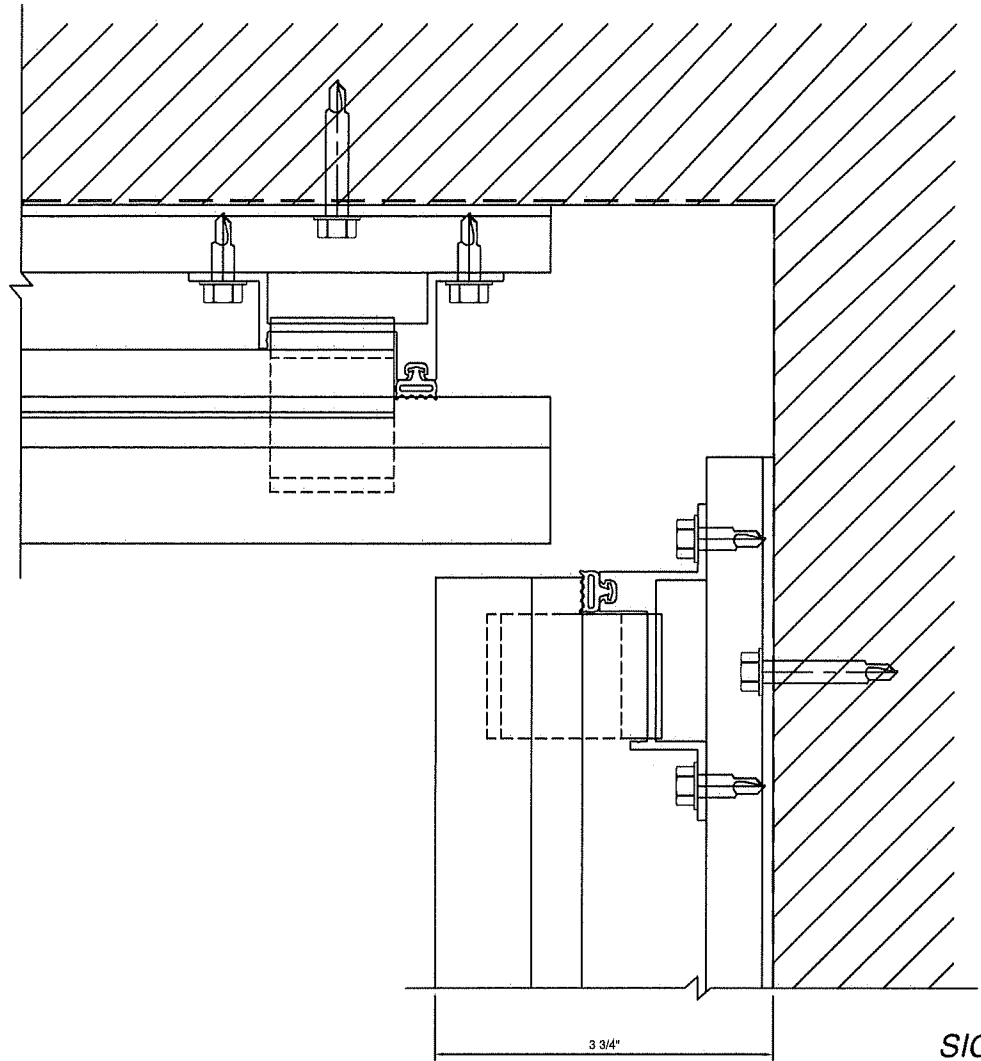

INSIDE CORNER 90 DEG

FOR ANCHOR TYPE, SPACING,
MINIMUM EDGE DISTANCE, AND
MINIMUM EMBEDMENT SEE SHEET 7.

PRODUCT REVISED
as complying with the Florida
Building Code

NOA-No. 23-1222.17

Expiration Date 12/24/2025

By [Signature]
Miami-Dade Product Control

SIGNED: 02/21/2024

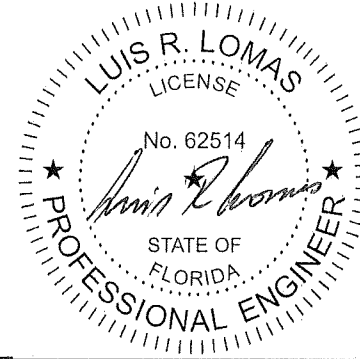

Revision	NOA SUB UPDATES
Date	4/21/15
Mark	△ △ △ △ △ △ △ △
PRODUCT DESCRIPTION:	SYSTEM: WALL CLADDING TERRA COTTA PANELS HORIZONTAL and VERTICAL
<p>Boston Valley Terra Cotta 6860 S ABBOT RD, ORCHARD PARK, NY 14127 1-716-649-7490 www.terraclad.com</p>	
<p>L. Roberto Lomas P.E. 1432 Woodford Road Lewisville, NC 27023 (434)-688-0609 www.lrlomaspe.com FL No. # 62514</p>	
Drawn By:	WJH&A
Date Drawn:	5/30/2015
Checked By:	
D-Scale:	Full
B-Scale:	6"=1'-0"
DRAWING:	12069B.01
Title:	
Sheet NO:	8 of 10

VERTICAL PANEL ORIENTATION OPTIONAL CORNER DETAILS

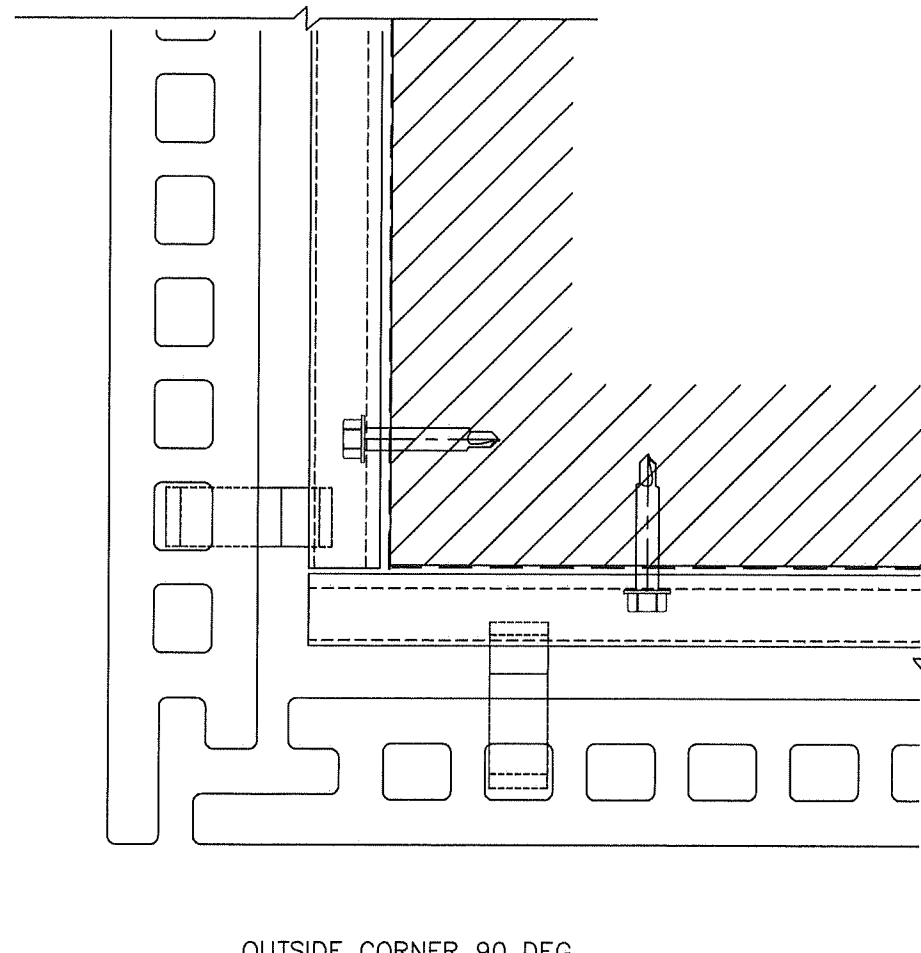

OUTSIDE CORNER 90 DEG

FOR ANCHOR TYPE, SPACING,
MINIMUM EDGE DISTANCE, AND
MINIMUM EMBEDMENT SEE SHEET 7.

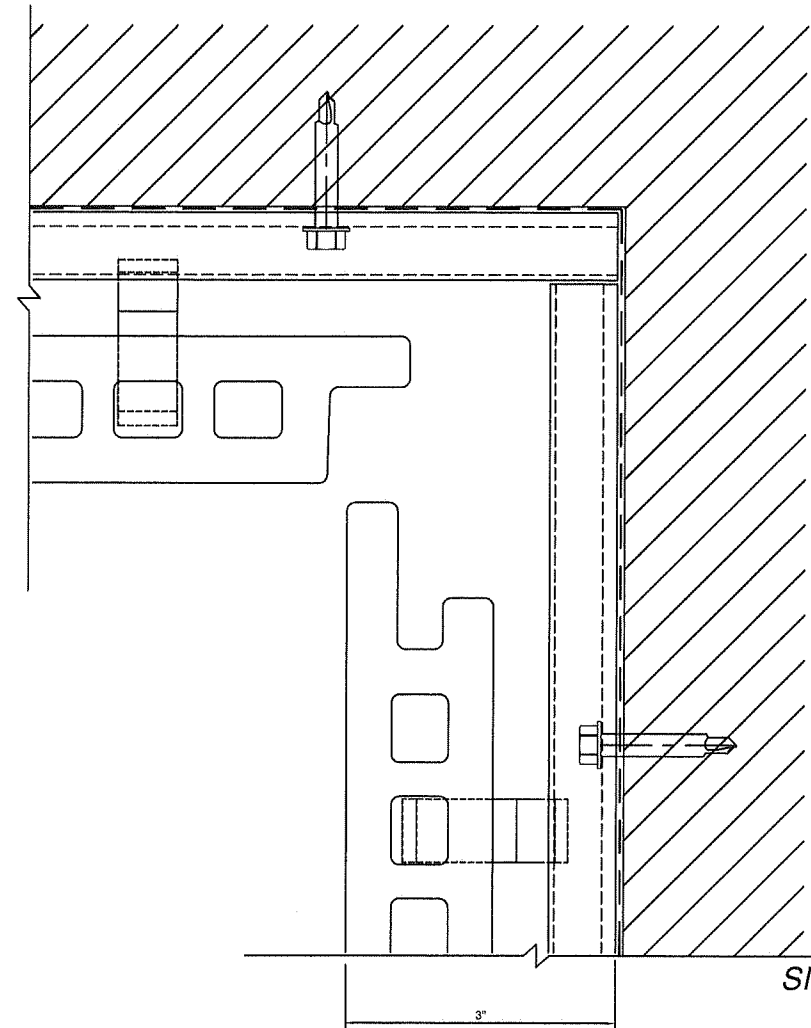

INSIDE CORNER 90 DEG

FOR ANCHOR TYPE, SPACING,
MINIMUM EDGE DISTANCE, AND
MINIMUM EMBEDMENT SEE SHEET 7.

PRODUCT REVISED
as complying with the Florida
Building Code
NOA-No. 23-1222.17

Expiration Date 12/24/2025

By *[Signature]*
Miami-Dade Product Control

SIGNED: 02/21/2024

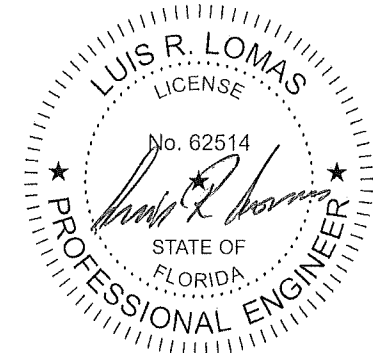

Mark	4/21/15	Revision	NOA SUB UPDATES
△			
△			
△			
△			
△			
△			
△			
PRODUCT DESCRIPTION: SYSTEM: WALL CLADDING TERRA COTTA PANELS HORIZONTAL and VERTICAL			
 Boston Valley Terra Cotta 6860 S ABBOT RD. ORCHARD PARK, NY 14127 1-716-649-7490 www.terraclad.com			
L. Roberto Lomas P.E. 1432 Woodford Road Lewisville, NC 27023 (434)-688-0609 www.lrlomaspe.com FL No. # 62514			
Drawn By:	WJH&A		
Date Drawn:	5/30/2015		
Checked By:			
D-Scale:	Full		
B-Scale:	8"=1'-0"		
DRAWING:	12069B.01		
Title:			
Sheet NO:	9 of 10		

AVAILABLE PANEL DIMENSIONS

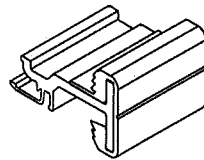
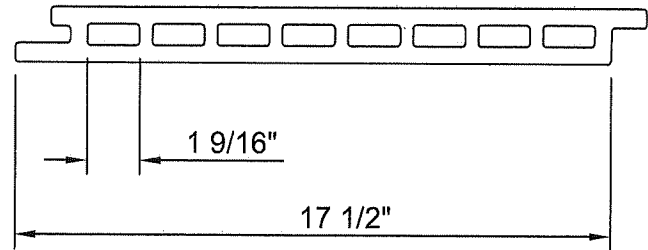

UTILIZES 1-1/2" LONG CLIPS
WHEN USED WITH HORIZONTAL TRACK SYSTEM

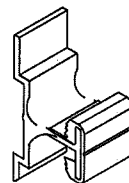
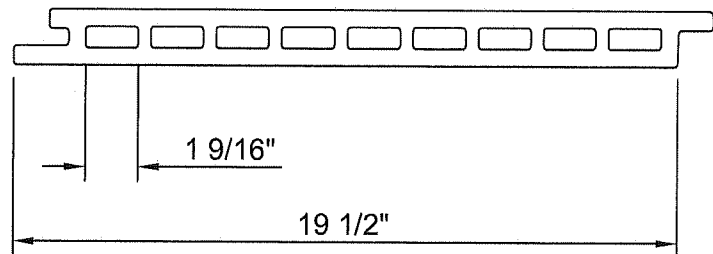

UTILIZES 1-3/8" LONG CLIPS
WHEN USED WITH VERTICAL TRACK SYSTEM

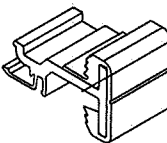
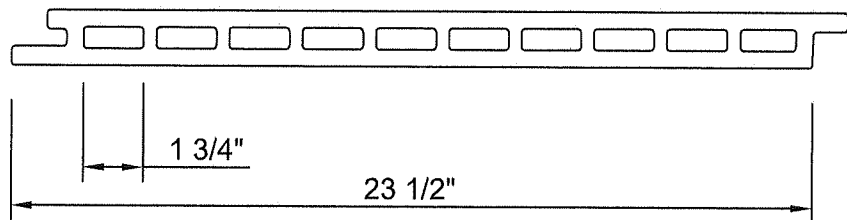

UTILIZES 1" LONG CLIPS
WHEN USED WITH HORIZONTAL TRACK SYSTEM

PRODUCT REVISED
as complying with the Florida Building Code
NOA-No. 23-1222.17
Expiration Date 12/24/2025
By *[Signature]*
Miami-Dade Product Control

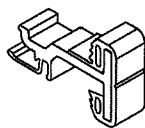

UTILIZES 5/8" LONG CLIPS
WHEN USE WITH HORIZONTAL TRACK SYSTEM

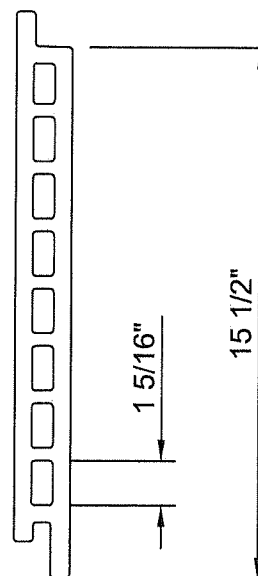
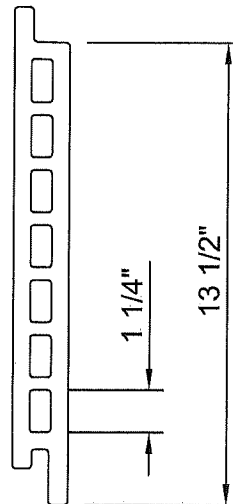
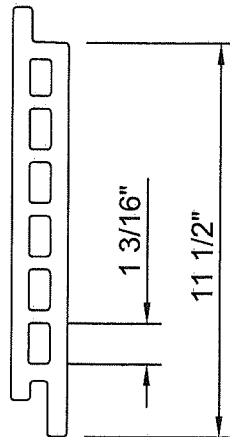
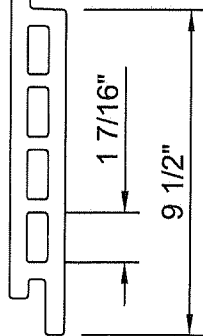
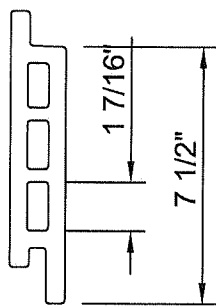
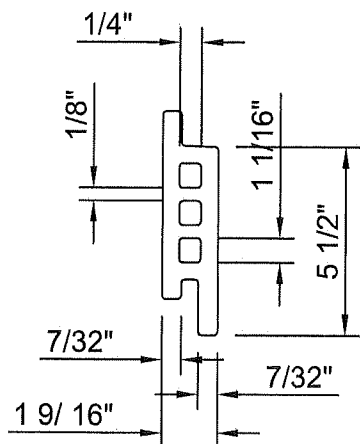

SIGNED: 02/21/2024

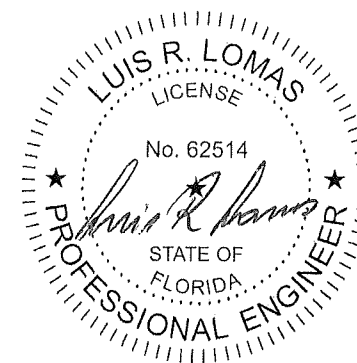

Mark	Date	Revision
△	4/21/15	NOA SUB UPDATES
△		
△		
△		
△		
△		

PRODUCT DESCRIPTION:
SYSTEM: WALL CLADDING
TERRA COTTA PANELS
HORIZONTAL and VERTICAL

Boston Valley Terra Cotta
6860 S ABBOT RD,
ORCHARD PARK, NY 14127
www.terraclad.com
1-716-649-7490

L. Roberto Lomas P.E.
1432 Woodford Road
Lewisville, NC 27023
(434)-688-0609
www.lrlomaspe.com
FL No. # 62514

Drawn By: WJH&A
Date Drawn: 5/30/2015
Checked By:
D-Scale: Full
B-Scale: 6"=1'-0"
DRAWING: 12089B.01
Title:
Sheet NO: 10 of 10