



MIAMI-DADE COUNTY
PRODUCT CONTROL SECTION
 11805 SW 26 Street, Room 208
 Miami, FL 33175-2474
 T (786) 315-2590 F (786) 315-2599
www.miamidade.gov/building

DEPARTMENT OF REGULATORY AND ECONOMIC RESOURCES (RER)
 BOARD AND CODE ADMINISTRATION DIVISION

NOTICE OF ACCEPTANCE (NOA)

Trulite Glass & Aluminum Solutions, LLC
403 West Park Ct, #201
Peachtree City, GA 30269

SCOPE:

This NOA is being issued under the applicable rules and regulations governing the use of construction materials. The documentation submitted has been reviewed and accepted by Miami-Dade County RER-Product Control Section to be used in Miami-Dade County and other areas where allowed by the Authority Having Jurisdiction (AHJ).

This NOA shall not be valid after the expiration date stated below. The Miami-Dade County Product Control Section (In Miami-Dade County) and/ or the AHJ (in areas other than Miami-Dade County) reserve the right to have this product or material tested for quality assurance purposes. If this product or material fails to perform in the accepted manner, the manufacturer will incur the expense of such testing and the AHJ may immediately revoke, modify, or suspend the use of such product or material within their jurisdiction. RER reserves the right to revoke this acceptance, if it is determined by Miami-Dade County Product Control Section that this product or material fails to meet the requirements of the applicable building code.

This product is approved as described herein, and has been designed to comply with the Florida Building Code, including the High Velocity Hurricane Zone.

DESCRIPTION: Series “3000R-Resistor” Aluminum Storefront/Window Wall System – L.M.I.

APPROVAL DOCUMENT: Drawing No. **AD18-17**, titled “Resistor 3000R Aluminum Storefront Wall - LMI”, sheets 1 through 14 of 14, dated 09/16/21, with revision **5** dated 11/18/23, prepared by MCY Engineering, Inc., signed and sealed by Yiping Wang, P.E., bearing the Miami-Dade County Product Control Revision stamp with the Notice of Acceptance number and expiration date by the Miami-Dade County Product Control Section.

MISSILE IMPACT RATING: Large and Small Missile Impact Resistant.

LABELING: Each unit shall bear a permanent label with the manufacturer's name or logo, city, state, series, and following statement: "Miami-Dade County Product Control Approved", unless otherwise noted herein.

RENEWAL of this NOA shall be considered after a renewal application has been filed and there has been no change in the applicable building code negatively affecting the performance of this product.

TERMINATION of this NOA will occur after the expiration date or if there has been a revision or change in the materials, use, and/ or manufacture of the product or process. Misuse of this NOA as an endorsement of any product, for sales, advertising or any other purposes shall automatically terminate this NOA. Failure to comply with any section of this NOA shall be cause for termination and removal of NOA.

ADVERTISEMENT: The NOA number preceded by the words Miami-Dade County, Florida, and followed by the expiration date may be displayed in advertising literature. If any portion of the NOA is displayed, then it shall be done in its entirety.

INSPECTION: A copy of this entire NOA shall be provided to the user by the manufacturer or its distributors and shall be available for inspection at the job site at the request of the Building Official.

This NOA **revises and renews NOA No. 21-1216.09** and consists of this page 1 and evidence pages E-1, E-2, E-3, E-4 and E-5, as well as approval document mentioned above.

The submitted documentation was reviewed by **Manuel Perez, P.E.**

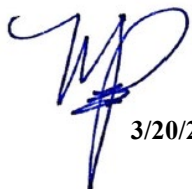

 3/20/24

NOA No. 24-0129.02
Expiration Date: March 18, 2029
Approval Date: March 28, 2024
 Page 1

Trulite Glass & Aluminum Solutions, LLC

NOTICE OF ACCEPTANCE: EVIDENCE SUBMITTED

1. EVIDENCE SUBMITTED UNDER PREVIOUS NOA's

A. DRAWINGS

1. Manufacturer's die drawings and sections.
(Submitted under NOA No. 03-1211.08)
2. Drawing No. **AD18-17**, titled "Resistor 3000R Aluminum Storefront Wall - LMP", sheets 1 through 14 of 14, dated 09/16/21, with revision 4 dated 03/09/22, prepared by MCY Engineering, Inc., signed and sealed by Yiping Wang, P.E.
(Submitted under NOA No. 21-1216.09)

B. TESTS

1. Test reports on: 1) Uniform Static Air Pressure Test, Loading per FBC, TAS 202-94
2) Large Missile Impact Test per FBC, TAS 201-94
3) Cyclic Wind Pressure Loading per FBC, TAS 203-94
along with marked-up drawings and installation diagram of a series 3100 aluminum storefront system, prepared by Intertek, Inc., Test Report No. **M3224.01-450-18 R0**, dated 12/13/21, signed and sealed by Vinu J. Abraham, P.E.
(Submitted under NOA No. 21-1216.09)
2. Test reports on: 1) Uniform Static Air Pressure Test, Loading per FBC, TAS 202-94
2) Large Missile Impact Test per FBC, TAS 201-94
3) Cyclic Wind Pressure Loading per FBC, TAS 203-94
along with marked-up drawings and installation diagram of a series 3100 aluminum storefront system, prepared by Intertek, Inc., Test Report No. **M7456.01-450-18R0**, dated 09/22/21, signed and sealed by Vinu J. Abraham, P.E.
(Submitted under NOA No. 21-0930.09)
3. Test reports on 1) Air Infiltration Test, per FBC, TAS 202-94
2) Uniform Static Air Pressure Test, Loading per FBC TAS 202-94
3) Water Resistance Test, per FBC, TAS 202-94
4) Large Missile Impact Test per FBC, TAS 201-94
5) Cyclic Wind Pressure Loading per FBC, TAS 203-94
6) Forced Entry Test, per FBC 2411 3.2.1, TAS 202-94
along with marked-up drawings and installation diagram of a series 3000/L-3000 aluminum window wall system, prepared by Fenestration Testing Laboratory, Inc., Test Report No. **FTL-5893**, dated 04/02/09, signed and sealed by Michael R. Wenzel, P.E.
(Submitted under NOA No. 09-1110.03)



Manuel Pérez, P.E.
Product Control Examiner
NOA No. 24-0129.02
Expiration Date: March 18, 2029
Approval Date: March 28, 2024

NOTICE OF ACCEPTANCE: EVIDENCE SUBMITTED

1. EVIDENCE SUBMITTED UNDER PREVIOUS NOA's (CONTINUED)

B. TESTS (CONTINUED)

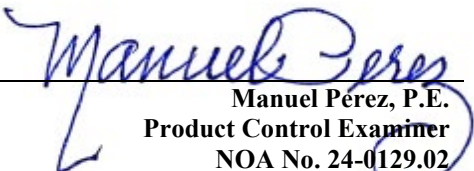
4. Test reports on: 1) Large Missile Impact Test per FBC, TAS 201-94
2) Cyclic Wind Pressure Loading per FBC, TAS 203-94
along with marked-up drawings and installation diagram of a series 3000/L-3000 aluminum window wall system, prepared by Fenestration Testing Laboratory, Inc., Test Report No. **FTL-5416**, dated 11/15/07, signed and sealed by Michael Wenzel, P.E.
(Submitted under NOA No. 09-0122.06)
5. Test reports on Safety Glazing Materials per ANSI Z97.1-1984 and CPSC 16 CFR 1201 of a series 3000/L-3000 aluminum window wall system, prepared by Fenestration Testing Laboratory, Inc., Test Report No. **FTL-5421**, dated 10/18/07, signed and sealed by Michael Wenzel, P.E.
(Submitted under NOA No. 09-0122.06)
6. Test reports on: 1) Uniform Static Air Pressure Test per FBC, TAS 202-94
2) Large Missile Impact Test per FBC, TAS 201-94
3) Cyclic Wind Pressure Loading per FBC, TAS 203-94
along with marked-up drawings and installation diagram of an aluminum storefront system, prepared by Fenestration Testing Laboratory, Test Report No. **FTL-3398**, dated 12/10/03, signed and sealed by Edmundo J. Largaespada, P.E.
(Submitted under NOA No. 03-1211.08)
7. Test reports on: 1) Uniform Static Air Pressure Test per FBC, TAS 202-94
2) Large Missile Impact Test per FBC, TAS 201-94
3) Cyclic Wind Pressure Loading per FBC, TAS 203-94
along with marked-up drawings and installation diagram of an aluminum window wall system, prepared by Fenestration Testing Laboratory, Inc. Test Report No. **FTL-3363**, dated 04/24/03, signed and sealed by Edmundo J. Largaespada, P.E.
(Submitted under NOA No. 03-1211.08)
8. Test reports on: 1) Large Missile Impact Test PA 201-94
2) Cyclic Loading Test, per SFBC PA 203-94
along with marked-up drawings and installation diagram of an aluminum window wall system, prepared by Fenestration Testing Laboratory, Inc. Test Report No. **FTL-3326**, dated 01/09/02, signed and sealed by Luis Antonio Figueredo, P.E.
(Submitted under NOA No. 03-1211.08)

Manuel Pérez, P.E.
Product Control Examiner
NOA No. 24-0129.02
Expiration Date: March 18, 2029
Approval Date: March 28, 2024

Trulite Glass & Aluminum Solutions, LLC

NOTICE OF ACCEPTANCE: EVIDENCE SUBMITTED

1. EVIDENCE SUBMITTED UNDER PREVIOUS NOA's (CONTINUED)

B. TESTS (CONTINUED)

9. Test reports on: 1) Air Infiltration Test, per SFBC, PA 202-94
2) Uniform Static Air Pressure Test, Loading per SFBC, PA 202-94
3) Water Resistance Test, per SFBC, PA 202-94
4) Large Missile Impact Test per SFBC, PA 201-94
5) Cyclic Wind Pressure Loading per SFBC, PA 203-94
along with marked-up drawings and installation diagram of an aluminum window wall system, prepared by Fenestration Testing Laboratory, Inc. Test Report No. **FTL-1010**, dated 10/25/94, signed and sealed by Yamil Gerardo Kuri, P.E.
(Submitted under NOA No. 03-1211.08)
10. Test reports on: 1) Air Infiltration Test, per SFBC, PA 202-94
2) Uniform Static Air Pressure Test, Loading per SFBC, PA 202-94
3) Water Resistance Test, per SFBC, PA 202-94
along with marked-up drawings and installation diagram of an aluminum window wall system, prepared by Fenestration Testing Laboratory, Inc. Test Report No. **FTL-2221**, dated 12/09/98, signed and sealed by Gilbert Diamond, P.E.
(Submitted under NOA No. 03-1211.08)

C. CALCULATIONS

1. Anchor verification calculations and structural analysis, complying with **FBC 6th Edition (2017)**, dated 12/04/18, prepared by MCY Engineering, Inc., signed and sealed by Yiping Wang, P.E.
(Submitted under NOA No. 19-0415.04)
2. Glazing complies with **ASTM E1300-09**

D. QUALITY ASSURANCE

1. Miami-Dade Department of Regulatory and Economic Resources (RER).

Manuel Pérez, P.E.
Product Control Examiner
NOA No. 24-0129.02
Expiration Date: March 18, 2029
Approval Date: March 28, 2024

Trulite Glass & Aluminum Solutions, LLC

NOTICE OF ACCEPTANCE: EVIDENCE SUBMITTED

1. EVIDENCE SUBMITTED UNDER PREVIOUS NOA's (CONTINUED)

E. MATERIAL CERTIFICATIONS

1. Notice of Acceptance No. **21-0216.01** issued to **Eastman Chemical Company (MA)** for their "**Saflex PVB Interlayers - Clear and Colored for Glass**" dated 04/29/21, expiring on 05/21/26.
2. Notice of Acceptance No. **20-0622.02** issued to **Eastman Chemical Company (MA)** for their "**Saflex HP Clear or Color Glass Interlayers**" dated 08/06/20, expiring on 04/14/23.
3. Notice of Acceptance No. **20-0915.19** issued to **Kuraray America, Inc.** for their "**SentryGlas® (Clear and White) Glass Interlayers**" dated 11/19/20, expiring on 07/04/23.
4. Notice of Acceptance No. **20-0929.03** issued to **Everlam N.V.** for their "**Everlam Super Tough PVB Glass Interlayer**", dated 04/29/21, expiring on 04/29/26.
5. Notice of Acceptance No. **21-0628.05** issued to **Everlam N.V.** for their "**Everlam LAM50 PVB Glass Interlayer**", dated 10/07/21, expiring on 10/07/26.

F. STATEMENTS

1. Statement letter of conformance, complying with **FBC 7th Edition (2020)**, and of no financial interest, dated March 10, 2022, issued by MCY Engineering, Inc., signed and sealed by Yiping Wang, P.E.
(Submitted under NOA No. 21-1216.09)
2. Test Proposal No. **21-0643R** issued by the Product Control Section, dated May 20, 2021, and revised on August 27, 2021, signed by Manuel Perez, P.E.
(Submitted under NOA No. 21-0930.09)
3. Proposal No. **17-0233** issued by the Product Control Section, dated April 21, 2017, signed by Manuel Perez, P.E.
(Submitted under NOA No. 19-0415.04)

G. OTHERS

1. Notice of Acceptance No. **21-0930.09** issued to Trulite Glass & Aluminum Solutions, LLC for their Series "3000R-Resistor" Aluminum Storefront/Window Wall System - L.M.I., approved on 10/21/21 and expiring on 03/18/24.

Manuel Pérez, P.E.
Product Control Examiner
NOA No. 24-0129.02
Expiration Date: March 18, 2029
Approval Date: March 28, 2024

Trulite Glass & Aluminum Solutions, LLC

NOTICE OF ACCEPTANCE: EVIDENCE SUBMITTED

2. NEW EVIDENCE SUBMITTED

A. DRAWINGS

1. Drawing No. **AD18-17**, titled “Resistor 3000R Aluminum Storefront Wall - LMI”, sheets 1 through 14 of 14, dated 09/16/21, with revision **5** dated 11/16/29, prepared by MCY Engineering, Inc., signed and sealed by Yiping Wang, P.E.

B. TESTS

1. None.

C. CALCULATIONS

1. None.

D. QUALITY ASSURANCE

1. Miami-Dade Department of Regulatory and Economic Resources (RER)

E. MATERIAL CERTIFICATIONS

1. Notice of Acceptance No. **23-0713.18** issued to **Eastman Chemical Company (MA)** for their “**Saflex® PVB Clear and Colored Interlayers for Laminated Glass**” dated 08/17/23, expiring on 05/21/26.
2. Notice of Acceptance No. **23-0713.20** issued to **Eastman Chemical Company (MA)** for their “**Saflex® HP Clear and Colored Interlayers for Laminated Glass**” dated 08/17/23, expiring on 04/14/28.
3. Notice of Acceptance No. **23-0713.21** issued to **Eastman Chemical Company (MA)** for their “**Saflex® Storm - Saflex® and Saflex® HP Composite Interlayers with PET Core Laminated Glass**” dated 08/17/23, expiring on 12/11/28.
4. Notice of Acceptance No. **23-0717.30** issued to **Kuraray America, Inc.** for their “**SentryGlas® (Clear and White) Glass Interlayers**” dated 08/31/23, expiring on 07/04/28.
5. Notice of Acceptance No. **23-1017.23** issued to **Everlam N.V.** for their “**Everlam Super Tough PVB Glass Interlayer**”, dated 11/30/23, expiring on 04/29/26.
6. Notice of Acceptance No. **23-1017.24** issued to **Everlam N.V.** for their “**Everlam™ LAM50 PVB Glass Interlayer**”, dated 11/30/23, expiring on 10/07/26.

F. STATEMENTS

1. Statement letter of conformance, complying with **FBC 8th Edition (2023)**, and of no financial interest, dated November 16, 2023, issued by MCY Engineering, Inc., signed and sealed by Yiping Wang, P.E.

G. OTHERS

1. Notice of Acceptance No. **21-1216.09** issued to Trulite Glass & Aluminum Solutions, LLC for their Series “3000R-Resistor” Aluminum Storefront/Window Wall System - L.M.I., approved on 03/31/22 and expiring on 03/18/24.

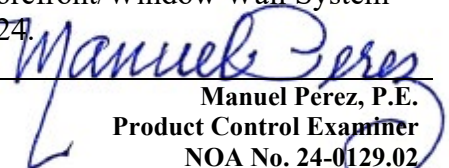
Manuel Pérez, P.E.
Product Control Examiner
NOA No. 24-0129.02
Expiration Date: March 18, 2029
Approval Date: March 28, 2024

SERIES 3000R ALUMINUM WINDOW WALL SYSTEM INSIDE GLAZED LARGE MISSILE IMPACT (L.M.I.)

GENERAL NOTES:

- THIS PRODUCT HAS BEEN DESIGNED AND TESTED TO COMPLY WITH THE REQUIREMENTS OF THE 8TH EDITION FLORIDA BUILDING CODE (2023) INCLUDING HIGH VELOCITY HURRICANE ZONE (HVHZ).
- WINDOW WALL RATED FOR LARGE AND SMALL MISSILE IMPACT. IMPACT SHUTTERS ARE NOT REQUIRED.
- ANCHORS SHALL BE AS LISTED, SPACED AS SHOWN ON DETAILS. ANCHORS EMBEDMENT TO BASE MATERIAL SHALL BE BEYOND WALL DRESSING OR STUCCO.
- ANCHORING OR LOADING CONDITIONS NOT SHOWN IN THESE DETAILS ARE NOT PART OF THIS APPROVAL.
- MATERIALS INCLUDING BUT NOT LIMITED TO STEEL/METAL SCREWS THAT COME INTO CONTACT WITH OTHER DISSIMILAR MATERIALS SHALL MEET THE REQUIREMENTS OF THE 8TH EDITION FLORIDA BUILDING CODE (2023) SECTION AS APPLICABLE.
- METAL STRUCTURES NOT BY TRULITE GLASS AND ALUMINUM SOLUTIONS TO BE DESIGNED TO SUPPORT THE LOADS IMPOSED BY THIS GLAZING SYSTEM AND TO TRANSFER SUCH LOADS TO THE BUILDING MAIN STRUCTURE.
- ULTIMATE LOAD OBTAINED FROM ASCE 7-22, MULTIPLY BY 0.6 SHALL BE LESS THAN OR EQUAL TO MAX. DESIGN LOAD IN THIS DOCUMENT. THE DESIGN LOADS SHOWN IN THIS DOCUMENT ARE ALLOWABLE DESIGN LOADS.
- MANUFACTURER'S LABEL SHALL BE LOCATED ON A READILY VISIBLE LOCATION IN ACCORDANCE WITH SECTION 1709.9.3 OF FLORIDA BUILDING CODE LABELING TO COMPLY WITH SECTION 1709.9.2.

USE CHARTS AS FOLLOWS.

STEP 1: DETERMINE DESIGN WIND LOAD REQUIREMENTS BASED ON WIND VELOCITY, BLDG. HEIGHT, WIND ZONE USING APPLICABLE ASCE 7-22 STANDARD.

STEP 2: SEE GLASS OPTIONS ON SHEET 3. SEE CHARTS ON SHEET 4 & 5 FOR DESIGN LOAD CAPACITY OF DESIRED GLASS SIZE BASED ON APPLICABLE WIND DURATION.

STEP 3: CHECK MULLION AND JAMB CAPACITY FOR A GIVEN SPACING AND HEIGHT USING CHARTS ON SHEET 6 THROUGH 7. THE CAPACITY SHOULD EXCEED THE DESIGN LOAD.

STEP 4: SEE SHEET 10 FOR ANCHOR OPTIONS. USING CHART ON SHEETS 8 THROUGH 9 SELECT ANCHOR OPTION WITH DESIGN RATING MORE THAN DESIGN LOAD SPECIFIED IN STEP 1 ABOVE.

STEP 5: THE LOWEST VALUE RESULTING FROM STEPS 2, 3 AND 4 SHALL APPLY TO ENTIRE SYSTEM.

PRODUCT COMPLIES WITH REQUIREMENTS OF ANSI Z97.1.



<http://www.trulite.com>

403 WESTPARK COURT, Suite 201
PEACHTREE CITY, GA 30269
p. 800-432-8132

PRODUCT:

Resistor
3000R ALUMINUM
STOREFRONT WALL-LMI



REVN	DATE/REMARKS
REV5	11.16.2023 UPDATE INTERLAYER

ENGINEER:



MCY ENGINEERING, INC.
GLAZING CONSULTANT

12781 Miramar Parkway #301
Miramar, FL 33027
P: (305) 271-0117
Email: mcy@mcycengineering.com
www.MCYEngineering.com

STAMP:

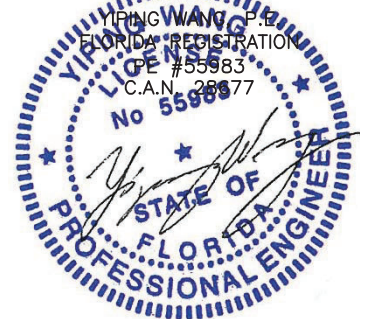

December 04th, 2023

PRODUCT CONTROL APPROVAL:

PRODUCT RENEWED
As complying with the Florida Building Code
NOA-No. 24-0129.02
Expiration Date: 03/18/2029
By: *Manuel Perez*
Miami-Dade Product Control

DRAWN: James
DATE: 11.16.2023
DWG: AD18-17

DRAWING No:
1 OF 14

PRODUCT:

Resistor
3000R ALUMINUM
STOREFRONT WALL-LMI

Resistor
PRODUCT SERIES

REV#	DATE/REMARKS
REV5	11.16.2023 UPDATE INTERLAYER

ENGINEER:



MCY ENGINEERING, INC.
GLAZING CONSULTANT

12781 Miramar Parkway #301
Miramar, FL 33027
P: (305) 271-0117
Email: mcy@mcyengineering.com
www.MCYEngineering.com

STAMP:



December 04th, 2023

PRODUCT CONTROL APPROVAL:

PRODUCT RENEWED
As complying with the Florida
Building Code

NOA-No. 24-0129.02

Expiration Date: 03/18/2029

By: *Manuel Torres*

Miami-Dade Product Control

DRAWN: James

DATE: 11.16.2023

DWG: AD18-17

DRAWING No:

2 OF 14

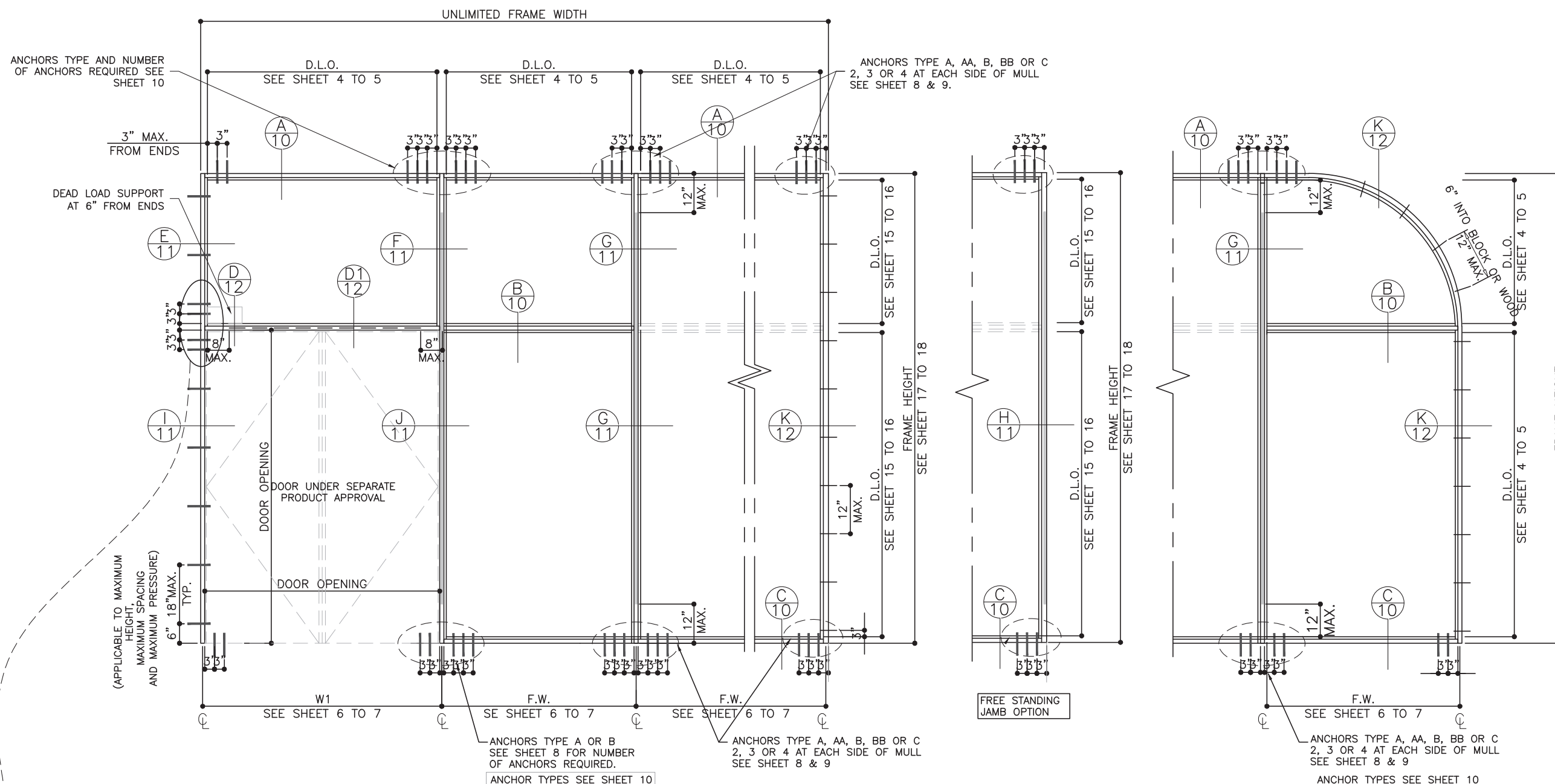

TYPICAL EXTERIOR ELEVATION

TRANSOM END ANCHOR CHART

ANCHOR TYPE	SUBSTRATE	NO. ANCHORS REQUIRED AT TRANSOM MULLION END
AA	WOOD	5
A	BLOCK	5
A	CONCRETE	4
BB	WOOD	4
B	BLOCK	5
B	CONCRETE	3
C	METAL	3

PRODUCT:

Resistor 3000R ALUMINUM STOREFRONT WALL-LMI

Resistor
PRODUCT SERIES

REVN	DATE/REMARKS
REV5	11.16.2023 UPDATE INTERLAYER

ENGINEER:



MCY ENGINEERING, INC.
GLAZING CONSULTANT

12781 Miramar Parkway #301
Miramar, FL 33027
P: (305) 271-0117
Email: mcy@mcyengineering.com
www.MCYEngineering.com

STAMP:

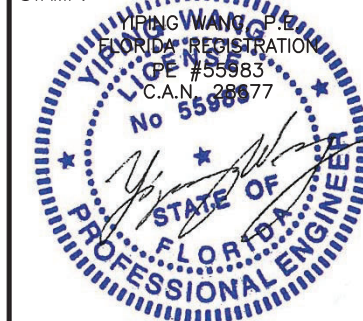

December 04th, 2023

PRODUCT CONTROL APPROVAL:

PRODUCT RENEWED
As complying with the Florida
Building Code

NOA-No. 24-0129.02

Expiration Date: 03/18/2029

By: *Manuel Ferrer*
Miami-Dade Product Control

DRAWN: James

DRAWING No:

DATE: 11.16.2023

3 OF 14

DWG: AD18-17

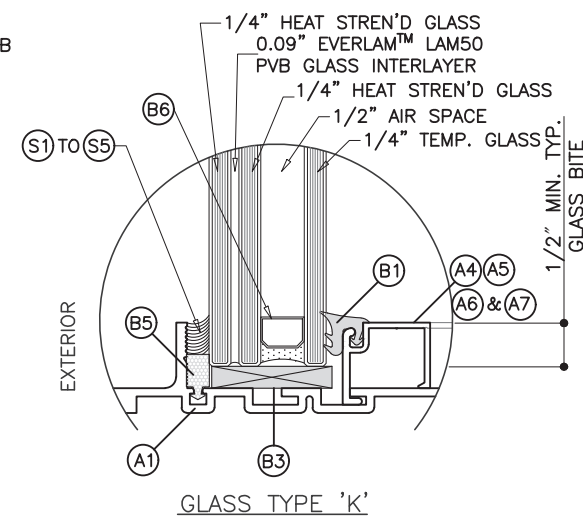
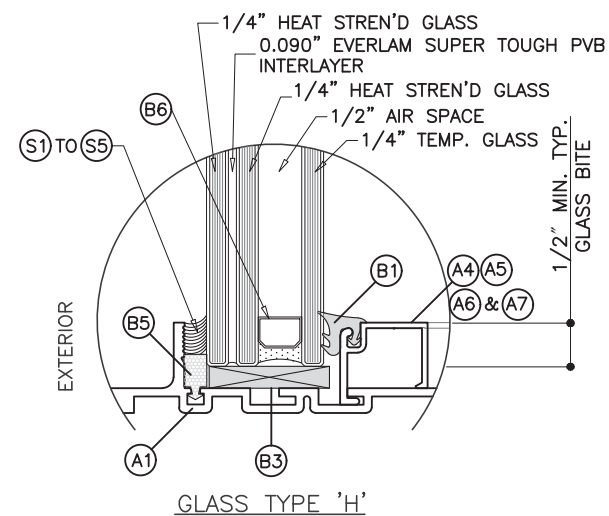
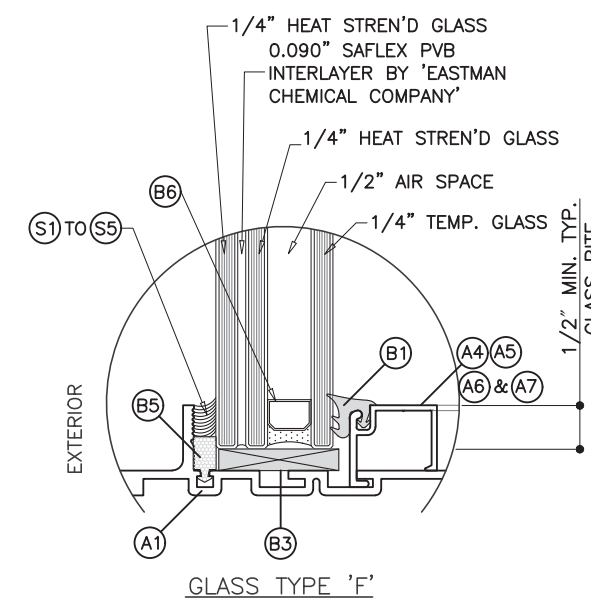
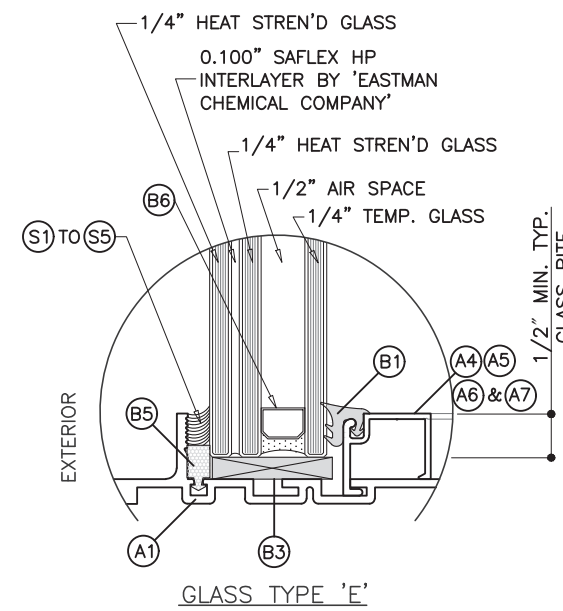
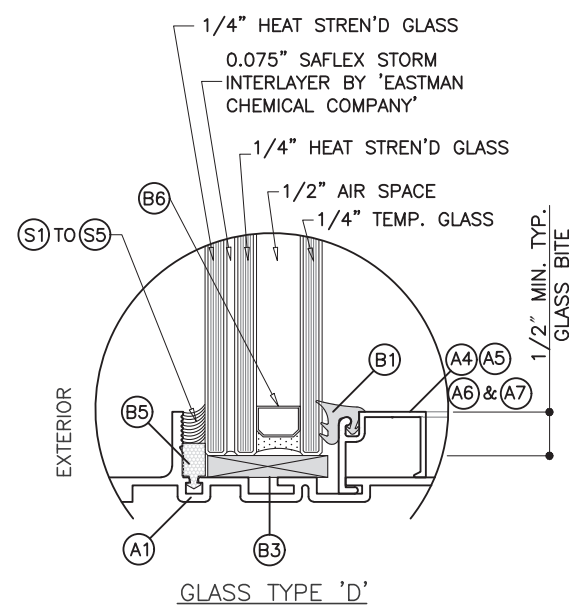
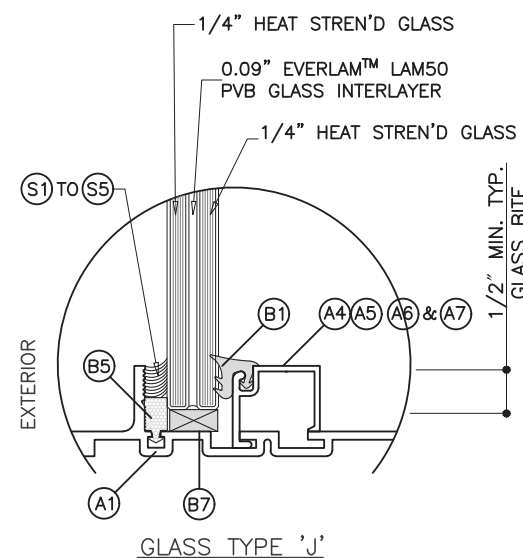
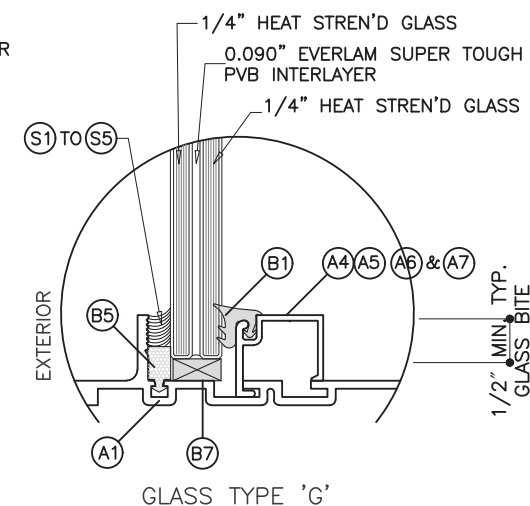
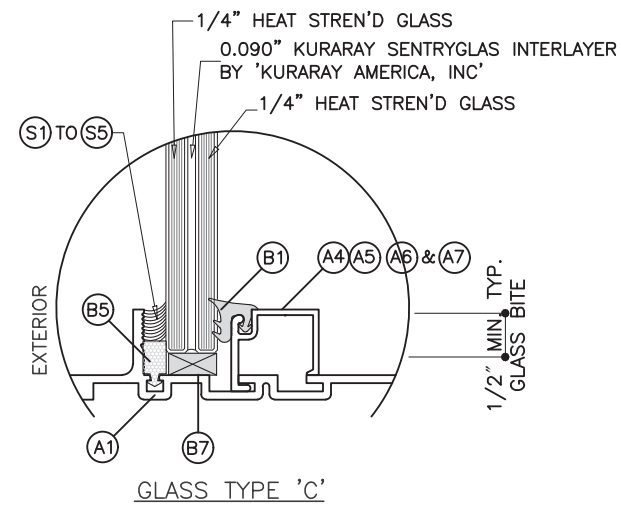
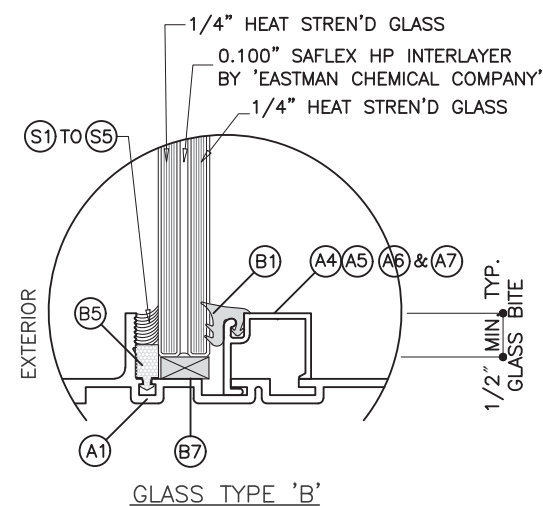
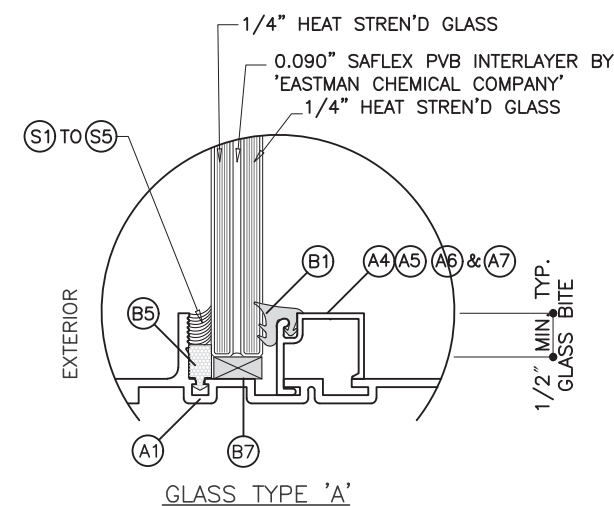

- SILICONE SEALANT OPTIONS:
(S1) DOWSIL 995 OR DOWSIL 983
(S2) GE SCS2000
(S3) TREMCO PROGLAZE SSG
(S4) DOWSIL 795
(S5) TREMCO SPECTREM 2

DESIGN LOAD CAPACITY – PSF											
NOMINAL DIMS.		GLASS TYPE 'D'		GLASS TYPE 'E'		GLASS TYPE 'F'		GLASS TYPE 'H'		GLASS TYPE 'K'	
D.L.O. WIDTH	D.L.O. HEIGHT	EXT. (+)	INT. (-)	EXT. (+)	INT. (-)	EXT. (+)	INT. (-)	EXT. (+)	INT. (-)	EXT. (+)	INT. (-)
36"	80"	85.0	105.0	65.0	80.0	60.0	75.0	70.0	85.0	65.0	75.0
39"		85.0	105.0	65.0	80.0	60.0	75.0	70.0	85.0	65.0	75.0
42"		85.0	105.0	65.0	80.0	60.0	75.0	70.0	85.0	65.0	75.0
45"		85.0	105.0	65.0	80.0	60.0	75.0	70.0	85.0	65.0	75.0
48"		85.0	105.0	65.0	80.0	60.0	75.0	70.0	85.0	–	–
51"		85.0	105.0	65.0	80.0	60.0	75.0	70.0	85.0	–	–
54"		85.0	105.0	65.0	80.0	–	–	–	–	–	–
57"		85.0	105.0	65.0	80.0	–	–	–	–	–	–
60"		85.0	105.0	65.0	80.0	–	–	–	–	–	–
63"		85.0	105.0	65.0	80.0	–	–	–	–	–	–
66"		85.0	105.0	–	–	–	–	–	–	–	–
69"		85.0	105.0	–	–	–	–	–	–	–	–
72"		85.0	105.0	–	–	–	–	–	–	–	–
36"		86"	85.0	105.0	65.0	80.0	60.0	75.0	70.0	85.0	65.0
39"	85.0		105.0	65.0	80.0	60.0	75.0	70.0	85.0	65.0	75.0
42"	85.0		105.0	65.0	80.0	60.0	75.0	70.0	85.0	65.0	75.0
45"	85.0		105.0	65.0	80.0	60.0	75.0	70.0	85.0	–	–
48"	85.0		105.0	65.0	80.0	60.0	75.0	70.0	85.0	–	–
51"	85.0		105.0	65.0	80.0	60.0	75.0	–	–	–	–
54"	85.0		105.0	65.0	80.0	–	–	–	–	–	–
57"	85.0		105.0	65.0	80.0	–	–	–	–	–	–
60"	85.0		105.0	65.0	80.0	–	–	–	–	–	–
63"	85.0		105.0	–	–	–	–	–	–	–	–
66"	85.0		105.0	–	–	–	–	–	–	–	–
69"	85.0		105.0	–	–	–	–	–	–	–	–
72"	85.0		105.0	–	–	–	–	–	–	–	–
36"	92"		85.0	105.0	65.0	80.0	60.0	75.0	70.0	85.0	65.0
39.25"		85.0	105.0	65.0	80.0	60.0	75.0	70.0	85.0	65.0	75.0
42"		85.0	105.0	65.0	80.0	60.0	75.0	70.0	85.0	–	–
45.25"		85.0	105.0	65.0	80.0	60.0	75.0	70.0	85.0	–	–
48"		85.0	105.0	65.0	80.0	–	–	–	–	–	–
51"		85.0	105.0	65.0	80.0	–	–	–	–	–	–
54"		85.0	105.0	65.0	80.0	–	–	–	–	–	–
57.25"		85.0	105.0	65.0	80.0	–	–	–	–	–	–
60"		85.0	105.0	–	–	–	–	–	–	–	–
63"		85.0	105.0	–	–	–	–	–	–	–	–
66"	85.0	105.0	–	–	–	–	–	–	–	–	
36"	98"	85.0	105.0	65.0	80.0	60.0	75.0	70.0	85.0	65.0	75.0
39"		85.0	105.0	65.0	80.0	60.0	75.0	70.0	85.0	–	–
42"		85.0	105.0	65.0	80.0	60.0	75.0	70.0	85.0	–	–
45"		85.0	105.0	65.0	80.0	–	–	–	–	–	–
48"		85.0	105.0	65.0	80.0	–	–	–	–	–	–
51"		85.0	105.0	65.0	80.0	–	–	–	–	–	–
54"		85.0	105.0	–	–	–	–	–	–	–	–
57"		85.0	105.0	–	–	–	–	–	–	–	–
60"		85.0	105.0	–	–	–	–	–	–	–	–
63"		85.0	105.0	–	–	–	–	–	–	–	–
66"	85.0	105.0	–	–	–	–	–	–	–	–	

DESIGN LOAD CAPACITY – PSF												
NOMINAL DIMS.		GLASS TYPE 'D'		GLASS TYPE 'E'		GLASS TYPE 'F'		GLASS TYPE 'H'		GLASS TYPE 'K'		
D.L.O. WIDTH	D.L.O. HEIGHT	EXT. (+)	INT. (-)	EXT. (+)	INT. (-)	EXT. (+)	INT. (-)	EXT. (+)	INT. (-)	EXT. (+)	INT. (-)	
35"	104"	85.0	105.0	65.0	80.0	60.0	75.0	70.0	85.0	65.0	75.0	
39"		85.0	105.0	65.0	80.0	60.0	75.0	70.0	85.0	–	–	
42"		85.0	105.0	65.0	80.0	–	–	–	–	–	–	
45"		85.0	105.0	65.0	80.0	–	–	–	–	–	–	
48"		85.0	105.0	65.0	80.0	–	–	–	–	–	–	
51"		85.0	105.0	–	–	–	–	–	–	–	–	
54"		85.0	105.0	–	–	–	–	–	–	–	–	
36"	110"	85.0	105.0	65.0	80.0	60.0	75.0	70.0	85.0	–	–	
39"		85.0	105.0	65.0	80.0	–	–	–	–	–	–	
42"		85.0	105.0	65.0	80.0	–	–	–	–	–	–	
45"		85.0	105.0	–	–	–	–	–	–	–	–	
48"		85.0	105.0	–	–	–	–	–	–	–	–	
51"		85.0	105.0	–	–	–	–	–	–	–	–	
54"		85.0	105.0	–	–	–	–	–	–	–	–	
36"	116"	85.0	105.0	65.0	80.0	60.0	75.0	–	–	–	–	
39"		85.0	105.0	65.0	80.0	–	–	–	–	–	–	
42"		85.0	105.0	65.0	80.0	–	–	–	–	–	–	
45"		85.0	105.0	65.0	80.0	–	–	–	–	–	–	
48"		85.0	105.0	–	–	–	–	–	–	–	–	
51"		85.0	105.0	–	–	–	–	–	–	–	–	
54"		85.0	105.0	–	–	–	–	–	–	–	–	
36"	122"	85.0	105.0	65.0	80.0	–	–	–	–	–	–	
39"		85.0	105.0	65.0	80.0	–	–	–	–	–	–	
42"		85.0	105.0	65.0	80.0	–	–	–	–	–	–	
45"		85.0	105.0	–	–	–	–	–	–	–	–	
48"		85.0	105.0	–	–	–	–	–	–	–	–	
52.5"		85.0	105.0	–	–	–	–	–	–	–	–	
36"		128"	85.0	105.0	65.0	80.0	–	–	–	–	–	–
39"	85.0		105.0	65.0	80.0	–	–	–	–	–	–	
42"	85.0		105.0	–	–	–	–	–	–	–	–	
45"	85.0		105.0	–	–	–	–	–	–	–	–	
48"	85.0		105.0	–	–	–	–	–	–	–	–	
36"	134"		85.0	105.0	65.0	80.0	–	–	–	–	–	–
39"			85.0	105.0	65.0	80.0	–	–	–	–	–	–
42"		85.0	105.0	–	–	–	–	–	–	–	–	
45"		85.0	105.0	–	–	–	–	–	–	–	–	
48"		85.0	105.0	–	–	–	–	–	–	–	–	
36"		140"	85.0	105.0	65.0	80.0	–	–	–	–	–	–
39"			85.0	105.0	–	–	–	–	–	–	–	–
42"	85.0		105.0	–	–	–	–	–	–	–	–	
45.5"	85.0		105.0	–	–	–	–	–	–	–	–	

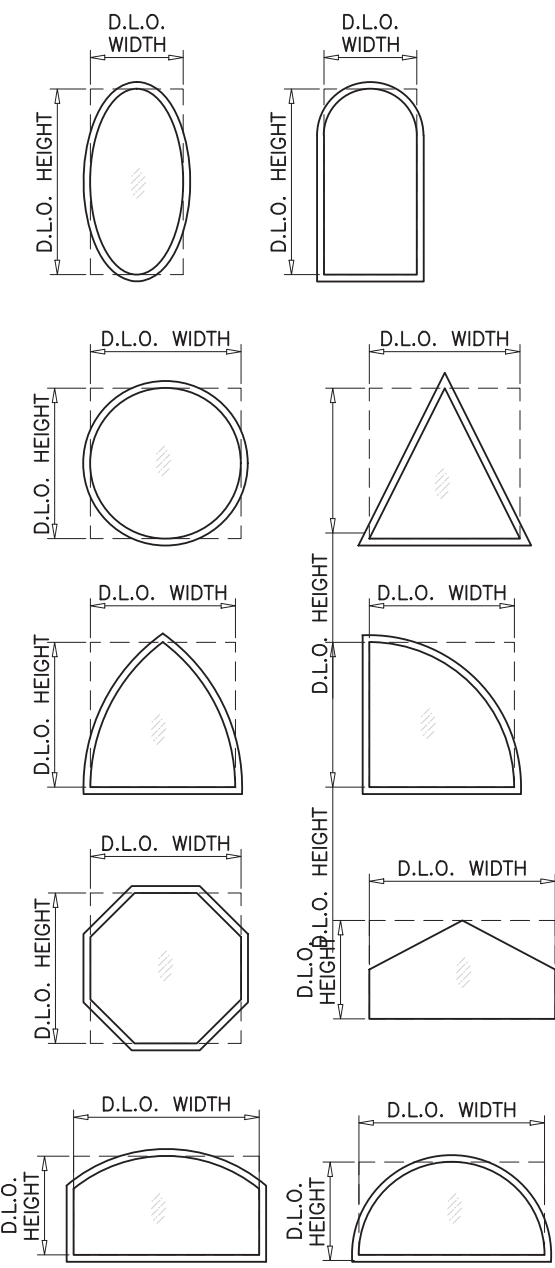

ALLOWABLE LOADS FOR ALTERNATE SHAPES AS SHOWN ABOVE OR SIMILAR CAN BE VERIFIED BY INSCRIBING PICTURE WINDOW SHAPE WITHIN SQUARE OR RECTANGLE AS SHOWN IN DOTTED LINES AND OBTAINING ALLOWABLE LOADS FROM THOSE SHAPES. SINGLE LITES MAY BE INSTALLED VERTICALLY AS SHOWN ABOVE OR HORIZONTALLY.

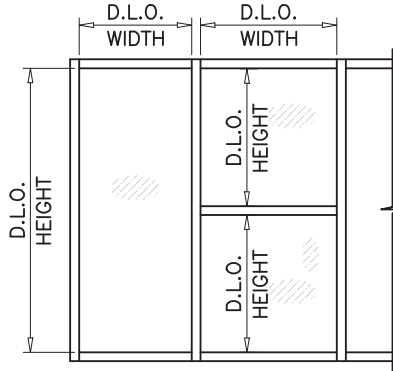

NOTE:
GLASS CAPACITIES ON THIS SHEET ARE
BASED ON ASTM E1300-09 (3 SEC. GUSTS)

Trulite

GLASS & ALUMINUM SOLUTIONS™
<http://www.trulite.com>
 403 WESTPARK COURT, Suite 201
 PEACHTREE CITY, GA 30269
 p. 800-432-8132

PRODUCT:
Resistor
3000R ALUMINUM
STOREFRONT WALL-LMI

Resistor
 PRODUCT SERIES

REVN	DATE/REMARKS
REV5	11.16.2023 UPDATE INTERLAYER

ENGINEER:



MCY ENGINEERING, INC.
 GLAZING CONSULTANT
 12781 Miramar Parkway #301
 Miramar, FL 33027
 P: (305) 271-0117
 Email: mcy@mcycyengineering.com
www.MCYEngineering.com

STAMP:

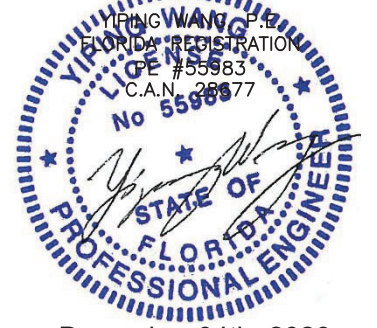

December 04th, 2023

PRODUCT CONTROL APPROVAL:

PRODUCT RENEWED
 As complying with the Florida
 Building Code
NOA-No. 24-0129.02
Expiration Date: 03/18/2029

By: 
 Miami-Dade Product Control

DRAWN: James	DRAWING No:
DATE: 11.16.2023	4 OF 14
DWG: AD18-17	

DESIGN LOAD CAPACITY – PSF								
NOMINAL DIMS.		GLASS TYPE 'A'	GLASS TYPE 'B'	GLASS TYPE 'C'	GLASS TYPE 'G'	GLASS TYPE 'J'		
D.L.O. WIDTH	D.L.O. HEIGHT	EXT. (+) INT. (-)	EXT. (+) INT. (-)	EXT. (+) INT. (-)	EXT. (+) INT. (-)	EXT. (+) INT. (-)	EXT. (+) INT. (-)	
36"	87"	87.0	100.0	100.0	70	85	65	75
39"		87.0	100.0	100.0	70	85	65	75
41.5"		87.0	100.0	100.0	70	85	65	75
45"		87.0	100.0	100.0	70	85	-	-
48"		87.0	100.0	100.0	-	-	-	-
51"		87.0	100.0	100.0	-	-	-	-
54"		87.0	100.0	100.0	-	-	-	-
57"		87.0	100.0	100.0	-	-	-	-
60"		87.0	100.0	100.0	-	-	-	-
63"		87.0	100.0	100.0	-	-	-	-
66"		87.0	100.0	100.0	-	-	-	-
69"	87.0	100.0	100.0	-	-	-	-	
72"	87.0	100.0	100.0	-	-	-	-	
36"	90"	87.0	100.0	100.0	70	85	65	75
39"		87.0	100.0	100.0	70	85	65	75
42"		87.0	100.0	100.0	70	85	-	-
45"		87.0	100.0	100.0	70	85	-	-
48"		87.0	100.0	100.0	-	-	-	-
51"		87.0	100.0	100.0	-	-	-	-
54"		87.0	100.0	100.0	-	-	-	-
57"		87.0	100.0	100.0	-	-	-	-
60"		87.0	100.0	100.0	-	-	-	-
63"		87.0	100.0	100.0	-	-	-	-
66"		87.0	100.0	100.0	-	-	-	-
69"	87.0	100.0	100.0	-	-	-	-	
72"	87.0	100.0	100.0	-	-	-	-	
36"	92"	87.0	100.0	100.0	70	85	65	75
39.25"		87.0	100.0	100.0	70	85	65	75
42"		87.0	100.0	100.0	70	85	-	-
45.25"		87.0	100.0	100.0	70	85	-	-
48"		87.0	100.0	100.0	-	-	-	-
51"		87.0	100.0	100.0	-	-	-	-
54"		87.0	100.0	100.0	-	-	-	-
57"		87.0	100.0	100.0	-	-	-	-
60"		87.0	100.0	100.0	-	-	-	-
63"		87.0	100.0	100.0	-	-	-	-
66"		87.0	100.0	100.0	-	-	-	-
69"	87.0	100.0	100.0	-	-	-	-	
72"	87.0	100.0	100.0	-	-	-	-	
36"	96"	87.0	100.0	100.0	70	85	65	75
37.6"		87.0	100.0	100.0	70	85	65	75
42"		87.0	100.0	100.0	70	85	-	-
45"		87.0	100.0	100.0	-	-	-	-
48"		87.0	100.0	100.0	-	-	-	-
51"		87.0	100.0	100.0	-	-	-	-
54"		87.0	100.0	100.0	-	-	-	-
57"		87.0	100.0	100.0	-	-	-	-
60"		87.0	100.0	100.0	-	-	-	-
63"		87.0	100.0	100.0	-	-	-	-
66"		87.0	100.0	100.0	-	-	-	-
69"	87.0	100.0	100.0	-	-	-	-	

DESIGN LOAD CAPACITY – PSF								
NOMINAL DIMS.		GLASS TYPE 'A'	GLASS TYPE 'B'	GLASS TYPE 'C'	GLASS TYPE 'G'	GLASS TYPE 'J'		
D.L.O. WIDTH	D.L.O. HEIGHT	EXT. (+) INT. (-)	EXT. (+) INT. (-)	EXT. (+) INT. (-)	EXT. (+) INT. (-)	EXT. (+) INT. (-)	EXT. (+) INT. (-)	
36"	99"	87.0	100.0	100.0	70	85	65	75
39"		87.0	100.0	100.0	70	85	-	-
42"		87.0	100.0	100.0	70	85	-	-
45"		87.0	100.0	100.0	-	-	-	-
48"		87.0	100.0	100.0	-	-	-	-
51"		87.0	100.0	100.0	-	-	-	-
54"		87.0	100.0	100.0	-	-	-	-
57"		87.0	100.0	100.0	-	-	-	-
60"		87.0	100.0	100.0	-	-	-	-
63"		87.0	100.0	100.0	-	-	-	-
66"		87.0	100.0	100.0	-	-	-	-
35"	102"	87.0	100.0	100.0	70	85	65	75
39"		87.0	100.0	100.0	70	85	-	-
42"		87.0	100.0	100.0	-	-	-	-
45"		87.0	100.0	100.0	-	-	-	-
48"		87.0	100.0	100.0	-	-	-	-
51"		87.0	100.0	100.0	-	-	-	-
54"		87.0	100.0	100.0	-	-	-	-
57"		87.0	100.0	100.0	-	-	-	-
60"		87.0	100.0	100.0	-	-	-	-
63"		87.0	100.0	100.0	-	-	-	-
66"		87.0	100.0	100.0	-	-	-	-
35"	105"	87.0	100.0	100.0	70	85	65	75
39"		87.0	100.0	100.0	70	85	-	-
42"		87.0	100.0	100.0	-	-	-	-
45"		87.0	100.0	100.0	-	-	-	-
48"		87.0	100.0	100.0	-	-	-	-
51"		87.0	100.0	100.0	-	-	-	-
54"		87.0	100.0	100.0	-	-	-	-
57"		87.0	100.0	100.0	-	-	-	-
60"		87.0	100.0	100.0	-	-	-	-
63"		87.0	100.0	100.0	-	-	-	-
66"		87.0	100.0	100.0	-	-	-	-
36"	108"	87.0	100.0	100.0	70	85	-	-
39"		87.0	100.0	100.0	-	-	-	-
42"		87.0	100.0	100.0	-	-	-	-
45"		87.0	100.0	100.0	-	-	-	-
48"		87.0	100.0	100.0	-	-	-	-
51"		87.0	100.0	100.0	-	-	-	-
54"		87.0	100.0	100.0	-	-	-	-
57"		87.0	100.0	100.0	-	-	-	-
60"		87.0	100.0	100.0	-	-	-	-
63"		87.0	100.0	100.0	-	-	-	-
66"		87.0	100.0	100.0	-	-	-	-
36"	111"	87.0	100.0	100.0	70	85	-	-
39"		87.0	100.0	100.0	-	-	-	-
42"		87.0	100.0	100.0	-	-	-	-
45"		87.0	100.0	100.0	-	-	-	-
48"		87.0	100.0	100.0	-	-	-	-
51"		87.0	100.0	100.0	-	-	-	-
54"		87.0	100.0	100.0	-	-	-	-
57"		87.0	100.0	100.0	-	-	-	-
60"		87.0	100.0	100.0	-	-	-	-
63"		87.0	100.0	100.0	-	-	-	-
66"		87.0	100.0	100.0	-	-	-	-
69"	87.0	100.0	100.0	-	-	-	-	

DESIGN LOAD CAPACITY – PSF									
NOMINAL DIMS.		GLASS TYPE 'A'	GLASS TYPE 'B'	GLASS TYPE 'C'	GLASS TYPE 'G'	GLASS TYPE 'J'			
D.L.O. WIDTH	D.L.O. HEIGHT	EXT. (+) INT. (-)	EXT. (+) INT. (-)	EXT. (+) INT. (-)	EXT. (+) INT. (-)	EXT. (+) INT. (-)	EXT. (+) INT. (-)		
36"	114"	87.0	100.0	100.0	70	85	-	-	
39"		87.0	100.0	100.0	-	-	-	-	
42"		87.0	100.0	100.0	-	-	-	-	
45"		87.0	100.0	100.0	-	-	-	-	
48"		87.0	100.0	100.0	-	-	-	-	
51"		87.0	100.0	100.0	-	-	-	-	
54"		87.0	100.0	100.0	-	-	-	-	
56"		87.0	100.0	97.9	-	-	-	-	
57"		87.0	100.0	-	-	-	-	-	
36"	117"	87.0	100.0	100.0	-	-	-	-	
39"		87.0	100.0	100.0	-	-	-	-	
42"		87.0	100.0	100.0	-	-	-	-	
45"		87.0	100.0	100.0	-	-	-	-	
48"		87.0	100.0	100.0	-	-	-	-	
51"	120"	87.0	100.0	100.0	-	-	-	-	
54"		87.0	100.0	100.0	-	-	-	-	
36"		120"	87.0	100.0	100.0	-	-	-	-
39"			87.0	100.0	100.0	-	-	-	-
42"			87.0	100.0	100.0	-	-	-	-
45"			87.0	100.0	100.0	-	-	-	-
48"			87.0	100.0	100.0	-	-	-	-
51"	87.0		100.0	100.0	-	-	-	-	
54"	87.0		98.5	98.5	-	-	-	-	
57"	87.0		98.5	98.5	-	-	-	-	

NOTE:
GLASS CAPACITIES ON THIS SHEET ARE
BASED ON ASTM E1300-09 (3 SEC. GUSTS)

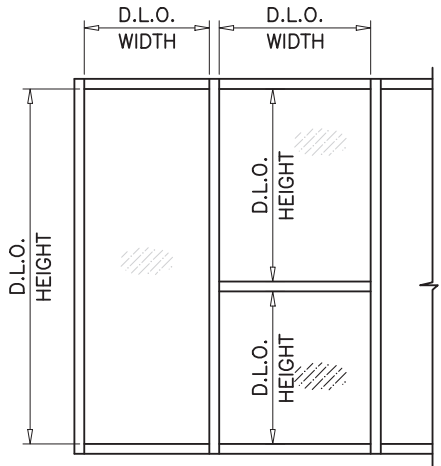

Trulite
GLASS & ALUMINUM SOLUTIONS™
http://www.trulite.com
403 WESTPARK COURT, Suite 201
PEACHTREE CITY, GA 30269
p. 800-432-8132

PRODUCT:
Resistor
3000R ALUMINUM
STOREFRONT WALL-LMI
Resistor
PRODUCT SERIES

REV#	DATE/REMARKS
REV5	11.16.2023 UPDATE INTERLAYER

ENGINEER:
MCY ENGINEERING, INC.
GLAZING CONSULTANT
12781 Miramar Parkway #301
Miramar, FL 33027
P: (305) 271-0117
Email: mcy@mcyengineering.com
www.MCYEngineering.com

STAMP:
YONG WANG, P.E.
FLORIDA REGISTRATION
NO. 55983
C.A.N. 28877
STATE OF FLORIDA
PROFESSIONAL ENGINEER
December 04th, 2023

PRODUCT CONTROL APPROVAL:
PRODUCT RENEWED
As complying with the Florida
Building Code
NOA-No. **24-0129.02**
Expiration Date: **03/18/2029**
By: *Manuel Perez*
Miami-Dade Product Control

DRAWN: James	DRAWING No:
DATE: 11.16.2023	5 OF 14
DWG: AD18-17	

MULLION & JAMB W/REINF. LOAD CAPACITY – PSF				
NOMINAL DIMS.		WITHOUT REINFORCING		
WIDTH (W)	FRAME HEIGHT	EXT.(+)	INT.(–)	
24"	78"	65.0	80.0	
30"		65.0	80.0	
36"		65.0	80.0	
42"		65.0	80.0	
48"		65.0	80.0	
54"		65.0	80.0	
60"		65.0	74.0	
66"		65.0	67.0	
72"		62.0	62.0	
24"		84"	65.0	80.0
30"	65.0		80.0	
36"	65.0		80.0	
42"	65.0		80.0	
48"	65.0		80.0	
54"	65.0		72.0	
60"	65.0		65.0	
66"	59.0		59.0	
24"	90"		65.0	80.0
30"			65.0	80.0
36"		65.0	80.0	
42"		65.0	80.0	
48"		65.0	71.0	
54"		63.0	63.0	
60"		57.0	57.0	
24"		96"	65.0	80.0
30"			65.0	80.0
36"			65.0	80.0
42"	65.0		71.0	
48"	62.0		62.0	
54"	55.0		55.0	
60"	50.0		50.0	

MULLION & JAMB W/O REINF. LOAD CAPACITY – PSF			
NOMINAL DIMS.		WITH REINFORCING	
WIDTH (W)	FRAME HEIGHT	EXT.(+)	INT.(–)
24"	78"	85.0	105.0
30"		85.0	105.0
36"		85.0	105.0
42"		85.0	105.0
48"		85.0	105.0
54"		85.0	105.0
60"		85.0	104.0
66"		85.0	95.0
72"		85.0	87.0
24"		84"	85.0
30"	85.0		105.0
36"	85.0		105.0
42"	85.0		105.0
48"	85.0		105.0
54"	85.0		105.0
60"	85.0		97.0
66"	85.0		88.0
72"	81.0		81.0
24"	90"		85.0
30"		85.0	105.0
36"		85.0	105.0
42"		85.0	105.0
48"		85.0	105.0
54"		85.0	100.0
60"		85.0	90.0
66"		82.0	82.0
72"		75.0	75.0
24"		96"	85.0
30"	85.0		105.0
36"	85.0		105.0
42"	85.0		105.0
48"	85.0		105.0
54"	85.0		94.0
60"	85.0		85.0
66"	77.0		77.0
72"	71.0		71.0
24"	102"		85.0
30"		85.0	105.0
36"		85.0	105.0
42"		85.0	105.0
48"		85.0	100.0
54"		85.0	88.0
60"		80.0	80.0
66"		72.0	72.0

MULLION & JAMB W/O REINF. LOAD CAPACITY – PSF					
NOMINAL DIMS.		WITH REINFORCING			
WIDTH (W)	FRAME HEIGHT	EXT.(+)	INT.(–)		
24"	108"	85.0	105.0		
30"		85.0	105.0		
36"		85.0	105.0		
42"		85.0	105.0		
48"		85.0	94.0		
54"		84.0	84.0		
60"		75.0	75.0		
24"		114"	85.0	105.0	
30"			85.0	105.0	
36"			85.0	105.0	
42"	85.0		102.0		
48"	85.0		89.0		
54"	79.0		79.0		
60"	71.0		71.0		
24"	120"		85.0	105.0	
30"			85.0	105.0	
36"			85.0	105.0	
42"		85.0	97.0		
48"		83.0	85.0		
54"		76.0	75.0		
36"		126"	85.0	105.0	
42"			85.0	90.0	
48"			79.0	79.0	
54"			70.0	70.0	
36"	132"		85.0	96.0	
42"			82.0	82.0	
48"			72.0	72.0	
36"			138"	85.0	87.0
42"				75.0	75.0
48"				66.0	66.0
36"		144"		78.0	78.0
42"				67.0	67.0
48"				58.0	58.0

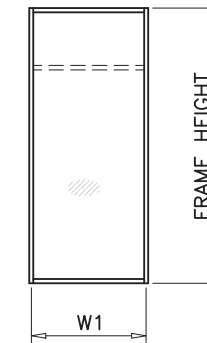

WIDTH (W) = W1 (JAMB)

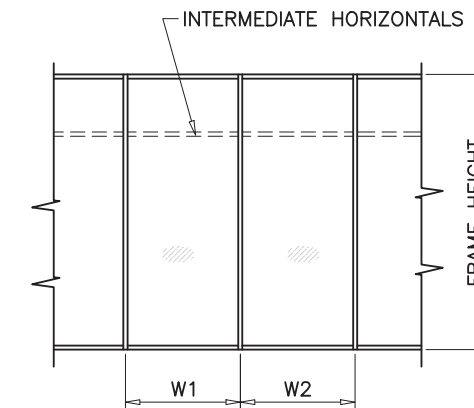

WIDTH (W) = $\frac{W1 + W2}{2}$

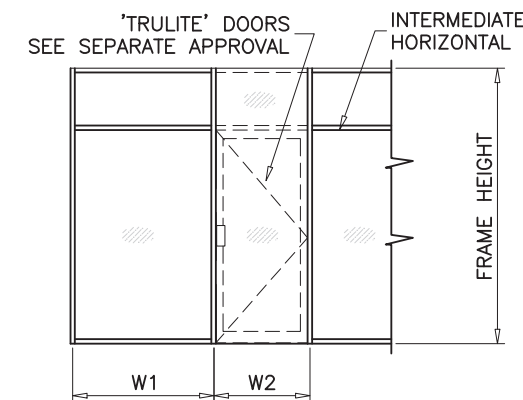

WIDTH (W) = $\frac{W1 + W2}{2}$

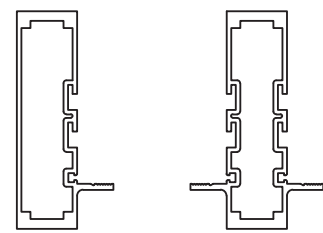

	Ix IN ⁴	Sx IN ³
3001R	4.0776	1.7355
3002R	4.2973	1.7729

WITHOUT REINFORCING

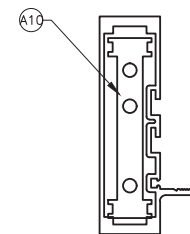

	Ix IN ⁴	Sx IN ³
3001R	4.0776	1.7355
3104R	2.967	1.4249
TOTAL	6.7912	

WITH ALUM. REINFORCING

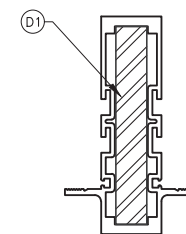

	Ix IN ⁴	Sx IN ³
3002R	4.2973	1.7729
STL. BAR	9.6670	(IN ALUM.)
TOTAL	13.964	

WITH STEEL REINFORCING



GLASS & ALUMINUM SOLUTIONS™

http://www.trulite.com

403 WESTPARK COURT, Suite 201
PEACHTREE CITY, GA 30269
p. 800-432-8132

PRODUCT:

Resistor
3000R ALUMINUM
STOREFRONT WALL-LMI



REV#	DATE/REMARKS
REV5	11.16.2023 UPDATE INTERLAYER

ENGINEER:



MCY ENGINEERING, INC.
GLAZING CONSULTANT

12781 Miramar Parkway #301
Miramar, FL 33027
P: (305) 271-0117
Email: mcy@mcyengineering.com
www.MCYEngineering.com

STAMP:



December 04th, 2023

PRODUCT CONTROL APPROVAL:

PRODUCT RENEWED
As complying with the Florida
Building Code
NOA-No. **24-0129.02**
Expiration Date: **03/18/2029**
By: *Manuel Perez*
Miami-Dade Product Control

DRAWN: James
DATE: 11.16.2023
DWG: AD18-17

DRAWING No:
6 OF 14

MULLION LOAD CAPACITY – PSF AT DOUBLE DOOR WITH/WITHOUT TRANSOM					
NOMINAL DIMS.				WITH REINFORCING	
WIDTH (W1)	WIDTH (W2)	HEIGHT (A)	HEIGHT (L)	EXT.(+)	INT.(-)
72"	30"	84"	108"	60.0	75.0
	36"			60.0	73.0
	42"			60.0	69.0
	48"			60.0	65.0
	54"			60.0	62.0
	60"			59.0	59.0
72"	30"	84"	114"	60.0	75.0
	42"			60.0	66.0
	48"			60.0	62.0
	54"			59.0	59.0
	60"			56.0	56.0
72"	30"	84"	120"	60.0	72.0
	36"			60.0	67.0
	42"			60.0	63.0
	54"			57.0	57.0
	60"			54.0	54.0
	72"			30"	84"
36"		60.0	65.0		
42"		60.0	61.0		
48"		58.0	58.0		
54"		54.0	54.0		
60"		51.0	51.0		
72"	30"	84"	132"	60.0	67.0
	36"			60.0	62.0
	42"			58.0	58.0
	48"			54.0	54.0
	60"			49.0	49.0
	72"			30"	84"
36"		59.0	59.0		
42"		52.0	52.0		
48"		49.0	49.0		
54"		46.0	46.0		
60"		45.0	45.0		
72"	30"	84"	144"	56.0	56.0
	36"			53.0	53.0
	48"			47.0	47.0
	54"			45.0	45.0

MULLION LOAD CAPACITY – PSF AT DOUBLE DOOR WITH/WITHOUT TRANSOM					
NOMINAL DIMS.				WITH REINFORCING	
WIDTH (W1)	WIDTH (W2)	HEIGHT (A)	HEIGHT (L)	EXT.(+)	INT.(-)
72"	30"	90"	114"	60.0	73.0
	36"			60.0	69.0
	42"			60.0	65.0
	48"			60.0	61.0
	54"			58.0	58.0
	60"			55.0	55.0
72"	30"	90"	120"	60.0	70.0
	36"			60.0	66.0
	42"			60.0	62.0
	48"			59.0	59.0
	54"			56.0	56.0
	60"			53.0	53.0
72"	30"	90"	126"	60.0	68.0
	36"			60.0	64.0
	42"			60.0	60.0
	48"			57.0	57.0
	54"			54.0	54.0
	60"			51.0	51.0
72"	30"	90"	132"	60.0	66.0
	36"			60.0	62.0
	42"			58.0	58.0
	48"			56.0	56.0
	54"			52.0	52.0
	60"			49.0	49.0
72"	30"	90"	138"	60.0	64.0
	36"			60.0	60.0
	42"			56.0	56.0
	48"			52.0	52.0
	54"			49.0	49.0
	60"			47.0	47.0
72"	30"	90"	144"	58.0	58.0
	36"			54.0	54.0
	42"			52.0	52.0
	48"			49.0	49.0
	54"			46.0	46.0

MULLION LOAD CAPACITY – PSF AT DOUBLE DOOR WITH TRANSOM					
NOMINAL DIMS.				WITH REINFORCING	
WIDTH (W1)	WIDTH (W2)	HEIGHT (A)	HEIGHT (L)	EXT.(+)	INT.(-)
72"	30"	96"	120"	60.0	69.0
	36"			60.0	65.0
	42"			60.0	61.0
	48"			58.0	58.0
	54"			55.0	55.0
	60"			52.0	52.0
72"	30"	96"	126"	60.0	67.0
	36"			60.0	63.0
	42"			59.0	59.0
	48"			56.0	56.0
	54"			53.0	53.0
	60"			50.0	50.0
72"	30"	96"	132"	60.0	65.0
	36"			60.0	61.0
	42"			57.0	57.0
	48"			54.0	54.0
	54"			51.0	51.0
	60"			49.0	49.0
72"	30"	96"	138"	60.0	63.0
	36"			59.0	59.0
	42"			55.0	55.0
	48"			52.0	52.0
	54"			49.0	49.0
	60"			47.0	47.0
72"	30"	96"	144"	60.0	60.0
	36"			56.0	56.0
	42"			53.0	53.0
	48"			50.0	50.0
	54"			48.0	48.0

ANCHORS TYPE	MAX. SHIM	TOTAL NO. OF ANCHORS AT DOOR MULLION HEAD	
		AT FIX. LITE	AT DOOR
AA	3/8"	4	4
BB	3/8"	3	3
A	3/8"	3	3
A	1/4"	2	3
B	3/8"	2	3
C	1/4"	2	3

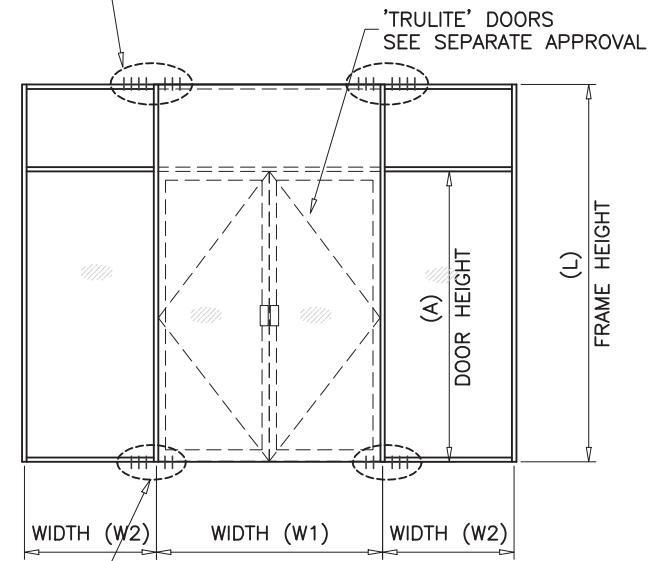

ANCHORS TYPE	MAX. SHIM	TOTAL NO. OF ANCHORS AT DOOR MULLION HEAD	
		AT FIX. LITE	AT DOOR
A	3/8"	3	2
B	3/8"	3	2

ANCHOR TYPE SEE SHEET 10

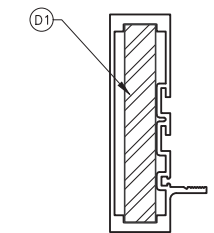

DOOR MULLION		
	1x 1IN^4	Sx 1IN^3
3001R	4.0776	1.7355
STL. BAR	9.6670	(IN ALUM.)
TOTAL	13.7446	



http://www.trulite.com
 403 WESTPARK COURT, Suite 201
 PEACHTREE CITY, GA 30269
 p. 800-432-8132

PRODUCT:
Resistor
3000R ALUMINUM
 STOREFRONT WALL-LMI
Resistor
 PRODUCT SERIES

REVN	DATE/REMARKS
REV5	11.16.2023 UPDATE INTERLAYER

ENGINEER:

MCY ENGINEERING, INC.
 GLAZING CONSULTANT
 12781 Miramar Parkway #301
 Miramar, FL 33027
 P: (305) 271-0117
 Email: mcy@mcyengineering.com
 www.MCYEngineering.com

STAMP:

 December 04th, 2023

PRODUCT CONTROL APPROVAL:
PRODUCT RENEWED
 As complying with the Florida Building Code
NOA-No. 24-0129.02
Expiration Date: 03/18/2029
 By: *Manuel Perez*
 Miami-Dade Product Control

DRAWN: James DRAWING No:
 DATE: 11.16.2023 **7 OF 14**
 DWG: AD18-17

ANCHOR LOAD CAPACITY – PSF EXT.(+) & INT.(-)															
NOMINAL DIMS.		3/8" SHIM			3/8" SHIM			3/8" SHIM			1/4" SHIM		3/8" SHIM		1/4"SHIM
WIDTH (W)	FRAME HEIGHT	ANCHOR TYPE 'AA'			ANCHOR TYPE 'BB'			ANCHOR TYPE 'A'			ANCHOR TYPE 'A'		ANCHOR TYPE 'B'		TYPE 'C'
		'AA2'	'AA3'	'AA4'	'BB2'	'BB3'	'BB4'	'A2'	'A3'	'A4'	'A2'	'A3'	'B2'	'B3'	'C2'
36"	78"	81.2	105.0	105.0	96.4	105.0	105.0	102.2	105.0	105.0	105.0	105.0	105.0	105.0	105.0
42"		69.6	104.4	105.0	82.6	105.0	105.0	87.6	105.0	105.0	105.0	105.0	105.0	105.0	105.0
48"		60.9	91.4	105.0	72.3	105.0	105.0	76.6	105.0	105.0	95.1	105.0	105.0	105.0	105.0
54"		54.2	81.2	105.0	64.3	96.4	105.0	68.1	102.2	105.0	84.5	105.0	100.6	105.0	105.0
60"		48.7	73.1	97.5	57.8	86.8	105.0	61.3	91.9	105.0	76.1	105.0	90.6	105.0	105.0
66"		44.3	66.5	88.6	52.6	78.9	105.0	55.7	83.6	105.0	69.1	103.7	82.3	105.0	102.5
72"		40.6	60.9	81.2	48.2	72.3	96.4	51.1	76.6	102.2	63.4	95.1	75.5	105.0	93.9
36"	84"	75.4	105.0	105.0	89.5	105.0	105.0	94.9	105.0	105.0	105.0	105.0	105.0	105.0	105.0
42"		64.7	97.0	105.0	76.7	105.0	105.0	81.3	105.0	105.0	100.9	105.0	105.0	105.0	105.0
48"		56.6	84.9	105.0	67.1	100.7	105.0	71.1	105.0	105.0	88.3	105.0	105.0	105.0	105.0
54"		50.3	75.4	100.6	59.7	89.5	105.0	63.2	94.9	105.0	78.5	105.0	93.5	105.0	105.0
60"		45.3	67.9	90.5	53.7	80.6	105.0	56.9	84.4	105.0	70.6	105.0	84.1	105.0	104.7
66"		41.1	61.7	83.3	48.8	73.2	97.7	51.7	77.6	103.5	64.2	96.3	76.5	105.0	95.2
72"		37.7	56.6	75.4	44.8	67.1	89.5	47.4	71.1	94.9	58.9	88.3	70.1	105.0	87.2
36"	90"	70.4	105.0	105.0	83.6	105.0	105.0	88.5	105.0	105.0	105.0	105.0	105.0	105.0	105.0
42"		60.3	90.5	105.0	71.6	105.0	105.0	75.9	105.0	105.0	94.2	105.0	105.0	105.0	105.0
48"		52.8	79.2	105.0	62.7	94.0	105.0	66.4	99.6	105.0	82.4	105.0	98.1	105.0	105.0
54"		46.9	70.4	93.9	55.7	83.6	105.0	59.0	88.5	105.0	73.2	105.0	87.2	105.0	105.0
60"		42.2	63.4	84.5	50.1	75.2	100.3	53.1	79.7	105.0	65.9	98.9	78.5	105.0	97.7
66"		38.4	57.6	76.8	45.6	68.4	91.2	48.3	72.4	96.6	59.9	89.9	71.4	105.0	88.8
72"		35.2	52.8	70.4	41.8	62.7	83.6	44.3	66.4	88.5	54.9	82.4	65.4	98.1	81.4
36"	96"	60.0	99.0	105.0	78.3	105.0	105.0	83.0	105.0	105.0	103.0	105.0	105.0	105.0	105.0
42"		56.6	84.9	105.0	67.1	100.7	105.0	71.1	105.0	105.0	88.3	105.0	105.0	105.0	105.0
48"		49.5	74.3	99.0	58.8	88.1	105.0	62.3	93.4	105.0	77.3	105.0	92.0	105.0	105.0
54"		44.0	66.0	88.0	52.2	78.3	104.4	55.3	83.0	105.0	68.7	103.0	81.8	105.0	101.8
60"		39.6	59.4	79.2	47.0	70.5	94.0	49.8	74.7	99.6	61.8	92.7	73.6	105.0	91.6
66"		36.0	54.0	72.0	42.7	64.1	85.1	45.3	67.9	90.5	56.2	84.3	66.9	100.4	83.3
72"		33.0	49.5	66.0	39.2	58.8	78.3	41.5	62.3	83.0	51.5	77.3	61.3	92.0	76.3
36"	102"	62.1	93.2	105.0	73.7	105.0	105.0	78.1	105.0	105.0	96.9	105.0	105.0	105.0	105.0
42"		53.2	79.9	105.0	63.2	94.8	105.0	67.0	100.4	105.0	83.1	105.0	99.0	105.0	105.0
48"		46.6	69.9	93.2	55.3	82.9	105.0	58.9	87.9	105.0	72.7	105.0	86.6	105.0	105.0
54"		41.4	62.1	82.8	49.2	73.7	98.3	52.1	78.1	104.2	64.6	96.9	77.0	105.0	95.8
60"		37.3	55.9	74.5	44.2	66.4	88.5	46.9	70.3	93.7	58.2	87.2	69.3	103.9	86.2
66"		33.9	50.8	67.8	40.2	60.3	80.4	42.6	63.9	85.2	52.9	79.3	63.0	94.5	78.4
36"		108"	58.7	88.0	105.0	69.6	104.4	105.0	73.8	105.0	105.0	91.6	105.0	105.0	105.0
42"	50.3		75.4	100.6	59.7	89.5	105.0	63.2	94.9	105.0	78.5	105.0	93.5	105.0	105.0
48"	44.0		66.0	88.0	52.2	78.3	104.4	55.3	83.0	105.0	68.7	103.0	81.8	105.0	101.8
54"	39.1		58.7	78.2	46.4	69.6	92.8	49.2	73.8	98.4	61.0	91.6	72.7	105.0	90.5
60"	35.2		52.8	70.4	41.8	62.7	83.6	44.3	66.4	88.5	54.9	82.4	65.4	98.1	81.4
36"	114"	55.6	83.4	105.0	66.0	98.9	105.0	69.9	104.8	105.0	86.7	105.0	103.3	105.0	105.0
42"		47.6	71.5	95.3	56.5	84.8	105.0	59.9	89.9	105.0	74.3	105.0	88.5	105.0	105.0
48"		41.7	62.5	83.4	49.5	74.2	98.9	52.4	78.6	104.8	65.1	97.6	77.5	105.0	96.4
54"		37.4	55.6	74.1	44.0	66.0	88.0	46.6	69.9	93.2	57.8	86.7	68.9	103.3	85.7
60"		33.3	50.0	66.7	39.6	59.4	79.2	41.9	62.9	83.9	52.0	78.1	62.0	93.0	77.1
36"	120"	52.8	79.2	105.0	62.7	94.0	105.0	66.4	99.6	105.0	82.4	105.0	98.1	105.0	105.0
42"		45.3	67.9	90.5	53.7	80.6	105.0	56.9	85.4	105.0	70.6	105.0	84.1	105.0	104.7
48"		39.6	59.4	79.2	47.0	70.5	94.0	49.8	74.7	99.6	61.8	92.7	73.6	105.0	91.6
54"		35.2	52.8	70.4	41.8	62.7	83.6	44.3	66.4	88.5	54.9	82.4	65.4	98.1	81.4

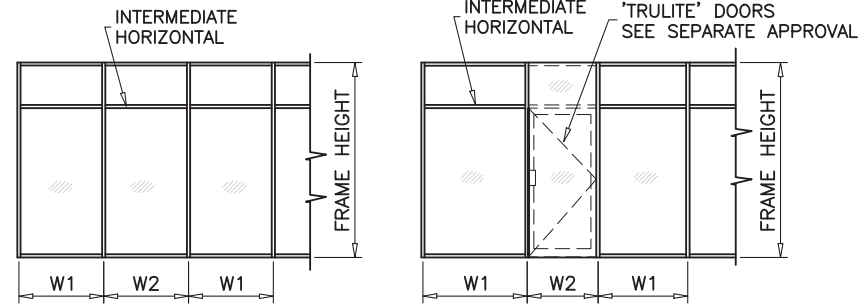

WIDTH (W) = W1 AT FRAME JAMB

WIDTH (W) = $\frac{W2 + W1}{2}$ AT FRAME MULLION

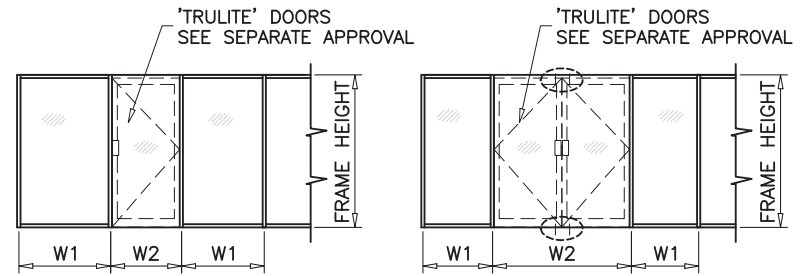

WIDTH (W) = W1 AT FRAME JAMB

WIDTH (W) = $\frac{W2 + W1}{4} + \frac{W1}{2}$ AT FRAME MULLION

ANCHORS TYPES:SEE SHEET 12 FOR DESCRIPTION
AA2 = (2) ANCHORS TYPE 'AA' AT EACH SIDE OF MULLION OR JAMB
A2 = (2) ANCHORS TYPE 'A' AT EACH SIDE OF MULLION OR JAMB
B2 = (2) ANCHORS TYPE 'B' AT EACH SIDE OF MULLION OR JAMB
BB2 = (2) ANCHORS TYPE 'BB' AT EACH SIDE OF MULLION OR JAMB
C2 = (2) ANCHORS TYPE 'C' AT EACH SIDE OF MULLION OR JAMB
AA3 = (3) ANCHORS TYPE 'AA' AT EACH SIDE OF MULLION OR JAMB
A3 = (3) ANCHORS TYPE 'A' AT EACH SIDE OF MULLION OR JAMB
B3 = (3) ANCHORS TYPE 'B' AT EACH SIDE OF MULLION OR JAMB
BB3 = (3) ANCHORS TYPE 'BB' AT EACH SIDE OF MULLION OR JAMB
AA4 = (4) ANCHORS TYPE 'AA' AT EACH SIDE OF MULLION OR JAMB
A4 = (4) ANCHORS TYPE 'A' AT EACH SIDE OF MULLION OR JAMB
BB4 = (4) ANCHORS TYPE 'BB' AT EACH SIDE OF MULLION OR JAMB
ALL OTHER ANCHORS TO BE SPACED AS PER ELEVATION.

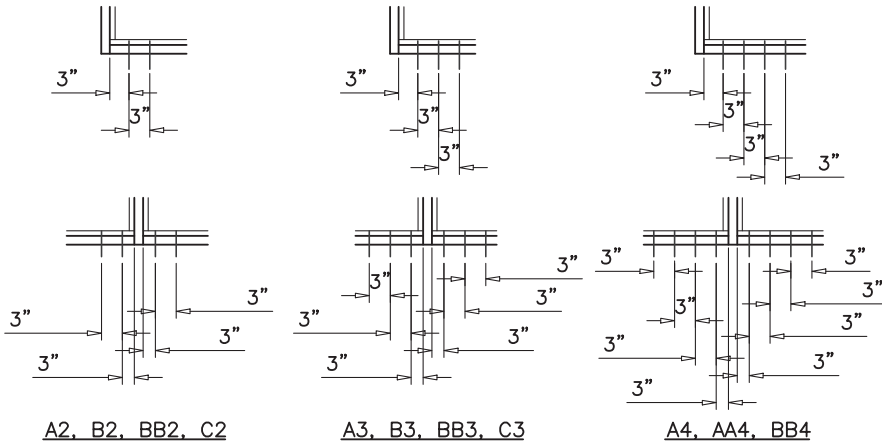

ANCHOR TYPE SEE SHEET 10

Trulite
GLASS & ALUMINUM SOLUTIONS™
http://www.trulite.com
403 WESTPARK COURT, Suite 201
PEACHTREE CITY, GA 30269
p. 800-432-8132

PRODUCT:
Resistor
3000R ALUMINUM
STOREFRONT WALL-LMI
Resistor
PRODUCT SERIES

REV#	DATE/REMARKS
REV5	11.16.2023 UPDATE INTERLAYER

ENGINEER:
MCY ENGINEERING, INC.
GLAZING CONSULTANT
12781 Miramar Parkway #301
Miramar, FL 33027
P: (305) 271-0117
Email: mcy@mcyengineering.com
www.MCYEngineering.com

STAMP:
December 04th, 2023

PRODUCT CONTROL APPROVAL:
PRODUCT RENEWED
As complying with the Florida Building Code
NOA-No. **24-0129.02**
Expiration Date: **03/18/2029**
By: *Manuel Perez*
Miami-Dade Product Control

DRAWN: James	DRAWING No:
DATE: 11.16.2023	8 OF 14
DWG: AD18-17	

ANCHOR LOAD CAPACITY - PSF EXT.(+) & INT.(-)															
NOMINAL DIMS.		3/8" SHIM			3/8" SHIM			3/8" SHIM			1/4" SHIM		3/8" SHIM		1/4"SHIM
		ANCHOR TYPE 'AA'			ANCHOR TYPE 'BB'			ANCHOR TYPE 'A'			ANCHOR TYPE 'A'		ANCHOR TYPE 'B'		TYPE 'C'
WIDTH (W)	FRAME HEIGHT	'AA2'	'AA3'	'AA4'	'BB2'	'BB3'	'BB4'	'A2'	'A3'	'A4'	'A2'	'A3'	'B2'	'B3'	'C2'
36"	126"	50.3	75.4	100.6	59.7	89.5	105.0	63.2	94.9	105.0	78.5	105.0	93.5	105.0	105.0
42"		43.1	64.7	86.2	51.2	76.7	102.3	54.2	81.3	105.0	67.3	100.9	80.1	105.0	99.7
48"		37.7	56.6	75.4	44.8	67.1	89.5	47.4	71.1	94.9	58.9	88.3	70.1	105.0	87.2
54"		33.5	50.3	67.0	39.8	59.7	79.6	42.2	63.2	84.3	52.3	78.5	62.3	93.5	77.5
36"	132"	48.0	72.0	96.0	57.0	85.5	105.0	60.4	90.5	105.0	74.9	105.0	89.2	105.0	105.0
42"		41.1	61.7	82.3	48.8	73.2	97.7	51.7	77.6	103.5	64.2	96.3	76.5	105.0	95.2
48"		36.0	54.0	72.0	42.7	64.1	85.5	45.3	67.9	90.5	56.21	84.3	66.9	100.4	83.3
36"	138"	45.9	68.9	91.8	54.5	81.7	105.0	57.7	86.6	105.0	71.7	105.0	85.3	105.0	105.0
42"		39.4	59.0	78.7	46.7	70.1	93.4	49.5	74.2	99.0	61.9	92.1	73.1	105.0	91.0
48"		34.4	51.7	68.9	40.9	61.3	81.7	43.3	65.0	86.6	53.7	80.6	64.0	96.0	79.7
36"	144"	44.0	66.0	88.0	52.2	78.3	104.4	55.3	83.0	105.0	68.7	103.0	81.8	105.0	101.8
42"		37.7	56.6	75.4	44.8	67.1	89.5	47.4	71.1	94.9	58.9	88.3	70.1	105.0	87.2
48"		33.0	49.5	66.0	39.2	58.8	78.3	41.5	62.3	83.0	51.5	77.3	61.3	92.0	76.3

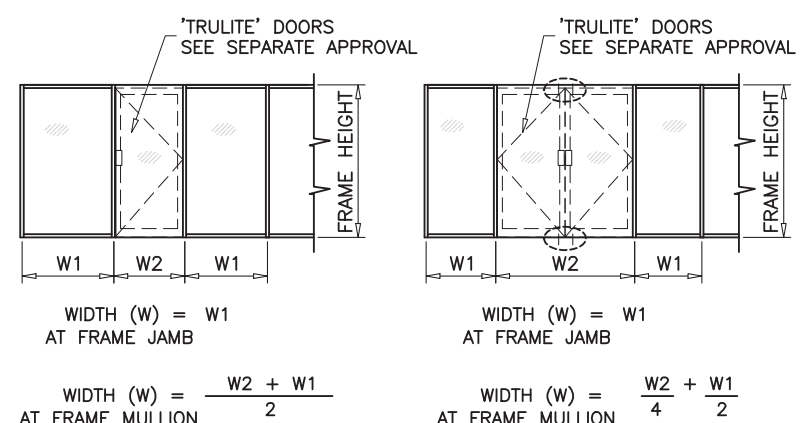
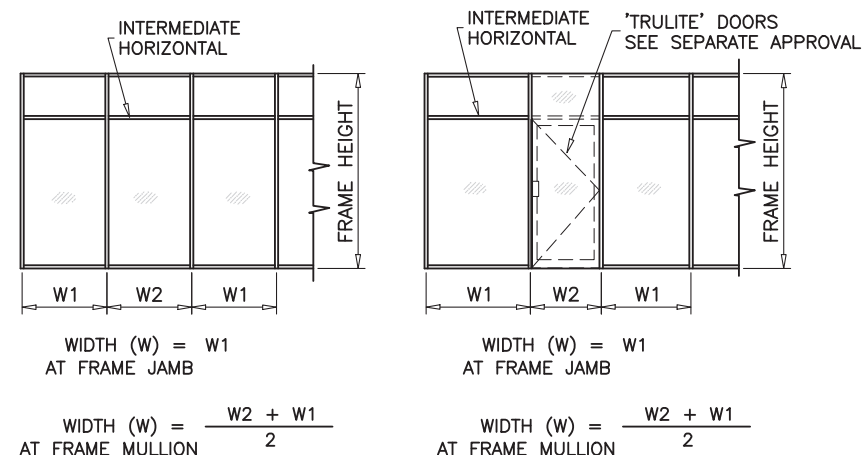

ANCHORS TYPES:SEE SHEET 12 FOR DESCRIPTION

AA2 = (2) ANCHORS TYPE 'AA' AT EACH SIDE OF MULLION OR JAMB
A2 = (2) ANCHORS TYPE 'A' AT EACH SIDE OF MULLION OR JAMB
B2 = (2) ANCHORS TYPE 'B' AT EACH SIDE OF MULLION OR JAMB
BB2 = (2) ANCHORS TYPE 'BB' AT EACH SIDE OF MULLION OR JAMB
C2 = (2) ANCHORS TYPE 'C' AT EACH SIDE OF MULLION OR JAMB
AA3 = (3) ANCHORS TYPE 'AA' AT EACH SIDE OF MULLION OR JAMB
A3 = (3) ANCHORS TYPE 'A' AT EACH SIDE OF MULLION OR JAMB
B3 = (3) ANCHORS TYPE 'B' AT EACH SIDE OF MULLION OR JAMB
BB3 = (3) ANCHORS TYPE 'BB' AT EACH SIDE OF MULLION OR JAMB
AA4 = (4) ANCHORS TYPE 'AA' AT EACH SIDE OF MULLION OR JAMB
A4 = (4) ANCHORS TYPE 'A' AT EACH SIDE OF MULLION OR JAMB
BB4 = (4) ANCHORS TYPE 'BB' AT EACH SIDE OF MULLION OR JAMB
ALL OTHER ANCHORS TO BE SPACED AS PER ELEVATION.

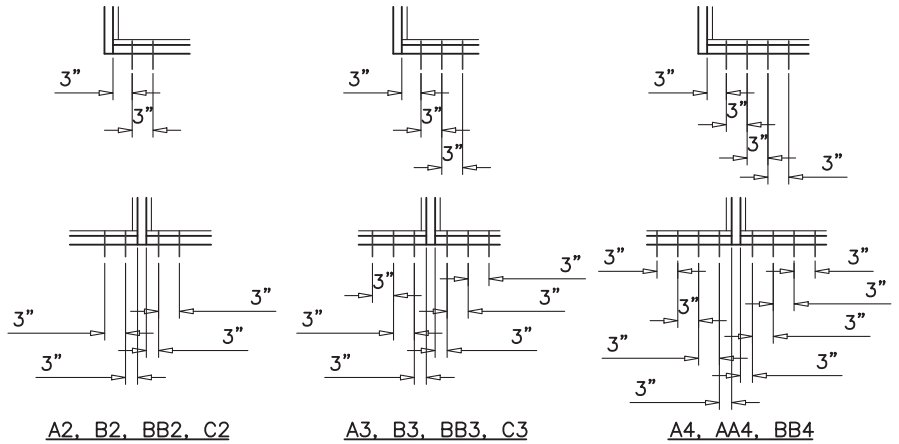

ANCHOR TYPE SEE SHEET 10

Trulite
GLASS & ALUMINUM SOLUTIONS™
http://www.trulite.com
403 WESTPARK COURT, Suite 201
PEACHTREE CITY, GA 30269
p. 800-432-8132

PRODUCT:

Resistor
3000R ALUMINUM
STOREFRONT WALL-LMI

Resistor
PRODUCT SERIES

REVN	DATE/REMARKS
REV5	11.16.2023 UPDATE INTERLAYER

ENGINEER:

MCY ENGINEERING, INC.
GLAZING CONSULTANT
12781 Miramar Parkway #301
Miramar, FL 33027
P: (305) 271-0117
Email: mcy@mcycengineering.com
www.MCYEngineering.com

STAMP:

December 04th, 2023

PRODUCT CONTROL APPROVAL:

PRODUCT RENEWED
As complying with the Florida Building Code
NOA-No. **24-0129.02**
Expiration Date: **03/18/2029**
By: *Manuel Perez*
Miami-Dade Product Control

DRAWN: James	DRAWING No:
DATE: 11.16.2023	9 OF 14
DWG: AD18-17	

PRODUCT:

Resistor 3000R ALUMINUM STOREFRONT WALL-LMI

Resistor
PRODUCT SERIES

REVN	DATE/REMARKS
REV5	11.16.2023 UPDATE INTERLAYER

ENGINEER:

MCY ENGINEERING, INC.
GLAZING CONSULTANT

12781 Miramar Parkway #301
Miramar, FL 33027
P: (305) 271-0117
Email: mcy@mcyengineering.com
www.MCYEngineering.com

STAMP:



December 04th, 2023

PRODUCT CONTROL APPROVAL:

PRODUCT RENEWED
As complying with the Florida
Building Code

NOA-No. **24-0129.02**

Expiration Date: **03/18/2029**

By: *Manuel Perez*
Miami-Dade Product Control

DRAWN: James

DATE: 11.16.2023

DWG: AD18-17

DRAWING No:

10 OF 14

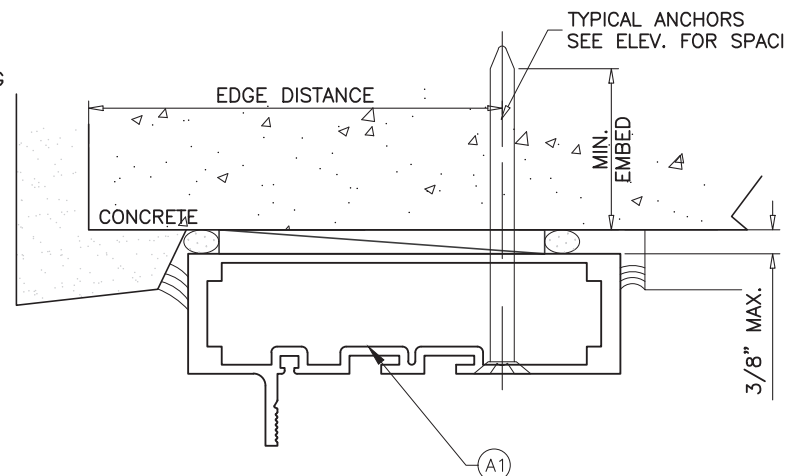
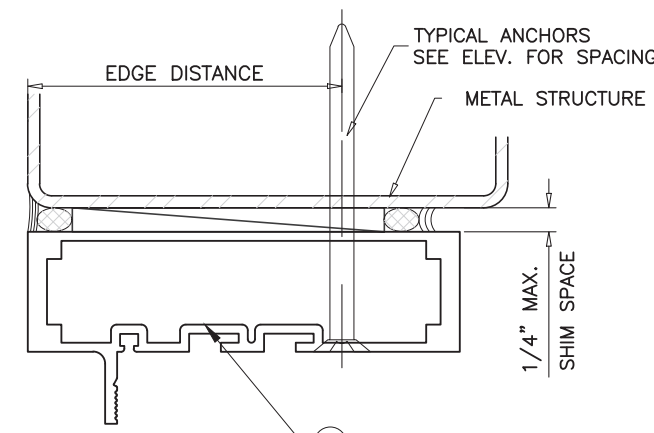
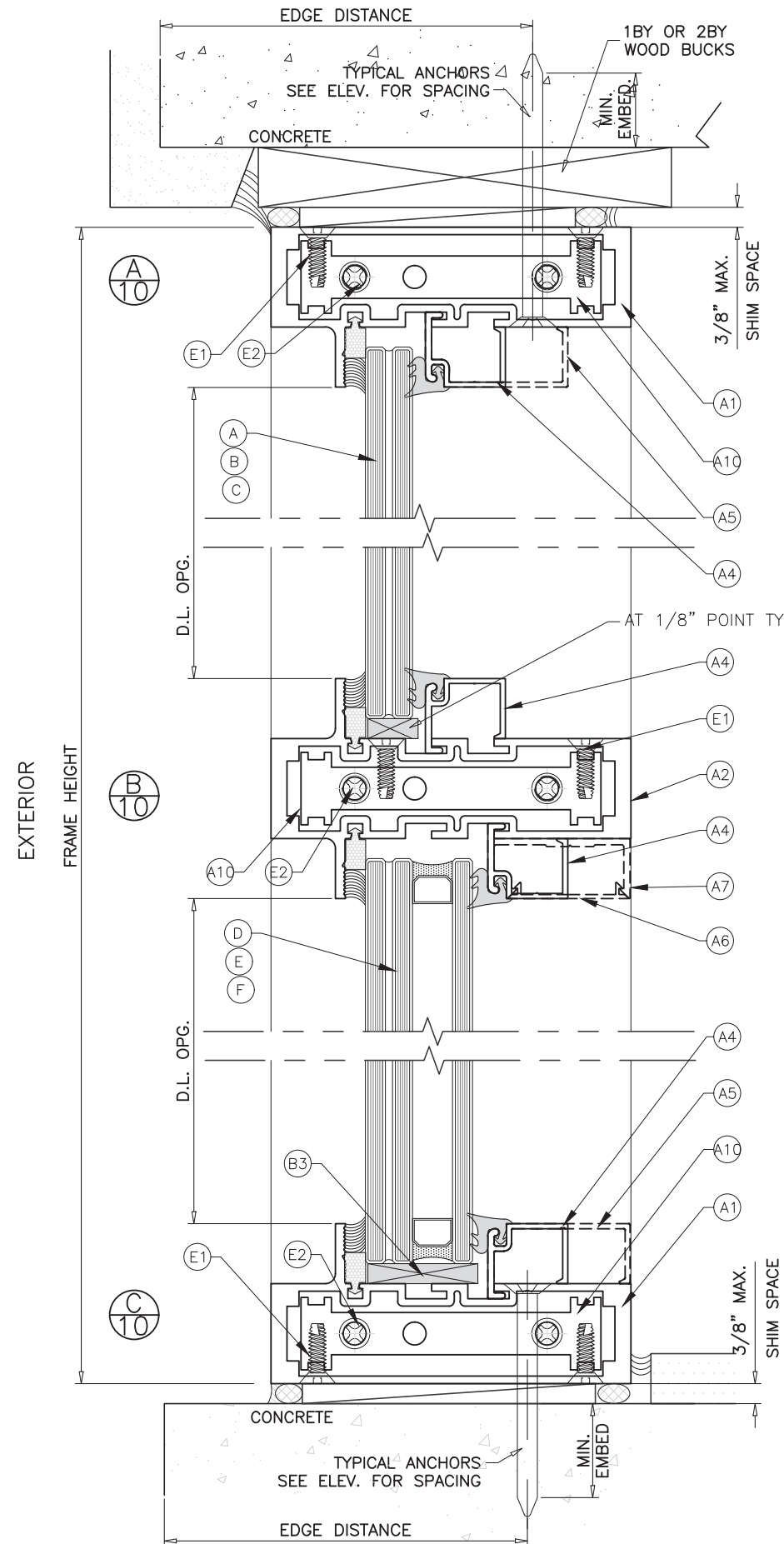

WOOD BUCKS AND METAL STRUCTURES NOT BY TRULITE. MUST SUSTAIN LOADS IMPOSED BY GLAZING SYSTEM AND TRANSFER THEM TO THE BUILDING STRUCTURE.

TYPICAL ANCHORS:
SEE ELEVATIONS FOR SPACING

TYPE 'AA' 1/4" DIA. TAPCON BY 'ITW' (Fu=120 KSI, Fy=92 KSI)
INTO 2BY WOOD BUCKS OR WOOD STRUCTURES
1-1/2" MIN. PENETRATION INTO WOOD
THRU WOOD BUCKS INTO CONC. OR MASONRY*
1-3/4" MIN. EMBED INTO MASONRY*
1-3/4" MIN. EMBED INTO CONC.

TYPE 'A' 1/4" TAPCON BY 'ITW' (Fu=120 KSI, Fy=92 KSI)
DIRECTLY INTO CONCRETE OR MASONRY*
1-3/4" MIN. EMBED INTO CONCRETE OR MASONRY*

TYPE 'BB' 1/4" DIA. ULTRACON+ BY 'DEWALT' (Fu=164 KSI, Fy=148 KSI)
INTO 2BY WOOD BUCKS OR WOOD STRUCTURES
1-1/2" MIN. PENETRATION INTO WOOD
THRU WOOD BUCKS INTO CONC. OR MASONRY*
1-3/4" MIN. EMBED INTO MASONRY*
1-3/4" MIN. EMBED INTO CONC.

TYPE 'B' 1/4" DIA. ULTRACON+ BY 'DEWALT' (Fu=164 KSI, Fy=148 KSI)
DIRECTLY INTO CONCRETE OR MASONRY*
1-3/4" MIN. EMBED INTO CONCRETE OR MASONRY*

TYPE 'C' #14 SMS (GRADE 2) (Fu=74 KSI, Fy=57 KSI)
OR SELF DRILLING SCREWS (GRADE 5) (Fu=120 KSI, Fy=92 KSI)
INTO MIAMI-DADE COUNTY APPROVED MULLIONS
(1/8" THK. MIN.) INTO METAL STRUCTURE.

STEEL : 12 GA. MIN. (Fy = 36 KSI MIN.)
ALUMINUM : 1/8" THK. MIN. (6063-T5 MIN.)
(STEEL IN CONTACT WITH ALUMINUM TO BE PLATED OR PAINTED)

SEALANTS:

FRAME CORNERS SEALED WITH DOWSIL 1199 OR EQUAL COMPATIBLE.

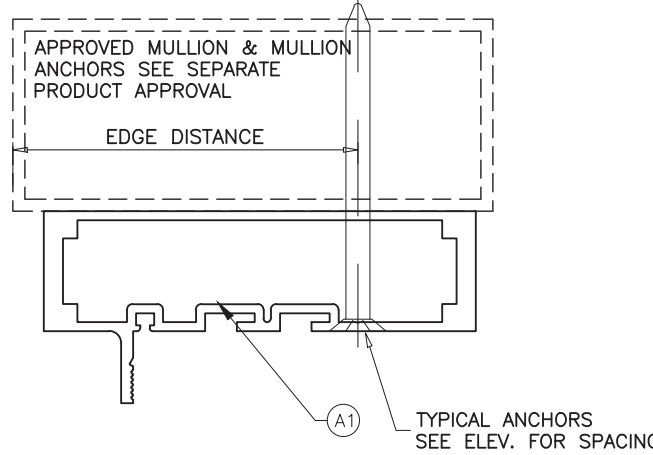
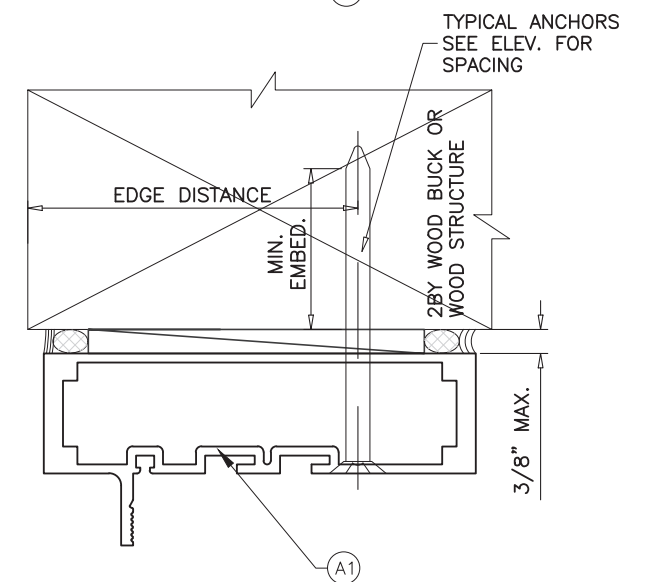

TYPICAL EDGE DISTANCE

INTO CONCRETE AND MASONRY* = 2-1/2" MIN.
INTO WOOD STRUCTURE = 1" MIN.
INTO METAL STRUCTURE = 3/4" MIN.

CONCRETE f'c = 3000 PSI MIN.
C-90 HOLLOW/FILLED BLOCK f'm = 2000 PSI MIN.

*MASONRY - GROUT FILLED CONCRETE BLOCK (f'c=2000 PSI MIN.)
NOTE: MASONRY USED AT JAMB SUBSTRATE ONLY

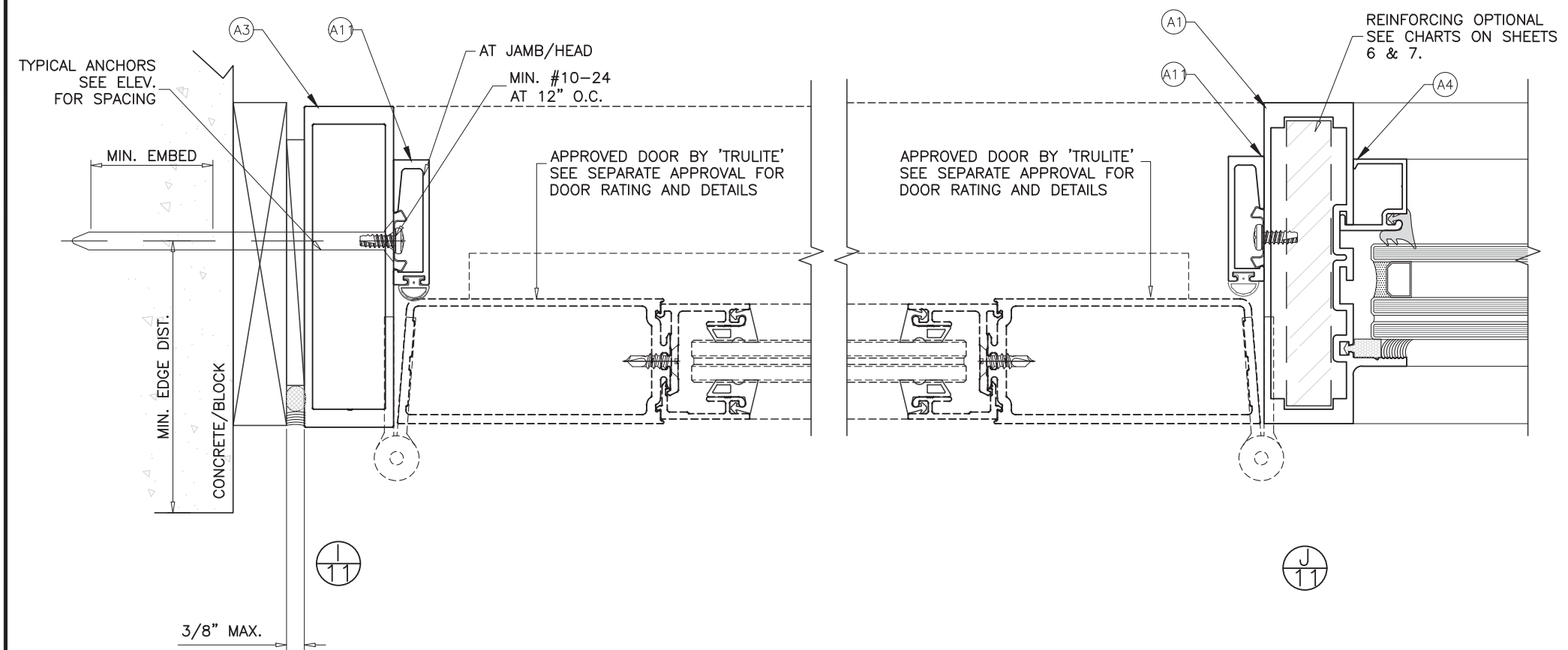
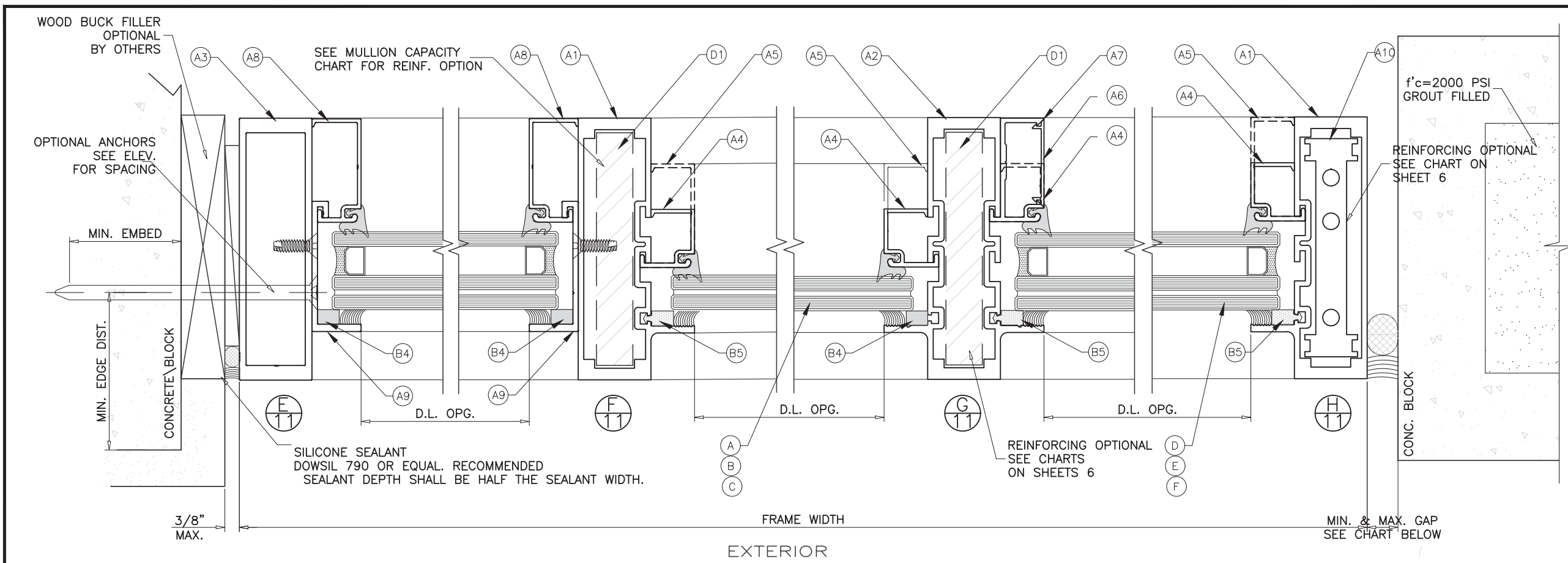

MAX. FRAME HEIGHT	GAP	
	MIN.	MAX.
96"	1/2"	1"
108"	5/8"	1 1/2"
120"	1/2"	1-1/8"
144"	3/4"	1-1/8"

MAX. FRAME WIDTH	MAX. GAP AT EACH SIDE
30 FT.	1-1/8"
60 FT.	1-1/8"

ALTERNATE SEALANTS AT JAMB GAPS CAN BE DESIGNED BY ENGINEER OF RECORD BASED ON MANUFACTURER GUIDE LINES.

Trulite
GLASS & ALUMINUM SOLUTIONS™
http://www.trulite.com
403 WESTPARK COURT, Suite 201
PEACHTREE CITY, GA 30269
p. 800-432-8132

PRODUCT:
Resistor
3000R ALUMINUM
STOREFRONT WALL-LMI
Resistor
PRODUCT SERIES

REVN	DATE/REMARKS
REV5	11.16.2023 UPDATE INTERLAYER

ENGINEER:
MCY ENGINEERING, INC.
GLAZING CONSULTANT
12781 Miramar Parkway #301
Miramar, FL 33027
P: (305) 271-0117
Email: mcy@mcyengineering.com
www.MCYEngineering.com

STAMP:
YI-PING WANG, P.E.
FLORIDA REGISTRATION
C.E. #55983
C.A.N. #28877
No 55983
STATE OF FLORIDA
PROFESSIONAL ENGINEER
December 04th, 2023

PRODUCT CONTROL APPROVAL:
PRODUCT RENEWED
As complying with the Florida Building Code
NOA-No. **24-0129.02**
Expiration Date: **03/18/2029**
By: *Manuel Perez*
Miami-Dade Product Control

DRAWN: James
DATE: 11.16.2023
DWG: AD18-17
DRAWING No:
11 OF 14

PRODUCT:

Resistor
3000R ALUMINUM
STOREFRONT WALL-LMI

Resistor
PRODUCT SERIES

REV#	DATE/REMARKS
REV5	11.16.2023 UPDATE INTERLAYER

ENGINEER:



MCY ENGINEERING, INC.
GLAZING CONSULTANT

12781 Miramar Parkway #301
Miramar, FL 33027
P: (305) 271-0117
Email: mcy@mcyengineering.com
www.MCYEngineering.com

STAMP:

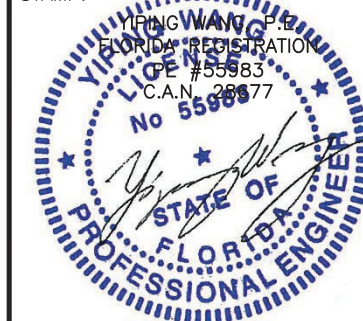

December 04th, 2023

PRODUCT CONTROL APPROVAL:

PRODUCT RENEWED
As complying with the Florida
Building Code

NOA-No. 24-0129.02

Expiration Date: 03/18/2029

By: *Manuel Ferrer*
Miami-Dade Product Control

DRAWN: James

DRAWING No:

DATE: 11.16.2023

12 OF 14

DWG: AD18-17

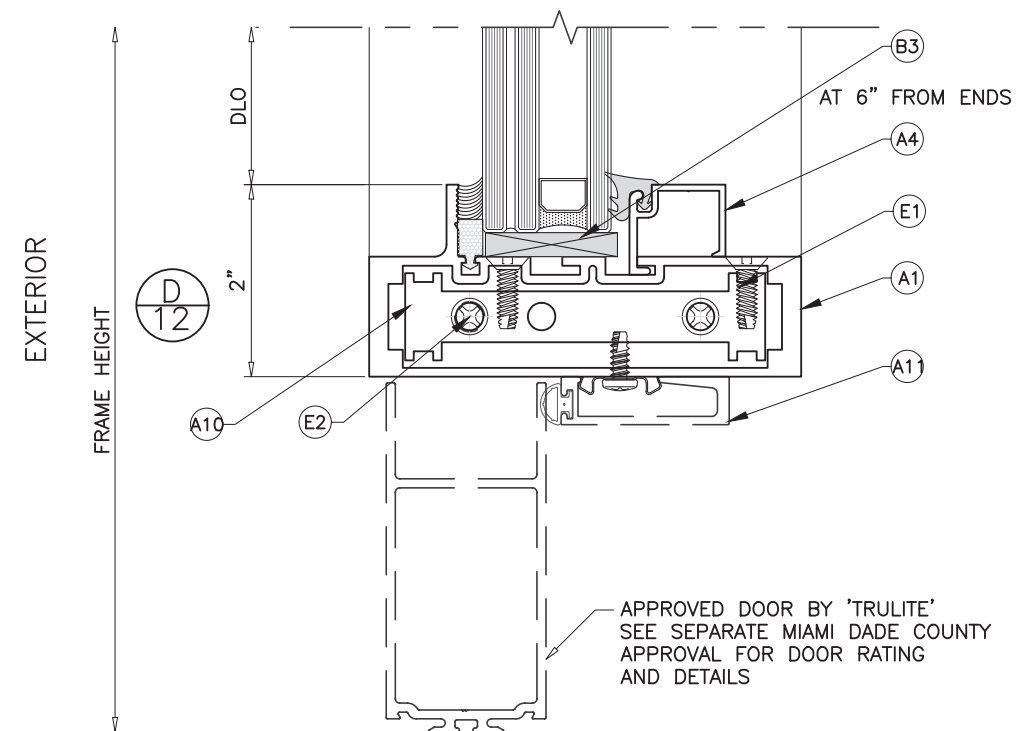

WITH INSULATED LAMINATED GLASS OPTION SHOWN

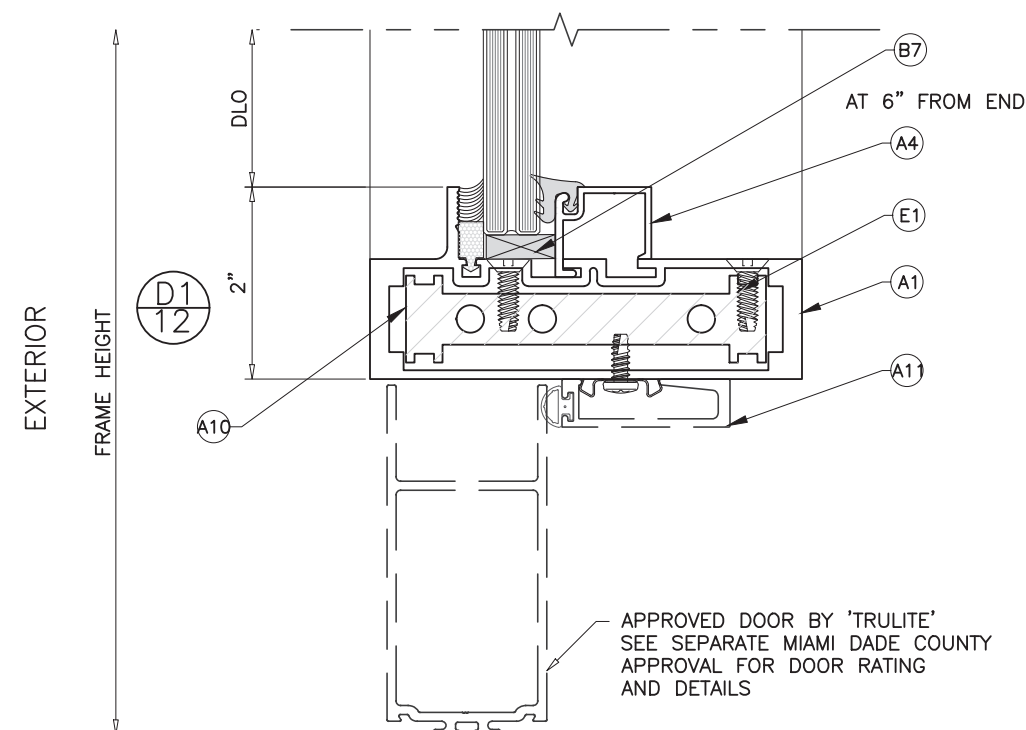
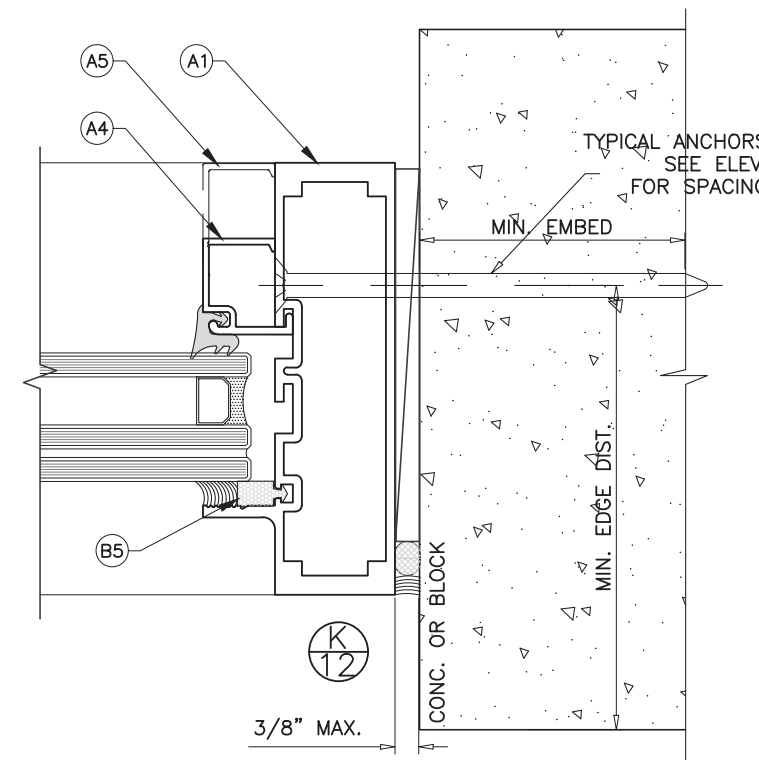

WITH LAMINATED GLASS OPTION SHOWN

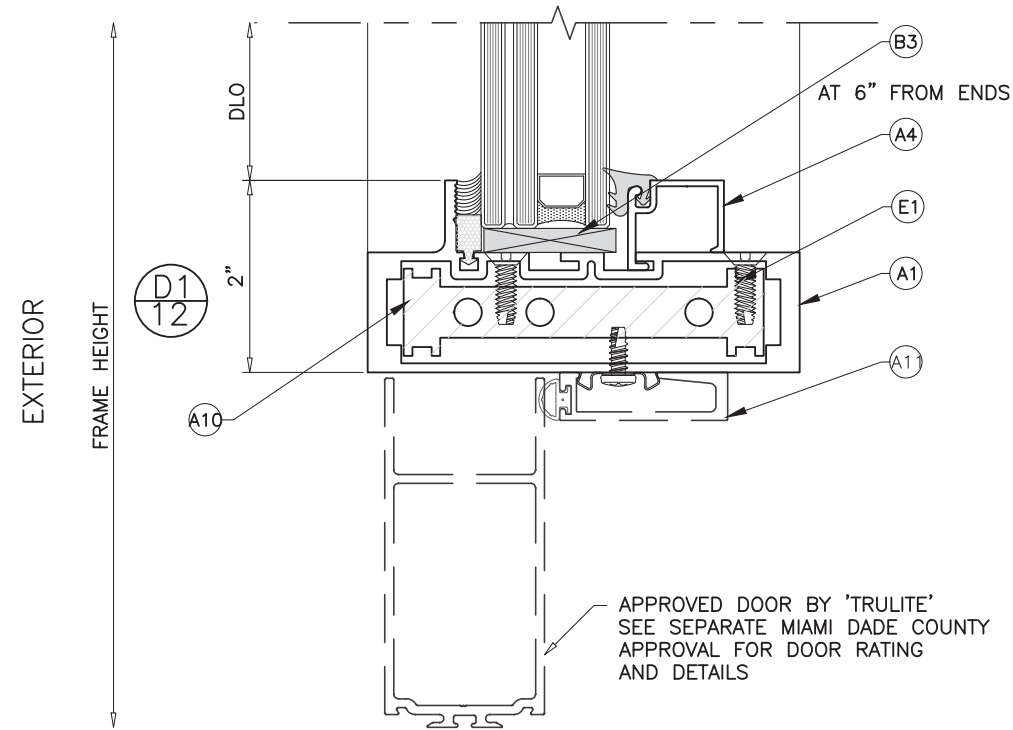

WITH INSULATED LAMINATED GLASS OPTION SHOWN

PRODUCT:

Resistor 3000R ALUMINUM STOREFRONT WALL-LMI

Resistor
PRODUCT SERIES

REVN	DATE/REMARKS
REV5	11.16.2023 UPDATE INTERLAYER

ENGINEER:

MCY ENGINEERING, INC.
GLAZING CONSULTANT

12781 Miramar Parkway #301
Miramar, FL 33027
P: (305) 271-0117
Email: mcy@mcycengineering.com
www.MCYEngineering.com

STAMP:



December 04th, 2023

PRODUCT CONTROL APPROVAL:

PRODUCT RENEWED
As complying with the Florida
Building Code
NOA-No. **24-0129.02**
Expiration Date: **03/18/2029**
By: *Manuel Perez*
Miami-Dade Product Control

DRAWN: James

DRAWING No:

DATE: 11.16.2023

13 OF 14

DWG: AD18-17

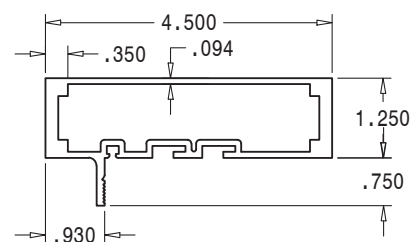

A1.) 3001R HEAD /SILL /JAMB

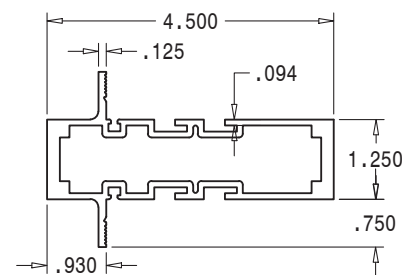

A2.) 3002R INT. VERTICAL

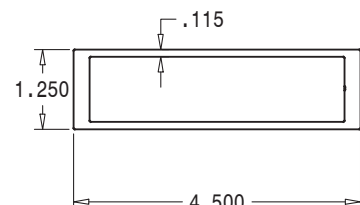

A3.) 3000 DOOR JAMB

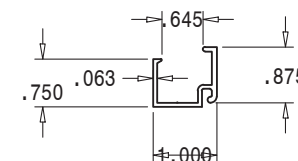

A4.) 3003 GLASS STOP

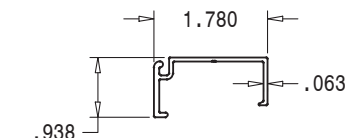

A5.) 3103 GLASS STOP

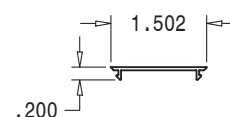

A6.) 3303 GLASS STOP (COVER) (OPTIONAL)

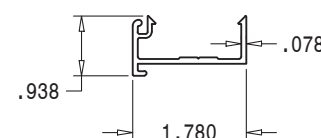

A7.) 3304 GLASS STOP (GUTTER) (OPTIONAL)

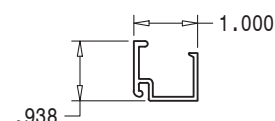

A13) 3003 GLASS STOP

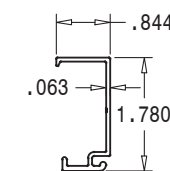

A8.) 3109 GLASS STOP (OPTIONAL)

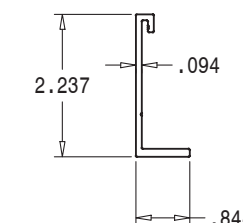

A9.) 3108 GLASS STOP

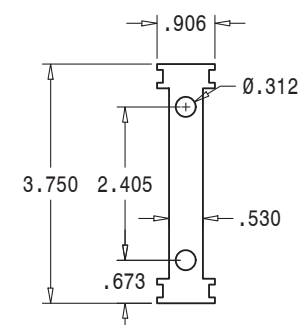

A10.) 3104 SHEAR CLIP / REINF.

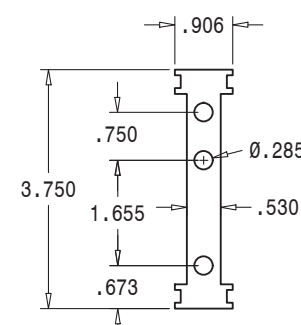

A10.) 3104C-SHEAR BLOCK/ #3104R-ALUM.MULLION REINF.

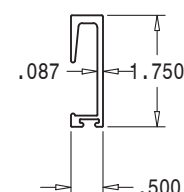

A11.) 10029 DOOR STOP



B1.) RG-1 GLAZ. GASKET



B2.) RG-5 GLAZ. GASKET

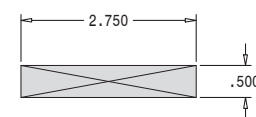

B3.) H62F SETTING BLOCK



B4.) V2108/ VK1826 VHB TAPE



B5.) RG-18 SPONGE GASKET

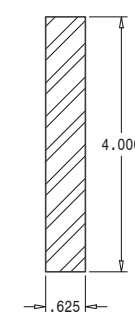

D1.) ST310-5/8" x 4" STEEL REINF.



B6.) SPACER



D2.) 23501 SPRINGCLIP

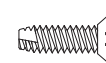

E1.) 23163 #12-24 x 3/4" UC-PFH 23

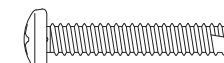

E2.) 23233 1/4-20 x 1 1/2" PPH 23



E3.) 23097 #10-24 x 1/2" PPH 23

BILL OF MATERIAL			
PART #'S	DESCRIPTION	MATERIAL	SUPPLIER/MANUF.
TRULITE			
A.FRAME EXTRUSIONS			
A1.) 3001R	HEAD/SILL/JAMB(1-1/4"X4-1/2")INSUL. GLASS	6063-T6	TRULITE
A2.) 3002R	INTERMEDIATE VERTICAL/HORIZONTAL	6063-T6	TRULITE
A3.) 3000	INTERMEDIATE VERTICAL/HORIZONTAL	6063-T6	TRULITE
A4.) 3003	GLASS STOP	6063-T6	TRULITE
A5.) 3103	GLASS STOP	6063-T6	TRULITE
A6.) 3303	GLASS STOP(COVER)	6063-T6	TRULITE
A7.) 3304	GLASS STOP(GUTTER)	6063-T6	TRULITE
A8.) 3109	GLASS STOP	6063-T6	TRULITE
A9.) 3108	GLASS STOP	6063-T6	TRULITE
A10.) 3104	SHEAR CLIP/REINFORCEMENT	6063-T6	TRULITE
A10.) 3104C/3104R	SHEAR BLOCK/REINFORCEMENT	6063-T6	TRULITE
A11.) 10029	DOOR STOP	6063-T6	TRULITE
A13.) 3003	GLASS STOP	6063-T6	TRULITE
B.GASKETS/SETTING BLOCKS			
B1.) RG-1	GLAZING GASKET	EPDM	TRULITE
B2.) RG-5	DOOR GASKET	EPDM	TRULITE
B3.) H62F	SETTING BLOCK	EPDM	TRULITE
B4.) V2108/ VK1826	GLAZING TAPE	EPDM	CAPITAL TAPE/SAINT GOBAIN
B5.) RG-18	0.236 X 0.375 SPONGE GASKET	EPDM	TRULITE
B6.) -	ALUMINUM SPACER	ALUMINUM	HELIMA HELVETION INT. /VARIES
B7.) H62D	1/2" X 1/4" X 4" LG SETTING BLOCK	EPDM	TRULITE
C.STRUCTURAL SILICON SEALANTS			
S1.) DOWSIL 795	STRUCTURAL SEALANT		DOWSIL
S2.) DOWSIL 995/ 983	STRUCTURAL SEALANT		DOWSIL
S3.) PROGLAZE SSG	STRUCTURAL SEALANT		TREMCO
S4.) SPECTREM 2	STRUCTURAL SEALANT		TREMCO
S5.) SCS2000	STRUCTURAL SEALANT		GE
D.MISCELLANEOUS ITEMS			
D1.) ST310	5/8" X 4" A36 STEEL REINFORCEMENT		VARIES
D2.) 23501	SPRING CLIP		EVANS
E.FASTENERS/ANCHORS			
E1.) 23163	SHEAR CLIP SCREWS #12-24X3/4" PFH-23		ALLOY FASTENER
E2.) 23233	HORIZ. FRAME SCREWS 1/4-20X1 1/2" PPH-23		ALLOY FASTENER
E3.) 23097	DOOR STOP SCREWS #10-24X2" PPH-23		ALLOY FASTENER



GLASS & ALUMINUM SOLUTIONS™

http://www.trulite.com

403 WESTPARK COURT, Suite 201
PEACHTREE CITY, GA 30269
p. 800-432-8132

PRODUCT:

Resistor
3000R ALUMINUM
STOREFRONT WALL-LMI



REV#	DATE/REMARKS
REV5	11.16.2023 UPDATE INTERLAYER

ENGINEER:



MCY ENGINEERING, INC.
GLAZING CONSULTANT

12781 Miramar Parkway #301
Miramar, FL 33027
P: (305) 271-0117
Email: mcy@mcyengineering.com
www.MCYEngineering.com

STAMP:

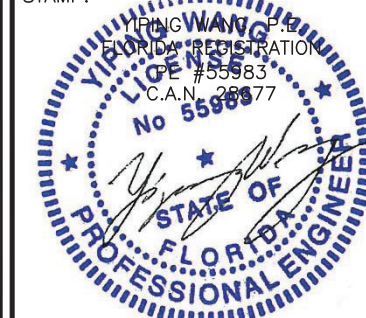

December 04th, 2023

PRODUCT CONTROL APPROVAL:

PRODUCT RENEWED
As complying with the Florida Building Code
NOA-No. **24-0129.02**
Expiration Date: **03/18/2029**
By: *Manuel Perez*
Miami-Dade Product Control

DRAWN: James

DRAWING No:

DATE: 11.16.2023

14 OF 14

DWG: AD18-17