



DEPARTMENT OF REGULATORY AND ECONOMIC RESOURCES (RER)
BOARD AND CODE ADMINISTRATION DIVISION

MIAMI-DADE COUNTY
PRODUCT CONTROL SECTION

11805 SW 26 Street, Room 208
Miami, Florida 33175-2474
T (786) 315-2590 F (786) 315-2599

www.miamidade.gov/economy

NOTICE OF ACCEPTANCE (NOA)

Glass Railing of Norway, LLC
2520 NE 9th Avenue
Cape Coral, Florida 33909

SCOPE:

This NOA is being issued under the applicable rules and regulations governing the use of construction materials. The documentation submitted has been reviewed and accepted by Miami-Dade County RER-Product Control Section to be used in Miami Dade County and other areas where allowed by the Authority Having Jurisdiction (AHJ).

This NOA shall not be valid after the expiration date stated below. The Miami-Dade County Product Control Section (In Miami Dade County) and/or the AHJ (in areas other than Miami Dade County) reserve the right to have this product or material tested for quality assurance purposes. If this product or material fails to perform in the accepted manner, the manufacturer will incur the expense of such testing and the AHJ may immediately revoke, modify, or suspend the use of such product or material within their jurisdiction. RER reserves the right to revoke this acceptance if it is determined by Miami-Dade County Product Control Section that this product or material fails to meet the requirements of the applicable building code.

This product is approved as described herein and has been designed to comply with the High Velocity Hurricane Zone of the Florida Building Code.

DESCRIPTION: Glassfit SV1401 Top Mount Railing System

APPROVAL DOCUMENT: Drawing No. AD18-33, titled "Glassfit SV1401 Top Mount Railing System", sheets 1 through 6 of 6, prepared by MCY Engineering, Inc., dated October 06, 2018, last revision #2 dated 03/14/24, signed and sealed by Yiping Wang, P.E., bearing Miami-Dade County Product Control Revision stamp with the Notice of Acceptance number & the expiration date by The Miami-Dade County Product Control Section.

MISSILE IMPACT RATING: Large and Small Missile Impact

LABELING: Each unit shall bear a permanent label with the manufacturer's name or logo, city, state and the following statement: "Miami-Dade County Product Control Approved", unless otherwise noted herein.

RENEWAL of this NOA shall be considered after a renewal application has been filed and there has been no change in the applicable building code negatively affecting the performance of this product.

TERMINATION of this NOA will occur after the expiration date or if there has been a revision or change in the materials, use, and/or manufacture of the product or process. Misuse of this NOA as an endorsement of any product, for sales, advertising or any other purposes shall automatically terminate this NOA. Failure to comply with any section of this NOA shall be cause for termination and removal of NOA.

ADVERTISEMENT: The NOA number preceded by the words Miami-Dade County, Florida, and followed by the expiration date may be displayed in advertising literature. If any portion of the NOA is displayed, then it shall be done in its entirety.

INSPECTION: A copy of this entire NOA shall be provided to the user by the manufacturer or its distributors and shall be available for inspection at the job site at the request of the Building Official. The structural adequacy of the supporting structures is not part of this approval & shall be reviewed by the corresponding Building Dept.

This NOA **revises and renews** NOA #20-1230.13 and consists of this page 1, evidence submitted pages E-1 and E-2 as well as approval document mentioned above.

The submitted documentation was reviewed by **Helmy A. Makar, P.E., M.S.**



Helmy A. Makar
05/30/24

NOA No. 24-0314.05
Expiration Date: 05/30/2029
Approval Date: 05/30/2024
Page 1

Glass Railing of Norway, LLC

NOTICE OF ACCEPTANCE: EVIDENCE SUBMITTED

1. EVIDENCE SUBMITTED UNDER PREVIOUS APPROVAL #18-1011.05

A. DRAWINGS

1. *Drawing No. AD18-33, titled "Glassfit SV1401 Top Mount Railing System", sheets 1 through 6 of 6, prepared by MCY Engineering, Inc., dated October 06, 2018, signed and sealed by Yiping Wang, P.E., on May 15, 2019.*

B. TESTS

1. *Test Report No. HETI-18-6044, by Hurricane Engineering & Testing, Inc., dated 08/14/18, signed and sealed by Rafael E. Droz-Seda, P.E., testing Glassfit SV1401 Top Mount Railing System for concentrated loads per FBC 1618.4.8, Impacts per NSI Z97.1, Static Wind Load per TAS 202-94 and Large Missile Impact per TAS 201.*

C. CALCULATIONS

1. *Calculation titled "Glassfit SV1401 Top Mount Railing System", sheets 1- 15, dated 10/08/2018, prepared by MCY Engineering, Inc., dated October 08, 2018, signed and sealed by Yiping Wang, P.E.*

D. QUALITY ASSURANCE

1. *By Miami-Dade County Department of Regulatory and Economic Resources (RER).*

E. MATERIAL CERTIFICATIONS

1. *None.*

2. EVIDENCE SUBMITTED UNDER PREVIOUS APPROVAL #20-1230.13

A. DRAWINGS

1. *Drawing No. AD18-33, titled "Glassfit SV1401 Top Mount Railing System", sheets 1 through 6 of 6, prepared by MCY Engineering, Inc., dated October 06, 2018, last revision #1 dated 12/21/20, signed and sealed by Yiping Wang, P.E.*

B. TESTS

1. *None.*

C. CALCULATIONS

1. *None.*

D. QUALITY ASSURANCE

1. *By Miami-Dade County Department of Regulatory and Economic Resources (RER).*

E. MATERIAL CERTIFICATIONS

1. *None.*

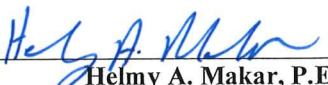

Helmy A. Makar, P.E., M.S.
Product Control Section Supervisor
NOA No. 24-0314.05
Expiration Date: 05/30/2029
Approval Date: 05/30/2024

Glass Railing of Norway, LLC

NOTICE OF ACCEPTANCE: EVIDENCE SUBMITTED

3. NEW EVIDENCE SUBMITTED

A. DRAWINGS

1. *Drawing No. AD18-33, titled "Glassfit SV1401 Top Mount Railing System", sheets 1 through 6 of 6, prepared by MCY Engineering, Inc., dated October 06, 2018, last revision #2 dated 03/14/24, signed and sealed by Yiping Wang, P.E.*

B. TESTS

1. *None.*

C. CALCULATIONS

1. *None.*

D. QUALITY ASSURANCE

1. *By Miami-Dade County Department of Regulatory and Economic Resources (RER).*

E. MATERIAL CERTIFICATIONS

1. *None.*



Helmy A. Makar, P.E., M.S.
Product Control Section Supervisor
NOA No. 24-0314.05
Expiration Date: 05/30/2029
Approval Date: 05/30/2024

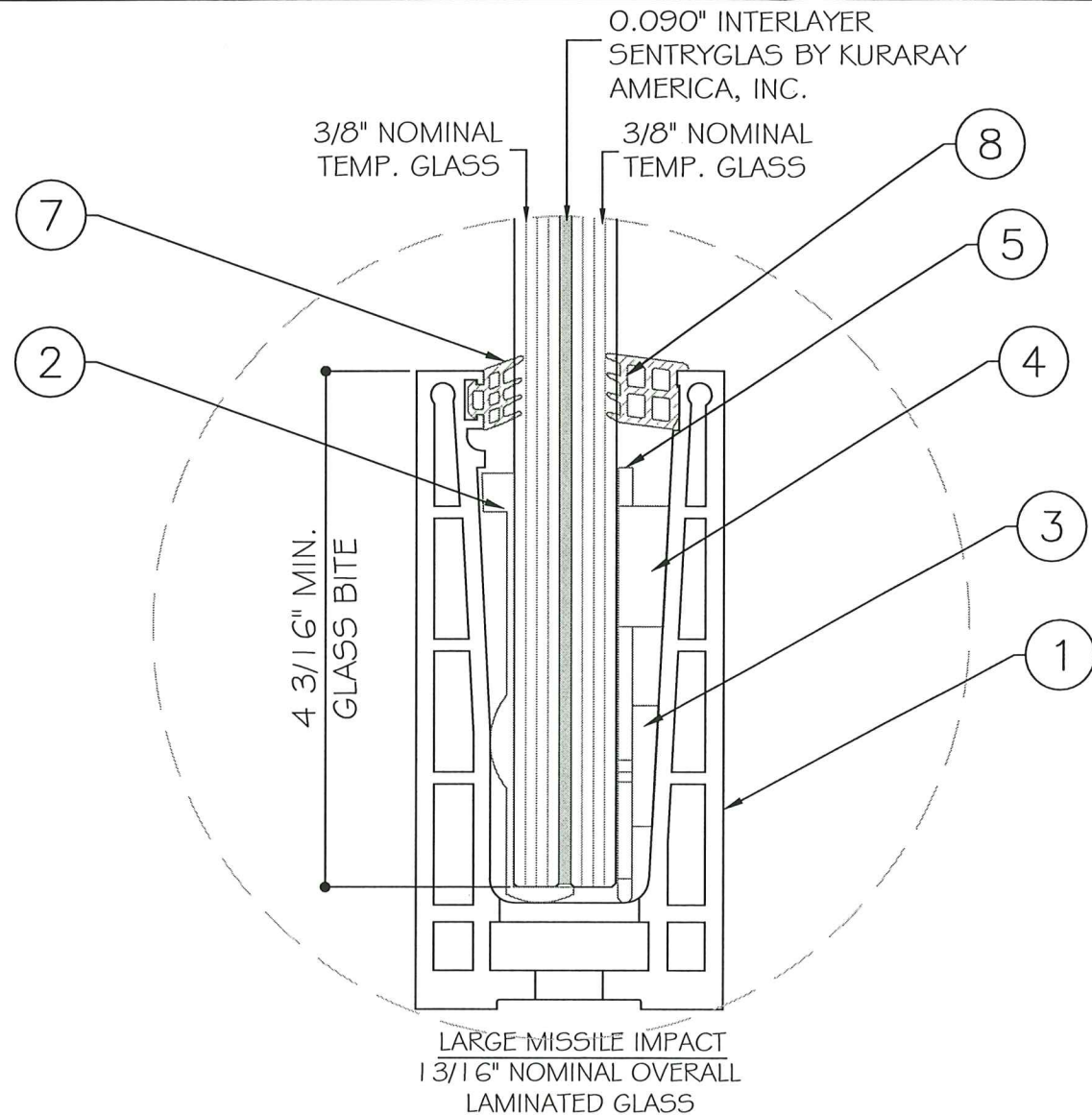

NOTE:
GLASS COMPLIES WITH ASTM E1300-09
(3 SEC. GUSTS).

GLASSFIT SV1401 TOP MOUNT RAILING SYSTEM W/ LAMINATED GLASS

- THIS PRODUCT HAS BEEN DESIGNED AND TESTED TO COMPLY WITH THE REQUIREMENTS OF THE 8TH EDITION FLORIDA BUILDING CODE (2023) INCLUDING HIGH VELOCITY HURRICANE ZONE (HVHZ).
- PRODUCT IS RATED FOR LARGE MISSILE IMPACT.
- ANCHORS SHALL BE AS LISTED, SPACED AS SHOWN ON DETAILS. ANCHORS EMBEDMENT TO BASE MATERIAL SHALL BE BEYOND WALL DRESSING OR STUCCO.
- ANCHORING OR LOADING CONDITIONS NOT SHOWN IN THESE DETAILS ARE NOT PART OF THIS APPROVAL.
- METAL STRUCTURES NOT BY GLASS RAILING OF NORWAY, INC. MUST SUPPORT LOADS IMPOSED BY RAILING SYSTEM AND TRANSFER THEM TO THE BUILDING STRUCTURE.
- MATERIALS INCLUDING BUT NOT LIMITED TO STEEL/METAL SCREWS THAT COME INTO CONTACT WITH OTHER DISSIMILAR MATERIALS SHALL MEET THE REQUIREMENTS OF THE 8TH EDITION FLORIDA BUILDING CODE (2023) SECTION AS APPLICABLE.
- THE DESIGN LOADS SHOWN IN THIS DOCUMENT ARE ALLOWABLE DESIGN LOADS. ULTIMATE DESIGN LOAD OBTAINED FROM ASCE 7-22, MULTIPLY BY 0.6, SHALL BE LESS THAN OR EQUAL TO MAX. ALLOWABLE DESIGN LOAD IN THIS DOCUMENT.

TESTED WITH ANSI Z97.1

LARGE AND SMALL MISSILE IMPACT

ABBREVIATIONS AND SYMBOLS	
D.L.O. - DAYLITE OPENING	
LG. - LONG	
O.C. - ON CENTER	
TEMP. - TEMPERED	
THK. - THICKNESS	
W/ - WITH	
W/O - WITHOUT	
	<div><div>SECTION NUMBER</div><div>4</div><div>D2</div><div>SHEET NUMBER</div></div>

MIAMI-DADE COUNTY

PRODUCT REVISED
as complying with the Florida
Building Code
Acceptance No. 24-0314.05
Expiration Date 05/30/29

By: [Signature]
Miami Lead Product Control

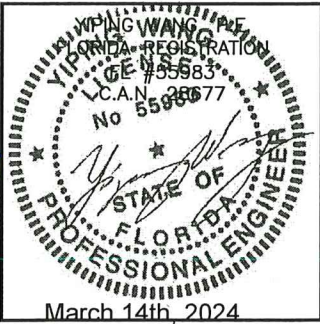

REVISIONS	
NO.	DATE DESCRIPTION
R2	03.14.2024 UPDATE FBC 2023

MCY ENGINEERING, INC.

GLAZING CONSULTANTS

12781 MIRAMAR PKWY. STE. 301
MIRAMAR, FL 33027 P: 305.271.0117

www.MCYEngineering.com mcy@mcyengineering.com

GLASSFIT SV1401 TOP MOUNT RAILING SYSTEM W/LAMINATED GLASS (LMI&SMI)

GLASS RAILING OF NORWAY
2520 NE 9th Ave.
CAPE CORAL FL 33908
TEL: +1 239 687 8411

COVER	
DATE	03.14.2024
SCALE	AS SHOWN
DRAWN	JAMES
PROJECT	
DRAWING NO.	AD18-33
	1 OF 6

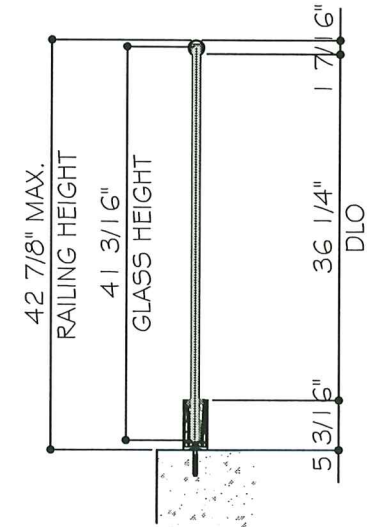
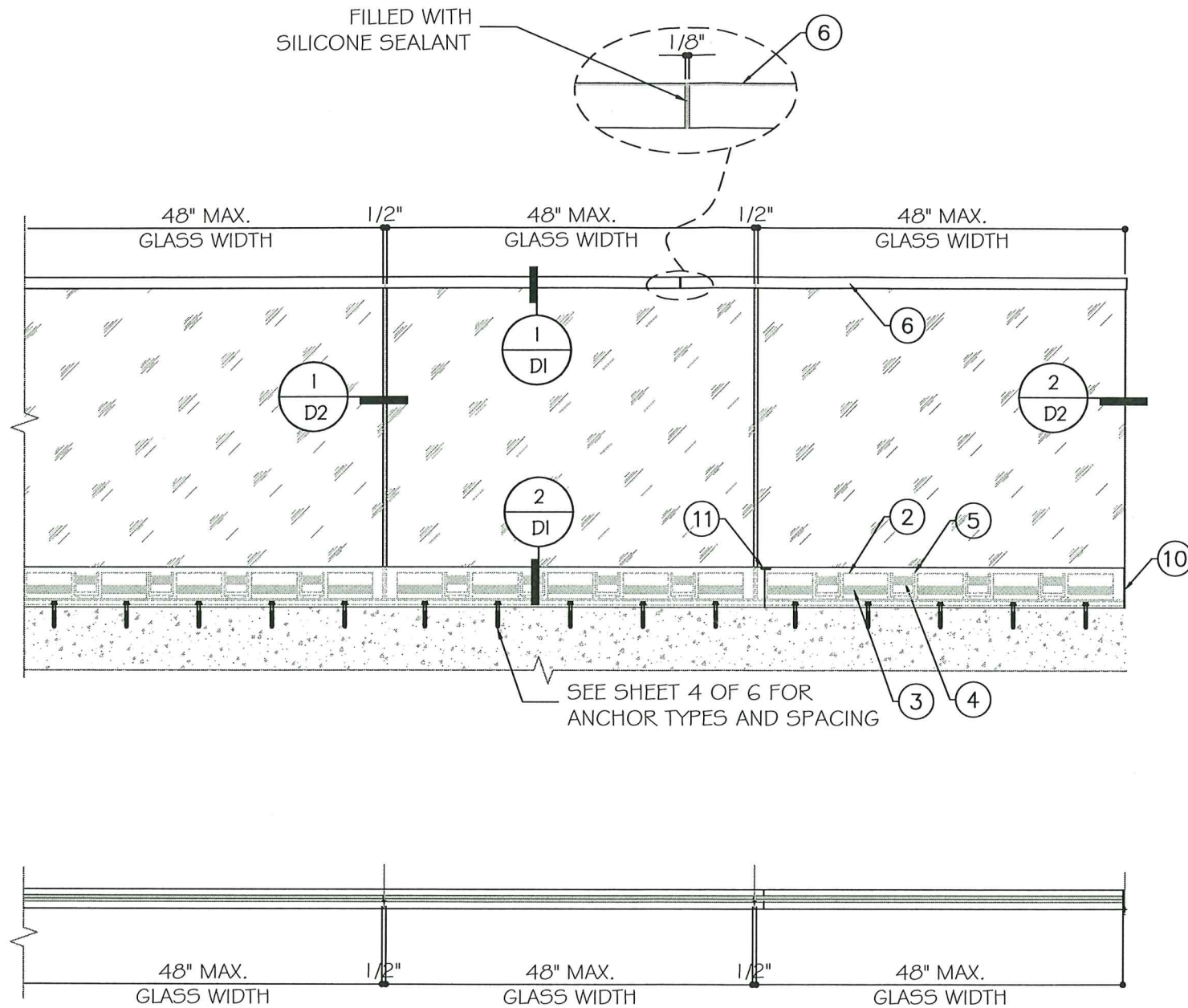

TYPICAL EXTERIOR ELEVATIONS
(WITH HANDRAIL)

MAX. ALLOWABLE DESIGN LOAD (FOR SIZES SHOWN ABOVE OR SMALLER) AS PERMITTED BY FBC
+80.0 PSF
-80.0 PSF

MIAMI-DADE COUNTY

PRODUCT REVISED
as complying with the Florida
Building Code
Acceptance No. 24-0314.05
Expiration Date 05/30/29
By *[Signature]*
Miami Dade Product Control

YIPONG WANG
FLORIDA REGISTRATION
No. 55983
C.A.N. 28677

[Signature]
STATE OF
FLORIDA
PROFESSIONAL ENGINEER

March 14th, 2024

GLASSFIT SV1401 TOP MOUNT RAILING SYSTEM W/LAMINATED GLASS (LMI&SMI)

GLASS RAILING OF NORWAY
2520 NE 9th Ave.
CAPE CORAL FL. 33909
TEL: +1 239 687 8411

MCY ENGINEERING, INC.
GLAZING CONSULTANTS
12781 MIRAMAR PKWY. STE. 301
MIRAMAR, FL 33027 P: 305.271.0117
www.MCYEngineering.com mcy@mcyengineering.com

REVISIONS

NO.	DATE	DESCRIPTION
R2	03.14.2024	UPDATE FBC 2023

E1

DATE	03.14.2024
SCALE	AS SHOWN
DRAWN	JAMES
PROJECT	

DRAWING NO.
AD18-33

2 OF 6

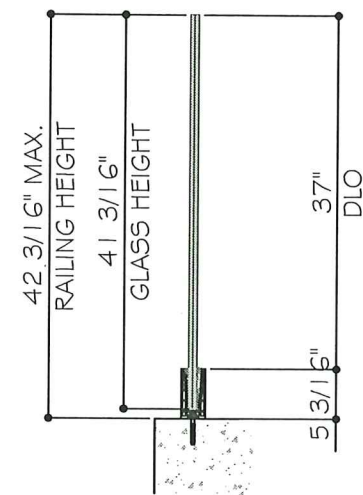
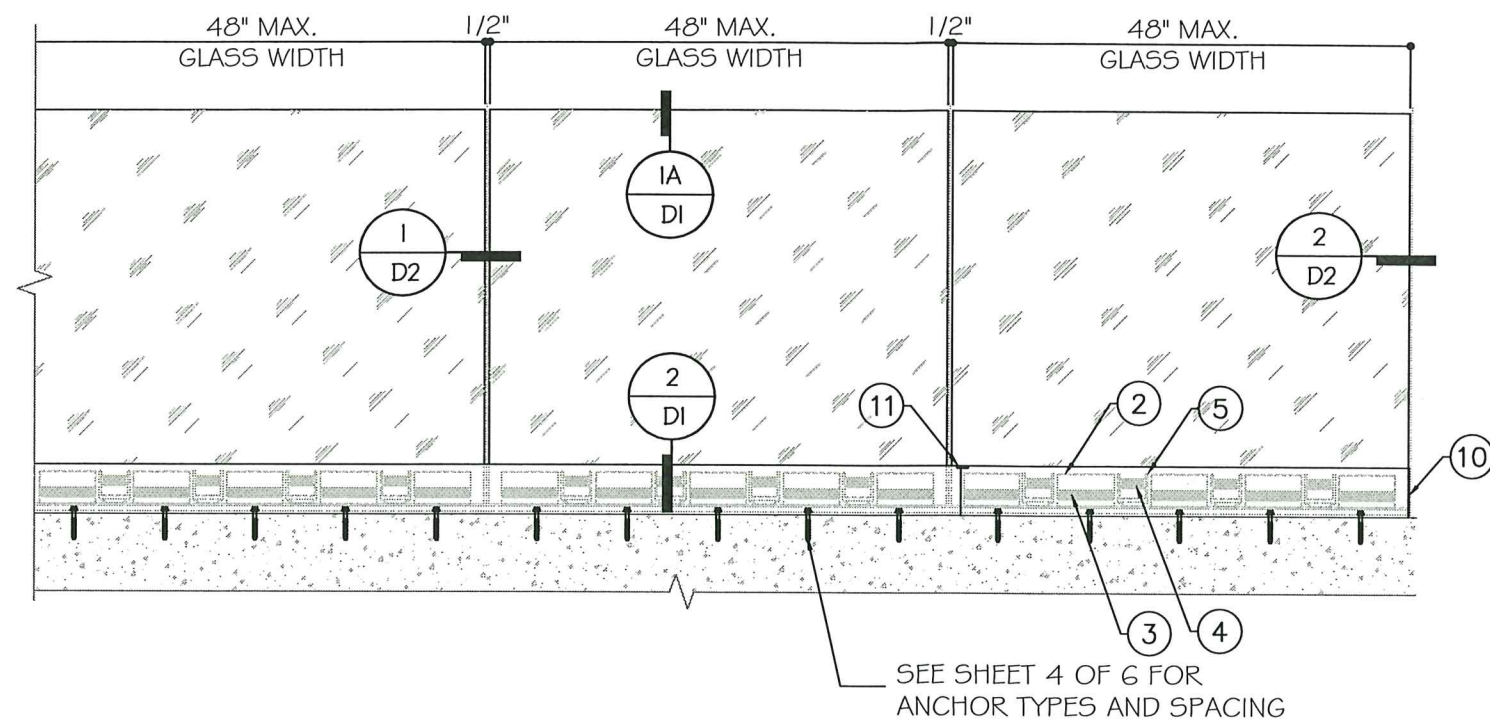

TYPICAL EXTERIOR ELEVATIONS
(WITHOUT HANDRAIL)

MAX. ALLOWABLE DESIGN LOAD
(FOR SIZES SHOWN ABOVE OR SMALLER) AS PERMITTED BY FBC
+80.0 PSF
-80.0 PSF

MIAMI-DADE COUNTY

PRODUCT REVISED
as complying with the Florida
Building Code
Acceptance No. 24-0314.05
Expiration Date 05/30/29

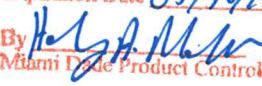
By 
Miami Dade Product Control

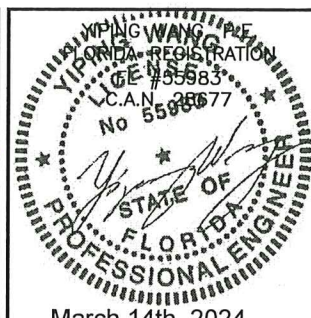

YIPING WANG, P.E.
FLORIDA REGISTRATION
License No. 55983
L.C.A.N. 38677

March 14th, 2024

GLASSFIT SV1401 TOP MOUNT RAILING SYSTEM W/LAMINATED GLASS (LMI&SMI)

GLASS RAILING OF NORWAY
2520 NE 9th Ave.
CAPE CORAL FL. 33909
TEL: +1 239 687 8411

MCY ENGINEERING, INC.
GLAZING CONSULTANTS
12781 MIRAMAR PKWY. STE. 301
MIRAMAR, FL 33027 P: 305.271.0117
www.MCYEngineering.com mcy@mcyengineering.com

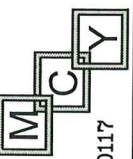

REVISIONS		
NO.	DATE	DESCRIPTION
R2	03.14.2024	UPDATE FBC 2023

E2
DATE 03.14.2024
SCALE AS SHOWN
DRAWN JAMES
PROJECT
DRAWING NO. AD18-33
3 OF 6

1
DI
DETAIL
W/ HAND RAIL

2
DI
DETAIL

REBAR BARS
CONTENTIOUS BY OTHERS

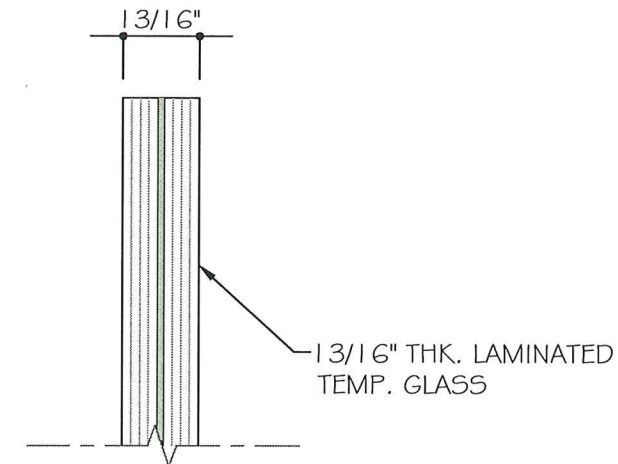
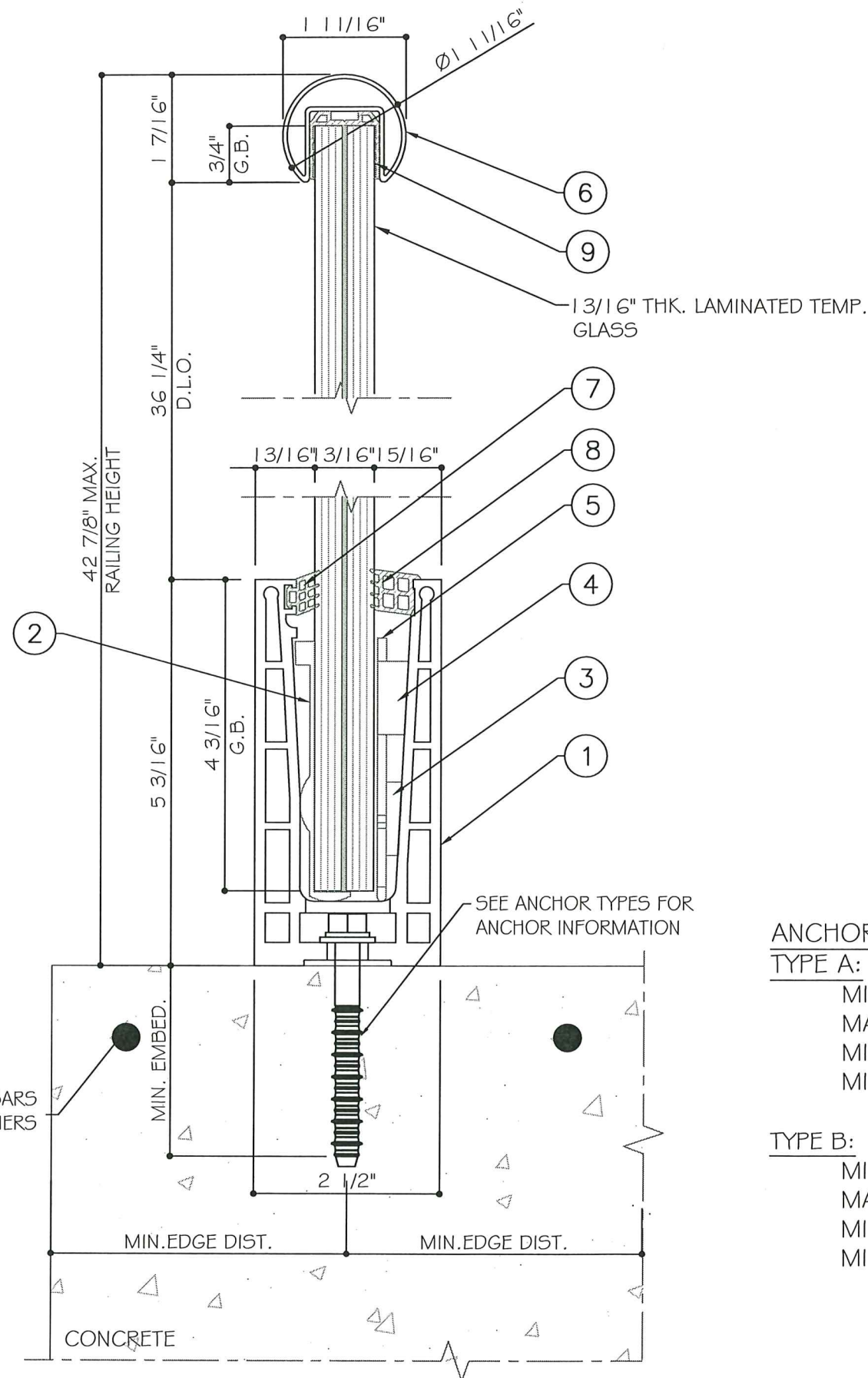

1A
DI
DETAIL
W/O HAND RAIL

ANCHOR TYPES :

TYPE A: 1/2" HIT RE500 EPOXY ADHESIVE ANCHOR WITH HAS SS AISI 304/3 1 6
MIN. EMBEDMENT: 4-1/2".
MAX. SPACING : @9 3/4" O.C. TYP. & 5" FROM EACH END.
MIN. EDGE DISTANCE: 4".
MIN. CONCRETE STRENGTH: $f_c' \geq 4000$ PSI.

TYPE B: 1/2" ELCO CONFLEX

MIN. EMBEDMENT: 4".
MAX. SPACING : @6" O.C. TYP. & 3" FROM EACH END.
MIN. EDGE DISTANCE: 4".
MIN. CONCRETE STRENGTH: $f_c' \geq 4510$ PSI.

MIAMI-DADE COUNTY

PRODUCT REVISED
as complying with the Florida
Building Code
Acceptance No. 24-0314-05
Expiration Date 05/10/29
By *[Signature]*
Miami Dade Product Control

STATE OF FLORIDA
Professional Engineer
No. 55983
C.A. No. 28677
March 14th, 2024

REVISIONS		
NO.	DATE	DESCRIPTION
R2	03.14.2024	UPDATE FBC 2023

MCY ENGINEERING, INC.
GLAZING CONSULTANTS
12781 MIRAMAR PKWY. STE. 301
MIRAMAR, FL 33027 P: 305.271.0117
www.MCYEngineering.com mcy@mcyengineering.com

GLASSFIT SV1401 TOP MOUNT RAILING SYSTEM W/LAMINATED GLASS (LM&SMI)

GLASS RAILING OF NORWAY
2520 NE 9th Ave.
CAPE CORAL FL. 33909
TEL: +1 239 687 8411

D1	
DATE	03.14.2024
SCALE	AS SHOWN
DRAWN	JAMES
PROJECT	
DRAWING NO. AD18-33	
4 OF 6	

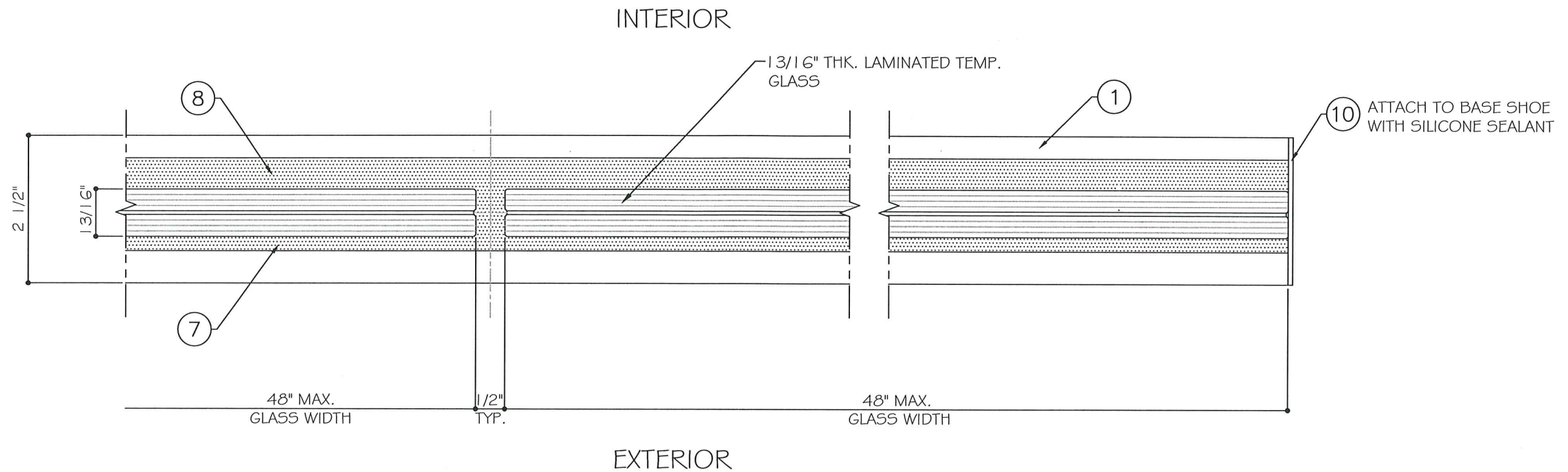

1
D2
DETAIL

2
D2
DETAIL

MIAMI-DADE COUNTY

PRODUCT REVISED
as complying with the Florida
Building Code
Acceptance No. 24-0314.05
Expiration Date 05/30/29
By H. A. Mohr
Miami-Dade Product Control

Professional Engineer
STATE OF FLORIDA
No. 35928677
C.F. #55983
PING WANG

March 14th, 2024

D2	
DATE	03.14.2024
SCALE	AS SHOWN
DRAWN	JAMES
PROJECT	
DRAWING NO. AD18-33	
5 OF 6	

MCY

MCY ENGINEERING, INC.
GLAZING CONSULTANTS
12781 MIRAMAR PKWY. STE. 301
MIRAMAR, FL 33027
P: 305.271.0117
www.MCYEngineering.com mcy@mcyengineering.com

GLASS RAILING OF NORWAY
2520 NE 9th Ave.
CAPE CORAL FL. 33909
TEL: +1 239 687 8411

GLASSFIT SV1401 TOP MOUNT RAILING SYSTEM W/LAMINATED GLASS (LM&SMI)

REVISIONS		
NO.	DATE	DESCRIPTION
R2	03.14.2024	UPDATE FEC 2023

BILL OF MATERIALS

ITEM #	PROFILE	DESCRIPTION	MATERIAL	MANUFACTURER/REMARKS
1	SV1401	TOP MOUNT BASE EXTRUSION	ALUM. 6063-T6	COMENZA
2	PL-20	L-SHAPED SPACER	PVC	COMENZA
3	PL-21	BOTTOM WEDGE	ABS	COMENZA
4	PL-22	SAFETY WEDGE	ABS	COMENZA
5	PL-23	SAFETY DEVICE	ABS	COMENZA
6	RPI400	HAND RAIL	S.S.304	COMENZA
7	PL-24	OUTER GASKET	EPDM - 60 DURO - SHORE 'A'	COMENZA
8	PL-25	INNER GASKET	EPDM - 60 DURO - SHORE 'A'	COMENZA
9	PL-03	HAND RAIL GASKET	EPDM - 50 DURO - SHORE 'A'	COMENZA
10	PM-10	END CAP	ALUM. 6063-T6	COMENZA
11	PM-01	JOINER PIN	AISI-316	COMENZA

1 TOP MOUNT BASE EXTRUSION
SV1401 6063-T6

2 L-SHAPED SPACER
PL-20 PVC

3 BOTTOM WEDGE
PL-21 ABS

4 SAFETY WEDGE
PL-22 ABS

5 SAFETY DEVICE
PL-23 ABS

6 HAND RAIL
RPI400 S.S. 304

7 OUTER GASKET
PL-24 EPDM

8 INNER GASKET
PL-25 EPDM

9 HAND RAIL GASKET
PL-03 EPDM

10 END CAP
PM10 6063-T6

11 JOINER PIN
PM01 AISI 316

MIAMI-DADE COUNTY

PRODUCT REVISED
as complying with the Florida
Building Code
Acceptance No 24-0314-05
Expiration Date 05/30/29
By *H. A. M.*
Miami Date Product Control

March 14th, 2024

REVISIONS

NO.	DATE	DESCRIPTION
RE	03.14.2024	UPDATE FBC 2023

MCY ENGINEERING, INC.
GLAZING CONSULTANTS
12781 MIRAMAR PKWY. STE.301
MIRAMAR, FL. 33027 P: 305.271.0117
www.MCYEngineering.com mcy@mcyengineering.com

GLASSFIT SV1401 TOP MOUNT RAILING SYSTEM W/LAMINATED GLASS (LM&SM)

GLASS RAILING OF NORWAY
2520 NE 9th Ave.
CAPE CORAL FL. 33909
TEL: +1 239 687 8411

BOM

DATE	03.14.2024
SCALE	AS SHOWN
DRAWN	JAMES
PROJECT	

DRAWING NO.
AD18-33

6 OF 6