



DEPARTMENT OF REGULATORY AND ECONOMIC RESOURCES (RER)
BOARD AND CODE ADMINISTRATION DIVISION

NOTICE OF ACCEPTANCE (NOA)

MIAMI-DADE COUNTY
PRODUCT CONTROL SECTION
11805 SW 26 Street, Room 208
Miami, Florida 33175-2474
T (786) 315-2590 F (786) 315-2599
www.miamidade.gov/economy

S&P USA Ventilation Systems, LLC
6393 Powers Avenue
Jacksonville, FL 32217

SCOPE:

This NOA is being issued under the applicable rules and regulations governing the use of construction materials. The documentation submitted has been reviewed and accepted by Miami-Dade County RER-Product Control Section to be used in Miami-Dade County and other areas where allowed by the Authority Having Jurisdiction (AHJ).

This NOA shall not be valid after the expiration date stated below. The Miami-Dade County Product Control Section (In Miami-Dade County) and/ or the AHJ (in areas other than Miami-Dade County) reserve the right to have this product or material tested for quality assurance purposes. If this product or material fails to perform in the accepted manner, the manufacturer will incur the expense of such testing and the AHJ may immediately revoke, modify, or suspend the use of such product or material within their jurisdiction. RER reserves the right to revoke this acceptance if it is determined by Miami-Dade County Product Control Section that this product or material fails to meet the requirements of the applicable building code.

This product is approved as described herein and has been designed to comply with the Florida Building Code, including the High Velocity Hurricane Zone.

DESCRIPTION: Series CM Steel Rooftop Fans

APPROVAL DOCUMENT: Drawing No. CMMD, titled "CM / CMHT / CMRHUL High Wind", sheets 1 through 8 of 8, dated 05/30/2022, prepared by the manufacturer, signed and sealed by Wayne K. Helmila, P.E., bearing the Miami-Dade County Product Control revision stamp with the Notice of Acceptance number and expiration date by the Miami-Dade County Product Control Section.

MISSILE IMPACT RATING: Large and Small Missile Impact Resistant

LABELING: A permanent label with the manufacturer's name or logo, Puebla, Mexico, model/ series, and following statement: "Miami-Dade County Product Control Approved", is to be located on each unit.

RENEWAL of this NOA shall be considered after a renewal application has been filed and there has been no change in the applicable building code negatively affecting the performance of this product.

TERMINATION of this NOA will occur after the expiration date or if there has been a revision or change in the materials, use, and/or manufacture of the product or process. Misuse of this NOA as an endorsement of any product, for sales, advertising or any other purposes shall automatically terminate this NOA. Failure to comply with any section of this NOA shall be cause for termination and removal of NOA.

ADVERTISEMENT: The NOA number preceded by the words Miami-Dade County, Florida, and followed by the expiration date may be displayed in advertising literature. If any portion of the NOA is displayed, then it shall be done in its entirety.

INSPECTION: A copy of this entire NOA shall be provided to the user by the manufacturer or its distributors and shall be available for inspection at the job site at the request of the Building Official.

This NOA **revises** NOA # 21-0722.05 consists of this page 1 and evidence pages E-1, as well as approval document mentioned above.

The submitted documentation was reviewed by **Carlos M. Utrera, P.E.**



05/22/24

NOA No. 24-0429.08
Expiration Date: July 14, 2027
Approval Date: May 30, 2024
Page 1

NOTICE OF ACCEPTANCE: EVIDENCE SUBMITTED

1. Evidence submitted under NOA # 21-0722.05 and new

A. DRAWINGS

1. Drawing No. **CMMD**, titled “CM / CMHT / CMRHUL High Wind”, sheets 1 through 8 of 8, dated 05/30/2022, prepared by the manufacturer, signed and sealed by Wayne K. Helmila, P.E.

B. TESTS

1. Test reports on 1) Uniform Static Air Pressure Test, Loading per FBC TAS 202-94
2) Large Missile Impact Test per FBC, TAS 201-94
along with marked-up drawings and installation diagram of Models CM24, CM36 and CM10 Fans, prepared by Fenestration Testing Laboratory (FTL) a QAI Company, Test Report No. **20-1009**, dated 04/26/2021, signed and sealed by Idalmis Ortega, P.E. on 06/10/2022.

C. CALCULATIONS

1. Anchor verification calculations, prepared by Rice Engineering, dated 06/10/2021, signed and sealed by Wayne K. Helmila, P.E. on 06/07/2022.

D. QUALITY ASSURANCE

1. Miami-Dade Department of Regulatory and Economic Resources (RER).

E. MATERIAL CERTIFICATIONS

1. None.

F. STATEMENTS

1. Statement letter of code conformance to the 8th edition (2023) of the FBC, issued Rice Engineering, dated 04/22/2024, signed and sealed by Wayne K. Helmila, P.E.
2. Statement letter of code conformance to the 7th edition (2020) of the FBC, issued Rice Engineering, dated 06/10/2021, signed and sealed by Wayne K. Helmila, P.E.
3. Statement letter of no financial interest, issued by Rice Engineering, dated 06/10/2021, signed and sealed by Wayne K. Helmila, P.E.
4. Distributor agreement 06/28/2021.



Carlos M. Utrera, P.E.
Product Control Examiner
NOA No. 24-0429.08
Expiration Date: July 14, 2027
Approval Date: May 30, 2024

SIZE	A	B	C	D	E	F	G	WT
10	23.54	18.63	23.74	17.28	19.53	25.43	12.05	123
12	26.81	21.75	29.13	21.70	23.95	28.52	15.16	154
14	25.58	21.75	32.65	23.04	25.29	30.59	16.59	172
16	29.65	32.26	36.65	25.32	27.57	31.36	18.36	202
18	35.20	26.04	40.75	28.58	30.83	36.90	20.65	251
20	36.81	28.89	44.76	31.50	33.75	38.38	22.61	287
22	38.78	30.87	49.19	35.17	37.42	40.48	25.20	389
24	40.16	33.82	57.05	39.45	41.70	41.74	29.75	465
27	47.56	36.95	58.86	43.96	47.21	49.87	31.34	680
30	51.18	41.50	63.90	49.24	52.49	53.56	34.33	931
36	52.36	46.63	71.69	55.29	58.54	54.65	38.43	1228

ALL DIMENSION ARE IN INCHES AND WEIGHT IN POUNDS UNLESS NOTED.

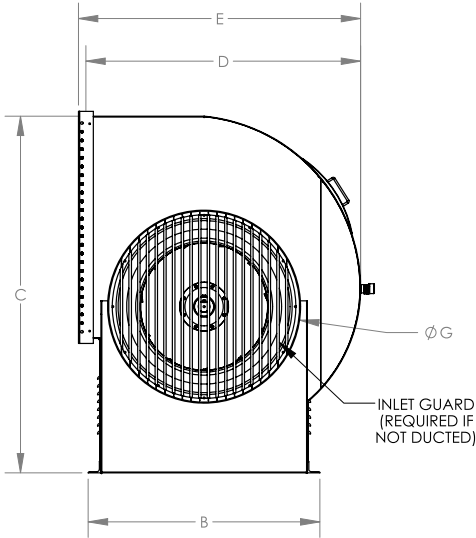
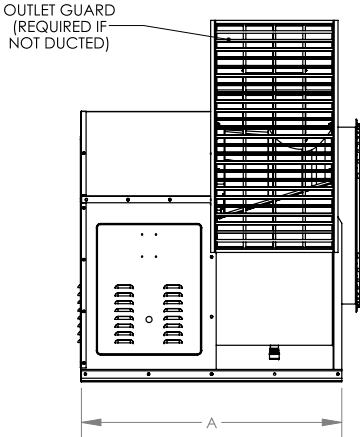
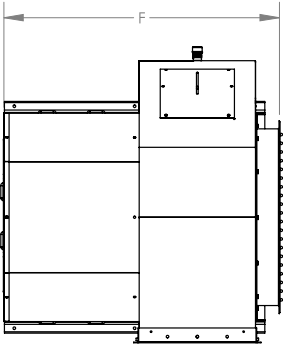

PRESSURE RATING
± 100 PSF

PRODUCT REVISED
as complying with the Florida
Building Code
NOA-No. 24-0429.08

Expiration Date 07/14/2027

By *[Signature]*
Miami-Dade Product Control

PRODUCT APPROVED
as complying with the Florida
Building Code
NOA-No. 21-0722.05
Approval Date 07/14/2022
By *[Signature]*
Miami-Dade Product Control

RICE
ENGINEERING
105 School Creek Trail
Luxemburg, WI 54217
Phone: (920) 617-1042
Fax: (920) 617-1100
www.rice-inc.com

Florida Firm No: F-01000005061
Certificate of Authorization: #9090
Wayne K. Helmila
Registration No: 59092

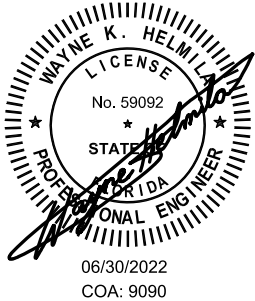

NOTES:

1. MODELS CM/CMHT/CMRHUL HAVE BEEN SUCCESSFULLY TESTED IN ACCORDANCE WITH FLORIDA BUILDING CODE/MIAMI DADE TEST PROTOCOL TAS 201 (LARGE IMPACT) AND TAS 202 (STATIC PRESSURE LOADING).
2. MODELS CM/CMHT/CMRHUL HAVE BEEN SUCCESSFULLY TESTED AND ANALYZED IN ACCORDANCE WITH 2020 FLORIDA BUILDING CODE.
3. THIS APPROVAL IS FOR THE STRUCTURAL PERFORMANCE AND IMPACT RESISTANCE ONLY. INTERIOR MECHANISM AND/OR ELECTRICAL CIRCUITRY ARE OUTSIDE THE SCOPE OF THIS APPROVAL.
4. THIS FAN/VENT HAS NOT BEEN TESTED FOR WATER PENETRATION ACCORDING TO FLORIDA BUILDING CODE, TAS 100(A) WIND DRIVEN RAIN TEST. IT CANNOT BE INSTALLED WITHIN THE RIDGE AREA FBC 1523.6.5.2.13.
5. DESIGN, TESTING, AND INSTALLATION CONFORMS TO FLORIDA BUILDING CODE.
6. ROOF STRUCTURE MUST BE DESIGNED TO WITHSTAND THE WEIGHT AND LOADING TRANSMITTED BY THE FANS. FASTENERS SHALL BE AS SPECIFIED AND INSTALLED AS DETAILED.
7. FAN CURBS MUST BE ANCHORED TO ROOF FRAMING MEMBERS.
8. All Stainless Steel Fasteners are to be provided as S.S. Series 300 Fasteners

REVISIONS				
REV	DESCRIPTION	BY	DATE	ECN
A	RELEASE	JX	9/9/20	-----
B	UPDATE ISOLATOR DETAILS	JX	6/18/21	-----
C	PRINTS UPDATED TO NOTES SUPPLIED BY MD REVIEW ENGINEER	JJD	5/30/22	-----

UNLESS OTHERWISE SPECIFIED
DIMENSIONS ARE IN INCHES

TOLERANCES ARE

FRACTIONS	DECIMALS	ANGLES
± 1/16	XX ± .03 XXX ± .005	± 1°

THIRD ANGLE
PROJECTION
⊕

DRAWN BY
JX
CHECKED BY
JX

DATE
9/1/2020
DATE
9/9/2020



S&P USA VENTILATION
SYSTEMS, LLC

JACKSONVILLE, FLORIDA

CM/CMHT/CMRHUL HIGH WIND

SIZE	PART NO.	REV.
B	CMMD	C
SCALE: 1:25 DO NOT SCALE DRAWING		SHEET 1 OF 8

SIZE	HOUSING - SIDE		HOUSING - SCROLL		INLET VENTURI		INLET FLANGE	
	MATERIAL	THK	MATERIAL	THK	MATERIAL	THK	MATERIAL	THK
10	CARBON STEEL	16	CARBON STEEL	18	G-90 GALV	20	G-90 GALV	18
12	CARBON STEEL	16	CARBON STEEL	18	G-90 GALV	20	G-90 GALV	16
14	CARBON STEEL	16	CARBON STEEL	18	G-90 GALV	20	G-90 GALV	16
16	CARBON STEEL	16	CARBON STEEL	18	G-90 GALV	20	G-90 GALV	14
18	CARBON STEEL	16	CARBON STEEL	18	G-90 GALV	20	G-90 GALV	14
20	CARBON STEEL	16	CARBON STEEL	18	G-90 GALV	16	G-90 GALV	14
22	CARBON STEEL	12	CARBON STEEL	16	G-90 GALV	16	G-90 GALV	14
24	CARBON STEEL	12	CARBON STEEL	16	G-90 GALV	16	G-90 GALV	14
27	CARBON STEEL	12	CARBON STEEL	12	G-90 GALV	16	G-90 GALV	14
30	CARBON STEEL	10	CARBON STEEL	12	G-90 GALV	16	G-90 GALV	14
36	CARBON STEEL	10	CARBON STEEL	12	G-90 GALV	16	G-90 GALV	14

SIZE	INLET SUPPORT		HOUSING SUPPORT PLATE		OUTLET FLANGE		MOUNTING ANGLE	
	MATERIAL	THK	MATERIAL	THK	MATERIAL	THK	MATERIAL	THK
10	CARBON STEEL	14	CARBON STEEL	14	G-90 GALV	16	G-90 GALV	10
12	CARBON STEEL	14	CARBON STEEL	14	G-90 GALV	16	G-90 GALV	10
14	CARBON STEEL	14	CARBON STEEL	14	G-90 GALV	16	G-90 GALV	10
16	CARBON STEEL	14	CARBON STEEL	14	G-90 GALV	16	G-90 GALV	10
18	CARBON STEEL	14	CARBON STEEL	14	G-90 GALV	16	G-90 GALV	10
20	CARBON STEEL	14	CARBON STEEL	14	G-90 GALV	14	G-90 GALV	10
22	CARBON STEEL	12	CARBON STEEL	12	G-90 GALV	14	G-90 GALV	10
24	CARBON STEEL	12	CARBON STEEL	12	G-90 GALV	14	G-90 GALV	10
27	CARBON STEEL	12	CARBON STEEL	12	G-90 GALV	12	G-90 GALV	1/4
30	CARBON STEEL	12	CARBON STEEL	12	G-90 GALV	12	G-90 GALV	1/4
36	CARBON STEEL	10	CARBON STEEL	10	G-90 GALV	14	G-90 GALV	1/4

SIZE	BEARING PEDESTAL		WEATHER COVER - TOP		WEATHER COVER - SIDE		WEATHER COVER - END COVER	
	MATERIAL	THK	MATERIAL	THK	MATERIAL	THK	MATERIAL	THK
10	CARBON STEEL	14	CARBON STEEL	20	-	-	CARBON STEEL	20
12	CARBON STEEL	14	CARBON STEEL	20	-	-	CARBON STEEL	20
14	CARBON STEEL	14	CARBON STEEL	20	-	-	CARBON STEEL	20
16	CARBON STEEL	14	CARBON STEEL	20	-	-	CARBON STEEL	20
18	CARBON STEEL	14	CARBON STEEL	20	-	-	CARBON STEEL	20
20	CARBON STEEL	14	CARBON STEEL	20	-	-	CARBON STEEL	20
22	CARBON STEEL	12	CARBON STEEL	18	-	-	CARBON STEEL	18
24	CARBON STEEL	12	CARBON STEEL	18	-	-	CARBON STEEL	18
27	CARBON STEEL	12	CARBON STEEL	18	CARBON STEEL	18	CARBON STEEL	18
30	CARBON STEEL	12	CARBON STEEL	18	CARBON STEEL	18	CARBON STEEL	18
36	CARBON STEEL	10	CARBON STEEL	16	CARBON STEEL	16	CARBON STEEL	16

THICKNESS (THK) EXPRESSED IN GAUGE OR 1/4"

PRODUCT REVISED
as complying with the Florida
Building Code
NOA-No. 24-0429.08

Expiration Date 07/14/2027

By 
Miami-Dade Product Control

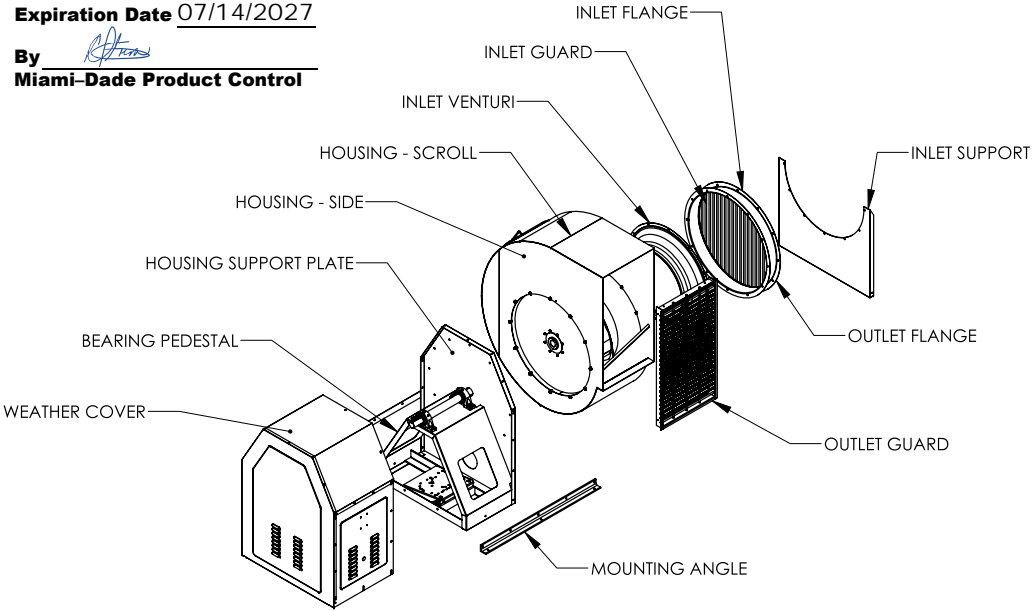

SEE PAGE 3 FOR FASTNER LISTING
SEE PAGE 4 FOR WELD LOCATIONS

PRODUCT APPROVED
as complying with the Florida
Building Code
NOA-No. 21-0722.05

Approval Date 07/14/2022

By 
Miami-Dade Product Control

RICE
ENGINEERING

105 School Creek Trail
Luxemburg, WI 54217
Phone: (920) 617-1042
Fax: (920) 617-1100
www.rice-inc.com

Florida Firm No: F-01000005061
Certificate of Authorization: #9090
Wayne K. Helmila
Registration No: 59092

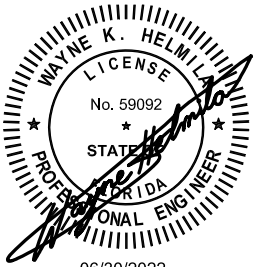

06/30/2022
COA: 9090

UNLESS OTHERWISE SPECIFIED
DIMENSIONS ARE IN INCHES

TOLERANCES ARE

FRACTIONS	DECIMALS	ANGLES
± 1/16	XX ± .03 XXX ± .005	± 1°

THIRD ANGLE
PROJECTION

DRAWN BY
JX
CHECKED BY
JX

DATE
9/1/2020
DATE
9/9/2020



S&P USA VENTILATION
SYSTEMS, LLC

JACKSONVILLE, FLORIDA

CM/CMHT/CMRHUL HIGH WIND

SIZE	PART NO.	REV.
B	CMMD	C
SCALE: 1:40 DO NOT SCALE DRAWING		SHEET 2 OF 8

Fastener Listing

REVISIONS				
REV	DESCRIPTION	BY	DATE	ECN
A	RELEASE	JX	9/9/20	-----
B	UPDATE ISOLATOR DETAILS	JX	6/18/21	-----
C	PRINTS UPDATED TO NOTES SUPPLIED BY MD REVIEW ENGINEER	JJD	5/30/22	-----

CM Size	Weather cover	Bearing Pedestal	Housing support plate/Scroll ass'y/ Inlet Support	Mounting Angle	Inlet guard	Outlet guard	CM Size	Weather cover	Bearing Pedestal	Housing support plate/Scroll ass'y/ Inlet Support	Mounting Angle	Inlet guard	Outlet guard
10	1/4-20 Riv-Nut, 1/4-20 X 3/4 Hex bolt Grade 2, 1/4 Lock Washer Grade 2	1/4-20 Riv-Nut, 1/4-20 X 3/4 Hex Bolt Grade 2, 3/8-16 x 1-1/2 Hex Bolt Grade 5, 3/8 Flat Washer Grade 5, 3/8 Lock Washer Grade 5	1/4-20 Riv-Nut, 1/4-20 X 3/4 Hex bolt Grade 2, 1/4 Lock Washer Grade 2	1/4-20 Riv-Nut, 1/4-20 X 3/4 Hex bolt Grade 2, 1/4 Flat Washer Grade 2, 1/4 Lock Washer Grade 2	1/4-20 Riv-Nut, 1/4-20 X 3/4 Hex Bolt Grade 2, 1/4 Washer Grade 2, 1/4 Lock Washer Grade 2, 3/8-16 x 1/2 Hex Bolt Grade 2, 3/8-16 Hex Nut Grade 2, 3/8 Flat Washer Grade 2, 3/8 Lock Washer Grade 2	5/16-18 x 3/4 Hex Bolt Grade 2, 5/16-18 Hex Nut, Grade 2, 5/16 Flat Washer Grade 2, 5/16 Lock Washer Grade 2	22	1/4-20 Riv-Nut, 1/4-20 X 3/4 Hex bolt Grade 2, 1/4 Lock Washer Grade 2	1/4-20 Riv-Nut, 1/4-20 X 3/4 Hex Bolt Grade 2, 1/4-20 X 3/4 Hex Bolt Grade 5, 1/2-13 x 2 Hex Bolt Grade 5, 1/2-13 Hex-Nut Grade 5, 5/16 Flat Washer Grade 5, 1/2 Lock Washer Grade 5	1/4-20 Riv-Nut, 1/4-20 X 3/4 Hex Bolt Grade 2, 1/4 Lock Washer Grade 2	5/16-18 Riv-Nut, 5/16-18 X 1 Hex Bolt Grade 2, 5/16 Flat Washer Grade 2, 5/16 Lock Washer Grade 2	5/16-18 Riv-Nut, 5/16-18 X 1 Hex Bolt Grade 2, 5/16 Flat Washer Grade 2, 5/16 Lock Washer Grade 2	5/16-18 x 3/4 Hex Bolt Grade 2, 5/16-18 Hex Nut, Grade 2, 5/16 Flat Washer Grade 2, 5/16 Lock Washer Grade 2
12	1/4-20 Riv-Nut, 1/4-20 X 3/4 Hex bolt Grade 2, 1/4 Lock Washer Grade 2	1/4-20 Riv-Nut, 1/4-20 X 3/4 Hex Bolt Grade 2, 3/8-16 x 1-1/2 Hex Bolt Grade 5, 3/8 Flat Washer Grade 5, 3/8 Lock Washer Grade 5	1/4-20 Riv-Nut, 1/4-20 X 3/4 Hex bolt Grade 2, 1/4 Lock Washer Grade 2	1/4-20 Riv-Nut, 1/4-20 X 3/4 Hex bolt Grade 2, 1/4 Flat Washer Grade 2, 1/4 Lock Washer Grade 2	1/4-20 Riv-Nut, 1/4-20 X 3/4 Hex Bolt Grade 2, 1/4 Washer Grade 2, 1/4 Lock Washer Grade 2, 3/8-16 x 1/2 Hex Bolt Grade 2, 3/8-16 Hex Nut Grade 2, 3/8 Flat Washer Grade 2, 3/8 Lock Washer Grade 2	5/16-18 x 3/4 Hex Bolt Grade 2, 5/16-18 Hex Nut, Grade 2, 5/16 Flat Washer Grade 2, 5/16 Lock Washer Grade 2	24	5/16 Riv-nut, 5/16-18 x 3/4 Hex Bolt Grade 2, 5/16 Flat Washer Grade 2, 5/16 Lock Washer Grade 2	5/16 Riv-nut, 5/16-18 x 3/4 Hex Bolt Grade 2, 5/16 Flat Washer Grade 2, 5/16 Lock Washer Grade 2	5/16 Riv-nut, 5/16-18 x 3/4 Hex Bolt Grade 2, 5/16 Flat Washer Grade 2, 5/16 Lock Washer Grade 2	1/2-13 Riv-Nut, 1/2-13 X 1.0 Hex Bolt Grade 2, 1/2 Flat Washer Grade 2, 1/2 Lock Washer Grade 2	5/16-18 Riv-Nut, 5/16-18 X 1 Hex Bolt Grade 2, 5/16 Flat Washer Grade 2, 5/16 Lock Washer Grade 2	5/16-18 x 3/4 Hex Bolt Grade 2, 5/16-18 Hex Nut, Grade 2, 5/16 Flat Washer Grade 2, 5/16 Lock Washer Grade 2
14	1/4-20 Riv-Nut, 1/4-20 X 3/4 Hex bolt Grade 2, 1/4 Lock Washer Grade 2	1/4-20 Riv-Nut, 1/4-20 X 3/4 Hex Bolt Grade 2, 3/8-16 x 1-1/2 Hex Bolt Grade 5, 3/8 Flat Washer Grade 5, 3/8 Lock Washer Grade 5	1/4-20 Riv-Nut, 1/4-20 X 3/4 Hex bolt Grade 2, 1/4 Lock Washer Grade 2	1/4-20 Riv-Nut, 1/4-20 X 3/4 Hex bolt Grade 2, 1/4 Flat Washer Grade 2, 1/4 Lock Washer Grade 2	1/4-20 Riv-Nut, 1/4-20 X 3/4 Hex Bolt Grade 2, 1/4 Washer Grade 2, 1/4 Lock Washer Grade 2, 3/8-16 x 1/2 Hex Bolt Grade 2, 3/8-16 Hex Nut Grade 2, 3/8 Flat Washer Grade 2, 3/8 Lock Washer Grade 2	5/16-18 x 3/4 Hex Bolt Grade 2, 5/16-18 Hex Nut, Grade 2, 5/16 Flat Washer Grade 2, 5/16 Lock Washer Grade 2	27	5/16 Riv-nut, 5/16-18 x 3/4 Hex Bolt Grade 2, 5/16 Flat Washer Grade 2, 5/16 Lock Washer Grade 2	5/16 Riv-nut, 5/16-18 x 3/4 Hex Bolt Grade 2, 5/16 Flat Washer Grade 2, 5/16 Lock Washer Grade 2	5/16 Riv-nut, 5/16-18 x 3/4 Hex Bolt Grade 2, 5/16 Flat Washer Grade 2, 5/16 Lock Washer Grade 2	1/2-13 Riv-Nut, 1/2-13 X 1.0 Hex Bolt Grade 2, 1/2 Flat Washer Grade 2, 1/2 Lock Washer Grade 2	1/4-20 Riv-Nut, 1/4-20 X 3/4 Hex Bolt Grade 2, 1/4 Washer Grade 2, 1/4 Lock Washer Grade 2, 3/8-16 x 1/2 Hex Bolt Grade 2, 3/8-16 Hex Nut Grade 2, 3/8 Flat Washer Grade 2, 3/8 Lock Washer Grade 2	5/16-18 x 3/4 Hex Bolt Grade 2, 5/16-18 Hex Nut, Grade 2, 5/16 Flat Washer Grade 2, 5/16 Lock Washer Grade 2
16	1/4-20 Riv-Nut, 1/4-20 X 3/4 Hex bolt Grade 2, 1/4 Lock Washer Grade 2	1/4-20 Riv-Nut, 1/4-20 X 3/4 Hex Bolt Grade 2, 3/8-16 x 1-1/2 Hex Bolt Grade 5, 3/8 Flat Washer Grade 5, 3/8 Lock Washer Grade 5	1/4-20 Riv-Nut, 1/4-20 X 3/4 Hex bolt Grade 2, 1/4 Lock Washer Grade 2	1/4-20 Riv-Nut, 1/4-20 X 3/4 Hex bolt Grade 2, 1/4 Flat Washer Grade 2, 1/4 Lock Washer Grade 2	1/4-20 Riv-Nut, 1/4-20 X 3/4 Hex Bolt Grade 2, 1/4 Washer Grade 2, 1/4 Lock Washer Grade 2, 3/8-16 x 1/2 Hex Bolt Grade 2, 3/8-16 Hex Nut Grade 2, 3/8 Flat Washer Grade 2, 3/8 Lock Washer Grade 2	5/16-18 x 3/4 Hex Bolt Grade 2, 5/16-18 Hex Nut, Grade 2, 5/16 Flat Washer Grade 2, 5/16 Lock Washer Grade 2	30	5/16 Riv-nut, 5/16-18 x 3/4 Hex Bolt Grade 2, 5/16 Flat Washer Grade 2, 5/16 Lock Washer Grade 2	5/16 Riv-nut, 5/16-18 x 3/4 Hex Bolt Grade 2, 5/16 Flat Washer Grade 2, 5/16 Lock Washer Grade 2	3/8-16 Riv-Nut, 3/8-16 X 1 Hex Bolt Grade 2, 3/8 Flat Washer Grade 2, 3/8 Lock Washer Grade 2	1/2-13 Riv-Nut, 1/2-13 X 1.0 Hex Bolt Grade 2, 1/2 Flat Washer Grade 2, 1/2 Lock Washer Grade 2	1/4-20 Riv-Nut, 1/4-20 X 3/4 Hex Bolt Grade 2, 1/4 Washer Grade 2, 1/4 Lock Washer Grade 2, 3/8-16 x 1/2 Hex Bolt Grade 2, 3/8-16 Hex Nut Grade 2, 3/8 Flat Washer Grade 2, 3/8 Lock Washer Grade 2	5/16-18 x 3/4 Hex Bolt Grade 2, 5/16-18 Hex Nut, Grade 2, 5/16 Flat Washer Grade 2, 5/16 Lock Washer Grade 2
18	1/4-20 Riv-Nut, 1/4-20 X 3/4 Hex bolt Grade 2, 1/4 Lock Washer Grade 2	1/4-20 Riv-Nut, 1/4-20 X 3/4 Hex Bolt Grade 2, 1/2-13 x 2 Hex Bolt Grade 5, 1/2-13 Hex-Nut Grade 5, 1/2 Flat Washer Grade 5, 1/2 Lock Washer Grade 5	1/4-20 Riv-Nut, 1/4-20 X 3/4 Hex bolt Grade 2, 1/4 Lock Washer Grade 2	1/4-20 Riv-Nut, 1/4-20 X 3/4 Hex bolt Grade 2, 1/4 Flat Washer Grade 2, 1/4 Lock Washer Grade 2	1/4-20 Riv-Nut, 1/4-20 X 3/4 Hex Bolt Grade 2, 1/4 Washer Grade 2, 1/4 Lock Washer Grade 2, 3/8-16 x 1/2 Hex Bolt Grade 2, 3/8-16 Hex Nut Grade 2, 3/8 Flat Washer Grade 2, 3/8 Lock Washer Grade 2	5/16-18 x 3/4 Hex Bolt Grade 2, 5/16-18 Hex Nut, Grade 2, 5/16 Flat Washer Grade 2, 5/16 Lock Washer Grade 2	36	5/16 Riv-nut, 5/16-18 x 3/4 Hex Bolt Grade 2, 5/16 Flat Washer Grade 2, 5/16 Lock Washer Grade 2	5/16 Riv-nut, 5/16-18 x 3/4 Hex Bolt Grade 2, 5/16 Flat Washer Grade 2, 5/16 Lock Washer Grade 2	3/8-16 Riv-Nut, 3/8-16 X 1 Hex Bolt Grade 2, 3/8 Flat Washer Grade 2, 3/8 Lock Washer Grade 2	1/2-13 Riv-Nut, 1/2-13 X 1.0 Hex Bolt Grade 2, 1/2 Flat Washer Grade 2, 1/2 Lock Washer Grade 2	1/4-20 Riv-Nut, 1/4-20 X 3/4 Hex Bolt Grade 2, 1/4 Washer Grade 2, 1/4 Lock Washer Grade 2, 3/8-16 x 1/2 Hex Bolt Grade 2, 3/8-16 Hex Nut Grade 2, 3/8 Flat Washer Grade 2, 3/8 Lock Washer Grade 2	5/16-18 x 3/4 Hex Bolt Grade 2, 5/16-18 Hex Nut, Grade 2, 5/16 Flat Washer Grade 2, 5/16 Lock Washer Grade 2
20	1/4-20 Riv-Nut, 1/4-20 X 3/4 Hex bolt Grade 2, 1/4 Lock Washer Grade 2	1/4-20 Riv-Nut, 1/4-20 X 3/4 Hex Bolt Grade 2, 1/2-13 x 2 Hex Bolt Grade 5, 1/2-13 Hex-Nut Grade 5, 1/2 Flat Washer Grade 5, 1/2 Lock Washer Grade 5	1/4-20 Riv-Nut, 1/4-20 X 3/4 Hex bolt Grade 2, 1/4 Lock Washer Grade 2	5/16-18 Riv-Nut, 1/4-20 X 3/4 Hex Bolt Grade 2, 5/16 Flat Washer Grade 2, 5/16 Lock Washer Grade 2	1/4-20 Riv-Nut, 1/4-20 X 3/4 Hex Bolt Grade 2, 1/4 Washer Grade 2, 1/4 Lock Washer Grade 2, 3/8-16 x 1/2 Hex Bolt Grade 2, 3/8-16 Hex Nut Grade 2, 3/8 Flat Washer Grade 2, 3/8 Lock Washer Grade 2	5/16-18 x 3/4 Hex Bolt Grade 2, 5/16-18 Hex Nut, Grade 2, 5/16 Flat Washer Grade 2, 5/16 Lock Washer Grade 2	Notes: Grades are based on SAE J429 & J995 Minimum Corrosion protection Zinc Plating All dimensions in inches Typical call out: 5/16-18 x 3/4 Hex Bolt Grade 2 (Fastener size)(Threads per inch)(X (Length)(Description)(Grade))						

PRODUCT REVISED
as complying with the Florida
Building Code
NOA-No. 24-0429.08
Expiration Date 07/14/2027
By 
Miami-Dade Product Control

PRODUCT APPROVED
as complying with the Florida
Building Code
NOA-No. 21-0722.05
Approval Date 07/14/2022
By 
Miami-Dade Product Control

RICE
ENGINEERING
105 School Creek Trail
Luxemburg, WI 54217
Phone: (920) 617-1042
Fax: (920) 617-1100
www.rice-inc.com

Florida Firm No: F-01000005061
Certificate of Authorization: #9090
Wayne K. Helmila
Registration No: 59092

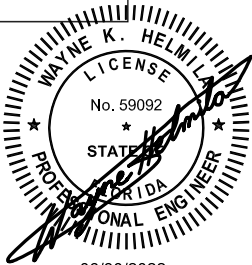

06/30/2022
COA: 9090

UNLESS OTHERWISE SPECIFIED
DIMENSIONS ARE IN INCHES

TOLERANCES ARE
FRACTIONS **DECIMALS** **ANGLES**
± 1/16 XX ± .03 ± 1°
XXX ± .005

THIRD ANGLE
PROJECTION

DRAWN BY
JX
CHECKED BY
JX

DATE
9/1/2020
DATE
9/9/2020



**S&P USA VENTILATION
SYSTEMS, LLC**

JACKSONVILLE, FLORIDA

CM/CMHT/CMRHUL HIGH WIND

SIZE PART NO.
B CMMD

REV.
C

SCALE: 1:40 DO NOT SCALE DRAWING

SHEET 3 OF 8

Scroll Weldment Scheme: CM units 10 Thru 24

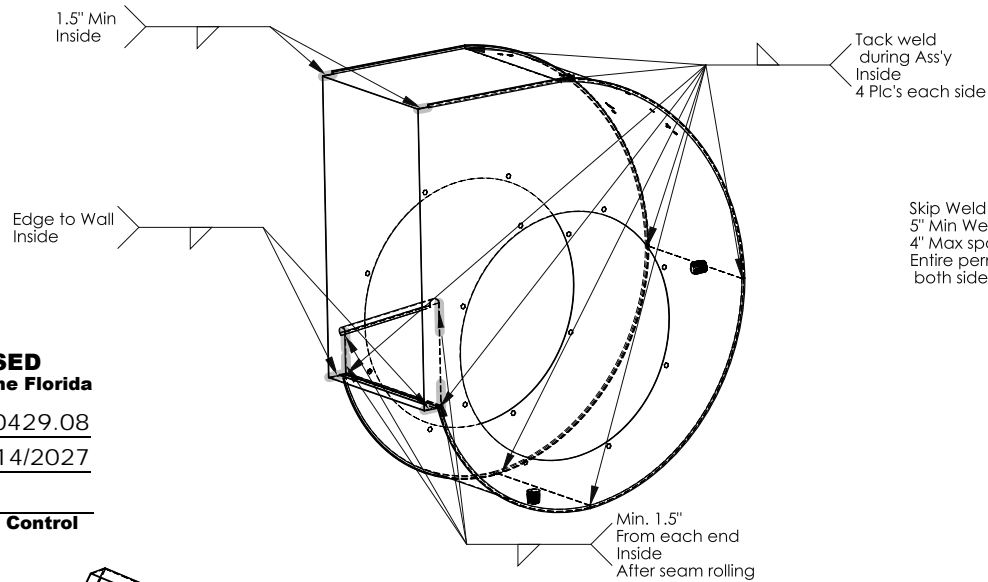

PRODUCT REVISED
as complying with the Florida
Building Code
NOA-No. 24-0429.08
Expiration Date 07/14/2027
By *[Signature]*
Miami-Dade Product Control

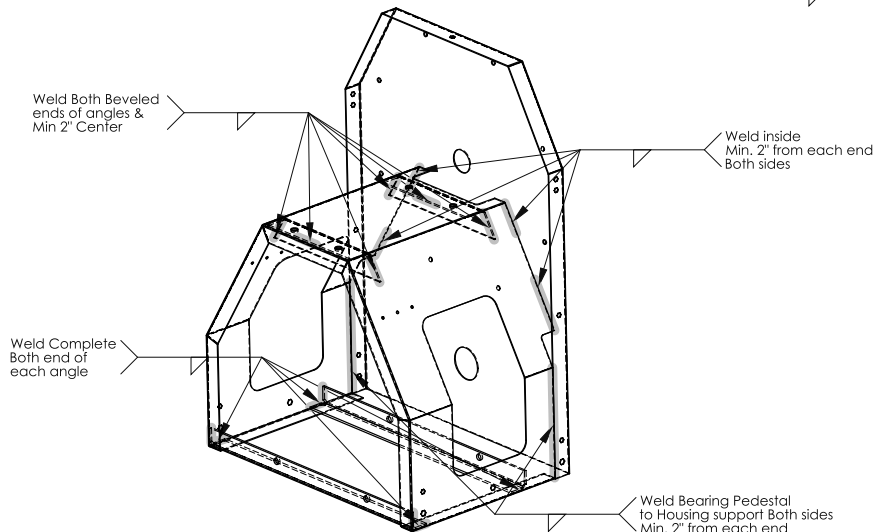

Bearing Pedestal/Housing Support weldment Scheme
All Sizes

RICE ENGINEERING

105 School Creek Trail
Luxemburg, WI 54217
Phone: (920) 617-1042
Fax: (920) 617-1100
www.rice-inc.com
Florida Firm No: F-01000005061
Certificate of Authorization: #9090
Wayne K. Helmila
Registration No: 59092

PRODUCT APPROVED
as complying with the Florida
Building Code
NOA-No. 21-0722.05
Approval Date 07/14/2022
By *[Signature]*
Miami-Dade Product Control

REVISIONS				
REV	DESCRIPTION	BY	DATE	ECN
A	RELEASE	JX	9/9/20	-----
B	UPDATE ISOLATOR DETAILS	JX	6/18/21	-----
C	PRINTS UPDATED TO NOTES SUPPLIED BY MD REVIEW ENGINEER	JJD	5/30/22	-----

Scroll Weldment Scheme: CM 27,30, and 36

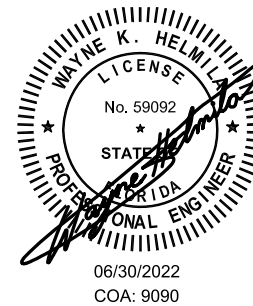
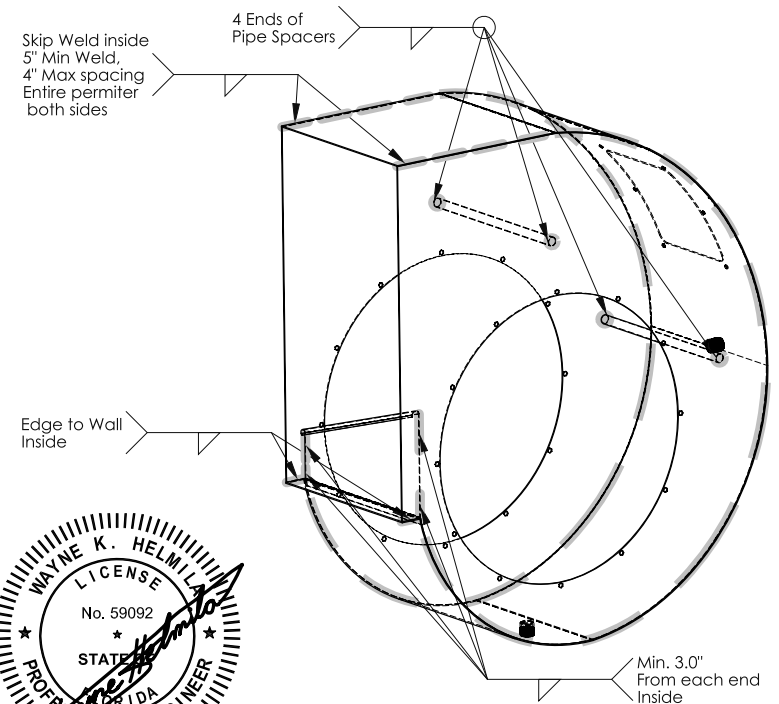

06/30/2022
COA: 9090

UNLESS OTHERWISE SPECIFIED
DIMENSIONS ARE IN INCHES

TOLERANCES ARE

FRACTIONS	DECIMALS	ANGLES
± 1/16	XX ± .03 XXX ± .005	± 1°

THIRD ANGLE PROJECTION 	DRAWN BY JX CHECKED BY JX	DATE 9/1/2020 DATE 9/9/2020
-------------------------------	------------------------------------	--------------------------------------



**S&P USA VENTILATION
SYSTEMS, LLC**

JACKSONVILLE, FLORIDA

CM/CMHT/CMRHUL HIGH WIND

SIZE PART NO. B CMMD	REV. C
SCALE: 1:25 DO NOT SCALE DRAWING	SHEET 4 OF 8

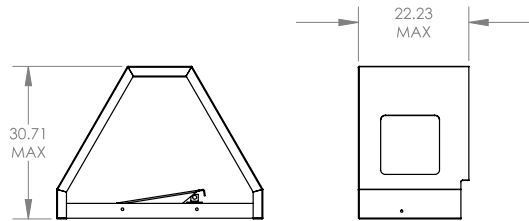
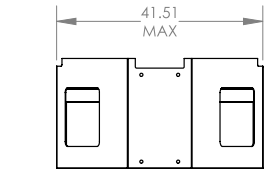

BEARING PEDESTAL

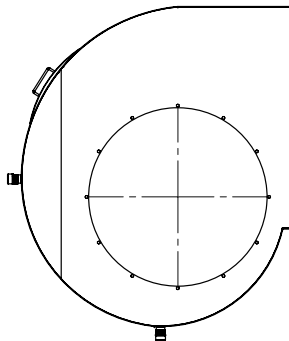
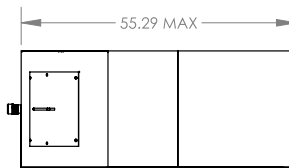

HOUSING ASSEMBLY (SIDES AND SCROLL)

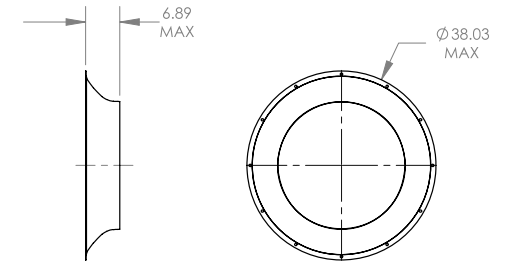
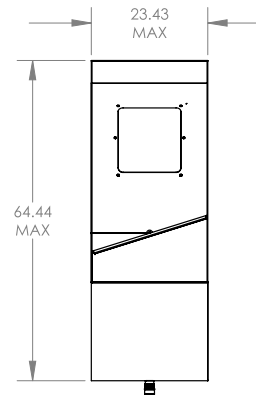

INLET VENTURI

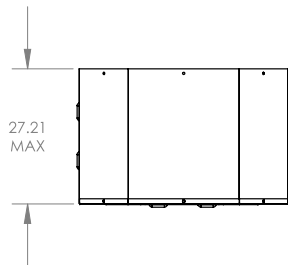

PRODUCT REVISED
as complying with the Florida
Building Code
NOA-No. 24-0429.08

Expiration Date 07/14/2027

By [Signature]
Miami-Dade Product Control

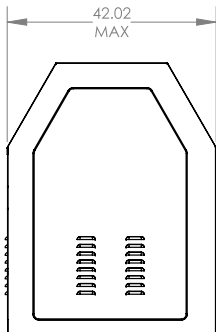

WEATHER COVER

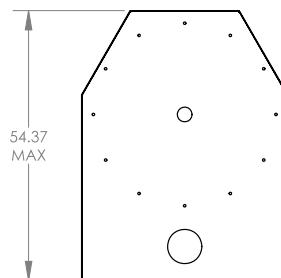
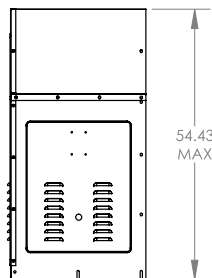

HOUSING SUPPORT PLATE

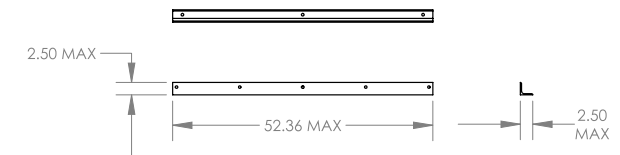
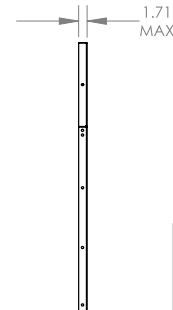

MOUNTING ANGLE

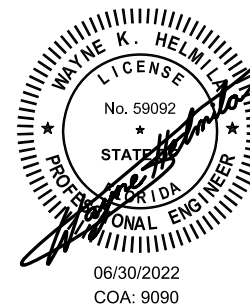

RICE
ENGINEERING

105 School Creek Trail
Luxemburg, WI 54217
Phone: (920) 617-1042
Fax: (920) 617-1100
www.rice-inc.com
Florida Firm No: F-01000005061
Certificate of Authorization: #9090
Wayne K. Helmila
Registration No: 59092

PRODUCT APPROVED
as complying with the Florida
Building Code
NOA-No. 21-0722.05
Approval Date 07/14/2022

By [Signature]
Miami-Dade Product Control

UNLESS OTHERWISE SPECIFIED
DIMENSIONS ARE IN INCHES

TOLERANCES ARE

FRACTIONS	DECIMALS	ANGLES
± 1/16	XX ± .03	± 1°
	XXX ± .005	

THIRD ANGLE
PROJECTION
⊕

DRAWN BY
JX
CHECKED BY
JX

DATE
9/1/2020
DATE
9/9/2020



**S&P USA VENTILATION
SYSTEMS, LLC**

JACKSONVILLE, FLORIDA

CM/CMHT/CMRHUL HIGH WIND

SIZE	PART NO.	REV.
B	CMMD	C

SCALE: 1:25 DO NOT SCALE DRAWING SHEET 5 OF 8

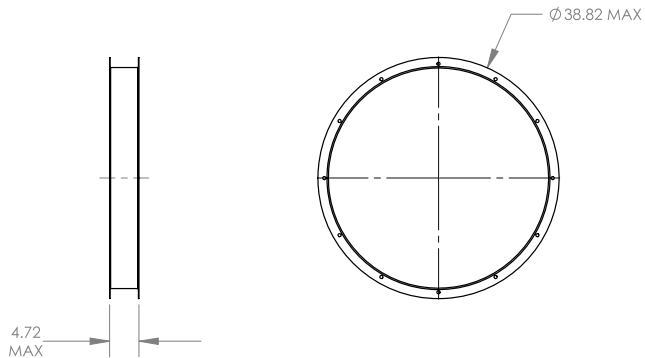

INLET FLANGE

PRODUCT REVISED
as complying with the Florida
Building Code
NOA-No. 24-0429.08

Expiration Date 07/14/2027

By [Signature]
Miami-Dade Product Control

REVISIONS				
REV	DESCRIPTION	BY	DATE	ECN
A	RELEASE	JX	9/9/20	-----
B	UPDATE ISOLATOR DETAILS	JX	6/18/21	-----
C	PRINTS UPDATED TO NOTES SUPPLIED BY MD REVIEW ENGINEER	JJD	5/30/22	-----

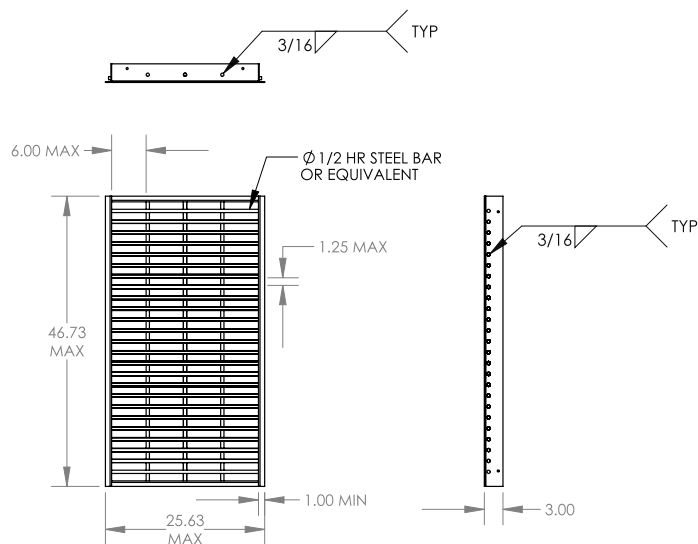

OUTLET GUARD

PRODUCT APPROVED
as complying with the Florida
Building Code
NOA-No. 21-0722.05
Approval Date 07/14/2022
By [Signature]
Miami-Dade Product Control

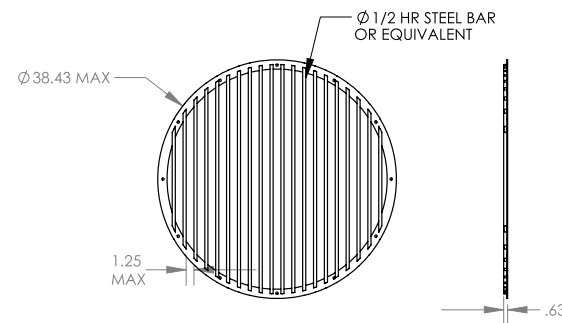

INLET GUARD

RICE
ENGINEERING

105 School Creek Trail
Luxemburg, WI 54217
Phone: (920) 617-1042
Fax: (920) 617-1100
www.rice-inc.com

Florida Firm No: F-01000005061
Certificate of Authorization: #9090
Wayne K. Helmila
Registration No: 59092

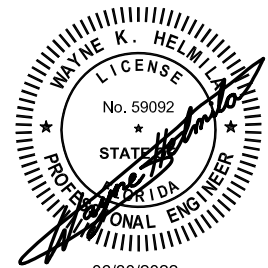

06/30/2022
COA: 9090

UNLESS OTHERWISE SPECIFIED
DIMENSIONS ARE IN INCHES

TOLERANCES ARE

FRACTIONS	DECIMALS	ANGLES
$\pm 1/16$	XX $\pm .03$ XXX $\pm .005$	$\pm 1^\circ$

THIRD ANGLE
PROJECTION

DRAWN BY
JX
CHECKED BY
JX

DATE
9/1/2020
DATE
9/9/2020



**S&P USA VENTILATION
SYSTEMS, LLC**

JACKSONVILLE, FLORIDA

CM/CMHT/CMRHUL HIGH WIND

SIZE PART NO.

B CMMD

SCALE: 1:20 DO NOT SCALE DRAWING

SHEET 6 OF 8

REV.
C

REVISIONS				
REV	DESCRIPTION	BY	DATE	ECN
A	RELEASE	JX	9/9/20	-----
B	UPDATE ISOLATOR DETAILS	JX	6/18/21	-----
C	PRINTS UPDATED TO NOTES SUPPLIED BY MD REVIEW ENGINEER	JJD	5/30/22	-----

SIZE	STEEL ROOF								WOOD & CONCRETE ROOF								FAN TO BASE ANGLE					
	A	B	D (DIA.)	E	F	G	QTY PER SIDE	TOTAL	A	B	D (DIA.)	E	F	G	QTY PER SIDE	TOTAL	H	J	K	L (BOLT SIZE OR EQUIV.)	QTY PER SIDE	TOTAL
10	17.00	22.31	0.31	2	3	6	6	12	17.00	22.31	0.44	3	4	12	8	16	4.50	18.50	-	5/16"-18 S.S. THRU-BOLT	2	4
12	19.75	25.56	0.31	2	3	6	6	12	19.75	25.56	0.44	3	4	12	8	16	4.50	21.88	-	5/16"-18 S.S. THRU-BOLT	2	4
14	19.75	27.31	0.31	2	3	6	6	12	19.75	27.31	0.44	3	4	12	8	16	4.69	23.38	-	5/16"-18 S.S. THRU-BOLT	2	4
16	21.25	28.38	0.31	2	3	6	6	12	21.25	28.38	0.44	3	4	12	8	16	4.69	24.56	-	5/16"-18 S.S. THRU-BOLT	2	4
18	24.06	33.94	0.31	2	3	6	6	12	24.06	33.94	0.44	3	4	12	8	16	5.81	28.81	-	5/16"-18 S.S. THRU-BOLT	2	4
20	26.81	35.56	0.31	2	3	6	6	12	26.81	35.56	0.44	3	4	12	8	16	5.75	30.00	-	5/16"-18 S.S. THRU-BOLT	2	4
22	29.13	37.50	0.31	5	1.50	7.50	12	24	29.13	37.50	0.44	4	4	16	10	20	6.19	31.81	14.94	1/2" S.S. THRU-BOLT	3	6
24	32.31	38.94	0.31	5	1.50	7.50	12	24	32.31	38.94	0.44	4	4	16	10	20	5.63	33.81	15.00	1/2" S.S. THRU-BOLT	3	6
27	35.19	46.31	0.31	5	1.50	7.50	12	24	35.19	46.31	0.44	4	4	16	10	20	0.81	46.00	25.25	1/2" S.S. THRU-BOLT	3	6
30	39.63	49.94	0.31	5	1.50	7.50	12	24	39.63	49.94	0.44	4	4	16	10	20	0.81	49.63	26.75	1/2" S.S. THRU-BOLT	3	6
36	44.38	51.13	0.31	5	1.50	7.50	12	24	44.38	51.13	0.44	4	4	16	10	20	0.81	50.81	25.38	1/2" S.S. THRU-BOLT	3	6

ALL DIMENSION ARE IN INCHES AND WEIGHT IN POUNDS UNLESS NOTED.

RICE ENGINEERING

105 School Creek Trail
Luxemburg, WI 54217
Phone: (920) 617-1042
Fax: (920) 617-1100
www.rice-inc.com

Florida Firm No: F-01000005061
Certificate of Authorization: #9090
Wayne K. Helmila
Registration No: 59092

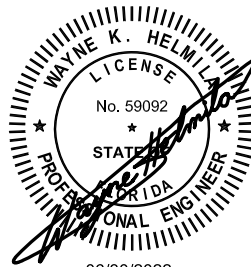

06/30/2022
COA: 9090

ROOF TRUSS
1/8" THICK OR
12 GA MIN

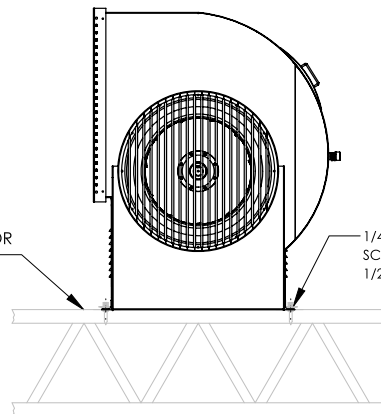

STEEL ANCHORING

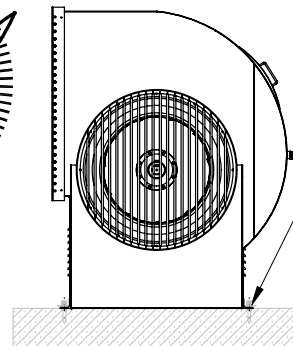

CONCRETE ANCHORING

PRODUCT APPROVED
as complying with the Florida
Building Code
NOA-No. **21-0722.05**

Approval Date **07/14/2022**

By *[Signature]*
Miami-Dade Product Control

3/8" DIA. SS HILTI KWIK BOLT TZ
EXPANSION ANCHORS OR EQUIVALENT
2-5/16" MIN. EMBEDMENT
3" MIN. EDGE DISTANCE

SIZE 10-20:
2500 MIN PSI
CONCRETE

SIZE 22-36:
4000 MIN PSI
CONCRETE

Seal all exposed Drill-Flex
Fasteners with Liquid Prosoco
Flashing.

1/4-20 DRILL-FLEX SELF DRILLING
SCREWS OR EQUIVALENT
1/2" MIN. EDGE AND END DISTANCE

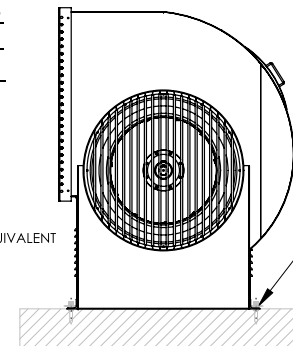

WOOD ANCHORING

PRODUCT REVISED
as complying with the Florida
Building Code
NOA-No. **24-0429.08**

Expiration Date **07/14/2027**

By *[Signature]*
Miami-Dade Product Control

3/8" DIA. S.S.
LAG BOLTS OR EQUIVALENT
3-1/2" MIN. THREAD PENETRATION
1-1/2" MIN. EDGE DIST

WOOD TIMBER
MIN 4" NOM. THK
MIN SG = 0.42

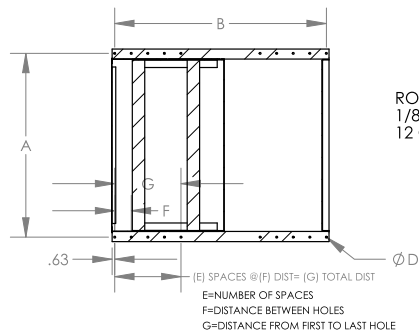
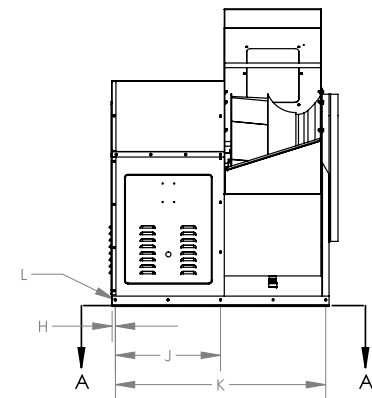

SECTION A-A

UNLESS OTHERWISE SPECIFIED
DIMENSIONS ARE IN INCHES

TOLERANCES ARE

FRACTIONS	DECIMALS	ANGLES
± 1/16	XX ± .03 XXX ± .005	± 1°

THIRD ANGLE
PROJECTION
⊕

DRAWN BY
JX
CHECKED BY
JX

DATE
9/1/2020
DATE
9/9/2020



**S&P USA VENTILATION
SYSTEMS, LLC**

JACKSONVILLE, FLORIDA

CM/CMHT/CMRHUL HIGH WIND

SIZE PART NO.	REV.
B CMMD	C
SCALE: 1:30 DO NOT SCALE DRAWING	SHEET 7 OF 8

SIZE	A	B	ISOLATOR PART NUMBER AT LOCATION			
			S1	S2	S3	S4
10	19.69	16.75	700000	700000	700000	700000
12	23.63	19.75	700000	700000	700000	700000
14	23.63	19.75	700000	700000	700000	700000
16	25.19	21.31	700000	700000	700000	700000
18	31.50	24.06	700000	700000	700000	700000
20	31.50	26.94	700000	700000	700000	700000
22	35.44	29.31	700000	700001	700000	700001
24	35.44	32.25	700001	700001	700001	700001
27	43.63	35.19	700001	700001	700001	700001
30	47.25	39.50	700002	700002	700002	700002
36	48.44	44.69	700002	700003	700002	700003

NOTES:

- STEEL ANCHORING
(4 QTY/ISOLATOR) 3/4" DIAMETER STAINLESS (300 SERIES, FY = 65KSI) THRU BOLT.
- WOOD ANCHORING
SIZES 10-20
(4 QTY/ISOLATOR) 3/4" DIAMETER STAINLESS LAG BOLT.
3" MIN THREAD PENETRATION. 1-1/2" MIN EDGE DISTANCE.
SIZES 22-36
(4 QTY/ISOLATOR) 3/4" DIAMETER STAINLESS LAG BOLT.
3" MIN THREAD PENETRATION. 3" MIN EDGE DISTANCE.
- CONCRETE ANCHORING
SIZES 10-20
(4 QTY/ISOLATOR) 3/4" DIA. SS HILTI KWIK BOLT TZ EXPANSION ANCHORS.
2-5/16" MIN EMBEDMENT. 2,500 PSI MIN CONCRETE.
SPACING PER ISOLATOR AS SHOWN. 6" MIN EDGE AND END DISTANCE.
SIZES 22-36
(4 QTY/ISOLATOR) 3/4" DIA. SS HILTI KWIK BOLT TZ EXPANSION ANCHORS.
4-5/16" MIN. EMBEDMENT. 4,000 PSI MIN NW CRACKED CONCRETE.
SPACING PER ISOLATOR AS SHOWN. 9" MIN EDGE AND END DISTANCE.

REVISIONS				
REV	DESCRIPTION	BY	DATE	ECN
A	RELEASE	JX	9/9/20	-----
B	UPDATE ISOLATOR DETAILS	JX	6/18/21	-----
C	PRINTS UPDATED TO NOTES SUPPLIED BY MD REVIEW ENGINEER	JJD	5/30/22	-----

PRODUCT REVISED
as complying with the Florida
Building Code
NOA-No. 24-0429.08

Expiration Date 07/14/2027

By *[Signature]*
Miami-Dade Product Control

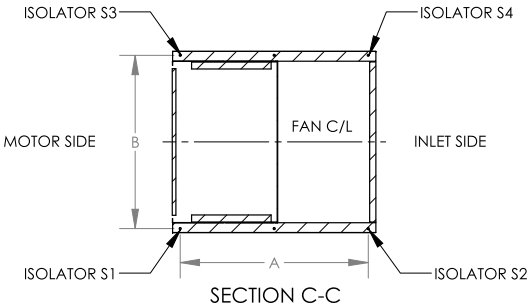
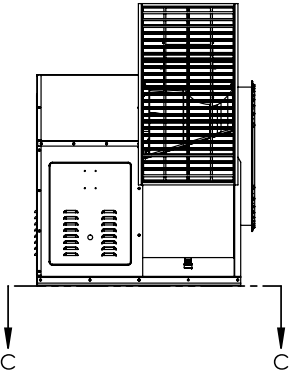

SECTION C-C

PRODUCT APPROVED
as complying with the Florida
Building Code
NOA-No. 21-0722.05
Approval Date 07/14/2022
By *[Signature]*
Miami-Dade Product Control

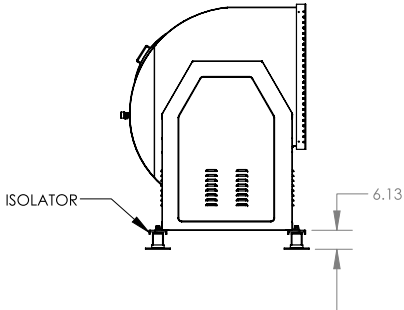

SPRING ISOLATOR ANCHORING

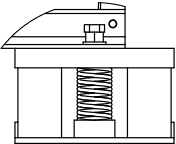
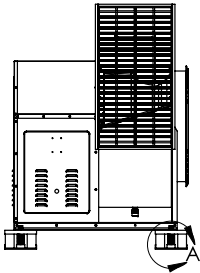

DETAIL A
SCALE 1 : 8

RICE
ENGINEERING

105 School Creek Trail
Luxemburg, WI 54217
Phone: (920) 617-1042
Fax: (920) 617-1100
www.rice-inc.com

Florida Firm No: F-01000005061
Certificate of Authorization: #9090
Wayne K. Helmila
Registration No: 59092

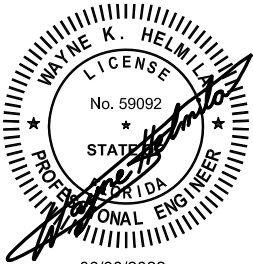

06/30/2022
COA: 9090

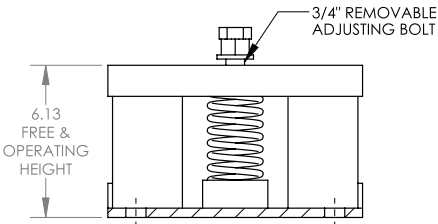
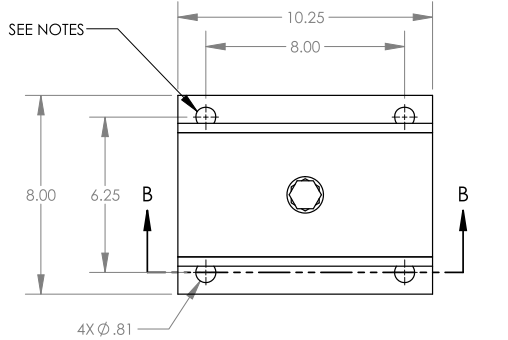

SECTION B-B
SCALE 1 : 5
Model MSS-1E or MSSH-1E
ISOLATOR DETAILS

UNLESS OTHERWISE SPECIFIED
DIMENSIONS ARE IN INCHES

TOLERANCES ARE

FRACTIONS	DECIMALS	ANGLES
± 1/16	XX ± .03 XXX ± .005	± 1°

THIRD ANGLE
PROJECTION
⊕

DRAWN BY
JX
CHECKED BY
JX

DATE
9/1/2020
DATE
9/9/2020



**S&P USA VENTILATION
SYSTEMS, LLC**

JACKSONVILLE, FLORIDA

CM/CMHT/CMRHUL HIGH WIND

SIZE	PART NO.	REV.
B	CMMD	C
SCALE: 1:40 DO NOT SCALE DRAWING		SHEET 8 OF 8