



DEPARTMENT OF REGULATORY AND ECONOMIC RESOURCES (RER)  
BOARD AND CODE ADMINISTRATION DIVISION

MIAMI-DADE COUNTY  
PRODUCT CONTROL SECTION

11805 SW 26 Street, Room 208  
Miami, Florida 33175-2474  
T (786) 315-2590 F (786) 315-2599

[www.miamidade.gov/economy](http://www.miamidade.gov/economy)

## NOTICE OF ACCEPTANCE (NOA)

**Nucor Corp. (Nucor Buildings Group)**  
**305 Industrial Parkway**  
**Waterloo, IN 46793**

### SCOPE:

This NOA is being issued under the applicable rules and regulations governing the use of construction materials. The documentation submitted has been reviewed and accepted by Miami-Dade County RER- Product Control Section to be used in Miami Dade County and other areas where allowed by the Authority Having Jurisdiction (AHJ).

This NOA shall not be valid after the expiration date stated below. The Miami-Dade County Product Control Section (In Miami Dade County) and/or the AHJ (in areas other than Miami Dade County) reserve the right to have this product or material tested for quality assurance purposes. If this product or material fails to perform in the accepted manner, the manufacturer will incur the expense of such testing and the AHJ may immediately revoke, modify, or suspend the use of such product or material within their jurisdiction. RER reserves the right to revoke this acceptance if it is determined by Miami-Dade County Product Control Section that this product or material fails to meet the requirements of the applicable building code.

This product is approved as described herein and has been designed to comply with the High Velocity Hurricane Zone of the Florida Building Code.

**DESCRIPTION:** 24 Ga. (0.023" min.) NBG R-Panel Structural Steel Roof Panel

**APPROVAL DOCUMENT:** Drawing No. MD-RPR24, titled "NBG R-Panel Roof Panels", sheets 1 through 5 of 5, prepared by Bala Sockalingam, P.E., last revision #0 dated 12/09/2024, signed and sealed by Bala Sockalingam, P.E. on 12/26/2024, bearing the Miami-Dade County Product Control Approval stamp with the Notice of Acceptance number and the approval date by the Miami-Dade County Product Control Section.

**MISSILE IMPACT RATING:** Large and Small Missile Impact Resistant

**LABELING:** Each panel shall bear a permanent label with the manufacturer's name or logo, Terrell, TX or Swansea, SC and the following statement: "Miami-Dade County Product Control Approved", unless otherwise noted herein.

**RENEWAL** of this NOA shall be considered after a renewal application has been filed and there has been no change in the applicable building code negatively affecting the performance of this product.

**TERMINATION** of this NOA will occur after the expiration date or if there has been a revision or change in the materials, use, and/or manufacture of the product or process. Misuse of this NOA as an endorsement of any product, for sales, advertising or any other purposes shall automatically terminate this NOA. Failure to comply with any section of this NOA shall be cause for termination and removal of NOA.

**ADVERTISEMENT:** The NOA number preceded by the words Miami-Dade County, Florida, and followed by the expiration date may be displayed in advertising literature. If any portion of the NOA is displayed, then it shall be done in its entirety.

**INSPECTION:** A copy of this entire NOA shall be provided to the user by the manufacturer or its distributors and shall be available for inspection at the job site at the request of the Building Official.

This NOA consists of this page 1, evidence submitted page E-1 as well as approval document mentioned above.

The submitted documentation was reviewed by **Helmy A. Makar, P.E., M.S.**

*Helmy A. Makar*  
06/19/2030



NOA No. 25-0421.01  
Expiration Date: 06/19/2030  
Approval Date: 06/19/2025  
Page 1

**Nucor Corp. (Nucor Buildings Group)**

**NOTICE OF ACCEPTANCE: EVIDENCE SUBMITTED**

**A. DRAWINGS**

1. *Drawing No. MD-RPR24, titled "NBG R-Panel Roof Panels", sheets 1 through 5 of 5, prepared by Bala Sockalingam, P.E., last revision #0 dated 12/09/2024, signed and sealed by Bala Sockalingam, P.E. on 12/26/2024.*

**B. TESTS**

1. *Test report on Accelerated Weathering Testing of Coating 2000 hours per ASTM G152, prepared by PPG Industrial Coil Coatings.*
2. *Test report on Salt Spray Testing of Coating 1000 hours per ASTM B117-95, prepared by PPG Industrial Coil Coatings.*
3. *Test report for Uniform Static Air Pressure on 24 ga. NBG-R-Panel Roof Panel, prepared by Farabaugh Engineering & Testing, per TAS 125-03 per ASTM E 1592-05, Report No. T332-24, dated December 12, 2024, signed and sealed by Daniel G. Farabaugh, P.E.*
4. *Susceptibility to leakage test in accordance with ASTM E2140-01, on 24 ga. NBS-R-Panel Roof Panel, prepared by FET, Report No. T335-24, dated 12/12/2024, signed and sealed by Daniel G. Farabaugh, P.E.*
5. *Wind Driven Rain Test in accordance with Miami-Dade County Protocol TAS 100-95 on 24 ga. NBG-R-Panel Roof Panel, prepared by FET, Report No. T334-24, dated 12/12/2024, signed and sealed by Daniel G. Farabaugh, P.E.*
6. *Impact test per TAS 201-94, test report #T331-24, dated 12/12/2024, signed and sealed by Daniel G. Farabaugh, P.E.*

**C. CALCULATIONS**

1. *Calculations titled "24 ga. R-Panel Allowable Load Calculations", dated 12/26/2024, pages 1 through 5 of 5, prepared by Bala Sockalingam, P.E., signed and sealed by Bala Sockalingam, P.E.*

**D. QUALITY ASSURANCE**

1. *By Miami Dade County Department of Regulatory and Economic Resources (RER).*

**E. MATERIAL CERTIFICATIONS**

1. *Tensile Test per ASTM A370-10, dated 12/03/2024.*

**F. STATEMENTS**

1. *Florida Building Code, 2023 Edition, compliance letter, dated 12/26/2024, prepared by Bala Sockalingam, P.E., signed and sealed by Bala Sockalingam P.E. on 12/26/2024.*

  
\_\_\_\_\_  
Helmy A. Makar, P.E., M.S.  
Product Control Section Supervisor  
NOA No. 25-0421.01  
Expiration Date: 06/19/2030  
Approval Date: 06/19/2025



Approved as complying with the  
Florida Building Code  
Date 06/19/25  
NOA# 25-0421-01  
Miami Dade Product Control  
By [Signature]



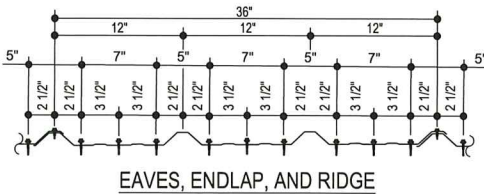
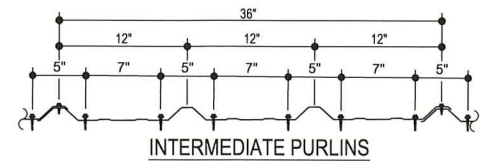

SEE THE R-PANEL ROOF SIDE LAP FASTENER SPACING DETAIL FOR SIDE LAP FASTENER SPACING

NOTE:  
FIELD DRILLING AT LAPPED OR NESTED PURLIN CONDITIONS MAY BE REQUIRED FOR STRUCTURAL FASTENERS

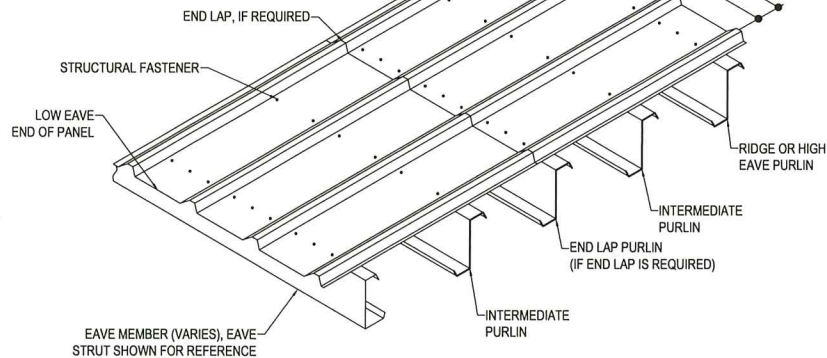

FASTEN INSULATION WITH FASTENER & INSULATION WASHER 12" O.C. AT LOW SIDE AND HIGH SIDE MEMBERS. FASTEN AT HIGH RIB LOCATIONS.

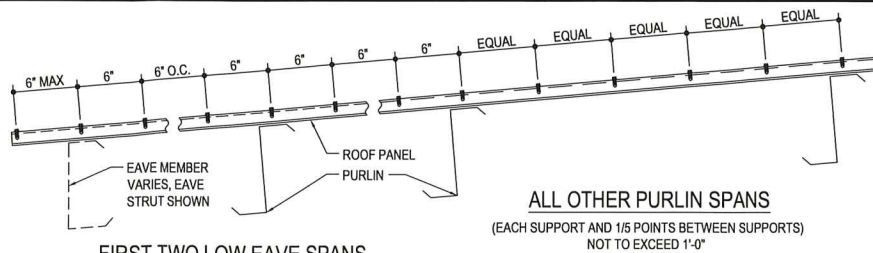

**FIRST TWO LOW EAVE SPANS**  
(EACH SUPPORT AND 6" ON CENTER BETWEEN SUPPORTS)

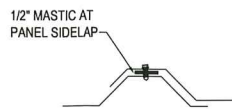

**SIDE LAP MASTIC DETAIL**  
(AT FULL LENGTH OF ALL SIDE LAPS)

**R-PANEL ROOF SIDE LAP FASTENER SPACING (1/5 POINTS)**

R-PANEL ROOF SEE WALL SHEETING ERECTION NOTES FOR WALL PANEL FASTENER LOCATIONS  
MIAMI-DADE COUNTY REQUIREMENT

SEE THE R-PANEL ROOF STRUCTURAL FASTENER SPACING DETAIL FOR STRUCTURAL FASTENER SPACING

**ALL OTHER PURLIN SPANS**  
(EACH SUPPORT AND 1/5 POINTS BETWEEN SUPPORTS)  
NOT TO EXCEED 1'-0"

SIDE LAP STITCH FASTENERS AT EACH SUPPORT AND AT 6" ON CENTER BETWEEN SUPPORTS AT THE FIRST TWO LOW EAVE PURLIN SPANS

TYPICAL SIDE LAP

SIDE LAP STITCH FASTENERS AT EACH SUPPORT AND AT 1/5 POINTS BETWEEN SUPPORTS THE REMAINDER OF THE PANEL RUN

SECOND PURLIN UPSLOPE FROM EAVE

FIRST PURLIN UPSLOPE FROM EAVE

EAVE MEMBER (VARIES), EAVE STRUT SHOWN FOR REFERENCE

**R-Panel ROOF STRUCTURAL FASTENER SPACING (STANDARD)**

R-PANEL ROOF SEE WALL SHEETING ERECTION NOTES FOR WALL PANEL FASTENER LOCATIONS  
MIAMI-DADE COUNTY REQUIREMENT

### FIRST PANEL RUN INSTALLATION:

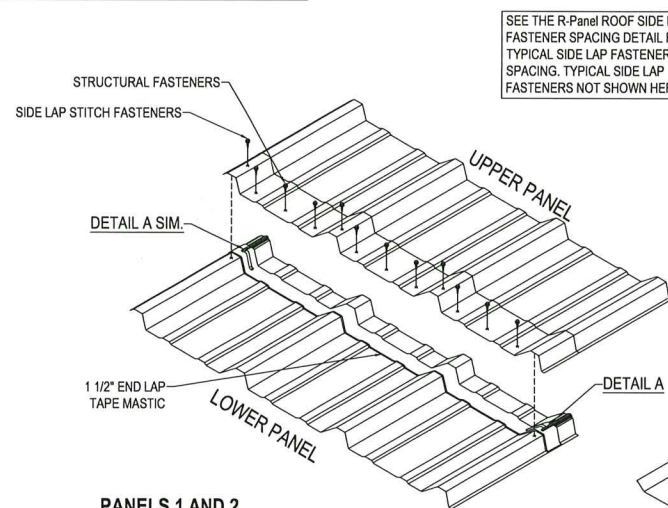

**PANELS 1 AND 2 EXPLODED VIEW**

SEE THE R-PANEL ROOF SIDE LAP FASTENER SPACING DETAIL FOR TYPICAL SIDE LAP FASTENER SPACING. TYPICAL SIDE LAP FASTENERS NOT SHOWN HERE.

### ASSEMBLED PANELS AT LAP

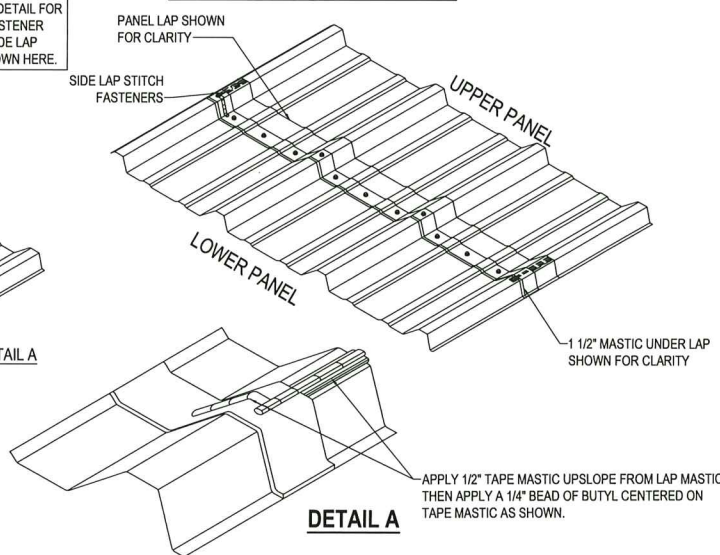

**DETAIL A**

APPLY 1/2" TAPE MASTIC UPSLOPE FROM LAP MASTIC. THEN APPLY A 1/4" BEAD OF BUTYL CENTERED ON TAPE MASTIC AS SHOWN.

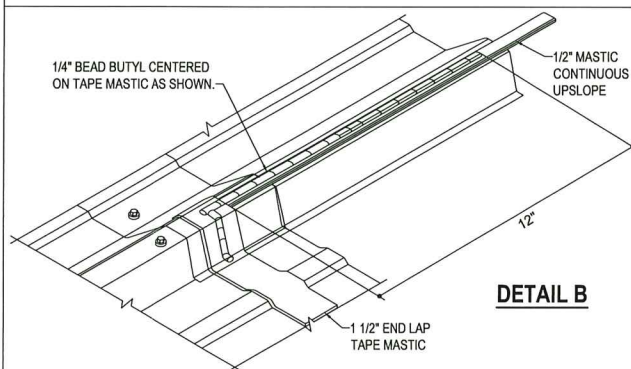
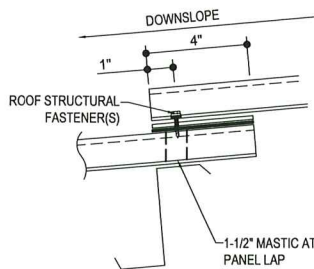

**DETAIL B**

NOTE:  
REFERENCE TRIM CONDITION DETAIL FOR REQUIRED SEALANT AND FASTENERS

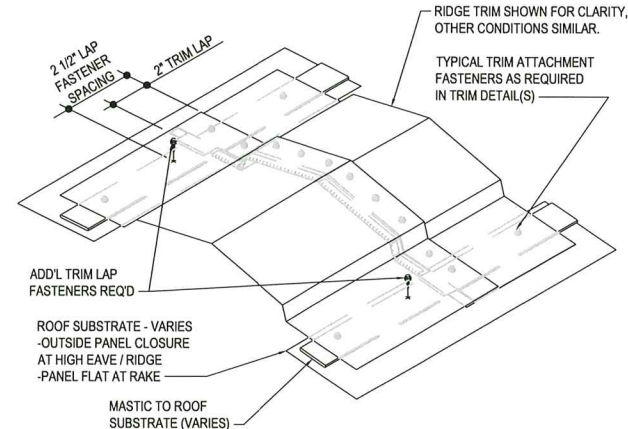

### TRIM LAP COMPRESSION FASTENER

THE ADDITIONAL FASTENER IS REQUIRED AT TRIM LAPS TO AID IN ELIMINATING GAPS AND COMPRESSING SEALANTS WHERE THE MULTIPLE LAYERS OF FLASHING COME TOGETHER.

### SECOND RUN INSTALLATION:

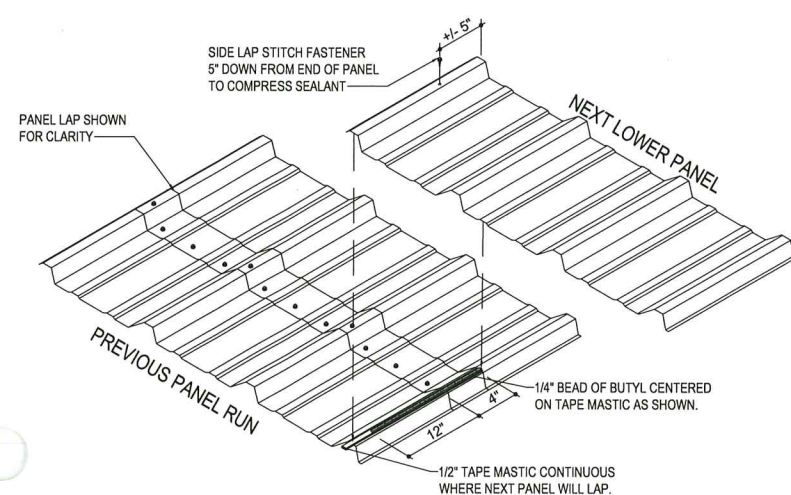

**PANEL ENDLAP**  
R-PANEL ROOF

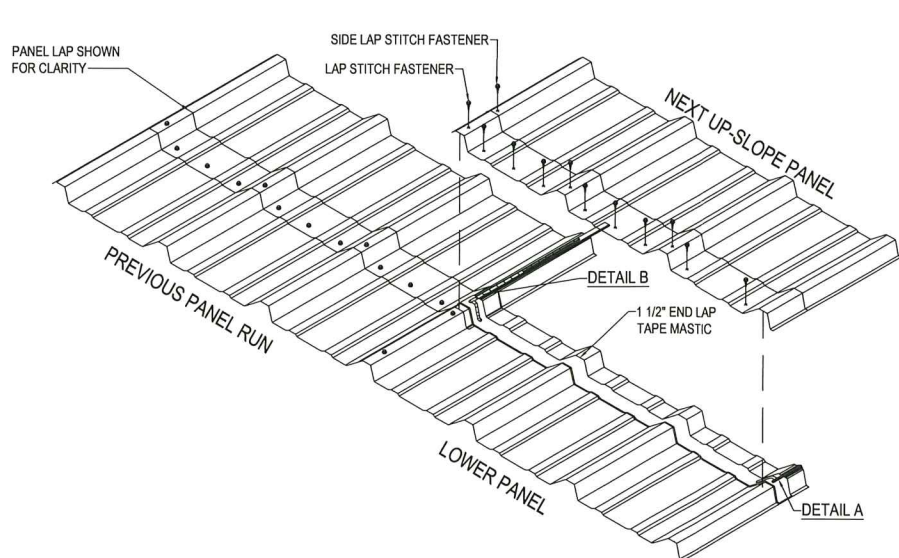

**DETAIL A**

**DETAIL B**

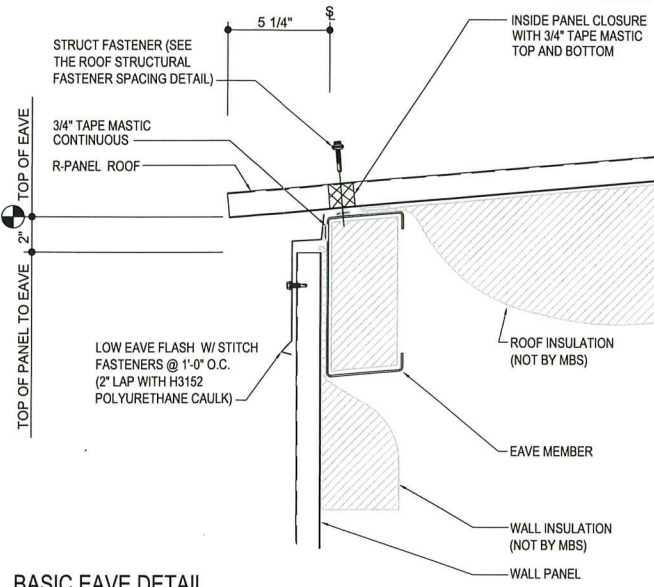

### BASIC EAVE DETAIL

R-PANEL ROOF  
SEE WALL SHEETING ERECTION NOTES FOR WALL PANEL FASTENER LOCATIONS

NO.	REVISION	MADE	CK'D.	DATE

NBG R-PANEL ROOF

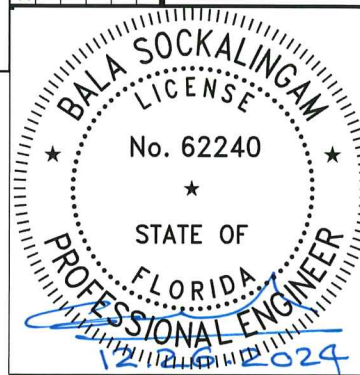

ENGINEER'S NAME: <b>BALA SOCKALINGAM</b> Ph.D., P.E.	ENGINEER'S STATE REGISTRATION NUMBER: <b>FL 62240</b>
DATE 12-09-24	SCALE NOT TO SCALE
CHECKED BY: BSS	DRAWN BY: BSS
DESIGN APP'D. BY:	ISSUED DATE:
305 INDUSTRIAL PARKWAY, WATERLOO, IN 46793 PHONE: (206) 837-7891 FAX: (206) 837-7384	<b>NUCOR CORP</b> NUCOR BUILDINGS GROUP
DRAWING #: MD-RPR24	Pg. 2 of 5
REVISION NUMBER	0

For Dade County Office Use Only

Approved as complying with the  
Florida Building Code  
Date 06/18/25  
NOA# 25-0421-01  
Miami Dade Product Control  
By Helga A. Kline



APPLY BEAD OF POLYURETHANE CAULK 1" FROM END OF TRIM AND LAP SECTIONS 2" AND FASTEN AS SHOWN. TO TERMINATE THE GUTTER APPLY POLYURETHANE CAULK TO THREE SIDES OF END CAP AND TOP RETURN AREA AS SHOWN AND INSERT INTO THE GUTTER LEAVING 1/2" EXPOSED. ATTACH WITH RIVETS SAME AS END LAP.

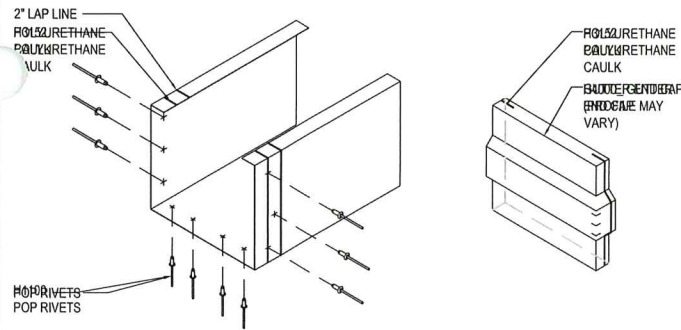

**NOTE:** PLACE  
GUTTER BRACKET  
UNDER THE LIP OF  
THE GUTTER

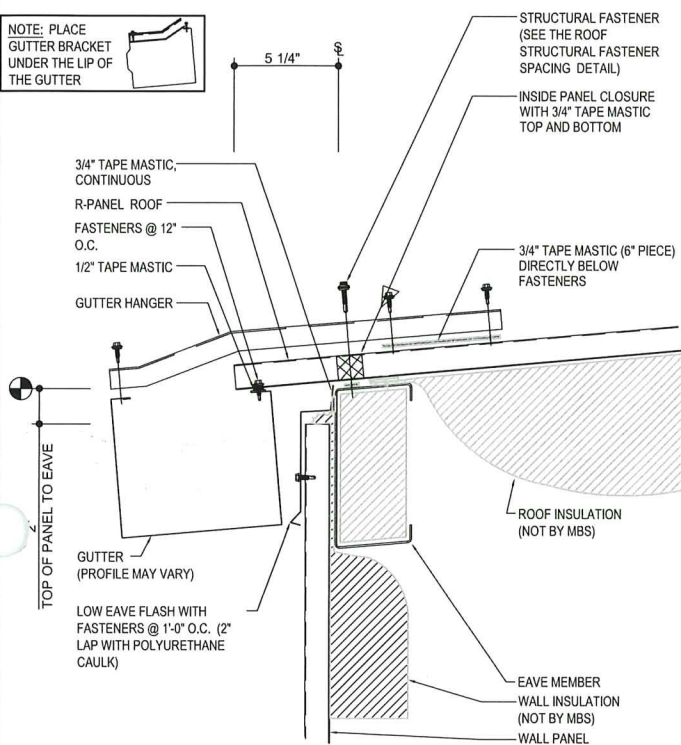

EAVE GUTTER DETAIL w/ WALL PANELS  
SEE WALL SHEETING ERECTION NOTES FOR WALL PANEL FASTENER LOCATIONS

SLIDE FIELD CUT SECTION OF FLASHING ENDLAP BACKER ONTO THE LOWER TRIM PIECE AS SHOWN BELOW. PLACE TAPE MASTIC NEXT TO HEM OF THE BACKER (NOT ON TOP OF HEM). APPLY CONTINUOUS BEAD OF CAULK 1" FROM END OF TRIM DOWN PROFILE OF TRIM. FASTEN LAP WITH STITCH FASTENERS AND POP RIVETS AS SHOWN. ROOF STRUCTURAL FASTENERS SHOULD BE USED TO FASTEN THROUGH PANEL FLAT INTO RAKE ANGLE.

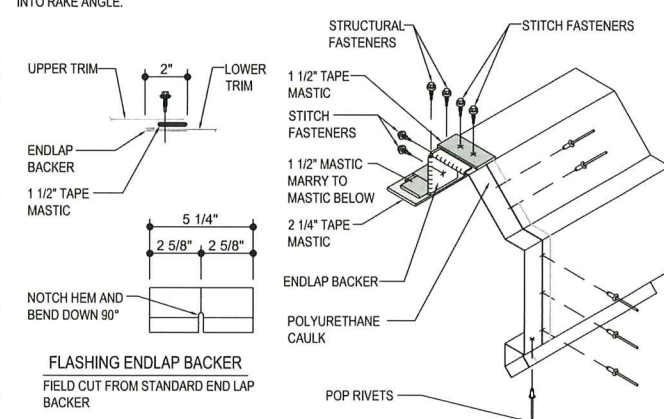

FLASHING ENDLAP BACKER  
FIELD CUT FROM STANDARD END LAP  
BACKER

**NOTE 1: REFERENCE DETAIL  
DA0076 FOR ADDITIONAL REQUIRED  
TRIM LAP FASTENER**

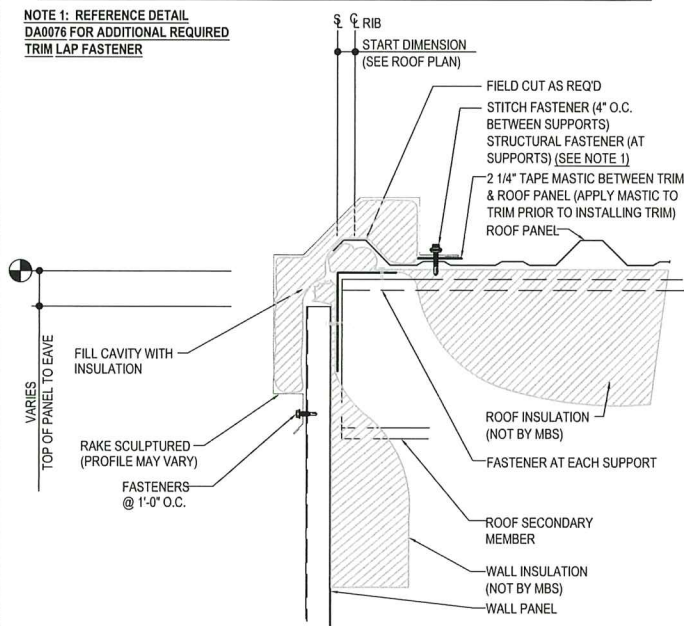

R-Panel ROOF w/ SCULPTURED RAKE DETAIL w/ WALL PANELS SEE WALL SHEETING  
ERECTION NOTES FOR WALL PANEL FASTENER LOCATIONS

ERECTOR NOTE:

1/4-14 FASTENERS (PURLINS) & 12-24 FASTENERS (JOISTS) WITH INSULATION WASHERS HAVE BEEN SUPPLIED 12" O.C. FOR INSULATION ATTACHMENT AT RIDGE.

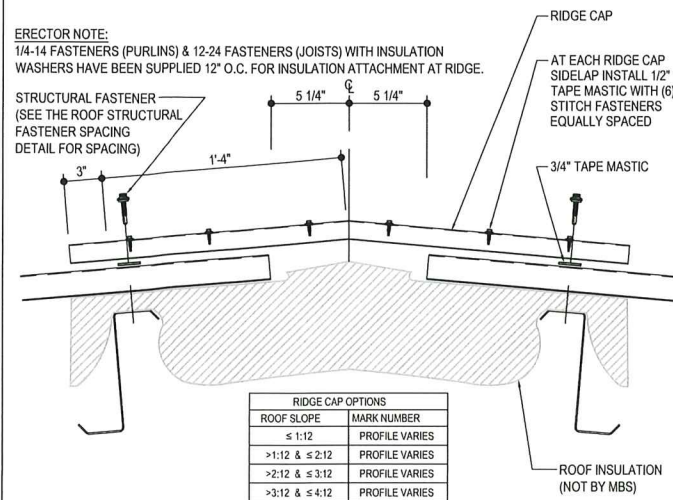

R-Panel ROOF  
WITH  $\leq 60'-0"$  PANEL RUN AND  $\leq 4:12$  ROOF SLOPE

SLIDE FIELD CUT SECTION FLASHING ENDLAP BACKER ONTO THE LOWER TRIM PIECE. PLACE TAPE MASTIC NEXT TO HEM OF THE BACKER (NOT ON TOP OF HEM). MARRY LAP MASTIC WITH MASTIC BETWEEN RIDGE CAP AND PANEL CLOSURE.

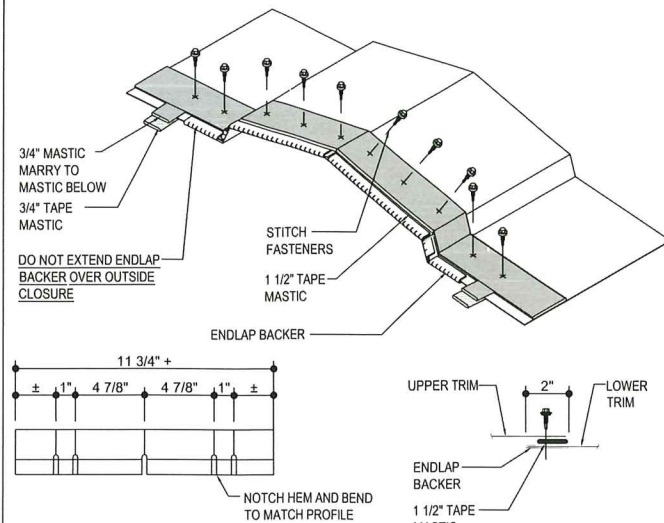

## FIELD CUT FROM STANDARD END LAP BACKER

ERECTOR NOTE:

1/4-14 FASTENERS (PURLINS) & 12-24 FASTENERS (JOISTS) WITH INSULATION  
WASHERS HAVE BEEN SUPPLIED 12" O.C. FOR INSULATION ATTACHMENT AT RIDGE.

NOTE 1: REFERENCE DETAIL  
DA0076 FOR ADDITIONAL  
REQUIRED TRIM LAP FASTENING

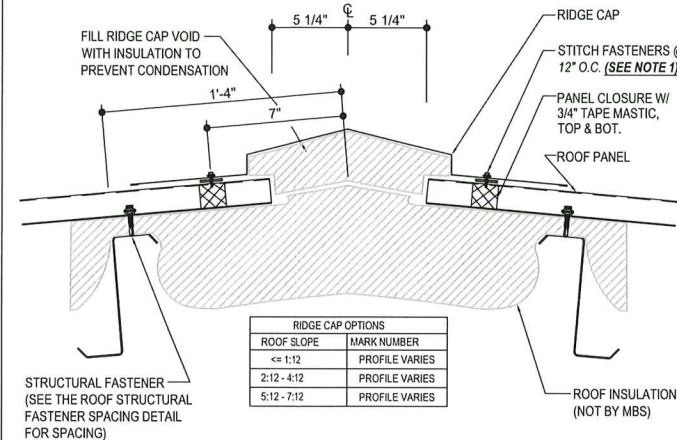

R-Panel ROOF WITH > 60'-0" PANEL RUN AND/OR > 4:12 ROOF SLOPE

RIDGE CAP OPTIONS	
ROOF SLOPE	MARK NUMBER
≤ 1:12	PROFILE VARIES
2:12 - 4:12	PROFILE VARIES
5:12 - 7:12	PROFILE VARIES

NO.	REVISION	MADE	CK'D.	DATE

NBG R-PANEL ROOF

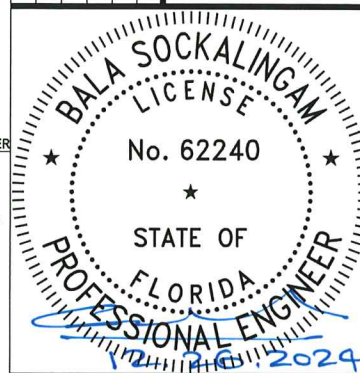

ENGINEER'S NAME:  
BALA SOCKALINGAM  
Ph.D., P.E.

ENGINEER'S STATE REGISTRATION NUMBER:

FL 62240

**NUCOR CORP**  
NUCOR BUILDINGS GROUP

DRAWING #: MD-RPR24	Pg. 3 of 5	REVISION NUMBER	0
---------------------	------------	-----------------	---

For Dade County Office Use Only	
---------------------------------	--

Approved as complying with the  
Florida Building Code  
Date 06/19/25  
NOA# 25-0421.01  
Miami Dade Product Control  
By Healy A. Malar



## **RAKE TRIM PREPARATION FOR SCULPTURED HIGH EAVE TRIM INSTALLATION**

### **STEP 1**

EXTEND THE RAKE TRIM DIMENSION VARIES PAST THE OUTSIDE FACE OF THE WALL CORNER TRIM. FIELD COPE THE VERTICAL LEG OF THE RAKE TRIM FLUSH TO THE OUTSIDE FACE OF THE WALL CORNER TRIM.

FIELD COPE THE UPPER SECTION OF THE RAKE TRIM BACK AS SHOWN. COPE THE "SLOPED" FACE OF THE RAKE TRIM BACK AT AN ANGLE AS SHOWN BEFORE INSTALLING THE HIGH EAVE TRIM, APPLY POLYURETHANE TUBE CAULK AROUND THE PERIMETER OF THE CORNER CAP (MK. VARIES). SLIDE THE CAP INTO THE END OF THE STANDARD RAKE TRIM, LEAVING 1/2" EXPOSED AS SHOWN BELOW.

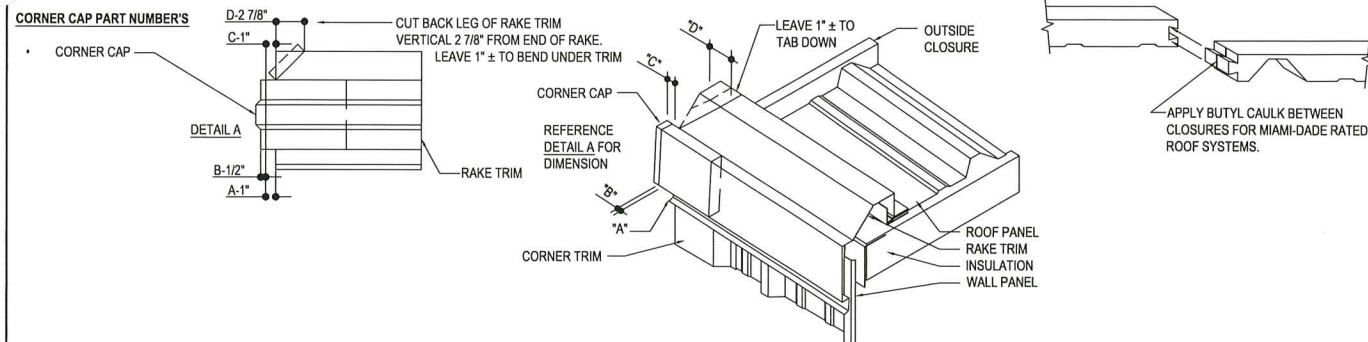

### SCULPTURED HIGH EAVE TRIM INSTALLATION STEP 2

FIELD CUT AN OUTSIDE CLOSURE LONG ENOUGH TO REACH BACK OF RAKE TRIM. APPLY 3/4" TAPE MASTIC CONTINUOUSLY ACROSS THE TOP AND BOTTOM OF THE CLOSURES.

LAY THE HIGH EAVE TRIM OVER THE OUTSIDE CLOSURE AND FASTEN WITH (4) TRIM-COLORED SELF-DRILLING SCREWS. NOTE: THE HIGH EAVE TRIM MUST BE PROPERLY POSITIONED BEFORE TOUCHING THE MASTIC. REMOVE THE PAPER BACKING ONLY AS WORK PROGRESSES.

FIELD COPE THE HIGH EAVE TRIM SIMILAR TO THE RAKE TRIM EXCEPT DO NOT CUT THE SLOPED FACE. INSTEAD, FOLD THE SLOPED FACE OVER THE SLOPED FACE OF THE RAKE TRIM. APPLY 2 1/4" TAPE MASTIC TO FLAT PORTION OF RAKE TRIM. APPLY 3/4" TAPE MASTIC TO SLOPING EDGE OF TRIM. MAKE SURE MASTIC SEALS AT ALL LOCATIONS OF TRIM INTERSECTIONS AND FASTEN WITH (3) POP RIVETS.

FASTEN THE HIGH EAVE TRIM AND THE RAKE TRIM TO THE CORNER CAP WITH **POP RIVETS** FASTEN THE TOP LEG OF THE HIGH EAVE TRIM WITH (4) TRIM- COLORED SELF DRILLING SCREWS.

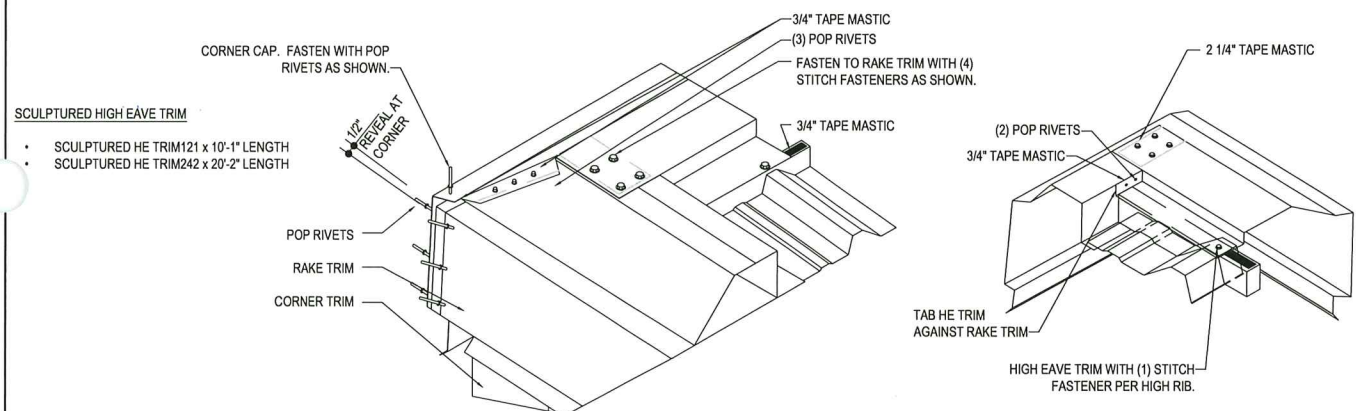

DETAIL SHOWN WITH ROOF AND WALL PANEL.

SLIDE FIELD CUT SECTION FLASHING ENDLAP BACKER ONTO THE LOWER TRIM PIECE. PLACE TAPE MASTIC NEXT TO HEM OF THE BACKER (NOT ON TOP OF HEM). APPLY CONTINUOUS BEAD OF CAULK 1" FROM END OF TRIM DOWN PROFILE OF TRIM. FASTEN LAP WITH STITCH FASTENERS AND POP RIVETS AS SHOWN.

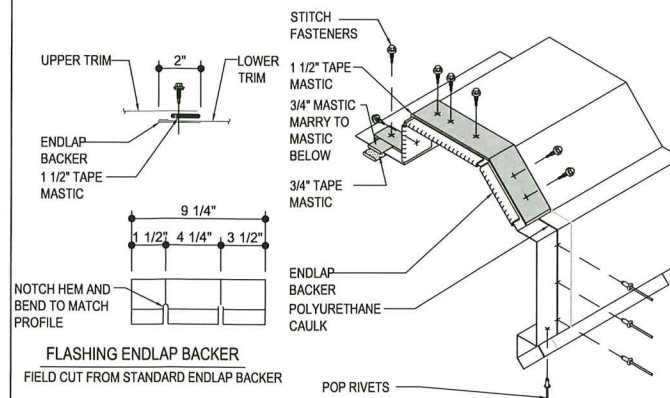

**ERECTOR NOTE:**

1/4 - 14 FASTENERS (PURLINS) & 12 -24 FASTENERS (JOISTS) WITH INSULATION  
WASHERS HAVE BEEN SUPPLIED 12" O.C. FOR INSULATION ATTACHMENT AT RIDGE.

**NOTE 1: REFERENCE DETAIL DA0076  
FOR ADDITIONAL REQUIRED TRIM  
LAP FASTENER**

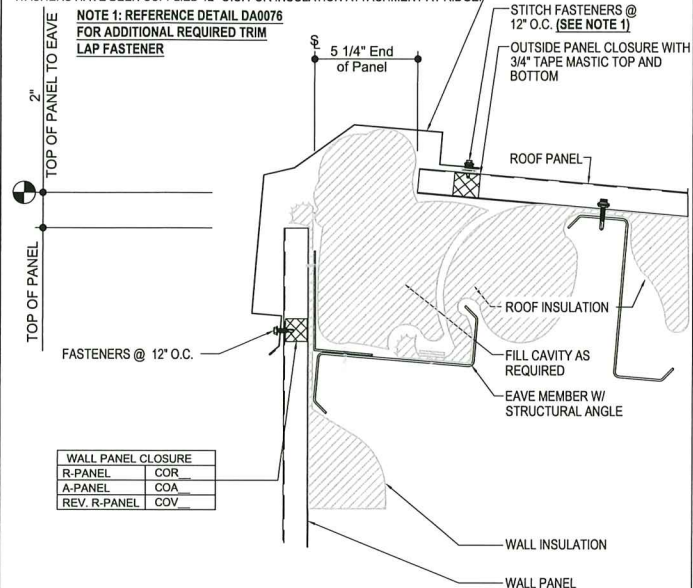

HIGH EAVE SCULPTURED DETAIL w/ R-Panel ROOF & WALL PANELS  
SEE WALL SHEETING ERECTION NOTES FOR WALL PANEL FASTENER LOCATIONS

WALL PANEL CLOSURE	
R-PANEL	COR__
A-PANEL	COA__
REV. R-PANEL	COV__

NO.	REVISION	MADE	CK'D.	DATE

NBG R-PANEL ROOF

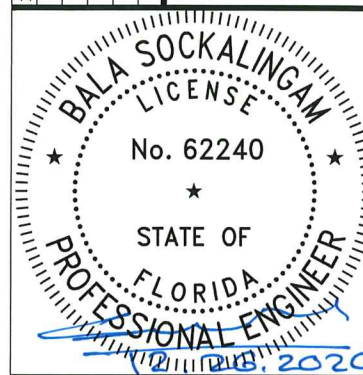

ENGINEER'S NAME:  
BALA SOCKALINGAM  
Ph.D., P.E.

ENGINEER'S STATE REGISTRATION NUMBER:

FL 62240

3305 INDUSTRIAL PARKWAY, WATERLOO,  
IN 46793 PHONE: (206) 837-7891  
FAX: (206) 837-7384

**NUCOR CORP**  
**NUCOR BUILDINGS GROUP**

DRAWING #:	MD-RPR24	Pg. 4 of 5	REVISION NUMBER	0
------------	----------	------------	-----------------	---

For Dade County Office Use Only	
---------------------------------	--

Approved as complying with the  
Florida Building Code  
Date 06/19/25  
NOA# 25-18921.01  
Miami Dade Product Control  
By H. G. A. M. W.



- 1) IF BUILDING HAS INSULATION, INSTALL THE INSULATION AFTER THE PURLINS HAVE BEEN INSTALLED AT THE VALLEY. FASTEN THE INSULATION TO ALL PURLINS WITH FASTENERS AND INSULATION WASHERS.
- 2) AFTER INSTALLATION OF THE PURLINS AND THE INSULATION, INSTALL THE VALLEY PLATE ABOVE THE INSULATION. IF BUILDING DOES NOT HAVE INSULATION, SIMPLY PLACE THE VALLEY PLATE ON TOP OF THE PURLINS. NOTCH THE FIRST PIECE OF THE VALLEY PLATE AT EAVE AS REQUIRED. EXTEND THE VALLEY PLATE TO LINE UP WITH THE PANEL OVERHANG OF 5 1/4". FASTEN AT EACH SECONDARY MEMBER WITH (3) FASTENERS. LAP THE VALLEY PLATE 2" AND FASTEN WITH (2) FASTENERS.
- 3) PLACE DIVERTER FLASH OVER THE VALLEY PLATE AND TEMPORARILY FASTEN WITH (1) AT OUTSIDE CORNERS OF THE VALLEY PLATE. (DO NOT USE THE VALLEY AS A WALKWAY OR A WORK PLATFORM). LAP DIVERTER FLASH 2" AND INSTALL TAPE MASTIC BETWEEN THE LAPS AND A BEAD OF UPSLOPE OF MASTIC.
- 4) INSTALL 2 1/4" TAPE MASTIC ON THE DIVERTER FLASH 7 1/2" FROM THE CENTERLINE OF THE VALLEY (AS SHOWN). ALSO APPLY A BEAD OF TUBE CAULK ALONG THE UPHILL SIDE OF THE TAPE MASTIC.
- 5) INSTALL THE ROOF PANELS, CUTTING ENDS AT THE REQUIRED ANGLE. CUT THE PANELS 7" FROM THE CENTERLINE OF THE VALLEY. (NOTE: KEEP METAL SHAVINGS OUT OF THE TAPE MASTIC). INSTALL FASTENERS 3" O.C. BETWEEN EACH MAJOR RIB, CENTERED OVER THE 2 1/4" TAPE MASTIC AS SHOWN.
- 6) TO ENSURE A WEATHERTIGHT SEAL AROUND THE RIB COVER, PLACE 2 1/4" TAPE MASTIC AROUND THE PANEL RIB ON TOP OF VALLEY DIVERTER AS DIMENSIONS SHOW IN ENLARGED VIEW. PLACE A BEAD OF BUTYL CAULK ALONG PANEL SIDLAP AT ALL RIB COVER LOCATIONS. COVER RIB AREA WITH 2 1/4" TAPE MASTIC. INSTALL RIB COVER WITH FASTENERS AT DIMPLE LOCATIONS ON RIB COVER.
- 7) ONCE MASTIC, RIB COVER AND FASTENERS ARE INSTALLED TRIM EXCESS MASTIC AND BUTYL AWAY FROM RIB COVER.
- 8) FIELD WORK THE HIGH AND LOW ENDS OF THE VALLEY AS REQUIRED TO ENSURE WEATHERTIGHTNESS.

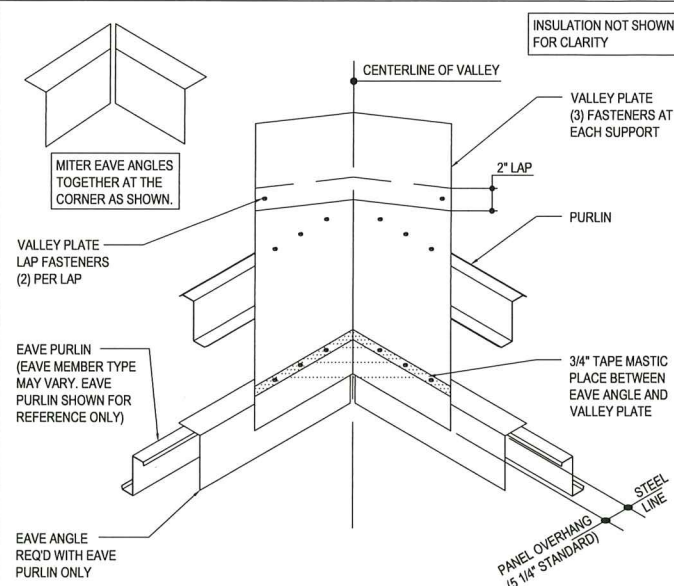

**VALLEY PLATE DETAIL AT LOW EAVE CORNER**  
SEE ERECTION NOTES 1 AND 2

**ERECTOR NOTE:**  
FASTENERS (PURLINS) WITH INSULATION WASHERS HAVE BEEN SUPPLIED FOR  
INSULATION ATTACHMENT AT VALLEY.

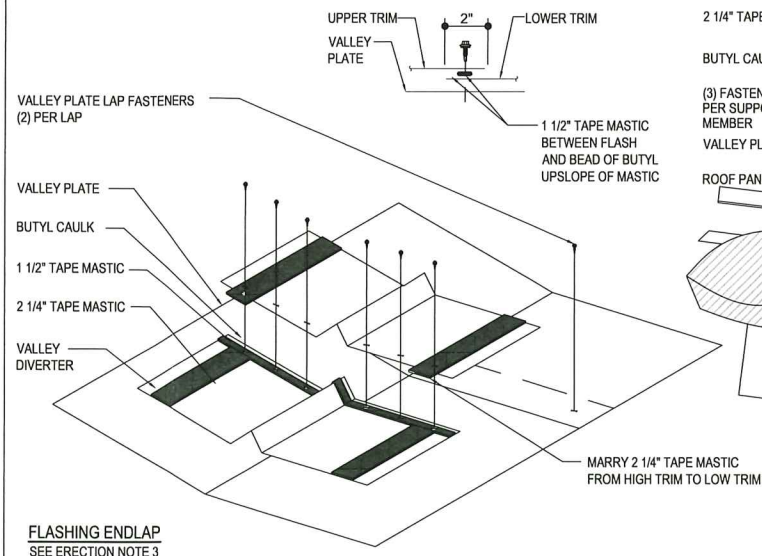

**R-PANEL VALLEY CONDITION FINAL ASSEMBLY DETAIL**  
SEE ERECTION NOTES 3 AND 4

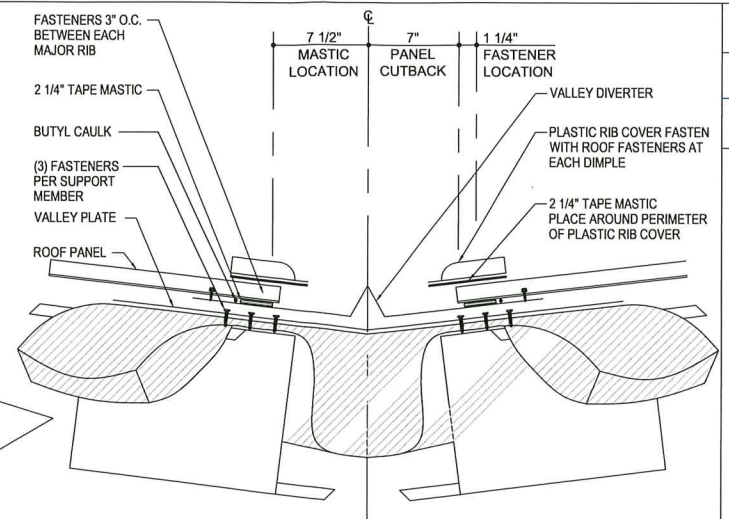

NO.	REVISION	MADE	CK'D.	DATE

NBG R-PANEL ROOF

## SEE ERECTION NOTES 4 AND 5

NOTE:  
FIELD TAB VALLEY DIVERTER FLASHING TO CLOSE OFF VALLEY AT LOW EAVE.

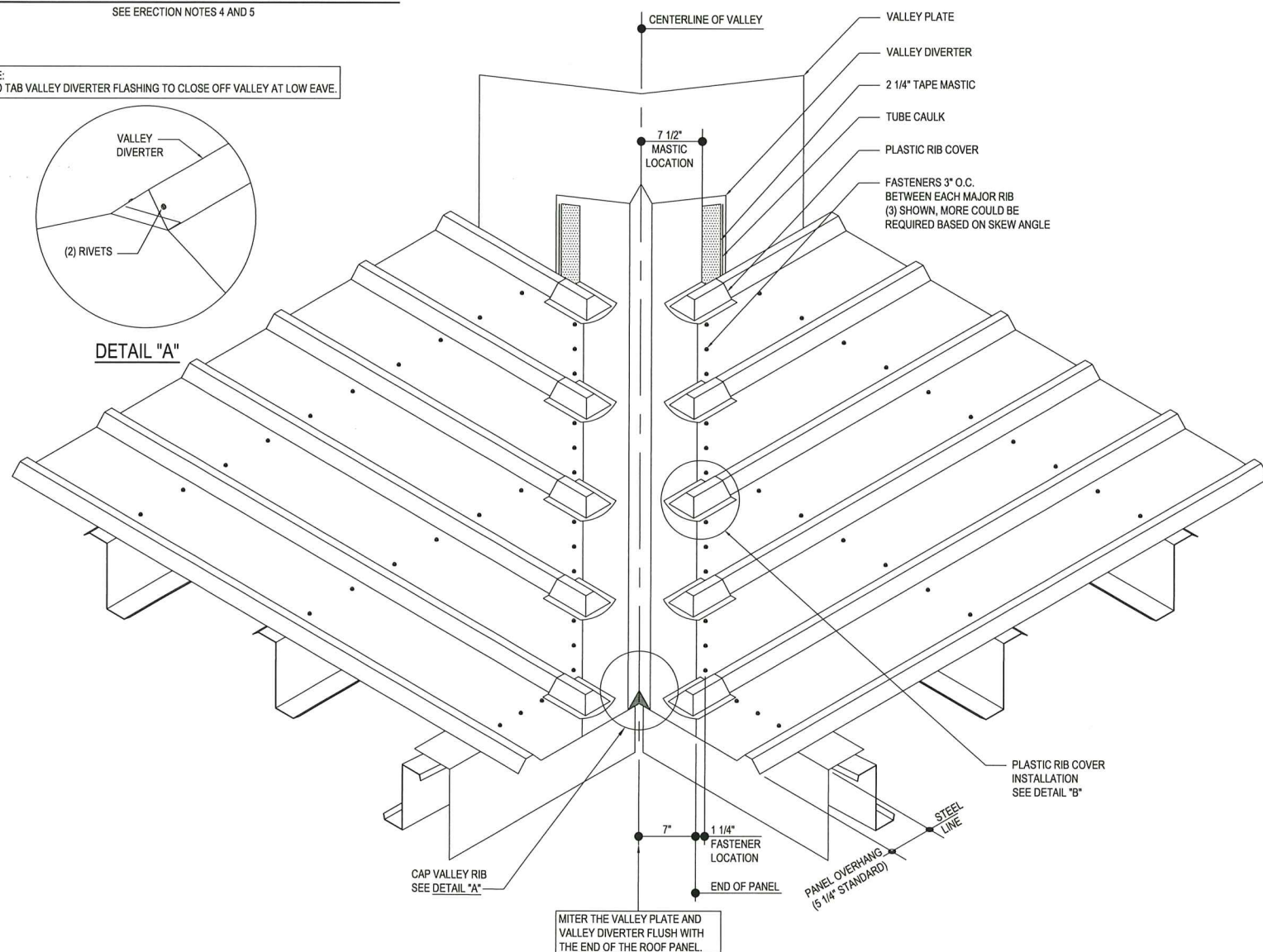

SEE ERECTION NOTES 6, 7, AND 8

**GENERAL RIB COVER NOTE:**  
TRACE RIB COVER IN ORDER TO KEEP 2 1/4"  
MASTIC BEAD ALONG EDGE FOR PROPER SEAL.

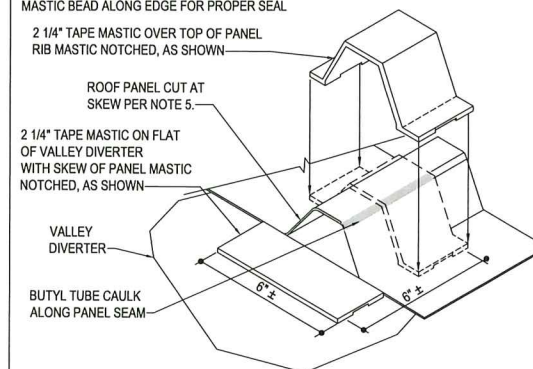

### STEP 1

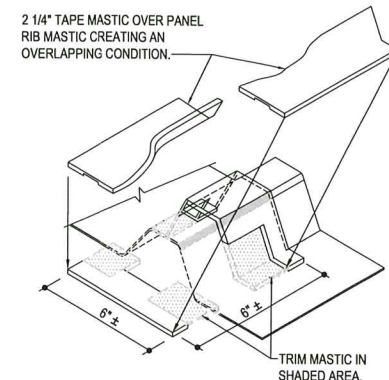

### STEP 2

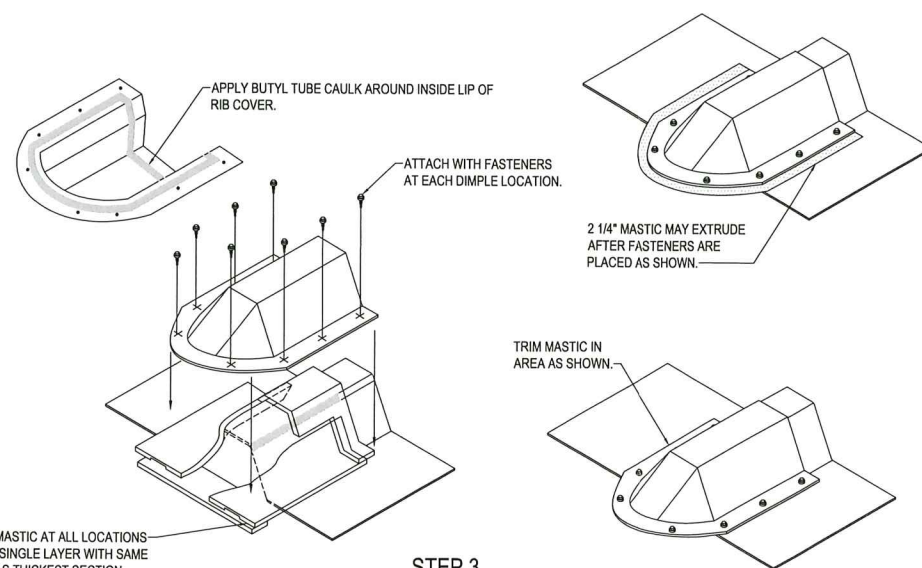

### STEP 3

## R-PANEL VALLEY CONDITION

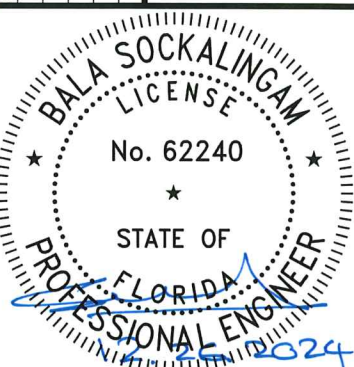

ENGINEER'S NAME:  
BALA SOCKALINGAM  
Ph.D., P.E.

ENGINEER'S STATE REGISTRATION NUMBER:

FL 62240

305 INDUSTRIAL PARKWAY, WATERLOO,  
IN 46793 PHONE: (206) 837-7891  
FAX: (206) 837-7384

**NUCOR CORP**  
**NUCOR BUILDINGS GROUP**

DRAWING #: MD-RPR24 Pg. 5 of 5

For Dade County Office Use Only

Approved as complying with the  
Florida Building Code  
Date 06/19/25  
NOAH# 25-0421.01  
Miami Dade Product Control  
By Helga M. M. M.