



DEPARTMENT OF REGULATORY AND ECONOMIC RESOURCES (RER)  
BOARD AND CODE ADMINISTRATION DIVISION

## NOTICE OF ACCEPTANCE (NOA)

MIAMI-DADE COUNTY  
PRODUCT CONTROL SECTION  
11805 SW 26 Street, Room 208  
Miami, Florida 33175-2474  
T (786) 315-2590 F (786) 315-2599  
[www.miamidade.gov/building](http://www.miamidade.gov/building)

**Boston Valley Terra Cotta LLC**  
**6860 South Abbott Rd.**  
**Orchard Park, NY 14127**

### SCOPE:

This NOA is being issued under the applicable rules and regulations governing the use of construction materials. The documentation submitted has been reviewed and accepted by Miami-Dade County RER-Product Control Section to be used in Miami Dade County and other areas where allowed by the Authority Having Jurisdiction (AHJ).

This NOA shall not be valid after the expiration date stated below. The Miami-Dade County Product Control Section (In Miami Dade County) and/or the AHJ (in areas other than Miami Dade County) reserve the right to have this product or material tested for quality assurance purposes. If this product or material fails to perform in the accepted manner, the manufacturer will incur the expense of such testing and the AHJ may immediately revoke, modify, or suspend the use of such product or material within their jurisdiction. RER reserves the right to revoke this acceptance if it is determined by Miami-Dade County Product Control Section that this product or material fails to meet the requirements of the applicable building code.

This product is approved as described herein and has been designed to comply with the Florida Building Code, including the High Velocity Hurricane Zone.

### DESCRIPTION: TerraClad® Ceramic Rainscreen Wall Cladding System

**APPROVAL DOCUMENT:** Drawing No. **12069B.01**, titled "System: Wall Cladding Terra Cotta Panels Horizontal and Vertical" sheets 1 through 10 of 10, dated 05/30/2015, prepared by L. Roberto Lomas, P.E., signed and sealed by Luis R. Lomas, P.E. on 02/21/2024, bearing the Miami-Dade County Product Control Renewal stamp with the Notice of Acceptance number and expiration date by the Miami-Dade County Product Control Section.

### MISSILE IMPACT RATING: Large and Small Missile Impact Resistant

**LABELING:** Each unit shall bear a permanent label with the manufacturer's name or logo, city, state and following statement: "Miami-Dade County Product Control Approved", unless otherwise noted herein.

**RENEWAL** of this NOA shall be considered after a renewal application has been filed and there has been no change in the applicable building code negatively affecting the performance of this product.

**TERMINATION** of this NOA will occur after the expiration date or if there has been a revision or change in the materials, use, and/or manufacture of the product or process. Misuse of this NOA as an endorsement of any product, for sales, advertising or any other purposes shall automatically terminate this NOA. Failure to comply with any section of this NOA shall be cause for termination and removal of NOA.

**ADVERTISEMENT:** The NOA number preceded by the words Miami-Dade County, Florida, and followed by the expiration date may be displayed in advertising literature. If any portion of the NOA is displayed, then it shall be done in its entirety.

**INSPECTION:** A copy of this entire NOA shall be provided to the user by the manufacturer or its distributors and shall be available for inspection at the job site at the request of the Building Official.

This NOA **renews NOA No. 23-1222.17** and consists of page 1 and evidence pages E-1, E-2 and E-3, as well as approval document mentioned above.

The submitted documentation was reviewed by **Carlos M. Utrera, P.E.**



11/13/25

NOA No. 25-1030.03  
Expiration Date: December 24, 2030  
Approval Date: November 20, 2025  
Page 1

**NOTICE OF ACCEPTANCE: EVIDENCE SUBMITTED**

**1. EVIDENCE SUBMITTED UNDER PREVIOUS NOA's**

**A. DRAWINGS**

1. Manufacturer's die drawings and sections.  
*(Submitted under NOA No. 15-0514.04)*
2. Drawing No **12069B.01**, titled: "System: Wall Cladding Terra Cotta Panels Horizontal and Vertical" sheets 1 through 10 of 10, dated 05/30/15, prepared by L. Roberto Lomas, P.E., signed and sealed by Luis R. Lomas, P.E.  
*(Submitted under NOA No. 15-0514.04)*

**B. TESTS**

1. Test reports on: 1) Air Infiltration Test, per FBC, TAS 202-94  
2) Uniform Static Air Pressure Test, Loading per FBC, TAS 202-94  
3) Water Resistance Test, per FBC, TAS 202-94  
4) Cyclic Wind Pressure Loading per FBC, TAS 203-94  
along with marked-up drawings and installation diagram of 5' by 2' Terra Cotta Panels (Horizontal Panel Orientation), prepared by Quast Consulting and Testing, Inc, Test Report No. **QCT15-3478.01**, dated 03/25/15, signed and sealed by Brian M. Sasman, P.E.  
*(Submitted under NOA No. 15-0514.04)*
2. Test reports on: 1) Air Infiltration Test, per FBC, TAS 202-94  
2) Uniform Static Air Pressure Test, Loading per FBC, TAS 202-94  
3) Water Resistance Test, per FBC, TAS 202-94  
4) Cyclic Wind Pressure Loading per FBC, TAS 203-94  
along with marked-up drawings and installation diagram of 2' by 5' Terra Cotta Panels (Vertical Panel Orientation), prepared by Quast Consulting and Testing, Inc, Test Report No. **QCT15-3479.02**, dated 03/25/15, signed and sealed by Brian M. Sasman, P.E.  
*(Submitted under NOA No. 15-0514.04)*
3. Test report on Clay Roof Tiles per ASTM C1167-03 of TerraClad Terra Cotta Panels, prepared by Architectural Testing, Inc, Test Report No. **73688.01-106-18**, dated 12/10/07, signed and sealed by Joseph A. Reed, P.E.  
*(Submitted under NOA No. 15-0514.04)*



---

Carlos M. Utrera, P.E.  
Product Control Examiner  
NOA No. 25-1030.03  
Expiration Date: December 24, 2030  
Approval Date: November 20, 2025

**NOTICE OF ACCEPTANCE: EVIDENCE SUBMITTED**

**1. EVIDENCE SUBMITTED UNDER PREVIOUS NOA's (CONTINUED)**

**C. CALCULATIONS**

1. Anchors calculations prepared by Luis R. Lomas, P.E., dated 11/20/17, signed and sealed by Luis R. Lomas, P.E.  
*(Submitted under NOA No. 18-0815.01)*

**D. QUALITY ASSURANCE**

1. Miami-Dade Department of Regulatory and Economic Resources (RER)

**E. MATERIAL CERTIFICATIONS**

1. None.

**F. STATEMENTS**

1. Statement letter of conformance, complying with **FBC 7<sup>th</sup> Edition (2020)** and of no financial interest, dated March 18, 2021, issued by L. Roberto Lomas, P.E., signed and sealed by Luis R. Lomas, P.E.  
*(Submitted under NOA No. 21-0106.07)*

**G. OTHERS**

1. Notice of Acceptance No. **18-0815.01**, issued to Boston Valley Pottery, Inc. for their TerraClad® Ceramic Rainscreen Wall Cladding System, approved on 09/27/18 and expiring on 12/24/20.



---

Carlos M. Utrera, P.E.  
Product Control Examiner  
NOA No. 25-1030.03  
Expiration Date: December 24, 2030  
Approval Date: November 20, 2025

**NOTICE OF ACCEPTANCE: EVIDENCE SUBMITTED**

**2. Evidence submitted under # 22-0908.06, 23-1222.17 and new**

**A. DRAWINGS**

1. Drawing No. **12069B.01**, titled "System: Wall Cladding Terra Cotta Panels Horizontal and Vertical" sheets 1 through 10 of 10, dated 05/30/15, prepared by L. Roberto Lomas, P.E., signed and sealed by Luis R. Lomas, P.E. on 02/21/2024.

**B. TESTS**

1. None.

**C. CALCULATIONS**

1. None.

**D. QUALITY ASSURANCE**

1. Miami-Dade Department of Regulatory and Economic Resources (RER).

**E. MATERIAL CERTIFICATIONS**

1. None.

**F. STATEMENTS**

1. Statement letter of code conformance with the 8<sup>th</sup> edition (2023) of the FBC and of no financial interest, issued by L. Roberto Lomas, P.E., dated 10/29/2025, signed and sealed by Luis R. Lomas, P.E.

*"Submitted under NOA # 22-0908.06"*

2. Statement letter requesting a name change of NOA No. 21-0106.07 from **Boston Valley Pottery, Inc.** to **Boston Valley Terra Cotta LLC**, dated 9/7/22, issued by Boston Valley Terra Cotta LLC, signed by Craig Cudney, Quality Control Manager.
3. Certificate of Merger of **Boston Valley Pottery, Inc.** and **Boston Valley Terra Cotta LLC** into **Boston Valley Terra Cotta LLC**, filed with the State of Delaware on October 26, 2021.
4. Certificate of Merger of **Boston Valley Pottery, Inc.** and **Boston Valley Terra Cotta LLC** into **Boston Valley Terra Cotta LLC**, filed with the State of New York on October 27, 2021.
5. Letter from owners of existing NOA No. **21-0106.07**, stating that a name change has legally occurred and requesting that a new NOA be issued under the new name **Boston Valley Terra Cotta LLC** and that the existing NOA be rescinded, dated October 13, 2022, signed by Ms. Amy Bossert.



---

Carlos M. Utrera, P.E.  
Product Control Examiner  
NOA No. 25-1030.03  
Expiration Date: December 24, 2030  
Approval Date: November 20, 2025

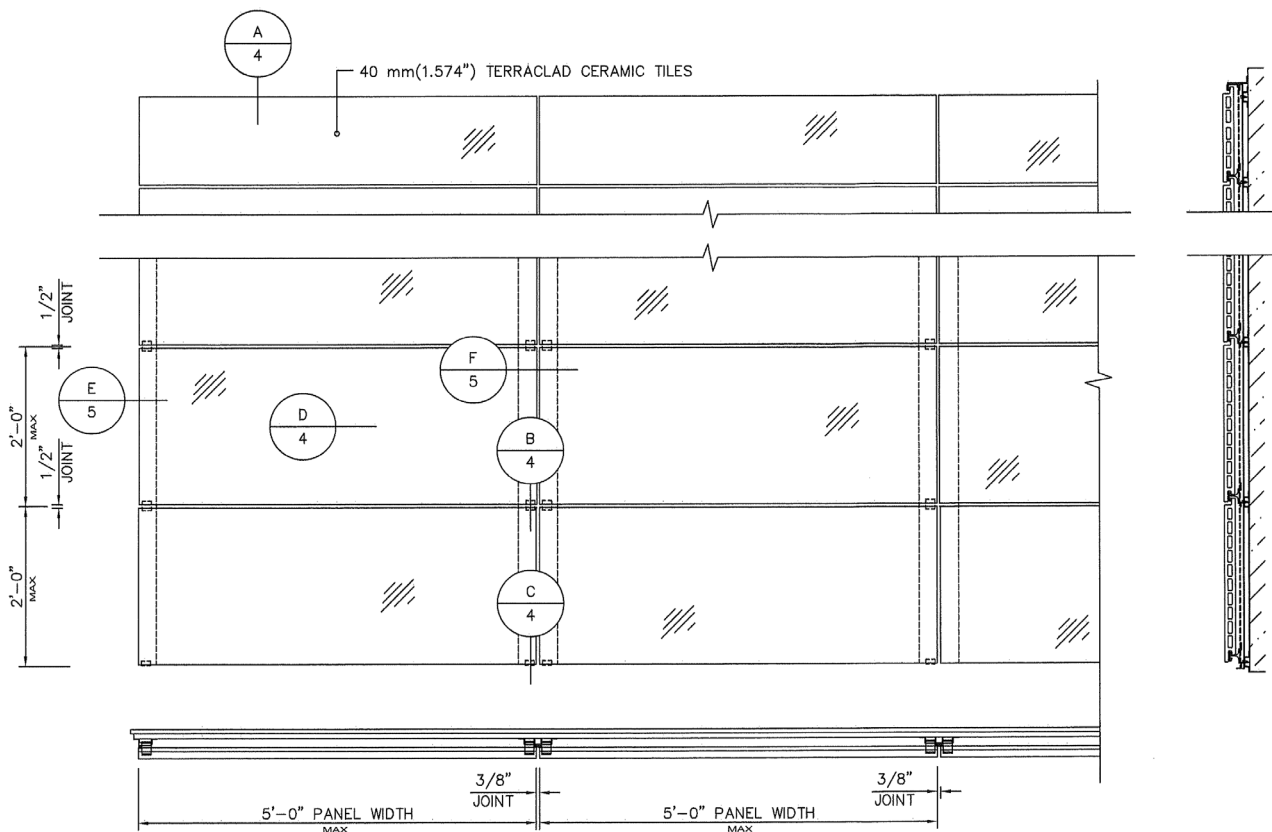

## HORIZONTAL PANEL SYSTEM

### TERRACLAD RAINSCREEN CLADDING SYSTEM

TERRACOTA TILES ANCHORED TO FBC WALL ASSEMBLY FOR EXTERIOR CLADDING.

APPROVAL APPLIES TO MULTIPLE UNIT INSTALLATIONS

MAX. DESIGN LOAD = + 80.0 PSF  
- 80.0 PSF

MAX. HAT CHANNEL SPACING = 24 IN.  
MAX. ATTACHMENT CLIP SPACING = 24 IN.  
MAX. VERTICAL TRACK SPACING = 60 IN.  
MAX. TILE SIZE = 24" HIGH X 60" WIDE

THIS PRODUCT HAS BEEN DESIGNED AND TESTED TO COMPLY WITH THE REQUIREMENTS OF THE FLORIDA BUILDING CODE INCLUDING THE HIGH VELOCITY HURRICANE ZONE (HVHZ)

ANCHORS SHALL BE AS LISTED, SPACED AS SHOWN ON DETAILS, ANCHORS EMBEDMENT TO BASE MATERIAL SHALL BE BEYOND WALL DRESSING OR STUCCO.

ANCHORING OR LOADING CONDITIONS NOT SHOWN IN THESE DETAILS ARE NOT PART OF THIS APPROVAL.

MATERIALS INCLUDING BUT NOT LIMITED TO STEEL/METAL SCREWS, THAT COME INTO CONTACT WITH OTHER DISSIMILAR MATERIALS SHALL MEET THE REQUIREMENTS OF THE FLORIDA BUILDING CODE.

**PRODUCT RENEWED**  
as complying with the Florida  
Building Code  
NOA-No. 25-1030.03

Expiration Date 12/24/2030

By *[Signature]*  
Miami-Dade Product Control

**PRODUCT REVISED**  
as complying with the Florida  
Building Code  
NOA-No. 23-1222.17

Expiration Date 12/24/2025

By *[Signature]*  
Miami-Dade Product Control

SIGNED: 02/21/2024

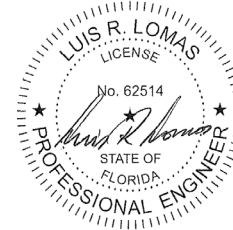

Rev	Date	Notes
1	4/23/15	NOA SUB UPDATES
2		
3		
4		
5		

PRODUCT DESCRIPTION:  
SYSTEM WALL CLADDING  
TERRACOTA PANELS  
HORIZONTAL and VERTICAL

**Boston Valley**  
Terra Cotta  
6860 S. ABBOTT RD.  
ORCHARD PARK, NY 14127  
www.terraclad.com  
1-716-649-7490

**L. Roberto Lomas P.E.**  
1432 Woodford Road  
Lewisville, NC 27023  
(434)-688-0609  
www.lromaspe.com  
FL No. # 62514

Drawn By: WJH&A  
Date Drawn: 5/30/2015  
Checked By:  
D-Scale: 1"=1'-0"  
B-Scale: 1/2"=1'-0"  
DRAWING: 12089B.01  
Title: TEST PLAN  
Sheet NO: 1 of 10

## VERTICAL PANEL SYSTEM

ASTM C 1167-03 Standard Specification  
for Clay Roof Tiles (with modification  
as required to ASTM C 67) DATA

TEST	RESULT
5 HOUR COLD WATER ABSORPTION	6.1%
24 HOUR COLD WATER ABSORPTION	6.3%
1 HOUR BOILING WATER ABSORPTION	8.8%
2 HOUR BOILING WATER ABSORPTION	8.8%
5 HOUR BOILING WATER ABSORPTION	9.5%
FREEZE/THAW	NO BREAKAGE OR CRACKING WITH +0.7% CHANGE
WET TRANSVERSE STRENGTH	1,031 LBS.
EFFLORESCENCE	NO CHANGE - "NOT EFFECTED"
PERMEABILITY	NO WATER DROPLETS HAVE FALLEN FROM THE UNDERSIDE OF THE TILE

### TERRACLAD RAINSCREEN CLADDING SYSTEM

TERRACOTA TILES ANCHORED TO FBC APPROVED WALL ASSEMBLY FOR  
EXTERIOR CLADDING.

APPROVAL APPLIES TO MULTIPLE UNIT INSTALLATIONS

MAX. DESIGN LOAD = + 80.0 PSF  
- 80.0 PSF

MAX. ATTACHMENT CLIP SPACING = 9 IN.

MAX. TRACK SPACING = 60 IN.

MAX. TILE SIZE = 24" HIGH X 60" WIDE

THIS PRODUCT HAS BEEN DESIGNED AND TESTED TO COMPLY WITH THE REQUIREMENTS OF THE  
FLORIDA BUILDING CODE INCLUDING THE HIGH VELOCITY HURRICANE ZONE (HVHZ)

ANCHORS SHALL BE AS LISTED, SPACED AS SHOWN ON DETAILS, ANCHORS EMBEDMENT TO  
BASE MATERIAL SHALL BE BEYOND WALL DRESSING OR STUCCO.

ANCHORING OR LOADING CONDITIONS NOT SHOWN IN THESE DETAILS ARE NOT PART OF THIS  
APPROVAL.

MATERIALS INCLUDING BUT NOT LIMITED TO STEEL/METAL SCREWS, THAT COME INTO CONTACT  
WITH OTHER DISSIMILAR MATERIALS SHALL MEET THE REQUIREMENTS OF THE FLORIDA BUILDING  
CODE.

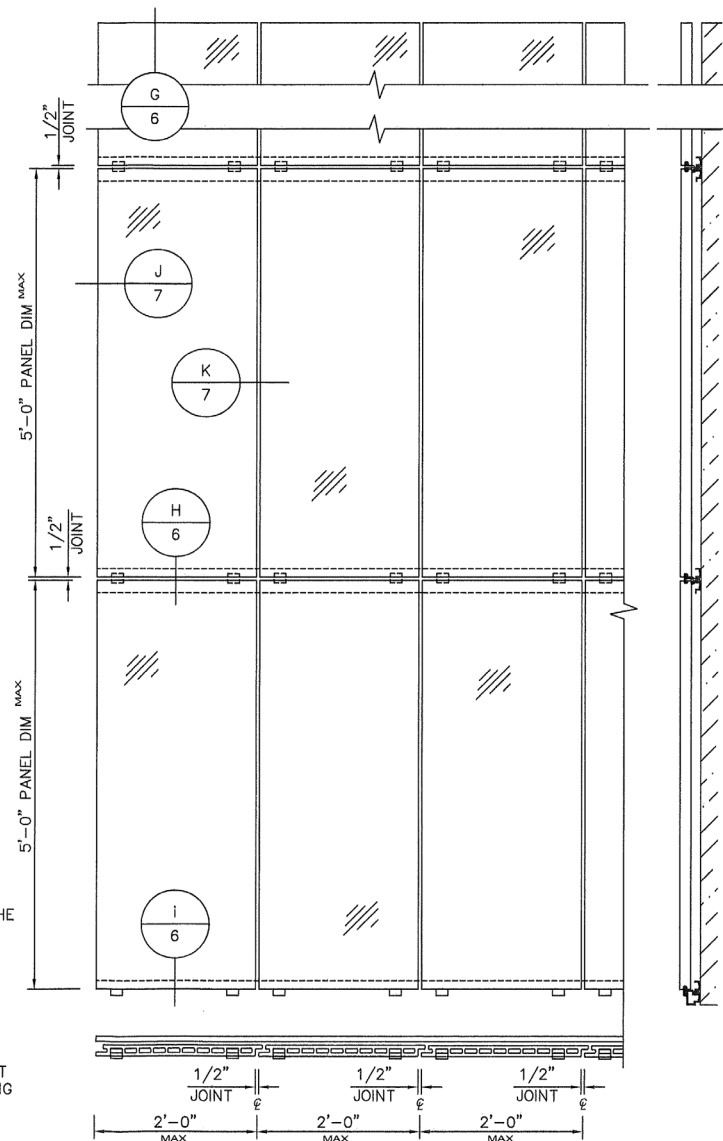

**PRODUCT RENEWED**  
as complying with the Florida  
Building Code  
NOA-No. 25-1030.03

Expiration Date 12/24/2030

By *[Signature]*  
Miami-Dade Product Control

**PRODUCT REVISED**  
as complying with the Florida  
Building Code  
NOA-No. 23-1222.17

Expiration Date 12/24/2025

By *[Signature]*  
Miami-Dade Product Control

SIGNED: 02/21/2024

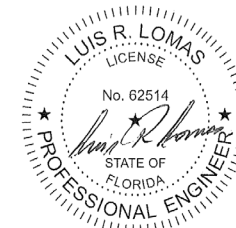

Rev	Date	By	Check	Notes
1	4/21/15			NOA SUB UPDATES
2				
3				
4				
5				

PRODUCT DESCRIPTION:  
SYSTEM WALL CLADDING  
TERRACOTA PANELS  
HORIZONTAL and VERTICAL

Boston Valley  
Terra Cotta  
5860 S. ABBOT RD.  
ORCHARD PARK, NY 14127  
www.terraclad.com  
1-716-649-7490

L. Roberto Lomas P.E.  
1432 Woodford Road  
Lewisville, NC 27023  
(434)-688-0609  
www.lromaspe.com  
FL No. # 62514

Drawn By: WJH&A  
Date Drawn: 5/30/2015  
Checked By:  
D-Scale: 1"=1'-0"  
B-Scale: 1/2"=1'-0"  
DRAWING: 12089B.01  
Title:  
Sheet NO: 2 of 10



VERTICAL TRACK SYSTEM  
HORIZONTAL PANEL  
ORIENTATION

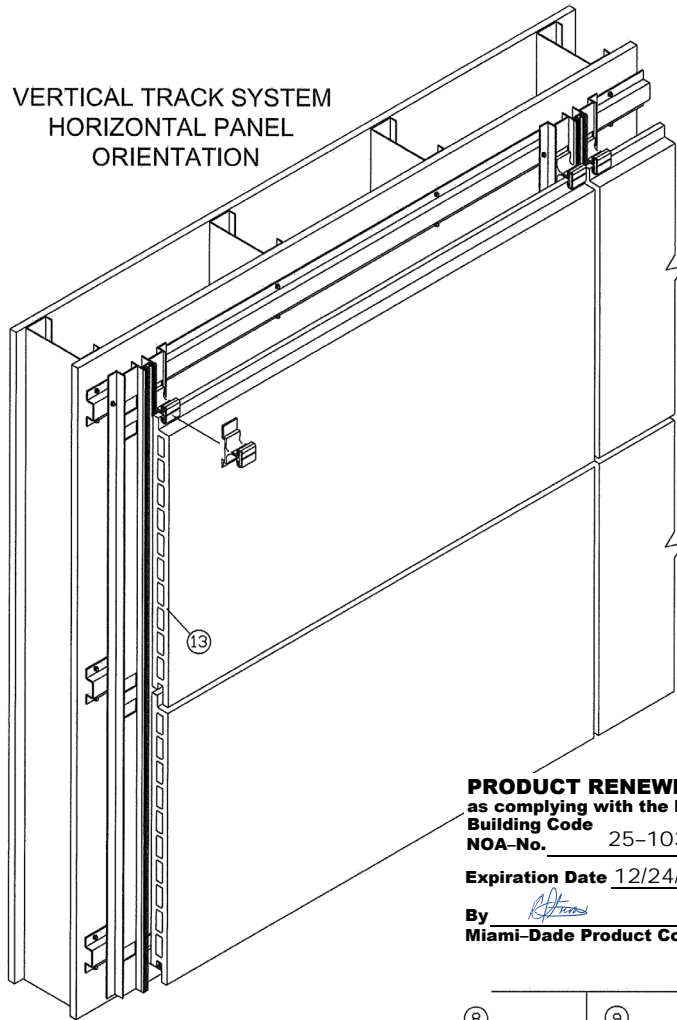

**PRODUCT RENEWED**  
as complying with the Florida  
Building Code  
NOA-No. 25-1030.03

Expiration Date 12/24/2030

By *[Signature]*  
Miami-Dade Product Control

BILL OF MATERIALS

ITEM NO.	QUANTITY	DESCRIPTION	MATERIAL
1	AS REQ'D	ROLLED FORMED HAT Fy=36ksi Fu=58ksi	STEEL
2		VERTICAL TRACK	ALUMINUM 6063-T6
3		VERTICAL CENTER TRACK	
4		HORIZONTAL PANEL CLIP A	
5		HORIZONTAL CENTER TRACK	
6		HORIZONTAL PANEL CLIP B	
7		HORIZONTAL TRACK	
8		HORIZONTAL PANEL CLIP C	SILICONE
9		VERTICAL PANEL CLIP	
10		PANEL CLIP GASKET	
11		VERTICAL TRACK GASKET	
12		PANEL CLIP COMPRESSION GASKET	EPDM
13		40 MM TERRA COTTA TILE PANEL	-

**PRODUCT REVISED**  
as complying with the Florida  
Building Code  
NOA-No. 23-1222.17  
Expiration Date 12/24/2025  
By *[Signature]*  
Miami-Dade Product Control

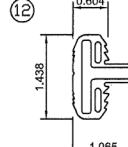
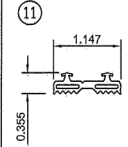
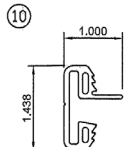
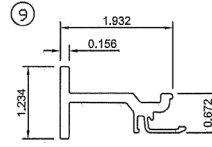
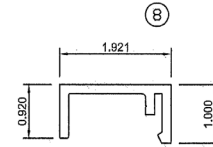
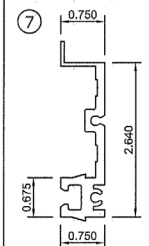
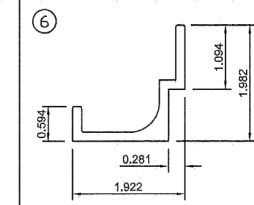
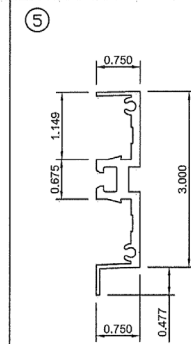
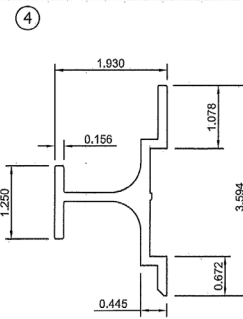
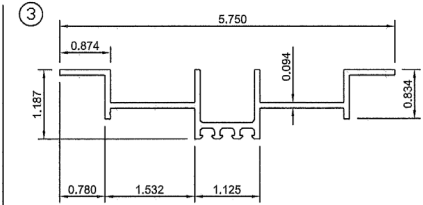
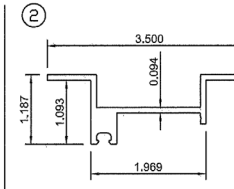
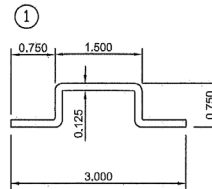

SIGNED: 02/21/2024

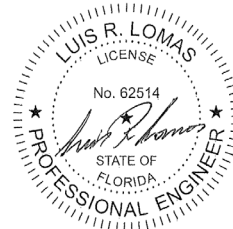

<p>PRODUCT DESCRIPTION: SYSTEM WALL CLADDING TERRA COTTA PANELS HORIZONTAL and VERTICAL</p>	<p>5860 S. ABBOT RD. ORCHARD PARK, NY 14127 Terra Cotta www.terracotta.com</p>	<p>1-716-649-7490</p>
<p>L. Roberto Lomas P.E. 1432 Woodford Road Lewisville, NC 27023 (434)-688-0609</p>	<p>www.lrlomaspe.com</p>	<p>FL No. # 62514</p>
<p>Drawn By: WJH&amp;A Date Drawn: 5/30/2015 Checked By: D-Scaler: Full B-Scaler: 8"x11" DRAWING: 120888.01 Title:</p>		
<p>Sheet NO: 3 of 10</p>		

**PRODUCT RENEWED**  
as complying with the Florida  
Building Code  
NOA-No. 25-1030.03

Expiration Date 12/24/2030

By *[Signature]*  
Miami-Dade Product Control

**PRODUCT REVISED**  
as complying with the Florida  
Building Code  
NOA-No. 23-1222.17

Expiration Date 12/24/2025

By *[Signature]*  
Miami-Dade Product Control

**A** PANEL HEAD  
SCALE: .5 = 1.0

40 MM (1.574") TERRA COTTA  
TYPICAL

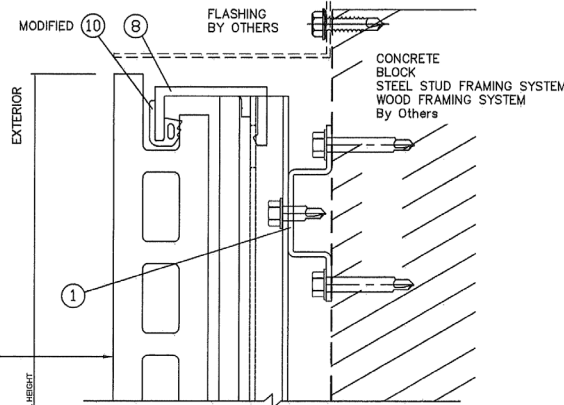

**B** HORZ PANEL / PANEL  
SCALE: .5 = 1.0

WATER RESISTIVE BARRIER  
(BY OTHERS)  
TYPICAL

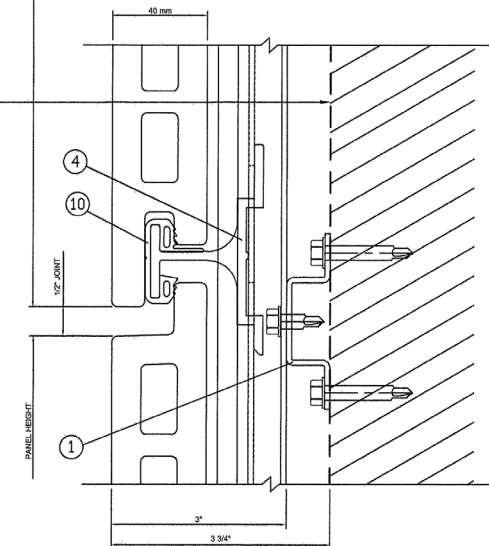

**C** PANEL SILL  
SCALE: .5 = 1.0

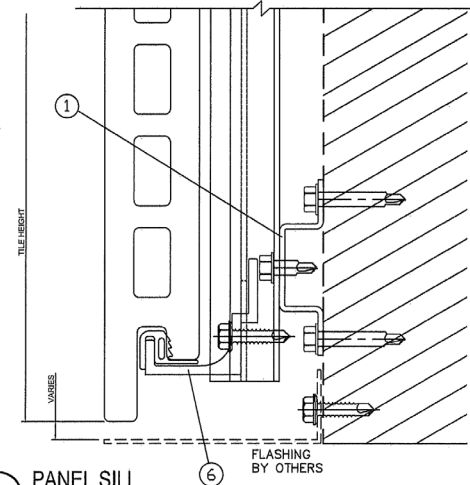

**D** CENTER of PANEL  
SCALE: .5 = 1.0

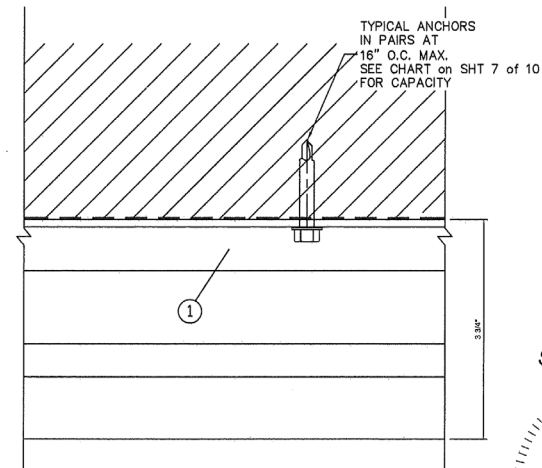

SIGNED: 02/21/2024

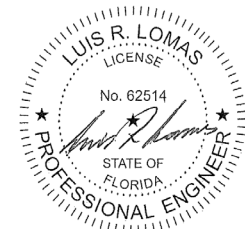

Drawn By: W.H&A	Scale: 1/4\"/>
-----------------	----------------



By   
Miami-Dade Product Control

**G** PANEL HEAD  
SCALE: .5 = 1.0

WATER RESISTIVE BARRIER  
(BY OTHERS)  
TYPICAL

**H** HORZ PANEL / PANEL  
SCALE: .5 = 1.0

40 MM (1.574") TERRA COTTA  
TYPICAL

**i** PANEL SILL  
SCALE: .5 = 1.0

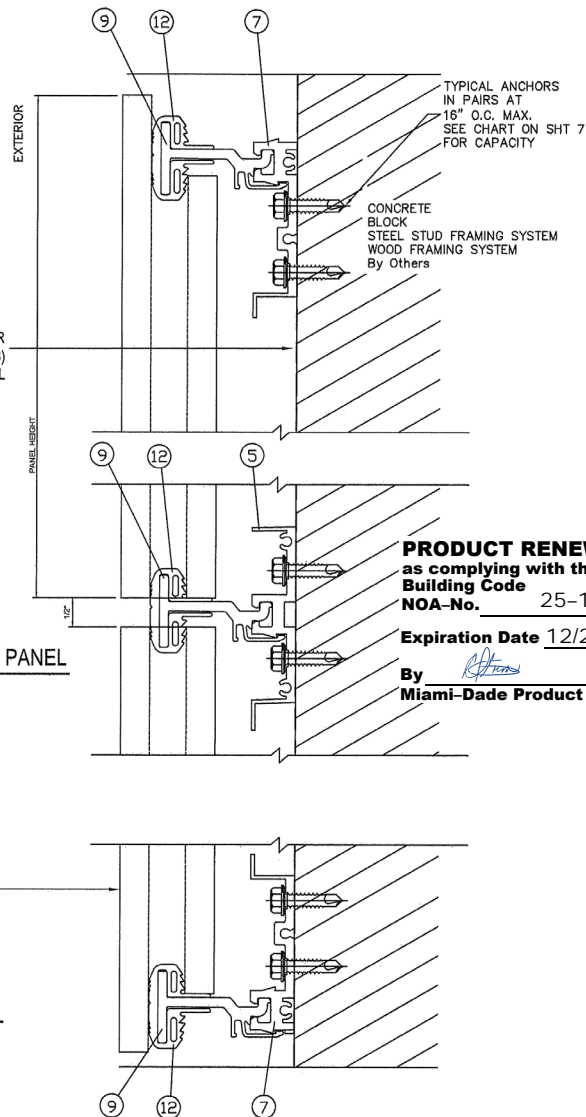

**PRODUCT RENEWED**  
as complying with the Florida  
Building Code  
NOA-No. 25-1030.03

Expiration Date 12/24/2030

By *[Signature]*  
Miami-Dade Product Control

## HORIZONTAL TRACK SYSTEM VERTICAL PANEL ORIENTATION

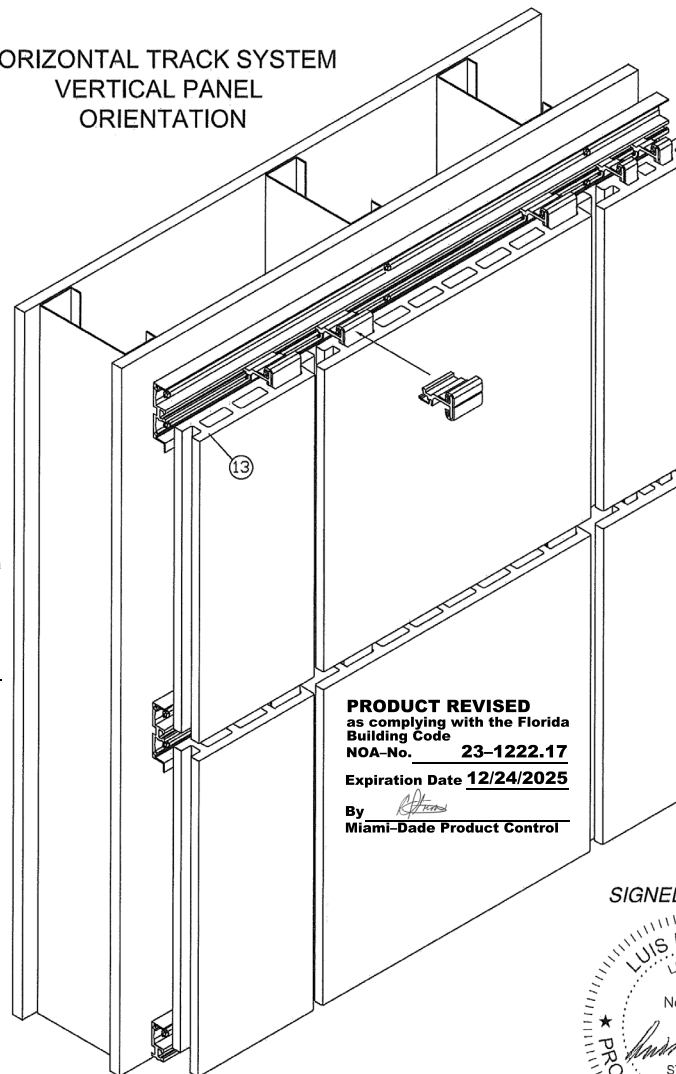

**PRODUCT REVISED**  
as complying with the Florida  
Building Code  
NOA-No. 23-1222.17  
Expiration Date 12/24/2025  
By *[Signature]*  
Miami-Dade Product Control

SIGNED: 02/21/2024

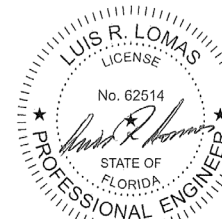

Rev	Date	Revised	NOA SUB UPDATES
1	4/20/15		
2			
3			
4			
5			
6			
7			
8			
9			
10			

PRODUCT DESCRIPTION:	SYSTEM: WALL CLADDING TERRA COTTA PANELS HORIZONTAL and VERTICAL
Boston Valley	8860 S ABBOT RD, ORCHARD PARK, NY 14127 www.bostonvalley.com
Terra Cotta	1-716-649-7490 www.terraclad.com
L. Roberto Lomas P.E.	1432 Woodford Road Lewisville, NC 27023 (434)-666-0609 www.lrlomaspe.com
FL No. #	62514
Drawn By: WJH/A	
Date Drawn: 5/30/2015	
Checked By:	
D-Scaler:	Full
D-Scale:	6"x1'-0"
DRAWING:	120898.01
Title:	
Sheet NO:	6 of 10

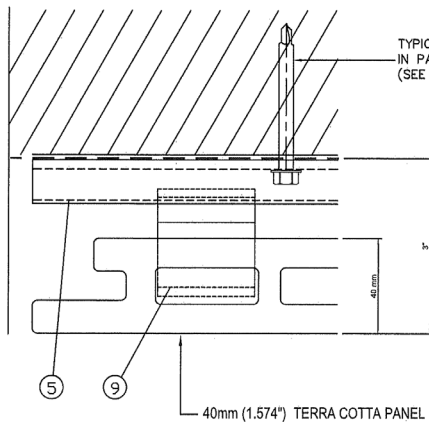

**J** PANEL JAMB  
SCALE: .5 = 1.0

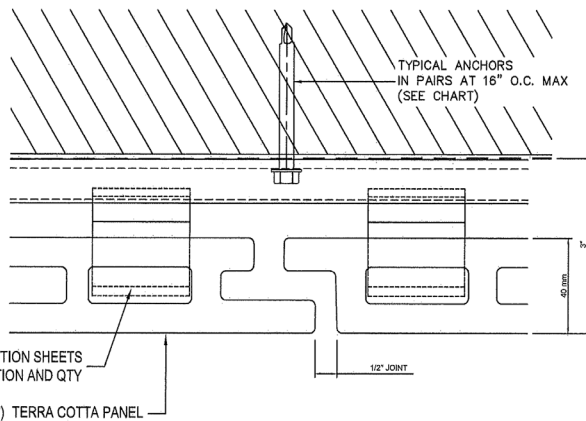

**K** VERTICAL PANEL / PANEL  
SCALE: .5 = 1.0

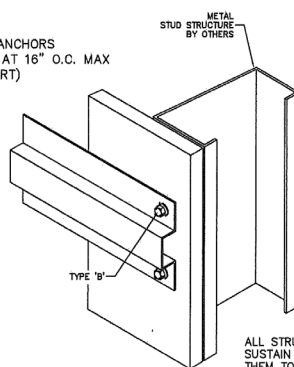

ALL STRUCTURES NOT BY BOSTON VALLEY TERRA COTTA. MUST  
SUSTAIN LOADS IMPOSED BY CLADDING SYSTEM AND TRANSFER  
THEM TO THE BUILDING.

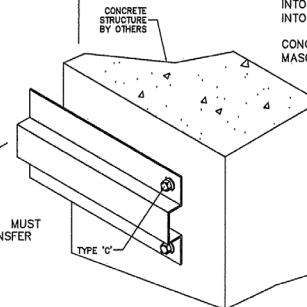
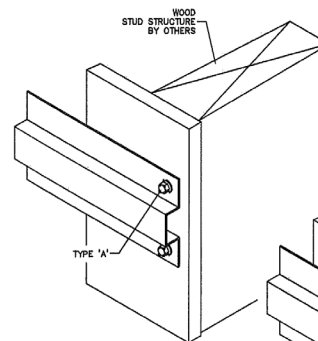

#### TYPICAL ANCHORS:

- TYPE 'A' #14 WOOD SCREWS  
INTO WOOD STRUCTURES  
2" MIN. PENETRATION INTO WOOD
- TYPE 'B' #14 SMS OR SELF-DRILLING SCREWS  
INTO METAL STUDS WITH WOOD BACKING  
1-1/2" MIN. PENETRATION INTO WOOD BACKING
- TYPE 'C' 1/4" DIA. ELCO ULTRACON  
DIRECTLY INTO MASONRY OR CONCRETE  
1-1/4" MIN. EMBED INTO MASONRY OR CONCRETE

#### TYPICAL EDGE DISTANCE

- INTO CONCRETE AND MASONRY = 3" MIN.  
INTO WOOD STRUCTURE = 5/8" MIN.  
INTO METAL STRUCTURE = 1" MIN.

CONCRETE  $f'_c$  = 3000 PSI MIN.  
MASONRY  $f_m$  = 2000 PSI MIN.

#### PRODUCT RENEWED as complying with the Florida Building Code

NOA-No. 25-1030.03

Expiration Date 12/24/2030

By *[Signature]*  
Miami-Dade Product Control

#### PRODUCT REVISED as complying with the Florida Building Code

NOA-No. 23-1222.17

Expiration Date 12/24/2025

By *[Signature]*  
Miami-Dade Product Control

SIGNED: 02/21/2024

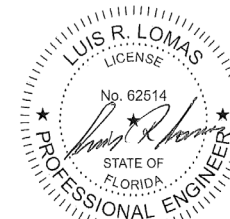

Rev	By	Date	Notes
1	AW	4/29/15	NON SUB UPDATES

PRODUCT DESCRIPTION:  
SYSTEM WALL CLADDING  
TERRA COTTA PANELS  
HORIZONTAL and VERTICAL

Boston Valley  
Terra Cotta  
8850 S. ABBOT RD.  
ORCHARD PARK, NY 14127  
www.terracotta.com  
1-716-649-7490

L. Roberto Lomas P.E.  
1432 Woodford Road  
Lewisville, NC 27023  
(434)-688-0609  
www.lrlomaspe.com  
FL No. # 62514

Drawn By: WJH&A  
Date Drawn: 5/30/2015  
Checked By:  
D-Grade: Full  
B-Grade: 8"x11" or  
DRAWING: 120699.01  
Title:  
Sheet NO: 7 of 10

# HORIZONTAL PANELS ORIENTATION OPTIONAL CORNER DETAILS

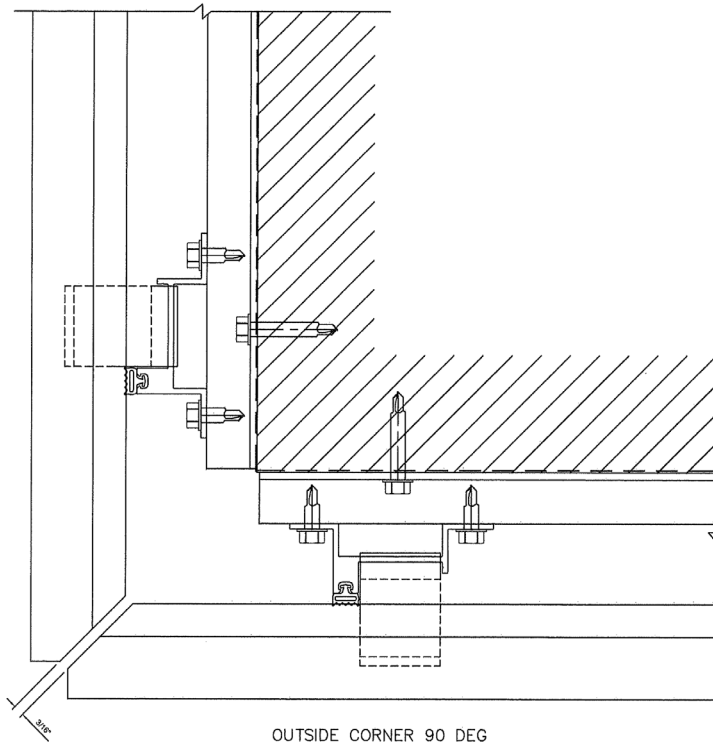

OUTSIDE CORNER 90 DEG

FOR ANCHOR TYPE, SPACING,  
MINIMUM EDGE DISTANCE, AND  
MINIMUM EMBEDMENT SEE SHEET 7.

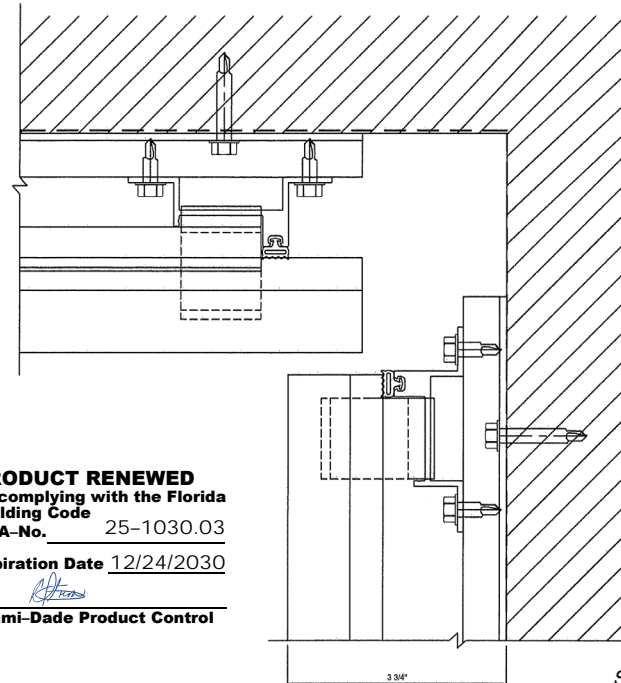

INSIDE CORNER 90 DEG

FOR ANCHOR TYPE, SPACING,  
MINIMUM EDGE DISTANCE, AND  
MINIMUM EMBEDMENT SEE SHEET 7.

**PRODUCT RENEWED**  
as complying with the Florida  
Building Code  
NOA-No. 25-1030.03

Expiration Date 12/24/2030

By *[Signature]*  
Miami-Dade Product Control

**PRODUCT REVISED**  
as complying with the Florida  
Building Code  
NOA-No. 23-1222.17

Expiration Date 12/24/2025

By *[Signature]*  
Miami-Dade Product Control

SIGNED: 02/21/2024

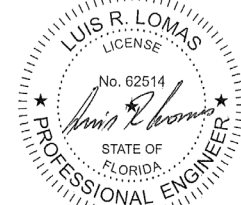

Rev.	Date	Revised
1	4/21/15	NOA SUB UPDATES
2		
3		
4		
5		
6		
7		
8		
9		
10		

PRODUCT DESCRIPTION:  
SYSTEM WALL CLADDING  
TERRA COTTA PANELS  
HORIZONTAL and VERTICAL

**Boston Valley**  
Terra Cotta  
6880 S. ABBOTT RD.  
ORCHARD PARK, NY 14127  
1-716-649-7490  
www.bostonvalley.com

**L. Roberto Lomas P.E.**  
1432 Woodford Road  
Lewisville, NC 27023  
(434)-688-0609  
www.lrlomaspe.com  
FL No. # 62514

Drawn By: WJH/A  
Date Drawn: 5/30/2015  
Checked By:  
D-Scaller: Full  
D-Scaller: 8"x11"-0"  
DRAWING: 120898.01  
Title:

Sheet NO: 8 of 10

# VERTICAL PANEL ORIENTATION OPTIONAL CORNER DETAILS

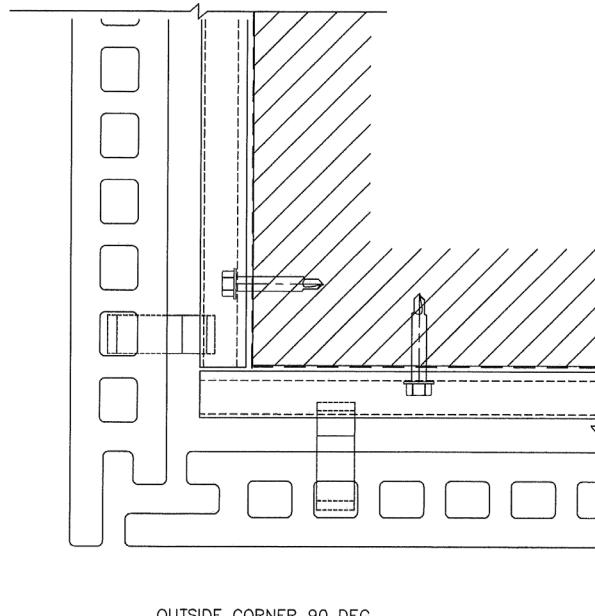

OUTSIDE CORNER 90 DEG

FOR ANCHOR TYPE, SPACING,  
MINIMUM EDGE DISTANCE, AND  
MINIMUM EMBEDMENT SEE SHEET 7.

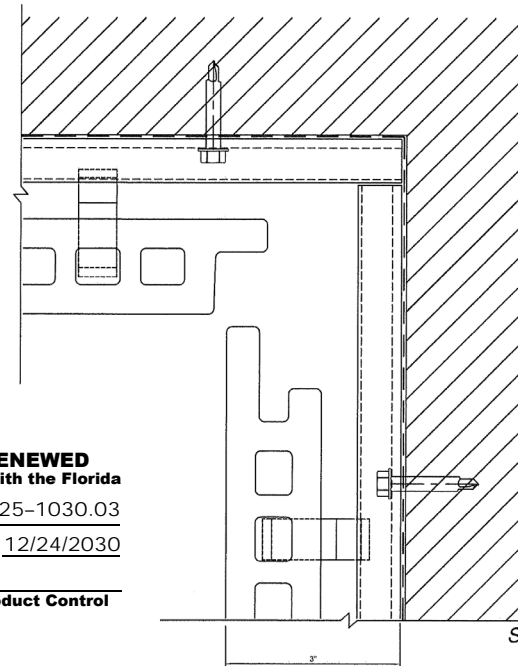

INSIDE CORNER 90 DEG

FOR ANCHOR TYPE, SPACING,  
MINIMUM EDGE DISTANCE, AND  
MINIMUM EMBEDMENT SEE SHEET 7.

**PRODUCT RENEWED**  
as complying with the Florida  
Building Code  
NOA-No. 25-1030.03

Expiration Date 12/24/2030

By *[Signature]*  
Miami-Dade Product Control

**PRODUCT REVISED**  
as complying with the Florida  
Building Code  
NOA-No. 23-1222.17

Expiration Date 12/24/2025

By *[Signature]*  
Miami-Dade Product Control

SIGNED: 02/21/2024

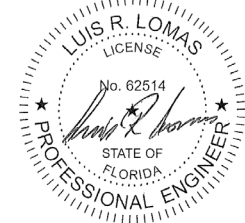

Rev	Date	Revised
1	4/27/15	NOA SUB UPDATES
2		
3		
4		
5		
6		
7		
8		
9		
10		

PRODUCT DESCRIPTION:  
SYSTEM: WALL CLADDING  
TERRA COTTA PANELS  
HORIZONTAL and VERTICAL

**Boston Valley**  
Terra Cotta  
6860 S. ABBOT RD.  
ORCHARD PARK, NY 14127  
1-716-649-7490  
www.terracotta.com

**L. Roberto Lomas P.E.**  
1432 Woodford Road  
Lewisville, NC 27023  
(434)-888-0609  
www.lrlomaspe.com  
FL No. # 62514

Drawn By: W.H&A  
Date Drawn: 5/30/2015  
Checked By:  
D-Scale: Full  
B-Scale: 6"-1'-0"  
DRAWING: 120698B.01  
Title:  
Sheet NO: 9 of 10

## AVAILABLE PANEL DIMENSIONS

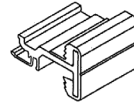
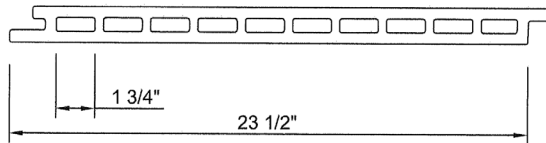
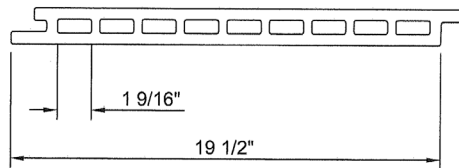
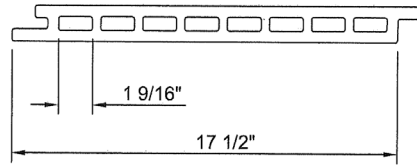

UTILIZES 1-1/2" LONG CLIPS  
WHEN USED WITH HORIZONTAL TRACK SYSTEM

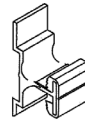

UTILIZES 1-3/8" LONG CLIPS  
WHEN USED WITH VERTICAL TRACK SYSTEM

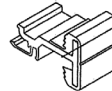

UTILIZES 1" LONG CLIPS  
WHEN USED WITH HORIZONTAL TRACK SYSTEM

**PRODUCT RENEWED**  
as complying with the Florida  
Building Code  
NOA-No. 25-1030.03

Expiration Date 12/24/2030

By *[Signature]*  
Miami-Dade Product Control

**PRODUCT REVISED**  
as complying with the Florida  
Building Code  
NOA-No. 23-1222.17

Expiration Date 12/24/2025

By *[Signature]*  
Miami-Dade Product Control



UTILIZES 5/8" LONG CLIPS  
WHEN USE WITH HORIZONTAL TRACK SYSTEM

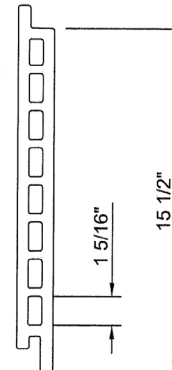
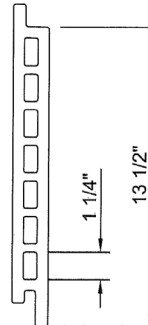
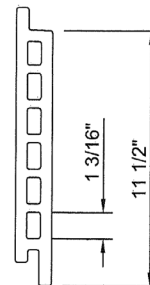
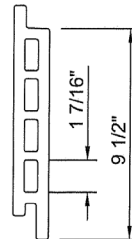
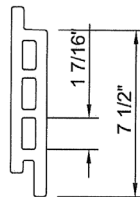
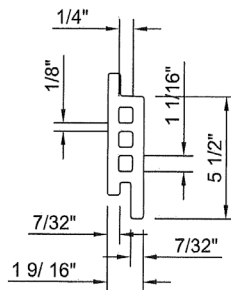

SIGNED: 02/21/2024

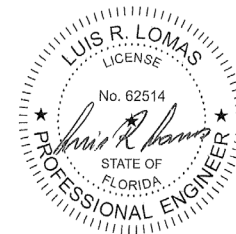

Rev	Date	By	Notes
1	4/29/15	Δ	NOA SUB UPDATES
2		Δ	
3		Δ	
4		Δ	
5		Δ	

PRODUCT DESCRIPTION:  
SYSTEM WALL CLADDING  
TERRA COTTA PANELS  
HORIZONTAL and VERTICAL

Boston Valley  
Terra Cotta  
6860 S. ABBOT RD.  
ORCHARD PARK, NY 14127  
www.terracotta.com  
1-716-649-7490

L. Roberto Lomas P.E.  
1432 Woodford Road  
Lewisville, NC 27023  
(434)-688-0609  
www.lrlomaspe.com  
FL No. # 62514

Drawn By: WJH/A  
Date Drawn: 5/30/2015  
Checked By:  
D-Scale: Full  
B-Scale: 6"=1'-0"  
DRAWING: 120898.01  
Title:  
Sheet NO: 10 of 10