

Date: April 6, 2010

To: Honorable Chairman Dennis C. Moss
and Members, Board of County Commissioners

Agenda Item No. 3(J)(1)(C)

From: George M. Burges
County Manager

Resolution No. R-420-10

Subject: Ratification of the Black Creek Trail Cultural Arts Center Bridge and Lighted Pedestrian Connection Grant Application to the Transportation Enhancement Grant Program

Recommendation

It is recommended that the Board adopt the attached resolution ratifying the submission of a grant application to the Transportation Enhancement Grant Program for \$1,000,000 in funding to support the engineering, design and construction of the Black Creek Trail Cultural Arts Center Bridge and Lighted Pedestrian Connection Project. It is further recommended that the Board authorize the County Mayor or County Mayor's designee to receive and expend funds and execute contracts and amendments as required.

Scope

The project site is located near SW 211 Street and SW 109 Avenue in Commission District 8. This project will have a countywide impact.

Fiscal Impact/Funding Source

This grant will contribute \$1,000,000 towards the total project cost of \$2,000,000. The grant match of \$1,000,000 is available from Building Better Communities, General Obligation Bond (BBC-GOB) Project No. 51, Site No. 70362, South Dade Greenway and Trail, Commission District 8, with an allocation of \$3,000,000.

Track Record/Monitor

The grant will be administered by Miami-Dade County Park and Recreation Department (MDPR), Grants Administrator, Greg Pessolano. MDPR has received over \$1.1 million in grant funds from the Transportation Enhancement Grant Program within the last five (5) years.

Background

The Transportation Enhancement Grant Program is an element of the Federal Highway Administration, Surface Transportation Program that provides funds for the development of "non-traditional" transportation projects including the provision of facilities for pedestrians and bicycles. This project will involve the engineering, design and construction of a bridge for pedestrians and bicycles across the Black Creek C-1 Canal. The bridge will improve safety for bicyclists and pedestrians who wish to access the cultural, civic and commercial facilities near the South Dade Government Center.

Ratification of this application is necessary because there was insufficient time to seek Board approval prior to the application deadline. Match funding for the grant was identified in late February. The application deadline was March 5, 2010.

Attachments

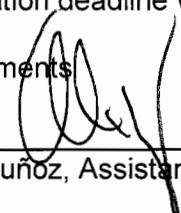

Alex Muñoz, Assistant County Manager



MEMORANDUM

(Revised)

TO: Honorable Chairman Dennis C. Moss
and Members, Board of County Commissioners

DATE: April 6, 2010

FROM: R. A. Cuevas, Jr.
County Attorney

SUBJECT: Agenda Item No. 3(J)(1)(C)

Please note any items checked.

- "3-Day Rule" for committees applicable if raised
- 6 weeks required between first reading and public hearing
- 4 weeks notification to municipal officials required prior to public hearing
- Decreases revenues or increases expenditures without balancing budget
- Budget required
- Statement of fiscal impact required
- Ordinance creating a new board requires detailed County Manager's report for public hearing
- No committee review
- Applicable legislation requires more than a majority vote (i.e., 2/3's ____, 3/5's ____, unanimous ____) to approve
- Current information regarding funding source, index code and available balance, and available capacity (if debt is contemplated) required

Approved _____ Mayor
Veto _____
Override _____

Agenda Item No. 3(J)(1)(C)
4-6-10

RESOLUTION NO. R-420-10

RESOLUTION RATIFYING SUBMISSION OF A GRANT APPLICATION IN THE AMOUNT OF \$1,000,000 TO THE TRANSPORTATION ENHANCEMENT GRANT PROGRAM FOR THE ENGINEERING, DESIGN AND CONSTRUCTION OF THE BLACK CREEK TRAIL CULTURAL ARTS CENTER BRIDGE AND LIGHTED PEDESTRIAN CONNECTION PROJECT AND FURTHER AUTHORIZING THE COUNTY MAYOR OR THE COUNTY MAYOR'S DESIGNEE TO RECEIVE AND EXPEND FUNDS, AND TO FILE AND EXECUTE CONTRACTS AND AMENDMENTS AS REQUIRED

WHEREAS, this Board desires to accomplish the purpose outlined in the accompanying memorandum, a copy of which is incorporated herein by reference,

NOW, THEREFORE, BE IT RESOLVED BY THE BOARD OF COUNTY COMMISSIONERS OF MIAMI-DADE COUNTY, FLORIDA, that this Board ratifies the submission of a grant application to the Transportation Enhancement Grant Program for \$1,000,000 in grant funding for the engineering, design and construction of the Black Creek Trail Cultural Arts Center Bridge and Lighted Pedestrian Connection Project; and further authorizes the County Mayor or County Mayor's designee to execute such contracts and amendments as are required by this governmental body following approval by the County Attorney's Office; to receive and expend all monies for the purposes described in the funding request; and to file and execute any necessary contracts and amendments to the agreement for and on behalf of Miami-Dade County, Florida.

Resolution No. R-420-10

Agenda Item No. 3(J)(1)(C)

Page No. 2

The foregoing resolution was offered by Commissioner **Jose "Pepe" Diaz**, who moved its adoption. The motion was seconded by Commissioner **Dorrin D. Rolle** and upon being put to vote, the vote was as follows:

	Dennis C. Moss, Chairman	aye		
	Jose "Pepe" Diaz, Vice-Chairman	aye		
Bruno A. Barreiro	absent	Audrey M. Edmonson	absent	
Carlos A. Gimenez	aye	Sally A. Heyman	aye	
Barbara J. Jordan	aye	Joe A. Martinez	aye	
Dorrin D. Rolle	aye	Natacha Seijas	aye	
Katy Sorenson	aye	Rebeca Sosa	aye	
Sen. Javier D. Souto	aye			

The Chairperson thereupon declared the resolution duly passed and adopted this 6th day of April, 2010. This resolution shall become effective ten (10) days after the date of its adoption unless vetoed by the Mayor, and if vetoed, shall become effective only upon an override by this Board.

MIAMI-DADE COUNTY, FLORIDA
BY ITS BOARD OF COUNTY
COMMISSIONERS

HARVEY RUVIN, CLERK



By: **DIANE COLLINS**
Deputy Clerk

Approved by County Attorney as to form and legal sufficiency. 

Monica Rizo

Cultural Arts Center Bridge & Lighted Pedestrian Connection Application for Transportation Enhancement Projects

Appendix B

Project Title: Cultural Arts Center Bridge and Lighted Pedestrian Connection

Project Sponsor: Miami-Dade County Park and Recreation Department

Contact: Greg Pessolano, Grants Administrator

Address: 275 NW 2 Street, Ste. 507, Miami, FL 33128

Phone: 305-755-7846 FAX: 305-755-7996

Priority: # 3

Name of Applicant: Miami Dade County Park and Recreation Department

1. Qualifying Enhancement Activities

Provision of facilities for pedestrians and bicycles

2. Project Description

a) Type of work being proposed

Engineering and Final Plans Preparation Work

Construction and Construction Engineering and Inspection Activities

b) Describe how the proposed project is related to the intermodal transportation system by either function, proximity or impact.

This project will have a direct connection to the existing bike lanes along SW 211 St. (Cutler Ridge Blvd) that extend from S. Dixie Hwy. (U.S. 1) to the Homestead Extension of Florida's Turnpike (S.R. 821-HEFT). In addition, it will improve intermodal transportation linkage by providing a connection to Metrobus Route 137 off SW 211 St. which is equipped with bicycle racks. This project ties directly into the existing Black Creek Trail which is one of 10 interconnecting trails proposed in the South Dade Greenways Network Master Plan that totals 194 miles in length. The Black Creek Trail ties into three existing trails: The South Dade Trail along the Busway near U.S. 1 and the Biscayne Trail (Segment B) near Black Point Park and Marina (near SW 244 St. bridge), and Old Cutler Trail near SW 216 St. and the HEFT. It also ties into other planned trails: Biscayne Trail (Segment C) near Black Point Park and Marina) and the Krome Trail near the L-31N Canal.

c) Where is the project located ?

The property is located in southeast Miami Dade County with a portion within the Town of Cutler Bay and a portion in an unincorporated part of the County. The project runs between SW 112 Ave (S. Allapattah Rd.) and the Homestead Extension of Florida's Turnpike (S.R. 821-HEFT) near SW 109 Ave south of SW 211 St. and north of SW 216 St. (Hainlin Mill Dr.) (**Attachment # 1**). The southern terminus is the existing Black Creek Trail and the northern terminus is SW 211 St. The bridge is estimated to be a three span keystone (bridge pier) structure approximately 180 feet long with a 12 foot width. The lighted pedestrian connection is estimated to be 570 feet long and is located on the north side of the canal parallel to the canal (**Attachments # 2, 3 and 4**) by the Cultural Arts Center.

d) Summarize any special characteristics of project.

This project will improve safety for cyclists and pedestrians by providing a safe, convenient, and affordable access across the Black Creek C-1 Canal from the south side of the canal to SW 211 St. connecting to a variety of important cultural, civic and commercial facilities. The current north-south access across the canal is via an existing narrow sidewalk on S. Allapattah Rd. (SW112 Ave.) which is substandard and difficult to widen and has no direct connection to the Cultural Arts Center or the South Dade Government Center complex. This project will further improve the neighborhood and community quality of life by providing access to nearby low income residents at Arthur Mays Village or Goulds Plaza who may not own a vehicle. In addition, this project will encourage cycling and walking to destinations where people want to go (Cultural Arts Center, Southland Mall, and the South Dade Government Complex) as well as access to public transit.

The bridge is intended to serve as a gateway and landmark that enhances travelers experience by offering scenic views of the canal and appealing architectural elements. Local artwork and vegetation will be incorporated throughout this project to provide visual interest, a sense of identity and a welcome atmosphere. Careful attention will be paid to the overall design and form as well as to the specific design of architectural, hardscape and landscape elements. The project will utilize consistent bridge design principles with a simple sub structure and support features, as well as a visually light rail structure to maximize views. Earthwork will be blended with existing slope conditions.

It is anticipated that the Cultural Art Center Bridge and Lighted Pedestrian Connection will enhance wayfinding by establishing dramatic and easily recognized landmarks and signs. The signs will focus on identity, orientation and wayfinding. The overall physical appearance of the project area will improve at key points of entry by framing views and adding plants and shade trees. The overall pedestrian experience in terms of comfort, safety, visual interest and civic engagement will be enhanced through special paving, lighting, seating areas, bike racks and artwork. The use of patterns and textures will be promoted at key locations such as crosswalks and high pedestrian areas.

e) Describe the project's existing right of way ownerships.

The right of way within the Black Creek (C-1) Canal corridor is owned by the South Florida Water Management District (SFWMD) with the canal width approximately 140 feet and approximately 40 feet of right-of-way on the south side of canal and 15 feet right-of-way on the north side of canal. The property between the north canal right-of-way and SW 211 St. is owned by Miami Dade County.

f) Describe any proposed right-of-way acquisition, including expected matching fund source, limitations on fund use or availability, and who will acquire and retain ownership of proposed right-of-way.

No additional right of way acquisition is needed for this project. The Miami Dade County Park and Recreation Department (MDPR) will request modification of right-of-way occupancy Permit #7333 to

6

build a portion of the project within the South Florida Water Management District (SFWMD) canal right of way. The remaining portion of the project site that is outside SFWMD right-of-way will be on land already owned by the County.

g) Describe any related project work phases that are already complete or currently underway.

URS Corporation completed a Phase 1 Programming and Schematic Design report on October 8, 2008 based on a very limited budget that resulted in a strictly utilitarian structure. This phase included a design concept and schematics report, comprising schematic design studies, a project development schedule and a statement of probable construction costs. Because the project is near the South Miami Dade Cultural Arts Center, the decision was made to secure additional funding sources for design and construction to provide an aesthetically pleasing bridge. The new Phase 1 Programming and Schematic Design scope of work will include among other tasks, research of comparable best practices, lessons learned summary, alternative scenarios, preliminary construction and life cycle costs.

Other related work phases include Kimley-Horn and Associates (KHA) completing 100% construction documents for the 9.1 mile Black Creek Trail Segment A (Black Point Park and Marina to Larry and Penny Thompson Park) on December 18, 2009. The segment A project involves resurfacing and widening 4.78 miles of existing shared use (multiple-purpose) trail and adding 4.32 miles of new shared-use trail in gap areas.

The three bid packages for Segment A are currently under review by FDOT for the LAP construction checklist process. The Cultural Arts Center Bridge and Pedestrian Connection project ties into the Phase III bid package (SW 127 Ave to SW 97 Ave) with trail construction anticipated around October 19, 2011. Phase III construction is being delayed from the other two phases because the Miami Dade Water and Sewer Department (WASD) 42" reclaimed water main Deep Water Aquifer project is being routed within the C-1 right-of-way. It is anticipated that the WASD contractor will rebuild the trail after installation of the pipe. It's anticipated Phase 1 bid package (SW 97 Ave to Black Point Park and Marina) and Phase II bid package (SW 134 Ave to SW 127 Ave) will commence around October 1, 2010 ahead of the Phase III bid package.

h) Other specific project information that should be considered.

The Cultural Arts Center Bridge and the Lighted Pedestrian Connection to SW 211 St. provide a critical link from the Black Creek Trail on the south side of the Black Creek C-1 Canal to the new South Miami Dade Cultural Arts Center and the existing South Dade Government Center complex which includes a library, courthouse, police station and government offices on the north side of the canal. The Cultural Arts Center is envisioned to serve as a vital force in the community's cultural and economic development. The Center is conceived as a multidisciplinary arts center and cultural village that will showcase the performing arts. The cultural village concept will help coordinate the Center's evolution with neighboring public and private sector development. Over 19,000 new homes have been built and 16,000 additional new homes are planned in the South Dade trade area, representing about 600,000 residents. The Cultural Arts Center Bridge and Lighted Pedestrian Connection will provide an alternative means of access so that all these people have a viable non-motorized option to get to the Cultural Center, South Dade Government Center complex and the Black Creek Trail.

3. Project Implementation Information

a) Describe the proposed method of performing and administering each work phase of the project.

All Engineering and Final Plans Preparation work and Construction Engineering and Inspection Activities work will be done through a consultant. Miami Dade County Park and Recreation Department will manage the consultants through its in house Project Management Division. Construction will be bid out through its Miscellaneous Construction Contracts through its Planning and Development Division. MDPR is LAP certified.

b) Described any public and private support of the proposed project.

This project ties into the South Dade Greenways Network Master Plan which was adopted by the Citizens Transportation Advisory Committee (CTAC) in 6/29/94, the Bicycle Pedestrian Advisory Committee (BPAC) 7/28/94, the City of Homestead 7/18/94, Florida City 9/9/94, Kendall Federation of Homeowners Association 10/14/94, United States Department of the Interior National Park Service 9/20/94, the Town of Cutler Bay 2/22/2010, the Miami Dade County Board Of Commissioners draft Resolution (**Attachment # 5**) and Miami Dade Department of Cultural Affairs 2/24/2010.

c) Describe the proposed ownership and maintenance responsibilities for the project when it is complete.

The land within the Black Creek C-1 Canal right-of-way is owned by the South Florida Water Management District (SFWMD). MDPR will request modification of existing right-of-way Permit #7333 which allows landscaping and improvements within the Black Creek Trail, along the C-1 canal from SW 137 Ave to Black Point Park and Marina to incorporate this project. In addition, MDPR will request at the same time a resolution from the Board of County Commissioners the County's intent to maintain the new facilities to be constructed within the canal right-of-way. Typical MDPR maintenance for the existing Black Creek Trail from SW 112 Ave (S.Allapattah Rd.) to the HEFT includes sweeping and mowing the grass 26 times per year including trash removal via a pick stick (tool with a pointed end to pierce trash). Each MDPR cycle consists of litter removal, mowing, weed eating and edging, tree trimming up to 10' and blowing pathways clear.

d) Describe source of matching funds and any restrictions on availability.

The source of matching funds is the Building Better Communities bond fund. Currently, two streams of funding are available for Black Creek Trail Segment A (Black Point Park and Marina to Larry and Penny Thompson Park):\$3,000,000 is programmed in District 8 from FY 05-11. There is a restriction on soft costs that currently limits expenditures to 17% of total bond proceeds allocated to the project for soft costs (planning services, design services and project administration costs).

e) Other specific implementation information that should be considered.

Miami Dade County Park and Recreation Department (MDPR) received \$180,000 in Phase 38 (Design) funds for the Three Greenways Bridges (FM416660-1) programmed in FY 04-05 and \$484,000 in Phase 58 (Construction) funds programmed in FY 09-10. The three bridges are for Black Creek Trail Bridge A (near U.S. 1 and Black Creek Canal), Biscayne Trail Bridge B (near SW 328 St. and L-31E Canal) and Black Creek Trail Bridge C (Cultural Arts Center bridge). URS Corporation completed 100% Construction Documents for both Bridge A and Bridge B on December 14, 2009. Both bridge projects are currently under review by FDOT for the LAP construction process. In addition, on January 22, 2010, MDPR received approval from FDOT of a LAP construction extension request for the Three Greenway Bridges from June 30, 2010 to June 30, 2012.

4. Project Cost:

What is the total estimated cost of the work requested to be funded as an enhancement project through this application?

Planning Activities	\$ _____
Project Development and Environmental Studies	\$ _____
Engineering and Final Plans Preparation Work	\$ <u>168,000</u>
Right of Way Acquisition	\$ _____
Construction	\$ <u>1,760,000</u>
Construction Engineering and Inspection Activities	\$ <u>72,000</u>
Other (Describe)	\$ _____
TOTAL:	\$ <u>2,000,000</u>

How will the project be funded?

FDOT Enhancement Funds \$1,000,000 + Local \$1,000,000 = Total \$2,000,000

FDOT Enhancement Funds 50% + Local 50% = 100%

CERTIFICATION OF PROJECT SPONSOR

I hereby certify that the proposed project herein described is supported Miami-Dade County (municipal, county, state, or federal agency, or tribal council) And that said entity will: (1) provide any required funding match; (2) enter into a maintenance agreement with the Florida Department of Transportation; (3) comply with the Federal Uniform Relocation Assistance and Acquisition Policies Act for any Right of Way actions required for the project, and (4) support other actions necessary to fully implement the proposed project. I further certify that the estimated costs included herein are reasonable and understand that significant increases in these costs could cause the project to be removed from the Florida Department of Transportation work program.

This project will be administered using the department's Local Agency Program (check one).
yes no

For FDOT Use only	Yes No	
	Yes	No
Application Complete	_____	_____
Project Eligible	_____	_____
Implementation Feasible	_____	_____
Include In work Program	_____	_____

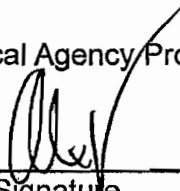

Signature
George M. Burgess
Name (please type or print)
County Manager
Title
3-3-10
Date



MIAMI-DADE COUNTY PARK and RECREATION DEPARTMENT CULTURAL ARTS CENTER BRIDGE and LIGHTED PEDESTRIAN CONNECTION

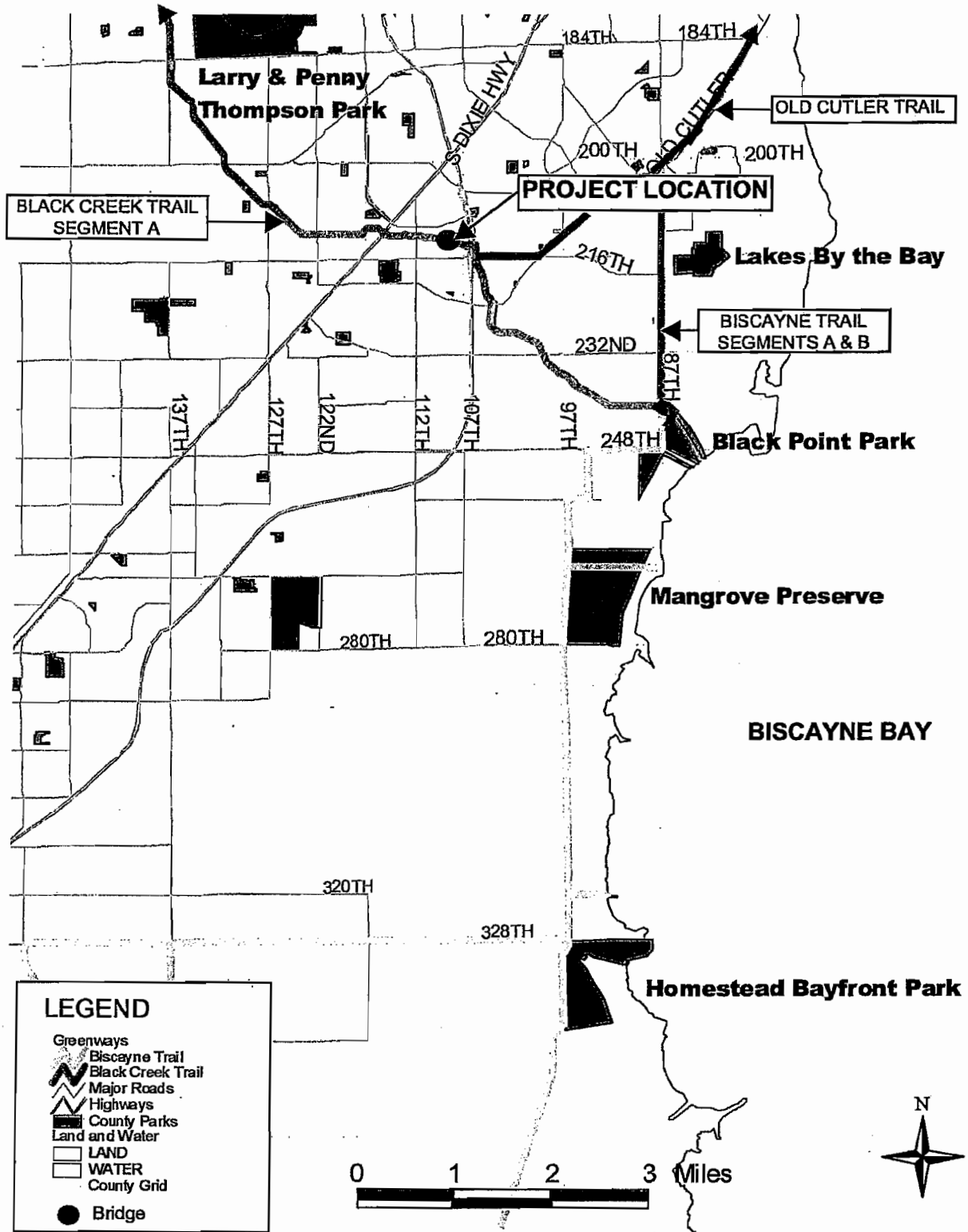

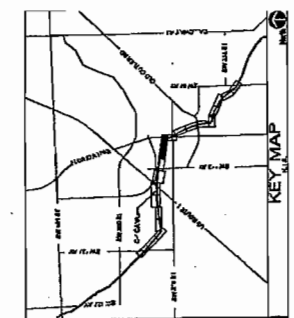
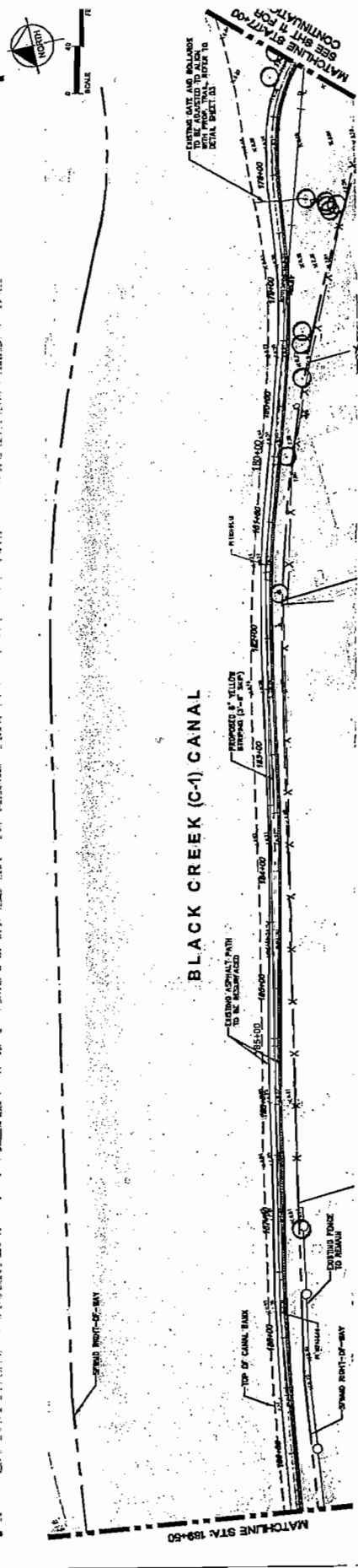
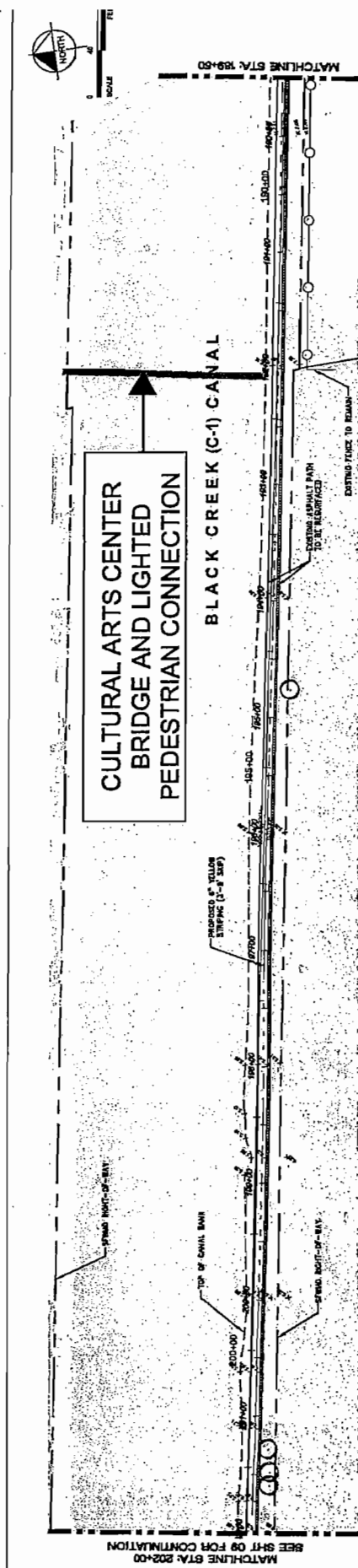

BLACK CREEK TRAIL - PHASE III (CURRENT PLANS AS OF NOVEMBER 6, 2009)		LANDSCAPE AND ENGINEERING	
 PARK AND RECREATION DEPARTMENT 375 BANKER STREET, SUITE 200, FORT LAUDERDALE, FL 33308 P. O. Box 100000, Fort Lauderdale, FL 33308 609.712.6840		SITE PLAN 07	
MIAMI-DADE PARK AND RECREATION		AS NOTED DATE: 11/11/09 PL-07 SHEET 10 OF 10	
Designer: _____ Date: _____	Checker: _____ Date: _____	Designer: _____ Date: _____	Checker: _____ Date: _____

Attachment 3

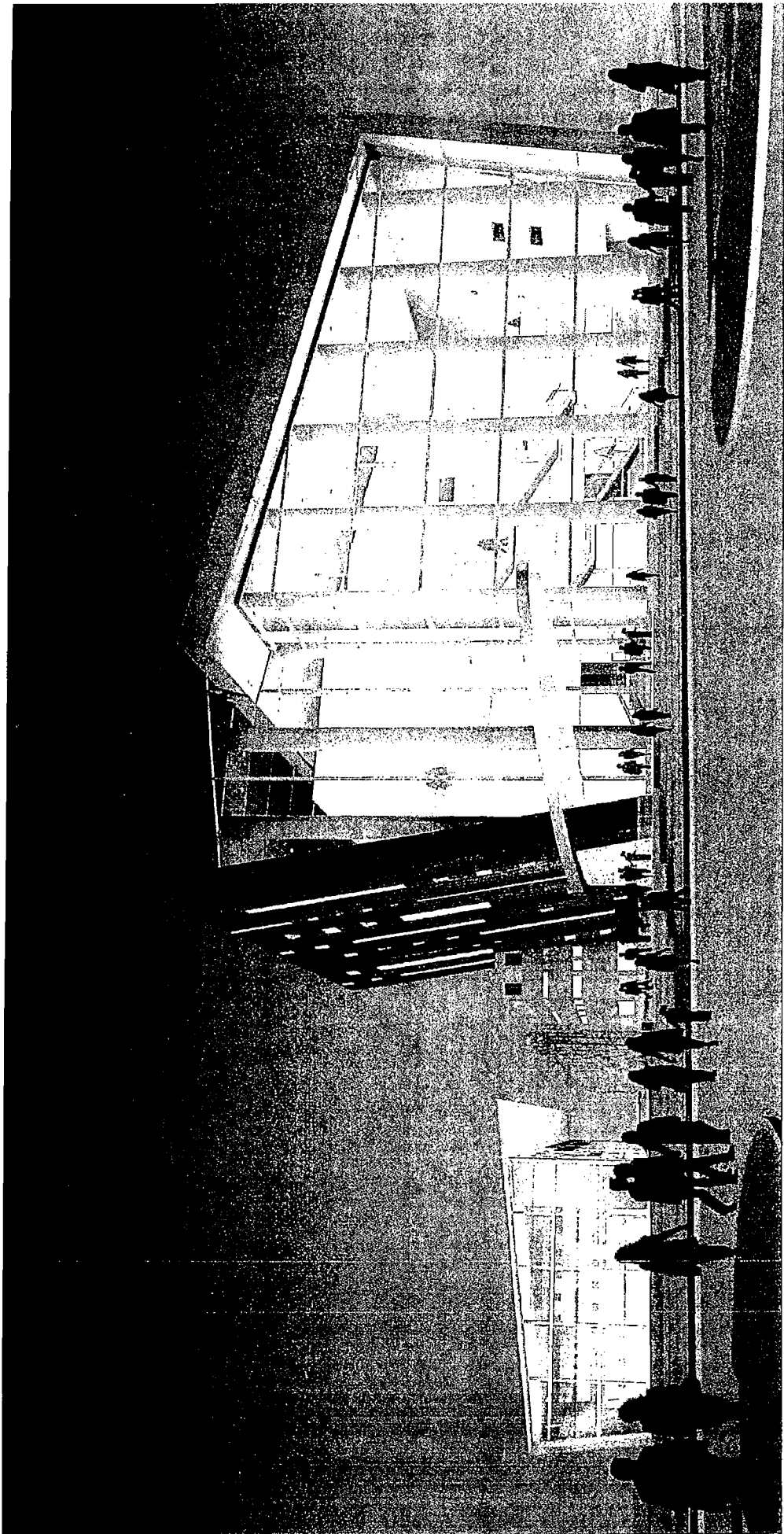

BRIDGE C: Keystone 180 ft. Simple Span

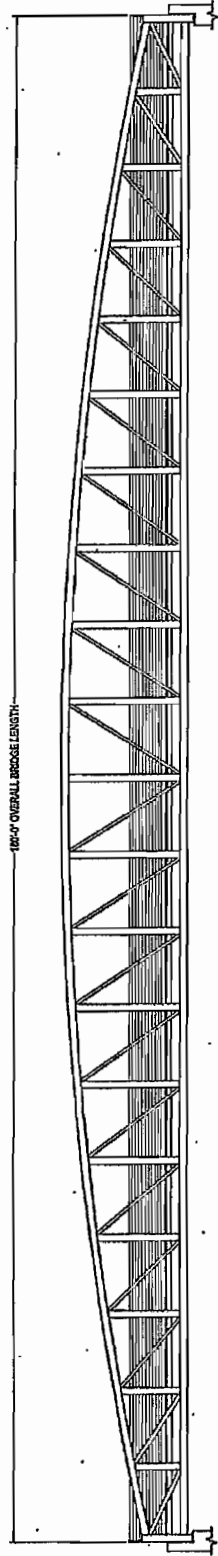

BRIDGE ELEVATION OPTION #1

BRIDGE C: Keystone 3-60 ft. Span

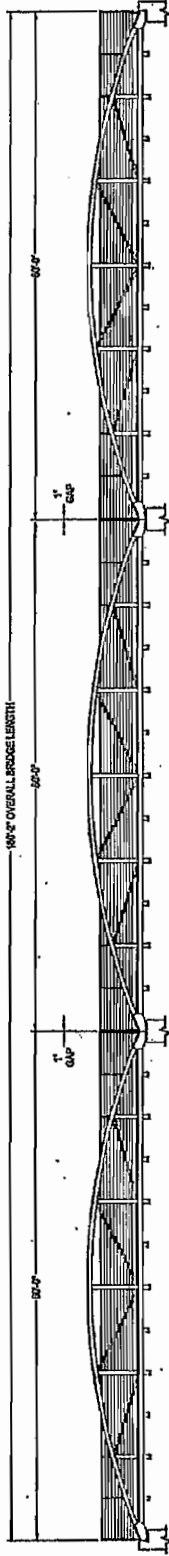

BRIDGE ELEVATION OPTION #2

<small> THE INFORMATION CONTAINED HEREIN IS THE PROPERTY OF CONTINENTAL BRIDGE SOLUTIONS, INC. AND IS NOT TO BE REPRODUCED OR TRANSMITTED IN ANY FORM OR BY ANY MEANS, ELECTRONIC OR MECHANICAL, INCLUDING PHOTOCOPYING, RECORDING, OR BY ANY INFORMATION STORAGE AND RETRIEVAL SYSTEM, WITHOUT THE WRITTEN PERMISSION OF CONTINENTAL BRIDGE SOLUTIONS, INC. </small>	REVISIONS DATE: _____ BY: _____	<p> CONTINENTAL BRIDGE SOLUTIONS, INC. 8301 S.W. Highway 28 N Alameda, Alaska 96538 907-855-5547 907-855-5520 907-855-7887 FAX </p>	<p> CONTINENTAL BRIDGE SOLUTIONS, INC. 180'-0" x 12'-0" MIAMI DADE PARKS & RECREATION KEYSTONE PEDESTRIAN BRIDGES MIAMI, FL </p>	Project Name: _____ Design: R/P Checked: CS Date: 10/8/09 Job No. PRELIM	Sheet: 1 of 2
	PRELIMINARY: NOT FOR CONSTRUCTION	Date: 10/8/09	Job No. PRELIM	Sheet: 1 of 2	

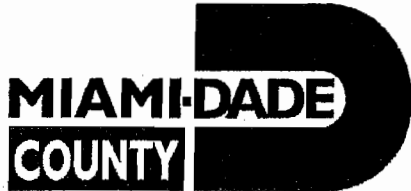

Cultural Affairs
111 NW 1st Street • Suite 625
Miami, FL 33128-1994
T 305-375-4634 F 305-375-3068
miamidadearts.org

Carlos Alvarez, Mayor

miamidade.gov

February 24, 2010

Jose-Luis Mesa, Director
Metropolitan Planning Organization
MPO Secretariat
111 NW 1 Street
Suite 920
Miami, FL 33128-1999

RE: Cultural Arts Center Bridge and Lighted Pedestrian Connection TEP

Dear Mr. Mesa,

Please accept this letter as an expression of my strong support of the Miami-Dade County Park and Recreation Department's application to the Metropolitan Planning Organization for funding from the Transportation Enhancement Program. The grant application requests funding for the design and construction of the Black Creek Trail Cultural Arts Center bridge and lighted pedestrian connection to SW 211 Street.

The Miami-Dade County Department of Cultural Affairs is currently completing construction and will be managing the South Miami-Dade Cultural Arts Center, a two-building complex containing a 966-seat, state-of-the-art theater and an activities building housing smaller performance, rehearsal, and classroom spaces. The Center will be located on more than six acres of county-owned land adjacent to the South Miami-Dade Government Center. As part of the design process, our architectural team, led by world-class firm Arquitectonica International, Inc. produced a master plan for the complex that provides connectivity with our neighbors: the South Miami-Dade Government Center to the east and the Southland Mall to the north. Through the treatment of the canal edge with landscaping and sidewalks, the plan also addresses the southern boundary, the Black Creek Canal, and creates a gentle sloping "green" space behind the buildings which will be used for outdoor concerts and festivals. The master plan contemplated the essential pedestrian connection across the canal to create access to the center from this adjoining neighborhood.

"Downtown" Cutler Bay is an area geographically bordered by the Black Creek Canal to the south, the Turnpike to the west, and US1 to the east. The Park and Recreation Department's proposed project for a pedestrian bridge will provide a direct connection to bike lanes along SW 211 Street and the existing 4.78 mile Black Creek Trail Segment A. It will provide a critical link between the trail, the new South Miami-Dade Cultural Arts Center, the existing South Dade Government Center complex which includes a library, courthouse, police station and government offices, and the Goulds community south of the Black Creek Canal. Support from the Metropolitan Planning Organization is critical to achieve this important connection between the civic facilities and the surrounding community, and once again, I urge your favorable review and approval of this grant application.

Sincerely,

A handwritten signature in black ink, appearing to read "Michael Spring", with a large, stylized flourish at the end.

Michael Spring
Director



Office of the Town Manager

Steven J. Alexander
Town Manager

February 22, 2010

Jose-Luis Mesa, Director
Metropolitan Planning Organization
MPO Secretariat
111 NW 1 Street, Suite 920
Miami, FL 33128-1999

RE: Cultural Arts Center Bridge and Lighted Pedestrian Connection TEP

Dear Mr. Mesa:

This letter is in support of the Miami-Dade County Park and Recreation Department's Transportation Enhancement Program application for the Black Creek Trail Cultural Arts Center Bridge and Lighted Pedestrian Connection to SW 211 St.

This project will have a direct connection to bike lanes along SW 211 St. and the existing 4.78 mile Black Creek Trail Segment A. It will provide a critical link to this trail as well as a non-motorized option to get to the new South Miami-Dade Cultural Arts Center and the existing South Dade Government Center complex which includes a library, courthouse, police station and government offices which are all within the Town of Cutler Bay's Town limits.

The Cultural Arts Center is conceived as a multidisciplinary arts center and cultural village that will attract up to 1,000 people at a time who will watch emerging artists, popular entertainers, community actors and smaller local groups.

We understand that the Miami-Dade County Park and Recreation Department is currently in Programming and Schematic Design phase for this project, but needs additional funding to design and construct a gateway and landmark facility that enhances travelers' experiences by offering scenic views of the canal and cultural center and appealing architectural elements.

We look forward to the completion of this project which will help provide an alternative means of transportation and enjoyment to the community. We urge the MPO to approve this application for funding for this important project.

Sincerely,

Steven J. Alexander
Town Manager



A RESOLUTION RECOMMENDING APPROVAL OF THE SOUTH DADE GREENWAY NETWORK PLAN FOR ADDITION IN THE FUNDED SECTION OF THE TRANSPORTATION IMPROVEMENT PROGRAM (TIP)

WHEREAS, the Metropolitan Planning Organization (MPO) has established the Citizens Transportation Advisory Committee (CTAC) to advise it on transportation related matters, and

WHEREAS, the Surface Transportation Subcommittee has heard a presentation on this proposal, and

WHEREAS, the Subcommittee recognizes that this is a worthwhile community project, providing a recreational opportunity and tourist attraction for the South Dade area.

WHEREAS, the Subcommittee recognizes that a project applying for TIP funding must compete with all other projects applying for TIP funding.

NOW, THEREFORE, BE IT RESOLVED BY THE CITIZENS TRANSPORTATION ADVISORY COMMITTEE OF THE METROPOLITAN PLANNING ORGANIZATION FOR THE MIAMI URBANIZED AREA:

SECTION 1. That the South Dade Greenway Network Plan is hereby recommended for approval in the funded section of the TIP.

The foregoing resolution was offered by Mac Glasgow, who moved its adoption. The motion was seconded by Leif Gunderson, and upon being put to vote the vote was as follows:

Rick Alayon	- aye	Don Hinson	- aye
Michael Barea	- aye	Keith Jennings	- absent
Victor Chapeton	- aye	Miles Moss	- excused
Dorothy Cissel	- absent	Maria Porrata	- absent
Angel Cortinas	- excused	Patrick Rebull	- aye
Xiomara Diaz	- aye	Stuart Schulman	- aye
Brunhilda Garcia	- aye	Leonard Sperraza	- aye
Jeff Gillman	- absent	Fred St. Amand	- absent
Mac Glasgow	- aye	Kathy Terry	- excused
Richard Gray	- excused	Calvin Zemsky	- excused
Leif Gunderson	- aye	Chairman Norman Wartman	- aye
David Haber	- aye		

The Chairman thereupon declared the resolution duly passed and adopted this 29th day of June, 1994.

CITIZENS TRANSPORTATION ADVISORY COMMITTEE
(CTAC)

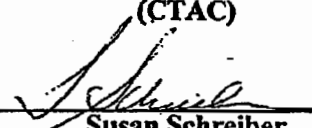
By 
Susan Schreiber
CTAC Secretariat

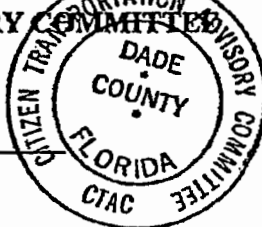

RESOLUTION NO. 94-50

A RESOLUTION OF THE CITY COMMISSION OF THE CITY OF FLORIDA CITY SUPPORTING THE CONCEPT OF THE SOUTH DADE GREENWAY NETWORK PLAN TO PROVIDE BICYCLE PATHS THROUGH SOUTH DADE COUNTY AND REQUESTING ALL GOVERNMENTAL AGENCIES TO SUPPORT AND HELP FINANCE THE SOUTH DADE GREENWAY NETWORK PLAN.

WHEREAS, the City Commission at its meeting of August 9, 1994 was presented with the South Dade Greenway Network Plan by its representatives and

WHEREAS, the City Commission of the City of Florida City approves of the concept of said plan,

NOW THEREFORE, BE IT RESOLVED BY THE MAYOR AND THE CITY COMMISSION OF THE CITY OF FLORIDA CITY, FLORIDA THAT:

1. The City of Florida City hereby approves the South Dade Greenway Network Plan, subject to restrictions, alterations, changes, and other requirements of the Staff of the City of Florida City for that portion of the South Dade Greenway Network Plan which runs through the City of Florida City.

2. The City of Florida City urges all governmental agencies to give their full support to the South Dade Greenway Network Plan.

PASSED and ADOPTED by the Mayor and City Commission of the City of Florida City, Florida this 23rd day of August, 1994.

Otis T. Wallace

Otis T. Wallace, Mayor

Attest:

Meighan J. Pier

Meighan J. Pier, City Clerk

STATE OF FLORIDA
COUNTY OF DADE

I, Meighan J. Pier, City Clerk

Of the City of Florida City, Florida do hereby certify that the above and foregoing is a true and correct copy of the original thereof on file in this office. WITNESS my hand and the seal of said City

This 9th day of Sept -A.D. 1994.

Meighan J. Pier

OCT-16-'94 SUN 16:09 ID:

TEL NO:

#368 P01



Kendall Federation of Homeowner Associations

Serving the Greater Kendall Community Since 1976

P.O. Box 160947

Miami, Florida 33176

October 14, 1994

To Whom It May Concern:

The Executive Board of the Kendall Federation Board of Directors discussed, resolved and passed the following resolution;

The Kendall Federation fully endorses and supports the proposed South Dade Greenway Network and feels this will be a substantial enhancement to the community.

The Kendall Federation congratulates the Redlands Conservancy for coordinating and designing this worthwhile project.

Sincerely,

A handwritten signature in cursive script that reads 'Dorothy J. Cissel'.

Dorothy J. Cissel, President KFHA
Executive Board of Directors KFHA



IN REPLY REFER TO:
L30

United States Department of the Interior

NATIONAL PARK SERVICE
Everglades National Park
and
Dry Tortugas National Park
40001 State Road 9336
Homestead, Florida 33034-6733

Ms. Kitty Roedel
Executive Director
The Redland Conservancy
PO Box 924684
Princeton, Fl 33902

Dear Ms. Roedel:

We are providing this letter in support of The Redland Conservancy's efforts to obtain funding for Phase I of the South Dade Greenway Network. This proposed Phase I demonstration project will link the Cutler Ridge trail with Biscayne National Park, Homestead Bayfront Park, and Everglades National Park through the Biscayne Wilderness and Everglades Trails. These trails will provide South Dade residents and visitors with a wonderful recreational opportunity and a unique way to see the wetland types characteristic of the Everglades ecosystem.

Everglades National Park looks forward to continuing to work with The Redland Conservancy and the National Park Service's Rivers, Trails, and Conservation Assistance Program on this exciting project.

Sincerely,

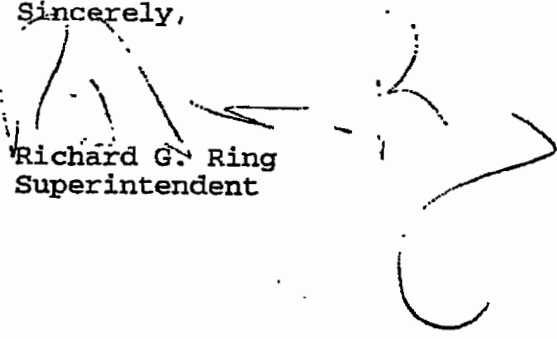
Richard G. Ring
Superintendent