

Memorandum



Date: January 23, 2017

To: Gary Hartfield, Division Director
Internal Services Department, Small Business Development

From: Milton L. Collins, Associate Director *M.L.C.*
Miami-Dade Aviation Department, Minority Affairs Division

Subject: Recommendation of Contract Measures
MIA - E FIS Renovations, 1st Level
Project No. MCC-T072-H

RECOMMENDATION:

This is a request for Small Business Development to proceed with the approval of the Recommendation of Contract Measures request for the **MIA – E FIS Renovations, 1st Level, Project No. MCC-T072-H**. MIA Staff have evaluated the subject project and recommends an **SBE-Construction Trade Set-Aside**.

The Term of this contract will be for one-hundred and ten days (110). The total suggested SBE/Construction participation for this project is 72% or \$1,540,000.00 of \$2,124,652.80. CWP does apply. Attached are MDAD's Services Description, CWP Breakdown and Contract Measures Analysis Worksheet findings and other supporting documents.

PROJECT SCOPE OF SERVICES:

MDAD is requesting that SBD review the following recommendation for SBE/Construction contract measures, in order for the MCC-8-10 Contractor to proceed on an emergency, rapid response basis to secure proposals and begin work by the 2nd week in February 2017. This work has become a safety, loss of revenue, and operational issue for the airport due to the increase in the number of international passengers that are delayed due to the lack of adequate capacity to process them. The area needs to be upgraded and remodeled in order to meet the demand of processing 2,000 to 4,000 passengers within a given hour, and by June 2017 international flights will increase significantly, thus creating a more hazardous congestion situation. In order to alleviate these congestions, the upgrade to the CBP facility is critical and must be performed immediately to avoid any further safety conditions and any further negative revenue impact in the operations of the airport.

The above renovation work will need to be done on an emergency basis whereby construction must begin the 2nd week of February 2017 in order to meet the June 2017 deadline. A site visit was conducted on January 12, 2017 by the general contractor with airport supervisor and project manager to identify the scope and to prepare a preliminary budget. Attached is a copy of the preliminary detailed scope of work for your reference.

The following trades have been identified and are being submitted for recommendation for SBE/Construction Trade Set-Aside measures:

- Package "A" Miscellaneous General Work
- Package "B" Painting
- Package "D" HVAC
- Package "E" Plumbing
- Package "F" Electrical

The suggested SBE/Construction subcontract items are listed on the Department Contract Measures Recommendation and Analysis form attached. This evaluation is based on the SBE/Construction Certification List as of January 18, 2017 from the Department of Small Business Development.

The MDAD Miscellaneous Construction Contract (MCC-8-10) requires that the General Contractor shall enter into subcontractor agreements to perform the work. Prior to the issuance of each Project Order Draft, or in the event of an emergency, as soon thereafter as practicable, per Ordinance 97-52, Miami Dade County will review each project for the establishment of contract measures relevant to Small Business Enterprise (SBE) Construction participation in the work to be performed, and will establish on each Project Order draft as it is transmitted to the Contractor.

Attachments

cc: L. Johnson, SBD
A. Calderin, MCM
V. Mirabal, MCM
C. DeLaHorra, Heery Int'l Inc.
R. Cabrera, MDAD
C. Corrales, MDAD
File

MDAD's CONTRACT MEASURES AND ANALYSIS WORKSHEET

To: Gary Hartfield, Division Director
Internal Services Department, Small Business Development

From: Milton L. Collins, Associate Director 
Miami-Dade Aviation Department
Minority Affairs Division

PROJECT/CONTRACT TITLE: MIA – E FIS Renovations, 1st level
PROJECT/CONTRACT NUMBER: MCC-T072-H
DEPARTMENT: Miami Dade Aviation Department
ESTIMATED PROJECT COST: 72% or \$1,540,000.00 of \$2,124,652.80
FUNDING SOURCE: Aviation Bonds

DESCRIPTION OF PROJECT/BID:

MDAD is requesting that SBD review the following recommendation for SBE/Construction contract measures, in order for the MCC-8-10 Contractor to proceed on an emergency, rapid response basis to secure proposals and begin work by the 2nd week in February 2017. This work has become a safety, loss of revenue, and operational issue for the airport due to the increase in the number of international passengers that are delayed due to the lack of adequate capacity to process them. The area needs to be upgraded and remodeled in order to meet the demand of processing 2,000 to 4,000 passengers within a given hour, and by June 2017 international flights will increase significantly, thus creating a more hazardous congestion situation. In order to alleviate these congestions, the upgrade to the CBP facility is critical and must be performed immediately to avoid any further safety conditions and any further negative revenue impact in the operations of the airport.

CONTRACT MEASURES RECOMMENDATION:

Measures: SBE-Construction Trade Set-Aside
Community Workforce Program (CWP) 10% Is Applicable (Breakdown Attached)

REASONS FOR RECOMMENDATION:

Analysis of the factors contained in Implementing Order #3-22 indicates that an SBE-Construction Trade Set-Aside is appropriate for this contract.

**DEPARTMENT CONTRACT MEASURES RECOMMENDATION AND ANALYSIS
CSBE**

To: Miton Collins - Associate Director
MDAD - Minority Affairs Division

From: Alberto Calderin MCC-8-10
General Manager/Munilla Construction Management,LLC (MCM) MCC

Project/Contract Title: MIA - E FIS Renovations, 1st Level

Contract Number: MCC - T072-H

Department: Aviation

Estimated Cost of Project/Bid: 2,124,652.80 *Funding Source:* Aviation Bonds

Description of Project/Bid: Renovations/remodeling of the CPB facility (E-FIS) to accommodate larger number of international passenders. Area to be completely upgraded.

Contract Measures Recommendations

Set aside Trade Set aside 1,540,000 Bid Preference

Goal 0% No Measures

Reasons for Recommendation

This is a reasonable contract measure, based on the availability of CSBE firms for the trades available on this project.

Analysis for Recommendation of a Goal

<u>Subtrade</u>	<u>Estimated Cost</u>	<u>% Of Item to Base Bid</u>	<u>SBE/Construction Availability</u>
Pkg. "A" Misc. General Work	980,000	46.1%	
Pkg. "B" Painting	35,000	1.6%	
Pkg. "D" HVAC	200,000	9.4%	
Pkg. "E" Plumbing	15,000	0.7%	
Pkg. "F" Electrical	310,000	14.6%	
Total	1,540,000	72%	
<i>Project cost</i>	1,640,000	input from bid line item	
<i>Allow. & Fee</i>	484,653	input from bid line item	
<i>Pre-Const. Svcs</i>	0	input from bid line item	
<i>Goal basis</i>	2,124,653		

E-FIS - Re-Opening Renovations - Phase 1
Implementation Plan

1/17/2017

Legend
 Scope by Area

Description	Construction			Notes	Reference
	FL1 - Existing Area	FL1 - Secondary Area	FL1 - Baggage Claim Area		
1ST LEVEL - BAGGAGE CLAIM AREA					
GENERAL REQUIREMENTS					
Clean and repair restrooms				By other	
Demolition of existing ceilings				By other	
Asbestos abatement				By other	
Extermination				By other	
SITE WORK					
Pressure Clean exterior tug drive area					
Scaffolding at escalators					
CONCRETE					
MASONRY					
METALS					
WOOD AND PLASTICS					
THERMAL AND MOISTURE PROTECTION					
DOORS AND WINDOWS					
Repair existing doors				By other	
New glass partitions bolted to floor around baggage claim area (Lavi Panels)					
New hardware for existing doors				By other	
FINISHES					
New 2x2 acoustical ceiling grid and tiles					
Repair, patch and paint existing walls					
Repair finishes at existing escalators					
Drywall repairs					
Patch and repair existing terrazzo flooring				By other	
Install new NEF walls				By other	
Patch and Paint MDAD Posting Room					
Paint exterior walls at tud drive area					
Provide and install rubber tile on carrousel					
SPECIALTIES					
Signage, wayfinding (incl. tug drive area)					Infrastructure by MCCB, LCD by MDAD IT, signs by MDAD Signage
FIDS/BIDS					Infrastructure by MCCB, LCD by MDAD IT, signs by MDAD Signage
Adjust data, telecommunication, CCTV and access control systems (incl. Posting Room)				By other	
WIFI				By other	
EQUIPMENT					
Computers at MDAD/Airline Counter				By other	
FURNISHING					
Millwork (MDAD/Airline Counter)				By other	
Repair Stainless Steel baseboards					
Furniture for Posting Room (supplied by service provider)				By other	
Install BIDS/LCD mounts				By other	
SPECIAL CONSTRUCTION					
Adjust fire protection / alarm system					
Flip sprinkler heads at exposed ceiling locations					
Modifications to the electrical system, wiring devices, branch wiring and power distribution system					
CONVEYING SYSTEMS					
Refurbishment of existing elevators and escalators				By other	
Refurbishment of three (3) existing Baggage Claim Units including conveyors modifications				By other	
MECHANICAL					
Modifications to the existing sprinklers					

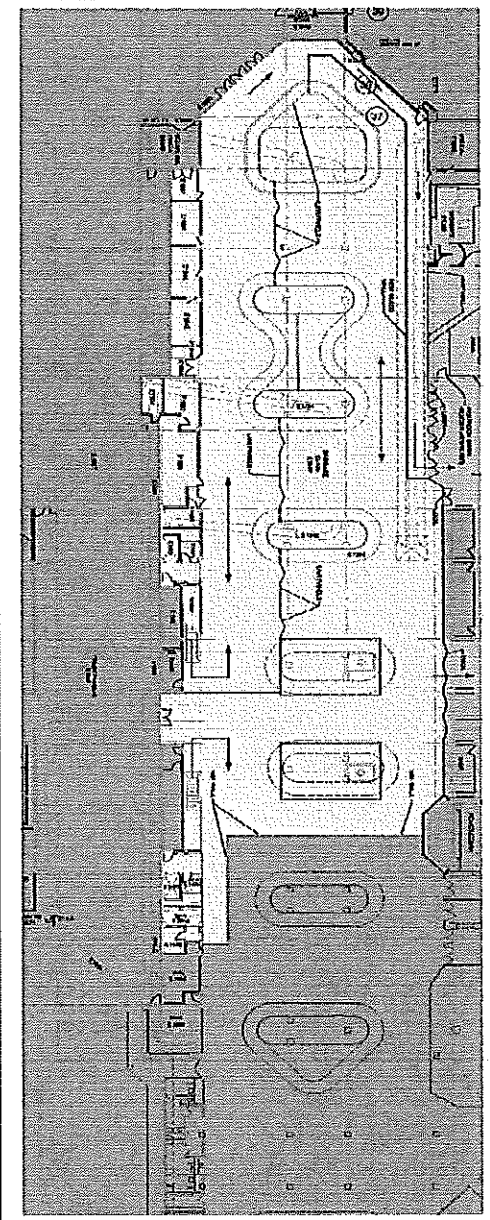

E-FIS - Re-Opening Renovations - Phase 1
Implementation Plan

1/17/2017

Legend
 Scope by Area

Description	Construction			Notes	Reference
	FL1 - Exiting Area	FL1 - Secondary Area	FL1 - Baggage Claim Area		
Modifications to the existing HVAC systems					
Cleaning of all existing HVAC systems					
ELECTRICAL					
Procure new LED light fixtures					
Replace existing light fixtures with new LED light fixtures					
PLUMBING					
Repair and Reroute existing piping					

E-FIS - Re-Opening Renovations - Phase 1
Implementation Plan

1/17/2017

Legend
Scope by Area

Description	Construction			Notes	Reference
	FL1 - Exiting Area	FL1 - Secondary Area	FL1 - Baggage Claim Area		
1ST LEVEL - SECONDARY AREA					
GENERAL REQUIREMENTS					
Clean and repair restrooms				By other	
Allowance for CBP upgrades					
Demolition of existing partitions and flooring				By other	
Asbestos abatement				By other	
Extermination				By other	
SITE WORK					
Demolition of existing CBP booths					
Remove debris from area					
CONCRETE					
MASONRY					
METALS					
Replace existing SS baseboards					
Polish existing SS column covers, wainscot and baseboards					
WOOD AND PLASTICS					
THERMAL AND MOISTURE PROTECTION					
DOORS AND WINDOWS					
New hardware for existing doors				By other	
Re-install Plexiglass window panel					
Install new door - metal framing to concrete deck					
Remove glass and SS panel for new access. Terminalon detail to be provided by MDAD					
FINISHES					
New ACT				By other	(ACT Tile) Secondary area by Cherokee
New acoustical ceiling grid and tiles in offices					(New Grid & Tile) Offices by MCC8
Replace ACT with SD or cameras (coordinate with Electrical contractor/Honeywell)					Offices and Secondary by MCC8 MDAD to coordinate camera removal and installation
Repair, patch and paint existing walls					
Painting window frames (Grey)					
New vinyl tile and baseboards					
Drywall repairs					
Drywall installation at abated areas (Offices & USDA)					Installation of drywall at Offices & USDA
Repair terrazzo flooring				By other	
Replace mirrors at restrooms					
Replace carpet in offices					
Replace ACT in offices. Adjust/Repair grid					
Painting walls (Airport White)					
SPECIALTIES					
Signage, wayfinding / BIDS					Infrastructure by MCC8, LCD by MDAD IT, signs by MDAD Signage
WIFI				By other	
EQUIPMENT					
Computers at Baggage Screening and CBP Offices				By other	
FURNISHING					
New millwork and furniture				By other	
New millwork (counter/sink) at breakroom					Millwork by MDAD, sink and faucet procurement & install by MCC8
New terminal seating				By other	
SPECIAL CONSTRUCTION					
Adjust data, telecommunication, CCTV and access control systems					
Provide and install Power Poles for desks					

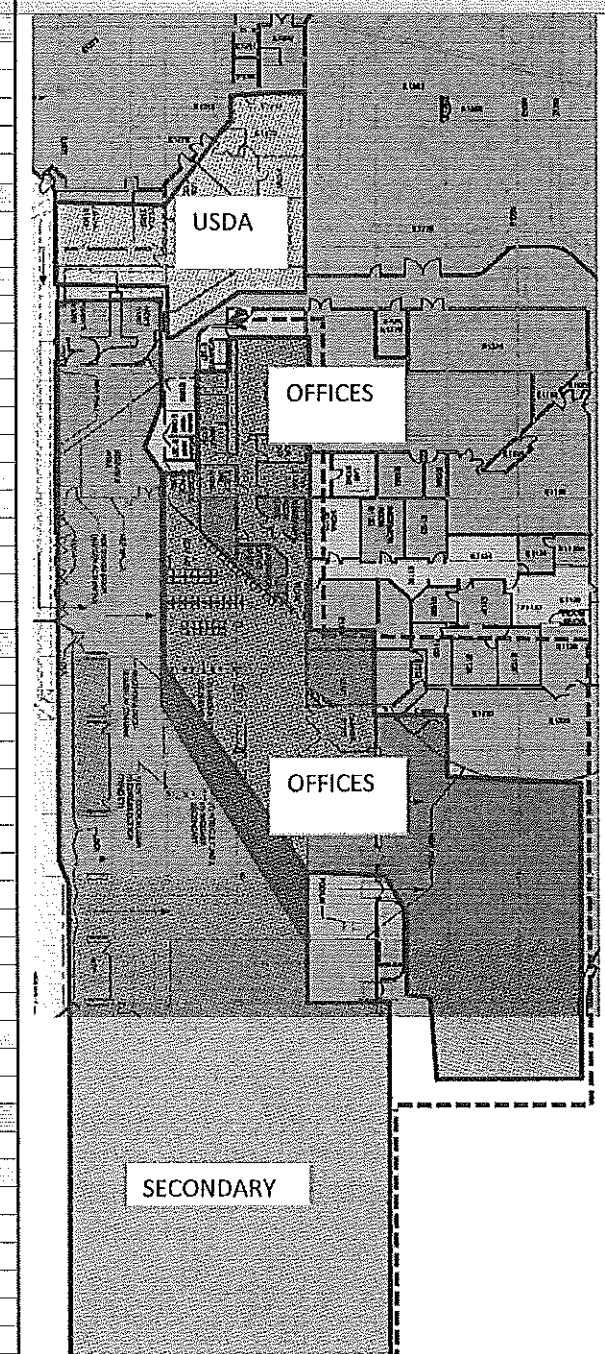

E-FIS - Re-Opening Renovations - Phase 1
Implementation Plan

1/17/2017

Legend
 Scope by Area

Description	Construction			Notes	Reference
	FL1 - Existing Area	FL1 - Secondary Area	FL1 - Baggage Claim Area		
CONVEYING SYSTEMS					
MECHANICAL					
Repairs to the existing sprinklers					
Flip sprinkler heads at exposed ceiling locations (USDA)				At abated USDA areas by MCC8	
Repairs and Modifications to the existing plumbing					
Cleaning of all existing HVAC systems					
ELECTRICAL					
Repair existing light fixtures					
Modifications to the electrical system, wiring devices, branch wiring and power distribution system					
Provide power and data in walls					
Replace damaged light bulbs					
PLUMBING					
Procure & Replace existing sink and faucet at breakroom			By other		

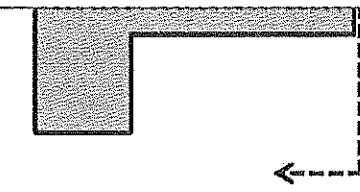

E-FIS - Re-Opening Renovations - Phase 1
Implementation Plan

1/17/2017

Legend
Scope by Area

Description	Construction			Notes	Reference
	FL1 - Exiting Area	FL1 - Secondary Area	FL1 - Baggage Claim Area		
1ST LEVEL - EXITING AREA					
GENERAL REQUIREMENTS					
Professional leanning existing area					
Allowance for CBP upgrades					
SITE WORK					
CONCRETE					
MASONRY					
METALS					
WOOD AND PLASTICS					
THERMAL AND MOISTURE PROTECTION					
DOORS AND WINDOWS					
Repair sllding glass doors					
FINISHES					
Repair of existing SS column covers and SS wainscot panels					
Repair and replace existing ACT - approximately 100% of the total ceiling area					
Replace ACT with SD or cameras (coordinate with Electrical contractor/Honeywell)				MDAD to coordinate camera removal and installation	
Replace ACT and grid at soffit near glass doors (Approx. 80 SF)					
Patch and paint existing walls and doors					
Polish existing SS column covers, wainscot panels and corner guards					
Painting soffits and exterior blue wall by La Carreta					
Patch and repair existing Terrazzo flooring					
SPECIALTIES					
Signage, wayfinding					
FIDS (millwork existing)					
WIFI					
EQUIPMENT					
FURNISHING					
SPECIAL CONSTRUCTION					
Adjust CCTV and access control system					
CONVEYING SYSTEMS					
MECHANICAL					
Clean HVAC ductwork and replace A/E diffusers					
ELECTRICAL					
Clean and re-adjust exisitng lighting fixtures					
Repair existing lighting fixtures by glass doors					

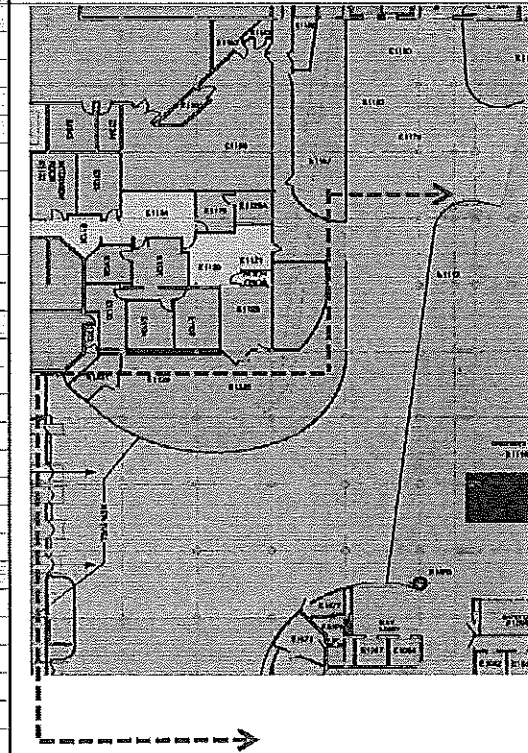

E-FIS - Re-Opening Renovations - Phase 1
Implementation Plan

1/17/2017

Legend
Scope by Area

Description	Construction			Notes	Reference
	FL1 - Exiting Area	FL1 - Secondary Area	FL1 - Baggage Claim Area		