



November 1, 2021

### RESPONSE LETTER NO. 3 TO REQUEST FOR INFORMATION

Project Title: **Roadway Improvements to NW 37th Avenue from NW 36th Street to NW 79th Street**

Project No.: **20210093 (Capital)**

**Email from Ms. Hamill Andrade , Ric-Man International, Inc.; dated October 19, 2021, at 3:59 PM. (attached)**

**QUESTION:** 21) Vol 4- PDF page 21 THRU 30 state: "...install temporary plug..." OR "...install temporary cap..." for WASD Sequence items 5 thru 66 resulting in a vast variety (42ea) of plug/cap installation work not provided by pay items. These consist of different sizes and unknown probable re-use depending on sequence variations, adjustments, and scheduling conflicts. Since the exact quantity is unobtainable currently, please provide a pay item for vast amount of work. Otherwise we would be forced to provide the full price value of all 42 caps/plugs. No savings for re-use.

**RESPONSE:** 21) Cost of temporary caps/plugs to be included as part of the price for furnish / installation of proposed water main.

**QUESTION:** 24) Vol 4- PDF page 37 States: "The Contractor further acknowledges that he has satisfied himself as to the character, quality, and quantity of surface and subsurface materials to be encountered from inspecting the site, making whatever site investigations he deems diligent or prudent, and from evaluating information derived from exploratory work that may have been done by the Department or included with these Contract Documents. Any failure by the Contractor to acquaint himself with all the available information will not relieve him from responsibility for properly estimating the difficulty or cost thereof under this Contract." Followed by "Prior to bidding and after written approval from the Department, bidder shall make his own investigations to satisfy himself with site conditions at his own cost." And also by "Prospective bidders are advised, at their own expense, to make such subsurface investigation, by boring or test hole excavation, as may be desirable. However, such work shall be scheduled by appointment with the Engineer if for a Department site or by notification to the Department and property permitted if in the public right of way." And finally on PDF page 39, Paragraph P; "Absolutely no extra compensation will be allowed for construction problems created by utility poles of whatever size, overhead electric, telephone or other lines whether shown on the Plans or not. The Contractor is solely responsible for discovering such items in the field prior to bidding and including all costs for such work in the prices bid. "Please provide permission to perform exploratory excavation throughout the project a minimum of 10 days prior to bid date to achieve and comply with the above requirements.

**RESPONSE:** 24) Please note that Geotechnical report has been performed and it's included as part of this Volume IV, Appendix R. Also, test holes were performed at several locations as part of the Design Phase of this project to confirm location/sizes of existing utilities. Test holes reports and Exhibit showing Test hole locations are being included under addendum No. 4. No permit can be provided to exploratory digging during the bidding process.

**QUESTION:** 26) Vol 4- PDF page 40 States: "The Department will furnish water at a charge for all construction activities unless otherwise specifically made exception..." Is there such an exception? Also, what is the cost of water for this project?

**RESPONSE:** 26) It is the Contractor's responsibility to verify cost of Water with MD-WASD and/or City of Hialeah. Refer to project Specs, section 4.01 Water used in Construction. Item C includes details about meter request process and payment with WASD – Utilities Development Division, located at 3575 South Lejune Road. Miami, FL 33133 , with phone number 786-268-5360. For City of Hialeah, Contractor shall reach out to Customer's service at 305-556-3800 and/ or visit City of Hialeah- Public Works Department at 3700 W 4th Avenue. Hialeah, FL 33012.

**QUESTION:** 32) Vol 4- PDF page 361 STATES; "In addition to the yearly crossing fees, We will require installation at each new crossing location a conduit of equal size, with two 1.25" innerducts, or a minimum of two 1.25" conduits, dedicated to FEC with terminating Quazite handholes equipped with EMS 1401 locators placed within the right of way. FEC handholes to be 24" below grade with EMS locators placed on top of handhole lid. Conduits to be extended 18" within handholes, and proofed to industry standards. A letter of completion with as-builts are to be provided to FEC upon final installation." We assume the County is handling this?

**RESPONSE:** 32) Please disregard answer provided on RFI No. 2 to this question. Correct answer is as follows: FEC Permit has been obtained and provided via addendum No. 3 for the proposed water main crossing by Microtunneling. Pay items related to Microtunneling installations are WS-1050-10-1316A, WS-1050-10-1316B & WS-1050-10-1316C. Yearly crossing fees are paid by WASD, which is the utility owner for the new Water Main.

**QUESTION:** 36) Vol 6- WASD SAN PLANS, PDF page 96 States: "C. Sewage Structures 1. Remove manhole frames and covers and any castings from the existing manholes, as shown on the Plans. Deliver these castings to the Department's storage yard." Which yard are these to be delivered to?

**RESPONSE:** 36) Once Construction phase starts, and if this service is required, Contractor shall follow up with assigned WASD's staff to request further information regarding their storage yards. MD-WASD yard location is



11800 SW 208 St. South Miami Heights, FL 33189. If removal and storage involve City of Hialeah, please note that their yard is located at 3700 W 4 Ave. Hialeah, FL 33012.

**QUESTION:** 43) Vol 7- WASD SAN PLANS, PDF page 6 of SANITARY PLANS, Item 6 States: "All pipe and fittings...must be color coded with blue paint..." Please clarify?

**RESPONSE:** 43) Please note that these plans are for the proposed Sanitary Sewer pipe, which must be color coded with green paint. Also, please note that as part of Volume VI, Sanitary Sewer Specs, page 19, item 25 specified that "green as the predominant color for sanitary sewage facilities". The blue color mentioned in page 6 of the pdf is a typo.

**QUESTION:** 44) Vol 7- WASD SAN PLANS, PDF page 31 Plan Sheet P-27 at Sta 29+20 +/- (plus in many other pages) States: "Prop. Sewer Pipe to be installed after removal of abandoned Gas Main." How many days before or after Notice to Proceed will this gas main be removed by Gas company?

**RESPONSE:** 44) Utility Coordination was performed as part of the proposed Water/Sewer projects since May 2019. As-builts from the Utility company were received on July 2019. Contractor is responsible to perform the work of removing abandoned Gas Main to be able to install proposed Sanitary Sewer. This activity (the removal of the abandoned gas line in conflict) will be paid as part of the installation of the proposed sewer line.

**END OF REQUEST FOR INFORMATION No. 3**

Sincerely,

Alfredo E. Muñoz, P.E.

Chief, Capital Improvements Division

Department of Transportation and Public Works (DTPW)

AM:kf

cc:

Katherine Fernandez, DTPW  
Roxana Bayarre, P.E., DTPW  
Rene Idarraga, P.E., DTPW  
Alejandro Barrios, DTPW

Fernando Mardones, DTPW  
Leandro Ona, P.E. DTPW  
Miguel Soria, P.E. DTPW  
Project File

Marcia Martin, ISD  
Jacqueline Fussell  
Jhonnatan Escalante ISD  
Clerk of the Board

## Fernandez, Katherine (DTPW)

---

**From:** Bayarre, Roxana (DTPW)  
**Sent:** Tuesday, October 19, 2021 4:14 PM  
**To:** Fernandez, Katherine (DTPW)  
**Subject:** FW: PROJECT NO.: 20210093 Roadway Improvements to NW 37th Avenue from NW 36th Street to NW 79th

Roxana Bayarre, P.E., Engineer 3  
**Capital Improvements Division**  
**Miami-Dade Transportation and Public Works Department**  
111 NW 1<sup>st</sup> Street, Suite 1410, Miami, FL 33128 – 1970  
305-375-3267 Phone 305-375-2931 Fax  
[www.miamidade.gov/pubworks](http://www.miamidade.gov/pubworks)  
for current solicitations information go to: <https://www8.miamidade.gov/Apps/ISD/DPMWW/SolicitationList.aspx>



Miami-Dade County is a public entity subject to Chapter 119 of the Florida Statutes concerning public records.  
E-mail messages are covered under such laws and thus subject to disclosure.

 Please consider your environmental responsibility before printing this e-mail

---

**From:** Hamill Andrade <hamilla@ric-man.us>  
**Sent:** Tuesday, October 19, 2021 3:59 PM  
**To:** Bayarre, Roxana (DTPW) <Roxana.Bayarre@miamidade.gov>; Carbonell, Patricia (DTPW) <Patricia.Carbonell@miamidade.gov>  
**Cc:** Andres Diaz <andresd@ric-man.us>; Andres, David (DTPW) <David.Andres@miamidade.gov>; Castro, Daniel (DTPW) <Daniel.Castro2@miamidade.gov>  
**Subject:** RE: PROJECT NO.: 20210093 Roadway Improvements to NW 37th Avenue from NW 36th Street to NW 79th

### EMAIL RECEIVED FROM EXTERNAL SOURCE

Below you will find question we have

### **VOLUME 1**

- 1) Vol 1- PDF page 31 **WS** Pay items ...0403 thru 1803 states; "Furnish and install Tapping Sleeve...( for various sizes), it does not state to furnish and install the tapping valves. Please clarify, is WASD providing the tapping valves?
- 2) Vol 1- PDF page 258 SBE recommendation states "...the following trades: Highway, Street and Bridge Construction (Concrete work) – 6.83% and Painting and Wall Covering Contractors (Traffic Stripes and Markings) – 1.06%. Please provide a detailed breakdown of these percentages.
- 3) Vol 1- PDF page 137 Permit fees? If the Contractor pays permit fees, please provide a list of permits we need to obtain and each of their values. Could the County consider adding an allowance?
- 4) Vol 1- PDF page 304 States: "2. Buy American: Contractor must comply with the requirements of Miami Dade County Code, Section 2- 8.2.6.1, Buy American Iron and Steel Products Procurement Program:

- a. The Buy American legislation requires that iron and steel products utilized in certain Miami-Dade County public improvement projects be produced in the United States.” Please clarify if this is a Buy American Project?
- 5) Vol 1- PDF page 309 - E States: “Right-of-Way Furnished by the Department 1. Except as otherwise stipulated in these Specifications or as shown in the Plans, the Department will furnish all rights-of-way necessary for the proper completion of the Work at no expense to Contractor.” Is there an exception to this stipulation?
- 6) Vol 1- PDF page 316 – C. States” Project Signs 2. The type, location, and number of signs required per each work site shall be at the discretion of Engineer.” Please provide the quantity of signs to be installed.
- 7) Vol 1- PDF page 322 States: “10. Contaminated Materials:
  - a. When the construction operations encounter or expose any abnormal condition that may indicate the presence of a contaminated material, discontinue such operations in the vicinity of the abnormal condition and notify Engineer immediately.” Please provide data on known contaminated sites.
- 8) Vol 1- PDF page 345 States: “16. Automated Flagger Assistance Devices (AFAD):
  - a. Furnish, install, maintain, remove and relocate AFADs in accordance with the Plans and FDOT Design Standards. “There is no pay item for this work, please provide a pay item, or an allowance, or details and quantities, or clarify if this is required.
- 9) Vol 1- PDF page 362 States: “LITTER REMOVAL AND MOWIN (REV. 11-25-2015)” Is this a requirement for this project? There is no pay item for it.

## **VOLUME II**

- 10) Vol 2- PDF page 13 Shows: “SUMMARY OF ASPHALT DRIVEWAYS”, but there is no pay item for asphalt driveways, please provide item
- 11) Vol 2- PDF Plan pages show many notes with: Exist. Utilities (Pole, F.H. FOC, M. WM, etc to be removed or relocated or placed out of service, by FPL or others. Will this be done prior to NTP or will coordination be required? If so what kind of control will the County apply to ensure this utility work will not affect progress causing delays?
- 12) Vol 2- PDF A variety of Plan pages show “ AS ABANDONED”, has the gas company certified that the mains have been confirmed “ABANDONED” to avoid onsite hazards during construction?
- 13) Vol 2- PDF page 32 Shows at Sta 126 86 “EXISTIN R R TRAC SYSTEM TO BE REMOVED BY CONTRACTOR”, please provide details on this removal, what are the vertical limits of removal, are materials to be disposed by the contractor? What is the NE to SW limits of removal, directly at the R W point?
- 14) Vol 2- PDF page 359 Shows Railroad Crossing Replacement,
  - a. there is no Pay Item for this work. Please provide under what item should these costs be provided.

- b. Please also clarify GENERAL NOTES on Vol 2 PDF page 358, specifically note 7 regarding 50' adjustment.
- c. What item is to be used for the widened shoulder pavement at the railroad and at what quantity? PDF Volume II Page 359

### VOLUME III

- 15) Vol 3- PDF page 10 states: "THE CONTRACTOR SHALL PAINT ALL STATIONS WITH STENCILED NUMBERS ON THE FACE OF CURB... C. WHERE CURB DOES NOT EXIST AND SHALL NOT BE CONSTRUCTED... THE CONTRACTOR SHALL MAINTAIN STATIONING WITH SURVEYING STAKES CONTRACTOR SHALL MAINTAIN THE STATION MARKS VISIBLE UNTIL FINAL INSPECTION". What type of stakes are these that last thru the life of the project?
- 16) Vol 3- PDF page 10 states: "THE CONTRACTOR SHALL BE RESPONSIBLE FOR OBTAINING THE DEWATERING PERMIT. COST OF THE PERMIT AND DEWATERING SHALL BE INCLUDED IN THE THE RELATED BID ITEM FOR THE WORK BEING DONE", Please remove this statement since there is an item for permits.
- 17) Vol 3- PDF page 10 Note 41 states: "EXISTING MANHOLES AND INLETS SCHEDULED TO REMAIN SHALL BE THOROUGHLY CLEANED BY REMOVING ALL DEBRIS AND SEDIMENTS, AND THE INTERIOR SHALL BE SEALED WITH AN APPROVED NON-TOXIC BITUMASTIC SEALANT." Please confirm this is indeed a requirement?

### VOLUME IV

- 18) Vol 4- PDF page 17 states: "The Contractor is advised that, if the work of this project includes work in the public right of way, that work may be shut down by the roadway governing authority during the period from the beginning of the Thanksgiving holiday through the end of the New Year holiday or some portion(s) of that period." What are the required shut down days for this project?
- 19) Vol 4- PDF page 18 states: "The Contractor is advised that, during the construction of the Project, the Construction Manager may require the Contractor to adjust the location of the proposed valves, fire hydrants and meter boxes from the locations shown on the Plans. This relocation(s) shall be performed at no additional cost to the Department.", Please clarify, what if such adjustments result in additional materials and efforts whereby we are unable to quantify and add such costs to bid now?
- 20) Vol 4- PDF page 20 states: "The Contractor is alerted to the fact that there are several areas within the Project limits where the existing tree canopies extend into the public right-of-way and cover the paved area. The cost of any tree pruning, arborist, permit or other work required by the agency having jurisdiction shall be the responsibility of the Contractor." Since there is no pay item for this work, please provide the quantity so sufficient cost can be added to bid.
- 21) Vol 4- PDF page 21 THRU 30 state: "...install temporary plug..." OR "...install temporary cap..." for WASD Sequence items 5 thru 66 resulting in a vast variety (42ea)



of plug cap installation work not provided by pay items. These consist of different sizes and unknown probable re-use depending on sequence variations, adjustments, and scheduling conflicts. Since the exact quantity is unobtainable currently, please provide a pay item for vast amount of work. Otherwise we would be forced to provide the full price value of all 42 caps plugs. No savings for re-use.

- 22) Both MD County and WASD require installation of provide signs, will there be two sets of signs foe each agency?
- 23) Vol 4- PDF page 33 States: “Where the project or part of the project is located in the City of Miami, in accordance with the City of Miami Code, a special paving bond is required by the City of Miami Public Works Department.” Is any part of this project in the City of Miami?
- 24) Vol 4- PDF page 37 States: “The Contractor further acknowledges that he has satisfied himself as to the character, quality, and quantity of surface and subsurface materials to be encountered from inspecting the site, making whatever site investigations he deems diligent or prudent, and from evaluating information derived from exploratory work that may have been done by the Department or included with these Contract Documents. Any failure by the Contractor to acquaint himself with all the available information will not relieve him from responsibility for properly estimating the difficulty or cost thereof under this Contract.” Followed by “Prior to bidding and after written approval from the Department, bidder shall make his own investigations to satisfy himself with site conditions at his own cost.” And also by “Prospective bidders are advised, at their own expense, to make such subsurface investigation, by boring or test hole excavation, as may be desirable. However, such work shall be scheduled by appointment with the Engineer if for a Department site or by notification to the Department and property permitted if in the public right of way.” And finally on PDF page 39, Paragraph P; “Absolutely no extra compensation will be allowed for construction problems created by utility poles of whatever size, overhead electric, telephone or other lines whether shown on the Plans or not. The Contractor is solely responsible for discovering such items in the field prior to bidding and including all costs for such work in the prices bid. “Please provide permission to perform exploratory excavation throughout the project a minimum of 10 days prior to bid date to achieve and comply with the above requirements.
- 25) Vol 4 pdf page 32- states: The Contractor, at its sole cost and expense, shall obtain and maintain in full force and effect during the term of the Agreement insurances as required by FEC FDOT-SFRTA. Permit approvals Right of Entries will not be granted until the contractor has provided the required insurance. Insurance requirements is included as part of Appendix N-Permits. What are the railroad insurance requirements, please provide Appendix N

- 26) Vol 4- PDF page 40 States: "The Department will furnish water at a charge for all construction activities unless otherwise specifically made exception..." Is there such an exception? Also what is the cost of water for this project?
- 27) Vol 4- PDF page 43 States: "Any salvable pipe, fitting, or other miscellaneous material or equipment, removed during construction and not reused in the work shall be cleaned, hauled to and stored by the Contractor at his expense, where directed by the Engineer, and shall remain the property of the Department. All other material and equipment shall be disposed of by the Contractor at his own expense." Please provide a list of materials salvageable on this Project.
- 28) Vol 4- PDF page 114 - , States: "Ductile iron pipe and fittings shall be encased in polyethylene encasement material, if required or as ordered by the Engineer..." Is the engineer requiring polyethylene encasement, so that cost can be added to bid instead of a future change order?
- 29) Vol 4- PDF page 164, 165, 166, 167 and 168 Items 45 thru 50, Water Services - Top paragraph, states: "... if required; salvage, cleaning, transport, unloading and storage of existing cast iron meter box lids to a Department storage yard as directed by the Engineer; ..." Is this required? Is the quantity the same and number of services?
- 30) The WASD Measurement and Payment Item Requirements:
- a. Volume IV from PDF pages 148 thru 176, items 1 thru 83 (8 ITEMS) do not match the MDC DTPW Volume 1 Bid Form on PDF pages 30 thru 38, items WS-1050-10-006 thru WS-1060-23-2840 (**1 1 ITEMS**). Please clarify. If WASD has 101 items why is there only 83 Item Requirements in WASD Volume IV?
  - b. We noticed WASD has 1 item 22 PDF page 153 for Casing Pipe under MDT, we did not notice this item in MDC DTPW Volume 1 Bid Form, please clarify.
- 31) Vol 4- PDF page 303 STATES; "44. ASBESTOS - Abatement Work - The abatement of asbestos containing material shall be performed by a Florida Licensed Asbestos Contractor. The asbestos abatement contractor must provide proof of license, employee worker certificates (medical, fit-test, training), site work action plan, company safety and respiratory protection plan, and an approved copy of the EPA - NESHAP Demolition and Renovation Notification Form prior to the Notice to Proceed." Is there any asbestos materials on this project, confirmation and quantity is needed so that we may include the above costs in the bid?
- 32) Vol 4- PDF page 361 STATES; "In addition to the yearly crossing fees, We will require installation at each new crossing location a conduit of equal size, with two 1.25" innerducts, or a minimum of two 1.25" conduits, dedicated to FEC with terminating uazite handholes equipped with EMS 1401 locators placed within the right of way. FEC handholes to be 24" below grade with EMS locators placed on top of handhole lid. Conduits to be extended 18" within handholes, and proofed to industry standards. A



letter of completion with as-builts are to be provided to FEC upon final installation.” We assume the County is handling this?

**VOLUME V**

- 33) Vol 5- WASH WM PLANS, PDF page 38 shows start of work at Sta 20 51 with a 12" tap, does the work at this location requires DOT full intersection restoration?

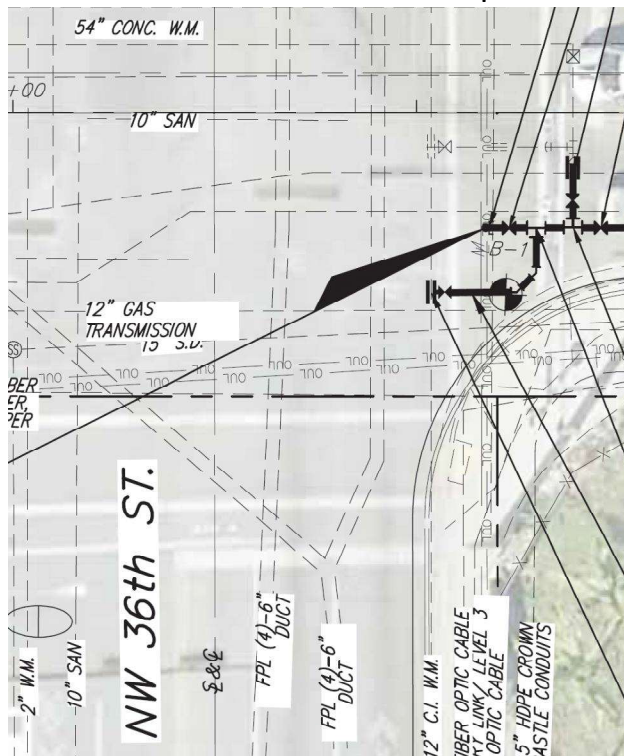

a.

## VOLUME VI

- 34) Vol 6- WASD SAN PLANS, PDF page 28 States: “44. Phase II of the proposed gravity sewer system includes sewer installation on the east side of NW 37 Ave and involves interconnections to existing manholes and proposed Pump Stations projects developed under different contracts. The certification and placement of lines into service will be subjected to certification final certification placement into service of Pump station projects. “ When will this proposed project be completed in comparison to the schedule for this project?
- 35) Vol 6- WASD SAN PLANS, PDF page 28 States: “3.02 PROJECT SIGN - A. - The County will supply signs for this Project. These signs will be produced, installed, and at the end of construction, removed by County forces. During the construction period, the Contractor shall maintain the signs in good condition, satisfactory to the Engineer. Should the signs be defaced, damaged or destroyed, the Contractor shall be responsible for their repair or replacement to the satisfaction of the Engineer and no extra compensation will be allowed.” Notes about project signs are specified in the County’s Road, Drainage, and WSAD Watermain, Sanitary Specs. Is it the intent to install 8 (eight) separate Project Signs (2 per construction type)?

- 36) Vol 6- WASD SAN PLANS, PDF page 96 States: “C. Sewage Structures 1. Remove manhole frames and covers and any castings from the existing manholes, as shown on the Plans. Deliver these castings to the Department s storage yard.” Which yard are these to be delivered to?
- 37) Vol 6- WASD SAN PLANS, PDF page 133 States: “Item No. 48 – Contingent Item For removal, transport and legal disposal of unsuitable backfill materials, including tipping fees, as ordered by the Engineer, will be paid for at the unit price bid times the number of cubic yards removed and legally disposed of, as measured by the truckload to the satisfaction of the Engineer.” Where is this item as well as the items in WASD s Measurement and Payment, Items list in MDC DTOW BID FORM?
- 38) Vol 6- WASD SAN PLANS, PDF page 143 UOTATION. Is this to be ignored? And only use the MDC BID FORM?  
The following 3 questions are from luis vidal conc prod of bp
- 39) - Indicate the casting required for the P-11 UTTER Inlets. Index 5F refers only to Driveway Curb Inlets.
- 40) Some J-11 inlets are located in the 2 valley gutters as well. Which casting will be required for these?
- 41) Which (9) inlets are considered SPECIAL INLETS? (Item 425-1-901C).
- 42) Item 102-3a Commercial Material for driveway maintenance the quantity is 40,500 CY and I believe it should be 40,500 CF.

## VOLUME VII

- 43) Vol 7- WASD SAN PLANS, PDF page 6 of SA ITA PLA S, Item 6 States: “All pipe and fittings...must be color coded with blue paint...” Please clarify?
- 44) Vol 7- WASD SAN PLANS, PDF page 31 Plan Sheet P-27 at Sta 29 20 - (plus in many other pages) States: “Prop. Sewer Pipe to be installed after removal of abandoned as Main.” How many days before or after Notice to Proceed will this gas main be removed by as company?
- 45) Vol 7- WASD SAN PLANS, PDF page 32 Plan Sheet P-28 at Sta 34 00 - at elevation (-) 2 - States: “Prop. 12” D.I. WM...” This main is being installed approximately 1 (one foot) below 10” PVC san. sewer, contrary to RDR-DERM eneral Notes on plan sheet P-02 PDF page 6, please clarify? Suggest the WM be designed over the san sewer.
- 46) Vol 7- WASD SAN PLANS, PDF page 50 Plan Sheet P-46 Note 7 states; “Regulatory speed...shall be 20 MPH...”, PDF page 51 bottom of page erroneously shows 30 MPH, please correct.
- 47) Testing of the drainage pipe was only found on Volume I, PDF page 286 where it directs you to DOT website link “o. Florida Department of Transportation Florida Sampling and Testing Methods”  
<http://www.fdot.gov/materials/administration/resources/library/publications/fstm/disc>

[laimer.shtmp. Florida Department of Transportation Flexible](http://laimer.shtmp.Florida Department of Transportation Flexible). that only provided this

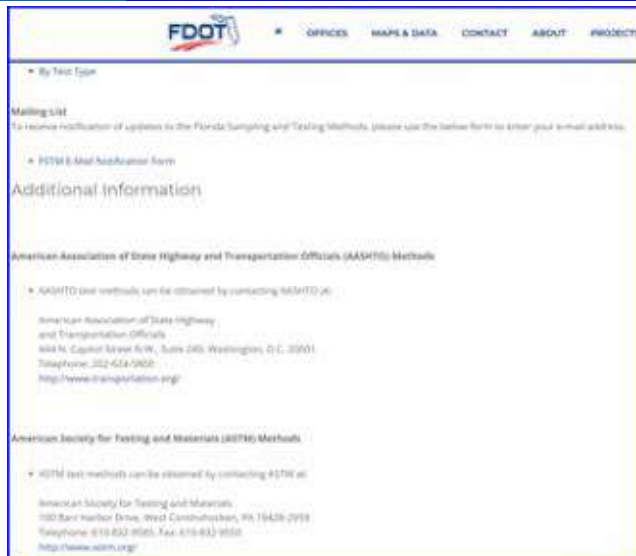

page. Can you please clarify the testing requirements for the drainage system?

48) Are all watermain related materials included in other bid items, if not, what are the pay limits of the Micro Tunnels?

**ADDE DUM 1 October 1 1**

- 49) Addendum 1 Page 2 of 5. "Pay item WS-1050-13-0712, For installing M.J. resilient seated gate valve (12"-13.9") complete with valve box, lid and riser pipe.", changed its quantity from 16 EA to 17 EA" is repeated twice.
- 50) W TER Plans ddendum No 1- Page P- added row pointing to an un-labeled pipe and bubble states Construct as per closure at side of intersection – standard detail . Not sure what this means Please clarif .

**Thank You,**  
**Ms. Hamill Andrade**  
**Ric-Man International, Inc**  
**New Address:**  
**1545 NW 27th Ave**  
**Pompano Beach, FL 33069**  
**Office: 954-426-1042**  
**Fax: 954-426-0717**  
**Email: [hamilla@ric-man.us](mailto:hamilla@ric-man.us)**



**North Miami Beach Office:**  
**1100 NE 163<sup>RD</sup> Street**  
**North Miami Beach, FL 33162**