

PLANS FOR PROPOSED
IMPROVEMENTS TO
OLD CUTLER ROAD AT 152 STREET AND AT SW 184 STREET

MIAMI-DADE COUNTY PROJECT NO. 20200119
ROADWAY IMPACT FEE (R.I.F.) 5

INDEX OF SHEETS

SHT. No.	SHEET DESCRIPTION
1	COVER SHEET
2A	SIGNATURE SHEET
2	TYPICAL SECTION
3	GENERAL NOTES
4	SUMMARY OF QUANTITIES
5	STORM WATER POLLUTION PREVENTION PLAN
6	INLET PROTECTION SYSTEMS DETAIL
7	SEDIMENT BARRIERS DETAIL
8-17	ROADWAY PLAN
18-20	SPECIAL DETAILS
21-30	ROADWAY PROFILE
31-32	GRADING PLAN
33-66	CROSS SECTIONS
67-70	MAINTENANCE OF TRAFFIC
71-81	SIGNING & PAVEMENT MARKING PLAN
82-84	SIGNALIZATION PLANS
85-94	UTILITY ADJUSTMENT SHEET
95-114	DRAINAGE STRUCTURES
115-116	TABULATION OF LIGHTING QUANTITIES
117	POLE DATA, LEGEND & GENERAL NOTES
118	POLE DATA
119-128	LIGHTING PLAN
129-130	DETAILS SHEET
131	LIGHT POLE DETAILS
132	CONDUIT BURIAL DETAILS
133-134	ELECTRICAL SERVICE DETAILS

SHT. No.	INDEX No.	SHEET DESCRIPTION
135	GSS-01	FDOT STANDARD SYMBOLS FOR KEY SHEET & PLAN SHEETS
136	110-100	FDOT TREE PROTECTION AND PRESERVATION
137	120-001	FDOT EMBANKMENT UTILIZATION
138-139	R12.3 - R12.5	ASPHALT DRIVEWAY
140-147	425-001	FDOT SUPPLEMENTARY DETAILS FOR DRAINAGE STRUCTURES
148-151	425-010	FDOT STRUCTURE BOTTOMS TYPE J AND P
152-154	425-020	FDOT CURB INLET TOP TYPES 1, 2, 3 AND 4
155-161	425-021	FDOT CURB INLET TOP TYPES 5 AND 6
162-165	425-052	FDOT DITCH BOTTOM INLET TYPE C, D, E AND H
166-167	425-080	FDOT UTILITY CONFLICT THRU DRAINAGE STRUCTURES
168-170	443-001	FDOT FRENCH DRAIN
171-172	443-002	FDOT SKIMMERS FOR FRENCH DRAIN OUTLETS
173-174	520-001	FDOT CURB AND GUTTER
175-178	522-001	FDOT CONCRETE SIDEWALK
177-180	522-002	FDOT DETECTABLE WARNINGS AND SIDEWALK CURB RAMPS
181-183	522-003	FDOT CONCRETE FLARED DRIVEWAYS

NOTE:

ATTENTION IS DIRECTED TO THE FACT THAT THESE PLANS MAY HAVE BEEN REDUCED IN SIZE BY REPRODUCTION. THIS MUST BE CONSIDERED WHEN OBTAINING SCALED DATA.

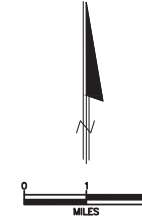
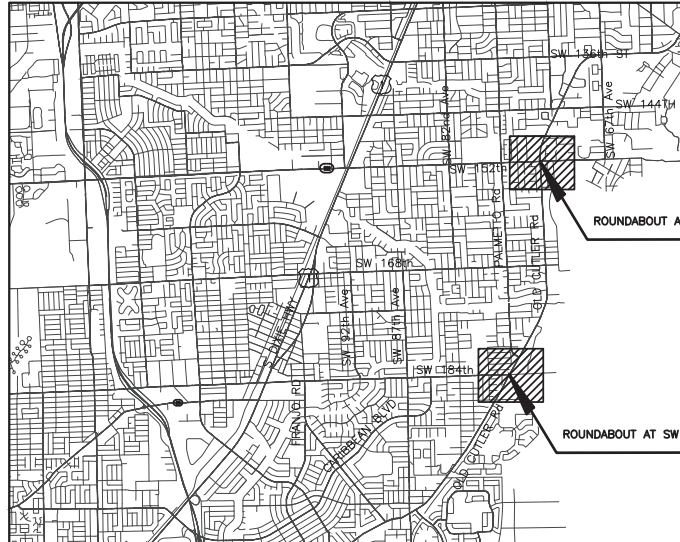

LENGTH OF JOB (SW 152 ST)		
	LIN. FT.	MILES
ROADWAY	2412	0.456
BRIDGE	--	--
GROSS LENGTH OF JOB	2412	0.456
EXCEPTIONS	--	--
NET LENGTH OF JOB	2412	0.456

LENGTH OF JOB (SW 184 ST)		
	LIN. FT.	MILES
ROADWAY	2363	0.447
BRIDGE	--	--
GROSS LENGTH OF JOB	2363	0.447
EXCEPTIONS	--	--
NET LENGTH OF JOB	2363	0.447

PREPARED FOR



MIAMI-DADE COUNTY
DEPARTMENT OF TRANSPORTATION AND PUBLIC WORKS
HIGHWAY DIVISION

STEPHEN P. CLARK CENTER
111 NW 1 ST
MIAMI, FLORIDA 33128

BY
MARLIN
ENGINEERING

3363 W. COMMERCIAL Blvd, Ste. 115 | FT Lauderdale, FL 33309
P: 954.870.5070 | CA. No. 6104

REVISIONS
SHEETS 1, 2-4, 8-11, 14, 91, 115-134 (REVISED 03-23-2022)
SHEET 2A (ADDED 03-23-2022)

KEY SHEET REVISIONS	
DATE	DESCRIPTION
03-23-2022	AF INDEX OF SHEETS REVISED LISTED REVISIONS

APPROVED	_____ COUNTY ENGINEER
RECOMMENDED	_____ ASSISTANT DIRECTOR
SUBMITTED	_____ HIGHWAY DIVISION
PROPOSED	CHECK _____
DESIGN	DRAWN _____
DATE _____	SHEET 1 OF 183

Always call 811 two full business days before you dig



THESE PLANS HAVE BEEN PREPARED IN ACCORDANCE WITH AND ARE COVERED BY THE MIAMI-DADE COUNTY PUBLIC WORKS DEPARTMENT STANDARDS AND SPECIFICATIONS PARTS 1, 2 AND 3, THE MANUAL OF UNIFORM MINIMUM STANDARDS FOR DESIGN, CONSTRUCTION AND MAINTENANCE FOR STREETS AND HIGHWAYS, THE FLORIDA DEPARTMENT OF TRANSPORTATION FY 2021-22 STANDARD PLANS FOR ROAD AND BRIDGE CONSTRUCTION, AND THE FLORIDA DEPARTMENT OF TRANSPORTATION JULY 2021 STANDARD SPECIFICATIONS eBOOK, AS AMENDED BY CONTRACT DOCUMENTS.

REVISED PLANS FOR ADDENDUM No. 2

MIAMI-DADE COUNTY DEPARTMENT OF TRANSPORTATION AND PUBLIC WORKS
HIGHWAY DIVISION
OLD CUTLER RD. ROUNDABOUTS AT SW 152 ST & SW 184 ST
PROJECT NO. 20220119 SHEET 2A OF 183

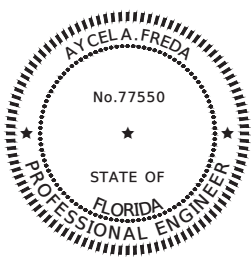

THIS ITEM HAS BEEN DIGITALLY
SIGNED AND SEALED BY

Aycel A Freda Digitally signed by Aycel A Freda
Date: 2022.03.24 12:31:11 -04'00'

ON THE DATE ADJACENT TO THE SEAL

PRINTED COPIES OF THIS DOCUMENT ARE
NOT CONSIDERED SIGNED AND SEALED
AND THE SIGNATURE MUST BE VERIFIED
ON ANY ELECTRONIC COPIES.

MARLING ENGINEERING
3363 W. COMMERCIAL Blvd - SUITE 115
FT LAUDERDALE, FL - 33309
CERTIFICATE OF AUTHORIZATION 00006104
AYCEL A. FREDA, P.E. NO. 77550

THE ABOVE NAMED PROFESSIONAL ENGINEER SHALL BE RESPONSIBLE FOR THE
FOLLOWING SHEETS IN ACCORDANCE WITH RULE 61G15-23.004, F.A.C.

INDEX OF DRAWINGS

SHT. No.	SHEET DESCRIPTION
1	COVER SHEET
2A	SIGNATURE SHEET
2	TYPICAL SECTION
3	GENERAL NOTES
4	SUMMARY OF QUANTITIES
5	STORM WATER POLLUTION PREVENTION PLAN
6	INLET PROTECTION SYSTEMS DETAIL
7	SEDIMENT BARRIERS DETAIL
8-17	ROADWAY PLAN
18-20	SPECIAL DETAILS
21-30	ROADWAY PROFILE
31-32	GRADING PLAN
33-66	CROSS SECTIONS
67-70	MAINTENANCE OF TRAFFIC
71-81	SIGNING & PAVEMENT MARKING PLAN
82-84	SIGNALIZATION PLANS
85-94	UTILITY ADJUSTMENT SHEET
95-114	DRAINAGE STRUCTURES

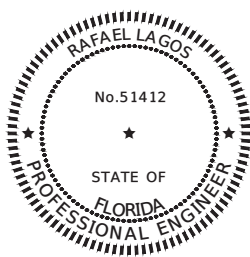

THIS ITEM HAS BEEN DIGITALLY
SIGNED AND SEALED BY

RAFAEL A LAGOS Date: 2022.03.24
12:34:18 -04'00'

ON THE DATE ADJACENT TO THE SEAL

PRINTED COPIES OF THIS DOCUMENT ARE
NOT CONSIDERED SIGNED AND SEALED
AND THE SIGNATURE MUST BE VERIFIED
ON ANY ELECTRONIC COPIES.

MARLING ENGINEERING
3363 W. COMMERCIAL Blvd - SUITE 115
FT LAUDERDALE, FL - 33309
CERTIFICATE OF AUTHORIZATION 00006104
RAFAEL LAGOS, P.E. NO. 51412

THE ABOVE NAMED PROFESSIONAL ENGINEER SHALL BE RESPONSIBLE FOR THE
FOLLOWING SHEETS IN ACCORDANCE WITH RULE 61G15-23.004, F.A.C.

INDEX OF DRAWINGS

SHT. No.	SHEET DESCRIPTION
2A	SIGNATURE SHEET
115-116	TABULATION OF LIGHTING QUANTITIES
117	POLE DATA, LEGEND & GENERAL NOTES
118	POLE DATA
119-128	LIGHTING PLAN
129-130	DETAILS SHEET
131	LIGHT POLE DETAILS
132	CONDUIT BURIAL DETAILS
133-134	ELECTRICAL SERVICE DETAILS

K:\DESIGN\20220119\000_EBP_0720200119\001_Cutler Rd Roundabout\001\001\2022-10-19-001_Cutler Rd Roundabout\001\001\2022-10-19-001_Cutler Rd Roundabout\SW 184 ST\SW184 ROUNDABOUT SHEET - REVISED MAR 24, 2022 - 11:50am - J.FEBER



REVISIONS

DATE	BY	DESCRIPTION	DATE	BY	DESCRIPTION
3-23-22	AF	ADDED SHEET			

MARLIN
ENGINEERING
AYCEL ABRIN FREDA | P.E. No.: 77550
3363 W. COMMERCIAL Blvd, Ste. 115 | Ft. Lauderdale, FL 33309
P: 954.870.5070 | C.A. No. 6104

DESIGNED BY	NAME	DATE	DRAWN BY	NAME	DATE
DESIGNED BY	R.L.		DRAWN BY	M.P.	
CHECKED BY	A.F.		CHECKED BY	A.F.	

MIAMI-DADE COUNTY DEPARTMENT OF TRANSPORTATION AND PUBLIC WORKS HIGHWAY DIVISION
STEPHEN P. CLARK, CENTER FOR THE STATE OF FLORIDA 33108

SIGNATURE SHEET

REVISED PLANS FOR ADDENDUM No. 2

MIAMI-DADE COUNTY DEPARTMENT OF TRANSPORTATION AND PUBLIC WORKS
HIGHWAY DIVISION
OLD CUTLER RD. ROUNDABOUTS AT SW 152 ST & SW 184 ST
PROJECT NO. 20200119 SHEET 2 OF 183

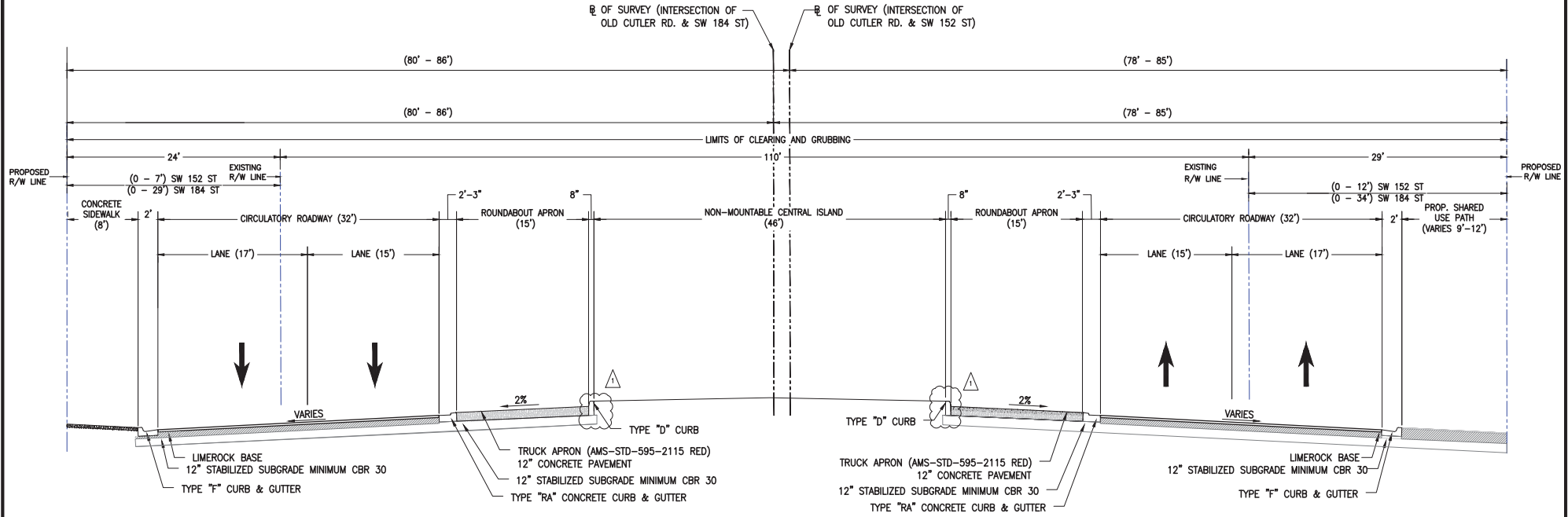

- TYPICAL SECTION NOTES:**
- ALL EXISTING LIMEROCK BASE THAT IS REMOVED IS TO BE INCORPORATED INTO THE STABILIZED PORTION OF THE SUBGRADE AND IS NOT TO BE USED IN CONSTRUCTION OF THE PROPOSED BASE.
 - EXTEND LIMEROCK BASE (8" THICK) 6" OUTSIDE EDGES OF PAVEMENT AT ALL CONNECTIONS AND INTERSECTIONS TO COUNTY STREETS AND ROADS.
 - STABILIZED ALL TURNOUTS AND INTERSECTIONS TO COUNTY ROADS AND STREETS TO A DEPTH OF 12" (MIN CBR OF 30) AND 12" OUTSIDE EDGES OF PAVEMENT, 6" BACK OF CURB.
 - DROP CURB AND DRIVEWAY CONNECTIONS SHALL BE PROVIDED FOR ACCESS TO ALL PRIVATE PROPERTIES ADJACENT TO THE PROJECT CONSTRUCTION. FINAL LOCATION OF DRIVEWAYS ACCESS TO BE DETERMINED BY THE ENGINEER.
 - COST OF LIMEROCK BASE BENEATH CURB AND GUTTER TYPE F AND TYPE E IS TO BE INCLUDED UNDER THEIR RESPECTIVE PAY ITEMS.

WIDENING/ RECONSTRUCTION
LIMEROCK BASE (8" THICK) PRIMED WITH HMA, TRAFFIC C, SP-12.5 (2")
HMA, FRICTION COURSE, TRAFFIC C, FC-9.5 (1")

MILLING & RESURFACING
MILL EXISTING ASPHALT PAVEMENT (1" AVERAGE DEPTH)
RESURFACE, FRICTION COURSE, TRAFFIC C, FC-9.5 (1")

SHARED USE PATH (SUP)
12" STABILIZED SUBGRADE MIN. CBR 30
LIMEROCK BASE (4" THICK) PRIMED WITH HMA, TRAFFIC A, SP-9.5 (1.5")

TURNOUT
LIMEROCK BASE (6" THICK) PRIMED WITH HMA, TRAFFIC A, SP-9.5 (1")

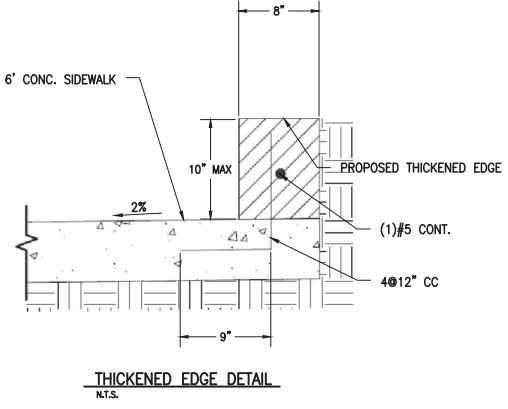
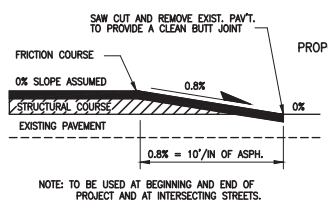

TYPICAL SECTION
INTERSECTION OF OLD CUTLER RD. AT SW 152 ST AND AT SW 184 (EUREKA DR.)

SPEED DESIGN 30 MPH

K:\2020\20200119\Old Cutler Rd Roundabout\ADD\2020-12-18-19- Old Cutler Roundabout\SW 184 ST\SW184 TYPICAL SECTION - REVISED MAR 24, 2022 - 11:08am - JFB/ER

REVISIONS					
DATE	BY	DESCRIPTION	DATE	BY	DESCRIPTION
3-23-22	AF	NOTE UPDATED CURB DETAIL MODIFIED			

MARLIN ENGINEERING
ANGEL ABRIL FREDA | P.E. No.: 77550
3363 W. COMMERCIAL BLVD. SUITE 113 | FT. LAUDERDALE, FL 33309
P: 954.870.5070 | C.A. No. 6104

DESIGNED BY	NAME	DATE	DRAWN BY	NAME	DATE
RL			M.P.		
ORDERED BY	A.F.		CHECKED BY	A.F.	
SUPERVISED BY:					

MIAMI-DADE COUNTY DEPARTMENT OF TRANSPORTATION AND PUBLIC WORKS
HIGHWAY DIVISION
STEPHEN P. CLARK, CHIEF ENGINEER
100 N.W. 1ST AVENUE
MIAMI, FLORIDA 33138

TYPICAL SECTION

REVISED PLANS FOR ADDENDUM No. 2

MIAMI-DADE COUNTY DEPARTMENT OF TRANSPORTATION AND PUBLIC WORKS
HIGHWAY DIVISION
OLD CUTLER RD. ROUNDABOUTS AT SW 152 ST & SW 184 ST
PROJECT NO. 20200119 SHEET 3 OF 183

GENERAL NOTES

1. B.M. DATA IS NATIONAL GEODETIC VERTICAL DATUM OF 1929 (N.G.V.D.-29).
2. ANY N.G.V.D. BENCH MARK MONUMENTS WITHIN THE LIMITS OF CONSTRUCTION IS TO BE PROTECTED AND PROPERLY REFERENCED BY A REGISTERED-LAND SURVEYOR IN ACCORDANCE WITH THE MINIMUM TECHNICAL STANDARDS OF THE FLORIDA BOARD OF PROFESSIONAL LAND SURVEYORS PRIOR TO BEGINNING WORK AT THE SITE. IF ANY MONUMENT IS IN DANGER OF DAMAGE, THE PROJECT ENGINEER SHALL NOTIFY THE BUREAU OF SURVEYING A MAPPING, FLORIDA DIVISION OF STATE LANDS, 3900 COMMERCIAL BLVD., MAIL STATION 100, TALLAHASSEE, FLORIDA 32399-3000 TELEPHONE (850) 245-2118.
3. ALL PUBLIC LAND CORNERS AND MONUMENTS WITHIN THE LIMITS OF CONSTRUCTION ARE TO BE PROTECTED BY THE CONTRACTOR AS FOLLOWS: CORNERS AND MONUMENTS IN CONFLICT WITH THE WORK AND IN DANGER OF BEING DAMAGED, DESTROYED, OR COVERED SHALL BE PROPERLY REFERENCED BY A REGISTERED-LAND SURVEYOR IN ACCORDANCE WITH THE MINIMUM TECHNICAL STANDARDS OF THE FLORIDA BOARD OF PROFESSIONAL LAND SURVEYORS PRIOR TO BEGINNING WORK AT THE SITE. THE CONTRACTOR SHALL RETAIN THE LAND SURVEYOR TO REFERENCE, AND RESTORE UPON COMPLETION OF THE WORK, ALL SUCH CORNERS AND MONUMENTS AND SHALL FURNISH TO MIAMI-DADE COUNTY PUBLIC WORKS DEPARTMENT A SIGNED AND SEALED COPY OF THE LAND SURVEYOR'S REFERENCE DRAWING.
4. ALL STATIONS AND OFFSETS REFER TO BASELINE OF SURVEY, UNLESS OTHERWISE STATED.
5. ALL GRADES SHOWN IN PLAN ARE FINISHED GRADES.
6. THE CONTRACTOR SHALL PAINT ALL STATIONS WITH STENCILED NUMBERS ON THE FACE OF CURB:
 - A. FROM THE BEGINNING OF THE PROJECT WHERE THE CURB IS TO REMAIN.
 - B. AT NEW CURB NOT LATER THAN 72 HOURS AFTER BEING POURED.
 - C. WHERE CURB DOES NOT EXIST AND SHALL NOT BE CONSTRUCTED.
 THE CONTRACTOR SHALL MAINTAIN STATIONING WITH SURVEYING STAKES. THE CONTRACTOR SHALL MAINTAIN THE STATION MARKS VISIBLE UNTIL FINAL INSPECTION.
7. ALL CONSTRUCTION SHALL BE IN STRICT ACCORDANCE WITH THE REQUIREMENTS OF THE MIAMI-DADE COUNTY PUBLIC WORKS DEPARTMENT, AND ANY OTHER STATE OR LOCAL AGENCY WITH JURISDICTION. IT IS THE INTENT OF THESE PLANS TO BE IN ACCORDANCE WITH APPLICABLE CODES AND AUTHORITIES HAVING JURISDICTION. ANY DISCREPANCIES BETWEEN THESE PLANS AND APPLICABLE CODES SHALL BE IMMEDIATELY BROUGHT TO THE ATTENTION OF THE ENGINEER.
8. CONTRACTOR SHALL COMPLY WITH THE REQUIREMENTS OF THE EPA AND THE NATIONAL POLLUTION DISCHARGE ELIMINATION SYSTEM (NPDES).
9. THE LOCATION AND SIZE OF THE UTILITIES SHOWN IN THE PLANS ARE BASED ON THE BEST AVAILABLE INFORMATION AND SHOULD BE CONSIDERED APPROXIMATE ONLY. NEITHER UTILITY DESIGNATES OR UTILITY LOCATES (U/Ls) WHERE AVAILABLE DURING THE DESIGN PHASE. ADDITIONAL UTILITIES MAY EXIST WHICH ARE NOT SHOWN ON THESE DRAWINGS. THE CONTRACTOR SHALL VERIFY ALL UTILITIES BY ELECTRICAL METHODS AND BY PRE-TRENCHING IN COORDINATION WITH ALL UTILITY COMPANIES PRIOR TO BEGINNING ANY CONSTRUCTION AND ALL LOCATIONS OF EXISTING UTILITIES WITH PROPOSED IMPROVEMENTS MUST BE RESOLVED BY THE CONTRACTOR AND THE UTILITY OWNER WITH THE APPROVAL OF THE ENGINEER. THE WORK BY THE CONTRACTOR SHALL BE CONSIDERED INCIDENTAL TO THE CONTRACT AND NO ADDITIONAL COMPENSATION SHALL BE ALLOWED.

ANY MODIFICATIONS TO PROPOSED DRAINAGE STRUCTURES, AND/OR ADJUSTMENT TO LOCATION OF DRAINAGE STRUCTURES/LIGHT POLES ARE THE RESPONSIBILITY OF THE CONTRACTOR AND SHALL BE SUBMITTED TO THE ENGINEER FOR APPROVAL.
10. BASELINE CONTROL SURVEY CONDUCTED BY MIAMI-DADE COUNTY. PLEASE CALL JEFFREY D. WHITMORE AT (305)-375-2657 CONCERNING SURVEY RELATED QUESTIONS.
11. EXISTING TOPOGRAPHIC INFORMATION WAS OBTAINED FROM SURVEY PREPARED BY MIAMI-DADE COUNTY.
12. CONTRACTOR SHALL CONTACT SUNSHINE STATE ONE-CALL AT 1-(800)-432-4770 AT LEAST 48 HOURS PRIOR TO PERFORMING ANY DIGGING TO VERIFY THE EXACT LOCATION OF EXISTING UTILITIES. A CONTRACTOR'S REPRESENTATIVE MUST BE PRESENT WHEN UTILITY COMPANIES LOCATE THEIR FACILITIES.
13. THE CONTRACTOR IS TO USE CAUTION WHEN WORKING IN OR AROUND AREAS OF OVERHEAD AND UNDERGROUND UTILITIES.
14. MIAMI-DADE WATER AND SEWER DEPARTMENT REQUIRES THAT ACCESS TO ALL WATER AND SEWER VALVES, SANITARY MANHOLES, AND OTHER CONTROL MECHANISMS BE MAINTAINED THROUGHOUT CONSTRUCTION IN THE EVENT OF AN EMERGENCY TO ENSURE THE PUBLIC HEALTH AND SAFETY. COVERING VALVE BOXES AND MANHOLES CAN BE CONSIDERED UNAUTHORIZED OBSTRUCTION OF AND TAMPERING WITH DEPARTMENT UTILITIES. ALL REQUESTS FOR UTILITY ADJUSTMENTS MUST BE MADE IN WRITING AT LEAST TWO (2) WEEKS IN ADVANCE. FOR MANHOLE AND VALVES, CONTACT THE CONSTRUCTION MANAGEMENT SECTION, PUMP STATIONS UNIT, 3071 SW 38 AVENUE, FAX NO. 305-469-3626. THE DEPARTMENT WILL MAKE ONE FINAL AND PERMANENT ADJUSTMENT AT NO COST TO THE REQUESTING AGENCY. FOR THE ADJUSTMENT OF WATER METERS, CONTACT THE CHIEF OF METER OPERATIONS AND MAINTENANCE, FAX NO. 305-545-3482. FOR ANY FIRE HYDRANTS THAT ARE DAMAGED OR BUMPED DURING CONSTRUCTION, CONTACT THE MIDWAY HYDRANT SHOP AT 305-805-4575 BEFORE POURING CONCRETE FOR THE SIDEWALK. IN THE EVENT OF A WATER OR SEWER EMERGENCY, CONTACT MIAMI DADE WATER AND SEWER DEPARTMENT AT 305-274-9272. THIS LINE IS OPEN 24 HOURS, 7 DAYS A WEEK.
15. KNOWN UTILITY COMPANIES IN THE PROJECT LIMITS INCLUDE, BUT ARE NOT LIMITED TO:

FR&L	JOHN GERALDO	(305) 442-5172
FLORIDA CITY GAS	GUSTAVO PEÑA	(305) 835-3603
MIAMI-DADE WSD	PATRICK CHONG	(786) 552-4416
AT&T	STEVE MASSIE	(305) 222-8754
COMCAST	LEONARD MAXWELL	(800) 778-9140
MCI	ANTHONY KOWALESKI	(469) 886-0346
CROWN CASTLE	NICK BELINSKY	(724) 416-2449
16. THE CONTRACTOR IS ADVISED THAT PROPERTIES ADJACENT TO THE PROJECT HAVE ELECTRIC, TELEPHONE, GAS, WATER, AND/OR SEWER SERVICE LATERALS WHICH MAY NOT BE SHOWN IN PLANS. THE CONTRACTOR MUST REQUEST THE LOCATION OF THESE LATERAL SERVICES FROM THE UTILITY COMPANIES. THE ADDITIONAL COST OF EXCAVATING, INSTALLING, BACKFILLING, AND COMPACTING AROUND THESE LATERAL SERVICES MUST BE INCLUDED IN THE BID RELATED ITEM FOR THE WORK BEING DONE.
17. THE CONTRACTOR MUST MAINTAIN CLEARANCES AS REQUIRED BY OSHA WHILE WORKING IN THE PROXIMITY OF FPL'S HIGH-VOLTAGE TRANSMISSION CONDUCTORS AND LOW VOLTAGE DISTRIBUTION CONDUCTORS.
18. THE ROADWAY CONTRACTOR MUST MAINTAIN ACCESS TO ALL PFL FACILITIES AT ALL TIMES DURING HIS CONSTRUCTION.
19. ALL EXISTING FACILITIES MUST REMAIN ENERGIZED DURING ROAD CONSTRUCTION.
20. ANY DAMAGE TO PUBLIC OR PRIVATE PROPERTY SHALL BE RESTORED BY THE CONTRACTOR AT NO ADDITIONAL COST TO THE OWNER.
21. ANY ENCROACHMENT WITHIN THE LIMITS OF CONSTRUCTION SHALL BE RELOCATED OR PROTECTED BY THE ADJACENT PROPERTY OWNER AT THEIR EXPENSE.

52. WHERE NEW PAVEMENT MEETS EXISTING, CONNECTION SHALL BE MADE IN A NEAT STRAIGHT LINE AND FLUSH WITH THE EXISTING PAVEMENT.
53. THE LOCATION OF SOME DRIVEWAYS IS APPROXIMATE. VERIFICATION OF EXACT LOCATION AND DIMENSIONS IS RECOMMENDED.
54. EXISTING DRIVEWAYS WITHIN THE LIMITS OF THIS PROJECT ARE TO BE REPLACED AT THE SAME LOCATION AND WIDTH, UNLESS OTHERWISE SHOWN IN PLANS.
55. WHERE CONNECTIONS TO EXISTING SIDEWALKS AND DRIVEWAYS ARE NOT INDICATED ON PLANS, PROPER CONNECTIONS ARE TO BE MADE AS DIRECTED BY THE ENGINEER. DROP CURB AND DRIVEWAY CONNECTIONS SHALL BE PROVIDED FOR ACCESS TO ALL PRIVATE PROPERTIES ADJACENT TO THE PROJECT. PAYMENT SHALL BE INCLUDED IN THE COST OF RELATED BID ITEMS.
56. CONTRACTOR TO INSTALL 1/2" PREFORMED EXPANSION JOINT WHEN PROPOSED SIDEWALK IMPROVEMENTS IS IMMEDIATELY ADJACENT TO EXISTING CONCRETE SLAB AND/OR BUILDING.
57. THE SIDEWALK AT DRIVEWAY TURNS SHALL BE 6" CONCRETE.
58. ALL BUS STOP SIGNS TO BE FURNISHED BY MIAMI-DADE TRANSIT. ENGINEER TO CONTACT MIAMI-DADE COUNTY TRANSIT AT (305)637-3753 ONE (1) WEEK PRIOR TO POURING SIDEWALKS AND COORDINATE THE REMOVAL AND REPLACEMENT OF BUS STOP SIGNS AND BENCHES.
59. COMPLETE AS-BUILT INFORMATION RELATIVE TO LOCATION AND DEPTH OF PIPES, MANHOLES, ETC. SHALL BE ACCURATELY RECORDED BY THE CONTRACTOR AND SUBMITTED TO THE ENGINEER PRIOR TO FINAL ACCEPTANCE OF THE WORK. ALL ELEVATIONS SHALL BE TAKEN BY A FLORIDA REGISTERED SURVEYOR AND SHOWN ON THE RECORD DRAWINGS.
60. DESIGN WATER TABLE ELEVATION: 7.0 FT (NGVD)
61. MIAMI-DADE COUNTY FLOOD CRITERIA ELEVATION:
 - OLD CUTLER & SW 152 ST; MIN ELEV. 11.0 FT (NAVD 88)
 - OLD CUTLER & SW 184 ST; MIN ELEV. 10.0 FT (NAVD 88)
62. THE INFORMATION PROVIDED IN THESE DRAWINGS IS SOLELY TO ASSIST THE CONTRACTOR IN ASSESSING THE NATURE AND EXTENT OF CONDITIONS WHICH WILL BE ENCOUNTERED DURING THE COURSE OF WORK. THE CONTRACTORS ARE DIRECTED, PRIOR TO BIDDING, TO CONDUCT WHATEVER INVESTIGATIONS THEY DEEM NECESSARY TO ARRIVE AT THEIR OWN CONCLUSION REGARDING THE ACTUAL CONDITIONS THAT WILL BE ENCOUNTERED AND UPON WHICH BIDS WILL BE BASED.
63. SHOP DRAWINGS FOR SIGNAL EQUIPMENT AND MAST-ARMS ARE TO BE DELIVERED TO TRAFFIC SIGNALS AND SIGN DIVISION LOCATED AT 7100 NW 36 ST MIAMI, FL 33166 TO THE ATTENTION OF OSCAR RUBIO IN ORDER TO ASSURE EQUIPMENT MEETS THE MDC STANDARDS.

64. EXISTING SIDEWALK/CURBING TO BE REPLACED AT THE NEAREST JOINT. A

K:\DESIGN\2020\16.000_IDP_MJ20200119\Old Cutler Rd. Roundabout\CAVD\2020-12-12-18 - Old Cutler Roundabout\SW 184 ST\16.000-03-CR6-NOTES - REV.dwg Mar 24, 2022 - 11:50am JFERRE

REVISIONS											
DATE	BY	DESCRIPTION	DATE	BY	DESCRIPTION	DATE	BY	DESCRIPTION	DATE	BY	DESCRIPTION
3-23-22	AF	NOTE ADDED									

MARLIN ENGINEERING
ARIEL ARN FRENK | P.E. No.: 775050
3363 W. COMMERCIAL BLVD., SUITE 115 | FT. LAUDERDALE, FL 33309
P: 954.870.5070 | CA. No. 6104

NAME	DATE	NAME	DATE
DESIGNED: RL		DRAWN BY: M.P.	
CHECKED: AF		CHECKED BY: A.F.	
APPROVED BY:			

**DEPARTMENT OF TRANSPORTATION AND PUBLIC WORKS
HIGHWAY DIVISION**
STEPHA P. CLARE, DIRECTOR
MIAMI, FLORIDA 33138

GENERAL NOTES

REVISED PLANS FOR ADDENDUM No. 2

MIAMI-DADE COUNTY DEPARTMENT OF TRANSPORTATION AND PUBLIC WORKS
HIGHWAY DIVISION
OLD CUTLER RD. ROUNDABOUTS AT SW 152 ST & SW 184 ST
PROJECT NO. 20200119 SHEET 4 OF 183

SUMMARY OF QUANTITIES - OLD CUTLER ROAD					
PAY ITEM NO.	DESCRIPTION	UNIT	TOTAL QUANTITY		
			ROADWAY SW 152ND STREET	ROADWAY SW 184TH STREET	
102-1A	MAINTENANCE OF TRAFFIC	L.S.	1	1	
104-10-3	SEDIMENT BARRIER	LF	4233	4414	
104-18	INLET PROTECTION SYSTEM	EA	2	13	
110-1-1B	CLEARING AND GRUBBING	L.S./AC	113.36	113.19	
110-4-10	REMOVAL OF EXISTING CONCRETE	SY	765	639	
110-7-1B	RELOCATE MAILBOX	EA	2	1	
120-1	REGULAR EXCAVATION	CY	4687.1	5419.6	
120-2-2	BORROW EXCAVATION	CY	346.3	362.9	
160-4	TYPE B STABILIZATION (12" THICK) (MIN. CBR 30)	SY	2711 9939	1263 11698	
200-1-3	LIMEROCK BASE (4" THICK, PRIMED)	SY	1156	645	
200-1-10	LIMEROCK BASE (8" THICK PRIMED)	SY	9777	9834 12223	
286-1	TURNOUT CONSTRUCTION	SY	289	50	
327-70-01	MILLING EXISTING ASPHALT (1" AVG. DEPTH)	SY	2072	1266	
334-2-11	HOT MIX ASPHALT, TRAFFIC A	TN	86.7	32.2	
334-2-13-2	HOT MIX ASPHALT, TRAFFIC C, SP-12.5	TN	977.7	1222.3	
337-6-42	HOT MIX ASPHALT FRICTION COURSE, TRAFFIC C, FC-9.5, PG 76-22	TN	602.8	660.8	
350-30-13	CONCRETE PAVEMENT FOR ROUNDABOUT APRON, 12" DEPTH	SY	320.0	320.0	
400-1-15	CLASS 1 CONCRETE (MISCELLANEOUS) (COLLARS, PIPE PLUGS, STRUCTURE PLUGS ETC)	CY	5.0	5.0	
425-1-331C	INLET CURB TYPE P-3 <10'	EA	1	2	
425-1-332	INLET CURB TYPE P-3 >10'	EA	1	1	
425-1-341	INLETS (CURB) TYPE P-4 <10'	EA	4	1	
425-1-341A	INLET CURB TYPE P-4 >10'	EA	1	4	
425-1-351	INLET CURB (TYPE P-5) <10'	EA	4	5	
425-1-353	INLETS (CURB) (TYPE P-5) (>10')	EA	1	1	
425-1-355	INLET TOP CURB (TYPE 5) INCLUDES ADJUSTMENT TO BOX, IF NECESSARY (PARTIAL)	EA	2	2	
425-1-361	CURB INLET, TYPE P-6 <10'	EA	2	2	
425-1-362A	INLET (CURB TYPE P-6) (>10')	EA	1	4	
425-1-442	INLETS (CURB) (TYPE J-4) (>10')	EA	1	1	
425-1-451B	INLET (CURB) TYPE J-5 (<10')	EA	1	1	
425-1-541A	INLETS, DITCH BOTTOM, TYPE D, J BOTTOM, <10'	EA	11	1	
425-1-802A	INLET CURB TYPE P-11 <10'	EA	1	1	
425-2-61	MANHOLES, P-8, <10'	EA	3	3	
425-2-62	MANHOLES, P-8, >10'	EA	1	2	
425-5	ADJUST MANHOLE (THIS ITEM IS CONTINGENT UPON FIELD CONDITIONS AND MAY BE INCREASED, DECREASED OR ELIMINATED BY THE ENGINEER)	EA	1	1	
425-5-1	ADJUST MANHOLE (UTILITIES) (MIAMI-DADE WATER & SEWER ONLY)	EA	1	7	
425-6	ADJUST EXISTING VALVE BOXES (MIAMI-DADE COUNTY ONLY)	EA	9	12	
430-175-118	PIPE CULVERT OPTIONAL MATERIAL, ROUND SHAPE, 18"	LF	1548	1860	
443-70-4-3	FRENCH DRAIN (24" DIAMETER PERFORATED PIPE, TRENCH DEPTH 15 FT. BLS)	LF	754	387	
500-1-7(1)	CONCRETE MEDIAN CURB (TYPE "E")	LF	862	1505	
520-1-10B	CONCRETE CURB AND GUTTER (TYPE F)	LF	3327	3573	
520-2-2	CONCRETE CURB (TYPE "B")	LF	61	281	
520-2-8A	CONCRETE CURB AND GUTTER (TYPE RA)	LF	242	242	
520-2-12	CONCRETE CURB (TYPE "D")	LF	145	145	
522-1(1)	CONCRETE SIDEWALK 4" THICK, 3000 PSI CONCRETE AT 28 DAYS (INCLUDES THE COST OF PEDESTRIAN RAMPS AND SIDEWALK CURBS)	SY	720	276	
522-2(1)	CONCRETE SIDEWALK (6" THICK) (INCLUDES DRIVEWAYS)	SY	570	616	
527-2	DETECTABLE WARNINGS	SF	329	417	
570-1-2	PERFORMANCE TURF, SOD	SY	5261	3504	
580-3	TREE PROTECTION BARRICADES	LF	1160	1160	
580-322-2A	TREE REMOVAL AND DISPOSAL (8" TO 12" DIA.)	EA	13	24	
580-322-4A	TREE REMOVAL AND DISPOSAL (12" TO 24" DIA.)	EA	34	26	
580-322-5A	TREE REMOVAL AND DISPOSAL (24" TO 36" Dia.)	EA	2	1	

PAY ITEM NOTES

102-1 TO BE ACCOMPLISHED IN ACCORDANCE WITH THE FLORIDA DEPARTMENT OF TRANSPORTATION INDEX 102 SERIES, THE MANUAL OF UNIFORM TRAFFIC CONTROL DEVICES FOR STREETS AND HIGHWAYS, U.S. DEPARTMENT OF TRANSPORTATION FEDERAL HIGHWAY ADMINISTRATION (ANSI D6 1-1978), PUBLIC WORKS MANUAL OF METROPOLITAN DADE COUNTY, AND THE LATEST REVISIONS OF THE AFORE MENTIONED MANUALS. INCLUDES THE COST OF FURNISHING, INSTALLING, MAINTAINING, AND REMOVING ALL ITEMS OF MAINTENANCE OF TRAFFIC NOT PAID FOR UNDER SEPARATE ITEMS INCLUDING BUT NOT LIMITED TO SIGNS, BARRICADES, FLASHING LIGHTS, TEMPORARY PAVEMENT, TEMPORARY PAVEMENT MARKINGS, TRAFFIC SIGNAL MODIFICATIONS FOR TRAFFIC CONTROL, ETC.

110-1-1 INCLUDES REMOVAL OF EXISTING PAVEMENT, CONCRETE SIDEWALK, DRIVEWAYS, CURB AND GUTTER, EXISTING STORM SEWERS (DRAINAGE STRUCTURES, PIPES, FRENCH DRAIN AND/OR SLAB COVERED TRENCHES. COST OF REMOVAL, DISPOSAL, BACKFILLING AND COMPACTING IS ALSO INCLUDED). MISCELLANEOUS CONCRETE, VEGETATION, TREES AND DEBRIS TO BE DISPOSED OF IN LEGAL AREAS PROVIDED BY THE CONTRACTOR. INCLUDES THE COST OF CLEANING-OUT ALL EXISTING DRAINAGE STRUCTURES WHICH ARE TO REMAIN WITHIN THE LIMITS OF CONSTRUCTION.

120-1 THESE ARE ESTIMATED QUANTITIES AND MAY BE INCREASED OR DECREASED BY THE ENGINEER. 443-70-4 INCLUDES THE COST OF EXCAVATION TO PLAN ELEVATION, PERFORATED PIPE, PEACOCK BALLAST ROCK, PLASTIC FILTER FABRIC AND BACKFILLING WITH SELECT FILL (SEE DETAIL OF EXFILTRATION DRAIN TO DETERMINE NON-PERFORATED PIPE QUANTITY) AND ALL APPLICABLE ITEMS REQUIRED TO CONSTRUCT EXFILTRATION DRAIN.

400-1-15 INCLUDES COLLARS, PIPE PLUGS, STRUCTURE PLUGS ETC.

520-1-10 INCLUDES DROP CURB AT DRIVEWAYS AND 3 FT OF CURB ENDING AS DIRECTED BY THE ENGINEER. ALSO INCLUDES COST OF LIMEROCK.

570-1-2 INCLUDES SOD TO BE USED IN THE RESTORATION OF LAWNS AND MAY BE INCREASED OR DECREASED AS DIRECTED BY THE ENGINEER.

SUMMARY OF EARTHWORK	
ITEM	QUANTITY
REGULAR EXCAVATION	10106.7 C.Y.
SUBSOIL EXCAVATION	C.Y.
FILL	739.2 C.Y.
EMBANKMENT (SUBSOIL EXCAVATION) + FILL	739.2 C.Y.

- SUMMARY OF EARTHWORK IS BASED ON THE CONSTRUCTION OF LIMEROCK BASE 8" & 4" THICK AS INDICATED ON THE CROSS SECTIONS.
- ANY EXCAVATED MATERIAL, IF UNSUITABLE, SHALL NOT BE USED IN THE CONSTRUCTION OF THE EMBANKMENT.
- EXCESS MATERIAL TO BE DISPOSED OF BY THE CONTRACTOR IN AREAS PROVIDED BY HIM. NO SEPARATE PAYMENT WILL BE MADE FOR THIS ITEM.
- AN ESTIMATED 8181 C.Y. OF UNCLASSIFIED MATERIAL IS TO BE DISPLACED BY THE STORM SEWER SYSTEM WHICH INCLUDES THE EXFILTRATION DRAIN AND IS NOT INCLUDED IN THE SUMMARY OF EARTHWORK QUANTITIES. THIS MATERIAL IS TO BE UTILIZED ON THE PROJECT AS DIRECTED BY THE ENGINEER. ANY EXCESS OF MATERIAL IS TO BE DISPOSED OF IN LEGAL AREAS AS PROVIDED BY THE CONTRACTOR.

REVISIONS

DATE	BY	DESCRIPTION	DATE	BY	DESCRIPTION	DATE	BY	DESCRIPTION
3-23-22	AF	QUANTITY REVISED PAY ITEM & PAY ITEM DESCRIPTION CHANGED						

MARLIN
ENGINEERING
ATCIEL ARMI FRENCH | P.E. No.: 77050
3363 W. COMMERCIAL, SUITE 115 | FT. LAUDERDALE, FL 33309
P: 954.870.9070 | CA. No. 6104

NAME	DATE	NAME	DATE
DESIGNED BY: RL		DRAWN BY: M.P.	
CHECKED BY: A.F.		CHECKED BY: A.F.	
SUPERVISED BY:			

MIAMI-DADE COUNTY DEPARTMENT OF TRANSPORTATION AND PUBLIC WORKS HIGHWAY DIVISION
STEPHEN P. CLARK, CHIEF
MIAMI, FLORIDA 33128

SUMMARY OF QUANTITIES

K:\DESIGN\2020\16.000_LDP_MJT2020119\Old Cutler Rd. Roundabout\CADD\2020-12-12-18- Old Cutler Roundabouts\SW 184 ST\DWG\04-SUMMARY-QNTS - REV.dwg Mar 24, 2022 - 11:59am JFBREB

REVISED PLANS FOR ADDENDUM No. 2

MIAMI-DADE COUNTY DEPARTMENT OF TRANSPORTATION AND PUBLIC WORKS
HIGHWAY DIVISION
OLD CUTLER RD. ROUNDABOUTS AT SW 152 ST & SW 184 ST
PROJECT NO. 20200119 SHEET 9 OF 183

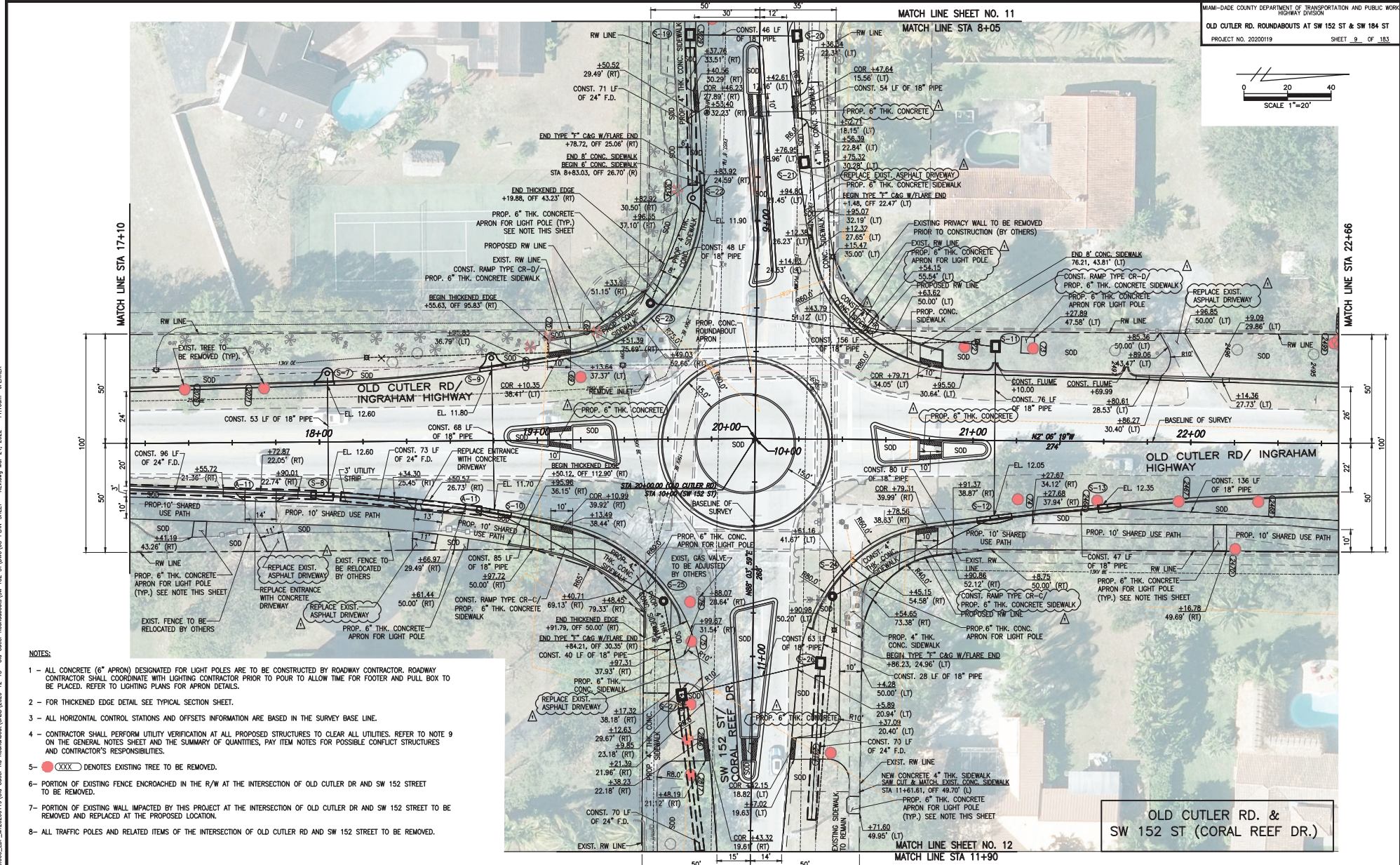
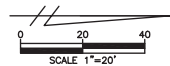

- NOTES:**
- 1 - ALL CONCRETE (6" APRON) DESIGNATED FOR LIGHT POLES ARE TO BE CONSTRUCTED BY ROADWAY CONTRACTOR. ROADWAY CONTRACTOR SHALL COORDINATE WITH LIGHTING CONTRACTOR PRIOR TO POUR TO ALLOW TIME FOR FOOTER AND PULL BOX TO BE PLACED. REFER TO LIGHTING PLANS FOR APRON DETAILS.
 - 2 - FOR THICKENED EDGE DETAIL SEE TYPICAL SECTION SHEET.
 - 3 - ALL HORIZONTAL CONTROL STATIONS AND OFFSETS INFORMATION ARE BASED IN THE SURVEY BASE LINE.
 - 4 - CONTRACTOR SHALL PERFORM UTILITY VERIFICATION AT ALL PROPOSED STRUCTURES TO CLEAR ALL UTILITIES. REFER TO NOTE 9 ON THE GENERAL NOTES SHEET AND THE SUMMARY OF QUANTITIES, PAY ITEM NOTES FOR POSSIBLE CONFLICT STRUCTURES AND CONTRACTOR'S RESPONSIBILITIES.
 - 5 - (XXX) DENOTES EXISTING TREE TO BE REMOVED.
 - 6 - PORTION OF EXISTING FENCE ENCRoACHED IN THE R/W AT THE INTERSECTION OF OLD CUTLER DR AND SW 152 STREET TO BE REMOVED.
 - 7 - PORTION OF EXISTING WALL IMPACTED BY THIS PROJECT AT THE INTERSECTION OF OLD CUTLER DR AND SW 152 STREET TO BE REMOVED AND REPLACED AT THE PROPOSED LOCATION.
 - 8 - ALL TRAFFIC POLES AND RELATED ITEMS OF THE INTERSECTION OF OLD CUTLER RD AND SW 152 STREET TO BE REMOVED.

OLD CUTLER RD. &
SW 152 ST (CORAL REEF DR.)

REVISIONS					
DATE	BY	DESCRIPTION	DATE	BY	DESCRIPTION
3-23-22	AF	TEXT LABELS REVISED STA. OFF UPDATED CONC. APRON RELOCATED			

MARLIN
ENGINEERING
ANGEL ABRN FREDA | P.E. No.: 77550
3363 W. COMMERCIAL BLVD. SU. 113 FT. LAUDERDALE, FL 33309
P: 954.870.5070 | C.A. No. 6104

DESIGNED BY	NAME	DATE	DRAWN BY	NAME	DATE
RL			M.P.		
CHECKED BY	A.F.		CHECKED BY	A.F.	
SUPERVISED BY:					

DEPARTMENT OF TRANSPORTATION
AND PUBLIC WORKS
HIGHWAY DIVISION
MIAMI-DADE COUNTY
SHARPE P. CLARK CENTER
MIAMI, FLORIDA 33138

ROADWAY PLAN

K:\DESIGN\20200119\19_OLD CUTLER RD ROUNDABOUT\CADD\2020-12-18-19-Old Cutler Roundabout\SW 152 ST\SW152-18-PLAN-SHEET - REVISED MAR 24, 2022 - 11:10am - JF95828