



DEPARTMENT OF REGULATORY AND ECONOMIC RESOURCES (RER)
BOARD AND CODE ADMINISTRATION DIVISION
NOTICE OF ACCEPTANCE (NOA)

MIAMI-DADE COUNTY
PRODUCT CONTROL SECTION
11805 SW 26 Street, Room 208
Miami, Florida 33175-2474
T (786) 315-2590 F (786) 315-2599
www.miamidade.gov/building

TKO Doors, Div. of 4Front Engineered Solutions, Inc.
N56 W24701 N. Corporate Circle
Sussex, WI 53089

SCOPE: This NOA is being issued under the applicable rules and regulations governing the use of construction materials. The documentation submitted has been reviewed and accepted by Miami-Dade County RER-Product Control Section to be used in Miami Dade County and other areas where allowed by the Authority Having Jurisdiction (AHJ).

This NOA shall not be valid after the expiration date stated below. The Miami-Dade County Product Control Section (In Miami Dade County) and/or the AHJ (in areas other than Miami Dade County) reserve the right to have this product or material tested for quality assurance purposes. If this product or material fails to perform in the accepted manner, the manufacturer will incur the expense of such testing and the AHJ may immediately revoke, modify, or suspend the use of such product or material within their jurisdiction. RER reserves the right to revoke this acceptance, if it is determined by Miami-Dade County Product Control Section that this product or material fails to meet the requirements of the applicable building code.

This product is approved as described herein and has been designed to comply with the Florida Building Code, including the High Velocity Hurricane Zone.

DESCRIPTION: Model WW WL Dock Plastic Sectional Garage Door up to 10'-0" Wide x 10'-0" High

APPROVAL DOCUMENT: Drawing No. **23-60382**, titled "Fiberglass Dock Doors WW WL Overhead Garage Door", sheets 1 through 7 of 7, dated 07/30/20, with revision dated 11/15/23, prepared by Engineering Express, signed and sealed by Frank L. Bennardo, P.E., bearing the Miami-Dade County Product Control Revision stamp with the NOA number and expiration date by the Miami-Dade County Product Control Section.

MISSILE IMPACT RATING: Large and Small Missile Impact Resistant

LABELING: Each unit shall bear a permanent label with the manufacturer's name or logo, manufacturing address, model number, the positive and negative design pressure rating, indicate impact rated if applicable, installation instruction drawing reference number, approval number (NOA), the applicable test standards, and the statement reading 'Miami-Dade County Product Control Approved' is to be located on the door's side track, bottom angle, or inner surface of a panel.

RENEWAL of this NOA shall be considered after a renewal application has been filed and there has been no change in the applicable building code negatively affecting the performance of this product.

TERMINATION of this NOA will occur after the expiration date or if there has been a revision or change in the materials, use, and/or manufacture of the product or process. Misuse of this NOA as an endorsement of any product, for sales, advertising or any other purposes shall automatically terminate this NOA. Failure to comply with any section of this NOA shall be cause for termination and removal of NOA.

ADVERTISEMENT: The NOA number preceded by the words Miami-Dade County, Florida, and followed by the expiration date may be displayed in advertising literature. If any portion of the NOA is displayed, then it shall be done in its entirety.

INSPECTION: A copy of this entire NOA shall be provided to the user by the manufacturer or its distributors and shall be available for inspection at the job site at the request of the Building Official.

This NOA **revises and renews** NOA No. **20-0901.15** and consists of this page 1 and evidence pages E-1, E-2 and E-3, as well as approval document mentioned above.

The submitted documentation was reviewed by **Manuel Perez, P.E.**

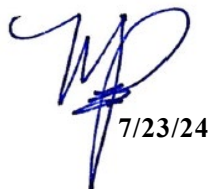

7/23/24

NOA No. 24-0226.09
Expiration Date: August 14, 2029
Approval Date: August 01, 2024
Page 1

NOTICE OF ACCEPTANCE: EVIDENCE SUBMITTED

1. EVIDENCE SUBMITTED UNDER PREVIOUS NOA's

A. DRAWINGS

1. Manufacturer's die drawings and sections.
(Submitted under NOA No. 13-0521.03)
2. Drawing No. **20-26602**, titled "Fiberglass Dock Doors WW WL Overhead Garage Door", sheets 1 through 8 of 8, dated 05/06/13, with revision dated 07/30/20, prepared by Engineering Express, signed and sealed by Frank L. Bennardo, P.E.
(Submitted under NOA No. 20-0901.15)

B. TESTS

1. Test report on Airflow (Infiltration and Exfiltration) Rate, per ASTM E283-04 of a Welter Weight (WW) WL dock door, prepared by Intertek/ATI, Test Report No. **E7174.01-602-18**, dated 07/21/15, signed and sealed by Justin P. McDonald, P.E.
(Submitted under NOA No. 16-0725.03)
2. Test reports on: 1) Uniform Static Air Pressure Test, Loading per FBC, TAS 202-94
2) Large Missile Impact Test per FBC, TAS 201-94
3) Cyclic Wind Pressure Loading per FBC, TAS 203-94
4) Forced Entry Test, per FBC, TAS 202-94
along with marked-up drawings and installation diagram of Welter Weight Doors, prepared by Architectural Testing, Inc., Test Report No. **D5680.01-602-18**, dated 04/07/14, signed and sealed by Shawn G. Collins, P.E.
(Submitted under NOA No. 13-0521.03)
3. Test reports on: 1) Uniform Static Air Pressure Test, Loading per FBC, TAS 202-94
2) Large Missile Impact Test per FBC, TAS 201-94
3) Cyclic Wind Pressure Loading per FBC, TAS 203-94
4) Forced Entry Test, per FBC, TAS 202-94
along with marked-up drawings and installation diagram of Welter Weight Doors, prepared by Architectural Testing, Inc., Test Report No. **C3614.01-602-18**, dated 03/28/13, signed and sealed by Shawn G. Collins, P.E.
(Submitted under NOA No. 13-0521.03)
4. Test report on Self-ignition Temperature per ASTM D1929, Smoke Density Rating per ASTM D2843 and Rate of Burn per ASTM D635 of various plastic door components, prepared by Architectural Testing, Inc., Test Report No. **C2850.01-106-18**, dated 11/21/12, signed and sealed by Gary T. Hartman, P.E.
(Submitted under NOA No. 13-0521.03)

C. CALCULATIONS

1. Jamb anchor calculations prepared by Engineering Express, dated 05/05/15, signed and sealed by Frank L. Bennardo, P.E.
(Submitted under NOA No. 15-0916.08)

Manuel Perez, P.E.
Product Control Examiner
NOA No. 24-0226.09
Expiration Date: August 14, 2029
Approval Date: August 01, 2024

TKO Doors, Div. of 4Front Engineered Solutions, Inc.

NOTICE OF ACCEPTANCE: EVIDENCE SUBMITTED

1. EVIDENCE SUBMITTED UNDER PREVIOUS NOA's (CONTINUED)

D. QUALITY ASSURANCE

1. Miami-Dade Department of Regulatory and Economic Resources (RER)

E. MATERIAL CERTIFICATIONS

1. Test report on Flame Spread Index and Smoke Developed Index per UL-723 of EXPS foam insulation, Test Report No. **BRYX.R3573** dated 07/12/10.
(Submitted under NOA No. 13-0521.03)

F. STATEMENTS

1. Statement letter of conformance, complying with **FBC 7^h Edition (2020)**, dated August 04, 2020, issued by Engineering Express, signed and sealed by Frank L. Bennardo, P.E.
(Submitted under NOA No. 20-0901.15)
2. Statement letter of no financial interest, dated August 04, 2020, issued by manufacturer Engineering Express, signed and sealed by Frank L. Bennardo, P.E.
(Submitted under NOA No. 20-0901.15)

G. OTHERS

1. Notice of Acceptance No. **19-0522.01**, issued to TKO Doors, Div. of 4Front Engineered Solutions, Inc, for their Model WW WL Dock Plastic Sectional Garage Door up to 10'-0" Wide x 10'-0" High, approved on 07/03/19 and expiring on 08/14/24.

Manuel Perez, P.E.
Product Control Examiner
NOA No. 24-0226.09
Expiration Date: August 14, 2029
Approval Date: August 01, 2024

TKO Doors, Div. of 4Front Engineered Solutions, Inc.

NOTICE OF ACCEPTANCE: EVIDENCE SUBMITTED

2. NEW EVIDENCE SUBMITTED

A. DRAWINGS

1. Drawing No. **23-60382**, titled “Fiberglass Dock Doors WW WL Overhead Garage Door”, sheets 1 through 8 of 8, dated 07/30/20, with revision dated 11/15/23, prepared by Engineering Express, signed and sealed by Frank L. Bennardo, P.E.

B. TESTS

1. None.

C. CALCULATIONS

1. None.

D. QUALITY ASSURANCE

1. Miami-Dade Department of Regulatory and Economic Resources (RER)

E. MATERIAL CERTIFICATIONS

1. None.

F. STATEMENTS

1. Statement letter of conformance, complying with **FBC 8^h Edition (2023)**, dated May 14, 2024, issued by Engineering Express, signed and sealed by Frank L. Bennardo, P.E.
2. Statement letter of conformance, complying with **FBC 8^h Edition (2023)**, dated November 15, 2023, issued by Engineering Express, signed and sealed by Frank L. Bennardo, P.E.
3. Statement letter of no financial interest, dated November 15, 2023, issued by manufacturer Engineering Express, signed and sealed by Frank L. Bennardo, P.E.

G. OTHERS

1. Notice of Acceptance No. **20-0901.15**, issued to TKO Doors, Div. of 4Front Engineered Solutions, Inc, for their Model WW WL Dock Plastic Sectional Garage Door up to 10’-0” Wide x 10’-0” High, approved on 11/12/20 and expiring on 08/14/24.

Manuel Perez, P.E.
Product Control Examiner
NOA No. 24-0226.09
Expiration Date: August 14, 2029
Approval Date: August 01, 2024

118.125 PANEL WIDTH

NOTE: PANELS MANUFACTURED 1.875" LESS THAN DOOR OPENING WIDTH

B

PLAN VIEW

118.125 PANEL WIDTH
-NOTE: PANELS MANUFACTURED 1.875"
LESS THAN DOOR OPENING WIDTH

PLAN VIEW

[illegible]

120.000 VARIES
DOOR HEIGHT WITH
FIVE PANELS

24.000 MAX
PANEL HEIGHT

24.000 MAX
PANEL HEIGHT

24.000 MAX
PANEL HEIGHT

24.000 MAX
PANEL HEIGHT

24.000 MAX
PANEL HEIGHT

— SEE SHEETS 7 OF 8
AND 8 OF 8 FOR DETAIL
PANEL HARDWARE

— SEE SHEET 4 OF 8
AND SHEET 5 OF 8
FOR DETAIL LOWER
TRACK ASSEMBLY

— SEE SHEET 2 OF 8
FOR DETAIL
PANEL ASSEMBLY

— SEE SHEET 6 OF 8
FOR DETAIL TRACK
ANCHOR MOUNTING

— SEE SHEET 3 OF 8
FOR DETAIL
PANEL COMPONENTS

60.000 CENTER POST CENTERED
IN DOOR OPENING/PANEL

120.000 MAX DOOR OPENING WIDTH/ TRACK SPACING
INTERIOR ELEVATION

PRODUCT REVISED
As complying with the Florida
Building Code
NOA-No. 24-0226.09
Expiration Date: 08/14/2029
By: Manuel Perez
Miami-Dade Product Control

FRANK BENNARDO, P.E.
PE# 0046549 CA# 9885

FEBRUARY 15, 2024

GENERAL NOTES

1. THE SYSTEM DESCRIBED HEREIN HAS BEEN DESIGNED AND TESTED IN ACCORDANCE WITH THE FLORIDA BUILDING CODE EIGHTH EDITION (2023), FOR USE WITHIN AND OUTSIDE THE HIGH VELOCITY HURRICANE ZONE, PER TAS 201 / 202 / 203 STANDARDS.
2. NO 33-1/3% INCREASE IN ALLOWABLE STRESS HAS BEEN USED IN THE DESIGN OF THIS SYSTEM. WIND LOAD DURATION FACTOR $C_d=1.6$ HAS BEEN USED FOR WOOD ANCHOR DESIGN.
3. POSITIVE AND NEGATIVE DESIGN PRESSURES CALCULATED FOR USE WITH THIS SYSTEM SHALL BE DETERMINED PER SEPARATE ENGINEERING IN ACCORDANCE WITH THE GOVERNING CODE. PRESSURE REQUIREMENTS AS DETERMINED IN ACCORDANCE WITH ASCE 7 AND SECTION 1620 OF THE FLORIDA BUILDING CODE SHALL BE LESS THAN OR EQUAL TO THE POSITIVE OR NEGATIVE DESIGN PRESSURE CAPACITY VALUES LISTED HEREIN FOR ANY ASSEMBLY AS SHOWN.
4. DESIGN PRESSURES NOTED HEREIN ARE BASED ON MAXIMUM TESTED PRESSURES DIVIDED BY A 1.5 SAFETY FACTOR.
5. THE SYSTEM DETAILED HEREIN IS GENERIC AND DOES NOT PROVIDE INFORMATION FOR A SPECIFIC SITE. FOR SITE CONDITIONS DIFFERENT FROM THE CONDITIONS DETAILED HEREIN, A LICENSED ENGINEER OR REGISTERED ARCHITECT SHALL PREPARE SITE SPECIFIC DOCUMENTS FOR USE IN CONJUNCTION WITH THIS DOCUMENT.
6. CONTRACTOR SHALL VERIFY THE ADEQUACY OF THE EXISTING STRUCTURE TO WITHSTAND SUPERIMPOSED LOADS. WOOD BUCKS (BY OTHERS) SHALL BE ANCHORED PROPERLY TO TRANSFER LOADS TO THE EXISTING STRUCTURE.
7. ALL BOLTS & WASHERS SHALL BE ZINC COATED STEEL, GALVANIZED STEEL, OR STAINLESS STEEL WITH A MINIMUM TENSILE YIELD STRENGTH OF 60 KSI U.O.N.
8. ALL DISSIMILAR MATERIALS IN CONTACT SHALL BE PAINTED, PLATED OR OTHERWISE INSULATED.
9. DOOR HEIGHT MAY VARY UP TO A MAXIMUM HEIGHT OF 120", PROVIDED THAT INDIVIDUAL PANEL HEIGHTS DO NOT EXCEED 24".
10. ALL HARDWARE & FASTENERS SHALL BE IN ACCORDANCE WITH THESE DRAWINGS & MAY NOT VARY UNLESS SPECIFICALLY MENTIONED ON THE DRAWINGS.

ALLOWABLE DESIGN PRESSURES

+52.0 PSF
-52.0 PSF

VISIT [ECALC.IO/26602](https://ecalc.io/26602)

FOR SITE SPECIFIC DEVIATIONS
& MORE INFORMATION ABOUT THIS DOCUMENT
OR SCAN THIS QR CODE
VISIT ENGINEERINGEXPRESS.COM/STORE
FOR ADDITIONAL PLANS, REPORTS & RESOURCES



EXENGINEERING
EXPRESS®

POSTAL ADDRESS:
2234 NORTH FEDERAL HWY #7664
BOCA RATON, FL 33431
ENGINEERINGEXPRESS.COM

TKO DOORS, DIVISION OF 4FRONT ENGINEERED SOLUTIONS, INC.

N56 W24701 NORTH CORPORATE CIRCLE, SUITE A
SUCCESSEY, WY 83006

PHONE: 1-800-575-3366 | FAX: (262) 246-1301

PHONE: 1-800-575-3366 | FAX: (262) 246-1301

FLORIDA BUILDING CODE EIGHTH EDITION (2023)

MIAMI-DADE COUNTY NOTICE OF ACCEPTANCE (NOA)

REMARKS	DATE	CHKD	DRWN	RWN	EPR	MRT	RWN
PREV. SUBMITTAL (20-26602)	07/30/20						
2023 FBC UPDATE	11/15/23						

COPYRIGHT ENGINEERING EXPRESS®

23-60382

SCALE: NTS UNLESS NOTED

1

FEBRUARY 15, 2024



N56 W24701 NORTH CORPORATE CIRCLE, SUITE A
SUSSEX, WI 53089
PHONE: 1-800-575-3366 | FAX: (262) 246-1301
FIBERGLASS DOCK DOORS WW WL OVERHEAD GARAGE DOOR
FLORIDA BUILDING CODE EIGHTH EDITION (2023)
MIAMI-DADE COUNTY NOTICE OF ACCEPTANCE (NOA)

REMARKS	DRWN	CHKD	DATE
PREV. SUBMITAL (20-26602)	EPR	RWN	07/30/20
2023 FBC UPDATE	MRT	RWN	11/15/23
*	*	*	*
*	*	*	*
*	*	*	*

COPYRIGHT ENGINEERING EXPRESS®

SCALE: NTS UNLESS NOTED

8

PRODUCT REVISED
As complying with the Florida
Building Code
NOA-No. **24-0226.09**
Expiration Date: **08/14/2029**
By: *Manuel Perez*
Miami-Dade Product Control

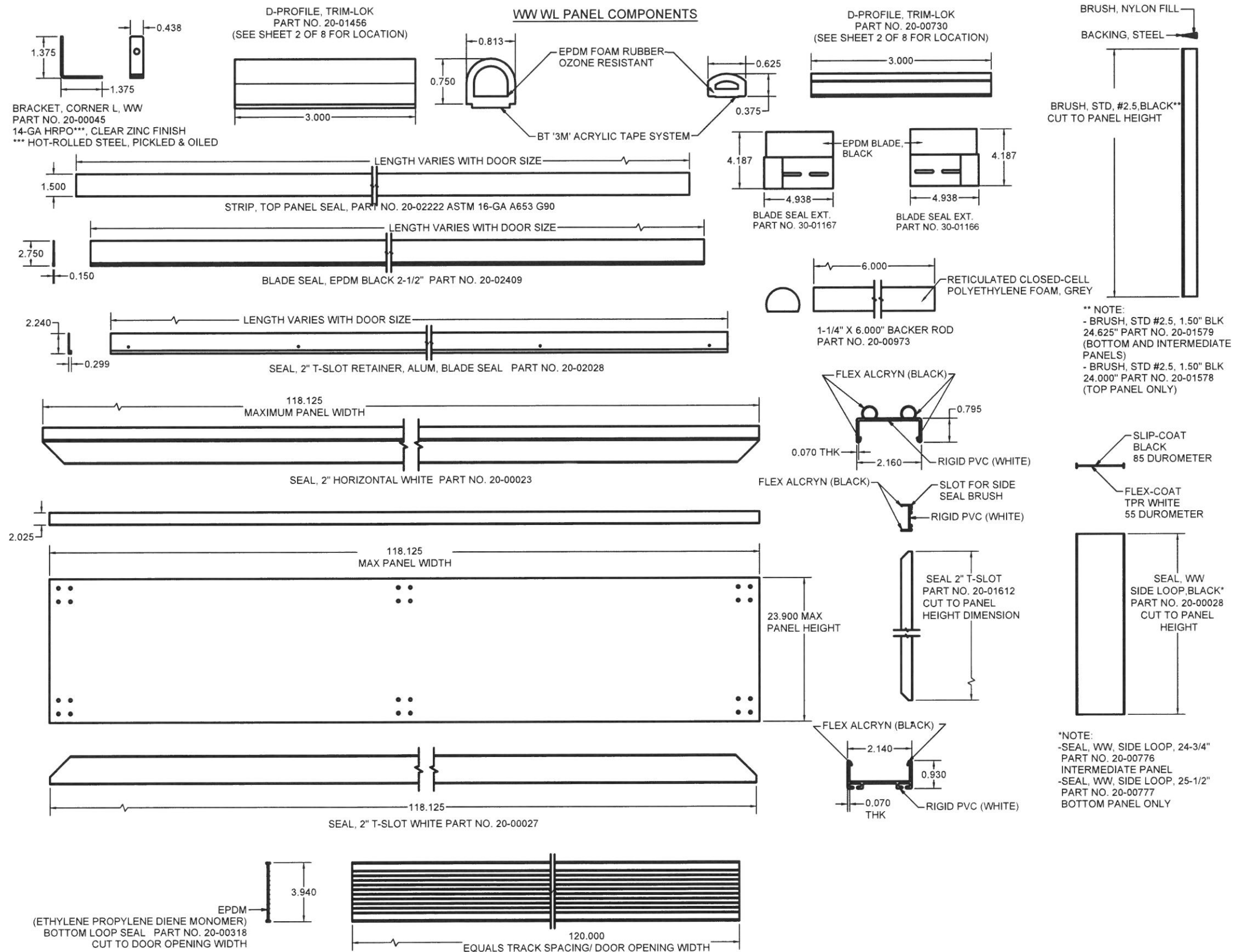

c:\users\milton\engineering express\production - documents\projects\23-60382 2023 noa product update 20-0901.15\work\2023 fbc\docs for review\5 - 23-60382b noa dwg_recover.dwg 2/15/2024 3:00 PM MILTON

LEFT HAND SIDE TRACK

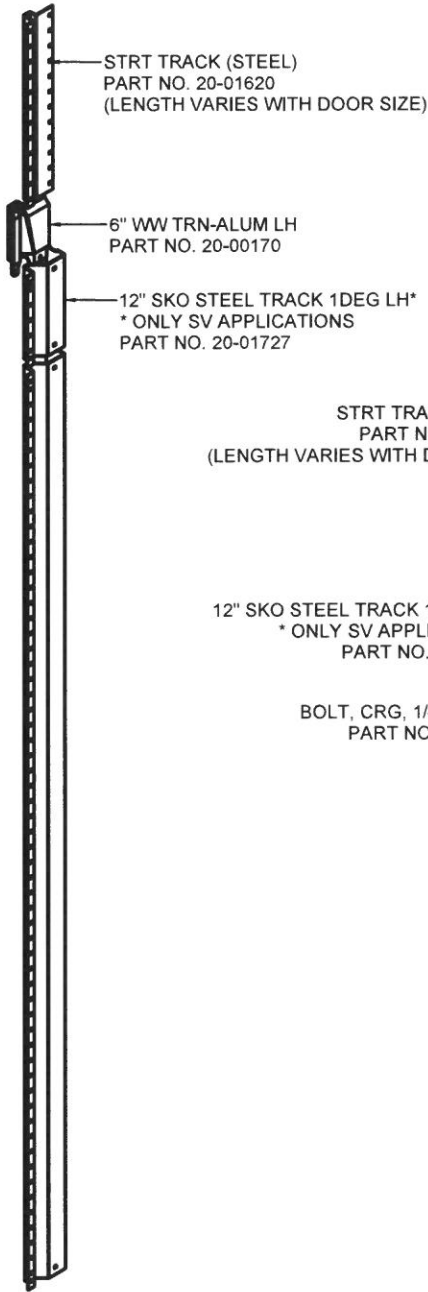

RIGHT HAND SIDE TRACK

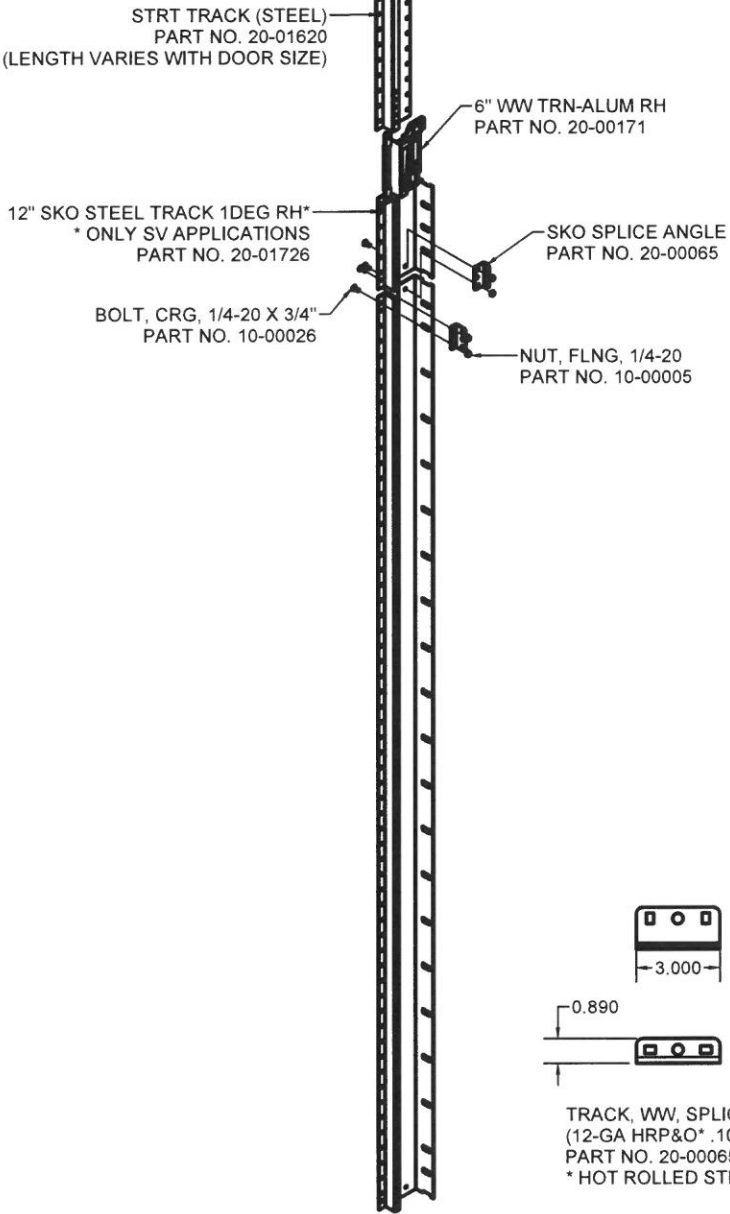

STL WW WL LOWER TRACK ASSEMBLY

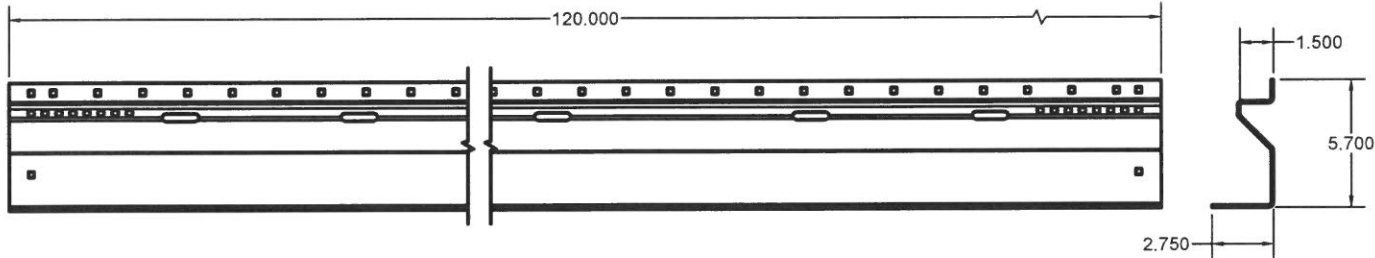

TRACK, WW, SKO EXT. 120" WLD PART NO. 20-02203
(12-GA STEEL, ASTM A653 G90)(Fy=36 Ksi, MIN)

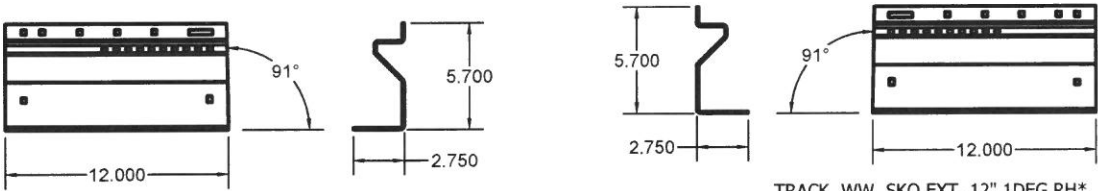

TRACK, WW, SKO EXT. 12" 1DEG LH*
(12-GA A653 G90 STEEL)
* ONLY SV APPLICATIONS
PART NO. 20-01727

TRACK, WW, SKO EXT. 12" 1DEG RH*
(12-GA A653 G90 STEEL)
* ONLY SV APPLICATIONS
PART NO. 20-01726

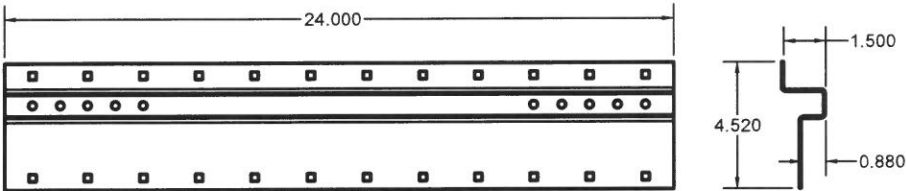

TRACK, WW, STRT EXT. 24" PART NO. 20-01620
(14-GA STEEL, ASTM A653 G90)(Fy=36 Ksi, MIN)

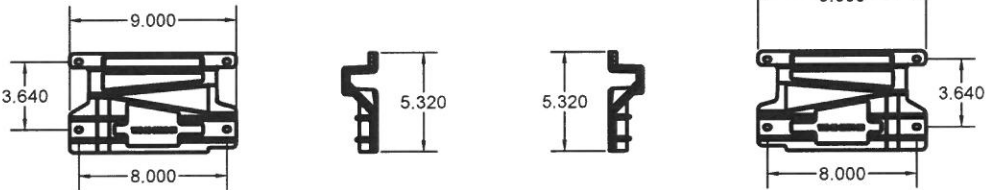

TRACK, WW, 6" TRN LH
(ALUMINUM)
PART NO. 20-00170

TRACK, WW, 6" TRN RH
(ALUMINUM)
PART NO. 20-00171

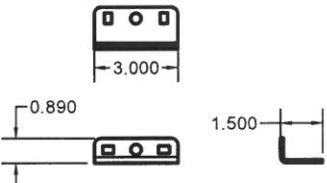

TRACK, WW, SPLICE ANGLE, SKO
(12-GA HRP&O* .1046)
PART NO. 20-00065
* HOT ROLLED STEEL, PICKLED & OILED

FRANK BENNARDO, P.E.
PE# 0046549 CA# 9885

FEBRUARY 15, 2024

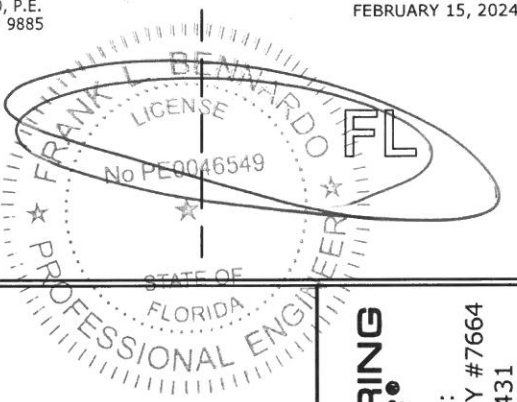

ENGINEERING EXPRESS®

POSTAL ADDRESS:
2234 NORTH FEDERAL HWY #7664
BOCA RATON, FL 33431
ENGINEERINGEXPRESS.COM

TKO DOORS, DIVISION OF 4FRONT ENGINEERED SOLUTIONS, INC.

N56 W24701 NORTH CORPORATE CIRCLE, SUITE A

SUSSEX, WI 53089

PHONE: 1-800-575-3366 | FAX: (262) 246-1301

FIBERGLASS DOCK DOORS WW WL OVERHEAD GARAGE DOOR

FLORIDA BUILDING CODE EIGHTH EDITION (2023)

MIAMI-DADE COUNTY NOTICE OF ACCEPTANCE (NOA)

REMARKS

PREV. SUBMITTAL (20-26602)

2023 FBC UPDATE

DATE

07/30/20

11/15/23

COPYRIGHT ENGINEERING EXPRESS®

PRODUCT REVISED
As complying with the Florida
Building Code
NOA-No. **24-0226.09**
Expiration Date: **08/14/2029**
By: *Manuel Perez*
Miami-Dade Product Control

23-60382
SCALE: NTS UNLESS NOTED
4

c:\users\milton\engineering\express\production - documents\projects\23-60382 2023 noa product update 20-0901.15\work\2023 fbc\docs for review\5 - 23-60382b noa dwg_recover.dwg 2/15/2024 3:00 PM MILTON

FULL HEIGHT IMPACT-A-TRACK (FH I-A-T) WW WL LOWER TRACK ASSEMBLY

FRANK BENNARDO, P.E.
PE# 0046549 CA# 9885

FEBRUARY 15, 2024

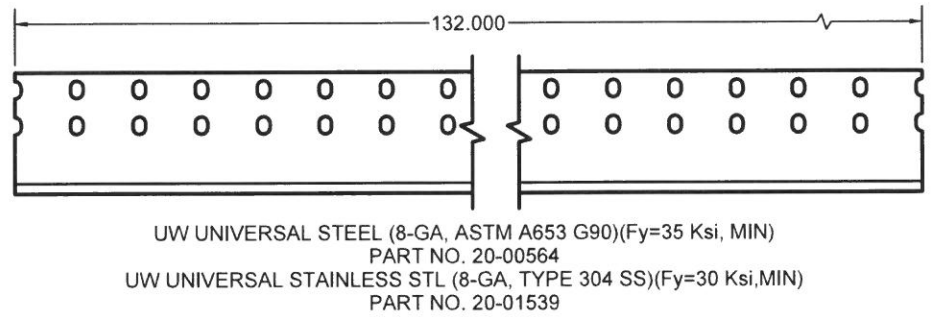
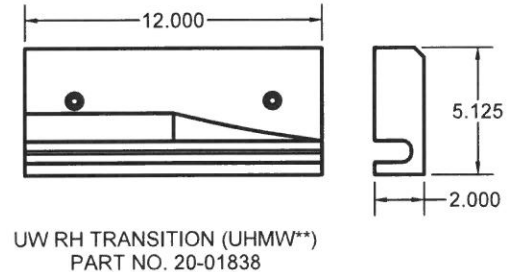
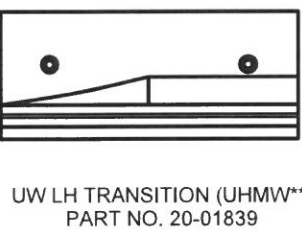
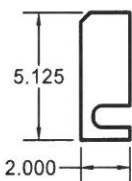
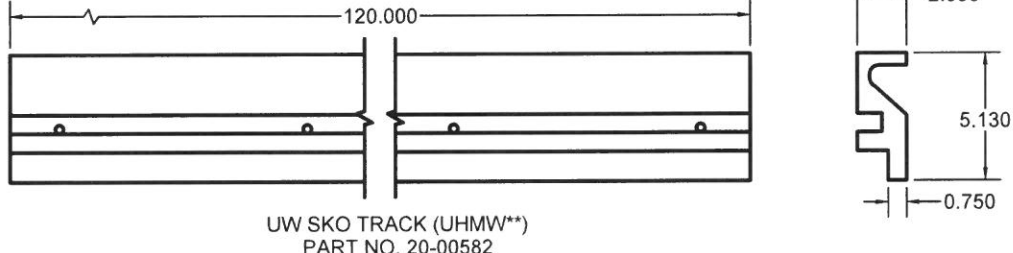
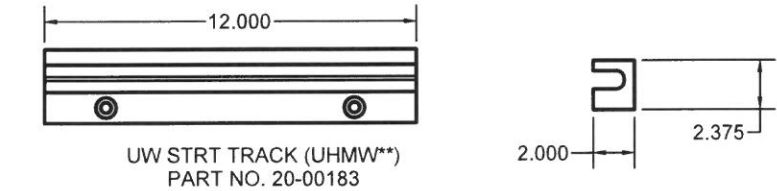
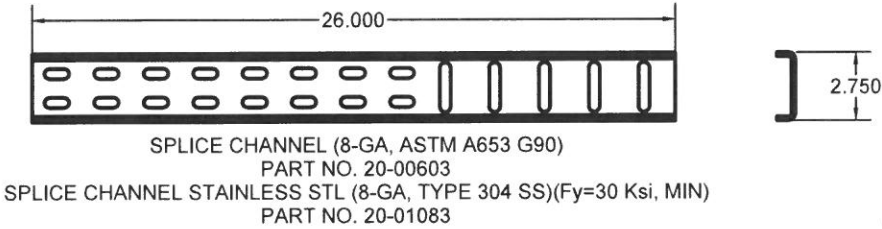
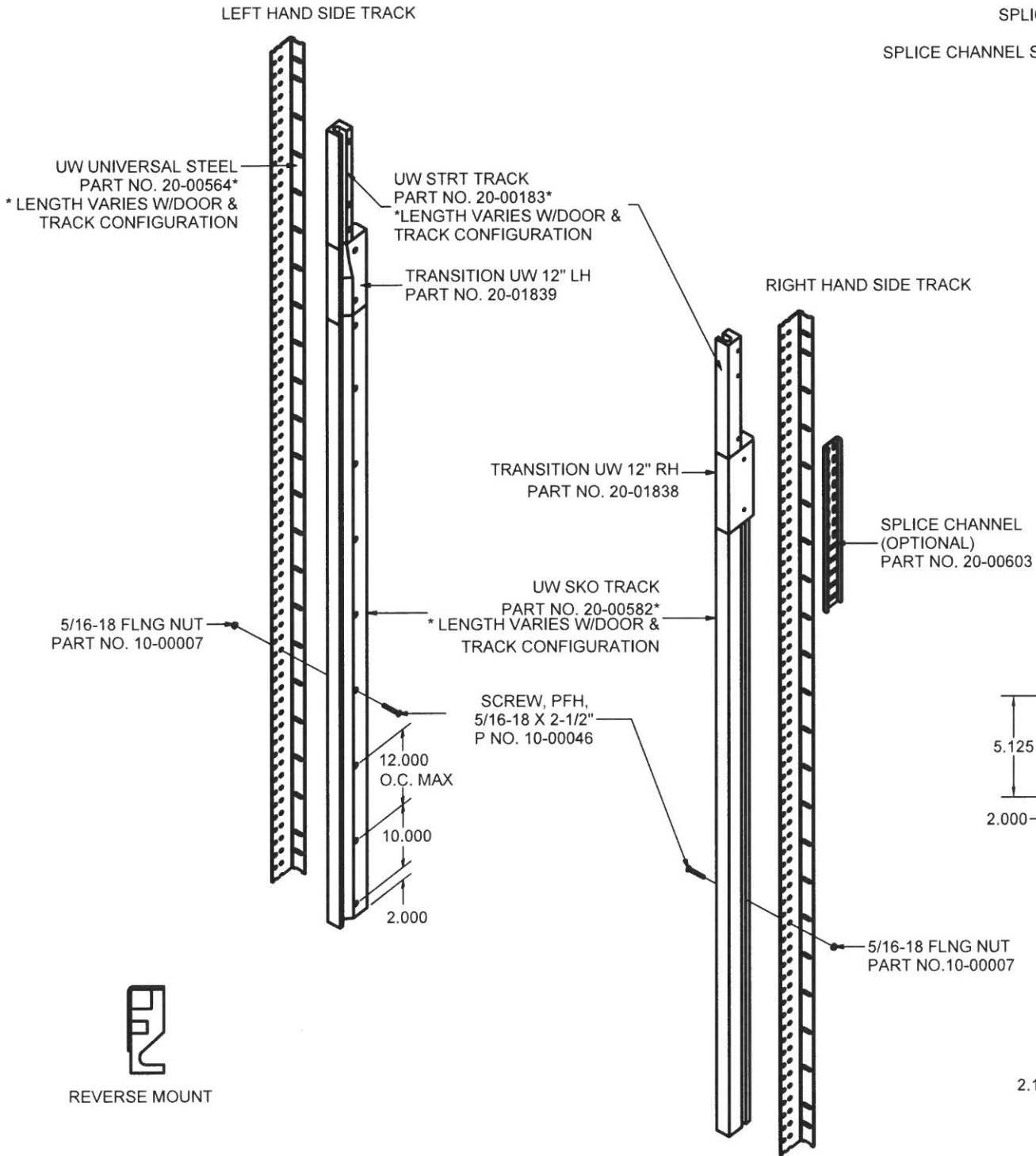

REVERSE MOUNT



STANDARD MOUNT

POSTAL ADDRESS:
2234 NORTH FEDERAL HWY #7664
BOCA RATON, FL 33431
ENGINEERINGEXPRESS.COM

TKO DOORS, DIVISION OF 4FRONT ENGINEERED SOLUTIONS, INC.
N56 W24701 NORTH CORPORATE CIRCLE, SUITE A
SUSSEX, WI 53089
PHONE: 1-800-575-3366 | FAX: (262) 246-1301
FIBERGLASS DOCK DOORS WW WL OVERHEAD GARAGE DOOR
FLORIDA BUILDING CODE EIGHTH EDITION (2023)
MIAMI-DADE COUNTY NOTICE OF ACCEPTANCE (NOA)

REMARKS	DRWN	CHKD	DATE
PREV. SUBMITTAL (20-26602)	RWN	RWN	07/30/20
2023 FBC UPDATE	MRT	RWN	11/15/23

PRODUCT REVISED
As complying with the Florida
Building Code
NOA-No. 24-0226.09
Expiration Date: 08/14/2029
By: *Manuel Perez*
Miami-Dade Product Control

23-60382
SCALE: NTS UNLESS NOTED
5

c:\users\milton\engineering\express\production - documents\projects\23-60382 2023 noa product update 20-0901.15\work\2023 fbc\docs for review\5 - 23-60382b noa dwg_recover.dwg 2/15/2024 3:00 PM MILTON

ANCHORING NOTES:

- 1. THIS SYSTEM SHALL BE ANCHORED WITH ANY OF THE ANCHORING METHODS SHOWN HEREIN, WITH A MINIMUM OF (2) ANCHORS LOCATED 3" AND 12" MAX. FROM THE BOTTOM OF THE TRACK AND 12" O.C. MAX THEREAFTER OR EVERY OTHER MOUNTING SLOT.
- 2. ANCHORS SHALL BE INSTALLED IN ACCORDANCE WITH MANUFACTURERS' RECOMMENDATIONS.
- 3. WHERE ANCHORS FASTEN TO NARROW FACE OF STUD FRAMING, ANCHOR SHALL BE LOCATED IN CENTER OF NOMINAL 2x (MIN) WOOD STUD (i.e. 3/4" EDGE DISTANCE IS ACCEPTABLE FOR ANCHORS TO WOOD FRAMING).
- 4. WOOD HOST STRUCTURE SHALL BE "SOUTHERN PINE" G=0.55 OR GREATER DENSITY.
- 5. MINIMUM EMBEDMENT SHALL BE AS NOTED IN ANCHOR DETAIL. MINIMUM EMBEDMENT AND EDGE DISTANCE EXCLUDES STUCCO, FOAM, BRICK, AND OTHER WALL FINISHES.
- 6. WHERE EXISTING STRUCTURE IS WOOD FRAMING, EXISTING CONDITIONS MAY VARY. FIELD VERIFY THAT FASTENERS ARE INTO ADEQUATE WOOD FRAMING MEMBERS, NOT INTO PLYWOOD.
- 7. WOOD BUCKS (BY OTHERS) SHALL BE ANCHORED PROPERLY TO TRANSFER LOADS TO THE EXISTING STRUCTURE.
- 8. MACHINE SCREWS SHALL HAVE MINIMUM OF 1/2" ENGAGEMENT OF THREADS IN BASE ANCHOR AND MAY HAVE EITHER A PAN HEAD, TRUSS HEAD, OR WAFER HEAD ("SIDEWALK BOLT") U.N.O.

PRODUCT REVISED
As complying with the Florida Building Code
NOA-No. 24-0226.09
Expiration Date: 08/14/2029
By: Manuel Perez
Miami-Dade Product Control

WW WL TRACK ANCHOR MOUNTING

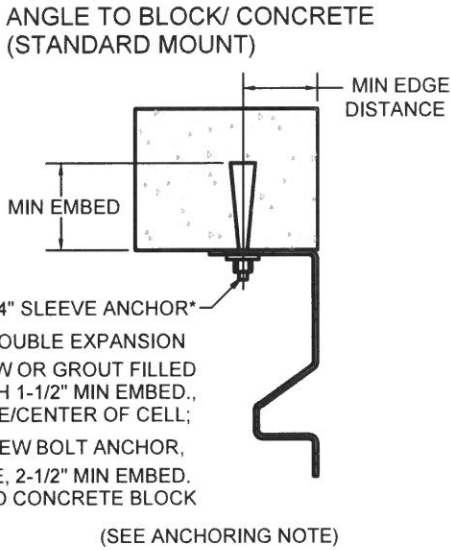

(SEE ANCHORING NOTE)

ANGLE TO STEEL WITH PLUG WELD (REVERSE MOUNT)

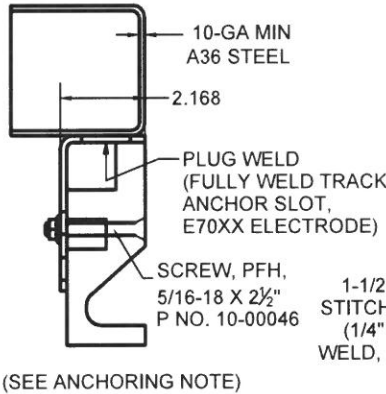

(SEE ANCHORING NOTE)

STEEL TRACK ANCHOR MOUNTING

ANGLE TO STEEL WITH PLUG WELD (STANDARD MOUNT)

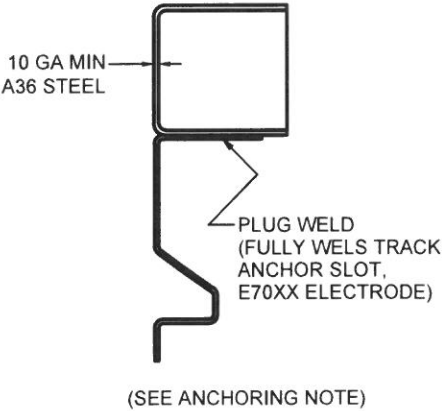

FH I-A-T TRACK ANCHOR MOUNTING

ANGLE TO STEEL WITH STITCH WELD (REVERSE MOUNT)

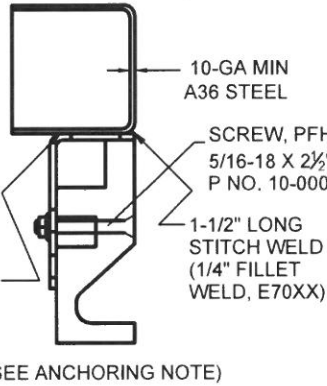

(SEE ANCHORING NOTE)

ANGLE TO STEEL WITH STITCH WELD (STANDARD MOUNT)

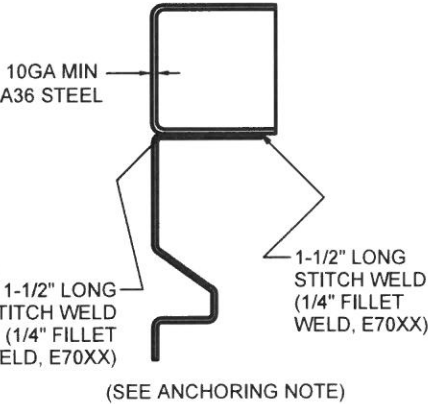

(SEE ANCHORING NOTE)

ANGLE TO BLOCK/ CONCRETE (STANDARD MOUNT)

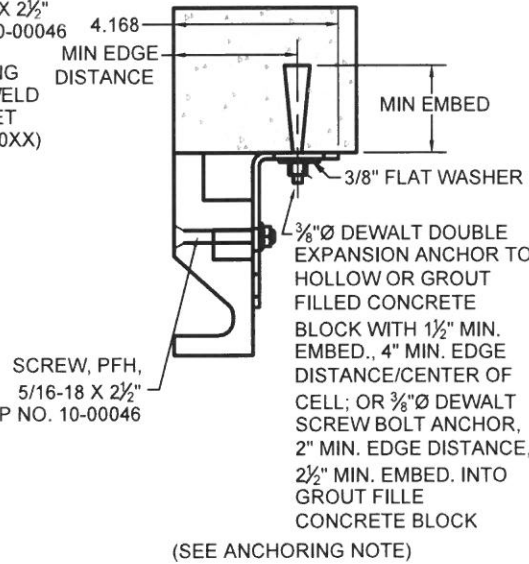

(SEE ANCHORING NOTE)

STEEL ANGLE TRACK ANCHOR SLOT

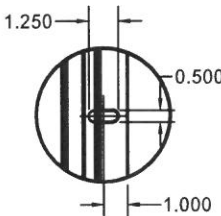

DETAIL A (SEE ANCHORING NOTE)

(FH I-A-T) STEEL ANGLE TRACK ANCHOR SLOT

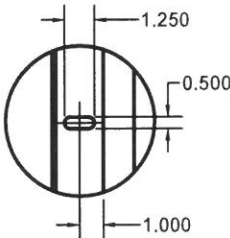

DETAIL B (SEE ANCHORING NOTE)

DETAIL C (SEE SHEET 5 OF 8 FOR DETAIL)

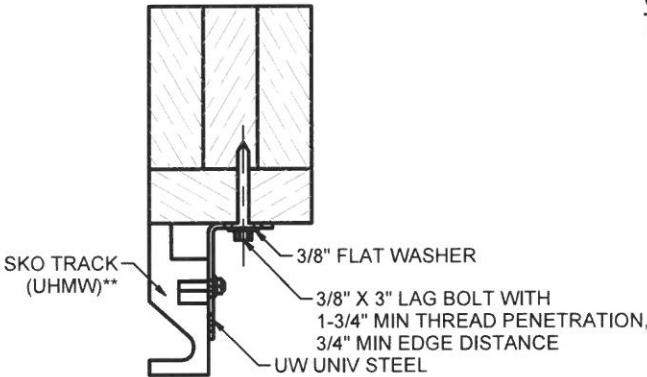
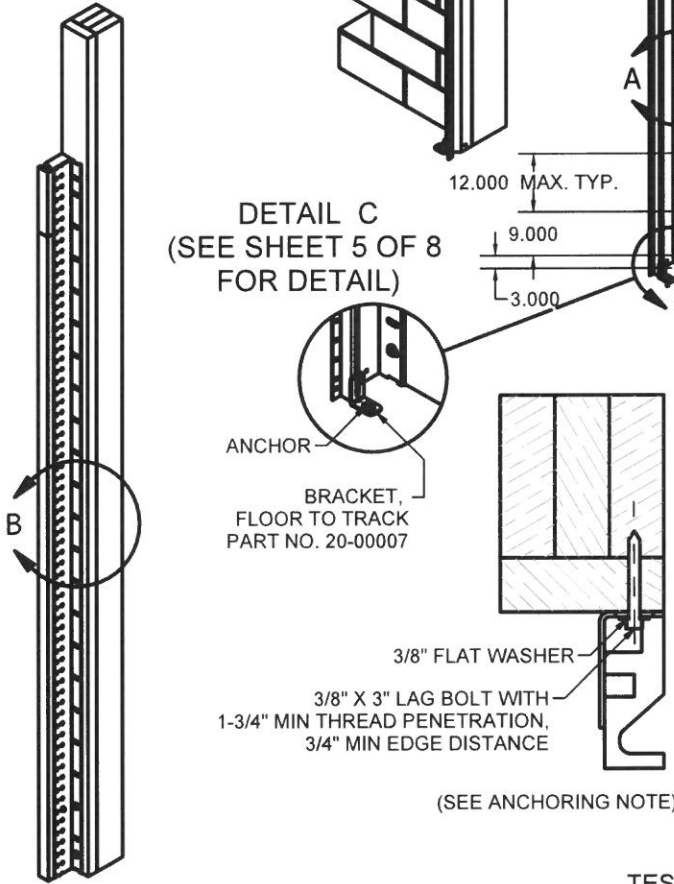

(SEE ANCHORING NOTE)
** ULTRA-HIGH-MOLECULAR-WEIGHT POLYETHYLENE

TEST MOUNTING ON WOOD

FRANK BENNARDO, P.E.
PE# 0046549 CA# 9885

FEBRUARY 15, 2024

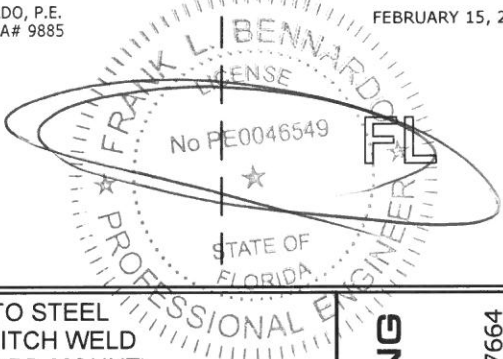

ENGINEERING EXPRESS

POSTAL ADDRESS:
2234 NORTH FEDERAL HWY #7664
BOCA RATON, FL 33431
ENGINEERINGEXPRESS.COM

TKO DOORS, DIVISION OF 4FRONT ENGINEERED SOLUTIONS, INC.

N56 W24701 NORTH CORPORATE CIRCLE, SUITE A

SUSSEX, WI 53089

PHONE: 1-800-575-3366 | FAX: (262) 246-1301

FIBERGLASS DOCK DOORS WW WL OVERHEAD GARAGE DOOR

FLORIDA BUILDING CODE EIGHTH EDITION (2023)

MIAMI-DADE COUNTY NOTICE OF ACCEPTANCE (NOA)

DATE	07/30/20
DRWN	RWN
CHKD	RWN
DATE	11/15/23
REMARKS	PREV. SUBMITTAL (20-26602) 2023 FBC UPDATE

COPYRIGHT ENGINEERING EXPRESS®

23-60382

SCALE: NTS UNLESS NOTED



c:\users\milton\engineering\express\production - documents\projects\23-60382 2023 noa product update 20-0901.15\work\2023 fbc\docs for review\5 - 23-60382b noa dwg_recover.dwg 2/15/2024 3:00 PM MILTON

FASTENER NOTE:

- 1. FIXED PLUNGERS, SPRING PLUNGERS, HANDLES, AND TPU BRACKETS ARE MOUNTED TO THE PANEL USING:
(4) 1/4-20 X 3.00" CARRIAGE BOLTS AND (4) 1/4-20 FLANGE NUTS.
- 2. HINGE SETS ARE MOUNTED TO THE PANELS USING:
(4) 1/4-20 X 3.00" CARRIAGE BOLTS AND 1/4-20 FLANGE NUTS.
- 3. PANEL PLATES ARE MOUNTED TO THE PANELS USING:
(12) 1/4-20 X 3.00" CARRIAGE BOLTS AND 1/4-20 FLANGE NUTS.
- 4. SLIDE LOCKS ARE MOUNTED TO THE PANELS USING:
(4) #14 X 3/4" TEK SCREWS.

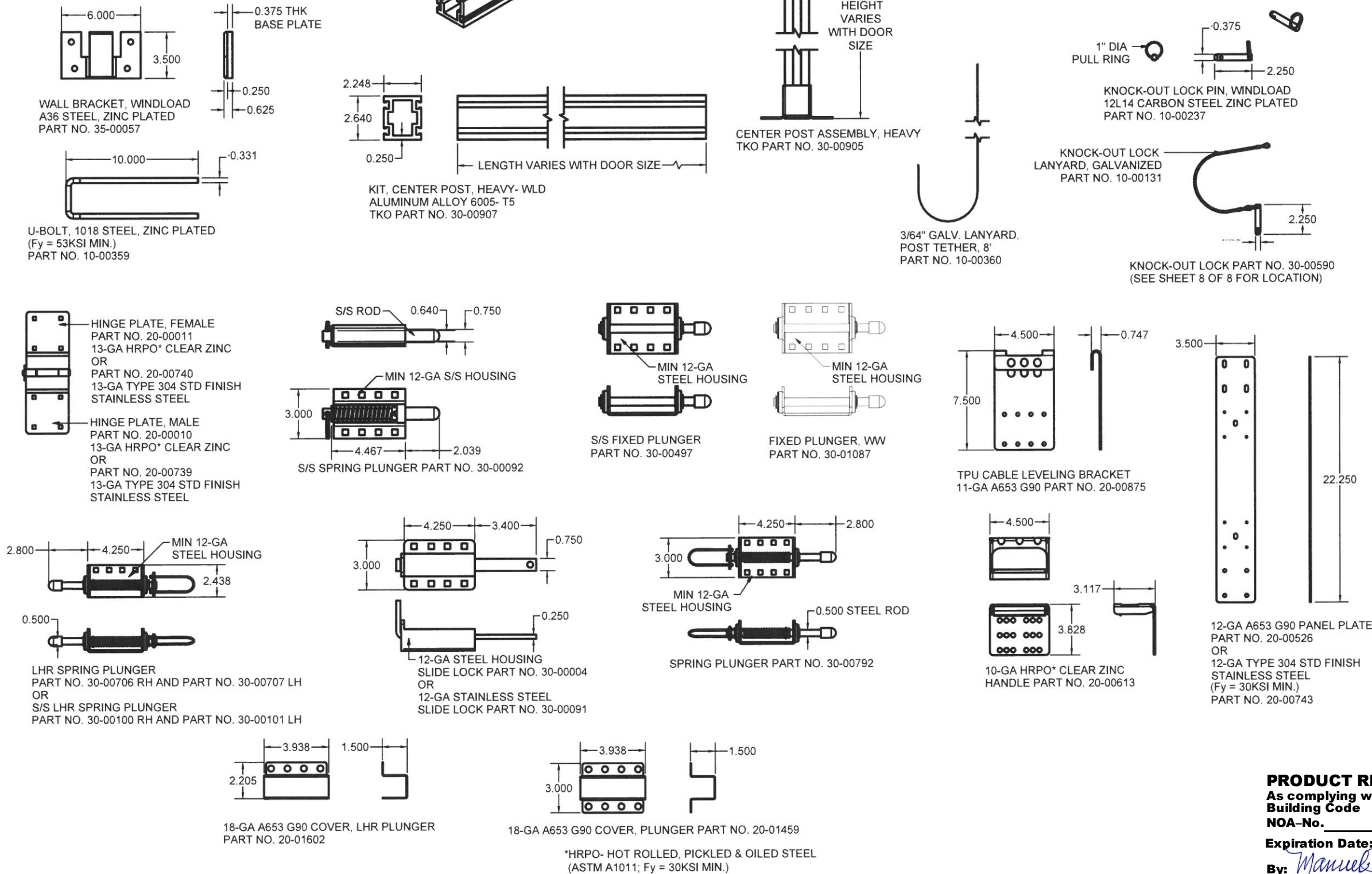

*HRPO- HOT ROLLED, PICKLED & OILED STEEL (ASTM A1011; Fy = 30KSI MIN.)

FRANK BENNARDO, P.E.
PE# 0046549 CA# 9885

FEBRUARY 15, 2024

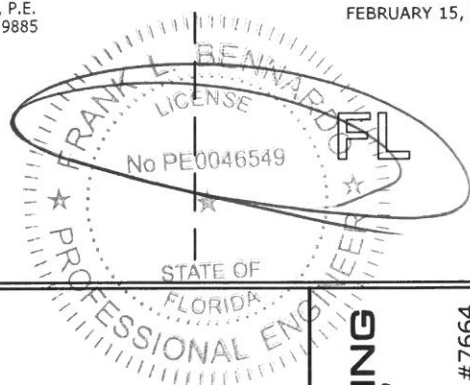

ENGINEERING EXPRESS
POSTAL ADDRESS:
2234 NORTH FEDERAL HWY #7664
BOCA RATON, FL 33431
ENGINEERINGEXPRESS.COM

TKO DOORS, DIVISION OF 4FRONT ENGINEERED SOLUTIONS, INC.
N56 W24701 NORTH CORPORATE CIRCLE, SUITE A
SUSSEX, WI 53089
PHONE: 1-800-575-3366 | FAX: (262) 246-1301
FIBERGLASS DOCK DOORS WW WL OVERHEAD GARAGE DOOR
FLORIDA BUILDING CODE EIGHTH EDITION (2023)
MIAMI-DADE COUNTY NOTICE OF ACCEPTANCE (NOA)

DATE	07/30/20	11/15/23			
DRWN	CHKD	RWN	RWN		
REMARKS	PREV. SUBMITTAL (20-26602)	EPR	MRT		
	2023 FBC UPDATE				

PRODUCT REVISED
As complying with the Florida Building Code
NOA-No. 24-0226.09
Expiration Date: **08/14/2029**
By: *Manuel Perez*
Miami-Dade Product Control

23-60382
SCALE: NTS UNLESS NOTED
7

WW WL PANEL HARDWARE (CONTINUED)

FRANK BENNARDO, P.E.
PE# 0046549 CA# 9885

FEBRUARY 15, 2024

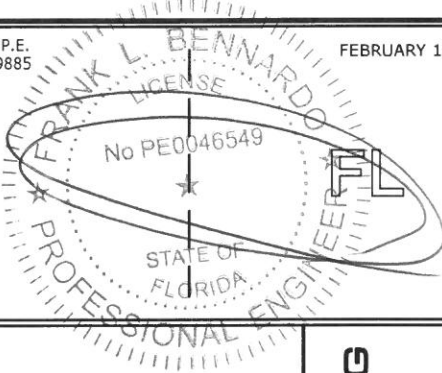

ENGINEERING EXPRESS
POSTAL ADDRESS:
2234 NORTH FEDERAL HWY #7664
BOCA RATON, FL 33431
ENGINEERINGEXPRESS.COM

TKO DOORS, DIVISION OF 4FRONT ENGINEERED SOLUTIONS, INC.
N56 W24701 NORTH CORPORATE CIRCLE, SUITE A
SUSSEX, WI 53089
PHONE: 1-800-575-3366 | FAX: (262) 246-1301
FIBERGLASS DOCK DOORS WW WL OVERHEAD GARAGE DOOR
FLORIDA BUILDING CODE EIGHTH EDITION (2023)
MIAMI-DADE COUNTY NOTICE OF ACCEPTANCE (NOA)

REMARKS	DATE	DRWN	CHKD
PREV. SUBMITTAL (20-26602)	07/30/20	RWN	RWN
2023 FBC UPDATE	11/15/23	MRT	RWN

COPYRIGHT ENGINEERING EXPRESS®

23-60382

SCALE: NTS UNLESS NOTED

8

PRODUCT REVISED
As complying with the Florida
Building Code
NOA-No. **24-0226.09**
Expiration Date: **08/14/2029**
By: *Manuel Perez*
Miami-Dade Product Control

WALL BRACKET, WINDLOAD
PART NO. 35-00057

3/8"X3" (X4) LAG BOLT WITH
1-3/4" MIN THREAD PENETRATION,
3/4" MIN. EDGE DISTANCE

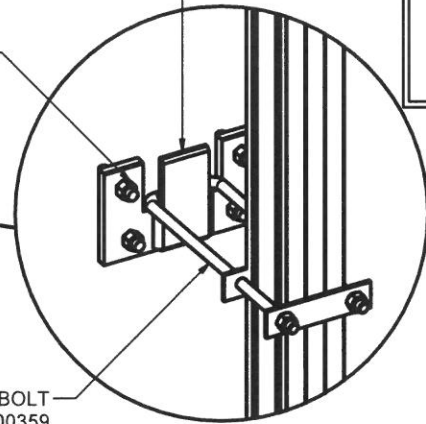

DETAIL A
SCALE 1 / 4

U-BOLT
PART NO. 10-00359

LANYARD ASSEMBLY
PART NO. 30-00916
SHALL BE ATTACHED TO POST
AND TRACK PER DETAILS "B" AND
"C"

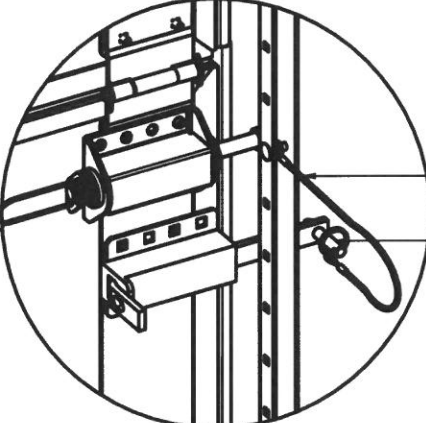

DETAIL B
SCALE 1 / 4

KNOCKOUT LANYARD
PART NO. 10-00131

KNOCKOUT PIN
PART NO. 10-00237

NOTE: REMOVE PINS FROM SLIDE LOCKS AFTER INSTALLATION. LATCH ONLY
IN THE ANTICIPATION OF HIGH WIND PRESSURE EVENT.

PANEL PLATE
PART NO. 20-00526

FIXED PLUNGER (X6)
QTY VARIES WITH DOOR SIZE
PART NO. 30-01087

HINGE SET, WW
PART NO. 30-00045

PANEL PLATE
PART NO. 20-00526

SLIDE LOCK ASSEMBLY (X16)
PART NO. 30-00004
#14 X 3/4" TEK SCREWS (X4)

SPRING PLUNGER (X6)
PART NO. 30-00792

PANEL PLATE
PART NO. 20-00526

KNOCKOUT LOCK (X16)
PART NO. 30-00590

HANDLE
PART NO. 20-00613

PANEL BRACKET, CENTER POST
(BOTTOM OF PANEL, ONE PER PANEL)
PART NO. 20-02018

KNOCK-OUT LOCK (X3)
PART NO. 30-00590

CENTER POST ASSEMBLY, HEAVY
TKO PART NO. 30-00905*
*MANUFACTURED BY SECURE ENTERPRISES, LLC

PANEL BRACKET, CENTER POST

1/4"-20 BOLT
AND NYLOK NUT

FINISHED FLOOR/
LEVELER BOARD

DETAIL C
SCALE 1/4

TOP PANEL

INTERMEDIATE PANEL

INTERMEDIATE PANEL

INTERMEDIATE PANEL

BOTTOM PANEL

INSIDE FACE OF PANEL

c:\users\milton\engineering\express\production - documents\projects\23-60382 2023 noa product update 20-0901.15\work\2023 fbc\docs for review\5 - 23-60382b noa dwg_recover.dwg 2/15/2024 3:00 PM MILTON