



DEPARTMENT OF REGULATORY AND ECONOMIC RESOURCES (RER)  
BOARD AND CODE ADMINISTRATION DIVISION

## NOTICE OF ACCEPTANCE (NOA)

MIAMI-DADE COUNTY  
PRODUCT CONTROL SECTION  
11805 SW 26 Street, Room 208  
Miami, Florida 33175-2474  
T (786) 315-2590 F (786) 315-2599  
[www.miamidade.gov/economy](http://www.miamidade.gov/economy)

E.S. Windows, LLC  
3550 NW 49 Street  
Miami, FL 33142

### SCOPE:

This NOA is being issued under the applicable rules and regulations governing the use of construction materials. The documentation submitted has been reviewed and accepted by Miami-Dade County RER -Product Control Section to be used in Miami Dade County and other areas where allowed by the Authority Having Jurisdiction (AHJ).

This NOA shall not be valid after the expiration date stated below. The Miami-Dade County Product Control Section (In Miami Dade County) and/or the AHJ (in areas other than Miami-Dade County) reserve the right to have this product or material tested for quality assurance purposes. If this product or material fails to perform in the accepted manner, the manufacturer will incur the expense of such testing and the AHJ may immediately revoke, modify, or suspend the use of such product or material within their jurisdiction. RER reserves the right to revoke this acceptance, if it is determined by Miami-Dade County Product Control Section that this product or material fails to meet the requirements of the applicable building code.

This product is approved as described herein and has been designed to comply with the Florida Building Code, including the High Velocity Hurricane Zone.

**DESCRIPTION:** Series “6000-3 Track” Aluminum Sliding Glass Doors –LMI

**APPROVAL DOCUMENT:** Drawing No. **18-35D Rev C**, titled “Series-6000-3 Track Alum Sliding Glass Door (LMI)”, sheets 1 through 12 of 12, prepared by Al-Farooq Corporation, dated 03-09-18 and last revised on JUL 17, 2023 signed and sealed by Jalal Farooq, P.E., bearing the Miami-Dade County Product Control Renewal stamp with the Notice of Acceptance number and expiration date by the Miami-Dade County Product Control Section.

**MISSILE IMPACT RATING:** Large and Small Missile Impact Resistant

**Limitations:** (6) Panels or less configured options (see sheet 3), not to exceed tested frame/panel area and tested panel height.

**LABELING:** Each unit shall bear a permanent label with the manufacturer's name or logo, **Barranquilla, Columbia** and series and following statement: "Miami-Dade County Product Control Approved", noted herein.

**RENEWAL** of this NOA shall be considered after a renewal application has been filed and there has been no change in the applicable building code negatively affecting the performance of this product.

**TERMINATION** of this NOA will occur after the expiration date or if there has been a revision or change in the materials, use, and/or manufacture of the product or process. Misuse of this NOA as an endorsement of any product, for sales, advertising or any other purposes shall automatically terminate this NOA. Failure to comply with any section of this NOA shall be cause for termination and removal of NOA.

**ADVERTISEMENT:** The NOA number preceded by the words Miami-Dade County, Florida, and followed by the expiration date may be displayed in advertising literature. If any portion of the NOA is displayed, then it shall be done in its entirety.

**INSPECTION:** A copy of this entire NOA shall be provided to the user by the manufacturer or its distributors and shall be available for inspection at the job site at the request of the Building Official.

This NOA **renews** NOA# **23-0724.17** and consists of this page 1 and evidence pages E-1, E-2, E-3 and E-4, as well as approval document mentioned above.

The submitted documentation was reviewed by **Ishaq I. Chanda, P.E.**

*Ishaq I. Chanda*



NOA No. 24-0312.05  
Expiration Date: August 22, 2029  
Approval Date: May 23, 2024  
Page 1

**NOTICE OF ACCEPTANCE: EVIDENCE SUBMITTED**

**1. EVIDENCE SUBMITTED UNDER PREVIOUS NOA's**

**A. DRAWINGS**

1. Manufacturer's die drawings and sections.
2. Drawing No. **W18-35D**, titled "Series-6000-3 Track Alum Sliding Glass Door (LMI)", sheets 1 through 12 of 12, prepared by Al-Farooq Corporation, dated 03/09/2018 with revision A dated 11/26/2018, signed and sealed by Javad Ahmad, P.E.

**B. TESTS**

1. Test reports on:
  - 1) Air Infiltration Test, per FBC, TAS 202-94
  - 2) Uniform Static Air Pressure Test, Loading per FBC TAS 202-94
  - 3) Water Resistance Test, per FBC, TAS 202-94
  - 4) Large Missile Impact Test per FBC, TAS 201-94
  - 5) Cyclic Wind Pressure Loading per FBC, TAS 203-94
  - 6) Forced Entry Test, per FBC 2411 3.2.1, TAS 202-94

Along with marked-up drawings and installation diagram of OXXXXX aluminum SGD, prepared by Fenestration Testing Laboratories, Test Report No. **FTL-8721**, dated 03/08/17, signed and sealed by Idalmis Ortega, P.E.

**C. CALCULATIONS**

1. Anchor verification calculations and structural analysis, complying with FBC-2017, prepared by Al-Farooq Corporation, dated 08/30/2017 and last revised on 01/19/2018, signed and sealed by Javad Ahmad, P.E. **(Submitted under NOA#16-1130.03)**
2. Glazing complies w/ ASTM E1300-09.

**D. QUALITY ASSURANCE**

1. Miami Dade Department of Regulatory and Economic Resources (RER).

**E. MATERIAL CERTIFICATIONS**

1. NOA No. **17-0808.02** issued to **Kuraray America, Inc.** for their "**SentryGlas® (Clear and White) Glass Interlayers**" dated 12/28/17, expiring on 07/04/23.

**F. STATEMENTS**

1. Statement letter of conformance, complying with **FBC 6<sup>th</sup> Edition (2017)**, dated January 12, 2018, issued by Al-Farooq Corporation, signed and sealed by Javad Ahmad, P.E. **(Submitted under NOA#16-1130.03)**
2. Lab compliance as part of the above referenced test report.
3. Distribution agreement between ES Windows-Energia Solar, SA, Colombia and ES Windows, LLC, USA, dated 10/29/10, signed by MS Carla Torrente and Andres Chomaro, respectively. **(Submitted under NOA#15-0430.04)**

**G. OTHER**

1. This is a Spin-off from NOA# **16-1130.03** (previous NOA#15-0430.04).

*Ishaq I. Chanda*

---

**Ishaq I. Chanda, P.E.**  
**Product Control Unit Supervisor**  
**NOA No. 24-0312.05**  
**Expiration Date: August 22, 2029**  
**Approval Date: May 23, 2024**

**NOTICE OF ACCEPTANCE: EVIDENCE SUBMITTED**

**2. NEW EVIDENCE SUBMITTED**

**A. DRAWINGS**

1. None.

**B. TESTS**

1. None

**C. CALCULATIONS**

1. None.

**D. QUALITY ASSURANCE**

1. Miami-Dade Department of Regulatory and Economic Resources (RER)

**E. MATERIAL CERTIFICATIONS**

1. Notice of Acceptance No. **20-0915.19** issued to **Kuraray America, Inc.** for their “SentryGlas® (Clear and White) Glass Interlayers” dated 11/19/20, expiring on 07/04/23.

**F. STATEMENTS**

1. Statement letter of conformance, complying with **FBC 7<sup>th</sup> Edition (2020)**, dated July 02, 2021, issued by Al-Farooq Corporation, signed and sealed by Jalal Farooq, P.E.

**G. OTHERS**

1. Notice of Acceptance No. **18-1004.05**, issued to E.S. Windows, LLC., for their Series “**6000-3 Track**” Aluminum Sliding Glass Doors –**LMI**, approved on 08/22/19 and expiring on 08/22/24.

*Ishaq I. Chanda*

---

**Ishaq I. Chanda, P.E.**  
**Product Control Unit Supervisor**  
**NOA No. 24-0312.05**  
**Expiration Date: August 22, 2029**  
**Approval Date: May 23, 2024**

**NOTICE OF ACCEPTANCE: EVIDENCE SUBMITTED**

**3. EVIDENCE SUBMITTED under previous approval**

**A. DRAWINGS**

1. Drawing No. **18-35D Rev C**, titled “Series-6000-3 Track Alum Sliding Glass Door (LMI)”, sheets 1 through 12 of 12, prepared by Al-Farooq Corporation, dated 03-09-18 and last revised on JUL 17, 2023 signed and sealed by Jalal Farooq, P.E.

**B. TESTS**

1. None.

**C. CALCULATIONS**

1. None.

**D. QUALITY ASSURANCE**

1. Miami-Dade Department of Regulatory and Economic Resources (RER)

**E. MATERIAL CERTIFICATIONS**

1. Notice of Acceptance No. **22-1116.01** issued to **Kuraray America, Inc.** for their “SentryGlas® (Clear and White) Glass Interlayers”, expiring on 07/04/28.

**F. STATEMENTS**

1. Statement letter of conformance, complying with **FBC 8<sup>th</sup> Edition (2023)**, dated July 17, 2023, issued by Al-Farooq Corporation, signed and sealed by Jalal Farooq, P.E.

**G. OTHERS**

1. This NOA **revises** NOA# **21-0719.06** and updates to FBC 2023, expiring 08/22/24.
2. Distribution agreement between ES Windows, LLC (distributor) and Energia Solar, S.A, (manufacturer, dated 08/01/18, signed by MS. Carla Garcia (MGR) and Ms. Evelyn Deas (MGR) respectively (submitted under previous approvals).

*Ishaq I. Chanda*

---

**Ishaq I. Chanda, P.E.**  
**Product Control Unit Supervisor**  
**NOA No. 24-0312.05**  
**Expiration Date: August 22, 2029**  
**Approval Date: May 23, 2024**

**NOTICE OF ACCEPTANCE: EVIDENCE SUBMITTED**

**4. NEW EVIDENCE SUBMITTED**

**A. DRAWINGS**

1. Drawing No. **18-35D Rev C**, titled “Series-6000-3 Track Alum Sliding Glass Door (LMI)”, sheets 1 through 12 of 12, prepared by Al-Farooq Corporation, dated 03-09-18 and last revised on JUL 17, 2023 signed and sealed by Jalal Farooq, P.E.

**B. TESTS**

1. None.

**C. CALCULATIONS**

1. None.

**D. QUALITY ASSURANCE**

1. Miami-Dade Department of Regulatory and Economic Resources (RER)

**E. MATERIAL CERTIFICATIONS**

1. Notice of Acceptance No. **22-1116.01** issued to **Kuraray America, Inc.** for their “SentryGlas® (Clear and White) Glass Interlayers”, expiring on 07/04/28.

**F. STATEMENTS**

1. Statement letter of conformance, complying with **FBC 8<sup>th</sup> Edition (2023)**, dated 03/07/24, issued by Al-Farooq Corporation, signed and sealed by Jalal Farooq, P.E
2. Statement letter of conformance, complying with **FBC 8<sup>th</sup> Edition (2023)**, dated July 17, 2023, issued by Al-Farooq Corporation, signed and sealed by Jalal Farooq, P.E. (submitted under previous approval)

**G. OTHERS**

1. This NOA **renews** NOA# **23-0724.17** and updates to FBC 2023, expiring 08/22/29.
2. Distribution agreement between ES Windows, LLC (distributor) and Energia Solar, S.A, (manufacturer, dated 08/01/18, signed by MS. Carla Garcia (MGR) and Ms. Evelyn Deas (MGR) respectively (submitted under previous approvals).

*Ishaq I. Chanda*

---

**Ishaq I. Chanda, P.E.**  
**Product Control Unit Supervisor**  
**NOA No. 24-0312.05**  
**Expiration Date: August 22, 2029**  
**Approval Date: May 23, 2024**

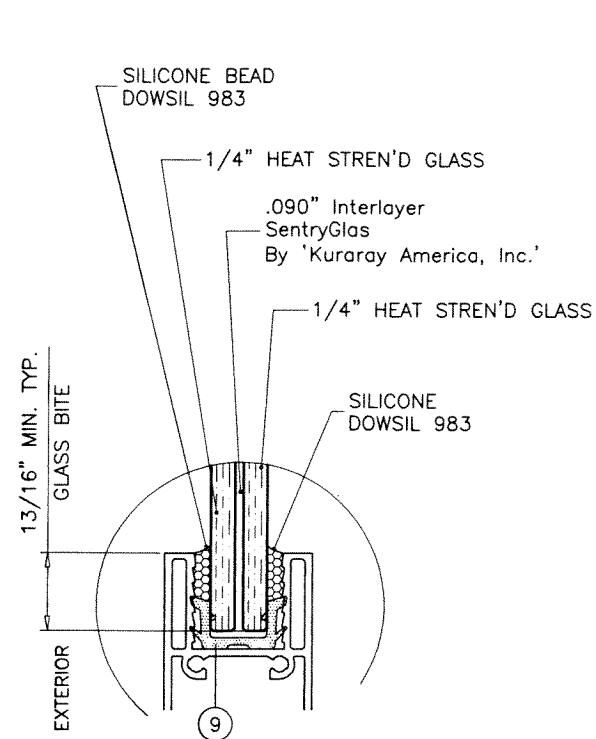

**GLASS TYPE 'A'**  
9/16" OVERALL LAM. GLASS

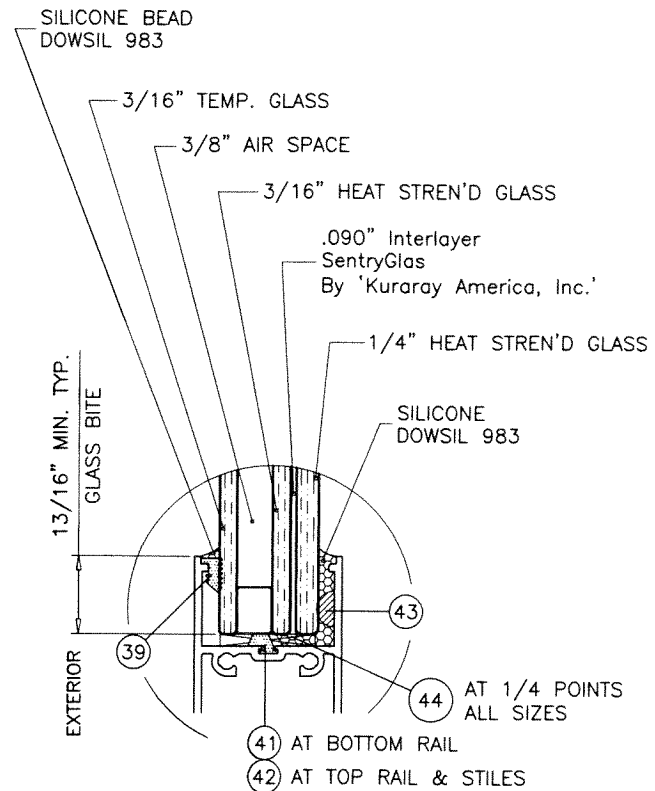

**GLASS TYPE 'B'**  
1-1/16" OVERALL INSUL. LAM. GLASS

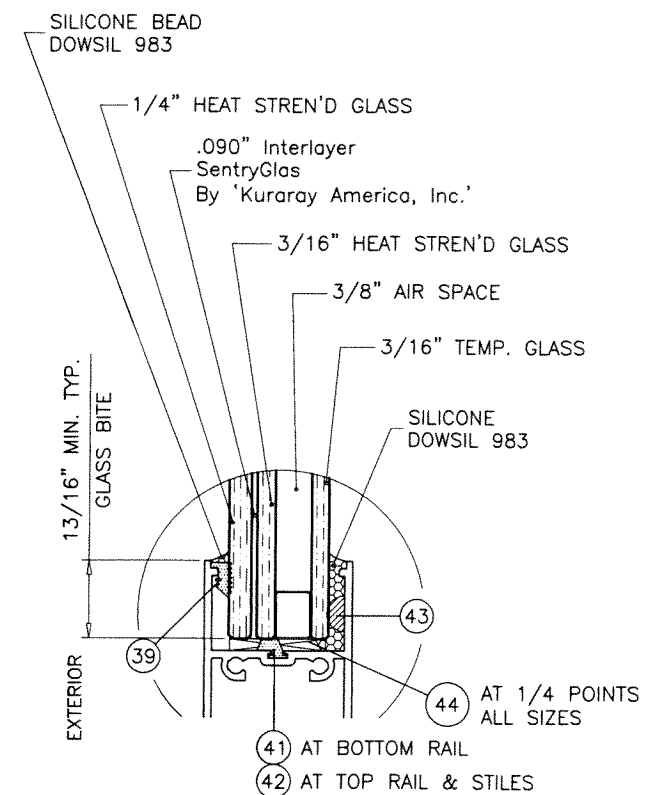

**GLASS TYPE 'B' (REVERSE)**  
1-1/16" OVERALL INSUL. LAM. GLASS

### GLAZING OPTIONS

### SERIES-6000-3 TRACK ALUMINUM SLIDING GLASS DOOR

SEE SHEET 4 FOR DESIGN LOAD CAPACITY OF DESIRED GLASS SIZE AND REQUIRED REINFORCING.

USING CHART ON SHEET 5 SELECT ANCHOR OPTION WITH DESIGN RATING MORE THAN DESIGN LOADS REQUIRED.

LOWER DESIGN PRESSURES FROM GLASS OR ANCHOR CHARTS WILL APPLY TO ENTIRE SYSTEM.

THIS PRODUCT HAS BEEN DESIGNED AND TESTED TO COMPLY WITH THE REQUIREMENTS OF THE 2020 (7TH EDITION)/2023 (8TH EDITION) FLORIDA BUILDING CODE INCLUDING HIGH VELOCITY HURRICANE ZONE (HVHZ).

1BY OR 2BY WOOD BUCKS & BUCK FASTENERS BY OTHERS, MUST BE DESIGNED AND INSTALLED ADEQUATELY TO TRANSFER APPLIED PRODUCT LOADS TO THE BUILDING STRUCTURE.

ANCHORS SHALL BE CORROSION RESISTANT, SPACED AS SHOWN ON DETAILS AND INSTALLED PER MANUF'S INSTRUCTIONS. SPECIFIED EMBEDMENT TO BASE MATERIAL SHALL BE BEYOND WALL DRESSING OR STUCCO.

A LOAD DURATION INCREASE IS USED IN DESIGN OF ANCHORS INTO WOOD ONLY.

ALL SHIMS TO BE HIGH IMPACT, NON-METALLIC AND NON-COMPRESSIBLE.

MATERIALS INCLUDING BUT NOT LIMITED TO STEEL/METAL SCREWS, THAT COME INTO CONTACT WITH OTHER DISSIMILAR MATERIALS SHALL MEET THE REQUIREMENTS OF THE 2020/2023 FLORIDA BLDG. CODE & ADOPTED STANDARDS.

THIS PRODUCT APPROVAL IS GENERIC AND DOES NOT PROVIDE INFORMATION FOR A SITE SPECIFIC PROJECT, i.e. LIFE SAFETY OF THIS PRODUCT, ADEQUACY OF STRUCTURE RECEIVING THIS PRODUCT AND SEALING AROUND OPENING FOR WATER INFILTRATION RESISTANCE ETC. CONDITIONS NOT SHOWN IN THIS DRAWING ARE TO BE ANALYZED SEPARATELY, AND TO BE REVIEWED BY BUILDING OFFICIAL.

DESIGN LOADS SHOWN ARE BASED ON 'ALLOWABLE STRESS DESIGN (ASD)'.

**PRODUCT RENEWED**  
as complying with the Florida  
Building Code  
NOA-No. 24-0312.05

Expiration Date 08/22/2029

By Ishag I. Chande  
Miami-Dade Product Control

**PRODUCT REVISED**  
as complying with the Florida  
Building Code  
NOA-No. 23-0724.17

Expiration Date 08/22/2024

By Ishag I. Chande  
Miami-Dade Product Control

### 3/8" AIR SPACE CONSISTING OF:

#### SPACER:

'HELIMA' LOW PROFILE ALUMINUM SPACER BY 'LINGERMANN GMBH' AROUND THE PERIMETER OF THE GLASS.

#### PERIMETER SEALANT:

SILICONE  
DOWSIL 791  
GE 2000

JUL 17 2023

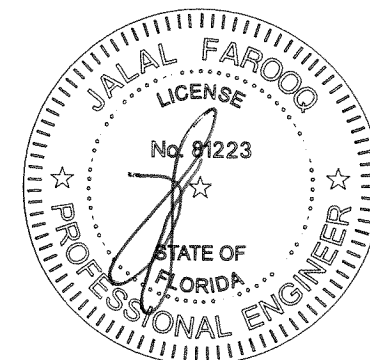

**AL-FAROOQ CORPORATION**  
ENGINEERS & PRODUCT DEVELOPMENT  
9360 SUNSET DRIVE, SUITE 220  
MIAMI, FLORIDA 33173  
TEL. (305) 264-8100 FAX. (305) 262-6978  
(C.A.N. 3538)

SERIES-6000-3 TRACK ALUM SLIDING GL. DOOR (L.M.I.)

**E.S. WINDOWS, LLC**  
3550 N.W. 49 STREET  
MIAMI, FL. 33142  
TEL. (305) 638-5151 FAX. (305) 638-5158

revisions:	no	date	by	description
	A	11.26.18		REV. PER PER COMMENTS
	B	06.22.21		UPDATED TO 2020 FBC
	C	07.14.23		UPDATED TO 2023 FBC
date:	03-09-18			
scale:	-			
dr. by:	TARIQ			
chk. by:				
drawing no.	18-35D			
sheet	1 of 12			

COMP-ANL 18-35D-ES



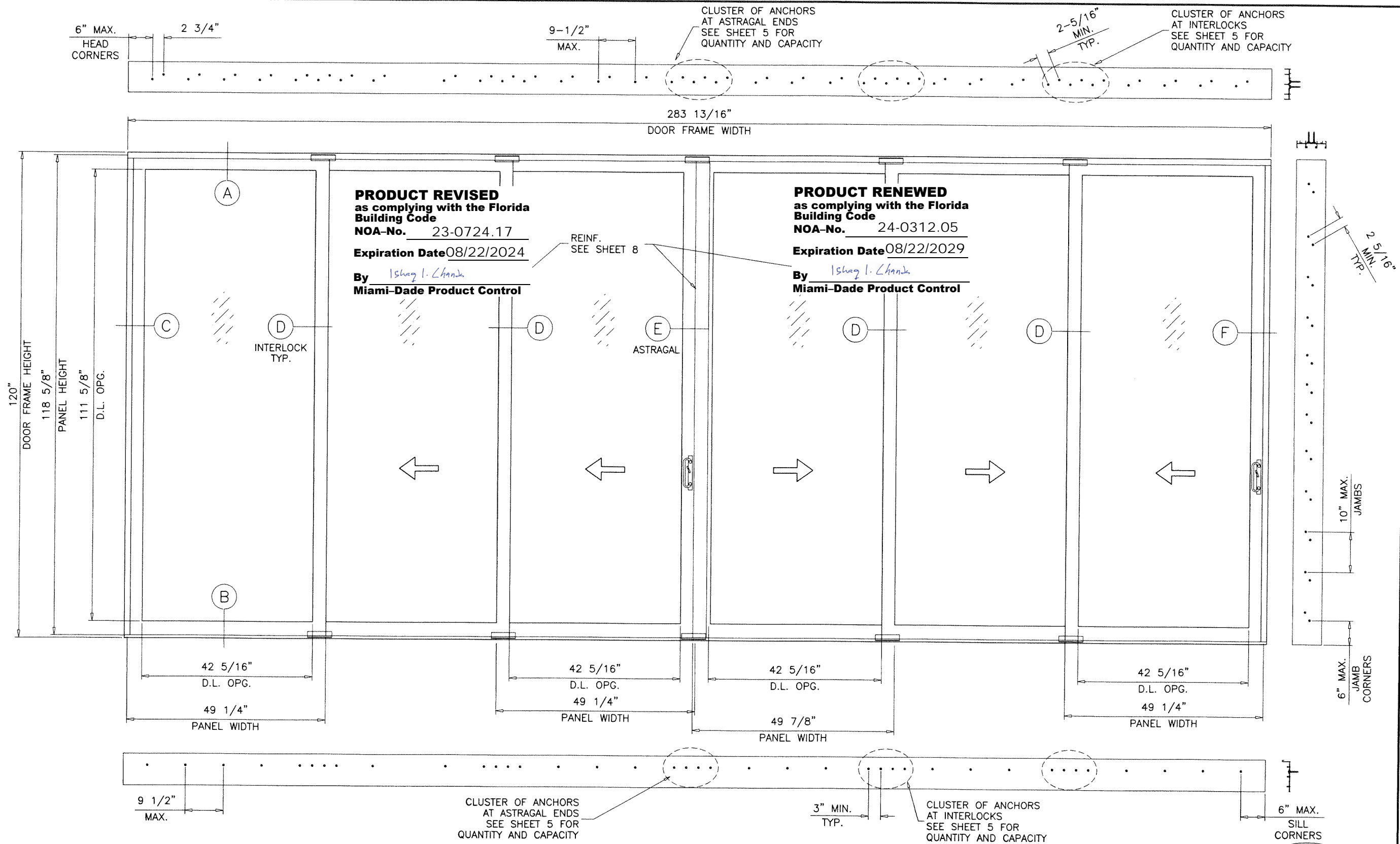

TYPICAL ELEVATION  
THREE (3) TRACK DOORS  
OXXXXX

DAYLITE OPENINGS:  
D.L.O. HEIGHT = PANEL HEIGHT - 7.000"  
D.L.O. WIDTH = PANEL WIDTH - 6.937"  
PANEL HEIGHT = FRAME HEIGHT - 1.375"

JUL 17 2023

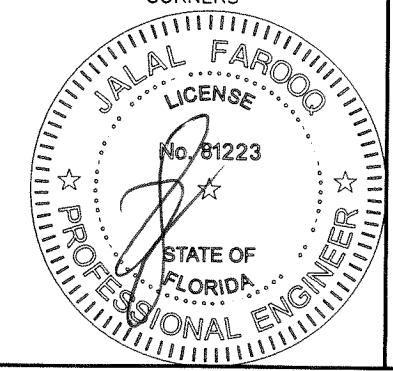

**af c**  
**AL-FAROOQ CORPORATION**  
ENGINEERS & PRODUCT DEVELOPMENT  
9360 SUNSET DRIVE, SUITE 220 (C.A.N. 3538)  
MIAMI, FLORIDA 33173  
TEL. (305) 264-8100 FAX. (305) 262-6978  
COMP-ANL 18-35D-ES

SERIES-6000-3 TRACK ALUM SLIDING GL. DOOR (L.M.I.)  
**E.S. WINDOWS, LLC**  
3550 N.W. 49 STREET  
MIAMI, FL. 33142  
TEL. (305) 638-5151 FAX. (305) 638-5158

no	date	by	description
A	11.26.18	REV.	PER PER COMMENTS
B	06.22.21	REV.	UPDATED TO 2020 FBC
C	07.14.23	NO	CHANGE THIS SHEET

date: 03-09-18  
scale: -  
dr. by: TARIQ  
chk. by:

drawing no.  
**18-35D**  
sheet 2 of 12

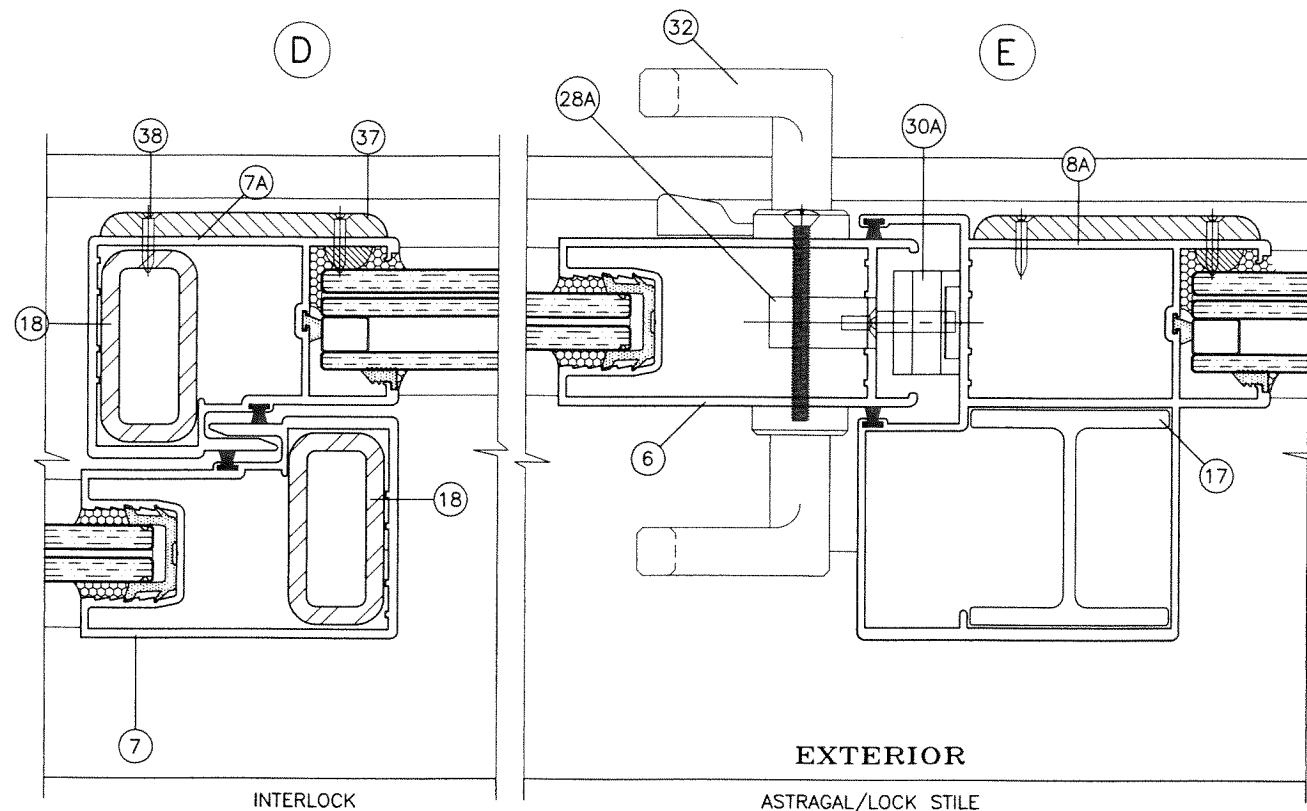

STEEL REINFORCING AT INTERLOCK  
ALUMINUM REINFORCING AT ASTRAGAL

**PRODUCT RENEWED**  
as complying with the Florida  
Building Code  
NOA-No. 24-0312.05  
Expiration Date 08/22/2029  
By Ishaq I. Chande  
Miami-Dade Product Control

**PRODUCT REVISED**  
as complying with the Florida  
Building Code  
NOA-No. 23-0724.17  
Expiration Date 08/22/2024  
By Ishaq I. Chande  
Miami-Dade Product Control

NOTE:  
GLASS CAPACITIES ON THIS SHEET ARE  
BASED ON ASTM E1300-09 (3 SEC. GUSTS)  
AND FLORIDA BUILDING COMMISSION  
DECLARATORY STATEMENT DCA05-DEC-219

DESIGN LOAD CAPACITY - PSF REINFORCING AT INTERLOCK & ASTRAGAL (3 TRACK FRAMES)							
PANEL WIDTH NOMINAL INCHES	DOOR FRAME HEIGHT INCHES	GLASS TYPE 'A'		GLASS TYPE 'B'		GLASS TYPE 'B' REVERSE	
		EXT. (+)	INT. (-)	EXT. (+)	INT. (-)	EXT. (+)	INT. (-)
36	82	85.0	110.0	85.0	110.0	85.0	110.0
40		85.0	110.0	85.0	110.0	85.0	110.0
44		85.0	110.0	85.0	110.0	85.0	110.0
48		85.0	110.0	85.0	110.0	85.0	110.0
50		81.6	110.0	81.6	110.0	81.6	105.6
53		77.0	110.0	77.0	110.0	77.0	99.6
56		72.9	110.0	72.9	110.0	72.9	94.3
60		68.0	104.0	68.0	104.0	68.0	88.0
36	96	85.0	110.0	85.0	110.0	85.0	110.0
40		85.0	110.0	85.0	110.0	85.0	110.0
44		85.0	110.0	85.0	110.0	85.0	110.0
48		85.0	110.0	85.0	110.0	85.0	110.0
50		81.6	110.0	81.6	110.0	81.6	105.6
53		77.0	110.0	77.0	110.0	77.0	99.6
56		72.9	110.0	72.9	110.0	72.9	94.3
60		68.0	104.0	68.0	104.0	68.0	88.0
36	102	85.0	110.0	85.0	110.0	85.0	110.0
40		85.0	110.0	85.0	110.0	85.0	110.0
44		85.0	110.0	85.0	110.0	85.0	110.0
48		85.0	110.0	85.0	110.0	85.0	110.0
50		81.6	110.0	81.6	110.0	81.6	105.6
53		77.0	110.0	77.0	110.0	77.0	99.6
56		72.9	110.0	72.9	110.0	72.9	94.3
36	108	85.0	110.0	85.0	110.0	85.0	110.0
40		85.0	110.0	85.0	110.0	85.0	110.0
44		85.0	110.0	85.0	110.0	85.0	110.0
48		85.0	110.0	85.0	110.0	85.0	110.0
50		81.6	110.0	81.6	110.0	81.6	105.6
53		77.0	110.0	77.0	110.0	77.0	99.6
56		72.9	110.0	72.9	110.0	72.9	94.3
36	114	85.0	110.0	85.0	110.0	85.0	110.0
40		85.0	110.0	85.0	110.0	85.0	110.0
44		85.0	110.0	85.0	110.0	85.0	110.0
48		85.0	110.0	85.0	110.0	85.0	110.0
50		81.6	105.6	81.6	105.6	81.6	105.6
53		77.0	110.0	77.0	110.0	77.0	99.6
56		72.9	110.0	72.9	110.0	72.9	94.3
36	120	85.0	110.0	85.0	110.0	85.0	110.0
40		85.0	110.0	85.0	110.0	85.0	110.0
44		85.0	110.0	85.0	110.0	85.0	110.0
48		85.0	110.0	85.0	110.0	85.0	110.0
50		81.6	105.6	81.6	105.6	81.6	105.6
53		77.0	110.0	77.0	110.0	77.0	99.6
56		72.9	110.0	72.9	110.0	72.9	94.3

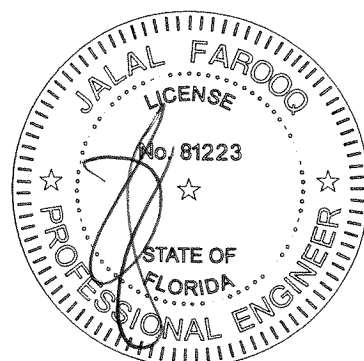

JUL 17 2023

**af c**

**AL-FAROOQ CORPORATION**  
ENGINEERS & PRODUCT DEVELOPMENT  
9360 SUNSET DRIVE, SUITE 220  
MIAMI, FLORIDA 33173  
TEL. (305) 264-8100 FAX. (305) 262-6978  
(C.A.N. 3538)

SERIES-6000-3 TRACK ALUM SLIDING GL. DOOR (L.M.I.)

**E.S. WINDOWS, LLC**  
3550 N.W. 49 STREET  
MIAMI, FL. 33142  
TEL. (305) 638-5151 FAX. (305) 638-5158

revisions:  
no. date by description  
A 11.26.18 NO CHANGE THIS SHEET  
B 06.22.21 UPDATED TO 2020 FBC  
C 07.14.23 NO CHANGE THIS SHEET

date: 03-09-18  
scale: 1/2" = 1"  
dr. by: TARIQ  
chk. by:

drawing no.  
**18-35D**

sheet 4 of 12



HEAD ANCHOR LOAD CAPACITY - PSF					
AVERAGE PANEL WIDTH INCHES	DOOR FRAME HEIGHT INCHES	ANCHOR TYPE 'A'		ANCHOR TYPE 'B'	ANCHOR TYPE 'C'
		6 ANCHORS AT MTG.	7 ANCHORS AT MTG.	6 ANCHORS AT MTG.	6 ANCHORS AT MTG.
		STILE ENDS	STILE ENDS	STILE ENDS	STILE ENDS
		INT. (-)	INT. (-)	INT. (-)	INT. (-)
30	82	110.0	110.0	110.0	110.0
36		110.0	110.0	110.0	110.0
40		110.0	110.0	110.0	110.0
42		110.0	110.0	110.0	110.0
44		110.0	110.0	110.0	110.0
48		110.0	110.0	110.0	110.0
50		110.0	110.0	110.0	110.0
53		110.0	110.0	110.0	110.0
56	96	110.0	110.0	110.0	110.0
60		110.0	110.0	110.0	110.0
30		110.0	110.0	110.0	110.0
36		110.0	110.0	110.0	110.0
40		110.0	110.0	110.0	110.0
42		110.0	110.0	110.0	110.0
44		110.0	110.0	110.0	110.0
48		110.0	110.0	110.0	110.0
50	102	110.0	110.0	110.0	110.0
53		110.0	110.0	110.0	110.0
56		94.3	94.3	94.3	94.3
60		88.0	88.0	88.0	88.0
30		110.0	110.0	110.0	110.0
36		110.0	110.0	110.0	110.0
40		110.0	110.0	110.0	110.0
42		110.0	110.0	110.0	110.0
44	108	110.0	110.0	110.0	110.0
48		110.0	110.0	110.0	110.0
50		107.3	110.0	110.0	110.0
53		99.6	99.6	99.6	99.6
56		94.3	94.3	94.3	94.3
30		110.0	110.0	110.0	110.0
36		110.0	110.0	110.0	110.0
40		110.0	110.0	110.0	110.0
42	114	110.0	110.0	110.0	110.0
44		109.1	110.0	110.0	110.0
48		102.4	110.0	110.0	110.0
50		99.5	105.6	105.6	105.6
53		95.6	99.6	99.6	99.6
30		110.0	110.0	110.0	110.0
36		110.0	110.0	110.0	110.0
40		109.8	110.0	110.0	110.0
42	120	105.7	110.0	110.0	110.0
44		102.0	110.0	110.0	110.0
48		95.6	110.0	110.0	110.0
50		92.8	108.3	110.0	110.0
30		110.0	110.0	110.0	110.0
36		110.0	110.0	110.0	110.0
40		103.2	110.0	110.0	110.0
42		99.3	110.0	110.0	110.0
44	120	95.8	110.0	110.0	110.0
48		89.6	104.6	110.0	110.0

EXT.(+) Dp = 85 PSF MAX.

SILL ANCHOR LOAD CAPACITY - PSF			
AVERAGE PANEL WIDTH INCHES	DOOR FRAME HEIGHT INCHES	ANCHOR TYPE 'B'	
		4 ANCHORS AT MTG.	5 ANCHORS AT MTG.
		STILE ENDS	STILE ENDS
		INT. (-)	INT. (-)
30	82	110.0	110.0
36		110.0	110.0
40		110.0	110.0
42		110.0	110.0
44		110.0	110.0
48		110.0	110.0
50		110.0	110.0
53		110.0	110.0
56	96	110.0	110.0
60		110.0	110.0
30		110.0	110.0
36		110.0	110.0
40		110.0	110.0
42		110.0	110.0
44		110.0	110.0
48		110.0	110.0
50	102	110.0	110.0
53		110.0	110.0
56		94.3	94.3
60		88.0	88.0
30		110.0	110.0
36		110.0	110.0
40		110.0	110.0
42	108	110.0	110.0
44		110.0	110.0
48		110.0	110.0
50		110.0	110.0
53		99.6	99.6
56		94.3	94.3
30		110.0	110.0
36		110.0	110.0
40	114	110.0	110.0
42		110.0	110.0
44		110.0	110.0
48		110.0	110.0
50		105.6	105.6
53		99.6	99.6
30		110.0	110.0
36		110.0	110.0
40	120	110.0	110.0
42		110.0	110.0
44		110.0	110.0
48		104.0	110.0
50		101.0	110.0
30		110.0	110.0
36		110.0	110.0
40		110.0	110.0
42	120	108.1	110.0
44		104.2	110.0
48	120	97.5	110.0

NOTE:  
SEE SHEET 4 FOR DESIGN LOAD CAPACITY OF DESIRED GLASS SIZE.  
USING CHART ON THIS SHEET SELECT ANCHOR OPTION WITH DESIGN RATING MORE THAN  
DESIGN LOADS REQUIRED.  
LOWER DESIGN PRESSURES FROM GLASS OR HEAD, SILL, JAMB ANCHOR CHARTS WILL  
APPLY TO ENTIRE SYSTEM.

## TYPICAL ANCHORS: SEE ELEV. FOR SPACING

### AT HEAD

TYPE 'A'- 1/4" DIA. ULTRACON+ BY 'DEWALT' (Fu=164 KSI, Fy=148 KSI)  
INTO 2BY WOOD BUCKS OR WOOD STRUCTURES  
1-1/2" MIN. PENETRATION INTO WOOD

THRU 1BY BUCKS INTO CONCRETE  
1-1/2" MIN. EMBED INTO CONCRETE

TYPE 'B'- 1/4" DIA. ULTRACON+ BY 'DEWALT' (Fu=164 KSI, Fy=148 KSI)  
DIRECTLY INTO CONCRETE  
1-1/2" MIN. EMBED

TYPE 'C'- #14 SMS OR SELF DRILLING SCREWS (GRADE 2 CRS)  
INTO MIAMI-DADE COUNTY APPROVED MULLIONS  
OR  
INTO METAL STRUCTURES  
(3) THREADS MIN. TO EXTEND BEYOND METAL THICKNESS  
ALUMINUM: 1/8" THK. MIN. (6063-T5 MIN.)  
STEEL: 1/8" THK. MIN. (Fy = 36 KSI MIN.)  
(STEEL IN CONTACT WITH ALUMINUM TO BE PLATED OR PAINTED)

**PRODUCT REVISED**  
as complying with the Florida  
Building Code  
NOA-No. 23-0724.17

Expiration Date 08/22/2024

By Ishaq I. Chande  
Miami-Dade Product Control

**PRODUCT RENEWED**  
as complying with the Florida  
Building Code  
NOA-No. 24-0312.05

Expiration Date 08/22/2029

By Ishaq I. Chande  
Miami-Dade Product Control

### AT SILL

TYPE 'B'- 1/4" DIA. ULTRACON+ BY 'DEWALT' (Fu=164 KSI, Fy=148 KSI)  
DIRECTLY INTO CONCRETE  
1-3/4" MIN. EMBED

### AT JAMBS

TYPE 'A'- 1/4" DIA. ULTRACON+ BY 'DEWALT' (Fu=164 KSI, Fy=148 KSI)  
INTO 2BY WOOD BUCKS OR WOOD STRUCTURES  
1-1/2" MIN. PENETRATION INTO WOOD

THRU 1BY BUCKS INTO CONC. OR BLOCKS  
1-1/4" MIN. EMBED INTO CONC. OR BLOCKS

TYPE 'B'- 1/4" DIA. ULTRACON+ BY 'DEWALT' (Fu=164 KSI, Fy=148 KSI)  
DIRECTLY INTO CONC. OR BLOCKS  
1-1/4" MIN. EMBED INTO CONC. OR BLOCKS

TYPE 'C'- #14 SMS OR SELF DRILLING SCREWS (GRADE 2 CRS)  
INTO MIAMI-DADE COUNTY APPROVED MULLIONS  
OR  
INTO METAL STRUCTURES  
(3) THREADS MIN. TO EXTEND BEYOND METAL THICKNESS  
ALUMINUM: 1/8" THK. MIN. (6063-T5 MIN.)  
STEEL: 1/8" THK. MIN. (Fy = 36 KSI MIN.)  
(STEEL IN CONTACT WITH ALUMINUM TO BE PLATED OR PAINTED)

### ANCHOR EDGE DISTANCES

INTO CONCRETE = 2-1/2" MIN.  
INTO WOOD STRUCTURE = 1" MIN.  
INTO METAL STRUCTURE = 3/4" MIN.

WOOD AT HEAD OR JAMBS SG = 0.55 MIN.  
CONCRETE AT HEAD, SILL OR JAMBS f'c = 3000 PSI MIN.  
C-90 HOLLOW/FILLED BLOCK AT JAMBS f'm = 2000 PSI MIN.

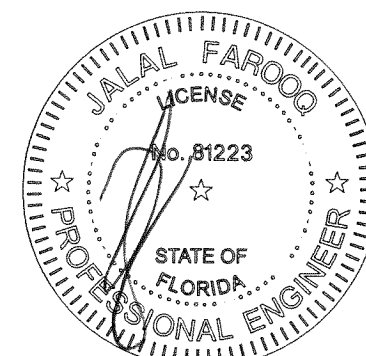

JUL 17 2023

**AL-FAROOQ CORPORATION**  
ENGINEERS & PRODUCT DEVELOPMENT  
9360 SUNSET DRIVE, SUITE 220  
MIAMI, FLORIDA 33173  
TEL. (305) 264-8100 FAX. (305) 262-6978

SERIES-6000-3 TRACK ALUM SLIDING GL. DOOR (L.M.I.)

**E.S. WINDOWS, LLC**  
3550 N.W. 49 STREET  
MIAMI, FL. 33142  
TEL. (305) 638-5151 FAX. (305) 638-5158

revisions:

no	date	by	description
A	11.26.18		NO CHANGE THIS SHEET
B	06.22.21		UPDATED TO 2020 FBC
C	07.14.23		NO CHANGE THIS SHEET

date: 03-09-18

scale: -

dr. by: TARIQ

chk. by:

drawing no.

**18-35D**

sheet 5 of 12

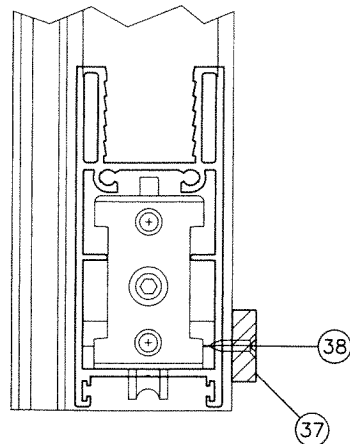
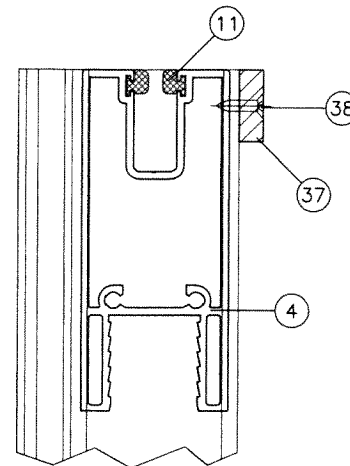
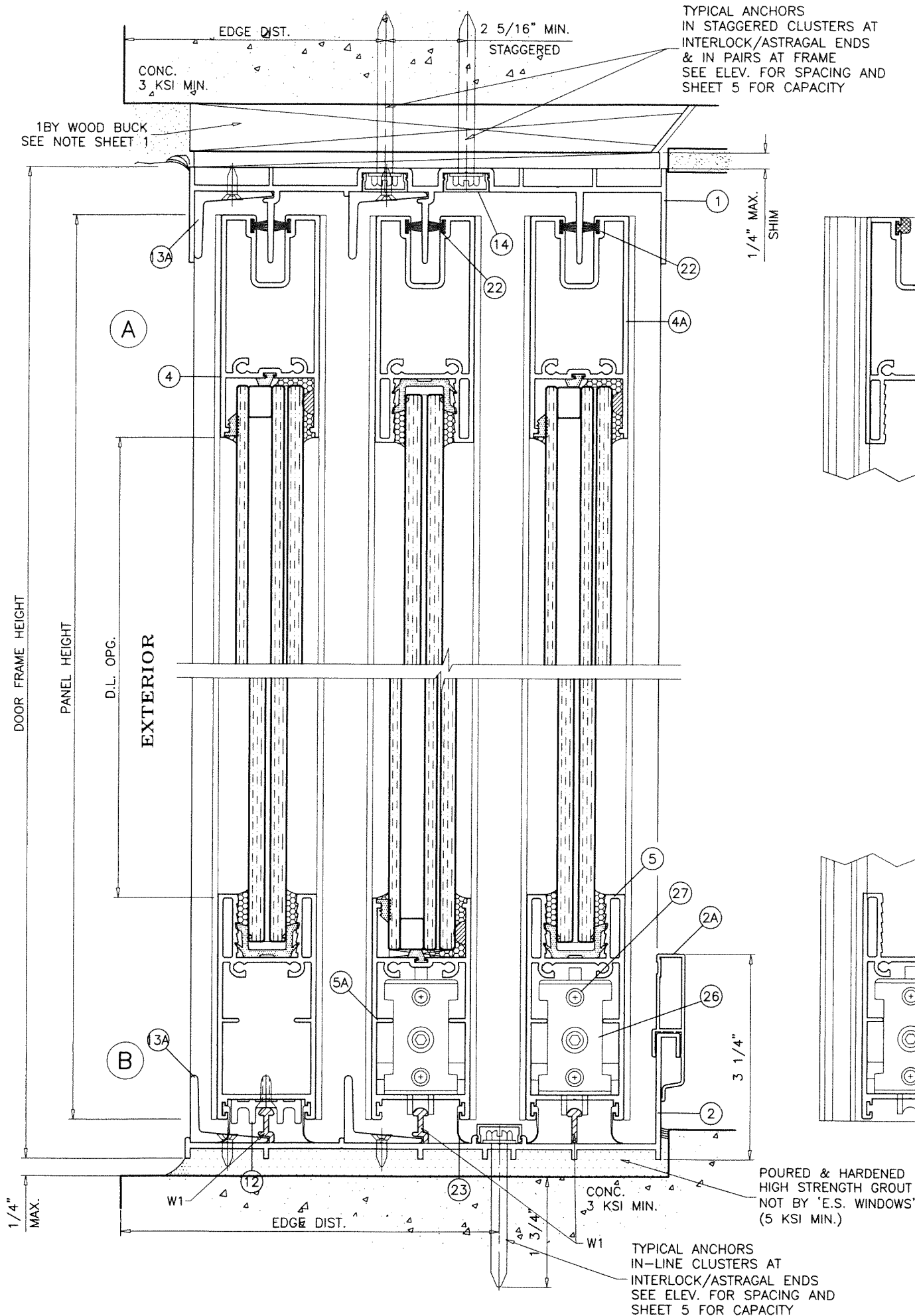

**PRODUCT RENEWED**  
as complying with the Florida  
Building Code  
NOA-No. 24-0312.05  
Expiration Date 08/22/2029  
By Ishay I. Chandra  
Miami-Dade Product Control

**PRODUCT REVISED**  
as complying with the Florida  
Building Code  
NOA-No. 23-0724.17  
Expiration Date 08/22/2024  
By Ishay I. Chandra  
Miami-Dade Product Control

**SEALANT:**

ALL JOINTS AND FRAME CONNECTIONS SEALED WITH WHITE/ALUMINUM COLORED SILICONE.

**WEEPHOLES:**

W1 = 2-5/8" LONG WEEP NOTCH AT EACH END

JUL 17 2023

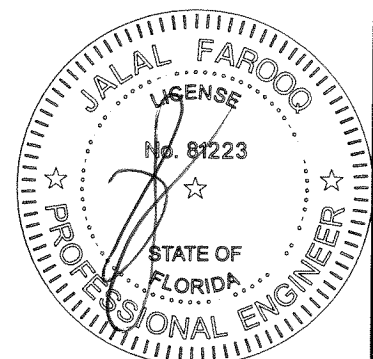

**AL-FAROOQ CORPORATION**  
ENGINEERS & PRODUCT DEVELOPMENT  
9360 SUNSET DRIVE, SUITE 220  
MIAMI, FLORIDA 33173  
TEL. (305) 264-8100 FAX. (305) 262-6978

COMP-ANL 18-35D-ES

---

SERIES-6000-3 TRACK ALUM SLIDING GL. DOOR (L.M.I.)

**E.S. WINDOWS, LLC**  
3550 N.W. 49 STREET  
MIAMI, FL. 33142  
TEL. (305) 638-5151 FAX. (305) 638-5158

---

REVISIONS:		no	date	by	description
A	11.26.18	REV. PER RER COMMENTS			
B	06.22.21	UPDATED TO 2020 FBC			
C	07.14.23	NO CHANGE THIS SHEET			

---

date: 03-09-18  
scale: 1/2" = 1"  
dr. by: TARIQ  
chk. by:

drawing no.  
**18-35D**  
sheet 6 of 12



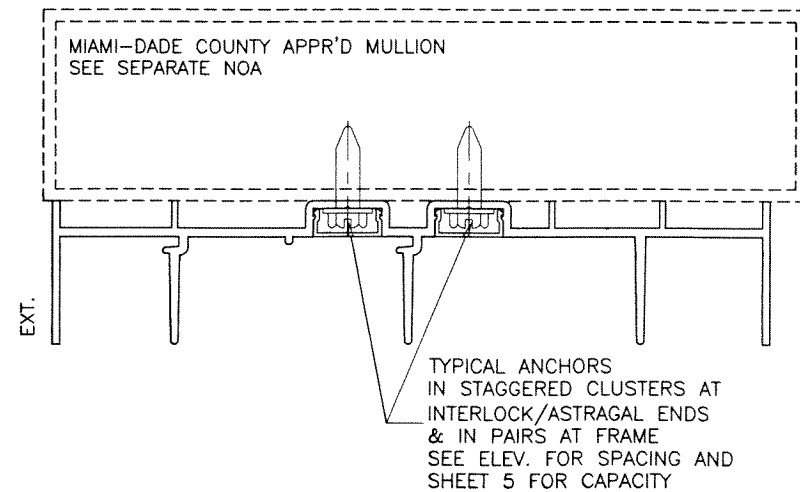
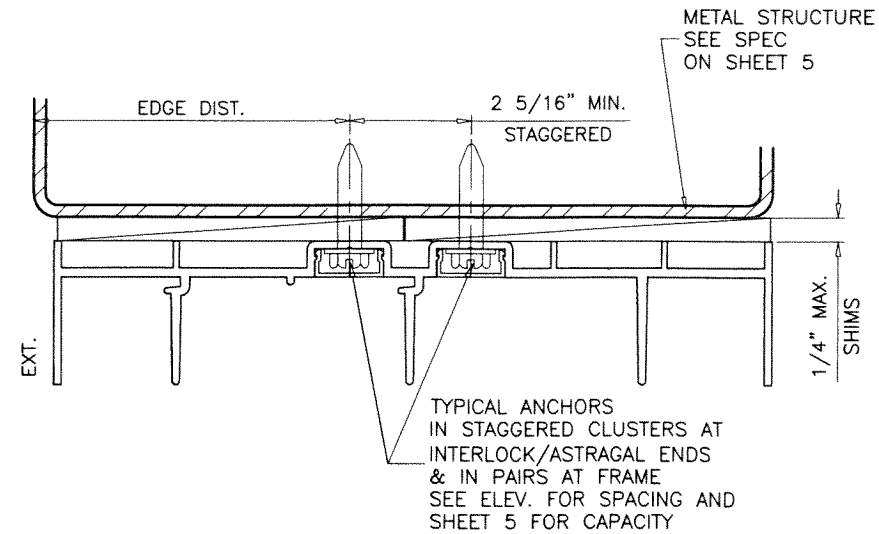
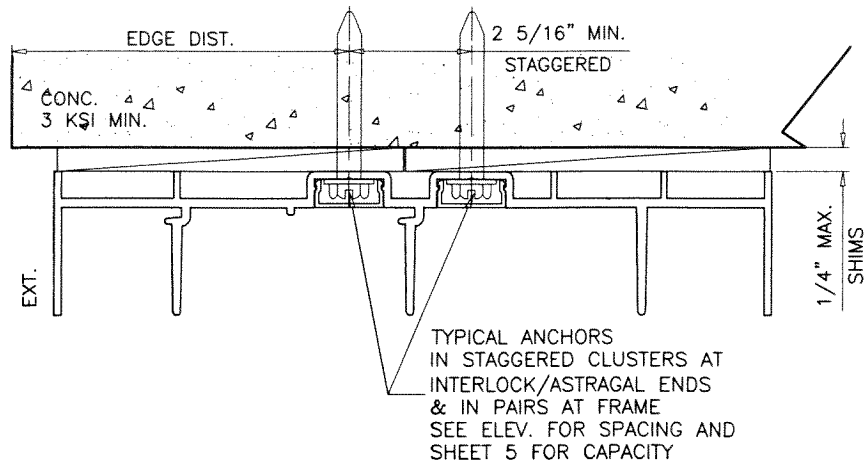
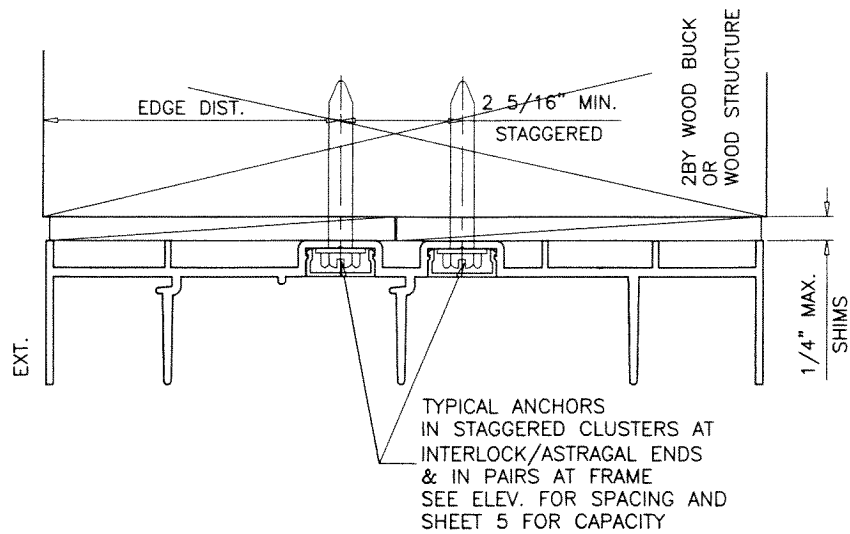

**PRODUCT RENEWED**  
as complying with the Florida  
Building Code  
NOA-No. 24-0312.05  
Expiration Date 08/22/2029  
By Ishag I. Chande  
Miami-Dade Product Control

**PRODUCT REVISED**  
as complying with the Florida  
Building Code  
NOA-No. 23-0724.17  
Expiration Date 08/22/2024  
By Ishag I. Chande  
Miami-Dade Product Control

JUL 17 2023

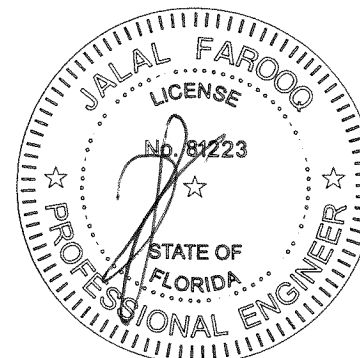

**AL-FAROOQ CORPORATION**  
ENGINEERS & PRODUCT DEVELOPMENT  
9360 SUNSET DRIVE, SUITE 220  
MIAMI, FLORIDA 33173  
TEL. (305) 264-8100 FAX. (305) 262-6978

**af c**  
(C.A.N. 3538)  
COMP-ANL\18-35D-ES

---

SERIES-6000-3 TRACK ALUM SLIDING GL. DOOR (L.M.I.)

**E.S. WINDOWS, LLC**  
3550 N.W. 49 STREET  
MIAMI, FL. 33142  
TEL. (305) 638-5151 FAX. (305) 638-5158

---

revisions:		description	
no	date	by	description
A	11.26.18		NO CHANGE THIS SHEET
B	06.22.21		UPDATED TO 2020 FBC
C	07.14.23		NO CHANGE THIS SHEET

---

date: 03-09-18  
scale: 1/2" = 1"  
dr. by: TARIQ  
chk. by:

drawing no.  
**18-35D**  
sheet 7 of 12

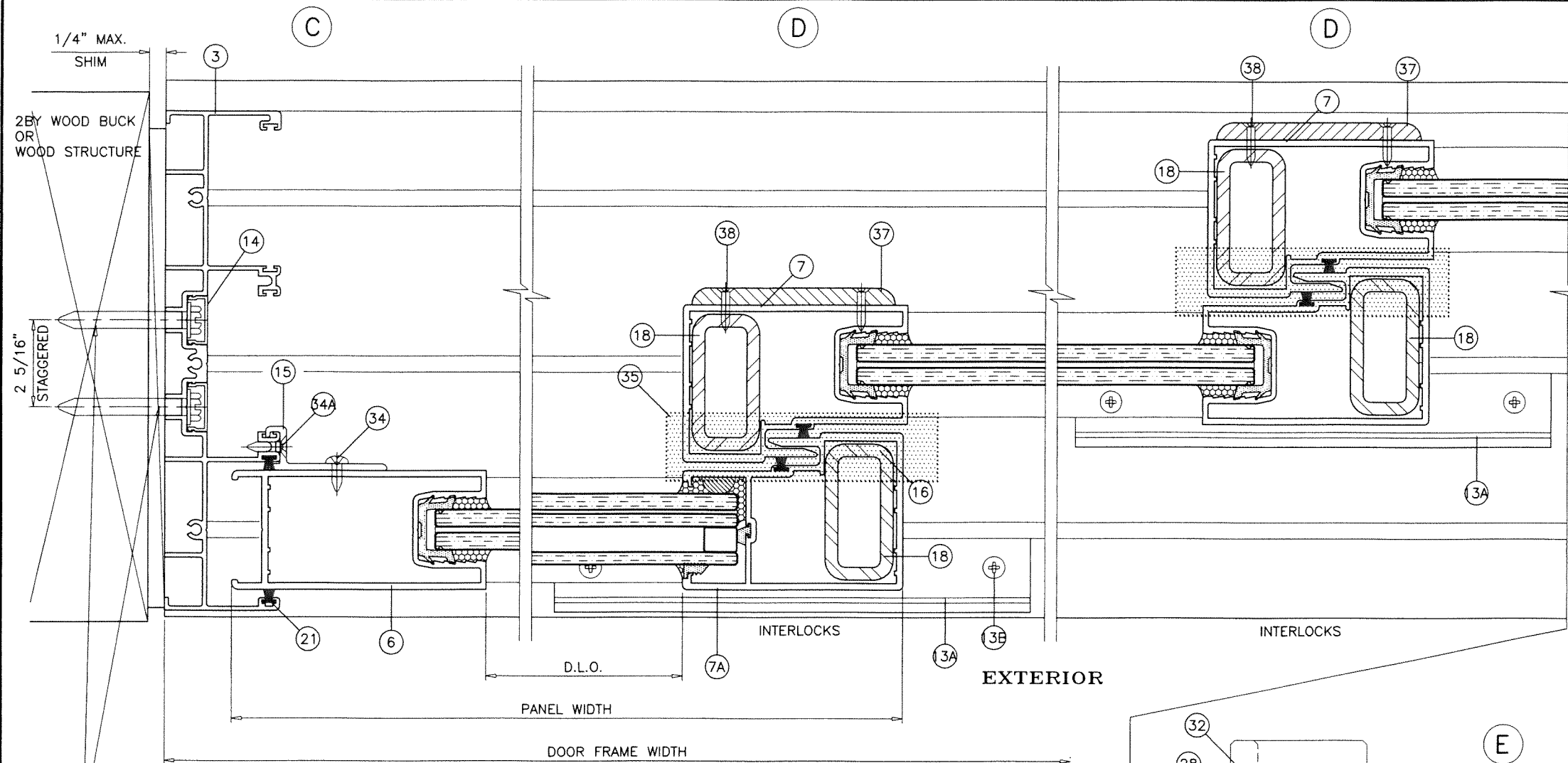

TYPICAL ANCHORS IN PAIRS  
SEE ELEV. FOR SPACING  
AND SHEET 5 FOR DESCRIPTION

**PRODUCT RENEWED**  
as complying with the Florida  
Building Code  
NOA-No. 24-0312.05  
Expiration Date 08/22/2029  
By *Ishag I. Chande*  
Miami-Dade Product Control

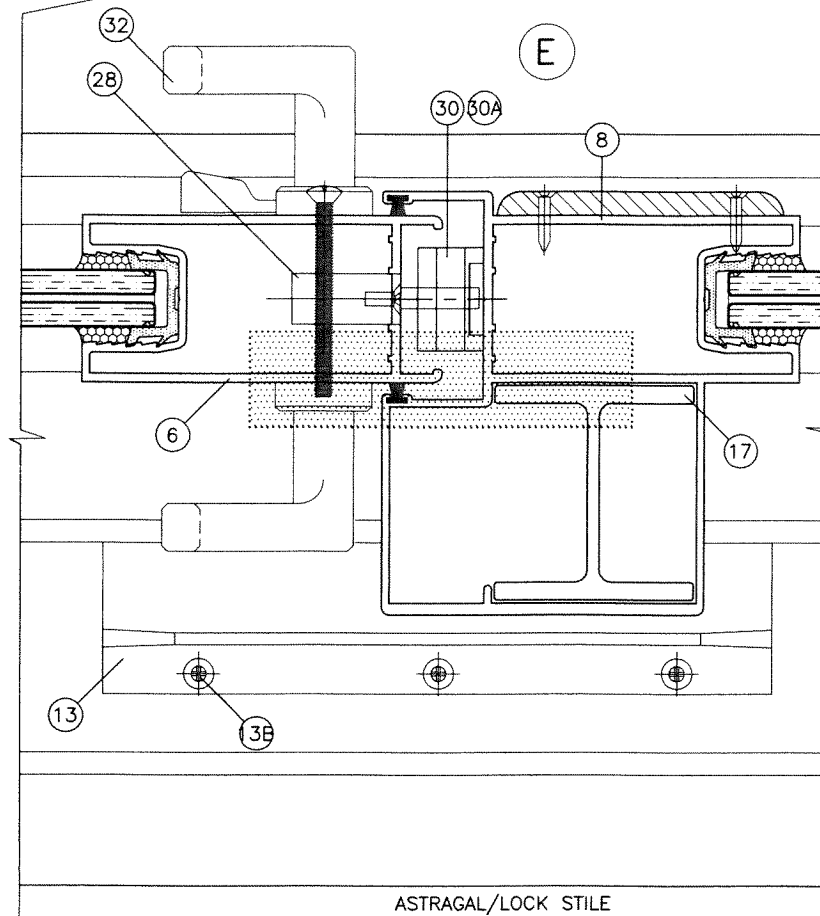

ASTRAGAL/LOCK STILE

**PRODUCT REVISED**  
as complying with the Florida  
Building Code  
NOA-No. 23-0724.17  
Expiration Date 08/22/2024  
By *Ishag I. Chande*  
Miami-Dade Product Control

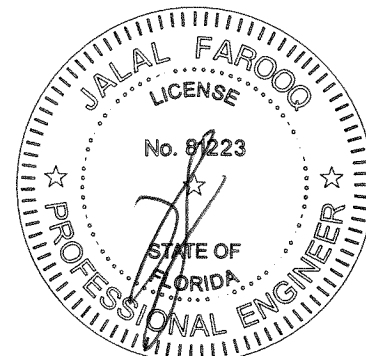

SERIES-6000-3 TRACK ALUM SLIDING GL. DOOR (L.M.I.)  
**E.S. WINDOWS, LLC**  
3550 N.W. 49 STREET  
MIAMI, FL. 33142  
TEL. (305) 638-5151 FAX. (305) 638-5158

no.	date	description	by
A	11.26.18	REV. PER RER COMMENTS	
B	06.22.21	UPDATED TO 2020 FBC	
C	07.14.23	NO CHANGE THIS SHEET	

date: 03-09-18	scale: 1/2" = 1"	dr. by: TARIQ	chk. by:
----------------	------------------	---------------	----------

  

drawing no.	18-35D
sheet	8 of 12

**AL-FAROOQ CORPORATION**  
ENGINEERS & PRODUCT DEVELOPMENT  
9360 SUNSET DRIVE, SUITE 220  
MIAMI, FLORIDA 33173  
TEL. (305) 264-8100 FAX. (305) 262-6978  
(C.A.N. 3538)

COMP-ANL 18-35D-ES



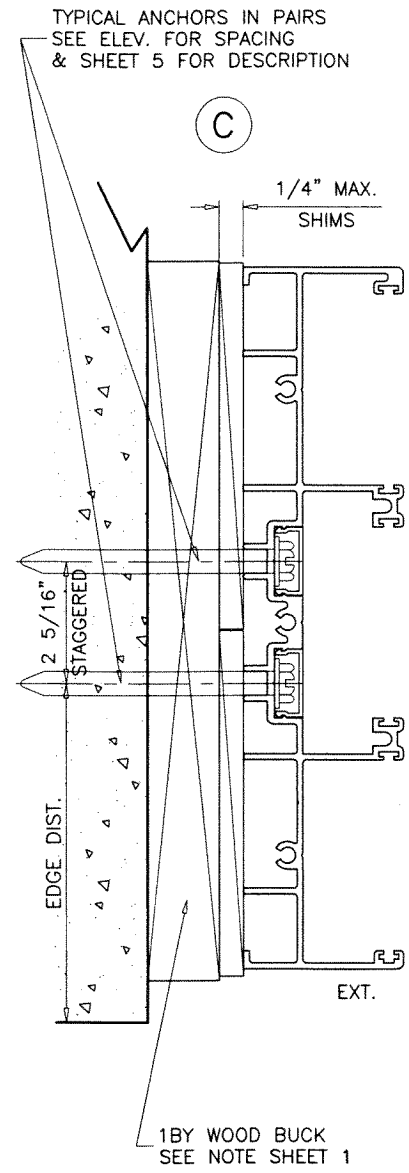

**PRODUCT RENEWED**  
 as complying with the Florida  
 Building Code  
 NOA-No. 24-0312.05  
 Expiration Date 08/22/2029  
 By Ishaq I. Chande  
 Miami-Dade Product Control

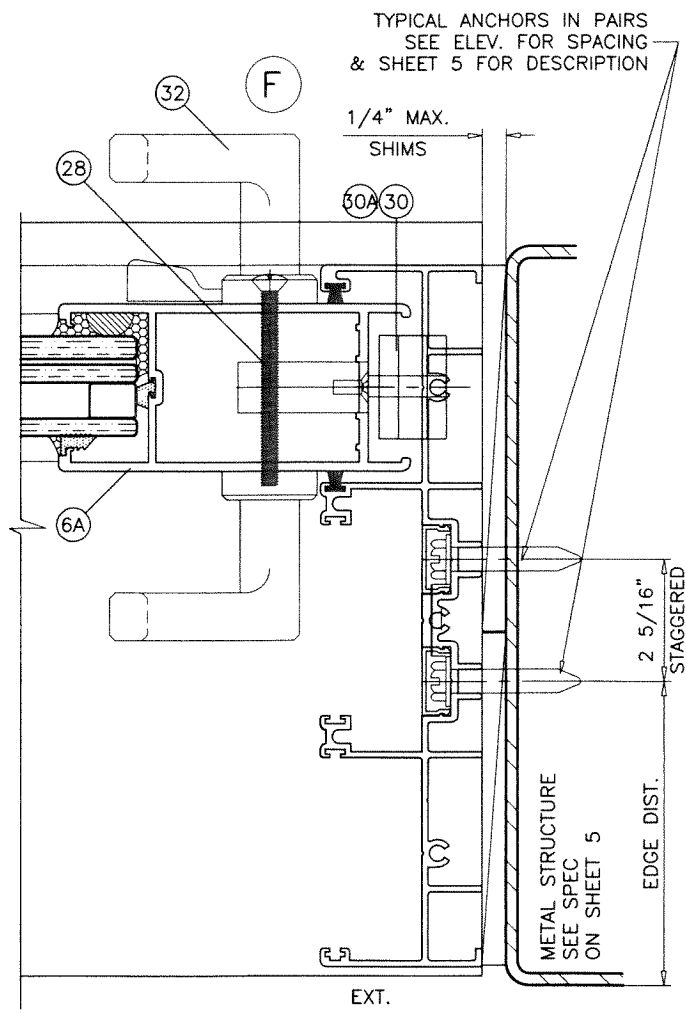

**PRODUCT REVISED**  
 as complying with the Florida  
 Building Code  
 NOA-No. 23-0724.17  
 Expiration Date 08/22/2024  
 By Ishaq I. Chande  
 Miami-Dade Product Control

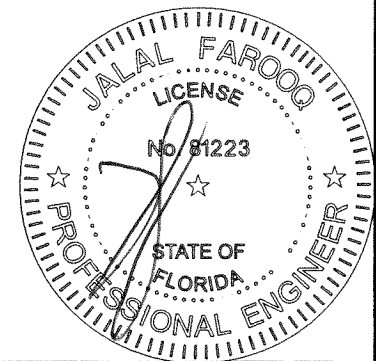
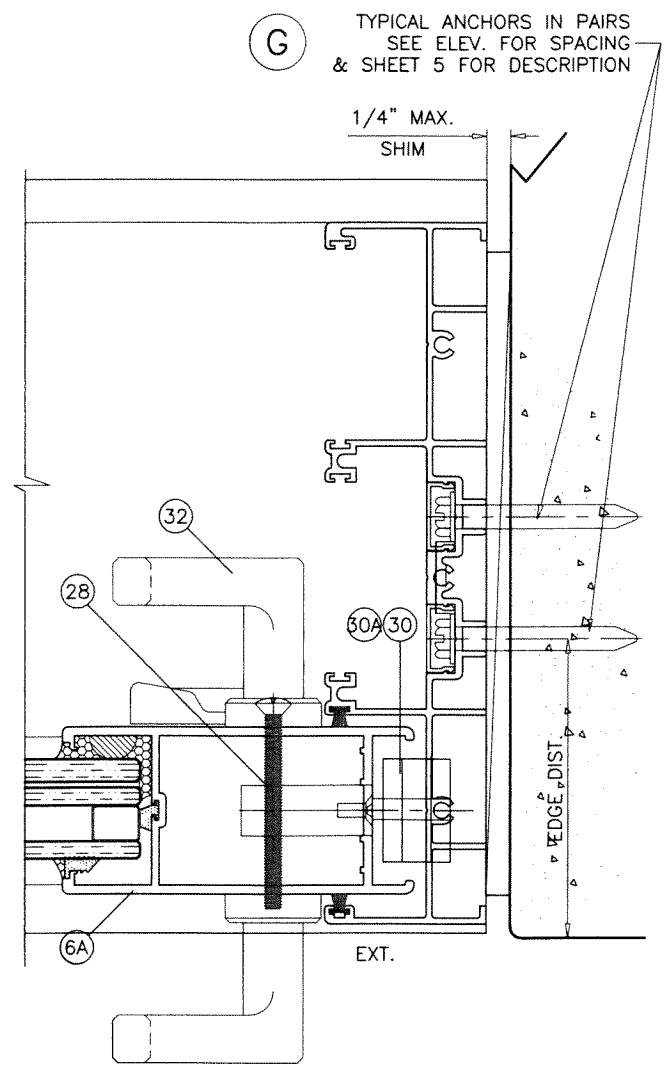

JUL 17 2023

**AL-FAROOQ CORPORATION**  
 ENGINEERS & PRODUCT DEVELOPMENT  
 9360 SUNSET DRIVE, SUITE 220  
 MIAMI, FLORIDA 33173  
 TEL. (305) 264-8100 FAX. (305) 262-6978

COMP-ANL\18-35D-ES

---

SERIES-6000-3 TRACK ALUM SLIDING GL. DOOR (L.M.I.)

E.S. WINDOWS, LLC  
 3550 N.W. 49 STREET  
 MIAMI, FL. 33142  
 TEL. (305) 638-5151 FAX. (305) 638-5158

---

revisions:		no	date	by	description
A	11.26.18				REV. PER PER COMMENTS
B	06.22.21				UPDATED TO 2020 FBC
C	07.14.23				NO CHANGE THIS SHEET

---

date: 03-09-18  
 scale: 1/2" = 1"  
 dr. by: TARIQ  
 chk. by:

drawing no.  
**18-35D**  
 sheet 9 of 12

ITEM #	PART #	QUANTITY	DESCRIPTION	MATERIAL	MANF./SUPPLIER/REMARKS
1	ES-6000-408	1	FRAME HEAD	6005-T5	-
2	ES-6000-402	1	FRAME SILL	6005-T5	-
2A	ES-6028	1	SILL RISER	6063-T6	-
3	ES-6000-403	2	FRAME JAMB	6063-T6	-
4	ES-6000-040	2/ PANEL	TOP RAIL (LAM. GLASS)	6063-T6	-
4A	ES-6004	2/ PANEL	TOP RAIL (INSUL. LAM. GLASS)	6063-T6	-
5	ES-6000-041	2/ PANEL	BOTTOM RAIL (LAM. GLASS)	6063-T6	-
5A	ES-6005	2/ PANEL	BOTTOM RAIL (INSUL. LAM. GLASS)	6063-T6	-
6	ES-6000-042	AS REQD.	LOCK STILE (LAM. GLASS)	6063-T6	-
6A	ES-6006	AS REQD.	LOCK STILE (INSUL. LAM. GLASS)	6063-T6	-
7	ES-6000-043	AS REQD.	INTERLOCK (LAM. GLASS)	6063-T6	-
7A	ES-6007	AS REQD.	INTERLOCK (INSUL. LAM. GLASS)	6063-T6	-
8	ES-6000-044	AS REQD.	FEMALE ASTRAGAL (LAM. GLASS)	6063-T6	-
8A	ES-6008	AS REQD.	FEMALE ASTRAGAL (INSUL. LAM. GLASS)	6063-T6	-
9	ES-6500-G01A	4/ PANEL	GLAZING GASKET (LAM. GLASS)	SILICONE	DUROMETER 65±5 SHORE A, EXTRUSIONES S.A.
11	ES-6016	4/ PANEL	PANEL GUIDE (TOP ONLY)	CELCON	LOCATED AT PANEL ENDS
12	ES-6015	2/ PANEL	FIXED PANEL BOTTOM CLIP , 7" LONG MIN.	6063-T6	SECURE W/ (2) #8 X 3/4" FH SMS
13	ES-6010	2/ PANEL	RETAINER CLIP, 7" LONG AT SILL, 8" LONG HEAD	6005-T5	AT ASTRAGAL STILE HEAD & SILL ENDS
13A	ES-6000-405	2/ PANEL	RETAINER CLIP, 7" LONG AT SILL, 8" LONG AT HEAD	6005-T5	AT INTERLOCK STILES HEAD & SILL ENDS
13B	#10 X 3/4"	3/ CLIP	RETAINER CLIP FASTENERS	-	FH SELF DRILLING SCREWS
14	ES-6011	2/ JAMB	JAMB SCREW COVER	6063-T5	OPTIONAL
17	ES-6013	AS REQD.	ASTRAGAL STIFFENER (LENGTH = PANEL HT. - 2-3/8")	6063-T6	-
18	1" X 2" X 3/16"	AS REQD.	STEEL TUBE REINFORCING (LENGTH = PANEL HT. - 2-3/8")	A36 STEEL	TO BE PAINTED
21	W222521K	AS REQD.	STILE & JAMB W'STRIPPING	-	ULTRAFAB
22	W223221K	AS REQD.	TOP RAIL PILE W'STRIPPING	-	ULTRAFAB
23	ES-6027	AS REQD.	BOTTOM RAIL W'STRIPPING	EPDM	DUROMETER 75±4 SHORE A
24	#10 X 1-1/2" PH SMS	8/ PANEL	PANEL ASSY SCREWS	ST. STEEL	-
25	#10 X 1" PH SMS	2/ CORNER	FRAME ASSY SCREWS	ST. STEEL	-
26	GTT-354/460-A	2/ MOV. PANEL	TANDEM ACETAL WHEELS IN METALLIC HOUSING	-	PABOSE
27	1/4-20 X 1-3/4" PH MS	2/ ROLLER	ROLLER INST. SCREWS	ST. STEEL	-
28	191014	1/ MOV. PANEL	MULTI POINT MORTISE LOCK, AT 40" FROM BOTTOM	ST. STEEL	INTERLOCK (ASSA ABLOY)
29	#10-24 X 3/8" PH MS	2/ LOCK	LOCK INSTALLATION SCREW	ST. STEEL	-
30	191040	1/ LOCK	LOCK KEEPER (MULTI POINT LOCK), AT 48-1/2" FROM BOTTOM	ST. STEEL	INTERLOCK (ASSA ABLOY)
31	#10 X 5/8" PH SMS B	2/ LOCK	LOCK KEEPER MOUNT. SCREW (STD. LOCK)	ST. STEEL	-
31A	#8 X 3/4" FH SMS	4/ LOCK	LOCK KEEPER MOUNT. SCREW (MULTI POINT LOCK)	ST. STEEL	-
32	#623Z	1/ LOCK	INTERIOR AND EXTERIOR PULL	-	(3) #6-32 X 1/2" FH MS, ST. STEEL
35	-	AS REQD.	1"x4" LONG SELF ADHESIVE PILE PAD	WOOLPILE	AT HEAD AND SILL
37	ES-6019	AS REQD.	RESTRAINING PLATE	NYLON	AT TOP & BOTT. INTERLOCKS & ASTRAGAL
38	#8 X 3/4" FH SMS	2/ PLATE	RESTRAINING PLATE FASTENER	-	-
39	ES-3000-G01	AS REQD.	GLAZING WEDGE	SILICONE	DUROMETER 70±5 SHORE A
41	ES-4014	AS REQD.	BOTTOM RAIL GLASS STOP	EPDM	DUROMETER 68±4 SHORE A
42	ES-4018	AS REQD.	TOP RAIL & STILES GLASS STOP	EPDM	DUROMETER 75±4 SHORE A
43	ES-8011A	AS REQD.	BUMPER SPACER	SILICONE	DUROMETER 65±5 SHORE A
44	-	2/ LITE	SETTING BLOCK, 1" X 1/8" X 2-1/2" LONG	EPDM	DUROMETER 80±5 SHORE A

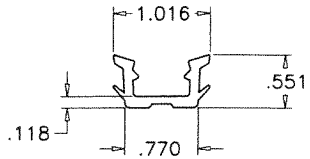

9 GLAZING GASKET  
(LAMINATED GLASS)

BASE POLYMER = EPDM RUBBER  
DENSITY = 10.26 Lbs/Gal  
HARDNESS = 70±5  
TENSILE STRENGTH = 905 PSI  
ELONGATION AT BREAK = 273%  
TEAR STRENGTH = 1.343 Kip/ft  
BRITTLENESS TEMPERATURE = -40° F  
COMPRESSION SET = 27% (22h@158°F)

**PRODUCT RENEWED**  
as complying with the Florida  
Building Code  
NOA-No. 24-0312.05

Expiration Date 08/22/2029

By Ishag I. Chank  
Miami-Dade Product Control

**PRODUCT REVISED**  
as complying with the Florida  
Building Code  
NOA-No. 23-0724.17

Expiration Date 08/22/2024

By Ishag I. Chank  
Miami-Dade Product Control

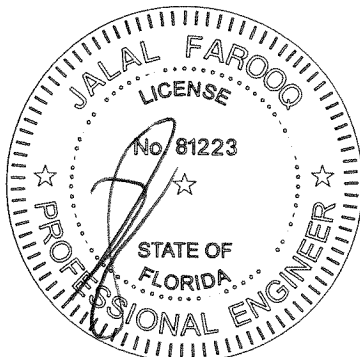

JUL 17 2023

afC

AL-FAROOQ CORPORATION  
ENGINEERS & PRODUCT DEVELOPMENT  
9360 SUNSET DRIVE, SUITE 220  
MIAMI, FLORIDA 33173  
TEL. (305) 264-8100 FAX. (305) 262-6978  
COMP-ANL\18-35D-ES

SERIES-6000-3 TRACK ALUM SLIDING GL. DOOR (L.M.I.)

E.S. WINDOWS, LLC  
3550 N.W. 49 STREET  
MIAMI, FL. 33142  
TEL. (305) 638-5151 FAX. (305) 638-5158

revisions:

no	date	by	description
A	11.26.18		REV. PER RER COMMENTS
B	06.22.21		UPDATED TO 2020 FBC
C	07.14.23		NO CHANGE THIS SHEET

date: 03-09-18  
scale: 1/2" = 1"  
dr. by: TARIQ  
chk. by:

drawing no.  
18-35D  
sheet 10 of 12



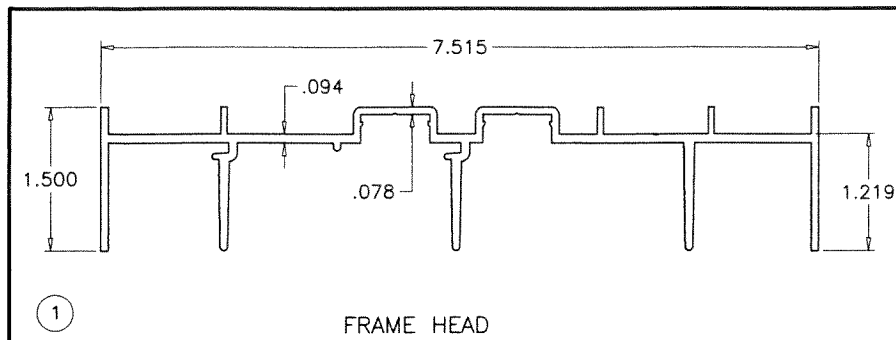

FRAME HEAD

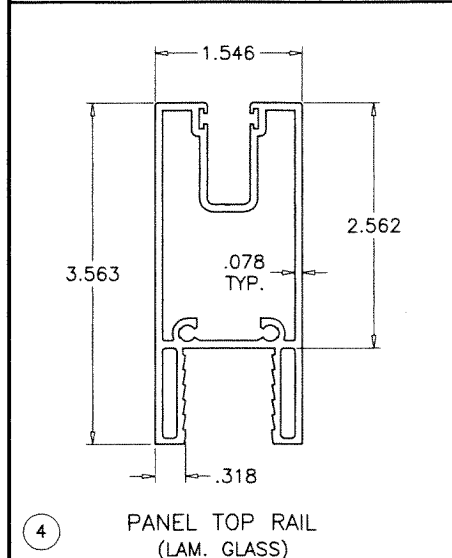

PANEL TOP RAIL  
(LAM. GLASS)

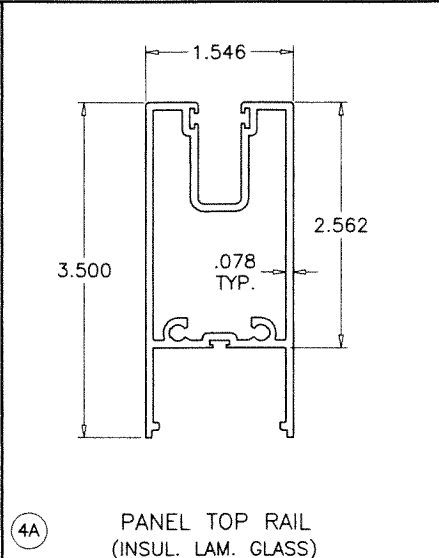

PANEL TOP RAIL  
(INSUL. LAM. GLASS)

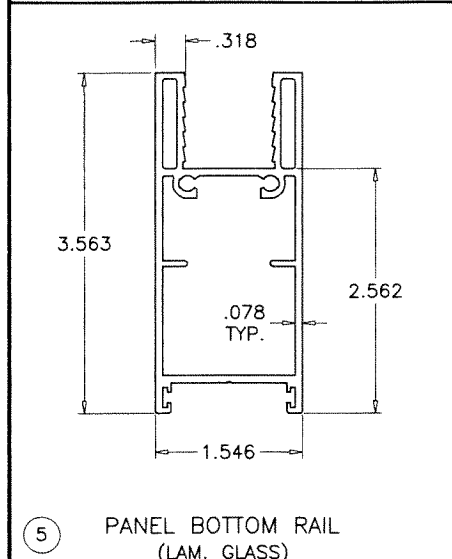

PANEL BOTTOM RAIL  
(LAM. GLASS)

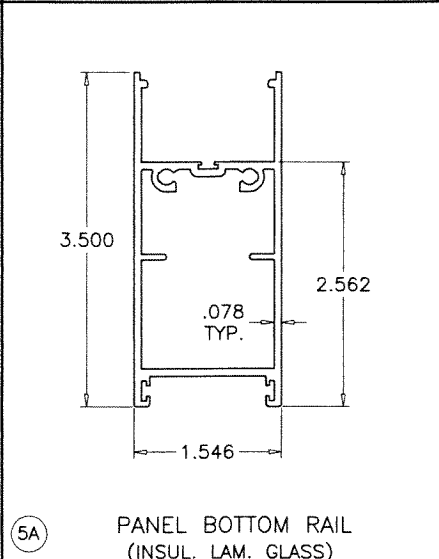

PANEL BOTTOM RAIL  
(INSUL. LAM. GLASS)

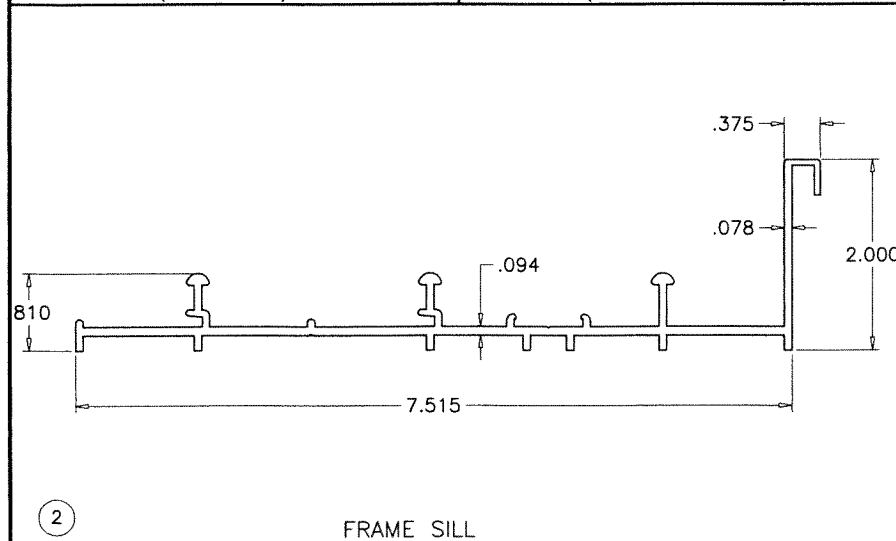

FRAME SILL

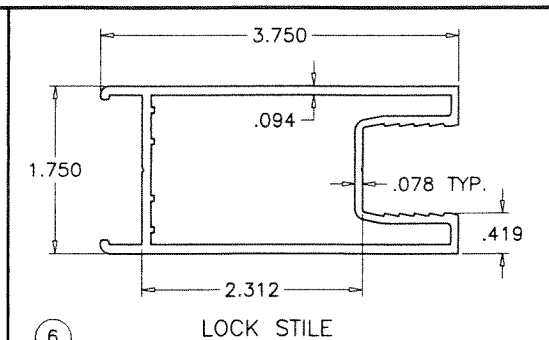

LOCK STILE  
(LAM. GLASS)

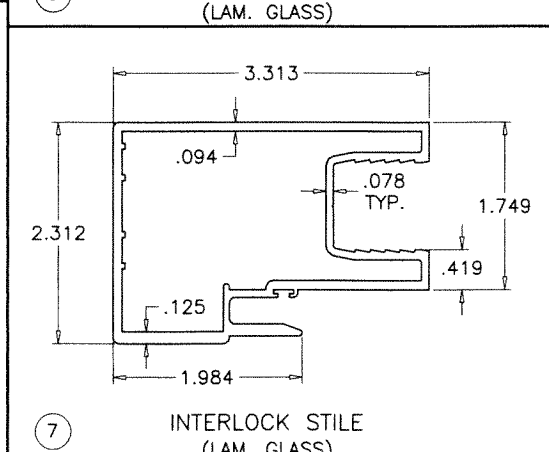

INTERLOCK STILE  
(LAM. GLASS)

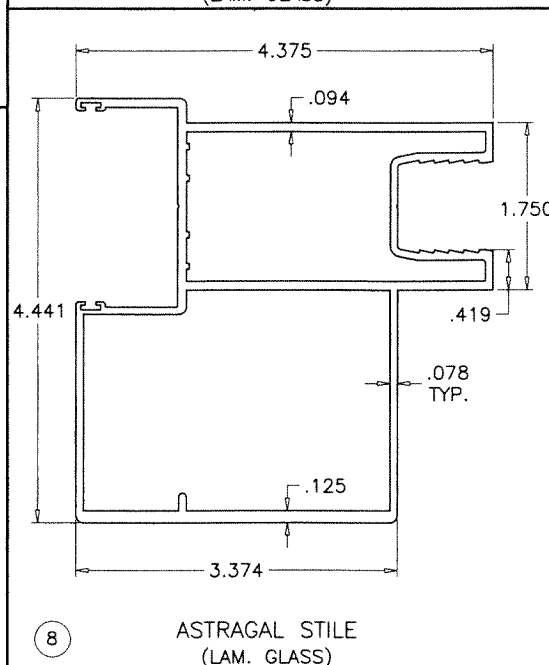

ASTRAGAL STILE  
(LAM. GLASS)

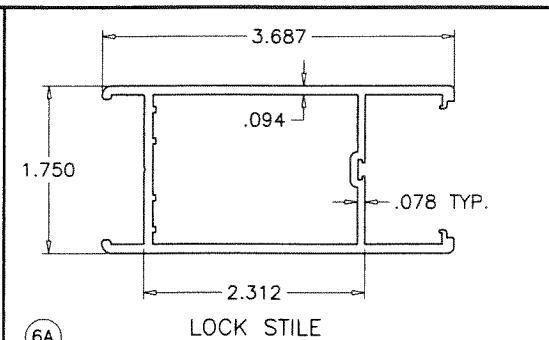

LOCK STILE  
(INSUL. LAM. GLASS)

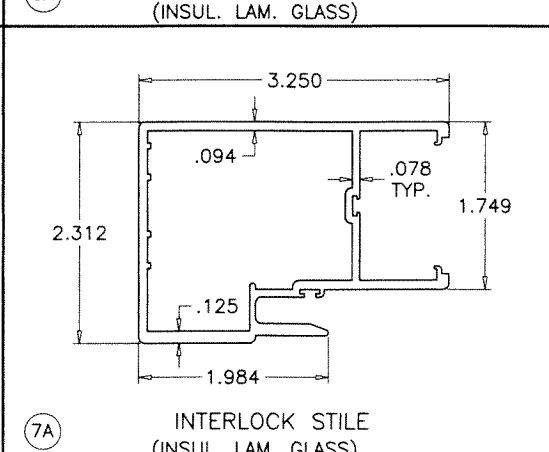

INTERLOCK STILE  
(INSUL. LAM. GLASS)

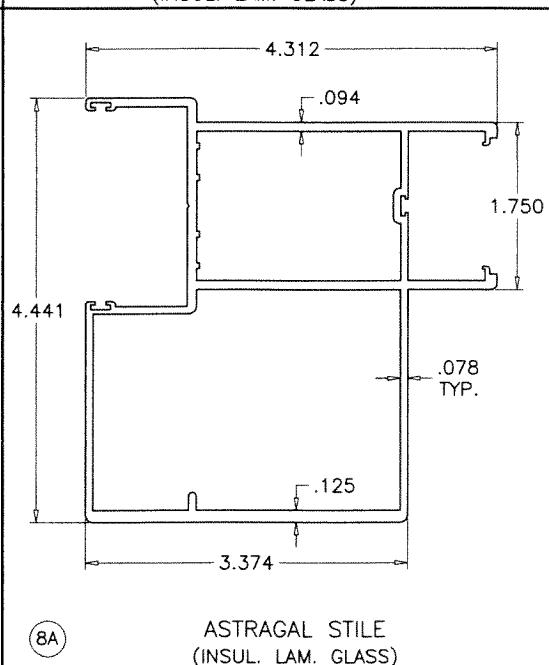

ASTRAGAL STILE  
(INSUL. LAM. GLASS)

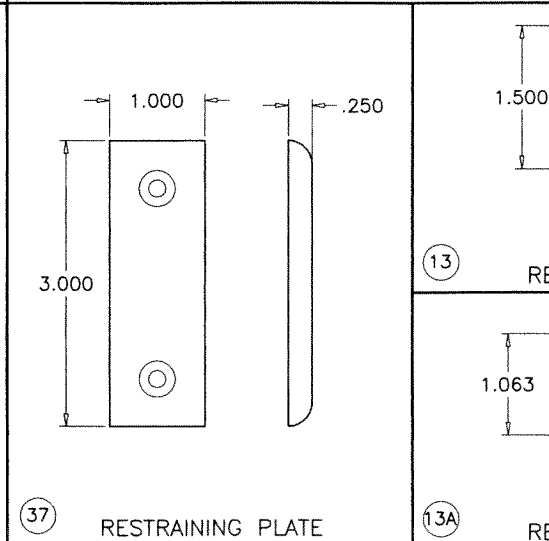

RESTRAINING PLATE

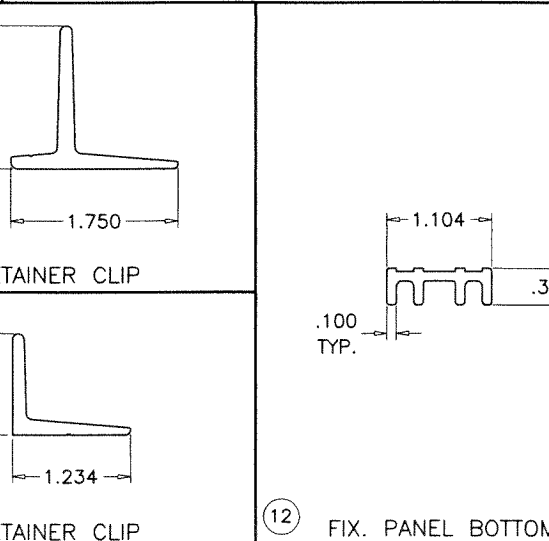

RETAINER CLIP

RETAINER CLIP

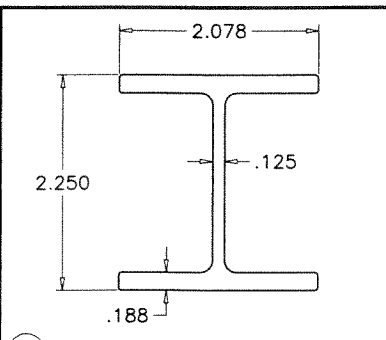

ALUM. ASTRAGAL STIFFENER

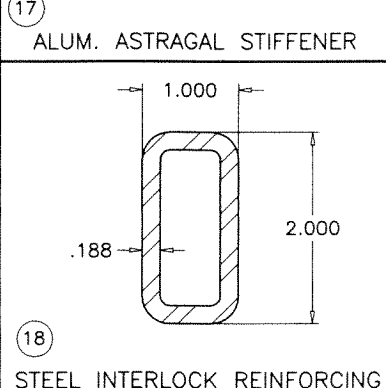

STEEL INTERLOCK REINFORCING

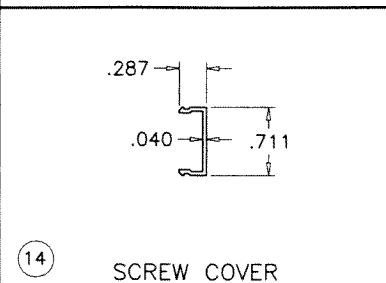

SCREW COVER

**PRODUCT RENEWED**  
as complying with the Florida  
Building Code  
NOA-No. 24-0312.05  
Expiration Date 08/22/2029  
By Ishag I. Chande  
Miami-Dade Product Control

**PRODUCT REVISED**  
as complying with the Florida  
Building Code  
NOA-No. 23-0724.17  
Expiration Date 08/22/2024  
By Ishag I. Chande  
Miami-Dade Product Control

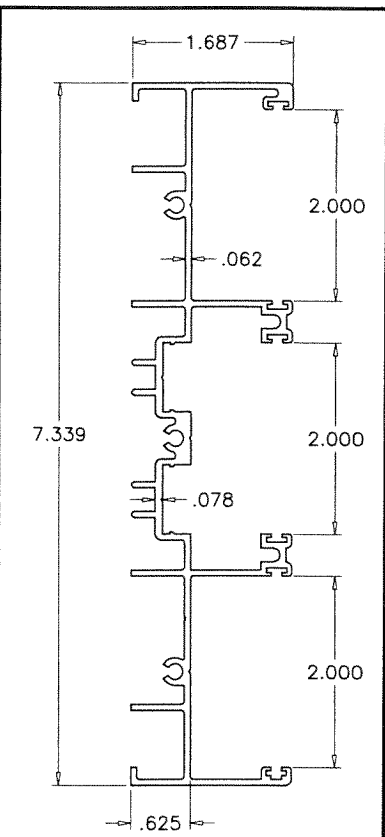

FRAME JAMB

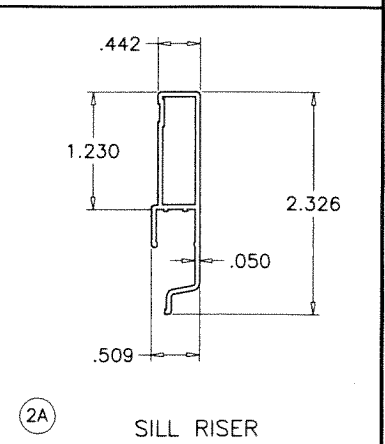

SILL RISER

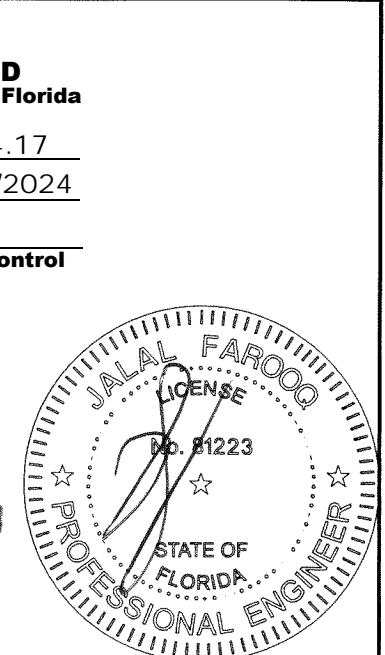

**AL-FAROOQ CORPORATION**  
ENGINEERS & PRODUCT DEVELOPMENT  
9360 SUNSET DRIVE, SUITE 220  
MIAMI, FLORIDA 33173  
TEL. (305) 264-8100 FAX. (305) 262-6978  
(C.A.N. 3538)

SERIES-6000-3 TRACK ALUM SLIDING GL. DOOR (L.M.I.)  
**E.S. WINDOWS, LLC**  
3550 N.W. 49 STREET  
MIAMI, FL. 33142  
TEL. (305) 638-5151 FAX. (305) 638-5158

revisions:	no.	date	description	by
	A	11.26.18	REV. PER RER COMMENTS	
	B	06.22.21	UPDATED TO 2020 FBC	
	C	07.14.23	NO CHANGE THIS SHEET	
date:	03-09-18			
scale:	1/2" = 1"			
dr. by:	TARIQ			
chk. by:				
drawing no.	18-35D			
sheet	11 of 12			

JUL 17 2023

COMP-ANL\18-35D-ES

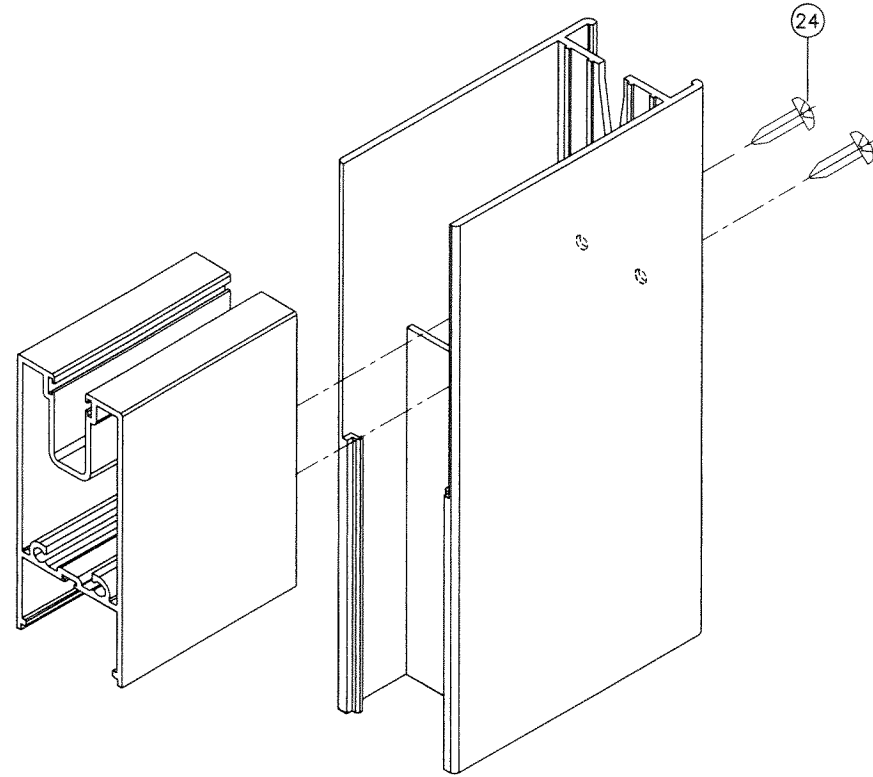

**PANEL TOP CORNER**

INSUL. LAM. GLASS RAIL & STILE (SHOWN)  
LAM. GLASS RAIL & STILE (SIMILAR)

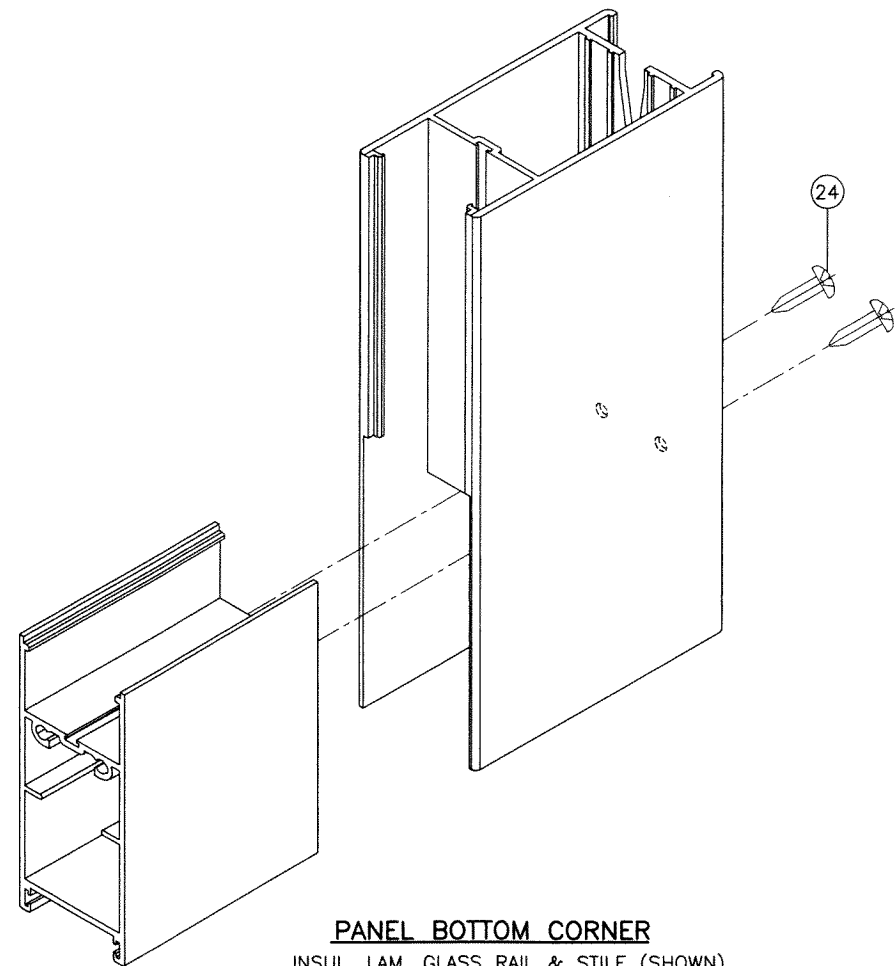

**PANEL BOTTOM CORNER**

INSUL. LAM. GLASS RAIL & STILE (SHOWN)  
LAM. GLASS RAIL & STILE (SIMILAR)

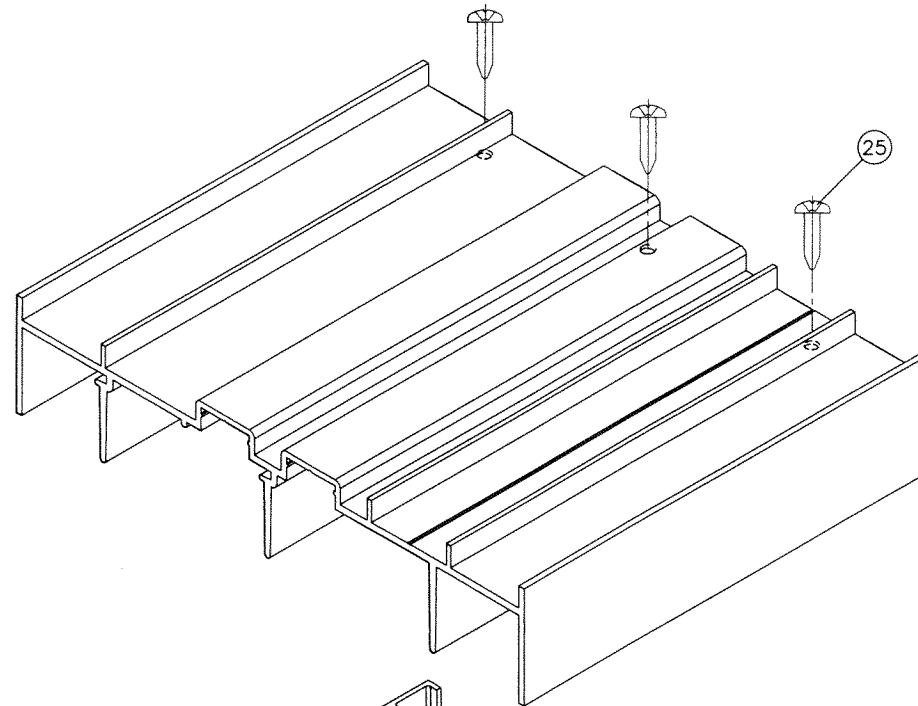

**FRAME TOP CORNER**

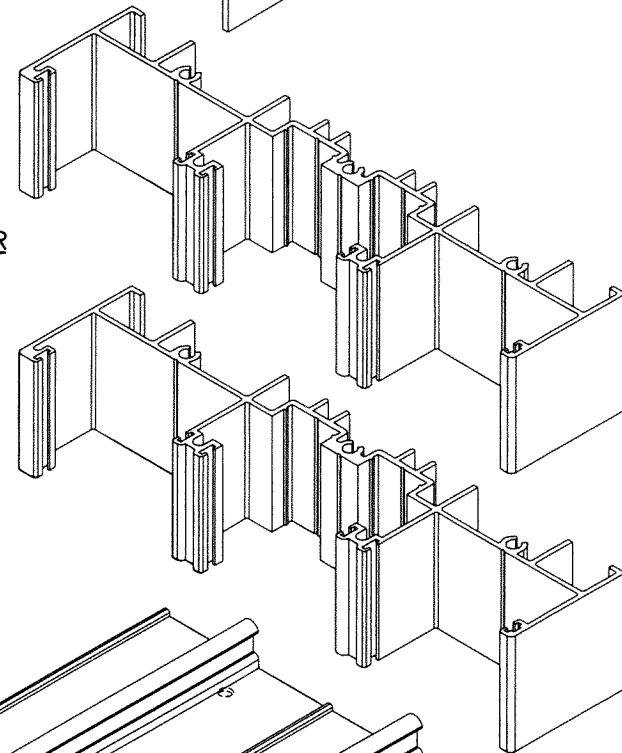

**FRAME BOTTOM CORNER**

**PRODUCT RENEWED**  
as complying with the Florida  
Building Code  
NOA-No. 24-0312.05

Expiration Date 08/22/2029

By Ishag I. Chande  
Miami-Dade Product Control

**PRODUCT REVISED**  
as complying with the Florida  
Building Code  
NOA-No. 23-0724.17

Expiration Date 08/22/2024

By Ishag I. Chande  
Miami-Dade Product Control

JUL 17 2023

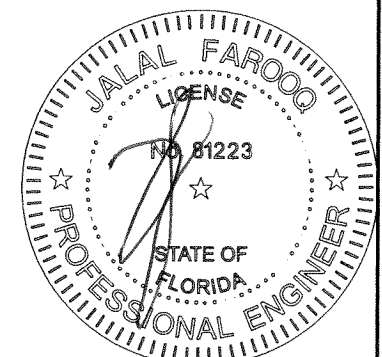

**AL-FAROOQ CORPORATION**  
ENGINEERS & PRODUCT DEVELOPMENT  
9360 SUNSET DRIVE, SUITE 220  
MIAMI, FLORIDA 33173  
TEL. (305) 264-8100 FAX. (305) 262-6978  
(C.A.N. 3538)  
COMP-ANL 18-35D-ES

SERIES-6000-3 TRACK ALUM SLIDING GL. DOOR (L.M.I.)

**E.S. WINDOWS, LLC**  
3550 N.W. 49 STREET  
MIAMI, FL. 33142  
TEL. (305) 638-5151 FAX. (305) 638-5158

revisions:		by description	
no	date	no	description
A	11.26.18	NO	CHANGE THIS SHEET
B	06.22.21	UPDATED	TO 2020 FBC
C	07.14.23	NO	CHANGE THIS SHEET
date: 03-09-18		scale: 1/2" = 1"	
dr. by: TARIQ		chk. by:	
drawing no.		18-35D	
sheet 12 of 12			