



DEPARTMENT OF REGULATORY AND ECONOMIC RESOURCES (RER)
BOARD AND CODE ADMINISTRATION DIVISION

NOTICE OF ACCEPTANCE (NOA)

MIAMI-DADE COUNTY
PRODUCT CONTROL SECTION
11805 SW 26 Street, Room 208
Miami, Florida 33175-2474
T (786) 315-2590 F (786) 315-2599

www.miamidade.gov/building

CDM Impact System, Inc.

8301 NW 27 Street, Suite 9-10

Doral, FL 33122

SCOPE:

This NOA is being issued under the applicable rules and regulations governing the use of construction materials. The documentation submitted has been reviewed and accepted by Miami-Dade County RER-Product Control Section to be used in Miami-Dade County and other areas where allowed by the Authority Having Jurisdiction (AHJ).

This NOA shall not be valid after the expiration date stated below. The Miami-Dade County Product Control Section (In Miami-Dade County) and/ or the AHJ (in areas other than Miami-Dade County) reserve the right to have this product or material tested for quality assurance purposes. If this product or material fails to perform in the accepted manner, the manufacturer will incur the expense of such testing and the AHJ may immediately revoke, modify, or suspend the use of such product or material within their jurisdiction. RER reserves the right to revoke this acceptance if it is determined by Miami-Dade County Product Control Section that this product or material fails to meet the requirements of the applicable building code.

This product is approved as described herein and has been designed to comply with the Florida Building Code, including the High Velocity Hurricane Zone.

DESCRIPTION: Series "CDM-D 100" Aluminum outswing Doors - L.M.I.

APPROVAL DOCUMENT: Drawing No. **CDM 2024-08**, titled "Series CDM-D Aluminum Outswing door (LMI)", sheets 1 through 10 of 10, dated AUG 26, 2024, prepared by AM American Consulting, Inc., signed and sealed by Daniel Gonzalez, P.E., bearing the Miami-Dade County Product Control Approval stamp with the Notice of Acceptance number and expiration date by the Miami-Dade County Product Control Section.

MISSILE IMPACT RATING: Large and Small Missile Impact Resistant

Limitations:

1. ADA threshold options are not approved for water infiltration.
2. Doors can be mulled with approved CDM Window wall system. Lower design pressure of the Doors or Window wall shall control.
3. Installation into wood substrates require six (6 screws) at double door lockstile/meeting stile (head/sill) and three (3) screws at single door lock stiles (head/sill).

LABELING: Each unit shall bear a permanent label with the manufacturer's name or logo, city, state, model/series, and following statement: "Miami-Dade County Product Control Approved", unless otherwise noted herein.

RENEWAL of this NOA shall be considered after a renewal application has been filed and there has been no change in the applicable building code negatively affecting the performance of this product.

TERMINATION of this NOA will occur after the expiration date or if there has been a revision or change in the materials, use, and/ or manufacture of the product or process. Misuse of this NOA as an endorsement of any product, for sales, advertising or any other purposes shall automatically terminate this NOA. Failure to comply with any section of this NOA shall be cause for termination and removal of NOA.

ADVERTISEMENT: The NOA number preceded by the words Miami-Dade County, Florida, and followed by the expiration date may be displayed in advertising literature. If any portion of the NOA is displayed, then it shall be done in its entirety.

INSPECTION: A copy of this entire NOA shall be provided to the user by the manufacturer or its distributors and shall be available for inspection at the job site at the request of the Building Official.

This NOA consists of this page 1 and evidence pages E-1, as well as approval document mentioned above.

The submitted documentation was reviewed by **Ishaq I. Chanda, P.E.**

Ishaq I. Chanda



NOA No. 24-0812.03
Expiration Date: September 05, 2029
Approval Date: September 05, 2024
Page 1

NOTICE OF ACCEPTANCE: EVIDENCE SUBMITTED

1. EVIDENCE SUBMITTED

A. DRAWINGS

1. Drawing No. **CDM 2024-08**, titled “Series CDM-D Aluminum Outswing door (LMI)”, sheets 1 through 10 of 10, dated AUG 26, 2024, prepared by AM American Consulting, Inc., signed and sealed by Daniel Gonzalez, P.E.

B. TESTS

1. Test reports on: 1) Air Infiltration Test, per PA 202-94
2) Uniform Static Air Pressure Test, Loading per TAS 202-94
3) Water Resistance Test, per TAS 202-94
4) Large Missile Impact Test per TAS 201-94
5) Cyclic Wind Pressure Loading per TAS 203-94
6) Forced Entry Test per FBC 2411.3.2.1, and TAS 202-94

along with marked-up drawings and installation diagram of double and single outswing doors w/ multi-point locks and Adams Rite CVR panic devices, prepared by Hurricane Engineering & Testing, Inc., Test Report No(s). **HETI-24-8194**, dated 07/12/24, **HETI-24-8167**, dated 07/12/24, **HETI-24-8158**, dated 06/05/24, **HETI-24-8154**, dated 05/17/24 and **HETI-24-8194** single, dated 07/12/24, signed and sealed by Ram N. Tewari, P.E.

C. CALCULATIONS

1. Anchor verification calculations and structural analysis, complying with FBC 8th Edition (2023), dated 08/06/24 and last revised on 08/26/2024, prepared by AM American Consulting, Inc., signed and sealed by Daniel Gonzalez, P.E.
2. Glazing complies with ASTM E1300-09.

D. QUALITY ASSURANCE

1. Miami-Dade Department of Regulatory and Economic Resources (RER)

E. MATERIAL CERTIFICATIONS

1. Notice of Acceptance No. **24-0205.08** issued to **Kuraray America, Inc.** for their “**Trosifol® Ultraclear, Clear and Color PVB Glass Interlayers**”, expiring on 07/08/29.

F. STATEMENTS

1. Statement letter of conformance, complying with **FBC 8th Edition (2023)** and no financial interest, dated 08/06/24, issued by AM American Consulting, Inc., signed and sealed by Daniel Gonzalez, P.E.

G. OTHERS

1. Test proposal # **23-1418**, dated Nov 29, 2023, approved by RER, Product Control Section.

Ishaq I. Chanda

Ishaq I. Chanda, P.E.
Product Control Unit Supervisor

NOA No. 24-0812.03
Expiration Date: September 05, 2029
Approval Date: September 05, 2024

SERIES "CDM-D100"
ALUMINUM OUTSWING DOOR

LAMINATED GLASS / INSULATED LAMINATED GLASS
LARGE MISSILE IMPACT.

THIS PRODUCT HAS BEEN DESIGNED AND TESTED TO COMPLY WITH THE REQUIREMENTS OF THE 2023 (8TH EDITION) FLORIDA BUILDING CODE INCLUDING HIGH VELOCITY HURRICANE ZONE (HVHZ).

THIS SYSTEM IS RATED FOR LARGE MISSILE IMPACT
SHUTTERS ARE NOT REQUIRED.

ANCHORS SHALL BE CORROSION RESISTANT, SPACED AS SHOWN ON DETAILS AND INSTALLED PER MANUFACTURER'S INSTRUCTIONS. SPECIFIED EMBEDMENT TO BASE MATERIAL SHALL BE BEYOND WALL DRESSING OR STUCCO.

ALL SHIMS TO BE HIGH IMPACT, NON-METALLIC AND NON-COMPRESSIBLE.

MATERIALS INCLUDING BUT NOT LIMITED TO STEEL/METAL SCREWS, THAT COME INTO CONTACT WITH OTHER DISSIMILAR MATERIALS SHALL MEET THE REQUIREMENTS OF THE 2023 FLORIDA BLDG. CODE & ADOPTED STANDARDS.

THIS PRODUCT APPROVAL IS GENERIC AND DOES NOT PROVIDE INFORMATION FOR A SITE SPECIFIC PROJECT, i.e. LIFE SAFETY OF THIS PRODUCT, ADEQUACY OF STRUCTURE RECEIVING THIS PRODUCT AND SEALING AROUND OPENING FOR WATER INFILTRATION ETC. CONDITIONS NOT SHOWN IN THIS DRAWING ARE TO BE ANALYZED SEPARATELY AND TO BE REVIEWED BY BUILDING OFFICIAL.

DESIGN INSTRUCTIONS:

STEP 1: DETERMINE DESIGN WIND LOAD REQUIREMENT BASED ON WIND VELOCITY, BLDG. HEIGHT, WIND ZONE USING APPLICABLE ASCE-07 STANDARD.

STEP 2: SEE SHEETS 2, 3 & 4 FOR DESIGN LOAD CAPACITY.

STEP 3: CHECK ANCHORS QUANTITIES & SPACING FOR DOOR SYSTEM ON SHEET 01.

STEP 4: CHECK GLASS FOR DOOR SYSTEM ON SHEET 01.

STEP 5: CHECK LOCK OPTIONS FOR DOOR SYSTEM ON SHEET 07.

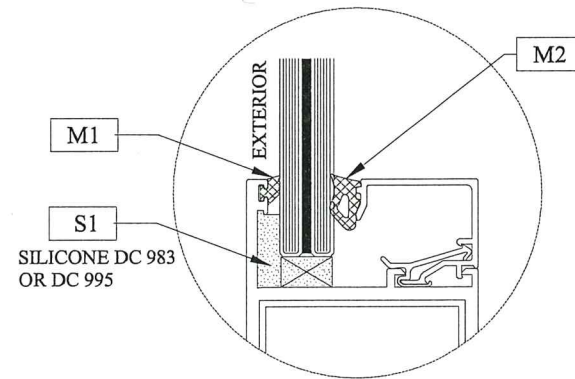

GLASS TYPE "G-1"

9/16" LAMINATED GLASS
1/4" HEAT STRENGTH GLASS
0.090" TROSIFOL PVB INTERLAYER BY
KURARAY AMERICA, INC.
1/4" HEAT STRENGTH GLASS

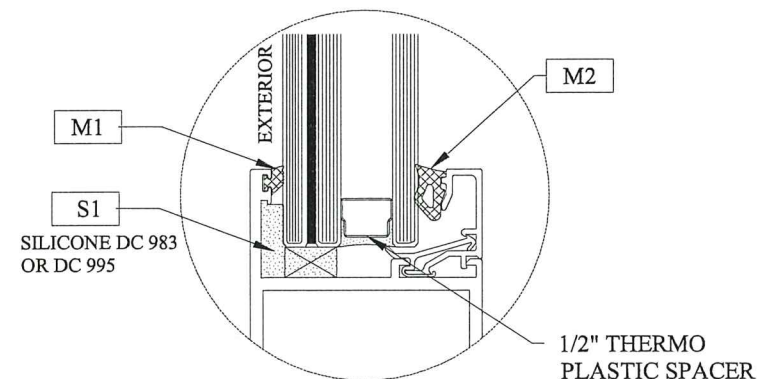

GLASS TYPE "G-2"

1 5/16" INSULATED -LAMINATED GLASS
1/4" HEAT STRENGTH GLASS
0.090" TROSIFOL PVB INTERLAYER BY
KURARAY AMERICA, INC.
1/4" HEAT STRENGTH GLASS
0.50" AIR SPACE
1/4" TEMPERED GLASS

TYPICAL ANCHORS:

HEX AND/OR FLAT HEAD ARE ALLOWED.

TYPE "A"

1/4" ULTRACON BY "DEWALT"
(Fu=177 KSI, Fy=155 KSI)

DIRECTLY INTO CONCRETE
WITH 1-3/4" MIN. EMBED INTO CONCRETE

ANCHOR EDGE DISTANCES
INTO CONCRETE AND MASONRY = 2-1/2" MIN.

TYPE "B"

1/4" ULTRACON BY "DEWALT"
(Fu=177 KSI, Fy=155 KSI)

INTO 2BY WOOD BUCKS OR WOOD STRUCTURES
WITH 1-1/2" MIN. PENETRATION INTO WOOD

THRU 1BY WOOD BUCKS INTO CONCRETE
WITH 1-3/4" MIN. EMBED INTO CONCRETE

ANCHOR EDGE DISTANCES
INTO CONCRETE AND MASONRY = 2-1/2" MIN.
INTO WOOD STRUCTURE = 1" MIN.

WOOD AT HEAD, JAMB SG = 0.55 MIN.
CONCRETE AT HEAD, SILL & JAMB
fc = 3000 PSI MIN.

TYPE "C"

1/4" DIA TEKS OR SELF DRILLING SCREWS
(Fu=120 KSI, Fy=92 KSI) (SAE GRADE 5)

INTO METAL STRUCTURES
(3) THREADS MIN. PENETRATION BEYOND SUBSTRATE
ALUMINUM: 1/8" THK. MIN (6063-T6 MIN.)
STEEL: 1/8" THK. MIN (Fy = 36 KSI MIN.)
(STEEL IN CONTACT WITH ALUMINUM TO BE PLATED OR PAINTED)

ANCHOR EDGE DISTANCES
INTO METAL STRUCTURE = 1/2" MIN.

SEALANTS:
ALL FRAME CORNERS, JOINTS,
MULLION SEAMS, AND
PERIMETER OF GLAZING BEAD TO
FRAME SEALED WITH SILICONE
SEALANT.

PRODUCT APPROVED
as complying with the Florida
Building Code
NOA-No. 24-0812.03

Approval Date 09/05/2024

By Ishay L. Chandra
Miami-Dade Product Control

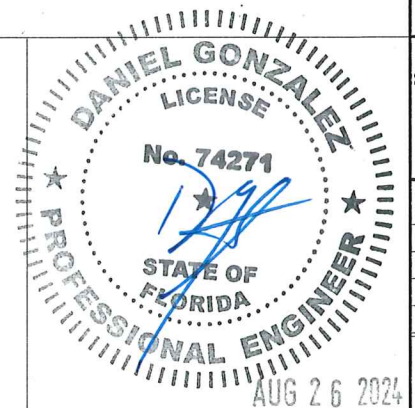

AM American Consulting, Inc.
14331 SW 120th Street, Suite 213, Miami, FL 33186
Ph (786) 219 9490 / www.americanconsulting.com
Cert. Authorization No. 31388

IMPACT SYSTEM
8303 NW 27th Street, Suite 17, Doral, FL 33122 / Ph: 305-267-1011

NO.	DATE	BY	REVISION

SERIES "CDM-D100"
ALUMINUM
OUTSWING DOOR
(LMI)

Drawings No:
CDM 2024-08
Drawn by: AP
Checked by: DG
Date: 08/5/24
Scale:

SHEET No:
1 of 10

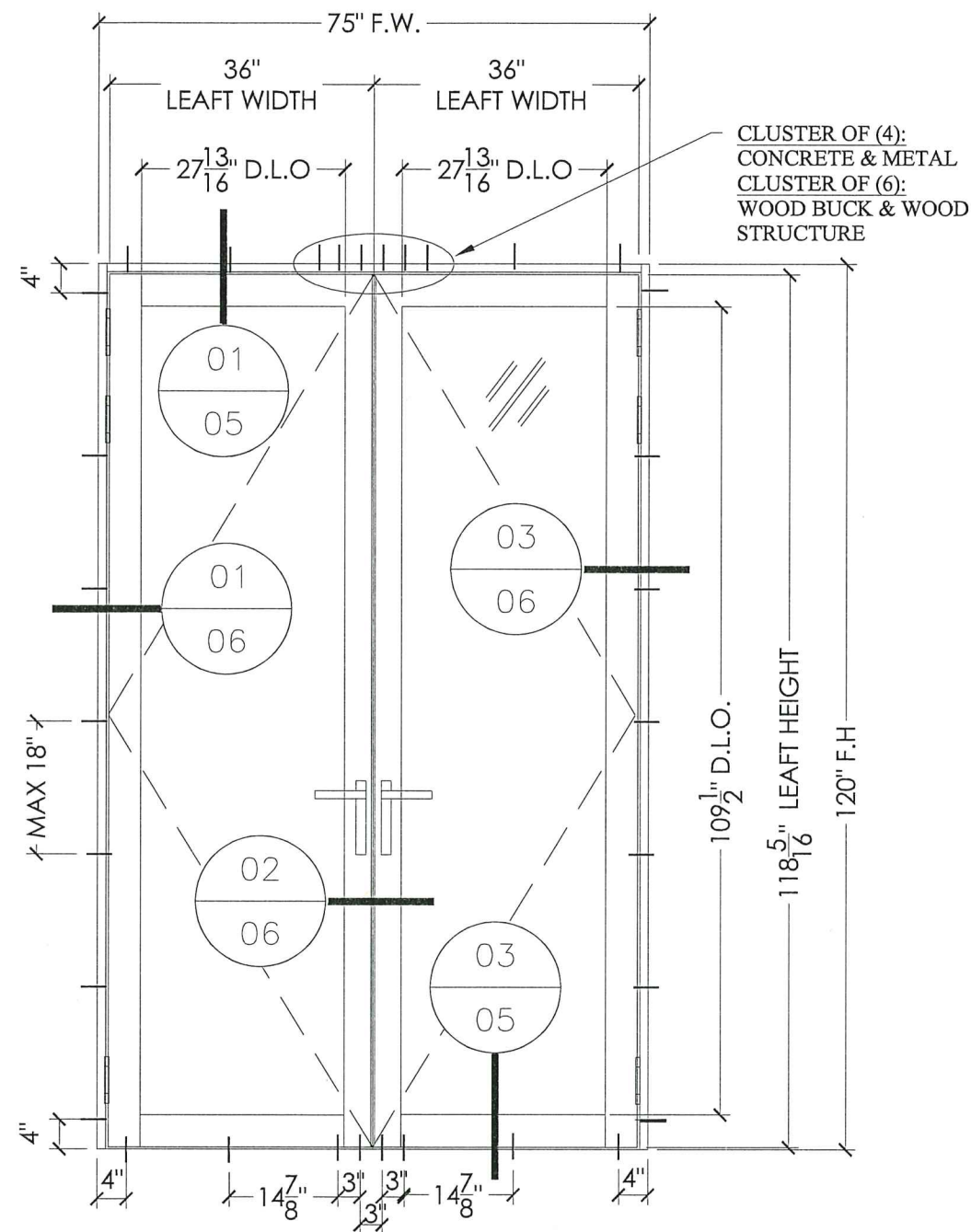

TYPICAL EXTERIOR ELEVATION
DOUBLE DOOR

DESIGN LOAD
+ 85 PSF
- 85 PSF

LOCK OPTION # 1
MULTIPOINT LOCK

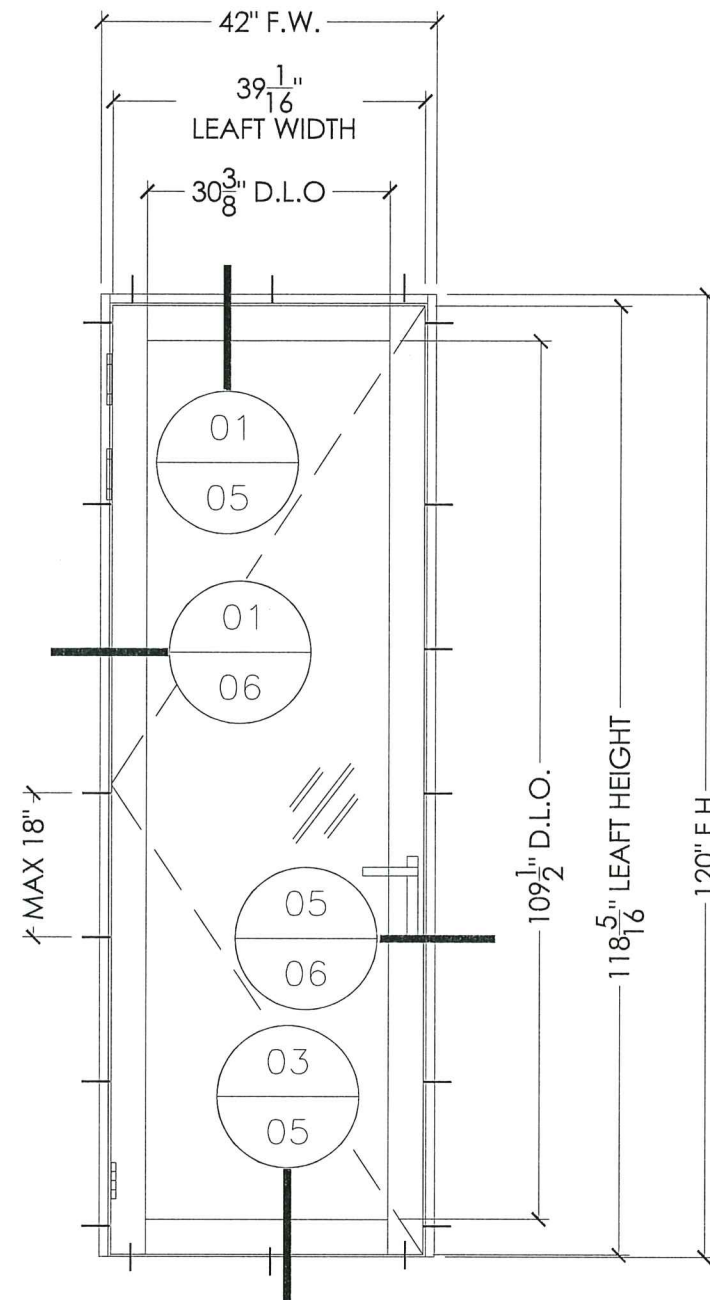

TYPICAL EXTERIOR ELEVATION
SINGLE DOOR

DESIGN LOAD
+ 85 PSF
- 85 PSF

LOCK OPTION # 1
MULTIPOINT LOCK

PRODUCT APPROVED
as complying with the Florida
Building Code
NOA-No. 24-0812.03

Approval Date 09/05/2024

By *Ismael L. Chando*
Miami-Dade Product Control

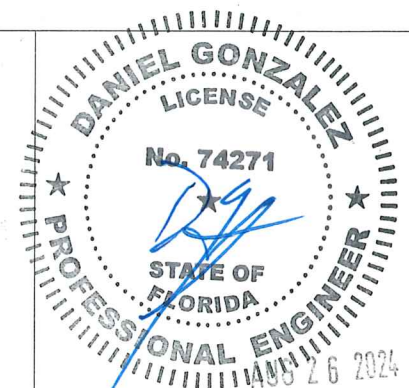

NO.	DATE	BY	REVISION

SERIES "CDM-D100"
ALUMINUM
OUTSWING DOOR
(LMI)

Drawings No:	CDM 2024-08
Drawn by:	AP
Checked by:	DG
Date:	08/5/24
Scale:	

SHEET No:
2 of 10

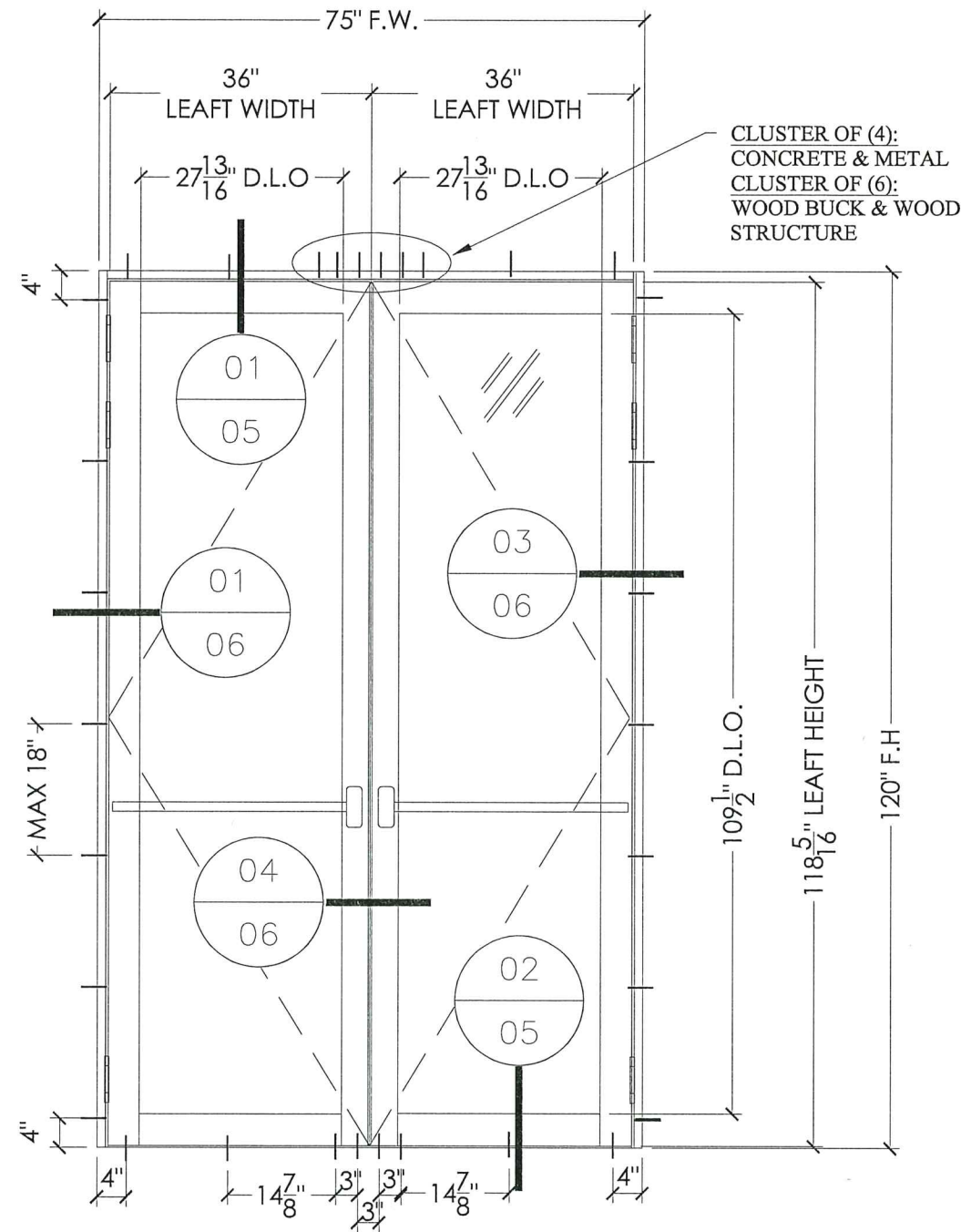

TYPICAL EXTERIOR ELEVATION
DOUBLE DOOR

DESIGN LOAD
+ 85 PSF
- 85 PSF

LOCK OPTION # 2
CONCEALED VERTICAL
ROD PANIC DEVICE

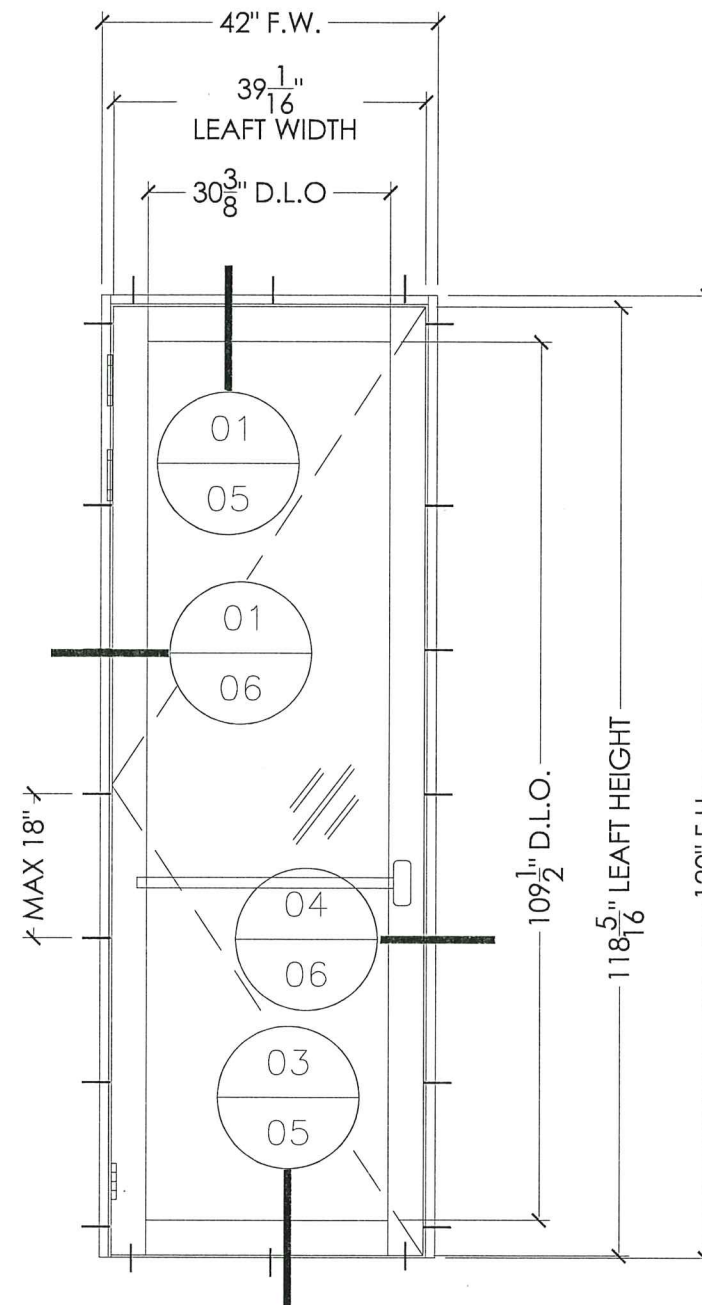

TYPICAL EXTERIOR ELEVATION
SINGLE DOOR

DESIGN LOAD
+ 85 PSF
- 85 PSF

LOCK OPTION # 2
CONCEALED VERTICAL
ROD PANIC DEVICE

PRODUCT APPROVED
as complying with the Florida
Building Code
NOA-No. 24-0812.03

Approval Date 09/05/2024

By *Isheq I. Chande*
Miami-Dade Product Control

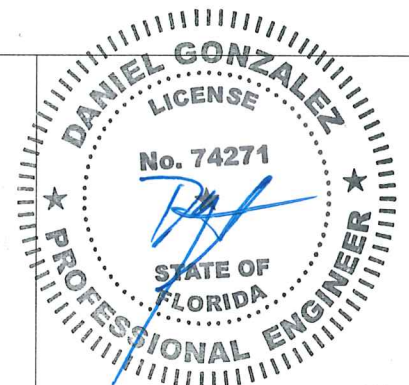

AUG 26 2024



AM American Consulting, Inc.
14331 SW 120th Street, Suite 213, Miami, FL 33186
Ph (786) 219 9490 / www.americanconsulting.com
Cert. Authorization No. 31388

CDM
IMPACT SYSTEM
8303 NW 27th Street, Suite 17, Doral, FL 33122 / Ph: 305-267-1011

NO.	DATE	BY	REVISION

SERIES "CDM-D100"
ALUMINUM
OUTSWING DOOR
(LMI)

Drawings No:	CDM 2024-08
Drawn by:	AP
Checked by:	DG
Date:	08/5/24
Scale:	

SHEET No:
3 of 10

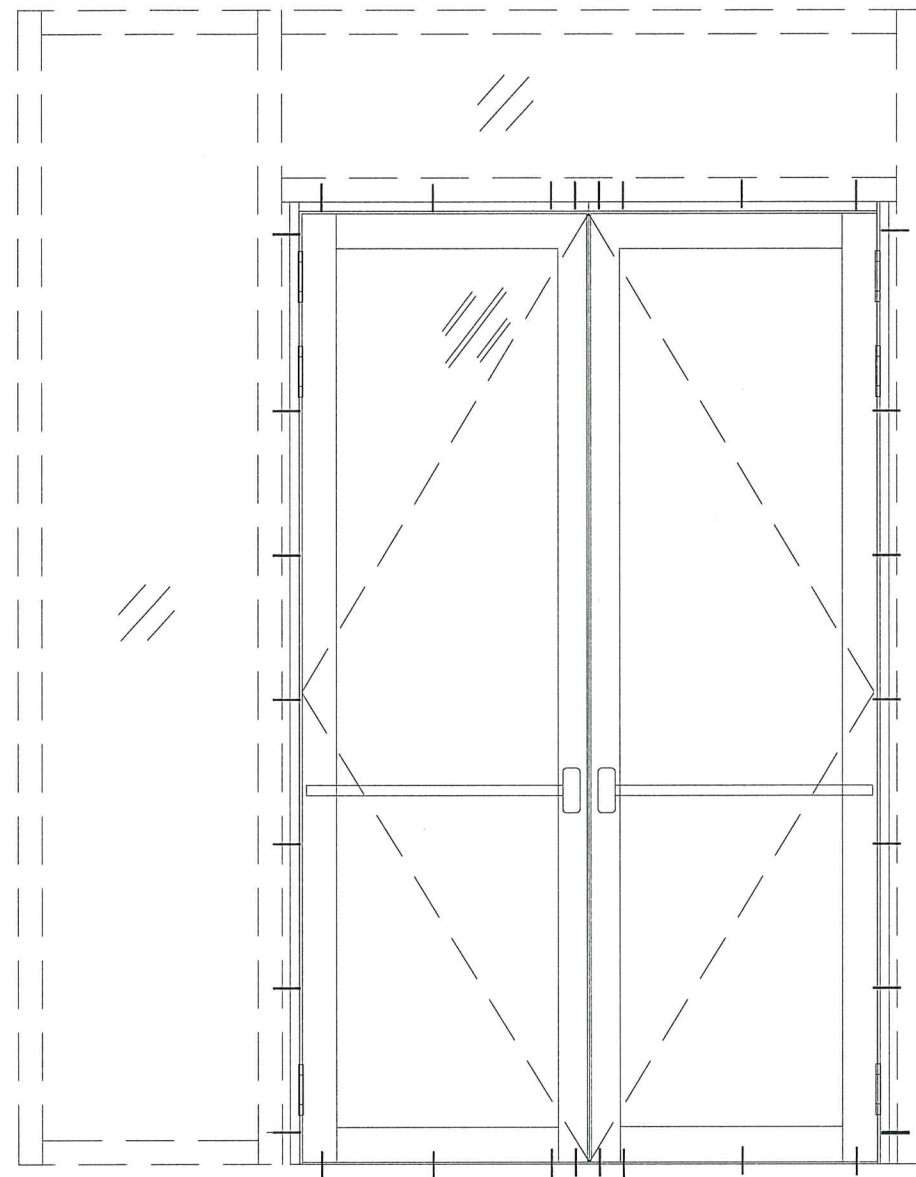

UNDER SEPARATED
APPROVAL SEE
NOA OF CDM
WINDOW WALL
(SERIES AC-0113)
FOR RATING &
DETAILS
LOWER DESIGN
PRESSURE FROM
WINDOW WALL OR
DOOR CONTROL

TYPICAL EXTERIOR ELEVATION
DOUBLE DOOR

DESIGN LOAD
+ 85 PSF
- 85 PSF

LOCK OPTION # 1
LOCK OPTION # 2

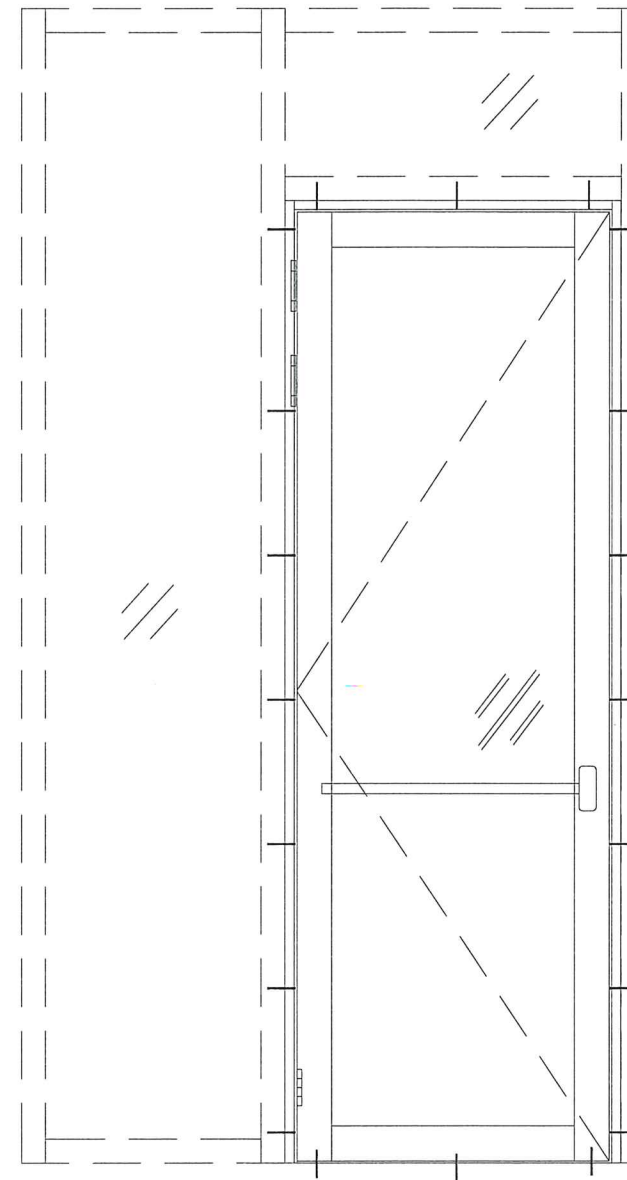

UNDER SEPARATED
APPROVAL SEE
NOA OF CDM
WINDOW WALL
(SERIES AC-0113)
FOR RATING &
DETAILS
LOWER DESIGN
PRESSURE FROM
WINDOW WALL OR
DOOR CONTROL

TYPICAL EXTERIOR ELEVATION
SINGLE DOOR

DESIGN LOAD
+ 85 PSF
- 85 PSF

LOCK OPTION # 1
LOCK OPTION # 2

PRODUCT APPROVED
as complying with the Florida
Building Code
NOA-No. 24-0812.03
Approval Date 09/05/2024
By *Isheq L. Chande*
Miami-Dade Product Control

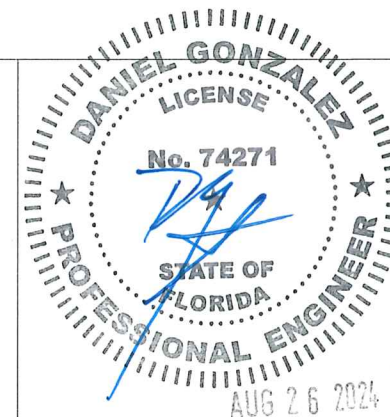

NO.	DATE	BY	REVISION

SERIES "CDM-D100"
ALUMINUM
OUTSWING DOOR
(LMI)

Drawings No:	CDM 2024-08
Drawn by:	AP
Checked by:	DG
Date:	08/5/24
Scale:	

SHEET No:
4 of 10

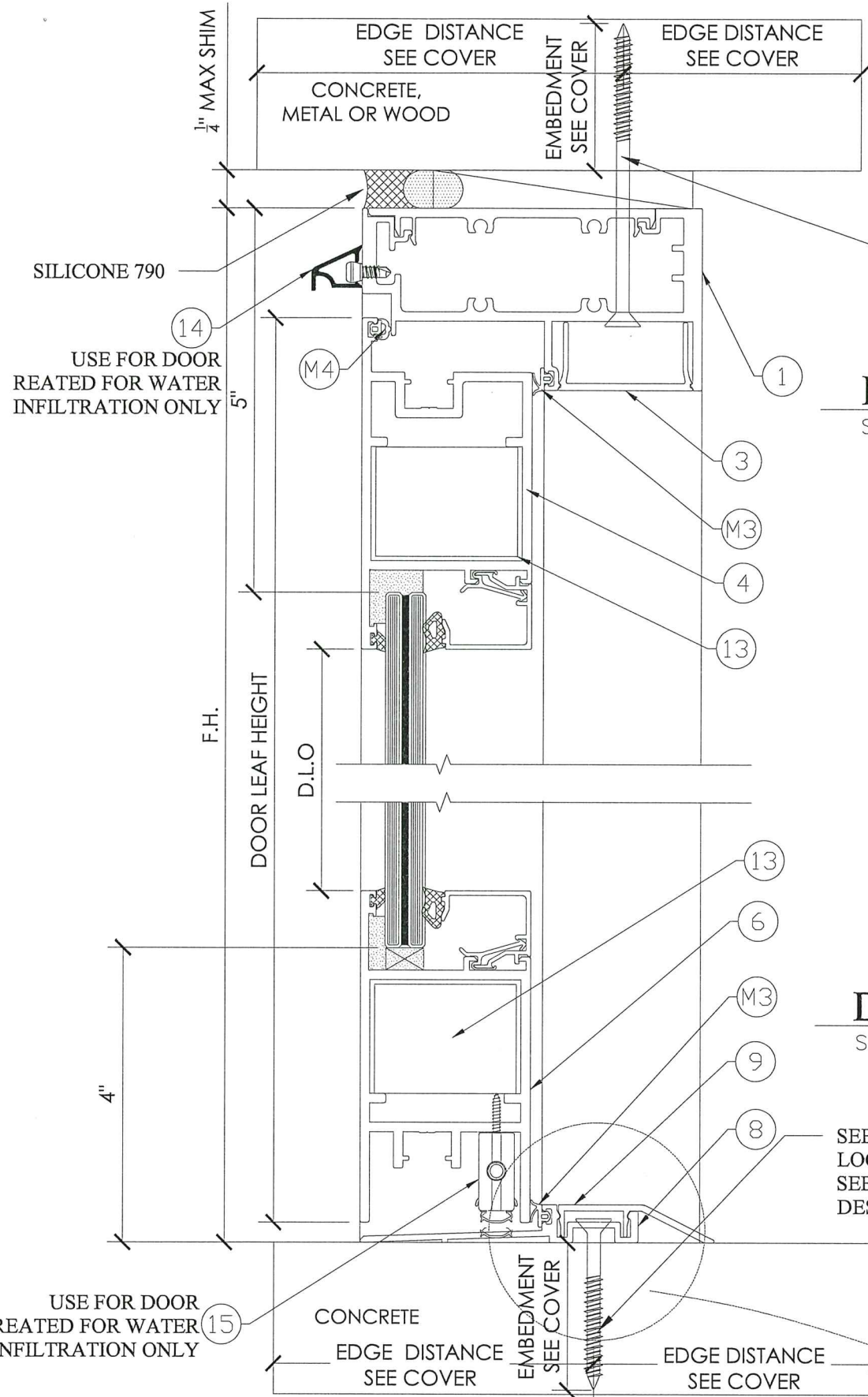

DETAIL-01

SCALE: 6"=1'-0"

SEE SHEET 2 & 3 FOR
LOCATION & QUANTITIES
SEE SHEET 1 FOR ANCHOR
DESCRIPTIONS

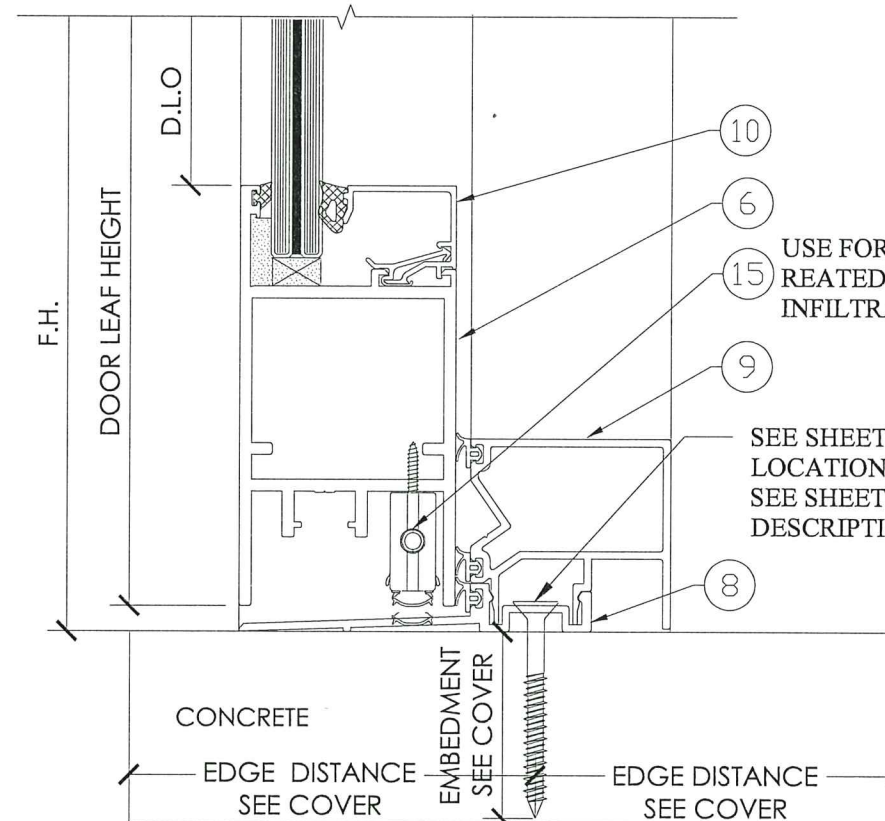

DETAIL-03

SCALE: 6"=1'-0"

HIGH THRESHOLD

APPROVED FOR WATER INFILTRATION RESISTANCE

USE FOR DOOR
REATED FOR WATER
INFILTRATION ONLY

SEE SHEET 2 & 3 FOR
LOCATION & QUANTITIES
SEE SHEET 1 FOR ANCHOR
DESCRIPTIONS

USE FOR DOOR
REATED FOR WATER
INFILTRATION ONLY

ADA THRESHOLD
NO APPROVED FOR WATER INFILTRATION RESIST

DETAIL-02

SCALE: 6"=1'-0"

SEE SHEET 2 & 3 FOR
LOCATION & QUANTITIES
SEE SHEET 1 FOR ANCHOR
DESCRIPTIONS

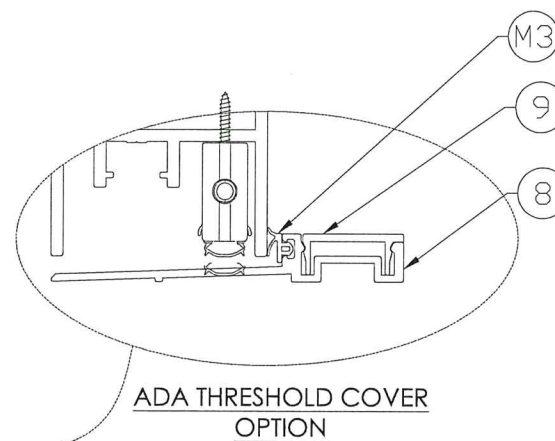

NO APPROVED FOR WATER INFILTRATION RESIST

PRODUCT APPROVED
as complying with the Florida
Building Code
NOA-No. 24-0812.03

Approval Date 09/05/2024

By *Ismael L. Chando*
Miami-Dade Product Control

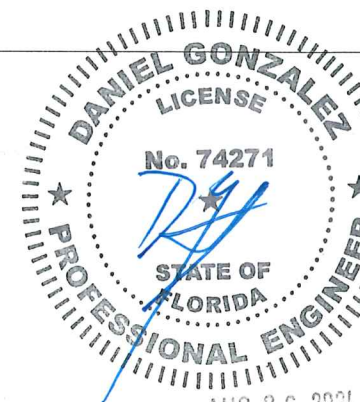

SERIES "CDM-D100"
ALUMINUM
OUTSWING DOOR
(LMI)

Drawings No:
CDM 2024-08
Drawn by: AP
Checked by: DG
Date: 08/5/24
Scale:

SHEET No:
5 of 10

AM American Consulting, Inc.
14331 SW 120th Street, Suite 213, Miami, FL 33186
Ph (786) 219 9490 / www.americanconsulting.com
Cert. Authorization No. 31388

IMPACT SYSTEM
8303 NW 27th Street, Suite 17, Doral, FL 33122 / Ph: 305-267-1011

NO.	DATE	BY	REVISION

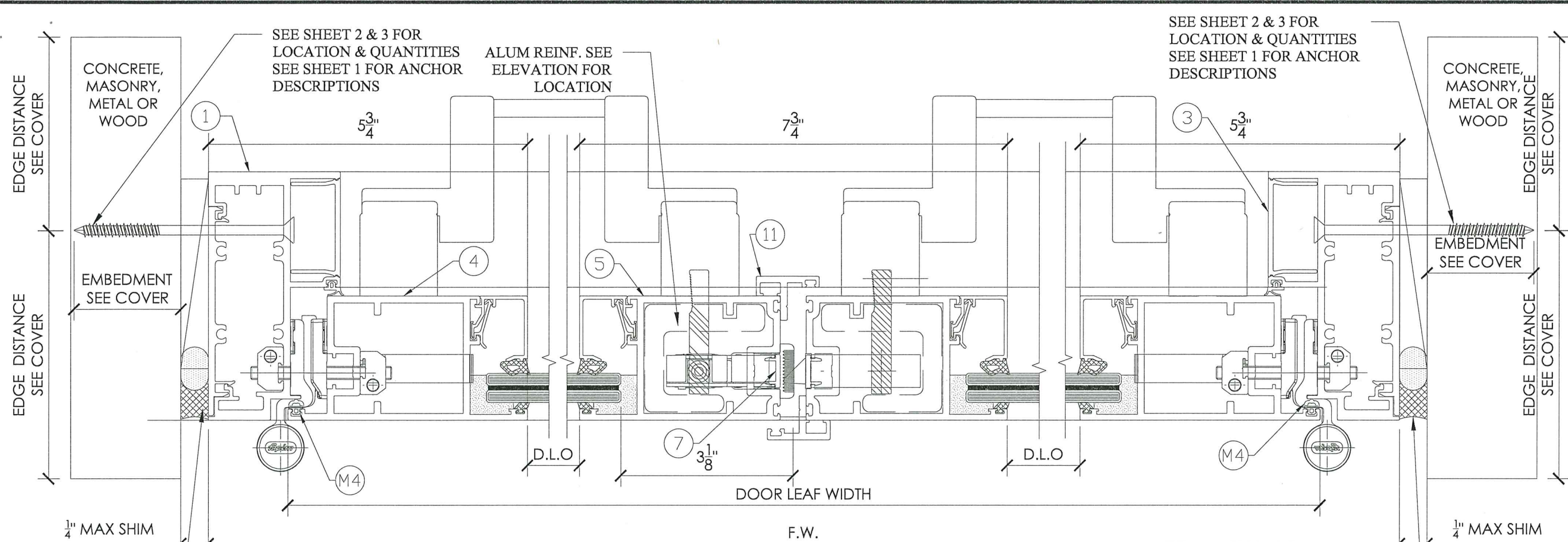

DETAIL-01
SCALE: 6"=1'-0"

DETAIL-02
SCALE: 6"=1'-0"

DETAIL-03
SCALE: 6"=1'-0"

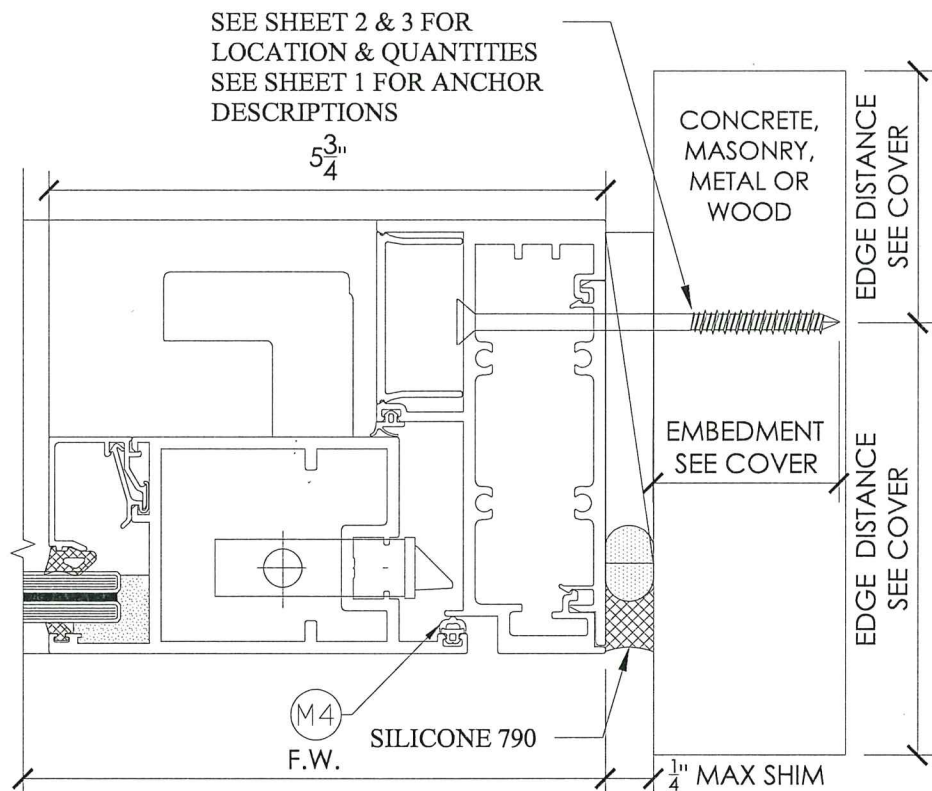

DETAIL-05
SCALE: 6"=1'-0"

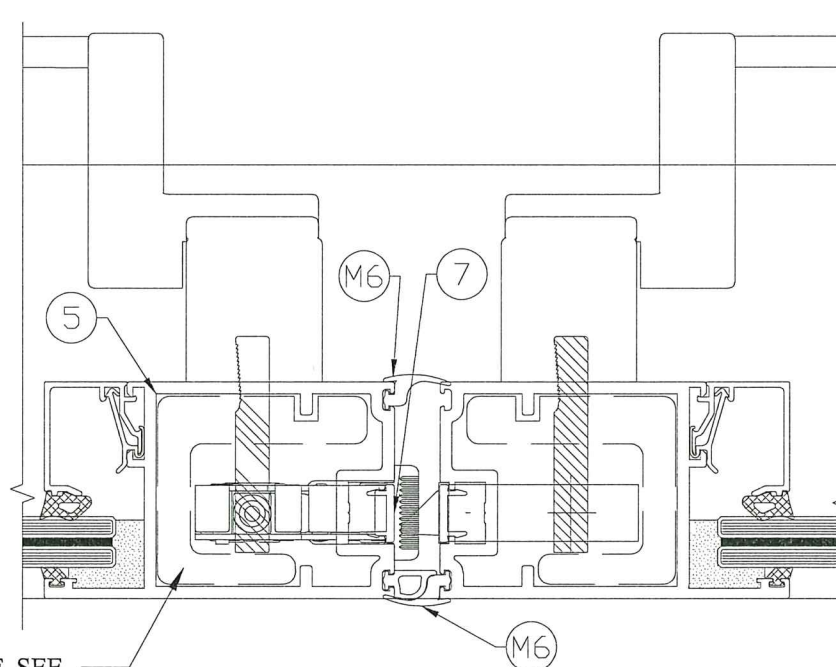

DETAIL-04
SCALE: 6"=1'-0"

PRODUCT APPROVED
as complying with the Florida
Building Code
NOA-No. 24-0812.03
Approval Date 09/05/2024
By *Ismael L. Chando*
Miami-Dade Product Control

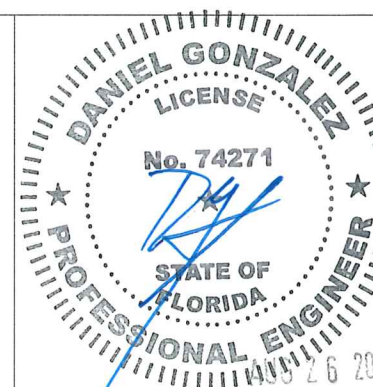

NO.	DATE	BY	REVISION

LOCK OPTION #1 :

MAX FRAME HEIGHT = 120 IN.
 MAX LEAF WIDTH = 36 IN.
 MAX DESIGN LOAD = +85 PSF , -85 PSF
ACTIVE LEAF:
 KEY OPERATED FIVE POINT LOCK SYSTEM
 SERIES 854/855 BY 'FUHR' LOCATED AT 11 ⁵/₈" ,
 38 ³/₈" , AND 70 ¹/₄" FROM BOTTOM.
 A THUMB TURN ON THE INTERIOR LOCATED
 AT 41"
 KEY OPERATED ON EXTERIOR AND INTERIOR
INACTIVE LEAF:
 MANUALLY OPERATED TWO POINT LOCK
 SYSTEM BY 'FUHR' WITH FLUSH BOLTS AT
 TOP AND BOTTOM OF MEETING STILE.

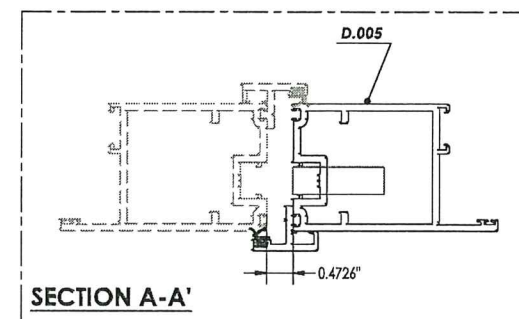
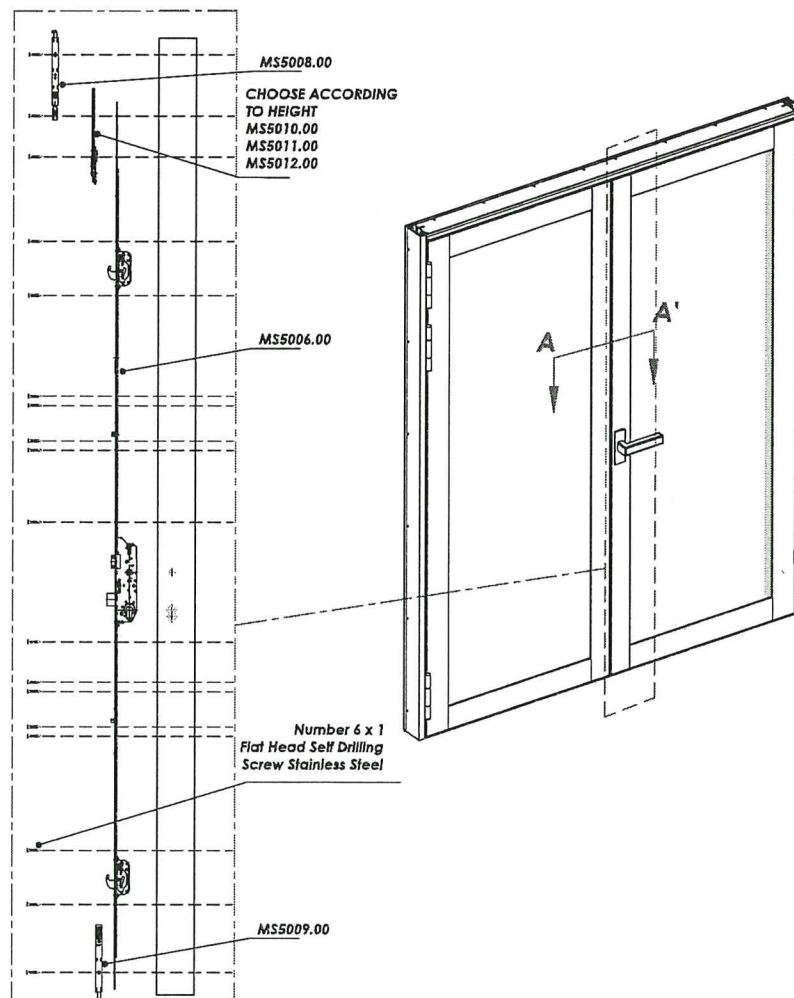
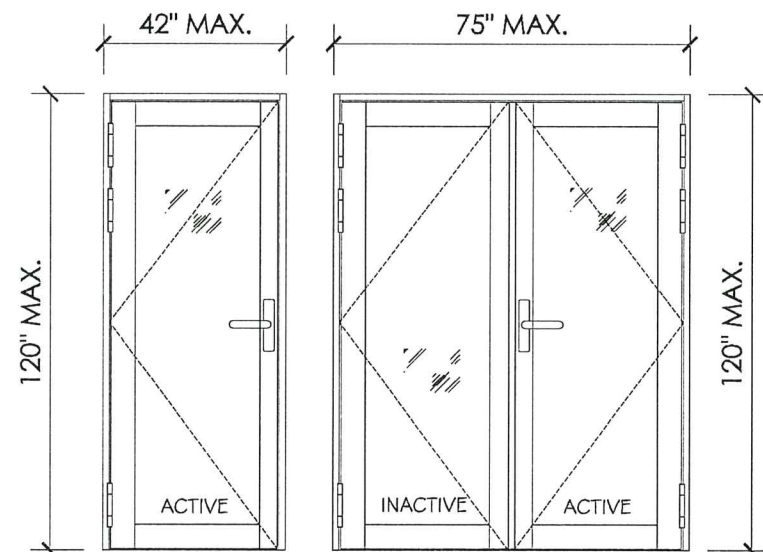

Hardware

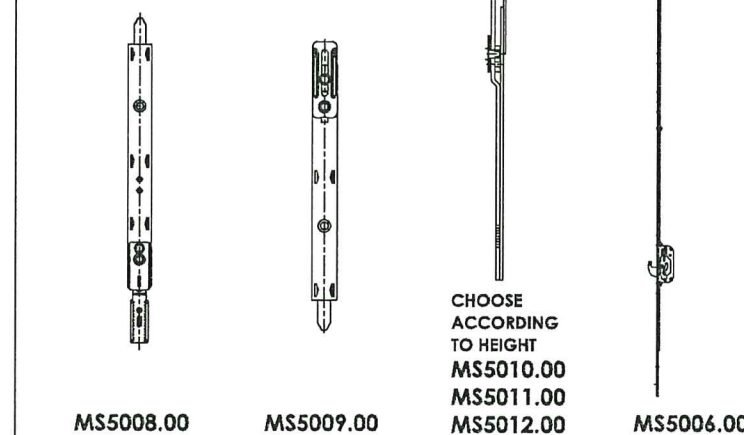

LOCK OPTION #2 :

MAX FRAME HEIGHT = 120 IN.
 MAX LEAF WIDTH = 36 IN.
 MAX DESIGN LOAD = +85 PSF , -85 PSF

ACTIVE & INACTIVE LEAF:
 CONCEALED VERTICAL ROD PANIC DEVICE SERIE
 8600/G86 BY ADAMS RITE/ASSA ABLOY. LOCATED AT 41"
 FROM BOTTOM AT EACH LEAF.

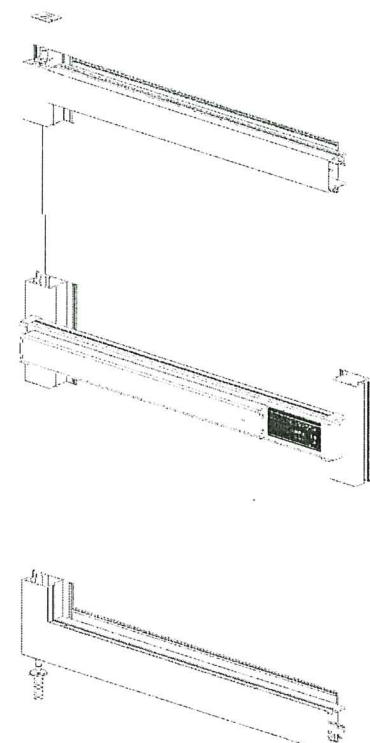
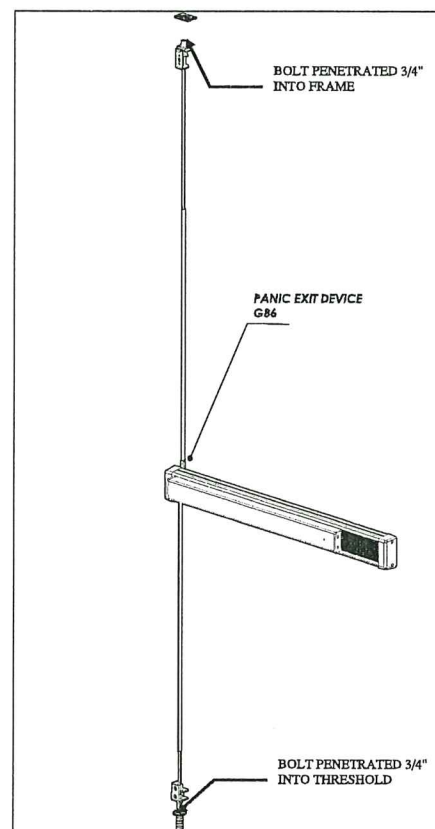
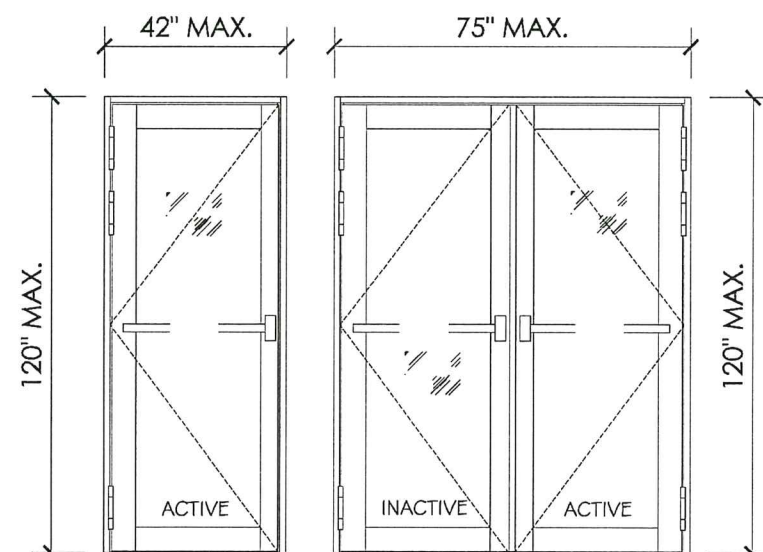

PRODUCT APPROVED
 as complying with the Florida
 Building Code
 NOA-No. 24-0812.03
 Approval Date 09/05/2024
 By Ishay I. Chande
 Miami-Dade Product Control

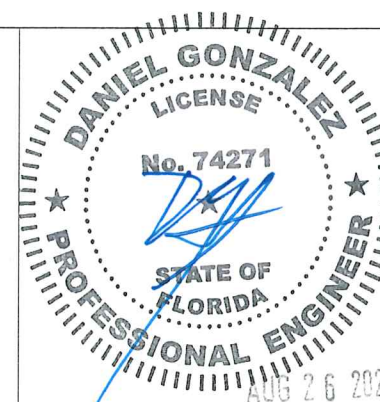

SERIES "CDM-D100"
 ALUMINUM
 OUTSWING DOOR
 (LMI)

Drawings No:
 CDM 2024-08

Drawn by: AP
 Checked by: DG
 Date: 08/5/24
 Scale:

SHEET No:
 7 of 10

NO.	DATE	BY	REVISION

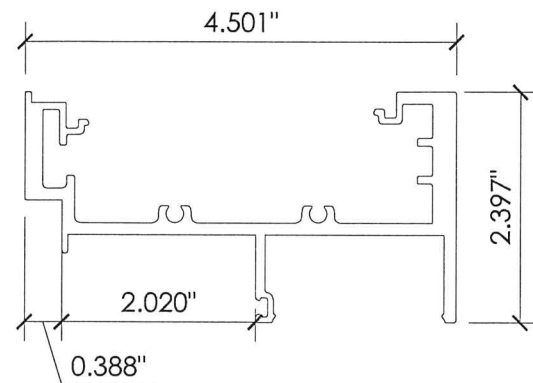

① ACD001 - FRAME HEAD/ JAMB
ALUM. 6063- T6

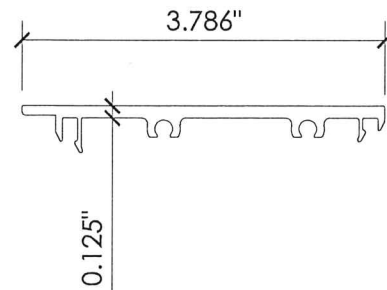

② ACD002 - FRAME SNAP COVER
ALUM. 6063- T6

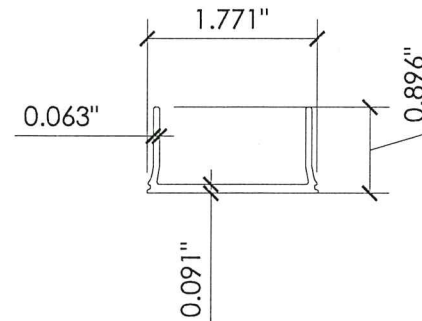

③ ACD003 - FRAME SCREW COVER
ALUM. 6063- T6

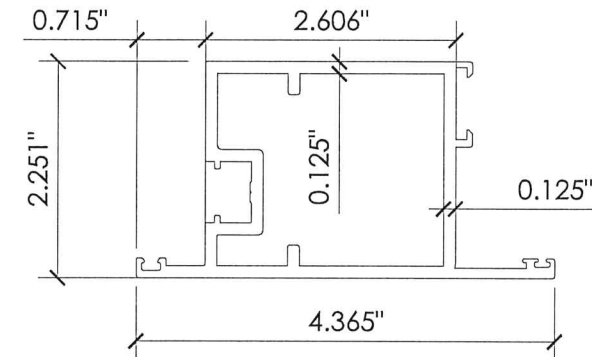

④ ACD004 - PANEL HEAD/ JAMB
ALUM. 6063- T6

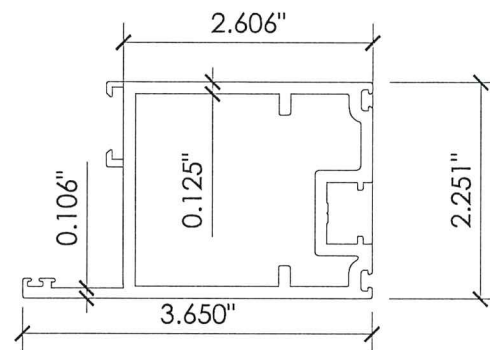

⑤ ACD005- PANEL JAMB
ALUM. 6063- T6

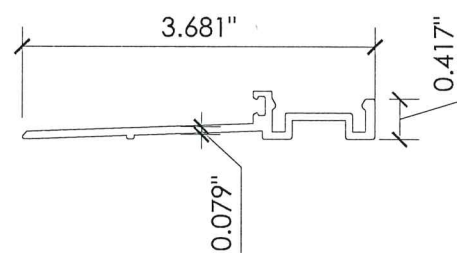

⑧ ACD010- THRESHOLD
ALUM. 6063- T6

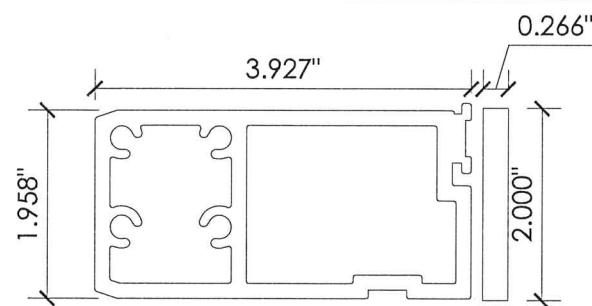

⑫ ACD019 T-JUNCTION
PVC OR ALUM. 6063- T6

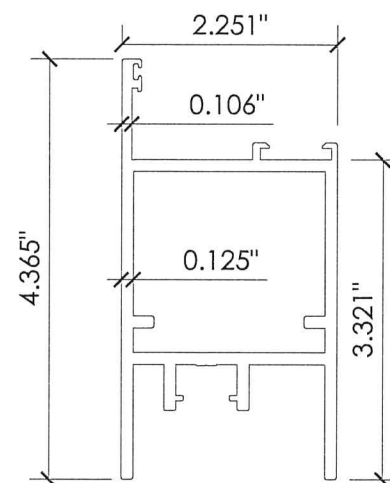

⑥ ACD006- 4\"/>

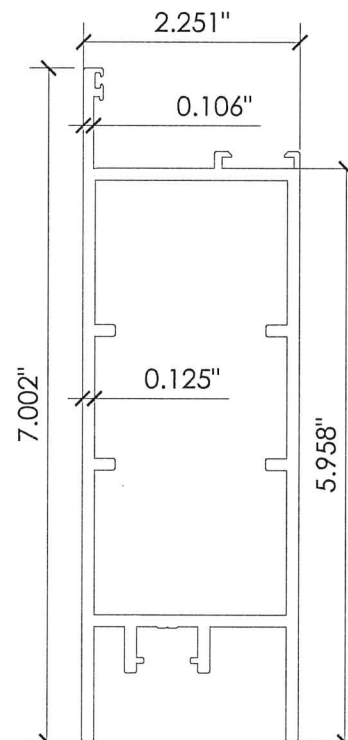

ACD007- 7\"/>

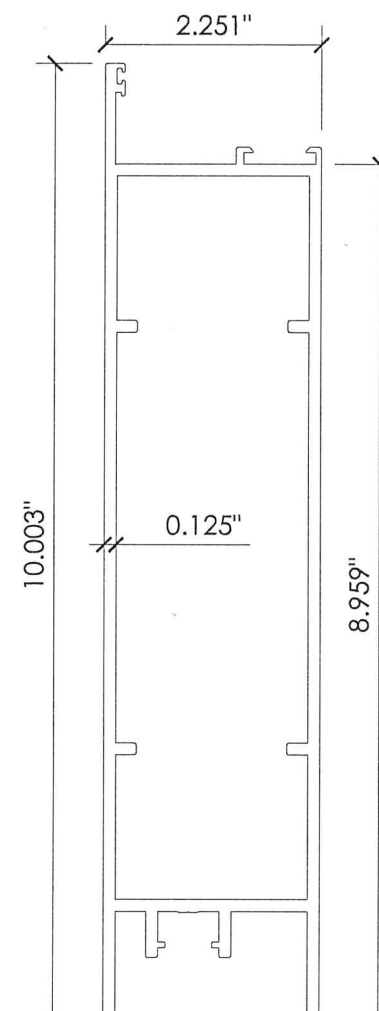

ACD008- 10\"/>

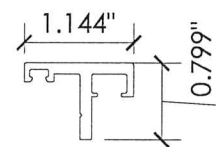

⑪ ACD017 MEETING RAIL ADAPTOR
INTELOCK SEAL
ALUM. 6063- T6

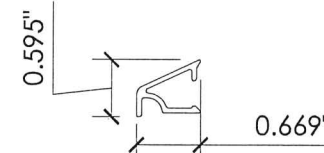

⑬ ACD021 DRIP CAP
ALUM. 6063- T6

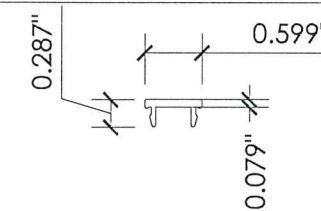

⑦ ACD009- 4\"/>

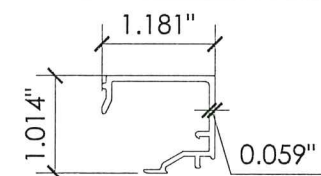

ACD014 GLASS STOP
LAMINATED GLASS
ALUM. 6063- T6

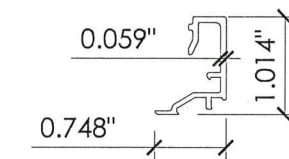

⑩ ACD015 GLASS STOP
INS. LAMI GLASS
ALUM. 6063- T6

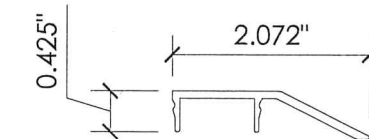

ACD011 ADA THRESHOLD
ALUM. 6063- T6

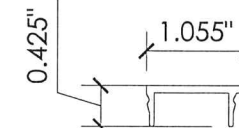

ACD012 ADA THRESHOLD
ALUM. 6063- T6

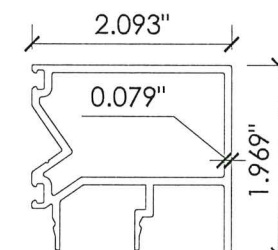

⑨ ACD013 ADA THRESHOLD
ALUM. 6063- T6

PRODUCT APPROVED
as complying with the Florida
Building Code
NOA-No. 24-0812.03

Approval Date 09/05/2024

By *Isheq I. Chande*
Miami-Dade Product Control

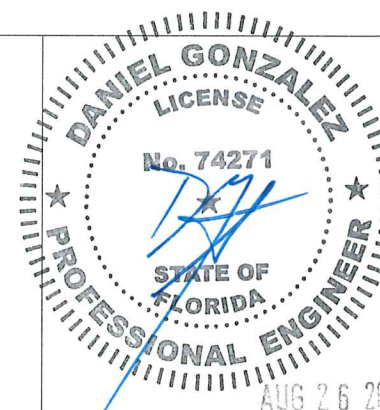







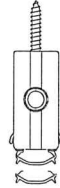
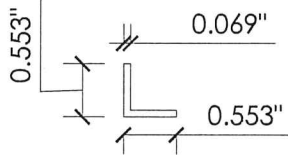
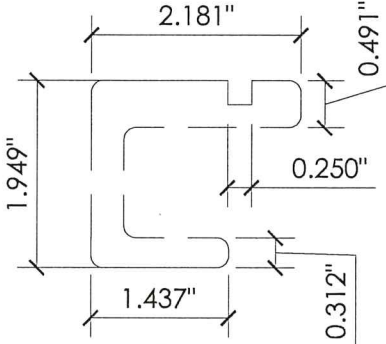

NO.	DATE	BY	REVISION

SERIES "CDM-D100"
ALUMINUM
OUTSWING DOOR
(LMI)

Drawings No:
CDM 2024-08
Drawn by: AP
Checked by: DG
Date: 08/5/24
Scale:

SHEET No:
8 of 10

				
14 <u>ACD022 DOOR SWEEP</u>	15 <u>ACD023 THRESHOLD CLIP</u> ALUM. 6063- T6	16 <u>ACD024 INTERLOCK REINFORCEMENT</u> ALUM.6063- T6	M1 <u>G-01 GASKET</u>	M2 <u>G-02 GASKET</u>
				
M3 <u>G-03 GASKET</u>	M4 <u>G-04 GASKET</u>	M5 <u>G-05 GASKET</u>	M6 <u>G-06 GASKET</u>	M7 <u>CLICK FOR GLASS STOP</u>

PRODUCT APPROVED
as complying with the Florida
Building Code
NOA-No. 24-0812.03
Approval Date 09/05/2024
By *Ishay I. Chandra*
Miami-Dade Product Control

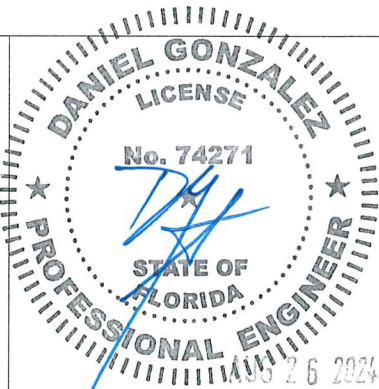

SERIES "CDM-D100"
ALUMINUM
OUTSWING DOOR
(LMI)

Drawings No:
CDM 2024-08
Drawn by: AP
Checked by: DG
Date: 08/5/24
Scale:

SHEET No:
9 of 10



AM American Consulting, Inc.
14331 SW 120th Street, Suite 213, Miami, FL 33186
Ph (786) 219 9490 / www.americanconsulting.com
Cert. Authorization No. 31388

IMPACT SYSTEM
8303 NW 27th Street, Suite 17, Doral, FL 33122 /Ph: 305-267-1011

NO.	DATE	BY	REVISION

BILL OF MATERIALS				
ITEM	PART	DESCRIPTION	MATERIAL	MANUF. / REMARKS
1	ACD001	FRAME HEAD/JAMB	ALUM. 6063-T6	CDM IMPACT WINDOWS , LLC
2	ACD002	FRAME SNAP COVER	ALUM. 6063-T6	CDM IMPACT WINDOWS , LLC
3	ACD003	FRAME SCREW COVER	ALUM. 6063-T6	CDM IMPACT WINDOWS , LLC
4	ACD004	PANEL HEAD/JAMB (HINGE SIDE)	ALUM. 6063-T6	CDM IMPACT WINDOWS , LLC
5	ACD005	PANEL JAMB (LOCK SIDE)	ALUM. 6063-T6	CDM IMPACT WINDOWS , LLC
6	ACD006	4" PANEL SILL	ALUM. 6063-T6	CDM IMPACT WINDOWS , LLC
	ACD007	7" PANEL SILL	ALUM. 6063-T6	CDM IMPACT WINDOWS , LLC
	ACD008	10" PANEL SILL	ALUM. 6063-T6	CDM IMPACT WINDOWS , LLC
7	ACD009	JAMB GROOVE COVER	ALUM. 6063-T6	CDM IMPACT WINDOWS , LLC
8	ACD010	THRESHOLD	ALUM. 6063-T6	CDM IMPACT WINDOWS , LLC
9	ACD011	ADA THRESHOLD COVER	ALUM. 6063-T6	CDM IMPACT WINDOWS , LLC
	ACD012	ADA THRESHOLD COVER	ALUM. 6063-T6	CDM IMPACT WINDOWS , LLC
	ACD013	BUMPER THRESHOLD COVER	ALUM. 6063-T6	CDM IMPACT WINDOWS , LLC
10	ACD014	GLASS STOP - LAMINATED GLASS	ALUM. 6063-T6	CDM IMPACT WINDOWS , LLC
	ACD015	GLASS STOP - INSULATED LAMINATED GLASS	ALUM. 6063-T6	CDM IMPACT WINDOWS , LLC
	ACD016	GLASS STOP - 1/4" INTERIOR	ALUM. 6063-T6	CDM IMPACT WINDOWS , LLC
11	ACD017	MEETING RAIL ADAPTOR INTERLOCK SEAL	ALUM. 6063-T6	CDM IMPACT WINDOWS , LLC
12	ACD019	T-JUNCTION EXTRUSION	ALUM. 6063-T6	
	ACD020	T-JUNCTION	ALUM. 6063-T6	MONTECELLI
13	ACD021	DRIP CAP	ALUM. 6063-T6	CDM IMPACT WINDOWS , LLC
14	ACD022	DOOR SWEEP	ALUM. 6063-T6	CDM IMPACT WINDOWS , LLC
15	ACD023	THRESHOLD CLIP	ALUM. 6063-T6	CDM IMPACT WINDOWS , LLC
16	ACD024	INTERLOCK REINFORCEMENT	ALUM. 6063-T6	CDM IMPACT WINDOWS , LLC
M1	G-01	GASKET	SILICONE	VARIES
M2	G-02	GASKET	SILICONE	VARIES
M3	G-03	GASKET	SILICONE	VARIES
M4	G-04	GASKET	SILICONE	VARIES
M5	G-05	GASKET	SILICONE	VARIES
M6	G-06	GASKET	SILICONE	VARIES
M7	-	GLASS STOP CLIP	PVC	VARIES
M8	-	5/16" X 1/2" X 2" LONG SETTING BLOCK, AT 1/4" POINTS	EPDM OR SILICONE	VARIES
S1	-	SILICONE DC 983 OR DC 995	SILICONE	DOW CORNING

PRODUCT APPROVED
as complying with the Florida
Building Code
NOA-No. 24-0812.03
Approval Date 09/05/2024
By Isheq I. Chande
Miami-Dade Product Control

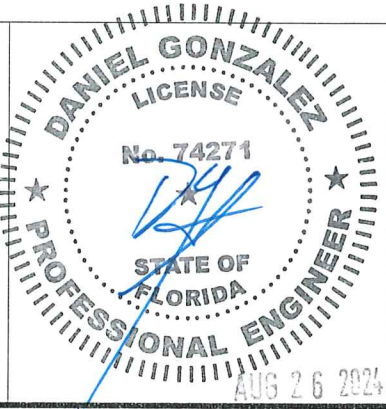

SERIES "CDM-D100"
ALUMINUM
OUTSWING DOOR
(LMI)
Drawings No:
CDM 2024-08
Drawn by: AP
Checked by: DG
Date: 08/5/24
Scale:
SHEET No:
10 of 10

AM American Consulting, Inc.
14331 SW 120th Street, Suite 213, Miami, FL 33186
Ph (786) 219 9490 / www.americanconsulting.com
Cert. Authorization No. 31388

IMPACT SYSTEM
8303 NW 27th Street, Suite 17, Doral, FL 33122 / Ph: 305-267-1011

NO.	DATE	BY	REVISION