



DEPARTMENT OF REGULATORY AND ECONOMIC RESOURCES (RER)
BOARD AND CODE ADMINISTRATION DIVISION

NOTICE OF ACCEPTANCE (NOA)

MIAMI-DADE COUNTY, FLORIDA
PRODUCT CONTROL SECTION

11805 SW 26 Street, Room 208
T (786) 315-2590 F (786) 315-2599

www.miamidade.gov/economy

PGT Industries, LLC
3400 Precision Drive,
North Venice, FL 34275

SCOPE:

This NOA is being issued under the applicable rules and regulations governing the use of construction materials. The documentation submitted has been reviewed and accepted by Miami-Dade County RER - Product Control Section to be used in Miami Dade County and other areas where allowed by the Authority Having Jurisdiction (AHJ).

This NOA shall not be valid after the expiration date stated below. The Miami-Dade County Product Control Section (In Miami Dade County) and/or the AHJ (in areas other than Miami Dade County) reserve the right to have this product or material tested for quality assurance purposes. If this product or material fails to perform in the accepted manner, the manufacturer will incur the expense of such testing and the AHJ may immediately revoke, modify, or suspend the use of such product or material within their jurisdiction. RER reserves the right to revoke this acceptance, if it is determined by Miami-Dade County Product Control Section that this product or material fails to meet the requirements of the applicable building code.

This product is approved as described herein and has been designed to comply with the Florida Building Code, including the High Velocity Hurricane Zone.

DESCRIPTION: Series "670HP" Aluminum Sliding Glass Doors w / Reinforcements

APPROVAL DOCUMENT: Drawing No. PGT0003 Rev I, titled "Series 670 H.P. Aluminum SGD-NI", sheets 1 through 10 of 10, prepared by manufacturer, dated 08/05/07 and last revised on 02/17/25, signed and sealed by Lynn Miller, P.E., bearing the Miami-Dade County Product Control Renewal stamp with the Notice of Acceptance number and expiration date by the Miami-Dade County Product Control Section.

MISSILE IMPACT RATING: None: Approved Hurricane Protection devices, complying w/ FBC, as applicable are required.

Limitations:

1. See **table 1**, sheet **4** of this approved drawing set for applicable SGD unit sizes, design pressures, reinforcements, glass types, sill riser for positive DP limit and anchors requirements.
2. Applicable, egress operable doors must comply with min. clear width & height requirements per FBC.

RENEWAL of this NOA shall be considered after a renewal application has been filed and there has been no change in the applicable building code negatively affecting the performance of this product.

TERMINATION of this NOA will occur after the expiration date or if there has been a revision or change in the materials, use, and/or manufacture of the product or process. Misuse of this NOA as an endorsement of any product, for sales, advertising or any other purposes shall automatically terminate this NOA. Failure to comply with any section of this NOA shall be cause for termination and removal of NOA.

ADVERTISEMENT: The NOA number preceded by the words Miami-Dade County, Florida, and followed by the expiration date may be displayed in advertising literature. If any portion of the NOA is displayed, then it shall be done in its entirety.

INSPECTION: A copy of this entire NOA shall be provided to the user by the manufacturer or its distributors and shall be available for inspection at the job site at the request of the Building Official.

This NOA **revises & renews NOA # 23-0710.04 (PGT Industries, Inc.)** and consists of this page 1 and evidence pages E-1, E-2, E-3, E-4 & E-5, as well as approval document mentioned above.

The submitted documentation was reviewed by **Ishaq I. Chanda, P. E.**



Ishaq I. Chanda

NOA No. 25-0220.02
Expiration Date: March 24, 2030
Approval Date: March 13, 2025
Page 1

NOTICE OF ACCEPTANCE: EVIDENCE SUBMITTED

1. Evidence submitted under previous approvals

A. DRAWINGS

1. Manufacturer's die drawings and sections (See test report below).
2. Drawing No. **PGT0003 Rev E**, titled "Series 670 H.P. Aluminum SGD-NI", sheets 1 through 10 of 10, prepared by manufacturer, dated 08/05/07 and last revised on 06/08/16, signed and sealed by Lynn Miller, P.E.

B. TESTS

1. REF Test report on 1) Uniform Static Air Pressure Test, per FBC, TAS 202-94
2) Large Missile Impact Test per FBC, TAS 201-94
3) Cyclic Wind Pressure Loading per FBC, TAS 203-94

Along with marked-up drawings and installation diagram of Aluminum Sliding Glass Doors (w/ TPS, Super, Cardinal & Duraseal Spacers), prepared by Fenestration Testing Laboratory, Inc., Test Reports No(s) **FTL-8717, FTL-8970 and FTL-8968**, dated 02/15/16, 06/07/16 and 06/20/16, all signed & sealed by Idalmis Ortega, P.E.

2. Test report on 1) Air Infiltration Test, per FBC, TAS 202-94
2) Uniform Static Air Pressure Test, per FBC, TAS 202-94
3) Water Resistance Test, per FBC, TAS 202-94.
4) Forced Entry Test, per FBC 2411.3.2.1 (b) and TAS 202-94

Along with marked-up drawings and installation diagram of Aluminum Sliding Glass Doors, prepared by Fenestration Testing Laboratory, Inc., Test Report No **FTL-5987 and FTL-5995**, dated 08/10/09, both signed & sealed by Julio Gonzales, P.E.(submitted under **#11-1018.18/# 09-0826.14**).

3. REF test report **FTL 7825** for Alum XOX SGD per TAS 201, 202 & 203-94 (submitted under **#15-0106.07**).

C. CALCULATIONS (submitted under #15-0106.07)

1. Anchor verification calculations and structural analysis, complying with FBC 5th Addition (2014), prepared by manufacturer, dated 03/05/15, signed and sealed by Lynn Miller, P.E
2. Glazing complies with ASTM E-1300-02, -04 & -09.

D. QUALITY ASSURANCE

1. Miami Dade Department of Regulatory and Economic Resources (RER).

E. MATERIAL CERTIFICATIONS

1. None

F. STATEMENTS (submitted under #15-0106.07)

1. Statement letter of conformance to and complying with FBC 5th Edition (2014), issued by manufacturer, dated 12/31/14, signed and sealed by Lynn Miller, P. E.
2. Letter of lab compliance, part of the above test reports.

G. OTHER

1. This NOA revises **# 15-0106.07**, expiring March 24, 2020.
2. Test proposal **# 16-0152** dated 03/09/16 approved by RER.
3. AAMA's Technical Paper for SGD & Bi-fold doors referenced to FBC 2014 (5th edition).
4. Test proposal dated 6/4/13 & 08/12/13 approved by Jaime Gascon, P.E.
5. Test proposals No(s) **09-0177, 0177-A, B & C** approved by BCCO.

Ishaq I. Chanda
Ishaq I. Chanda, P. E.

Product Control Unit Supervisor

NOA No. 25-0220.02

Expiration Date: March 24, 2030

Approval Date: March 13, 2025

NOTICE OF ACCEPTANCE: EVIDENCE SUBMITTED

2. Evidence submitted under previous submittal

A. DRAWINGS

1. Drawing No. **PGT0003 Rev F**, titled "Series 670 H.P. Aluminum SGD-NI", sheets 1 through 10 of 10, prepared by manufacturer, dated 08/05/07 and last revised on 086/108/17, signed and sealed by Lynn Miller, P.E.

B. TESTS

1. REF Test report on 1) Uniform Static Air Pressure Test, per FBC, TAS 202-94
2) Large Missile Impact Test per FBC, TAS 201-94
3) Cyclic Wind Pressure Loading per FBC, TAS 203-94

Along with marked-up drawings and installation diagram of Aluminum Sliding Glass Doors (w/ Fixed glass clips), prepared by Fenestration Testing Laboratory, Inc., Test Reports No(s) **FTL-7468**, dated 08/23/13, signed & sealed by Jorge A. Naya, Jr, P.E.

C. CALCULATIONS

1. Anchor verification calculations and structural analysis, complying with FBC 2014(5th Edition) and FBC 2017(6th Edition), prepared by manufacturer, dated 04/08/7 and last revised on 08/10/17, signed and sealed by Lynn Miller, P. E.
2. Glazing complies with ASTM E-1300-02, -04 & -09.

D. QUALITY ASSURANCE

1. Miami Dade Department of Regulatory and Economic Resources (RER).

E. MATERIAL CERTIFICATIONS

1. None.

F. STATEMENTS

1. Statement letter of conformance to FBC 2014 (5th Edition) & FBC 2017 (6th Edition), issued by manufacturer, dated 08/10/17, signed and sealed by Lynn Miller, P. E.

G. OTHER

1. This NOA **revises # 16-0629.04**, expiring March 24, 2020.

3. Evidence submitted under previous approval.

A. DRAWINGS

2. Drawing No. **PGT0003 Rev F**, titled "Series 670 H.P. Aluminum SGD-NI", sheets 1 through 10 of 10, prepared by manufacturer, dated 08/05/07 and last revised on 086/108/17, signed and sealed by Lynn Miller, P.E.

B. TESTS

1. REF Test report on 1) Uniform Static Air Pressure Test, per FBC, TAS 202-94
2) Large Missile Impact Test per FBC, TAS 201-94
3) Cyclic Wind Pressure Loading per FBC, TAS 203-94

Along with marked-up drawings and installation diagram of Aluminum Sliding Glass Doors (w/ Fixed glass clips), prepared by Fenestration Testing Laboratory, Inc. Test Reports No(s) **FTL-7468**, dated 08/23/13, signed & sealed by Jorge A. Naya, Jr, P.E. *Ishaq I. Chanda*

Ishaq I. Chanda, P. E.
Product Control Unit Supervisor
NOA No. 25-0220.02
Expiration Date: March 24, 2030
Approval Date: March 13, 2025

NOTICE OF ACCEPTANCE: EVIDENCE SUBMITTED

C. CALCULATIONS (submitted under file #17-0420.10)

1. None.
2. Glazing complies with ASTM E-1300-02, -04 & -09

D. QUALITY ASSURANCE

1. Miami Dade Department of Regulatory and Economic Resources (RER).

E. MATERIAL CERTIFICATIONS

1. None.

F. STATEMENTS

1. Statement letter of conformance to FBC 2014 (5th Edition) & FBC 2017 (6th Edition), issued by manufacturer, dated 08/10/17, signed and sealed by Lynn Miller, P. E.

G. OTHER

1. This NOA **renews # 17-0420.10**, expiring March 24, 2025.

4. Evidence submitted under previous approval

A. DRAWINGS

1. Drawing No. **PGT0003 Rev G**, titled "Series 670 H.P. Aluminum SGD-NI", sheets 1 through 10 of 10, prepared by manufacturer, dated 08/05/07 and last revised on 04/22/20, signed and sealed by Lynn Miller, P.E.

B. TESTS

1. Test reports on: 1) Air Infiltration Test, per FBC, TAS 202-94
2) Uniform Static Air Pressure Test, Loading per FBC, TAS 202-94
3) Water Resistance Test, per FBC, TAS 202-94
4) Large Missile Impact Test per FBC, TAS 201-94
5) Cyclic Wind Pressure Loading per FBC, TAS 203-94

along with marked-up drawings and installation diagram of all PGT Industries, Inc.

representative units listed below and tested to qualify **Dowsil 791** and **Dowsil 983** silicones, prepared by Fenestration Testing Laboratory, Inc., Test Reports No.:

FTL-7897, PGT PW5520 PVC Fixed Window (unit 6 in proposal), dated 09/03/14

FTL-20-2107.1, PGT SGD780 Aluminum Sliding Glass Door (unit 7 in proposal) **FTL-20-**

2107.2, PGT CA740 Alum. Outswing Casement Window (unit 8 in proposal) **FTL-20-2107.3**,

PGT PW7620A Aluminum Fixed Window (unit 9 in proposal) and **FTL-20-2107.4**, PGT

PW7620A Aluminum Fixed Window (unit 10 in proposal) dated 07/13/20, all signed and sealed by Idalmis Ortega, P.E.

C. CALCULATIONS

1. Anchor verification calculations and structural analysis, complying with **FBC 7th Edition (2020)**, dated 04/22/20, prepared by manufacturer, signed and sealed by Anthony Lynn Miller, P.E.
2. Glazing complies with **ASTM E1300-04, -09, -12 and -16**.

Ishaq I. Chanda

Ishaq I. Chanda, P. E.
Product Control Unit Supervisor
NOA No. 25-0220.02
Expiration Date: March 24, 2030
Approval Date: March 13, 2025

PGT Industries, LLC

NOTICE OF ACCEPTANCE: EVIDENCE SUBMITTED

4. Evidence submitted (continue):

D. QUALITY ASSURANCE

1. Miami Dade Department of Regulatory and Economic Resources (RER).

E. MATERIAL CERTIFICATIONS

1. None.

F. STATEMENTS

1. Statement letters of conformance to FBC 2020(7th Edition), dated 04/18/20, prepared, signed & sealed by Lynn Miller, P. E.

G. OTHER

1. This NOA revises **NOA #19-1126.02** and updates to FBC 2020 (7th Edition), expiring 03/24/25.
2. RER Test proposals **#19-1155** dated 01/10/20 approved by Ishaq I. Chanda, P.E, expiring 04/14/21 expiring 04/07/25.

Ishaq I. Chanda

Ishaq I. Chanda, P. E.
Product Control Unit Supervisor
NOA No. 25-0220.02
Expiration Date: March 24, 2030
Approval Date: March 13, 2025

NOTICE OF ACCEPTANCE: EVIDENCE SUBMITTED

5. Evidence submitted under previous approval

A. DRAWINGS

1. Drawing No. **PGT0003 Rev H**, titled "Series 670 H.P. Aluminum SGD-NI", sheets 1 through 10 of 10, prepared by manufacturer, dated 08/05/07 and last revised on 06/18/23, signed and sealed by Lynn Miller, P.E.

B. TESTS (submitted under previous approval)

1. None.

C. CALCULATIONS (submitted under previous approval)

1. None.

D. QUALITY ASSURANCE

1. Miami Dade Department of Regulatory and Economic Resources (RER).

E. MATERIAL CERTIFICATIONS

1. None.

F. STATEMENTS

1. Statement letter of conformance, complying with **FBC 7th Edition (2020)** and the **FBC 8th Edition (2023)**, dated 06-18-23, issued by manufacturer, signed and sealed by Anthony Lynn Miller, P.E.
2. Statement letters of conformance to FBC 2020(7th Edition), dated 04/18/20, prepared, signed & sealed by Lynn Miller, P. E.

G. OTHER

1. This NOA revises **NOA #20-0429.08** and updates to FBC 2023 (8th Edition), expiring 03/24/25.

Ishaq I. Chanda

Ishaq I. Chanda, P. E.
Product Control Unit Supervisor
NOA No. 25-0220.02
Expiration Date: March 24, 2030
Approval Date: March 13, 2025

NOTICE OF ACCEPTANCE: EVIDENCE SUBMITTED

6. New Evidence submitted

A. DRAWINGS

1. Drawing No. **PGT0003 Rev I**, titled "Series 670 H.P. Aluminum SGD-NI", sheets 1 through 10 of 10, prepared by manufacturer, dated 08/05/07 and last revised on 02/187/25, signed and sealed by Lynn Miller, P.E.

B. TESTS (submitted under previous approval)

1. None.

C. CALCULATIONS (submitted under previous approval)

1. None.

D. QUALITY ASSURANCE

1. Miami Dade Department of Regulatory and Economic Resources (RER).

E. MATERIAL CERTIFICATIONS

1. None.

F. STATEMENT

1. Statement letter of conformance, complying with and the FBC 8th Edition (2023), dated 02-17-25, issued by manufacturer, signed and sealed by Anthony Lynn Miller, P.E.
2. Statement letter dated 02/17/25 issued by manufacturer requesting renewal with company name change to PGT industries, LLC, signed and sealed by Anthony Lynn Miller, P.E.
3. e-mail dated 12/23/24 sent by Lynn Miller (PGT Code Compliance Manager), consists of PGT innovation form 8-k filed w/SEC, PGT innovation form 10-K filled w/SEC and Exhibit 21(Form 10-K); PGT innovation's list of subsidiaries.

G. OTHER

1. This NOA **revises & renews NOA # 23.0710.04 (PGT Industries, Inc.)**, expiring April 07, 2030.
2. Article of conversion of PGT Industries, Inc to PGT industries, LLC pdf provided on 12/24/24 by Ms. April Lee, Assistant General Counsel.
3. Florida Department of State, Division of Corporation listing # L2400142070 of PGT Industries LLC as active status since 12/17/24.
4. Florida Department of State, Division of Corporation listing # F03387 of PGT Industries, Inc as Inactive status.
5. PGT Name change organization chart layout prepared by RER (for file use only).

Ishaq I. Chanda

Ishaq I. Chanda, P. E.
Product Control Unit Supervisor
NOA No. 25-0220.02
Expiration Date: March 24, 2030
Approval Date: March 13, 2025

SERIES 670HP, NON-IMPACT RESISTANT SLIDING GLASS DOOR

1) THIS PRODUCT HAS BEEN DESIGNED & TESTED TO COMPLY WITH THE REQUIREMENTS OF THE FLORIDA BUILDING CODE, INCLUDING THE HIGH VELOCITY HURRICANE ZONE (HVHZ).

2) SHUTTERS ARE REQUIRED WHEN USED IN WIND-BORNE DEBRIS REGIONS.

3) FOR MASONRY APPLICATIONS IN MIAMI-DADE COUNTY, USE ONLY MIAMI-DADE COUNTY APPROVED MASONRY ANCHORS. MATERIALS USED FOR ANCHOR EVALUATIONS WERE SOUTHERN PINE, ASTM C90 CONCRETE MASONRY UNITS AND CONCRETE WITH MIN. KSI PER ANCHOR TYPE.

4) ALL WOOD BUCKS LESS THAN 1-1/2" THICK ARE TO BE CONSIDERED 1X INSTALLATIONS. 1X WOOD BUCKS ARE OPTIONAL IF UNIT IS INSTALLED DIRECTLY TO SUBSTRATE. WOOD BUCKS DEPICTED AS 2X ARE 1-1/2" THICK OR GREATER. 1X AND 2X BUCKS (WHEN USED) SHALL BE DESIGNED AND SECURED TO PROPERLY TRANSFER LOADS TO THE STRUCTURE. WOOD BUCK DESIGN AND INSTALLATION IS THE RESPONSIBILITY OF THE ENGINEER, (EOR) OR ARCHITECT OF RECORD, (AOR).

5) ANCHOR EMBEDMENT TO BASE MATERIAL SHALL BE BEYOND WALL DRESSING OR STUCCO. USE ANCHORS OF SUFFICIENT LENGTH TO ACHIEVE REQUIRED MIN. EMBEDMENT. SILL ANCHORS MUST BE SEALED. INSTALLATION SCREWS, FRAME AND PANEL CORNERS TO BE SEALED WITH NARROW JOINT SEALANT. OVERALL SEALING/FLASHING STRATEGY FOR WATER RESISTANCE OF INSTALLATION SHALL BE DONE BY OTHERS AND IS BEYOND THE SCOPE OF THESE INSTRUCTIONS.

6) 1/4" MAX. SHIMS ARE REQUIRED AT EACH ANCHOR LOCATION WHERE THE PRODUCT IS NOT FLUSH TO THE SUBSTRATE. USE SHIMS CAPABLE OF TRANSFERRING APPLIED LOADS.

7) DESIGN PRESSURES:
A. NEGATIVE DESIGN LOADS BASED ON STRUCTURAL TESTING AND GLASS PER ASTM E1300.
B. POSITIVE DESIGN LOADS BASED ON WATER TEST PRESSURE, STRUCTURAL TESTING AND GLASS PER ASTM E1300.
C. DESIGN LOADS ARE BASED ON ALLOWABLE STRESS DESIGN, ASD.

8) THE ANCHORAGE METHODS SHOWN HAVE BEEN DESIGNED TO RESIST THE WINDLOADS CORRESPONDING TO THE REQUIRED DESIGN PRESSURE. THE 33-1/3% STRESS INCREASE HAS NOT BEEN USED IN THE DESIGN OF THIS PRODUCT. THE 1.6 LOAD DURATION FACTOR WAS USED FOR THE EVALUATION OF ANCHORS INTO WOOD. ANCHORS THAT COME INTO CONTACT WITH OTHER DISSIMILAR MATERIALS SHALL MEET THE REQUIREMENTS OF THE FLORIDA BUILDING CODE FOR CORROSION RESISTANCE.

9) METAL SUBSTRATE TO MEET MIN. STRENGTH AND THICKNESS REQUIREMENTS PER CURRENT FLORIDA BUILDING CODE AND TO BE REVIEWED BY THE AUTHORITY HAVING JURISDICTION.

10) APPLICABLE EGRESS REQUIREMENTS TO BE REVIEWED BY BUILDING OFFICIAL.

11) IF SILL IS TIGHT TO SUBSTRATE, GROUT OR OTHER MATERIAL IS NOT REQUIRED. IF USED, NON-SHRINK, NON-METALLIC GROUT, MAX. 1/4" THICK & 3400 PSI MIN., (DONE BY OTHERS) MUST FULLY SUPPORT THE ENTIRE LENGTH OF THE SILL THAT IS NOT TIGHT TO THE SUBSTRATE, AND TRANSFER SHEAR LOAD TO SUBSTRATE. IF SUBSTRATE IS WOOD, 30# FELT PAPER OR MASTIC IS REQUIRED BETWEEN THE GROUT AND WOOD SUBSTRATE, OR AS APPROVED BY THE AUTHORITY HAVING JURISDICTION.

12) REFERENCES: TEST REPORTS FTL-5987, FTL-5995 AND FTL-7825; DEWALT ULTRACON+ NOA; ELCO ULTRACON NOA; DEWALT/ELCO CRETEFLEX NOA AND AGGREGATOR NOA

| DESIGN PRESSURE RATING | IMPACT RATING |
|------------------------|---|
| SEE TABLE 1 ON SHEET 4 | NOT RATED FOR MISSILE IMPACT RESISTANCE |

TABLE A:

| Anchor Group | Anchor Type | Frame Member | Substrate | Min. Edge Distance | Min. O.C. Distance | Min. Embedment or Metal Thickness |
|--------------|----------------------------|--------------|---------------------------|--------------------|--------------------|-----------------------------------|
| A | #12 18-8 or 410 SS SMS | All | Southern Pine (SG = 0.55) | 9/16" | 7/8" | 1-3/8" |
| | | | 6063-T5 Aluminum | 3/8" | 9/16" | 0.071" (20 Ga) |
| | | | A36 Steel | 3/8" | 9/16" | 0.050" |
| | | | Gr. 33 Steel Stud | 3/8" | 9/16" | 0.045" (18 Ga) |
| | 1/4" Elco Aggre-Gator | All | Concrete (min. 2.22 ksi) | 1-1/2" | 3" | 1-3/8" |
| | | Jamb | Filled Block (ASTM C90) | 2" | 3" | 2" |
| B | #12 Steel SMS (Gr. 5) | All | Southern Pine (SG = 0.55) | 9/16" | 7/8" | 1-3/8" |
| | | | 6063-T5 Aluminum | 3/8" | 9/16" | 0.071" (20 Ga) |
| | | | A36 Steel | 3/8" | 9/16" | 0.050" |
| | | | Gr. 33 Steel Stud | 3/8" | 9/16" | 0.045" (18 Ga) |
| | 1/4" DeWalt UltraCon+ | Head / Sill | Concrete (min. 3 ksi) | 1-5/16" | 4" | 1-3/8" |
| | | Jamb | Concrete (min. 3 ksi) | 1" | 4" | 1-3/8" |
| C | 1/4" DeWalt UltraCon+ | All | Hollow Block (ASTM C90) | 1" | 3" | 1-1/4" |
| | | | Southern Pine (SG = 0.55) | 1" | 1" | 1-3/8" |
| | 1/4" 410 SS Elco CreteFlex | Head / Sill | Concrete (min. 3.35 ksi) | 1" | 4" | 1-3/4" |
| | | Jamb | Concrete (min. 3.35 ksi) | 1" | 6" | 1-3/4" |
| | | Jamb | Hollow Block (ASTM C90) | 2-1/2" | 6" | 1-1/4" |
| | | All | Southern Pine (SG = 0.55) | 1" | 1" | 1-3/8" |

- 1) WHERE SUBSTRATE CONDITIONS REQUIRE ANCHORAGE FROM MORE THAN ONE OF THE ANCHOR GROUPS ABOVE, CHOOSE THE ANCHOR GROUP OF THE LOWEST LETTER FOR ALL TABLES IN THIS APPROVAL.
2) ALL ANCHOR HEAD TYPES ARE APPLICABLE.
3) FOR THE MINIMUM STRENGTHS OF ANCHORS AND SUBSTRATES, SEE TABLE 3, SHEET 9.
4) HOLLOW BLOCK VALUES MAY ALSO BE USED IN FILLED BLOCK APPLICATIONS.
5) ANCHORS MUST BE OF SUFFICIENT LENGTH SO THAT A MINIMUM OF 3 THREADS EXTEND BEYOND METAL SUBSTRATE.

DLO WIDTH = NOM. PANEL WIDTH - 7"
PANEL HEIGHT = DOOR UNIT HEIGHT - 1-7/8"
DLO HEIGHT = DOOR UNIT HEIGHT - 10-1/8"
DLO HEIGHT = PANEL HEIGHT - 8-1/4"

CODES / STANDARDS USED:

- 2023 FLORIDA BUILDING CODE (FBC), 8TH EDITION
- ASTM E1300-09
- ANSI/AF&PA NDS-2018 FOR WOOD CONSTRUCTION
- ALUMINUM DESIGN MANUAL, ADM-2020
- AISI S100-16
- AISC 360-16

- GENERAL NOTES.....1
ELEVATIONS.....2
GLAZING DETAILS.....3
DESIGN PRESSURES.....4
ELEVATION.....5
INSTAL. SECTIONS.....6
ANCHOR LAYOUT.....7
ASSEMBLY SECTIONS....8
PARTS LIST.....9
EXTRUSIONS.....10

PRODUCT RENEWED
as complying with the Florida
Building Code
Acceptance No. 25-0220-02
Expiration Date 3/24/2030
By Ishag I. (Signature)
Miami Dade Product Control

UPDATE COMPANY ADDRESS.
AM-02/17/25

| | | | | | |
|--|----------------------------------|---------------------------|---------------|---------|---------|
| PREPARED BY A. LYNN MILLER 1070 TECHNOLOGY DRIVE N. VENICE, FL 34275 (941) 480-1600 | REGISTRATION #29296 | 03/21/20 | JENS ROSOWSKI | PGT0003 | Rev. 1 |
| | | | | | |
| PGT Custom Windows and Doors 3400 PRECISION DRIVE N. VENICE, FL 34275 (941) 480-1600 | ALUMINUM SLIDING GLASS DOOR (NI) | ANCHOR TYPES & GEN. NOTES | SGD670 HP | 1 OF 10 | DWG No. |
| | | | | | |
| Series Desc Title | | | | | |

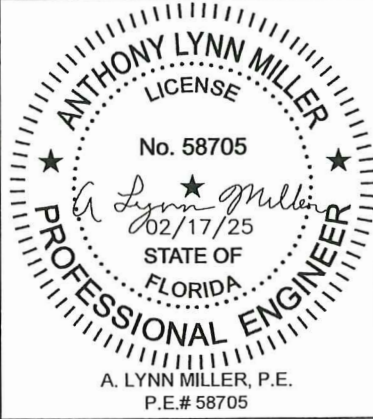

EXAMPLE CONFIGURATIONS

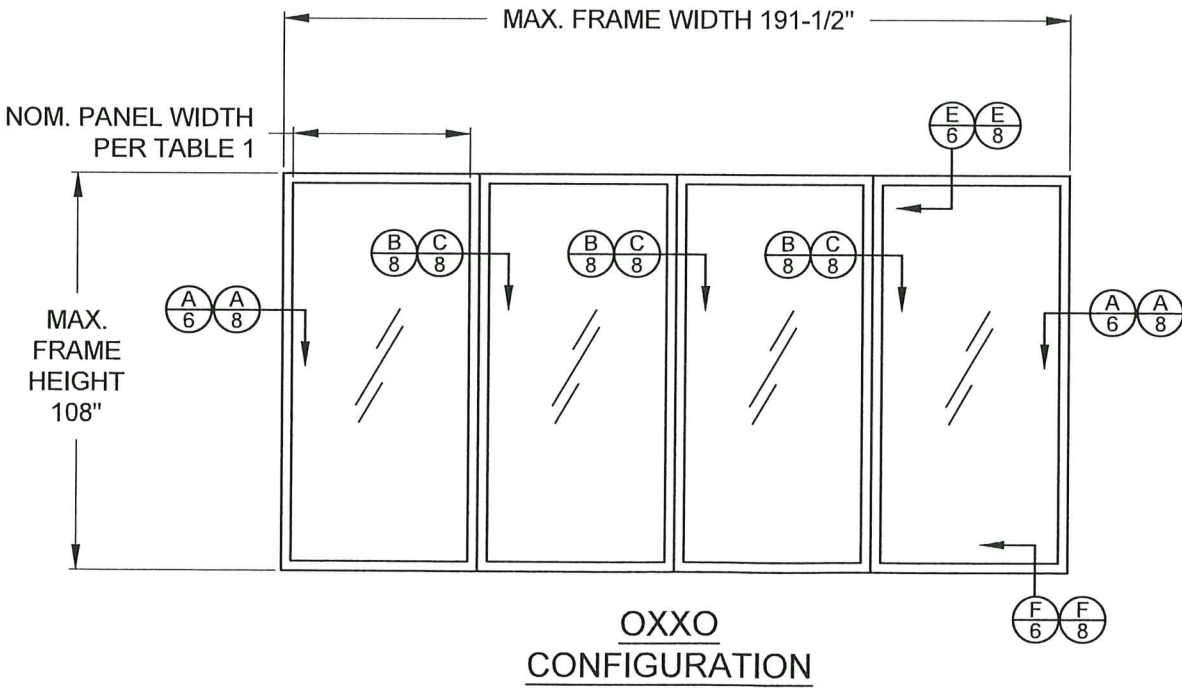
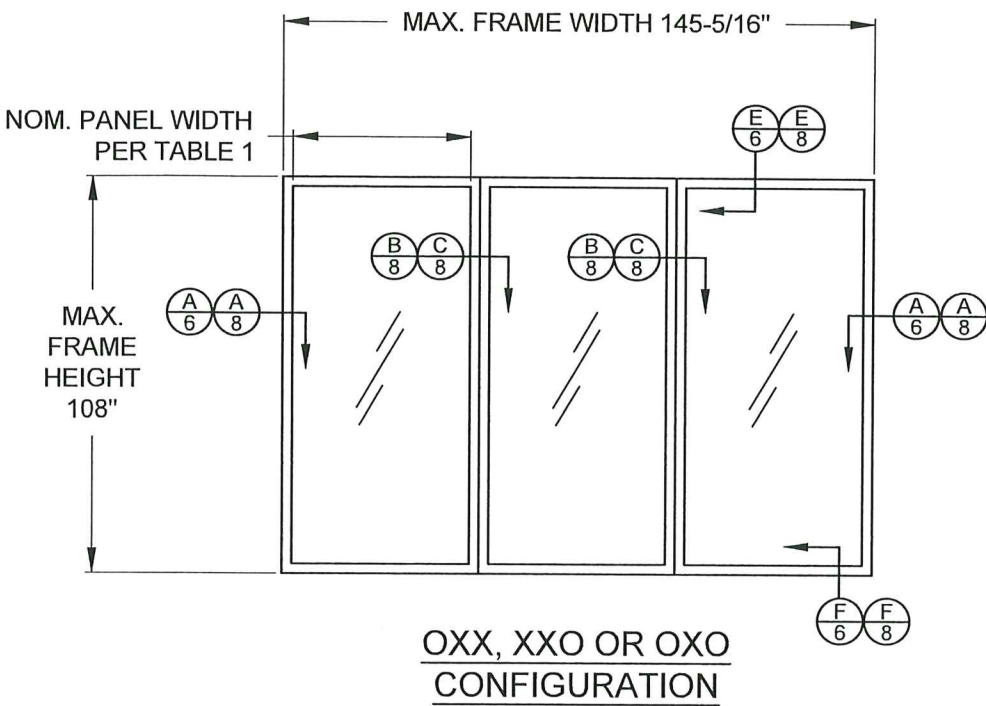
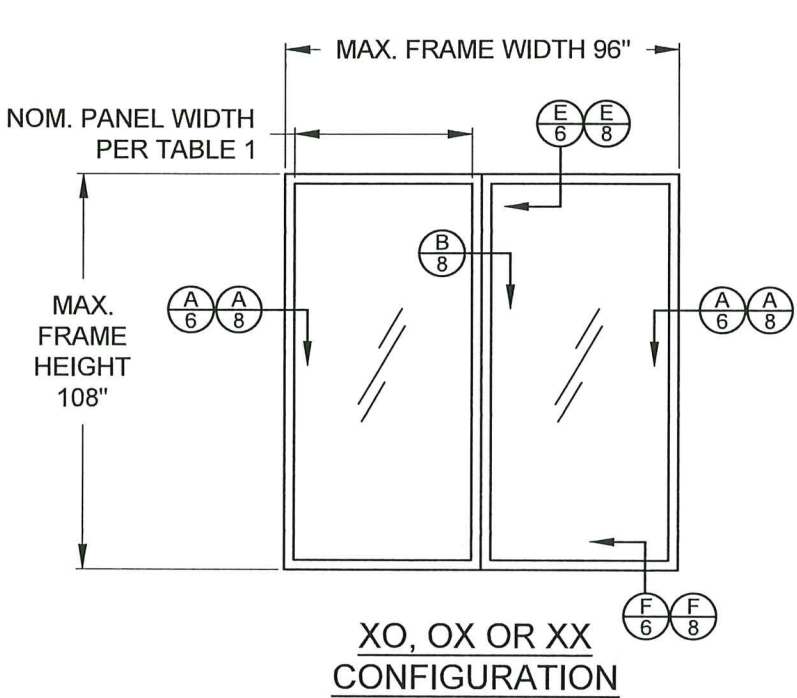

DLO WIDTH = NOM. PANEL WIDTH - 7"
PANEL HEIGHT = DOOR UNIT HEIGHT - 1-7/8"
DLO HEIGHT = DOOR UNIT HEIGHT - 10-1/8"
DLO HEIGHT = PANEL HEIGHT - 8-1/4"

PRODUCT RENEWED
as complying with the Florida
Building Code
Acceptance No. 25-022-02
Expiration Date 3/24/2030
By Sheng L. Chan
Miami Dade Product Control

Revision: UPDATE COMPANY ADDRESS.
AM-02/17/25

| | | | | | | |
|--|----------------------------------|------------------------|----------|---------------|---------|----------|
| PREPARED BY A. LYNN MILLER 1070 TECHNOLOGY DRIVE N. VENICE, FL 34275 (941) 480-1600 | REGISTRATION #29296 | Date | 03/21/20 | JENS ROSOWSKI | PGT0003 | Rev 1 |
| | | By | | | | |
| | | Drawn | | | | |
| PGT Custom Windows and Doors 3400 PRECISION DRIVE N. VENICE, FL 34275 (941) 480-1600 | ALUMINUM SLIDING GLASS DOOR (NI) | 2 OF 10 | | SGD670 HP | Sheet | No. |
| | | DWG | | | | |
| | | EXAMPLE CONFIGURATIONS | | | | |
| Series | | Desc. | Title | | | |

ANTHONY LYNN MILLER
LICENSE
No. 58705
02/17/25
STATE OF
FLORIDA
PROFESSIONAL ENGINEER
A. LYNN MILLER, P.E.
P.E.# 58705

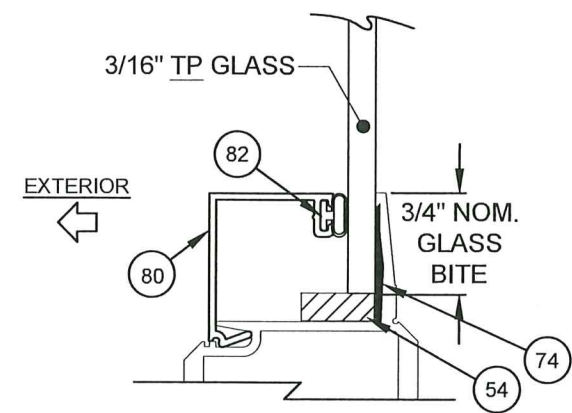

3/16" TEMPERED GLASS
TYPE G1
GLASS: 3/16" NOM.

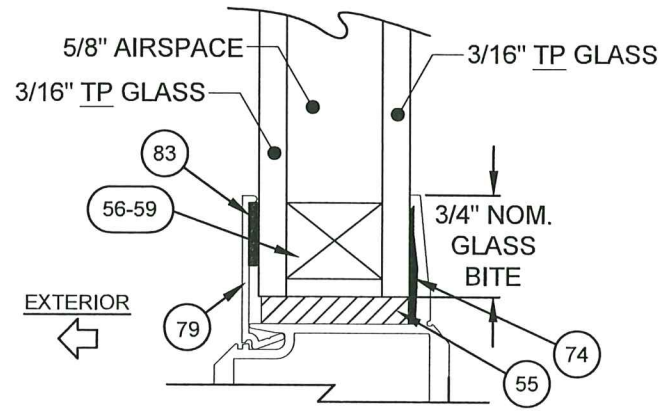

1" I.G. GLASS
TYPE G2
GLASS: 1" NOM.

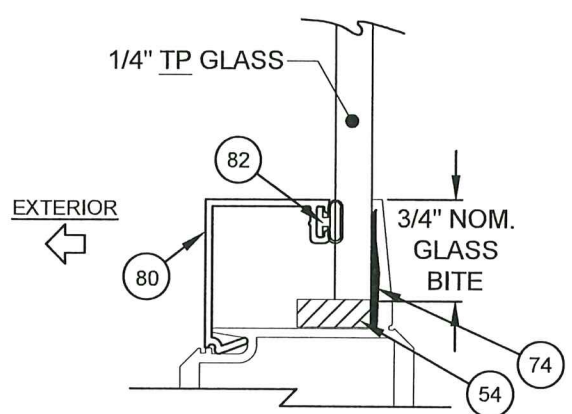

1/4" TEMPERED GLASS
TYPE G1A
GLASS: 1/4" NOM.

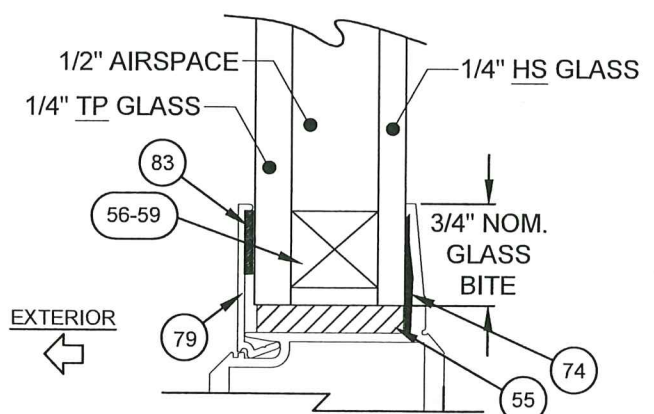

1" I.G. GLASS
TYPE G2A
GLASS: 1" NOM.

"AN" = ANNEALED
"HS" = HEAT STRENGTHENED
"TP" = TEMPERED

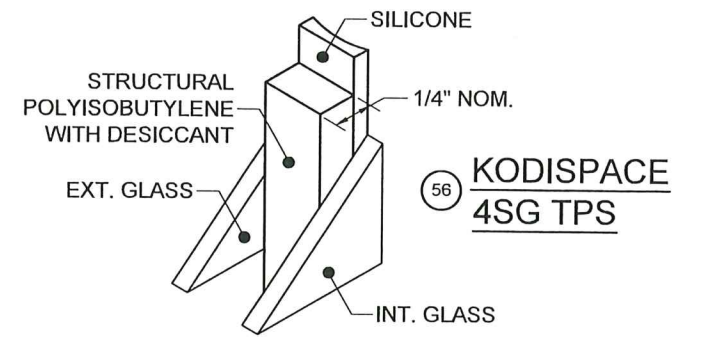

KODISPACE
4SG TPS

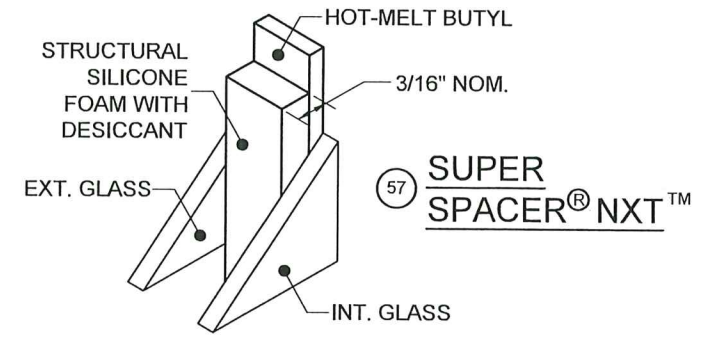

SUPER
SPACER® NXT™

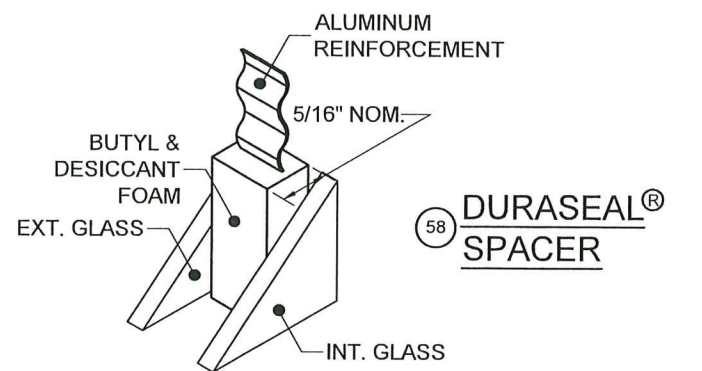

DURASEAL®
SPACER

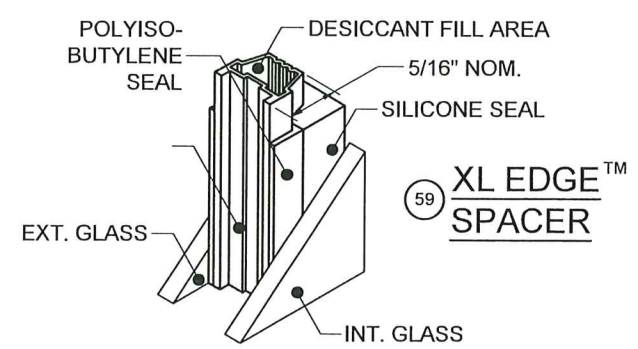

XL EDGE™
SPACER

| Part # | Description | Material |
|--------|---|------------------------------|
| 56 | Kommerling 4SG TPS Spacer System | See this Sheet for Materials |
| 57 | Quanex Super Spacer nXT with Hot Melt Butyl | |
| 58 | Quanex Duraseal Spacer | |
| 59 | Cardinal XL Edge Spacer | |

REFERENCE TEST REPORTS: FTL-8717, 8968 & 8970

PRODUCT REVIEWED
as complying with the Florida
Building Code
Acceptance No. 25-0220-02
Expiration Date 3/24/2030
By *Chang I. G...*
Miami Dade Product Control

Revision:
UPDATE COMPANY
ADDRESS.
AM-02/17/25

| | | | | | | | |
|---|-----------|--|---------------|---------|---------|-----|---|
| <div>PGT</div> <div>Custom Windows and Doors</div> <div>3400 PRECISION DRIVE N. VENICE, FL 34275 (941) 480-1600</div> | | PREPARED BY A. LYNN MILLER 1070 TECHNOLOGY DRIVE N. VENICE, FL 34275 (941) 480-1600 | | | | | |
| | | REGISTRATION #29296 | | | | | |
| | | Title | 03/21/20 | | | | |
| | | Desc. | Date | | | | |
| | | ALUMINUM SLIDING GLASS DOOR (NI) | | | | | |
| GLAZING DETAILS | | By | JENS ROSOWSKI | | | | |
| Series | SGD670 HP | Sheet | 3 OF 10 | DWG No. | PGT0003 | Rev | I |

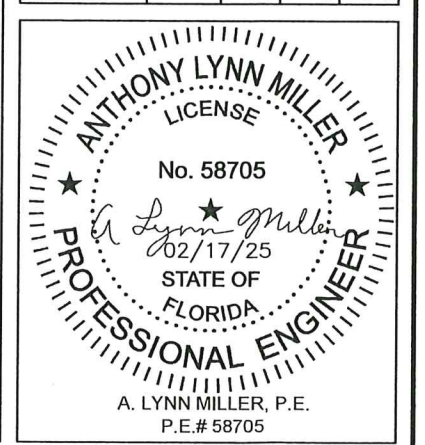
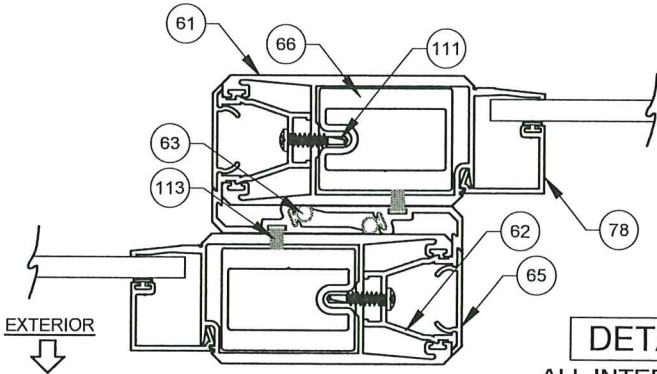

TABLE 1:

| Design Pressure (DP) and Anchor Quantities Required (For all approved Configurations, Sheet 2 and Glass Types, Sheet 3) | | | | | | | | | | | | | | | | | | | | | | | | | | | |
|---|-----|---------|-----------------|--------------|------|------|------|--------------|------|------|------|--------------|------|------|------|--------------|------|------|------|-------------------------|------|------|------|-------------------------------------|------|------|------|
| Table applies to all Glass Types, unless noted otherwise, and the Stile/Astragal types shown on this sheet. Positive (+) DP may be limited by Table 1A. | | | | Frame Height | | | | | | | | | | | | | | | | | | | | | | | |
| | | | | 80" | | | | 84" | | | | 90" | | | | 96" | | | | 102" | | | | 108" | | | |
| | | | | 69-7/8" DLO | | | | 73-7/8" DLO | | | | 79-7/8" DLO | | | | 87-7/8" DLO | | | | 91-7/8" DLO | | | | 97-7/8" DLO | | | |
| | | | | Anchor Group | | | | Anchor Group | | | | Anchor Group | | | | Anchor Group | | | | Anchor Group | | | | Anchor Group | | | |
| | | | | A | B | C | D | A | B | C | D | A | B | C | D | A | B | C | D | A | B | C | D | A | B | C | D |
| Nominal Panel Width (in) | 24" | 17" DLO | Design Pressure | +90/-209 | | | | +90/-209 | | | | +90/-209 | | | | +90/-209 | | | | +90/-205.3 | | | | +90/-192.5 | | | |
| | | | Head/Sill | C6+2 | C6+2 | C6+2 | C6+2 | C6+2 | C6+2 | C6+2 | C7+2 | C7+2 | C7+2 | C7+2 | C7+2 | C7+2 | C7+2 | C7+2 | C8+2 | C8+2 | C7+2 | C7+2 | C8+2 | C8+2 | C7+2 | C7+2 | |
| | | | Jamb | 14 | 12 | 10 | 8 | 16 | 12 | 10 | 8 | 18 | 14 | 10 | 10 | 18 | 14 | 12 | 10 | 20 | 16 | 12 | 10 | 20 | 16 | 12 | 10 |
| | 30" | 23" DLO | Design Pressure | +90/-209 | | | | +90/-209 | | | | +90/-197.1 | | | | +90/-182.5 | | | | +90/-169.9 | | | | +90/-159 | | | |
| | | | Head/Sill | C7+2 | C7+2 | C7+2 | C7+2 | C8+2 | C8+2 | C7+2 | C7+2 | C8+2 | C8+2 | C7+2 | C7+2 | C8+2 | C8+2 | C7+2 | C7+2 | C8+2 | C8+2 | C7+2 | C7+2 | C8+2 | C8+2 | C7+2 | C7+2 |
| | | | Jamb | 18 | 14 | 12 | 10 | 18 | 16 | 12 | 10 | 20 | 16 | 12 | 10 | 20 | 16 | 12 | 10 | 20 | 16 | 12 | 10 | 20 | 16 | 12 | 10 |
| | 36" | 29" DLO | Design Pressure | +90/-171 | | | | +90/-164 | | | | +90/-157 | | | | +90/-151 | | | | +90/-146 | | | | +90/-136.9 | | | |
| | | | Head/Sill | C7+2 | C7+2 | C6+2 | C6+2 | C7+2 | C7+2 | C7+2 | C7+2 | C7+2 | C7+2 | C7+2 | C7+2 | C8+2 | C8+2 | C7+2 | C7+2 | C8+2 | C8+2 | C7+2 | C7+2 | C8+2 | C8+2 | C7+2 | C7+2 |
| | | | Jamb | 16 | 14 | 10 | 8 | 16 | 14 | 10 | 8 | 18 | 14 | 12 | 10 | 18 | 14 | 12 | 10 | 20 | 16 | 12 | 10 | 20 | 16 | 12 | 10 |
| | 42" | 35" DLO | Design Pressure | +90/-153 | | | | +90/-142 | | | | +90/-128 | | | | +90/-118 | | | | +90/-110 | | | | +90/-104, Glass Type G1 | | | |
| | | | Head/Sill | C7+3 | C7+3 | C6+3 | C6+3 | C7+3 | C7+3 | C6+2 | C6+2 | C7+2 | C7+2 | C6+2 | C6+2 | C7+2 | C7+2 | C6+2 | C6+2 | C7+2 | C7+2 | C6+2 | C6+2 | +90/-121.4, Glass Type G1A, G2, G2A | | | |
| | | | Jamb | 16 | 14 | 10 | 8 | 16 | 14 | 10 | 8 | 16 | 14 | 10 | 10 | 16 | 14 | 10 | 10 | 16 | 14 | 10 | 10 | 20 | 16 | 12 | 10 |
| | 48" | 41" DLO | Design Pressure | +90/-151 | | | | +90/-140 | | | | +90/-124 | | | | +90/-113 | | | | +90/-103, Glass Type G1 | | | | +90/-104, Glass Type G1 | | | |
| | | | Head/Sill | C7+3 | C7+3 | C7+3 | C7+3 | C7+3 | C7+3 | C7+3 | C7+3 | C7+3 | C7+3 | C7+3 | C7+3 | C7+3 | C7+3 | C7+3 | C7+3 | C8+3 | C8+3 | C7+3 | C7+3 | +90/-118.5, Glass Type G1A, G2, G2A | | | |
| | | | Jamb | 18 | 14 | 12 | 10 | 18 | 14 | 10 | 10 | 18 | 14 | 10 | 10 | 16 | 14 | 10 | 10 | 20 | 16 | 12 | 10 | 20 | 16 | C7+2 | C7+2 |
| NOTE: JAMB ANCHORS ARE SPECIFIED AS THE TOTAL QUANTITY DIVIDE BY 2 FOR EACH SIDE OF THE JAMB. | | | | | | | | | | | | | | | | | | | | | | | | | | | |

NOTE: JAMB ANCHORS ARE SPECIFIED AS THE TOTAL QUANTITY, DIVIDE BY 2 FOR PAIRS TO BE INSTALLED.

EXAMPLE ON SHEET 5



DETAIL B
ALL INTERLOCKS TO BE REINFORCED

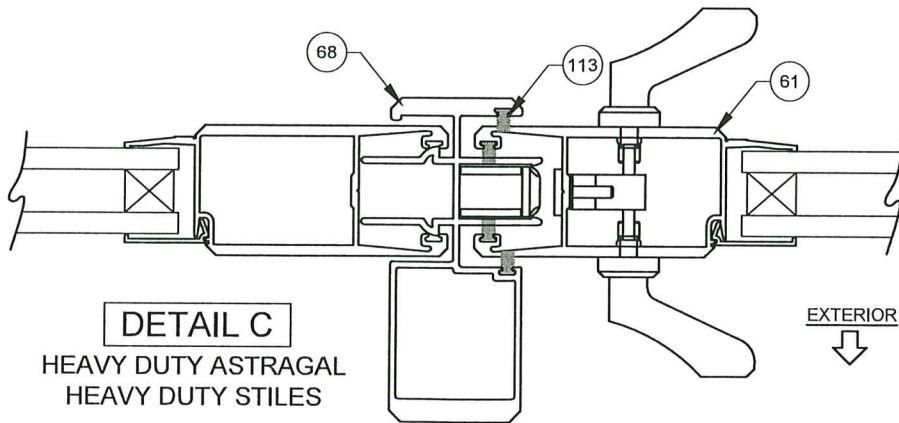

DETAIL C
HEAVY DUTY ASTRAGAL
HEAVY DUTY STILES

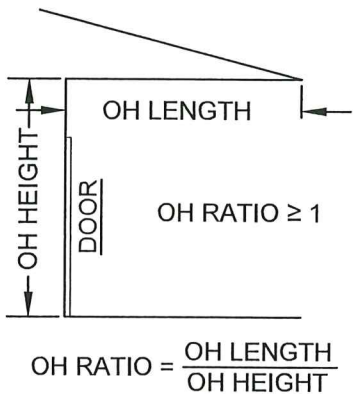

- 1) POSITIVE PRESSURES IN TABLE ARE BASED ON THE USE OF THE 4" SILL.
- 2) WHEN USING THE 2 1/2" SILL, POSITIVE DP IS 46.67 PSF MAX. AND WITH THE 3 1/4" SILL, POSITIVE PRESSURES IS 60.0 PSF MAX. (NEGATIVE PRESSURES UNCHANGED). SEE TABLE 1A ON THIS SHEET.
- 3) 2-1/2", 3-1/4" AND 4" SILL HEIGHTS ARE TESTED FOR WATER INFILTRATION WHEREAS THE 1-1/2" SILL IS NOT AND MUST ONLY BE USED WHERE WATER RESISTANCE IS NOT REQUIRED. POSITIVE DESIGN PRESSURES SHOWN IN TABLE 1 MAY BE USED WHEN THE DOOR IS PROTECTED BY AN OVERHANG COMPLYING WITH THE FLORIDA BUILDING CODE (SEE ADJACENT DIAGRAM); THIS CONDITION IS NOT RATED FOR WATER INFILTRATION.
- 4) SEE SHEETS 6 & 7 FOR ANCHORAGE SPACING AND EMBEDMENT INFORMATION. DOOR SIZE TO COMPLY WITH FBC EGRESS REQUIREMENTS.

DLO WIDTH = NOM. PANEL WIDTH - 7"
PANEL HEIGHT = DOOR UNIT HEIGHT - 1-7/8"
DLO HEIGHT = DOOR UNIT HEIGHT - 10-1/8"
DLO HEIGHT = PANEL HEIGHT - 8-1/4"

| Sill Height to Max. (+) DP (Water Infiltration Rating) | |
|---|--------------------------|
| Sill Riser Height (Flat or Box, see Sheet 9) | (+) Design Pressure, psf |
| Flush - 1-1/2" | see note 3 |
| Low - 2-1/2" | + 46.67 |
| Medium - 3-1/4" | + 60.0 |
| High - 4" | + 90.0 |

SEE NOTES 1-3

PRODUCT RENEWED
as complying with the Florida
Building Code
Acceptance No. 25-0220.02
Expiration Date 3/28/2030
By: [Signature]
Miami Dade Product Control

Revision:
UPDATE COMPANY
ADDRESS.
AM-02/17/25

| | | | | | |
|---|----------------------------------|----------------------------|---------------|---------|--------|
| PREPARED BY A. LYNN MILLER 1070 TECHNOLOGY DRIVE N. VENICE, FL 34275 (941) 480-1600 | REGISTRATION #29296 | 03/21/20 | JENS ROSOWSKI | PGT0003 | Rev. 1 |
| | | | | | |
| | | | | | |
| | | | | | |
| PGT Custom Windows and Doors 3400 PRECISION DRIVE N. VENICE, FL 34275 (941) 480-1600 | ALUMINUM SLIDING GLASS DOOR (NI) | DP & ANCHOR QUANTITY TABLE | SGD670 HP | 4 OF 10 | Sheet |
| | | | | | |
| | | | | | |
| | | | | | |
| ANTHONY LYNN MILLER LICENSE No. 58705 02/17/25 STATE OF FLORIDA PROFESSIONAL ENGINEER A. LYNN MILLER, P.E. P.E.# 58705 | Title | Desc. | Series | No. | Rev. |
| | | | | | |
| | | | | | |
| | | | | | |

EXAMPLE OXX ANCHORAGE PLAN:

(3) PANEL, 48" x 108" DOOR FROM TABLE ON SHEET 4, ANCHOR TYPES C IN CONCRETE SUBSTRATE

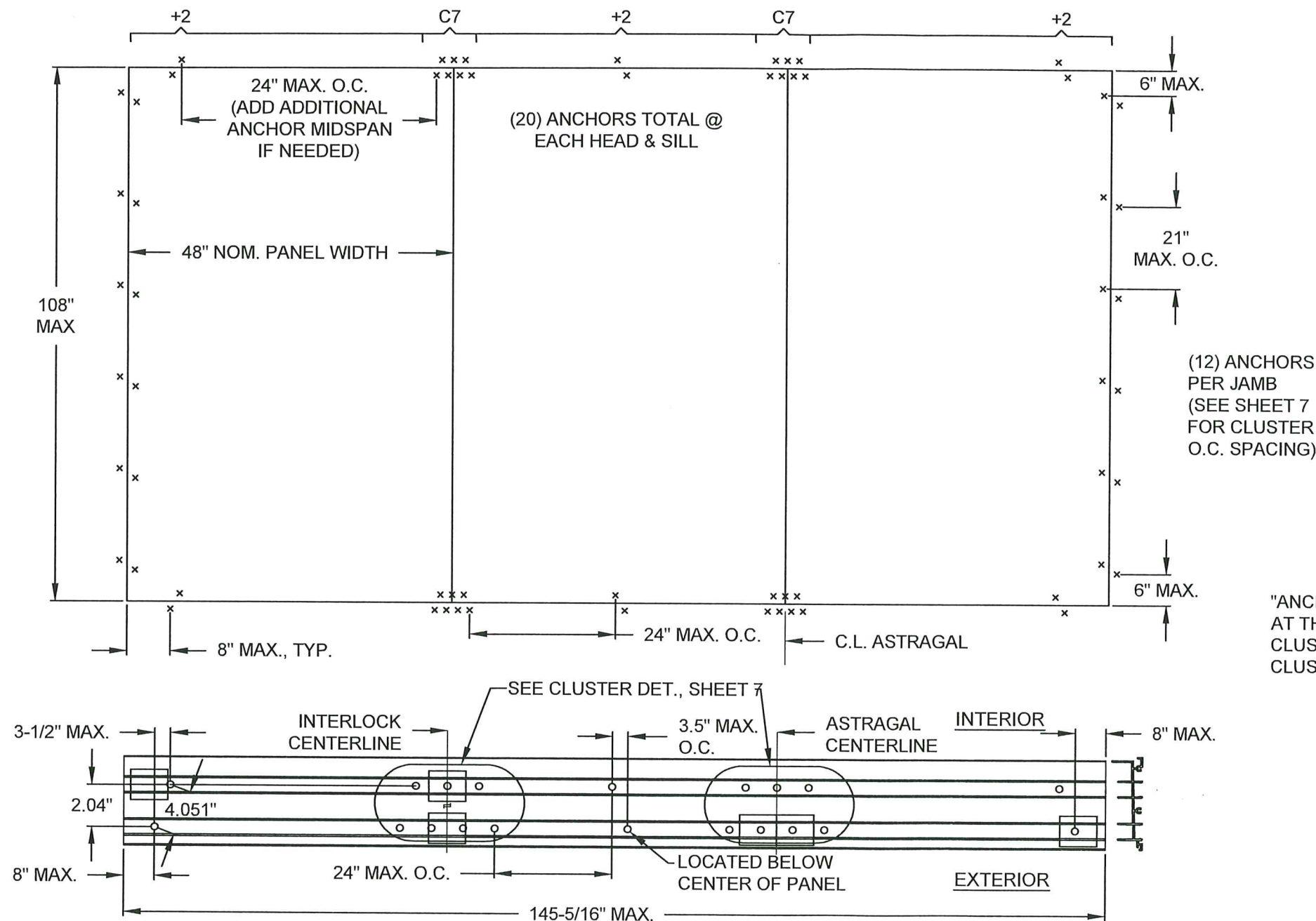

"ANCHORS PER PANEL" ARE THOSE AT THE HEAD AND SILL BETWEEN CLUSTERS OR THOSE BETWEEN A CLUSTER AND A FRAME JAMB.

ANCHORAGE REQUIREMENTS NOTES:

1. APPROVED ANCHOR TYPES: SEE TABLE A, SHEET 1.
2. ANCHOR LOCATION SPACING FOR ANCHOR QUANTITIES SPECIFIED IN TABLE 1 ON SHEET 4:

HEAD & SILL..... 8" MAX. FROM FRAME CORNERS. USE SPECIFIED CLUSTER FROM TABLE ON SHEET 4 AT EACH INTERLOCK AND ASTRAGAL LOCATION, PLUS SPECIFIED QUANTITY OF ADDITIONAL INTERMEDIATE ANCHORS PER PANEL (THE 8" FROM CORNER ANCHORS CAN BE INCLUDED). ADDITIONAL ANCHORS 24" MAX. ON CENTER. SEE EXAMPLE ANCHORAGE PLANS ABOVE AND EXAMPLE CLUSTERS AT ASTRAGAL / INTERLOCKS ON SHEET 7.

JAMBS..... 6" MAX. FROM BOTTOM AND 21" MAX. O.C. UTILIZING JAMB ANCHOR QUANTITIES FROM TABLE ON SHEET 4.

DLO WIDTH = NOM. PANEL WIDTH - 7"
PANEL HEIGHT = DOOR UNIT HEIGHT - 1-7/8"
DLO HEIGHT = DOOR UNIT HEIGHT - 10-1/8"
DLO HEIGHT = PANEL HEIGHT - 8-1/4"

PRODUCT RENEWED
as complying with the Florida
Building Code
Acceptance No. 25-0220.02
Expiration Date 3/24/2030
By Ishag I. Chahine
Miami Dade Product Control

REFORMATION PANEL
DOOR LAYOUT.
JAN-08/06/25

| | | | | | |
|--|----------------------------------|--------------------------|---------------|---------|-------|
| PREPARED BY A. LYNN MILLER 1070 TECHNOLOGY DRIVE N. VENICE, FL 34275 (941) 480-1600 | REGISTRATION #29296 | 03/21/20 | JENS ROSOWSKI | PGT0003 | 1 |
| | | | | | |
| | | | | | |
| PGT Custom Windows and Doors 3400 PRECISION DRIVE N. VENICE, FL 34275 (941) 480-1600 | ALUMINUM SLIDING GLASS DOOR (NI) | ELEVATION ANCHOR SPACING | SGD670 HP | 5 OF 10 | Sheet |
| | | | | | |
| | | | | | |

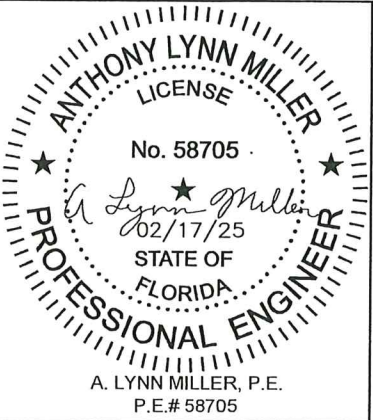

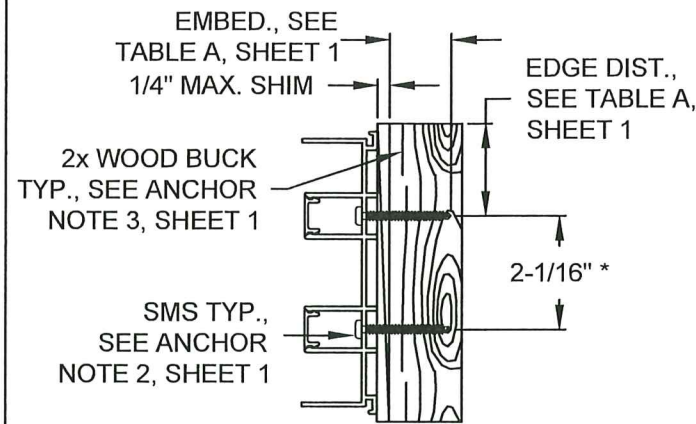

DETAIL A 2-TRACK FRAME JAMB
WOOD INSTALLATION

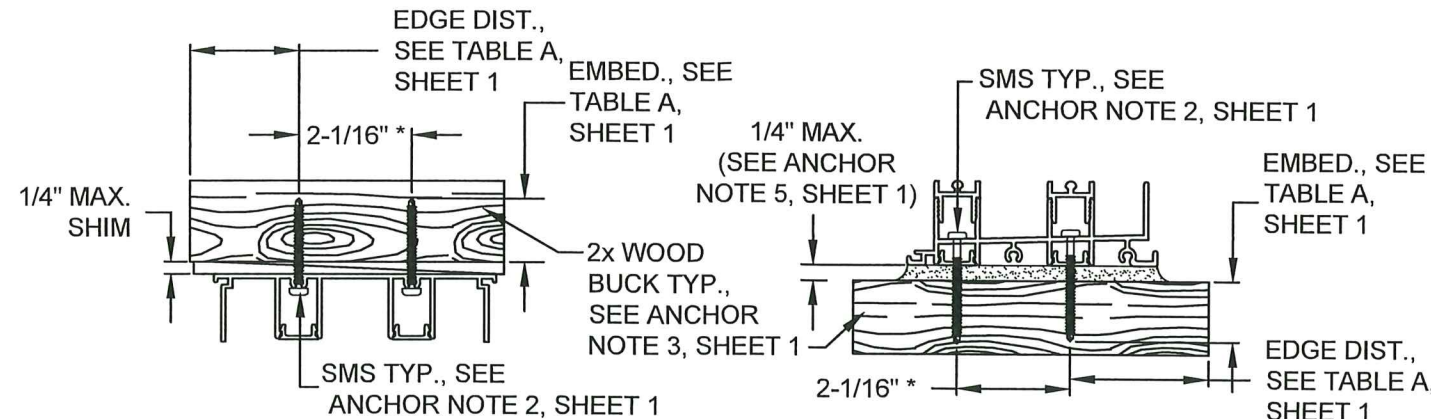

DETAIL E 2-TRACK FRAME HEAD
WOOD INSTALLATION

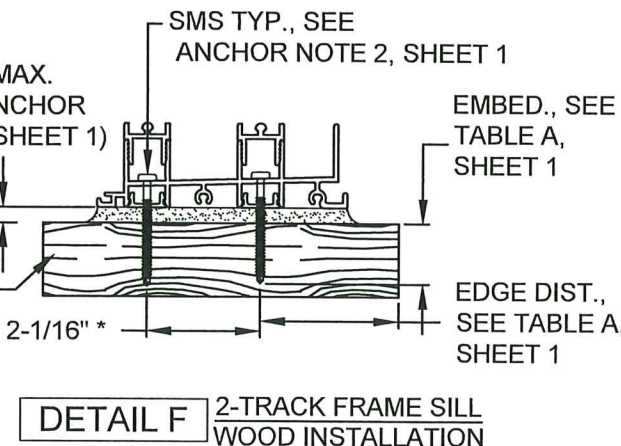

DETAIL F 2-TRACK FRAME SILL
WOOD INSTALLATION

NOTES:

- 1) ALL DIMENSIONS SHOWN ARE BASED ON MINIMUM ALLOWED.
- 2) METAL SUBSTRATES SIMILAR TO WOOD SUBSTRATES AS SHOWN.
- 3) ANCHORS MUST BE OF SUFFICIENT LENGTH SO THAT A MINIMUM OF 3 THREADS EXTEND BEYOND METAL SUBSTRATE.
- 4) 1/4" SHIM MAY BE SHORTER THAN THE FRAME BUT MUST FULLY SUPPORT THE LOADS IMPOSED ON IT.

* DIAGONAL, O.C. DIMENSION IS 4.051" IN THE HEAD & SILL, 6" IN THE JAMB.

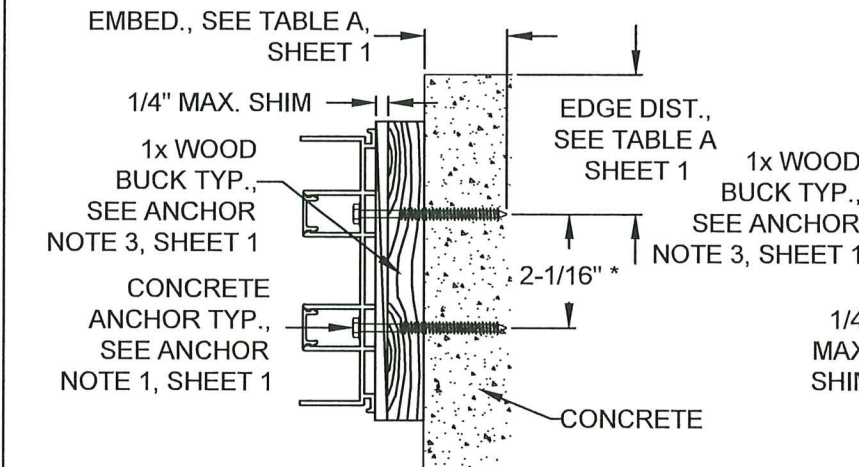

DETAIL A 2-TRACK FRAME JAMB
CONCRETE INSTALLATION

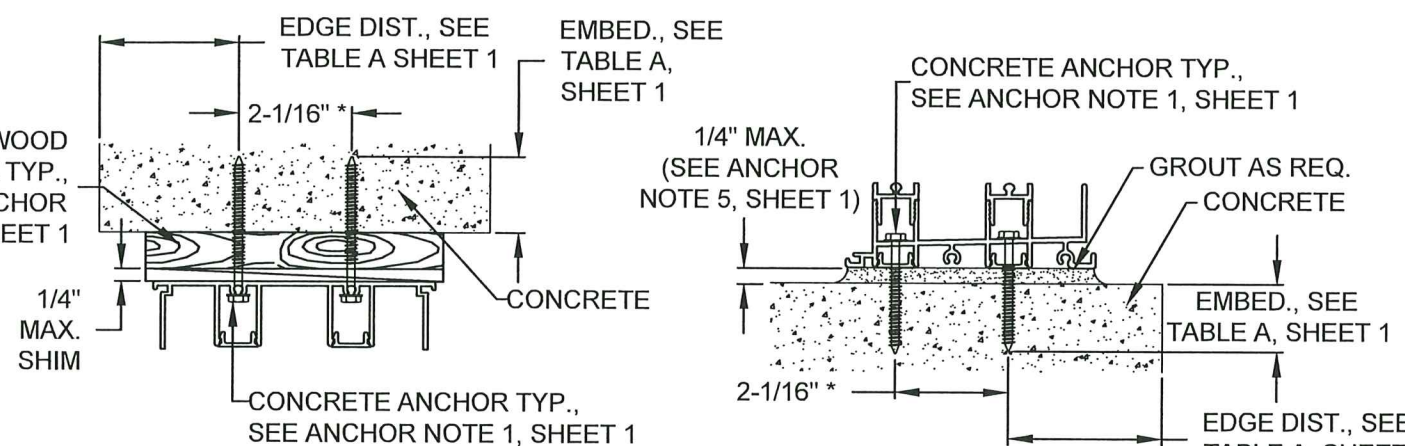

DETAIL E 2-TRACK FRAME HEAD
CONCRETE INSTALLATION

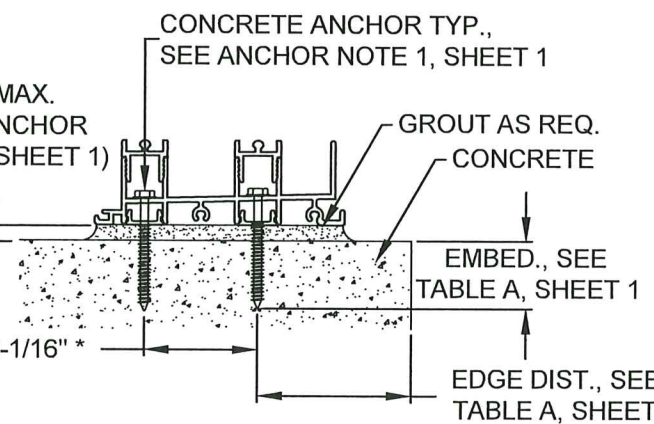

DETAIL F 2-TRACK FRAME SILL
CONCRETE INSTALLATION

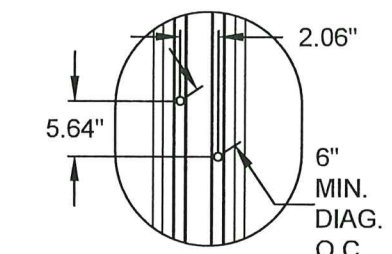

**TYPICAL JAMB ANCHOR PAIR
FOR DETAIL "A", SEE
ELEVATION FOR O.C.
SPACING, SHEET 5.**

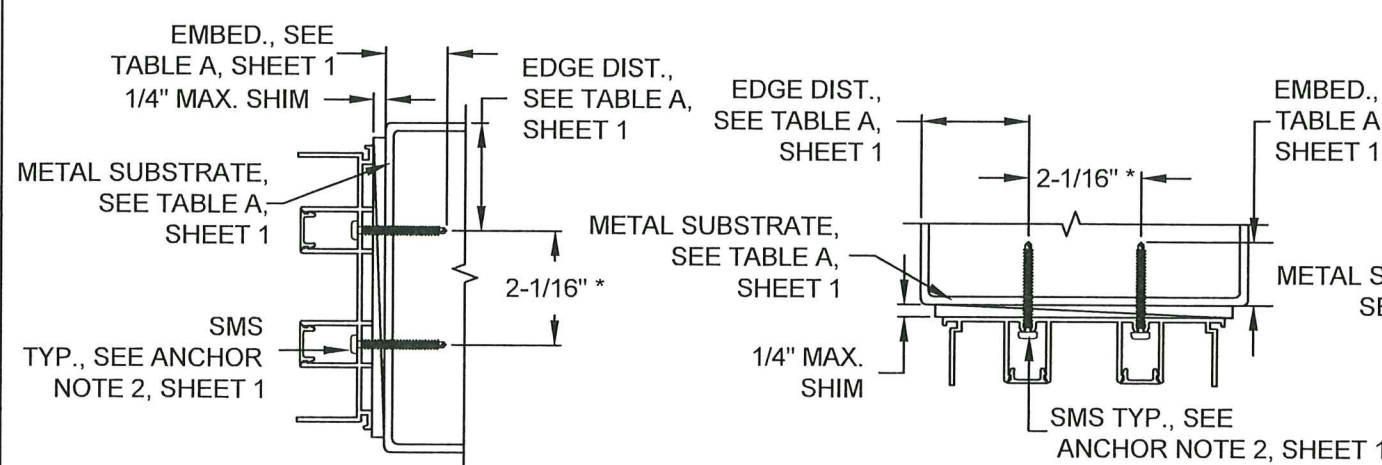

DETAIL A 2-TRACK FRAME JAMB
WOOD INSTALLATION

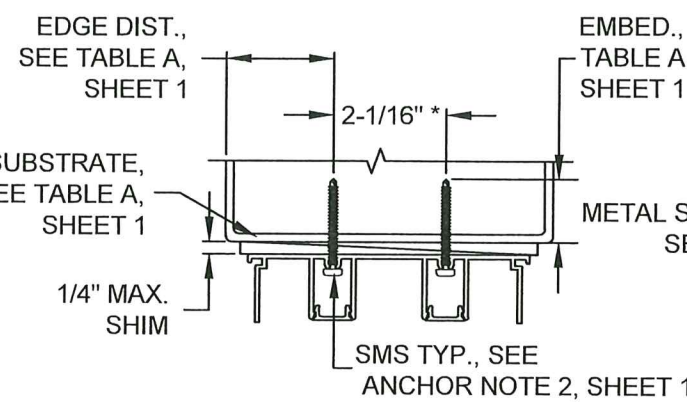

DETAIL E 2-TRACK FRAME HEAD
WOOD INSTALLATION

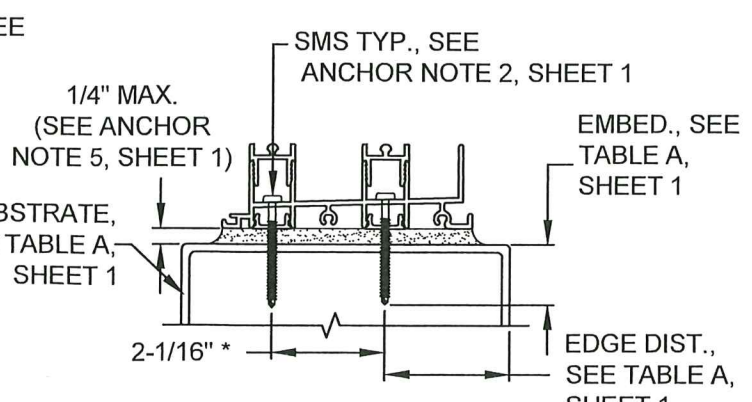

DETAIL F 2-TRACK FRAME SILL
WOOD INSTALLATION

← **EXTERIOR** **INTERIOR** →
(ALL VERT. SECTIONS)

PRODUCT REVIEW
complying with the Florida
Building Code
Acceptance No. **25-0220.02**
Expiration Date **3/27/2030**
By **Ishag I. Khan**
Miami Dade Product Control

**UPDATE COMPANY
ADDRESS.**
AM-02/17/25

| | | | | |
|---|---|--------------------|---------------------|-----------------|
| PREPARED BY A. LYNN MILLER 1070 TECHNOLOGY DRIVE N. VENICE, FL 34275 (941) 480-1600 | REGISTRATION #29296 ALUMINUM SLIDING GLASS DOOR (NI) | 03/21/20 Date | JENS ROSOWSKI By | PGT0003 Rev. |
| | | | | |
| | | | | |
| | | | | |
| PGT Custom Windows and Doors 3400 PRECISION DRIVE N. VENICE, FL 34275 (941) 480-1600 | INSTAL. CROSS SECTIONS SGD670 HP | 6 OF 10 Dwg No. | 6 OF 10 Sheet | 6 OF 10 Rev. |
| | | | | |
| | | | | |
| | | | | |

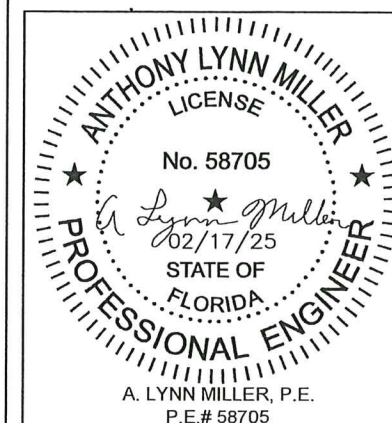

| | | | |
|------------------------|------------------|--|------------------|
| K | SINGLE INTERLOCK | | LOCKSTILE |
| A | SINGLE INTERLOCK | | LOCKSTILE |
| D | LOCKSTILE | | SINGLE INTERLOCK |
| M | LOCKSTILE | | SINGLE INTERLOCK |
| L (BOX OUT) | SINGLE INTERLOCK | | ASTRAGAL OUT |
| LR (BOX OUT) | ASTRAGAL OUT | | SINGLE INTERLOCK |
| N (BOX OUT) | ASTRAGAL IN | | SINGLE INTERLOCK |
| C (BOX IN) | SINGLE INTERLOCK | | ASTRAGAL IN |
| P | SINGLE INTERLOCK | | FIXED LOCKSTILE |
| R | FIXED LOCKSTILE | | SINGLE INTERLOCK |
| T (BOX OUT) | ASTRAGAL OUT | | FIXED LOCKSTILE |
| T (BOX IN) | ASTRAGAL IN | | FIXED LOCKSTILE |
| S (BOX OUT) | FIXED LOCKSTILE | | ASTRAGAL OUT |
| S (BOX IN) | FIXED LOCKSTILE | | ASTRAGAL IN |

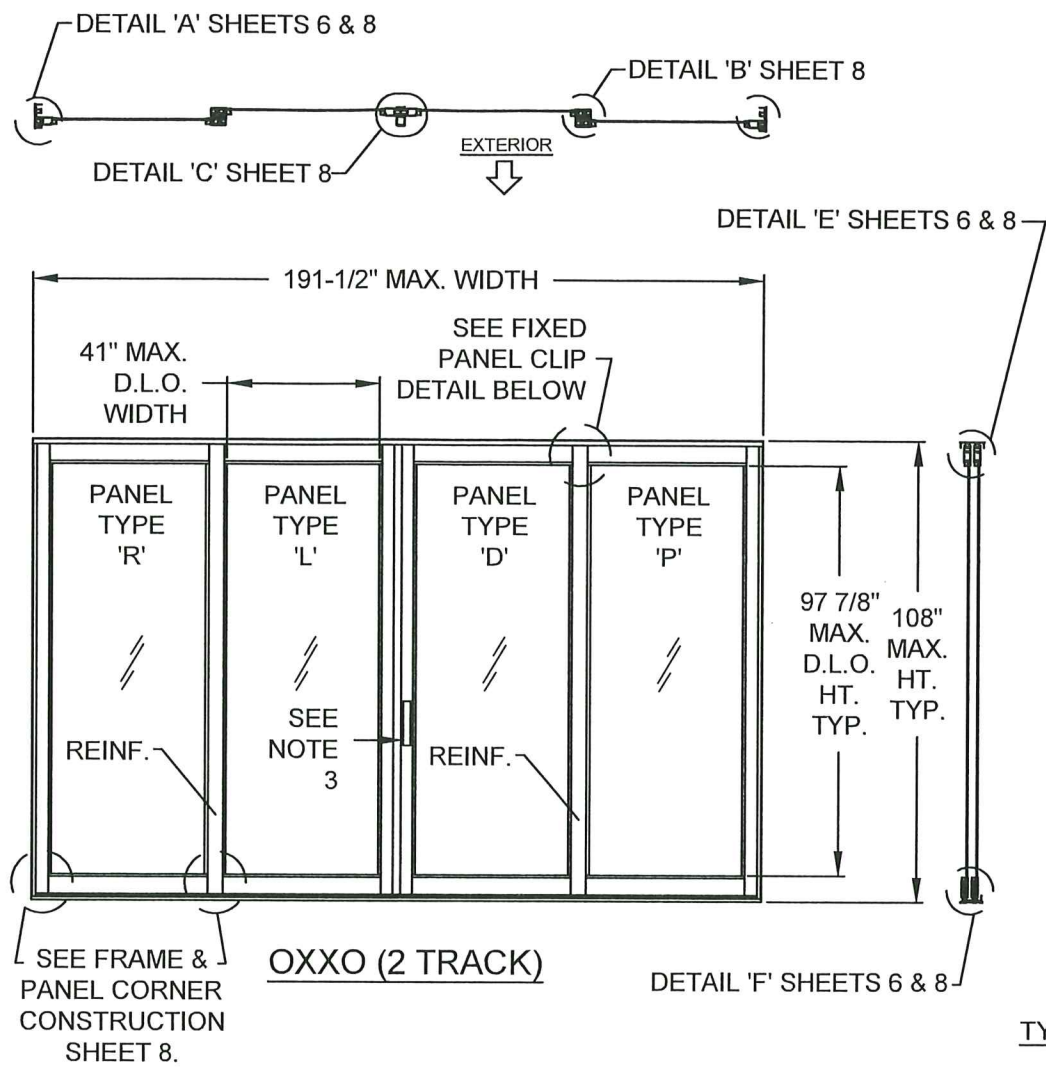

- NOTES:**
- 1) SEE THIS SHEET FOR INDIVIDUAL PANEL CONFIGURATIONS. SEE SHEET 8 FOR SECTION DETAILS AND SHEETS 4-6 FOR ANCHORAGE DETAILS.
 - 2) DLO WIDTH = 41" MAX.
DLO HEIGHT = 97-7/8" MAX.
 - 3) (1) LOCK (ITEMS 75 & 107) AT EACH LOCKSTILE, LOCKING INTO KEEPER (ITEM 103) AT FRAME JAMB OR ASTRAGAL.
 - 4) MAXIMUM NOMINAL PANEL WIDTH FOR ALL PANEL CONFIGURATIONS EQUALS 48".

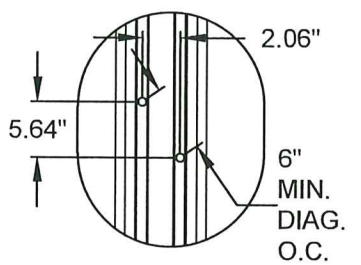

TYPICAL JAMB ANCHOR PAIR FOR
DETAIL 'A', SEE ELEVATION
FOR O.C. SPACING, SHEET 5

NOTE:
REINFORCEMENT
REQUIRED AT
ALL
INTERLOCKS.

↑ INTERIOR
(ALL PANEL TYPES)
↓ EXTERIOR

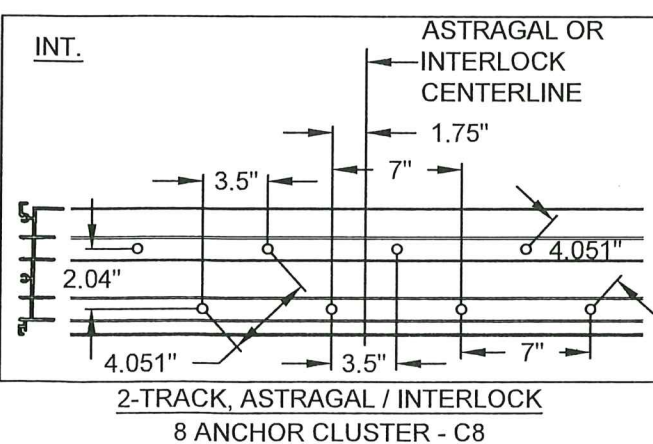
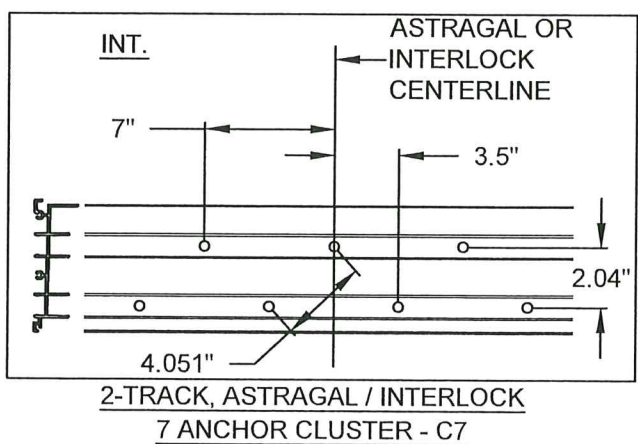
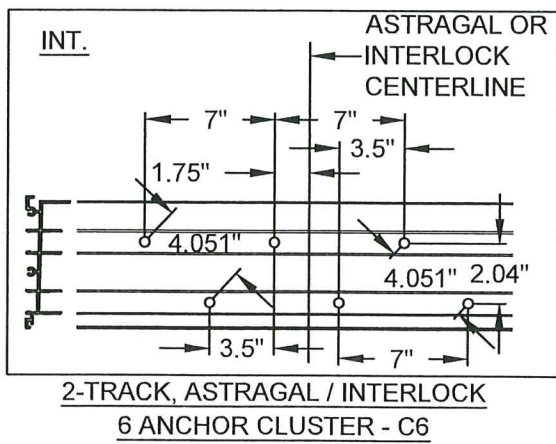

- NOTES:**
- 1) ALL DIMENSIONS SHOWN ARE BASED ON MINIMUM ALLOWED.
 - 2) METAL SUBSTRATES SIMILAR TO WOOD SUBSTRATES AS SHOWN.
 - 3) DIAGONAL, O.C. DIMENSION IS 4.051" IN THE HEAD & SILL, 6" IN THE JAMB.

PRODUCT RENEWED
as complying with the Florida
Building Code
Acceptance No **25-0220.02**
Expiration Date **3/24/2030**
By **Ishag I. Uman**
Miami Dade Product Control

Revision: UPDATE COMPANY ADDRESS.
AM-02/17/25

| | | | | | | | |
|---|----------------------------------|-------|----------|---------------|---------|----------------------------|---------|
| PREPARED BY A. LYNN MILLER 1070 TECHNOLOGY DRIVE N. VENICE, FL 34275 (941) 480-1600 | REGISTRATION #29296 | Date | 03/21/20 | JENS ROSOWSKI | PGT0003 | | |
| | | By | | | | | |
| | | Drawn | | | | | |
| PGT Custom Windows and Doors 3400 PRECISION DRIVE N. VENICE, FL 34275 (941) 480-1600 | ALUMINUM SLIDING GLASS DOOR (NI) | Title | Desc. | Series | Sheet | | |
| | | | | | | Panel Types & Anch. Layout | 7 OF 10 |
| | | | | | | | |

ANTHONY LYNN MILLER
LICENSE
No. 58705
02/17/25
STATE OF
FLORIDA
PROFESSIONAL ENGINEER
A. LYNN MILLER, P.E.
P.E.# 58705

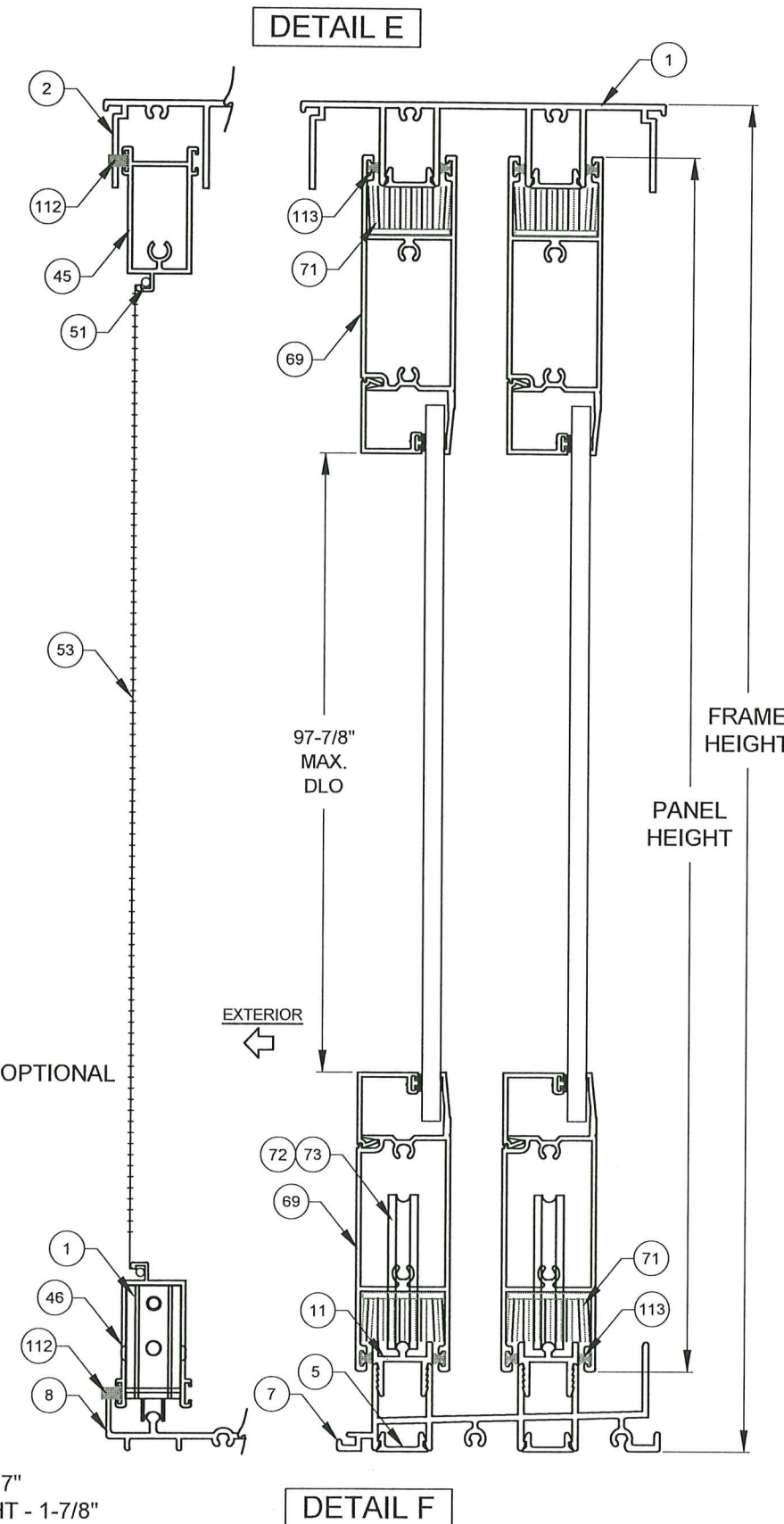
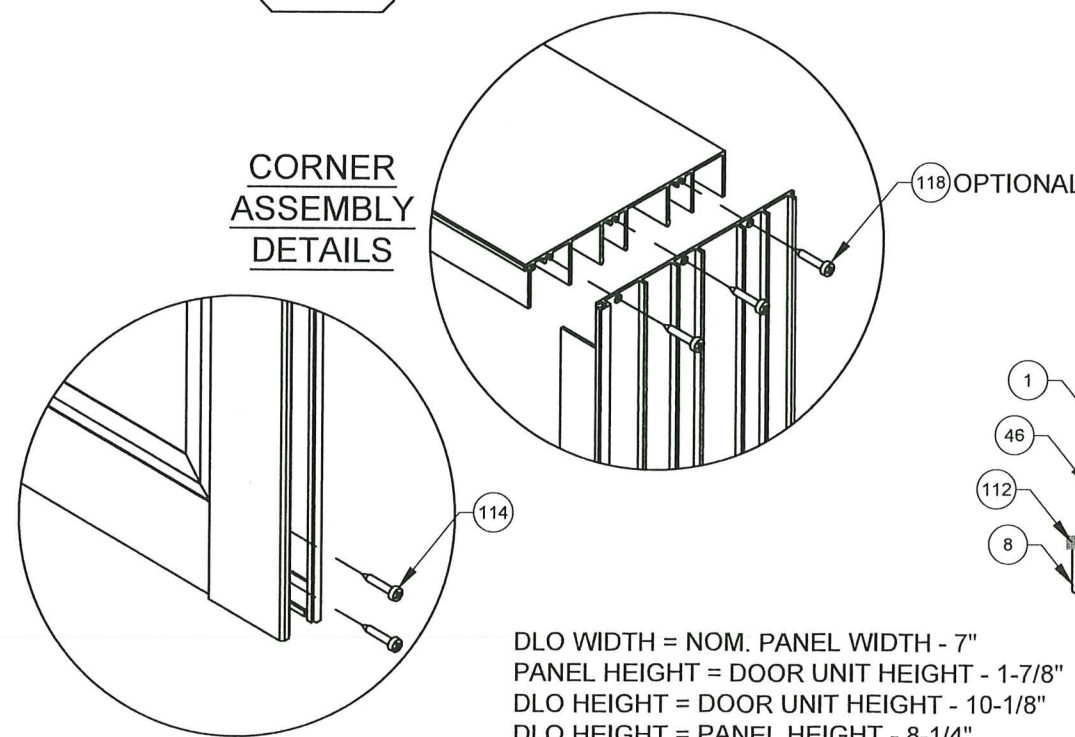
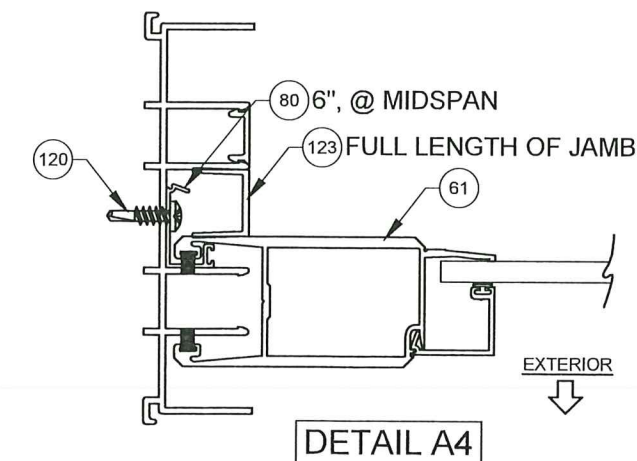
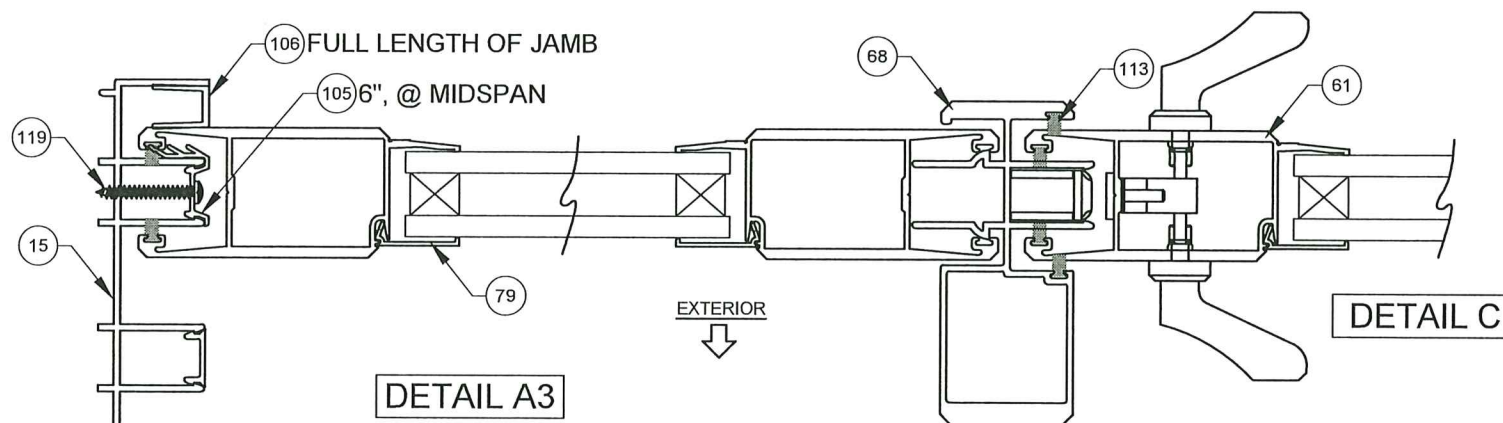
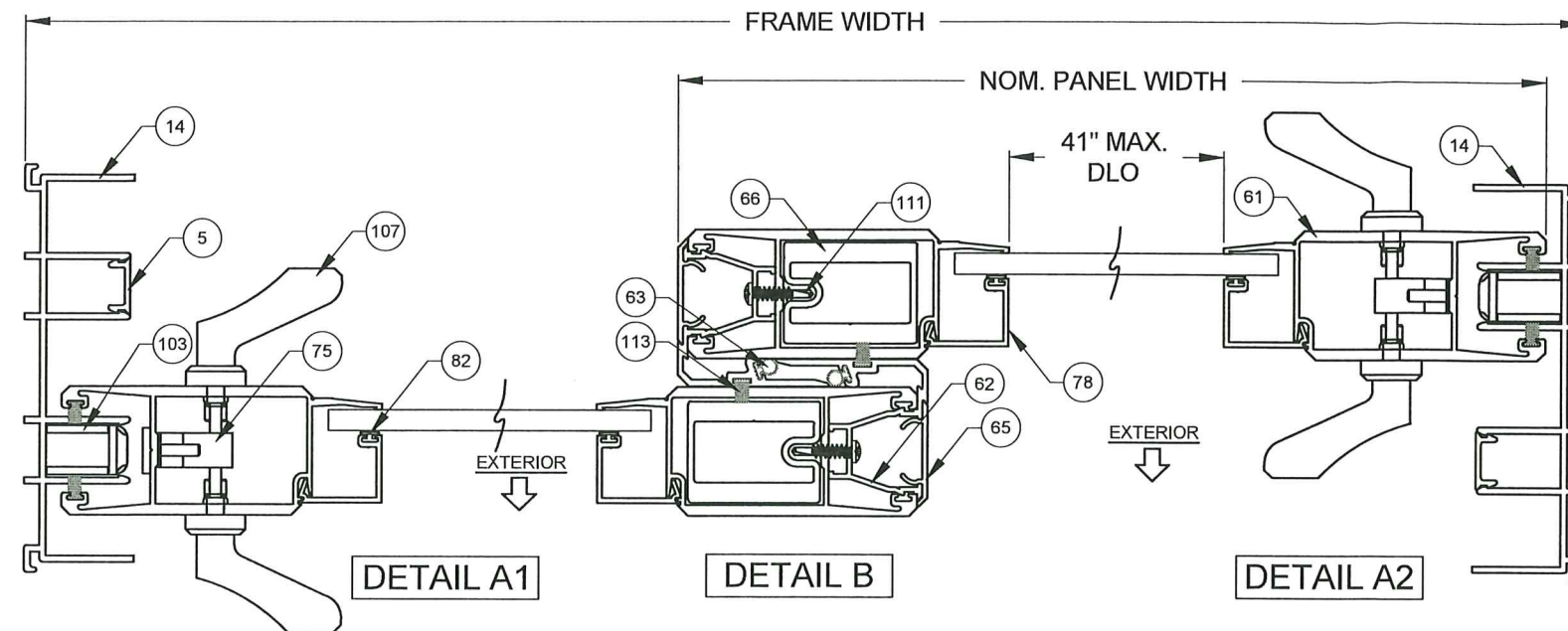

PRODUCT RENEWED
 as complying with the Florida
 Building Code
 Acceptance No. 25-0220.02
 Expiration Date 3/24/2030
 By *Ishaghi, L.*
 Miami Dade Product Control

Revision:
 UPDATE COMPANY
 ADDRESS.
 AM-02/17/25

| | | | | | |
|--|--|---|---------------------------|------------------|-----------------|
| PREPARED BY A. LYNN MILLER 1070 TECHNOLOGY DRIVE N. VENICE, FL 34275 (941) 480-1600 | REGISTRATION #29296 N. VENICE, FL 34275 (941) 480-1600 | ALUMINUM SLIDING GLASS DOOR (NI) ASSEMBLY CROSS SECTIONS | JENS ROSOWSKI Drawn By | 03/21/20 Date | PGT0003 Rev. |
| | | | | | |
| | | | | | |
| | | | | | |

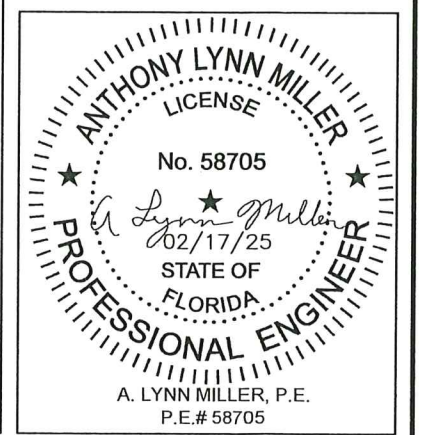

TABLE 2:

| ITEM | PGT. # | Description | Material |
|------|-------------|---|-----------------|
| 1 | 617306 | 2-TRACK HEAD | 6063-T6 ALUM. |
| 2 | 617303 | 2-TRACK HEAD WITH SCREEN RAIL | 6063-T6 ALUM. |
| 5 | 617314 | FRAME SCREW COVER | 6063-T6 ALUM. |
| 7 | 617304 | 2-TRACK SILL | 6063-T6 ALUM. |
| 8 | 617301 | 2-TRACK SILL WITH SCREEN RAIL | 6063-T6 ALUM. |
| 11 | 617313 | FRAME SILL TRACK INSERT | 6063-T6 ALUM. |
| 14 | 617305 | 2-TRACK JAMB | 6063-T6 ALUM. |
| 15 | 617302 | 2-TRACK JAMB WITH SCREEN RAIL | 6063-T6 ALUM. |
| 18 | 617322 | SILL RISER, FLAT, 1-1/2" | 6063-T6 ALUM. |
| 19 | 617319 | SILL RISER, BOX, 1-1/2" | 6063-T6 ALUM. |
| 20 | 617321 | SILL RISER, FLAT, 2-1/2" | 6063-T6 ALUM. |
| 21 | 617318 | SILL RISER, BOX, 2-1/2" | 6063-T6 ALUM. |
| 22 | 617355 | SILL RISER, FLAT, 3-1/4" | 6063-T6 ALUM. |
| 23 | 617354 | SILL RISER, BOX, 3-1/4" | 6063-T6 ALUM. |
| 24 | 617320 | SILL RISER, FLAT, 4" | 6063-T6 ALUM. |
| 25 | 617323 | SILL RISER, BOX, 4" | 6063-T6 ALUM. |
| 40 | 612258 | SCREEN SIDE RAIL - LOCKSTILE | 6063-T6 ALUM. |
| 41 | 7LOCKWGSK | SCREEN LOCKSET | |
| 42 | 41818 | SCREEN KEEPER SPACER SET | |
| 45 | 612256 | SCREEN TOP RAIL | 6063-T6 ALUM. |
| 46 | 612257 | SCREEN BOTTOM RAIL | 6063-T6 ALUM. |
| 47 | 7SRAZ | STANDARD ROLLER | |
| 48 | 7SRAX | STANDARD ROLLER - ST. STL. | STAINLESS STEEL |
| 51 | 61692 | SCREEN SPLINE - .165 | |
| 53 | 61816C20 | SCREEN CLOTH | |
| 54 | | 1/2" x 4" x 1/16" SETTING BLOCK | NEOPRENE |
| 55 | | 1" X 4" X 1/16" SETTING BLOCK | NEOPRENE |
| 61 | 617326 | PANEL STILE (HEAVY DUTY) | 6063-T6 ALUM. |
| 62 | 617327 | INTERLOCK ADAPTOR | 6063-T6 ALUM. |
| 63 | 6TP248 | VINYL BULB WSTP. - THIN (INSIDE INTERLOCK) | |
| 64 | 71729 | SILL END WEATHERSTRIP PAD | |
| 65 | 617328 | INTERLOCK SCREW COVER | 6063-T6 ALUM. |
| 66 | 617346 | INTERLOCK ALUM REINFORCEMENT | 6063-T6 ALUM. |
| 68 | 617339 | HEAVY DUTY ASTRAGAL | 6063-T6 ALUM. |
| 69 | 617324 | TOP & BOTTOM RAIL | 6063-T6 ALUM. |
| 70 | 417350 | WEATHERSTRIP EXTENSION (INJECTION MOLDED) | |
| 71 | 71695 | 1-1/2" X 1" X 3/4" HIGH FIN SEAL DUST PLUGS | |
| 72 | 78153X | TANDEM ROLLER ASSY. | STAINLESS STEEL |
| 73 | 78153N | TANDEM ROLLER ASSY. | NYLON |
| 74 | SILICONE | DOW 791, 899, 983, 995 OR GE 7700 | |
| 75 | 78185X | GEMINI MORTICE 3-PLY LOCK W/LONG TRIM PLATE | |
| 76 | 71032X1FPFX | #10-32 X 1" FH SCREW W/ TYPE "F" TIP | STAINLESS STEEL |
| 77 | 7103239 | 10-32 STEEL U-NUT | ZINC |
| 78 | 617358 | 3/16" & 1/4" SQUARE BEAD | 6063-T6 ALUM. |
| 79 | 617357 | 1" IG BEAD | 6063-T6 ALUM. |
| 80 | 617359 | FIXED PANEL CLIP | 6063-T6 ALUM. |

| ITEM | PGT. # | Description | Material |
|------|--------------|--|-----------------|
| 82 | 6TP247K | VINYL BULB WEATHERSTRIP | |
| 83 | IGTAPE | 1/2" X 1/16" SINGLE SIDE ADHESIVE TAPE | |
| 100 | 48052 | ROLLER ADJ. HOLE PLUG | |
| 101 | 72087 | JAMB BUMPER | |
| 102 | 71696 | DUST PLUG | PVC |
| 103 | 78186X | 1" KEEPER | |
| 104 | 7SDKEEP | SCREEN LOCK KEEPER | |
| 105 | 617344 | FIXED PANEL CLIP - 6" LONG | 6063-T6 ALUM. |
| 106 | 617352 | EXTERIOR FIXED PANEL RETAINER | 6063-T6 ALUM. |
| 107 | varies | HANDLE KIT | |
| 111 | 710X34PPSDAX | #10 X 3/4" PH. PN. TEK | STAINLESS STEEL |
| 112 | 67S16 | WSTP, 0.270" X 0.170" FIN SEAL | |
| 113 | 64066 | WSTP, 0.187" X .230 FINSEAL | |
| 114 | 710X115PPX | #10 X 1-1/2" SMS | STAINLESS STEEL |
| 115 | 710XPPT | #10 X 1" SMS | STAINLESS STEEL |
| 116 | 720X1X | #14-20 X 1" MS | STAINLESS STEEL |
| 117 | 720X112X | #14-20 X 1-1/2" MS | STAINLESS STEEL |
| 118 | | #8 X 1" SMS | STAINLESS STEEL |
| 119 | | #8 X 1-1/4" SMS | STAINLESS STEEL |
| 120 | | #10 X 1" SMS | STAINLESS STEEL |

ITEMS # 3, 4, 6, 9, 10, 12, 13, 16 ,17, 26-39, 43, 44, 49, 50, 52, 56-60, 67, 81, 84-99 & 108-110 ARE NOT USED AND ARE NOT PART OF THIS APPROVAL.

TABLE 3:

| Material | Min. F _y | Min. F _u |
|------------------------------------|---------------------|---------------------|
| #12 Steel Screw | 92 ksi | 120 ksi |
| #12 18-8 Screw | 60 ksi | 95 ksi |
| #12 410 Screw | 90 ksi | 110 ksi |
| 1/4" DeWalt/Elco Aggre-Gator® | 57 ksi | 96 ksi |
| 1/4" DeWalt UltraCon+® | 148 ksi | 164 ksi |
| 1/4" 410 SS DeWalt/Elco CreteFlex® | 127.4 ksi | 189.7 ksi |
| 6063-T5 Aluminum | 16 ksi | 22 ksi |
| A36 Steel | 36 ksi | 58 ksi |
| Gr. 33 Steel Stud | 33 ksi | 45 ksi |

PRODUCT RENEWED
as complying with the Florida
Building Code
Acceptance No. 25-0220.02
Expiration Date 3/24/2030
By Ishag I. Chaudhary
Miami Dade Product Control

Revision:

UPDATE COMPANY ADDRESS.
AM-02/17/25

PREPARED BY A. LYNN MILLER
1070 TECHNOLOGY DRIVE
N. VENICE, FL 34275
(941) 480-1600

PCT
Custom Windows and Doors
3400 PRECISION DRIVE
N. VENICE, FL 34275
(941) 480-1600

REGISTRATION #29296

ALUMINUM SLIDING GLASS DOOR (NI)

03/21/20

JENS ROSOWSKI

1

9 OF 10

SGD670 HP

PGT0003

ANTHONY LYNN MILLER
LICENSE
No. 58705
A. LYNN MILLER, P.E.
P.E.# 58705

Professional Engineer
STATE OF FLORIDA
02/17/25

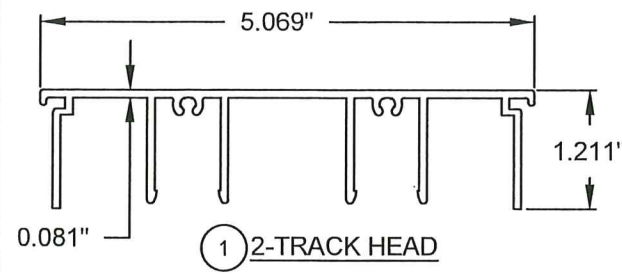

1 2-TRACK HEAD

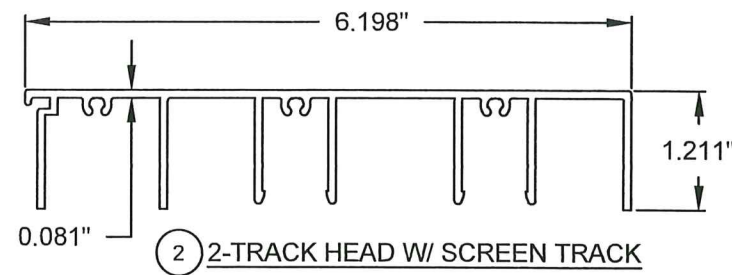

2 2-TRACK HEAD W/ SCREEN TRACK

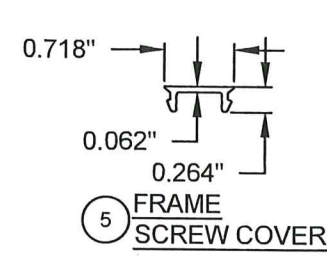

5 FRAME SCREW COVER

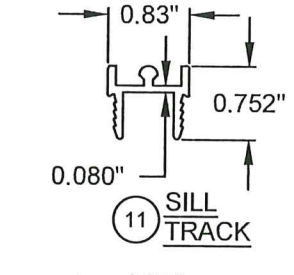

11 SILL TRACK

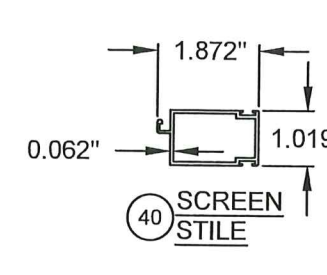

40 SCREEN STILE

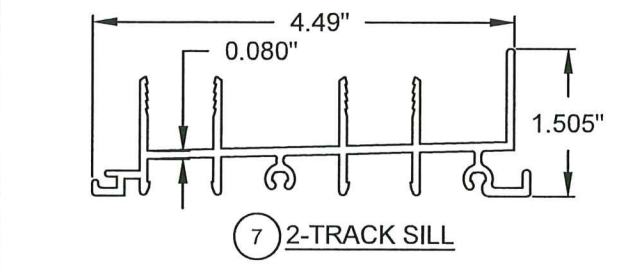

7 2-TRACK SILL

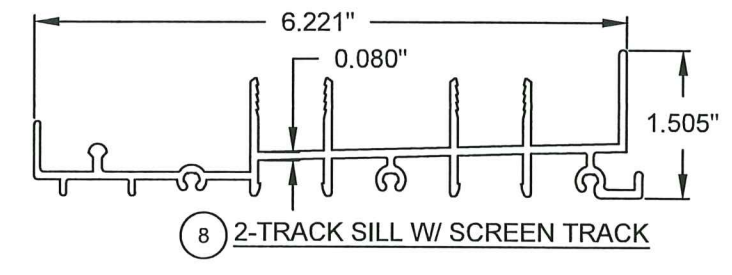

8 2-TRACK SILL W/ SCREEN TRACK

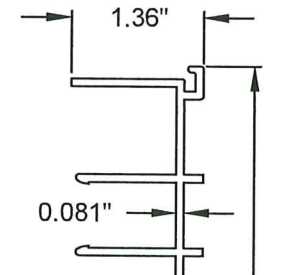

14 2-TRACK JAMB

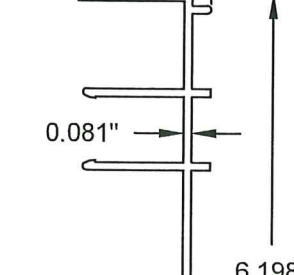

15 2-TRACK JAMB W/ SCREEN TRACK

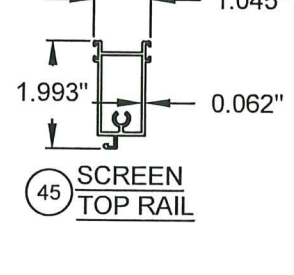

45 SCREEN TOP RAIL

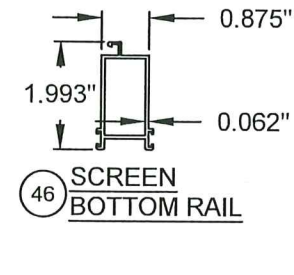

46 SCREEN BOTTOM RAIL

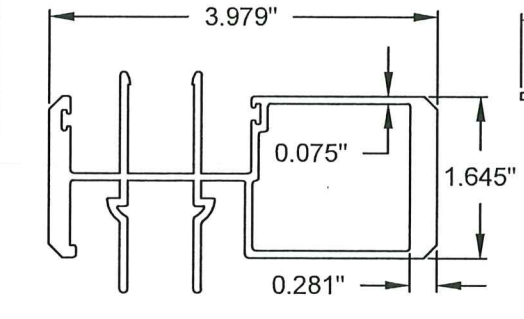

68 HEAVY DUTY ASTRAGAL

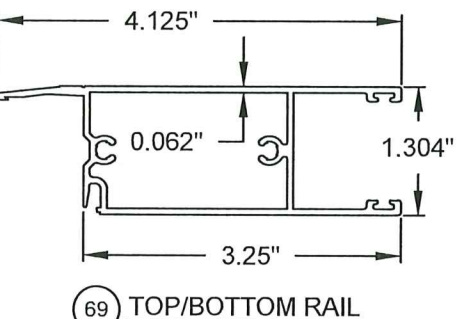

69 TOP/BOTTOM RAIL

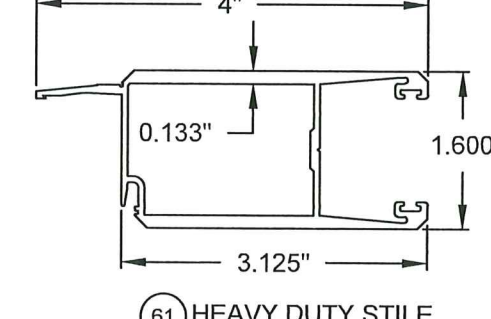

61 HEAVY DUTY STILE

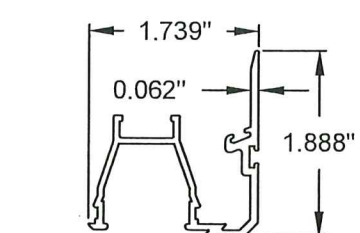

62 INTERLOCK ADAPTER

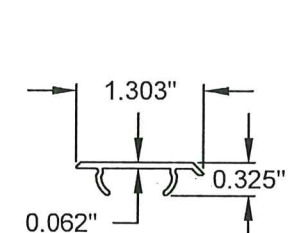

65 INTERLOCK SCREW COVER

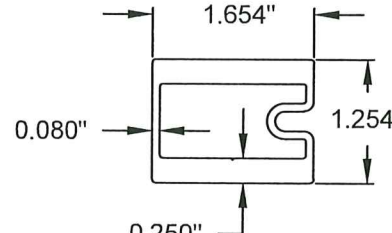

66 REINFORCEMENT

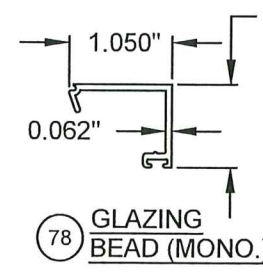

78 GLAZING BEAD (MONO.)

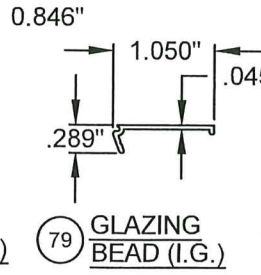

79 GLAZING BEAD (I.G.)

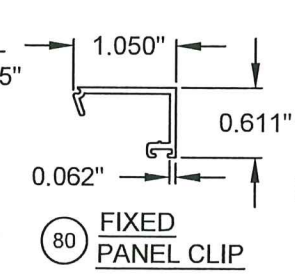

80 FIXED PANEL CLIP

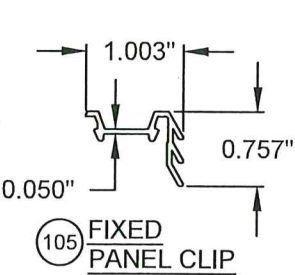

105 FIXED PANEL CLIP

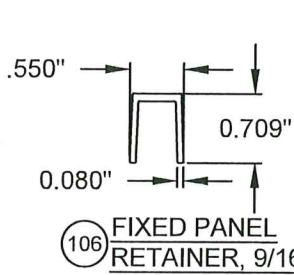

106 FIXED PANEL RETAINER, 9/16"

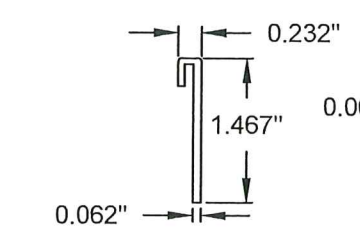

18* SILL RISER, FLAT, 1-1/2"*

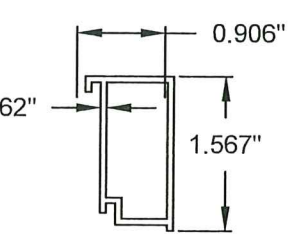

19* SILL RISER, BOX, 1-1/2"*

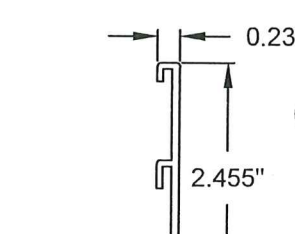

20 SILL RISER, FLAT, 2-1/2"

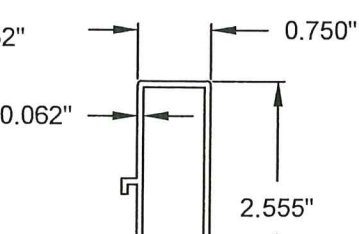

21 SILL RISER, BOX, 2-1/2"

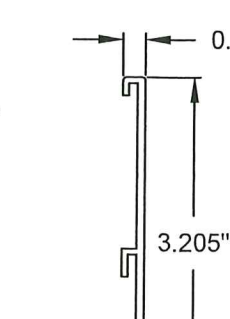

22 SILL RISER, FLAT, 3-1/4"

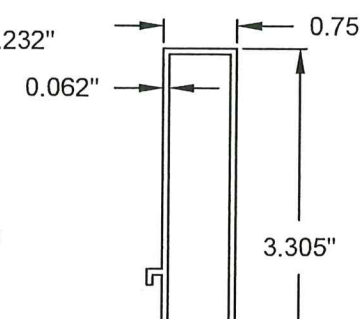

23 SILL RISER, BOX, 3-1/4"

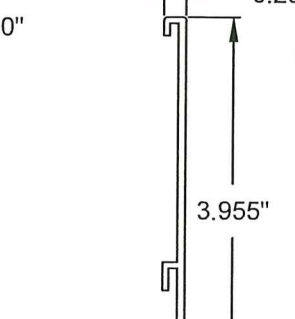

24 SILL RISER, FLAT, 4"

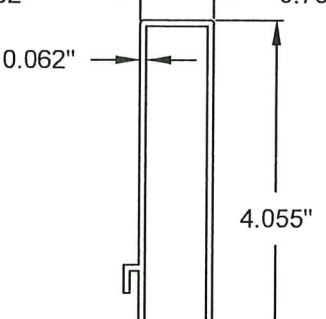

25 SILL RISER, BOX, 4"

* NOT VALID FOR WATER INFILTRATION RESISTANCE REQUIREMENTS.

PRODUCT RENEWED
as complying with the Florida
Building Code
Acceptance No. 25-0220-02
Expiration Date 3/24/2030
By *Lynn Miller*
Miami Dade Product Control

Revision:
UPDATE COMPANY
ADDRESS.
AM-02/17/25

| | | | | | | | | | | |
|--|---|--|----------|--|---------------|--|---------|--|-----------|--|
| PREPARED BY A. LYNN MILLER 1070 TECHNOLOGY DRIVE N. VENICE, FL 34275 (941) 480-1600 | REGISTRATION #29296 | | 03/21/20 | | JENS ROSOWSKI | | PGT0003 | | Rev. 1 | |
| | ALUMINUM SLIDING GLASS DOOR (NI) | | Date | | By | | DWG No. | | Sheet | |
| | CUSTOM WINDOWS AND DOORS 3400 PRECISION DRIVE N. VENICE, FL 34275 (941) 480-1600 | | Title | | Desc. | | Series | | SGD670 HP | |

