



DEPARTMENT OF REGULATORY AND ECONOMIC RESOURCES (RER)
BOARD AND CODE ADMINISTRATION DIVISION

MIAMI-DADE COUNTY
PRODUCT CONTROL SECTION
11805 SW 26 Street, Room 208
Miami, Florida 33175-2474
T (786) 315-2590 F (786) 315-2599

www.miamidade.gov/economy

NOTICE OF ACCEPTANCE (NOA)

**Ply Gem Residential Solutions,
A Division of Cornerstone Building Brands, Inc.
5020 Weston Pkwy
Cary, NC 27513**

SCOPE:

This NOA is being issued under the applicable rules and regulations governing the use of construction materials. The documentation submitted has been reviewed and accepted by Miami-Dade County RER- Product Control Section to be used in Miami Dade County and other areas where allowed by the Authority Having Jurisdiction (AHJ).

This NOA shall not be valid after the expiration date stated below. The Miami-Dade County Product Control Section (In Miami Dade County) and/or the AHJ (in areas other than Miami Dade County) reserve the right to have this product or material tested for quality assurance purposes. If this product or material fails to perform in the accepted manner, the manufacturer will incur the expense of such testing and the AHJ may immediately revoke, modify, or suspend the use of such product or material within their jurisdiction. RER reserves the right to revoke this acceptance if it is determined by Miami-Dade County Product Control Section that this product or material fails to meet the requirements of the applicable building code.

This product is approved as described herein and has been designed to comply with the High Velocity Hurricane Zone of the Florida Building Code.

DESCRIPTION: PVC Privacy Fence Panels

APPROVAL DOCUMENT: Drawing No. PGR011, titled "Privacy PVC Fence System", dated March 03, 2025, sheets 1 through 3 of 3, signed and sealed by Hermes F. Norero, P.E. on April 22, 2025, bearing the Miami-Dade County Product Control Revision stamp with the Notice of Acceptance number and the expiration date by the Miami-Dade County Product Control Section.

MISSILE IMPACT RATING: None

LABELING: Each fence panel shall bear a permanent label with the manufacturer's name or logo, York, NE and the following statement: "Miami-Dade County Product Control Approved", unless otherwise noted herein.

RENEWAL of this NOA shall be considered after a renewal application has been filed and there has been no change in the applicable building code negatively affecting the performance of this product.

TERMINATION of this NOA will occur after the expiration date or if there has been a revision or change in the materials, use, and/or manufacture of the product or process. Misuse of this NOA as an endorsement of any product, for sales, advertising or any other purposes shall automatically terminate this NOA. Failure to comply with any section of this NOA shall be cause for termination and removal of NOA.

ADVERTISEMENT: The NOA number preceded by the words Miami-Dade County, Florida, and followed by the expiration date may be displayed in advertising literature. If any portion of the NOA is displayed, then it shall be done in its entirety.

INSPECTION: A copy of this entire NOA shall be provided to the user by the manufacturer or its distributors and shall be available for inspection at the job site at the request of the Building Official.

This NOA revises NOA #22-0118.02 and consists of this page 1, evidence submitted pages E-1 and E-2 as well as approval document mentioned above.

The submitted documentation was reviewed by **Helmy A. Makar, P.E., M.S.**



H. A. Makar
05/08/25

NOA No. 25-0423.01
Expiration Date: 09/15/2026
Approval Date: 05/08/2025
Page 1

Ply Gem Residential Solutions,
A Division of Cornerstone Building Brands, Inc.

NOTICE OF ACCEPTANCE: EVIDENCE SUBMITTED

- 1. EVIDENCE SUBMITTED UNDER PREVIOUS APPROVAL #15-1124.11**
 - A. DRAWINGS**
 1. *Drawing No. KS2065, titled "6' x 6' Performance Privacy PVC Fence System", dated 06/16/16, sheets 1 thru 3 of 3, signed & sealed by Theodore Berman, P.E. on 06/16/16*
 - B. TESTS**
 1. *Test Report # D5835.01-119-18, dated 09/01/2015, issued by Intertek/Architectural Testing, signed and sealed by Joseph A. Reed, P.E. on September 02, 2015.*
 - C. CALCULATIONS**
 1. *Fence and Post Analysis, dated November 17, 2015, two sheets, signed and sealed by Theodore Berman, P.E.*
 - D. QUALITY ASSURANCE**
 1. *By Miami-Dade County Department of Regulatory and Economic Resources.*
 - E. MATERIAL CERTIFICATIONS**
 1. *Test Report # D5835.01-119-18, dated September 01, 2015, issued by Intertek / Architectural Testing, signed and sealed by Joseph A. Reed, P.E. on 09/02/2015.*
 - F. STATEMENTS**
 1. *FBC, 2014 Edition compliance letter issued by Ted Berman and Associates, LLC, dated November 17, 2015, signed and sealed by Theodore Berman, P.E.*
- 2. EVIDENCE SUBMITTED UNDER PREVIOUS APPROVAL #22-0118.02**
 - A. DRAWINGS**
 1. *Drawing No. KS2065, titled "6' x 6' Performance Privacy PVC Fence System", dated 06/16/16, sheets 1 thru 3 of 3, signed & sealed by Allen N. Reeves, P.E. on 02/21/22.*
 - B. TESTS**
 1. *None.*
 - C. CALCULATIONS**
 1. *None.*
 - D. QUALITY ASSURANCE**
 1. *By Miami-Dade County Department of Regulatory and Economic Resources.*
 - E. MATERIAL CERTIFICATIONS**
 1. *None.*
 - F. STATEMENTS**
 1. *FBC, 2020 Edition compliance letter issued by Allen N. Reeves, dated 02/16/22, signed and sealed by Allen N. Reeves, P.E.*

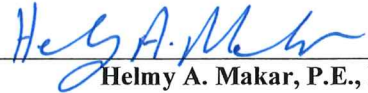
Helmy A. Makar, P.E., M.S.
Product Control Section Supervisor
NOA No. 25-0423.01
Expiration Date: 09/15/2026
Approval Date: 05/08/2025

Ply Gem Residential Solutions,
A Division of Cornerstone Building Brands, Inc.

NOTICE OF ACCEPTANCE: EVIDENCE SUBMITTED

3. NEW EVIDENCE SUBMITTED

A. DRAWINGS

1. *Drawing No. PGR011, titled "Privacy PVC Fence System", dated March 03, 2025, sheets 1 through 3 of 3, signed and sealed by Hermes F. Norero, P.E. on April 22, 2025.*

B. TESTS

1. *None.*

C. CALCULATIONS

1. *Privacy Fence System, dated April 02, 2025, two sheets, signed and sealed by Hermes F. Norero, P.E. on April 22, 2025.*

D. QUALITY ASSURANCE

1. *By Miami-Dade County Department of Regulatory and Economic Resources (RER).*

E. MATERIAL CERTIFICATIONS

1. *None.*

F. STATEMENTS

1. *FBC, 2023 Edition compliance letter issued by Building Drops, dated 04/22/25, signed and sealed by Hermes F. Norero, P.E. on April 22, 2025.*

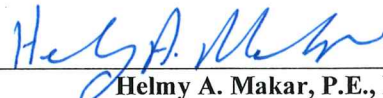

Helmy A. Makar, P.E., M.S.
Product Control Section Supervisor
NOA No. 25-0423.01
Expiration Date: 09/15/2026
Approval Date: 05/08/2025

PLY GEM RESIDENTIAL SOLUTIONS DIVISION OF CORNERSTONE BUILDING BRANDS, INC.

PRIVACY FENCE SYSTEM

GENERAL NOTES:

1. THE PRODUCT SHOWN HEREIN IS DESIGNED AND MANUFACTURED TO COMPLY WITH THE 8TH EDITION FLORIDA BUILDING CODE (FBC), INCLUDING HVHZ AND HAS BEEN EVALUATED ACCORDING TO THE FOLLOWING:
 - SECTION 1709.3
2. ADEQUACY OF THE EXISTING STRUCTURAL CONCRETE/MASONRY, 2X FRAMING, AND METAL FRAMING AS A MAIN WIND FORCE RESISTING SYSTEM CAPABLE OF WITHSTANDING AND TRANSFERRING APPLIED PRODUCT LOADS TO THE FOUNDATION IS THE RESPONSIBILITY OF THE ENGINEER OR ARCHITECT OF RECORD FOR THE PROJECT OF INSTALLATION.
3. THE INSTALLATION DETAILS DESCRIBED HEREIN ARE GENERIC AND MAY NOT REFLECT ACTUAL CONDITIONS FOR A SPECIFIC SITE. IF SITE CONDITIONS CAUSE INSTALLATION TO DEVIATE FROM THE REQUIREMENTS DETAILED HEREIN, A LICENSED ENGINEER OR ARCHITECT SHALL PREPARE SITE SPECIFIC DOCUMENTS FOR USE WITH THIS DOCUMENT.
4. WINDOW FRAME MATERIAL: ALUMINUM 6063-T5

PARTS LIST		
QTY	DESCRIPTION	LENGTH
1	5" X 5" RW POST	102"
1	5" X 5" POST TOWER INSERT	72"
2	2" X 6-1/2" SLOTTED RAIL	68"
8	1" X 8" T&G PANEL	59-1/2"
2	1" U-CHANNEL	56-7/8"
6	#10 X 3/4" SCREW	N/A
1	INSERT, LARGE P-CHANNEL	68"
1	5" X 5" EXT. LONG CAP	N/A

P-CHANNEL NOT REQUIRED FOR WHITE, TAN, OR SANDSTONE

TABLE OF CONTENTS	
SHEET	SHEET DESCRIPTION
1	GENERAL NOTES, ELEVATION AND ANCHOR DETAILS
2	PARTS DETAIL
3	PARTS DETAIL

DESIGN PRESSURE RATING (PSF)			
WIDTH (IN.)	HEIGHT (IN.)	DESIGN PRESSURE (PSF)	MISSILE IMPACT RATING
70	72	18.10	NOT RATED

PRODUCT REVISED
as complying with the Florida
Building Code
Acceptance No 25-0423.01
Expiration Date 09/15/2026
By *Helya A. Mohr*
Miami Data Product Control

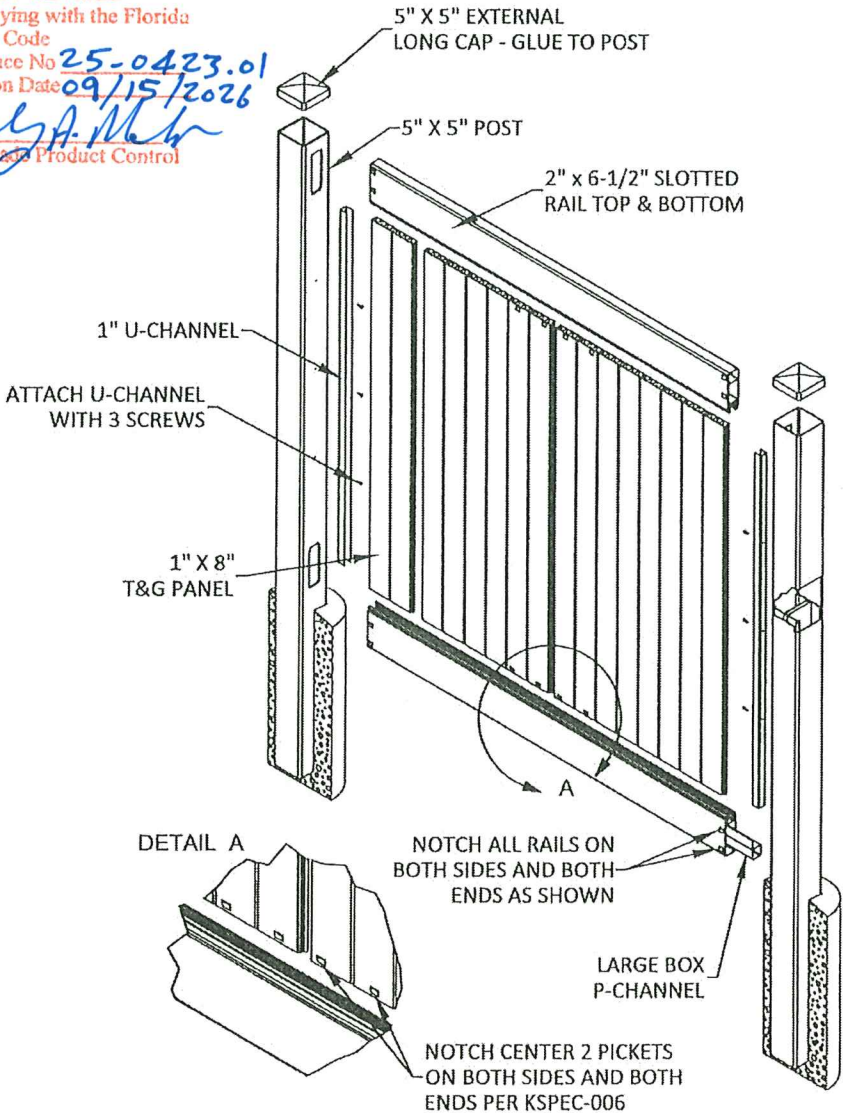
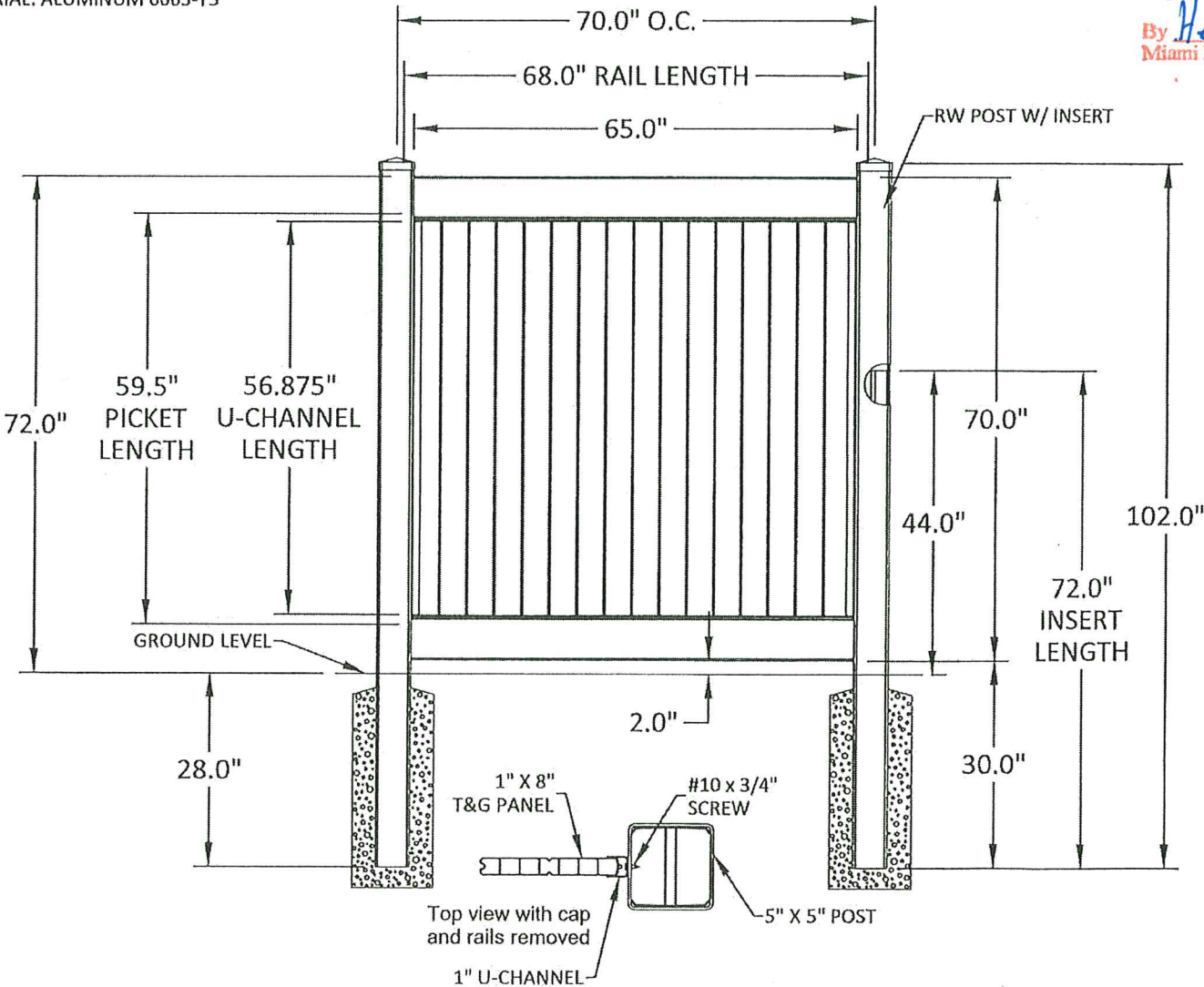

PLY GEM RESID. SOLUT., DIV. OF CORNERSTONE
BLDG. BRANDS, INC.
5020 WEST PARKWAY SUITE 400
CARY, NC 27513

PREPARED BY: **BUILDING DROPS, INC.**
1900 NE MIAMI CT. SUITE 2-15
MIAMI, FL 33132
PH: (954) 399-8478
FAX: (954) 744-4738
WEB: www.buildingdrops.com

REMARKS	BY	DATE

THE INSTALLATION DETAILS DESCRIBED HEREIN ARE GENERIC AND MAY NOT REFLECT ACTUAL CONDITIONS FOR A SPECIFIC SITE. IF SITE CONDITIONS CAUSE INSTALLATION TO DEVIATE FROM THE REQUIREMENTS DETAILED HEREIN, A LICENSED ENGINEER OR ARCHITECT SHALL PREPARE SITE SPECIFIC DOCUMENTS FOR USE WITH THIS DOCUMENT.

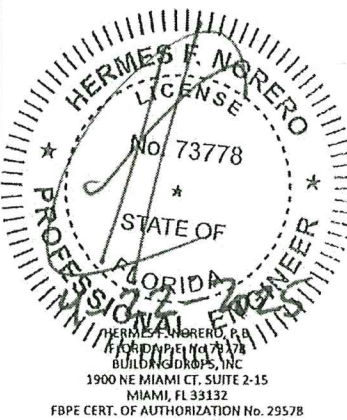

DATE: 03.03.25

DWG. BY: DI CHK. BY: HFN

SCALE: NTS

DWG. #: PGR011

SHEET:

1

PLY GEM RESID. SOLUT., DIV. OF CORNERSTONE
BLDG. BRANDS, INC.
5020 WEST PARKWAY SUITE 400
CARY, NC 27513

TITLE: **PRIVACY FENCE SYSTEM**
PARTS DETAIL
PREPARED BY: **BUILDING DROPS, INC.**
1900 NE MIAMI CT. SUITE 2-15
MIAMI, FL 33132
PH: (954) 399-8478
FAX: (954) 744-4738
WEB: www.buildingdrops.com

REMARKS	BY	DATE

THE INSTALLATION DETAILS DESCRIBED HEREIN ARE GENERIC AND MAY NOT REFLECT ACTUAL CONDITIONS FOR A SPECIFIC SITE. IF SITE CONDITIONS CAUSE INSTALLATION TO DEVIATE FROM THE REQUIREMENTS DETAILED HEREIN, A LICENSED ENGINEER OR ARCHITECT SHALL PREPARE SITE SPECIFIC DOCUMENTS FOR USE WITH THIS DOCUMENT.

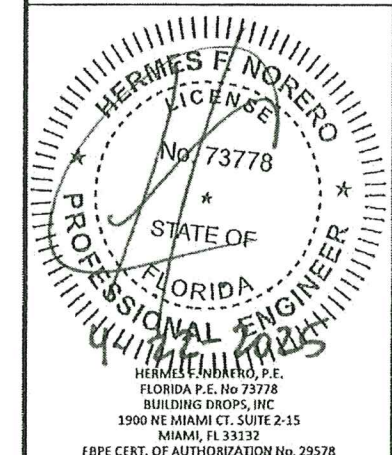

DATE: 03.03.25	
DWG. BY: DI	CHK. BY: HFN
SCALE: NTS	
DWG. #: PGR011	
SHEET: 2	
OF 3	

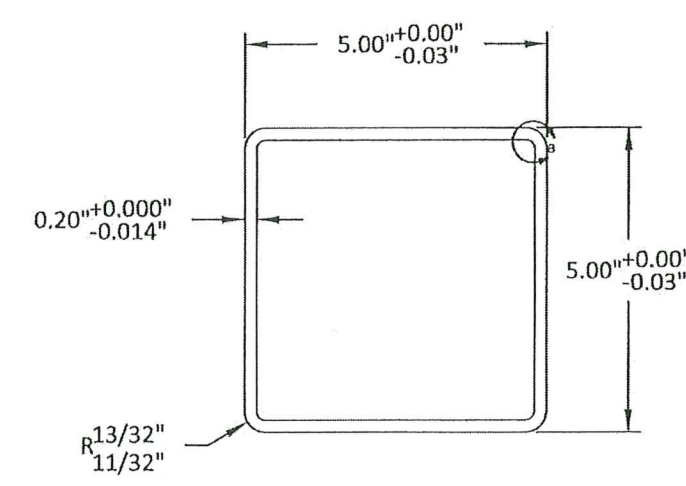

A
2 DETAIL
5' X 5' RW POST
PVC

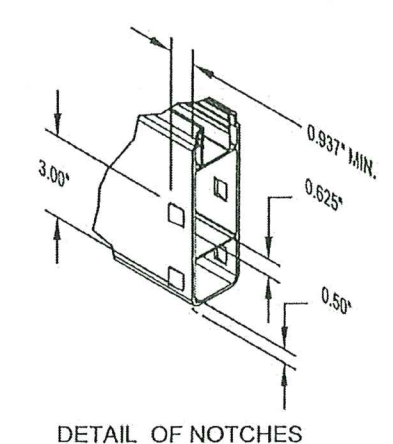
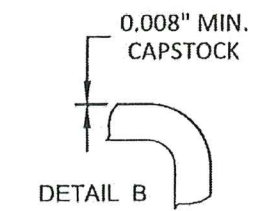

DETAIL OF NOTCHES

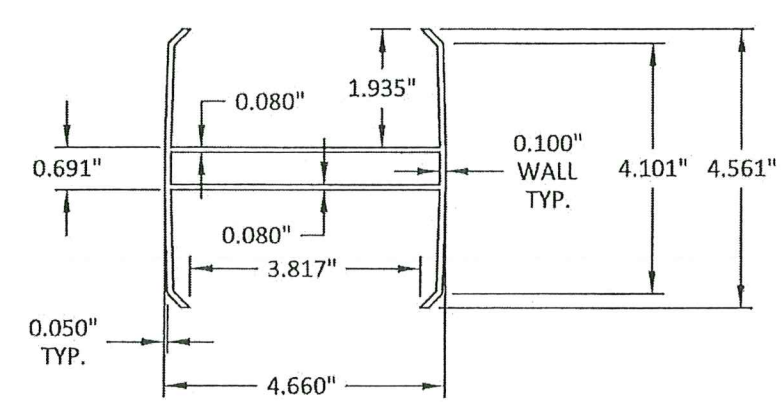

C
2 DETAIL
5' X 5' ALUMINUM POST TOWER
6063-T6 ALUMINUM

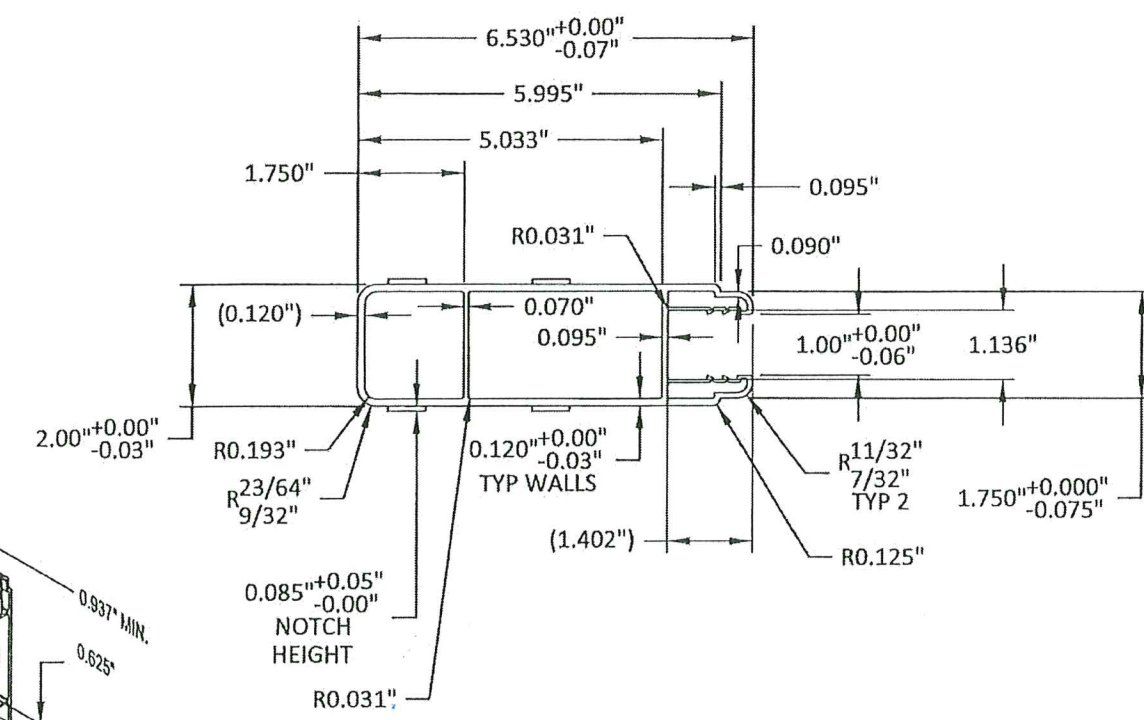

B
2 DETAIL
2' X 6-1/2' SLOTTED RIBBED SLOTTED RAIL
PVC

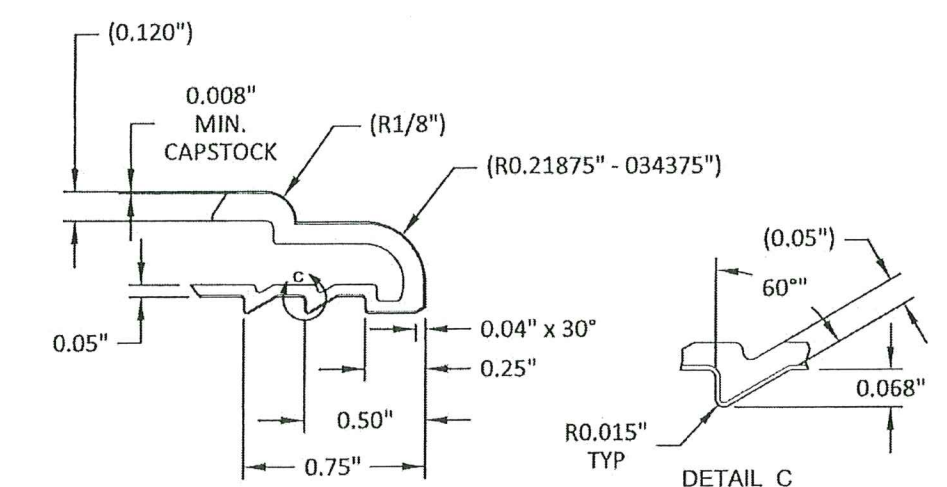

D
2 DETAIL
2' X 6-1/2' SLOTTED RIBBED SLOTTED RAIL
PVC

PRODUCT REVISED
as complying with the Florida
Building Code
Acceptance No. 25-0423.01
Expiration Date 09/15/2026
By: *Hesha A. Miller*
Miami Data Product Control

TITLE: PRIVACY FENCE SYSTEM	PARTS DETAIL	
	PREPARED BY: BUILDING DROPS, INC. 1900 NE MIAMI CT. SUITE 2-15 MIAMI, FL 33132 PH: (954) 399-8478 FAX: (954) 744-4738 WEB: www.buildingdrops.com	

REMARKS	BY	DATE
THE INSTALLATION DETAILS DESCRIBED HEREIN ARE GENERIC AND MAY NOT REFLECT ACTUAL CONDITIONS FOR A SPECIFIC SITE. IF SITE CONDITIONS CAUSE INSTALLATION TO DEVIATE FROM THE REQUIREMENTS DETAILED HEREIN, A LICENSED ENGINEER OR ARCHITECT SHALL PREPARE SITE SPECIFIC DOCUMENTS FOR USE WITH THIS DOCUMENT.		

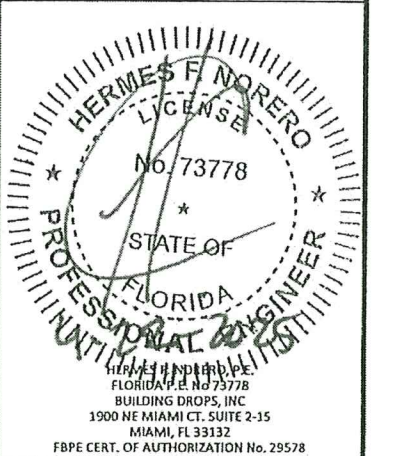

DATE:	03.03.25
DWG. BY:	DI
CHK. BY:	HFN
SCALE:	NTS
DWG. #:	PGR011
SHEET:	3

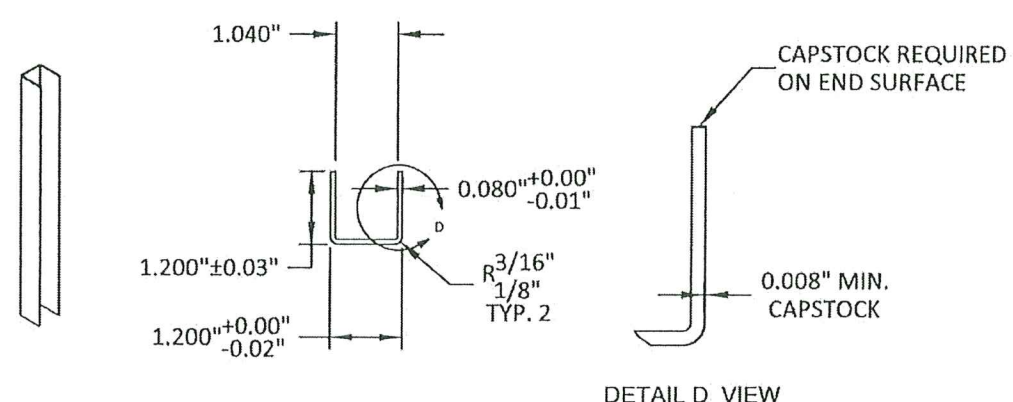
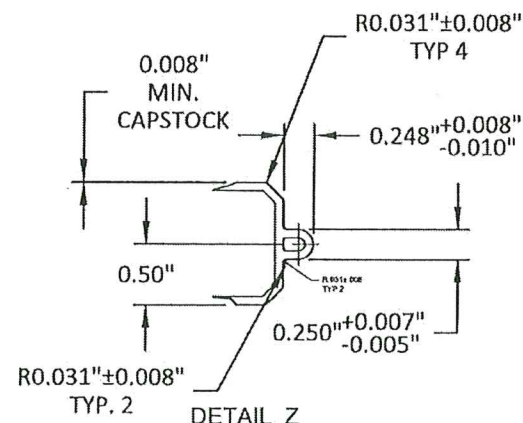

A
2 **DETAIL**
5\"/>

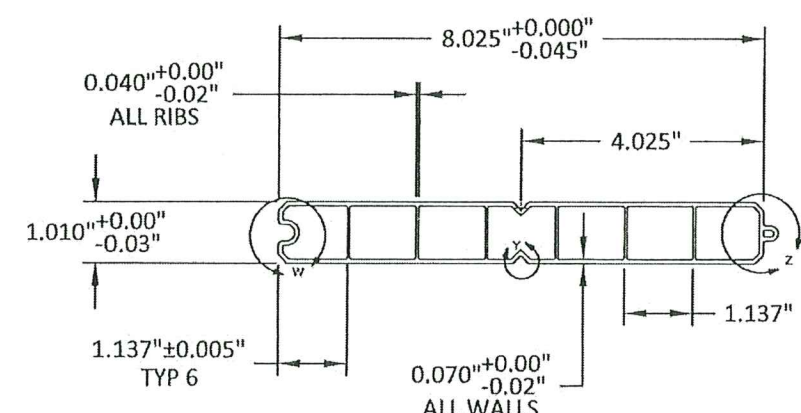

B
2 **DETAIL**
2\"/>

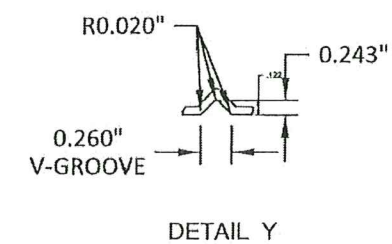
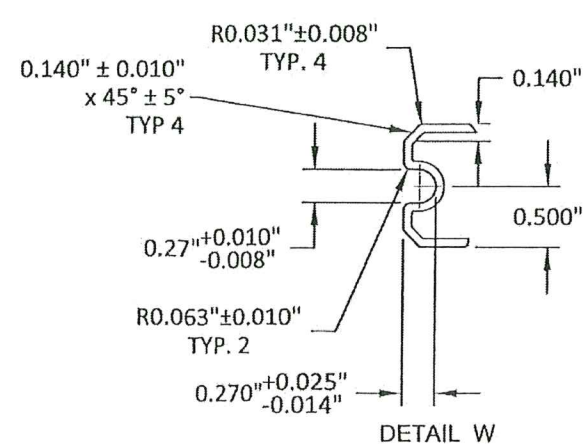

PRODUCT REVISED
as complying with the Florida
Building Code
Acceptance No. 25-092304
Expiration Date 07/15/2026
By: *H. A. M.*
Miami Trade Product Control