



MIAMI DADE EXPRESSWAY AUTHORITY TRANSPORTATION SUMMIT

JANUARY 2018

ABOUT MDX

- MDX operates 5 roads in Miami Dade County
 - ▶ SR 924, SR 112, SR 836, SR 874 and SR 878
- MDX Primary Source of Revenue: User Fees-Tolls
- MDX receives no sales tax, gas tax, property tax or half-penny sales tax
- Efficient transportation agency with staff of 36 public employees supported by contracted private sector consultants for specific tasks
- 100% of net revenues invested locally

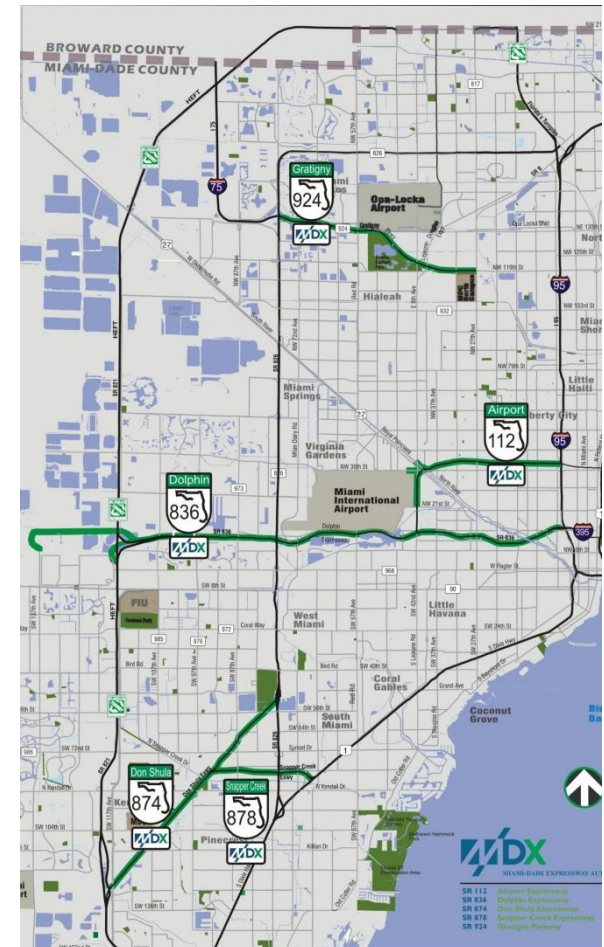

THE NEED FOR MOBILITY IS GROWING

- Increased multimodal mobility to move freight, visitors and residents is needed
 - ▶ **15.8 million** overnight visitors in 2016
 - ▶ MIA total cargo tons reached **2.2 million**, with **8 million** tons arriving at the Port
 - ▶ Miami-Dade's population increased **20%** between Census 2000 and 2016
- Miami-Dade is a global logistics hub. The increase in **mobility** provided by MDX's planned extensions is critical to enhance economic opportunities for residents
- Miami-Dade is not alone in the mobility race needed for jobs. Tampa, Jacksonville, Atlanta, Savannah are investing in "smart" highway systems

MAJOR PROJECTS ON SR 836

**Dolphin Station
Park & Ride**
- In Construction

**Widening of the SR
836 Mainline and 87th
Ave. Interchange**
- In Construction

**SR 836/I-95
Interchange
Improvements**
- In DB Procurement

**SR 836 Southwest
Extension "Kendall
Parkway"**
- In PD&E

**SR 836 HEFT
Ramps**
- In DB
Procurement

**Widening from
57th Ave. to NW
17th Ave.**
- In Construction

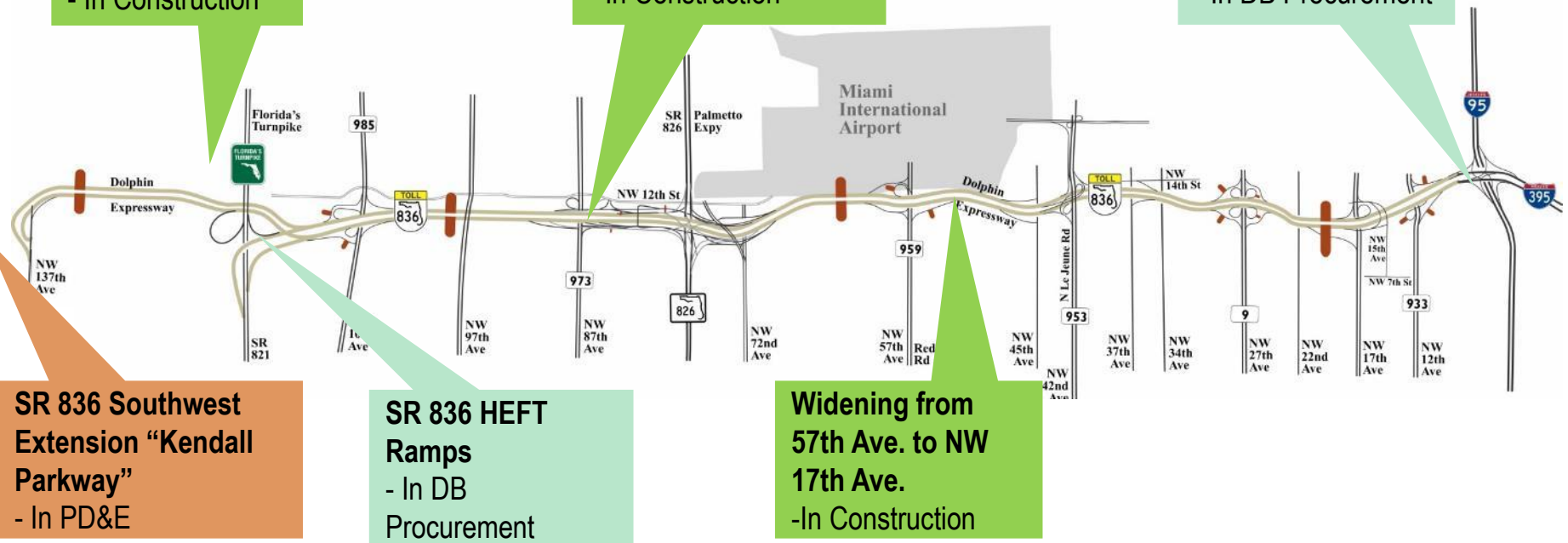

MAJOR PROJECTS ON SR 874 AND SR 878

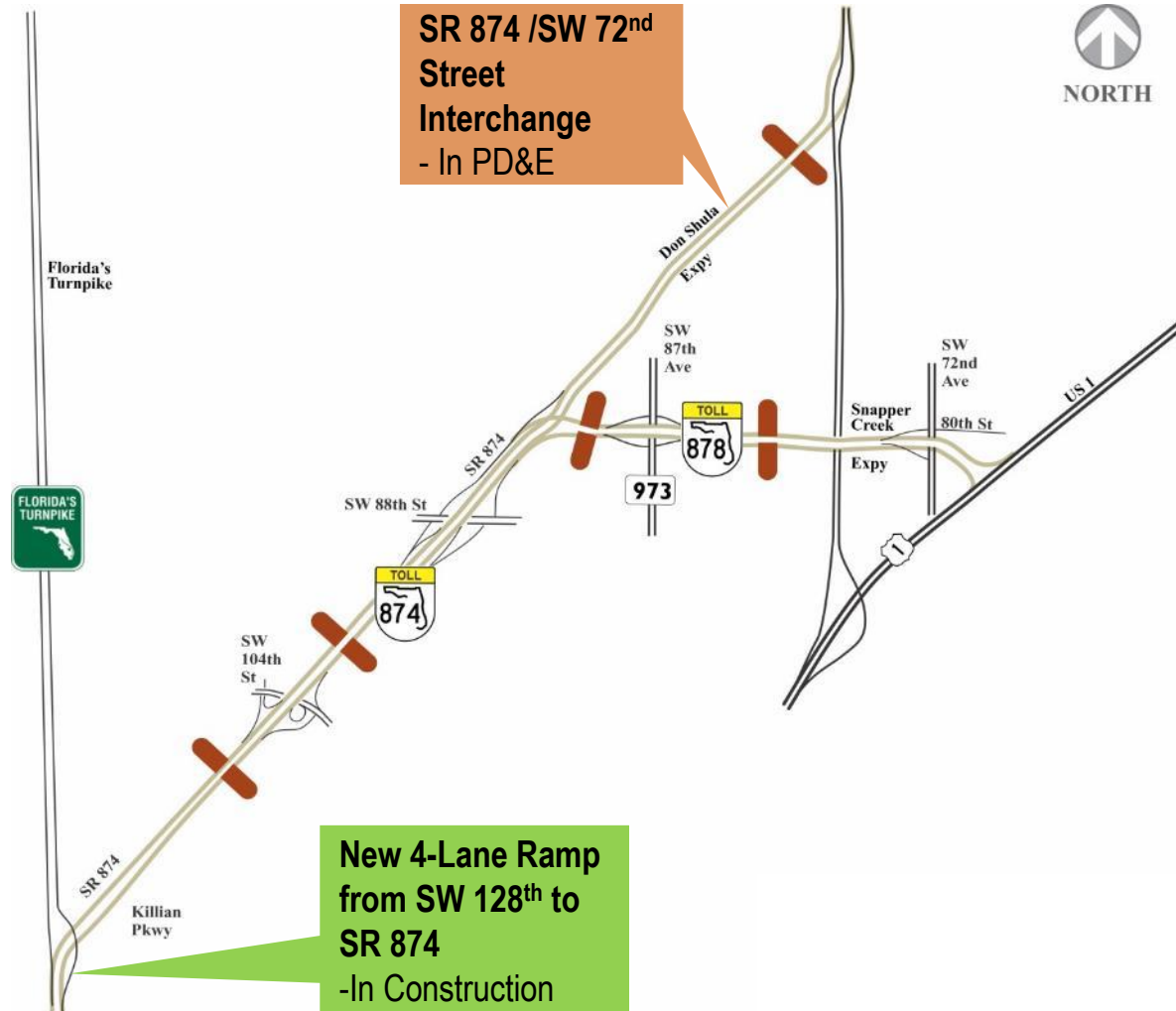

MAJOR PROJECTS ON SR 112 AND SR 924

**SR 924 West
Extension to HEFT**
- In PD&E

**SR 924 Partial
Interchange at
NW 67th Ave.**
- In PD&E

**SR 924 East
Extension to I-95**
- In PD&E

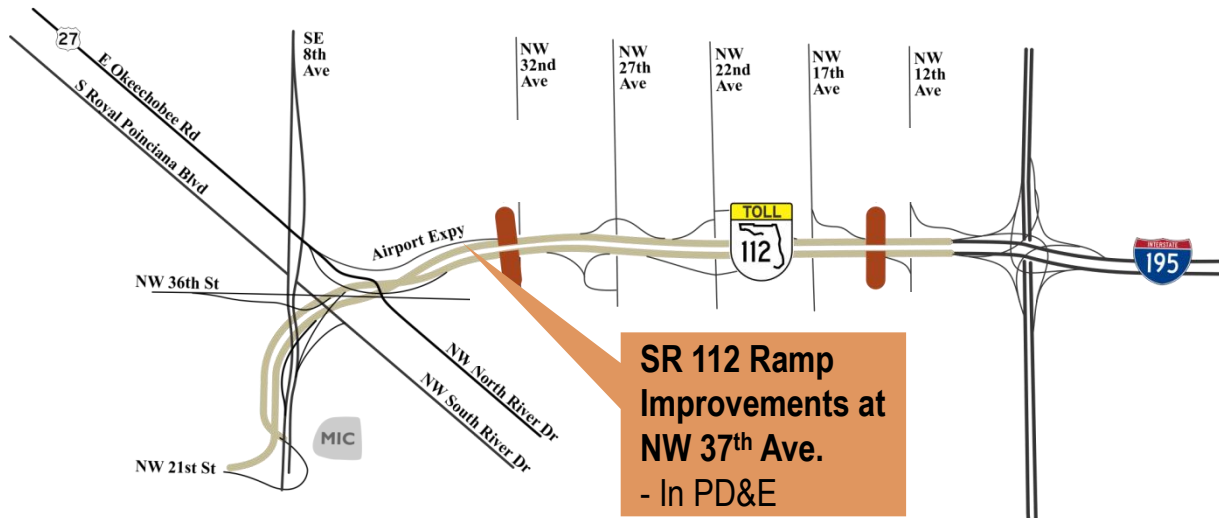
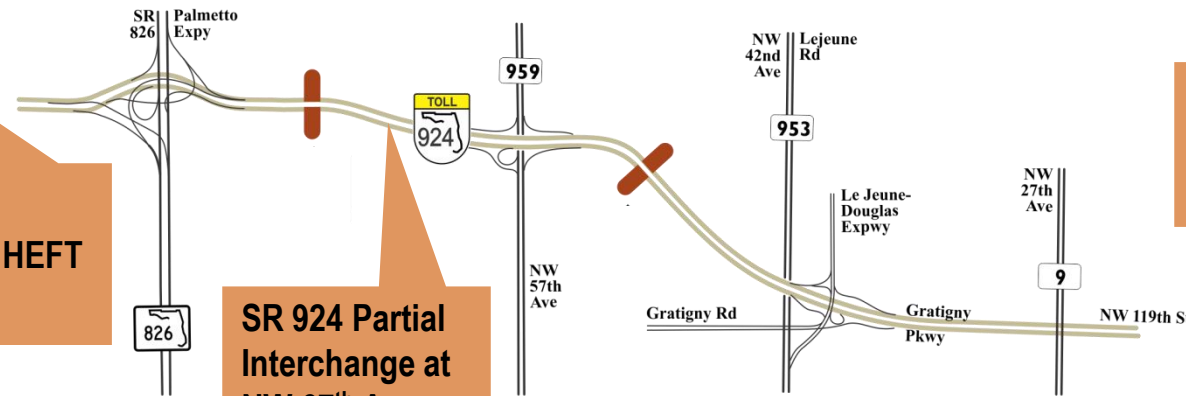

**SR 112 Ramp
Improvements at
NW 37th Ave.**
- In PD&E

MAJOR LONG-RANGE PROJECTS AND SMART PLAN INTEGRATION

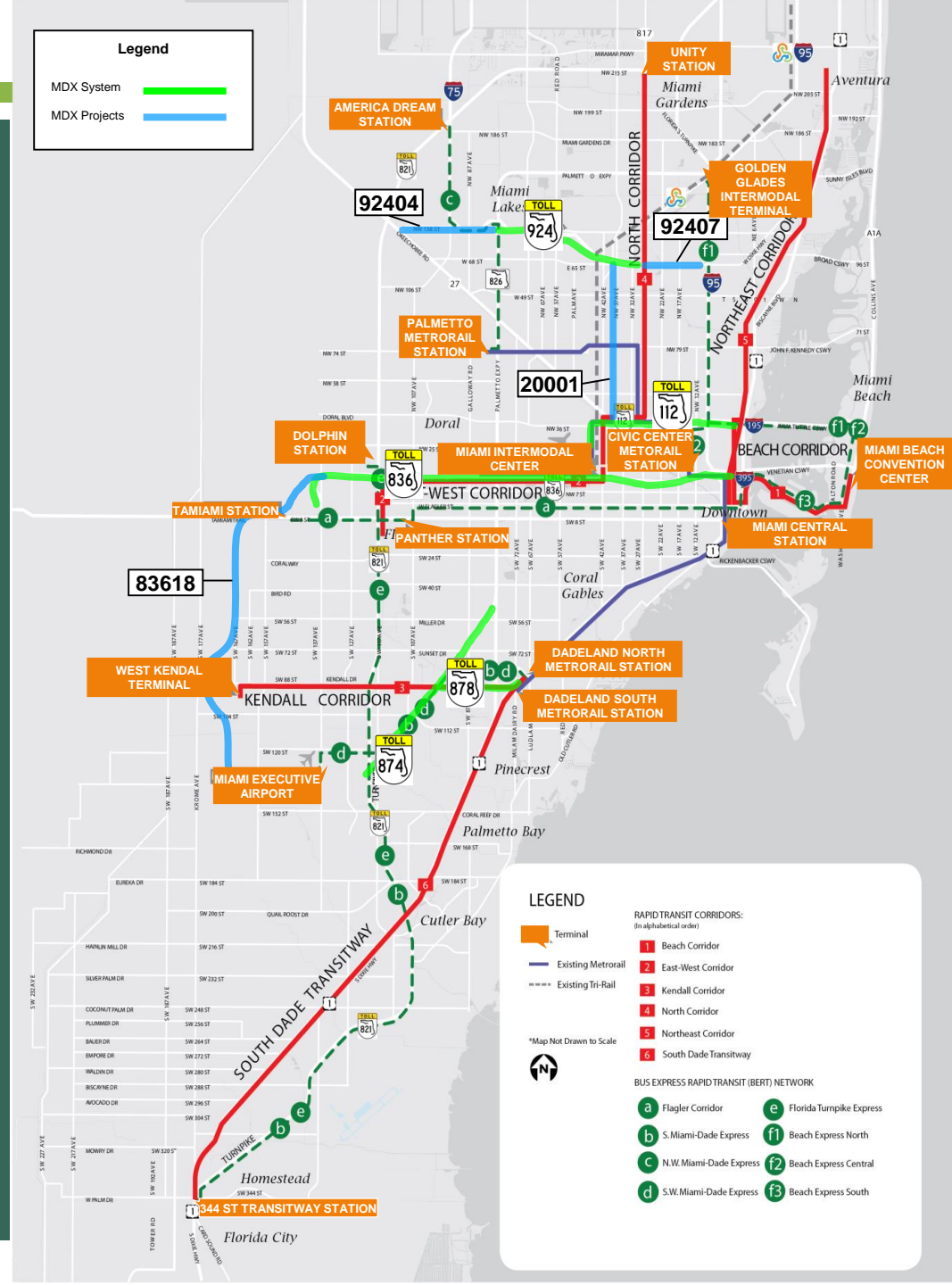
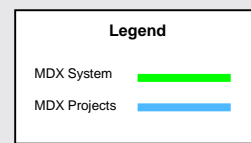

SR 836 SW EXTENSION “KENDALL PARKWAY”

Project Development & Environmental study (PD&E) underway. Benefits include:

- ▶ New multi-modal north-south expressway serving west Miami-Dade and Kendall
- ▶ Improves connectivity to and from employment, educational and commercial centers
- ▶ Serves travel demand for 600k residents and businesses generated inside the UDB
- ▶ Improves hurricane/emergency evacuation routes and travel times
- ▶ Evaluates multimodal transportation opportunities
- ▶ Splits east/west traffic flow on arterials between SR 836 Extension and the HEFT
 - ▶ Current traffic pattern is uni-directional towards/away from the HEFT on east/west arterials during peak
 - ▶ 45+ minute peak travel time on arterials
 - ▶ New traffic pattern will split flow between the SR 836 Extension and the HEFT on east/west arterials
 - ▶ 15+/- minute peak travel time on arterials

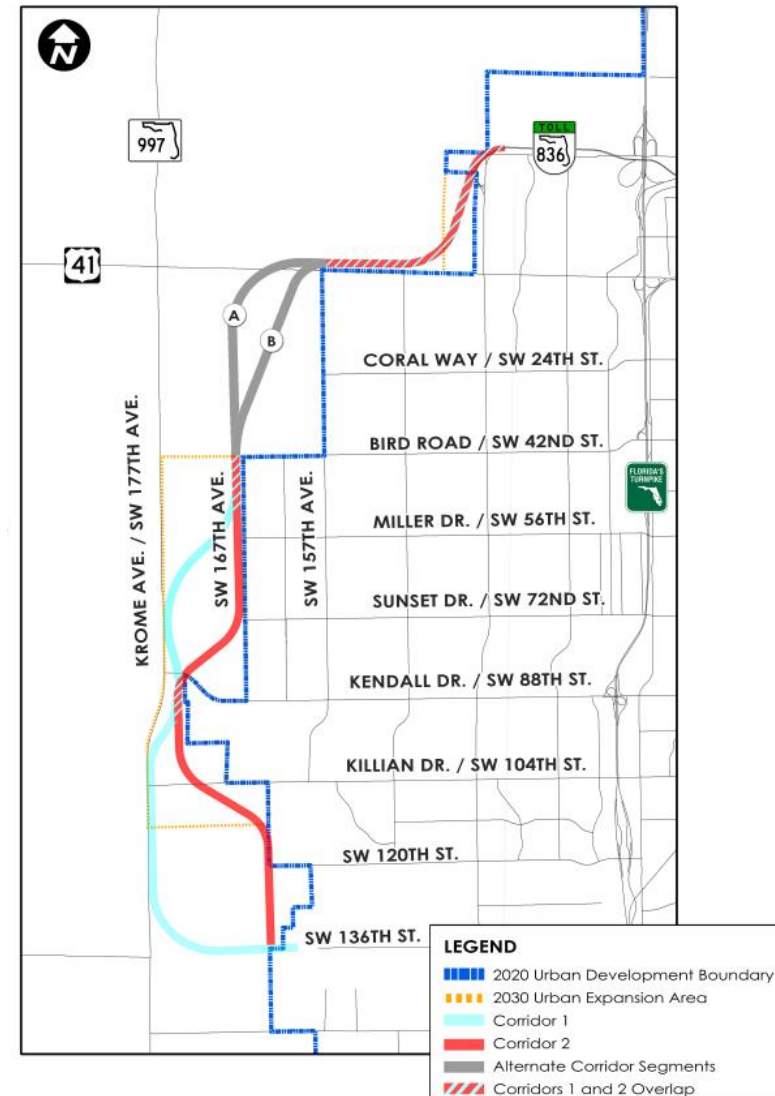

SR 836 SW EXTENSION “KENDALL PARKWAY”

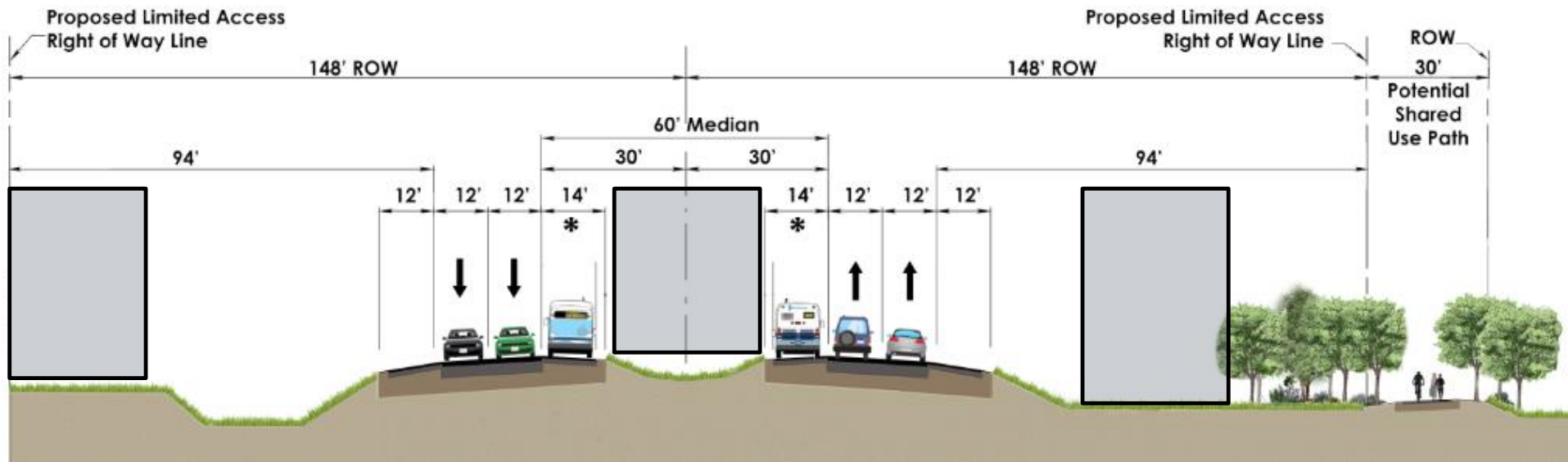

* 12-ft Inside Paved Shoulder and Peak Hour Express Transit/Technology Lane

Potential Transit Envelope

Potential Shared Use Path



TECHNOLOGY IS TRANSFORMING TRANSPORTATION

- MDX Strategic Master Transportation Plan addresses the future of transportation creating a framework of XT (Express Technology) lanes within our expressways
- XT lanes are dedicated platforms for private and public autonomous vehicles linked to future intermodal hubs
- Current projects on SR 836 complete the first phase of XT lanes infrastructure within one year to be used for premium rapid transit and private ride sharing services
- Automated vehicle technology is under development and MDX is ready to respond
- Our mobility problems require forward thinking, non-traditional mobility solutions

WHY IS THIS IMPORTANT?

- MDX identified the SR 836 corridor for multimodal transportation solutions to support the County's future population and employment growth as part of its Strategic Plan
- The TPO identified the SR 836 corridor as a component of its SMART Plan
- SR 836 cannot be widened further and technology oriented solutions to increase throughput are required
- Multimodal solutions will provide options on SR 836 for MDX's customers
- MDX is supporting the implementation of Rapid Transit/Mobility Options on SR 836
- MDX will use the Dolphin Park and Ride to anchor these services

HOW DOES IT WORK?

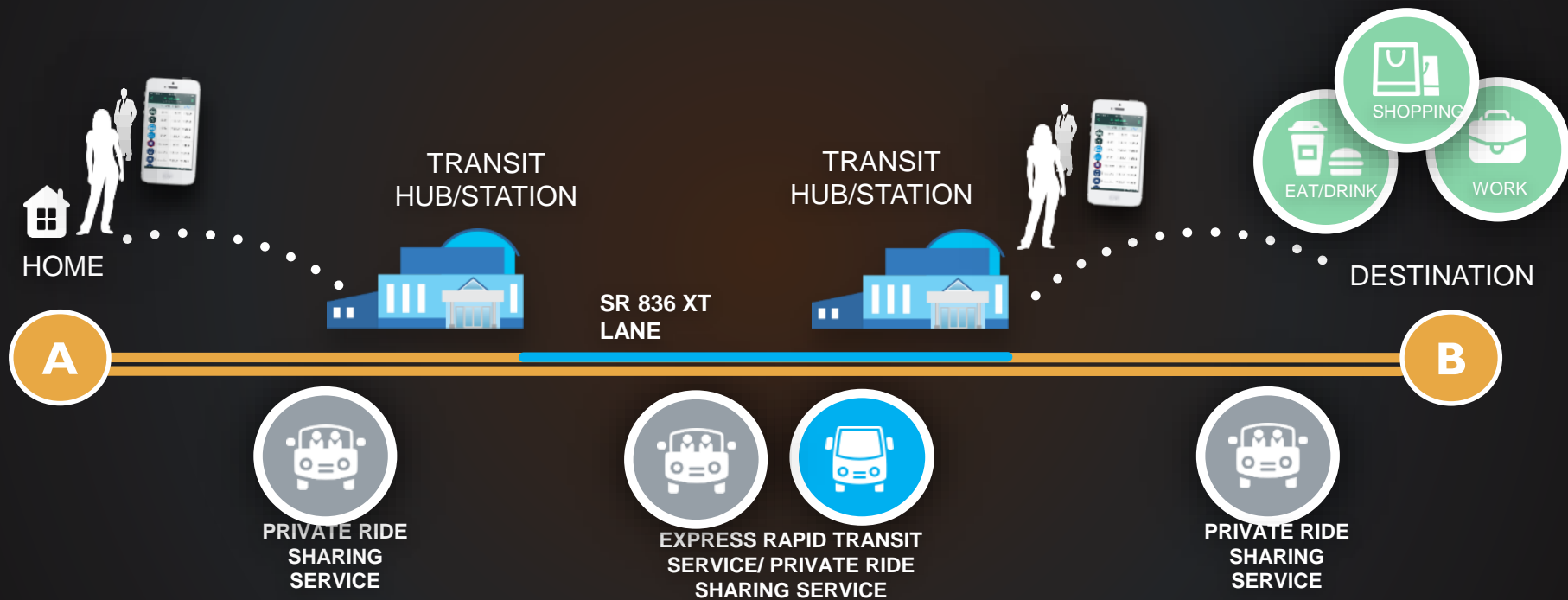

TYPICAL SECTION SR 836 UNDER CONSTRUCTION

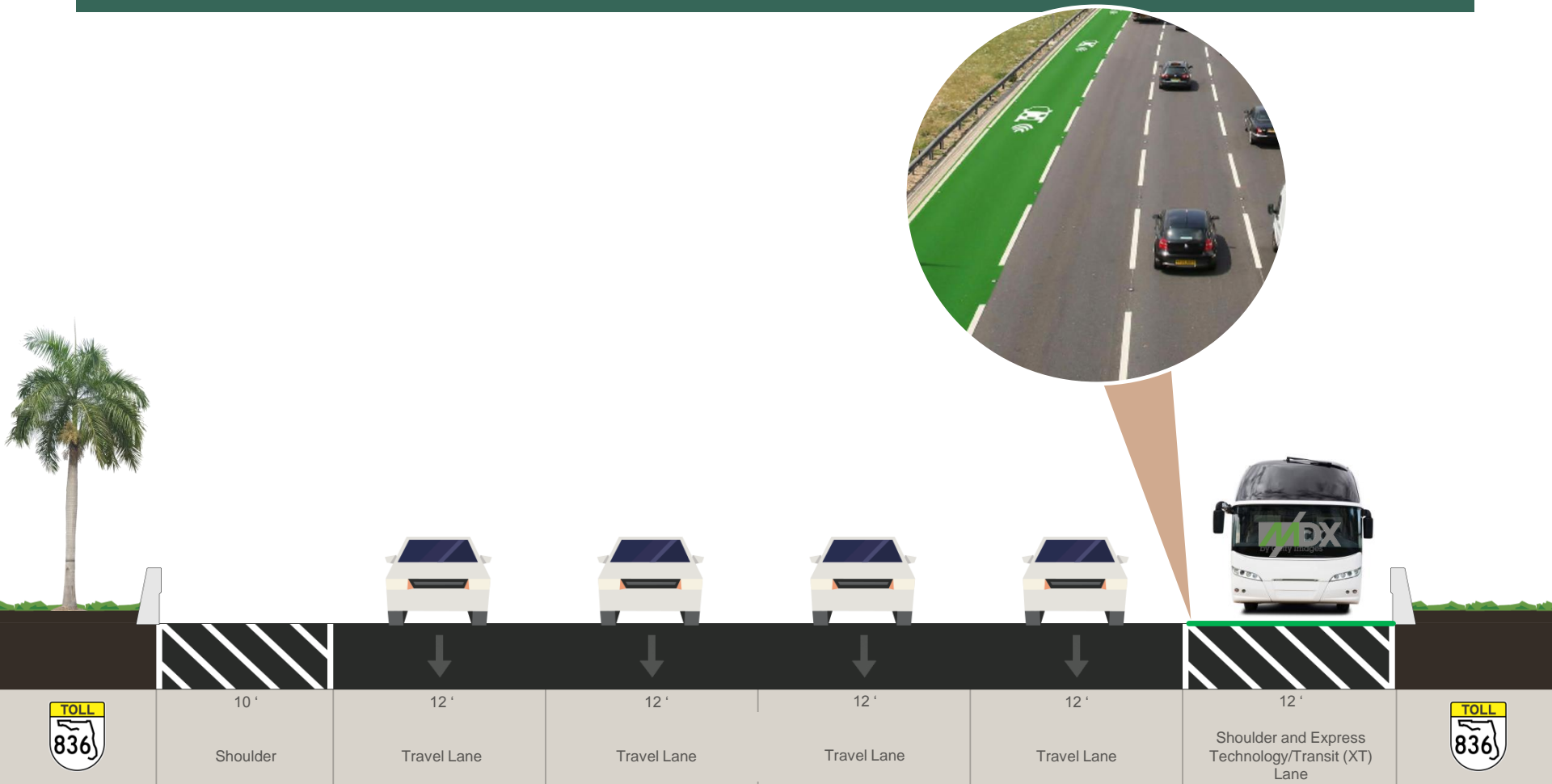

CURRENT SR 836 PREMIUM TRANSIT PLAN



FEATURES

- PREMIUM EXPERIENCE
- RELIABLE SERVICE



High-End
Vehicles



Meet LyftLine



HUB/Station
Amenities

BENEFITS

- Provides multimodal options
- Promotes the use of public transit
- Allows for partnership and collaboration - Public/Private
- Maximizes use of existing infrastructure
- Accommodates current technology
- Attractive to choice riders
- Provides alternatives to current toll customers
- Can be implemented in the short term

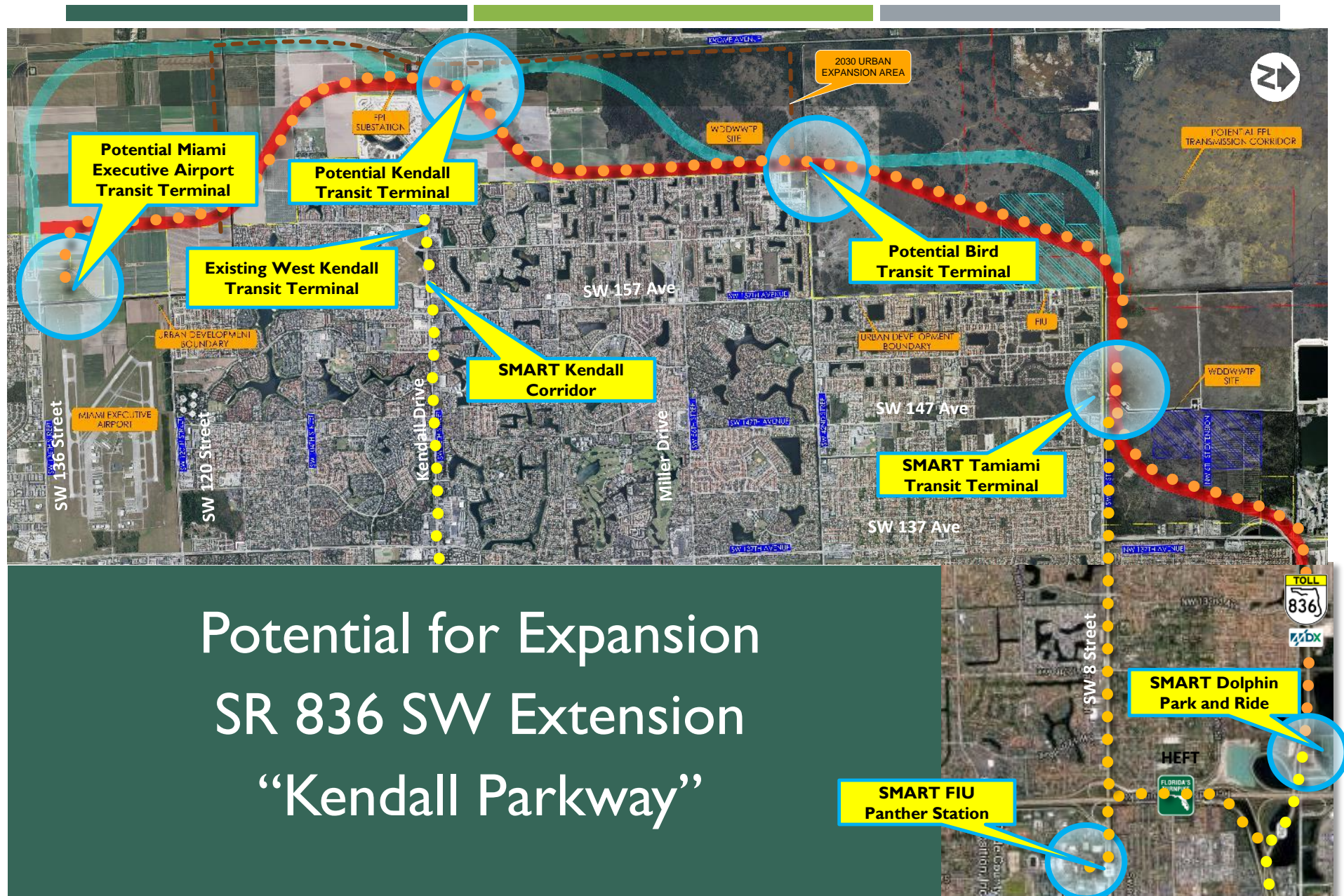

POTENTIAL FOR EXPANSION SR 874 & SR 878



WHERE WE ARE HEADED

Potential
upgrade of
vehicles



Private/public
autonomous
vehicles



Integrated
strategy of HUBS

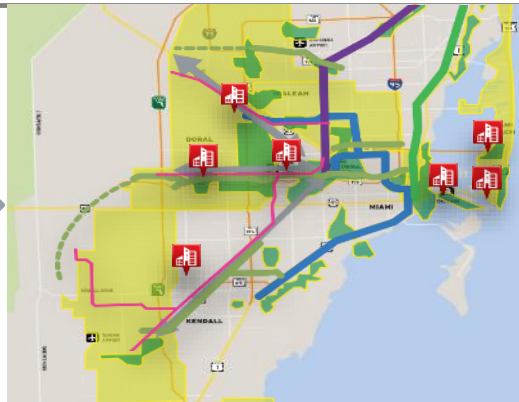

MDX OF THE FUTURE



LONG TERM FOCUS

- Mobility Solutions with Multimodal Approach
- Smart Roads Connecting Vehicles to Vehicles (V2V) and Vehicles to Infrastructure (V2I)
- Autonomous Vehicles and Platooning Opportunities
- Leveraging Data Capture for the Benefit of the Customer (e.g. Travel Time Reliability and Alternative Route Guidance)
- Custom Route Guidance based on Congestion, Shortest Path, etc.