



# **MIAMI-DADE PUBLIC SAFETY TRAINING INSTITUTE**

## **JOB-RELATED TASK ASSESSMENT**

### **INTRODUCTION**

The Job-Related Task Assessment (JTA) you are about to take is comprised of numerous obstacles that an officer may encounter within the course of duties. These obstacles may challenge your physical strength and endurance, balance, flexibility, agility, and cardiovascular fitness. The JTA requires maximum effort and pacing yourself will be important for the successful completion of the test. The time it takes to complete the test will be recorded as your test effort.

### **HYDRATION AND NUTRITION**

On your test date, you are to report to the testing area, hydrated and prepared to take the test. The Miami-Dade Public Safety Training Institute (MDPSTI) is not responsible for providing water or food prior to, during, or after the JTA. Candidates should consume plenty of fluids 2-3 days prior to testing and a light meal 2-3 hours prior to testing. Candidates should bring additional water and food to be consumed at the completion of their testing.

### **YOUR BEST EFFORT IS ENCOURAGED! PACE YOURSELF AND GOOD LUCK!**

The JTA measures specific physical abilities through participation in a series of tasks which are listed as follows:

- |  |   |
|--|---|
| - Sprinting                                    | - 150 lbs. Dummy Rescue Drag for 50 feet        |
| - Jumping over a 4 foot wall                   | - Walking/running across a balance beam         |
| - Crawling under and through a 3'x5' enclosure | - Climbing through a window                     |
| - Jumping over hurdles as high as 2 feet       | - Running up and down stairs                    |
| - Changing directions rapidly while running    | - 180 lbs. sled push and pull                   |
| - Climbing up and over a 12 foot ladder        | - Simulated controlling of a struggling subject |

The test is conducted in a continuous manner resulting in a total composite score.

### **EVALUATION**

To receive a passing score, the candidate must complete the JTA in a time of **7 minutes, 57 seconds or less.**



## **MIAMI-DADE PUBLIC SAFETY TRAINING INSTITUTE**

### **PRE-ACADEMY JOB-RELATED TASK ASSESSMENT**

### **INFORMATION**

#### **Scheduling**

- All JTA appointment dates and times are scheduled only to qualified police officer applicants by the Personnel Management Bureau
- The JTA is only administered at the Miami-Dade Public Safety Training Institute (MDPSTI) located at 9601 NW 58 Street, Doral, Florida 33178 (See map on page 7)
- The JTA is administered by appointments only

#### **Reporting Information**

When reporting for the JTA, you MUST report 15 minutes prior to the scheduled time in appropriate exercise attire. The west side entrance of the MDPSTI is on NW 97 Avenue which is indicated as #1 on the map. The test will be administered in the area designated as #4 on the map.

You MUST bring the following items:

- The attached Physician's Medical Consent Form (completed and signed by a Physician)
- JTA Data Sheet
- Government Issued Picture ID (i.e. Driver's License, Passport, Military ID, etc.)
- Receipt of payment from the MDPSTI Basic Training Section

*Note: Candidates will not be allowed to participate in the JTA without the aforementioned items.*

#### **No Exceptions.**

#### **Scoring**

The minimum standard for a passing score is 7 minutes, 57 seconds (7:57) and will be provided to candidates immediately following the test.

#### **Fees**

The cost of the JTA is \$45. All JTA fees are non-refundable and non-transferable.

#### **Contact Information**

- For more information on the JTA, please contact [PMBinfo@mdpd.com](mailto:PMBinfo@mdpd.com)



## MIAMI-DADE PUBLIC SAFETY TRAINING INSTITUTE

### JOB-RELATED TASK ASSESSMENT

### PAYMENT FORM

**Payments are made on-site by Money Order only. Cash will not be accepted. Money Orders are made payable to the Miami-Dade Police Department.**

#### **Instructions:**

- Submit completed forms on **THE DAY OF YOUR TEST.**
- **Do not respond to MDPSTI before your exam.**
- Location: MDPSTI, 9601 NW 58 Street, Doral, Florida
- Enter at NW 97 Avenue (#1 on the map)

#### **Candidate Information**

Name: \_\_\_\_\_

Date: \_\_\_\_\_ (mm/dd/yy)

Last four of SSN: \_\_\_\_\_

#### **Payment Information**

I, \_\_\_\_\_, understand the following:

- The JTA fee (\$45) must be on-site the day of the scheduled appointment JTA
- Payments may be made in money order only
- All fees are **non-refundable and non-transferable**

Candidate Signature: \_\_\_\_\_

Cashier: \_\_\_\_\_  
(Print: Rank, Last name, First) (Signature)

Payment Receipt #: \_\_\_\_\_



# Miami-Dade Police Department Job-Related Task Assessment

## Pre-participation Physical Evaluation Form

### Part 1. Candidate Information.

Candidate Name: \_\_\_\_\_ Sex: M / F Age: \_\_\_\_ DOB: \_\_\_\_ / \_\_\_\_ / \_\_\_\_

Home Address: \_\_\_\_\_ Home Phone: ( ) \_\_\_\_\_  
Street address Apt. City State Zip

Candidate Driver License: State: \_\_\_\_\_ DL Number: \_\_\_\_\_

Emergency Contact Name: \_\_\_\_\_ Telephone: ( ) \_\_\_\_\_

### MIAMI-DADE PUBLIC SAFETY TRAINING INSTITUTE JOB-RELATED TASK ASSESSMENT INTRODUCTION

The Job-Related Task Assessment (JTA) you will be taking is comprised of numerous obstacles that an officer may encounter within the course of duties. These obstacles will be conducted in a continuous manner and may challenge your physical strength and endurance, balance, flexibility, agility, and cardiovascular fitness. The JTA requires a maximum effort and pacing yourself will be important for the successful completion of the test. The time it takes to complete the test will be recorded as your test effort. To receive a passing score, you must complete the JTA in a time of 6 minutes, 57 seconds or less.

The JTA measures specific physical abilities through participation in a series of tasks which are listed as follows:

- |   |  |
|---|--|
| -Sprinting                              | -Crawling under and through a 3'x5' enclosure  |
| -150 lbs. Dummy Rescue Drag for 50 feet | -Simulated controlling of a struggling subject |
| -Jumping over a 4-foot wall             | -Climbing up and over a 12-foot ladder         |
| -Walking/running across a balance beam  | -180 lbs. sled push and pull                   |
| -Climbing through a window              | -Changing directions rapidly while running     |
| -Jumping over hurdles as high as 2 feet | -Running up and down stairs                    |

### Part 2. Physical Examination (to be completed by physician).

Patient Name: \_\_\_\_\_ Sex: M / F Age: \_\_\_\_ DOB: \_\_\_\_ / \_\_\_\_ / \_\_\_\_

Height: \_\_\_\_ Weight: \_\_\_\_ Pulse: \_\_\_\_ Blood Pressure: \_\_\_\_ / \_\_\_\_ ( / ), ( / )

Assessment of Examining Physician

Physician Initials

Patient is cleared to participate in the Job-Related Task Assessment \_\_\_\_\_

Patient is **NOT** cleared to participate in the Job-Related Task Assessment \_\_\_\_\_

Name of Physician (print or type) \_\_\_\_\_ Date: \_\_\_\_ / \_\_\_\_ / \_\_\_\_

Business address: \_\_\_\_\_ Phone: ( ) \_\_\_\_\_  
Street address Apt. City State Zip

**Physician  
Office Stamp**

For questions, please contact the Miami-Dade Police Department Personnel Management Bureau.  
9105 Northwest 25 Street  
Doral, Florida 33172  
305-471-1945  
[pmbinfo@mdpd.com](mailto:pmbinfo@mdpd.com)



**Miami-Dade Police Department  
Job-Related Task Assessment**

**Job-Related Task Assessment  
Testing Data Sheet**

Test Date: \_\_\_\_ / \_\_\_\_ / \_\_\_\_

**Part 1. Candidate Information.**

Candidate Name: \_\_\_\_\_ Sex: M / F Age: \_\_\_\_ DOB: \_\_\_\_ / \_\_\_\_ / \_\_\_\_

Home Address: \_\_\_\_\_ Home Phone: (\_\_\_\_) \_\_\_\_\_  
Street address Apt. City State Zip

Candidate Driver License: State: \_\_\_\_\_ DL Number: \_\_\_\_\_

Emergency Contact Name: \_\_\_\_\_ Telephone: (\_\_\_\_) \_\_\_\_\_

**Part 2. MDPSTI&RC Assessor.**

JTA Evaluation (circle):      PASS                      FAIL                      DISQUALIFIED

JTA Test Score: \_\_\_\_ :

**MDPSTI&RC Assessor Comments and Observations**

---

---

---

---

---

---

---

Timer Name:  
(PRINT ONLY)

Rank / Last-First Name

Scribe Name:  
(PRINT ONLY)

Rank / Last-First Name

Signature

JTA Testing  
Supervisor:  
(PRINT ONLY)

Rank / Last-First Name

Signature



**MIAMI-DADE POLICE DEPARTMENT JOB-RELATED TASK ASSESSMENT  
LIABILITY WAIVER AND HOLD HARMLESS AGREEMENT**

I, \_\_\_\_\_, being eighteen years of age or older, hereby acknowledge that my participation in the Job-Related Task Assessment (JTA) may result in being exposed to danger of physical harm, personal injury, or death. The JTA incorporates varying obstacles and events with degrees of physical effort associated with law enforcement. These obstacles and events require stamina, bursts of short-term effort, muscular strength, muscular endurance, and flexibility. Injuries may result from activities such as running, jumping, climbing, crawling, and lifting, pulling, or pushing heavy objects. I agree to obey all instructions, orders, and commands given to me by the officer or officers in command of the JTA.

I, my heirs, successors, and assignees agree to hold Miami-Dade County, its Board of County Commissioners, its employees, agents, independent contractors, and servants harmless from all liability for property damage, physical harm, personal injury, or death arising out of my participation in the JTA or instruction provided to me. I further agree to waive all rights or claims to damages, legal or equitable, arising out of any intentional or negligent acts or omissions by me, or any officer, employee, official, independent contractor, or agent of Miami-Dade County, or a from a malfunction of any equipment used during the JTA.

\_\_\_\_\_  
Participant (print)

\_\_\_\_\_  
Date of Birth

\_\_\_\_\_  
Signature

\_\_\_\_\_  
Date



## **MIAMI-DADE PUBLIC SAFETY TRAINING INSTITUTE**

### **JOB-RELATED TASK ASSESSMENT**

### **PROHIBITED ACTIVITIES**

Applicants are prohibited from:

- Wearing headphones, ear buds or any other listening or communication device that has the potential to obstruct audible instructions
- Carrying any device that projects sound during the JTA
- Wearing of any body worn camera/recording system
- Recording video or taking photographs of themselves or any other applicant at the MDPSTI
- Asking anyone to record video or take photographs of themselves or any other applicant at the MDPSTI
- Having any family members, friends, associates, etc. accompany them to or meeting them at the MDPSTI (this includes all MDC employees)
- Wearing any article of clothing, device, or equipment that offers any potential for an unfair advantage during testing (i.e. weight lifting gloves, wrist wraps, back braces, etc.)
- Pacing, running alongside of or cheering on another applicant

Any violations of the aforementioned prohibited activities will result in applicant self eliminating.

For more additional information on prohibited activities, please contact [PMBinfo@mdpd.com](mailto:PMBinfo@mdpd.com).



## MIAMI-DADE PUBLIC SAFETY TRAINING INSTITUTE MAP

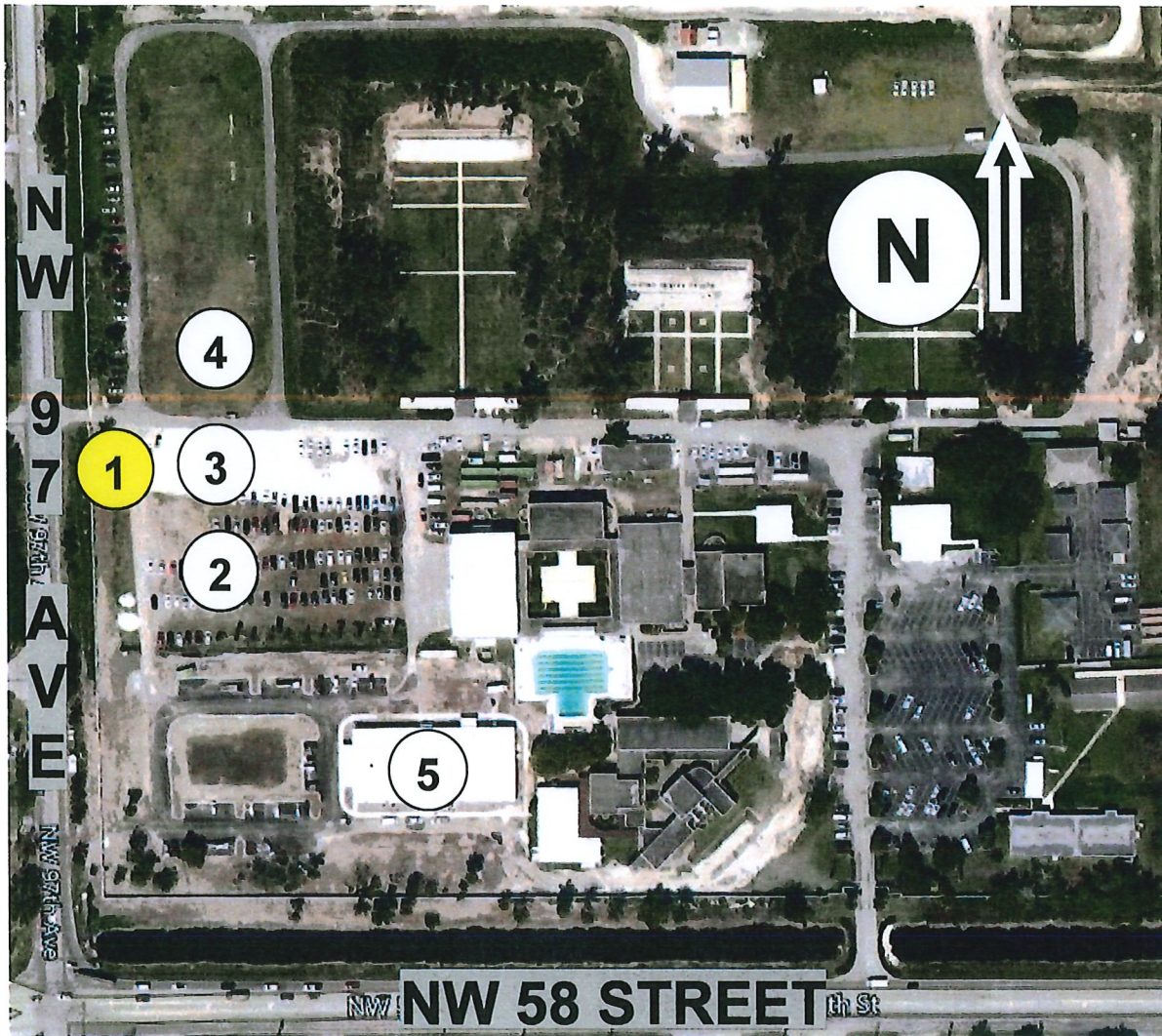

1. JTA Entrance

2. JTA Applicant Parking

3. Applicant Holding Area

4. JTA Obstacle Course

5. 1000 Building Bathrooms



West Union MONEY ORDER

**FUBLIX #0845**

19-034900431

A 324784 D 050120  
1504 00  
190849004317 L 000445 \$ **35.00**

PAY EXACTLY THIRTY-FIVE DOLLARS AND NO CENTS

PAY TO THE ORDER OF **Miami Dade Police Department**

DATE **5/2/20**

NAME + Address

1021004001 40190849004317

Sign your name

UNITED STATES POSTAL SERVICE

Serial Number **26675826322**

Postage **\$35.00**

Pay to **Miami Dade**

Address **9601 NW 13th St**

City **Miami**

State **FL**

Zip **33157**

H7

000000800

Complete Requested Information

THE BACK OF THIS DOCUMENT CONTAINS AN "AMSCOT" ARTIFICIAL WATERMARK - HOLD AT AN ANGLE

**AMSCOT** INTERNATIONAL MONEY ORDER

The Money Superstore

88-490 1031 **2208709652**

H7 **Miami Dade Police Department** **05/01/2020**

AMSCOT CORPORATION  
P.O. BOX 28107  
TAMPA, FL 33622-0107

PURCHASER **[Redacted]** **\$35.00**

THIRTY-FIVE AND 00/100 DOLLARS

NOT VALID FOR MORE THAN ONE THOUSAND FIVE HUNDRED DOLLARS (\$1500)

**AMSCOT CORPORATION**

PURCHASER AND PAYEE ARE SUBJECT TO THE SERVICE CHARGE AND OTHER TERMS ON THE REVERSE SIDE

THE FACE OF THIS DOCUMENT HAS A COLORED BACKGROUND ON WHITE PAPER

1031049001 4297 2208709652

Print your name

Sign your name