



Technical Specifications – MAIN STAGE THEATRE

LOCATION:

The Dennis C. Moss Cultural Arts Center is located in the town of Cutler Bay

10950 Southwest 211th Street
Cutler Bay, Florida 33189

For directions, please visit [https://The Moss Center.org/content/plan-your-visit](https://TheMossCenter.org/content/plan-your-visit)

Main Office- 786-573-5316

Box Office- 786-573-5300

Fax- 786-573-5330

STAFF:

Managing Director- Eric Fliss – Eric.Fliss@miamidade.gov

Assistant Theater Director, Production Manager- Joyce Fleming – Joyce.Fleming@miamidade.gov

Assistant Production Manager- David Solomon

Office Manager- Vanessa Moreira – Vanessa.Turnes@miamidade.gov

Box Office Manager- Paula Parra - Paula.Parra@miamidade.gov

Front of House Manager- Stephanie Aponte - Stephanie.Aponte@miamidade.gov

Front of House Manager- Thomas Cavanaugh - Thomas.Cavanaugh@miamidade.gov

Building Maintenance Manager- Sixto Tamarit - Sixto.Tamarit@miamidade.gov

Safety Security Supervisor – Juan Villegas - Juan.Villegas@miamidade.gov

Marketing Manager- Nicolle Ugarriza – Nicole.Ugarriza@miamidade.gov

Food & Beverage Manager- Jesse Royer - Jesse.Royer@miamidade.gov

OVERVIEW:

The Main Stage Theater is a proscenium theatre with a single-purchase rigging system. Downstage of the plaster line is an apron as well as an adjustable Orchestra Pit lift. The Orchestra Pit can be set at stage level, at audience level for additional seating (standard), a lower position for a small pit position, or at the basement level when use of the full orchestra pit is necessary. Permanently installed orchestra shell ceilings utilize 4-line sets; the locations of which are indicated on the line set schedule on pages 7 and 8. Access from backstage to Front-of-House Lobby and Audience Seating is through doors downstage left and right. The sprung dance floor construction is topped with 2 sheets of ¾" plywood and is covered with Masonite.

THEATER TYPE:

Proscenium with adjustable hard portal border & hard legs (to resize proscenium opening)

MAIN CURTAIN:

Guillotine style with a center split, allowing for performers/speakers to be paged through onto the apron.

LOAD IN / LOADING DOCK:

The loading dock is located on the west side of the building

The loading dock consists of two side by side dock height loading bays 10' X 12', each equipped with electric dock levelers, and lights to illuminate into trailers/trucks. The loading bays open to the 80' x 60' Scene Shop / Loading Area which is located directly stage left, 44' from stage.



A 1 ton stacking motor is available 10' on the left of Bay #1, inside the loading dock.
Shore power is available within 50'.

BUILDING ENTRY / DELIVERIES / CHECKING -IN:

The main point of entry to our building is through our Backstage entrance. Once parked please proceed around the back of the theater (towards canal). Our backstage door has a canopy above it that reads "BACKSTAGE".

STAGE:

The stage is a sprung floor built on rubber sleepers, 2x ¾" layers of plywood topped with a black Masonite surface. ****Please note that screwing or drilling into the floor may incur additional charges.*

Access to the Stage from Dressing Rooms is through doors located upstage left & right; loading access to the stage is through two double-wide doors from the Scene Shop / Loading Area.

STAGE DIMENSIONS:

Height of proscenium opening: 34'-0" adjustable w/ hard portal border.

Width of proscenium opening: 51'-10-3/4" adjustable w/ hard portal legs.

Width of hard portal legs: 42' unless otherwise requested.

Width of entire Stage 77'-0"

Proscenium edge to Stage Right: 10'-0"

Proscenium edge to Stage Left: 15'-0"

Distance from Downstage edge (curved) to Plaster line 5'-2 1/8"

Distance from Downstage edge (curved) to back wall: 50'-11"

Distance from Plaster line to last line set: 39'-0"

Distance from Plaster line to back wall: 52'-4"

Stage floor to Fly floor, rear catwalk/ Pin rail platform: 41'-6"

Stage Floor to loading bridge: 74'-6"

Stage Floor to gridiron: 80'-4"

Stage Floor to rigging beam: 87'-4- 3/8"

Please note that the fire curtain plane must always be kept completely clear of all objects. There can be no obstructions of any kind preventing the fire curtain from lowering all the way to the stage floor. Any concerns about this must be discussed with the Production Manager.

ORCHESTRA PIT:

The adjustable height orchestra pit is a Gala Systems mechanical lift which can be positioned at any point from stage level to basement level. In its standard configuration, it is positioned at audience level with 36 reservable seats located on it (comprising rows AA & BB).

The Pit Lift is trapezoidal, with measurements of 11'-2" deep, 32'-9 1/4" wide upstage and 30'-2 1/4" wide downstage.

When the pit is at the basement level, there is additional space under stage which can be utilized for an expanded pit position. The total area (including the orchestra pit lift) is 50' wide x 18' deep x 8'-10" high. This is accessible on stage right by stairs or a small freight elevator, or on stage left by stairs.

GROUND PLAN:

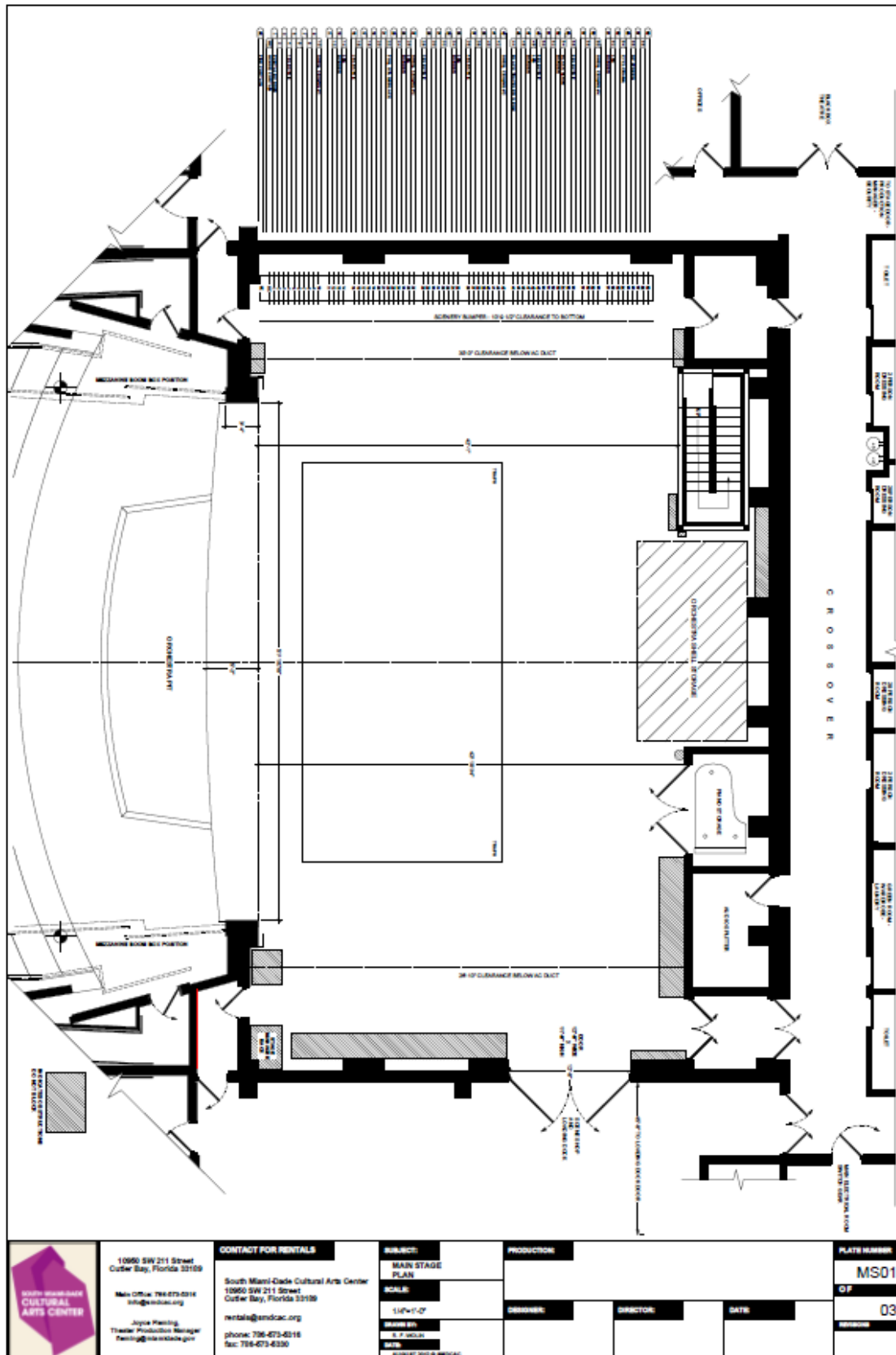

THEATER SECTION:

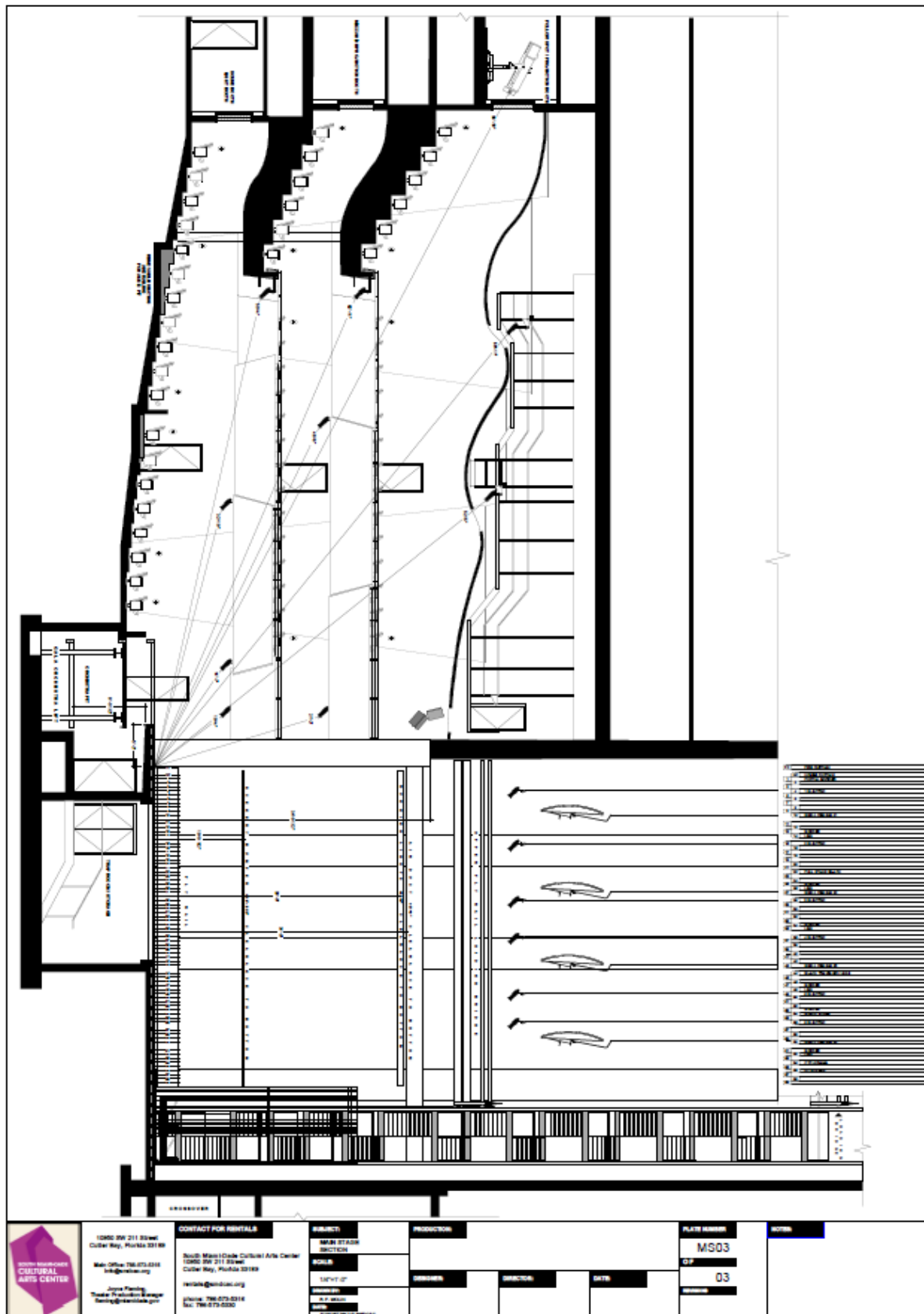

FLY SYSTEM/ RIGGING:

Counterweight system:

69- single purchase manual counterweight sets, with lines and arbors located stage right, along with upper and lower continuous lock rails and associated index strip lights which allow for operations from stage level or fly floor. Stage right can also serve as a mid-level loading rail.

69- 1.5" Schedule 80 pipe battens 60'-0" length

All arbors capable of 1600#

60,000 pounds of steel counterweights

Pin Rail system:

The pin rail runs on both sides of the stage at 41'-6" above the deck

01-Capstan winch- 1000#, 20 FPM, with footswitch, with 90' ¾" rope

Grid construction is of steel slats, and points can be created utilizing 6" diameter x 3' long schedule-80 pipe sections

AVAILABLE SOFT GOODS:

The following soft goods hang on the main stage as per the house line set schedule below.

Please note: Re-hanging or re-positioning may result in additional labor charges and must be restored to house hang positions before the conclusion of the rental period/agreement.

Description	Quantity	Height	Width
Hard Portal border	1	20'	60'
Hard Portal legs	2	35'-6"	6'
Borders	7	15'	60'
Legs	14	36'	15'
Bi-part traveler	1	36'	60'
Cyclorama	1	30'	60'
Black sharks tooth scrim	1	28'	60'
Rosco Twin White Proj. screen	1	32'	60'

ADDITIONAL SOFT GOODS:

The following soft goods are generally found in storage. Use may result in additional labor charges and must be returned to storage.

Description	Quantity	Height	Width
White sharks tooth scrim	1	30'	60'
Tabs (side masking)	10	36'	8'
Oval Cut drop (painted grey)	1	30'	60' with a 22' h x 25' W irregular oval cut

LINESET SCHEDULE 1of 2:

The Dennis C. Moss Cultural Arts Center LINESET SCHEDULE						
Line	fr PL	delta	House Hang	Show Hang	Notes	Trim
FC	0' - 3"	-	Fire Curtain		<i>motorized</i>	
HC	1' - 0"	9"	House Curtain		59' W x 36' H	60'-0"
1	1' - 6"	6"	Portal Border		67'- 6" W x 20' - 0" H	42'-3"
2	2' - 0"	6"	Portal Legs		6'- 0" W x 35' - 6" H	35'-9"
3	2' - 6"	6"				
4	3' - 0"	6"	1 ELECTRIC			24'-0"
5	3' - 6"	6"				
6	4' - 0"	6"				
7	4' - 6"	6"				
8	5' - 0"	6"				
9	5' - 6"	6"	PROJECTOR (if used)			
10	6' - 0"	6"	Shell Ceiling #1			
EMPTY SPACE- TO ALLOW SHELL TO FLY						
11	7' - 0"	12"	DEAD IF PROJ. USED			
12	7' - 6"	6"				
13	8' - 0"	6"	BORDER		60'- 0" W x 15' - 0" H	37'-8"
14	8' - 6"	6"	LEGS		15'-0"W x 35-6" H	35'-8"
EMPTY SPACE-NO HANG PIPE						
15	9' - 6"	12"	2 ELECTRIC			24'-0"
16	10' - 0"	6"				
17	10' - 6"	6"				
18	11' - 0"	6"	DS MOVERS (5)			25'-6"
19	11' - 6"	6"				
20	12' - 0"	6"				
21	12' - 6"	6"				
22	13' - 0"	6"	FULL STAGE BLACK		45'-0"W x 35'-6" H	35'-6"
23	13' - 6"	6"				
24	14' - 0"	6"	<i>RP Seasonal Position</i>			
25	14' - 6"	6"	BORDER		60'- 0" W x 15' - 0" H	38'-0"
26	15' - 0"	6"	LEGS		15'-0"W x 35-6" H	35'-6"
27	15' - 6"	6"	Shell Ceiling #2			
EMPTY SPACE- TO ALLOW SHELL TO FLY						
28	16' - 6"	12"	3 ELECTRIC			24'-0"
29	17' - 0"	6"				
30	17' - 6"	6"				
31	18' - 0"	6"				
32	18' - 6'	6"				
33	19' - 0"	6"				
34	19' - 6"	6"	BORDER		60'- 0" W x 15' - 0" H	38'-0"

LINESET SCHEDULE 2 of 2:

The Dennis C. Moss Cultural Arts Center LINESET SCHEDULE						
fr PL	Line	delta	House Hang	Show Hang	Notes	Trim
35	20' - 0"	6"	Black Legs		15'-0"W x 35-6" H	35'-6"
EMPTY SPACE-NO HANG PIPE						
36	21' - 0"	12"	4 ELECTRIC			24'-0"
37	21' - 6"	6"				
38	22' - 0"	6"				
39	22' - 6"	6"				
40	23' - 0"	6"				
41	23' - 6"	6"	US MOVERS (5)			26'-0"
42	24' - 0"	6"				
43	24' - 6"	6"	Shell Ceiling #3			
EMPTY SPACE- TO ALLOW SHELL TO FLY						
44	25' - 6"	12"	BLACK TRAVELLER / LEGS		60'- 0" W x 30' - 0" H	
45	26' - 0"	6"				
46	26' - 6"	6"	BORDER		60'- 0" W x 15' - 0" H	39'-0"
47	27' - 0"	6"	LEGS		15'-0"W x 35-6" H	35'-6"
48	27' - 6"	6"				
49	28' - 0"	6"	5 ELECTRIC			24'-0"
50	28' - 6"	6"				
51	29' - 0"	6"				
52	29' - 6"	6"	flies between ceiling #3 & #4 when orchestral ceiling is deployed			
53	30' - 0"	6"	BORDER		60'- 0" W x 15' - 0" H	39'-0"
54	30' - 6"	6"	BLACK SCRIM		60'- 0" W x 28' - 0" H	
55	31' - 0"	6"				
56	31' - 6"	6"				29'-6"
EMPTY SPACE-NO HANG PIPE						
57	32' - 6"	12"	BORDER		60'- 0" W x 15' - 0" H	
58	33' - 0"	6"				
59	33' - 6"	6"	6 ELECTRIC - CYC LIGHTS			
60	34' - 0"	6"	Shell Ceiling #4			
EMPTY SPACE- TO ALLOW SHELL TO FLY						
61	35' - 0"	12"	BORDER		60'- 0" W x 15' - 0" H	39'-0"
62	35' - 6"	6"	LEGS		15'-0"W x 35-6" H	35'-6"
63	36' - 0"	6"				
64	36' - 6"	6"	CYCLORAMA		60' W x 30' H	30'-0"
65	37' - 0"	6"				
66	37' - 6"	6"	RP SCREEN		60' W x 36' H	36'-0"
67	38' - 0"	6"				
68	38' - 6"	6"	FULL STAGE BLACK		60' W x 35' 6" H	35'-6"
69	39" - 0"	6"	TRAVELLER TRACK STORAGE			

LIGHTING:

House Lighting Plot & Paperwork available as PDF on our rental page, [https://The Moss Center.org/venues/main-stage](https://TheMossCenter.org/venues/main-stage)

LIGHTING CONTROL:

Console: ETC Gio @5 w/ full backup

House Light control: Paradigm Architectural Control system

With touchscreens located Stage Left, Light Booth, and wired remote at the Lighting Console.

STAGE LIGHTING FIXTURE INVENTORY:

- 20- ETC Source4 10°
- 20- ETC Source4 14°
- 5- ETC LED Series 3, Lustr X8 - 14°
- 29- ETC Source4 19°
- 5- ETC LED Series 3, Lustr X8 - 19°
- 10- ETC Source4FWD (2nd shin in the Booms)
- 61- ETC Source4 26°
- 88- ETC Source4 36°
- 12- ETC Source4 15°-30° Zoom
- 14- ETC Source4 25°-50° Zoom
- 60- ETC Source4 PAR EA (MFL)
- 08- ETC Source4 PAR EA (WFL)

- 07- Altman 4-cell Sky Cyc Units
- 17- Chauvet LED Batten 144 strip lights
- 04- Altman Q-LITE Halogen Floodlight

- 34- ETC Desire Lustre+ LED wash fixtures w/45° field diffuser

MOVING LIGHTS:

- 12- Robin DLS profile (*rental fees & additional labor hours apply*)

FOLLOW SPOTS:

- 2- Lycian 1290- 2000w Xenon Long Throw Followspots (*rental fees & additional labor apply*)

LIGHTING FIXTURE ACCESSORIES:

20- Source4 PAR; Extra Wide Flood Lens
69- Source4 PAR; Wide Flood Lens
09- Source4 PAR; Medium Flood Lens
94- Source4 PAR; Narrow Spot Lens
92- Source4 PAR; Very Narrow Spot Lens
20- A-Size Source4 Template Holder
10- B-Size Source4 Template Holders
06- A-Size Source4 Glass Gobo Holders
06- B-Size Source4 Glass Gobo Holders
20- Donut for Source4
09- Drop-In for Source4
03- EDLT 19° Source4 Lens tubes
03- EDLT 36° Source4 Lens tubes
10- 6.25" Half Top Hat
20- 6.25" Top Hat
20- 7.5" Top Hat
23- 12" Top Hat
20- Barndoor for Source4 PARs

SPECIAL EFFECTS:

02- UltraTec Touring Hazer with fan (*rental fees apply*)
02- UltraTec Stage Fogger with pipe hangers and fan (*rental fees apply*)

CUE LIGHT SYSTEM:

Paradigm – Control console located in the stage left rack. Cue lights on SR Fly rail, FOH lighting position, and SL Boom

POWER DISTRO (IF AVAILABLE):

01- Lex 100-amp 3 Phase distro panel
04- Lex Products 20-amp 3 Phase GFCI Quad Stringer
04- 50' extensions
01- Lex products 20-amp 3 Phase GFCI Gang Box

LIGHTING HARDWARE:

10- 12' tall Boom trusses 6 Units each - See Plot (hung with 5x 36° Source4 fixtures for shins, mids, and highs & 1x 26° Source4 fixture at top)

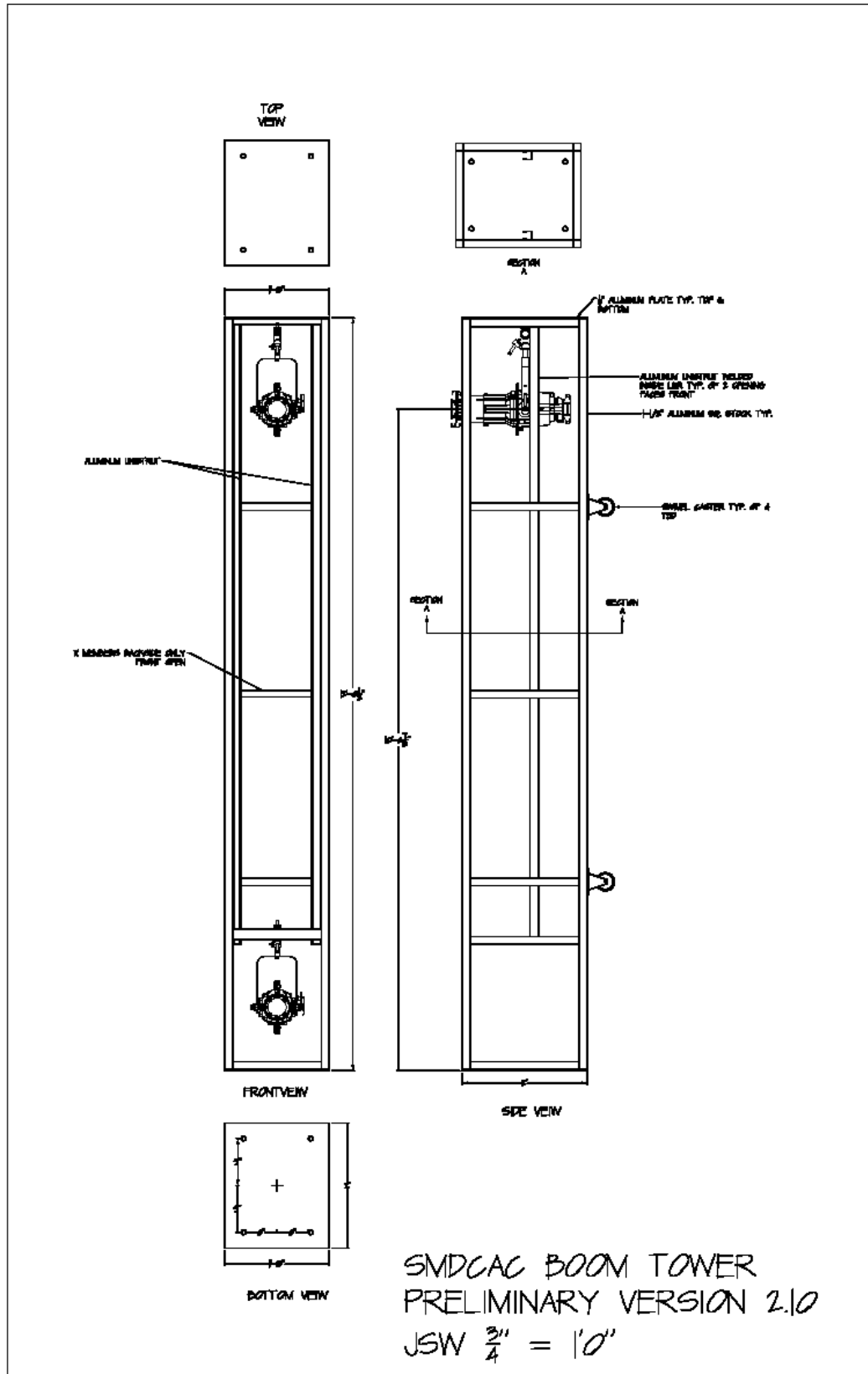

STAGE EQUIPMENT:

01- 30'- Aerial Work Platform, push around (Brand, Genie)

01- 40'- Aerial Work Platform, push around (Brand; Genie) Battery operated, with built in 110-volt charger included; outriggers included.

01-10'- Fiberglass A frame ladder

02-8'- Fiberglass A frame ladder

01-6'- Fiberglass A frame ladder

DANCE FLOORS: (rental fees apply)

60' wide x 30' deep; Full stage Rosco dance floor; two sided (Black/Grey)

60' wide x 30' deep; Full stage Rosco dance floor; (White)

CHAIRS/STOOLS: (rental fees apply)

08-30" stools, espresso brown

02-30" stools, natural finish

04-30" stools, painted black

04-24" stools, natural finish

04-24" stools, painted black

12-straight back café chairs, cherry brown finish

4-straight back, black chairs

ORCHESTRA SHELL:

Wenger Diva concert shell including adjustable 9 tower side walls, 4 ceiling pieces with integrated downlight system.

ORCHESTRA EQUIPMENT (WENGER): (rental fees apply)

100- Black padded 17.5" orchestra chairs

10- Black padded cello 18.5" orchestra chairs

100- Music stands

110- Music stand lights

01- Conductors platform

01- Conductors music stand

01- Conductors stool

ELECTRICAL

COMPANY SWITCHES:

Please note: Additional electrical charges may apply.

Upstage Left back wall:

01- 100amp 3 phase panel, w/ cam-loc connections

Upstage Right back wall:

01- 100amp 3 phase panels, w/ cam-loc connections

Upstage Left:

03- 400amp 3 phase panels, w/ cam-loc connections

Downstage Left:

01- 100amp 3 phase panels, w/ cam-loc connections

01- 100amp 3 phase panels, w/ cam-loc connections ground isolated for audio usage

SHORE POWER:

Loading Dock, 10' from loading bays:

01- 400amp 3 phase panels, w/ cam-loc connections

01- 100amp 3 phase panel, w/ cam-loc connections

01- 200amp 3 phase panel, w/ cam-loc connections

Outdoors, East side adjacent to plaza area:

01- 200amp 3 phase panel, w/ cam-loc connections

04- 20amp circuits

AUDIO:

The Dennis C. Moss Cultural Arts Center in Miami is equipped with separate Sound and Communication (S&C) systems serving the house, stage areas, backstage areas, dressing rooms and lounges, control rooms, broadcast position (receiving/loading dock area), production offices and public areas.

Sound Pressure Levels:

Sound engineers are responsible for maintaining sound level limits for the safety and enjoyment of patrons. The maximum sound level allowance is **95dbA**.

Performance Loudspeaker Systems:

The house is served by a primary center d&b audiotechnik loudspeaker array and primary loudspeakers placed at the left and right sides of the proscenium. This is supplemented by EAW near-fill loudspeakers concealed in the stage edge and pit lift, along with recessed ceiling loudspeakers at the sides and deep under balcony seating areas. There are also side-fill and d&b audiotechnik subwoofer loudspeakers located to either side of the proscenium.

Dedicated programmable digital loudspeaker signal processors providing equalization, time delay, phase, and gain adjustment are provided for all permanent and portable loudspeaker systems. These processors are in the Sound Booth. Adjustment of the entire loudspeaker system is possible via notebook computer.

Center Cluster: 08- d&b audiotechnik Ti10L loudspeakers & 02- d&b audiotechnik TiSUB subwoofers

Left and Right: 06- Qi7 loudspeakers & 06-EAW UB12 (Orchestra, Mezzanine and Balcony levels)

Sub: 02- d&b audiotechnik J-Sub Subwoofer (Orchestra level Only)

Under Balcony: 15-Tannoy CMS50 ICT

Stage Monitors: (rental fees apply)

08- d&b audiotechnik M4 floor monitors

04- d&b audiotechnik E8 front fill or dance side fills

02- d&b audiotechnik Side fill Q7/Qsub combo

House Sound Console:

Digico X-Q225 pulse control surface, 4 AES/EBU outputs, 48 - 32-bit A to D mic pre inputs

Control Positions:

There are two sound reinforcement control positions in the main stage theater:

1-Sound Control Room (There is a 4' x 4' window which opens).

2-Audio Pit- Mix Position 14' w x 5'8" or 8'7" deep, 56' from D.S. Center. This option requires removal of audience seating, and will increase labor costs, as well as reduce seating by 35 seats.

Performance Loudspeaker System Optimization Processing Components continued:

8-input by 8-output loudspeaker processor providing digital delay, crossover filters, parametric equalization and limiting with balanced analog inputs and outputs. Signal routing and processing functions are addressed via the front panel controls or RS-232 interface. BSS Soundweb software; 04- BSS 9088

Programmable Loudspeaker Controller Interface (LC-1):

R-1 d&b loudspeaker remote for control of DSP-1 digital system processors at equipment rack in Sound Control Room.

1-BSS 9010

AUDIO continued...

Microphones, DI's, and Accessories:

08-Shure SM 58
02- Shure Beta SM 58
10- Shure SM 57
01-Shure SM87
04-Sennheiser E835
03-Sennheiser E 604
02-Shure KSM 137
01-Shure Beta SM 91
01-Shure Beta SM 52A
04-Sennheiser MD 421-II
02-Shure KSM 137
02-Shure 141 (stereo matched pair)
02-Shure KSM 32
04-Audix SCX-1 CMP (2 stereo matched pairs)
12- ShureMX202B/C Microflex overhead microphones
02-AKG 414 XLS (stereo matched pair)
05-Crown PCC 160
02-AKG CGN 99 C/L podium mic
01-RTA 420

02-DPA d:vote 4099P stereo microphone system
02-DPA 4099-DC CORE Loud SPL for Piano (stereo matched pair)
02-DPA 4099-DC- 2 199T Load SPL

04-DPA d:fine dual ear Omni 4066 (beige) w/DAD 6010
09-DPA d:fine 4266 (beige) w/DAD 6010
04-DPA d:fine 4266 (brown) w/DAD 6010

02- Radial JDI Duplex stereo direct boxes
02- Radial Pro D2 stereo direct boxes
02- Radial Pro48 active direct boxes
04- Radial Pro Di passive direct boxes

Wireless Microphones: (rental fees apply)

02-ShureULXD4QJ50 band 7=572-636Mhz
08- SM58 handheld transmitters
08- Body pack transmitters
08- Sennheiser ME104 condenser clip-on cardioid microphones, 08-Instrument cables

AUDIO PROGRAM MONITOR /PAGING SYSTEM:

The audio program monitor/paging system is an integrated public address system which feeds loudspeakers distributed throughout the technical backstage area, control and equipment rooms, dressing rooms, lounges, offices, and other support locations. Many areas, such as dressing rooms, offices, and other technical areas are provided with local wall mounted volume controls.

VIDEO PROJECTION: (rental fees apply)

The video projection system is a semi-fixed system capable of projecting on our full stage screen which hangs at the rear of the stage on lineset #67.

Alterations to the projector, or screen position may incur additional labor charges.

Projectors:

02-Barco R9010134 – G100 W22 TA WW Projectors

02-Barco R9802300 G Lens (0.65-01.75:1)

02-Barco R98021851 GC+ Lens (2.0-4.0:1)

02-Rigtec Airframe AF02-X40- Barco G100 edition w/ AG02-H Atom grip clamps

Processors:

Barco R9029610BF S3

02-S3 VPU cards

01-4K60 Tri-Combo Input Card

02-4K60 Tri-Combo output cards

Accessories:

04-Extron Electronics 60-1869-53 4K/60 HDMI DTP3 Receiver with Audio De-Embedding

04- Extron Electronics 60-1869-52 4K/60 HDMI DTP3 Transmitter w/input loop-through & Audio embedding

PRODUCTION STAGE INTERCOM:

A four-channel production intercom system is provided with receptacles serving the stage, backstage areas, audience area, control and equipment rooms and technical offices.

10- Wireless dual channel belt packs

10- Wired single channel belt packs

04- Wired dual channel belt packs

10- Single muff- Headsets

02- Ultra light- Headsets

Paging and program sound are available to all dressing rooms and backstage areas. Paging position is at SL Stage Manager's Console, or from the FOH booth position.

DRESSING ROOMS

All dressing rooms are located upstage of the stage house on the same ground floor. All dressing rooms are located on stage level. All are equipped with mirrors, chairs, lights, counters and/or tables, and clothes racks. See Backstage Dressing Room Hallway drawing for locations and details.

02- Principal Dressing Rooms (10' x 10') with private bathrooms and showers can accommodate 1-3 people per room at make-up mirrors.

02- Chorus Dressing Rooms with private bathrooms and showers; can accommodate up to 30 people per room at make-up mirrors.

GREEN ROOM/ WARDROBE/LAUNDRY ROOM:

Please note: We do not provide laundry detergent or dryer supplies

Hospitality equipment – tables and chairs for up to 30 people

Refrigerator, Microwave, Sink, Coffee machine, Tea pot

02-washers

02-dryers

01- Jiffy 4000 steamer

02 -irons and ironing boards

10 -heavy duty Z type rolling wardrobe racks

WI-FI:

There is free and open Miami Dade County Wi-Fi throughout the building.

PHONES:

On request- Dressing rooms may be equipped with a phone for local dialing only.

PARKING:

On non-performance dates, parking for meetings is available in the East lot, next to the theater.

NEARBY HOTELS:

La Quinta Inns & Suites Cutler Bay (walking distance)

10821 Caribbean Blvd.

Miami, FL 33016

1-800-531-5900

www.lq.com

Hampton Inn & Suites- Miami South Homestead

2285 NE 9th Street

Homestead, FL 33033

305-257-7000

305-257-7200 fax

[HSTFL Hampton Suites@hilton.com](mailto:HSTFL_Hampton_Suites@hilton.com)

Use client ID# 0002735310 to receive a specially negotiated rate