



MIAMI-DADE COUNTY, FLORIDA  
STEPHEN P. CLARK GOVERNMENT CENTER  
Department of Regulatory and Economic Resources  
Board and Code Administration Division  
111 N.W. 1 Street • Room 1251  
MIAMI, FLORIDA 33128  
(786) 315-2509 FAX (786) 315-2560

[www.miamidade.gov/global/economy/board-and-code](http://www.miamidade.gov/global/economy/board-and-code)

## **ADVISORY MEMO**

**TO:** All Building Officials in Miami-Dade County

**FROM:**   
Jaime D. Gascon, P.E., Division Director  
Board and Code Administration Division

**DATE:** June 2, 2026

**SUBJECT:** Standard Wood Fence Detail with Horizontal Planks/Boards  
for Use as Swimming Pool Barriers

---

At their meeting of May 14<sup>th</sup>, 2026, the Miami-Dade County Board of Rules and Appeals (BORA) accepted the attached detail for *Standard Wood Fence with Horizontal Planks/Boards* for use throughout Miami Dade County. The Board approved the detail to reaffirm their BORA Interpretation from May 24<sup>th</sup>, 2017 – *Horizontal Pickets in a Swimming Pool Barrier*. They determined that the detail meets the Code of Miami-Dade County Sec. 33-12(g) for non-claimable pool barrier fence and complies with Section 454.2.17.1.4 of the 8<sup>th</sup> Edition (2023) Florida Building Code, Building, and Section R4501.17.1.4 of the 8<sup>th</sup> Edition (2023) Florida Building Code, Residential.

Should you have any questions, please contact Dexter Bleasdel, Senior Code Officer, Building, at (786) 315-2556 or Lundy Clarke, Chief Code Officer at (786) 315-2057.

Attachment

## STANDARD WOOD FENCE WITH HORIZONTAL PLANKS/BOARDS.

CODE: FBC 2023, 8th EDITION  
 6'-0" HIGH MAXIMUM HEIGHT

ADDRESS: \_\_\_\_\_

FENCE HEIGHT: \_\_\_\_\_ FT      FENCE LENGTH: \_\_\_\_\_ FT      DATE: \_\_\_\_\_

\*\*\*\*\* ADDITIONAL IMPORTANT INFORMATION FOR USE AS A POOL BARRIER \*\*\*\*\*

- OUTDOOR SWIMMING POOLS SHALL BE PROVIDED WITH A BARRIER COMPLYING WITH FLORIDA BUILDING CODE SECTIONS R4501.17.1.1 THROUGH R4501.17.1.14
- ACCESS GATES SHALL BE EQUIPPED WITH A SELF-CLOSING SELF-LATCHING LOCKING DEVICE LOCATED NO LESS THAN 54 INCHES FROM THE BOTTOM OF THE GATE. THE DEVICE RELEASE MECHANISM SHALL BE LOCATED ON THE POOL SIDE OF THE GATE AND SO PLACED THAT IT CANNOT BE REACHED BY A YOUNG CHILD OVER THE TOP OR THROUGH ANY OPENING OR GAP. GATES THAT PROVIDE ACCESS TO THE SWIMMING POOL MUST OPEN OUTWARD AWAY FROM THE POOL.
- THE TOP OF THE BARRIER SHALL BE AT LEAST 48 INCHES ABOVE GRADE MEASURED ON THE SIDE OF THE BARRIER WHICH FACES AWAY FROM THE SWIMMING POOL.
- THE MAXIMUM VERTICAL CLEARANCE BETWEEN GRADE AND THE BOTTOM OF THE BARRIER SHALL BE 2 INCHES MEASURED ON THE SIDE OF THE BARRIER WHICH FACES AWAY FROM THE SWIMMING POOL.
- THE BARRIER MAY NOT HAVE ANY GAPS, OPENINGS, INDENTATIONS, PROTRUSIONS, OR STRUCTURAL COMPONENTS THAT COULD ALLOW A YOUNG CHILD TO CRAWL UNDER, SQUEEZE THROUGH, OR CLIMB OVER THE BARRIER.

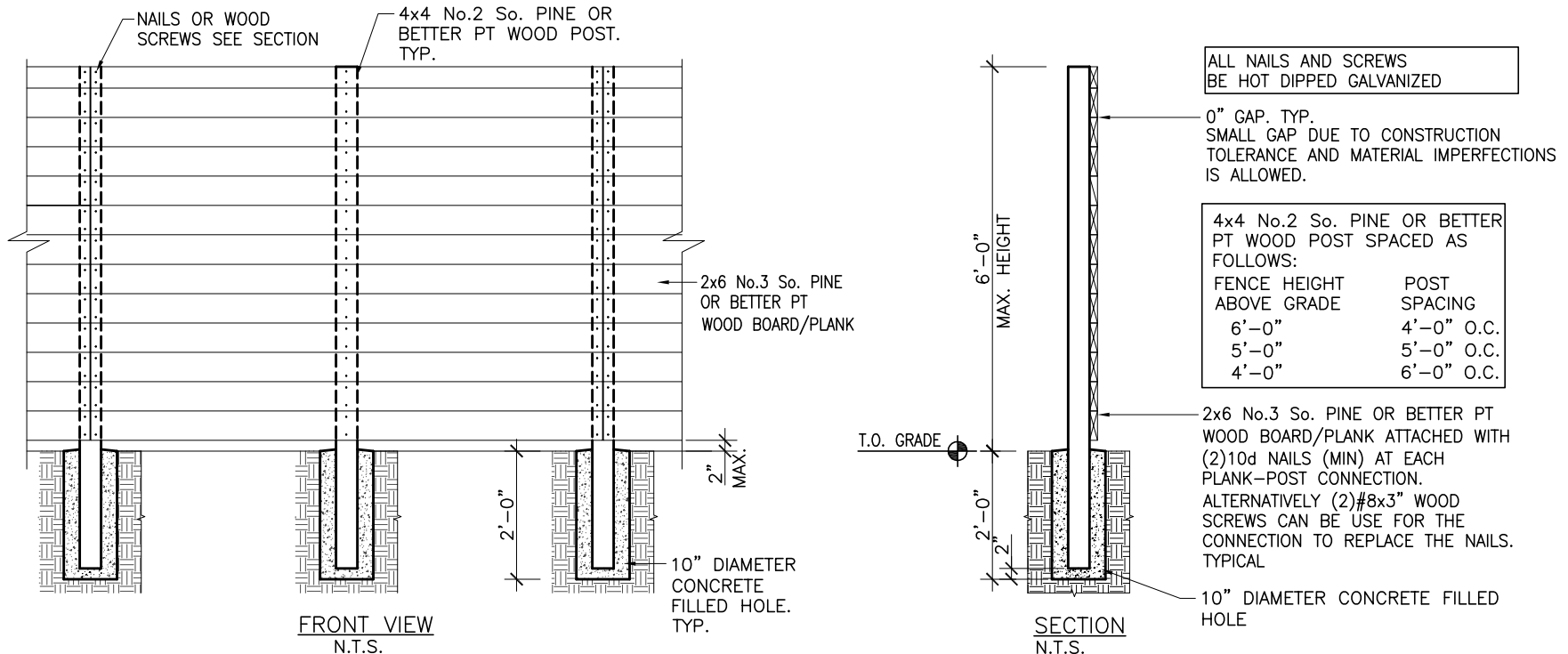

NOTE: POST FOUNDATION HOLE INSPECTION IS REQUIRED.